

HIP - 78

GENERAL CORRESPONDENCE

YEAR(S):

2022

ENERGY, MINERALS AND NATURAL RESOURCES DEPT.

-521

NO. 128126

Official Receipt

Received from: RC Phillips Tex. Oil Co.

Date: 8-13-02 19 02

Dollar Amount 250

DR CR.	AMOUNT NUMBER	CENTER NUMBER	CREDIT AMOUNT	DEPOSIT NUMBER	WORK ORDER NO.
60	42907				
60	4291				
60	3450				
60	3451				
60	3410				
60	4210				
60	4240				
60			100.00		
60			150.00		
60					
60					

TOTAL

250.00

By: [Signature]

ACKNOWLEDGEMENT OF RECEIPT
OF CHECK/CASH

I heraby acknowledge receipt of check No. 024572 dated 8-2-02,
or cash received on 8-13-02 in the amount of \$ 100.00
from Phillips ~~Tex~~ Texas Pipeline Co.

for Phillips Pipeline Company HI-078

Submitted by: Martynne Kiehn Date: 8-13-02

Submitted to ASD by: Martynne Kiehn Date: 8-13-02

Received in ASD by: _____ Date: _____

Filing Fee ☒ New Facility _____ Renewal _____

Modification _____ Other _____

Organization Code 521.07 Applicable FY 2002

To be deposited in the Water Quality Management Fund.

Full Payment ☒ or Annual Increment _____

THIS IS WATERMARKED PAPER - DO NOT ACCEPT WITHOUT NOTING WATERMARK - HOLD TO LIGHT TO VERIFY WATERMARK

ARVEST BANK

Phillips Texas Pipeline Co.
Bartlesville, OK 74004

91931

08/02/2002 024572 \$*****100.00*

PAY TO THE ORDER OF

EXACTLY ****100 US Dollars and 00 Cents****

NMED WATER QUALITY MANAGEMENT FUND
OIL CONSERVATION DIVISION
ENVIRONMENTAL BUREAU
1220 SOUTH SAINT FRANCIS DRIVE
SANTA FE, NM 87508

J. W. Smith
Treasurer

⑈00024572⑈ ⑆103100823⑆ 0040555⑈

ACKNOWLEDGEMENT OF RECEIPT
OF CHECK/CASH

I hereby acknowledge receipt of check No. 024571 ~~9773~~ dated 8-2-02
or cash received on 8-13-02 in the amount of \$ 150.00
from Phillips Texas Pipeline Co.
for Phillips Pipeline Company Hydrostatic test HI-078
Submitted by: Martyne Kiehl Date: 8-13-02
Submitted to ASD by: Martyne Kiehl Date: 8-13-02
Received in ASD by: _____ Date: _____

Filing Fee _____ New Facility _____ Renewal _____

Modification _____ Other Temporary Authorization

Organization Code 521.07 Applicable FY 2002

To be deposited in the Water Quality Management Fund.

Full Payment ✓ or Annual Increment _____

THIS IS WATERMARKED PAPER - DO NOT ACCEPT WITHOUT NOTING WATERMARK - HOLD TO LIGHT TO VERIFY WATERMARK

ARVEST BANK

Phillips Texas Pipeline Co.
Bartlesville, OK 74004

91931

08/02/2002 024571 \$*****150.00*

PAY TO THE ORDER OF

EXACTLY *****150 US Dollars and 00 Cents****

NMED WATER QUALITY MANAGEMENT FUND
OIL CONSERVATION DIVISION
ENVIRONMENTAL BUREAU
1220 SOUTH SAINT FRANCIS DRIVE
SANTA FE, NM 87508

J. W. Smith

Treasurer

"00024571" 103100823: 0040555"

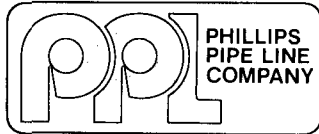

RECEIVED

August 7, 2002

AUG 12 2002
Environmental Bureau
Oil Conservation Division

**Permitting Fees
Hydrostatic Test Dewatering
Teppco-Hobbs
West Texas District – New Mexico**

Martyne Kieling
NM Oil Conservation Division
Environmental Bureau
1220 So. St. Francis Dr.
Santa Fe, NM 87508

VIA OVERNIGHT MAIL

Dear Ms. Kieling:

Phillips Pipe Line Company hereby submits two checks for fees associated with the hydrostatic test dewatering for the Teppco-Hobbs Line:

- Check Number 024571 in the amount of \$150.00 for the Temporary Permission Fees, and
- Check Number 024572 in the amount of \$100.00 for the Filing Fees.

If you have any questions regarding the information provided, please contact me at 918-661-3557 or at awalker@ppco.com.

Sincerely,

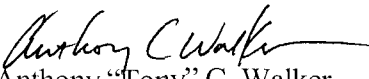
Anthony "Tony" C. Walker
Phillips Pipe Line Company
Staff Environmental Representative
3 B10 Adams Building

ACW: HydroAppFees.doc

cc: S. E. Maddox r. A. C. Walker r. File \
D. M. Schomp

DATE	INVOICE NO. (DESCR)	CO DOCUMENT NO.	GROSS	DISCOUNT	NET
07/31/02	PT 1200007049 USD		150.00	0.00	150.00
TEMPORARY	PERMISSION FEE				
	PAYEE NUMBER	CHECK DATE	CHECK NO	CHECK AMOUNT	
	91931	08/02/2002	024571	150.00	
If you have questions about this check, call (918)661-5746.					

DATE	INVOICE NO. (DESCR)	CO DOCUMENT NO.	GROSS	DISCOUNT	NET
07/31/02	PT 1200007050 USD		100.00	0.00	100.00
FILING FEE					
PAYEE NUMBER	CHECK DATE	CHECK NO	CHECK AMOUNT		
91931	08/02/2002	024572	100.00		

If you have questions about this check, call (918)661-5746.



July 25, 2002

**Permit Application
Hydrostatic Test Discharges
Used Pipeline – Teppco Hobbs**

Martyne Kieling
New Mexico Oil Conservation Division
Environmental Bureau
~~2040 South Pacheco~~ *1220 So. St Francis Drive*
Santa Fe, NM 87505

Dear Mrs. Kieling:

Phillips Pipe Line Company (PPL) submits this application for the discharge of water associated with the hydrostatic testing of a used pipeline.

- 1) The line name is Teppco Hobbs Lines.
- 2) The volume of water to be discharged is approximately 1400 barrels (58,800 gallons).
- 3) A map showing the location of the pipelines is attached. The line is described as follows: The lines are 6" and 8" lines that are in crude service. The location of the test is in Lea County. The lines run northwest and southeast. The retention and discharge location is at the southeast end of the line as indicated on the attached map.
- 4) A description of the test, including, if applicable, pigging and washing of the line prior to the hydrotest and disposition of the fluids and solids, is as follows: A pig was sent through the line for cleaning purposes. The pigged material was injected into our existing crude oil pipeline system. On the backside of the first pig was the hydrotest water. The hydro water was then followed with another pig. No solids were handled. The hydrotest water was discharged into frac tanks awaiting approval of discharge to the surface.
- 5) The source of the water for the test was fresh water from a fresh water hauler.
- 6) The point of discharge of the test water is about 3 miles south of Hobbs on Hwy 18 and 0.7 miles west, as indicated on the attached map.
- 7) The method and location for collection and retention of fluids and solids is as follows: The hydrostatic test has already been performed. The water has been moved from the line into frac tanks for disposal. The water will be discharged upon approval by the NMOCD.
- 8) The monitoring program for this discharge is as follows: An analysis for the water to be discharged is provided with this application. Based on the analysis, it is proposed that no further testing be required.
- 9) The available information on the depth and quality of ground water at the proposed discharge site is as follows: Not provided
- 10) The geological characteristics of the subsurface at the proposed discharge site are as follows: Not provided.
- 11) The test water and the solids will be disposed of in the following manner: The test water will be discharged to the ground with no possibility of entry into a surface water. No solids were generated to be handled from this hydrostatic test.
- 12) The landowner at the location of discharge and collection is Phillips Pipe Line Company.
- 13) The landowners adjacent to the location of the discharge and collection are as follows: The distance to adjacent landowners, combined with the volume of water to be discharged, is such that adjacent landowners will not be affected.
- 14) Permission has been granted from Phillips Pipe Line Company, the landowner at the location of the collection and retention site.

If you have questions concerning this application, please contact me at (918) 661-3557 or via email at awalker@ppco.com.

Sincerely,

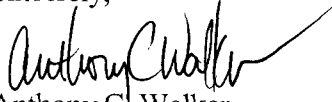

Anthony C. Walker
Phillips Pipe Line Company
Environmental Representative
3B10 Adams Bldg.

ACW: HydroAppUsed2.doc

cc: S. E. Maddox r. A. C. Walker r. File S11-001 (111.02)
Don Schomp

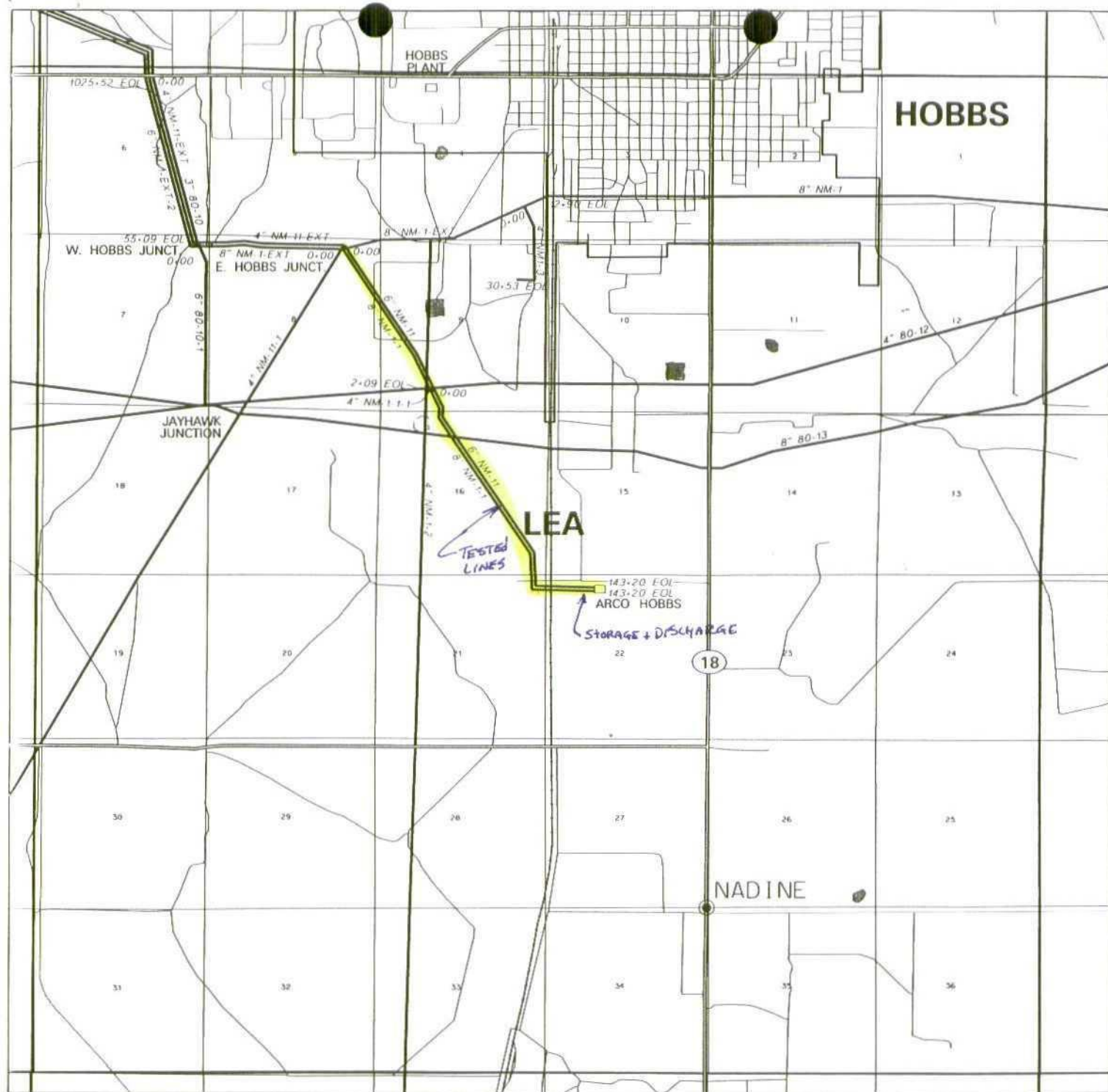

T19S R38E

LEGEND

- SWEET CRUDE LINES
- SOUR CRUDE LINES
- NGL LINES
- PRIMARY PAVED ROADS
- SECONDARY PAVED ROADS
- LIGHT DUTY ROADS (GRAVEL, DIRT, ETC.)
- CREEKS, RIVERS, LAKES





PHONE (915) 673-7001 • 2111 BEECHWOOD • ABILENE, TX 79603

PHONE (505) 393-2326 • 101 E. MARLAND • HOBBS, NM 88240

ANALYTICAL RESULTS FOR
PHILLIPS PIPELINE
ATTN: DON SCHOMP
2200 W. 34th
ODESSA, TX 79764
FAX TO: (915)368-6551

Receiving Date: 03/26/02
Reporting Date: 04/02/02
Project Number: NOT GIVEN
Project Name: TEPPCO/HOBBS INTERNAL INSP.
Project Location: TEPPCO/HOBBS LINES

Sampling Date: 03/26/02
Sample Type: WATER
Sample Condition: COOL & INTACT
Sample Received By: BC
Analyzed By: AH

LAB NUMBER	SAMPLE ID	Na (mg/L)	Ca (mg/L)	Mg (mg/L)	K (mg/L)	Conductivity (mS/cm)	T-Alkalinity (mgCaCO ₃ /L)
------------	-----------	--------------	--------------	--------------	-------------	-------------------------	--

ANALYSIS DATE:	04/02/02	04/01/02	04/01/02	04/01/02	04/02/02	04/01/02
H6622-1	45	123	27	8.22	1363	147
Quality Control	NR	55	49	5.27	1489	NR
True Value QC	NR	50	50	5.00	1413	NR
% Recovery	NR	110	97.2	105	105	NR
Relative Percent Difference	NR	0	6.0	0	0.3	NR

METHODS:	SM3500-Ca-D	3500-Mg E	8049	120.1	310.1
----------	-------------	-----------	------	-------	-------

	Cl ⁻ (mg/L)	SO ₄ (mg/L)	CO ₃ (mg/L)	HCO ₃ (mg/L)	pH (s.u.)	TDS (mg/L)
ANALYSIS DATE:	04/01/02	04/01/02	04/01/02	04/01/02	04/02/02	04/02/02
H6622-1	196	99	0	179	7.59	819
Quality Control	1040	52.66	NR	975	7.00	NR
True Value QC	1000	50.00	NR	1000	7.00	NR
% Recovery	104	105	NR	97.5	100	NR
Relative Percent Difference	1.0	0.6	NR	2.7	0.1	8.5

METHODS:	SM4500-Cl-B	375.4	310.1	310.1	150.1	160.1
----------	-------------	-------	-------	-------	-------	-------

Chemist

Date

PLEASE NOTE: Liability and Damages. Cardinal's liability and client's exclusive remedy for any claim arising, whether based in contract or tort, shall be limited to the amount paid by client for analyses. All claims, including those for negligence and any other cause whatsoever shall be deemed waived unless made in writing and received by Cardinal within thirty (30) days after completion of the applicable service. In no event shall Cardinal be liable for incidental or consequential damages, including, without limitation, business interruptions, loss of use, or loss of profits incurred by client, its subsidiaries, affiliates or successors arising out of or related to the performance of services hereunder by Cardinal, regardless of whether such claim is based upon any of the above-stated reasons or otherwise.

H6622



ANALYTICAL RESULTS FOR
 PHILLIPS PIPELINE
 ATTN: DON SCHOMP
 2200 W. 34th
 ODESSA, TX 79764

Receiving Date: 03/26/02

Reporting Date: 04/05/02

Project Number: NOT GIVEN

Project Name: TEPPCO/HOBBS INTERNAL INSP.

Project Location: TEPPCO/HOBBS LINES

FAX TO: (915)368-6551

Sampling Date: 03/26/02

Sample Type: WATER

Sample Condition: COOL & INTACT

Sample Received By: BC

Analyzed By: AH

TOTAL METALS

LAB NUMBER SAMPLE ID

As	Ba	Cd	Fe	Hg
(ppm)	(ppm)	(ppm)	(ppm)	(ppm)

ANALYSIS DATE:	04/04/02	04/04/02	04/04/02	04/04/02	04/04/02
H6622-1	<0.1	<0.5	<0.01	<0.5	<0.002
Quality Control	0.057	24.48	1.048	4.984	0.00951
True Value QC	0.050	25.00	1.000	5.000	0.01000
% Recovery	114	97.9	105	99.7	95.1
Relative Percent Difference	1.8	3.8	0.4	0.1	4.9

METHODS: 600/4-79-020	206.2	208.1	213.1	236.1	245.1
-----------------------	-------	-------	-------	-------	-------

Mn	Pb	Se	Zn
(ppm)	(ppm)	(ppm)	(ppm)

ANALYSIS DATE:	04/04/02	04/04/02	04/04/02	04/04/02
H6622-1	0.437	<0.05	<0.05	<0.5
Quality Control	4.983	5.052	0.054	0.503
True Value QC	5.000	5.000	0.050	0.500
% Recovery	99.7	101	108	100
Relative Percent Difference	0.1	0.8	1.9	0.7

METHODS: 600/4-79-020	243.1	239.1	270.2	289.1
-----------------------	-------	-------	-------	-------

Chemist

Date

PLEASE NOTE: Liability and Damages. Cardinal's liability and client's exclusive remedy for any claim arising, whether based in contract or tort, shall be limited to the amount paid by client for analyses. All claims, including those for negligence and any other cause whatsoever shall be deemed waived unless made in writing and received by Cardinal within thirty (30) days after completion of the applicable service. In no event shall Cardinal be liable for incidental or consequential damages, including, without limitation, business interruptions, loss of use, or loss of profits incurred by client, its subsidiaries, affiliates or successors arising out of or related to the performance of services hereunder by Cardinal, regardless of whether such claim is based upon any of the above-stated reasons or otherwise.

h6622m



ANALYTICAL RESULTS FOR
 PHILLIPS PIPELINE
 ATTN: DON SCHOMP
 2200 W. 34th

Receiving Date: 03/26/02

Reporting Date: 04/03/02

Project Number: NOT GIVEN

Project Name: TEPPCO/HOBBS INTERNAL INSP.

Project Location: TEPPCO/HOBBS LINES

Lab Number: H6622-1

Sample ID: -

ODESSA, TX 79764

FAX TO: (915) 368-6551

Analysis Date: 04/01/02

Sampling Date: 03/26/02

Sample Type: GROUNDWATER

Sample Condition: COOL & INTACT

Sample Received By: AH

Analyzed By: BC

POLYNUCLEAR AROMATIC

HYDROCARBON - 8270 (mg/L)

	Sample Result	Method Blank	QC	% Recov.	True Value QC
1 Naphthalene	0.00016	<0.00009	0.035	70	0.050
2 Acenaphthylene	<0.00015	<0.00015	0.037	74	0.050
3 Acenaphthene	<0.00012	<0.00012	0.040	80	0.050
4 Fluorene	0.00010	<0.00009	0.039	78	0.050
5 Phenanthrene	0.00052	<0.00011	0.040	80	0.050
6 Anthracene	<0.00021	<0.00021	0.040	80	0.050
7 Fluoranthene	<0.00011	<0.00011	0.039	78	0.050
8 Pyrene	<0.00029	<0.00029	0.040	80	0.050
9 Benzo(a)anthracene	<0.00028	<0.00028	0.038	76	0.050
10 Chrysene	<0.00046	<0.00046	0.039	78	0.050
11 Benzo(b)fluoranthene	<0.00023	<0.00023	0.043	86	0.050
12 Benzo(k)fluoranthene	<0.00070	<0.00070	0.044	88	0.050
13 Benzo(a)pyrene	<0.00009	<0.00009	0.042	84	0.050
14 Indeno(1,2,3-cd)pyrene	<0.00027	<0.00027	0.042	84	0.050
15 Dibenzo(a,h)anthracene	<0.00012	<0.00012	0.042	84	0.050
16 Benzo(g,h,i)perylene	<0.00037	<0.00037	0.040	80	0.050

% Recovery

17 Nitrobenzene-d5	63
18 2-Fluorobiphenyl	65
19 Terphenyl-d14	66

METHODS: EPA SW-846 8270, 3510, and gc/ms with Selected Ion Monitoring (SIM).

NOTES: Detection limits are MDLs for SIM, determined as per SW-846, Ch. 1, Sec. 5.0, p. 25.

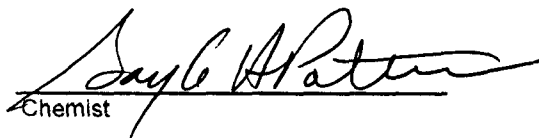
 Chemist

 04/05/2002
 Date

PLEASE NOTE: Liability and Damages. Cardinal's liability and client's exclusive remedy for any claim arising, whether based in contract or tort, shall be limited to the amount paid by client for analyses. All claims, including those for negligence and any other cause whatsoever shall be deemed waived unless made in writing and received by Cardinal within thirty (30) days after completion of the applicable service. In no event shall Cardinal be liable for incidental or consequential damages, including, without limitation, business interruptions, loss of use, or loss of profits incurred by client, its subsidiaries, affiliates or successors arising out of or related to the performance of services hereunder by Cardinal, regardless of whether such claim is based upon any of the above-stated reasons or otherwise.

H6622P.XLS





ARDINAL LABORATORIES

PHONE (915) 873-7001 • 2111 BEECHWOOD • ABILENE, TX 79603

PHONE (505) 393-2326 • 101 E. MARLAND • HOBBS, NM 88240

ANALYTICAL RESULTS FOR
PHILLIPS PIPELINE
ATTN: DON SCHOMP
2200 W. 34th
ODESSA, TX 79764
FAX TO: (915) 368-6551

Receiving Date: 03/26/02
Reporting Date: 04/03/02
Project Number: NOT GIVEN
Project Name: TEPPCO/HOBBS INTERNAL INSP.
Project Location: TEPPCO/HOBBS LINES

Sampling Date: 03/26/02
Sample Type: GROUNDWATER
Sample Condition: COOL & INTACT
Sample Received By: AH
Analyzed By: BC

LAB NUMBER	SAMPLE ID	BENZENE (mg/L)	TOLUENE (mg/L)	ETHYL BENZENE (mg/L)	TOTAL XYLENES (mg/L)
ANALYSIS DATE		04/01/02	04/01/02	04/01/02	04/01/02
H6622-1	-	<0.002	<0.002	<0.002	<0.006
Quality Control		0.109	0.107	0.111	0.315
True Value QC		0.100	0.100	0.100	0.300
% Recovery		109	107	111	105
Relative Percent Difference		1.3	1.9	2.4	1.4

METHOD: EPA SW-846 8260

Chemist

04/05/2002
Date

PLEASE NOTE: Liability and Damages. Cardinal's liability and client's exclusive remedy for any claim arising, whether based in contract or tort, shall be limited to the amount paid by client for analyses. All claims, including those for negligence and any other cause whatsoever shall be deemed waived unless made in writing and received by Cardinal within thirty (30) days after completion of the applicable service. In no event shall Cardinal be liable for incidental or consequential damages, including, without limitation, business interruptions, loss of use, or loss of profits incurred by client, its subsidiaries, affiliates or successors arising out of or related to the performance of services hereunder by Cardinal, regardless of whether such claim is based upon any of the above-stated reasons or otherwise.

H6622B.XLS



2111 Beechwood, Abilene, TX 79603 101 East Marland, Hobbs, NM 88240
(915) 673-7001 Fax (915) 673-7020 (505) 393-2326 Fax (505) 393-2476

Page ____ of ____

[illegible]



Date: 7-26-2002

FACSIMILE TRANSMISSION COVER SHEET

THIS TELECOPY IS INTENDED FOR THE SOLE USE OF THE PERSON TO WHOM IT IS SPECIFICALLY ADDRESSED AND SHOULD NOT BE READ BY, OR DELIVERED TO, ANYONE ELSE. It may contain privileged or confidential information, the disclosure of which may result in the breach of certain laws or the infringement of rights of third parties. If you have received this telecopy in error, please call immediately (collect if necessary) at the number below. We thank you for your cooperation and assistance.

To: Martyne Kieling

phone: 505-476-3488

fax: 505-476-3462

From: Tony Walker

address: 3B10 Adams Building
Bartlesville, OK 74004
phone: (918)661-3557
fax: (918)662-5464

RE: Permit to Discharge Hydrostatic Test Waters

COMMENTS: Martyne, Per our conversation, I am providing an application
(including test results, location, etc.) from water generated from a hydro test that is being
stored in frac tanks awaiting discharge approval. Please give me a call at your earliest
convenience regarding the approval of this discharge.

Thanks for your assistance.

1
ony
Walker

*Original will follow
via USPS.
AW*

Page(s) to follow: 8



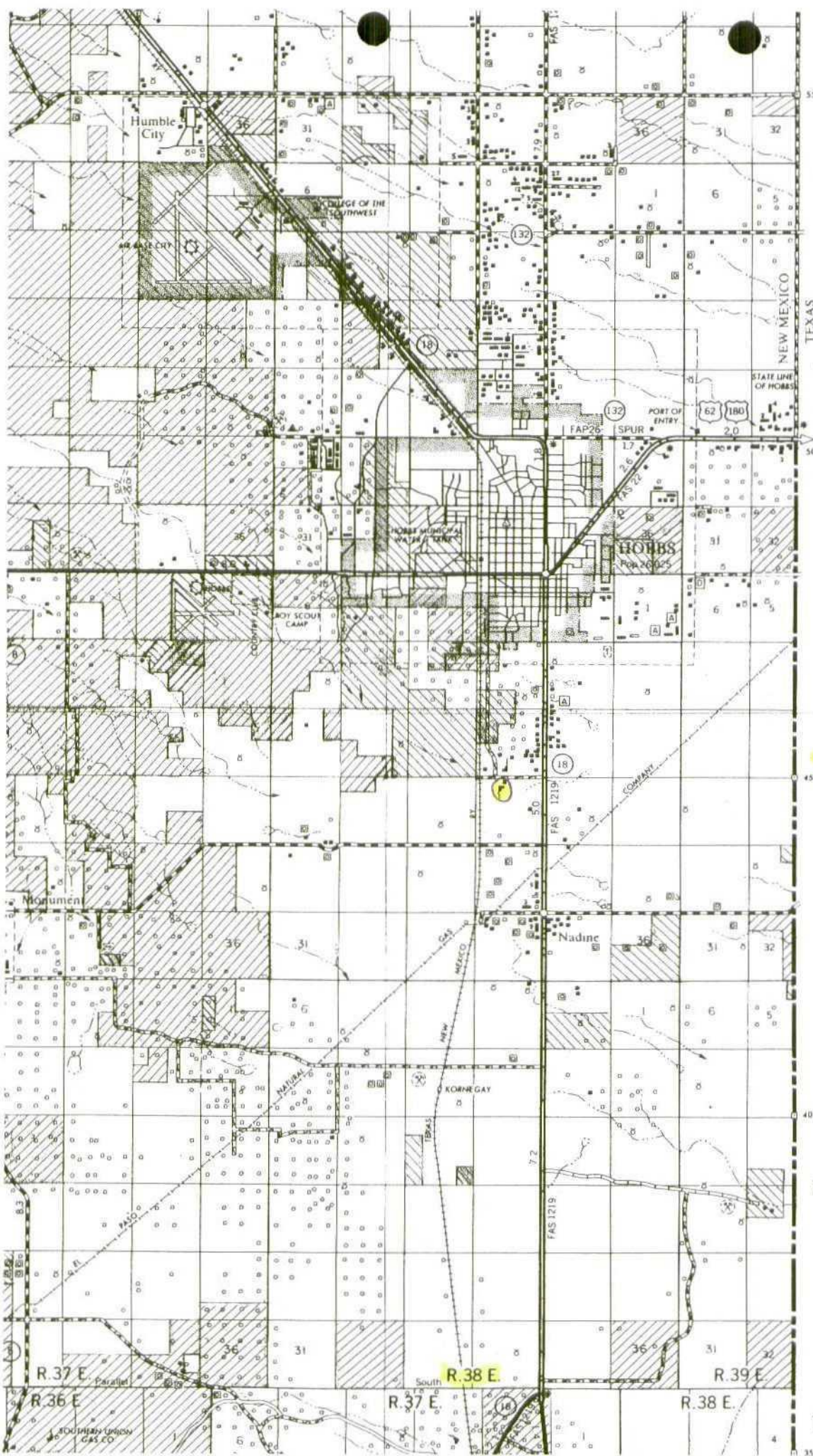

T.18 S.

T.19 S.

T.20 S.

T.21 S.

To Seminole, Tex.

GW ~ 50' Feet

40'

Date: 7-26-2002

FACSIMILE TRANSMISSION COVER SHEET

THIS TELECOPY IS INTENDED FOR THE SOLE USE OF THE PERSON TO WHOM IT IS SPECIFICALLY ADDRESSED AND SHOULD NOT BE READ BY, OR DELIVERED TO, ANYONE ELSE. It may contain privileged or confidential information, the disclosure of which may result in the breach of certain laws or the infringement of rights of third parties. If you have received this telecopy in error, please call immediately (collect if necessary) at the number below. We thank you for your cooperation and assistance.

To: Martyne Kielingphone: 505-476-3488fax: 505-476-3462From: Tony Walkeraddress: 3B10 Adams Building
Bartlesville, OK 74004phone: (918)661-3557fax: (918)662-5464RE: Permit to Discharge Hydrostatic Test Waters

COMMENTS: Martyne, Per our conversation, I am providing an application
(including test results, location, etc.) from water generated from a hydro test that is being
stored in frac tanks awaiting discharge approval. Please give me a call at your earliest
convenience regarding the approval of this discharge.

Thanks for your assistance.

Tony

*Original will follow
via USPS.
HW*

Page(s) to follow: 8



July 25, 2002

**Permit Application
Hydrostatic Test Discharges
Used Pipeline – Teppco Hobbs**

Martyne Kieling
New Mexico Oil Conservation Division
Environmental Bureau
2040 South Pacheco
Santa Fe, NM 87505

Dear Mrs. Kieling:

Phillips Pipe Line Company (PPL) submits this application for the discharge of water associated with the hydrostatic testing of a used pipeline.

- 1) The line name is Teppco Hobbs Lines.
- 2) The volume of water to be discharged is approximately 1400 barrels (58,800 gallons).
- 3) A map showing the location of the pipelines is attached. The line is described as follows: The lines are 6" and 8" lines that are in crude service. The location of the test is in Lea County. The lines run northwest and southeast. The retention and discharge location is at the southeast end of the line as indicated on the attached map.
- 4) A description of the test, including, if applicable, pigging and washing of the line prior to the hydrotest and disposition of the fluids and solids, is as follows: A pig was sent through the line for cleaning purposes. The pigged material was injected into our existing crude oil pipeline system. On the backside of the first pig was the hydrotest water. The hydro water was then followed with another pig. No solids were handled. The hydrotest water was discharged into frac tanks awaiting approval of discharge to the surface.
- 5) The source of the water for the test was fresh water from a fresh water hauler.
- 6) The point of discharge of the test water is about 3 miles south of Hobbs on Hwy 18 and 0.7 miles west, as indicated on the attached map.
- 7) The method and location for collection and retention of fluids and solids is as follows: The hydrostatic test has already been performed. The water has been moved from the line into frac tanks for disposal. The water will be discharged upon approval by the NMOCD.
- 8) The monitoring program for this discharge is as follows: An analysis for the water to be discharged is provided with this application. Based on the analysis, it is proposed that no further testing be required.
- 9) The available information on the depth and quality of ground water at the proposed discharge site is as follows: Not provided
- 10) The geological characteristics of the subsurface at the proposed discharge site are as follows: Not provided.
- 11) The test water and the solids will be disposed of in the following manner: The test water will be discharged to the ground with no possibility of entry into a surface water. No solids were generated to be handled from this hydrostatic test.
- 12) The landowner at the location of discharge and collection is Phillips Pipe Line Company.
- 13) The landowners adjacent to the location of the discharge and collection are as follows: The distance to adjacent landowners, combined with the volume of water to be discharged, is such that adjacent landowners will not be affected.
- 14) Permission has been granted from Phillips Pipe Line Company, the landowner at the location of the collection and retention site.

If you have questions concerning this application, please contact me at (918) 661-3557 or via email at awalker@ppco.com.

Sincerely,

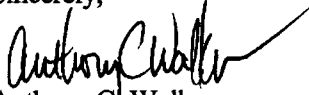

Anthony C. Walker
Phillips Pipe Line Company
Environmental Representative
3B10 Adams Bldg.

ACW: HydroAppUsed2.doc

cc: S. E. Maddox r. A. C. Walker r. File S11-001 (111.02)
Don Schomp

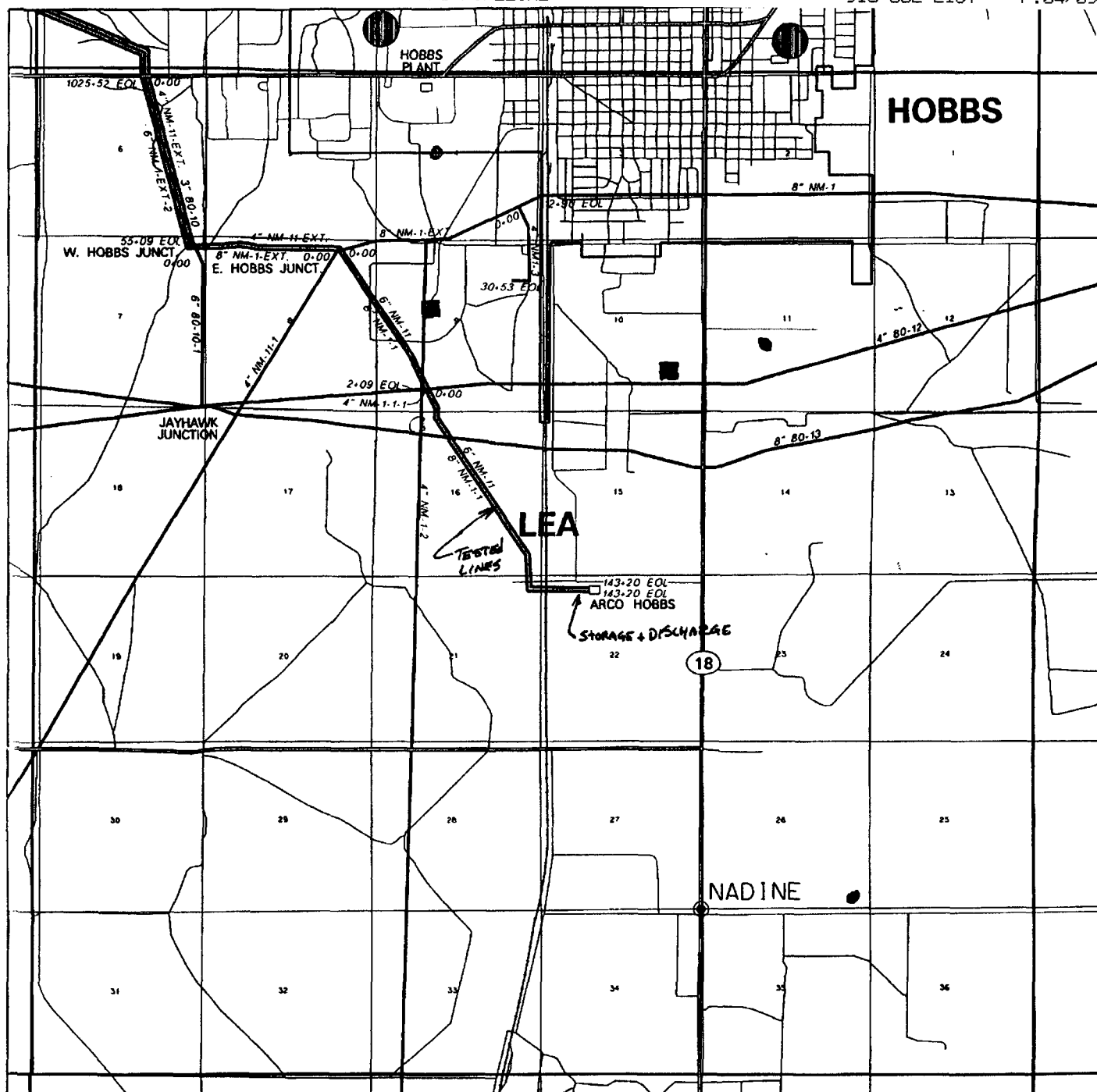
**T19S R38E****LEGEND**

- SWEET CRUDE LINES
- SOUR CRUDE LINES
- NGL LINES
- PRIMARY PAVED ROADS
- SECONDARY PAVED ROADS
- LIGHT DUTY ROADS (GRAVEL, DIRT, ETC.)
- ~ CREEKS, RIVERS, LAKES

ARDINAL
LABORATORIES

PHONE (915) 873-7001 • 2111 BEECHWOOD • ABILENE, TX 79603

PHONE (505) 393-2326 • 101 E. MARLAND • HOBBS, NM 88240

ANALYTICAL RESULTS FOR
 PHILLIPS PIPELINE
 ATTN: DON SCHOMP
 2200 W. 34th
 ODESSA, TX 79764
 FAX TO: (915)368-6551

Receiving Date: 03/26/02
 Reporting Date: 04/02/02
 Project Number: NOT GIVEN
 Project Name: TEPPCO/HOBBS INTERNAL INSP.
 Project Location: TEPPCO/HOBBS LINES

Sampling Date: 03/26/02
 Sample Type: WATER
 Sample Condition: COOL & INTACT
 Sample Received By: BC
 Analyzed By: AH

LAB NUMBER	SAMPLE ID	Na (mg/L)	Ca (mg/L)	Mg (mg/L)	K (mg/L)	Conductivity (mS/cm)	T-Alkalinity (mgCaCO ₃ /L)
------------	-----------	--------------	--------------	--------------	-------------	-------------------------	--

ANALYSIS DATE:	04/02/02	04/01/02	04/01/02	04/01/02	04/02/02	04/01/02
H6622-1	45	123	27	8.22	1363	147
Quality Control	NR	55	49	5.27	1489	NR
True Value QC	NR	50	50	5.00	1413	NR
% Recovery	NR	110	97.2	105	105	NR
Relative Percent Difference	NR	0	6.0	0	0.3	NR

METHODS:	SM3500-Ca-D	3500-Mg E	8049	120.1	310.1
----------	-------------	-----------	------	-------	-------

Cl ⁻ (mg/L)	SO ₄ (mg/L)	CO ₃ (mg/L)	HCO ₃ (mg/L)	pH (s.u.)	TDS (mg/L)
---------------------------	---------------------------	---------------------------	----------------------------	--------------	---------------

ANALYSIS DATE:	04/01/02	04/01/02	04/01/02	04/01/02	04/02/02	04/02/02
H6622-1	196	99	0	179	7.59	819
Quality Control	1040	52.66	NR	975	7.00	NR
True Value QC	1000	50.00	NR	1000	7.00	NR
% Recovery	104	105	NR	97.5	100	NR
Relative Percent Difference	1.0	0.6	NR	2.7	0.1	8.5

METHODS:	SM4500-Cl-B	375.4	310.1	310.1	150.1	160.1
----------	-------------	-------	-------	-------	-------	-------

Don Schomp
 Chemist

04/05/2002
 Date

PLEASE NOTE: Liability and Damages. Cardinal's liability and client's exclusive remedy for any claim arising, whether based in contract or tort, shall be limited to the amount paid by client for analyses. All claims, including those for negligence and any other cause whatsoever shall be deemed waived unless made in writing and received by Cardinal within thirty (30) days after completion of the applicable service. In no event shall Cardinal be liable for incidental or consequential damages, including, without limitation, business interruptions, loss of use, or loss of profits incurred by client, its subsidiaries, affiliates or successors arising out of or related to the performance of services hereunder by Cardinal, regardless of whether such claim is based upon any of the above-stated reasons or otherwise.

H6622

ARDINAL
LABORATORIES

PHONE (915) 673-7001 • 2111 BEECHWOOD • ABILENE, TX 79603

PHONE (505) 393-2326 • 101 E. MARLAND • HOBBS, NM 88240

ANALYTICAL RESULTS FOR
 PHILLIPS PIPELINE
 ATTN: DON SCHOMP
 2200 W. 34th
 ODESSA, TX 79764

Receiving Date: 03/26/02

Reporting Date: 04/05/02

Project Number: NOT GIVEN

Project Name: TEPPCO/HOBBS INTERNAL INSP.

Project Location: TEPPCO/HOBBS LINES

FAX TO: (915)368-6551

Sampling Date: 03/26/02

Sample Type: WATER

Sample Condition: COOL & INTACT

Sample Received By: BC

Analyzed By: AH

TOTAL METALS

LAB NUMBER SAMPLE ID

As Ba Cd Fe Hg
 (ppm) (ppm) (ppm) (ppm) (ppm)

ANALYSIS DATE:	04/04/02	04/04/02	04/04/02	04/04/02	04/04/02
H6622-1	<0.1	<0.5	<0.01	<0.5	<0.002
Quality Control	0.057	24.48	1.048	4.984	0.00951
True Value QC	0.050	25.00	1.000	5.000	0.01000
% Recovery	114	97.9	105	99.7	95.1
Relative Percent Difference	1.8	3.8	0.4	0.1	4.9

METHODS: 600/4-79-020	206.2	208.1	213.1	236.1	245.1
-----------------------	-------	-------	-------	-------	-------

Mn Pb Se Zn
 (ppm) (ppm) (ppm) (ppm)

ANALYSIS DATE:	04/04/02	04/04/02	04/04/02	04/04/02
H6622-1	0.437	<0.05	<0.05	<0.5
Quality Control	4.983	5.052	0.054	0.503
True Value QC	5.000	5.000	0.050	0.500
% Recovery	99.7	101	108	100
Relative Percent Difference	0.1	0.8	1.9	0.7

METHODS: 600/4-79-020	243.1	239.1	270.2	289.1
-----------------------	-------	-------	-------	-------

 Chemist

 Date

PLEASE NOTE: Liability and Damages. Cardinal's liability and client's exclusive remedy for any claim arising, whether based in contract or tort, shall be limited to the amount paid by client for analyses. All claims, including those for negligence and any other cause whatsoever shall be deemed waived unless made in writing and received by Cardinal within thirty (30) days after completion of the applicable service. In no event shall Cardinal be liable for incidental or consequential damages, including, without limitation, business interruptions, loss of use, or loss of profits incurred by client, its subsidiaries, affiliates or successors arising out of or related to the performance of services hereunder by Cardinal, regardless of whether such claim is based upon any of the above-stated reasons or otherwise.

h6622m

ARDINAL
LABORATORIES

PHONE (915) 673-7001 • 2111 BEECHWOOD • ABILENE, TX 79603

PHONE (505) 393-2326 • 101 E. MARLAND • HOBBS, NM 88240

ANALYTICAL RESULTS FOR

PHILLIPS PIPELINE

ATTN: DON SCHOMP

2200 W. 34th

ODESSA, TX 79784

FAX TO: (915) 368-6551

Receiving Date: 03/26/02

Reporting Date: 04/03/02

Project Number: NOT GIVEN

Project Name: TEPPCO/HOBBS INTERNAL INSP.

Project Location: TEPPCO/HOBBS LINES

Lab Number: H6622-1

Sample ID: -

Analysis Date: 04/01/02

Sampling Date: 03/26/02

Sample Type: GROUNDWATER

Sample Condition: COOL & INTACT

Sample Received By: AH

Analyzed By: BC

POLYNUCLEAR AROMATIC

HYDROCARBON - 8270 (mg/L)

	Sample Result	Method Blank	QC	% Recov.	True Value QC
1 Naphthalene	0.00018	<0.00009	0.035	70	0.050
2 Acenaphthylene	<0.00015	<0.00015	0.037	74	0.050
3 Acenaphthene	<0.00012	<0.00012	0.040	80	0.050
4 Fluorene	0.00010	<0.00009	0.039	78	0.050
5 Phenanthrene	0.00052	<0.00011	0.040	80	0.050
6 Anthracene	<0.00021	<0.00021	0.040	80	0.050
7 Fluoranthene	<0.00011	<0.00011	0.039	78	0.050
8 Pyrene	<0.00029	<0.00029	0.040	80	0.050
9 Benzo(a)anthracene	<0.00028	<0.00028	0.038	76	0.050
10 Chrysene	<0.00046	<0.00046	0.039	78	0.050
11 Benzo(b)fluoranthene	<0.00023	<0.00023	0.043	86	0.050
12 Benzo(k)fluoranthene	<0.00070	<0.00070	0.044	88	0.050
13 Benzo(a)pyrene	<0.00009	<0.00009	0.042	84	0.050
14 Indeno(1,2,3-cd)pyrene	<0.00027	<0.00027	0.042	84	0.050
15 Dibenzo(a,h)anthracene	<0.00012	<0.00012	0.042	84	0.050
16 Benzo(g,h,i)perylene	<0.00037	<0.00037	0.040	80	0.050

% Recovery

17 Nitrobenzene-d5	63
18 2-Fluorobiphenyl	65
19 Terphenyl-d14	66

METHODS: EPA SW-846 8270, 3510, and gc/ms with Selected Ion Monitoring (SIM).

NOTES: Detection limits are MDLs for SIM, determined as per SW-846, Ch. 1, Sec. 5.0, p. 25.

Dayle A. Patton
 Chemist

04/05/2002
 Date

PLEASE NOTE: Liability and Damages. Cardinal's liability and client's exclusive remedy for any claim arising, whether based in contract or tort, shall be limited to the amount paid by client for analyses. All claims, including those for negligence and any other cause whatsoever shall be deemed waived unless made in writing and received by Cardinal within thirty (30) days after completion of the applicable service. In no event shall Cardinal be liable for incidental or consequential damages, including, without limitation, business interruptions, loss of use, or loss of profits incurred by client, its subsidiaries, affiliates or successors arising out of or related to the performance of services hereunder by Cardinal, regardless of whether such claim is based upon any of the above-stated reasons or otherwise.

H6622P.XLS

ARDINAL
LABORATORIES

PHONE (915) 873-7001 • 2111 BEECHWOOD • ABILENE, TX 79603

PHONE (505) 393-2328 • 101 E. MARLAND • HOBBS, NM 88240

ANALYTICAL RESULTS FOR
 PHILLIPS PIPELINE
 ATTN: DON SCHOMP
 2200 W. 34th
 ODESSA, TX 79764
 FAX TO: (915) 368-6551

Receiving Date: 03/26/02
 Reporting Date: 04/03/02
 Project Number: NOT GIVEN
 Project Name: TEPPCO/HOBBS INTERNAL INSP.
 Project Location: TEPPCO/HOBBS LINES

Sampling Date: 03/28/02
 Sample Type: GROUNDWATER
 Sample Condition: COOL & INTACT
 Sample Received By: AH
 Analyzed By: BC

LAB NUMBER	SAMPLE ID	BENZENE (mg/L)	TOLUENE (mg/L)	ETHYL BENZENE (mg/L)	TOTAL XYLENES (mg/L)
ANALYSIS DATE		04/01/02	04/01/02	04/01/02	04/01/02
H6622-1	-	<0.002	<0.002	<0.002	<0.006
Quality Control		0.109	0.107	0.111	0.315
True Value QC		0.100	0.100	0.100	0.300
% Recovery		109	107	111	105
Relative Percent Difference		1.3	1.9	2.4	1.4

METHOD: EPA SW-846 8260

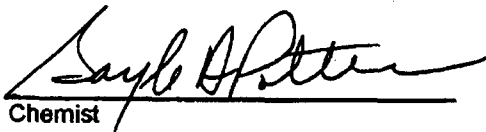
 Chemist

04/05/2002
 Date

PLEASE NOTE: **Liability and Damages.** Cardinal's liability and client's exclusive remedy for any claim arising, whether based in contract or tort, shall be limited to the amount paid by client for analyses. All claims, including those for negligence and any other cause whatsoever shall be deemed waived unless made in writing and received by Cardinal within thirty (30) days after completion of the applicable service. In no event shall Cardinal be liable for incidental or consequential damages, including, without limitation, business interruptions, loss of use, or loss of profits incurred by client, its subsidiaries, affiliates or successors arising out of or related to the performance of services hereunder by Cardinal, regardless of whether such claim is based upon any of the above-stated reasons or otherwise.

H6622B.XLS

CHAIN-OF-CUSTODY AND ANALYSIS REQUEST

Page of

ARDINAL LABORATORIES, INC.

22111 Beechwood, Abilene, TX 79603 101 East Marland, Hobbs, NM 88240
(915) 673-7001 Fax (915) 673-7020 (505) 393-2326 Fax (505) 393-2476

Company Name: Ph. H. J. S. P. po Line Project Manager: Don Schamp Address: 2200 W. 34th City: Odeessa State: TX Zip: 79764 Phone #: 915-556-9040 Fax #: 915-368-6551		PO #:	
Project #:		Project Owner:	
Project Name: Tepper/Hobbs Interval Insp.		Project Location: Tepper/Hobbs Lines	

FOR LAB USE ONLY		Sample I.D.	
LAB I.D.	N6622-1	Sample I.D.	

FOR LAB USE ONLY		Sample I.D.	
LAB I.D.	N6622-1	Sample I.D.	

FOR LAB USE ONLY		Sample I.D.	
LAB I.D.	N6622-1	Sample I.D.	

FOR LAB USE ONLY		Sample I.D.	
LAB I.D.	N6622-1	Sample I.D.	

FOR LAB USE ONLY		Sample I.D.	
LAB I.D.	N6622-1	Sample I.D.	

FOR LAB USE ONLY		Sample I.D.	
LAB I.D.	N6622-1	Sample I.D.	

FOR LAB USE ONLY		Sample I.D.	
LAB I.D.	N6622-1	Sample I.D.	

FOR LAB USE ONLY		Sample I.D.	
LAB I.D.	N6622-1	Sample I.D.	

FOR LAB USE ONLY		Sample I.D.	
LAB I.D.	N6622-1	Sample I.D.	

FOR LAB USE ONLY		Sample I.D.	
LAB I.D.	N6622-1	Sample I.D.	

FOR LAB USE ONLY		Sample I.D.	
LAB I.D.	N6622-1	Sample I.D.	

FOR LAB USE ONLY		Sample I.D.	
LAB I.D.	N6622-1	Sample I.D.	

FOR LAB USE ONLY		Sample I.D.	
LAB I.D.	N6622-1	Sample I.D.	

FOR LAB USE ONLY		Sample I.D.	
LAB I.D.	N6622-1	Sample I.D.	

FOR LAB USE ONLY		Sample I.D.	
LAB I.D.	N6622-1	Sample I.D.	

FOR LAB USE ONLY		Sample I.D.	
LAB I.D.	N6622-1	Sample I.D.	

FOR LAB USE ONLY		Sample I.D.	
LAB I.D.	N6622-1	Sample I.D.	

FOR LAB USE ONLY		Sample I.D.	
LAB I.D.	N6622-1	Sample I.D.	

FOR LAB USE ONLY		Sample I.D.	
LAB I.D.	N6622-1	Sample I.D.	

FOR LAB USE ONLY		Sample I.D.	
LAB I.D.	N6622-1	Sample I.D.	

FOR LAB USE ONLY		Sample I.D.	
LAB I.D.	N6622-1	Sample I.D.	

FOR LAB USE ONLY		Sample I.D.	
LAB I.D.	N6622-1	Sample I.D.	

FOR LAB USE ONLY		Sample I.D.	
LAB I.D.	N6622-1	Sample I.D.	

FOR LAB USE ONLY		Sample I.D.	
LAB I.D.	N6622-1	Sample I.D.	

FOR LAB USE ONLY		Sample I.D.	
LAB I.D.	N6622-1	Sample I.D.	

||
||
||