

**GW - 108**

**PERMITS,  
RENEWALS,  
& MODS  
Application**

District I  
1625 N. French Dr., Hobbs, NM 88240  
District II  
1301 W. Grand Avenue, Artesia, NM 88210  
District III  
1000 Rio Brazos Road, Aztec, NM 87410  
District IV  
1220 S. St. Francis Dr., Santa Fe, NM 87505

State of New Mexico  
Energy Minerals and Natural Resources

Revised June 10, 2003

Oil Conservation Division  
1220 South St. Francis Dr.  
Santa Fe, NM 87505

Submit Original  
Plus 1 Copy  
to Santa Fe  
1 Copy to Appropriate  
District Office

**DISCHARGE PLAN APPLICATION FOR SERVICE COMPANIES, GAS  
PLANTS, REFINERIES, COMPRESSOR, GEOTHERMAL FACILITIES  
AND CRUDE OIL PUMP STATIONS**

(Refer to the OCD Guidelines for assistance in completing the application)

☐ New ☒ Renewal ☐ Modification

1. Type: Compressor Station (30-5 Central Delivery Point, GW-108)

2. Operator: Williams Four Corners, LLC

Address: 188 CR 4900, Bloomfield, NM 87413

Contact Person: David Bays

Phone: 505-632-4951

3. Location: Section 18 Township 30 North Range 5 West  
Submit large scale topographic map showing exact location.

4. Attach the name, telephone number and address of the landowner of the facility site.

5. Attach the description of the facility with a diagram indicating location of fences, pits, dikes and tanks on the facility.

6. Attach a description of all materials stored or used at the facility.

7. Attach a description of present sources of effluent and waste solids. Average quality and daily volume of waste water must be included.

8. Attach a description of current liquid and solid waste collection/treatment/disposal procedures.

9. Attach a description of proposed modifications to existing collection/treatment/disposal systems.

10. Attach a routine inspection and maintenance plan to ensure permit compliance.

11. Attach a contingency plan for reporting and clean-up of spills or releases.

12. Attach geological/hydrological information for the facility. Depth to and quality of ground water must be included.

13. Attach a facility closure plan, and other information as is necessary to demonstrate compliance with any other OCD rules, regulations and/or orders.

14. CERTIFICATION I hereby certify that the information submitted with this application is true and correct to the best of my knowledge and belief.

Name: David Bays

Title: Sr. Environmental Specialist

Signature: David Bays

E-mail Address: david.bays@williams.com

Date: Dec. 19, 2006



WILLIAMS FOUR CORNERS, LLC  
30-5 CENTRAL DELIVERY POINT  
DISCHARGE PLAN GW-108 RENEWAL

Prepared for:

New Mexico Oil Conservation Division  
Williams Four Corners, LLC  
188 County Road 4900  
Bloomfield, NM 87413

---

**Item 1**

*Indicate the major operational purpose of the facility. If the facility is a natural gas purification plant (CO<sub>2</sub> removal) and compressor station include the total combined site rated horsepower.*

The 30-5 Central Delivery Point is a compressor station owned and operated by Williams Four Corners, LLC (Williams). The site will include the following equipment:

The site is permitted for nine Waukesha 7042GL Reciprocating Compressor Engines (site-rated compressor horsepower is 1374 hp) and six glycol dehydrators; however only eight engines and four dehydrators are currently installed at the site. Compressors and dehydrators may be installed or removed to meet demand. In addition, there are various storage tanks, support structures and ancillary equipment.

**Item 2**

*Name of operator or legally responsible party and local representative.*

<b>Legally Responsible Party/ Operator</b>	Williams Four Corners, LLC 188 County Road 4900 Bloomfield, NM 87413 (505) 632-4600/4634 (800)-645-7400 (24 hour emergency notification)
--	--

<b>Local Representative</b>	David Bays Williams Four Corners, LLC 188 County Road 4900 Bloomfield, NM 87413 (505) 634-4951
-----------------------------	--

**Item 3**

*Give a legal description of the location and county. Attach a large-scale topographic map.*

Rio Arriba County, New Mexico  
Township 30 North, Range 5 West, Section 18  
The topographic map is attached as Figure 1.

**Item 4**

*Attach the name, telephone number and address of the landowner of the facility site.*

Williams is leasing the subject property from:

Ted Frick  
c/o Attorney Thomas Bonham  
317 6<sup>th</sup> Street, NW  
Albuquerque, NM 87102

**Item 5**

*Attach a description of the facility with a diagram indicating location of fences, pits, dikes and tanks on the facility.*

An updated facility diagram is included as Figure 2. The updated diagram shows the facility fenceline extended to the south, and updates the locations of tanks at the site.

**Item 6**

*Attach a description of all materials stored or used at the facility.*

Table 1 describes the transfer, storage and disposal of exempt and non-exempt process fluids, effluents, and waste solids expected to be generated at the site.

MSDSs for materials at the site are maintained in WFS's corporate office and are available upon request.

**Item 7**

*Attach a description of present sources of effluent and waste solids. Average quality and daily volume of wastewater must be included.*

The source, quantity, and quality of effluent and waste solids generated at the compressor station are summarized in Table 2.

**Item 8**

*Attach a description of current liquid and solid waste collection/treatment/disposal procedures.*

There have been no modifications to this item. Additionally, Table 1 describes the transfer, storage and disposal of exempt and non-exempt process fluids, effluents, and waste solids expected to be generated at the site.

**Item 9**

*Attach a description of proposed modifications to existing collection/treatment/disposal systems.*

No modifications to the facility are necessary to meet NMOCD requirements.

**Item 10**

*Attach a routine inspection and maintenance plan to ensure permit compliance.*

There have been no modifications to this item. See information on-file at OCD.

**Item 11**

*Attach a contingency plan for reporting and clean up of spills or releases.*

WFS will handle all spills and leaks immediately as required by company procedures and will report all spills and leaks according to the requirements of the State of New Mexico as found in NMOCD Rule 116 and WQCC Section 1203.

**Item 12**

*Attach ecological/hydrological information for the facility. Depth to and quality of groundwater must be included.*

A current well search was performed for this renewal application. There is no new information to report for this item. See information on-file at OCD.

**Item 13**

*Attach a facility closure plan, and other information as is necessary to demonstrate compliance with any other OCD rules, regulations and/or orders.*

There have been no modifications to this item. See information on-file at OCD.

## **PUBLIC NOTICE**

### **Notice of Discharge Plan Renewal Application**

#### **30-5 Central Delivery Point**

Pursuant to the requirements of the New Mexico Water Quality Control Commission Regulation 20 NMAC 2.6.2 – GROUND AND SURFACE WATER PROTECTION, Williams Four Corners, LLC of 188 County Road 4900, Bloomfield, NM 87413, hereby announces intent to apply to the New Mexico Oil Conservation Division to renew the Discharge Plan for the 30-5 Central Delivery Point. Williams expects to submit the permit application to the Oil Conservation Division in December 2006.

The facility, located in Section 18, Township 30 North, Range 5 West, Rio Arriba County, New Mexico, approximately 32 miles east-northeast of Bloomfield, provides natural gas compression and conditioning services.

The discharge permit addresses how spills, leaks, and other accidental discharges to the surface will be managed. The facility does not discharge wastewater to surface or subsurface waters. All wastes generated will be temporarily stored in tanks or containers. Waste shipped offsite will be disposed or recycled at an OCD approved site. In the event of an accidental discharge, ground water most likely will not be affected. The estimated ground water depth at the site is expected to be in the range of 200 to 500 feet. The total dissolved solids concentration of area ground water is expected to be in the range of 200-2,000 parts per million.

Comments or inquiries regarding this permit or the permitting process may be directed to:

Director of the Oil Conservation Division  
1220 South Saint Francis Dr.  
Santa Fe NM 87505  
(505) 827-1464

Please refer to the company name and site name, as used in this notice, or send a copy of this notice when making inquiries, since the Department might not have received the application at the time of this notice.



Williams Four Corners, LLC  
Environmental Department  
#188 County Road 4900  
Bloomfield, N.M. 87413  
Phone: (505) 632-4825  
Fax: (505) 632-4781

December 5, 2006

**CERTIFIED MAIL – RETURN RECEIPT REQUESTED**

Bureau of Land Management  
1235 La Plata Highway  
Farmington, NM 87401

Dear Madam/Sir:

This letter is to advise you that Williams Four Corners, LLC is preparing to submit to the Oil Conservation Division a Discharge Plan Renewal application for the permitted 30-5 Central Delivery Point (GW-108). This notice is a requirement pursuant to New Mexico Water Quality Control Commission Regulations. We expect to submit the Discharge Plan Renewal application to the Oil Conservation Division during December 2006.

The facility, located in Section 18, Township 30 North, Range 5 West, Rio Arriba County, New Mexico, approximately 32 miles east-northeast of Bloomfield, provides natural gas compression and conditioning services.

The discharge permit addresses how spills, leaks, and other accidental discharges to the surface will be managed. The facility does not discharge wastewater to surface or subsurface waters. All wastes generated will be temporarily stored in tanks or containers. Waste shipped offsite will be disposed or recycled at an OCD approved site. In the event of an accidental discharge, ground water most likely will not be affected. The estimated ground water depth at the site is 200 to 500 feet. The total dissolved solids concentration of area ground water is expected to be in the range of 200-2,000 parts per million.

Comments or inquiries regarding this permit or the permitting process may be directed to:

Director of the Oil Conservation Division  
1220 South Saint Francis Dr.  
Santa Fe NM 87505

Respectfully submitted,

  
Clara Cardoza  
Environmental Compliance Administrator

U.S. Postal Service™	
CERTIFIED MAIL™ RECEIPT	
(Domestic Mail Only; No Insurance Coverage Provided)	
For delivery information visit our website at <a href="http://www.usps.com">www.usps.com</a> .	
OFFICIAL USE	
Postage	\$ 0.39
Certified Fee	\$2.40
Return Receipt Fee (Endorsement Required)	\$1.85
Restricted Delivery Fee (Endorsement Required)	\$0.00
Total Postage & Fees	\$ 4.64
Sent To	
Street, Apt. No., or PO Box No.	
City, State, ZIP+4	
PS Form 3800, June 2002 See Reverse for Instructions	

1235 La Plata Hwy  
Farmington, NM 87401

12/07/2006





Williams Four Corners, LLC  
Environmental Department  
#188 County Road 4900  
Bloomfield, N.M. 87413  
Phone: (505) 832-4825  
Fax: (505) 632-4781

December 5, 2006

**CERTIFIED MAIL – RETURN RECEIPT REQUESTED**

Commissioner of Public Lands  
State Land Office, Bldg 310  
Old Santa Fe Trail  
Santa Fe, NM 87410

Dear Madam/Sir:

This letter is to advise you that Williams Four Corners, LLC is preparing to submit to the Oil Conservation Division a Discharge Plan Renewal application for the permitted 30-5 Central Delivery Point (GW-108). This notice is a requirement pursuant to New Mexico Water Quality Control Commission Regulations. We expect to submit the Discharge Plan Renewal application to the Oil Conservation Division during December 2006.

The facility, located in Section 18, Township 30 North, Range 5 West, Rio Arriba County, New Mexico, approximately 32 miles east-northeast of Bloomfield, provides natural gas compression and conditioning services.

The discharge permit addresses how spills, leaks, and other accidental discharges to the surface will be managed. The facility does not discharge wastewater to surface or subsurface waters. All wastes generated will be temporarily stored in tanks or containers. Waste shipped offsite will be disposed or recycled at an OCD approved site. In the event of an accidental discharge, ground water most likely will not be affected. The estimated ground water depth at the site is 200 to 500 feet. The total dissolved solids concentration of area ground water is expected to be in the range of 200-2,000 parts per million.

Comments or inquiries regarding this permit or the permitting process may be directed to:

Director of the Oil Conservation Division  
1220 South Saint Francis Dr.  
Santa Fe NM 87505

Respectfully submitted,

  
Clara Cardoza  
Environmental Compliance Administrator

DEC 05 2006 10:00 AM 0330

U.S. Postal Service™	
CERTIFIED MAIL™ RECEIPT	
(Domestic Mail Only; No Insurance Coverage Provided)	
For delivery information visit our website at <a href="http://www.usps.com">www.usps.com</a>	
OFFICIAL USE	
Postage	\$ 0.39
Certified Fee	\$ 2.40
Return Receipt Fee (Endorsement Required)	\$ 0.00
Restricted Delivery Fee (Endorsement Required)	\$ 0.00
Total Postage & Fees	\$ 2.79

Sent To: Commissioner Public Lands  
Street, Apt. No. or PO Box No.: State Land Bldg 310  
City, State, ZIP+4: Old Santa Fe Trail, Santa Fe, NM 87410

PS Form 3800, June 2002 See Reverse for Instructions



Williams Four Corners, LLC  
Environmental Department  
#188 County Road 4900  
Bloomfield, N.M. 87413  
Phone: (505) 632-4825  
Fax: (505) 632-4781

December 5, 2006

**CERTIFIED MAIL – RETURN RECEIPT REQUESTED**

Ted and Ann Frick  
c/o Tom Bonham, Attorney-at-Law  
317 6<sup>th</sup> Street, Northwest  
Albuquerque, NM 87102

Dear Madam/Sir:

This letter is to advise you that Williams Four Corners, LLC is preparing to submit to the Oil Conservation Division a Discharge Plan Renewal application for the permitted 30-5 Central Delivery Point (GW-108). This notice is a requirement pursuant to New Mexico Water Quality Control Commission Regulations. We expect to submit the Discharge Plan Renewal application to the Oil Conservation Division during December 2006.

The facility, located in Section 18, Township 30 North, Range 5 West, Rio Arriba County, New Mexico, approximately 32 miles east-northeast of Bloomfield, provides natural gas compression and conditioning services.

The discharge permit addresses how spills, leaks, and other accidental discharges to the surface will be managed. The facility does not discharge wastewater to surface or subsurface waters. All wastes generated will be temporarily stored in tanks or containers. Waste shipped offsite will be disposed or recycled at an OCD approved site. In the event of an accidental discharge, ground water most likely will not be affected. The estimated ground water depth at the site is 200 to 500 feet. The total dissolved solids concentration of area ground water is expected to be in the range of 200-2,000 parts per million.

Comments or inquiries regarding this permit or the permitting process may be directed to:

Director of the Oil Conservation Division  
1220 South Saint Francis Dr.  
Santa Fe NM 87505

Respectfully submitted,

  
Clara Cardoza  
Environmental Compliance Administrator

U.S. Postal Service<sup>TM</sup>  
**CERTIFIED MAIL<sup>TM</sup> RECEIPT**  
(Domestic Mail Only; No Insurance Coverage Provided)

For delivery information visit our website at [www.usps.com](http://www.usps.com).

ALBUQUERQUE NM 87102

Postage	\$	\$0.39
Certified Fee		\$2.40
Return Receipt Fee (Endorsement Required)		\$1.85
Restricted Delivery Fee (Endorsement Required)		\$0.00
Total Postage & Fees	\$	\$4.64

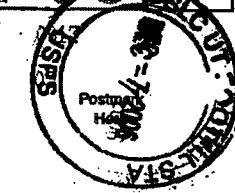

12/07/2006

Sent To

Ted + Ann Frick  
c/o Tom Bonham - Attorney  
317 6th St, NW Albuquerque, 87102

PS Form 3800, June 2002

See Reverse for Instructions



Williams Four Corners, LLC  
Environmental Department  
#188 County Road 4800  
Bloomfield, N.M. 87413  
Phone: (505) 632-4825  
Fax: (505) 632-4781

December 5, 2006

**CERTIFIED MAIL - RETURN RECEIPT REQUESTED**

Gomez Y Gomez, Inc  
Gomez Ranch  
Blanco, NM 87412

Dear Madam/Sir:

This letter is to advise you that Williams Four Corners, LLC is preparing to submit to the Oil Conservation Division a Discharge Plan Renewal application for the permitted 30-5 Central Delivery Point (GW-108). This notice is a requirement pursuant to New Mexico Water Quality Control Commission Regulations. We expect to submit the Discharge Plan Renewal application to the Oil Conservation Division during December 2006.

The facility, located in Section 18, Township 30 North, Range 5 West, Rio Arriba County, New Mexico, approximately 32 miles east-northeast of Bloomfield, provides natural gas compression and conditioning services.

The discharge permit addresses how spills, leaks, and other accidental discharges to the surface will be managed. The facility does not discharge wastewater to surface or subsurface waters. All wastes generated will be temporarily stored in tanks or containers. Waste shipped offsite will be disposed or recycled at an OCD approved site. In the event of an accidental discharge, ground water most likely will not be affected. The estimated ground water depth at the site is 200 to 500 feet. The total dissolved solids concentration of area ground water is expected to be in the range of 200-2,000 parts per million.

Comments or inquiries regarding this permit or the permitting process may be directed to:

Director of the Oil Conservation Division  
1220 South Saint Francis Dr.  
Santa Fe NM 87505

Respectfully submitted,

  
Clara Cardoza  
Environmental Compliance Administrator

U.S. Postal Service <sup>TM</sup>	
CERTIFIED MAIL <sup>TM</sup> RECEIPT	
(Domestic Mail Only; No Insurance Coverage Provided)	
For delivery information visit our website at <a href="http://www.usps.com">www.usps.com</a>	
<b>OFFICIAL USE</b>	
Postage	\$ 0.39
Certified Fee	\$ 2.40
Return Receipt Fee (Endorsement Required)	\$ 1.85
Restricted Delivery Fee (Endorsement Required)	\$ 0.00
Total Postage & Fees	\$ 4.64
Sent To Gomez Y Gomez Gomez Ranch Blanco NM 87412	

PS Form 3800, June 2002 See Reverse for Instructions

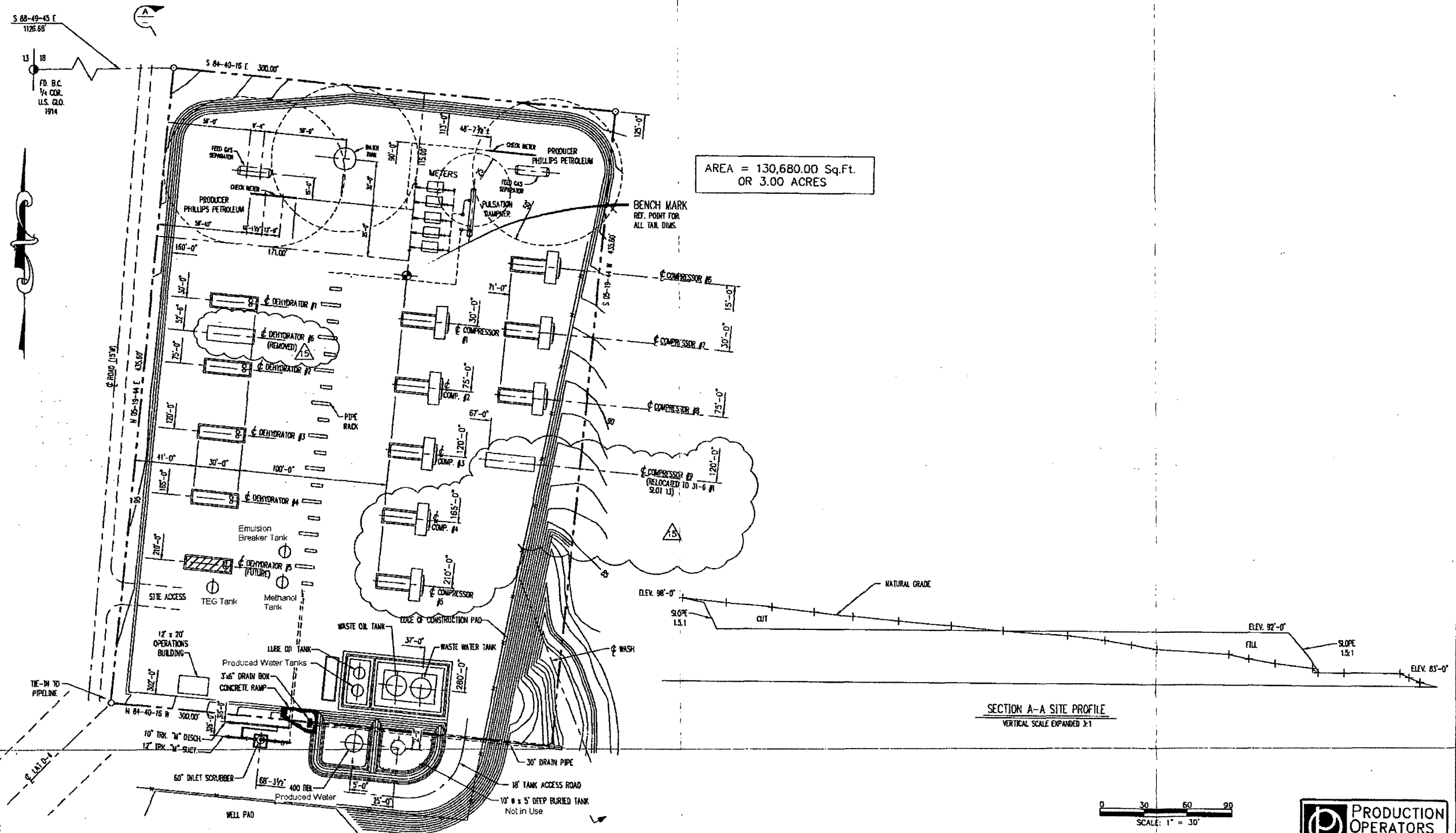

- NOTES:

1. EXCAVATION AREA SHOWN IS AN APPROXIMATE AREA REQUIRED, AND MAY BE ADJUSTED AS REQUIRED BY ACTUAL FIELD CONDITIONS.

2. DRAINAGE AND DIVERSION DAMS ARE TO BE CONSTRUCTED AS REQUIRED AFTER FINAL EXCAVATION AND GRADING IS COMPLETE.

Not Shown - each engine is equipped with a 500 gallon lube oil tank  
Each dehydrator is equipped with a 100 gallon TEG tank.

11	1/2/96	JW	CONNECTED DRAINAGE	14549	5	11/2/93	BF	ADDED COWLEY'S PL. & R. & REBT PL	16331		DRAFTING	BY	DATE	<div>WILLIAMS FIELD SERVICES</div> <div>ONE OF THE WILLIAMS COMPANIES</div> <div>SAN JUAN 30-5 No.1 C.D.P.</div> <div>EXCAVATION &amp; SITE LAYOUT</div>
11	10/23/96	DDA	ADDED COMPRESSORS, PL. & PL	14549	5	2/19/93	TT	ADD COMPRESSOR J0			DRAWN	HW	11/11/93	
10	2/25/96	IT	ADDED NEW SUTHERLAND, CO. LOCATOR	14549	5	1/19/93	RNE	ADD METER J0	10083		CHECKED			
9	9/23/95	PHM	ADDED COWLEY'S PL. & R. & NEW METER	17280	15	4/9/95	DDA	AS-BUILT PER FIELD COMMENTS			APPROVED			
8	10/21/94	IT	RELOCATED COMPRESSORS, PL. & PL	11367	13	1/2/95	DDA	REPLACED METER SQUARE			ENGINEERING	BY	DATE	
7	10/7/93	TT	ADD COMPRESSORS RE & IT	11367	0	9/24/91	DDA	AS-BUILT PER FIELD COMMENTS	700375					
							HW	ISSUED FOR CONSTRUCTION						
NO.	DATE	BY	DESCRIPTION	W.D. #	APP.	NO.	DATE	SY	DESCRIPTION	W.D. #	APP.	C & S REVIEW		
REVISIONS														
REVISIONS														
PROJECT APPROVED												SCALE: 1" = 30'		DWG. NO. 30-5-1-M1
PLOT DATE/TIME 9/10/2001 8:49 A.M.												W.D. # 10083		



**PRODUCTION  
OPERATORS  
INC.**

**WILLIAMS FIELD SERVICES**  
ONE OF THE WILLIAMS COMPANIES  
**SAN JUAN 30-5 No.1 C.D.P.**  
**EXCAVATION & SITE LAYOUT**

DWG. NO. 30-5-1-M1

**TABLE 1**  
**TRANSFER, STORAGE AND DISPOSAL OF PROCESS FLUIDS, EFFLUENT AND WASTE SOLIDS**  
**30-5 CENTRAL DELIVERY POINT**

PROCESS FLUID/WASTE	STORAGE	STORAGE CAPACITY (approximate)	CONTAINMENT/ SPILL PREVENTION	RCRA STATUS	DESCRIPTION OF FINAL DISPOSITION
Used Oil	Above Ground Storage Tank	6930 gal	Berm	Non-exempt	May be hauled to a WFS or contractor consolidation point before transport to EPA-registered used oil marketer for recycling.
Produced Water	Above Ground Storage Tank	400 bbl 150 bbl	Berm	Exempt	Saleable liquids may be sold to refinery. The remaining liquids may be transported to a Williams evaporation facility or may be disposed at NMOCOD-approved facility.
Wash-down Water	Above Ground Storage Tank	6930 gal	Dual-walled fiberglass tank	Non-exempt	Contractor may pump wash water back into truck after washing; water may be transported to NMOCOD-approved facility, or evaporation at WFS facility may be considered.
Used Oil Filters	Drum or other container	Varies	Transported to a Williams or contractor facility in drum or other container	Non-exempt	Transported to a Williams or contractor consolidation point, drained, and ultimately transported for disposal at an approved disposal facility. A Waste Acceptance Profile will be filed with the disposal facility. Recycling options may be considered when available.
Used Process Filters	Drum or other container	Varies	Transported to a Williams or contractor facility in drum or other container	Exempt	Transported to a Williams or contractor consolidation point, drained, and ultimately transported for disposal at an approved disposal facility. A Waste Acceptance Profile will be filed with the disposal facility. Recycling options may be considered when available.
Spill Residue (i.e., soil, gravel, etc.)	N/A	N/A	In situ treatment, land-farm, or alternate method	Incident dependent	Per Section VI, Remediation, in 8/13/93 NMOCOD Guidelines for Remediation of Leaks, Spills, and Releases.
Used Absorbents	Drum or other container	Varies	Transported to a Williams or contractor facility in drum or other container	Non-exempt	Transported to a Williams or contractor consolidation point, drained, and ultimately transported for disposal at an approved disposal facility. A Waste Acceptance Profile will be filed with the disposal facility. Recycling options may be considered when available.
Empty Drums / Containers	N/A	N/A	Berm	Non-exempt	Barrels are returned to supplier or transported to a Williams or contractor consolidation point and ultimately recycled/disposed consistent with applicable regulations.
Methanol	Above Ground Storage Tank	225 gal	Berm	N/A	Off-spec material recycled or disposed consistent with applicable regulations.
Emulsion Breaker	Above Ground Storage Tank	225 gal	Berm	N/A	Off-spec material recycled or disposed consistent with applicable regulations.
Solvent	Above Ground Storage Tank	500 gal	Concrete pad and wastewater system	N/A	Off-spec material recycled or disposed consistent with applicable regulations.
Antifreeze	Above Ground Storage Tank	500 gal	Concrete pad and wastewater system	N/A	Off-spec material recycled or disposed consistent with applicable regulations.
Glycol	Above Ground Storage Tank	500 gal 100 gal*	Berm Concrete pad and wastewater system	N/A	Off-spec material recycled or disposed consistent with applicable regulations.
Lube Oil	Above Ground Storage Tank	4200 gal 500 gal*	Berm Concrete pad and wastewater system	N/A	Off-spec material recycled or disposed consistent with applicable regulations.

\*Number of tanks installed dependent on number of engines and dehydrators installed on site. Engines and dehydrators are installed or removed to meet demand.

**TABLE 2**  
**SOURCE, QUANTITY AND QUALITY OF EFFLUENT AND WASTE SOLIDS**  
**30-5 CENTRAL DELIVERY POINT**

PROCESS FLUID / WASTE	SOURCE	QUANTITY (Ranges)	QUALITY
Produced Water	Inlet Scrubber	100-6000 bbl/year	No Additives
Produced Water	Dehydrator	100-6000 bbl/year	No Additives; may be trace lube oil or emulsion breaker
Wash Down Water	Compresor Skid	500-5000 gal/year/engine	Biodegradable soap and tap water with traces of used oil
Used Oil	Compressor	500-2000 gal/year/engine	Used Motor Oil w/ No Additives
Used Oil Filters	Compressor	50-500/year/engine	No Additives
Used Process Filters	Air, Inlet, Fuel Gas	75-500/year	No Additives
Empty Drums/Containers	Liquid Containers	0-80/year	No Additives
Spill Residue ( i.e. soil, gravel, etc)	Incidental Spill	Incident Dependent	Incident Dependent
Used Adsorbents	Incidental Spill/Leak Equipment Wipe-down	Incident Dependent	No Additives