

GW - 176

**PERMITS,
RENEWALS,
& MODS
Application**

New Mexico Energy, Minerals and Natural Resources Department

Susana Martinez
Governor

John H. Bemis
Cabinet Secretary-Designate

Brett F. Woods, Ph.D.
Deputy Cabinet Secretary

Jami Bailey
Division Director
Oil Conservation Division



JUNE 22, 2011

Mr. Keith Warren
DCP Midstream
1625 West Marland
Hobbs, New Mexico 88240

Dear Mr. Warren:

Based on your responses given in the "Oil & Gas Facilities Questionnaire for Determination of a WQCC Discharge Permit", the Oil Conservation Division (OCD) has determined that three of your facilities do not require a Water Quality Control Commission (WQCC) Discharge Permit. This means that the WQCC Discharge Permits GW-015 (Linam Ranch GP), GW-237 (Pecos Diamond GP), GW-176 (Bootleg CS) are hereby rescinded and you are not required to proceed with the renewal of these WQCC Discharge Permits. OCD will close these permits in its database.

Because your WQCC Discharge Permits are no longer valid, you may be required to obtain a separate permit(s) for other processes at your facility, such as: pits, ponds, impoundments, below-grade tanks; waste treatment, storage and disposal operations; and landfarms and landfills. OCD will make an inspection of your facility to determine if any of these existing processes may require a separate permit under OCD's Oil, Gas, and Geothermal regulations. If OCD determines that a separate permit(s) is required, then a letter will be sent to you indicating what type of permit is required.

Please keep in mind, if your facility has any discharges that would require a WQCC Discharge Permit now or in the future, then you will be required to renew or obtain a WQCC Discharge Permit.

If you have any questions regarding this matter, please contact Glenn von Gonten at 505-476-3488.

Thank you for your cooperation.

Jami Bailey
Director

AFFIDAVIT OF PUBLICATION

State of New Mexico,
County of Lea.

I, Kenneth Norris

GENERAL MANAGER

of the Hobbs News-Sun, a newspaper published at Hobbs, New Mexico, do solemnly swear that the clipping attached hereto was published in the regular and entire issue of said paper, and not a supplement thereof for a period

of 1 issue(s).

Beginning with the issue dated
December 6, 2009

and ending with the issue dated
December 6, 2009

GENERAL MANAGER

Sworn and subscribed to before
me this 15th day of
December, 2009

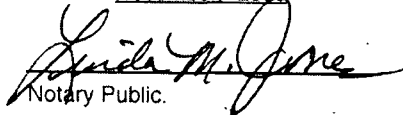
Notary Public.

My Commission expires
JUNE 16, 2013

(Seal)



This newspaper is duly qualified to publish legal notices or advertisements within the meaning of Section 3, Chapter 167, Laws of 1937, and payment of fees for said publication has been made.

(GW-176) Ms. Diane Kocis, Senior Environmental Specialist, DCP Midstream LP, 370 17th Street, Suite 2500, Denver, Colorado 80202 has submitted a renewal application for the previously approved discharge plan for their Bootleg Compressor Station, located in the NW/4 of the SE/4 of Section 18, Township 22S, Range 33E, NMPM, Lea County, New Mexico. The facility is located approximately 38 miles southwest of Hobbs, NM. The facility processes natural gas to remove liquids from the natural gas stream. Approximately 254 bbls per month of produced water and 1,100 gals per year of used oil are generated and stored onsite. These fluids are not to be intentionally discharged to the ground. If accidental discharge occurs immediate recovery/reclamation shall be implemented. All fluids utilized at the facility are stored in dedicated storage tanks prior to offsite disposal or recycling at an OCD approved site. Fluids other than clean water, including dry chemicals, shall be stored within secondary containment and properly bermed. Waste shall be properly maintained and manifested. A copy of the discharge permit once renewed shall be posted on location at all times and made familiar to all facility personnel. Groundwater most likely to be affected by a spill, leak or accidental discharge is at a depth of approximately 224 feet, with a total dissolved solids concentration of approximately 1,973 mg/L. The discharge plan addresses how oilfield products and waste will be properly handled, stored, and disposed of, including how spills, leaks, and other accidental discharges to the surface will be managed in order to protect fresh water. Any interested person or persons may obtain information, submit comments, and request to be placed on a facility-specific mailing list for future notices by contacting Leonard Lowe at the New Mexico OCD at 1220 South St. Francis Drive, Santa Fe, New Mexico 87505, Telephone (505) 476-3492. The OCD will accept comments and statements of interest regarding the renewal and will create a facility-specific mailing list for persons who wish to receive future notices.

03101363
DCP MIDSTREAM
DIANE KOCIS
370 17TH STREET, SUITE 2500
DENVER, CO 80202

00043388

AFFIDAVIT OF PUBLICATION

State of New Mexico,
County of Lea.

I, Kenneth Norris

GENERAL MANAGER

of the Hobbs News-Sun, a newspaper published at Hobbs, New Mexico, do solemnly swear that the clipping attached hereto was published in the regular and entire issue of said paper, and not a supplement thereof for a period

of 1 issue(s).
Beginning with the issue dated
December 6, 2009
and ending with the issue dated
December 6, 2009

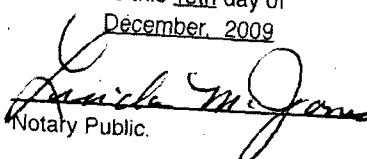
GENERAL MANAGER
Sworn and subscribed to before
me this 15th day of
December, 2009

Notary Public.

My Commission expires
JUNE 16, 2013
(Seal)



This newspaper is duly qualified to publish legal notices or advertisements within the meaning of Section 3, Chapter 167, Laws of 1937, and payment of fees for said publication has been made.

03101363

00043389

DCP MIDSTREAM
DIANE KOCIS
370 17TH STREET, SUITE 2500
DENVER, CO 80202

(GW-176) La Srita. Diane Kocis, especialista ambiental de la empresa DCP Midstream LP, cuya oficina esta localizada en el 370 de la calle 17 numero 2500 en la Ciudad de Denver, Colorado Código Postal 80202, sometió una aplicación para renovar un permiso (el cual fue previamente aprobado) de líquidos inservibles asociados con Estación de Compresión Bootleg. La Estación de Compresión esta localizada en el NW/4 de el SE/4, en la sección 18, Township 22S, Range 33E, NMPM, en el condado de Lea, en el estado de Nuevo México. Esta instalación esta localizada aproximadamente a 38 millas al suroeste de la ciudad de Hobbs, en Nuevo México. Esta instalación procesa el gas natural removiendo los líquidos. Aproximadamente, 254 barriles de agua son extraídos por mes y 1,000 galones de petróleo son usados por año, ambos líquidos son generados y almacenados en estas instalaciones. Estos líquidos no serán intencionalmente liberados o descargados al suelo. En caso de que accidentalmente estos líquidos sean liberados o descargados, se requerirá que los líquidos se recuperen inmediatamente o si no se pueden recuperar al momento la tierra debiera de ser extraída, procesada y curada. Todos los líquidos utilizados en esta instalación estan cuidadosamente almacenados en tanques especiales antes de ser llevados por un tercer partido. Estos líquidos tambien pueden ser reciclados o desechados en lugares autorizados por el OCD (Oil Conservation Division o La División de Conservación de Petróleo) de el estado de Nuevo México. Los líquidos que no sean agua limpia, incluyendo quimicos secos, deberan de ser contenidos en un contenedor secundario y con sus propias barreras de contención. Los desechos líquidos deberan de ser mantenidos y manifestados propiamente. Cuando el permiso sea renovado una copia deberá de ser expuesta en la locación en todo momento y familiarizar a todo el personal con dicho permiso. El agua que se encuentra en el subsuelo esta mas propensa a ser afectada por un derrame, fuga o descarga accidental, el agua se encuentra a aproximadamente 224 pies de profundidad con un total 1,973 miligramos por litro de concentración de quimicos sólidos diluidos aproximadamente. El permiso de desechos indica como los productos de gas y desechos seran propiamente manejados, almacenados y desechados. Incluyendo también los derrames, fugas o derrames accidentales en la superficie seran manejados apropiadamente para proteger el agua fresca. Cualquier persona(s) interesada en este tema la cual desee obtener mas información, proveer comentarios y/o ser agregado a la lista de correo para obtener futuras noticias por favor de contactar a Leonardo Lowe en la OCD, en la Ciudad de Nuevo México. En el 1220 Sur St. Francis Drive, Santa Fe, Nuevo México Código Postal 87505 o al teléfono (505) 476-3492. El OCD aceptara comentarios y/o cualquier forma de interés que se refiera a la renovación del permiso, así como también se creara una lista de correo para las personas que deseen recibir noticias en el futuro.

✓ ①
(GW-176) Ms. Diane Kocis, Senior Environmental Specialist, DCP
Midstream LP, 370 17th Street, Suite 2500, Denver, Colorado 80202 has
submitted a renewal application for the previously approved discharge
plan for their Bootleg Compressor Station, located in the NW/4 of the
SE/4 of Section 18, Township 22S, Range 33E, NMPM, Lea County, ✓ ②
New Mexico. The facility is located approximately 38 miles southwest of
Hobbs, NM. The facility processes natural gas to remove liquids from ✓ ③
the natural gas stream. Approximately 254 bbls per month of produced
water and 1,100 gals per year of used oil are generated and stored ✓ ④
onsite. These fluids are not to be intentionally discharged to the ground.
If accidental discharge occurs immediate recovery/reclamation shall be
implemented. All fluids utilized at the facility are stored in dedicated
storage tanks prior to offsite disposal or recycling at an OCD approved
site. Fluids other than clean water, including dry chemicals, shall be
stored within secondary containment and properly bermed. Waste shall
be properly maintained and manifested. A copy of the discharge permit
once renewed shall be posted on location at all times and made familiar
to all facility personnel. Groundwater most likely to be affected by a
spill, leak or accidental discharge is at a depth of approximately 224 } ⑤ ✓
feet, with a total dissolved solids concentration of approximately 1973
mg/L. The discharge plan addresses how oilfield products and waste
will be properly handled, stored, and disposed of, including how spills,
leaks, and other accidental discharges to the surface will be managed in
order to protect fresh water. Any interested person or persons may
obtain information, submit comments, and request to be placed on a
facility-specific mailing list for future notices by contacting Leonard
Lowe at the New Mexico OCD at 1220 South St. Francis Drive, Santa } ⑥ ✓
Fe, New Mexico 87505, Telephone (505) 476-3492. The OCD will accept } ⑦ ✓
comments and statements of interest regarding the renewal and will
create a facility-specific mailing list for persons who wish to receive
future notices.

Approved 11.5.9

Lowe, Leonard, EMNRD

From: Lowe, Leonard, EMNRD
Sent: Tuesday, November 24, 2009 2:10 PM
To: 'Kocis, Diane E'
Subject: GW-176, Administratively Complete
Attachments: GW-176 Admin Complete Letter.pdf; GW-176 Draft Permit Cover.pdf; GW-176 Draft Permit.pdf; GW-176 OCD PN.pdf

Diane,

OCD finds your submitted application to be Administratively Complete. See attachments.

The submitted public notice has been approved for publishing. Once published please submit the proof of publication to my attention.

If you have any questions please feel free to contact me.

llowe

Leonard Lowe

Environmental Engineer
Oil Conservation Division/EMNRD
1220 S. St. Francis Drive
Santa Fe, N.M. 87505
Office: 505-476-3492
Fax: 505-476-3462
E-mail: leonard.lowe@state.nm.us
Website: <http://www.emnrd.state.nm.us/ocd/>



New Mexico Energy, Minerals and Natural Resources Department

Bill Richardson

Governor
Joanna Prukop
Cabinet Secretary

Mark Fesmire
Division Director
Oil Conservation Division



November 24, 2009

Dear Ms. Kocis:

**Re: Discharge Plan Renewal Permit GW-176
DCP Midstream LP.
Bootleg Compressor Station
Lea County, New Mexico**

The New Mexico Oil Conservation Division (NMOCD) has received DCP Midstream's request and initial fee, dated September 3, 2009, to renew GW-176 for their Bootleg Compressor Station located in the NW/4 SE/4 of Section 18, Township 22 South, Range 33 East, NMPM, Lea County, New Mexico. The initial submittal provided the required information in order to deem the application "administratively" complete.

The New Mexico Water Quality Control Commission regulations (WQCC) notice requirements of 20.6.2.3108 NMAC was satisfied and demonstrated to the NMOCD. Provide a proof of publication affidavit to the agency once received. NMOCD will provide public notice pursuant to the WQCC notice requirements of 20.6.2.3108 NMAC to determine if there is any public interest.

If there are any questions regarding this matter, please do not hesitate to contact me at (505) 476-3492 or leonard.lowe@state.nm.us. On behalf of the staff of the NMOCD, I wish to thank you and your staff for your cooperation during this discharge permit review.

Sincerely,

Leonard Lowe
Environmental Engineer

LRL/lrl

xc: OCD District I Office





New Mexico Energy, Minerals and Natural Resources Department

Bill Richardson
Governor

Joanna Prukop
Cabinet Secretary

Mark Fesmire
Division Director
Oil Conservation Division



November 24, 2009

Ms. Diane Kocis
DCP Midstream
370 17th Street, Suite 2500
Denver, CO 80020

Re: **DRAFT** Discharge Permit Renewal (GW-176), Bootleg Compressor Station
NW/4 SE/4 of Section 18, Township 22 South, Range 33 East, NMPM
Lea County, New Mexico

Dear Ms. Kocis:

Pursuant to Water Quality Control Commission (WQCC) Regulations 20.6.2.3104 - 20.6.2.3114 NMAC, the Oil Conservation Division (OCD) hereby approves the discharge permit for the DCP Midstream LP., (owner/operator) for the above-referenced site contingent upon the conditions specified in the enclosed Attachment to the Discharge Permit. Enclosed are two copies of the conditions of approval. Please sign and return one copy to the New Mexico Oil Conservation Division (OCD) Santa Fe Office within 45 days of receipt of this letter including permit fees.

Please be advised that approval of this permit does not relieve the owner/operator of responsibility should operations result in pollution of surface water, ground water or the environment. Nor does approval of the permit relieve the owner/operator of its responsibility to comply with any other applicable governmental authority's rules and regulations.

If you have any questions, please contact Leonard Lowe of my staff at (505-476-3492) or E-mail leonard.lowe@state.nm.us. On behalf of the staff of the OCD, I wish to thank you and your staff for your cooperation during this discharge permit review.

Sincerely,

Glenn von Gonten
Acting Environmental Bureau Chief



DISCHARGE PERMIT GW-176

1. GENERAL PROVISIONS.

A. PERMITTEE AND PERMITTED FACILITY: The Oil Conservation Division (OCD) of the Energy, Minerals and Natural Resources Department issues discharge permit GW-176 (Discharge Permit) to DCP Midstream L.P. (Owner/Operator), located at 370 17th Street Suite 2500, Denver CO 80202, to operate the Bootleg Gas Compressor Station located in the NW/4 SE/4 of Section 18, Township 22 South, Range 33 East, NMPM, Lea County (Facility).

The facility compresses natural gas for the Eunice gathering system. Total horsepower is 2956 HP. Approximately 254 bbls/month of produced water, 1100 gal/year of used oil, and 5 bbls/month of wash/skid water are generated and stored in onsite. Groundwater most likely to be affected by a spill, leak or accidental discharge is at a depth of approximately 224 feet, with a total dissolved solids concentration of approximately 1973 mg/L.

B. SCOPE OF PERMIT: OCD regulates the disposition of nondomestic wastes resulting from the oil field service industry to protect the public health and the environment pursuant to authority granted in the Oil and Gas Act (Chapter 70, Article 2 NMSA 1978) at NMSA 1978, Section 70-2-12(B)(22). OCD has been granted authority to administer the Water Quality Act (Chapter 74, Article 6 NMSA 1978) as it applies to the oil and field service industry by statute, NMSA 1978, Section 70-2-12(B)(22), and by delegation from the Water Quality Control Commission pursuant to NMSA 1978, Section 74-6-4(E).

The Water Quality Act and the rules issued under that Act protect ground water and surface water of the State of New Mexico by providing that, unless otherwise allowed by rule, no person shall cause or allow effluent or leachate to discharge so that it may move directly or indirectly into ground water unless such discharge is pursuant to an approved discharge plan. See 20.6.2.3.104 NMAC and 20.6.2.3.106 NMAC. A facility having no intentional liquid discharges is still required to have a discharge plan. Inadvertent discharges of liquids (e.g., leaks and spills, or any type of accidental discharge of contaminants) or improper disposal of waste solids still have a potential to cause ground water contamination or threaten public health and the environment.

Because the Owner/Operator did not identify any intentional discharge that will occur at the Facility, this Discharge Permit does not authorize any discharge. This Discharge Permit addresses the protection of public health and the environment, and the prevention of water pollution, by preventing and mitigating unintentional discharges.

This Discharge Permit does not convey any property rights of any sort or any exclusive privilege, and does not authorize any injury to persons or property, any invasion of other private rights, or any infringement of state, federal or local laws, rules or regulations.

C. DISCHARGE PERMIT CONDITIONS: By agreeing to this Discharge Permit, the Owner/Operator agrees to the specific provisions set out in this document, and the commitments made in the approved Discharge Plan Application and the attachments to that application, which are incorporated into the Discharge Permit by reference. Subsequent modifications of this Discharge Permit pursuant to the Water Quality Act, and subsequent approvals granted by OCD under this Discharge Permit are incorporated into the Discharge Permit, and the Owner/Operator agrees to the provisions in those subsequent modifications and approvals.

If this Discharge Permit is a permit renewal, it replaces the permit being renewed. Replacement of a prior permit does not relieve the Owner/Operator of its responsibility to comply with the terms of that prior permit while that permit was in effect.

D. DEFINITIONS: Terms not specifically defined in this Discharge Permit shall have the same meanings as those in the Water Quality Act, the Oil and Gas Act or the rules adopted pursuant to those Acts, as the context requires.

E. GENERAL PERFORMANCE STANDARDS: The Owner/Operator shall operate in accordance with the Discharge Permit conditions to comply with the Water Quality Act and the Oil and Gas Act and the rules issued pursuant to those Acts, so that neither a hazard to public health nor undue risk to property will result (see 20.6.2.3109.C NMAC); so that no discharge will cause or may cause any stream standard to be violated (see 20.6.2.3109.H(2) NMAC); so that no discharge of any water contaminant will result in a hazard to public health, (see 20.6.2.3109.H(3) NMAC); so that the numerical standards specified of 20.6.2.3103 NMAC are not exceeded; to protect public health and the environment (see NMSA 1978, Section 70-2-12(B)(22)); and to prevent waste of oil and gas, prevent the contamination of fresh waters and so that oil and gas are not used wastefully or allowed to leak or escape from a natural reservoir or from wells, tanks, containers, pipe or other storage conduit or operating equipment. See 19.15.2.8 NMAC.

The Owner/Operator shall not allow or cause water pollution, discharge or release of any water contaminant that exceeds the WQCC standards specified at 20.6.2.3101 NMAC and 20.6.2.3103 NMAC or 20.6.4 NMAC (Water Quality Standards for Interstate and Intrastate Streams).

F. FILING FEES AND PERMIT FEES: Pursuant to 20.6.2.3114 NMAC, every facility that submits a discharge permit application for initial approval or renewal shall pay the permit fees specified in Table 1 and the filing fee specified in Table 2 of 20.6.2.3114 NMAC. The OCD has already received the required \$100.00 filing fee for this application. The flat fee for a compressor station with horse power greater than 1001 HP is \$1,700.00. The Owner/Operator shall submit this amount along with the signed Discharge Permit. Checks should be made out to the "New Mexico Water Quality Management Fund," not the Oil Conservation Division.

G. EFFECTIVE DATE, EXPIRATION, RENEWAL CONDITIONS, AND PENALTIES FOR OPERATING WITHOUT A DISCHARGE PERMIT: This Discharge Permit is effective when the OCD receives the signed Discharge Permit from the

Owner/Operator, and the \$1,700.00 fee. This Discharge Permit will expire on **January 20, 2015**. The Owner/Operator shall submit an application for renewal no later than 120 calendar days before that expiration date, pursuant to 20.6.2.3106.F NMAC. If an Owner/Operator submits a renewal application at least 120 calendar days before the Discharge Permit expires and is in compliance with the approved Discharge Permit, then the existing Discharge Permit will not expire until OCD has approved or disapproved the renewal application. Operating with an expired Discharge Permit may subject the Owner/Operator to civil and/or criminal penalties. See NMSA 1978, Section 74-6-10.1 and NMSA 1978, Section 74-6-10.2.

H. MODIFICATIONS: The Owner/Operator shall notify OCD of any facility expansion, production increase, or process modification that would result in any significant modification in the discharge of water contaminants. See 20.6.2.3107.C NMAC. OCD may require the Owner/Operator to submit a permit modification pursuant to 20.6.2.3109.E NMAC, and the OCD may modify or terminate a permit pursuant to NMSA 1978, Section 74-6-5(M) through (N).

I. TRANSFER OF DISCHARGE PERMIT: Prior to any transfer of ownership, control, or possession (whether by lease, conveyance or otherwise) of the Facility, the transferor shall notify the transferee in writing of the existence of the Discharge Permit, and shall deliver or send by certified mail to OCD a copy of such written notification, together with a certification or other proof that such notification has been received by the transferee pursuant to 20.6.2.3111 NMAC. Upon receipt of such notification, the transferee shall inquire into all of the provisions and requirements contained in the Discharge Permit, and the transferee shall be charged with notice of all such provisions and requirements as they appear of record in OCD's file or files concerning the Discharge Permit. Upon assuming either ownership or possession of the Facility the transferee shall have the same rights and responsibilities under the Discharge Permit as were applicable to the transferor. See 20.6.2.3111 NMAC.

The transferee (new owner/operator) shall provide the OCD with a signed original of the Discharge Permit.

Transfer of the ownership, control, or possession of the Facility does not relieve the transferor of responsibility or liability for any act or omission which occurred while the transferor owned, controlled or was in possession of the Facility. See 20.6.2.3111.E NMAC.

J. CLOSURE PLAN AND FINANCIAL ASSURANCE: The Owner/Operator shall notify OCD in writing when any operations of the Facility are to be discontinued for a period in excess of six months. Prior to closure, or as a condition of this Discharge Permit, or upon request from OCD, the Owner/Operator shall submit a closure plan, modified closure plan, and/or provide adequate financial assurance. See 20.6.2.3107 NMAC.

K. COMPLIANCE AND ENFORCEMENT: If the Owner/Operator violates or is violating a condition of this Discharge Permit, the OCD may issue a compliance order requiring compliance immediately or within a specified time period, suspending or terminating this Discharge Permit, and/or assessing a civil penalty. See NMSA 1978, Section 74-6-10. OCD may

also commence a civil action in district court for appropriate relief, including injunctive relief. See NMSA 1978, Section 74-6-10(A)(2); NMSA 1978, Section 74-6-11. The Owner/Operator may be subject to criminal penalties for discharging a water contaminant without a discharge permit or in violation of a condition of a discharge permit; making any false material statement, representation, certification or omission of material fact in an application, record, report, plan or other document filed, submitted or required to be maintained under the Water Quality Act; falsifying, tampering with or rendering inaccurate any monitoring device, method or record required to be maintained under the Water Quality Act; or failing to monitor, sample or report as required by a permit issued pursuant to a state or federal law or regulation. See NMSA 1978, Section 74-6-10.2.

2. GENERAL FACILITY OPERATIONS

A. LABELING: The Owner/Operator shall clearly label all tanks, drums, and containers to identify the contents and provide other emergency-notification information. The Owner/Operator may use a tank code numbering system, if that tank code numbering system is incorporated into its approved Contingency Plan.

B. INSPECTIONS AND MAINTENANCE OF SECONDARY CONTAINMENT SYSTEMS: The Owner/Operator shall inspect all secondary containment systems and sumps designed for spill collection/prevention and leak detection at least weekly to ensure proper operation and to prevent over topping or system failure. The Owner/Operator shall record the results of its inspection in a log book.

The Owner/Operator shall empty all spill collection and/or secondary containment devices of fluids within 72 hours of discovery. The Owner/Operator shall report any leak or failure of a secondary containment system to OCD as a release, in accordance with Permit Condition 2.E. The Owner/Operator shall repair any leak or failure of a secondary containment system as provided in its approved Contingency Plan or as required by OCD.

C. RECORD KEEPING: The Owner/Operator shall maintain at the Facility records of all inspections required by this Discharge Permit for a minimum of five years and shall make those records available for OCD inspection.

D. TESTING: The Owner/Operator shall provide OCD with notice one week prior to conducting any test required under this Discharge Permit, so that OCD may witness the test. The Owner/Operator shall maintain at the Facility records of all tests conducted pursuant to this Discharge Permit and the results of those tests, and make those records available for OCD inspection. The Owner/Operator shall give verbal notice of a test failure to OCD within 24 hours, and file a written report of the failure with the OCD within 15 days. The Owner/Operator shall complete repairs to correct the failure as provided in its approved Contingency Plan or as required by OCD.

E. RELEASE REPORTING: The Owner/Operator shall report unauthorized releases of water contaminants pursuant to 19.15.29 NMAC and any additional commitments made in the approved Contingency Plan. For purposes of this Discharge Permit, "releases" includes breaks,

leaks, spills and other failures of a primary or secondary containment system, and the movement of storm water from a "contact area" to a "non-contact area." At a minimum, the Owner/Operator shall file a written report of the release with both the OCD District Office and the OCD Santa Fe Office within 15 days for both "major releases" and "minor releases" as defined in 19.15.29.7 NMAC, and give verbal notice to both the OCD District Office and the OCD Santa Fe Office within 24 hours of discovering a "major release."

F. CORRECTIVE ACTION FOR RELEASES: The Owner/Operator shall take appropriate corrective action as specified in its approved Contingency Plan for all releases of contaminants whether or not the release qualifies as a "major" or "minor" release as defined in 19.15.29.7 NMAC.

The Owner/Operator shall address any contamination through the discharge permit process or pursuant to 20.6.2.4000 NMAC through 20.6.2.4116 NMAC (Prevention and Abatement of Water Pollution). OCD may require the Owner/Operator to modify its Discharge Permit to provide for investigation, remediation, abatement, and monitoring for any vadose zone or water pollution.

G. ANNUAL REPORT: The Owner/Operator shall submit an annual report to OCD by March 15 of each year. The annual report shall include the following:

1. For each waste stream, the amount of effluent and waste solids generated and stored in the prior calendar year;
2. The amount of and final disposition of each waste stream;
3. A copy of all inspections conducted of secondary containment systems; and
4. The nature and amount of any releases, with a description of the disposition of any contaminated soil or water.

3. MATERIAL STORAGE.

A. DRUM AND CONTAINER STORAGE: The Owner/Operator shall store all drums and other containers, including empty drums and containers, on a curbed, impermeable pad. "Containers" include tote tanks, sacks, and buckets. The Owner/Operator shall store empty drums on their sides with the bungs in place and lined up on a horizontal plane. These requirements do not apply to drums and containers that contain only fresh water and are clearly so labeled.

B. PROCESS, MAINTENANCE, MATERIAL, AND WASTE STORAGE AREAS: The Owner/Operator shall pave and curb all process, maintenance, material and waste storage areas at its facility, or incorporate another appropriate spill collection device for the areas. (See 20.6.2.1203C(2) NMAC).

C. ABOVE GROUND TANKS: The Owner/Operator shall place above ground tanks on impermeable pads and surround the tanks with lined berms or other impermeable secondary containment system having a capacity at least equal to one and one-third times the capacity of the largest tank, or, if the tanks are interconnected, of all interconnected tanks. The

Owner/Operator is not required to provide secondary containment for any tanks that contain fresh water, and that are clearly so labeled.

The Owner/Operator shall retrofit existing above ground tanks that do not meet the requirements described above. The Owner/Operator shall submit a plan for the retrofitting to the OCD no later than the date for submitting an application for renewal of this Permit. The OCD will review and approve, approve with conditions, or deny the Owner/Operator's plan. The approved plan for retrofitting existing above ground tanks shall be incorporated into any permit renewal.

4. WASTE MANAGEMENT.

A. WASTE STREAMS: This Discharge Permit authorizes the Owner/Operator to handle the waste streams identified in its approved Discharge Plan Application. **Owner/Operator must obtain OCD approval for disposal of any waste stream not identified in its approved Discharge Plan Application.**

B. WASTE STORAGE: The Owner/Operator shall store waste at its Facility only in clearly marked waste storage areas that have been identified in its approved Discharge Plan Application, except that waste generated during emergency response operations may be stored elsewhere for no more than 72 hours. OCD may approve additional waste storage areas on a case-by-case basis. The Owner/Operator shall not store oil field waste (see 19.15.2 NMAC) on site for more than 180 calendar days without obtaining approval from OCD.

C. WASTE DISPOSAL: This Discharge Permit does not authorize on site disposal of nondomestic wastes.

The Owner/Operator shall dispose of the waste streams identified in its approved Discharge Plan Application at OCD permitted or approved facilities in accordance with the applicable rules for disposal at those facilities. The Owner/Operator is approved for the simplified procedure set out in 19.15.35.8.B(4) NMAC for disposal of wastes specified in 19.15.35.8.C(2) and (3) NMAC at solid waste facilities without OCD's prior written authorization provided that the waste stream has been identified in the approved Discharge Plan Application and existing process knowledge of the waste stream does not change.

D. CLASS V WELLS: Leach fields and other wastewater disposal systems at OCD-regulated facilities that inject non-hazardous fluid into or above an underground source of drinking water are UIC Class V injection wells, pursuant to 20.6.2.5002.B NMAC.

This Discharge Permit does not authorize the use of a Class V injection well for the disposal of industrial waste at the Facility. The Owner/Operator shall close any Class V industrial waste injection wells at the Facility that inject non-hazardous industrial wastes or a mixture of industrial wastes and domestic wastes (*e.g.*, septic systems, leach fields, dry wells, *etc.*) pursuant to 20.6.2.5005 NMAC within 90 calendar days of the issuance of this Discharge Permit. Other Class V wells, including wells used only for the injection of domestic wastes, must be permitted by the New Mexico Environment Department.

5. BELOW-GRADE TANKS, PITS, PONDS, AND SUMPS.

A. EXISTING BELOW-GRADE TANKS, PITS AND PONDS: Below-grade tanks, pits, and ponds must have secondary containment systems with leak detection. The Owner/Operator shall retrofit existing below-grade tanks, pits and ponds that do not have secondary containment and leak detection systems to meet these requirements. The Owner/Operator shall submit a plan for the retrofitting to OCD no later than the date for submitting an application for renewal of this Discharge Permit. OCD shall review and approve, approve with conditions, or deny the Owner/Operator's retrofit plan. The approved plan for retrofitting existing below-grade tanks, pits and ponds shall be incorporated into any permit renewal.

The Owner/Operator must test existing below-grade tanks, pits and ponds without secondary containment and leak detection annually or as specified herein. The Owner/Operator may propose various methods for testing such as pressure testing to 3 pounds per square inch greater than normal operating pressure and/or visual inspection of cleaned tanks and/or sumps, or other OCD-approved methods.

B. EXISTING SUMPS: A sump is any impermeable vessel or collection device incorporated within a secondary containment system, with a capacity less than 500 gallons, which remains predominantly empty, serves as a drain or receptacle for *de minimis* releases on an intermittent basis and is not used to store, treat, dispose of or evaporate products or wastes. The Owner/Operator shall empty all sumps of all materials at least once a week.

C. NEW BELOW-GRADE TANKS, PITS, PONDS AND SUMPS: The Owner/Operator shall obtain OCD's approval before installing a new below-grade tank, pit, pond or sump. The Owner/Operator should submit a proposed design plan to OCD to install a new below-grade tank, pit, pond or sump at least 90 calendar days before it intends to install the new unit. Design plans for below-grade tanks, pits, and ponds shall incorporate secondary containment and leak detection. Proposed design plans for pits and ponds shall include hydrologic and geologic reports, siting information, monitoring and closure plans and information on foundation and liners. OCD will review and approve, approve with conditions, or deny the Owner/Operator's proposed design for a new below-grade tank, pit, pond or sump.

D. FENCING: The Owner/Operator shall fence all below-grade tanks, pits and ponds pursuant to 19.15.17.11.D NMAC.

E. SCREENING AND NETTING: The Owner/Operator shall screen or net all open top tanks that are eight feet in diameter or larger and all pits (including lined pits), or otherwise render the tanks and pits non-hazardous to wildlife, including migratory birds, pursuant to 19.15.17.11.E NMAC.

6. UNDERGROUND PROCESS AND WASTEWATER PIPELINES.

A. TESTING: The Owner/Operator shall test all underground process/wastewater pipelines at least once every five (5) years to demonstrate their mechanical integrity, except lines containing fresh water. The Owner/Operator shall test all pressure-rated pipe to 150% of the normal operating pressure, if possible, or for atmospheric drain systems, to 3 pounds per square inch greater than normal operating pressure, and pressure held for a minimum of 30 minutes with no more than a 1% loss/gain in pressure. The Owner/Operator may propose other test methods for OCD's review and approval.

B. SCHEMATIC DIAGRAMS OR PLANS: The Owner/Operator shall maintain at its Facility all underground process and wastewater pipeline schematic diagrams or plans showing all drains, vents, risers, valves, underground piping, pipe type, rating, size, and approximate location.

C. NEW UNDERGROUND PIPING: The Owner/Operator must notify OCD prior to installing any new underground piping. The Owner/Operator should submit a design plan to the OCD for new underground piping at least 90 calendar days before it intends to begin construction. The OCD shall determine whether any modifications to this Discharge Permit are necessary and appropriate based on the new underground piping.

7. STORM WATER: The Owner/Operator shall implement and maintain storm water run-on and run-off plans and controls to separate chemical process areas and flow lines (contact areas) from storm water areas (non-contact areas), and shall comply with any additional commitments made in its approved Contingency Plan. The movement of storm water from a contact area to a non-contact area is a release, and the Owner/Operator shall report that release and take corrective action.

8. ADDITIONAL SITE SPECIFIC CONDITIONS: N/A

9. CERTIFICATION: (OWNER/OPERATOR) by the officer whose signature appears below, acknowledges receipt of this Discharge Permit, and has reviewed its terms and conditions.

Company Name - print name above

Company Representative - print name

Company Representative - Signature

Title _____

Date: _____

NOTICE OF PUBLICATION

STATE OF NEW MEXICO ENERGY, MINERALS AND NATURAL RESOURCES DEPARTMENT OIL CONSERVATION DIVISION

Notice is hereby given that pursuant to New Mexico Water Quality Control Commission Regulations (20.6.2.3106 NMAC), the following discharge permit application(s) has been submitted to the Director of the New Mexico Oil Conservation Division ("NMOCD"), 1220 S. Saint Francis Drive, Santa Fe, New Mexico 87505, Telephone (505) 476-3440:

(GW-176) Ms. Diane Kocis, DCP Midstream, 370 17th Street Suite 2500, Denver CO 80020, has submitted a renewal application for the previously approved discharge plan for their Bootleg compressor station, located in the NW/4 SE/4 of Section 18, Township 22 South, Range 33 East, NMPM, Lea County. The facility compresses natural gas for the Eunice gathering system. Total horsepower is 2956 HP. Approximately 254 bbls/month of produced water, 1100 gal/year of used oil, and 5 bbls/month of wash/skid water are generated and stored onsite. Groundwater most likely to be affected by a spill, leak or accidental discharge is at a depth of approximately 224 feet, with a total dissolved solids concentration of approximately 1973 mg/L. The discharge plan addresses how oilfield products and waste will be properly handled, stored, and disposed of, including how spills, leaks, and other accidental discharges to the surface will be managed in order to protect fresh water.

The NMOCD has determined that the application is administratively complete and has prepared a draft permit. The NMOCD will accept comments and statements of interest regarding this application and will create a facility-specific mailing list for persons who wish to receive future notices. Persons interested in obtaining further information, submitting comments or requesting to be on a facility-specific mailing list for future notices may contact the Environmental Bureau Chief of the Oil Conservation Division at the address given above. The administrative completeness determination and draft permit may be viewed at the above address between 8:00 a.m. and 4:00 p.m., Monday through Friday, or may also be viewed at the NMOCD web site <http://www.emnrd.state.nm.us/ocd/>. Persons interested in obtaining a copy of the application and draft permit may contact the NMOCD at the address given above. Prior to ruling on any proposed discharge permit or major modification, the Director shall allow a period of at least thirty (30) days after the date of publication of this notice, during which interested persons may submit comments or request that NMOCD hold a public hearing. Requests for a public hearing shall set forth the reasons why a hearing should be held. A hearing will be held if the Director determines that there is significant public interest.

If no public hearing is held, the Director will approve or disapprove the proposed permit based on information available, including all comments received. If a public hearing is held, the director will approve or disapprove the proposed permit based on information in the permit application and information submitted at the hearing.

Para obtener más información sobre esta solicitud en español, sirvase comunicarse por favor: New Mexico Energy, Minerals and Natural Resources Department (Depto. Del Energia, Minerals y Recursos Naturales de Nuevo México), Oil Conservation Division (Depto. Conservación Del Petróleo), 1220 South St. Francis Drive, Santa Fe, New México (Contacto: Dorothy Phillips, 505-476-3461)

GIVEN under the Seal of New Mexico Oil Conservation Commission at Santa Fe, New Mexico, on this **24** day of November 2009.

STATE OF NEW MEXICO
OIL CONSERVATION DIVISION

SEAL

Mark Fesmire, Director

ACKNOWLEDGEMENT OF RECEIPT
OF CHECK/CASH

I hereby acknowledge receipt of check No. _____ dated 9/21/09

or cash received on _____ in the amount of \$ 100⁰⁰

from DCP Midstream LP

for GW-176

Submitted by: Lawrence Romero Date: 9/25/09

Submitted to ASD by: Lawrence Romero Date: 9/25/09

Received in ASD by: _____ Date: _____

Filing Fee _____ New Facility _____ Renewal _____

Modification _____ Other _____

Organization Code 521.07 Applicable FY 2004

To be deposited in the Water Quality Management Fund.

Full Payment _____ or Annual Increment _____



RECEIVED
2009 SEP 22 AM 11 50

September 21, 2009

UPS NEXT DAY AIR (Tracking Number 1Z F46 915 13 9330 6465)

Mr. Leonard Lowe
Environmental Engineer
Oil Conservation Division
New Mexico Energy, Minerals
& Natural Resources Department
1220 South St. Francis Drive
Santa Fe, NM 87505

Subject: Bootleg Compressor Station Discharge Permit Renewal Application (GW-176)
Lea County, New Mexico

Dear Mr. Lowe:

Enclosed are the original and two copies of DCP Midstream, LP's ("DCP MIDSTREAM") discharge permit renewal application for the Bootleg Compressor Station (GW-176). Also enclosed is a check in the amount of \$100.00 for the discharge permit application filing fee.

DCP MIDSTREAM will satisfy the requirements of 20.6.2.3108 NMAC by providing notice under Subsection B of 20.6.2.3108NMAC. DCP MIDSTREAM plans to publish a public notice in the Hobbs News Sun for the Bootleg Compressor Station discharge permit renewal application. DCP MIDSTREAM will publish a synopsis of the notice, in English and in Spanish, in a display ad at least two inches by three inches, not in the classified or legal advertisements section in the Hobbs News Sun.

The Bootleg Compressor Station does not have any discharges that may move directly or indirectly into groundwater. Please be advised that DCP MIDSTREAM's submittal of the application and application filing fee does not waive DCP MIDSTREAM's objection to the OCD's position regarding applicability of the WQCC regulations.

If you have any questions concerning DCP MIDSTREAM's renewal application, please contact me at (303) 605-2176. Please send all correspondence regarding this renewal to me at dekocis@dcpmidstream.com or 370 17th Street, Suite 2500, Denver, CO 80202.

Sincerely,
DCP Midstream, LP

Diane E. Kocis
Senior Environmental Specialist

Enclosures

cc: Larry Hill
NMOCD District 1 Office (Certified Mail Return Receipt Article No. 91 7108 2133 3932 9259 6614)
1625 N. French Drive
Hobbs, NM 88240

District I
1625 N. French Dr., Hobbs, NM 88240
District II
1301 W. Grand Avenue, Artesia, NM 88210
District III
1000 Rio Brazos Road, Aztec, NM 87410
District IV
1220 S. St. Francis Dr., Santa Fe, NM 87505

State of New Mexico
Energy Minerals and Natural Resources
Oil Conservation Division
1220 South St. Francis Dr.
Santa Fe, NM 87505

Revised June 10, 2003

Submit Original
Plus 1 Copy
to Santa Fe
1 Copy to Appropriate
District Office

**DISCHARGE PLAN APPLICATION FOR SERVICE COMPANIES, GAS PLANTS,
REFINERIES, COMPRESSOR, GEOTHERMAL FACILITIES
AND CRUDE OIL PUMP STATIONS**

(Refer to the OCD Guidelines for assistance in completing the application)

☐ New ☒ Renewal ☐ Modification

1. Type: Bootleg Compressor Station
2. Operator: DCP Midstream, L.P.
Address: see enclosed discharge plan
Contact Person: see enclosed discharge plan Phone: _____
3. Location: NW /4 SE /4 Section 28 Township 22S Range 33E
Submit large scale topographic map showing exact location.
4. Attach the name, telephone number and address of the landowner of the facility site.
see enclosed discharge plan
5. Attach the description of the facility with a diagram indicating location of fences, pits, dikes and tanks on the facility.
see enclosed discharge plan
6. Attach a description of all materials stored or used at the facility.
see enclosed discharge plan
7. Attach a description of present sources of effluent and waste solids. Average quality and daily volume of waste water must be included.
see enclosed discharge plan
8. Attach a description of current liquid and solid waste collection/treatment/disposal procedures.
see enclosed discharge plan
9. Attach a description of proposed modifications to existing collection/treatment/disposal systems.
see enclosed discharge plan
10. Attach a routine inspection and maintenance plan to ensure permit compliance.
see enclosed discharge plan
11. Attach a contingency plan for reporting and clean-up of spills or releases.
see enclosed discharge plan
12. Attach geological/hydrological information for the facility. Depth to and quality of ground water must be included.
see enclosed discharge plan
13. Attach a facility closure plan, and other information as is necessary to demonstrate compliance with any other OCD rules, regulations and/or orders.
see enclosed discharge plan
14. CERTIFICATION: I hereby certify that the information submitted with this application is true and correct to the best of my knowledge and belief.

Name: Kelly Jamerson

Title: Asset Manager

Signature: Kelly Jamerson

Date: 9/3/09

E-mail Address: KJJamerson@dcpmidstream.com

Bootleg Compressor Station
NW/4 SE/4 Section 18 Township 22S Range 33E

DISCHARGE PLAN

This document constitutes a renewal application for the Groundwater Discharge Plan for the Bootleg Compressor Station, Discharge Permit GW-176. This Discharge Plan application has been prepared in accordance with the NMOCD "Guidelines for the Preparation of Discharge Plans at Natural Gas Plants, Refineries, Compressor and Crude Oil Pump Stations" (revised 12-95) and New Mexico Water Quality Control Commission (WQCC) regulations, 20.6.2.3106.C NMAC.

1 Type of Operation

The Bootleg facility is a compressor station. The total site horsepower is 2,956. The facility does not intend or have a discharge or discharges that may move directly or indirectly into groundwater.

2 Operator / Legally Responsible Party

Operator

DCP Midstream, LP
1625 West Marland
Hobbs, NM 88240
(575) 397-5500
Contact Person: Mr. Kelly Jamerson – Asset Manager

Legally Responsible Party

DCP Midstream, LP
370 17th Street, Suite 2500
Denver, CO 80202
(303) 595-3331
Contact Person: John Admire – Director, Environmental Protection

3 Location Facility

NW/4 SE/4 Section 18 Township 22S Range 33E, Lea County, NM

See Figure 1 – Site Location Map.

4 Landowner

DCP Midstream, LP
370 17th Street, Suite 2500
Denver, CO 80202
(303) 595-3331

5 Facility Description

The facility provides natural gas compression for the Eunice Gathering System. See Figure 2 – Site Plot Plan.

6 Materials Stored or Used

There are no materials stored on-site or used that are discharged on site so that they may move directly or indirectly into groundwater.

Materials used or stored on site are summarized in the following table. Volumes represented in the table are the container capacities.

Materials Stored/Used	Method of Storage	Approximate Volume
Slop Oil/Equipment Washdown Water	Aboveground storage tank within secondary containment	100 barrels
Produced Water	Aboveground storage tank within secondary containment	100 barrels
Condensate	Aboveground storage tanks within secondary containment	(2) 210 barrels
Lube Oil	Aboveground storage tank within secondary containment	(2) 500 gallons
Antifreeze	Aboveground storage tank within secondary containment	(2) 400 gallons
Methanol	Aboveground storage tank within secondary containment	(3) 500 gallons
Triethylene Glycol (TEG)	Aboveground storage tank within secondary containment	1,000 gallons
Engine Skid Drain Storage (equipment washdown and stormwater)	Below-grade tank with leak detection (tank within a tank)	1,000 gallons
Used Oil	Aboveground storage tank within secondary containment	1,000 gallons

7 Sources and Quantities of Effluent and Waste Solids

All effluent and waste solids generated at the facility are stored in enclosed, above-ground tanks with secondary containment or in a below-grade tank with secondary containment and removed from the facility for off-site disposal in accordance with applicable NMOC, NMED, and EPA regulations. No effluent or waste solids are discharged onto or below the surface of the ground so that they may move directly or indirectly into groundwater.

Separators/Scrubbers

Effluent or waste solids generated from separators or scrubbers are not discharged on site so that they may move directly or indirectly into groundwater. They are routed to a 100-barrel slop oil tank where they are stored for offsite disposal.

Boilers and Cooling Towers/Fans

There are no boilers or cooling towers/fans at the facility.

Process and Storage Equipment Wash Down

Effluent or waste solids generated from process equipment wash down are not discharged on site so that they may move directly or indirectly into groundwater. Wash down fluids are routed through the sump to the 100-barrel slop oil tank for storage. The contents of the slop oil tank are routed through the Eunice Gas Plant stabilizer and heater-treater prior to sale or off site disposal, respectively.

Solvents/Degreasers

Solvent or degreasers are not used on site and therefore not discharged on site so that they may move directly or indirectly into groundwater.

Spent Acids/Caustics

Spent acids or caustics are not generated on site and therefore not discharged on site so that they may move directly or indirectly into groundwater.

Used Engine Coolants

Used antifreeze is not generated at the facility. The antifreeze is consumed by the engines so no waste coolant is generated. Antifreeze is not discharged on site so that it may move directly or indirectly into groundwater.

Used Oil

Used oil is not discharged on site so that it may move directly or indirectly into groundwater. Used oil is stored on site in an aboveground tank within secondary containment and transported offsite for recycling.

Used Oil Filters

Used oil filters are not discharged on site so that they may move directly or indirectly into groundwater. Used oil filters are transported to the Eunice Gas Plant for storage and transported offsite for recycling.

Solids and Sludges

Solids and sludges are not generated on site and therefore not discharged on site so that they may move directly or indirectly into groundwater.

Painting Wastes

Painting wastes are not generated at the facility and therefore not discharged on site so that they may move directly or indirectly into groundwater.

Sewage

Sewage is not generated at the facility and therefore not discharged on site so that it may move directly or indirectly into groundwater. There are no leach fields on site.

Lab Wastes

Lab wastes are not generated at the facility and therefore not discharged on site so that they may move directly or indirectly into groundwater.

Other Liquids and Solid Wastes

There are no other liquids or solid wastes generated at the facility.

8 Liquid and Solid Waste Collection / Storage / Disposal

Collection/Storage

All liquid and solid wastes are collected and stored in containers for off-site disposal. The table below provides a summary of storage and collection methods.

On-site Disposal

There are no on-site disposal activities at the facility.

Off-site Disposal

All liquid and solid wastes are disposed off site. The following table provides information regarding wastes collected and stored for off site disposal and/or recycling.

Waste	Collection Method/Storage	Quantity Generated	Final Disposition	Receiving Facility
Produced Water	Aboveground storage tank within secondary containment	254 bbls water/month	Off-site disposal	Eunice Plant Heater Treater
Equipment Skid/Washdown Water	1,000 gallon below-grade tank with secondary containment, then pumped to aboveground storage tank within secondary containment	5 bbls/month	Off-site disposal	Eunice Plant Heater Treater
Used Oil Filters	Removed from site when generated and taken to Eunice Gas Plant	3-5/month	Off-site recycling	Eunice Plant then to Thermo Fluids, Inc.
Used Oil	1,000 gallon aboveground storage tank	~ 1100 gals/year	Off-site recycling	Eunice Plant then to Thermo Fluids, Inc.

9 Proposed Modifications

None

10 Inspection, Maintenance, and Reporting

Routine inspections and maintenance are performed to ensure proper collection, storage, and off-site disposal of all wastes generated at the facility.

11 Spill / Leak Prevention and Reporting (Contingency Plans)

Routine inspections and maintenance are performed to ensure proper collection, storage, and off-site disposal of all wastes generated at the facility.

DCP will respond to and report spills according to the requirements of the State of New Mexico found in 19.15.29 NMAC and WQCC regulation, 20.6.2.1203 NMAC.

12 Site Characteristics

There are no water wells within one mile of the facility, according to the Office of the State Engineer's Water Rights Reporting System. A discharge permit application submitted in 1999 by LG&E Natural Gathering and Processing Company lists depth to groundwater as 224 feet with a total dissolved solids concentration of 1973 milligrams per liter.

The facility is located on sedimentary deposits derived from wind-blown deposits. According to the U.S. Department of Agriculture Soil Conservation Service, the area soil is well-drained. A typical soil profile is: 0 – 24 inches: Fine sand; 24-50 inches: Sandy clay loam; 50-60 inches: Cemented Material (caliche).

13 Additional Information

All unauthorized releases and discharges will be reported to the NMOCD in accordance with 19.15.29 NMAC and WQCC regulation 20.6.2.1203 NMAC.

FIGURES

FIGURE 1. Site Location Map – Bootleg Compressor Station

FIGURE 2. Facility Plot Plan – Bootleg Compressor Station.

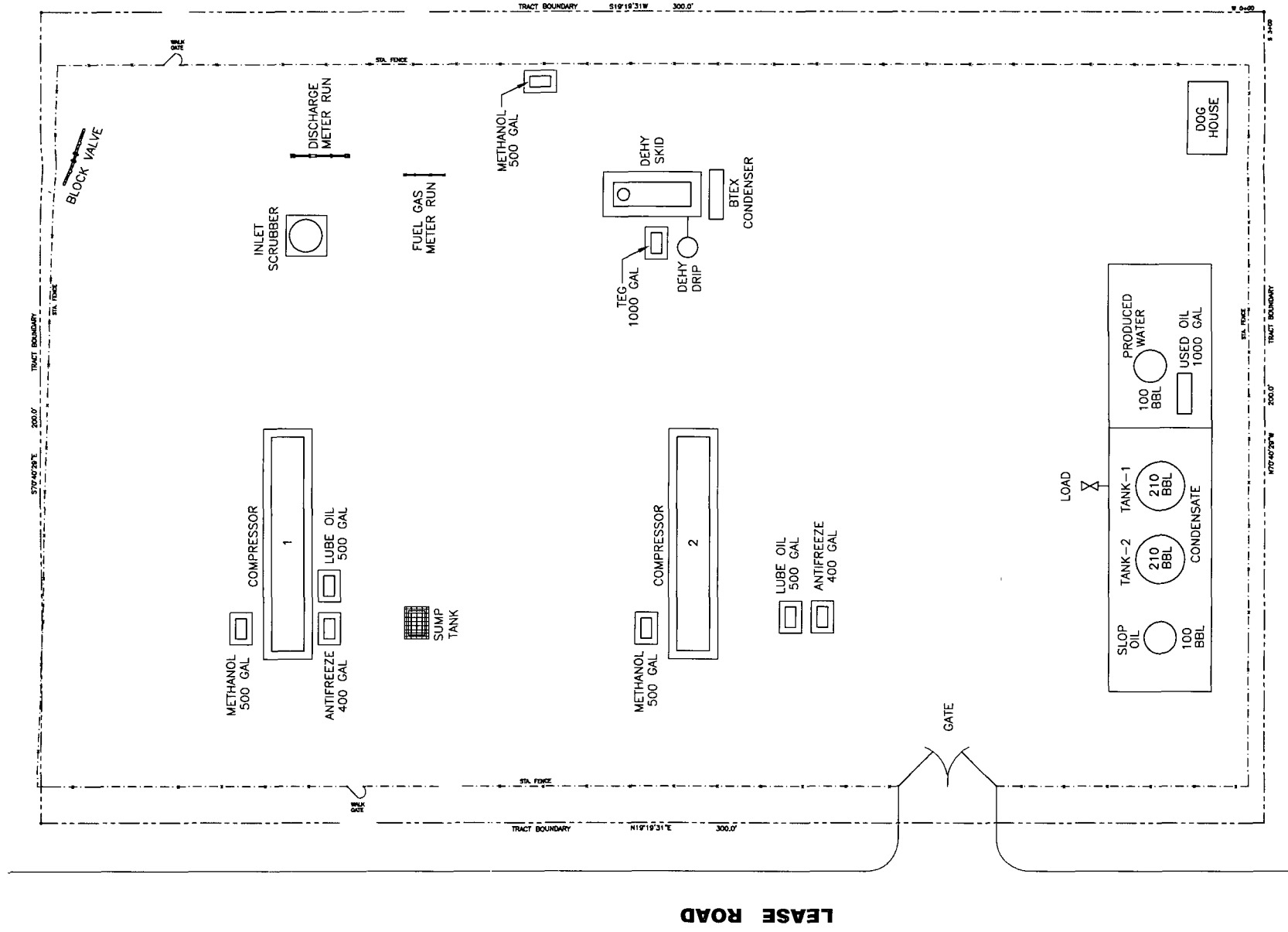

NOT TO SCALE
NOTE: SCALE IS APPROXIMATE.
DRAWING IS BASED ON A
FIELD SKETCH; ACTUAL
FACILITIES MAY VARY IN SIZE
AND POSITION FROM THOSE
REPRESENTED HERE.

BOOTLEG COMPRESSOR STATION EUNICE GATHERING SYSTEM

\\data\EhsDrawings\Mapping\NewMexico\Eunice\Bootleg_Plot

[illegible]

Chavez, Carl J, EMNRD

From: Klein, Elisabeth A [EAKlein@dcpmidstream.com]

Sent: Tuesday, June 26, 2007 10:01 AM

To: Chavez, Carl J, EMNRD

Subject: Affidavits of Publications

Attachments: Affidavit_Wonton CS GW-178.pdf; Affidavit_Antelope Ridge GP_ GW-162.pdf;
Affidavit_Bootleg CS GW-176.pdf; Affidavit_Cotton Draw CS GW-311.pdf; Affidavit_Maljamar
CS GW-177.pdf; Affidavit_Paige Hat Mesa CS GW-316.pdf

Attached are the affidavits of publication for: Antelope Ridge, Bootleg, Cotton Draw, Maljamar, Paige Hat Mesa and Wonton. These affidavits were delayed because the paper lost the original set of affidavits so they had to reissue.

I previously forwarded the affidavit for P&P Malaga.

Please call me if you have any questions.

Thanks,
Elisabeth Klein
303-605-1778

This inbound email has been scanned by the MessageLabs Email Security System.

6/28/2007

Hobbs
392-3929

(505) 739-BACK (2225)

80202 has submitted a Draw Compressor Station located in the NW 7 SE 7 of Section 28, Township 22 South, Range 33 East, Lea County, New Mexico, approximately 43 miles southwest of Hobbs, NM to the Oil Conservation Division, 1220 South St. Francis Drive, Santa Fe, New Mexico, 87505. Telephone (505) 476-3440. DCP MIDSTREAM, LP does not propose to discharge effluent or waste solids on site; all effluent and waste solids generated at the facility are removed from the facility for off site disposal in accordance with applicable New Mexico Oil Conservation Division, New Mexico Environment Department, and EPA regulations. Ground water most likely to be affected in an event of an accidental discharge at the surface is at a depth of approximately 224 feet with a total dissolved solids concentration of approximately 1973 mg/L. The discharge plan addresses how spills, leaks, and other accidental discharges to the surface will be managed. Any interested person may obtain further information, submit comments, and request to be placed on a facility-specific mailing list to receive future notices to the Oil Conservation Division at the address or telephone number given above. The Oil Conservation Division will accept comments and statements of interest regarding the renewal application and will create a facility-specific mailing list for persons who wish to receive future notices.

El DCP 80202 se han sometido una aplicación (GW-176) de la renovación del plan de la descarga para su estación de compresor de Borelog en el NW 7 SE 7 de la Sección 28, Municipio 22 al sur, la Rango 33 al este, Lea County, New Mexico, aproximadamente 43 surcetes de millas de Hobbs, NM to the Oil Conservation Division, 1220 South St. Francis Drive, Santa Fe, New Mexico, 87505, el Teléfono (505) 476-3440. DCP MIDSTREAM, LP no propone descargar efluente ni los sólidos del desecho en el sitio; todo efluente y los sólidos del desecho engendrados en la facilidad son quitados de la facilidad para de la disposición del sitio de acuerdo con División aplicable de la Conservación del Petróleo de nuevo México, del Departamento del Ambiente de nuevo México, y de las regulaciones de EPA. Molió agua muy probable de ser afectada en un acontecimiento de una descarga accidental en la superficie está en una profundidad de aproximadamente 224 pies con un suma la concentración disuelta de sólidos de aproximadamente 1973 mg/L. Las direcciones del plan de la descarga como reclar, los escapes, y otras descargas accidentales a la superficie serán manejados. Alguna persona interesada puede obtener información adicional, se somete los comentarios, y se pedido para ser colocada en un dirección de envío facilidad-específico para recibir notas futuras a la División de la Conservación del Petróleo en la dirección o el número de teléfono dados arriba. La División de la Conservación del Petróleo aceptará los comentarios y las declaraciones del interés con respecto a la aplicación de la renovación y creará una lista de envío facilidad-específico para personas que desea recibir notas futuras.

DCP Midstream, LP, 370 17th Street, Suite 2500, Denver, Colorado 80202 has submitted a discharge plan renewal application (GW-176) for its Borelog Compressor Station located in the NW 7 SE 7 of Section 28, Township 22 South, Range 33 East, Lea County, New Mexico, approximately 43 miles southwest of Hobbs, NM to the Oil Conservation Division, 1220 South St. Francis Drive, Santa Fe, New Mexico, 87505. Telephone (505) 476-3440. DCP MIDSTREAM, LP does not propose to discharge effluent or waste solids on site; all effluent and waste solids generated at the facility are removed from the facility for off site disposal in accordance with applicable New Mexico Oil Conservation Division, New Mexico Environment Department, and EPA regulations. Ground water most likely to be affected in an event of an accidental discharge at the surface is at a depth of approximately 224 feet with a total dissolved solids concentration of approximately 1973 mg/L. The discharge plan addresses how spills, leaks, and other accidental discharges to the surface will be managed. Any interested person may obtain further information, submit comments, and request to be placed on a facility-specific mailing list to receive future notices to the Oil Conservation Division at the address or telephone number given above. The Oil Conservation Division will accept comments and statements of interest regarding the renewal application and will create a facility-specific mailing list for persons who wish to receive future notices.

DCP Midstream, LP, 370 17th Street, Suite 2500, Denver, Colorado 80202 se han sometido una aplicación (GW-176) de la renovación del plan de la descarga para su estación de compresor de Borelog en el NW 7 SE 7 de la Sección 28, Municipio 22 al sur, la Rango 33 al este, Lea County, New Mexico, aproximadamente 43 surcetes de millas de Hobbs, NM to the Oil Conservation Division, 1220 South St. Francis Drive, Santa Fe, New Mexico, 87505, el Teléfono (505) 476-3440. DCP Midstream, LP no propone descargar efluente ni los sólidos del desecho en el sitio; todo efluente y los sólidos del desecho engendrados en la facilidad son quitados de la facilidad para de la disposición del sitio de acuerdo con División aplicable de la Conservación del Petróleo de nuevo México, del Departamento del Ambiente de nuevo México, y de las regulaciones de EPA. Molió agua muy probable de ser afectada en un acontecimiento de una descarga accidental en la superficie está en una profundidad de aproximadamente 224 pies con un suma la concentración disuelta de sólidos de aproximadamente 1973 mg/L. Las direcciones del plan de la descarga como reclar, los escapes, y otras descargas accidentales a la superficie serán manejados. Alguna persona interesada puede obtener información adicional, se somete los comentarios, y se pedido para ser colocada en un dirección de envío facilidad-específico para recibir notas futuras a la División de la Conservación del Petróleo en la dirección o el número de teléfono dados arriba. La División de la Conservación del Petróleo aceptará los comentarios y las declaraciones del interés con respecto a la aplicación de la renovación y creará una lista de envío facilidad-específico para personas que desea recibir notas futuras.

*ist extremely professional people
ith, and they're always looking
for you, the customer."*

Phil Millender
Phil Millender Agency
Farmers Insurance

Give Names and Numbers A Call At:

00-592-7625

009

Much of the al-Busissat
province from the terror ne
the Iraqi Sunni leaders
area near Fallujah, Tuesda
tribal chiefs who opposed al
BAGHDAD (AP) — A su

Suicide bomber tar

Briefs

democracy.
their troubled records
both Russia and China
system. Then, Bush fault
cizing the U.S. anti-mis
China joined Russia in cr
In a swift turn of ever
missile shield is erected.
missiles on Europe if a l
threatened to retaliate Rus
Bush emphasized after Pu
"Russia is not our enem
lying to Germany.
of remarks in Prague bel
Bush set the stage with a se
Heilighendamm, Germany
summit of major powers
and the opening of the ann
each other until Wednesday
The two leaders won't
promised.

"The Cold War is over," Bu
Europe, Bush assured h
missile defense system
But don't worry about a
Russian leader
Stop backsliding on democ
chill.
Moscow fell deeper into an
between Washington
Madimir Putin as relat
Tuesday toward Russ
double-barreled appro
(AP) — President Bush too
PRAGUE, Czech Repul

shield in Europe
says not to fear miss
Putin over reforms,
President chides

Bush p
cop, ba
with Ri

AFFIDAVIT OF PUBLICATION

State of New Mexico,
County of Lea.

I, KATHI BEARDEN

PUBLISHER

of the Hobbs News-Sun, a news-
paper published at Hobbs, New
Mexico, do solemnly swear that
the clipping attached hereto was
published once a week in the reg-
ular and entire issue of said
paper, and not a supplement
thereof for a period

of 1

issue(s).

Beginning with the issue dated

June 6, 2007

and ending with the issue dated

June 6, 2007

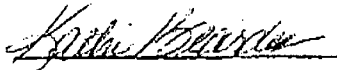

PUBLISHER

Sworn and subscribed to before

this 20th day of

June, 2007

Notary Public

My Commission expires
February 07, 2009
(Seal)

This newspaper is duly qualified to
publish legal notices or advertise-
ments within the meaning of
Section 3, Chapter 167, Laws of
1937, and payment of fees for said
publication has been made.

49100061
JEFF ROSS
DCP MIDSTREAM
370 17TH ST, SUITE 2500
DENVER, CO 80202-5604

49664053

Elisabeth A. Klein
Principal Specialist
DCP Midstream L.P.
370 17th Street, Suite 2500
Denver, CO 80202

July 30, 2007

Dear Ms. Klein:

Re: Minor Modification to DP Permit (GW-176): Corrected Expiration Date: January 20, 2010

By receipt of this e-mail correspondence, and mail, the Oil Conservation Division recently discovered that the date of expiration on the final signed discharge plan (DP) issued on June 13, 2007, for the Bootleg Compressor Station contained an incorrect "Expiration Date." This e-mail/letter serves as a "Minor Modification" to the DP Permit and serves to correct the expiration date in the existing permit from June 10, 2012 to January 20, 2010, the correct date of expiration.

Please contact me if you have questions on the corrected and official expiration date of January 20, 2010 for this facility. This "Minor Modification" has been attached to the DP in our file. Sorry for any inconvenience this may have caused you. Thank you.

Carl J. Chavez, CHMM
New Mexico Energy, Minerals & Natural Resources Dept.
Oil Conservation Division, Environmental Bureau
1220 South St. Francis Dr., Santa Fe, New Mexico 87505
Office: (505) 476-3491
Fax: (505) 476-3462
E-mail: CarlJ.Chavez@state.nm.us
Website: <http://www.emnrd.state.nm.us/ocd/index.htm>
(Pollution Prevention Guidance is under "Publications")



DCP Midstream
370 17th Street, Suite 2500
Denver, CO 80202
303-595-3331

July 16, 2007

UPS Next Day Air (Tracking Number 1Z F46 915 23 1003 5028)

Mr. Carl Chavez
New Mexico Energy, Minerals
& Natural Resources Department
Oil Conservation Division
1220 South St. Francis Drive
Santa Fe, NM 87505

SUBJECT:

Discharge Plan Renewals GW-162, GW-316, GW-311, GW-178, GW-177, and GW-176 ⁺¹⁶⁷
Lea County, New Mexico

Dear Mr. Chavez:

DCP Midstream LP submits the following:

- Check in the amount of \$4,000.00 the Antelope Ridge Gas Plant discharge plan flat fee and
- Signed copy of the Discharge Plan Approval Conditions for the Antelope Ridge Gas Plant
- Checks in the amount of \$1,700.00 each for the Paige Hat Mesa Compressor Station (GW-316), Cotton Draw Compressor Station (GW-311), Wonton Compressor Station (GW-178), Maljamar Compressor Station (GW-177), Bootleg Compressor Station (GW-176)
- Signed copies of the Discharge Plan Approval Conditions for the facilities listed above.

DCP Midstream's submittal of the signed conditions and fee does not waive our objections to the obtaining a discharge permit. DCP Midstream disagrees that any discharge plan is required for this facility under the WQCC's regulations.

If you have any questions regarding this submittal, please call me at (303) 605-1778.

Sincerely,

DCP Midstream LP

Elisabeth A. Klein
Principal Specialist

Enclosures

cc: NMOCD District 1 Office
1625 N. French Drive
Hobbs, New Mexico 88240

ACKNOWLEDGEMENT OF RECEIPT
OF CHECK/CASH

I hereby acknowledge receipt of check No. dated 7/13/07

or cash received on in the amount of \$ 1200⁰⁰

from DCP Midstream LP

for EW-176

Submitted by: Lawrence Romero Date: 7/26/07

Submitted to ASD by: Lawrence Romero Date: 7/26/07

Received in ASD by: Date:

Filing Fee New Facility Renewal ☒

Modification Other

Organization Code 521.07 Applicable FY 2004

To be deposited in the Water Quality Management Fund.

Full Payment ☒ or Annual Increment



NEW MEXICO ENERGY, MINERALS and NATURAL RESOURCES DEPARTMENT

BILL RICHARDSON

Governor

Joanna Prukop

Cabinet Secretary

Mark E. Fesmire, P.E.

Director

Oil Conservation Division

June 13, 2007

Eliabeth Klein
DCP Midstream, LP
370 17th Street, Suite 2500
Denver, Colorado 80202

RECEIVED

JUN 19 2007

Re: Discharge Permit GW-176
Bootleg Compressor Station

**DCP Midstream
Environment Health & Safety**

Dear Ms. Klein:

Pursuant to Water Quality Control Commission (WQCC) Regulations 20.6.2.3000 - 20.6.2.3114 NNAC, the Oil Conservation Division (OCD) hereby approves the discharge permit for the DCP Midstream, LP (owner/operator) Bootleg Compressor Station GW-176 located in the NW/4 SE/4 of Section 28, Township 22 South, Range 33 East, NMPM, Lea County, New Mexico, under the conditions specified in the enclosed **Attachment To The Discharge Permit**. Enclosed are two copies of the conditions of approval. **Please sign and return one copy to the New Mexico Oil Conservation Division (OCD) Santa Fe Office within 30 working days of receipt of this letter including permit fees.**

Please be advised that approval of this permit does not relieve the owner/operator of responsibility should operations result in pollution of surface water, ground water or the environment. Nor does approval of the permit relieve the owner/operator of its responsibility to comply with any other applicable governmental authority's rules and regulations.

If you have any questions, please contact Carl Chavez of my staff at (505-476-3491) or E-mail carlj.chavez@state.nm.us. On behalf of the staff of the OCD, I wish to thank you and your staff for your cooperation during this discharge permit review.

Sincerely,

Wayne Price
Environmental Bureau Chief

LWP/cc
Attachments-1
xc: OCD District Office

**ATTACHMENT TO THE DISCHARGE PERMIT
DCP MIDSTREAM, LP, BOOTLEG COMPRESSOR STATION (GW-176)
DISCHARGE PERMIT APPROVAL CONDITIONS**

June 13, 2007

Please remit a check for \$1700.00 made payable to Water Quality Management Fund:

**Water Quality Management Fund
C/o: Oil Conservation Division
1220 S. Saint Francis Drive
Santa Fe, New Mexico 87505**

1. **Payment of Discharge Plan Fees:** All discharge permits are subject to WQCC Regulations. Every billable facility that submits a discharge permit application will be assessed a filing fee of \$100.00, plus a renewal flat fee (*see* WQCC Regulation 20.6.2.3114 NMAC). The Oil Conservation Division ("OCD") has received the required \$100.00 filing fee. However, the owner/operator still owes the required \$1700.00 renewal permit fee for a gas compressor station greater than 1001 horsepower.
2. **Permit Expiration, Renewal Conditions and Penalties:** Pursuant to WQCC Regulation 20.6.2.3109.H.4 NMAC, this permit is valid for a period of five years. **The permit will expire on June 10, 2012** and an application for renewal should be submitted no later than 120 days before that expiration date. Pursuant to WQCC Regulation 20.6.2.3106.F NMAC, if a discharger submits a discharge permit renewal application at least 120 days before the discharge permit expires and is in compliance with the approved permit, then the existing discharge permit will not expire until the application for renewal has been approved or disapproved. *Expired permits are a violation of the Water Quality Act {Chapter 74, Article 6, NMSA1978} and civil penalties may be assessed accordingly.*
3. **Permit Terms and Conditions:** Pursuant to WQCC Regulation 20.6.2.3104 NMAC, when a permit has been issued, the owner/operator must ensure that all discharges shall be consistent with the terms and conditions of the permit. In addition, all facilities shall abide by the applicable rules and regulations administered by the OCD pursuant to the Oil and Gas Act, NMSA 1978, Sections 70-2-1 through 70-2-38.
4. **Owner/Operator Commitments:** The owner/operator shall abide by all commitments submitted in its February 7, 2007 discharge plan renewal application, including attachments and subsequent amendments and these conditions for approval. Permit applications that reference previously approved plans on file with the division shall be incorporated in this permit and the owner/operator shall abide by all previous commitments of such plans and these conditions for approval.

5. Modifications: WQCC Regulation 20.6.2.3107.C, and 20.6.2.3109 NMAC addresses possible future modifications of a permit. The owner/operator (discharger) shall notify the OCD of any facility expansion, production increase or process modification that would result in any significant modification in the discharge of water contaminants. The Division Director may require a permit modification if any water quality standard specified at 20.6.2.3103 NMAC is being or will be exceeded, or if a toxic pollutant as defined in WQCC Regulation 20.6.2.7 NMAC is present in ground water at any place of withdrawal for present or reasonably foreseeable future use, or that the Water Quality Standards for Interstate and Intrastate streams as specified in 20.6.4 NMAC are being or may be violated in surface water in New Mexico.

6. Waste Disposal and Storage: The owner/operator shall dispose of all wastes at an OCD-approved facility. Only oil field RCRA-exempt wastes may be disposed of by injection in a Class II well. RCRA non-hazardous, non-exempt oil field wastes may be disposed of at an OCD-approved facility upon proper waste determination pursuant to 40 CFR Part 261. Any waste stream that is not listed in the discharge permit application must be approved by the OCD on a case-by-case basis.

A. OCD Rule 712 Waste: Pursuant to OCD Rule 712 (19.15.9.712 NMAC) disposal of certain non-domestic waste without notification to the OCD is allowed at NMED permitted solid waste facilities if the waste stream has been identified in the discharge permit and existing process knowledge of the waste stream does not change.

B. Waste Storage: The owner/operator shall store all waste in an impermeable bermed area, except waste generated during emergency response operations for up to 72 hours. All waste storage areas shall be identified in the discharge permit application. Any waste storage area not identified in the permit shall be approved on a case-by-case basis only. The owner/operator shall not store oil field waste on-site for more than 180 days unless approved by the OCD.

7. Drum Storage: The owner/operator must store all drums, including empty drums, containing materials other than fresh water on an impermeable pad with curbing. The owner/operator must store empty drums on their sides with the bungs in place and lined up on a horizontal plane. The owner/operator must store chemicals in other containers, such as tote tanks, sacks, or buckets on an impermeable pad with curbing.

8. Process, Maintenance and Yard Areas: The owner/operator shall either pave and curb or have some type of spill collection device incorporated into the design at all process, maintenance, and yard areas which show evidence that water contaminants from releases, leaks and spills have reached the ground surface.

9. Above Ground Tanks: The owner/operator shall ensure that all aboveground tanks have impermeable secondary containment (e.g., liners and berms), which will contain a volume of at least one-third greater than the total volume of the largest tank or all interconnected tanks. The owner/operator shall retrofit all existing tanks before discharge permit renewal. Tanks that contain fresh water or fluids that are gases at atmospheric temperature and pressure are exempt from this condition.

10. Labeling: The owner/operator shall clearly label all tanks, drums, and containers to identify their contents and other emergency notification information. The owner/operator may use a tank code numbering system, which is incorporated into their emergency response plans.

11. Below-Grade Tanks/Sumps and Pits/Ponds.

A. All below-grade tanks and sumps must be approved by the OCD prior to installation and must incorporate secondary containment with leak detection into the design. The owner/operator shall retrofit all existing systems without secondary containment and leak detection before discharge permit renewal. All existing below-grade tanks and sumps without secondary containment and leak detection must be tested annually or as specified herein. Systems that have secondary containment with leak detection shall have a monthly inspection of the leak detection system to determine if the primary containment is leaking. Small sumps or depressions in secondary containment systems used to facilitate fluid removal are exempt from these requirements if fluids are removed within 72 hours.

B. All pits and ponds, including modifications and retrofits, shall be designed by a certified registered professional engineer and approved by the OCD prior to installation. In general, all pits or ponds shall have approved hydrologic and geologic reports, location, foundation, liners, and secondary containment with leak detection, monitoring and closure plans. All pits or ponds shall be designed, constructed and operated so as to contain liquids and solids in a manner that will protect fresh water, public health, safety and the environment for the foreseeable future. The owner/operator shall retrofit all existing systems without secondary containment and leak detection before discharge permit renewal.

C. The owner/operator shall ensure that all exposed pits, including lined pits and open top tanks (8 feet in diameter or larger) shall be fenced, screened, netted, or otherwise rendered non-hazardous to wildlife, including migratory birds.

D. The owner/operator shall maintain the results of tests and inspections at the facility covered by this discharge permit and available for OCD inspection. The owner/operator shall report the discovery of any system which is found to be leaking or has lost integrity to the OCD within 15 days. The owner/operator may propose various methods for testing such as pressure testing to 3 pounds per square inch greater than normal operating pressure and/or visual inspection of cleaned tanks and/or sumps, or other OCD-approved methods. The owner/operator shall notify the OCD at least 72 hours prior to all testing.

12. Underground Process/Wastewater Lines:

A. The owner/operator shall test all underground process/wastewater pipelines at least once every five (5) years to demonstrate their mechanical integrity, except lines containing fresh water or fluids that are gases at atmospheric temperature and pressure. Pressure rated pipe shall be tested by pressuring up to one and one-half times the normal operating pressure, if possible, or for atmospheric drain systems, to 3 pounds per square inch greater than normal operating pressure, and pressure held for a minimum of 30 minutes with no more than a 1% loss/gain in pressure. The owner/operator may use other methods for testing if approved by the OCD.

B. The owner/operator shall maintain underground process and wastewater pipeline schematic diagrams or plans showing all drains, vents, risers, valves, underground piping, pipe type, rating, size, and approximate location. All new underground piping must be approved by the OCD prior to installation. The owner/operator shall report any leaks or loss of integrity to the OCD within 15 days of discovery. The owner/operator shall maintain the results of all tests at the facility covered by this discharge permit and they shall be available for OCD inspection. The owner/operator shall notify the OCD at least 72 hours prior to all testing.

13. Class V Wells: The owner/operator shall close all Class V wells (e.g., septic systems, leach fields, dry wells, etc.) that inject non-hazardous industrial wastes or a mixture of industrial wastes and domestic wastes unless it can be demonstrated that ground water will not be impacted in the reasonably foreseeable future. Leach fields and other wastewater disposal systems at OCD-regulated facilities that inject non-hazardous fluid into or above an underground source of drinking water are considered Class V injection wells under the EPA UIC program. Class V wells that inject domestic waste only, must be permitted by the New Mexico Environment Department (NMED).

14. Housekeeping: The owner/operator shall inspect all systems designed for spill collection/prevention and leak detection at least monthly to ensure proper operation and to prevent over topping or system failure. All spill collection and/or secondary containment devices shall be emptied of fluids within 72 hours of discovery. The owner/operator shall maintain all records at the facility and available for OCD inspection.

15. Spill Reporting: The owner/operator shall report all unauthorized discharges, spills, leaks and releases and conduct corrective action pursuant to WQCC Regulation 20.5.12.1203 NMAC and OCD Rule 116 (19.15.3.116 NMAC). The owner/operator shall notify both the OCD District Office and the Santa Fe Office within 24 hours and file a written report within 15 days.

16. OCD Inspections: The OCD may place additional requirements on the facility and modify the permit conditions based on OCD inspections.

17. Storm Water: The owner/operator shall implement and maintain run-on and runoff plans and controls. The owner/operator shall not discharge any water contaminant that exceeds the WQCC standards specified in 20.6.2.3101 NMAC or 20.6.4 NMAC (Water Quality Standards for Interstate and Intrastate Streams) including any oil sheen in any stormwater run-off. The owner/operator shall notify the OCD within 24 hours of discovery of any releases and shall take immediate corrective action(s) to stop the discharge.

18. Unauthorized Discharges: The owner/operator shall not allow or cause water pollution, discharge or release of any water contaminant that exceeds the WQCC standards listed in 20.6.2.3101 NMAC or 20.6.4 NMAC (Water Quality Standards for Interstate and Intrastate Streams) unless specifically listed in the permit application and approved herein. *An unauthorized discharge is a violation of this permit.*

19. Vadose Zone and Water Pollution: The owner/operator shall address any contamination through the discharge permit process or pursuant to WQCC 20.6.2.4000-.4116 NMAC (Prevention and Abatement of Water Pollution). The OCD may require the owner/operator to modify its permit for investigation, remediation, abatement, and monitoring requirements for any vadose zone or water pollution. Failure to perform any required investigation, remediation, abatement and submit subsequent reports will be a violation of the permit.

20. Additional Site Specific Conditions: N/A

21. Transfer of Discharge Permit (WQCC 20.6.2.3111) Prior to any transfer of ownership, control, or possession (whether by lease, conveyance or otherwise) of a facility with a discharge permit, the transferor shall notify the transferee in writing of the existence of the discharge permit, and shall deliver or send by certified mail to the department a copy of such written notification, together with a certification or other proof that such notification has in fact been received by the transferee. Upon receipt of such notification, the transferee shall have the duty to inquire into all of the provisions and requirements contained in such discharge permit, and the transferee shall be charged with notice of all such provisions and requirements as they appear of record in the department's file or files concerning such discharge permit. The transferee (new owner/operator) shall sign and return an original copy of these permit conditions and provide a written commitment to comply with the terms and conditions of the previously approved discharge permit.

22. Closure: The owner/operator shall notify the OCD when operations of the facility are to be discontinued for a period in excess of six months. Prior to closure of the facility, the operator shall submit a closure plan for approval. Closure and waste disposal shall be in accordance with the statutes, rules and regulations in effect at the time of closure.

23. Certification: DCP Midstream, LP, (Owner/Operator), by the officer whose signature appears below, accepts this permit and agrees to comply with all submitted commitments, including these terms and conditions contained here. **Owner/Operator** further acknowledges that the OCD may, for good cause shown, as necessary to protect fresh water, public health, safety, and the environment, change the conditions and requirements of this permit administratively.

Elsabeth Klein

GV-176

June 13, 2007

Page 7 of 7

Conditions accepted by: "I certify under penalty of law that I have personally examined and am familiar with the information submitted in this document and all attachments and that, based on my inquiry of those individuals immediately responsible for obtaining the information, I believe that the information is true, accurate, and complete. I am aware that there are significant penalties for submitting false information including the possibility of fine and imprisonment."

D.P. MIDSTREAM LP
Company Name-print name above

TONY R. LEE
Company Representative- print name

Tony R Lee
Company Representative signature

Title ASSET MANAGER

Date: 7-3-07



NEW MEXICO ENERGY, MINERALS and NATURAL RESOURCES DEPARTMENT

BILL RICHARDSON

Governor

Joanena Prukop

Cabinet Secretary

Mark E. Fesmire, P.E.

Director

Oil Conservation Division

June 13, 2007

Elisabeth Klein
DCP Midstream, LP
370 17th Street, Suite 2500
Denver, Colorado 80202

Re: Discharge Permit GW-176
Bootleg Compressor Station

Dear Ms. Klein:

Pursuant to Water Quality Control Commission (WQCC) Regulations 20.6.2.3000 - 20.6.2.3114 NMAC, the Oil Conservation Division (OCD) hereby approves the discharge permit for the DCP Midstream, LP (owner/operator) Bootleg Compressor Station GW-176 located in the NW/4 SE/4 of Section 28, Township 22 South, Range 33 East, NMPM, Lea County, New Mexico, under the conditions specified in the enclosed **Attachment To The Discharge Permit**. Enclosed are two copies of the conditions of approval. **Please sign and return one copy to the New Mexico Oil Conservation Division (OCD) Santa Fe Office within 30 working days of receipt of this letter including permit fees.**

Please be advised that approval of this permit does not relieve the owner/operator of responsibility should operations result in pollution of surface water, ground water or the environment. Nor does approval of the permit relieve the owner/operator of its responsibility to comply with any other applicable governmental authority's rules and regulations.

If you have any questions, please contact Carl Chavez of my staff at (505-476-3491) or E-mail carlj.chavez@state.nm.us. On behalf of the staff of the OCD, I wish to thank you and your staff for your cooperation during this discharge permit review.

Sincerely,

Wayne Price

Environmental Bureau Chief

LWP/cc

Attachments-1

xc: OCD District Office

**ATTACHMENT TO THE DISCHARGE PERMIT
DCP MIDSTREAM, LP, BOOTLEG COMPRESSOR STATION (GW-176)
DISCHARGE PERMIT APPROVAL CONDITIONS
June 13, 2007**

Please remit a check for \$1700.00 made payable to Water Quality Management Fund:

**Water Quality Management Fund
C/o: Oil Conservation Division
1220 S. Saint Francis Drive
Santa Fe, New Mexico 87505**

- 1. Payment of Discharge Plan Fees:** All discharge permits are subject to WQCC Regulations. Every billable facility that submits a discharge permit application will be assessed a filing fee of \$100.00, plus a renewal flat fee (*see* WQCC Regulation 20.6.2.3114 NMAC). The Oil Conservation Division ("OCD") has received the required \$100.00 filing fee. However, the owner/operator still owes the required \$1700.00 renewal permit fee for a gas compressor station greater than 1001 horsepower.
- 2. Permit Expiration, Renewal Conditions and Penalties:** Pursuant to WQCC Regulation 20.6.2.3109.H.4 NMAC, this permit is valid for a period of five years. **The permit will expire on June 10, 2012** and an application for renewal should be submitted no later than 120 days before that expiration date. Pursuant to WQCC Regulation 20.6.2.3106.F NMAC, if a discharger submits a discharge permit renewal application at least 120 days before the discharge permit expires and is in compliance with the approved permit, then the existing discharge permit will not expire until the application for renewal has been approved or disapproved. *Expired permits are a violation of the Water Quality Act {Chapter 74, Article 6, NMSA1978} and civil penalties may be assessed accordingly.*
- 3. Permit Terms and Conditions:** Pursuant to WQCC Regulation 20.6.2.3104 NMAC, when a permit has been issued, the owner/operator must ensure that all discharges shall be consistent with the terms and conditions of the permit. In addition, all facilities shall abide by the applicable rules and regulations administered by the OCD pursuant to the Oil and Gas Act, NMSA 1978, Sections 70-2-1 through 70-2-38.
- 4. Owner/Operator Commitments:** The owner/operator shall abide by all commitments submitted in its February 7, 2007 discharge plan renewal application, including attachments and subsequent amendments and these conditions for approval. Permit applications that reference previously approved plans on file with the division shall be incorporated in this permit and the owner/operator shall abide by all previous commitments of such plans and these conditions for approval.

- 5. Modifications:** WQCC Regulation 20.6.2.3107.C, and 20.6.2.3109 NMAC addresses possible future modifications of a permit. The owner/operator (discharger) shall notify the OCD of any facility expansion, production increase or process modification that would result in any significant modification in the discharge of water contaminants. The Division Director may require a permit modification if any water quality standard specified at 20.6.2.3103 NMAC is being or will be exceeded, or if a toxic pollutant as defined in WQCC Regulation 20.6.2.7 NMAC is present in ground water at any place of withdrawal for present or reasonably foreseeable future use, or that the Water Quality Standards for Interstate and Intrastate streams as specified in 20.6.4 NMAC are being or may be violated in surface water in New Mexico.
- 6. Waste Disposal and Storage:** The owner/operator shall dispose of all wastes at an OCD-approved facility. Only oil field RCRA-exempt wastes may be disposed of by injection in a Class II well. RCRA non-hazardous, non-exempt oil field wastes may be disposed of at an OCD-approved facility upon proper waste determination pursuant to 40 CFR Part 261. Any waste stream that is not listed in the discharge permit application must be approved by the OCD on a case-by-case basis.
- A. OCD Rule 712 Waste:** Pursuant to OCD Rule 712 (19.15.9.712 NMAC) disposal of certain non-domestic waste without notification to the OCD is allowed at NMED permitted solid waste facilities if the waste stream has been identified in the discharge permit and existing process knowledge of the waste stream does not change.
- B. Waste Storage:** The owner/operator shall store all waste in an impermeable bermed area, except waste generated during emergency response operations for up to 72 hours. All waste storage areas shall be identified in the discharge permit application. Any waste storage area not identified in the permit shall be approved on a case-by-case basis only. The owner/operator shall not store oil field waste on-site for more than 180 days unless approved by the OCD.
- 7. Drum Storage:** The owner/operator must store all drums, including empty drums, containing materials other than fresh water on an impermeable pad with curbing. The owner/operator must store empty drums on their sides with the bungs in place and lined up on a horizontal plane. The owner/operator must store chemicals in other containers, such as tote tanks, sacks, or buckets on an impermeable pad with curbing.
- 8. Process, Maintenance and Yard Areas:** The owner/operator shall either pave and curb or have some type of spill collection device incorporated into the design at all process, maintenance, and yard areas which show evidence that water contaminants from releases, leaks and spills have reached the ground surface.
- 9. Above Ground Tanks:** The owner/operator shall ensure that all aboveground tanks have impermeable secondary containment (e.g., liners and berms), which will contain a volume of at least one-third greater than the total volume of the largest tank or all interconnected tanks. The owner/operator shall retrofit all existing tanks before discharge permit renewal. Tanks that contain fresh water or fluids that are gases at atmospheric temperature and pressure are exempt from this condition.

10. Labeling: The owner/operator shall clearly label all tanks, drums, and containers to identify their contents and other emergency notification information. The owner/operator may use a tank code numbering system, which is incorporated into their emergency response plans.

11. Below-Grade Tanks/Sumps and Pits/Ponds.

A. All below-grade tanks and sumps must be approved by the OCD prior to installation and must incorporate secondary containment with leak detection into the design. The owner/operator shall retrofit all existing systems without secondary containment and leak detection before discharge permit renewal. All existing below-grade tanks and sumps without secondary containment and leak detection must be tested annually or as specified herein. Systems that have secondary containment with leak detection shall have a monthly inspection of the leak detection system to determine if the primary containment is leaking. Small sumps or depressions in secondary containment systems used to facilitate fluid removal are exempt from these requirements if fluids are removed within 72 hours.

B. All pits and ponds, including modifications and retrofits, shall be designed by a certified registered professional engineer and approved by the OCD prior to installation. In general, all pits or ponds shall have approved hydrologic and geologic reports, location, foundation, liners, and secondary containment with leak detection, monitoring and closure plans. All pits or ponds shall be designed, constructed and operated so as to contain liquids and solids in a manner that will protect fresh water, public health, safety and the environment for the foreseeable future. The owner/operator shall retrofit all existing systems without secondary containment and leak detection before discharge permit renewal.

C. The owner/operator shall ensure that all exposed pits, including lined pits and open top tanks (8 feet in diameter or larger) shall be fenced, screened, netted, or otherwise rendered non-hazardous to wildlife, including migratory birds.

D. The owner/operator shall maintain the results of tests and inspections at the facility covered by this discharge permit and available for OCD inspection. The owner/operator shall report the discovery of any system which is found to be leaking or has lost integrity to the OCD within 15 days. The owner/operator may propose various methods for testing such as pressure testing to 3 pounds per square inch greater than normal operating pressure and/or visual inspection of cleaned tanks and/or sumps, or other OCD-approved methods. The owner/operator shall notify the OCD at least 72 hours prior to all testing.

12. Underground Process/Wastewater Lines:

A. The owner/operator shall test all underground process/wastewater pipelines at least once every five (5) years to demonstrate their mechanical integrity, except lines containing fresh water or fluids that are gases at atmospheric temperature and pressure. Pressure rated pipe shall be tested by pressuring up to one and one-half times the normal operating pressure, if possible, or for atmospheric drain systems, to 3 pounds per square inch greater than normal operating pressure, and pressure held for a minimum of 30 minutes with no more than a 1% loss/gain in pressure. The owner/operator may use other methods for testing if approved by the OCD.

B. The owner/operator shall maintain underground process and wastewater pipeline schematic diagrams or plans showing all drains, vents, risers, valves, underground piping, pipe type, rating, size, and approximate location. All new underground piping must be approved by the OCD prior to installation. The owner/operator shall report any leaks or loss of integrity to the OCD within 15 days of discovery. The owner/operator shall maintain the results of all tests at the facility covered by this discharge permit and they shall be available for OCD inspection. The owner/operator shall notify the OCD at least 72 hours prior to all testing.

13. Class V Wells: The owner/operator shall close all Class V wells (e.g., septic systems, leach fields, drywells, etc.) that inject non-hazardous industrial wastes or a mixture of industrial wastes and domestic wastes unless it can be demonstrated that ground water will not be impacted in the reasonably foreseeable future. Leach fields and other wastewater disposal systems at OCD-regulated facilities that inject non-hazardous fluid into or above an underground source of drinking water are considered Class V injection wells under the EPA UIC program. Class V wells that inject domestic waste only, must be permitted by the New Mexico Environment Department (NMED).

14. Housekeeping: The owner/operator shall inspect all systems designed for spill collection/prevention and leak detection at least monthly to ensure proper operation and to prevent over topping or system failure. All spill collection and/or secondary containment devices shall be emptied of fluids within 72 hours of discovery. The owner/operator shall maintain all records at the facility and available for OCD inspection.

15. Spill Reporting: The owner/operator shall report all unauthorized discharges, spills, leaks and releases and conduct corrective action pursuant to WQCC Regulation 20.5.12.1203 NMAC and OCD Rule 116 (19.15.3.116 NMAC). The owner/operator shall notify both the OCD District Office and the Santa Fe Office within 24 hours and file a written report within 15 days.

16. OCD Inspections: The OCD may place additional requirements on the facility and modify the permit conditions based on OCD inspections.

17. Storm Water: The owner/operator shall implement and maintain run-on and runoff plans and controls. The owner/operator shall not discharge any water contaminant that exceeds the WQCC standards specified in 20.6.2.3101 NMAC or 20.6.4 NMAC (Water Quality Standards for Interstate and Intrastate Streams) including any oil sheen in any stormwater run-off. The owner/operator shall notify the OCD within 24 hours of discovery of any releases and shall take immediate corrective action(s) to stop the discharge.

18. Unauthorized Discharges: The owner/operator shall not allow or cause water pollution, discharge or release of any water contaminant that exceeds the WQCC standards listed in 20.6.2.3101 NMAC or 20.6.4 NMAC (Water Quality Standards for Interstate and Intrastate Streams) unless specifically listed in the permit application and approved herein. An unauthorized discharge is a violation of this permit.

19. Vadose Zone and Water Pollution: The owner/operator shall address any contamination through the discharge permit process or pursuant to WQCC 20.6.2.4000-.4116 NMAC (Prevention and Abatement of Water Pollution). The OCD may require the owner/operator to modify its permit for investigation, remediation, abatement, and monitoring requirements for any vadose zone or water pollution. Failure to perform any required investigation, remediation, abatement and submit subsequent reports will be a violation of the permit.

20. Additional Site Specific Conditions: N/A

21. Transfer of Discharge Permit (WQCC 20.6.2.3111) Prior to any transfer of ownership, control, or possession (whether by lease, conveyance or otherwise) of a facility with a discharge permit, the transferor shall notify the transferee in writing of the existence of the discharge permit, and shall deliver or send by certified mail to the department a copy of such written notification, together with a certification or other proof that such notification has in fact been received by the transferee. Upon receipt of such notification, the transferee shall have the duty to inquire into all of the provisions and requirements contained in such discharge permit, and the transferee shall be charged with notice of all such provisions and requirements as they appear of record in the department's file or files concerning such discharge permit. The transferee (new owner/operator) shall sign and return an original copy of these permit conditions and provide a written commitment to comply with the terms and conditions of the previously approved discharge permit.

22. Closure: The owner/operator shall notify the OCD when operations of the facility are to be discontinued for a period in excess of six months. Prior to closure of the facility, the operator shall submit a closure plan for approval. Closure and waste disposal shall be in accordance with the statutes, rules and regulations in effect at the time of closure.

23. Certification: **DCP Midstream, LP, (Owner/Operator)**, by the officer whose signature appears below, accepts this permit and agrees to comply with all submitted commitments, including these terms and conditions contained here. **Owner/Operator** further acknowledges that the OCD may, for good cause shown, as necessary to protect fresh water, public health, safety, and the environment, change the conditions and requirements of this permit administratively.

Elsabeth Klein

GV-176

June 13, 2007

Page 7 of 7

Conditions accepted by: "I certify under penalty of law that I have personally examined and am familiar with the information submitted in this document and all attachments and that, based on my inquiry of those individuals immediately responsible for obtaining the information, I believe that the information is true, accurate, and complete. I am aware that there are significant penalties for submitting false information including the possibility of fine and imprisonment."

Company Name-print name above

Company Representative- print name

Company Representative- signature

Title _____

Date: _____



DCP Midstream
370 17th Street, Suite 2500
Denver, CO 80202
303-595-3331

February 28, 2007

2007 MAR 2 PM 12 34

UPS NEXT DAY AIR (Tracking Number 1Z F46 915 22 1005 963 9)

Mr. Wayne Price, Chief
Environmental Bureau
Oil Conservation Division
New Mexico Energy, Minerals
& Natural Resources Department
1220 South St. Francis Drive
Santa Fe, NM 87505

Subject: Bootleg Compressor Station
Discharge Permit Renewal (GW-176)
Lea County, New Mexico

Dear Mr. Price:

Enclosed are the original and one copy of DCP Midstream, LP's ("DCP MIDSTREAM") discharge permit renewal application for the Bootleg Compressor Station. Also enclosed is a check in the amount of \$100 for the discharge plan renewal application filing fee.

DCP MIDSTREAM will satisfy the requirements of 20.6.2.3108(A) NMAC by providing notice under Paragraph (2) of Subsection C of 20.6.2.3108 NMAC. DCP MIDSTREAM plans to publish a public notice in the Hobbs News-Sun for the Bootleg Compressor Station Discharge Permit Renewal. DCP MIDSTREAM will publish a synopsis of the notice, in English and in Spanish, in a display ad at least two inches by three inches, not in the classified or legal advertisements section in the Hobbs News-Sun. Additionally, DCP MIDSTREAM is the owner of the property, therefore no landowner notification is necessary.

As we have discussed previously, DCP MIDSTREAM does not believe that the New Mexico Water Quality Act, NMSA 1978, §§74-6-1 to 17, and the regulations adopted under that act are applicable to compressor stations. Further, even if the Water Quality Act and regulations applied, the WQCC regulations do not require a discharge plan for this facility. The Bootleg Compressor Station does not have any discharges that may move directly or indirectly into groundwater. Therefore, DCP MIDSTREAM does not believe that a discharge plan is required under the Water Quality Control Commission (WQCC) regulations. Since the WQCC regulations do not require a discharge plan, DCP MIDSTREAM is under no legal obligation to renew Discharge Plan GW-176.

Please be advised that DCP MIDSTREAM's submittal of the renewal application and application filing fee does not waive DCP MIDSTREAM's objection to the Oil Conservation Division's (OCD) position regarding applicability of the WQCC regulations. If you have any questions concerning DCP MIDSTREAM's position or the renewal application, please contact me at (303) 605-1778. Please send all correspondence regarding this renewal to me at 370 17th Street, Suite 2500, Denver, CO 80202.

Sincerely,
DCP Midstream, LP

Elisabeth Klein
Principal Environmental Specialist

Enclosures

cc: NMOCD District 1 Office (1Z F46 915 22 1005 964 8)
1625 N. French Drive
Hobbs, NM 88240

District I
1625 N. French Dr., Hobbs, NM 88240
District II
1301 W. Grand Avenue, Artesia, NM 88210
District III
1000 Rio Brazos Road, Aztec, NM 87410
District IV
1220 S. St. Francis Dr., Santa Fe, NM 87505

State of New Mexico
Energy Minerals and Natural Resources
Oil Conservation Division
1220 South St. Francis Dr.
Santa Fe, NM 87505

Revised June 10, 2003

Submit Original
Plus 1 Copy
to Santa Fe
1 Copy to Appropriate
District Office

**DISCHARGE PLAN APPLICATION FOR SERVICE COMPANIES, GAS PLANTS,
REFINERIES, COMPRESSOR, GEOTHERMAL FACILITIES
AND CRUDE OIL PUMP STATIONS**

(Refer to the OCD Guidelines for assistance in completing the application)

☐ New ☒ Renewal ☐ Modification

1. Type: Boot Leg Compressor Station
2. Operator: DCP Midstream, LP
Address: See enclosed discharge plan.
Contact Person: See enclosed discharge plan. Phone: _____
3. Location: NW /4 SE /4 Section 28 Township 22S Range 33E
Submit large scale topographic map showing exact location.
4. Attach the name, telephone number and address of the landowner of the facility site.
See enclosed discharge plan.
5. Attach the description of the facility with a diagram indicating location of fences, pits, dikes and tanks on the facility.
See enclosed discharge plan.
6. Attach a description of all materials stored or used at the facility.
See enclosed discharge plan.
7. Attach a description of present sources of effluent and waste solids. Average quality and daily volume of waste water must be included.
See enclosed discharge plan.
8. Attach a description of current liquid and solid waste collection/treatment/disposal procedures.
See enclosed discharge plan.
9. Attach a description of proposed modifications to existing collection/treatment/disposal systems.
See enclosed discharge plan.
10. Attach a routine inspection and maintenance plan to ensure permit compliance.
See enclosed discharge plan.
11. Attach a contingency plan for reporting and clean-up of spills or releases.
See enclosed discharge plan.
12. Attach geological/hydrological information for the facility. Depth to and quality of ground water must be included.
See enclosed discharge plan.
13. Attach a facility closure plan, and other information as is necessary to demonstrate compliance with any other OCD rules, regulations and/or orders.
See enclosed discharge plan.
14. CERTIFICATION I hereby certify that the information submitted with this application is true and correct to the best of my knowledge and belief.

Name: Tony Lee

Title: Asset Manager

Signature: 

Date: 2-26-07

E-mail Address: TRLee@dcpmidstream.com

Bootleg Compressor Station
NW ¼ SE ¼ Section 28 T22S, R33E

DISCHARGE PLAN

This document constitutes a renewal application for a Groundwater Discharge Permit (GW-176) for the Bootleg Compressor Station as previously approved by New Mexico Oil Conservation Division (OCD) on January 20, 1995. This Discharge Permit application has been prepared in accordance with the New Mexico Oil Conservation Division (OCD) "Guidelines for the Preparation of Discharge Plans at Natural Gas Plants, Refineries, Compressor and Crude Oil Pump Stations" (revised 12-95) and New Mexico Water Quality Control Commission (WQCC) regulations, 20.6.2.3-106C NMAC.

1 Type of Operation

The facility is a compressor station.

2 Operator / Legally Responsible Party

Operator

DCP Midstream, LP (formerly Duke Energy Field Services)
10 Desta Drive, Suite 400W
Midland, TX 79705
(505) 397-5520
Contact Person: Mr. Tony Lee – Asset Manager

Legally Responsible Party

DCP Midstream, LP
370 17th Street, Suite 2500
Denver, CO 80202
(303) 595-3331
Contact Person: John Admire – Director, Environmental Protection

3 Location of Discharge / Facility

NW ¼ SE ¼ Section 28 Township 22 South, Range 33 East

See Figure 1 – Site Location Map.

4 Landowner

DCP Midstream, LP
370 17th Street, Suite 2500
Denver, CO 80202
(303) 595-3331

5 Facility Description

The facility provides compression for the Llano Gathering System. The facility consists of two skid-mounted engine-driven natural gas compressors, a skid mounted dehydration unit, an inlet filter separator, aboveground storage tanks containing used oil, lube oil, condensate, methanol, antifreeze, Triethylene glycol (TEG), produced water, and slop oil; and associated piping.

Natural gas enters the compressor station from the north via aboveground pipelines. The gas goes through an inlet separator before going into the compressors. After compression the gas flows through the dehydration unit. The gas is dried in the dehydrator before metering and exiting the compressor station.

6 Materials Stored or Used

There are no materials stored on-site or used that are discharged so that they may move directly or indirectly into groundwater.

Material Stored/Used	Method of Storage
Antifreeze	Aboveground storage tanks within secondary containment.
Used Oil	Aboveground storage bin within secondary containment.
Produced water/Condensate	Aboveground storage tank within secondary containment.
Lube Oil	Aboveground storage tank within secondary containment.
Methanol	Aboveground storage tank within secondary containment.
Engine Skid Drain (equipment wash down water, stormwater, and slop oil)	Below-grade double-walled sump with a high level alarm and an aboveground storage tank within secondary containment.
Triethylene glycol (TEG)	Aboveground storage tank within secondary containment.

7 Sources and Quantities of Effluent and Waste Solids

All effluent and waste solids generated at the facility are stored in enclosed, above-ground tanks with secondary containment and removed from the facility for off-site disposal in accordance with applicable NMOCD, New Mexico Environment Department (NMED), and Environmental Protection Agency (EPA) regulations. Approximate quantities are provided in the table in the following response to Item #8. There are no effluents or waste solids are discharged on site onto or below the surface of the ground so that they may move directly or indirectly into groundwater.

Separators/Scrubbers

Effluent or waste solids generated from separators or scrubbers are not discharged on site; wastewater from the inlet scrubber is routed via piping to an aboveground storage tank within secondary containment and is trucked off site for treatment.

Boilers and Cooling Towers/Fans

There are no boilers or cooling towers/fans at the facility.

Dehydration unit

Waste is not generated from the dehydration unit. Triethylene glycol (TEG) is continually circulated in order to dry the gas.

Process and Storage Equipment Wash Down/Slop

Effluent or waste solids generated from process equipment wash down is collected in an aboveground storage tank and transported off-site for treatment.

Solvents/Degreasers

Solvents or degreasers are not used at the facility.

Spent Acids/Caustics

Spent acids or caustics are not typically generated at the facility. If generated at the facility, spent acids or caustics will be collected and stored in aboveground storage containers and disposed off-site in accordance with applicable Federal, State, and local regulations.

Used Engine Coolants

Antifreeze waste is not generated at the facility. The antifreeze is consumed by the engines so no waste is generated. Antifreeze is not discharged on site so that it may move directly or indirectly into groundwater.

Waste Lubrication and Motor Oils

Lubricating and motor oils are not discharged on site. Used oil is stored in aboveground storage containers within secondary containment and removed for off-site recycling.

Used Oil Filters

Used oil filters generated at the facility are collected in an aboveground storage bin which is stored off-site and then picked up for recycling.

Solids and Sludges

Solids and sludges are not discharged on site. Any solids or sludges generated on site are collected and stored in aboveground storage tanks within secondary containment for off-site disposal.

Painting Wastes

Paint wastes are not generated at the site.

Sewage

Sewage is not generated at the facility.

Lab Wastes

Lab wastes are not generated at the facility.

Other Liquids and Solid Wastes

There are no other liquids or solid wastes generated at the facility.

8 Liquid and Solid Waste Collection / Storage / Disposal

Collection/Storage

All liquid and solid waste are collected and stored in containers for off-site disposal in accordance with applicable NMOCD, NMED, and EPA regulations.

On-site Disposal

There is no on-site disposal at the facility. None of the containment structures at the facility are equipped with valves. Rainwater collected inside containment structures is lost through evaporation or pumped out by a contractor for off site disposal in accordance with applicable NMOCD, NMED, and EPA regulations.

Off-site Disposal

All liquid and solid wastes are disposed off site in accordance with applicable NMOCD, NMED, and EPA regulations.

The following table on the following page provides information regarding wastes collected and stored for off-site disposal and/or recycling.

Waste	Collection Method/Storage	Quantity Generated	Final Disposition	Receiving Facility
Produced Water/Condensate	Aboveground storage tank within secondary containment	~ 450 bbls/month	Off-site treatment	Eunice Plant Heater Treater
Equipment Washdown Water/skid drain/slop oil	Below-grade double-walled sump with a high level alarm and an aboveground storage tank within secondary containment.	~ 100 bbls/month	Off-site treatment	Eunice Plant Heater Treater
Used Oil Filters	Aboveground storage bin located off-site	~ 4 filters/year	Off-site recycling	Thermofluids, Inc.
Used Oil	Aboveground storage tank within secondary containment	~ 500 gal/year	Off-site recycling	Thermofluids, Inc.

9 Proposed Modifications

No modifications to the facility are planned. DCP Midstream would like to modify the housekeeping condition regarding the frequency of inspections to one time per month to be consistent with our other discharge plans.

10 Inspection, Maintenance, and Reporting

Currently, routine inspections and maintenance are performed weekly to ensure proper collection, storage, and off site disposal of all wastes generated at the facility.

11 Spill / Leak Prevention and Reporting (Contingency Plans)

DCP Midstream will respond to spills according to the requirements of the State of New Mexico found in NMOCD Rule 116, 19.15.C.116 NMAC and WQCC regulation, 20.6.2.1203 NMAC.

12 Site Characteristics

No Changes.

13 Additional Information

All unauthorized releases and discharges will be reported to the NMOCD in accordance with NMOCD Rule 116, 19.15.C.116 NMAC and WQCC regulation, 20.6.2.1203 NMAC.

FIGURES

Figure 1. Site Location Map – *Bootleg Compressor Station*

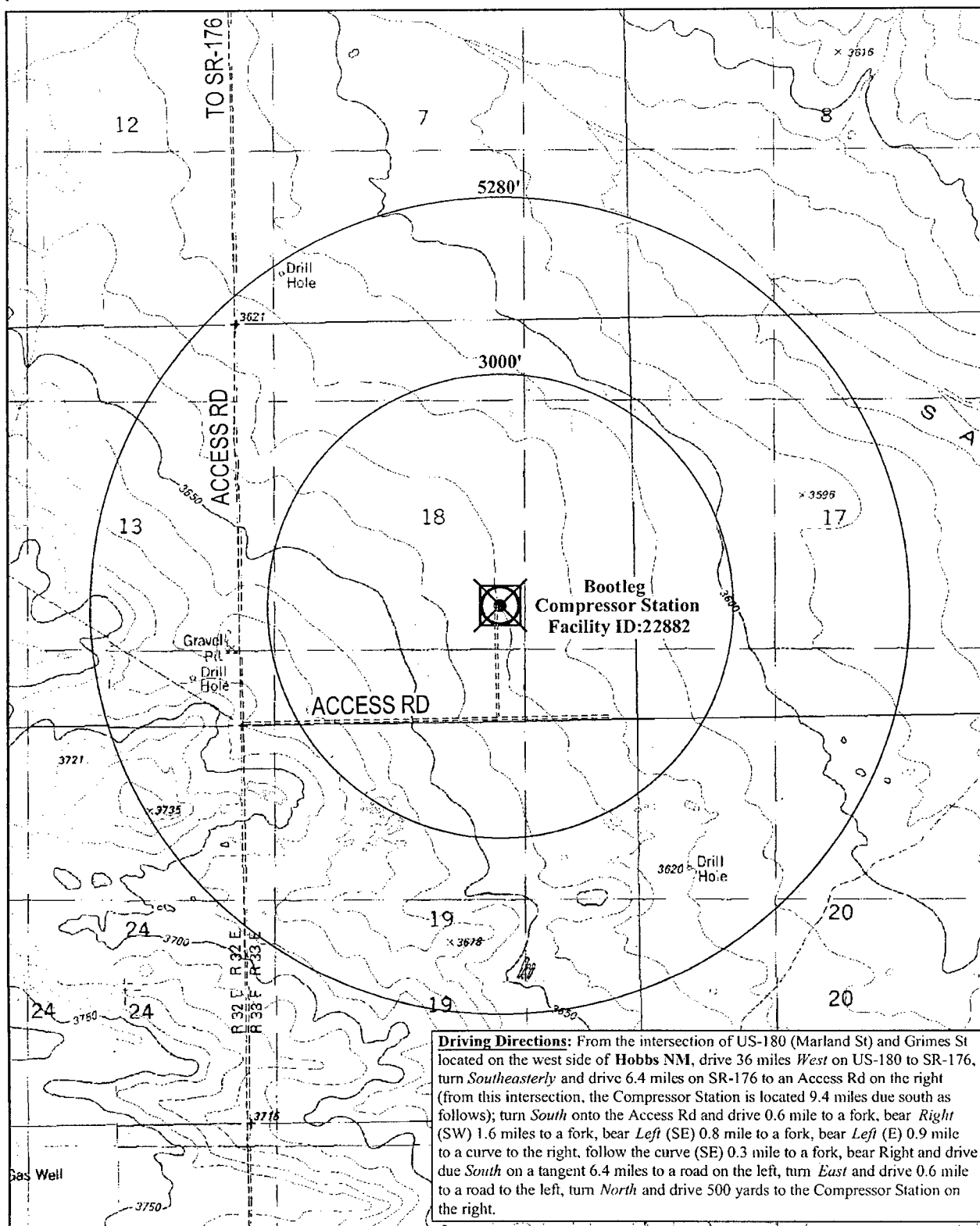

Driving Directions: From the intersection of US-180 (Marland St) and Grimes St located on the west side of Hobbs NM, drive 36 miles *West* on US-180 to SR-176, turn *Southeasterly* and drive 6.4 miles on SR-176 to an Access Rd on the right (from this intersection, the Compressor Station is located 9.4 miles due south as follows); turn *South* onto the Access Rd and drive 0.6 mile to a fork, bear *Right* (SW) 1.6 miles to a fork, bear *Left* (SE) 0.8 mile to a fork, bear *Left* (E) 0.9 mile to a curve to the right, follow the curve (SE) 0.3 mile to a fork, bear *Right* and drive due *South* on a tangent 6.4 miles to a road on the left, turn *East* and drive 0.6 mile to a road to the left, turn *North* and drive 500 yards to the Compressor Station on the right.

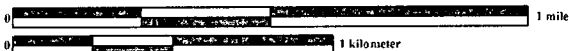

dcp
Midstream.

Bootleg Compressor Station

Lea County, New Mexico
Zone 13 UTMH 630898m UTMV 3584363m
Lat: 32° 23' 19" Long: 103° 36' 30"

PHOTO VERIFIED

VICINITY



32103D5 Grama Ridge
Source: USGS 1:24,000 scale
Drawn by: JRE
Revised by:
Date: 2-1-07
ENVIRONMENTAL
AFFAIRS DEPARTMENT

Figure 2. Facility Plot Plan – *Bootleg Compressor Station*

Price, Wayne

From: Price, Wayne**Sent:** Tuesday, February 05, 2002 12:08 PM**To:** 'Bishop, Mark A.'**Subject:** RE: Non-exempt waste disposal for Conoco CG&P

OCD hereby approves of your request and will place a copy of this approval in each Discharge Plan.

-----Original Message-----

From: Bishop, Mark A. [mailto:Mark.A.Bishop@conoco.com]**Sent:** Tuesday, February 05, 2002 11:24 AM**To:** WPrice@state.nm.us**Subject:** Non-exempt waste disposal for Conoco CG&P facilities

Mr. Price,

A reevaluation of preferred non-exempt waste handling facilities has been completed for southeast New Mexico and a team of Conoco personnel has chosen Sundance waste handling facility at Eunice, NM to be our primary non-exempt waste handling facility. Controlled recovery Inc. will be the secondary facility. We would like to amend the following OCD Groundwater discharge permits to include the Sundance facility for disposal of non-exempt fluids. Thank you for your consideration of our request

Maljamar Gas Plant	GW-020
Maljamar Area Blanket OCD permit	
Antelope Ridge Gas Plant	GW-162
Hobbs Gas Plant	GW-175
Apex compressor Station	GW-163
Bootleg Compressor Station	GW-176
Bright /Yates Compressor Station	GW-160
Cedar Canyon Compressor Station	GW-296
Cal-Mon Compressor Station	GW-143
NE Carlsbad Compressor Station	GW-280
Cotton Draw Compressor Station	GW-311
Hat Mesa Compressor Station	GW-316
Lee Compressor Station	GW-227
Pardue Compressor Station	GW-288
Pure Gold Compressor Station	GW-150
Malaga Compressor Station	GW-167

Mark Bishop
 Environmental Specialist
 Conoco Inc. CG&P
 SE New Mexico Operating Unit
 505-391-1956

2/6/2002

RECEIVED
FFR 25 2000
Environmental Bureau
Oil Conservation Division

**ATTACHMENT TO THE DISCHARGE PLAN GW-176 APPROVAL
LG&E Energy Marketing Inc. Bootleg Compressor Station (GW-176)
DISCHARGE PLAN APPROVAL CONDITIONS
February 3, 2000**

1. Payment of Discharge Plan Fees: The \$50.00 filing fee has been received by OCD. The \$345.00 flat fee shall be submitted upon receipt of this approval. The required flat fee may be paid in a single payment due at the time of approval, or in equal annual installments over the duration of the plan, with the first payment due upon receipt of this approval.
2. Commitments: LG&E Energy Marketing Inc. will abide by all commitments submitted in the discharge plan renewal application dated October 18, 1999 and these conditions for approval.
3. Drum Storage: All drums containing materials other than fresh water must be stored on an impermeable pad with curbing. All empty drums should be stored on their sides with the bungs in place and lined up on a horizontal plane. Chemicals in other containers such as sacks or buckets must also be stored on an impermeable pad with curbing.
4. Process Areas: All process and maintenance areas which show evidence that leaks and spills are reaching the ground surface must be either paved and curbed or have some type of spill collection device incorporated into the design.
5. Above Ground Tanks: All above ground tanks which contain fluids other than fresh water must be bermed to contain a volume of one-third more than the total volume of the largest tank or of all interconnected tanks. All new facilities or modifications to existing facilities must place the tank on an impermeable type pad within the berm.
6. Above Ground Saddle Tanks: Above ground saddle tanks must have impermeable pad and curb type containment unless they contain fresh water or fluids that are gases at atmospheric temperature and pressure.

7. Labeling: All tanks, drums, and other containers should be clearly labeled to identify their contents and other emergency information necessary if the tank were to rupture, spill, or ignite.
8. Below Grade Tanks/Sumps: All below grade tanks, sumps, and pits must be approved by the OCD prior to installation or upon modification and must incorporate secondary containment and leak-detection into the design. All pre-existing sumps and below-grade tanks must be tested to demonstrate their mechanical integrity no later than April 1, 2000 and every year from tested date, thereafter. Permittees may propose various methods for testing such as pressure testing to 3 pounds per square inch above normal operating pressure and/or visual inspection of cleaned out tanks and/or sumps, or other OCD approved methods. The OCD will be notified at least 72 hours prior to all testing. The test results will be submitted to OCD by April 31, 2000.
9. Underground Process/Wastewater Lines: All underground process/wastewater pipelines must be tested to demonstrate their mechanical integrity no later than April 1, 2000 and every 5 years, from tested date, thereafter. Permittees may propose various methods for testing such as pressure testing to 3 pounds per square inch above normal operating pressure or other means acceptable to the OCD. The OCD will be notified at least 72 hours prior to all testing. The test results will be submitted to OCD by April 30, 2000.
10. Class V Wells: No Class V wells that inject non-hazardous industrial wastes or a mixture of industrial wastes and domestic wastes will be approved for construction and/or operation unless it can be demonstrated that groundwater will not be impacted in the reasonably foreseeable future. Leach fields and other wastewater disposal systems at OCD regulated facilities which inject non-hazardous fluid into or above an underground source of drinking water are considered Class V injection wells under the EPA UIC program. Class V wells that inject domestic waste only must be permitted by the New Mexico Environment Department.
11. Housekeeping: All systems designed for spill collection/prevention, and leak detection will be inspected daily to ensure proper operation and to prevent overtopping or system failure.
12. Spill Reporting: All spills/releases shall be reported pursuant to OCD Rule 116. and WQCC 1203. to the OCD Hobbs District Office.

13. Waste Disposal: All wastes will be disposed of at an OCD approved facility. Only oilfield exempt wastes shall be disposed of down Class II injection wells. Non-exempt oilfield wastes that are non-hazardous may be disposed of at an OCD approved facility upon proper waste characterization per 40 CFR Part 261.
14. Transfer of Discharge Plan: The OCD will be notified prior to any transfer of ownership, control, or possession of a facility with an approved discharge plan. A written commitment to comply with the terms and conditions of the previously approved discharge plan must be submitted by the purchaser and approved by the OCD prior to transfer.
15. Closure: The OCD will be notified when operations of the facility are discontinued for a period in excess of six months. Prior to closure of the facility a closure plan will be submitted for approval by the Director. Closure and waste disposal will be in accordance with the statutes, rules and regulations in effect at the time of closure.
16. OCD Inspections: Additional requirements may be placed on the facility based upon results from OCD inspections.
17. Certification: **LG&E Energy Marketing Inc.** by the officer whose signature appears below, accepts this permit and agrees to comply with all terms and conditions contained herein. **LG&E Energy Marketing Inc.** further acknowledges that these conditions and requirements of this permit may be changed administratively by the Division for good cause shown as necessary to protect fresh water, human health and the environment.

Conditions accepted by: **LG&E Energy Marketing Inc.**

John R Delaney
Company Representative- print name

[Signature]
Company Representative Sign

Date 2-14-00

Title General Manager

5/9.

State of New Mexico
Energy, Minerals and Natural Resources Department
OIL CONSERVATION DIVISION
P.O. Box 2088
Santa Fe, NM 87501

OIL CONSERVATION DIVISION
Environmental Bureau
6661 97 NOV 1999

**DISCHARGE PLAN APPLICATION FOR NATURAL GAS PROCESSING PLANTS,
OIL REFINERIES AND GAS COMPRESSOR STATIONS**

(Refer to OCD Guidelines for assistance in completing the application.)

Renew Plan # GW-176

- I. TYPE:** Compressor Station (Bootleg Compresso Station)
- II. OPERATOR:** LG&E Natural Gathering and Processing Co.
- ADDRESS:** 921 West Sanger, Hobbs, NM 88240
- CONTACT PERSON:** Ed Sloman **PHONE** 505-393-2153
- III. LOCATION:** NW /4 SE /4 Section (28) Township 22 S Range 33 E
Submit large scale topographic map showing exact location.
- IV.** Attach the name and address of the landowner(s) of the disposal facility site.
- V.** Attach description of the facility with a diagram indicating location of fences, pits, dikes, and tanks on the facility.
- VI.** Attach a description of sources, quantities and quality of effluent and waste solids.
- VII.** Attach a description of current liquid and solid waste transfer and storage procedures.
- VIII.** Attach a description of current liquid and solid waste disposal procedures.
- IX.** Attach a routine inspection and maintenance plan to ensure permit compliance.
- X.** Attach a contingency plan for reporting and clean-up of spills or releases.
- XI.** Attach geological/hydrological evidence demonstrating that disposal of oil field wastes will not adversely impact fresh water. Depth to and quality of ground water must be included.
- XII.** Attach such other information as is necessary to demonstrate compliance with any other OCD rules, regulations and/or orders.
- XIII. CERTIFICATION**

I hereby certify that the information submitted with this application is true and correct to the best of my knowledge and belief.

Name: John R. Delaney

Title: General Manager

Signature: 

Date: 10-18-99

DISTRIBUTION: Original and one copy to Santa Fe with one copy to appropriate Division District Office.

LG&E Natural Gathering & Processing

PNC Bank, National Association

STUB CHECK NO: 90406770
1 OF 1 DATE: 02/23/00

62-176

INVOICE NUMBER	DATE	PAYMENT ADVICE	GROSS	DISCOUNT	NET
REQ021700A	02/17/00		345.00		345.00
67184	WATER QUALITY MANAGEMENT FUND	TOTALS	345.00		345.00

REORDER FT 803 • U.S. PATENT NO. 5538290;5575508;5641183

Renewal of Cisharge Plan # GW-176:

Compression:

There have been no significant changes in the compression in this station. We still have two compressors in this station.

Liquid Storage:

In this area we have had some changes. For better management of fluids we have made the following additions. There have been no tanks removed or changed out.

An additional 210 Bbl. API closed top steel tank has been set for the collection of exempt fluids. These fluids consist of produced water and condensate gathered from our pipelines. A 200 Bbl. Fiberglass tank has been set for the holding of the produced water from the 210 Bbl. tanks. By using this tank we have been able to drain the produced water from the condensate tanks, the 210 Bbl. tanks, and better manage the handling of these fluids.

The condensate is sold as a product to a refinery of choice. The produced water is hauled off and disposed of in an approved disposal by Key Energy Services (Rowland Trucking).

A 100 Bbl. Steel API tank has been set for the proper management of the non-exempt fluids. These fluids consist of rainwater from the compressor skids, and wash down water from the compressors. These fluids are collected in this tank, and disposed of at CRI with the proper analytical work being done prior to disposal.

This constitutes the changes of this station since the original Discharge Plan.

RECEIVED
NOV 26 1999
Environmental Bureau
Oil Conservation Division

State of New Mexico
ENERGY, MINERALS and NATURAL RESOURCES DEPARTMENT
Santa Fe, New Mexico 87505



January 20, 1995

CERTIFIED MAIL
RETURN RECEIPT NO. P-176-012-096

Mr. J.R. Delaney
Llano Inc.
921 W. Sanger
Hobbs, New Mexico 88240

**Re: Discharge Plan (GW-176)
Bootleg Compressor Station
Lea County, New Mexico**

Dear Mr. Delaney:

The groundwater discharge plan GW-176 for the Llano Inc. Bootleg Compressor Station located in the NW/4 SE/4 Section 18, Township 22 South, Range 33 East, NMPM, Lea County, New Mexico is hereby approved under the conditions contained in the enclosed attachment. The discharge plan consists of the application dated October 21, 1994.

The discharge plan was submitted pursuant to section 3-106 of the Water Quality Control Commission Regulations. It is approved pursuant to section 3-109.A.. Please note Section 3-109.F., which provides for possible future amendment of the plan. Please be advised that approval of this plan does not relieve you of liability should your operation result in actual pollution of surface or ground waters or the environment which may be actionable under other laws and/or regulations.

Please be advised that all exposed pits, including lined pits and open top tanks (exceeding 16 feet in diameter) shall be screened, netted, or otherwise rendered nonhazardous to wildlife including migratory birds.

Please note that section 3-104 of the regulations requires that "when a plan has been approved, discharges must be consistent with the terms and conditions of the plan". Pursuant to Section 3-107.C. you are required to notify the Director of any facility expansion, production increase, or process modification that would result in any change in the discharge of water quality or volume.

VILLAGRA BUILDING - 408 Galisteo

Forestry and Resources Conservation Division
P.O. Box 1948 87504-1948
827-5830

Park and Recreation Division
P.O. Box 1147 87504-1147
827-7465

2040 South Pacheco

Office of the Secretary
827-5950

Administrative Services
827-5925

Energy Conservation & Management
827-5900

Mining and Minerals
827-5970

Oil Conservation
827-7131

Mr. J.R. Delaney
January 20, 1995
Page 2

Pursuant to Section 3-109.G.4., this approval is for a period of five years. This approval will expire January 20, 2000 and you should submit an application for renewal in ample time before that date.

The discharge plan application for the Llano Inc. Bootleg Compressor Station is subject to the WQCC Regulation 3-114 discharge plan fee. Every billable facility submitting a discharge plan will be assessed a fee equal to the filing fee of fifty (50) dollars plus a flat rate fee. The flat rate fee for compressor stations with horsepower between 1000 and 3000 is six hundred ninety dollars (\$690.00)

The OCD has received your \$50 filing fee. The flat fee for an approved discharge plan may be paid in full due at the time of approval, or in equal installments over the duration of the plan, with the first payment due upon receipt of this approval.

Please make all checks payable to: NMED-Water Quality Management and addressed to the OCD Santa Fe Office.

On behalf of the staff of the Oil Conservation Division, I wish to thank you and your staff for your cooperation during this discharge plan review.

Sincerely,

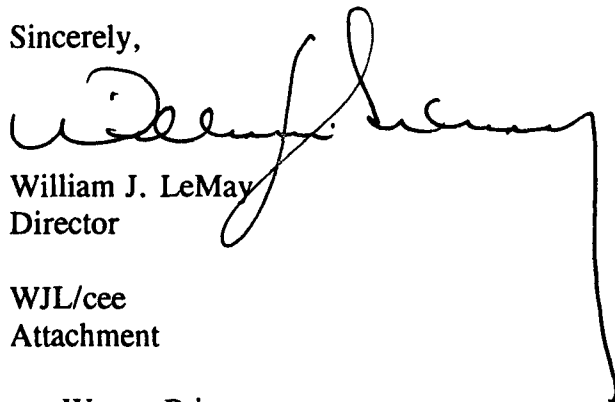
A handwritten signature in black ink, appearing to read 'William J. LeMay', with a long, sweeping horizontal line extending to the right.

William J. LeMay
Director

WJL/cee
Attachment

xc: Wayne Price

ATTACHMENT TO THE DISCHARGE PLAN GW-176 APPROVAL
LLANO INC.

BOOTLEG COMPRESSOR STATION
DISCHARGE PLAN CONDITIONS

(January 20, 1995)

1. Drum Storage: All drums will be stored on pad and curb type containment.
2. Sump Inspection: All existing sumps will be cleaned and visually inspected on an annual basis. Any new sumps or below-grade tanks will incorporate leak detection in their designs.
3. Berms: All tanks that contain materials other than freshwater will be bermed to contain one and one-third (1-1/3) the capacity of the largest tank within the berm or one and one-third (1-1/3) the total capacity of all interconnected tanks.
4. Pressure testing: All discharge plan facilities are required to pressure test all underground piping at the time of discharge plan renewal. All new underground piping shall be designed and installed to allow for isolation and pressure testing at 3 psi above normal operating pressure.
5. Spills: All spills and/or leaks will be reported to the OCD district office pursuant to WQCC Rule 1-203 and OCD Rule 116.
6. OCD Inspection: Additional requirements may be placed on the facility based upon results from OCD inspections.