

GW - 236

MONITORING REPORTS

DATE:

1998

Pate Trucking Co., Inc.

New Mexico Operations

P. O. Box 1008
3800 S. Eunice Highway

505-397-6264
800-657-9353
Fax 505-397-2597

Hobbs, New Mexico 88241

March 17, 1998

State of New Mexico
Energy, Minerals and Natural Resources Department
Oil Conservation Division
2040 S. Pacheco
Santa Fe, NM 87505
Attn: Mr. Jack Ford

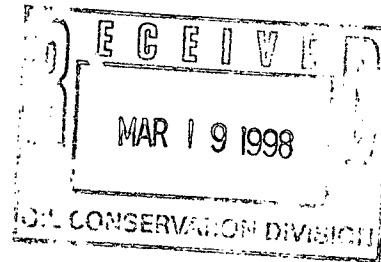

GW-236

RE: Closure Report for Pate Trucking Co., Inc. yard, located 3800 S. Eunice Hwy

Dear Mr. Ford,

We are sorry for the delay in getting this closure report back to you. Initially we were in correspondence with Mr. Pat Sanchez, then the property in question was in litigation between the two owners. This caused a delay in the closure report not knowing ultimately who would be the final responsible party. The legal matter has since been resolved with Pate Trucking Co., Inc. being sole owner.

Please find enclosed the closure report for the 2-Class V EPA Leach Fields, located at 3800 S. Eunice Hwy, Hobbs, NM. Mr. Ford, your attention in this matter would be deeply appreciated. We are also sending a carbon copy to Mr. Wayne Price, Engineer- OCD District I, Hobbs, NM.

If you have any questions or need any additional information in regards to this project, please call at any time 505-397-6264. Thank you for your time and assistance in this matter.

Sincerely,

A handwritten signature in cursive script that reads "Gary Mead".

Gary Mead
President
Pate Trucking Co., Inc.

Cc: Mr. Wayne Price
Engineer-District I
OCD Hobbs Office

Presented to

Pate Trucking Company, Inc.

Mr. Gary Mead
P.O. Box 1008
Hobbs, NM 88241

Yard at 3800 S. Eunice Hwy.

**EPA Class V
Leach Field Closure**

From:

Western Environmental Consultants

P.O. Box 1816
Hobbs, NM 88241

INDEX

I. OVERVIEW OF SITE REMEDIATION

II. ON SITE TPH ANALYSIS

III. LABORATORY ANALYSIS

IV. NMOC DISPOSAL APPROVAL

V. WATER WELLS

VI. SITE AND PLOT MAPS

VII. JOB PHOTOS

**OVERVIEW AND SUMMARY
OF SITE REMEDIATION**



P.O. Box 1816
Hobbs, New Mexico 88241

Phone (505) 392-5021
Fax (505) 397-2597

Sept. 15, 1997

Pate Trucking Company, Inc.
P.O. Box 1008
Hobbs, New Mexico 88241

Attn.: Mr. Gary Mead

Re: Remediation and Clean up of Yard Located at 3800 S. Eunice Hwy.

Dear Mr. Mead

Western Environmental Consultants (WEC) would like to take this time to thank you and Pate Trucking for the opportunity to be of service on the cleanup and the remediation of the yard, located at 3800 S. Eunice Hwy. Hobbs, New Mexico 88241.

Job Summary

Cleanup and remediation began with a backhoe being used to excavate and expose the impacted soils to allow samples to be taken for classification. These samples were tested at a laboratory for a full TCLP profile analysis to classify the impacted soils as hazardous or non-hazardous. The laboratory analysis indicated that the impacted soils at the two areas of concern were non-hazardous. You may refer to the lab analysis for the actual levels (See Lab analysis).

WEC then used a backhoe to excavate the impacted soils from the leach field area on the west end of the shop. The area of impact was very small, 10' x 10' x 5' in size. The impacted soils from this area were stock piled on plastic for off site disposal pending approval from the state. The on site soil analysis of this area indicated that the Total Petroleum Hydrocarbons (TPH) were less than 100 ppm, well below the states guidelines for closure of the leach fields. This area was left open until the leachfield on the east end of the shop could be completed and ready for state inspection.

Page Two

WEC then started the completion of the source removal of impacted soils on the leach field located on the east side of the shop.

The impacted soils from this area that were removed were placed on plastic for off site disposal. At 14' the excavation limits of the backhoe were reached and the TPH levels were still in the 10,000 ppm range.

WEC then used a trackhoe to access the additional digging depth that was needed to remove the remaining impacted soils. At 20' the pit was ramped to access the trackhoe to the additional digging depths. The final excavation depth was 30 x 30 with a depth of 25'. The impacted soils were placed on plastic to be removed off site. The soil that was not impacted but was excavated during the digging process was stockpiled to be used as backfill and to dress the site after completion.

Once WEC felt that all impacted soils had been addressed for closure Mr. Wayne Price an engineer with the NMOCD was asked to be on site to visually verify that all the impacted soils with a TPH greater than 100 had been adequately addressed.

WEC then gathered final samples from the two leach fields. These samples were composite samples taken from the bottom and side walls of the excavation. These samples were sent to a laboratory for TPH, BTEX and Cl analysis. At this time Mr. Price gave verbal approval to begin backfilling operations.

The backfilling began with clean topsoil being brought in and placed in the excavation from 25' up to 5'. Then at 5' WEC placed a 2' thick layer of red bed clay in the excavation for a subsurface confining layer. At this time stockpiled caliche with a TPH level below 100 PPM was placed in the excavation from 2' to surface. The site was then dressed off and clean up operations finished.

The impacted soils with high levels of TPH that were excavated and placed on plastic were removed off site and taken to Sundance/Parabo disposal facility in Eunice, New Mexico a NMOCD approved site. There was a total of 524 cyds of impacted soils that were removed off site

Findings

1. Depth to ground water is 58.7' this information is from the New Mexico State Engineers office in Roswell, New Mexico. Included in this report is a list of all domestic water wells in the 1/4 to 1/2 mile range of this site.

Page Three

2. Pursuant to NMOCD guidelines for closure of this site the bottom cleanup level would be 100 PPM of TPH. This is due to the shallow depth of ground water and the close proximity to other domestic sources.
3. Overall the yard is in good condition with some minor surface staining from equipment being parked on site.
4. The active on site water well is in good shape with good records of testing.

Conclusions

1. This site cleaned up very well and should pose little or no chance of further impact.
2. Clean backfill was placed in the excavation from 25' back to 5'.
3. A subsurface red bed clay layer from 5' back to 3' was put in place
4. The site was crowned to prevent rain from standing.

Note This report may include and/or disclose sensitive information and is intended only for the use of the client, except as limited and/or required by consultant to disclose certain findings to governmental agencies. All data, maps, notes, reports and other information held by consultant are confidential and restricted, and are only available to client.

If you have any questions or need any additional information in regards to this project, please call at any time 505-392-5021

Sincerely,

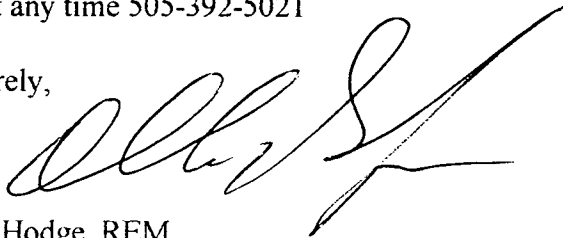

Allen Hodge, REM
VP Operations
Western Environmental Consultants

ON SITE TPH ANALYSIS

P.O. Box 1816
Hobbs, New Mexico 88241



Phone (505) 392-5021
Fax (505) 397-2597

SOIL ANALYSIS REPORT

DATE: 8/15/97
CLIENT: Pate Trucking
SUPERVISOR: A. Hodge
Sample Matrix: Soil

FACILITY: Yard on Eunice Hwy.
Test Method: EPA 418.1
Order No. Gary Mead
SAMPLE RECEIVED: Intact on site

	TPH		DEPTH	LOCATION
SAMPLE NO. 1:	42	PPM	25'	Northwest corner bottom
SAMPLE NO. 2:	58	PPM	25'	Northeast corner bottom
SAMPLE NO. 3:	17	PPM	25'	Southwest corner bottom
SAMPLE NO. 4:	09	PPM	25'	Southeast corner bottom
SAMPLE NO. 5:	23	PPM	25'	Center of pit
SAMPLE NO. 6:		PPM		
SAMPLE NO. 7:		PPM		
SAMPLE NO. 8:		PPM		
SAMPLE NO. 9:		PPM		
SAMPLE NO. 10:		PPM		

COMMENTS: These samples were taken and run on site by Western Environmental Consultants. These samples were taken at the completion of source removal from the leach field on the east side of the shop, to insure that all impacted soils had been addressed under the NMOCD guidelines for closure. Mr. Wayne Price from the NMOCD was on site and a witness of the bottom of the excavation.



P.O. Box 1816
Hobbs, New Mexico 88241

Phone (505) 332-5021
Fax (505) 397-2597

SOIL ANALYSIS REPORT

DATE: 8/9/97
CLIENT: Pate Trucking
SUPERVISOR: A. Hodge
Sample Matrix: Soil

FACILITY: Yard on Eunice Hwy.
Test Method: EPA 418.1
Order No. Gary Mead
SAMPLE RECEIVED: Intact on site

	TPH		DEPTH	LOCATION
SAMPLE NO. 1:	247	PPM	4'	Composite from west pit
SAMPLE NO. 2:	823	PPM	20'	Composite from east pit
SAMPLE NO. 3:	361	PPM	23'	Composite from east pit
SAMPLE NO. 4:	128	PPM	24'	Composite from east pit
SAMPLE NO. 5:		PPM		
SAMPLE NO. 6:		PPM		
SAMPLE NO. 7:		PPM		
SAMPLE NO. 8:		PPM		
SAMPLE NO. 9:		PPM		
SAMPLE NO. 10:		PPM		

COMMENTS: These samples were taken and run on site by Western Environmental Consultants. These samples were taken to monitor the TPH levels during the excavation operations.



P.O. Box 1816
Hobbs, New Mexico 88241

Phone (505) 392-5021
Fax (505) 397-2597

SOIL ANALYSIS REPORT

DATE: 8/15/97
CLIENT: Pate Trucking
SUPERVISOR: A. Hodge
Sample Matrix: Soil

FACILITY: Yard on Eunice Hwy.
Test Method: EPA 418.1
Order No. Gary Mead
SAMPLE RECEIVED: Intact on site

	TPH		DEPTH	LOCATION
SAMPLE NO. 1:	62	PPM	5'	Northwest corner bottom
SAMPLE NO. 2:	37	PPM	5'	Northeast corner bottom
SAMPLE NO. 3:	76	PPM	5'	Southwest corner bottom
SAMPLE NO. 4:	21	PPM	5'	Southeast corner bottom
SAMPLE NO. 5:		PPM		
SAMPLE NO. 6:		PPM		
SAMPLE NO. 7:		PPM		
SAMPLE NO. 8:		PPM		
SAMPLE NO. 9:		PPM		
SAMPLE NO. 10:		PPM		

COMMENTS: These samples were taken and run on site by Western Environmental Consultants. These samples were taken at the completion of source removal from the leach field on the west side of the shop, to insure that all impacted soils had been addressed under the NMOCD guidelines for closure. Mr. Wayne Price from the NMOCD was on site and a witness of the bottom of the excavation.



LABORATORY ANALYSIS



ARDINAL LABORATORIES

PHONE (915) 673-7001 • 2111 BEECHWOOD • ABILENE, TX 79603

PHONE (505) 393-2326 • 101 E. MARLAND • HOBBS, NM 88240

ANALYTICAL RESULTS FOR
WESTERN ENVIRONMENTAL CONSULTANTS
ATTN: ALLEN HODGE
P.O. BOX 1816
HOBBS, NM 88241
FAX TO: 505-397-2597

Receiving Date: 08/12/97
Reporting Date: 08/13/97
Project Number: EAST PIT & WEST PIT
Project Name: CLASS V LEACH PIT CLOSURE
Project Location: PATE TRUCKING, HOBBS

Sampling Date: 08/12/97
Sample Type: SOIL
Sample Condition: COOL & INTACT
Sample Received By: GP
Analyzed By: BC

LAB NUMBER	SAMPLE ID	TPH (mg/Kg)	CI (mg/Kg)	BENZENE (mg/Kg)	TOLUENE (mg/Kg)	ETHYL BENZENE (mg/Kg)	TOTAL XYLENES (mg/Kg)
ANALYSIS DATE:		08/12/97	08/13/97	08/12/97	08/12/97	08/12/97	08/12/97
H3124-1	W.LEACH PIT BTM. @5', COMPOSITE	<10	32	<0.002	<0.002	<0.002	<0.006
H3124-2	E.LEACH PIT BTM. @25', COMPOSITE	<10	96	<0.002	<0.002	<0.002	<0.006
Quality Control		203	480	0.089	0.090	0.086	0.247
True Value QC		200	500	0.090	0.090	0.087	0.260
% Accuracy		102	96	100	100	99.2	95.0
Relative Percent Difference		1.9	0	4.0	9.2	6.7	6.7

METHODS: TRPHC - EPA 600/7-79-020, 418.1; CI - EPA 600/7-79-020, 325.3; BTEX - EPA SW-846-8020

Gayle A. Potter
Chemist

08/13/97
Date

PLEASE NOTE: Liability and Damages. Cardinal's liability and client's exclusive remedy for any claim arising, whether based in contract or tort, shall be limited to the amount paid by client for analyses. All claims, including those for negligence and any other cause whatsoever shall be deemed waived unless made in writing and received by Cardinal within thirty (30) days after completion of the applicable service. In no event shall Cardinal be liable for incidental or consequential damages, including, without limitation, business interruptions, loss of use, or loss of profits incurred by client, its subsidiaries, affiliates or successors arising out of or related to the performance of services hereunder by Cardinal, regardless of whether such claim is based upon any of the above-stated reasons or otherwise.

Company Name: <u>WEC</u>		BILTO		PO #:	
Project Manager: <u>Allen Hebbes</u>		Company: <u>WEC</u>			
Address: <u>P.O. Box 1816</u>		Attn: <u>Allen Hebbes</u>			
City: <u>Hebbes</u>		Address: <u>P.O. Box 1816</u>			
State: <u>NM</u> Zip: <u>88241</u>		City: <u>Hebbes</u>			
Phone #: <u>392-5021</u>		State: <u>NM</u> Zip: <u>88241</u>			
Fax #: <u>392-2597</u>		Phone #: <u>392-5021</u>			
Project #: <u>EAST PIT + WEST PIT</u>		Fax #: <u>392-2597</u>			
Project Name: <u>CLASS IV LEACH PIT CLOSURE</u>					
Project Location: <u>PATZ TRUCKING Hebbes</u>					

LAB ID. #	Sample ID.	COMP(C) OR GRAB(C)	# CONTAINERS	MATRIX						DATE	TIME	ANALYSIS REQUEST						
				GROUNDWATER	WASTEWATER	SOIL	SL	SLUDGE	OTHER :			ACID:	ICE / COOL	OTHER :	TPH	BTEX	CL	
H-3124-1	WEST LEACH PIT	C	1			X					8-29-97	12:30	X	X	X			
	BOTTOM @ 5'																	
	COMPOSITE																	
H-3124-2	EAST LEACH PIT	C	1			X					8-12-97	12:30	X	X	X			
	BOTTOM @ 25'																	
	COMPOSITE																	

Date: <u>8-12-97</u> Time: <u>12:30pm</u>		Received By: <u>[Signature]</u>	
Date: <u>08/12/97</u> Time: <u>12:45</u>		Received By: (Lab Staff) <u>[Signature]</u>	
Delivered By: (Circle One) <input checked="" type="checkbox"/> UPS - Fed Ex <input type="checkbox"/> Bus <input type="checkbox"/> Other:		Sample Condition Cool <input checked="" type="checkbox"/> Yes <input type="checkbox"/> No Impact <input type="checkbox"/> Yes <input type="checkbox"/> No	
Reindurished By: <u>[Signature]</u>		CHECKED BY: (Initials) <u>[Signature]</u>	

Phone Result <input type="checkbox"/> Yes <input type="checkbox"/> No Fax Results <input type="checkbox"/> Yes <input type="checkbox"/> No	REMARKS: BOTH SAMPLES WERE COMPOSITE SAMPLES TAKEN FROM THE BOTTOM OF THE TWO LEACH FIELD PITS. LOCATED AT PATZ TRUCKING
---	---



ARDINAL LABORATORIES

PHONE (915) 673-7001 • 2111 BEECHWOOD • ABILENE, TX 79603

PHONE (505) 393-2326 • 101 E. MARLAND • HOBBS, NM 88240

ANALYTICAL RESULTS FOR
WESTERN ENVIRONMENTAL CONSULTANTS
ATTN: ALLEN HODGE
P.O. BOX 1816
HOBBS, NM 88241
FAX TO:

Receiving Date: 06/16/97
Reporting Date: 06/18/97
Project Number: NOT GIVEN
Project Name: PATE TRUCKING
Project Location: HOBBS YARD
Lab Number: H3002-1
Sample ID: STOCKPILE SOIL

Analysis Date: 06/17/97
Sampling Date: 06/16/97
Sample Type: SOIL
Sample Condition: COOL & INTACT
Sample Received By: GP
Analyzed By: BC

TCLP VOLATILES (ppm)	EPA LIMIT	Sample Result H3002-1	Method Blank	QC	%Recov.	True Value QC
Vinyl Chloride	0.20	<0.005	<0.005	0.114	114	0.100
1,1-Dichloroethylene	0.7	<0.005	<0.005	0.086	86	0.100
Methyl Ethyl Ketone	200	<0.050	<0.050	0.084	84	0.100
Chloroform	6.0	<0.005	<0.005	0.097	97	0.100
1,2-Dichloroethane	0.5	<0.005	<0.005	0.111	111	0.100
Benzene	0.5	0.011	<0.005	0.085	85	0.100
Carbon Tetrachloride	0.5	<0.005	<0.005	0.104	104	0.100
Trichloroethylene	0.5	<0.005	<0.005	0.084	84	0.100
Tetrachloroethylene	0.7	<0.005	<0.005	0.089	89	0.100
Chlorobenzene	100	<0.005	<0.005	0.097	97	0.100
1,4-Dichlorobenzene	7.5	<0.005	<0.005	0.113	113	0.100

% RECOVERY

Dibromofluoromethane	92
Toluene-d8	101
Bromofluorobenzene	98

METHODS: EPA SW 846-8260, 1311

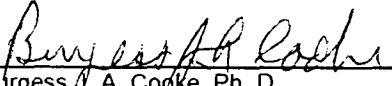
Burgess A. Cooke, Ph. D.

Date



ARDINAL LABORATORIES

PHONE (915) 673-7001 • 2111 BEECHWOOD • ABILENE, TX 79603

PHONE (505) 393-2326 • 101 E. MARLAND • HOBBS, NM 88240

ANALYTICAL RESULTS FOR
WESTERN ENVIRONMENTAL CONSULTANTS
ATTN: ALLEN HODGE
P.O. BOX 1816
HOBBS, NM 88241
FAX TO:

Receiving Date: 06/16/97
Reporting Date: 06/19/97
Project Number: NOT GIVEN
Project Name: PATE TRUCKING
Project Location: HOBBS YARD
Lab Number: H3002-1
Sample ID: STOCKPILE SOIL

Analysis Date: 06/18/97
Sampling Date: 06/16/97
Sample Type: SOIL
Sample Condition: COOL & INTACT
Sample Received By: GP
Analyzed By: BC

TCLP SEMIVOLATILES (ppm)	EPA LIMIT	Sample Result H3002-1	Method Blank	QC	%Recov.	True Value QC
Pyridine	5.00	<0.005	<0.005	0.040	40	0.100
1,4-Dichlorobenzene	7.50	<0.005	<0.005	0.059	59	0.100
o-Cresol	200	<0.005	<0.005	0.058	58	0.100
m, p-Cresol	200	<0.005	<0.005	0.108	54	0.200
Hexachloroethane	3.00	<0.005	<0.005	0.055	55	0.100
Nitrobenzene	2.00	<0.005	<0.005	0.084	84	0.100
Hexachloro-1,3-butadiene	0.500	<0.005	<0.005	0.067	67	0.100
2,4,6-Trichlorophenol	2.00	<0.005	<0.005	0.100	100	0.100
2,4,5-Trichlorophenol	400	<0.005	<0.005	0.099	99	0.100
2,4-Dinitrotoluene	0.130	<0.005	<0.005	0.103	103	0.100
Hexachlorobenzene	0.130	<0.005	<0.005	0.111	111	0.100
Pentachlorophenol	100	<0.005	<0.005	0.111	111	0.100

% RECOVERY

Fluorophenol	60
Phenol-d5	60
Nitrobenzene-d5	71
2-Fluorobiphenyl	82
2,4,6-Tribromophenol	91
Terphenyl-d14	82

METHODS: EPA SW 846-8270, 1311

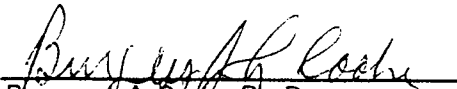
Burgess J. A. Cooke, Ph. D.

6/19/97
Date

PLEASE NOTE: Liability and Damages. Cardinal's liability and client's exclusive remedy for any claim arising, whether based in contract or tort, shall be limited to the amount paid by client for analyses. All claims, including those for negligence and any other cause whatsoever shall be deemed waived unless made in writing and received by Cardinal within thirty (30) days after completion of the applicable service. In no event shall Cardinal be liable for incidental or consequential damages, including, without limitation, business interruptions, loss of use, or loss of profits incurred by client, its subsidiaries, affiliates or successors arising out of or related to the performance of services hereunder by Cardinal, regardless of whether such claim is based upon any of the above-stated reasons or otherwise.



ARDINAL LABORATORIES

PHONE (915) 673-7001 • 2111 BEECHWOOD • ABILENE, TX 79603

PHONE (505) 393-2326 • 101 E. MARLAND • HOBBS, NM 88240

ANALYTICAL RESULTS FOR
WESTERN ENVIRONMENTAL CONSULTANTS
ATTN: ALLEN HODGE
P. O. BOX 1816
HOBBS, NM 88241
FAX TO:

Receiving Date: 06/16/97
Reporting Date: 06/19/97
Project Number: NOT GIVEN
Project Name: PATE TRUCKING
Project Location: HOBBS, NM

Sampling Date: 06/16/97
Sample Type: SOIL
Sample Condition: COOL & INTACT
Sample Received By: GP
Analyzed By: GP

TCLP METALS

LAB NO.	SAMPLE ID	As ppm	Ag ppm	Ba ppm	Cd ppm	Cr ppm	Pb ppm	Hg ppm	Se ppm
---------	-----------	-----------	-----------	-----------	-----------	-----------	-----------	-----------	-----------

ANALYSIS DATE:	6/17/97	6/17/97	6/17/97	6/17/97	6/17/97	6/17/97	6/17/97	6/19/97	6/17/97
EPA LIMITS:	5	5	100	1	5	5	0.2	1	
H3002-1 STOCK PILE	<1	<1	<10	<0.1	<1	<1	0.02	<0.1	
Quality Control	0.208	3.98	20.30	2.001	0.96	1.94	0.0097	0.094	
True Value QC	0.200	4.00	20.00	2.000	1.00	2.00	0.0100	0.100	
% Accuracy	104	99	102	101	96	97	97	94	
Relative Standard Deviation	1.96	0.1	0.6	0.7	2.4	1	5.2	1.9	

METHODS: EPA 1311, 600/4-9	206.2	272.1	208.1	213.1	218.1	239.1	245.1	270.2	
----------------------------	-------	-------	-------	-------	-------	-------	-------	-------	--

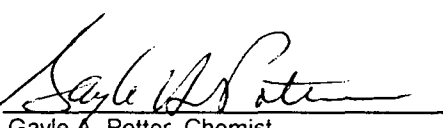
Gayle A. Potter, Chemist

06/20/97
Date

PLEASE NOTE: Liability and Damages. Cardinal's liability and client's exclusive remedy for any claim arising, whether based in contract or tort, shall be limited to the amount paid by client for analyses. All claims for negligence and any other cause whatsoever shall be deemed waived unless made in writing and received by Cardinal within thirty (30) days after completion of the applicable service. In no event shall Cardinal be liable for incidental or consequential damages, including, without limitation, business interruptions, loss of use, or loss of profits incurred by client, its subsidiaries, affiliates or successors arising out of or related to the performance of services hereunder by Cardinal, regardless of whether such claim is based upon any of the above-stated reasons or otherwise.



PHONE (915) 673-7001 • 2111 BEECHWOOD • ABILENE, TX 79603

PHONE (505) 393-2326 • 101 E. MARLAND • HOBBS, NM 88240

ANALYTICAL RESULTS FOR
WESTERN ENVIRONMENTAL CONSULTANTS
ATTN: ALLEN HODGE
P.O. BOX 1816
HOBBS, NM 88241
FAX TO:

Receiving Date: 06/16/97
Reporting Date: 06/17/97
Project Number: NOT GIVEN
Project Name: PATE TRUCKING
Project Location: HOBBS YARD

Sampling Date: 06/16/97
Sample Type: SOIL
Sample Condition: COOL & INTACT
Sample Received By: GP
Analyzed By: BC/AH

LAB NUMBER	SAMPLE ID	REACTIVITY			
		Sulfide (ppm)	Cyanide (ppm)	CORROSIVITY (pH)	IGNITABILITY (°F)
ANALYSIS DATE:		06/17/97	06/17/97	06/16/97	06/17/97
H3002-1	STOCKPILE SOIL	<50	<50	6.61	Nonflammable
Quality Control		NR	NR	7.02	NR
True Value QC		NR	NR	7.00	NR
% Accuracy		NR	NR	100	NR
Relative Percent Difference		NR	NR	0.6	NR

METHOD: EPA SW 846-7.3, 7.2, 1030 (proposed), 1311, 40 CFR 261

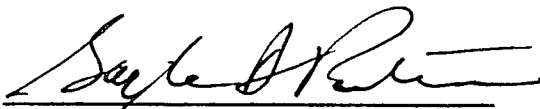
Chemist

06/18/97
Date

PLEASE NOTE: Liability and Damages. Cardinal's liability and client's exclusive remedy for any claim arising, whether based in contract or tort, shall be limited to the amount paid by client for analyses. All claims, including those for negligence and any other cause whatsoever shall be deemed waived unless made in writing and received by Cardinal within thirty (30) days after completion of the applicable service. Cardinal shall be liable for incidental or consequential damages, including, without limitation, business interruptions, loss of use, or loss of profits incurred by client, its subsidiaries, affiliates or successors arising out of or related to the performance of services hereunder by Cardinal, regardless of whether such claim is based upon any of the above-stated reasons or otherwise.



CHAIN-OF-CUSTODY AND ANALYSIS REQUEST

ANALYSIS REQUEST

Company Name: USEC		BIL170		PO #:		ANALYSIS REQUEST	
Project Manager: ALLAN Hedges							
Address: P.O. Box 1816		Company: USEC		Altin: A. Hedges			
City: Hobbs		State: NM		Zip: 88241			
Phone #: 392-5021		Address: Box 1816		City: Hobbs			
Fax #: 397-2597		State: NM		Zip: 88241			
Project #: _____		Phone #: 392-5021		Fax #: 397-2597			
Project Location: Hobbs Yard							

LAB ID. #	Sample I.D.	COMP(C) OR GRAB(G)	# CONTAINERS	MATRIX					DATE	TIME	ANALYSIS REQUEST	
				GROUNDWATER	WASTEWATER	SOIL	OIL	SLUDGE				OTHER :
#3002-1	Stack Pile soils	C	1			X				6/16/97	12:30 PM	X TCLP VOC
												X TCLP Semi VOC
												X TCLP METALS
												X RCI

Date: 6-16-97 Time: 1:20 Received By: [Signature]		Date: 6/16/97 Time: 1:20 Received By: [Signature]	
Delivered By: (Circle One) UPS - Fed Ex - Bus - Other:		Sample Condition Cool <input checked="" type="checkbox"/> Yes <input type="checkbox"/> No Impact <input checked="" type="checkbox"/> Yes <input type="checkbox"/> No	
Phone Result: <input type="checkbox"/> Yes <input type="checkbox"/> No Fax Results: <input type="checkbox"/> Yes <input type="checkbox"/> No Additional Fax #: _____		REMARKS: THIS SAMPLE WAS A COMPOSITE SAMPLE TAKEN FROM THE STACK PILE SOILS IN YARD	

NMOCD DISPOSAL APPROVAL

Albuquerque, NM 87101-1700
District II - (505) 748-1283
814 S. First
Albuquerque, NM 88210
District III - (505) 334-6178
1000 Rio Brazos Road
Albuquerque, NM 87410
District IV - (505) 827-7131

Energy Minerals and Natural Resources Department

Oil Conservation Division

2040 South Pacheco Street
Santa Fe, New Mexico 87505
(505) 827-7131

Att: MARYAN

PLEASE CC MR. SANDERSON

Original
Submitted
Plus
Approved
Date

REQUEST FOR APPROVAL TO ACCEPT SOLID WASTE

1. RCRA Exempt: <input type="checkbox"/> Non-Exempt: <input checked="" type="checkbox"/>	4. Generator PATE TRUCKING
Verbal Approval Received: Yes <input type="checkbox"/> No <input type="checkbox"/>	5. Originating Site HOBBS FACI
2. Management Facility Destination SUNDANCE SERVICES INC.	6. Transporter PATE
3. Address of Facility Operator P.O. BOX 1737 Eunice NM 88231g. State NEW MEXICO	
7. Location of Material (Street Address or ULSTR) 3800 South Eunice Hwy. Hobbs, NM 88231	
9. Circle One: A. All requests for approval to accept oilfield exempt wastes will be accompanied by a certification of waste from Generator; one certificate per job. B. All requests for approval to accept non-exempt wastes must be accompanied by necessary chemical analysis PROVE the material is not-hazardous and the Generator's certification of origin. No waste classified hazardous listing or testing will be approved. All transporters must certify the wastes delivered are only those consigned for transport.	

BRIEF DESCRIPTION OF MATERIAL:

The following analytical is from Pate Trucking's Hobbs Facility. This waste was generated during normal activity of namely MacIskey Oilfield Service and Pate Trucking. This waste is generated from the wash bay and shop septic tank from the washing of trucks. I have included a certificate of waste status and chain of custody. Sundance Services would like approval to dispose of this material at our Parabo Facility.

JUL 10 1997

RECEIVED

JUL 8 7 1997

RECEIVED

Estimated Volume 250 yards cy Known Volume (to be entered by the operator at the end of the haul)

SIGNATURE: Donna L. Roach TITLE: Office Manager DATE: 7-10-97
Waste Management Facility Authorized Agent
TYPE OR PRINT NAME: Donna L. Roach TELEPHONE NO. 505-394-2511

(This space for State Use)

APPROVED BY: [Signature] TITLE: Engr Engr DATE: 7/11/97

APPROVED BY: [Signature] TITLE: Engr Geologist DATE: 7/14/97

Pate Trucking Co., Inc.
New Mexico Operations

P. O. Box 1008
3800 S. Eunice Highway

505-397-6264
800-657-9353
Fax 505-397-2597

Hobbs, New Mexico 88241

June 25, 1997

Dear Sir:

I have at 3800 South Eunice Hwy, Hobbs, New Mexico approximately 250 cubic yards of soil to dispose of.

This waste was generated during normal operations of namely, Maclaskey Oil Field Service, Inc., previous owners, from the wash bay and shop septic tank at the Hobbs, New Mexico yard from the washing of trucks, from which the waste went into the oil sump and impacted the ground in same area

Sincerely,



Gary Mead
President - Pate Trucking Co., Inc.
NM Operations - Hobbs, New Mexico

CERTIFICATE OF WASTE STATUS

NON-EXEMPT WASTE MATERIAL

ORIGINATING LOCATION: PATE Trucking Co., Inc.

SOURCE: WASH BAY AND SHOP SEPTIC TANK

DISPOSAL LOCATION: SUNDANCE DISPOSAL FACILITY

As a condition of acceptance for disposal, I hereby certify that this waste is a non-exempt waste as defined by the Environmental Protection Agency's (EPA) July 1988 Regulatory Determination. To my knowledge, this waste will be analyzed pursuant to the provisions of 40 CFR Part 261 to verify the nature as non-hazardous. I further certify that to my knowledge no "hazardous or listed waste" pursuant to the provisions of 40 CFR, Part 261, Subparts C and D, has been added or mixed with the waste so as to make the resultant mixture a "hazardous waste" pursuant to the provisions of 40 CFR, Section 261.3.

I, the undersigned as the agent for PATE Trucking Co., Inc.
concur with the status of the waste from the subject site.

Name GARY MEAD

Title/Angency President

Address P.O. Box 1008, 3800 S. Euwice Hwy.
Hobbs, NM 88240

Signature Gary Mead

Date 6-25-97

WATER WELLS

Table 4
Summary of Water Wells Identified within 1/2 mile of Pate Trucking Facility
Well Records on File with the State Engineers Office

Well Owner	Permit No.	Total Depth	Depth to Water	Date Completed	Date Plugged	Well Use	Well Township	Well Range	Well Section	Location
Narroquin, Franciso	L-6759	100	45	03/10/71	--	DOM	T19S	R38E	15	221
Warroquis, Francisco	L-6858	100	45	12/06/71	--	DOM	T19S	R38E	15	230
Townsend, Bobby	L-7357	101		04/12/75	--	DOM	T19S	R38E	15	24221
Lee, G. D.	L-8046	130	58	03/20/80	--	DOM	T19S	R38E	15	244
Sherrill, Wilbur	L-7359	117	57	04/11/75	--	DOM	T19S	R38E	15	24444
Dean, T. M.	L-2667	108	70	02/21/57	--	DOM	T19S	R38E	15	400
Bonner, C. C.	L-7512	100	32	04/14/76	--	--	T19S	R38E	15	4122
Weldy, G. W.	L-7882	100	32	04/19/79	--	DOM	T19S	R38E	15	41100
Glasspoole, Frank	L-6101	100	38	12/22/85	--	DOM	T19S	R38E	15	41131
Clark, J. C.	L-4489	100	41	08/28/60	--	DOM	T19S	R38E	15	413
Fulkerson, James	L-10046	120	70	11/26/88	--	DOM	T19S	R38E	15	4130
Benny, Bobby	L-9821	100	51	05/03/86	--	DOM	T19S	R38E	15	41340
Dobbins	L-9012	100	32	08/02/82	--	DOM	T19S	R38E	15	414
Dobbins, Hazel	L-9310	120	58	08/29/83	--	DOM	T19S	R38E	15	414
Dobbins, B. R.	L-7381	100	50	05/16/75	--	DOM	T19S	R38E	15	41412
Attaway, Neal	L-5013	100	47	04/09/63	--	DOM	T19S	R38E	15	420
Scott, R. W.	L-9896	100	38	02/17/87	--	DOM	T19S	R38E	15	42124
Ballew, Wayne	L-4107	112	60	04/23/59	--	DOM	T19S	R38E	15	422
Barton, J. E.	L-4622	70	46	06/01/61	--	DOM	T19S	R38E	15	422
Morrow, Terry	L-7379	120	44	05/31/75	--	DOM	T19S	R38E	15	42312
Phar, T.	L-4539	100	48	11/05/60	--	DOM	T19S	R38E	15	424
Hardin & Houston	L-6733	123	50	11/16/79	--	DOM	T19S	R38E	15	424233
Spradley, Jim	L-10322	133	44	04/13/93	--	D&S	T19S	R38E	15	42424
Hardin & Houston	L-5623	142	52	06/06/64	--	COM	T19S	R38E	15	42441
Bingham, M. L.	L-2689	83	49	11/30/54	--	--	T19S	R38E	15	444
Bingham, N. L.	L-3248	123	48	04/28/58	--	IRR	T19S	R38E	15	44412
Aaron, A. A.	L-8352	118	50	09/17/80	--	DOM	T19S	R38E	15	44
Tarber, Joe	L-10138	170	60	12/15/90	--	IRR	T19S	R38E	15	44333
Wallen Production	L-8250	125	80	01/12/80	--	OWD	T19S	R38E	15	34244
Younger Construction	L-3658	120	50	08/28/57	--	DOM	T19S	R38E	14	310
Selman, J. A.	L-1021	168	75	02/22/57	--	IRR	T19S	R38E	14	222
Selman, Frank	L-345	124	--	10/26/47	--	--	T19S	R38E	14	142
Selman	W-8	125	65	04/13/53	--	--	T19S	R38E	14	240
Caprock Communications	L-10011	140	60	06/15/88	--	DOM	T19S	R38E	14	1110

Permit No. is issued by State Engineer. Where no well completion record was identified in State files a unique number beginning with a "W" was used to reference the well in this report.

Location uses state number code

-- No data available

Well Use - DOM=Domestic, IRR=Irrigation, COM=Commercial, OWD=Oil well drilling

Table 3
Water Quality of Water Wells with 1/2 Mile of Pate Trucking Facility
Analytical Results Obtained from the State Engineers Office

Well Owner	Permit No.	Total Depth (ft)	Water Zone	Date Sampled	Well Use	Well Township	Range	Section	Location	Chloride	Water SG	Quality Temperature	pH
Marroquin, Frank	W-1	100 --	TOG	12/20/79	IRR	T19S	R38E	15	41214	188	1348	--	--
Marroquin, Frank	W-2	100 --	TOG	12/20/79	DOM	T19S	R38E	15	412321	186	1049	--	--
Marroquin, Frank	W-2	100 --	TOG	11/29/84	DOM	T19S	R38E	15	412321	276	1331	--	--
Marroquin, Frank	W-2	100 --	TOG	07/12/90	DOM	T19S	R38E	15	412321	450	1988	--	--
Terry, Johnny	W-3	--	TOG	11/29/84	DOM	T19S	R38E	15	412322	284	1602	--	--
Viro-Montes	W-4	--	TOG	11/12/84	DOM	T19S	R38E	15	41413	158	1178	--	--
Champion Chemical	W-5	--	TOG	11/30/79	DOM	T19S	R38E	15	422444	186	1405	66	--
Champion Chemical	W-6	123 --	TOG	08/17/77	DOM	T19S	R38E	15	424233	504	2370	82	--
Champion Chemical	W-6	123 --	TOG	11/29/84	DOM	T19S	R38E	15	424233	372	2208	--	--
Champion Chemical	W-7	142 --	TOG	08/25/65	COM	T19S	R38E	15	42441	830	3110	--	--

Permit No. is issued by State Engineer. Where no well completion record was identified in State files a unique number beginning with a "W" was used to reference the well in this report.

Location uses state number code

Well Use - DOM=Domestic, IRR=Irrigation, COM=Commercial, OWD=Oil well drilling

-- No data available

SITE MAP

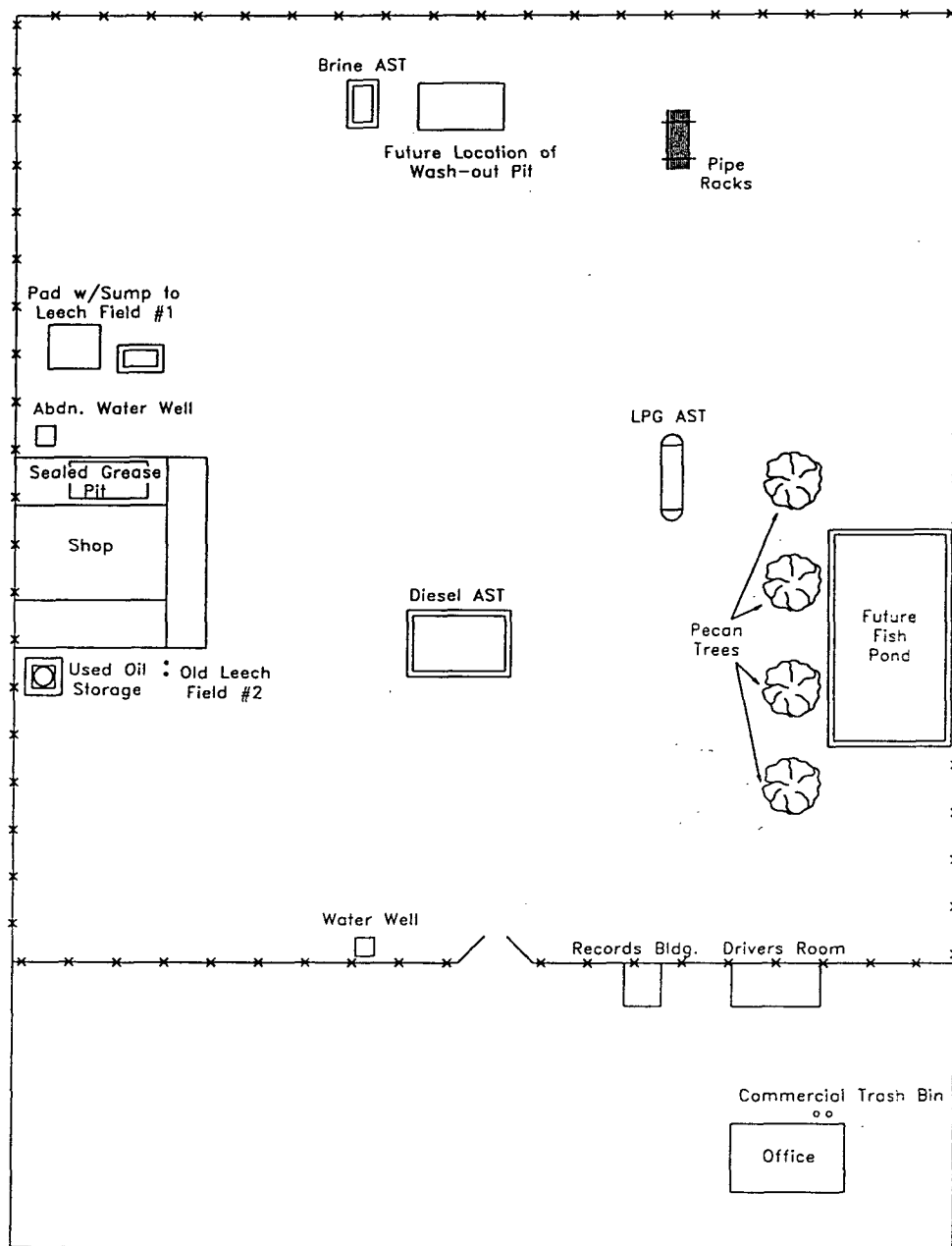

AST = Aboveground Storage Tank

PATE TRUCKING Co., Inc.

SITE MAP
3800 S. EUNICE HIGHWAY
NW4/SW4 SEC, 14, T19S, R38E
HOBBS, NEW MEXICO

DATE: 2-7-96	DRAWN: M.F.G.	REV. DATE	DIV
SCALE: 1" = 100'		JOB #	
DRAWING 3 OF 3		FILE:	

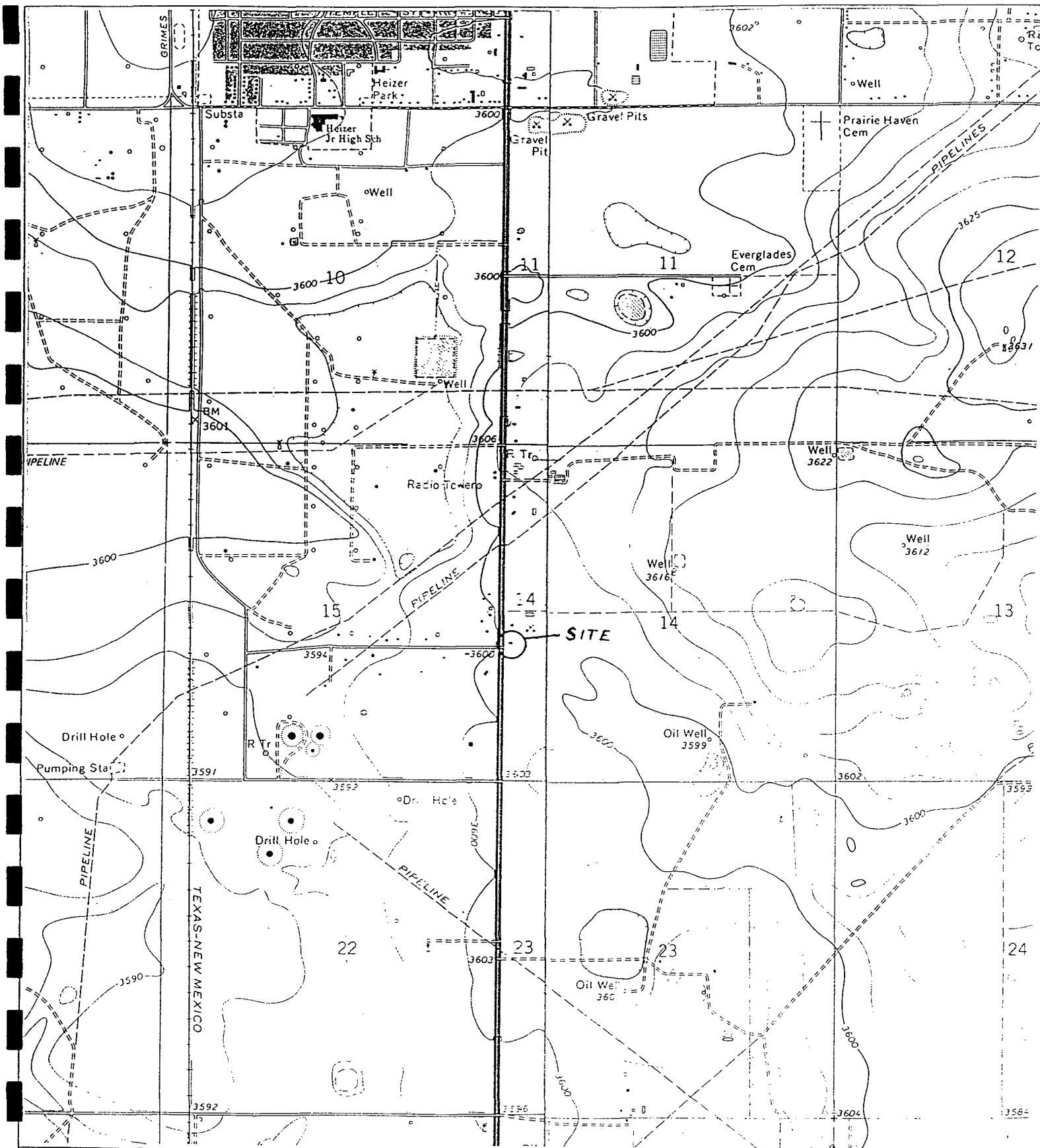

USGS TOPOGRAPHIC MAP

HOBBS WEST & HOBBS EAST
QUADRANGLES
LEA Co., NEW MEXICO
1969 PHOTOREVISED 1979

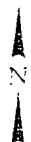

PATE TRUCKING Co., Inc.

CONTOUR TOPOGRAPHY
3800 S. EUNICE HIGHWAY
NW4/SW4 SEC. 14 T19S, R38E
HOBBS, NEW MEXICO

SCALE: 1" = 2000'

JOB #

SHEET 1 OF 2

FILE

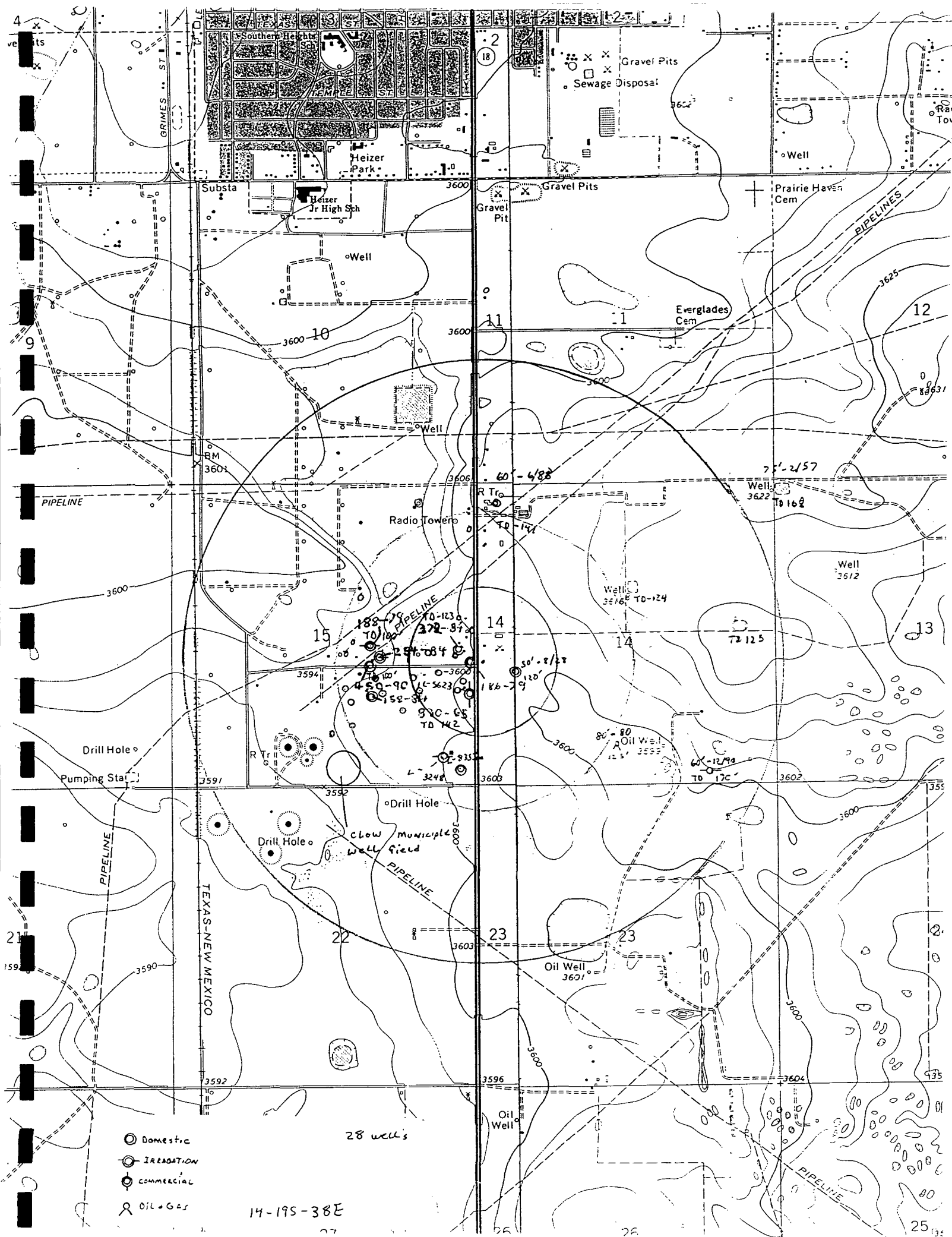

JOB PHOTOS



PATE TRUCKING
EAST PIT





**PATE TRUCKING
EAST PIT**





**PATE TRUCKING
EAST PIT**





**PATE TRUCKING
EAST PIT**





**PATE TRUCKING
EAST PIT**





**PATE TRUCKING
EAST PIT**



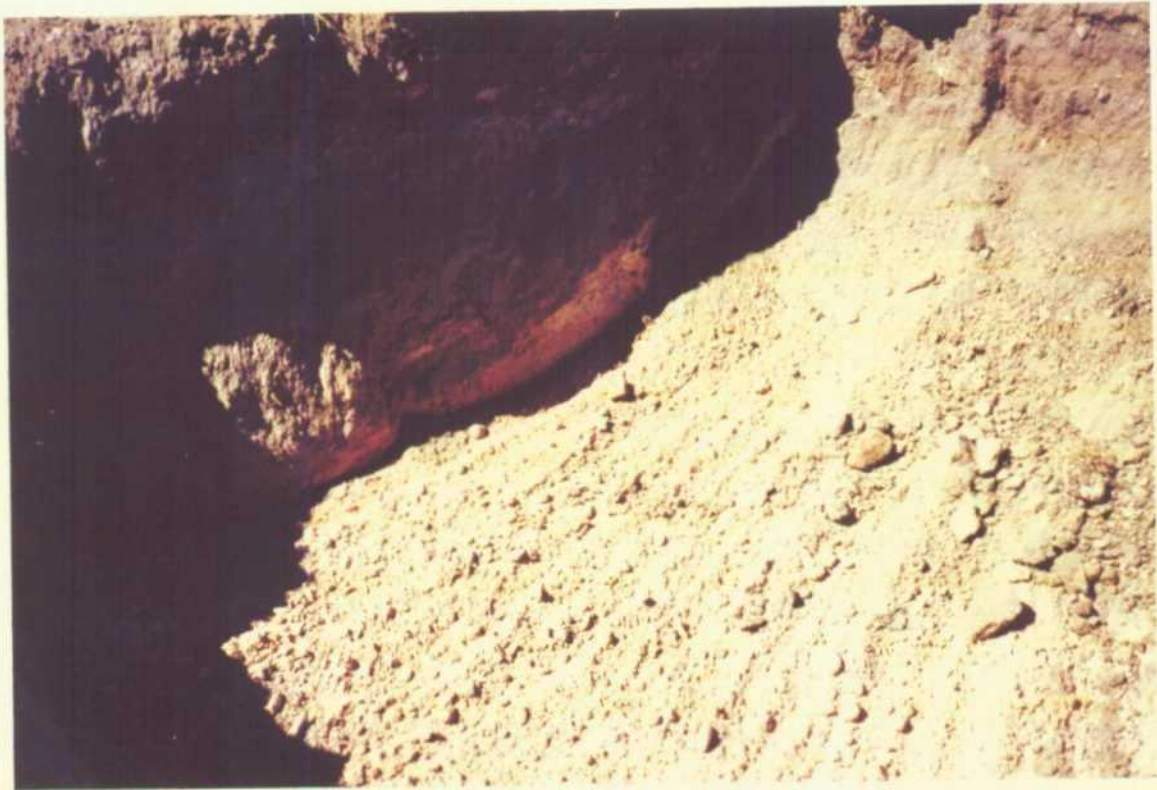

**PATE TRUCKING
WEST PIT**



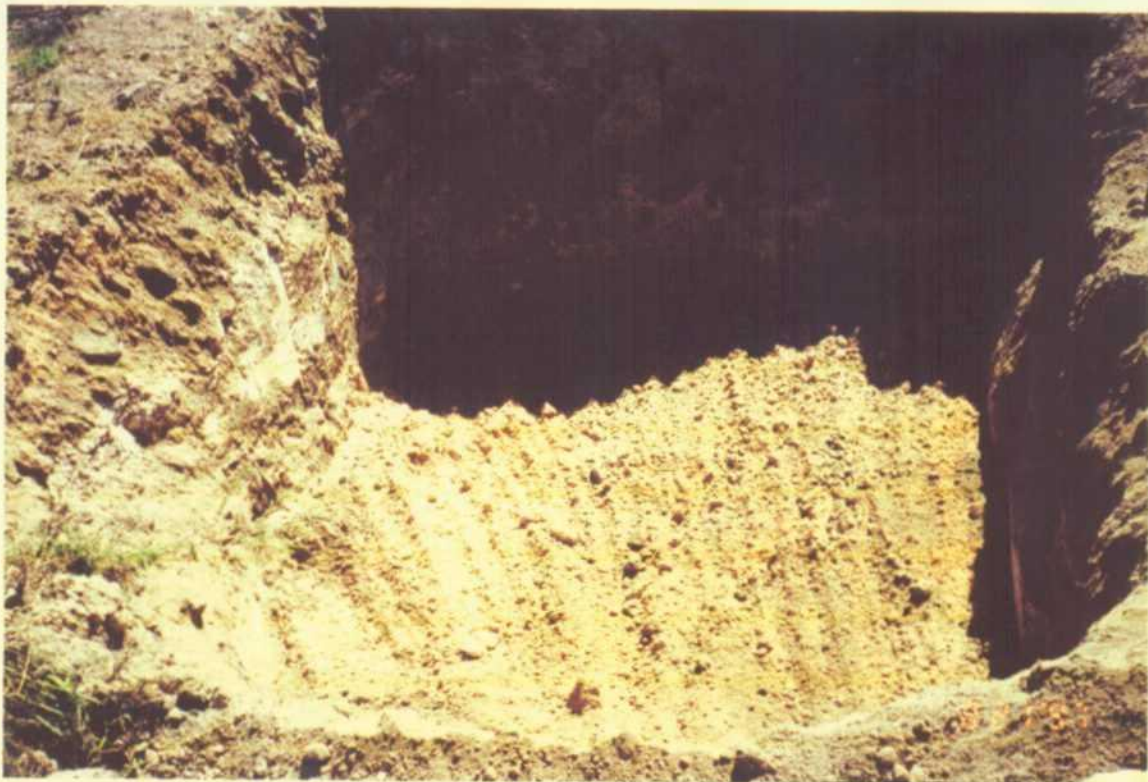

**PATE TRUCKING
WEST PIT**





**PATE TRUCKING
WEST PIT**

