

GW - 258

**PERMITS,
RENEWALS,
& MODS
Application**



June 4, 2010

RECEIVED OCD
2010 JUL -1 P 2:45



*****AUTO**MIXED AADC 680

State Of New Mexico
Natural Resources Dept
Water Quality Mgmt Fund
1220 S Saint Francis Dr
Santa Fe, NM 87505-4225

8589
T41 P1

Dear Valued Supplier,

This letter provides notice that the entities listed on the enclosed document have changed their names. Please revise your records to reflect the new names. All future notices or other communications sent pursuant to any contracts or agreements between State Of New Mexico and any of the listed entities should continue to be sent to the address you have on record.

All terms and conditions of any contracts or agreements between State Of New Mexico and any of the entities named on the attached list remain unchanged, and such contracts or agreements continue in full force and effect.

Please also be reminded of Enterprise Products Company (formerly EPCO, Inc.) and its affiliates' invoice requirements under our new Procure-to-Pay system, where all supplier invoices submitted must now include one of the following four key identifiers:

- Purchase Order ("PO") number
- Authorization for Expenditure ("AFE") number
- Work Order ("WO") number
- Pay Key number

Invoices received without one of the key identifiers will be returned to the supplier requesting the appropriate information. The key identifiers serve to authenticate the purchase and to route the invoice to the appropriate requestor or approver. In addition to requiring a key identifier, invoices containing multiple PO billings will be sent back to the supplier for correction. System limitations require an invoice to contain only one PO reference.

Please do not hesitate to contact me with any questions at 713-381-1527 or patnguyen@eprod.com.

Sincerely,

Patrick Nguyen
Director, Accounts Receivable and Accounts Payable

Enclosure

Entity Name Changes	
Old Name	New Name
EPCO, Inc.	Enterprise Products Company
TE Products Pipeline Company, LLC	Enterprise TE Products Pipeline Company LLC
TEPPCO Colorado, LLC	Enterprise Colorado LLC
TEPPCO Crude GP, LLC	Enterprise Crude GP LLC
TEPPCO Crude Oil, LLC	Enterprise Crude Oil LLC
TEPPCO Crude Pipeline, LLC	Enterprise Crude Pipeline LLC
TEPPCO GP, LLC	Enterprise GP LLC
TEPPCO Investments, LLC	Enterprise TE Investments LLC
TEPPCO Midstream Companies, LLC	Enterprise Midstream Companies LLC
TEPPCO NGL Pipelines, LLC	Enterprise NGL Pipelines II LLC
TEPPCO Partners, L.P.	Enterprise TE Partners L.P.
TEPPCO Seaway, L.P.	Enterprise Seaway L.P.
TEPPCO Terminaling and Marketing Company LLC	Enterprise Refined Products Company LLC
TEPPCO Terminals Company, L.P.	Note: TEPPCO Terminals Company, L.P. merged into TEPPCO Terminaling and Marketing Company LLC which then changed its name to Enterprise Refined Products Company LLC
Texas Eastern Products Pipeline Company, LLC	Enterprise Products Pipeline Company LLC



June 4, 2010

RECEIVED OCD
2010 JUL -1 P 2:45



*****AUTO**MIXED AADC 680

State Of New Mexico
C/O Oil Conservation Division
1220 S Saint Francis Dr
Santa Fe, NM 87505-4225

8592
T41 P1

Dear Valued Supplier,

This letter provides notice that the entities listed on the enclosed document have changed their names. Please revise your records to reflect the new names. All future notices or other communications sent pursuant to any contracts or agreements between State Of New Mexico and any of the listed entities should continue to be sent to the address you have on record.

All terms and conditions of any contracts or agreements between State Of New Mexico and any of the entities named on the attached list remain unchanged, and such contracts or agreements continue in full force and effect.

Please also be reminded of Enterprise Products Company (formerly EPCO, Inc.) and its affiliates' invoice requirements under our new Procure-to-Pay system, where all supplier invoices submitted must now include one of the following four key identifiers:

- Purchase Order ("PO") number
- Authorization for Expenditure ("AFE") number
- Work Order ("WO") number
- Pay Key number

Invoices received without one of the key identifiers will be returned to the supplier requesting the appropriate information. The key identifiers serve to authenticate the purchase and to route the invoice to the appropriate requestor or approver. In addition to requiring a key identifier, invoices containing multiple PO billings will be sent back to the supplier for correction. System limitations require an invoice to contain only one PO reference.

Please do not hesitate to contact me with any questions at 713-381-1527 or patnguyen@eprod.com.

Sincerely,

Patrick Nguyen
Director, Accounts Receivable and Accounts Payable

Enclosure

Entity Name Changes	
Old Name	New Name
EPCO, Inc.	Enterprise Products Company
TE Products Pipeline Company, LLC	Enterprise TE Products Pipeline Company LLC
TEPPCO Colorado, LLC	Enterprise Colorado LLC
TEPPCO Crude GP, LLC	Enterprise Crude GP LLC
TEPPCO Crude Oil, LLC	Enterprise Crude Oil LLC
TEPPCO Crude Pipeline, LLC	Enterprise Crude Pipeline LLC
TEPPCO GP, LLC	Enterprise GP LLC
TEPPCO Investments, LLC	Enterprise TE Investments LLC
TEPPCO Midstream Companies, LLC	Enterprise Midstream Companies LLC
TEPPCO NGL Pipelines, LLC	Enterprise NGL Pipelines II LLC
TEPPCO Partners, L.P.	Enterprise TE Partners L.P.
TEPPCO Seaway, L.P.	Enterprise Seaway L.P.
TEPPCO Terminaling and Marketing Company LLC	Enterprise Refined Products Company LLC
TEPPCO Terminals Company, L.P.	Note: TEPPCO Terminals Company, L.P. merged into TEPPCO Terminaling and Marketing Company LLC which then changed its name to Enterprise Refined Products Company LLC
Texas Eastern Products Pipeline Company, LLC	Enterprise Products Pipeline Company LLC



NEW MEXICO ENERGY, MINERALS and NATURAL RESOURCES DEPARTMENT

BILL RICHARDSON

Governor

Joanna Prukop

Cabinet Secretary

Mark E. Fesmire, P.E.

Director

Oil Conservation Division

October 23, 2006

Deodat Bhagwandin, P.E.
TEPPCO NGL Pipelines, LLC
P.O. Box 2521
2929 Allen Parkway
Houston, Texas 77252-2521

Re: Discharge Permit GW-258 Renewal
Cedar Hill Compressor Station

Dear Mr. Bhagwandin:

Pursuant to Water Quality Control Commission (WQCC) Regulations 20.6.2.3104 - 20.6.2.3114 NMAC, the Oil Conservation Division (OCD) hereby **approves the discharge permit** for the TEPPCO NGL Pipelines, LLC (owner/operator) Cedar Hill Compressor Station GW-258 located in the SW/4 of Section 29, NW/4 of Section 32, Township 32 North, Range 10 West, NMPM, San Juan County, New Mexico, under the conditions specified in the enclosed **Attachment To The Discharge Permit**. Enclosed are two copies of the conditions of approval. **Please sign and return one copy to the New Mexico Oil Conservation Division (OCD) Santa Fe Office within 30 working days of receipt of this letter including permit fees.**

Please be advised that approval of this permit does not relieve the owner/operator of responsibility should operations result in pollution of surface water, ground water or the environment. Nor does approval of the permit relieve the owner/operator of its responsibility to comply with any other applicable governmental authority's rules and regulations.

If you have any questions, please contact Carl Chavez of my staff at (505-476-3491) or E-mail carlj.chavez@state.nm.us. On behalf of the staff of the OCD, I wish to thank you and your staff for your cooperation during this discharge permit review.

Sincerely,

Wayne Price
Environmental Bureau Chief

LWP/cc

Attachments-1

xc: OCD District Office

**ATTACHMENT TO THE DISCHARGE PERMIT
TEPPCO NGL PIPELINES, LLC, CEDAR HILL COMPRESSOR STATION (GW-258)
DISCHARGE PERMIT APPROVAL CONDITIONS
October 23, 2006**

Please remit a check for \$1700.00 made payable to Water Quality Management Fund:

**Water Quality Management Fund
C/o: Oil Conservation Division
1220 South Saint Francis Drive
Santa Fe, New Mexico 87505**

- 1. Payment of Discharge Plan Fees:** All discharge permits are subject to WQCC Regulations. Every billable facility that submits a discharge permit application will be assessed a filing fee of \$100.00, plus a renewal flat fee (*see* WQCC Regulation 20.6.2.3114 NMAC). The Oil Conservation Division ("OCD") has received the required \$100.00 filing fee. However, the owner/operator still owes the required \$1700.00 renewal permit fee for a gas compressor station greater than 1001 horsepower.
- 2. Permit Expiration and Renewal:** Pursuant to WQCC Regulation 20.6.2.3109.H.4 NMAC, this permit is valid for a period of five years. **The permit will expire on September 30, 2011** and an application for renewal should be submitted no later than 120 days before that expiration date. Pursuant to WQCC Regulation 20.6.2.3106.F NMAC, if a discharger submits a discharge permit renewal application at least 120 days before the discharge permit expires and is in compliance with the approved permit, then the existing discharge permit will not expire until the application for renewal has been approved or disapproved.
- 3. Permit Terms and Conditions:** Pursuant to WQCC Regulation 20.6.2.3104 NMAC, when a permit has been issued, the owner/operator must ensure that all discharges shall be consistent with the terms and conditions of the permit. In addition, all facilities shall abide by the applicable rules and regulations administered by the OCD pursuant to the Oil and Gas Act, NMSA 1978, Sections 70-2-1 through 70-2-38.
- 4. Owner/Operator Commitments:** The owner/operator shall abide by all commitments submitted in its September 7, 2006 discharge permit renewal application, including attachments and subsequent amendments and these conditions for approval. Permit applications that reference previously approved plans on file with the division shall be incorporated in this permit and the owner/operator shall abide by all previous commitments of such plans and these conditions for approval.
- 5. Modifications:** WQCC Regulation 20.6.2.3109.G NMAC addresses possible future modifications of a permit. Pursuant to WQCC Regulation 20.6.2.3107.C NMAC, the owner/operator (discharger) shall notify the OCD of any facility expansion, production increase or process modification that would result in any significant modification in the discharge of water contaminants. Pursuant to WQCC Regulation 20.6.2.3109.E NMAC, the Division Director may require a permit modification if any water quality standard specified at 20.6.2.3103

NMAC is being or will be exceeded, or if a toxic pollutant as defined in WQCC Regulation 20.6.2.7 NMAC is present in ground water at any place of withdrawal for present or reasonably foreseeable future use, or that the Water Quality Standards for Interstate and Intrastate streams as specified in 20.6.4 NMAC are being or may be violated in surface water in New Mexico.

6. Waste Disposal and Storage: The owner/operator shall dispose of all wastes at an OCD-approved facility. Only oil field RCRA-exempt wastes may be disposed of by injection in a Class II well. RCRA non-hazardous, non-exempt oil field wastes may be disposed of at an OCD-approved facility upon proper waste determination pursuant to 40 CFR Part 261. Any waste stream that is not listed in the discharge permit application must be approved by the OCD on a case-by-case basis.

A. OCD Rule 712 Waste: Pursuant to OCD Rule 712 (19.15.9.712 NMAC) disposal of certain non-domestic waste without notification to the OCD is allowed at NMED permitted solid waste facilities if the waste stream has been identified in the discharge permit and existing process knowledge of the waste stream does not change.

B. Waste Storage: The owner/operator shall store all waste in an impermeable bermed area, except waste generated during emergency response operations for up to 72 hours. All waste storage areas shall be identified in the discharge permit application. Any waste storage area not identified in the permit shall be approved on a case-by-case basis only. The owner/operator shall not store oil field waste on-site for more than 180 days unless approved by the OCD.

7. Drum Storage: The owner/operator must store all drums, including empty drums, containing materials other than fresh water on an impermeable pad with curbing. The owner/operator must store empty drums on their sides with the bungs in place and lined up on a horizontal plane. The owner/operator must store chemicals in other containers, such as tote tanks, sacks, or buckets on an impermeable pad with curbing.

8. Process, Maintenance and Yard Areas: The owner/operator shall either pave and curb or have some type of spill collection device incorporated into the design at all process, maintenance, and yard areas which show evidence that water contaminants from releases, leaks and spills have reached the ground surface.

9. Above Ground Tanks: The owner/operator shall ensure that all aboveground tanks have impermeable secondary containment (e.g., liners and berms), which will contain a volume of at least one-third greater than the total volume of the largest tank or all interconnected tanks. The owner/operator shall retrofit all existing tanks before discharge permit renewal. Tanks that contain fresh water or fluids that are gases at atmospheric temperature and pressure are exempt from this condition.

10. Labeling: The owner/operator shall clearly label all tanks, drums, and containers to identify their contents and other emergency notification information. The owner/operator may use a tank code numbering system, which is incorporated into their emergency response plans.

11. Below-Grade Tanks/Sumps and Pits/Ponds.

A. All below-grade tanks and sumps must be approved by the OCD prior to installation and must incorporate secondary containment with leak detection into the design. The owner/operator shall retrofit all existing systems without secondary containment and leak detection before discharge permit renewal. All existing below-grade tanks and sumps without secondary containment and leak detection shall be tested annually or as specified herein. Systems that have secondary containment with leak detection shall have a monthly inspection of the leak detection system to determine if the primary containment is leaking. Small sumps or depressions in secondary containment systems used to facilitate fluid removal are exempt from these requirements if fluids are removed within 72 hours.

B. All pits and ponds, including modifications and retrofits, shall be designed by a certified registered professional engineer and approved by the OCD prior to installation. In general, all pits or ponds shall have approved hydrologic and geologic reports, location, foundation, liners, and secondary containment with leak detection, monitoring and closure plans. All pits or ponds shall be designed, constructed and operated so as to contain liquids and solids in a manner that will protect fresh water, public health, safety and the environment for the foreseeable future. The owner/operator shall retrofit all existing systems without secondary containment and leak detection before discharge permit renewal.

C. The owner/operator shall ensure that all exposed pits, including lined pits and open top tanks (8 feet in diameter or larger) shall be fenced, screened, netted, or otherwise rendered non-hazardous to wildlife, including migratory birds.

D. The owner/operator shall maintain the results of tests and inspections at the facility covered by this discharge permit and available for OCD inspection. The owner/operator shall report the discovery of any system which is found to be leaking or has lost integrity to the OCD within 15 days. The owner/operator may propose various methods for testing such as pressure testing to 3 pounds per square inch greater than normal operating pressure and/or visual inspection of cleaned tanks and/or sumps, or other OCD-approved methods. The owner/operator shall notify the OCD at least 72 hours prior to all testing.

12. Underground Process/Wastewater Lines:

A. The owner/operator shall test all underground process/wastewater pipelines at least once every five (5) years to demonstrate their mechanical integrity, except lines containing fresh water or fluids that are gases at atmospheric temperature and pressure. Pressure rated pipe shall be tested by pressuring up to one and one-half times the normal operating pressure, if possible, or for atmospheric drain systems, to 3 pounds per square inch greater than normal operating pressure, and pressure held for a minimum of 30 minutes with no more than a 1% loss/gain in pressure. The owner/operator may use other methods for testing if approved by the OCD.

B. The owner/operator shall maintain underground process and wastewater pipeline schematic diagrams or plans showing all drains, vents, risers, valves, underground piping, pipe

type, rating, size, and approximate location. All new underground piping must be approved by the OCD prior to installation. The owner/operator shall report any leaks or loss of integrity to the OCD within 15 days of discovery. The owner/operator shall maintain the results of all tests at the facility covered by this discharge permit and they shall be available for OCD inspection. The owner/operator shall notify the OCD at least 72 hours prior to all testing.

13. Class V Wells: The owner/operator shall close all Class V wells (e.g., septic systems, leach fields, dry wells, etc.) that inject non-hazardous industrial wastes or a mixture of industrial wastes and domestic wastes unless the owner/operator can demonstrate that ground water will not be impacted in the reasonably foreseeable future. Leach fields and other wastewater disposal systems at OCD-regulated facilities that inject non-hazardous fluid into or above an underground source of drinking water are considered Class V injection wells under the EPA UIC program. Class V wells that inject domestic waste only, must be permitted by the New Mexico Environment Department (NMED).

14. Housekeeping: The owner/operator shall inspect all systems designed for spill collection/prevention and leak detection at least monthly to ensure proper operation and to prevent over topping or system failure. All spill collection and/or secondary containment devices shall be emptied of fluids within 72 hours of discovery. The owner/operator shall maintain all records at the facility and available for OCD inspection.

15. Spill Reporting: The owner/operator shall report all unauthorized discharges, spills, leaks and releases and conduct corrective action pursuant to WQCC Regulation 20.5.12.1203 NMAC and OCD Rule 116 (19.15.3.116 NMAC). The owner/operator shall notify both the OCD District Office and the Santa Fe Office within 24 hours and file a written report within 15 days.

16. OCD Inspections: The OCD may place additional requirements on the facility and modify the permit conditions based on OCD inspections.

17. Storm Water: The owner/operator shall implement and maintain run-on and run-off plans and controls. The owner/operator shall not discharge any water contaminant that exceeds the WQCC standards specified in 20.6.2.3101 NMAC or 20.6.4 NMAC (Water Quality Standards for Interstate and Intrastate Streams) including any oil sheen in any stormwater run-off. The owner/operator shall notify the OCD within 24 hours of discovery of any releases and shall take immediate corrective action(s) to stop the discharge.

18. Unauthorized Discharges: The owner/operator shall not allow or cause water pollution, discharge or release of any water contaminant that exceeds the WQCC standards listed in 20.6.2.3101 NMAC or 20.6.4 NMAC (Water Quality Standards for Interstate and Intrastate Streams) unless specifically listed in the permit application and approved herein. **An unauthorized discharge is a violation of this permit.**

19. Vadose Zone and Water Pollution: The owner/operator shall address any contamination through the discharge permit process or pursuant to WQCC 20.6.2.4000-.4116 NMAC (Prevention and Abatement of Water Pollution). The OCD may require the owner/operator to modify its permit for investigation, remediation, abatement, and monitoring requirements for any vadose zone

or water pollution. Failure to perform any required investigation, remediation, abatement and submit subsequent reports will be a violation of the permit.

20. Additional Site Specific Conditions: N/A

21. Transfer of Discharge Permit: The owner/operator shall notify the OCD prior to any transfer of ownership, control or possession of a facility with an approved discharge permit. The purchaser shall submit a written commitment to comply with the terms and conditions of the previously approved discharge permit and shall seek OCD approval prior to transfer.

22. Closure: The owner/operator shall notify the OCD when operations of the facility are to be discontinued for a period in excess of six months. Prior to closure of the facility, the operator shall submit a closure plan for approval. Closure and waste disposal shall be in accordance with the statutes, rules and regulations in effect at the time of closure.

23. Certification: Certification: **TEPPCO NGL Pipelines, LLC**, by the officer whose signature appears below, accepts this permit and agrees to comply with all submitted commitments, including these terms and conditions contained herein. **TEPPCO NGL Pipelines, LLC** further acknowledges that the OCD may, for good cause shown, as necessary to protect fresh water, public health, safety, and the environment, change the conditions and requirements of this permit administratively.

Conditions accepted by: **TEPPCO NGL Pipelines, LLC**

Terry Haulburt
Company Representative- print name

[Signature]
Company Representative- signature

Date 1/8/07

Title [Signature]
Sr. VP Operations



September 7, 2006

SENT VIA FED-EX NEXT DAY

Mr. Wayne Price
New Mexico Energy, Minerals & Natural Resources Department
Oil Conservation Division
1220 South St. Francis Drive
Santa Fe, New Mexico 87505

Re: TEPPCO NGL Pipelines, LLC
TEPPCO Cedar Hill Compressor Station
San Juan County, New Mexico
Groundwater Discharge Plan (GW-258) Renewal Application

Dear Mr. Price:

TEPPCO NGL Pipelines, LLC ("TEPPCO") is submitting the enclosed Discharge Plan Application (Attachment 1) for its TEPPCO Cedar Hill Compressor Station in San Juan County, New Mexico. Enclosed with the discharge plan renewal is TEPPCO Check No. **0200441645** (Attachment 4) in the amount of **\$100.00** for the application filing fee. The permit fee in the amount of \$1,700 will be paid once the application is approved.

As mentioned in previous permit renewal applications submitted by the former operator, Duke Energy Field Services ("DEFS"), TEPPCO does not believe that a discharge plan is required for this facility under the Water Quality Control Commission ("WQCC") regulations because there are no discharges from the TEPPCO Cedar Hill Compressor Station.

Notwithstanding the submittal of the enclosed permit fees and documents, TEPPCO does not waive its right to question or dispute the need and/or requirement for this permit at the referenced facility or other Val Verde facilities.

If you have any questions or require additional information, please contact Peter Cain at (713) 284-5213 or myself at (713) 803-8789.

Sincerely,

A handwritten signature in black ink, appearing to read "Deodat Bhagwandin".

Deodat Bhagwandin, P.E.
Manager, Environmental Management Systems

**TEPPCO NGL Pipelines, LLC
TEPPCO Cedar Hill Compressor Station
Groundwater Discharge Plan Renewal Application**

**Attachment 1
Discharge Plan Application**

September 7, 2006

District I
1625 N. French Dr., Hobbs, NM 88240
District II
1301 W. Grand Avenue, Artesia, NM 88210
District III
1000 Rio Brazos Road, Aztec, NM 87410
District IV
1220 S. St. Francis Dr., Santa Fe, NM 87505

State of New Mexico
Energy Minerals and Natural Resources
Oil Conservation Division
1220 South St. Francis Dr.
Santa Fe, NM 87505

Revised June 10, 2003
Submit Original
Plus 1 Copy
to Santa Fe
1 Copy to Appropriate
District Office

**DISCHARGE PLAN APPLICATION FOR SERVICE COMPANIES, GAS PLANTS,
REFINERIES, COMPRESSOR, GEOTHERMAL FACILITIES
AND CRUDE OIL PUMP STATIONS**

(Refer to the OCD Guidelines for assistance in completing the application)

☐ New ☒ Renewal ☐ Modification

1. Type: TEPPCO Cedar Hill Compressor Station
2. Operator: TEPPCO NGL Pipelines, LLC
Address: PO Box 2521, Houston, Texas 77252-2521
Contact Person: L. Kristine Aparicio Phone: 713-880-6550
3. Location: NW /4 SW /4 Section 32 Township 32N Range 10W
Submit large scale topographic map showing exact location.
4. Attach the name, telephone number and address of the landowner of the facility site.
5. Attach the description of the facility with a diagram indicating location of fences, pits, dikes and tanks on the facility.
6. Attach a description of all materials stored or used at the facility.
7. Attach a description of present sources of effluent and waste solids. Average quality and daily volume of waste water must be included.
8. Attach a description of current liquid and solid waste collection/treatment/disposal procedures.
9. Attach a description of proposed modifications to existing collection/treatment/disposal systems.
10. Attach a routine inspection and maintenance plan to ensure permit compliance.
11. Attach a contingency plan for reporting and clean-up of spills or releases.
12. Attach geological/hydrological information for the facility. Depth to and quality of ground water must be included.
13. Attach a facility closure plan, and other information as is necessary to demonstrate compliance with any other OCD rules, regulations and/or orders.

14. CERTIFICATION: I hereby certify that the information submitted with this application is true and correct to the best of my knowledge and belief.

Name: Deodat Bhagwandin, P.E.

Title: Manager, Environmental Management Systems

Signature: *Deodat Bhagwandin*

Date: 9/7/2006

E-mail Address: dpbhagwandin@teppco.com

Cedar Hill Compressor Station
SW/4 of Section 29, NW/4 of Section 32, Township 32N, Range 10W
San Juan County, New Mexico

GROUNDWATER DISCHARGE PLAN

This document constitutes a renewal application for the Groundwater Discharge Plan for the Cedar Hill Compressor Station in San Juan County, New Mexico. This Groundwater Discharge Plan has been prepared in accordance with the NMOCD "Guidelines for the Preparation of Discharge Plans at Natural Gas Plants, Refineries, Compressor and Crude Oil Pump Stations" (rev. 12-95) and the New Mexico Water Quality Control Commission ("WQCC") regulations, 20.6.2.3-104 and 3-106 NMAC.

1 Type of Operation

The facility does not intend or have a discharge or discharges that may move directly or indirectly into groundwater.

2 Operator / Legally Responsible Party

Operator

TEPPCO NGL Pipelines, LLC
PO Box 2521
Houston, Texas 77252-2521
(713) 759-3636
Contact Person: L. Kristine Aparicio

Owner

Val Verde Gas Gathering Company, LP
PO Box 2521
Houston, Texas 77252-2521

3 Facility Location

SW/4 of Section 29, NW/4 of Section 32, Township 32N, Range 10W

4 Landowner

TEPPCO NGL Pipelines, LLC
PO Box 2521
Houston, Texas 77252-2521

5 Facility Description

The facility provides natural gas compression for the gathering system.

6 Materials Stored or Used

There are no materials stored on-site or used that are discharged on site so that they may move directly or indirectly into groundwater.

7 Sources and Quantities of Effluent and Waste Solids

There are no effluents or waste solids that are discharged on-site or off-site at the TEPPCO Cedar Hill Compressor Station. All effluent and waste solids generated at the facility are removed from the facility for off-site disposal in accordance with applicable NMOCD, New Mexico Environmental Department ("NMED"), and EPA regulations as stated in previous groundwater discharge plans.

Separators/Scrubbers

Effluents or waste solids generated from separators or scrubbers are not discharged on site so that they may move directly or indirectly into groundwater.

Boilers and Cooling Towers/Fans

There are no boilers or cooling towers/fans at the facility.

Process and Storage Equipment Wash Down

Effluent or waste solids generated from process and storage equipment wash down are not discharged on site so that they may move directly or indirectly into groundwater.

Solvents/Degreasers

Solvent or degreasers are not discharged on site so that they may move directly or indirectly into groundwater.

Spent Acids/Caustics

If generated, spent acids or caustics are not discharged on site so that they may move directly or indirectly into groundwater.

Used Engine Coolants

Engine coolants are not discharged on site so that they move directly or indirectly into groundwater.

Waste Lubrication and Motor Oils

Lubricating and motor oils are not discharged on site so that they may move directly or indirectly into groundwater.

Used Oil Filters

Used oil filters are not discharged on site so that they may move directly or indirectly into groundwater.

Solids and Sludges

Solids and sludges are not discharged on site so that they may move directly or indirectly into groundwater

Painting Wastes

Painting wastes are not discharged on site so that they may move directly or indirectly into groundwater

Sewage

There are no restroom facilities at the facility. A portable toilet is kept on site.

Lab Wastes

Lab wastes are not generated at the facility.

Other Liquids and Solid Wastes

Other liquids and solid wastes are not discharged on site so that they may move directly or indirectly into groundwater.

8 Liquid and Solid Waste Collection / Storage / Disposal**Collection / Storage**

All liquid and solid wastes are collected and stored in closed containers for off-site disposal.

On-site Disposal

There are no on-site disposal activities at the facility

Off-site Disposal

All liquid and solid wastes are disposed off site.

9 Proposed Modifications

No modifications are proposed at this time.

10 Inspection, Maintenance, and Reporting

Routine inspections and maintenance are performed to ensure proper collection, storage, and off-site disposal of all wastes generated at the facility.

11 Spill / Leak Prevention and Reporting (Contingency Plans)

TEPPCO will respond to and report spills as outlined in the TEPPCO SPCC plan for TEPPCO Cedar Hill Compressor Station and in accordance with the requirements of NMOCD Rule 116 (19.15.C.116) and WQCC regulation (20.6.2.1203 NMAC)

12 Site characteristics

Geological/hydrological information for this facility has not changed since the previous renewal application.

Hydrologic Features

There are no known domestic water supplies or surface water bodies within one mile of Cedar Hill Compressor Station. The Animas River is approximately 1.5 miles south of the site.

No domestic water wells are located within $\frac{1}{4}$ mile of the facility.

Based on a review of the topographic map for the area, groundwater flow direction is likely to be to the northwest.

Geologic Description

The aquifer most likely to be affected by a discharge in this area is the San Jose formation of Eocene age. A poorly graded clean to slightly silty sand and lean clay was found as the predominant soil type. These two soil types are found from the ground surface to the top of the sandstone bedrock which ranges from 2.5 feet to 4.5 feet below the ground surface. Sandstone found in the soil borings was classified as moderately hard to hard and slightly weathered.

TEPPCO Cedar Hill Compressor Station lies more than 250 feet above the Animas River, therefore special flood protection measures are not needed.

13 Additional Information

Any unauthorized releases or discharge will be reported to the NMOCD in accordance with NMOCD Rule 116, 19.15.C.116 NMAC, and WQCC regulation, 20.6.2.1203.

**TEPPCO NGL Pipelines, LLC
TEPPCO Cedar Hill Compressor Station
Groundwater Discharge Plan Renewal Application**

**Attachment 2
Site Location Map
USGS Topographic Map
Cedar Hill, NM Quad**

September 7, 2006

6.3 Site Location





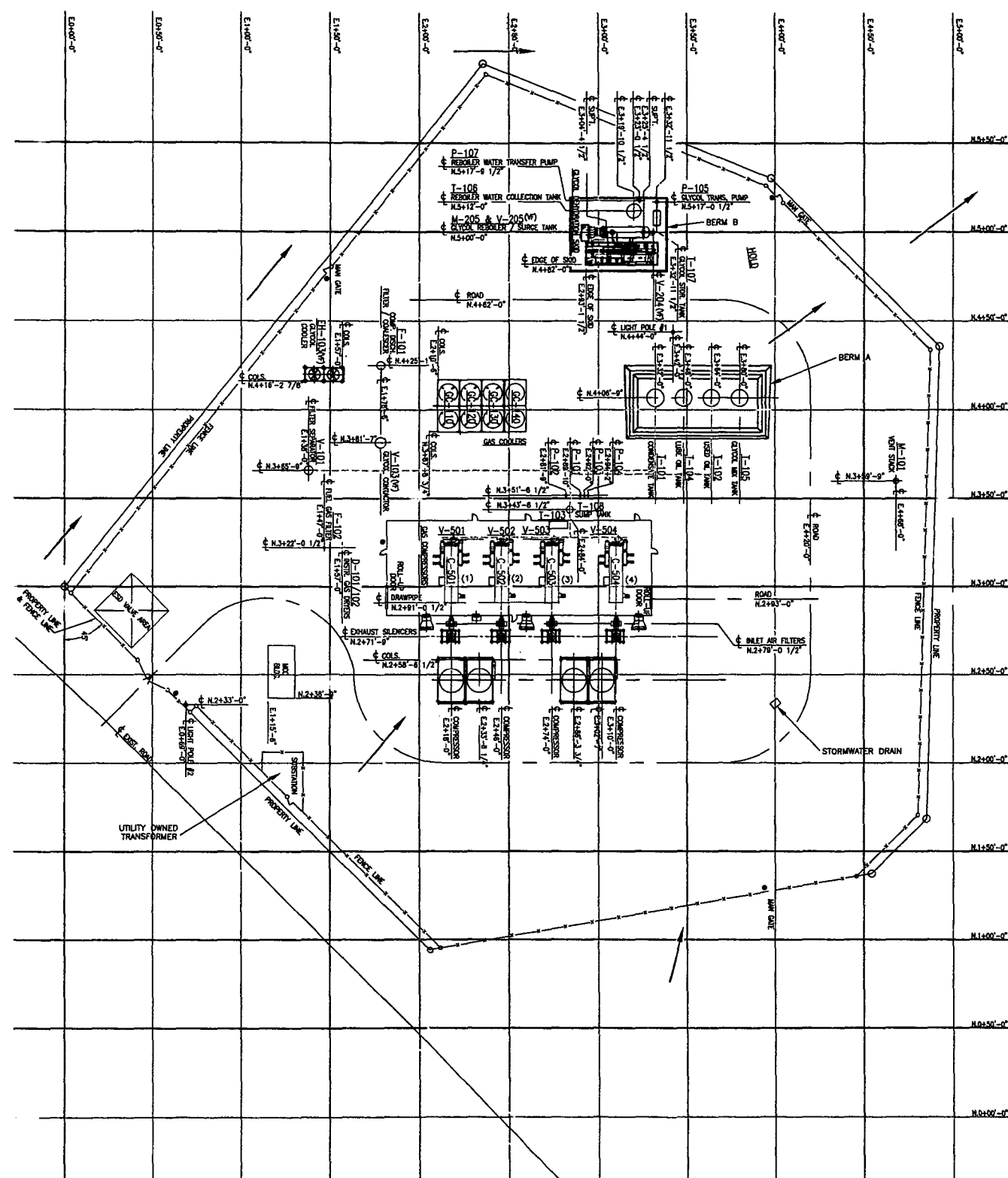

**TEPPCO NGL Pipelines, LLC
TEPPCO Cedar Hill Compressor Station
Groundwater Discharge Plan Renewal Application**

**Attachment 3
Facility Plot Plan**

September 7, 2006



LEGEND:

- | | |
|---|----------------------------------|
|  | FENCE |
|  | APPROXIMATE PROPERTY BOUNDARY |
|  | OIL CONTAINING PIPE |
|  | SURFACE WATER DRAINAGE DIRECTION |
|  | SECONDARY CONTAINMENT BERM |



Oil Storage Containers

AMS Name	Field Name	Contents Description	Capacity
T-101	T-101	Produced Water	210 bbl
T-104	T-104	Lube Oil	100 bbl
T-102	T-102	Used Oil	100 bbl
T-106	T-106	Dehy Drip	64 bbl
T-103	T-103	Lube Oil	2 bbl

Process Equipment Containing Oils

AMS Name	Field Name	Contents Description	Capacity
T-108	T-108 Sump	Used Oil, Wastewater	750 gal
V-101	V-101 Inlet Filter Separator	Produced Water	1600 gal

Oil Containing Equipment

AMS Name	Field Name	Contents Description	Capacity
C-1	Compressor 1	Lube Oil	80 gal
1	Engine 1	Lube Oil	220 gal
C-2	Compressor 2	Lube Oil	80 gal
2	Engine 2	Lube Oil	220 gal
C-3	Compressor 3	Lube Oil	80 gal
3	Engine 3	Lube Oil	220 gal
C-4	Compressor 4	Lube Oil	80 gal
4	Engine 4	Lube Oil	220 gal

Non-Oil Storage Containers

AMS Name	Field Name	Contents Description
T-105	T-105	Glycol
T-107	T-107	Glycol

NOT TO SCALE

Note: This drawing is based on a field sketch and depicts the location and contents of each oil containing container, equipment, and piping (as required by 40 CFR 112.7(3)). This drawing should only be used for Spill Prevention Control and Countermeasure Plan(SPPC) purposes. As drawing is not to scale, actual containers, equipment, or piping may vary in size and position from those represented here.

SPCC PLOT PLAN

CEDAR HILL COMPRESSOR STATION VAL VERDE GATHERING SYSTEM

**San Juan County
NEW MEXICO**

DWG. NAME: Cedar Hill Compressor Station_SPCC_Plan.dwg

[illegible]

**TEPPCO NGL Pipelines, LLC
TEPPCO Cedar Hill Compressor Station
Groundwater Discharge Plan Renewal Application**

**Attachment 4
TEPPCO Check No 0200441645**

September 7, 2006

ATTACHMENT TO THE DISCHARGE PLAN GW-258 APPROVAL
Burlington Resources, Cedar Hill Compressor Station
DISCHARGE PLAN APPROVAL CONDITIONS
October 25, 2001

1. Payment of Discharge Plan Fees: The \$100.00 filing fee has been received by the OCD. There is a required flat fee of \$ 1700.00 for natural gas compressor stations with horsepower ratings above 1000 horsepower. The fee may be paid in a single payment due at the time of approval, or in equal annual installments over the duration of the discharge plan, with the first payment due upon receipt of this approval.
2. Commitments: Burlington Resources will abide by all commitments submitted in the discharge plan renewal application dated July 26, 2001 including attachments, and these conditions for approval.
3. Drum Storage: All drums containing materials other than fresh water must be stored on an impermeable pad with curbing. All empty drums should be stored on their sides with the bungs in place and lined up on a horizontal plane. Chemicals in other containers such as sacks or buckets must also be stored on an impermeable pad with curbing.
4. Process Areas: All process and maintenance areas which show evidence that leaks and spills are reaching the ground surface must be either paved and curbed or have some type of spill collection device incorporated into the design.
5. Above Ground Tanks: All above ground tanks which contain fluids other than fresh water must be bermed to contain a volume of one-third more than the total volume of the largest tank or of all interconnected tanks. All new facilities or modifications to existing facilities must place the tank on an impermeable type pad within the berm.
6. Above Ground Saddle Tanks: Above ground saddle tanks must have impermeable pad and curb type containment unless they contain fresh water or fluids that are gases at atmospheric temperature and pressure.
7. Labeling: All tanks, drums, and other containers should be clearly labeled to identify their contents and other emergency information necessary if the tank were to rupture, spill, or ignite.

8. Below Grade Tanks/Sumps: All below grade tanks, sumps, and pits must be approved by the OCD prior to installation or upon modification and must incorporate secondary containment and leak-detection into the design. All pre-existing sumps and below-grade tanks must be tested to demonstrate their mechanical integrity no later than December 15, 2001 and every year from tested date, thereafter. Permittees may propose various methods for testing such as pressure testing to 3 pounds per square inch above normal operating pressure and/or visual inspection of cleaned out tanks and/or sumps, or other OCD approved methods. The OCD will be notified at least 72 hours prior to all testing. The test results will be submitted to OCD annually by December 31 of each year.
9. * Underground Process/Wastewater Lines: All underground process/wastewater pipelines must be tested to demonstrate their mechanical integrity no later than December 15, 2001 and every 5 years, from tested date, thereafter. Permittees may propose various methods for testing such as pressure testing to 3 pounds per square inch above normal operating pressure or other means acceptable to the OCD. The OCD will be notified at least 72 hours prior to all testing. The test results will be submitted to OCD by December 31, 2001.
10. Class V Wells: No Class V wells that inject non-hazardous industrial wastes or a mixture of industrial wastes and domestic wastes will be approved for construction and/or operation unless it can be demonstrated that groundwater will not be impacted in the reasonably foreseeable future. Leach fields and other wastewater disposal systems at OCD regulated facilities which inject non-hazardous fluid into or above an underground source of drinking water are considered Class V injection wells under the EPA UIC program. Class V wells that inject domestic waste only must be permitted by the New Mexico Environment Department.
11. Housekeeping: All systems designed for spill collection/prevention, and leak detection will be inspected daily to ensure proper operation and to prevent over topping or system failure. All spill collection and/or secondary containment devices will be emptied of fluids within 48 hours of discovery. A record of inspection will be retained on site for a period of five years.
12. Spill Reporting: All spills/releases shall be reported pursuant to OCD Rule 116. and WQCC 1203. to the OCD Aztec District Office.

* Process lines do not include gas supply lines.

13. Waste Disposal: All wastes will be disposed of at an OCD approved facility. Only oilfield exempt wastes shall be disposed of down Class II injection wells. Non-exempt oilfield wastes that are non-hazardous may be disposed of at an OCD approved facility upon proper waste determination per 40 CFR Part 261. Any waste stream that is not listed in the discharge plan will be approved by OCD on a case-by-case basis.

Rule 712 Waste: Pursuant to Rule 712, disposal of certain non-domestic waste is allowed at solid waste facilities permitted by the New Mexico Environment Department as long as the waste stream is identified in the discharge plan, and existing process knowledge of the waste stream does not change without notification to the Oil Conservation Division. The following waste is hereby approved:

1. TEG, OIL and Coalecer Filters as listed in Section VIII B. of the discharge plan.
2. Solid Waste (Trash/Refuse).

14. OCD Inspections: Additional requirements may be placed on the facility based upon results from OCD inspections.

15. Storm Water Plan: Burlington Resources shall maintain stormwater runoff controls as submitted in the discharge plan item IX. B. "Precipitation/Stormwater Runoff Control." As a result of Burlington's operations if any water contaminant that exceeds the WQCC standards listed in 20 NMAC 6.2.3101 is discharged in any stormwater run-off then Burlington shall notify the OCD within 24 hours, modify the plan within 15 days and submit for OCD approval. Burlington shall also take immediate corrective actions pursuant to Item 12 of these conditions.

16. Transfer of Discharge Plan: The OCD will be notified prior to any transfer of ownership, control, or possession of a facility with an approved discharge plan. A written commitment to comply with the terms and conditions of the previously approved discharge plan must be submitted by the purchaser and approved by the OCD prior to transfer.

17. Closure: The OCD will be notified when operations of the facility are discontinued for a period in excess of six months. Prior to closure of the facility a closure plan will be submitted for approval by the Director. Closure and waste disposal will be in accordance with the statutes, rules and regulations in effect at the time of closure.

18. Certification: **Burlington Resources** by the officer whose signature appears below, accepts this permit and agrees to comply with all terms and conditions contained herein.
Burlington Resources further acknowledges that these conditions and requirements of this permit may be changed administratively by the Division for good cause shown as necessary to protect fresh water, human health and the environment.

Conditions accepted by: **Burlington Resources** Gathering Inc.

John F. Zent
Company Representative- print name

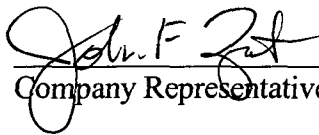
 Date 11/16/01
Company Representative- Sign

Title Attorney in fact

October 24, 2001

Sent Email

Mr. Wayne Price
Environmental Bureau
New Mexico Oil Conservation Division
2040 S. Pacheco
Santa Fe, New Mexico 87505

RECEIVED
OCT 24 2001
Environmental Bureau
Oil Conservation Division

**Re: Addendum Discharge Plan (GW258)
Cedar Hill Compressor Station**

Dear Mr. Price:

Burlington Resources Inc. is providing your department with two copies of an addendum to the Discharge Plan for the Cedar Hill Compressor Station (GW 258). This addendum addresses the recent OCD Rule 712 promulgation.

A revision to Section VIII, EFFLUENT AND SOLIDS DISPOSAL, Part B Offsite Disposal, Page 5 was added to clarify the Rule 712 waste classification. In addition, an attachment was added providing waste profile information and a copy of the Generators Waste Profile Sheet renewed by Waste Management Inc., San Juan County Regional Landfill 10/23/01.

Addendum Directions: Remove page five and replace with new page five. Add Attachment A, Waste Analysis and San Jaun County Landfill Profile Approval

Please note in the distribution, one copy of this Addendum has been sent to Denny Foust at the NMOCD office in Aztec, New Mexico.

If you have any questions concerning this proposed discharge plan, please contact me at 326-9537.

Sincerely,

Gregg Wurtz
Sr. Environmental Representative

Attachments: Addendum pages to Discharge Plan (2 Copies)

cc: Denny Foust - NMOCD Aztec Office (one copy)
File – Cedar Hill Compressor Station: Discharge Plan\Correspondence

B. Off-Site Disposal

The following table provides information about off-site waste disposal:

Waste Stream	Shipment Method	Shipping Agent	Final Disposition	Receiving Facility	OCD Rule Waste Approval
Produced Water	Truck	<i>See Note 1</i>	Class II Well	<i>See Note 2</i>	None Required
TEG Filters Oil Filters Coalecer Filters	Truck	Waste Management County Rd 3100 Aztec, NM (Ref. Note #3)	Filters are landfilled	Waste Management County Rd 3100 Aztec, NM (Ref. Note 3)	Rule 712 D. (2) Waste Profile (Ref. Note 3)
Antifreeze Spent Glycol	Truck	Coastal Chemical	Recycled	Coastal Chemical Co. 10 Road 5911 Farmington, NM	None Required
Used Oil	Truck	<i>See Note 1</i>	Recycled	Safety Kleen Corp. 4210 Hawkins Rd. Farmington, NM	None Required
Impacted Soil	Truck	Tierra Landfarm	Landfarmed	Tierra Environmental Sec 2, T29N, R12W San Juan Co., NM. Farmington, NM	Rule 711 Permit NM-01-0010 Cert. of Waste provided to OCD prior to disposal
Solid Waste (Trash/Refuse)	Truck	Waste Management	Landfill	Waste Management County Rd 3100 Aztec, NM	Rule 712 D. (1)

Note 1: The trucking agent contracted to ship effluents off-site will be one of the following:

Dawn Trucking Co.
318 Hwy. 64
Farmington, New Mexico.

Key Trucking
708 S. Tucker Ave.
Farmington, New Mexico

Safety-Kleen
4210 A Hawkins Rd
Farmington, NM

Note 2: The off-site Disposal Facility will be one of the following:

McGrath SWD #4
Sec. 34, T-30-N, R-12-W
San Juan County
New Mexico

Basin Disposal
Sec. 3, T-29-N, R-11-W
6 County Rd 5046
Bloomfield, New Mexico

Key Disposal
Sec. 2, T-29-N, R-12-W
323 County Rd. 3500
Farmington, New Mexico

Note 3: *Landfill* approval for disposal of the shipped wastes to landfill:

Waste Management
C/R 3100 Aztec, NM

Waste Profile # CD 1496 Waste
Waste Profile data (Attachment A)

IX. INSPECTION, MAINTENANCE AND REPORTING

A. Leak Detection/Site Visits

The sump incorporates NMOCD required secondary containment and leak detection systems. In addition, the sump is equipped with an inspection port between the primary and secondary walls to allow for visual inspection of the leak detection system.

ATTACHMENT A

WASTE ANALYSIS AND

**SAN JAUN COUNTY LANDFILL PROFILE
APPROVAL**

SEE EW-239

District I
1625 N. French Dr., Hobbs, NM 88240
District II
1301 W. Grand Avenue, Artesia, NM 88210
District III
1000 Rio Brazos Road, Aztec, NM 87410
District IV
1220 S. St. Francis Dr., Santa Fe, NM 87505

State of New Mexico
Energy Minerals and Natural Resources

Oil Conservation Division
1220 South St. Francis Dr.
Santa Fe, NM 87505

Revised January 24, 2001

Submit Original
Plus 1 Copy
to Santa Fe
1 Copy to Appropriate
District Office

**DISCHARGE PLAN APPLICATION FOR SERVICE COMPANIES, GAS PLANTS,
REFINERIES, COMPRESSOR, GEOTHERMAL FACILITIES
AND CRUDE OIL PUMP STATIONS**

(Refer to the OCD Guidelines for assistance in completing the application)

☐ New ☒ Renewal ☐ Modification

RECEIVED
JUL 27 2001
Environmental Bureau
Oil Conservation Division

1. Type: Cedar Hill Natural Gas Compressor Station (GW258)
2. Operator: Burlington Resources Inc.
Address: P.O. Box 4289 Farmington NM 87499-4289
Contact Person: Gregg Wurtz Phone: (505) 326-9537
3. Location: SW /4 SW /4 Section 29 Township 32N Range 10W
Submit large scale topographic map showing exact location.
4. Attach the name, telephone number and address of the landowner of the facility site.
5. Attach the description of the facility with a diagram indicating location of fences, pits, dikes and tanks on the facility.
6. Attach a description of all materials stored or used at the facility.
7. Attach a description of present sources of effluent and waste solids. Average quality and daily volume of waste water must be included.
8. Attach a description of current liquid and solid waste collection/treatment/disposal procedures.
9. Attach a description of proposed modifications to existing collection/treatment/disposal systems.
10. Attach a routine inspection and maintenance plan to ensure permit compliance.
11. Attach a contingency plan for reporting and clean-up of spills or releases.
12. Attach geological/hydrological information for the facility. Depth to and quality of ground water must be included.
13. Attach a facility closure plan, and other information as is necessary to demonstrate compliance with any other OCD rules, regulations and/or orders.
14. CERTIFICATION I hereby certify that the information submitted with this application is true and correct to the best of my knowledge and belief.

Name: Gregg Wurtz

Title: SR. Environmental Representative

Signature: 

Date: 7/26/01

Mr. Craig Bock
Burlington Resources
GW-258
Page 3
September 30, 1996

RECEIVED

DEC 1 0 1996

Environmental Bureau
Oil Conservation Division

ATTACHMENT TO DISCHARGE PLAN GW-258
Burlington Resources - Cedar Hill Compressor Station
DISCHARGE PLAN REQUIREMENTS
(September 30, 1996)

1. **Payment of Discharge Plan Fees:** The \$50 filing fee has been received by the OCD. The \$1,380 flat fee has not been received by the OCD and is due upon receipt of this approval. The flat fee may be paid in one lump sum or in five equal annual installments of \$ 276 over the term of the permit with the first payment due upon receipt of this approval.

2. **Burlington Resources Commitments:** Burlington Resources will abide by all commitments submitted in the application dated July 25, 1996, from Burlington Resources and the letter from OCD dated August 15, 1996, and this approval letter with conditions of approval from OCD dated September 30, 1996.

3. **Drum Storage:** All drums containing materials other than fresh water must be stored on an impermeable pad and curb type containment. All empty drums should be stored on their sides with the bungs in place and lined up on a horizontal plane. Chemicals in other containers such as sacks or buckets should also be stored on an impermeable pad and curb type containment.

All drums and chemical containers shall be clearly labeled to identify their contents and other emergency information necessary if they were to rupture, spill, or ignite.

4. **Process Areas:** All process and maintenance areas which show evidence that leaks and spills are reaching the ground surface must be either paved and curbed or have some type of spill collection device incorporated into the design.

5. **Above Ground Tanks:** All above ground tanks which contain fluids other than fresh water must be bermed to contain a volume of one-third more than the total volume of the largest tank or of all interconnected tanks. All new facilities or modifications to existing facilities must place the tank on an impermeable type pad.

6. **Above Ground Saddle Tanks:** Above ground saddle tanks must have impermeable pad and curb type containment unless they contain fresh water or fluids that are gases at atmospheric temperature and pressure.

7. **Tank Labeling:** All tanks should be clearly labeled to identify their contents and other emergency information necessary if the tank were to rupture, spill, or ignite.

8. **Below Grade Tanks/Sumps:** All below grade tanks, sumps, and pits must be approved by the OCD prior to installation or upon modification and must incorporate secondary containment and leak-detection into the design. All pre-existing sumps and below-grade tanks that do not have secondary containment and leak detection must demonstrate integrity on an annual basis. Integrity tests include pressure testing to 3 pounds per square inch above normal operating pressure and/or visual inspection of cleaned out tanks /or sumps.

Mr. Craig Bock
Burlington Resources
GW-258
Page 4
September 30, 1996

DEC 10 1996

Environmental Bureau
Oil Conservation Division

9. **Underground Process/Wastewater Lines:** All underground process/wastewater pipelines must be tested to demonstrate their mechanical integrity at present and then every 5 years there after. Companies may propose various methods for testing such as pressure testing to 3 pounds per square inch above normal operating pressure or other means acceptable to the OCD. The OCD will be notified at least 72 hours prior to all testing so that an OCD representative may witness the testing.

10. **Housekeeping:** All systems designed for spill collection/prevention should be inspected to ensure proper operation and to prevent overtopping or system failure.

Any soils contaminated with a non-exempt waste at the facility will be tested for hazardous constituents, and after receiving OCD approval, will be disposed of at an OCD approved site

11. **Spill Reporting:** All spills/releases shall be reported pursuant to OCD Rule 116 and WQCC 1203 to the Aztec OCD District Office at (505)-334-6178.

12. **Transfer of Discharge Plan:** The OCD will be notified prior to any transfer of ownership, control, or possession of a facility with an approved discharge plan. A written commitment to comply with the terms and conditions of the previously approved discharge plan must be submitted by the purchaser and approved by the OCD prior to transfer.

13. **Closure:** The OCD will be notified when operations of the facility are discontinued for a period in excess of six months. Prior to closure of the facility a closure plan will be submitted for approval by the director. Closure and waste disposal will be in accordance with the statutes, rules and regulations in effect at the time of closure.

14. **Certification:** Burlington Resources, by the officer whose signature appears below, accepts this permit and agrees to comply with all terms and conditions contained herein. Burlington Resources, further acknowledges that these conditions and requirements of this permit may be changed administratively by the Division for good cause shown as necessary to protect groundwater, human health and the environment.

Accepted:

Burlington Resources

by

B. Voile 12/4/96
Title Pipe line foreman



NEW MEXICO ENERGY, MINERALS
& NATURAL RESOURCES DEPARTMENT

OIL CONSERVATION DIVISION
2040 South Pacheco Street
Santa Fe, New Mexico 87505
(505) 827-7131

October 15, 1996

CERTIFIED MAIL

RETURN RECEIPT NO. P-288-258-669

Mr. Craig Bock
Burlington Resources
P.O. Box 4289
Farmington, NM 87499-4289

**RE: Discharge Plan GW-239, GW-255,
and GW-258
Permit Condition Clarification**

Dear Mr. Bock:

Pursuant to the phone conversation between yourself, Mr. Roger Anderson of the OCD, and myself today October 15, 1996 at 11:55 AM the permit Condition under "Housekeeping" has been amended per the concerns that you expressed in the conversation. Two copies of each amended page 4 for GW-239, GW-255, and GW-258 have been enclosed for signature. Please sign and return a copy to the OCD Santa Fe Division Office within 5 working days of receipt of this letter.

The condition originally read: "Any contaminated soils that are collected at the facility will be tested for hazardous constituents, and after receiving OCD approval, will be disposed of at an OCD approved site."

The condition now reads: "Any soils contaminated with a non-exempt waste at the facility will be tested for hazardous constituents, and after receiving OCD approval, will be disposed of at an OCD approved site."

The OCD hopes that this has clarified your concern, and we appreciate your input into this process.

Sincerely,

Patricio W. Sanchez
Petroleum Engineering Specialist

xc: Mr. Denny Foust - Aztec OCD District Office

Enclosed - Amended page 4 (2 Copies/one Back To OCD Santa Fe) for GW-239, GW-255, and GW-258.



STATE OF NEW MEXICO
ENERGY, MINERALS AND NATURAL RESOURCES DEPARTMENT

OIL CONSERVATION DIVISION
2040 S. PACHECO
SANTA FE, NEW MEXICO 87505
(505) 827-7131

September 30, 1996

CERTIFIED MAIL
RETURN RECEIPT NO. P-288-258-648

Mr. Craig Bock
Burlington Resources
P.O. Box 4289
Farmington, NM 87499-4289

**RE: Approval of Discharge Plan GW-258
Cedar Hill Compressor Station
San Juan County, New Mexico**

Dear Mr. Bock:

The discharge plan GW-258 for the Burlington Resources Cedar Hill Compressor Station located in the SW/4 SW/4, Section 29, Township 32 North, Range 10 West, NMPM, San Juan County, New Mexico, is hereby approved under the conditions contained in the enclosed attachment. The discharge plan consists of the application dated July 25, 1996, from Burlington Resources and the letter from OCD dated August 15, 1996, and this approval letter with conditions of approval from OCD dated September 30, 1996. Enclosed are two copies of the conditions of approval. **Please sign and return one copy to the New Mexico Oil Conservation Division (OCD) Santa Fe Office within five working days of receipt of this letter.**

The discharge plan application was submitted pursuant to Section 3106 of the New Mexico Water Quality Control Commission Regulations. Please note Sections 3109.E and 3109.F which provide for possible future amendments or modifications of the plan. Please be advised that the approval of this plan does not relieve **Burlington Resources** of liability should the operations associated with this facility result in pollution of surface water, ground water, or the environment.

Please be advised that all exposed pits, including lined pits and open top tanks (tanks exceeding 16 feet in diameter), shall be screened, netted, or otherwise rendered nonhazardous to wildlife including migratory birds.

Please note that Section 3104 of the regulations requires that "When a plan has been approved, discharges must be consistent with the terms and conditions of the plan." Pursuant to Section 3107.C Burlington Resources is required to notify the Director of any facility expansion, production increase, or process modification that would result in any change in the discharge of water quality or volume.

Mr. Craig Bock
Burlington Resources
GW-258
Page 2
September 30, 1996

Pursuant to Section 3109.G.4, this plan is for a period of five (5) years. **This approval will expire September 30, 2001, and an application for renewal should be submitted in ample time before that date.** It should be noted that all discharge plan facilities will be required to submit plans for, or the results of, an underground drainage testing program as a requirement for discharge plan approval.

The discharge plan for the Burlington Resources Cedar Hill Compressor Station GW-258 is subject to the WQCC Regulation 3114 discharge plan fee. Every billable facility submitting a discharge plan will be assessed a fee equal to the filing fee of fifty dollars (\$50) and a flat fee of one-thousand three-hundred and eighty dollars (\$ 1,380) for compressor stations over 3,000 horsepower.

The \$50 filing fee has been received by the OCD. The \$1,380 flat fee has not been received by the OCD and is due upon receipt of this approval. The flat fee may be paid in one lump sum or in five equal annual installments of \$ 276 over the term of the permit with the first payment due upon receipt of this approval.

On behalf of the staff of the Oil Conservation Division, I wish to thank you and your staff for your cooperation during this discharge plan review.

Sincerely,

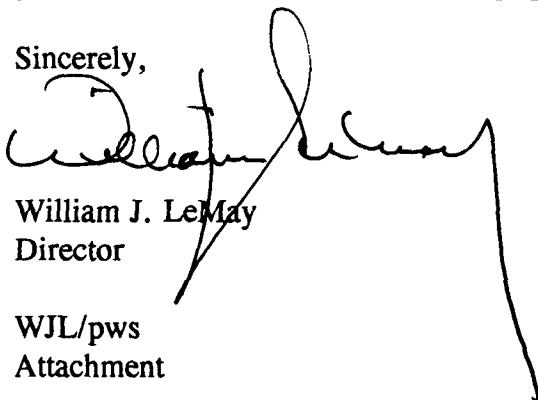

William J. LeMay
Director

WJL/pws
Attachment

xc: Mr. Denny Foust

P 288 258 648

US Postal Service

Receipt for Certified Mail

No Insurance Coverage Provided.

Do not use for International Mail (See reverse)

Sent to	
Bock - Burlington	
Street & Number	
GW-258	
Post Office, State, & ZIP Code	
Postage	\$
Certified Fee	
Special Delivery Fee	
Restricted Delivery Fee	
Return Receipt Showing to Whom & Date Delivered	
Return Receipt Showing to Whom, Date, & Addressee's Address	
TOTAL Postage & Fees	\$
Postmark or Date	

PS Form 3800, April 1995

Mr. Craig Bock
Burlington Resources
GW-258
Page 3
September 30, 1996

ATTACHMENT TO DISCHARGE PLAN GW-258
Burlington Resources - Cedar Hill Compressor Station
DISCHARGE PLAN REQUIREMENTS
(September 30, 1996)

1. **Payment of Discharge Plan Fees:** The \$50 filing fee has been received by the OCD. The \$1,380 flat fee has not been received by the OCD and is due upon receipt of this approval. The flat fee may be paid in one lump sum or in five equal annual installments of \$ 276 over the term of the permit with the first payment due upon receipt of this approval.
2. **Burlington Resources Commitments:** Burlington Resources will abide by all commitments submitted in the application dated July 25, 1996, from Burlington Resources and the letter from OCD dated August 15, 1996, and this approval letter with conditions of approval from OCD dated September 30, 1996.
3. **Drum Storage:** All drums containing materials other than fresh water must be stored on an impermeable pad and curb type containment. All empty drums should be stored on their sides with the bungs in place and lined up on a horizontal plane. Chemicals in other containers such as sacks or buckets should also be stored on an impermeable pad and curb type containment.

All drums and chemical containers shall be clearly labeled to identify their contents and other emergency information necessary if they were to rupture, spill, or ignite.
4. **Process Areas:** All process and maintenance areas which show evidence that leaks and spills are reaching the ground surface must be either paved and curbed or have some type of spill collection device incorporated into the design.
5. **Above Ground Tanks:** All above ground tanks which contain fluids other than fresh water must be bermed to contain a volume of one-third more than the total volume of the largest tank or of all interconnected tanks. All new facilities or modifications to existing facilities must place the tank on an impermeable type pad.
6. **Above Ground Saddle Tanks:** Above ground saddle tanks must have impermeable pad and curb type containment unless they contain fresh water or fluids that are gases at atmospheric temperature and pressure.
7. **Tank Labeling:** All tanks should be clearly labeled to identify their contents and other emergency information necessary if the tank were to rupture, spill, or ignite.
8. **Below Grade Tanks/Sumps:** All below grade tanks, sumps, and pits must be approved by the OCD prior to installation or upon modification and must incorporate secondary containment and leak-detection into the design. All pre-existing sumps and below-grade tanks that do not have secondary containment and leak detection must demonstrate integrity on an annual basis. Integrity tests include pressure testing to 3 pounds per square inch above normal operating pressure and/or visual inspection of cleaned out tanks /or sumps.

Mr. Craig Bock
Burlington Resources
GW-258
Page 4
September 30, 1996

9. **Underground Process/Wastewater Lines:** All underground process/wastewater pipelines must be tested to demonstrate their mechanical integrity at present and then every 5 years there after. Companies may propose various methods for testing such as pressure testing to 3 pounds per square inch above normal operating pressure or other means acceptable to the OCD. The OCD will be notified at least 72 hours prior to all testing so that an OCD representative may witness the testing.

10. **Housekeeping:** All systems designed for spill collection/prevention should be inspected to ensure proper operation and to prevent overtopping or system failure.

Any contaminated soils that are collected at the facility will be tested for hazardous constituents, and after receiving OCD approval, will be disposed of at an OCD approved site.

11. **Spill Reporting:** All spills/releases shall be reported pursuant to OCD Rule 116 and WQCC 1203 to the Aztec OCD District Office at (505)-334-6178.

12. **Transfer of Discharge Plan:** The OCD will be notified prior to any transfer of ownership, control, or possession of a facility with an approved discharge plan. A written commitment to comply with the terms and conditions of the previously approved discharge plan must be submitted by the purchaser and approved by the OCD prior to transfer.

13. **Closure:** The OCD will be notified when operations of the facility are discontinued for a period in excess of six months. Prior to closure of the facility a closure plan will be submitted for approval by the director. Closure and waste disposal will be in accordance with the statutes, rules and regulations in effect at the time of closure.

14. **Certification:** Burlington Resources, by the officer whose signature appears below, accepts this permit and agrees to comply with all terms and conditions contained herein. Burlington Resources, further acknowledges that these conditions and requirements of this permit may be changed administratively by the Division for good cause shown as necessary to protect groundwater, human health and the environment.

Accepted:

Burlington Resources

by _____
Title