

1R - 124

REPORTS

DATE:

4-12-2006



NEW MEXICO ENERGY, MINERALS and NATURAL RESOURCES DEPARTMENT

BILL RICHARDSON

Governor

Joanna Prukop

Cabinet Secretary

Mark E. Fesmire, P.E.

Director

Oil Conservation Division

April 12, 2006

Ms. Camille Reynolds
Plains All American
3112 West Highway 82
Lovington, NM 88260

RE: Soil Investigation Work Plan
Plains Marketing, L.P. Monument 18 Site
Plains Reference: TNM Monument-18
NW/4 NW/4 Section 7, Township 20 South, Range 37 East
Lea County, New Mexico
NMOCD File Number 1R-0124

Dear Ms. Reynolds:

The New Mexico Oil Conservation Division (NMOCD) has received and reviewed the above report, submitted, on behalf of Plains Pipeline, L.P. (Plains), by NOVA Safety and Environmental. This report is hereby accepted and approved with the following understandings and conditions:

1. Plains will install ten soil borings along the former TNM pipeline route to delineate hydrocarbon soil impact.
2. Plains will sample the soil at 5-foot intervals in each of the ten soil borings to a minimum total depth of 20 feet. If no evidence of hydrocarbon contamination is encountered in the 20-foot boring, the boring will be terminated at 20 feet.
3. Plains will submit select soil samples to a certified laboratory for the analysis of BTEX and TPH per the methods described in section 3.2 of the above report.
4. Plains will prepare a report documenting soil delineation findings and, if necessary, a work plan for addressing any further impact discovered.

NMOCD approval does not relieve Plains of liability should its operations at this site prove to have been harmful to public health or the environment. Nor does it relieve Plains of its responsibility to comply with the rules and regulations of any other governmental agency.

If you have any questions, contact me at (505) 476-3492 or ed.martin@state.nm.us

NEW MEXICO OIL CONSERVATION DIVISION

Edwin E. Martin
Environmental Bureau

Copy: NMOCD, Hobbs
Todd K. Choban, NOVA



**PLAINS
Marketing, L.P.**

February 27, 2006

Mr. Ed Martin
New Mexico Oil Conservation Division
Environmental Bureau
1220 South St. Francis Drive
Santa Fe, New Mexico 87505

Re: Plains Marketing, L.P. Soil Investigation Work Plan
Monument 18
Unit Letter D of Section 07, Township 20S, Range 37E
Lea County, New Mexico

Dear Mr. Martin:

Please find attached for your approval the Soil Investigation Work Plan, dated February 2006, for the Monument 18 release site located in Unit Letter D of Section 07 of Township 20 South, and Range 37 East of Lea County, New Mexico. The Work Plan details site activities to be conducted to complete soil delineation of the site.

Should you have any questions or comments, please contact me at (505) 441-0965.

Sincerely,

Camille Reynolds
Remediation Coordinator
Plains All American Pipeline

Enclosure

SOIL INVESTIGATION WORK PLAN

MONUMENT 18

LEA COUNTY, NEW MEXICO
NW ¼ NW ¼ SECTION 07, TOWNSHIP 20 SOUTH, RANGE 37 EAST
PLAINS EMS NUMBER: TNM MONUMENT-18
NMOCD REFERENCE 1R-0124

Prepared For:

PLAINS MARKETING, L.P.
333 CLAY STREET, SUITE 1600
HOUSTON, TEXAS 77002



Prepared By:

NOVA Safety and Environmental
2057 Commerce Street
Midland, Texas 79703

February 2006

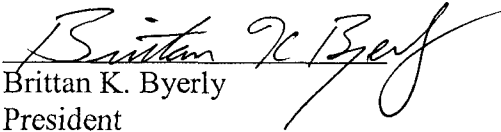
Brittan K. Byerly
President



Todd K. Choban
Vice-President Technical Services

TABLE OF CONTENTS

1.0	INTRODUCTION	1
2.0	SITE BACKGROUND.....	1
3.0	LEAK ZONE INVESTIGATION	
3.1	Review of Soil Data	1
3.2	Proposed Soil Investigation Activities	2
4.0	SUMMARY OF INTENDED ACTIVITIES	2
5.0	LIMITATIONS.....	3
6.0	DISTRIBUTION	4

FIGURES

- FIGURE 1: Site Location Map
- FIGURE 2: Site Map
- FIGURE 3: Inferred Groundwater Gradient Map
- FIGURE 4: Proposed Soil Boring Location Map

TABLES

- TABLE 1: Concentrations of BTEX and TPH in Soil
- TABLE 2: Groundwater Elevation and PSH Thickness Data
- TABLE 3: Concentrations of TPH & BTEX in Groundwater

APPENDICES

- APPENDIX A: Notification of Release and Corrective Action (Form C-141)

1.0 INTRODUCTION

On behalf of Plains Marketing, L.P., (Plains), NOVA Safety and Environmental (NOVA) is pleased to submit this Soil Investigation Work Plan for the site known as TNM Monument 18. The purpose of this Soil Investigation Work Plan is to summarize known soil data and propose a plan for the delineation of hydrocarbon impacted soil at the site. A Site Location Map is provided as Figure 1. The legal description of the site is the NW $\frac{1}{4}$ NW $\frac{1}{4}$ Section 07, Township 20 South, Range 37 East.

2.0 SITE BACKGROUND

No information with respect to the release date, volume of crude oil released and recovered, excavation dimensions or pipeline repair is available as this release occurred while the pipeline was operated by Texas New Mexico Pipeline Company (TNM). The initial site investigation, which consisted of the installation of eight (8) groundwater monitor wells (MW-1 through MW-8), was conducted by previous consultants. Monitor wells MW-9 and MW-10 were installed in November of 2004 to further delineate the groundwater plume and to gain information on vadose hydrocarbon concentrations to the east and west of the suspected release point. On September 13, 2005, monitor well MW-2 was plugged and abandoned with New Mexico Oil Conservation Division (NMOCD) approval granted on June 22, 2005. A total of nine (9) groundwater monitor wells (MW-1, and MW-3 through MW-10) are currently located on the site. A site map illustrating site details is provided as Figure 2.

3.0 LEAK ZONE INVESTIGATION

3.1 Review of Soil Data

No known information exists regarding the magnitude of the release, emergency response activities, pipeline repair, or initial remedial actions at the site, with the exception of the existence of eight monitor wells. There is no known soil data associated with the installation of monitor wells MW-1 through MW-8. Monitor wells MW-9 and MW-10, installed by NOVA in November of 2004, and were sampled for the presence of hydrocarbons in the vadose zone.

On November 4, 2004, two (2) monitor wells were installed in the side gradient directions of the hydrocarbon impacted groundwater zone to more fully delineate the extent of groundwater impact at the site. During installation of monitor well MW-9, soil samples were collected at ten (10) feet below ground surface (bgs), twenty (20) feet bgs and thirty (30) feet bgs. During the installation of monitor well MW-10, soil samples were collected at fifteen (15) feet and thirty (30) feet bgs. Analytical results of the soil samples indicate that no Benzene, Toluene, Ethyl-benzene, and total Xylene constituents (BTEX) exist above detection limits of the analytical method at the tested depth. Analysis of Gasoline Range Organics (GRO) and Diesel Range Organics (DRO) analytes also indicated no detectable hydrocarbons in the tested soil samples.

3.2 Proposed Soil Investigation Activities

Based upon the distribution of dissolved phase hydrocarbons in the groundwater, the site's groundwater gradient (Figure 3), surficially disturbed area where no mesquite trees have re-established, and the limited soil data available, ten (10) borings will be placed along the former TNM pipeline between the pipeline and Maddox Road. Based upon initial results of the ten (10) borings, additional borings may be installed if needed to delineate further hydrocarbon impact. Please refer to Figure 4 for proposed locations of the ten proposed soil boring locations.

Soil samples will be collected on five-foot intervals (upon refusal of the sampling device, samples will be collected at the next possible foot interval) to a total depth of each boring. Each boring will be drilled to a minimum depth of 20 feet. If no evidence of hydrocarbon impact is documented by utilizing either Photo-Ionization Detector (PID), visual or olfactory methods, the boring will be terminated at 20 feet. If impacted soil is documented in a soil sample by the methods listed above, the boring will be extended to the top of groundwater. An adequate number of borings will be advanced to delineate the horizontal and vertical area of existing hydrocarbon impacted soil at the site.

Select soil samples will be submitted to the laboratory based on field observations and PID readings. Samples will be collected and placed into glassware provided by Trace Analysis in Lubbock, Texas. The samples will then be placed on ice in the field to be cooled to approximately 4°C. Strict chain-of-custody documentation will be maintained at all times. Samples will be analyzed for BTEX utilizing EPA Method SW 846-8021b and for Total Petroleum Hydrocarbons (TPH) by SW846-8015 gas and diesel range organics.

4.0 SUMMARY OF INTENDED ACTIVITIES

Plains proposes the following actions intended to progress the site towards NMOCD approved closure:

- Install ten (10) soil borings along former TNM pipeline to locate (if existent) and delineate hydrocarbon soil impact.
- Submit select soil samples to laboratory analysis for documentation.
- Prepare a report documenting soil delineation findings, and a work plan for addressing any impact above NMOCD cleanup standards.

5.0 LIMITATIONS

NOVA has prepared this Soil Investigation Work Plan to the best of its ability. No other warranty, expressed or implied, is made or intended. NOVA has examined and relied upon documents referenced in the report and has relied on oral statements made by certain individuals. NOVA has not conducted an independent examination of the facts contained in referenced materials and statements. We have presumed the genuineness of the documents and that the information provided in documents or statements is true and accurate. NOVA has prepared this report in a professional manner, using the degree of skill and care exercised by similar environmental consultants. NOVA also notes that the facts and conditions referenced in this report may change over time and the conclusions and recommendations set forth herein are applicable only to the facts and conditions as described at the time of this report.

This report has been prepared for the benefit of Plains. The information contained in this report including all exhibits and attachments may not be used by any other party without the express written consent of NOVA and/or Plains.

6.0 DISTRIBUTION

- Copy 1 Ed Martin
New Mexico Energy, Minerals and Natural Resources Department
Oil Conservation Division
1220 South St. Francis Drive
Santa Fe, NM 87505
- Copy 2: Larry Johnson and Paul Sheeley
New Mexico Energy, Minerals and Natural Resources Department
Oil Conservation Division, District 1
1625 French Drive
Hobbs, NM 88240
- Copy 3: Camille Reynolds
Plains Marketing, L.P.
3112 Highway 82
Lovington, NM
cjreynolds@paalp.com
- Copy 4: Jeff Dann
Plains Marketing, L.P.
333 Clay Street
Suite 1600
Houston, TX 77002
jpdann@paalp.com
- Copy 5: NOVA Safety and Environmental
2057 Commerce Street
Midland, TX 79703
cstanley@novatraining.cc

Figures

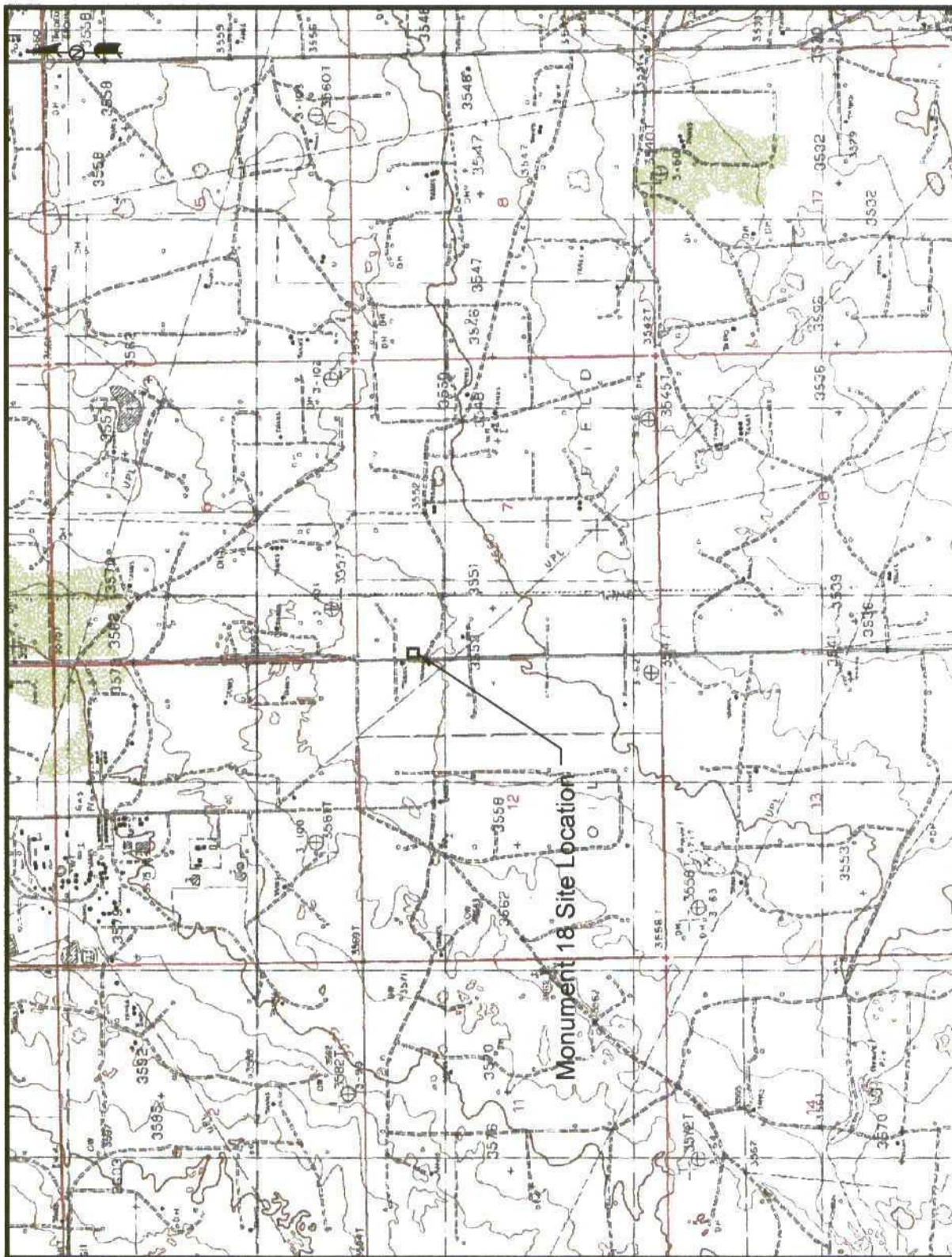

NW1/4 NW1/4 Sec 7 T20S R37E
NE1/4 NE1/4 Sec 12 T20S R36E



Figure 1
Site Location Map

Plains Marketing, L.P.
Monument 18
Lea County, NM

NOVA Safety and Environmental



Scale: 1" = 5 Miles
Prep By: CDS
February 28, 2005
Section 7 Township 20S Range 37E
Checked By: RHH
Lat 37° 35' 30.0"N Long 103° 17' 55.0"W



MW-7

MW-4

Former Tex-New Mex Pipeline

MW-3

MW-6

MW-8

MW-2
(P & A 09/05)

MW-1

MW-10

MW-5

MW-9

MADDOX ROAD

NOTE:
MW-2 Was Plugged and Abandoned September 2005
Per NMOCDA Approval



Distance in Feet

Legend:
(3525.84) Groundwater Elevation (In Feet)
Monitor Well Location

Figure 2
Site Map

Plains Marketing, L.P.
Monument 18
Lea County, NM

NOVA Safety and Environmental



Scale: 1" = 82'
March 10, 2006
Drawn By: DPM
Prepared By: COS

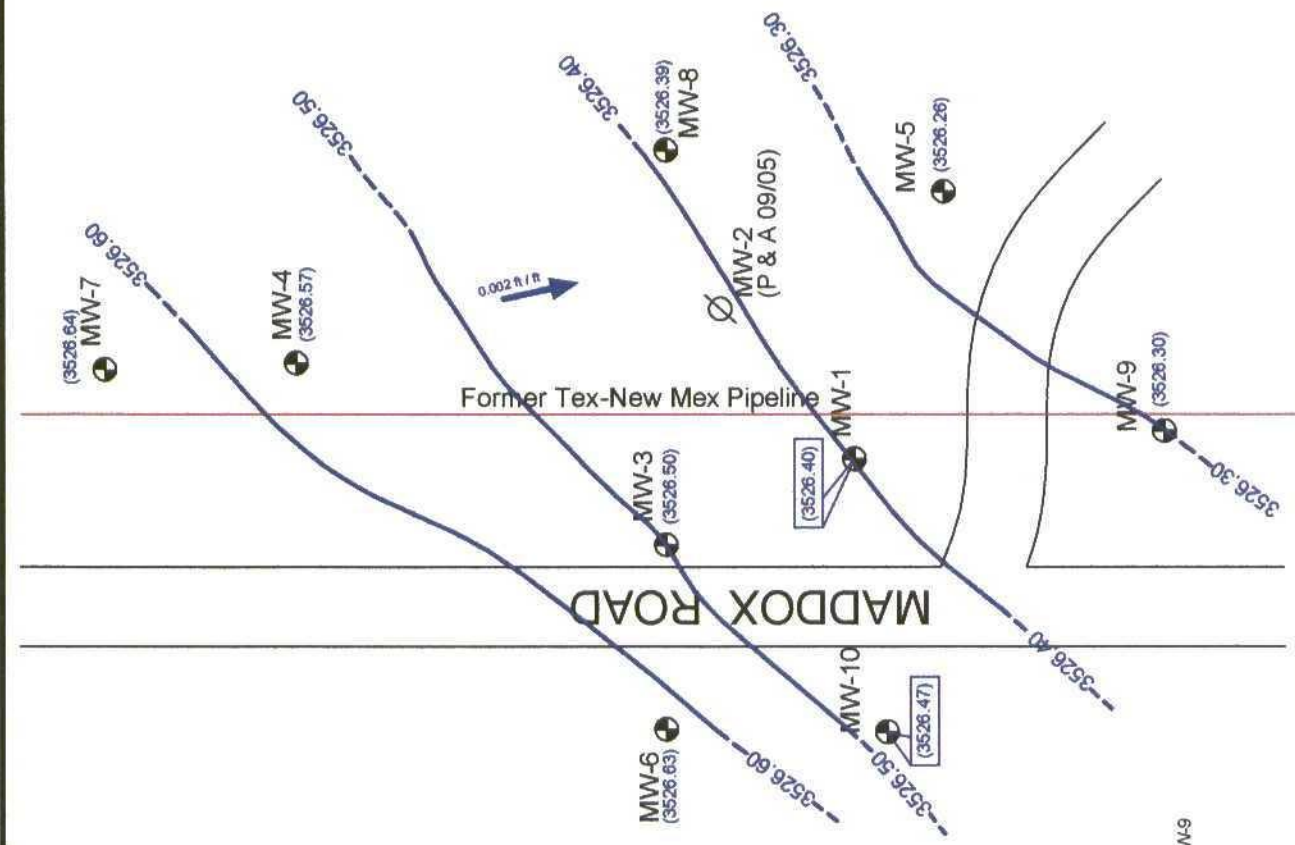

NOTE:
Contour Interval = 0.10'
Groundwater Gradient Measured Between MW-6 and MW-9



Legend:

- Monitor Well Location
- Well Plugged and Abandoned
- Pipeline
- Ground Water Contour Line
- (3526.05)
- Groundwater Elevation (feet)
- Groundwater Gradient Direction and Magnitude

Figure 3
Inferred Groundwater
Gradient Map
(12/19/05)
Plains Marketing, L.P.
Monument 18
Lea County, NM

NOVA Safety and Environmental

NOVA
SHELL INTERNATIONAL COMPANY LIMITED

Scale: 1" = 80'
Drawn By: DPM
Prepared By: CDS
January 25, 2008

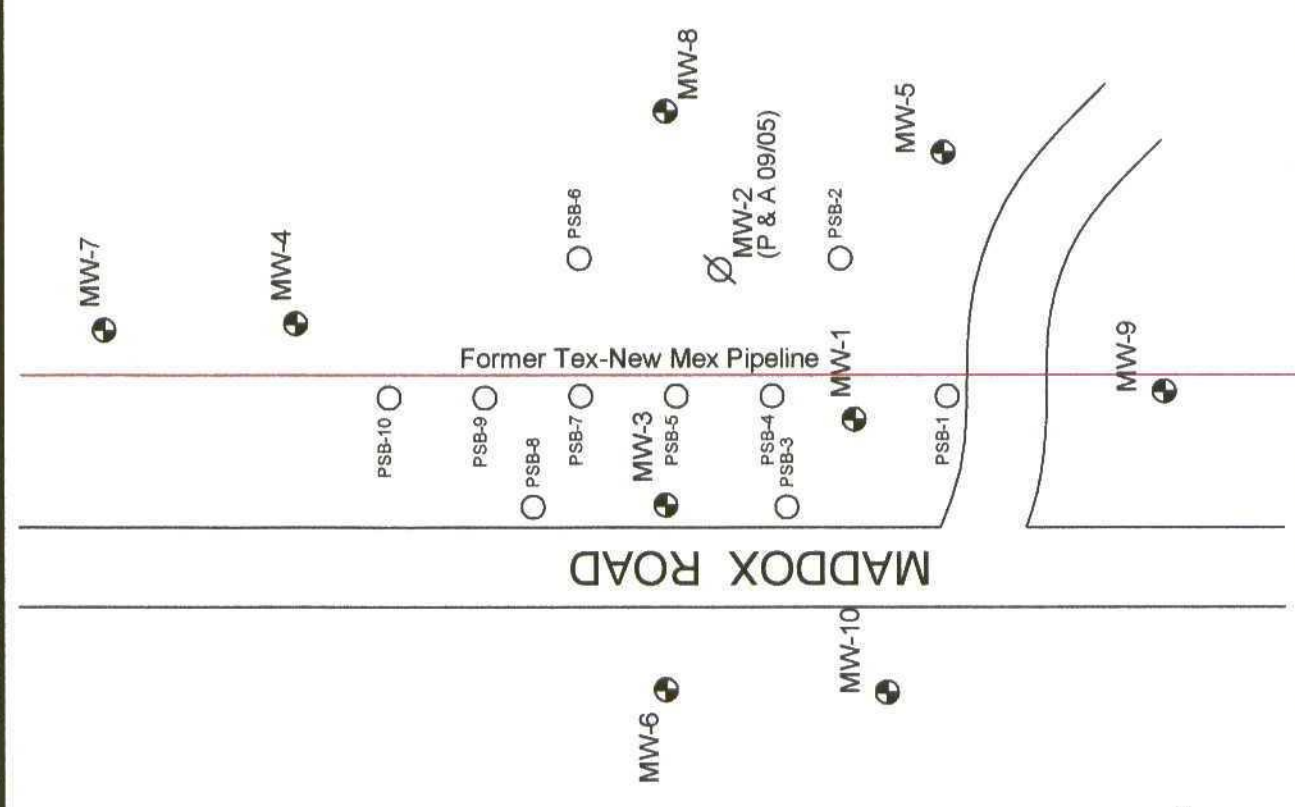

NOTE:
MW-2 Was Plugged and Abandoned September 2005
Per NMOCD Approval



- Legend:**
- Groundwater Elevation (in Feet)
 - Monitor Well Location
 - Proposed Monitor Well Location

Figure 4
Proposed Soil Boring
Location Map
Plains Marketing, L.P.
Monument 18
Lea County, NM

NOVA Safety and Environmental



NOVA
Safety and Environmental

Scale: 1" = 60'	Drawn By: DPM	Prepared By: COS
February 2, 2006		

Tables

TABLE 1
CONCENTRATIONS OF TPH AND BTEX IN SOIL

MONUMENT #18
PLAINS MARKETING, L.P.
LEA COUNTY, NM

SAMPLE LOCATION	SAMPLE DATE	SAMPLE DEPTH (feet)	Methods: EPA SW 846-8021B, 5030				Methods: EPA SW 846-8015M GRO/DRO	
			BENZENE (mg/Kg)	TOLUENE (mg/Kg)	ETHYL- BENZENE (mg/Kg)	m,p,o- XYLENE (mg/Kg)	GRO C ⁶ -C ¹⁰ (mg/kg)	DRO >C ¹⁰ -C ²⁵ (mg/kg)
MW-9	11/04/04	10'	<0.001	<0.001	<0.001	<0.001	<1	<50
MW-9	11/04/04	20'	<0.001	<0.001	<0.001	<0.001	<1	<50
MW-9	11/04/04	30'	<0.001	<0.001	<0.001	<0.001	<1	<50
MW-10	11/04/04	15'	<0.001	<0.001	<0.001	<0.001	<1	<50
MW-10	11/04/04	30'	<0.001	<0.001	<0.001	<0.001	<1	<50

TABLE 2
GROUNDWATER ELEVATION AND PSH THICKNESS DATA

PLAINS MAREKTING, L.P.
MONUMENT 18
LEA COUNTY, NEW MEXICO

SAMPLE LOCATION	SAMPLE DATE	TOP OF CASING ELEVATION	DEPTH TO PRODUCT	DEPTH TO WATER	PSH THICKNESS	CORRECTED GROUND WATER ELEVATION
MW - 1	01/24/00	3,558.71	32.20	35.57	3.37	3,526.00
	06/07/00	3,558.71	32.22	35.13	2.91	3,526.05
	09/06/00	3,558.71	High H ₂ S in area-not gauged.			-
	09/14/00	3,558.71	32.51	35.68	3.17	3,525.72
	12/06/00	3,558.71	32.70	35.78	3.08	3,525.55
	03/09/01	3,558.71	32.77	35.50	2.73	3,525.53
	06/21/01	3,558.71	32.80	35.52	2.72	3,525.50
	09/22/01	3,558.71	32.34	34.62	2.28	3,526.03
	10/12/01	3,558.71	33.13	35.60	2.47	3,525.21
	03/18/02	3,558.71	33.25	36.28	3.03	3,525.01
	03/27/02	3,558.71	33.27	36.00	2.73	3,525.03
	03/28/02	3,558.71	33.28	36.04	2.76	3,525.02
	04/03/02	3,558.71	33.26	35.94	2.68	3,525.05
	04/12/03	3,558.71	33.27	36.00	2.73	3,525.03
	04/16/02	3,558.71	33.32	35.60	2.28	3,525.05
	05/03/02	3,558.71	33.25	35.93	2.68	3,525.06
	05/10/02	3,558.71	33.31	35.66	2.35	3,525.05
	05/16/02	3,558.71	33.29	35.74	2.45	3,525.05
	05/24/02	3,558.71	33.31	36.02	2.71	3,524.99
	06/10/02	3,558.71	33.31	36.18	2.87	3,524.97
	06/19/02	3,558.71	33.37	35.91	2.54	3,524.96
	07/03/02	3,558.71	33.40	35.94	2.54	3,524.93
	07/11/02	3,558.71	33.37	36.06	2.69	3,524.94
	07/16/02	3,558.71	33.42	35.51	2.09	3,524.98
	08/21/02	3,558.71	33.40	36.21	2.81	3,524.89
	08/27/02	3,558.71	33.40	36.26	2.86	3,524.88
	09/05/02	3,558.71	33.46	36.04	2.58	3,524.86
	09/16/02	3,558.71	33.54	35.86	2.32	3,524.82
	10/03/02	3,558.71	33.51	36.28	2.77	3,524.78
	10/08/02	3,558.71	33.61	35.71	2.10	3,524.79
	10/15/02	3,558.71	33.63	35.78	2.15	3,524.76
	12/19/02	3,558.71	33.58	36.44	2.86	3,524.70
	03/03/03	3,558.71	NM	NM	NM	NM
	06/17/03	3,558.71	33.66	36.42	2.76	3,524.64
	09/05/03	3,558.71	33.85	36.70	2.85	3,524.43
	12/16/03	3,558.71	34.02	36.74	2.72	3,524.28
	03/08/04	3,558.71	34.05	36.78	2.73	3,524.25
	05/25/04	3,558.71	33.79	36.34	2.55	3,524.54
	08/31/04	3,558.71	34.00	36.70	2.70	3,524.31

TABLE 2

GROUNDWATER ELEVATION AND PSH THICKNESS DATA

PLAINS MAREKTING, L.P.
 MONUMENT 18
 LEA COUNTY, NEW MEXICO

SAMPLE LOCATION	SAMPLE DATE	TOP OF CASING ELEVATION	DEPTH TO PRODUCT	DEPTH TO WATER	PSH THICKNESS	CORRECTED GROUND WATER ELEVATION
MW-1	09/14/04	3,558.71	34.05	36.80	2.75	3,524.25
	09/21/04	3,558.71	34.14	36.22	2.08	3,524.26
	10/14/04	3,558.71	33.23	34.10	0.87	3,525.35
	10/21/04	3,558.71	33.30	34.15	0.85	3,525.28
	10/28/04	3,558.71	33.44	34.05	0.61	3,525.18
	11/04/04	3,558.71	33.40	34.40	1.00	3,525.16
	11/11/04	3,558.71	33.44	33.94	0.50	3,525.20
	11/17/04	3,558.71	33.43	34.55	1.12	3,525.11
	11/30/04	3,558.71	32.98	33.60	0.62	3,525.64
	12/07/04	3,558.71	32.91	33.60	0.69	3,525.70
	12/15/04	3,558.71	32.90	33.50	0.60	3,525.72
	12/13/04	3,558.71	32.90	33.50	0.60	3,525.72
	12/28/04	3,558.71	32.97	33.78	0.81	3,525.62
	01/12/05	3,558.71	32.96	33.51	0.55	3,525.67
	01/19/05	3,558.71	32.97	33.40	0.43	3,525.68
	01/26/05	3,558.71	33.00	33.67	0.67	3,525.61
	02/01/05	3,558.71	33.01	33.61	0.60	3,525.61
	02/09/05	3,558.71	33.21	33.69	0.48	3,525.43
	02/16/05	3,558.71	32.99	33.60	0.61	3,525.63
	02/23/05	3,558.71	33.00	33.49	0.49	3,525.64
	03/02/05	3,558.71	33.00	33.41	0.41	3,525.65
	03/09/05	3,558.71	32.98	33.39	0.41	3,525.67
	03/11/05	3,558.71	32.98	33.37	0.39	3,525.67
	03/17/05	3,558.71	33.04	33.54	0.50	3,525.60
	03/23/05	3,558.71	32.96	33.49	0.53	3,525.67
	03/30/05	3,558.71	32.92	33.32	0.40	3,525.73
	04/06/05	3,558.71	32.90	33.34	0.44	3,525.74
	04/14/05	3,558.71	32.89	33.25	0.36	3,525.77
	05/24/05	3,558.71	32.69	32.99	0.30	3,525.98
	06/08/05	3,558.71	32.61	33.25	0.64	3,526.00
	06/14/05	3,558.71	32.59	33.04	0.45	3,526.05
	06/22/05	3,558.71	32.59	33.00	0.41	3,526.06
	07/13/05	3,558.71	32.54	33.05	0.51	3,526.09
	07/28/05	3,558.71	32.54	32.90	0.36	3,526.12
	08/11/05	3,558.71	32.50	32.75	0.25	3,526.17
	08/24/05	3,558.71	32.66	33.02	0.36	3,526.00
	09/13/05	3,558.71	32.78	33.01	0.23	3,525.90
	09/13/05	3,558.71	32.33	33.10	0.77	3,526.26
	09/30/05	3,558.71	32.36	33.12	0.76	3,526.24

TABLE 2
GROUNDWATER ELEVATION AND PSH THICKNESS DATA

PLAINS MAREKTING, L.P.
MONUMENT 18
LEA COUNTY, NEW MEXICO

SAMPLE LOCATION	SAMPLE DATE	TOP OF CASING ELEVATION	DEPTH TO PRODUCT	DEPTH TO WATER	PSH THICKNESS	CORRECTED GROUND WATER ELEVATION
MW-1	10/11/05	3,558.71	32.36	33.11	0.75	3,526.24
	10/28/05	3,558.71	32.34	33.10	0.76	3,526.26
	11/17/05	3,558.71	32.27	33.04	0.77	3,526.32
	12/02/05	3,558.71	32.22	32.80	0.58	3,526.40
	12/07/05	3,558.71	32.31	32.75	0.44	3,526.33
	12/19/05	3,558.71	32.23	32.75	0.52	3,526.40
	12/30/05	3,558.71	32.20	32.80	0.60	3,526.42
MW - 2	01/24/00	3,559.64	-	34.03	0.00	3,525.61
	06/07/00	3,559.64	-	33.55	0.00	3,526.09
	09/06/00	3,559.64	-	33.83	0.00	3,525.81
	12/06/00	3,559.64	-	34.03	0.00	3,525.61
	03/09/01	3,559.64	-	33.93	0.00	3,525.71
	06/21/01	3,559.64	-	34.00	0.00	3,525.64
	09/22/01	3,559.64	-	34.32	0.00	3,525.32
	10/12/01	3,559.64	-	34.34	0.00	3,525.30
	03/27/02	3,559.64	-	34.46	0.00	3,525.18
	05/16/02	3,559.64	-	34.48	0.00	3,525.16
	09/16/02	3,559.64	-	34.69	0.00	3,524.95
	12/19/02	3,559.64	-	34.80	0.00	3,524.84
	03/03/03	3,559.64	NM	NM	NM	NM
	06/17/03	3,559.64	-	34.94	0.00	3,524.70
	09/05/03	3,559.64	-	35.14	0.00	3,524.50
	12/16/03	3,559.64	-	35.12	0.00	3,524.52
	03/08/04	3,559.64	-	35.35	0.00	3,524.29
	05/25/04	3,559.64	-	35.00	0.00	3,524.64
	08/31/04	3,559.64	-	35.31	0.00	3,524.33
	12/13/04	3,559.64	-	34.00	0.00	3,525.64
	03/11/05	3,559.64	-	33.95	0.00	3,525.69
	06/14/05	3,559.64	-	33.60	0.00	3,526.04
	08/11/05	3,559.64	sheen	33.48	0.00	3,526.16
	09/13/05	3,559.64	sheen	33.43	0.00	3,526.21
	09/13/05	Plugged and Abandoned				
MW - 3	01/24/00	3,558.53	31.99	34.52	2.53	3,526.16
	06/07/00	3,558.53	32.05	34.38	2.33	3,526.13
	09/06/00	3,558.53	High H ₂ S in area-not gauged.			-
	09/14/00	3,558.53	32.32	34.84	2.52	3,525.83
	12/06/00	3,558.53	32.48	34.80	2.32	3,525.70

TABLE 2
GROUNDWATER ELEVATION AND PSH THICKNESS DATA

PLAINS MARKETING, L.P.
MONUMENT 18
LEA COUNTY, NEW MEXICO

SAMPLE LOCATION	SAMPLE DATE	TOP OF CASING ELEVATION	DEPTH TO PRODUCT	DEPTH TO WATER	PSH THICKNESS	CORRECTED GROUND WATER ELEVATION
MW-3	03/09/01	3,558.53	32.61	34.32	1.71	3,525.66
	06/21/01	3,558.53	32.65	34.30	1.65	3,525.63
	09/22/01	3,558.53	32.64	34.74	2.10	3,525.58
	10/12/01	3,558.53	33.06	34.06	1.00	3,525.32
	03/18/02	3,558.53	33.30	33.48	0.18	3,525.20
	03/27/02	3,558.53	33.30	33.53	0.23	3,525.20
	03/28/02	3,558.53	33.29	33.46	0.17	3,525.21
	04/03/02	3,558.53	33.30	33.43	0.13	3,525.21
	04/12/02	3,558.53	33.31	33.40	0.09	3,525.21
	04/16/02	3,558.53	33.31	33.39	0.08	3,525.21
	05/03/02	3,558.53	33.31	33.36	0.05	3,525.21
	05/10/02	3,558.53	33.30	33.38	0.08	3,525.22
	05/16/02	3,558.53	33.32	33.39	0.07	3,525.20
	05/24/02	3,558.53	33.30	33.40	0.10	3,525.22
	06/10/02	3,558.53	33.39	33.47	0.08	3,525.13
	06/19/02	3,558.53	33.40	33.49	0.09	3,525.12
	07/03/02	3,558.53	33.42	33.50	0.08	3,525.10
	07/11/02	3,558.53	33.42	33.52	0.10	3,525.10
	07/16/02	3,558.53	33.39	33.49	0.10	3,525.13
	08/21/02	3,558.53	33.46	33.59	0.13	3,525.05
	08/27/02	3,558.53	33.47	33.61	0.14	3,525.04
	09/05/02	3,558.53	33.50	33.57	0.07	3,525.02
	09/16/02	3,558.53	33.55	33.58	0.03	3,524.98
	10/03/02	3,558.53	33.59	33.63	0.04	3,524.93
	10/08/02	3,558.53	33.59	33.65	0.06	3,524.93
	10/15/02	3,558.53	33.62	33.67	0.05	3,524.90
	12/19/02	3,558.53	33.66	33.76	0.10	3,524.86
	03/03/03	3,558.53	NM	NM	NM	NM
	06/17/03	3,558.53	33.70	33.94	0.24	3,524.79
	09/05/03	3,558.53	33.91	34.15	0.24	3,524.58
	12/16/03	3,558.53	34.05	34.38	0.33	3,524.43
	03/08/04	3,558.53	34.10	34.47	0.37	3,524.37
	05/25/04	3,558.53	33.80	34.00	0.20	3,524.70
	08/31/04	3,558.53	34.04	34.40	0.36	3,524.44
	09/14/04	3,558.53	34.07	34.33	0.26	3,524.42
	09/21/04	3,558.53	34.07	34.42	0.35	3,524.41
	10/14/04	3,558.53	sheen	33.04	0.00	3,525.49
	10/21/04	3,558.53	sheen	33.15	0.00	3,525.38
	10/28/04	3,558.53	sheen	33.16	0.00	3,525.37

TABLE 2
GROUNDWATER ELEVATION AND PSH THICKNESS DATA

PLAINS MARKETING, L.P.
MONUMENT 18
LEA COUNTY, NEW MEXICO

SAMPLE LOCATION	SAMPLE DATE	TOP OF CASING ELEVATION	DEPTH TO PRODUCT	DEPTH TO WATER	PSH THICKNESS	CORRECTED GROUND WATER ELEVATION
MW-3	11/04/04	3,558.53	sheen	33.30	0.00	3,525.23
	11/11/04	3,558.53	sheen	33.30	0.00	3,525.23
	11/17/04	3,558.53	sheen	33.32	0.00	3,525.21
	11/30/04	3,558.53	sheen	32.75	0.00	3,525.78
	12/07/04	3,558.53	sheen	32.70	0.00	3,525.83
	12/15/04	3,558.53	sheen	32.60	0.00	3,525.93
	12/28/04	3,558.53	sheen	32.72	0.00	3,525.81
	01/12/05	3,558.53	sheen	32.76	0.00	3,525.77
	01/19/05	3,558.53	sheen	32.79	0.00	3,525.74
	01/26/05	3,558.53	sheen	32.79	0.00	3,525.74
	02/01/05	3,558.53	sheen	32.80	0.00	3,525.73
	02/09/05	3,558.53	sheen	32.80	0.00	3,525.73
	02/16/05	3,558.53	sheen	32.79	0.00	3,525.74
	02/23/05	3,558.53	sheen	32.78	0.00	3,525.75
	03/02/05	3,558.53	sheen	32.76	0.00	3,525.77
	03/09/05	3,558.53	sheen	32.70	0.00	3,525.83
	03/11/05	3,558.53	sheen	32.70	0.00	3,525.83
	03/17/05	3,558.53	sheen	32.81	0.00	3,525.72
	03/23/05	3,558.53	sheen	32.70	0.00	3,525.83
	03/30/05	3,558.53	sheen	32.69	0.00	3,525.84
	04/06/05	3,558.53	sheen	32.68	0.00	3,525.85
	04/14/05	3,558.53	sheen	32.81	0.00	3,525.72
	05/24/05	3,558.53	sheen	32.47	0.00	3,526.06
	06/08/05	3,558.53	sheen	32.41	0.00	3,526.12
	06/14/05	3,558.53	-	32.36	0.00	3,526.17
	06/22/05	3,558.53	sheen	32.36	0.00	3,526.17
	07/13/05	3,558.53	sheen	32.33	0.00	3,526.20
	07/28/05	3,558.53	sheen	32.33	0.00	3,526.20
	08/24/05	3,558.53	32.25	32.33	0.08	3,526.27
	09/13/05	3,558.53	32.18	32.45	0.27	3,526.31
	09/13/05	3,558.53	32.16	32.47	0.31	3,526.32
	09/30/05	3,558.53	32.11	32.65	0.54	3,526.34
	10/11/05	3,558.53	32.11	32.70	0.59	3,526.33
	10/28/05	3,558.53	32.10	32.70	0.60	3,526.34
	11/17/05	3,558.53	32.05	32.66	0.61	3,526.39
	12/02/05	3,558.53	32.00	32.21	0.21	3,526.50
	12/07/05	3,558.53	32.02	32.30	0.28	3,526.47
	12/19/05	3,558.53	31.97	32.36	0.39	3,526.50
	12/30/05	3,558.53	31.95	32.29	0.34	3,526.53

TABLE 2
GROUNDWATER ELEVATION AND PSH THICKNESS DATA

PLAINS MARKETING, L.P.
MONUMENT 18
LEA COUNTY, NEW MEXICO

SAMPLE LOCATION	SAMPLE DATE	TOP OF CASING ELEVATION	DEPTH TO PRODUCT	DEPTH TO WATER	PSH THICKNESS	CORRECTED GROUND WATER ELEVATION
MW - 4	01/24/00	3,558.14	31.73	32.96	1.23	3,526.23
	06/07/00	3,558.14	31.75	33.30	1.55	3,526.16
	09/06/00	3,558.14	High H ₂ S in area-not gauged.			-
	09/14/00	3,558.14	32.03	33.67	1.64	3,525.86
	12/06/00	3,558.14	32.26	33.16	0.90	3,525.75
	03/09/01	3,558.14	32.32	32.81	0.49	3,525.75
	06/21/01	3,558.14	32.37	32.80	0.43	3,525.71
	09/22/01	3,558.14	32.91	34.86	1.95	3,524.94
	10/12/01	3,558.14	32.20	32.91	0.71	3,525.83
	03/18/02	3,558.14	32.89	33.00	0.11	3,525.23
	03/27/02	3,558.14	32.88	33.02	0.14	3,525.24
	03/28/02	3,558.14	32.89	32.98	0.09	3,525.24
	04/03/02	3,558.14	32.88	33.01	0.13	3,525.24
	04/12/02	3,558.14	32.89	32.93	0.04	3,525.24
	04/16/02	3,558.14	32.89	32.93	0.04	3,525.24
	05/03/02	3,558.14	32.87	32.90	0.03	3,525.27
	05/10/02	3,558.14	32.89	32.91	0.02	3,525.25
	05/16/02	3,558.14	32.90	32.93	0.03	3,525.24
	05/24/02	3,558.14	32.93	32.98	0.05	3,525.20
	06/10/02	3,558.14	32.96	33.01	0.05	3,525.17
	06/19/02	3,558.14	32.98	33.03	0.05	3,525.15
	07/03/02	3,558.14	33.00	33.06	0.06	3,525.13
	07/11/02	3,558.14	33.00	33.07	0.07	3,525.13
	07/16/02	3,558.14	32.98	33.04	0.06	3,525.15
	08/21/02	3,558.14	33.40	36.21	2.81	3,524.32
	08/27/02	3,558.14	33.05	33.16	0.11	3,525.07
	09/05/02	3,558.14	33.08	33.15	0.07	3,525.05
	09/16/02	3,558.14	33.11	33.15	0.04	3,525.02
	10/15/02	3,558.14	33.19	33.24	0.05	3,524.94
	12/19/02	3,558.14	33.22	33.34	0.12	3,524.90
	03/03/03	3,558.14	NM	NM	NM	NM
	06/17/03	3,558.14	33.29	33.45	0.16	3,524.83
	09/05/03	3,558.14	33.48	33.62	0.14	3,524.64
	12/16/03	3,558.14	33.64	33.79	0.15	3,524.48
	03/08/04	3,558.14	33.69	33.72	0.03	3,524.45
	05/25/04	3,558.14	33.42	33.45	0.03	3,524.72
	08/31/04	3,558.14	33.64	33.80	0.16	3,524.48
	09/14/04	3,558.14	33.66	33.85	0.19	3,524.45

TABLE 2

GROUNDWATER ELEVATION AND PSH THICKNESS DATA

PLAINS MAREKTING, L.P.
MONUMENT 18
LEA COUNTY, NEW MEXICO

SAMPLE LOCATION	SAMPLE DATE	TOP OF CASING ELEVATION	DEPTH TO PRODUCT	DEPTH TO WATER	PSH THICKNESS	CORRECTED GROUND WATER ELEVATION
MW-4	09/21/04	3,558.14	33.66	33.87	0.21	3,524.45
	10/14/04	3,558.14	sheen	32.80	0.00	3,525.34
	10/21/04	3,558.14	sheen	32.80	0.00	3,525.34
	10/28/04	3,558.14	sheen	32.83	0.00	3,525.31
	11/04/04	3,558.14	sheen	32.87	0.00	3,525.27
	11/11/04	3,558.14	sheen	32.87	0.00	3,525.27
	11/17/04	3,558.14	sheen	32.91	0.00	3,525.23
	11/30/04	3,558.14	sheen	32.47	0.00	3,525.67
	12/07/04	3,558.14	sheen	32.41	0.00	3,525.73
	12/13/04	3,558.14	-	32.36	0.00	3,525.78
	12/15/04	3,558.14	sheen	32.36	0.00	3,525.78
	12/28/04	3,558.14	sheen	32.40	0.00	3,525.74
	01/12/05	3,558.14	sheen	32.38	0.00	3,525.76
	01/19/05	3,558.14	sheen	32.39	0.00	3,525.75
	01/26/05	3,558.14	sheen	32.40	0.00	3,525.74
	02/01/05	3,558.14	sheen	32.43	0.00	3,525.71
	02/09/05	3,558.14	sheen	32.39	0.00	3,525.75
	02/16/05	3,558.14	sheen	32.84	0.00	3,525.30
	02/23/05	3,558.14	sheen	32.36	0.00	3,525.78
	03/02/05	3,558.14	sheen	32.34	0.00	3,525.80
	03/09/05	3,558.14	sheen	32.31	0.00	3,525.83
	03/11/05	3,558.14	sheen	32.35	0.00	3,525.79
	03/17/05	3,558.14	sheen	32.39	0.00	3,525.75
	03/23/05	3,558.14	sheen	32.32	0.00	3,525.82
	03/30/05	3,558.14	sheen	32.28	0.00	3,525.86
	04/06/05	3,558.14	sheen	32.27	0.00	3,525.87
	04/14/05	3,558.14	sheen	32.23	0.00	3,525.91
	05/24/05	3,558.14	sheen	32.20	0.00	3,525.94
	06/08/05	3,558.14	sheen	31.97	0.00	3,526.17
	06/14/05	3,558.14	31.93	31.94	0.01	3,526.21
	06/22/05	3,558.14	sheen	31.94	0.00	3,526.20
	07/13/05	3,558.14	sheen	32.00	0.00	3,526.14
	07/28/05	3,558.14	sheen	31.88	0.00	3,526.26
	08/24/05	3,558.14	sheen	31.55	0.00	3,526.59
	09/13/05	3,558.14	31.76	31.77	0.01	3,526.38
	09/30/05	3,558.14	31.73	31.76	0.03	3,526.41
	10/11/05	3,558.14	31.73	31.76	0.03	3,526.41
	10/28/05	3,558.14	31.71	31.78	0.07	3,526.42
	11/17/05	3,558.14	31.69	31.71	0.02	3,526.45
	12/07/05	3,558.14	31.59	31.69	0.10	3,526.54
	12/19/05	3,558.14	31.56	31.63	0.07	3,526.57

TABLE 2

GROUNDWATER ELEVATION AND PSH THICKNESS DATA

PLAINS MARKETING, L.P.
MONUMENT 18
LEA COUNTY, NEW MEXICO

SAMPLE LOCATION	SAMPLE DATE	TOP OF CASING ELEVATION	DEPTH TO PRODUCT	DEPTH TO WATER	PSH THICKNESS	CORRECTED GROUND WATER ELEVATION
MW-4	12/30/05	3,558.14	31.55	31.65	0.10	3,526.58
MW - 5	01/24/00	3,560.07	-	34.10	0.00	3,525.97
	06/07/00	3,560.07	-	34.12	0.00	3,525.95
	09/06/00	3,560.07	-	34.41	0.00	3,525.66
	12/06/00	3,560.07	-	34.61	0.00	3,525.46
	03/09/01	3,560.07	-	34.53	0.00	3,525.54
	06/21/01	3,560.07	-	34.59	0.00	3,525.48
	09/22/01	3,560.07	-	34.85	0.00	3,525.22
	10/12/01	3,560.07	-	34.88	0.00	3,525.19
	03/27/02	3,560.07	-	35.05	0.00	3,525.02
	05/16/02	3,560.07	-	35.05	0.00	3,525.02
	09/16/02	3,560.07	-	35.29	0.00	3,524.78
	12/19/02	3,560.07	-	35.39	0.00	3,524.68
	03/03/03	3,560.07	NM	NM	NM	NM
	06/17/03	3,560.07	-	35.53	0.00	3,524.54
	09/05/03	3,560.07	-	35.72	0.00	3,524.35
	12/16/03	3,560.07	-	35.70	0.00	3,524.37
	03/08/04	3,560.07	-	35.92	0.00	3,524.15
	05/25/04	3,560.07	-	35.57	0.00	3,524.50
	08/31/04	3,560.07	-	35.90	0.00	3,524.17
	12/13/04	3,560.07	-	34.60	0.00	3,525.47
	03/11/05	3,560.07	-	34.56	0.00	3,525.51
	06/14/05	3,560.07	-	34.20	0.00	3,525.87
	09/13/05	3,560.07	-	34.02	0.00	3,526.05
	12/07/05	3,560.07	-	33.85	0.00	3,526.22
	12/19/05	3,560.07	-	33.81	0.00	3,526.26
MW - 6	01/24/00	3,557.64	-	31.34	0.00	3,526.30
	06/07/00	3,557.64	-	31.35	0.00	3,526.29
	09/06/00	3,557.64	-	31.65	0.00	3,525.99
	12/06/00	3,557.64	-	31.86	0.00	3,525.78
	03/09/01	3,557.64	-	31.77	0.00	3,525.87
	06/21/01	3,557.64	-	31.85	0.00	3,525.79
	09/22/01	3,557.64	-	32.15	0.00	3,525.49
	10/12/01	3,557.64	-	32.13	0.00	3,525.51
	03/27/02	3,557.64	-	32.29	0.00	3,525.35
	05/16/02	3,557.64	-	32.28	0.00	3,525.36
	09/16/02	3,557.64	-	32.52	0.00	3,525.12

TABLE 2
GROUNDWATER ELEVATION AND PSH THICKNESS DATA

PLAINS MAREKTING, L.P.
MONUMENT 18
LEA COUNTY, NEW MEXICO

SAMPLE LOCATION	SAMPLE DATE	TOP OF CASING ELEVATION	DEPTH TO PRODUCT	DEPTH TO WATER	PSH THICKNESS	CORRECTED GROUND WATER ELEVATION
MW-6	12/19/02	3,557.64	-	32.63	0.00	3,525.01
	03/03/03	3,557.64	NM	NM	NM	NM
	06/17/03	3,557.64	NM	NM	NM	NM
	09/05/03	3,557.64	NM	NM	NM	NM
	12/16/03	3,557.64	-	33.11	0.00	3,524.53
	03/08/04	3,557.64	-	33.17	0.00	3,524.47
	05/25/04	3,557.64	-	32.87	0.00	3,524.77
	08/31/04	3,557.64	-	33.12	0.00	3,524.52
	12/13/04	3,557.64	-	31.65	0.00	3,525.99
	03/11/05	3,557.64	-	31.71	0.00	3,525.93
	06/14/05	3,557.64	-	31.37	0.00	3,526.27
	09/13/05	3,557.64	-	31.23	0.00	3,526.41
	12/07/05	3,557.64	-	31.07	0.00	3,526.57
	12/19/05	3,557.64	-	31.01	0.00	3,526.63
MW - 7	01/24/00	3,558.65	-	32.30	0.00	3,526.35
	06/07/00	3,558.65	-	32.38	0.00	3,526.27
	09/06/00	3,558.65	High H ₂ S in area-not gauged.			-
	12/06/00	3,558.65	-	32.81	0.00	3,525.84
	03/09/01	3,558.65	-	32.71	0.00	3,525.94
	06/21/01	3,558.65	-	32.79	0.00	3,525.86
	09/22/01	3,558.65	-	33.05	0.00	3,525.60
	10/12/01	3,558.65	-	33.08	0.00	3,525.57
	03/27/02	3,558.65	-	34.15	0.00	3,524.50
	05/16/02	3,558.65	-	33.25	0.00	3,525.40
	09/16/02	3,558.65	-	33.48	0.00	3,525.17
	12/19/02	3,558.65	-	33.65	0.00	3,525.00
	03/03/03	3,558.65	NM	NM	NM	NM
	06/17/03	3,558.65	-	33.67	0.00	3,524.98
	09/05/03	3,558.65	NM	33.86	0.00	3,524.79
	12/16/03	3,558.65	-	33.83	0.00	3,524.82
	03/08/04	3,558.65	-	34.13	0.00	3,524.52
	05/25/04	3,558.65	-	33.90	0.00	3,524.75
	08/31/04	3,558.65	-	34.11	0.00	3,524.54
	12/13/04	3,558.65	-	32.82	0.00	3,525.83
	03/11/05	3,558.65	-	32.65	0.00	3,526.00
	06/14/05	3,558.65	-	32.42	0.00	3,526.23
	09/13/05	3,558.65	-	32.22	0.00	3,526.43
	12/07/05	3,558.65	-	32.04	0.00	3,526.61

TABLE 2
GROUNDWATER ELEVATION AND PSH THICKNESS DATA

PLAINS MAREKTING, L.P.
MONUMENT 18
LEA COUNTY, NEW MEXICO

SAMPLE LOCATION	SAMPLE DATE	TOP OF CASING ELEVATION	DEPTH TO PRODUCT	DEPTH TO WATER	PSH THICKNESS	CORRECTED GROUND WATER ELEVATION
MW-7	12/19/05	3,558.65	-	32.01	0.00	3,526.64
MW - 8	01/24/00	3,559.30	-	33.21	0.00	3,526.09
	09/06/00	3,559.30	-	33.51	0.00	3,525.79
	12/06/00	3,559.30	-	33.71	0.00	3,525.59
	03/09/01	3,559.30	-	33.62	0.00	3,525.68
	06/21/01	3,559.30	-	33.70	0.00	3,525.60
	09/22/01	3,559.30	-	33.95	0.00	3,525.35
	10/12/01	3,559.30	-	33.98	0.00	3,525.32
	03/27/02	3,559.30	-	34.15	0.00	3,525.15
	05/16/02	3,559.30	-	34.16	0.00	3,525.14
	09/16/02	3,559.30	-	34.40	0.00	3,524.90
	12/19/02	3,559.30	-	34.49	0.00	3,524.81
	03/03/03	3,559.30	NM	NM	NM	NM
	06/17/03	3,559.30	-	34.63	0.00	3,524.67
	09/05/03	3,559.30	-	34.76	0.00	3,524.54
	12/16/03	3,559.30	-	34.74	0.00	3,524.56
	03/08/04	3,559.30	-	35.02	0.00	3,524.28
	05/25/04	3,559.30	-	34.75	0.00	3,524.55
	08/31/04	3,559.30	-	35	0.00	3,524.30
	12/13/04	3,559.30	-	33.7	0.00	3,525.60
	03/11/05	3,559.30	-	33.67	0.00	3,525.63
	06/14/05	3,559.30	-	33.31	0.00	3,525.99
	09/13/05	3,559.30	-	33.12	0.00	3,526.18
	12/07/05	3,559.30	-	32.95	0.00	3,526.35
	12/19/05	3,559.30	-	32.91	0.00	3,526.39
MW-9	11/08/04	3,559.94	-	34.87	0.00	3,525.07
	11/10/04	3,559.94	-	34.87	0.00	3,525.07
	03/11/05	3,559.94	-	34.36	0.00	3,525.58
	06/14/05	3,559.94	-	34.01	0.00	3,525.93
	09/13/05	3,559.94	-	33.84	0.00	3,526.10
	12/07/05	3,559.94	-	33.68	0.00	3,526.26
	12/19/05	3,559.94	-	33.64	0.00	3,526.30
MW-10	11/08/04	3,558.06	-	32.75	0.00	3,525.31
	11/10/04	3,558.06	-	32.77	0.00	3,525.29
	03/11/05	3,558.06	-	32.25	0.00	3,525.81
	06/14/05	3,558.06	-	31.93	0	3,526.13

TABLE 2

GROUNDWATER ELEVATION AND PSH THICKNESS DATA

PLAINS MAREKTING, L.P.
MONUMENT 18
LEA COUNTY, NEW MEXICO

SAMPLE LOCATION	SAMPLE DATE	TOP OF CASING ELEVATION	DEPTH TO PRODUCT	DEPTH TO WATER	PSH THICKNESS	CORRECTED GROUND WATER ELEVATION
MW-10	09/13/05	3,558.06	-	31.77	0	3526.29
	12/07/05	3,558.06	-	31.62	0	3526.44
	12/19/05	3,558.06	-	31.59	0	3526.47

TABLE 3
CONCENTRATIONS OF BTEX IN GROUNDWATER
PLAINS MARKETING, L.P.
MONUMENT 18
LEA COUNTY, NEW MEXICO

All concentrations are reported in mg/L.

SAMPLE LOCATION	SAMPLE DATE	SW 846-8012B, 5030				
		BENZENE	TOLUENE	ETHYL-BENZENE	m, p - XYLENES	o - XYLENE
NMOCD REGULATORY LIMIT		0.01	0.75	0.75	0.62	
MW-1	3/11/2005	Not Sampled Due to PSH in Well				
	6/14/2005	Not Sampled Due to PSH in Well				
	9/13/2005	Not Sampled Due to PSH in Well				
	12/19/2005	Not Sampled Due to PSH in Well				
MW - 2	09/08/99	0.003	<0.001	0.002	<0.001	0.001
	11/10/99	0.002	0.001	0.001	0.001	0.002
	01/24/00	0.002	<0.001	0.001	<0.001	0.001
	06/07/00	0.002	<0.001	<0.001	<0.001	<0.001
	09/06/00	0.002	<0.001	<0.001	<0.001	<0.001
	12/06/00	<0.001	<0.001	<0.001	<0.001	<0.001
	03/09/01	0.001	<0.001	<0.001	<0.001	<0.001
	06/21/01	<0.005	<0.005	<0.005	<0.005	
	09/27/01	<0.001	<0.001	<0.001	<0.001	<0.001
	10/12/01	0.001	<0.001	<0.001	<0.001	<0.001
	03/27/02	0.002	<0.001	<0.001	<0.001	<0.001
	05/16/02	0.001	<0.001	<0.001	<0.001	<0.001
	09/16/02	<0.001	<0.001	<0.001	<0.001	<0.001
	12/19/02	0.003	0.003	0.002	0.004	0.002
	03/03/03	NA	NA	NA	NA	NA
	06/17/03	0.001	<0.001	<0.001	<0.001	<0.001
	09/05/03	<0.001	<0.001	<0.001	<0.001	<0.001
	12/16/03	<0.001	<0.001	<0.001	<0.002	<0.001
	03/08/04	<0.001	<0.001	<0.001	<0.002	<0.001
	12/13/04	0.003	<0.001	<0.001	<0.001	
	03/11/05	Not Sampled Due to Sample Reduction				
	06/14/05	Not Sampled Due to Sample Reduction				
	09/13/05	Plugged and Abandoned				
MW-3	03/11/05	0.043	0.007	0.005	0.018	
	06/14/05	0.068	<0.005	0.007	0.033	
	09/13/05	Not Sampled Due to PSH in Well				
	12/19/05	Not Sampled Due to PSH in Well				
MW-4	12/13/04	<0.005	<0.005	<0.005	<0.005	
	03/11/05	0.047	<0.005	0.049	0.031	
	06/14/05	Not Sampled Due to PSH in Well				
	09/13/05	Not Sampled Due to PSH in Well				
	12/19/05	Not Sampled Due to PSH in Well				
MW - 5	09/08/99	0.002	0.001	<0.001	<0.001	<0.001
	11/10/99	0.002	0.001	<0.001	<0.001	0.001
	01/24/00	0.002	0.002	0.002	<0.001	<0.001
	06/07/00	0.003	0.002	<0.001	<0.001	0.001
	09/06/00	0.004	0.001	0.002	<0.001	0.001
	12/06/00	<0.001	0.002	<0.001	<0.001	<0.001

TABLE 3
CONCENTRATIONS OF BTEX IN GROUNDWATER
PLAINS MARKETING, L.P.
MONUMENT 18
LEA COUNTY, NEW MEXICO

All concentrations are reported in mg/L.

SAMPLE LOCATION	SAMPLE DATE	SW 846-8012B, 5030				
		BENZENE	TOLUENE	ETHYL-BENZENE	m, p - XYLENES	o - XYLENE
NMOC REGULATORY LIMIT		0.01	0.75	0.75	0.62	
MW-5	03/09/01	<0.001	0.002	<0.001	<0.001	<0.001
	06/21/01	<0.005	<0.005	<0.005	<0.005	
	09/27/01	0.001	<0.001	<0.001	<0.001	<0.001
	10/12/01	<0.001	<0.001	<0.001	<0.001	<0.001
	03/27/02	0.001	<0.001	<0.001	<0.001	<0.001
	05/16/02	<0.001	<0.001	<0.001	<0.001	<0.001
	09/16/02	0.001	<0.001	<0.001	<0.001	<0.001
	12/19/02	0.002	0.001	<0.001	0.001	<0.001
	03/03/03	NA	NA	NA	NA	NA
	06/17/03	<0.001	<0.001	<0.001	<0.001	<0.001
	09/05/03	<0.001	<0.001	<0.001	<0.001	<0.001
	12/16/03	0.001	<0.001	<0.001	<0.002	<0.001
	03/08/04	0.002	<0.001	<0.001	<0.002	<0.001
	05/25/04	<0.001	<0.001	<0.001	<0.002	<0.001
	12/13/04	<0.001	<0.001	<0.001	<0.001	
	03/11/05	Not Sampled Due to Sample Reduction				
	06/14/05	0.0018	<0.001	<0.001	<0.001	
	09/13/05	Not Sampled Due to Sample Reduction				
	12/19/05	0.0018	<0.001	<0.001	<0.001	
MW - 6	09/08/99	<0.001	<0.001	<0.001	<0.001	<0.001
	11/10/99	<0.001	<0.001	<0.001	<0.001	<0.001
	01/24/00	0.002	0.001	<0.001	0.002	<0.001
	06/07/00	0.002	0.001	<0.001	0.002	0.002
	09/06/00	0.002	<0.001	<0.001	<0.001	<0.001
	12/06/00	0.001	<0.001	<0.001	<0.001	<0.001
	03/09/01	0.002	<0.001	<0.001	<0.001	<0.001
	06/21/01	<0.005	<0.005	<0.005	0.008	
	09/27/01	0.003	<0.001	<0.001	<0.001	<0.001
	10/12/01	0.001	<0.001	<0.001	<0.001	<0.001
	03/27/02	0.003	<0.001	<0.001	<0.001	<0.001
	05/16/02	0.003	<0.001	<0.001	<0.001	<0.001
	09/16/02	0.003	<0.001	<0.001	<0.001	<0.001
	12/19/02	0.008	0.007	0.002	0.004	0.001
	03/03/03	NA	NA	NA	NA	NA
	06/17/03	NA	NA	NA	NA	NA
	12/16/03	0.009	<0.001	<0.001	<0.002	<0.001
	03/08/04	<0.001	<0.001	<0.001	<0.002	<0.001
	12/13/04	<0.001	<0.001	<0.001	<0.001	
	03/11/05	Not Sampled Due to Sample Reduction				
	06/14/05	Not Sampled Due to Sample Reduction				
	09/13/05	Not Sampled Due to Sample Reduction				
	12/19/05	<0.001	<0.001	<0.001	<0.001	
MW - 7	09/08/99	<0.001	<0.001	<0.001	<0.001	<0.001
	11/10/99	<0.001	<0.001	<0.001	<0.001	<0.001

TABLE 3
CONCENTRATIONS OF BTEX IN GROUNDWATER

PLAINS MARKETING, L.P.
MONUMENT 18
LEA COUNTY, NEW MEXICO

All concentrations are reported in mg/L.

SAMPLE LOCATION	SAMPLE DATE	SW 846-8012B, 5030				
		BENZENE	TOLUENE	ETHYL-BENZENE	m, p - XYLENES	o - XYLENE
NMOCD REGULATORY LIMIT		0.01	0.75	0.75	0.62	
MW-7	01/24/00	0.002	0.001	0.002	<0.001	0.001
	06/07/00	0.001	0.002	<0.001	<0.001	<0.001
	12/06/00	<0.001	<0.001	<0.001	<0.001	<0.001
	03/09/01	<0.001	<0.001	<0.001	<0.001	<0.001
	06/21/01	<0.005	<0.005	<0.005	<0.005	
	09/27/01	<0.001	<0.001	<0.001	<0.001	<0.001
	10/12/01	<0.001	<0.001	<0.001	<0.001	<0.001
	03/27/02	0.002	<0.001	<0.001	<0.001	<0.001
	05/16/02	<0.001	<0.001	<0.001	<0.001	<0.001
	09/16/02	<0.001	<0.001	<0.001	<0.001	<0.001
	12/19/02	0.005	0.004	0.002	0.003	0.001
	03/03/03	NA	NA	NA	NA	NA
	06/17/03	<0.001	<0.001	<0.001	<0.001	<0.001
	09/05/03	<0.001	<0.001	<0.001	<0.001	<0.001
	12/16/03	<0.001	<0.001	<0.001	<0.002	<0.001
	03/08/04	<0.001	<0.001	<0.001	<0.002	<0.001
	12/13/04	<0.001	<0.001	<0.001	<0.001	
	03/11/05	Not Sampled Due to Sample Reduction				
	06/14/05	Not Sampled Due to Sample Reduction				
	09/13/05	Not Sampled Due to Sample Reduction				
	12/19/05	<0.001	<0.001	<0.001	<0.001	
MW - 8	09/08/99	0.001	<0.001	<0.001	<0.001	0.001
	11/10/99	0.002	<0.001	<0.001	<0.001	0.001
	01/24/00	0.002	<0.001	0.002	<0.001	0.001
	09/06/00	0.002	<0.001	<0.001	<0.001	<0.001
	12/06/00	<0.001	<0.001	<0.001	<0.001	<0.001
	03/09/01	<0.001	<0.001	<0.001	<0.001	<0.001
	06/21/01	<0.005	<0.005	<0.005	<0.005	
	09/27/01	<0.001	<0.001	<0.001	<0.001	<0.001
	10/12/01	<0.001	<0.001	<0.001	<0.001	<0.001
	03/27/02	0.002	<0.001	<0.001	<0.001	<0.001
	05/16/02	<0.001	<0.001	<0.001	<0.001	<0.001
	09/16/02	0.001	<0.001	<0.001	<0.001	<0.001
	12/19/02	0.002	0.001	<0.001	0.001	<0.001
	03/03/03	NA	NA	NA	NA	NA
	06/17/03	<0.001	<0.001	<0.001	<0.001	<0.001
	09/05/03	<0.001	<0.001	<0.001	<0.001	<0.001
	12/16/03	<0.001	<0.001	<0.001	<0.002	<0.001
	03/08/04	<0.001	<0.001	<0.001	<0.002	<0.001
	12/13/04	<0.001	<0.001	<0.001	<0.001	
	03/11/05	Not Sampled Due to Sample Reduction				
	06/14/05	Not Sampled Due to Sample Reduction				
	09/13/05	Not Sampled Due to Sample Reduction				
	12/19/05	<0.001	<0.001	<0.001	<0.001	

TABLE 3
CONCENTRATIONS OF BTEX IN GROUNDWATER
PLAINS MARKETING, L.P.
MONUMENT 18
LEA COUNTY, NEW MEXICO

All concentrations are reported in mg/L.

SAMPLE LOCATION	SAMPLE DATE	SW 846-8012B, 5030				
		BENZENE	TOLUENE	ETHYL-BENZENE	m, p - XYLENES	o - XYLENE
NMOCD REGULATORY LIMIT		0.01	0.75	0.75	0.62	
MW-9	11/10/04	<0.001	<0.001	<0.001	<0.001	
	03/11/05	<0.001	<0.001	<0.001	<0.001	
	06/14/05	<0.001	<0.001	<0.001	<0.001	
	09/13/05	<0.001	<0.001	<0.001	<0.001	
	12/19/05	<0.001	<0.001	<0.001	<0.001	
MW-10	11/10/04	0.004	<0.001	<0.001	<0.001	
	03/11/05	0.002	<0.001	<0.001	<0.001	
	06/14/05	0.002	<0.001	<0.001	<0.001	
	09/13/05	0.002	<0.001	<0.001	<0.001	
	12/19/05	0.0025	<0.001	<0.001	<0.001	
EB - 1	12/06/00	<0.001	<0.001	<0.001	<0.001	<0.001
	10/12/01	<0.001	<0.001	<0.001	<0.001	<0.001
	03/27/02	<0.001	<0.001	<0.001	<0.001	<0.001
	05/16/02	<0.001	<0.001	<0.001	<0.001	<0.001
	09/16/02	<0.001	<0.001	<0.001	<0.001	<0.001
	12/19/02	<0.001	<0.001	<0.001	<0.001	<0.001
Note: NA indicates well not sampled due to access limitations imposed by landowner.						

Appendices

Appendix A:
Notification of Release and Corrective
Action (Form C-141)

District I
1625 N. French Dr., Hobbs, NM 88240
District II
1301 W. Grand Avenue, Artesia, NM 88210
District III
1000 Rio Brazos Road, Aztec, NM 87410
District IV
1220 S. St. Francis Dr., Santa Fe, NM 87505

State of New Mexico
Energy Minerals and Natural Resources

Oil Conservation Division
1220 South St. Francis Dr.
Santa Fe, NM 87505

Form C-141
Revised October 10, 2003

Submit 2 Copies to appropriate
District Office in accordance
with Rule 116 on back
side of form

Release Notification and Corrective Action

OPERATOR ☒ Initial Report ☐ Final Report

Name of Company	Plains Pipeline, LP	Contact:	Camille Reynolds
Address:	3705 E. Hwy 158, Midland, TX 79706	Telephone No.	505-441-0965
Facility Name	Monument # 18	Facility Type:	Pipeline

Surface Owner: Jim B Cooper	Mineral Owner	Lease No.
--------------------------------	---------------	-----------

LOCATION OF RELEASE

Unit Letter D	Section 7	Township 20S	Range 37E	Feet from the	North/South Line	Feet from the	East/West Line	County Lea
------------------	--------------	-----------------	--------------	---------------	------------------	---------------	----------------	---------------

Latitude 32 degrees 35' 30.0" **Longitude** 103 degrees 17' 55.9"

NATURE OF RELEASE

Type of Release:	Volume of Release:	Volume Recovered
Source of Release:	Date and Hour of Occurrence Unknown	Date and Hour of Discovery
Was Immediate Notice Given? Yes <input type="checkbox"/> No <input type="checkbox"/> Not Required	If YES, To Whom?	
By Whom?	Date and Hour	
Was a Watercourse Reached? <input type="checkbox"/> Yes <input checked="" type="checkbox"/> No	If YES, Volume Impacting the Watercourse.	

If a Watercourse was Impacted, Describe Fully.*

Describe Cause of Problem and Remedial Action Taken.*

Describe Area Affected and Cleanup Action Taken.*

NOTE: Texas-New Mexico Pipeline was the owner/operator of the pipeline system at the time of the release, initial response information is unavailable.

I hereby certify that the information given above is true and complete to the best of my knowledge and understand that pursuant to NMOCD rules and regulations all operators are required to report and/or file certain release notifications and perform corrective actions for releases which may endanger public health or the environment. The acceptance of a C-141 report by the NMOCD marked as "Final Report" does not relieve the operator of liability should their operations have failed to adequately investigate and remediate contamination that pose a threat to ground water, surface water, human health or the environment. In addition, NMOCD acceptance of a C-141 report does not relieve the operator of responsibility for compliance with any other federal, state, or local laws and/or regulations.

OIL CONSERVATION DIVISION

Signature:	Approved by District Supervisor:		
Printed Name: Camille Reynolds	Approval Date:		
Title: Remediation Coordinator	Expiration Date:		Attached <input type="checkbox"/>
E-mail Address: cjreynolds@paalp.com	Conditions of Approval:		
Date: 3/21/2005	Phone: (505)441-0965		

* Attach Additional Sheets If Necessary