

1R - 173

REPORTS

DATE:

1/23/1998



**KOCH PIPELINE CO., L.P.
Crouch Station**

**Work Plan
Installation of Monitor Well
Lea County, New Mexico**

*Safety & Environmental Solutions, Inc.
703 E. Clinton Suite 103
Hobbs, New Mexico 88240
(505) 397-0510*

TABLE OF CONTENTS

Purpose	<u>1</u>
Background	<u>1</u>
Method	<u>1</u>
Monitoring Parameters.....	<u>1</u>
Maps and Figures.....	<u>2</u>

Purpose

The purpose of this Work Plan is to propose installation of a down-gradient monitor well at the Crouch Station in Section 18 Township 18S Range 36E in Lea County, New Mexico. (See Vicinity Map)

Background

This plan is in response to the August 14, 1997 letter from the New Mexico Oil Conservation Division which requires Koch Pipeline Co., L.P. to submit a work plan to determine the extent of ground water contamination at the Crouch Station site.

Method

Koch Pipeline Co., L.P. proposes to install a monitor well down-gradient at the property line at Crouch Station. The groundwater flow at this location is from the northwest to the southeast. The proposed down gradient monitor well will be located southeast of the two existing monitor wells, approximately one hundred fifty five feet (155'), at the fence line.

The purpose of this well will be twofold; to determine the extent of ground water contamination down gradient from the leak site (See Site Plan) and to monitor that the SVE unit is performing proper remediation at the Crouch Station.

The physical description of the monitor well installation is as follows:

The well will be drilled to a depth of ten (10) feet below the water table. Split spoon samples will be collected at ten (10) foot intervals and analyzed in the field for with a PID. All samples collected will be preserved. The sample with the highest field reading will be sent for third party testing for TPH and BTEX confirmation tests. A driller's log noting sample points and changes in lithology will be kept. The well will be cased with 2" PVC pipe with a minimum of fifteen (15) feet of well screen on the bottom, five (5) feet above the water table and ten (10) feet below the water table. Screen will be gravel packed to a point 2-3 feet above the screen, with a bentonite plug set above the gravel pack. The remainder of the casing annulus to surface will be grouted with cement containing 5% bentonite. The well will be equipped with a locking well cap. (See monitor well diagram)

Monitoring Parameters

The monitor well will initially be sampled and analyzed for TPH, BTEX, Chlorides, major Cations and Anions, and Total Dissolved Solids with results filed with the OCD Santa Fe and Hobbs District offices.

Maps and Figures

Site Plan

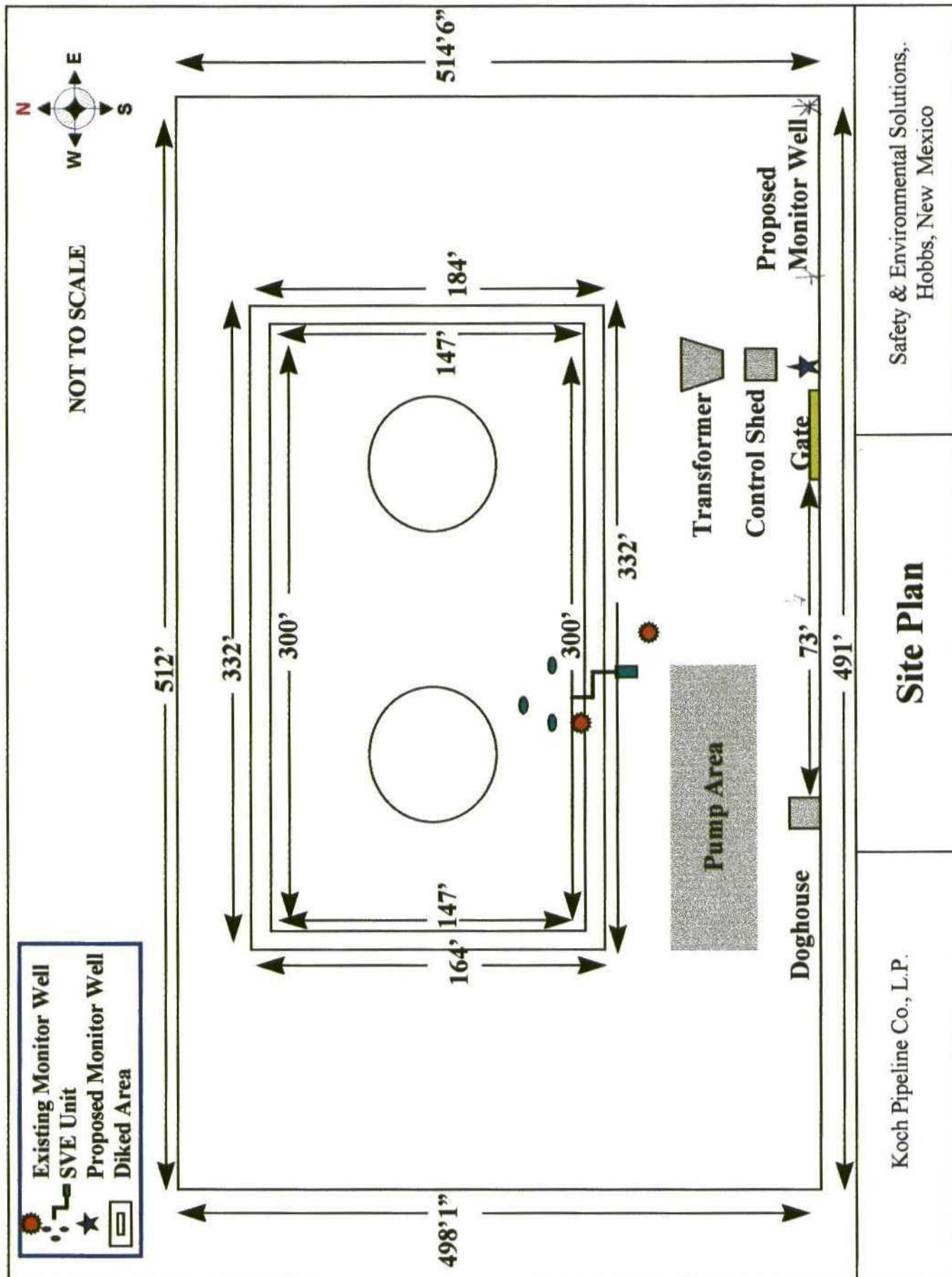

Koch Pipeline Co., L.P.

Site Plan

Safety & Environmental Solutions,
Hobbs, New Mexico