

1R - 192

**GENERAL
CORRESPONDENCE**

YEAR(S):

2/95



OIL CONSERVATION DIVISION
RECEIVED

OXY USA INC.
Box 50250, Midland, TX 79710
February 7, 1995

1995 FEB 27 AM 8 52

Mr. Jerry Sexton
State of New Mexico
Oil Conservation Division
District 1 - Hobbs
P. O. Box 1980
Hobbs, NM 88241-1980

Re: Pit Closure Report - Myers Langlie Mattix Unit

Dear Mr. Sexton:

OXY USA Inc. (OXY) would like to submit the attached closure reports for three pits and a tank battery location at our Myers Langlie Mattix Unit located in Lea County. Also, included for your information, is a copy of the closure report prepared by Big D Environmental Services, the contractor we used to remediate these sites. The closures were completed in October, 1994. Mr. Wayne Price of your office inspected the sites during closure.

If you have any questions concerning this closure report please contact me at (915) 685-5669.

Lance W. Bowers
Engineering Tech
Western Region

cc: C. Oney
B. Meadows
B. Hunt
C. Pollard
S. Nichols

State of New Mexico ← THIS COPY FOR
Energy, Minerals and Natural Resources Department
Oil Conservation Division
P. O. Box 2088
Santa Fe, New Mexico 87504-2088

F: Hobbs PFA NMOCD Correspondence

District I

P.O. Box 1980, Hobbs, NM

District II

P.O. Drawer DD, Artesia, NM 88211

District III

1000 Rio Brazos Rd, Aztec, NM 87410

State of New Mexico

Energy, Minerals and Natural Resources Department

OIL CONSERVATION DIVISIONP.O. Box 2088
Santa Fe, New Mexico 87504-2088SUBMIT 1 COPY TO
APPROPRIATE
DISTRICT OFFICE
AND 1 COPY TO
SANTA FE OFFICE

(Revised 3/9/94)

PIT REMEDIATION AND CLOSURE REPORTOperator: OXY USA INC. Telephone: 915/685-5669Address: P. O. Box 50250, Midland, Texas 79710-0250Facility Or: Myers Langlie Mattix Unit Battery near Well No. 227
Well NameLocation: Unit or Qtr/Qtr Sec _____ Sec 10 T 24S R 37E County Lea

Pit Type: Separator ___ Dehydrator ___ Other ___ Battery ___

Land Type: BLM X, State ___, Fee ___, Other _____Pit Location: Pit dimensions: length _____, width _____, depth 2.5'
(Attach diagram)

Reference: wellhead ___, other _____

Footage from reference: _____

Direction from reference: _____ Degrees _____ East North _____
of
_____ West South _____**Depth To Ground Water:**(Vertical distance from
contaminants to seasonal
high water elevation of
ground water)Less than 50 feet (20 points)
50 feet to 99 feet (10 points)
Greater than 100 feet (0 Points) NA**Wellhead Protection Area:**(Less than 200 feet from a private
domestic water source, or; less than
1000 feet from all other water sources)Yes (20 points)
No (0 points) NA**Distance To Surface Water:**(Horizontal distance to perennial
lakes, ponds, rivers, streams, creeks,
irrigation canals and ditches)Less than 200 feet (20 points)
200 feet to 1000 feet (10 points)
Greater than 1000 feet (0 points) NA**RANKING SCORE (TOTAL POINTS):** _____

Date Remediation Started: 8/8/94 Date Completed: 10/26/94

Remediation Method: Excavation X Approx. cubic yards 59
(Check all appropriate sections) Landfarmed X Insitu Bioremediation X
Other _____

Remediation Location: Onsite X Offsite _____
(ie. landfarmed onsite, name and location of offsite facility)

General Description Of Remedial Action: _____

Asphaltic materials and contaminated soil was removed and transported to
CRI. A biocell was constructed and maintained until closure 10/26/94.

Ground Water Encountered: No X Yes _____ Depth _____

Final Pit: Sample location Composite of pit walls 448 TPH
Closure Sampling: Biocell to 8" 3,345 TPH
(if multiple samples, attach sample results and diagram of sample locations and depths) Sample depth _____
Sample date 10/18/94 Sample time _____

Sample Results
Benzene(ppm) _____
Total BTEX(ppm) _____
Field headspace(ppm) _____
TPH _____

Ground Water Sample: Yes _____ No X (If yes, attach sample results)

I HEREBY CERTIFY THAT THE INFORMATION ABOVE IS TRUE AND COMPLETE TO THE BEST OF MY KNOWLEDGE AND BELIEF

DATE 2/7/95

SIGNATURE

Lance W. Bowers

PRINTED NAME
AND TITLE

Lance W. Bowers
Engineering Tech



OIL CONSERVATION DIVISION
RECEIVED

JUL 15 25 AM 8 50

OXY USA INC.

Box 50250, Midland, TX 79710

July 15, 1994

VIA OVERNIGHT MAIL

Mr. Jerry Sexton
State of New Mexico
Oil Conservation Division
District 1 - Hobbs
1000 W. Broadway
Hobbs, NM 88240

Re: Unit Wide Pit and Tank Battery Closure Plan

Dear Mr. Sexton:

OXY USA Inc. (OXY) would like to submit the attached closure plan for your approval. The plan is a unit wide closure plan for three pits and two tank batteries located on our Myers Langlie Mattix Unit located in Lea County. Big D Environmental will be performing the remediation of the pits and batteries and have prepared this Remediation Action Plan (RAP) in accordance with the New Mexico Oil Conservation Divisions guidance document on closure of surface impoundments.

If you have any questions concerning the RAP please contact me at 915/685-5824.

Charles W. Lock
Sr. Environmental Advisor

Attachment

cc: Chuck Pollard (w/attach)
Sid Nichols (w/attach)

Mr. Wayne Price (w/attach)
State of New Mexico Oil Conservation Division
District 1 - Hobbs
1000 W. Broadway
Hobbs, NM 88240

F: Loco Hills PFA Corresp.

Submit 3 Copies
to Appropriate
District Office

State of New Mexico
Energy, Minerals and Natural Resources Department

Form C-103
Revised 1-1-89

DISTRICT I
P.O. Box 1980, Hobbs, NM 88240

DISTRICT II
P.O. Drawer DD, Artesia, NM 88210

DISTRICT III
1000 Rio Brazos Rd., Aztec, NM 87410

OIL CONSERVATION DIVISION
310 Old Santa Fe Trail, Room 206
Santa Fe, New Mexico 87503

WELL API NO.

5. Indicate Type of Lease
STATE ☒ FEE ☒

6. State Oil & Gas Lease No.

SUNDRY NOTICES AND REPORTS ON WELLS
(DO NOT USE THIS FORM FOR PROPOSALS TO DRILL OR TO DEEPEN OR PLUG BACK TO A
DIFFERENT RESERVOIR. USE "APPLICATION FOR PERMIT"
(FORM C-101) FOR SUCH PROPOSALS.)

1. Type of Well:

OIL
WELL ☐

GAS
WELL ☐

OTHER See Block 12

2. Name of Operator

OXY USA INC.

3. Address of Operator

P. O. Box 50250, Midland, Texas 79710

4. Well Location

Unit Letter _____ : _____ Feet From The _____ Line and _____ Feet From The _____ Line

Section

Township

Range

NMPM

Lea

County

10. Elevation (Show whether DF, RKB, RT, GR, etc.)

11. Check Appropriate Box to Indicate Nature of Notice, Report, or Other Data

NOTICE OF INTENTION TO:

PERFORM REMEDIAL WORK ☒

PLUG AND ABANDON ☐

TEMPORARILY ABANDON ☐

CHANGE PLANS ☐

PULL OR ALTER CASING ☐

OTHER: _____ ☐

SUBSEQUENT REPORT OF:

REMEDIAL WORK ☐

ALTERING CASING ☐

COMMENCE DRILLING OPNS. ☐

PLUG AND ABANDONMENT ☐

CASING TEST AND CEMENT JOB ☐

OTHER: _____ ☐

12. Describe Proposed or Completed Operations (Clearly state all pertinent details, and give pertinent dates, including estimated date of starting any proposed work) SEE RULE 1103.

Remediation of three (3) pits and two (2) tank batteries located on Unit.
See attached Remedial Action Plan for location of pits and batteries.

I hereby certify that the information above is true and complete to the best of my knowledge and belief.

SIGNATURE Charles W. Lock TITLE Environmental Advisor DATE 7/15/94

TYPE OR PRINT NAME Charles W. Lock

TELEPHONE NO. 915/685-5824

(This space for State Use)

APPROVED BY [Signature] TITLE DISTRICT I SUPERVISOR DATE JUL 19 1994

CONDITIONS OF APPROVAL, IF ANY:

**PROPOSED UNIT WIDE
PIT CLOSURE AND TANK BATTERY REMEDIATION ACTION PLANS
MYERS LANGLIE MATTIX UNIT, LEA COUNTY, NEW MEXICO**

Prepared for:

Mr. Charles Lock
Senior Environmental Advisor
OXY USA
P.O. Box 50250
Midland, Texas 79710

Prepared by:

BIG D ENVIRONMENTAL SERVICES
P.O. Box 7808
Midland, Texas 79708

Barry L. Keith, Geologist

NOTICE OF INTENTION TO PERFORM REMEDIAL WORK

**PROPOSED UNIT WIDE
PIT CLOSURE AND BATTERY SITE REMEDIATION ACTION PLAN**

Big D Environmental Services proposes to conduct the following Remedial Activities on the OXY USA, MYERS LANGLIE MATTIX UNIT, LEA COUNTY, NEW MEXICO.

Based on the hydrological data presented in a Phase I Environmental Assessment, conducted during October, 1994, at the Myers Langlie Mattix Unit, the ranking criteria (NMOCD Environ. Regs., Unlined Surface Impoundment Closure Guidelines, Section II.A.2.a.), would be Zero (0). This ranking indicates recommended remediation levels for this ranking score to be 10ppm Benzene, 50ppm for BTEX and 5000ppm for TPH. These are the target levels upon which the following REMEDIAL ACTION PLANS (RAP) are based.

The pits located near Well 196 and Well 226 contain "Sediment Oil". This material will be excavated and manifested to the CRI, Inc. recovery facility for processing. The "Sediment Oil" will be tested for recoverability, prior to transport.

The asphalt like pads, at the abandoned Battery Sites, will be excavated and manifested to CRI, Inc. disposal facility for disposal. Thses pads were apparently added, years ago, for enhanced vehicular access.

Five sites are addressed in this RAP and they are as follows (see attached plat for locations):

- * Pit near Well 196--R37E, T24S, Sec9--660FNL, 2010FWL
- * Pit near Well 226--R37E, T24S, Sec 11--1980FNL, 660FWL
- * Pit near Well 11--R36E, T23S, Sec 25--660FNL, 1980FEL
- * Old Battery Site near Well 227--
R37E, T24S, Sec 10--1980FSL,1980FEL
- * Old Battery Site Near Well 226--
R37E, T24S, Sec 11--1980FNL,660FWL

The estimated start up date is immediately after NMOCD approval of this plan.

The Remedial Action Plan for the soils at the above sites is proposed as follows:

- * Priority will be given those sites where disposal is a factor.

- * The impacted soils at the site will be excavated and placed in an adjacent bermed area for bioremediation via enhanced landfarming.

- * The areas will be over excavated and composite samples will be collected to verify walls and bottoms are equal to or below ranking criteria levels.

- * The contaminated soils will be inoculated with a urea based nutrient, disced, tilled and moisturized.

- * Hay will be added as a bulking agent, moisture retainer and additional enhancement.

- * Fresh water will be applied on an as needed basis, via hand sprinklers.

- * A 120 day bio-maintenance program will be conducted as part of these remedial activities. This program includes one or more of the following: aeration, sample collecting, moisturization, re-inoculation, onsite inspections, etc.

- * Open pit areas will be protected by temporary fencing and appropriate signage.

- * Once ranking criteria levels are reached or exceeded, the remediated soils will be returned to the original site, graded to guideline specifications and then seeded with a BLM mix of native species.

- * A final Closure Report document, outlining procedures and results, will be prepared for submittal.

Soil samples collected at these sites will be taken to Environmental Lab of Texas, at Midland, Texas, for analyses. All samples will be analyzed using EPA or OCD approved methods. Soil sampling for laboratory analyses will be conducted using approved industry standards or other OCD approved procedures.

The enhanced remediation procedure is proposed, in order to shorten degradation time and maximize the remaining summer heat.

All remedial activities undertaken, will be done in accordance with all applicable federal, state and local regulations. An area wide Closure Document will be prepared for final closure.

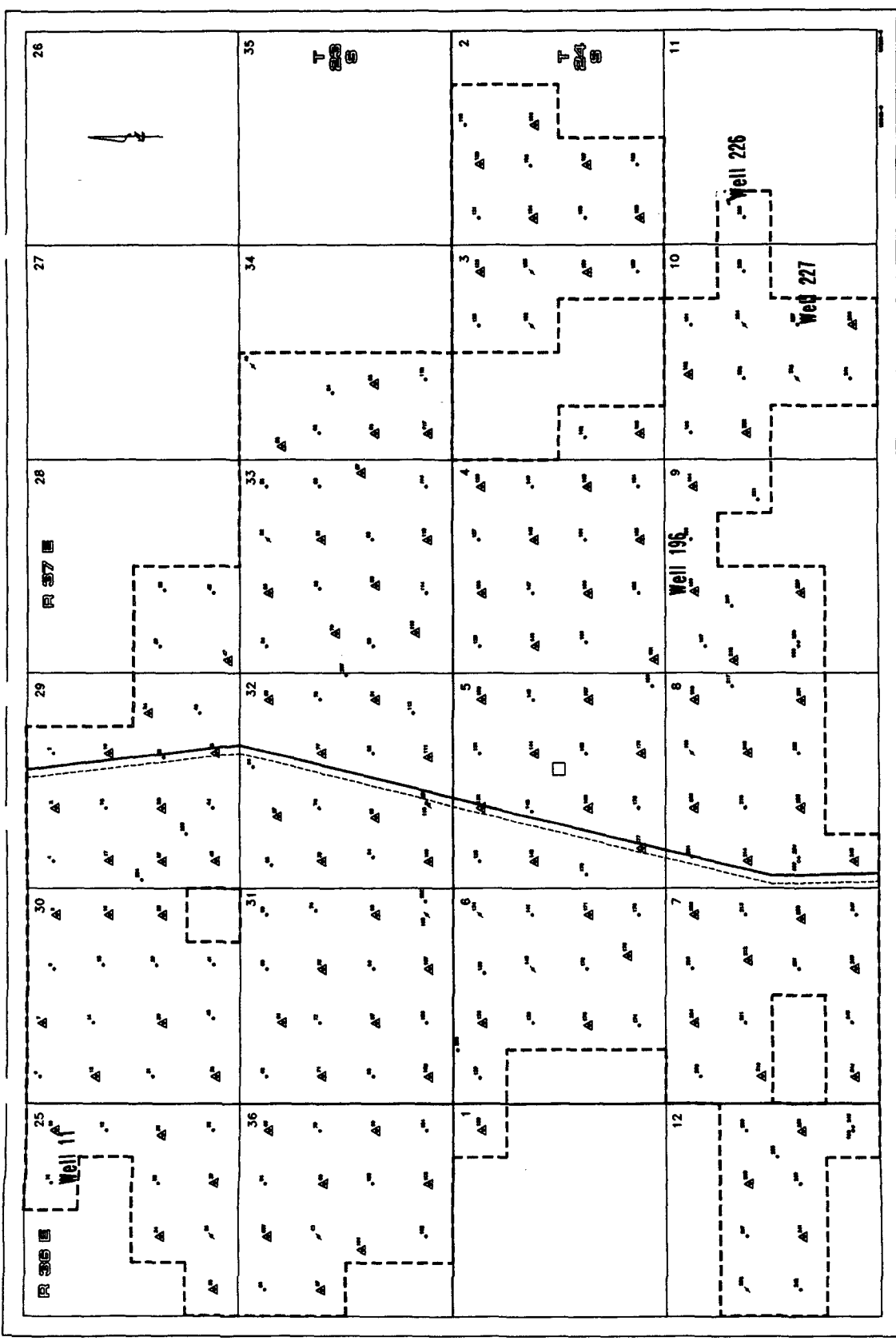

MYERS LANGLEY MATTHEW QUEEN UNIT
Last County, New Mexico

Legend
● METER
▲ WATER METER
□ PUMP & MANHOLE



Map Revised July, 1980