

1R -

315

**GENERAL
CORRESPONDENCE**

YEAR(S):

2004 -

Price, Wayne

From: Price, Wayne
Sent: Thursday, December 02, 2004 4:13 PM
To: Mike Griffin (E-mail)
Cc: Carolyn Doran Haynes (E-mail)
Subject: ABO F-31 Pit

In order to close the file, I need verification that the monitor well on-site has been properly closed. Please provide.

Sincerely:

Wayne Price
New Mexico Oil Conservation Division
1220 S. Saint Francis Drive
Santa Fe, NM 87505
505-476-3487
fax: 505-476-3462
E-mail: WPRICE@state.nm.us

Price, Wayne

From: Price, Wayne
Sent: Wednesday, October 27, 2004 3:25 PM
To: 'Mike Griffin'; Price, Wayne
Cc: enviro@leaco.net; Carolyn Doran Haynes (E-mail)
Subject: RE: Rice F-31 (ABO) Well Plugging

I only authorized the plugging of the one MW at the site. The others are associated with another project.

-----Original Message-----

From: Mike Griffin [mailto:whearth@msn.com]
Sent: Wednesday, October 27, 2004 2:58 PM
To: wprice@state.nm.us
Cc: enviro@leaco.net
Subject: Rice F-31 (ABO) Well Plugging

Wayne,

It was brought to my attention this afternoon that there are three more monitor wells at the F-31 site installed well prior to 1997. Rice has "deeded" one of the wells (shown on the attached schematic as MW-4) to the City of Lovington as a method of checking water levels. When we plug MW-1, we are also going to plug MW's 2 & 3 at the same time. We'll send plugging reports on all three to you.

Mike Griffin

Whole Earth Environmental, Inc.
Phone: 281.394.2050
FAX: 281.394.2051

This email has been scanned by the MessageLabs Email Security System.
For more information please visit <http://www.messagelabs.com/email>



Whole Earth Environmental, Inc.

19606 San Gabriel Houston, Tx. 77084
Tel: 281.492.7077 Fax: 281.646.8996
whearth@iamerica.net

RECEIVED
APR 07 2003
Environmental Bureau
Oil Conservation Division

April 2, 2003

Wayne Price
NMOCD
1220 South St. Francis Dr.
Sante Fe, NM 87505

Dear Wayne:

Enclosed, please find a copy of the annual quarterly sampling results for the Rice Operating F-31 (Abo) SWD south of Lovington. Due to some confusion in the first quarter of last year, neither Whole Earth nor Rice Operating sampled the site. We each thought that the other had responsibility for the task and subsequently allowed the sampling window to lapse.

We are now scheduled to pull both BTEX and chloride samples from the well on or about the first day of each quarter. In about two weeks, we further intend to sample for both BTEX and chlorides at the down-gradient wells described as MW-2 and MW-3 on the attached plat map. These wells remain in place from a previous leak site project (case # 1R0220). Assuming that the results continue to show acceptable BTEX and chloride concentrations, this schedule of testing the primary monitor well (# 1) quarterly and the outlying wells annually will continue for a minimum of five additional consecutive quarters.

I do apologize for the confusion and hope that the very satisfactory results we've obtained in the testing program ameliorates our error.

Warmest personal regards,

Mike Griffin
President
Whole Earth Environmental, Inc.

Cc: Carolyn Haynes / Rice Operating Co.
Paul Sheeley / NMOCD – Hobbs
Pat Wise / City Mgr. / City of Lovington

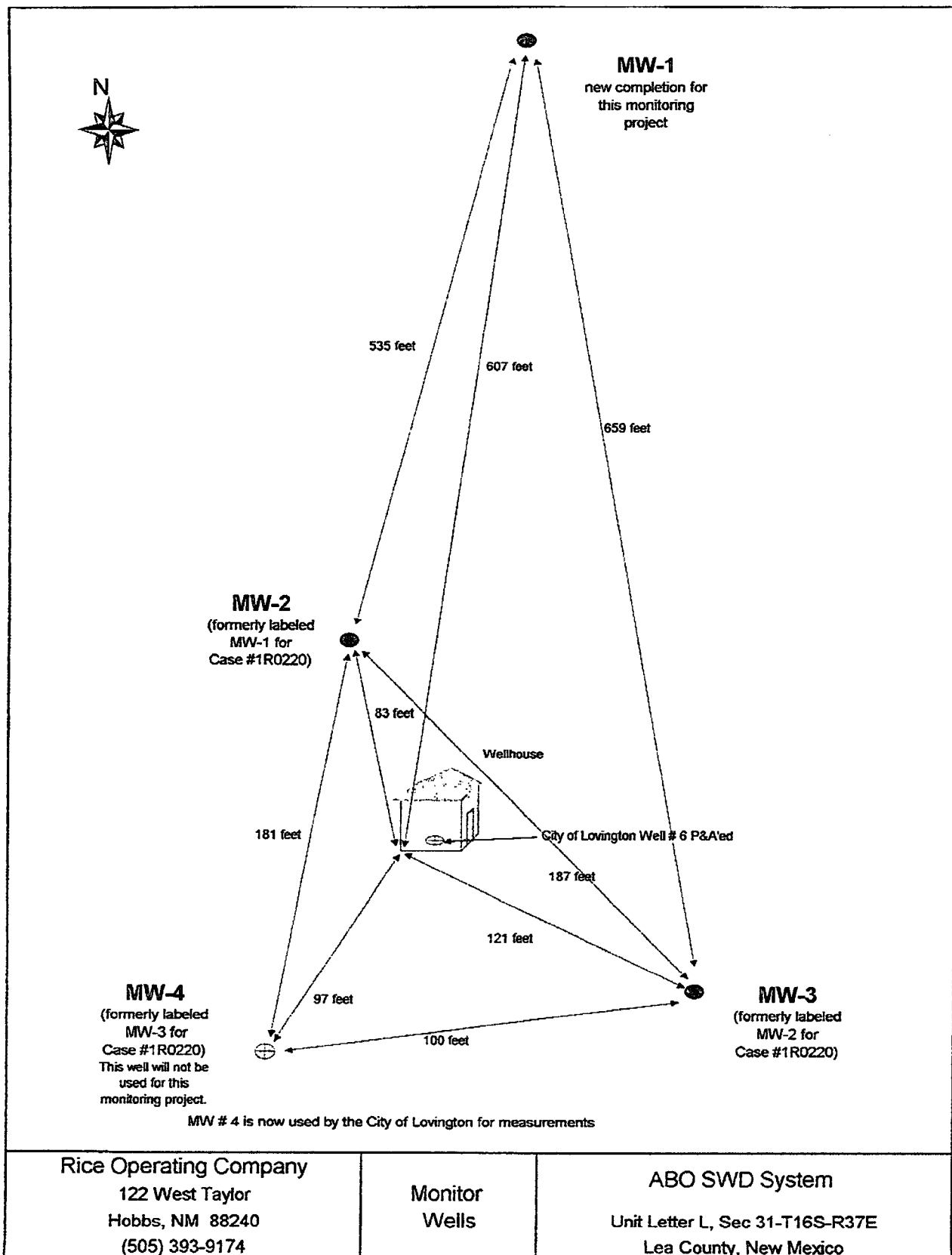

Rice Operating Co.
SWD F-31 (Abo)
Monitor Well Sampling Results

Lab. #	020510	020510	020510
Sample Date	6/17/02	10/24/02	12/30/02
Chlorides	88.6	97.5	97.5
Benzene		0.001	
Toluene		0.001	
Ethylbenzene		0.001	
m,p Xylene		0.001	
o Xylene		0.001	
Total Xylene		0.002	
Total BTEX		0.005	

ANALYTICAL REPORT

Prepared for:

**MIKE GRIFFIN
WHOLE EARTH
19606 SAN GABRIEL
HOUSTON, TX 77084**

**Project: Rice ABO
Order#: G0203578
Report Date: 06/17/2002**

Certificates

US EPA Laboratory Code TX00158

ENVIRONMENTAL LAB OF TEXAS

ANALYTICAL REPORT

MIKE GRIFFIN
WHOLE EARTH
19606 SAN GABRIEL
HOUSTON, TX 77084

Order#: G0203578
Project:
Project Name: Rice ABO
Location: Lovington

Lab ID: 0203578-01
Sample ID: ABO MW-1

Test Parameters

<u>Parameter</u>	<u>Result</u>	<u>Units</u>	<u>Dilution Factor</u>	<u>RL</u>	<u>Method</u>	<u>Date Analyzed</u>	<u>Analyst</u>
Chloride	88.6	mg/L	1	5.00	9253	6/11/02	SB

Approval:

Raland K. Tuttle 6-17-02
Raland K. Tuttle, Lab Director, QA Officer
Celey D. Keene, Org. Tech. Director
Jeanne McMurrey, Inorg. Tech. Director
Sandra Biezugbe, Lab Tech.
Sara Molina, Lab Tech.

RL = Reporting Limit N/A = Not Applicable

Page 1 of 1

ENVIRONMENTAL LAB OF TEXAS I, LTD.

12600 West I-20 East, Odessa, TX 79765 Ph: 915-563-1800

ENVIRONMENTAL LAB OF TEXAS

SAMPLE WORK LIST

WHOLE EARTH
19606 SAN GABRIEL
HOUSTON, TX 77084
281-646-8996

Order#: G0203578
Project:
Project Name: Rice ABO
Location: Lovington

The samples listed below were submitted to Environmental Lab of Texas and were received under chain of custody. Environmental Lab of Texas makes no representation or certification as to the method of sample collection, sample identification, or transportation/handling procedures used prior to the receipt of samples by Environmental Lab of Texas.

<u>Lab ID:</u>	<u>Sample :</u>	<u>Matrix:</u>	<u>Date / Time</u> <u>Collected</u>	<u>Date / Time</u> <u>Received</u>	<u>Container</u>	<u>Preservative</u>
0203578-01	ABO MW-1	WATER	6/6/02 13:45	6/6/02 20:02	See COC	See COC
<u>Lab Testing:</u>		Rejected: No	Temp: -2 C			
8021B/5030 BTEX Chloride						

ENVIRONMENTAL LAB OF TEXAS

QUALITY CONTROL REPORT

Test Parameters

Order#: G0203578

BLANK						
	WATER	LAB-ID #	Sample Concentr.	Spike Concentr.	QC Test Result	Pct (%) Recovery RPD
Chloride-mg/L		0002043-01			<5.00	
MS						
	WATER	LAB-ID #	Sample Concentr.	Spike Concentr.	QC Test Result	Pct (%) Recovery RPD
Chloride-mg/L		0203578-01	88.6	250	341	101.0%
MSD						
	WATER	LAB-ID #	Sample Concentr.	Spike Concentr.	QC Test Result	Pct (%) Recovery RPD
Chloride-mg/L		0203578-01	88.6	250	341	101.0% 0.0%
SRM						
	WATER	LAB-ID #	Sample Concentr.	Spike Concentr.	QC Test Result	Pct (%) Recovery RPD
Chloride-mg/L		0002043-04		5000	5050	101.0%

ENVIRONMENTAL LAB OF TEXAS

QUALITY CONTROL REPORT

8021B/5030 BTEX

Order#: G0203578

BLANK		LAB-ID #	Sample Concentr.	Spike Concentr.	QC Test Result	Pct (%) Recovery	RPD
	WATER						
Benzene-mg/L		0001959-02			<0.001		
Ethylbenzene-mg/L		0001959-02			<0.001		
Toluene-mg/L		0001959-02			<0.001		
p/m-Xylene-mg/L		0001959-02			<0.001		
o-Xylene-mg/L		0001959-02			<0.001		
MS		LAB-ID #	Sample Concentr.	Spike Concentr.	QC Test Result	Pct (%) Recovery	RPD
	WATER						
Benzene-mg/L		0203585-02	0	0.1	0.104	104.%	
Ethylbenzene-mg/L		0203585-02	0	0.1	0.100	100.%	
Toluene-mg/L		0203585-02	0	0.1	0.098	98.%	
p/m-Xylene-mg/L		0203585-02	0	0.2	0.200	100.%	
o-Xylene-mg/L		0203585-02	0	0.1	0.100	100.%	
MSD		LAB-ID #	Sample Concentr.	Spike Concentr.	QC Test Result	Pct (%) Recovery	RPD
	WATER						
Benzene-mg/L		0203585-02	0	0.1	0.096	96.%	8.%
Ethylbenzene-mg/L		0203585-02	0	0.1	0.092	92.%	8.3%
Toluene-mg/L		0203585-02	0	0.1	0.093	93.%	5.2%
p/m-Xylene-mg/L		0203585-02	0	0.2	0.183	91.5%	8.9%
o-Xylene-mg/L		0203585-02	0	0.1	0.092	92.%	8.3%
SRM		LAB-ID #	Sample Concentr.	Spike Concentr.	QC Test Result	Pct (%) Recovery	RPD
	WATER						
Benzene-mg/L		0001959-05		0.1	0.102	102.%	
Ethylbenzene-mg/L		0001959-05		0.1	0.098	98.%	
Toluene-mg/L		0001959-05		0.1	0.096	96.%	
p/m-Xylene-mg/L		0001959-05		0.2	0.194	97.%	
o-Xylene-mg/L		0001959-05		0.1	0.098	98.%	

CHAIN OF CUSTODY RECORD AND ANALYSIS REQUEST

**2600 West I-20 East
Odessa, Texas 79763**

Project Name: Kice A150

Project #:

Project Loc:

PO#:

Fax No: 281.646.8996

Sampler Signature:

[illegible]

ANALYTICAL REPORT

Prepared for:

MIKE GRIFFIN
WHOLE EARTH
19606 SAN GABRIEL
HOUSTON, TX 77084

Project: Rice Operating

PO#:

Order#: G0204812

Report Date: 10/24/2002

Certificates

US EPA Laboratory Code TX00158

ENVIRONMENTAL LAB OF TEXAS

SAMPLE WORK LIST

WHOLE EARTH
19606 SAN GABRIEL
HOUSTON, TX 77084
281-646-8996

Order#: G0204812
Project: None Given
Project Name: Rice Operating
Location: None Given

The samples listed below were submitted to Environmental Lab of Texas and were received under chain of custody. Environmental Lab of Texas makes no representation or certification as to the method of sample collection, sample identification, or transportation/handling procedures used prior to the receipt of samples by Environmental Lab of Texas, unless otherwise noted.

<u>Lab ID:</u>	<u>Sample :</u>	<u>Matrix:</u>	<u>Date / Time</u> <u>Collected</u>	<u>Date / Time</u> <u>Received</u>	<u>Container</u>	<u>Preservative</u>
0204812-01	ABO	WATER	10/19/02 15:00	10/21/02 12:50	2- 40 mL VOA / 1- 4 oz glas	See COC
	<u>Lab Testing:</u> 8021B/5030 BTEX Chloride	Rejected: No		Temp: 3 C		
0204812-02	E-15 North Cueto	WATER	10/19/02 15:45	10/21/02 12:50	2- 40 mL VOA / 1- 4 oz glas	See COC
	<u>Lab Testing:</u> 8021B/5030 BTEX Chloride	Rejected: No		Temp: 3 C		
0204812-03	E-15 Source - Center	WATER	10/19/02 15:55	10/21/02 12:50	2- 40 mL VOA / 1- 4 oz glas	See COC
	<u>Lab Testing:</u> 8021B/5030 BTEX Chloride	Rejected: No		Temp: 3 C		
0204812-04	E-15 South	WATER	10/19/02 16:05	10/21/02 12:50	2- 40 mL VOA / 1- 4 oz glas	See COC
	<u>Lab Testing:</u> 8021B/5030 BTEX Chloride	Rejected: No		Temp: 3 C		
0204812-05	E-15 South East	WATER	10/19/02 16:25	10/21/02 12:50	2- 40 mL VOA / 1- 4 oz glas	See COC
	<u>Lab Testing:</u> 8021B/5030 BTEX Chloride	Rejected: No		Temp: 3 C		

CASE NARRATIVE

ENVIRONMENTAL LAB OF TEXAS

Prepared for:

WHOLE EARTH
19606 SAN GABRIEL
HOUSTON, TX 77084

Order#: G0204812

Project: Rice Operating

The following samples were received as indicated below and on the attached Chain of Custody record. All analyses were performed within the holding time and with acceptable quality control results unless otherwise noted.

SAMPLE ID	LAB ID	MATRIX	Date Collected	Date Received
ABO	0204812-01	WATER	10/19/2002	10/21/2002
E-15 North Cueto	0204812-02	WATER	10/19/2002	10/21/2002
E-15 Source - Center	0204812-03	WATER	10/19/2002	10/21/2002
E-15 South	0204812-04	WATER	10/19/2002	10/21/2002
E-15 South East	0204812-05	WATER	10/19/2002	10/21/2002

Surrogate recoveries are outside control limits due to matrix interference from coeluting compounds.

The enclosed results of analyses are representative of the samples as received by the laboratory. Environmental Lab of Texas makes no representations or certifications as to the methods of sample collection, sample identification, or transportation handling procedures used prior to our receipt of samples. To the best of my knowledge, the information contained in this report is accurate and complete.

Approved By: _____

Raland K. J. [Signature]
Environmental Lab of Texas I, Ltd.

Date: _____

10-26-02

ENVIRONMENTAL LAB OF TEXAS

QUALITY CONTROL REPORT

8021B/5030 BTEX

Order#: G0204812

BLANK		LAB-ID #	Sample Concentr.	Spike Concentr.	QC Test Result	Pct (%) Recovery	RPD
	WATER						
Benzene-mg/L		0003519-02			<0.001		
Ethylbenzene-mg/L		0003519-02			<0.001		
Toluene-mg/L		0003519-02			<0.001		
p/m-Xylene-mg/L		0003519-02			<0.001		
o-Xylene-mg/L		0003519-02			<0.001		
CONTROL		LAB-ID #	Sample Concentr.	Spike Concentr.	QC Test Result	Pct (%) Recovery	RPD
	WATER						
Benzene-mg/L		0003519-03		0.1	0.110	110.0%	
Ethylbenzene-mg/L		0003519-03		0.1	0.113	113.0%	
Toluene-mg/L		0003519-03		0.1	0.112	112.0%	
p/m-Xylene-mg/L		0003519-03		0.2	0.230	115.0%	
o-Xylene-mg/L		0003519-03		0.1	0.114	114.0%	
CONTROL DUP		LAB-ID #	Sample Concentr.	Spike Concentr.	QC Test Result	Pct (%) Recovery	RPD
	WATER						
Benzene-mg/L		0003519-04		0.1	0.108	108.0%	1.8%
Ethylbenzene-mg/L		0003519-04		0.1	0.111	111.0%	1.8%
Toluene-mg/L		0003519-04		0.1	0.110	110.0%	1.8%
p/m-Xylene-mg/L		0003519-04		0.2	0.226	113.0%	1.8%
o-Xylene-mg/L		0003519-04		0.1	0.112	112.0%	1.8%
SRM		LAB-ID #	Sample Concentr.	Spike Concentr.	QC Test Result	Pct (%) Recovery	RPD
	WATER						
Benzene-mg/L		0003519-05		0.1	0.110	110.0%	
Ethylbenzene-mg/L		0003519-05		0.1	0.113	113.0%	
Toluene-mg/L		0003519-05		0.1	0.112	112.0%	
p/m-Xylene-mg/L		0003519-05		0.2	0.229	114.5%	
o-Xylene-mg/L		0003519-05		0.1	0.114	114.0%	

ENVIRONMENTAL LAB OF TEXAS

ANALYTICAL REPORT

MIKE GRIFFIN
WHOLE EARTH
19606 SAN GABRIEL
HOUSTON, TX 77084

Order#: G0204812
Project: None Given
Project Name: Rice Operating
Location: None Given

Lab ID: 0204812-01
Sample ID: ABO

Test Parameters

<u>Parameter</u>	<u>Result</u>	<u>Units</u>	<u>Dilution Factor</u>	<u>RL</u>	<u>Method</u>	<u>Date Analyzed</u>	<u>Analyst</u>
Chloride	97.5	mg/L	1	5.00	9253	10/21/02	SB

Lab ID: 0204812-02
Sample ID: E-15 North Cueto

Test Parameters

<u>Parameter</u>	<u>Result</u>	<u>Units</u>	<u>Dilution Factor</u>	<u>RL</u>	<u>Method</u>	<u>Date Analyzed</u>	<u>Analyst</u>
Chloride	620	mg/L	1	5.00	9253	10/21/02	SB

Lab ID: 0204812-03
Sample ID: E-15 Source - Center

Test Parameters

<u>Parameter</u>	<u>Result</u>	<u>Units</u>	<u>Dilution Factor</u>	<u>RL</u>	<u>Method</u>	<u>Date Analyzed</u>	<u>Analyst</u>
Chloride	39000	mg/L	1	5.00	9253	10/21/02	SB

Lab ID: 0204812-04
Sample ID: E-15 South

Test Parameters

<u>Parameter</u>	<u>Result</u>	<u>Units</u>	<u>Dilution Factor</u>	<u>RL</u>	<u>Method</u>	<u>Date Analyzed</u>	<u>Analyst</u>
Chloride	827	mg/L	1	5.00	9253	10/21/02	SB

Lab ID: 0204812-05
Sample ID: E-15 South East

Test Parameters

<u>Parameter</u>	<u>Result</u>	<u>Units</u>	<u>Dilution Factor</u>	<u>RL</u>	<u>Method</u>	<u>Date Analyzed</u>	<u>Analyst</u>
Chloride	1600	mg/L	1	5.00	9253	10/21/02	SB

Approval: Raland K. Tuttle 10-26-02
Raland K. Tuttle, Lab Director, QA Officer Date
Celey D. Keene, Org. Tech. Director
Jeanne McMurrey, Inorg. Tech. Director
Sandra Biezugbe, Lab Tech.
Sara Molina, Lab Tech.

ENVIRONMENTAL LAB OF TEXAS

ANALYTICAL REPORT

MIKE GRIFFIN
WHOLE EARTH
19606 SAN GABRIEL
HOUSTON, TX 77084

Order#: G0204812
Project: None Given
Project Name: Rice Operating
Location: None Given

Lab ID: 0204812-01
Sample ID: ABO

8021B/5030 BTEX

Method	Date	Date	Sample	Dilution	Analyst	Method
<u>Blank</u>	<u>Prepared</u>	<u>Analyzed</u>	<u>Amount</u>	<u>Factor</u>		
0003519-02		10/24/02 2:07	1	1	CK	8021B

Parameter	Result mg/L	RL
Benzene	<0.001	0.001
Ethylbenzene	<0.001	0.001
Toluene	<0.001	0.001
p/m-Xylene	<0.001	0.001
o-Xylene	<0.001	0.001

Surrogates	% Recovered	QC Limits (%)	
aaa-Toluene	110%	80	120
Bromofluorobenzene	112%	80	120

Lab ID: 0204812-02
Sample ID: E-15 North Cueto

8021B/5030 BTEX

Method	Date	Date	Sample	Dilution	Analyst	Method
<u>Blank</u>	<u>Prepared</u>	<u>Analyzed</u>	<u>Amount</u>	<u>Factor</u>		
0003519-02		10/24/02 2:30	1	1	CK	8021B

Parameter	Result mg/L	RL
Benzene	<0.001	0.001
Ethylbenzene	<0.001	0.001
Toluene	<0.001	0.001
p/m-Xylene	<0.001	0.001
o-Xylene	<0.001	0.001

Surrogates	% Recovered	QC Limits (%)	
aaa-Toluene	98%	80	120
Bromofluorobenzene	99%	80	120

DL = Diluted out N/A = Not Applicable RL = Reporting Limit

Page 1 of 3

ANALYTICAL REPORT

Prepared for:

ELLIOT WERNER
WHOLE EARTH
19606 SAN GABRIEL
HOUSTON, TX 77084

Project: ABO

PO#:

Order#: G0205347

Report Date: 12/30/2002

Certificates

US EPA Laboratory Code TX00158

ENVIRONMENTAL LAB OF TEXAS

SAMPLE WORK LIST

WHOLE EARTH
19606 SAN GABRIEL
HOUSTON, TX 77084
281-646-8996

Order#: G0205347
Project:
Project Name: ABO
Location: None Given

The samples listed below were submitted to Environmental Lab of Texas and were received under chain of custody. Environmental Lab of Texas makes no representation or certification as to the method of sample collection, sample identification, or transportation/handling procedures used prior to the receipt of samples by Environmental Lab of Texas, unless otherwise noted.

<u>Lab ID:</u>	<u>Sample :</u>	<u>Matrix:</u>	<u>Date / Time</u> <u>Collected</u>	<u>Date / Time</u> <u>Received</u>	<u>Container</u>	<u>Preservative</u>
0205347-01	ABO	WATER	12/30/02	12/30/02 12:40	4 oz glass	None
<u>Lab Testing:</u>		Rejected: No	Temp: 1.5 C			
Chloride						

ENVIRONMENTAL LAB OF TEXAS

QUALITY CONTROL REPORT

Test Parameters

Order#: G0205347

<i>BLANK</i>	WATER	LAB-ID #	Sample Concentr.	Spike Concentr.	QC Test Result	Pct (%) Recovery	RPD
Chloride-mg/L		0004212-01			<5.00		
<i>MS</i>	WATER	LAB-ID #	Sample Concentr.	Spike Concentr.	QC Test Result	Pct (%) Recovery	RPD
Chloride-mg/L		0205347-01	97.5	250	346	99.4%	
<i>MSD</i>	WATER	LAB-ID #	Sample Concentr.	Spike Concentr.	QC Test Result	Pct (%) Recovery	RPD
Chloride-mg/L		0205347-01	97.5	250	350	101.1%	1.1%
<i>SRM</i>	WATER	LAB-ID #	Sample Concentr.	Spike Concentr.	QC Test Result	Pct (%) Recovery	RPD
Chloride-mg/L		0004212-04		5000	4960	99.2%	

ENVIRONMENTAL LAB OF TEXAS

ANALYTICAL REPORT

ELLIOT WERNER
WHOLE EARTH
19606 SAN GABRIEL
HOUSTON, TX 77084

Order#: G0205347
Project:
Project Name: ABO
Location: None Given

Lab ID: 0205347-01
Sample ID: ABO

Test Parameters

<u>Parameter</u>	<u>Result</u>	<u>Units</u>	<u>Dilution</u> <u>Factor</u>	<u>RL</u>	<u>Method</u>	<u>Date</u> <u>Analyzed</u>	<u>Analyst</u>
Chloride	97.5	mg/L	1	5.00	9253	12/30/02	SB

Approval: Jeanne McMurrey 12-30-02
Rafael K. Tuttle, Lab Director, QA Officer Date
Coley D. Keene, Org. Tech. Director
Jeanne McMurrey, Inorg. Tech. Director
Sandra Diezuga, Lab Tech.
Sara Molina, Lab Tech.

RL = Reporting Limit N/A = Not Applicable

Page 1 of 1

ENVIRONMENTAL LAB OF TEXAS I, LTD.

12606 West I-20 East, Odessa, TX 79765 Ph: 915-563-1800

CHAIN OF CUSTODY RECORD AND ANALYSIS REQUEST

**12600 West I-20 East
Odessa, Texas 79763**
Phone: 915-563-1800
Fax: 915-563-4713

Project Manager: E. Weaver
 Company Name: Whole Earth Environ.
 Company Address: 19626 San Gabriel
 City/State/Zip: Houston, Tx 77058
 Project Name: ABC
 Project #: _____
 Project Loc: _____
 PO #: _____

Fax No:

Sampler Signature:

lab use only) ORDER #: 0205347

[illegible]

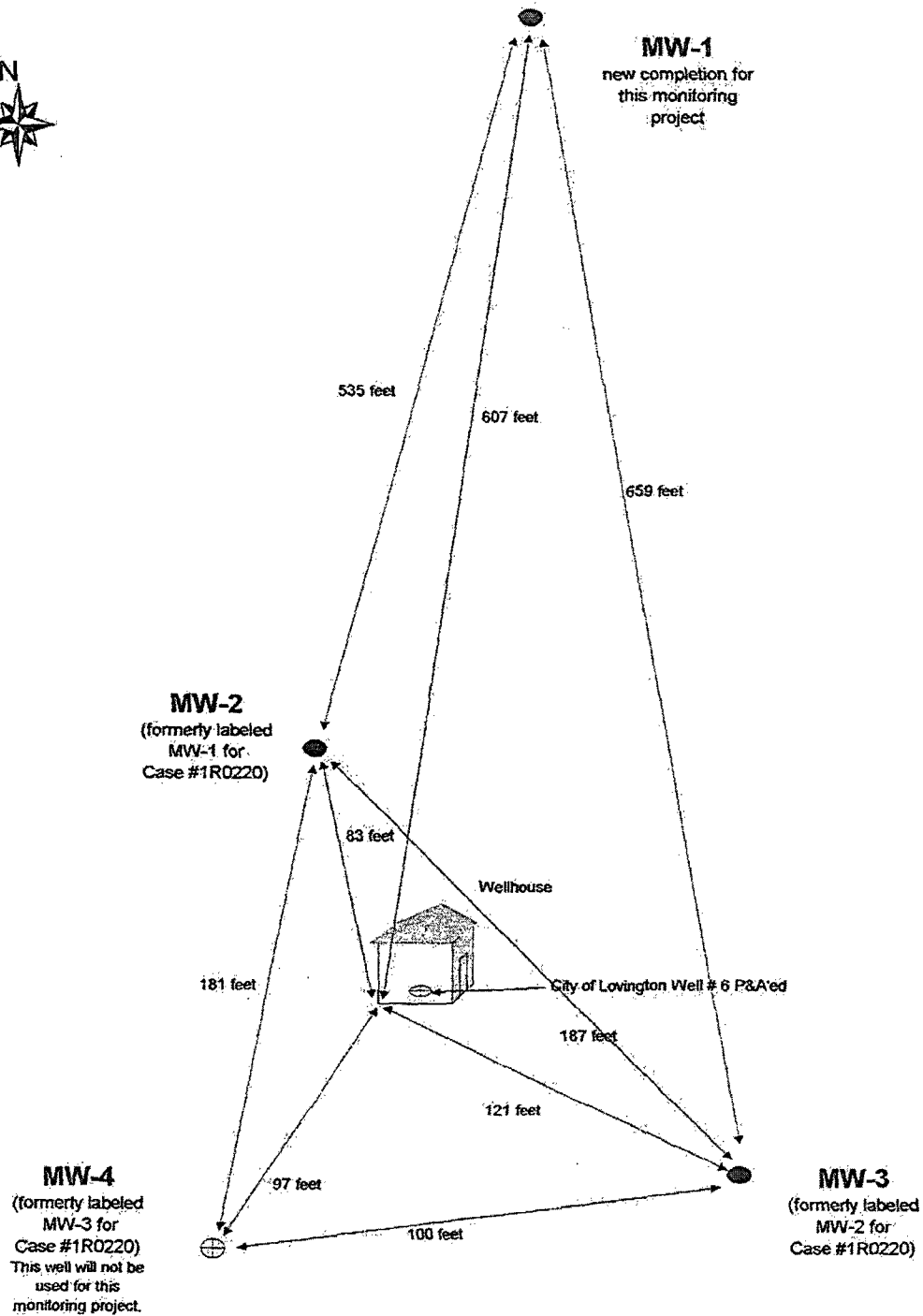

Rice Operating Company
122 West Taylor
Hobbs, NM 88240
(505) 393-9174

Monitor
Wells

ABO SWD System
Unit Letter L, Sec 31-T16S-R37E
Lea County, New Mexico

Price, Wayne

From: Price, Wayne
Sent: Wednesday, October 27, 2004 2:45 PM
To: 'Kristin Farris'; Price, Wayne
Subject: RE: Rice E-31 (ABO) Monitor Well Plugging

Ok I thought so! It's the one up in the Lovington well field area east of the refinery, is that right?

-----Original Message-----

From: Kristin Farris [mailto:enviro@leaco.net]
Sent: Wednesday, October 27, 2004 12:34 PM
To: Price, Wayne
Subject: Re: Rice E-31 (ABO) Monitor Well Plugging

Wayne, the site is referred to Abo F-31 pit, not E.

Kristin

----- Original Message -----

From: "Price, Wayne" <WPrice@state.nm.us>
To: "'Mike Griffin'" <whearth@msn.com>; "Price, Wayne" <WPrice@state.nm.us>
Cc: <enviro@leaco.net>
Sent: Wednesday, October 27, 2004 11:45 AM
Subject: RE: Rice E-31 (ABO) Monitor Well Plugging

> YES

>

> -----Original Message-----

> From: Mike Griffin [mailto:whearth@msn.com]
> Sent: Wednesday, October 27, 2004 11:40 AM
> To: wprice@state.nm.us
> Cc: enviro@leaco.net
> Subject: Rice E-31 (ABO) Monitor Well Plugging

>

>

>

>

> Wayne:

>

> We're planning to plug the monitor well associated with E-31 on November
> 4th. Do you need a copy of the plugging log from the driller for your
> files?

>

> Mike Griffin
> Whole Earth Environmental, Inc.
> Phone: 281.394.2050
> FAX: 281.394.2051

>

>

>

>

>

> This email has been scanned by the MessageLabs Email Security System.
> For more information please visit <http://www.messagelabs.com/email>

>

>

> Confidentiality Notice: This e-mail, including all attachments is for the
> sole use of the intended recipient(s) and may contain confidential and
> privileged information. Any unauthorized review, use, disclosure or
> distribution is prohibited unless specifically provided under the New
> Mexico Inspection of Public Records Act. If you are not the intended

> recipient, please contact the sender and destroy all copies of this
> message. -- This email has been scanned by the MessageLabs Email Security
> System.
>

This email has been scanned by the MessageLabs Email Security System.
For more information please visit <http://www.messagelabs.com/email>

Price, Wayne

From: Kristin Farris [enviro@leaco.net]
Sent: Wednesday, October 27, 2004 12:34 PM
To: Price, Wayne
Subject: Re: Rice E-31 (ABO) Monitor Well Plugging

Wayne, the site is referred to Abo F-31 pit, not E.

Kristin

----- Original Message -----

From: "Price, Wayne" <WPrice@state.nm.us>
To: "'Mike Griffin'" <whearth@msn.com>; "Price, Wayne" <WPrice@state.nm.us>
Cc: <enviro@leaco.net>
Sent: Wednesday, October 27, 2004 11:45 AM
Subject: RE: Rice E-31 (ABO) Monitor Well Plugging

> YES

>

> -----Original Message-----

> **From:** Mike Griffin [mailto:whearth@msn.com]
> **Sent:** Wednesday, October 27, 2004 11:40 AM
> **To:** wprice@state.nm.us
> **Cc:** enviro@leaco.net
> **Subject:** Rice E-31 (ABO) Monitor Well Plugging

>

>

>

>

> Wayne:

>

> We're planning to plug the monitor well associated with E-31 on November
> 4th. Do you need a copy of the plugging log from the driller for your
> files?

>

> Mike Griffin
> Whole Earth Environmental, Inc.
> Phone: 281.394.2050
> FAX: 281.394.2051

>

>

>

>

> This email has been scanned by the MessageLabs Email Security System.
> For more information please visit <http://www.messagelabs.com/email>

>

>

> Confidentiality Notice: This e-mail, including all attachments is for the
> sole use of the intended recipient(s) and may contain confidential and
> privileged information. Any unauthorized review, use, disclosure or
> distribution is prohibited unless specifically provided under the New
> Mexico Inspection of Public Records Act. If you are not the intended
> recipient, please contact the sender and destroy all copies of this
> message. -- This email has been scanned by the MessageLabs Email Security
> System.

>

This email has been scanned by the MessageLabs Email Security System.
For more information please visit <http://www.messagelabs.com/email>

Price, Wayne

From: Price, Wayne
Sent: Friday, October 01, 2004 8:51 AM
To: Price, Wayne; 'Carolyn Doran Haynes (E-mail)'; 'Mike Griffin (E-mail)'
Cc: Sheeley, Paul
Subject: RE: Rice ABO F-31 SWD Emergency Overflow Pit OCD Case #1R0220

The case # for this project is 1R0315 not 1R0220

-----Original Message-----

From: Price, Wayne
Sent: Thursday, September 30, 2004 5:02 PM
To: Carolyn Doran Haynes (E-mail); Mike Griffin (E-mail)
Cc: Sheeley, Paul
Subject: Rice ABO F-31 SWD Emergency Overflow Pit OCD Case #1R0220

OCD is in receipt of the closure report Dated July 23, 2004 and hereby approves of the plan and requires no further action at this time.

Please be advised that NMOCD approval of this plan does not relieve (Rice Operating Company) of liability should their operations fail to adequately investigate and remediate contamination that pose a threat to ground water, surface water, human health or the environment. In addition, NMOCD approval does not relieve (Rice Operating Company) of responsibility for compliance with any other federal, state, or local laws and/or regulations.

Sincerely:

Wayne Price
New Mexico Oil Conservation Division
1220 S. Saint Francis Drive
Santa Fe, NM 87505
505-476-3487
fax: 505-476-3462
E-mail: WPRICE@state.nm.us

Price, Wayne

From: Price, Wayne
Sent: Thursday, September 30, 2004 5:04 PM
To: Price, Wayne; 'Carolyn Doran Haynes (E-mail)'; 'Mike Griffin (E-mail)'
Cc: Sheeley, Paul
Subject: RE: Rice ABO F-31 SWD Emergency Overflow Pit OCD Case #1R0220

Please provide documentation of the MW plugging by Oct 30, 2004.

1R0315

-----Original Message-----

From: Price, Wayne
Sent: Thursday, September 30, 2004 5:02 PM
To: Carolyn Doran Haynes (E-mail); Mike Griffin (E-mail)
Cc: Sheeley, Paul
Subject: Rice ABO F-31 SWD Emergency Overflow Pit OCD Case #1R0220

OCD is in receipt of the closure report Dated July 23, 2004 and hereby approves of the plan and requires no further action at this time.

Please be advised that NMOCD approval of this plan does not relieve (Rice Operating Company) of liability should their operations fail to adequately investigate and remediate contamination that pose a threat to ground water, surface water, human health or the environment. In addition, NMOCD approval does not relieve (Rice Operating Company) of responsibility for compliance with any other federal, state, or local laws and/or regulations.

Sincerely:

Wayne Price
New Mexico Oil Conservation Division
1220 S. Saint Francis Drive
Santa Fe, NM 87505
505-476-3487
fax: 505-476-3462
E-mail: WPRICE@state.nm.us

Price, Wayne

From: Price, Wayne
Sent: Thursday, September 30, 2004 5:02 PM
To: Carolyn Doran Haynes (E-mail); Mike Griffin (E-mail)
Cc: Sheeley, Paul
Subject: Rice ABO F-31 SWD Emergency Overflow Pit OCD Case #1R0220

OCD is in receipt of the closure report Dated July 23, 2004 and hereby approves of the plan and requires no further action at this time.

Please be advised that NMOCD approval of this plan does not relieve (Rice Operating Company) of liability should their operations fail to adequately investigate and remediate contamination that pose a threat to ground water, surface water, human health or the environment. In addition, NMOCD approval does not relieve (Rice Operating Company) of responsibility for compliance with any other federal, state, or local laws and/or regulations.

Sincerely:

Wayne Price
New Mexico Oil Conservation Division
1220 S. Saint Francis Drive
Santa Fe, NM 87505
505-476-3487
fax: 505-476-3462
E-mail: WPRICE@state.nm.us