

1R - 404

APPROVALS

YEAR(S):



NEW MEXICO ENERGY, MINERALS and NATURAL RESOURCES DEPARTMENT

BILL RICHARDSON

Governor

Joanna Prukop

Cabinet Secretary

Mark E. Fesmire, P.E.

Director

Oil Conservation Division

May 2, 2006

Ms. Camille Reynolds
Plains Marketing, L.P.
3112 West Highway 82
Lovington, NM 88260

RE: 2005 Annual Monitoring Reports
Various Plains Marketing, L.P. Sites

Dear Ms. Reynolds:

The New Mexico Oil Conservation Division (NMOCD) has received and reviewed the Annual Monitoring Reports shown below. All are accepted and approved with the understandings and conditions, if any, shown:

1. **TNM 97-17**; NE/4 SW/4 Section 21, Township 20 South, Range 37 East; EMS number TNM 97-17, NMOCD file AP-017; quarterly gauging and sampling will continue throughout 2006, the results of which will be reported in the 2006 Annual Monitoring Report due by April 1, 2007. The NMOCD expects a "Site Restoration Work Plan and Soil Closure Strategy Report" by June 30, 2006.
2. **Bob Durham**; NW/4 NW/4 Section 32, Township 19 South, Range 37 East; EMS number TNM LF2000-07; NMOCD file AP-0016; quarterly monitoring and sampling will continue in 2006, the results of which will be reported in the 2006 Annual Monitoring Report due by April 1, 2007.
3. **Monument 17**; SE/4 NW/4 Section 29, Township 19 South, Range 37 East; EMS number TNM Monument-17-Known; NMOCD file 1R-0123; monitor well gauging and sampling, and product recovery will continue throughout 2006, the results of which will be reported in the 2006 Annual Monitoring Report due by April 1, 2007. The NMOCD expects a "Soil Investigation Work Plan" by June 30, 2006.
4. **Monument 10**; SE/4 NE/4 Section 30, Township 19 South, Range 37 East; EMS number TNM monument-10; NMOCD file 1R-0119; monitor well gauging and sampling, and product recovery will continue throughout 2006, the results of which will be reported in the 2006 Annual Monitoring Report due by April 1, 2007. The NMOCD expects a "Soil Investigation Work Plan" by June 30, 2006.
5. **Lea Station to Monument 6 Inch**; NE/4 SE/4 Section 5, Township 20 South, Range 37 East; EMS number 2001-11056; NMOCD file 1R-0404; monitor well gauging and sampling will continue throughout 2006, the results of which will be reported in the 2006 Annual Monitoring

Report due by April 1, 2007. The NMOCD expects a separate report on additional soil investigation/remediation by September 30, 2006.

6. **Monument Barber 10-Inch Sour**; SW/4 SW/4 Section 32, Township 19 South, Range 37 East; EMS number 2000-10655; NMOCD file 1R-0388; monitor well gauging and sampling will continue throughout 2006, the results of which will be reported in the 2006 Annual Monitoring Report due by April 1, 2007. The NMOCD expects a work plan, by June 30, 2006, to address further excavation of the sidewalls of the existing excavation for possible soil closure at the site.
7. **Monument 18**; NW/4 NW/4 Section 7, Township 20 South, Range 37 East; EMS number TNM Monument 18-Known; NMOCD file 1R-0124; monitor well gauging and sampling, and product recovery will continue throughout 2006, the results of which will be reported in the 2006 Annual Monitoring Report due by April 1, 2007. The NMOCD expects a "Soil Investigation Work Plan" by September 30, 2006.
8. **Monument 2**; SW/4 SW/4 Section 6, Township 20 South, Range 37 East and the NW/4 NW/4 Section 7, Township 20 South, Range 37 East; EMS number TNM Monument 2-Known; NMOCD file 1R-0110; monitor well gauging and sampling, and product recovery will continue throughout 2006, the results of which will be reported in the 2006 Annual Monitoring Report due by April 1, 2007. The NMOCD expects a "Soil Investigation Work Plan" by September 30, 2006.
9. **LF-59**; NW/4 SW/4 Section 32, Township 19 South, Range 37 East; EMS number TNM-LF-59; NMOCD file 1R-0103; monitor well gauging and sampling will continue throughout 2006, the results of which will be reported in the 2006 Annual Monitoring Report due by April 1, 2007.

NMOCD approval of these reports does not relieve Plains of liability should its operations at any of these sites prove to have been harmful to public health or the environment. Nor does it relieve Plains of its responsibility to comply with the rules and regulations of any other governmental agency.

If you have any questions, contact me at (505) 476-3492 or ed.martin@state.nm.us

NEW MEXICO OIL CONSERVATION DIVISION



Edwin E. Martin
Environmental Bureau

Copy: NMOCD, Hobbs
Curt Stanley, NOVA



NEW MEXICO ENERGY, MINERALS and NATURAL RESOURCES DEPARTMENT

BILL RICHARDSON

Governor

Joanna Prukop

Cabinet Secretary

Mark E. Fesmire, P.E.

Director

Oil Conservation Division

October 14, 2004

Mr. Jeffrey P. Dann
Plains All American L.P.
P.O. Box 4648
Houston, TX 77210-4648

404
IR-399

Dear Mr. Dann:

The New Mexico Oil Conservation Division (NMOCD) has received your letter, dated September 20, 2004, identifying the need for additional groundwater monitor and/or recovery wells at various sites. This request is hereby approved.

This approval does not relieve Plains Marketing, L.P. of any future liability at these sites should it prove that Plains' operations have caused harm to public health or the environment. Nor does it relieve Plains of its obligation to comply with the rules and regulations of any other governmental agency.

If you have any questions, contact me at (505) 476-3492 or emartin@state.nm.us

NEW MEXICO OIL CONSERVATION DIVISION

Edwin E. Martin
Environmental Bureau

Cc: Larry Johnson, NMOCD, Hobbs
Camille Reynolds, Plains, Midland

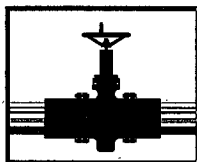

PLAINS

MARKETING, L.P.

September 20, 2004

Mr. Ed Martin
New Mexico Oil Conservation Division
Environmental Bureau
1220 South St. Francis Drive
Santa Fe, New Mexico 87505

Re: Plains Marketing, L.P. (formerly Link Energy) Remediation Sites
Various Locations in Lea County

Dear Mr. Martin:

Based on the results of our ongoing groundwater monitoring and sampling program at several of our remediation and groundwater monitoring sites in Lea County, we have identified the need for additional groundwater monitor and/or recovery wells at the flowing sites.

Site Name	Plains EMS No.	Site Location	Number of Wells
Jct 34 to Lea	2002-10286	Section 21, T20S, R37E	3
Livingston Line-Bob McCasland	2001-11043	Section 3, T21S, R37E	2
Hugh Gathering	2002-10235	Section 11, T21S, R37E	1
C. S. Caylor	2002-10250	Section 6, T17S, R37E	5
Lovington Deep 6-Inch	2002-1-312	Section 6, T21S, R36E	6
Kimbrough Sweet	2000-10757	Section 3, T18S, R37E	2
8" Moore to Jal #1	2002-10270	Section 16, T17S, R37E	3
8" Moore to Jal #2	2002-10273	Section 16, T17S, R37E	3
Darr Angell #1	Darr Angell #1	Section 11, T15S, R37E	1
Darr Angell #4	2001-10876	Section 2/11, T15S, R37E	2
Red Byrd #1	Red Byrd #1	Section 1, T19S, R36E	5
HDO 90-23	HDO 90-23	Section 6, T20S, R37E	2
Monument 6" Pipeline	2001-11056	Section 5, T20S, R37E	3
Texaco Skelly F	2002-11229	Section 21, T20S, R37E	1
SPS-11	SPS-11	Section 18, T18S, R36E	2
Monument #11	TNM Mon #11	Section 30, T19S, R37E	2
Monument #2	TNM Mon #2	Section 6, T20S, R37E	1
Monument #17	TNM Mon #17	Section 29, T19S, R37E	1
Monument #18	TNM Mon #18	Section 7, T20S, R37E	2
98-05A	TNM 98-05A	Section 26, T21S, R37E	1
LF-59	LF-59	Section 32, T19S, R37E	2

The proposed well locations are illustrated on the attached site maps. Plains requests your approval of the proposed monitor well locations at the above-referenced sites. We anticipate commencement of drilling activities the week of October 4, 2004.

Should you have any questions or comments concerning this information, please contact me at (713) 646-4657.

Sincerely,

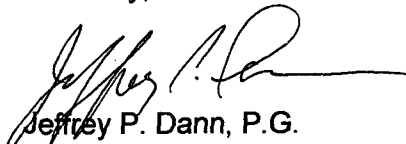

Jeffrey P. Dann, P.G.
Sr. Environmental Specialist
Plains All American

CC: Larry Johnson, NMOCD, Hobbs, NM
Camille Reynolds, Plains
Todd Choban, Nova
Pat McCasland, EPI

File: c:\jeff-files\OCD-DrillingSchOct2004

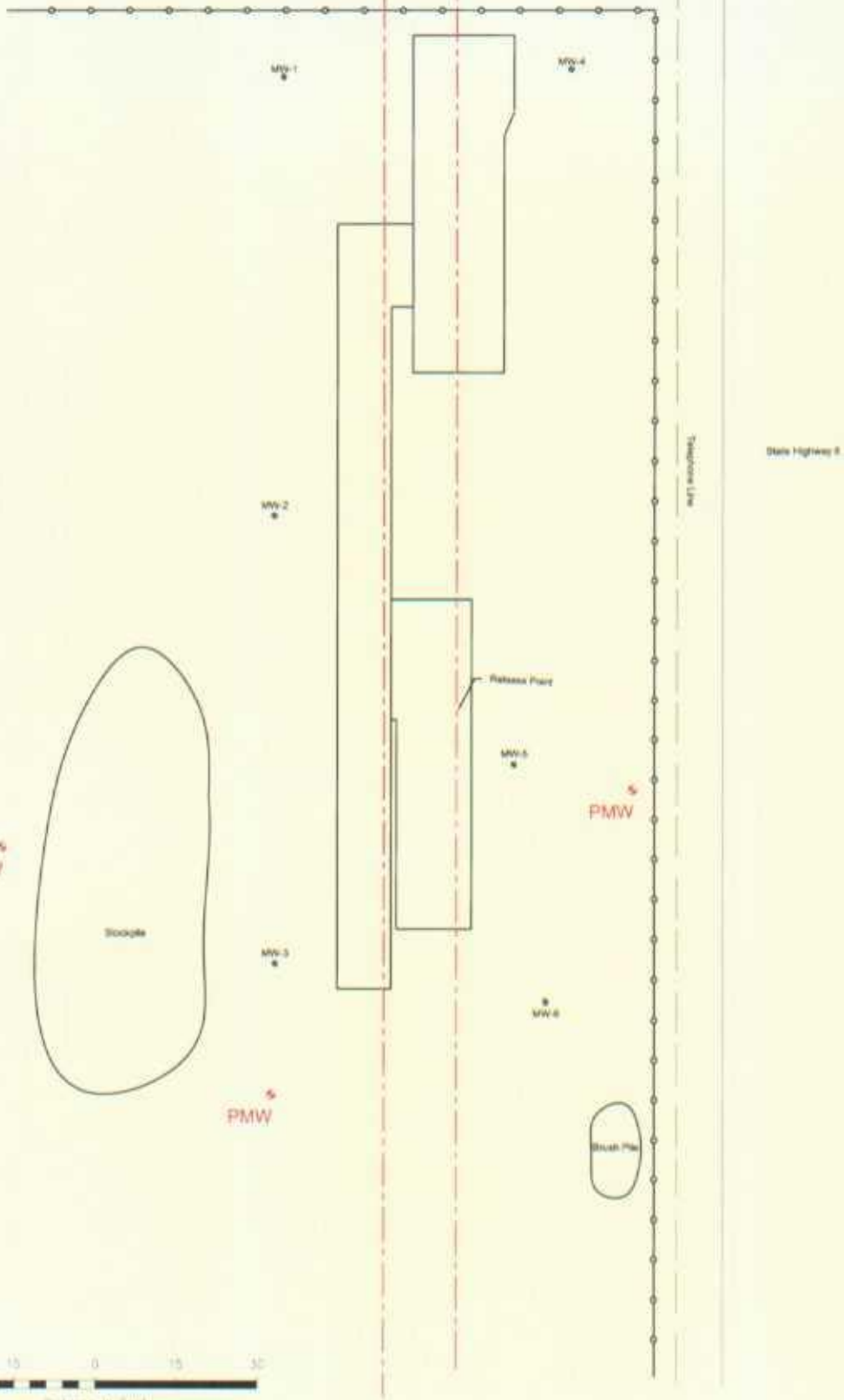

- Legend:
- GeoProbe Sample Location
 - Pipeline
 - Fence
 - Monitor Well Location
 - Proposed Monitor Well

Figure 2
Site Map
Plains Pipeline, L.P.
Lea Station to
Monument 6" Pipeline
Lea County, NM

NOVA Safety and Environmental

NOVA

Scale: 1" = 30'	Prep By: CR	Checked By: TAC
September 2, 2004	Lat: 32° 36' 5.4"N	Long: 102° 15' 55.1"W

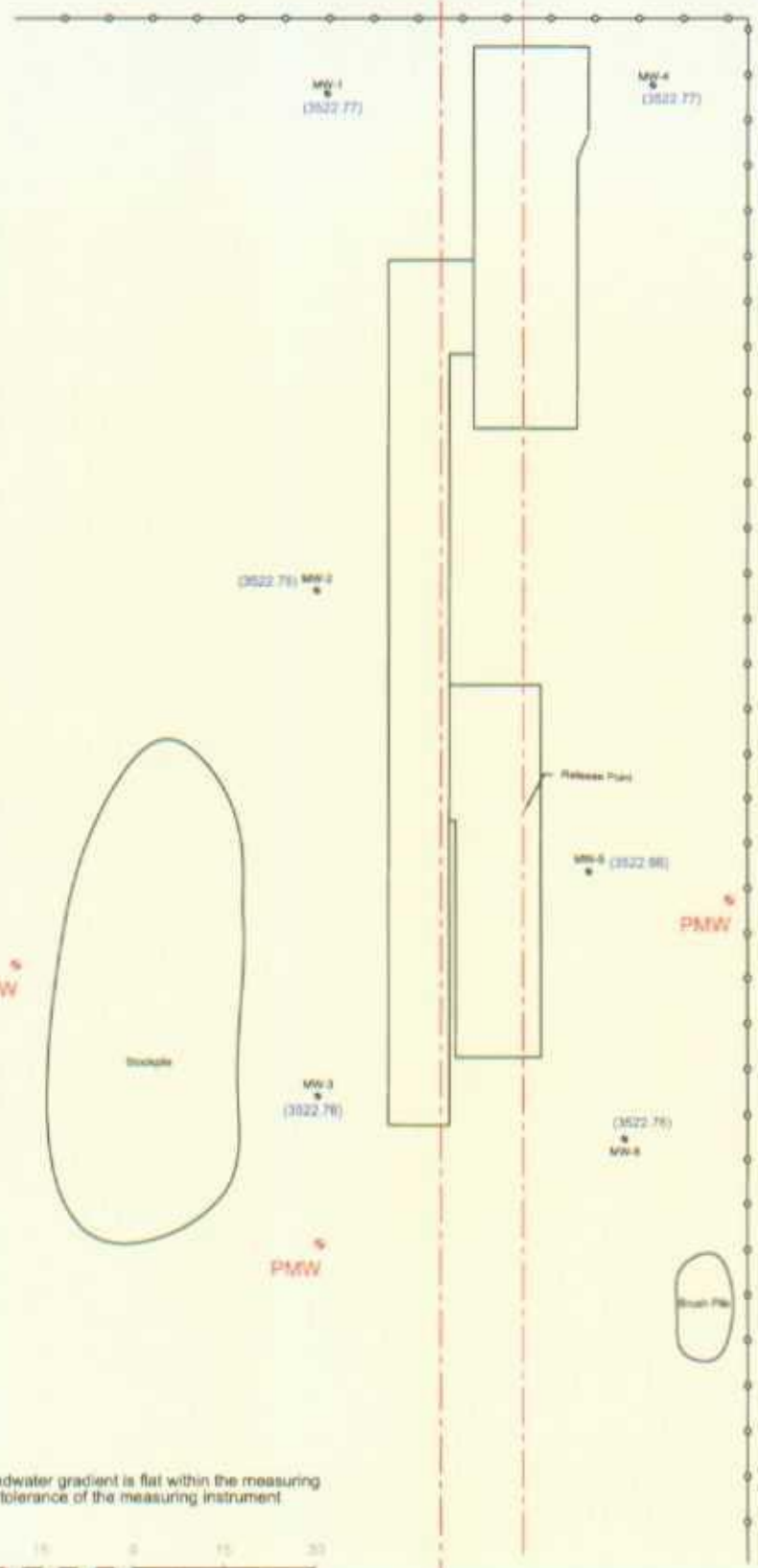

Groundwater gradient is flat within the measuring tolerance of the measuring instrument.



- Legend
- Pipeline
 - - - Fence
 - Monitor Well Location
 - (3523.35) Groundwater Elevation (in Feet)
 - Proposed Monitor Well
 - PMW

NE 1/4, SE 1/4, Sec. 5, T20S, R37E

Figure 2D
Inferred Groundwater Gradient
Map (11/2/2009)
Pinto Pipeline, L.P.
Lee Station to
Monument 6" Pipeline
Lee County, NM

NOVA Safety and Environmental



Scale: 1" = 30'	Prep By: JH	Checked By: TNC
January 25, 2009	Lat: 32° 38' 5.47" N Long: 107° 15' 35.1" W	