

1R - 426-101

REPORTS

DATE:

7/19/2004

BD H-14-2

1R0426-101

DISCLOSURE REPORT

**RICE OPERATING COMPANY
JUNCTION BOX DISCLOSURE REPORT**

BOX LOCATION

SWD SYSTEM	JUNCTION	UNIT	SECTION	TOWNSHIP	RANGE	COUNTY	BOX DIMENSIONS - FEET		
							Length	Width	Depth
BD	H-14-2	H	14	22S	37E	Lea	eliminated		

LAND TYPE: BLM _____ STATE _____ FEE LANDOWNER Leo V. Sims OTHER _____

Depth to Groundwater 65 feet NMOCD SITE ASSESSMENT RANKING SCORE: 20 *

Date Started 5/17/2004 Date Completed 6/8/2004 OCD Witness No

Soil Excavated 304 cubic yards Excavation Length 38 Width 36 Depth 6 feet

Soil Disposed 0 cubic yards Offsite Facility n/a Location n/a

FINAL ANALYTICAL RESULTS: Sample Date 5/21/2004 Sample Depth 6 ft

Procure 5-point composite sample of bottom and 4-point composite sample of sidewalls. TPH and Chloride laboratory test results completed by using an approved lab and testing procedures pursuant to NMOCD guidelines.

CHLORIDE FIELD TESTS

Sample Location	PID ppm	GRO mg/kg	DRO mg/kg	Chloride mg/kg
SIDEWALLS	6.7	<10.0	<10.0	576
BOTTOM	0.1	<10.0	<10.0	896
REMEDIED	5.2	<10.0	<10.0	240

LOCATION	DEPTH (ft)	ppm
Vertical	8	719
at source	9	1289
	10	1019
	11	749
	12	589
	13	329
	14	5428
	15	1530
15 ft West	5	2909
	6	2369
	7	3958
	8	2429
	9	1529
	10	1859
	11	3358
	12	4348
	13	5998
	14	8217
	15	8997
4-wall comp.	n/a	786
bottom comp.	6	942
remed. comp.	n/a	680

General Description of Remedial Action: This junction was one of a three-box cluster in close proximity. Delineation trenches were made with a backhoe to 12 ft as chloride field tests and PID field screenings were conducted at regular intervals. Chloride concentrations did not exhibit a trend of decline with depth or breadth within the excavation. PID readings were minimal and lab results confirmed TPH concentrations well below NMOCD guidelines. A compacted clay barrier was installed in the 38 x 36 x 6-ft-deep excavation and the excavated soil was blended and backfilled on top of the clay (see diagram). An identification plate was set on the surface to mark the site for future considerations and to identify the clay below. This junction has been eliminated and re-plumbed straight through. The disturbed surface has been seeded with a blend of native vegetation and will be monitored for growth.

ADDITIONAL EVALUATION IS HIGH PRIORITY

* Windmill located 570 ft south of the location.

enclosures: chloride graphs, photos, lab results, clay test, PID field screenings, diagram

I HEREBY CERTIFY THAT THE INFORMATION ABOVE IS TRUE AND COMPLETE TO THE BEST OF MY KNOWLEDGE AND BELIEF.

SITE SUPERVISOR Joe Gatts SIGNATURE *Joe Gatts* COMPANY RICE Operating Company

REPORT ASSEMBLED BY Kristin Farris Pope SIGNATURE *Kristin Farris Pope*

DATE 7/19/2004 TITLE Project Scientist

*** This site is a "DISCLOSURE." It will be placed on a prioritized list of similar sites for further consideration.**

BD jct. H-14-2



site prior to excavation

2/6/2002



H-14-2 junction box site

8/19/2003



delineation

May 2004

BD jct. H-14-2



compacting clay

May 2004



testing clay

5/26/2004



Backfilled site with new jct. box; clay ID plate in foreground

June 2004

BD jct H-14-2

38 x 36 x 6-ft-deep

Excavation Cross-Section

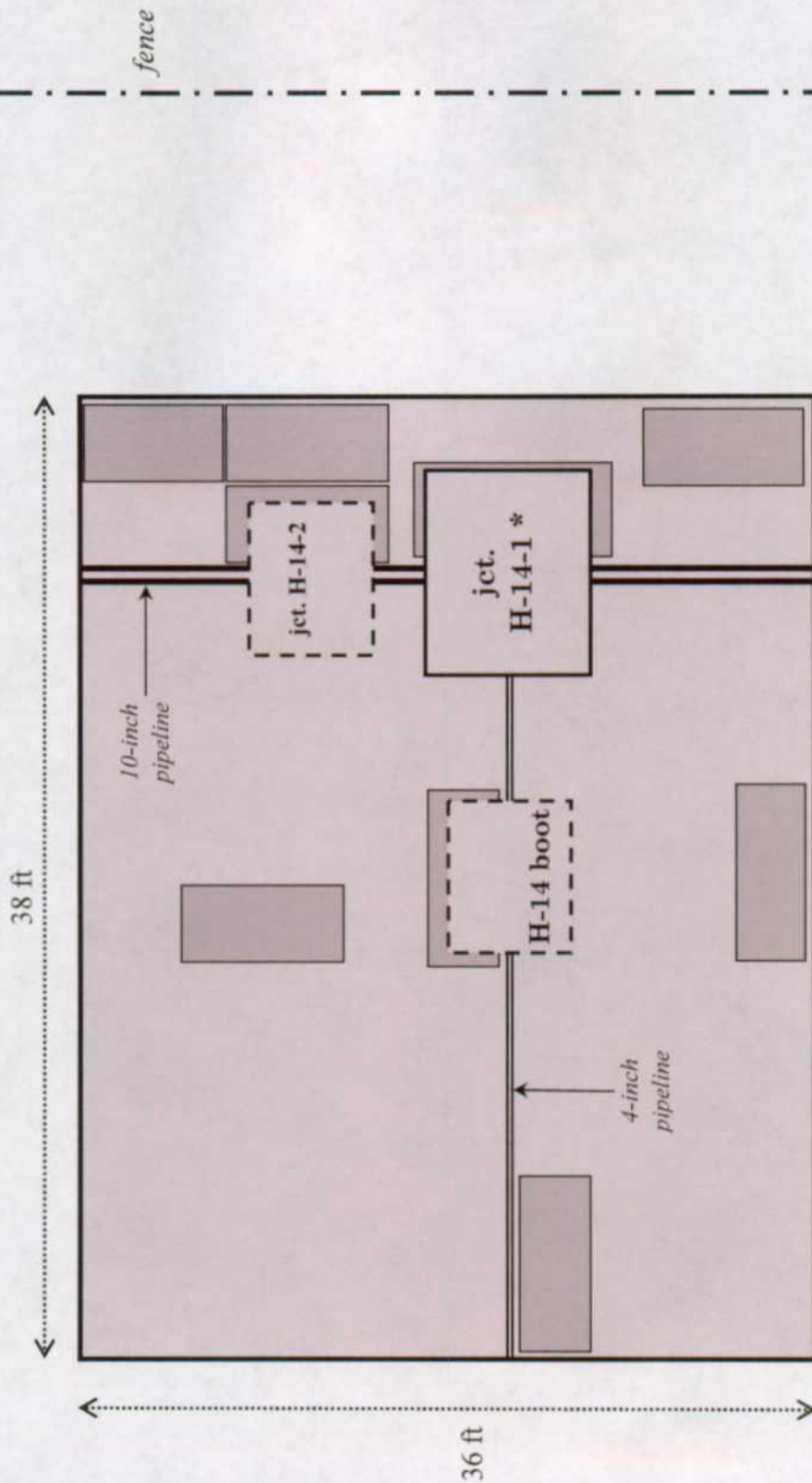
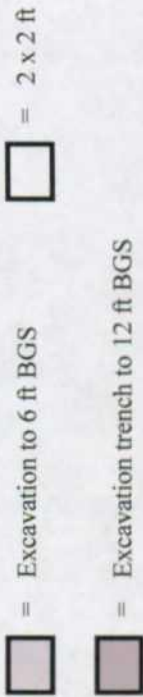

* New watertight junction box "H-14" has replaced H-14-1; H-14 boot and H-14-2 have been eliminated

BD H-14-2

T22S, R37E

Vertical Delineation at Source

Depth bgs (ft)	[Cl ⁻] ppm
8	719
9	1289
10	1019
11	749
12	589
13	329
14	5428
15	1530

Groundwater = 65 ft

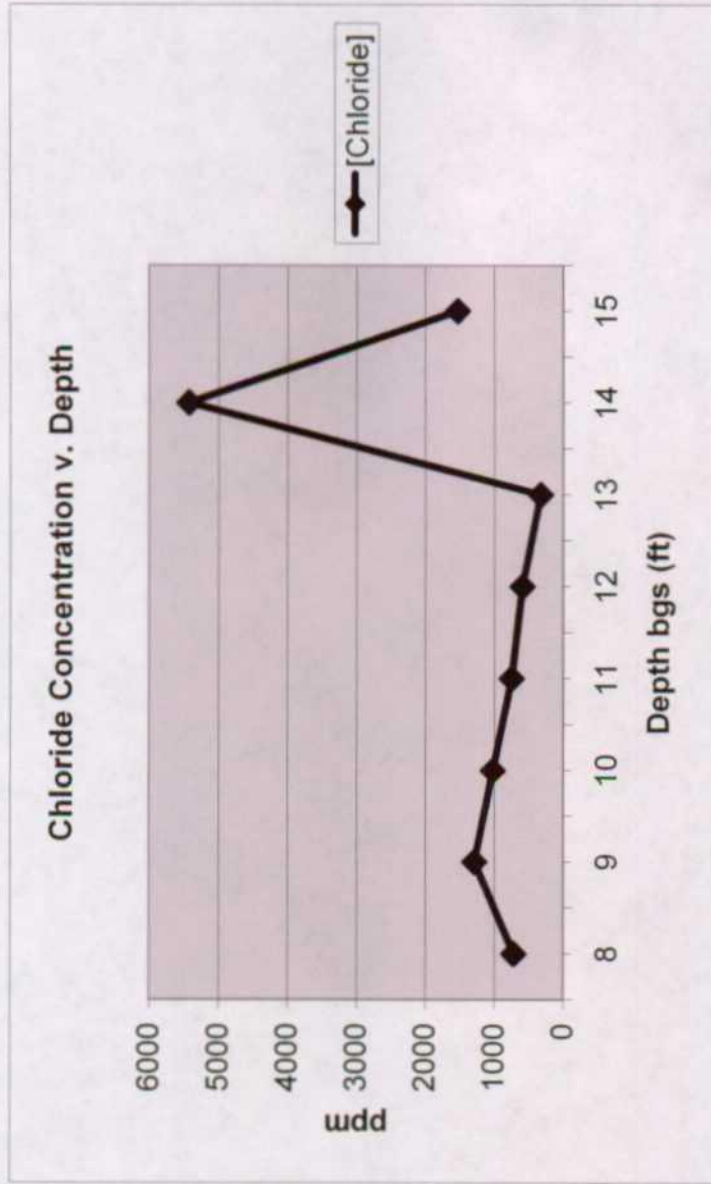

BD H-14-2

T22S, R37E

15 ft West of Junction

Depth bgs (ft)	[Cl ⁻] ppm
5	2909
6	2369
7	3958
8	2429
9	1529
10	1859
11	3358
12	4348
13	5998
14	8217
15	8997

Groundwater = 65 ft

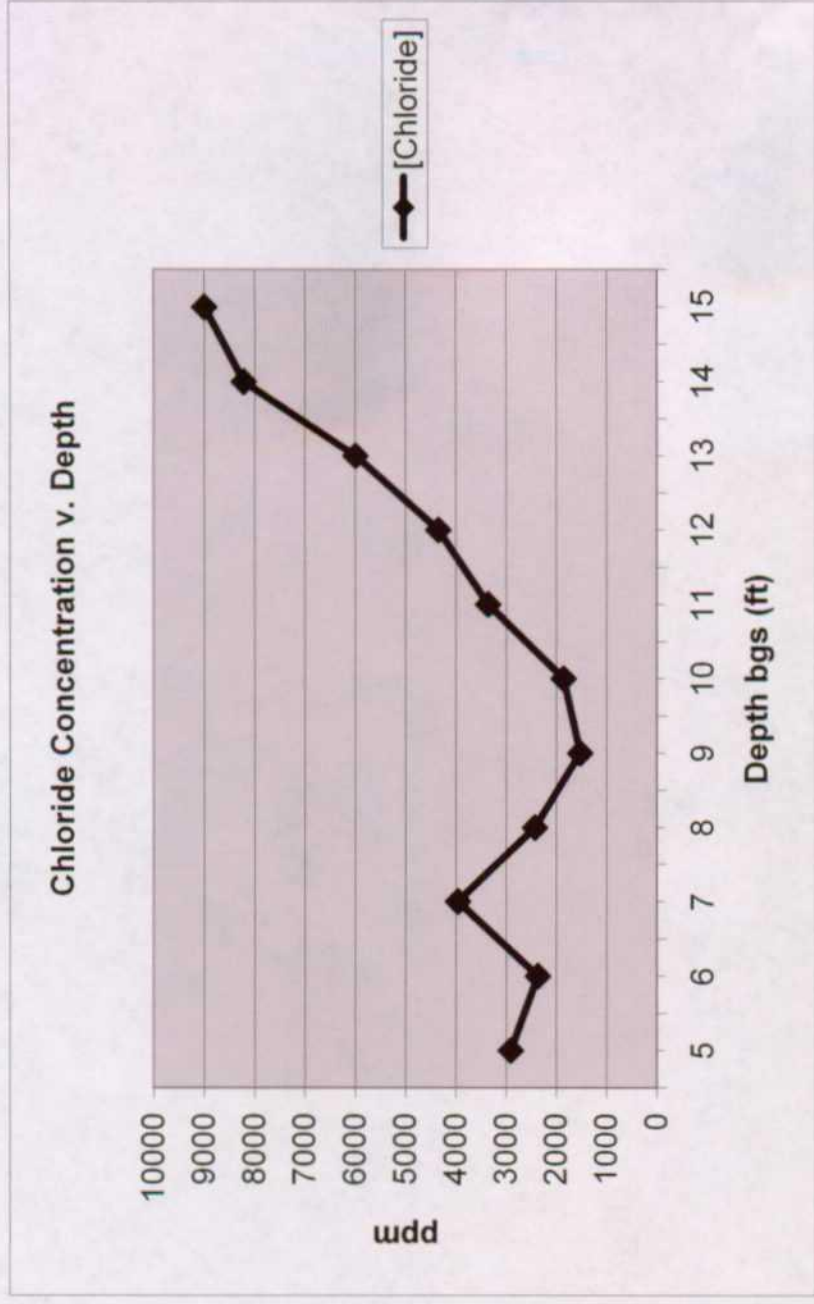



ARDINAL LABORATORIES

PHONE (325) 673-7001 • 2111 BEECHWOOD • ABILENE, TX 79603

PHONE (505) 393-2326 • 101 E. MARLAND • HOBBS, NM 88240

ANALYTICAL RESULTS FOR
RICE OPERATING CO.
ATTN: J. GATTS
122 W. TAYLOR
HOBBS, NM 88240
FAX TO:

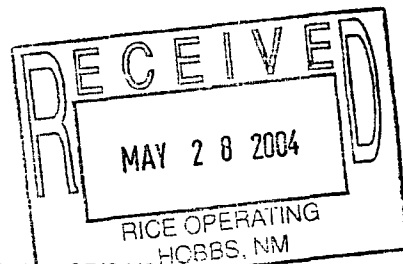

Receiving Date: 05/21/04
Reporting Date: 05/24/04
Project Number: NOT GIVEN
Project Name: H-14, H-14-1, H-14-2
Project Location: NOT GIVEN

Sampling Date: 05/21/04
Sample Type: SOIL
Sample Condition: COOL & INTACT
Sample Received By: HM
Analyzed By: BC/AH

LAB NUMBER	SAMPLE ID	GRO (C ₆ -C ₁₀) (mg/Kg)	DRO (>C ₁₀ -C ₂₈) (mg/Kg)	Cl* (mg/Kg)
		05/21/04	05/21/04	05/24/04
H8724-1	BOTT. COMP. AT 6' BGS	<10.0	<10.0	896
H8724-2	4 WALL COMP.	<10.0	<10.0	576
H8724-3	REMD. BACKFILL	<10.0	<10.0	240
Quality Control		794	752	990
True Value QC		800	800	1000
% Recovery		99.2	94.0	99.0
Relative Percent Difference		7.6	1.9	4.0

METHODS: TPH GRO & DRO: EPA SW-846 8015 M; Cl*: Std. Methods 4500-Cl*B

*Analyses performed on 1:4 w:v aqueous extracts.

Chemist

Date

H8724.XLS

PLEASE NOTE: **Liability and Damages.** Cardinal's liability and client's exclusive remedy for any claim arising, whether based in contract or tort, shall be limited to the amount paid by client for analyses. All claims, including those for negligence and any other cause whatsoever shall be deemed waived unless made in writing and received by Cardinal within thirty (30) days after completion of the applicable service. In no event shall Cardinal be liable for incidental or consequential damages, including, without limitation, business interruptions, loss of use, or loss of profits incurred by client, its subsidiaries, affiliates or successors arising out of or related to the performance of services hereunder by Cardinal, regardless of whether such claim is based upon any of the above-stated reasons or otherwise.

ARDINAL LABORATORIES, INC.

Page ____ of ____

3 + Card(nal cannot accept verbal changes. Please fax written changes to (915) 673-7020.

RICE OPERATING COMPANY
122 WEST TAYLOR
HOBBS, NEW MEXICO 88240
PHONE: (505) 393-9174 FAX: (505) 397-1471
VOC FIELD TEST REPORT FORM
MINI RAE PLUS CLASSIC PHOTOIONIZATION GAS DETECTOR

MODEL NO: PGM 761S
CALIBRATION GAS
GAS COMPOSITION: ISOBUTYLENE
AIR
LOT NO: 02-22-30
EXP. DATE: 11/20/04
METER READING
ACCURACY: 100.1

SERIAL NO: 104412
100 PPM
BALANCE
FILL DATE: 5/20/03
ACCURACY: +/- 290

SYSTEM	JUNCTION	UNIT	SECTION	TOWNSHIP	RANGE
BD	H-14 H-14-1 H-14-2	H	14	22	37

SAMPLE	PID RESULT	SAMPLE	PID RESULT
20' N. WALL	2.1		
16' S. WALL	1.3		
8' E. WALL	2.2		
30' W. WALL	4.6		
4 WALL COMP	6.7		
REMO BACKHILL	5.2		
Batt. Comp at 6' by	0.1		

I certify that I have calibrated the above instrument in accordance to the manufacture operation manual.

Signature

5/21/04
Date



LABORATORY TEST REPORT
PETTIGREW & ASSOCIATES, P.A.
1110 N. GRIMES
HOBBS, NM 88240
(505) 393-9827



DEBRA P. HICKS, P.E./L.S.I.
WILLIAM M. HICKS, III, P.E./P.S.

To: Rice Operating
Attn: Carolyn Haynes
122 W. Taylor
Hobbs, NM 88240

Material: Red Clay

Test Method: ASTM: D 2922

Project: Boot H-14, H-14-1, H-14-2

Date of Test: May 26, 2004

Depth: Finished Subgrade

Test No.	Location	Dry Density % Maximum	% Moisture	Depth
SG-1	Pit - 15' E. & 20' S. of the NW Corner	101.2	18.7	
SG-2	Pit - 20' W. & 10' N. of the SE Corner	105.0	16.5	

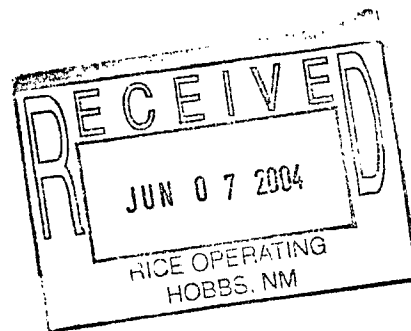

Control Density: 109.5
ASTM: D 698

Optimum Moisture: 16.6%

Required Compaction: 95%

Lab No.: 04 6661-6663

Copies To: Rice

PETTIGREW & ASSOCIATES

BY: S.E.T.