

3R - 22

**GENERAL
CORRESPONDENCE**

YEAR(S):

1995

District I
P.O. Box 1980, Hobbs, NM
District II
P.O. Drawer DD, Artesia, NM 88211
District III
1000 Rio Brazos Rd, Aztec, NM 87410

State of New Mexico
Energy, Minerals and Natural Resources Department

OIL CONSERVATION DIVISION
P.O. Box 2088
Santa Fe, New Mexico 87504-2088

80258
SUBMIT 1 COPY TO
APPROPRIATE
DISTRICT OFFICE
AND 1 COPY TO
SANTA FE OFFICE

GW above limits

PIT REMEDIATION AND CLOSURE REPORT

Operator: Amoco Production Company Telephone: (505) - 326-9200

Address: 200 Amoco Court, Farmington, New Mexico 87401

Facility Or: GCU com D 160
Well Name

Location: Unit or Qtr/Qtr Sec I Sec 27 T 4N R 12W County SAN JUAN

Pit Type: Separator ☒ Dehydrator ☐ Other ☐

Land Type: BLM ☐, State ☐, Fee ☐, Other COM. AGMT.

Pit Location: Pit dimensions: length 35', width 23', depth 23'
(Attach diagram)

Reference: wellhead ☒, other ☐

Footage from reference: 164'

Direction from reference: 60 Degrees ☐ East North ☐
☒ West of South ☒

Depth To Ground Water: Less than 50 feet (20 points)
(Vertical distance from 50 feet to 99 feet (10 points)
contaminants to seasonal Greater than 100 feet (0 Points) 20
high water elevation of
ground water)

Wellhead Protection Area: Yes (20 points)
(Less than 200 feet from a private No (0 points) 20
domestic water source, or; less than
1000 feet from all other water sources)

Distance To Surface Water: Less than 200 feet (20 points)
(Horizontal distance to perennial 200 feet to 1000 feet (10 points) 10
lakes, ponds, rivers, streams, creeks, Greater than 1000 feet (0 points)
irrigation canals and ditches)

RANKING SCORE (TOTAL POINTS): 50

Date Remediation Started: _____ Date Completed: 4/7/95

Remediation Method: Excavation ☒ Approx. cubic yards 675
(Check all appropriate sections) Landfarmed _____ Insitu Bioremediation _____
Other COMPOSTED

Remediation Location: Onsite ☒ Offsite _____
(ie. landfarmed onsite, name and location of offsite facility)

General Description Of Remedial Action: _____

Excavation - GROUNDWATER NOT PUMPED OUT OF PIT.Ground Water Encountered: No _____ Yes ☒ Depth 18'Final Pit: Sample location see Attached Documents

Closure Sampling:
(if multiple samples, attach sample results and diagram of sample locations and depths)

Sample depth 18'Sample date 4/5/95 Sample time 0830

Sample Results

Benzene (ppm) 0.0377Total BTEX (ppm) 0.3637

Field headspace (ppm) _____

TPH _____

Ground Water Sample: Yes ☒ No _____ (If yes, attach sample results)

I HEREBY CERTIFY THAT THE INFORMATION ABOVE IS TRUE AND COMPLETE TO THE BEST OF MY KNOWLEDGE AND BELIEF

DATE 4/7/95SIGNATURE B. ShawPRINTED NAME
AND TITLEBuddy D. Shaw
ENVIRONMENTAL COORDINATOR

TRAVEL NOTES: CALLOUT: 4/4/95 eve ONSITE: 4/5/95 morn.

OFF: (505) 325-8786



LAB: (505) 325-5667

AROMATIC VOLATILE ORGANICS

Attn: *Nelson Velez*
Company: *Blagg Engineering*
Address: *P.O. Box 87*
City, State: *Bloomfield, NM 87413*

Date: *4/6/95*
Lab ID: *2922*
Sample ID: *5792*
Job No. *2-1000*

Project Name: *GCU COM D 160*
Project Location: *PW 1 @ GW (18') - Sep. Pit*
Sampled by: *NV* Date: *4/5/95*
Analyzed by: *DLA* Date: *4/6/95*
Sample Matrix: *Water*

Time: *8:30*

Aromatic Volatile Organics

Component	Measured Concentration ug/L	Detection Limit Concentration ug/L
<i>Benzene</i>	<i>37.7</i>	<i>0.2</i>
<i>Toluene</i>	<i>44.7</i>	<i>0.2</i>
<i>Ethylbenzene</i>	<i>69.3</i>	<i>0.2</i>
<i>m,p-Xylene</i>	<i>190.5</i>	<i>0.2</i>
<i>o-Xylene</i>	<i>21.4</i>	<i>0.2</i>
	<i>TOTAL 363.7 ug/L</i>	

ND - Not Detectable

Method - SW-846 EPA Method 8020 Aromatic Volatile Organics by Gas Chromatography

Approved by: *Daly*
Date: *4/6/95*

P. O. BOX 2606 • FARMINGTON, NM 87499

80258

District I

P.O. Box 1980, Hobbs, NM

District II

P.O. Drawer DD, Artesia, NM 88211

District III

1000 Rio Brazos Rd, Aztec, NM 87410

State of New Mexico
Energy, Minerals and Natural Resources Department

OIL CONSERVATION DIVISION

P.O. Box 2088
Santa Fe, New Mexico 87504-2088SUBMIT 1 COPY TO
APPROPRIATE
DISTRICT OFFICE
AND 1 COPY TO
SANTA FE OFFICE

GW blue limits

PIT REMEDIATION AND CLOSURE REPORT

Operator: Amoco Production Company Telephone: (505) - 326-9200

Address: 200 Amoco Court, Farmington, New Mexico 87401

Facility Or: GCU com D 160

Well Name

Location: Unit or Qtr/Qtr Sec I Sec 27 T 29 N R 12 W County SAN JUANPit Type: Separator ___ Dehydrator ___ Other BLOWLand Type: BLM ___, State ___, Fee ___, Other Com. AGMT.Pit Location: Pit dimensions: length 82', width 56', depth 18'
(Attach diagram)Reference: wellhead X, other _____Footage from reference: 170'Direction from reference: 48 Degrees ___ East North ___
___ X West of South X

Depth To Ground Water:

(Vertical distance from
contaminants to seasonal
high water elevation of
ground water)Less than 50 feet (20 points)
50 feet to 99 feet (10 points)
Greater than 100 feet (0 Points) 20

Wellhead Protection Area:

(Less than 200 feet from a private
domestic water source, or; less than
1000 feet from all other water sources)Yes (20 points)
No (0 points) 20

Distance To Surface Water:

(Horizontal distance to perennial
lakes, ponds, rivers, streams, creeks,
irrigation canals and ditches)Less than 200 feet (20 points)
200 feet to 1000 feet (10 points) 10
Greater than 1000 feet (0 points) _____

RANKING SCORE (TOTAL POINTS):

50

Date Remediation Started: _____ Date Completed: 4/7/95

Remediation Method: Excavation ☒ Approx. cubic yards 3,000
(Check all appropriate sections) Landfarmed _____ Insitu Bioremediation _____
Other COMPOSTED

Remediation Location: Onsite ☒ Offsite _____
(ie. landfarmed onsite, name and location of offsite facility)

General Description Of Remedial Action: _____
Excavation - GROUNDWATER NOT PUMPED OUT OF PIT.

Ground Water Encountered: No _____ Yes ☒ Depth 17'

Final Pit: Sample location see Attached Documents
Closure Sampling: _____
(if multiple samples, attach sample results and diagram of sample locations and depths)

Sample depth 17'

Sample date 4/5/95 Sample time 0815

Sample Results

Benzene(ppm) 0.0867

Total BTEX(ppm) 1.6647

Field headspace(ppm) _____

TPH _____

Ground Water Sample: Yes ☒ No _____ (If yes, attach sample results)

I HEREBY CERTIFY THAT THE INFORMATION ABOVE IS TRUE AND COMPLETE TO THE BEST OF MY KNOWLEDGE AND BELIEF

DATE 4/7/95

SIGNATURE

B. Shaw

PRINTED NAME
AND TITLE

Buddy D. Shaw
Environmental Coordinator

CLIENT: <u>AMOCO</u>	BLAGG ENGINEERING, INC. P.O. BOX 87, BLOOMFIELD, NM 87413 (505) 632-1199	LOCATION NO: <u>80258</u> C.O.C. NO: <u>2922</u>
----------------------	--	---

FIELD REPORT: CLOSURE VERIFICATION	PAGE No: <u> 1 </u> of <u> 1 </u>
------------------------------------	---------------------------------------

LOCATION: NAME: <u>GCH CON D</u> WELL #: <u>160</u> PIT: <u>BLW</u>	DATE STARTED: <u>4/5/95</u>
QUAD/UNIT: <u>I</u> SEC: <u>27</u> TWP: <u>29N</u> RNG: <u>12W</u> PM: <u>NM</u> CNTY: <u>ST</u> ST: <u>OK</u>	DATE FINISHED: _____
QTR/FOOTAGE: <u>SE14</u> <u>SE14</u> CONTRACTOR: <u>P. VELAZQUEZ</u>	ENVIRONMENTAL SPECIALIST: <u>NV</u>

EXCAVATION APPROX. 82 FT. x 56 FT. x 18 FT. DEEP. CUBIC YARDAGE: 3,000
DISPOSAL FACILITY: ON-SITE REMEDIATION METHOD: COMPOSTED
LAND USE: RANGE / RESIDENTIAL LEASE: 5F-080224 FORMATION: DK

FIELD NOTES & REMARKS:		PIT LOCATED APPROXIMATELY <u>170</u> FT. <u>548W</u> FROM WELLHEAD.	
DEPTH TO GROUNDWATER: <u>< 50'</u>	NEAREST WATER SOURCE: <u>< 1000'</u>	NEAREST SURFACE WATER: <u>< 1000'</u>	
NMOCB RANKING SCORE: <u>50</u>	NMOCB TPH CLOSURE STD: <u>100</u> PPM	<div style="border: 1px solid black; padding: 5px;"> <p style="text-align: center;"><u>CHECK ONE :</u></p> <p><input checked="" type="checkbox"/> PIT ABANDONED</p> <p><input type="checkbox"/> STEEL TANK INSTALLED</p> </div>	
<u>SOIL AND EXCAVATION DESCRIPTION:</u>			

SIDEWALL SAMPLES UNOBTAINABLE DUE TO INACCESSIBILITY. SIDEWALLS APPEAR TO BE UNSTAINED (MUD. YELL. ORANGE SAND). NO SHEEN OBSERVED ON GROUNDWATER SURFACE. PIT NOT PUMPED. MONITOR WELL(S) TO BE INSTALLED AT A LATER DATE.

FIELD 418.1 CALCULATIONS

TIME	SAMPLE I.D.	LAB No:	WEIGHT (g)	mL. FREON	DILUTION	READING	CALC. ppm

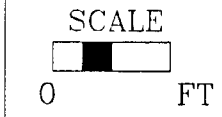

PIT PERIMETER

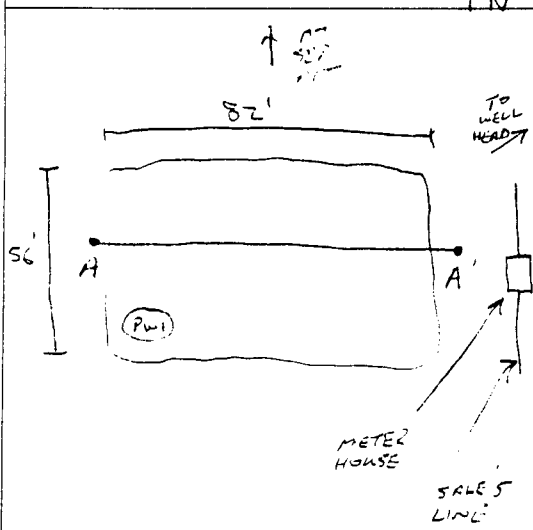

OVM RESULTS

[illegible]

PIT PROFILE

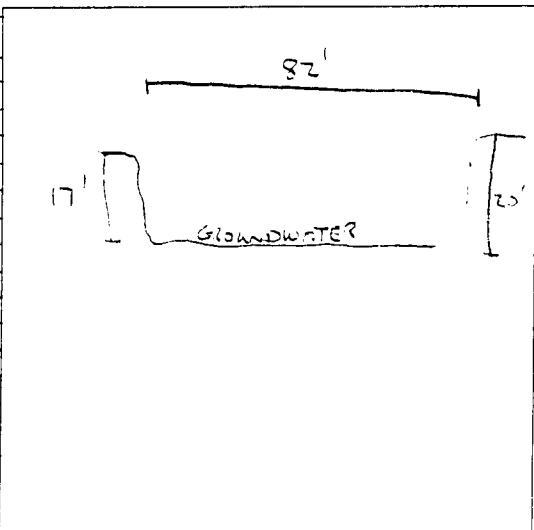

TRAVEL NOTES: CALLOUT: 4/4/95 ELE. ONSITE: 4/5/95 MORN.

OFF: (505) 325-8786

ON SITE
TECHNOLOGIES, LTD.

LAB: (505) 325-5667

AROMATIC VOLATILE ORGANICS

Attn: *Nelson Velez*
Company: *Blagg Engineering*
Address: *P.O. Box 87*
City, State: *Bloomfield, NM 87413*

Date: *4/6/95*
Lab ID: *2922*
Sample ID: *5791*
Job No. *2-1000*

Project Name: *GCU COM D 160*
Project Location: *PW 1 @ GW (17') - Blow Pit*
Sampled by: *NV* Date: *4/5/95*
Analyzed by: *DLA* Date: *4/6/95*
Sample Matrix: *Water*

Time: *8:15*

Aromatic Volatile Organics

Component	Measured Concentration ug/L	Detection Limit Concentration ug/L
<i>Benzene</i>	<i>86.7</i>	<i>0.2</i>
<i>Toluene</i>	<i>590.0</i>	<i>0.2</i>
<i>Ethylbenzene</i>	<i>158.3</i>	<i>0.2</i>
<i>m,p-Xylene</i>	<i>713.2</i>	<i>0.2</i>
<i>o-Xylene</i>	<i>116.4</i>	<i>0.2</i>
	TOTAL <i>1664.7 ug/L</i>	

ND - Not Detectable

Method - *SW-846 EPA Method 8020 Aromatic Volatile Organics by Gas Chromatography*

Approved by: *Ja G*

Date: *4/6/95*

UNITED STATES
DEPARTMENT OF THE INTERIOR
BUREAU OF LAND MANAGEMENT

FORM APPROVED
Budget Bureau No. 1004-0135
Expires: March 31, 1993

SUNDRY NOTICES AND REPORTS ON WELLS

Do not use this form for proposals to drill or to deepen or reentry to a different reservoir.
Use "APPLICATION FOR PERMIT—" for such proposals

SUBMIT IN TRIPLICATE

1. Type of Well

☐ Oil Well ☒ Gas Well ☐ Other

2. Name of Operator

Amoco Production Company

3. Address and Telephone No.

200 Amoco Court, Farmington, N.M. 87401 Tel: (505) 326-9200

4. Location of Well (Footage, Sec., T., R., M., or Survey Description)

NE/4 SE/4, SEC. 27, T29N, R12W, NMPM

5. Lease Designation and Serial No.

SF - 080224

6. If Indian, Allottee or Tribe Name

7. If Unit or CA Agreement Designation

SW 163

8. Well Name and No.

GCU Com D 160

9. API Well No.

3004507832

10. Field and Pool, or Exploratory Area

DAKOTA

11. County or Parish, State

SAN JUAN, NM

12. CHECK APPROPRIATE BOX(S) TO INDICATE NATURE OF NOTICE, REPORT, OR OTHER DATA

TYPE OF SUBMISSION

- ☐ Notice of Intent
☒ Subsequent Report
☐ Final Abandonment Notice

TYPE OF ACTION

- ☐ Abandonment
☐ Recompletion
☐ Plugging Back
☐ Casing Repair
☐ Altering Casing
☒ Other Pit closure
- ☐ Change of Plans
☐ New Construction
☐ Non-Routine Fracturing
☐ Water Shut-Off
☐ Conversion to Injection
☐ Dispose Water

(Note: Report results of multiple completion on Well Completion or Recompletion Report and Log form.)

13. Describe Proposed or Completed Operations (Clearly state all pertinent details, and give pertinent dates, including estimated date of starting any proposed work. If well is directionally drilled, give subsurface locations and measured and true vertical depths for all markers and zones pertinent to this work.)

Pit closure verification - see attached documentation.

BLOW PIT - ABANDONED

SEPARATOR PIT - STEEL TANK INSTALLED:

14. I hereby certify that the foregoing is true and correct

Signed B. Shaw

Title Enviro. Coordinator

Date 4/7/95

(This space for Federal or State office use)

Approved by

Title

Date

Conditions of approval, if any:

Title 18 U.S.C. Section 1001, makes it a crime for any person knowingly and willfully to make to any department or agency of the United States any false, fictitious or fraudulent statements or representations as to any matter within its jurisdiction.

*See instruction on Reverse Side