

**3R -** 40

# **REPORTS**

**DATE:**

1994

District I  
P.O. Box 1980, Hobbs, NM  
District II  
P.O. Drawer DD, Artesia, NM 88211  
District III  
1000 Rio Brazos Rd, Aztec, NM 87410

State of New Mexico  
Energy, Minerals and Natural Resources Department

OIL CONSERVATION DIVISION  
P.O. Box 2088  
Santa Fe, New Mexico 87504-2088

SUBMIT 1 COPY TO  
APPROPRIATE  
DISTRICT OFFICE  
AND 1 COPY TO  
SANTA FE OFFICE

*Denier*  
*GW close stds*

## PIT REMEDIATION AND CLOSURE REPORT

Operator: Amoco Production Company Telephone: (505) - 326-9200  
Address: 200 Amoco Court, Farmington, New Mexico 87401  
Facility Or: MCDANIEL GC BIE  
Well Name  
Location: Unit or Qtr/Qtr Sec F sec 26 T 29 R 10W County SAN JUAN  
Pit Type: Separator Dehydrator ☒ other \_\_\_\_\_  
Land Type: BLM \_\_\_\_\_, State \_\_\_\_\_, Fee \_\_\_\_\_, other COM. AGMT.

Pit Location: Pit dimensions: length 20', width 23', depth 4'  
(Attach diagram) Reference: wellhead ☒, other \_\_\_\_\_  
Footage from reference: 110'  
Direction from reference: 32 Degrees ☒ East North \_\_\_\_\_  
of  
\_\_\_\_\_ West South ☒

Depth To Ground Water: Less than 50 feet (20 points)  
(Vertical distance from 50 feet to 99 feet (10 points)  
contaminants to seasonal Greater than 100 feet (0 Points) 20  
high water elevation of  
ground water)

Wellhead Protection Area: Yes (20 points)  
(Less than 200 feet from a private No (0 points) 0  
domestic water source, or; less than  
1000 feet from all other water sources)

Distance To Surface Water: Less than 200 feet (20 points)  
(Horizontal distance to perennial 200 feet to 1000 feet (10 points)  
lakes, ponds, rivers, streams, creeks, Greater than 1000 feet (0 points) 20  
irrigation canals and ditches)

RANKING SCORE (TOTAL POINTS): 40

Date Remediation Started: \_\_\_\_\_ Date Completed: 12/30/94Remediation Method: Excavation ☒ Approx. cubic yards 50  
(Check all appropriate sections) Landfarmed ☒ Insitu Bioremediation \_\_\_\_\_

Other \_\_\_\_\_

Remediation Location: Onsite ☒ Offsite \_\_\_\_\_  
(ie. landfarmed onsite, name and location of offsite facility) \_\_\_\_\_

General Description Of Remedial Action: \_\_\_\_\_

Excavation GROUNDWATER PUMPED &amp; HAILED

Ground Water Encountered: No \_\_\_\_\_ Yes ☒ Depth 3'Final Pit: Sample location see Attached DocumentsClosure Sampling: MULTIPLE SAMPLES  
(if multiple samples, attach sample results and diagram of sample locations and depths)

Sample depth \_\_\_\_\_

Sample date \_\_\_\_\_ Sample time \_\_\_\_\_

Sample Results

Benzene(ppm) \_\_\_\_\_

Total BTEX(ppm) \_\_\_\_\_

Field headspace(ppm) \_\_\_\_\_

TPH \_\_\_\_\_

Ground Water Sample: Yes ☒ No \_\_\_\_\_ (If yes, attach sample results)

I HEREBY CERTIFY THAT THE INFORMATION ABOVE IS TRUE AND COMPLETE TO THE BEST OF MY KNOWLEDGE AND BELIEF

DATE 12/30/94

SIGNATURE

B. ShawPRINTED NAME  
AND TITLEBuddy D. Shaw  
Environmental Coordinator

LOCATION NO: B0191  
2329

C.O.C. NO: 2563

PAGE No: 1 of 1

DATE STARTED: 12/15/94  
DATE FINISHED: \_\_\_\_\_  
ENVIRONMENTAL  
SPECIALIST: NV

EXCAVATION APPROX. 20 FT. x 23 FT. x 4 FT. DEEP. CUBIC YARDAGE: 50  
DISPOSAL FACILITY: ON-SITE REMEDIATION METHOD: LANDFARMED  
LAND USE: RANGE LEASE: - FORMATION: OK

FIELD NOTES & REMARKS: PIT LOCATED APPROXIMATELY 110 FT. 532E FROM WELLHEAD.  
DEPTH TO GROUNDWATER: <50' NEAREST WATER SOURCE: >1000' NEAREST SURFACE WATER: <200'  
NMOC D RANKING SCORE: 40 NMOC D TPH CLOSURE STD: 100 PPM  
SOIL AND EXCAVATION DESCRIPTION: CHECK ONE :  
☒ PIT ABANDONED  
☐ STEEL TANK INSTALLED

COLLECTED WATER SAMPLE ONLY. NO APPARENT HC ODOR IN  
SAMPLE CONTAINER OR VISIBLE INDICATION. SLIGHT SHEEN IN  
GROUNDWATER OBSERVED IN TRENCH AREA. UNABLE TO COLLECT  
SOIL SAMPLE(S) FROM ANY SIDEWALLS. GROUNDWATER PUMPED  
BY TRIPLE S & HAULED.

FIELD 418.1 CALCULATIONS

| TIME | SAMPLE I.D. | LAB No: | WEIGHT (g) | mL. FREON | DILUTION | READING | CALC. ppm |
|------|-------------|---------|------------|-----------|----------|---------|-----------|
|      |             |         |            |           |          |         |           |
|      |             |         |            |           |          |         |           |
|      |             |         |            |           |          |         |           |

0 FT

| PIT PERIMETER | OVM RESULTS |
|---------------|-------------|
| 1             | 1           |
| 2             | 2           |
| 3             | 3           |
| 4             | 4           |
| 5             | 5           |
| 6             | 6           |
| 7             | 7           |
| 8             | 8           |
| 9             | 9           |
| 10            | 10          |
| 11            | 11          |
| 12            | 12          |
| 13            | 13          |
| 14            | 14          |
| 15            | 15          |
| 16            | 16          |
| 17            | 17          |
| 18            | 18          |
| 19            | 19          |
| 20            | 20          |
| 21            | 21          |
| 22            | 22          |
| 23            | 23          |
| 24            | 24          |
| 25            | 25          |
| 26            | 26          |
| 27            | 27          |
| 28            | 28          |
| 29            | 29          |
| 30            | 30          |
| 31            | 31          |
| 32            | 32          |
| 33            | 33          |
| 34            | 34          |
| 35            | 35          |
| 36            | 36          |
| 37            | 37          |
| 38            | 38          |
| 39            | 39          |
| 40            | 40          |
| 41            | 41          |
| 42            | 42          |
| 43            | 43          |
| 44            | 44          |
| 45            | 45          |
| 46            | 46          |
| 47            | 47          |
| 48            | 48          |
| 49            | 49          |
| 50            | 50          |
| 51            | 51          |
| 52            | 52          |
| 53            | 53          |
| 54            | 54          |
| 55            | 55          |
| 56            | 56          |
| 57            | 57          |
| 58            | 58          |
| 59            | 59          |
| 60            | 60          |
| 61            | 61          |
| 62            | 62          |
| 63            | 63          |
| 64            | 64          |
| 65            | 65          |
| 66            | 66          |
| 67            | 67          |
| 68            | 68          |
| 69            | 69          |
| 70            | 70          |
| 71            | 71          |
| 72            | 72          |
| 73            | 73          |
| 74            | 74          |
| 75            | 75          |
| 76            | 76          |
| 77            | 77          |
| 78            | 78          |
| 79            | 79          |
| 80            | 80          |
| 81            | 81          |
| 82            | 82          |
| 83            | 83          |
| 84            | 84          |
| 85            | 85          |
| 86            | 86          |
| 87            | 87          |
| 88            | 88          |
| 89            | 89          |
| 90            | 90          |
| 91            | 91          |
| 92            | 92          |
| 93            | 93          |
| 94            | 94          |
| 95            | 95          |
| 96            | 96          |
| 97            | 97          |
| 98            | 98          |
| 99            | 99          |
| 100           | 100         |

# PIT PROFILE

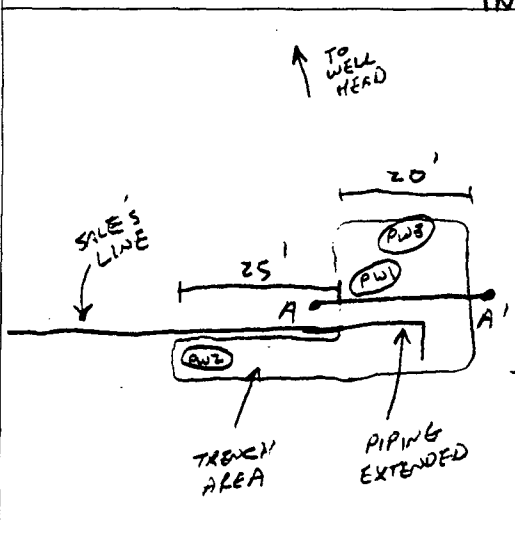
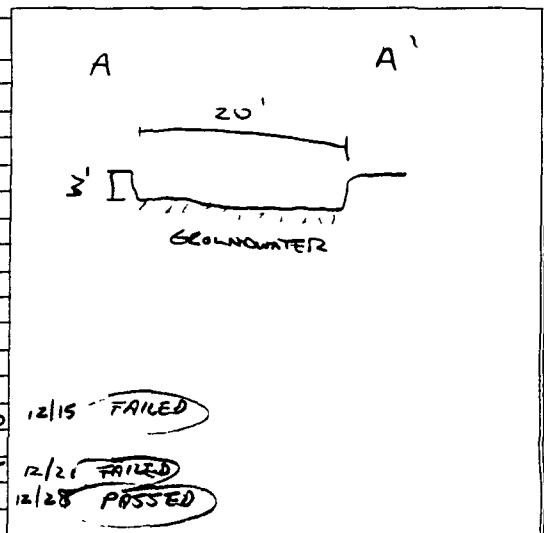
[illegible]

TRAVEL NOTES: CALLOUT: 12/14/94 ONSITE: 12/15/94



OFF: (505) 325-8786

LAB: (505) 325-5667

**AROMATIC VOLATILE ORGANICS**

Attn: *Nelson Velez*  
Company: *Blagg Engineering*  
Address: *P.O. Box 87*  
City, State: *Bloomfield, NM 87413*

Date: *12/16/94*  
Lab ID: *2329*  
Sample ID: *4403*  
Job No. *2-1000*

Project Name: *McDaniel GC B 1 E*  
Project Location: *PW 1 @ GW (3') - Dehy Pit*  
Sampled by: *NV* Date: *12/15/94*  
Analyzed by: *DLA* Date: *12/16/94*  
Sample Matrix: *Water*

Time: *14:20*

**Aromatic Volatile Organics**

| <b>Component</b>    | <b>Measured<br/>Concentration ug/L</b> | <b>Detection Limit<br/>Concentration ug/L</b> |
|---------------------|--|---|
| <i>Benzene</i>      | <i>130.9</i>                           | <i>0.2</i>                                    |
| <i>Toluene</i>      | <i>84.4</i>                            | <i>0.2</i>                                    |
| <i>Ethylbenzene</i> | <i>30.7</i>                            | <i>0.2</i>                                    |
| <i>m,p-Xylene</i>   | <i>284.6</i>                           | <i>0.2</i>                                    |
| <i>o-Xylene</i>     | <i>53.7</i>                            | <i>0.2</i>                                    |
|                     | <i>TOTAL 584.4 ug/L</i>                |   |

*ND - Not Detectable*

**Method** - SW-846 EPA Method 8020 Aromatic Volatile Organics by Gas Chromatography

Approved by: *[Signature]*  
Date: *12/17/94*



OFF: (505) 325-8786

LAB: (505) 325-5667

**AROMATIC VOLATILE ORGANICS**

Attn: *Nelson Velez*  
Company: *Blagg Engineering*  
Address: *P.O. Box 87*  
City, State: *Bloomfield, NM 87413*

Date: *12/22/94*  
Lab ID: *2563*  
Sample ID: *4480*  
Job No. *2-1000*

Project Name: *McDaniel GC B 1 E*  
Project Location: *PW 2 @ GW ( 3' ) - Dehy Pit*  
Sampled by: *NV* Date: *12/21/94*  
Analyzed by: *DLA* Date: *12/22/94*  
Sample Matrix: *Water*

Time: *9:25*

**Aromatic Volatile Organics**

| <b>Component</b>    | <b>Measured<br/>Concentration ug/L</b> | <b>Detection Limit<br/>Concentration ug/L</b> |
|---------------------|--|---|
| <i>Benzene</i>      | <i>112.6</i>                           | <i>0.2</i>                                    |
| <i>Toluene</i>      | <i>36.1</i>                            | <i>0.2</i>                                    |
| <i>Ethylbenzene</i> | <i>24.0</i>                            | <i>0.2</i>                                    |
| <i>m,p-Xylene</i>   | <i>308.8</i>                           | <i>0.2</i>                                    |
| <i>o-Xylene</i>     | <i>57.4</i>                            | <i>0.2</i>                                    |
|                     | <b>TOTAL</b> <i>539.0 ug/L</i>         |   |

*ND - Not Detectable*

**Method** - *SW-846 EPA Method 8020 Aromatic Volatile Organics by Gas Chromatography*

Approved by: *[Signature]*  
Date: *12/22/94*

P. O. BOX 2606 • FARMINGTON, NM 87499



OFF: (505) 325-8786

LAB: (505) 325-5667

**AROMATIC VOLATILE ORGANICS**

Attn: *Nelson Velez*  
Company: *Blagg Engineering*  
Address: *P.O. Box 87*  
City, State: *Bloomfield, NM 87413*

Date: *12/30/94*  
Lab ID: *2515*  
Sample ID: *4550*  
Job No. *2-1000*

Project Name: *McDaniel GC B 1 E*  
Project Location: *PW 3 @ GW ( 3' ) - Dehy Pit*  
Sampled by: *NV* Date: *12/28/94*  
Analyzed by: *DLA* Date: *12/30/94*  
Sample Matrix: *Water*

Time: *14:00*

**Aromatic Volatile Organics**

| <b>Component</b>    | <b>Measured<br/>Concentration ug/L</b> | <b>Detection Limit<br/>Concentration ug/L</b> |
|---------------------|--|---|
| <i>Benzene</i>      | <i>0.8</i>                             | <i>0.2</i>                                    |
| <i>Toluene</i>      | <i>0.5</i>                             | <i>0.2</i>                                    |
| <i>Ethylbenzene</i> | <i>0.3</i>                             | <i>0.2</i>                                    |
| <i>m,p-Xylene</i>   | <i>4.2</i>                             | <i>0.2</i>                                    |
| <i>o-Xylene</i>     | <i>0.8</i>                             | <i>0.2</i>                                    |
|                     | <b>TOTAL</b>                           |   |
|                     | <i>6.7 ug/L</i>                        |   |

*ND - Not Detectable*

**Method** - SW-846 EPA Method 8020 Aromatic Volatile Organics by Gas Chromatography

Approved by:

Date:

*[Signature]*  
*12/30/94*

P. O. BOX 2606 • FARMINGTON, NM 87499

- TECHNOLOGY BLENDING INDUSTRY WITH THE ENVIRONMENT -

UNITED STATES  
DEPARTMENT OF THE INTERIOR  
BUREAU OF LAND MANAGEMENTFORM APPROVED  
Budget Bureau No. 1004-0135  
Expires: March 31, 1993

## SUNDRY NOTICES AND REPORTS ON WELLS

Do not use this form for proposals to drill or to deepen or reentry to a different reservoir.  
Use "APPLICATION FOR PERMIT—" for such proposals

## SUBMIT IN TRIPLICATE

|  |  |
|--|--|
| 1. Type of Well<br><input type="checkbox"/> Oil Well <input checked="" type="checkbox"/> Gas Well <input type="checkbox"/> Other | 5. Lease Designation and Serial No.                |
| 2. Name of Operator<br>Amoco Production Company  | 6. If Indian, Allottee or Tribe Name               |
| 3. Address and Telephone No.<br>200 Amoco Court, Farmington, N.M. 87401 Tel: (505) 326-9200                                      | 7. If Unit or (CA) Agreement Designation<br>SW 217 |
| 4. Location of Well (Footage, Sec., T., R., M., or Survey Description)<br>SE 1/4 NW 1/4, SEC. 26, T 29 N, R 10 W, NMPM           | 8. Well Name and No.<br>McDANIEL GC BIE            |
|  | 9. API Well No.<br>3004523855                      |
|  | 10. Field and Pool, or Exploratory Area<br>DAKOTA  |
|  | 11. County or Parish, State<br>SAN JUAN, NM        |

## 12. CHECK APPROPRIATE BOX(s) TO INDICATE NATURE OF NOTICE, REPORT, OR OTHER DATA

| TYPE OF SUBMISSION                                    | TYPE OF ACTION  |
|---|---|
| <input type="checkbox"/> Notice of Intent             | <input type="checkbox"/> Abandonment                  |
| <input checked="" type="checkbox"/> Subsequent Report | <input type="checkbox"/> Recompletion                 |
| <input type="checkbox"/> Final Abandonment Notice     | <input type="checkbox"/> Plugging Back                |
|   | <input type="checkbox"/> Casing Repair                |
|   | <input type="checkbox"/> Altering Casing              |
|   | <input checked="" type="checkbox"/> Other Pit closure |
|   | <input type="checkbox"/> Change of Plans              |
|   | <input type="checkbox"/> New Construction             |
|   | <input type="checkbox"/> Non-Routine Fracturing       |
|   | <input type="checkbox"/> Water Shut-Off               |
|   | <input type="checkbox"/> Conversion to Injection      |
|   | <input type="checkbox"/> Dispose Water                |

(Note: Report results of multiple completion on Well Completion or Recompletion Report and Log form.)

13. Describe Proposed or Completed Operations (Clearly state all pertinent details, and give pertinent dates, including estimated date of starting any proposed work. If well is directionally drilled, give subsurface locations and measured and true vertical depths for all markers and zones pertinent to this work.)

Pit closure verification - see attached documentation.

DEHYDRATOR PIT - ABANDONED

14. I hereby certify that the foregoing is true and correct

Signed

B. Shaw

Title

Enviro. Coordinator

Date

12/30/94

(This space for Federal or State office use)

Approved by

Title

Date

Conditions of approval, if any: