

**3R - 223**

---

# **REPORTS**

**DATE:**

**2000**

---



**Certified Mail:** #7000 1670 0012 7260 6739

February 26, 2001

Mr. William C. Olson  
New Mexico Oil Conservation Division  
1220 St. Francis Dr.  
Santa Fe, NM 87504

**RECEIVED**

FEB 28 2001

ENVIRONMENTAL BUREAU  
OIL CONSERVATION DIVISION

**RE: 2000 Pit Project Annual Groundwater Report**

Dear Mr. Olson:

In accordance with reporting requirements, El Paso Field Services (EPFS) has enclosed annual updates for the 32 remaining groundwater impacted sites that were identified during our pit closure project of 1994 / 1995.

Of the 32 reports (Volumes 1-4), EPFS hereby requests closure of six sites. The six sites EPFS is requesting closure on are presented in one separate binder entitled "San Juan Basin Pit Closures, El Paso Field Services, Pit Closure Reports". Four of the six sites were submitted in last years report and a decision has not been made on closure. The remaining two sites have been submitted in previous years and denied closure.

The Jaquez Com. C #1 and Jaquez Com. E #1 site is not included in with this years report and will be submitted by the required deadline of April 1, 2001

EPFS has also included for your information six Navajo sites in a separate binder.

If you have any questions concerning the enclosed reports or closure requests, please call me at (505) 599-2124.

Sincerely,

A handwritten signature in dark ink, appearing to read 'Scott T. Pope', with a long horizontal flourish extending to the right.

Scott T. Pope P.G.  
Senior Environmental Scientist

xc: Mr. Denny Foust, NMOCD, Aztec - w / enclosures; Certified Mail # 7000 1670 0012 7260 6722  
Mr. Bill Liesse, BLM - w / enclosures (federal sites only), Certified Mail # 7000 1670 0012 7260 6715

**SAN JUAN BASIN PIT CLOSURES**  
**San Juan Basin, New Mexico**

**El Paso Field Services**  
**Pit Project Groundwater Report**  
**Annual Report**  
**Volume III**

**March 2001**

**Prepared For**

**El Paso Field Services**  
**Farmington, New Mexico**

**Project 62800398**



243

# EPFS GROUNDWATER PITS

## 2000 ANNUAL GROUNDWATER REPORT

---

MILES FEDERAL #1A (CH)  
Meter/Line ID - 94810

---

### SITE DETAILS

Legals - Twn: 26N      Rng: 7W      Sec: 5      Unit: F  
NMOCD Hazard Ranking: 40      Land Type: FEDERAL  
Operator: LOUIS DREYFUS NATURAL GAS

---

### PREVIOUS ACTIVITIES

Site Assessment: May-94      Excavation: Jun-94 (50 cy)      Soil Boring: Sep-95  
Monitor Well: Sep-95      Geoprobe: Feb-97      Additional Monitor Wells: Oct-99

### 2000 ACTIVITIES

Phase Separated Hydrocarbon (PSH) Removal - PSH removal from MW-1 was continued in 2000.

### SUMMARY TABLES

Groundwater level data and PSH recovery data are presented in Table 1.

### SITE MAP

A site map showing the groundwater gradient is presented as Figure 1.

### GEOLOGIC LOGS AND WELL COMPLETION DIAGRAMS

There were no drilling activities at this site during 2000.

### DISPOSITION OF GENERATED WASTES

There were no wastes generated at this site in 2000.

### ISOCONCENTRATION MAPS

Isoconcentration maps were not generated for this site.

### CONCLUSIONS

Monitor wells were evaluated for presence of PSH in October of 2000. Product thickness in MW-1 was 0.62 feet. Product was not recovered. Product was not detected in MW-2 or MW-3, and historical analytical data for these wells have shown only trace levels of hydrocarbon constituents.

Based on groundwater elevations observed in monitor wells MW-1, MW-2, and MW-3 the groundwater gradient is to the west-northwest. A downgradient monitor well is considered necessary but impracticable due to the proximity of MW-1 and the former pit to the edge of the mesa. EPFS has made an effort to drill between the former pit and the mesa edge and was unable due to the steep slope down to the gully below.

# **EPFS GROUNDWATER PITS**

## **2000 ANNUAL GROUNDWATER REPORT**

---

### **RECOMMENDATIONS**

- Continue quarterly monitoring of PSH thickness.
- If PSH persist, install a passive skimmer for product removal.
- Following removal of PSH, sample annually until BTEX levels are below New Mexico groundwater standards, then sample quarterly for closure.

Table 1

March 2001

| Meter/Line # | Location/Line Name     | Date    | MW | Depth to Product | Depth to Water | Product Thickness | Volume Removed Gallons | Cumulative Gallons |
|--------------|------------------------|---------|----|------------------|----------------|-------------------|------------------------|--------------------|
| 94810        | MILES FEDERAL #1A (CH) | 10/5/00 | 1  | 31.24            | 31.86          | 0.62              | 0                      | 0                  |
| 94810        | MILES FEDERAL #1A (CH) | 10/5/00 | 2  | 0                | 28.82          | 0                 | 0                      | 0                  |
| 94810        | MILES FEDERAL #1A (CH) | 10/5/00 | 3  | 0                | 28.84          | 0                 | 0                      | 0                  |

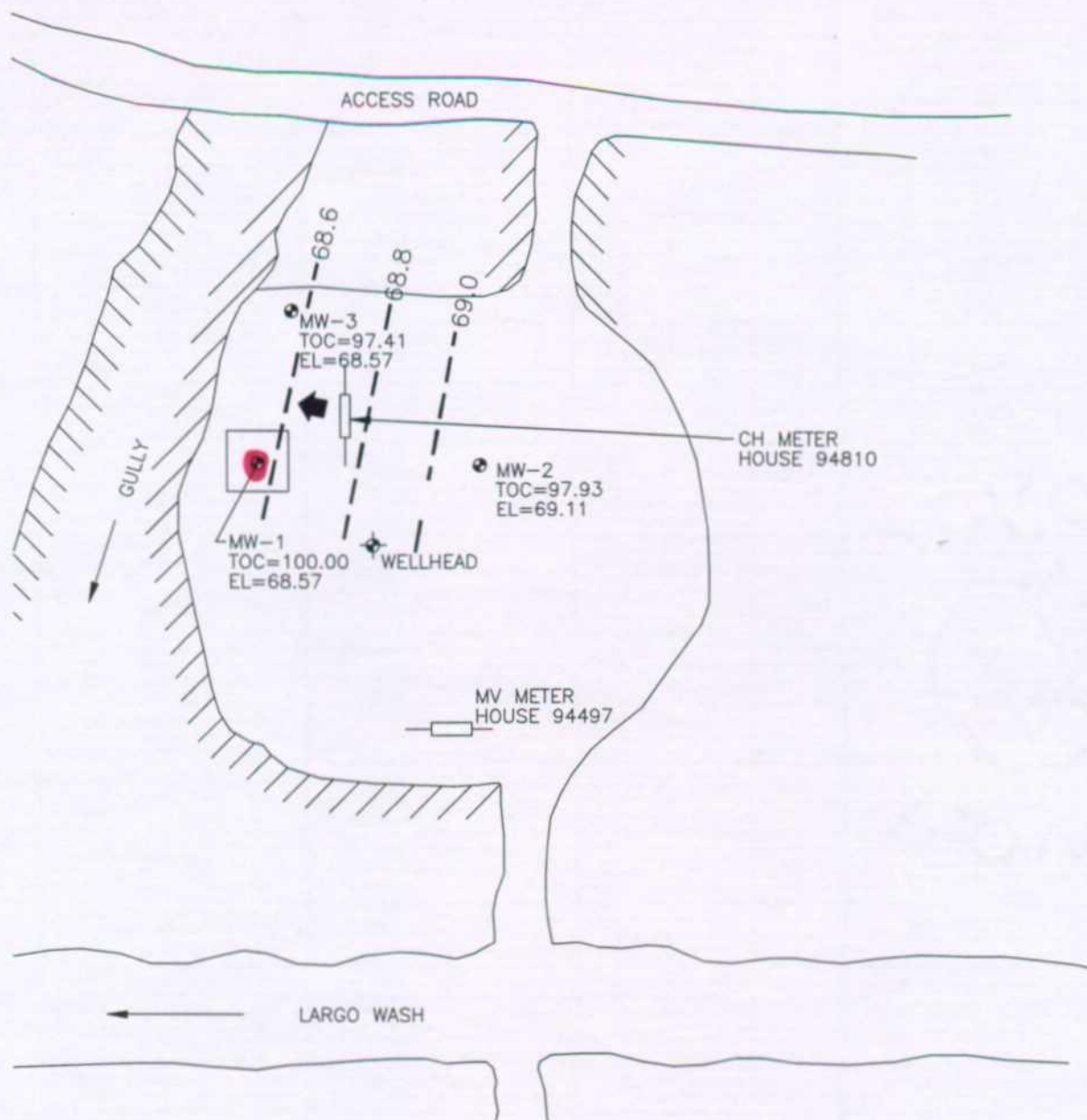

# LEGEND

- MW-1 APPROXIMATE MONITORING WELL LOCATION AND NUMBER
- TOC TOP OF CASING ELEVATION
- EL GROUNDWATER ELEVATION
- 75.0 GROUNDWATER POTENTIOMETRIC SURFACE
- GROUNDWATER GRADIENT

NOT TO SCALE



TITLE:  
 MILES FED 1A (CH)  
 METER 94810  
 OCTOBER 5, 2000

|         |       |
|---------|-------|
| DWN:    | DES.: |
| TMM     | LW    |
| CHKD:   | APPD: |
| LW      | MN    |
| DATE:   | REV.: |
| 1/31/01 | 0     |

PROJECT NO.: 62800219  
 EPFS GW PITS

FIGURE 1