

NSP-35
Amel Dec 12

RECEIVED
NOV 10 1954

Drawer D
Monument, New Mexico
November 9, 1954

New Mexico Oil Conservation Commission
Box 871
Santa Fe, New Mexico

Re: Application for Exception to Rule
5 (a) of Order No. R-520 for
Amerada Weir No. 7, Monument Pool

Gentlemen:

By this letter of application Amerada Petroleum Corporation wishes to state the following:

- (a) That Amerada Petroleum Corporation Weir No. 7 located 660 feet FSL and 1980 feet FEL of Section 26, Township 19-S, Range 36-E is a closed-in well completed November 25, 1936, in the Monument Pool.
- (b) That the applicant proposes to recomplete the subject well in the Eumont Gas Pool.
- (c) That the applicant proposes to assign this well a non-standard gas unit consisting of 40 acres which is the SW/4 of the SE/4 of Section 26, Township 19-S, Range 36-E.
- (d) That the proposed non-standard gas proration unit lies wholly within a single governmental section.
- (e) That the proposed non-standard gas proration unit may reasonably be presumed to be productive of gas.
- (f) That the proposed non-standard gas proration unit does not exceed 5280 feet in length or width.
- (g) That by copy of this letter of application all operators owning interests (1) in the subject section and (2) within 1500 feet of the subject well of the proposed gas unit are notified by registered mail of this proposed non-standard gas proration unit.

Therefore, Amerada Petroleum Corporation requests that through provisions of Rule 5 (b) of Order No. R-520, the Secretary of the Oil

Conservation Commission approve the subject non-standard gas proration unit as proposed in this application.

Respectfully submitted,

By: D. C. Capps
D. C. Capps
District Superintendent

DCC/WGA/df

cc: Gulf Oil Corporation
Box 1667
Hobbs, New Mexico

Continental Oil Company
Box 427
Hobbs, New Mexico

The Texas Company
Box 1270
Midland, Texas

The Ohio Oil Company
Box 1607
Hobbs, New Mexico

Sun Oil Company
Box 1861
Midland, Texas

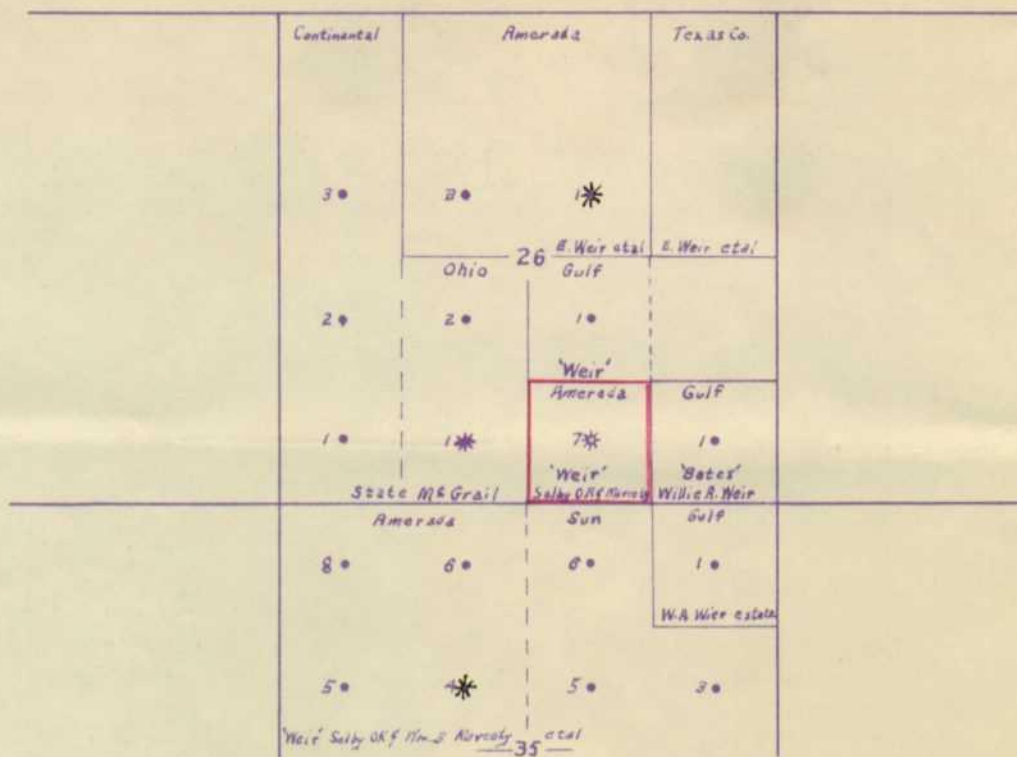

AMERADA PETROLEUM CORPORATION

'Weir' Selby O.R. & Wm. B. Maveety et al Lease
SW/4 of the SE/4 Sec. 26, T19-S, R36-E
Lea County, New Mexico

Scale 1" 2000'