

3R - 316

REPORTS

DATE:

JAN. 27, 2000

Public Service Company
of New Mexico
603 W. Elm - P.O. Box 4750
Farmington, NM 87499
505 950-1997
Fax 505 325-7365

RECEIVED

FEB 01 2000

ENVIRONMENTAL BUREAU
OIL CONSERVATION DIVISION



January 27, 2000

Oil Conservation Division
Attention: Bill Olson
2040 South Pacheco
Santa Fe, NM 87505

Subject: OCD Closure Reports - 4th Reporting Quarter, 1999

Dear Mr. Olson:

PNM Environmental Services is submitting a closure report to the Oil Conservation Division one groundwater site, Florance #44. I have provided copies of the closure to Denny Foust for his information.

I have also enclosed copies of closures submitted to Denny Foust for his approval for the sites listed below:

- | | | |
|--------------------------------|------------------------------|------------------------------------|
| 1. Cole A #1E | 32. New Mexico Federal N #1E | 63. Summit #9 |
| 2. Culpepper Martin #4 Energen | 33. New Mexico Federal N #3E | 64. Summit Viles #5 |
| 3. Culpepper Martin #5 RH | 34. Newman #1E | 65. Taliaferro #2 |
| 4. East #5A | 35. Newman #1E Drip | 66. Taliaferro #3 |
| 5. EH Pipken #5E | 36. Nye Federal #1M | 67. Taliaferro #3E |
| 6. Elledge Federal #34-11 | 37. Oliver #3 | 68. Taliaferro #4 |
| 7. Grenier #14 | 38. P & R #1 Drip | 69. Taliaferro #4E |
| 8. Grenier #19 | 39. Payne #1 (PRI) | 70. Taliaferro #5M |
| 9. Grenier #1A | 40. Payne #4 | 71. Taliaferro #6 |
| 10. Grenier #23 | 41. Pritchard #4 | 72. Taliaferro #7 |
| 11. Grenier A #1A Dehy | 42. Pritchard #4A | 73. Thompson #10 |
| 12. Grenier A #7 | 43. R.P. Hargrave F #2 Drip | 74. Thompson #11 |
| 13. Grenier B #6 Drip | 44. Rawson #2 | 75. Thompson #12 |
| 14. Hanks #11E | 45. Reid #20 Dakota | 76. Thompson #2A |
| 15. Hanks #13 East | 46. Reid #20 Drip | 77. Thompson #3 |
| 16. Hanks #13 West | 47. Reid A #1M | 78. Thompson #5 |
| 17. Hanks #13E | 48. Reid A #2 | 79. Thompson #7 |
| 18. Hanks #14 | 49. Richardson #12A | 80. Thompson #7A Drip |
| 19. Lybrook Line Drip | 50. Richardson #2A | 81. Thompson #9 |
| 20. Mangum #4E | 51. Richardson #9E | 82. Thompson #9A |
| 21. McClanahan #20E | 52. Sadie West #1 | 83. Ute Indian A #2 Drip |
| 22. McCord #1E | 53. Sanchez #3A | 84. Ute Indian A #21 Drip |
| 23. McCord #4 | 54. Sanchez #3E | 85. Whitley #3 |
| 24. McCord #4E | 55. Senter #1M | 86. Whitley #5 |
| 25. McCord #5 | 56. Southern Union #1M | 87. Whitley #5 Drip |
| 26. McCord #5E | 57. Southern Union #1M Drip | 88. Whitley #7E |
| 27. McCord B #1 | 58. Starr #1M | 89. Whitley #8 |
| 28. McDaniel C #1 | 59. State A Gas Com #1 | 90. Whitley #9 |
| 29. McGrath C #1 | 60. Summit #6 | 91. Wright State Com #1E South Pit |
| 30. Montoya Gas Com #1 | 61. Summit #6E | |
| 31. Nance #1 | 62. Summit #6E Drip | |

If you have any questions, please call me at 324-3764.

Sincerely,

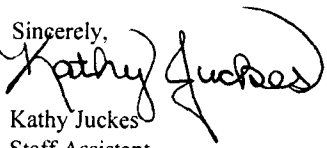
Kathy Juckes
Staff Assistant

cc: Denny Foust

District I
P.O. Box 1980, Hobbs, NM

District II
P.O. Drawer DD, Artesia, NM 88221

District III
1000 Rio Brazos Rd, Aztec, NM 87410

State of New Mexico
Energy, Minerals and Natural Resources Department

OIL CONSERVATION DIVISION

2040 South Pacheco Street
Santa Fe, New Mexico 87505

SUBMIT 1 COPY TO
APPROPRIATE
DISTRICT OFFICE
AND 1 COPY TO
SANTA FE OFFICE

PIT REMEDIATION AND CLOSURE REPORT

Operator: PNM Gas Services (Amoco) Telephone: 324-3764

Address: 603 W. Elm Street Farmington, NM 87401

Facility or Well Name: Florance #44

Location: Unit H Sec 31 T 30 N R 8 W County San Juan

Pit Type: Separator ☐ Dehydrator ☒ Other

Land Type: BLM ☒ State ☐ Fee ☐ Other

Pit Location: Pit dimensions: length 20 ' width 20 ' depth 3 '

(Attach diagram) Reference: wellhead ☒ other

Footage from reference: 96 '

Direction from reference: 65 Degrees ☒ East North ☒
of ☐ West South ☐

Depth to Ground Water:

(Vertical distance from contaminants to
seasonal high water elevation of ground
water)

Less than 50 feet	(20 points)	
50 feet to 99 feet	(10 points)	
Greater than 100 feet	(0 points)	<u>20</u>

Wellhead Protection Area:

(Less than 200 feet from a private
domestic water source, or; less than 1,000
feet from all other water sources)

Yes	(20 points)	
No	(0 points)	<u>0</u>

Distance to Surface Water:

(Horizontal distance to perennial lakes,
ponds, rivers, streams, creeks, irrigation
canals and ditches)

Less than 200 feet	(20 points)	
200 feet to 1,000 feet	(10 points)	
Greater than 1,000 feet	(0 points)	<u>0</u>

RANKING SCORE (TOTAL POINTS) : 20

Florance #44

Date Remediation Started: 05/13/1996

Date Completed: 05/17/1996

Remediation Method:

Excavation

☒

Approx. Cubic Yard

582

(Check all appropriate sections)

Landfarmed

☒

Amount Landfarmed (cubic yds)

582

Other

Remediation Location:

Onsite

X - 120 cu yds

Offsite

Florance 44E - 462 cu yds.

(i.e., landfarmed onsite, name and location of offsite facility)

Backfill Material Location:

General Description of Remedial Action:

Excavated contaminated soil to a pit size of 25' X 37' X 17' and landfarmed soil on location and on Florance 44E within bermed areas at a depth of 6" to 12". Soil was aerated by disking/plowing until soil met regulatory levels.

Ground Water Encountered:

No

☐

Yes

☒

Depth

14'

Final Pit Closure Sampling:

Sample Location

Composite - four side walls and center of pit bottom.

(if multiple samples, attach sample result and diagram of sample locations and depths.)

Sample depth

17'

Sample date

05/14/1996

Sample time

3:15:00 PM

Sample Results

Benzene (ppm)

0.0259

Total BTEX (ppm)

1.4807

Field headspace (ppm)

TPH (ppm)

< 5.00

Method

8015A

Vertical Extent (ft)

Risk Analysis form attached Yes

☐

No

☐

Ground Water Sample:

Yes

☒

No

☐

(If yes, see attached Groundwater Site Summary Report)

I HEREBY CERTIFY THAT THE INFORMATION ABOVE IS TRUE AND COMPLETE TO THE BEST OF MY KNOWLEDGE AND MY BELIEF

DATE January 24, 2000

SIGNATURE

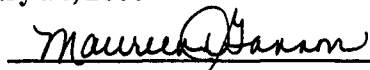

PRINTED NAME Maureen Gannon
AND TITLE Project Manager

N

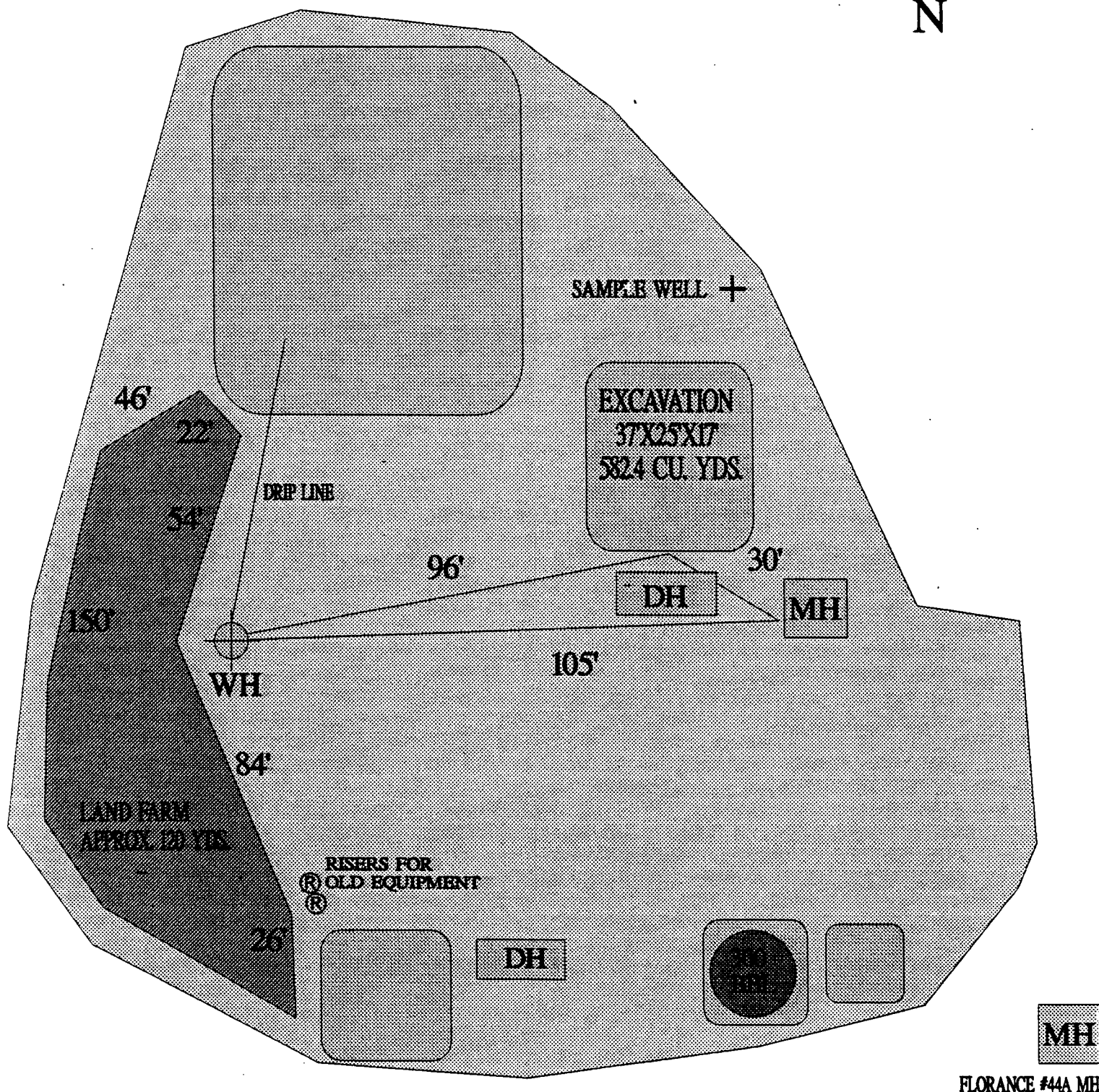

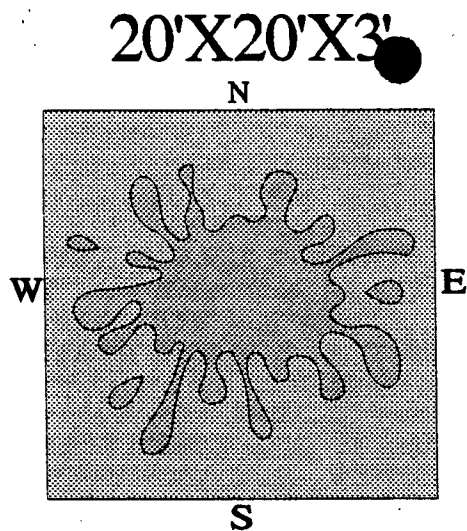

PIT AT START

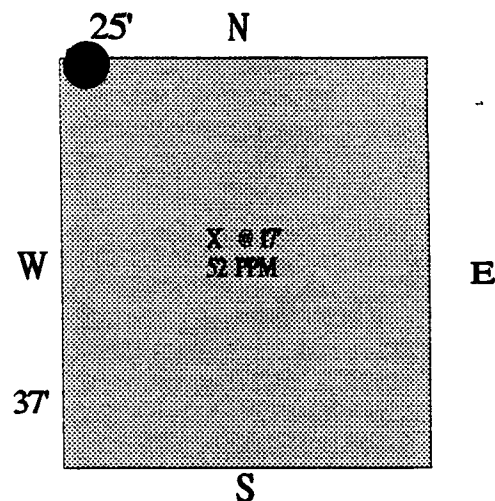

COMPOSITE SAMPLE TAKEN
OF NORTH, SOUTH, EAST, &
WEST WALLS OF EXCAVATION.

SAMPLE # 9605011515

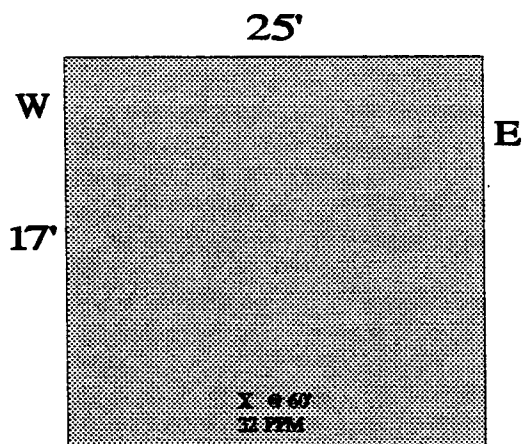

NORTH WALL

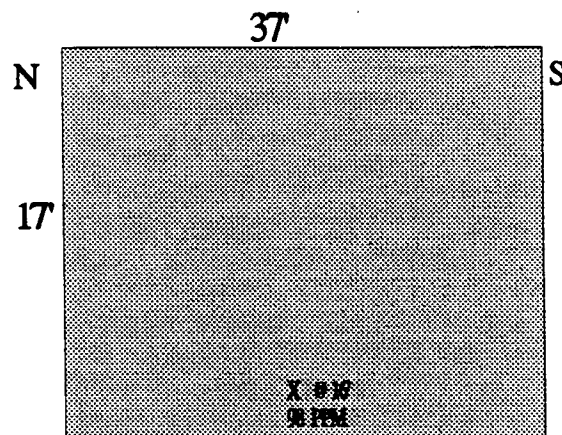

EAST WALL

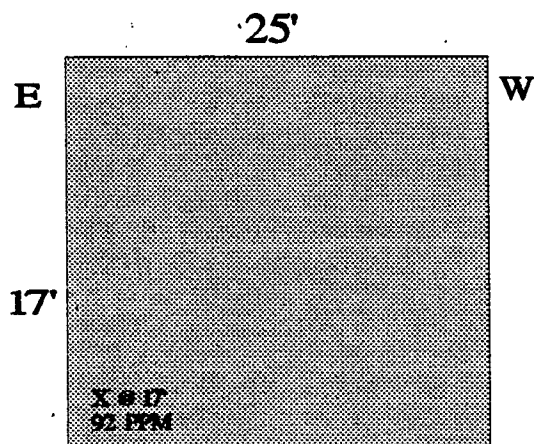

SOUTH WALL

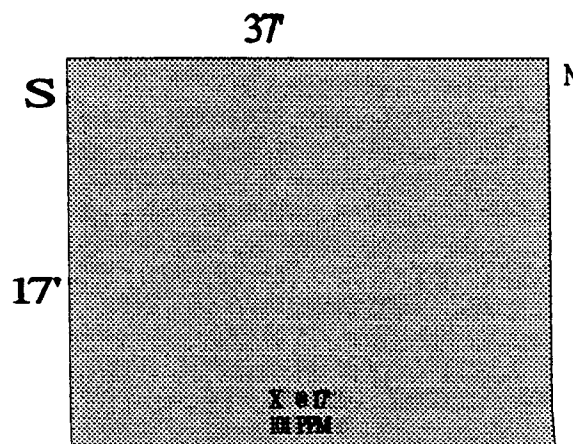

WEST WALL

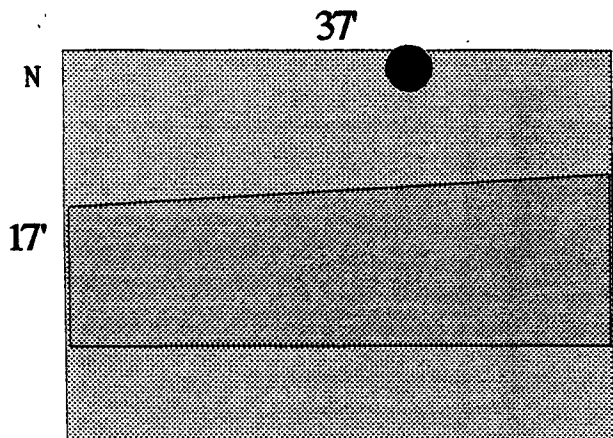

EAST WALL

EXCAVATION AT END
 PIT WATER SAMPLE 9605151010
 WELL H2O SAMPLE 9605151005
 WEST WALL SAMPLE 9605151630

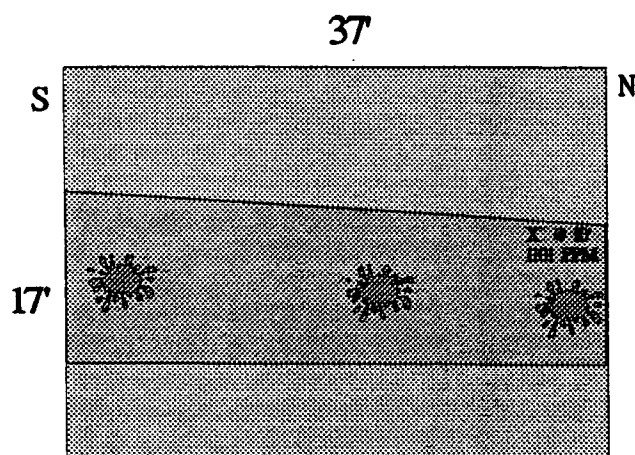

WEST WALL

 = WATER SEEPS

 = CONTAMINATION

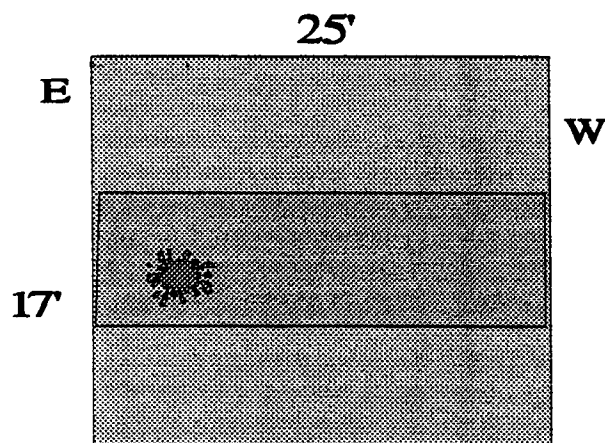

SOUTH WALL

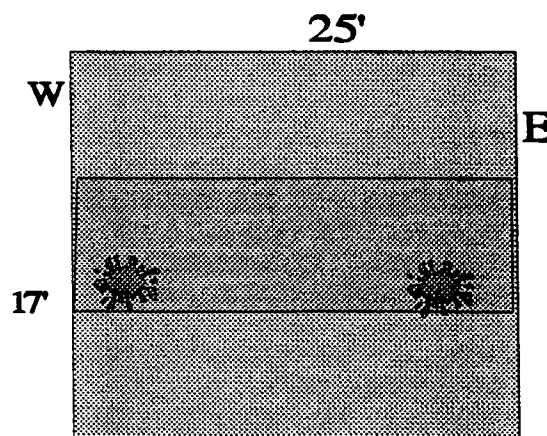

NORTH WALL



OFF: (505) 325-8786

LAB: (505) 325-5667

Diesel Range Organics

Attn: *Denver Bearden*
Company: *PNM Gas Services*
Address: *603 W. Elm*
City, State: *Farmington, NM 87401*

Date: *16-May-96*
COC No.: *4624*
Sample No. *10886*
Job No. *2-1000*

Project Name: *PNM Gas Services - Florance 44*
Project Location: *9605141515; Pit Excavation Composite Sample*
Sampled by: *RH* Date: *14-May-96* Time: *15:15*
Analyzed by: *HR* Date: *15-May-96*
Sample Matrix: *Soil*

Laboratory Analysis

<i>Parameter</i>	<i>Result</i>	<i>Unit of Measure</i>	<i>Detection Limit</i>	<i>Unit of Measure</i>
<i>Diesel Range Organics (C10 - C28)</i>	<i><5.0</i>	<i>mg/kg</i>	<i>5.0</i>	<i>mg/kg</i>

Quality Assurance Report

DRO QC No.: *0475-QC*

Calibration Check

<i>Parameter</i>	<i>Method Blank</i>	<i>Unit of Measure</i>	<i>True Value</i>	<i>Analyzed Value</i>	<i>% Diff</i>	<i>Limit</i>
<i>Diesel Range (C10 - C28)</i>	<i><5.0</i>	<i>ppm</i>	<i>2,000</i>	<i>1,816</i>	<i>9.2</i>	<i>15%</i>

Matrix Spike

<i>Parameter</i>	<i>1 - Percent Recovered</i>	<i>2 - Percent Recovered</i>	<i>Limit</i>	<i>%RSD</i>	<i>Limit</i>
<i>Diesel Range (C10-C28)</i>	<i>88</i>	<i>96</i>	<i>(70-130)</i>	<i>6</i>	<i>20%</i>

Method - SW-846 EPA Method 8015A mod. - Nonhalogenated Volatile Hydrocarbons by Gas Chromatography

Approved by: *Ja 4*

Date: *5/16/96*

P. O. BOX 2606 • FARMINGTON, NM 87499

— TECHNOLOGY BLENDING INDUSTRY WITH THE ENVIRONMENT —



OFF: (505) 325-8786

LAB: (505) 325-5667

AROMATIC VOLATILE ORGANICS

Attn: *Denver Bearden*
Company: *PNM Gas Services*
Address: *603 W. Elm*
City, State: *Farmington, NM 87401*

Date: *16-May-96*
COC No.: *4624*
Sample No.: *10886*
Job No.: *2-1000*

Project Name: *PNM Gas Services - Florance 44*
Project Location: *9605141515; Pit Excavation Composite Sample*
Sampled by: *RH* Date: *14-May-96* Time: *15:15*
Analyzed by: *HR* Date: *15-May-96*
Sample Matrix: *Soil*

Laboratory Analysis

Component	Result	Unit of Measure	Detection Limit	Unit of Measure
<i>Benzene</i>	<i>25.9</i>	<i>ug/kg</i>	<i>0.2</i>	<i>ug/kg</i>
<i>Toluene</i>	<i>167.0</i>	<i>ug/kg</i>	<i>0.2</i>	<i>ug/kg</i>
<i>Ethylbenzene</i>	<i>243.9</i>	<i>ug/kg</i>	<i>0.2</i>	<i>ug/kg</i>
<i>m,p-Xylene</i>	<i>777.4</i>	<i>ug/kg</i>	<i>0.2</i>	<i>ug/kg</i>
<i>o-Xylene</i>	<i>266.4</i>	<i>ug/kg</i>	<i>0.2</i>	<i>ug/kg</i>
<i>TOTAL</i>	<i>1480.7</i>	<i>ug/kg</i>		

Method - *SW-846 EPA Method 8020 Aromatic Volatile Organics by Gas Chromatography*

Approved by: *Daly*
Date: *5/16/96*

P. O. BOX 2606 • FARMINGTON, NM 87499

— TECHNOLOGY BLENDING INDUSTRY WITH THE ENVIRONMENT —

FLORANCE #44
Amoco
Sec. 31-30N-09W

July 23, 1996

Land Farm: On Location
120 Yards

Composite Sample #: 9607231500

Soil Vapor Head-Space Reading = 3.8 ppm (PID)

Sample depths between 2" and 12"

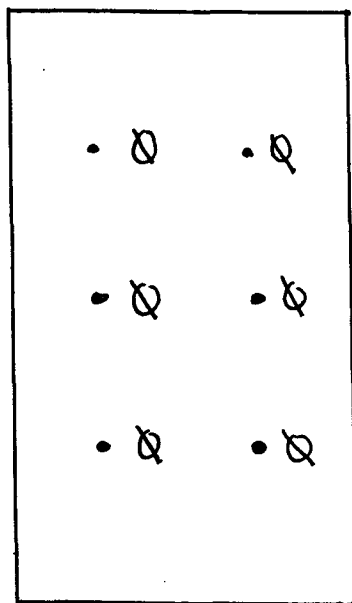

OFF: (505) 325-5667



LAB: (505) 325-1556

Diesel Range Organics

Attn: *Denver Bearden*
Company: *PNM Gas Services*
Address: *603 W. Elm*
City, State: *Farmington, NM 87401*

Date: *25-Jul-96*
COC No.: *4916*
Sample No. *11580*
Job No. *2-1000*

Project Name: *PNM Gas Services - Florance #44 Landfarm*
Project Location: *9607231500; 6pt. Composite, 2" - 12" depth*
Sampled by: *GC* Date: *23-Jul-96* Time: *15:00*
Analyzed by: *HR* Date: *25-Jul-96*
Sample Matrix: *Soil*

Laboratory Analysis

<i>Parameter</i>	<i>Result</i>	<i>Unit of Measure</i>	<i>Detection Limit</i>	<i>Unit of Measure</i>
<i>Diesel Range Organics (C10 - C28)</i>	<i><5.0</i>	<i>mg/kg</i>	<i>5.0</i>	<i>mg/kg</i>

Quality Assurance Report

DRO QC No.: *0479-QC*

Calibration Check

<i>Parameter</i>	<i>Method Blank</i>	<i>Unit of Measure</i>	<i>True Value</i>	<i>Analyzed Value</i>	<i>% Diff</i>	<i>Limit</i>
<i>Diesel Range (C10 - C28)</i>	<i><5.0</i>	<i>ppm</i>	<i>2,000</i>	<i>1,931</i>	<i>3.4</i>	<i>15%</i>

Matrix Spike

<i>Parameter</i>	<i>1 - Percent Recovered</i>	<i>2 - Percent Recovered</i>	<i>Limit</i>	<i>%RSD</i>	<i>Limit</i>
<i>Diesel Range (C10-C28)</i>	<i>111</i>	<i>121</i>	<i>(70-130)</i>	<i>6</i>	<i>20%</i>

Method - SW-846 EPA Method 8015A mod. - Nonhalogenated Volatile Hydrocarbons by Gas Chromatography

Approved by: *[Signature]*
Date: *7/25/96*

P.O. BOX 2606 • FARMINGTON, NM 87499

FLORANCE #4 LANDFARM
ON FLORANCE #44E
05/17/96

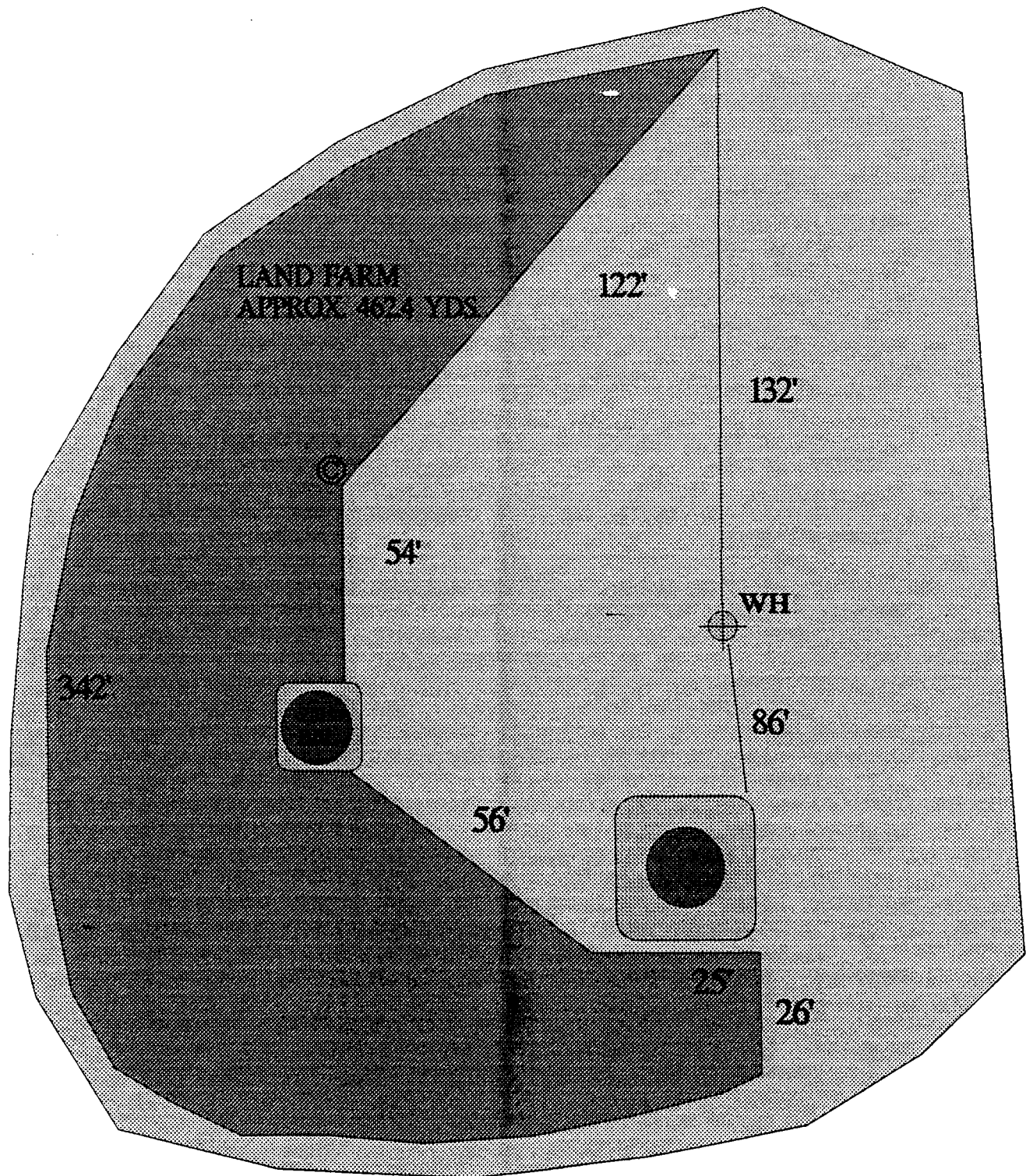

Groundwater Site Summary Report

Reporting Period Quarter/Year: 1st/99, 2nd/99, 3rd/99 and 4th/99

Operator: Amoco

Vulnerable Class: Extended

Sec: 31 Twn: 30 Rng: 8 Unit: H

OCD Ranking: 20

Canyon: Salvador, San Juan

Lead Agency: OCD

Topo Map: Figure 1

Well Completion Diagram: previously submitted

Site Map with Groundwater Analysis: Figure 2

Groundwater Contour Maps: Figure 3 (January 1999), Figure 4 (May 1999), Figure 5 (July 1999) and Figure 6 (October 1999).

Hydrograph: Figure 7

Full Suite- Groundwater Sampling: previously submitted

Analytical Results: attached

Site Hydrology:

The Florance 44 site lies in a small side canyon immediately west of Salvador Canyon, which empties into the San Juan River near the town of Archuleta, New Mexico. The side canyon drops in elevation towards the east, and is hemmed in by steep cliffs to the north and south of the site (see Figure 1). The wellhead elevation is 5836 ft. amsl. A small spring formerly flowed across the well pad, entering the site from the south. However, after the secondary source removal activities in November 1997 the springflow was diverted to the east, and was prevented from entering the area of the well pad by berms on the south side of the pad (Figure 2).

Alluvial materials encountered beneath the site are composed primarily of sand, with varying amounts of clay. Bedrock in the area is hard sandstone, and was frequently encountered at shallow depths beneath the site. At the extreme southern end of the site (in the area of Amoco's separator pit), hard bedrock was found at depths of 18 to 20 feet. Towards the west (upstream), bedrock was found at 14 feet deep in the area of MW-1. In the center of the site (near MW-2), bedrock was found at 20 feet. In general, the top of the bedrock surface parallels surface topography, and slopes towards the center of the drainage and thence towards the east.

Groundwater beneath the site is as shallow as 7 feet (in upgradient well MW-1) to as deep as 43 feet (in downgradient well MW-4). Groundwater flows east-northeast beneath the site (Figures: 3-6), parallel with surface topography and in the same direction as the assumed bedrock-alluvium contact. The water levels are found within alluvium, which is saturated in the area of study.

The hydrograph of the site (Figure 7) shows fairly steady to slightly falling water levels over time. Owing to the removal and reinstallation of wells, it is not possible to construct a comprehensive hydrograph in the central part of the well pad. However, bore holes SB-1 through SB-3 (see Figure 2) showed dry conditions to the bedrock surface, and wells MW-5 and MW-6 contain only a few feet or less of saturated alluvium. It is believed that the diversion of the spring on the south side of the study area has caused the gradual dewatering of the local alluvium. The site was recently resurveyed using a slightly different datum, thus the inconsistency of past hydrographs to current. However, the groundwater elevations recorded at each of the monitoring wells track nicely with the greatest changes occurring in wells MW-1 and MW-6, closest to the wash on the northern edge of the site.

Florance 44 (continued)

Activities for Previous Year:

Because of contamination discovered during PNM's additional source removal activities at the Florance 44 in November 1997, which included recontamination of the clean fill in our previous excavation, PNM prepared and submitted to OCD a summary report detailing the activities, results and recommendations at the Florance 44 in April 1998. In July 1998, the OCD directed PNM to remediate the site jointly with the operator, Amoco. After discussion and analysis, PNM proposed a well installation and sampling plan in December 1998. Amoco accepted, and the field program commenced in January 1999.

Soil borings SB-1, -2 and -3 encountered dry conditions and did not produce groundwater. Soil boring SB-3 was left open for 24-hours, with no indications of the presence of water. All efforts to re-establish a "source" well were unsuccessful. Little to no contamination was observed in these borings (Figure 2). Soil borings SB-4 and SB-5 encountered saturated alluvium and were completed as monitor wells MW-5 and MW-6.

PNM conducted quarterly groundwater sampling at the Florance 44 on January 12, May 26, July 28, and again on October 28, 1999. Water level data were collected from all wells during each sampling event. All sampling was performed in strict compliance with EPA protocol. PNM delivered the samples to OnSite Technologies, Farmington, New Mexico for chemical analyses of BTEX using EPA method 8021B.

Results:

Figure 2 is a site map of the Florance 44 and includes groundwater analytical results. Upgradient well MW-1 and downgradient well MW-4 have been below standards during every sampling event. Wells MW-5 and MW-6 also showed BTEX concentrations below standards. It is believed that the additional excavation, in addition to other actions taken by the operator, were successful in controlling the source of hydrocarbon contamination at the Florance 44 site.

BTEX concentrations in all wells have been below standards for four consecutive quarters. Apparently the additional source removal performed in November, 1997 appears to have accelerated the reduction of benzene in this area.

Future Actions:

Consistent with PNM's San Juan Basin Groundwater Management Plan, PNM requests closure of the Florance 44. This request is based upon the analytical data collected over the last three years at the site. The secondary excavation of additional source materials appears to have been successful in achieving clean-up at the Florance 44; the BTEX concentrations in all of the wells have been below standards for four consecutive quarters.

Upon approval of the groundwater closure report, PNM will plug and abandon the four groundwater monitoring wells at the site. The concrete pad and metal vault surrounding each well will be removed. The well casing will be removed or cut below ground surface and each well will be plugged to the surface with cement containing 5% bentonite.



Figure 1.
Florance 44
Sec. 31 Twn. 30N Rng. 8W Unit H

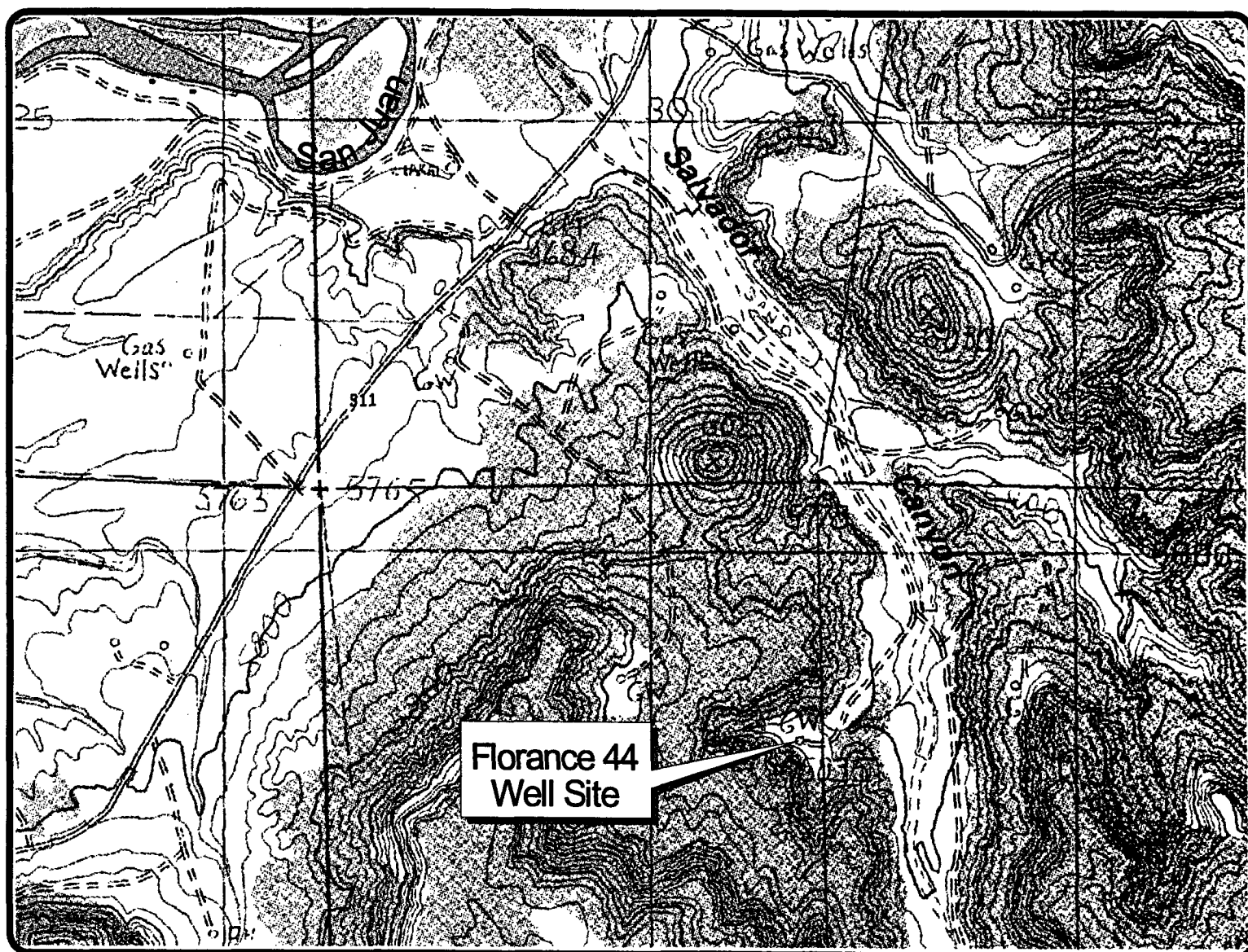

Archuleta, NM 7.5' Quadrangle

0 1000 2000 3000 4000 5000 Feet





Figure 2.
Florance 44 Site Map and Analytical Results
(Concentrations in mg/l)

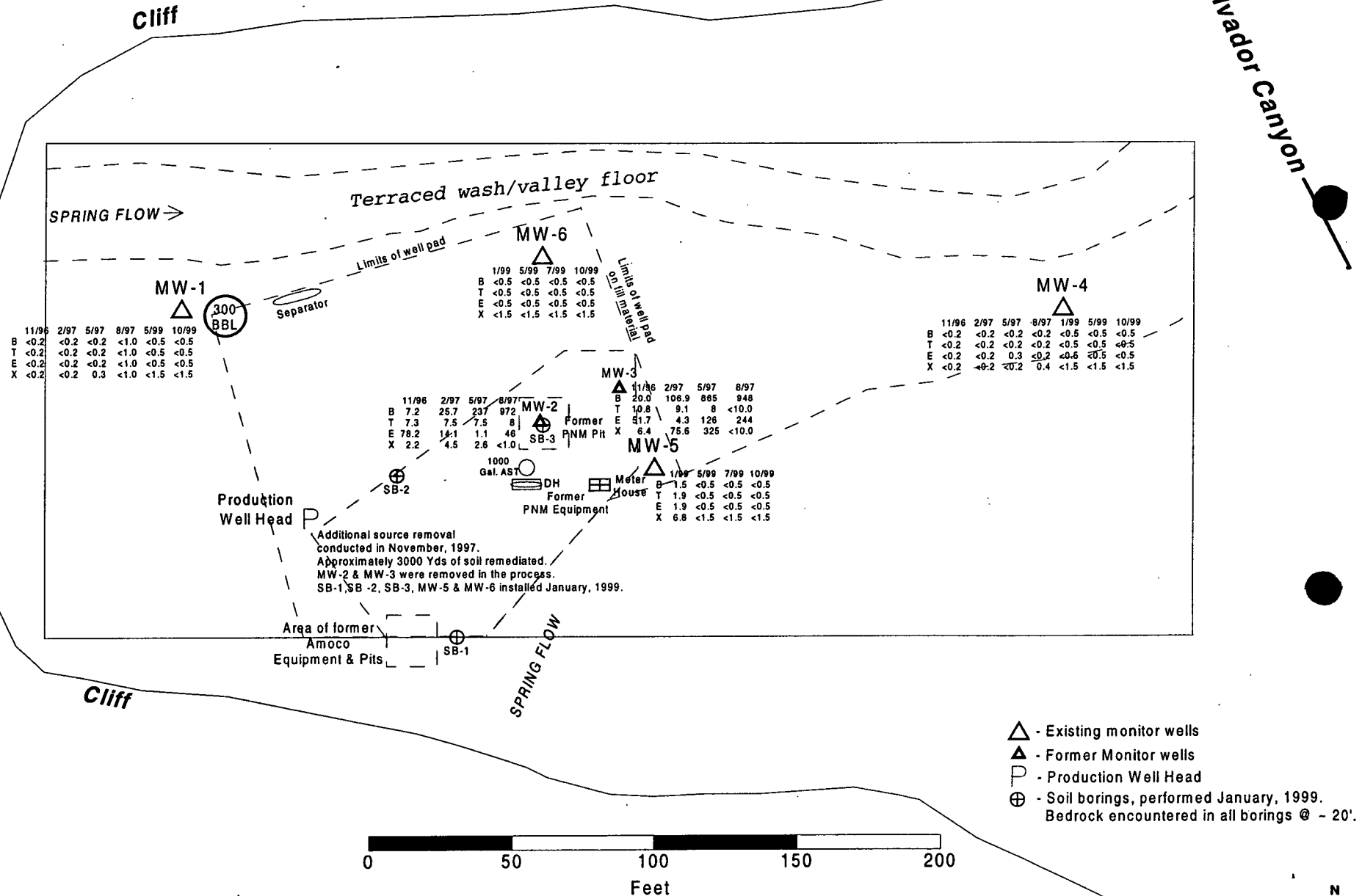

Figure 3.
Florance 44 Groundwater Contour Map (January 12, 1999)

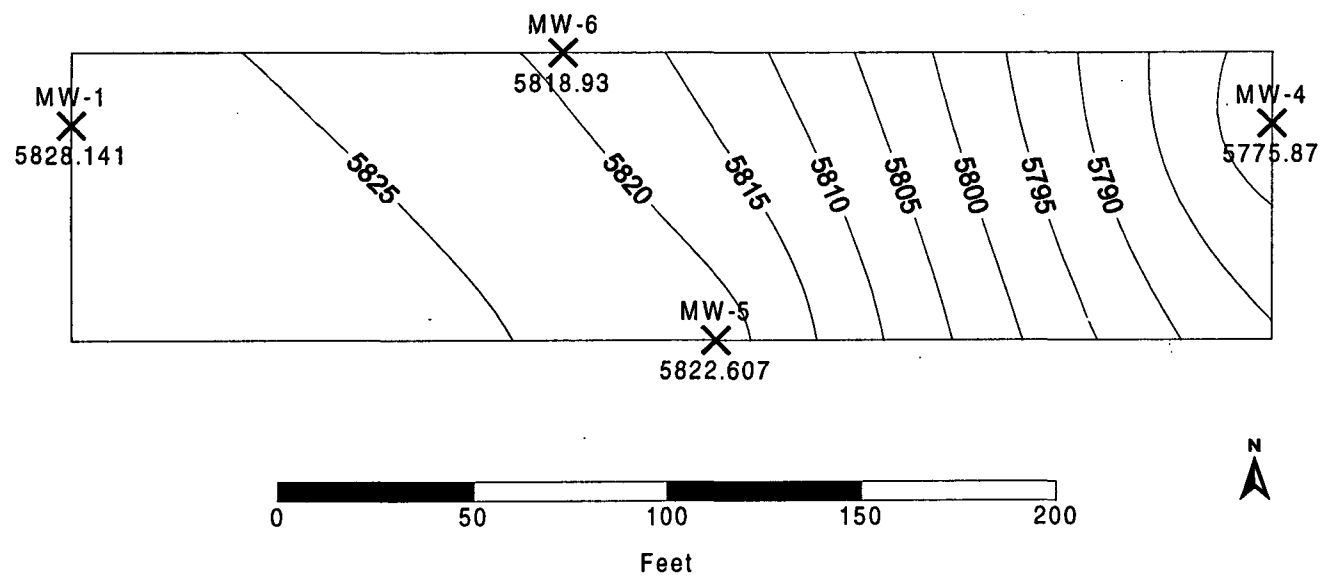

Figure 4.
Florance 44 Groundwater Contour Map (May 26, 1999)

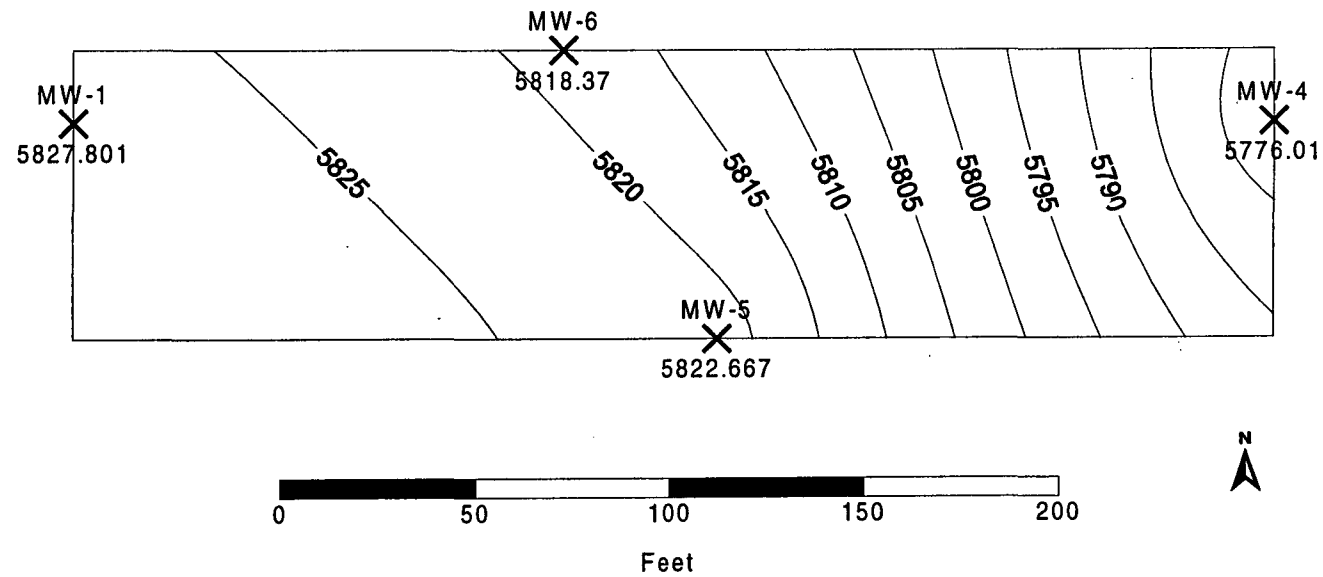

Figure 5.
Florance 44 Groundwater Contour Map (July 28, 1999)

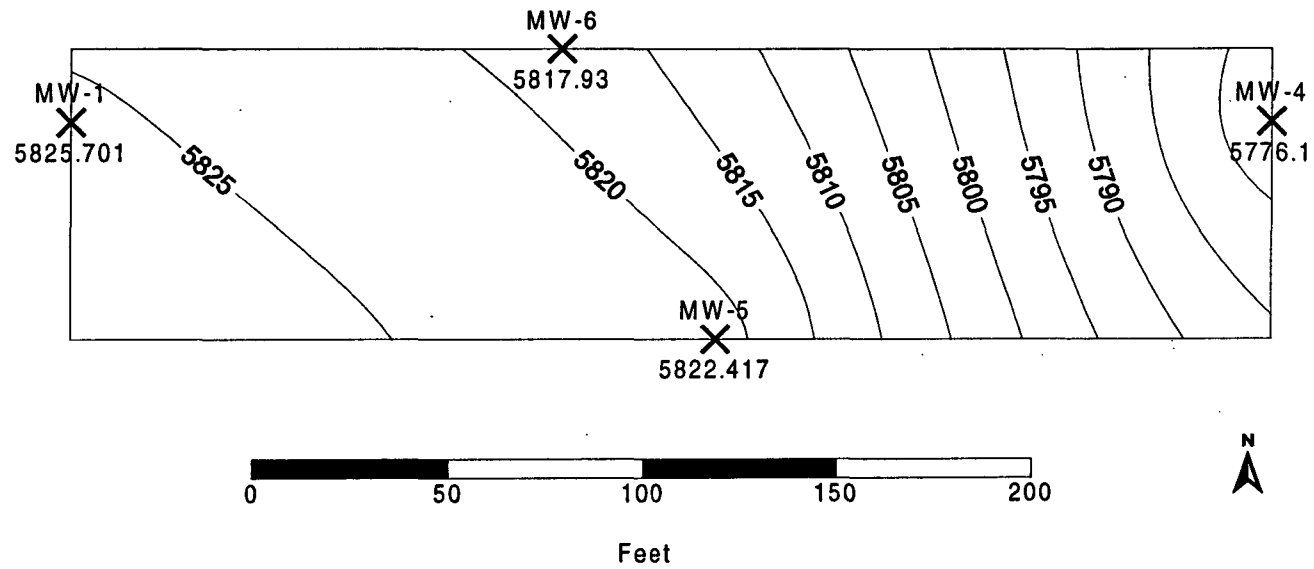

Figure 6.
Florance 44 Groundwater Contour Map (October 20, 1999)

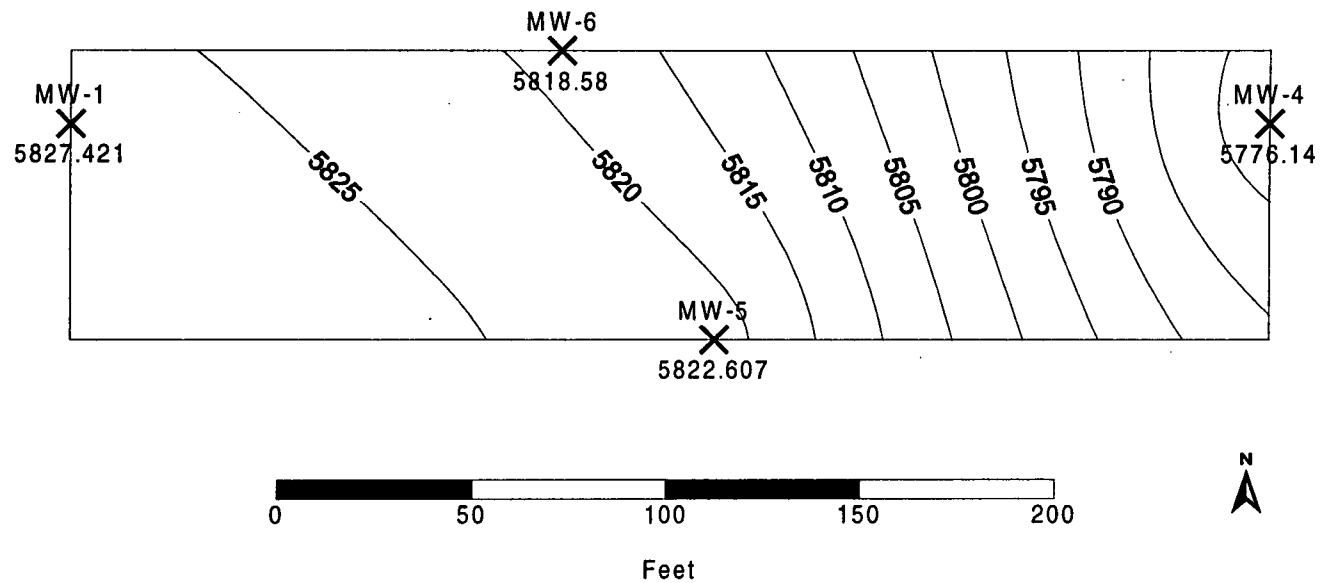
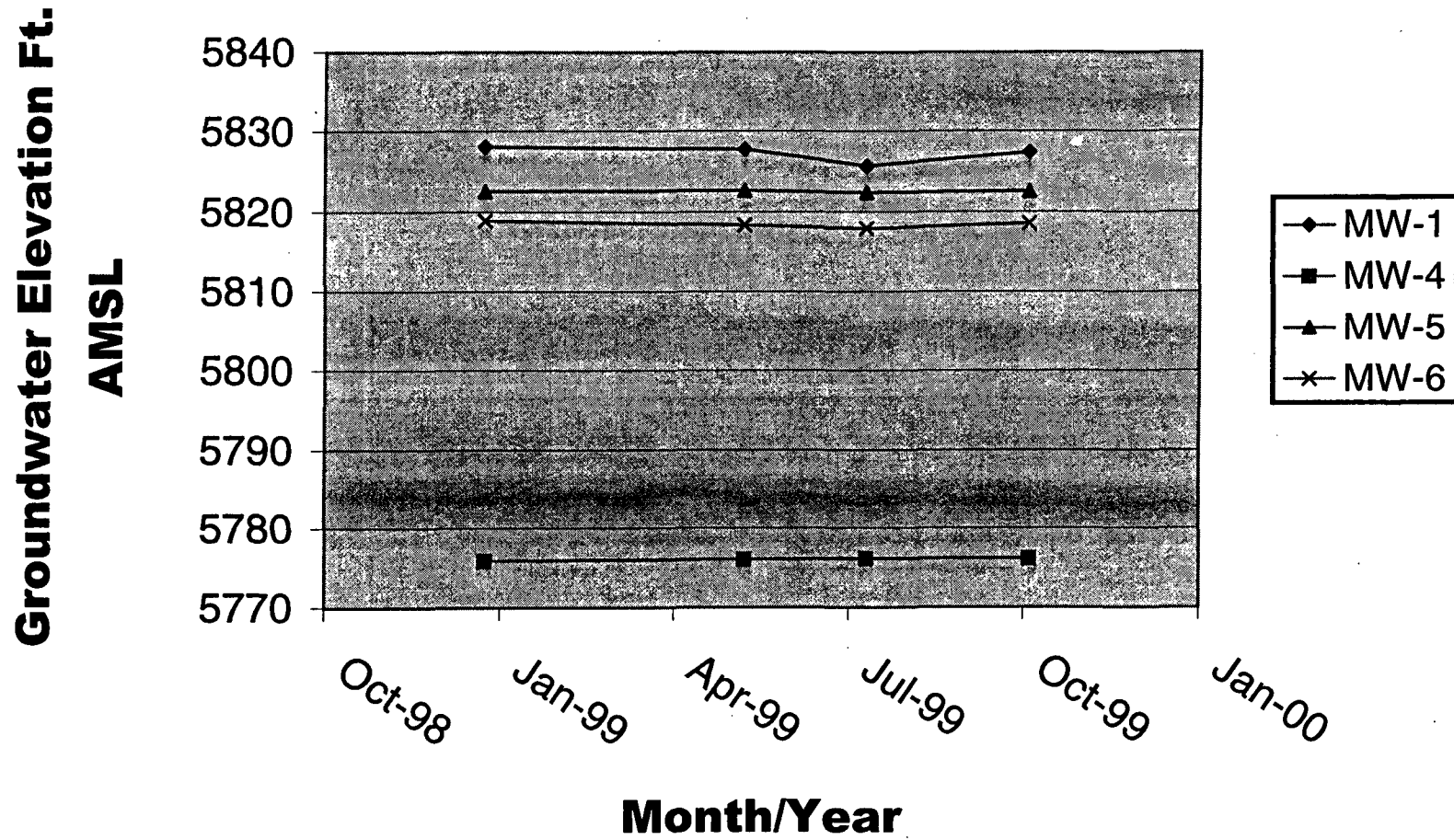

Figure 7.
Florance 44 Hydrograph



OFF: (505) 325-5667



Rec'd 1/27/99
(included in 1999
Annual Report)
LAB: (505) 325-1556 1/27/99

January 21, 1999

Maureen Gannon
PNM - Public Service Company of NM
Alvarado Square Mail Stop 0408
Albuquerque, NM 87158
TEL: (505) 241-2974
FAX (505) 241-2340

1st Quarter 1999

RE: Florance 44

Order No.: 9901005

Dear Maureen Gannon,

On Site Technologies, LTD. received 4 samples on 1/12/99 for the analyses presented in the following report.

The Samples were analyzed for the following tests:
BTEX (SW8021B)

There were no problems with the analyses and all data for associated QC met EPA or laboratory specifications except where noted in the Case Narrative.

If you have any questions regarding these tests results, please feel free to call.

Sincerely,

A handwritten signature in dark ink, appearing to read "David Cox", is written over a horizontal line.

David Cox

OFF: (505) 325-5667



LAB: (505) 325-1556

On Site Technologies, LTD.

Date: 21-Jan-99

CLIENT: PNM - Public Service Company of NM
Project: Florance 44
Lab Order: 9901005

CASE NARRATIVE

Samples were analyzed using the methods outlined in the following references:

Test Methods for Evaluating Solid Waste, Physical/Chemical Methods, SW846, 3rd Edition

All method blanks, laboratory spikes, and/or matrix spikes met quality assurance objectives.

OFF: (505) 325-5667



LAB: (505) 325-1556

ANALYTICAL REPORT

Date: 21-Jan-99

Client:	PNM - Public Service Company of NM	Client Sample Info:	Florance 44
Work Order:	9901005	Client Sample ID:	9901121030; MW-4
Lab ID:	9901005-01A	Matrix:	AQUEOUS
Project:	Florance 44	Collection Date:	1/12/99 10:30:00 AM
		COC Record:	7462

Parameter	Result	PQL	Qual	Units	DF	Date Analyzed
BTEX		SW8021B				Analyst: HR
Benzene	ND	0.5		µg/L	1	1/13/99
Toluene	ND	0.5		µg/L	1	1/13/99
Ethylbenzene	ND	0.5		µg/L	1	1/13/99
m,p-Xylene	ND	1		µg/L	1	1/13/99
o-Xylene	ND	0.5		µg/L	1	1/13/99

Qualifiers:

PQL - Practical Quantitation Limit

ND - Not Detected at Practical Quantitation Limit

J - Analyte detected below Practical Quantitation Limit

B - Analyte detected in the associated Method Blank

S - Spike Recovery outside accepted recovery limits

R - RPD outside accepted recovery limits

E - Value above quantitation range

Surr: - Surrogate

1 of 1

P.O. BOX 2606 • FARMINGTON, NM 87499

- TECHNOLOGY BLENDING INDUSTRY WITH THE ENVIRONMENT -

OFF: (505) 325-5667



LAB: (505) 325-1556

ANALYTICAL REPORT

Date: 21-Jan-99

Client:	PNM - Public Service Company of NM	Client Sample Info:	Florance 44
Work Order:	9901005	Client Sample ID:	9901121050; MW-5
Lab ID:	9901005-02A	Matrix:	AQUEOUS
Project:	Florance 44	Collection Date:	1/12/99 10:50:00 AM
		COC Record:	7462

Parameter	Result	PQL	Qual	Units	DF	Date Analyzed
BTEX		SW8021B				Analyst: HR
Benzene	1.5	0.5		µg/L	1	1/13/99
Toluene	1.9	0.5		µg/L	1	1/13/99
Ethylbenzene	1.9	0.5		µg/L	1	1/13/99
m,p-Xylene	6.8	1		µg/L	1	1/13/99
o-Xylene	ND	0.5		µg/L	1	1/13/99

Qualifiers:

PQL - Practical Quantitation Limit

ND - Not Detected at Practical Quantitation Limit

J - Analyte detected below Practical Quantitation Limit

B - Analyte detected in the associated Method Blank

S - Spike Recovery outside accepted recovery limits

R - RPD outside accepted recovery limits

E - Value above quantitation range

Surr: - Surrogate

1 of 1

P.O. BOX 2606 • FARMINGTON, NM 87499

- TECHNOLOGY BLENDING INDUSTRY WITH THE ENVIRONMENT -

OFF: (505) 325-5667



LAB: (505) 325-1556

ANALYTICAL REPORT

Date: 21-Jan-99

Client:	PNM - Public Service Company of NM	Client Sample Info:	Florance 44
Work Order:	9901005	Client Sample ID:	9901121110; MW-6
Lab ID:	9901005-03A	Matrix:	AQUEOUS
Project:	Florance 44	Collection Date:	1/12/99 11:10:00 AM
		COC Record:	7462

Parameter	Result	PQL	Qual	Units	DF	Date Analyzed
BTEX		SW8021B				Analyst: HR
Benzene	ND	0.5		µg/L	1	1/13/99
Toluene	ND	0.5		µg/L	1	1/13/99
Ethylbenzene	ND	0.5		µg/L	1	1/13/99
m,p-Xylene	ND	1		µg/L	1	1/13/99
o-Xylene	ND	0.5		µg/L	1	1/13/99

Qualifiers:

PQL - Practical Quantitation Limit

ND - Not Detected at Practical Quantitation Limit

J - Analyte detected below Practical Quantitation Limit

B - Analyte detected in the associated Method Blank

S - Spike Recovery outside accepted recovery limits

R - RPD outside accepted recovery limits

E - Value above quantitation range

Surr: - Surrogate

1 of 1

P.O. BOX 2606 • FARMINGTON, NM 87499

- TECHNOLOGY BLENDING INDUSTRY WITH THE ENVIRONMENT -

OFF: (505) 325-5667

ON SITE
TECHNOLOGIES, LTD.

LAB: (505) 325-1556

*Duplicate
of MW-6*

ANALYTICAL REPORT

Date: 21-Jan-99

Client: PNM - Public Service Company of NM
Work Order: 9901005
Lab ID: 9901005-04A
Project: Florance 44

Client Sample Info: Florance 44
Client Sample ID: 9901121130; MW-7
Collection Date: 1/12/99 11:30:00 AM
COC Record: 7462

*Duplicate
of
MW-6*

Parameter	Result	PQL	Qual	Units	DF	Date Analyzed
BTEX		SW8021B				Analyst: HR
Benzene	ND	0.5		µg/L	1	1/13/99
Toluene	ND	0.5		µg/L	1	1/13/99
Ethylbenzene	ND	0.5		µg/L	1	1/13/99
m,p-Xylene	ND	1		µg/L	1	1/13/99
o-Xylene	ND	0.5		µg/L	1	1/13/99

Qualifiers:

PQL - Practical Quantitation Limit

ND - Not Detected at Practical Quantitation Limit

J - Analyte detected below Practical Quantitation Limit

B - Analyte detected in the associated Method Blank

S - Spike Recovery outside accepted recovery limits

R - RPD outside accepted recovery limits

E - Value above quantitation range

Surr: - Surrogate

1 of 1

P.O. BOX 2606 • FARMINGTON, NM 87499

- TECHNOLOGY BLENDING INDUSTRY WITH THE ENVIRONMENT -

OFF: (505) 325-5667



LAB: (505) 325-1556

June 08, 1999

RECEIVED
JUN 09 1999

Maureen Gannon
PNM - Public Service Company of NM
Alvarado Square Mail Stop 0408
Albuquerque, NM 87158
TEL: (505) 241-2974
FAX (505) 241-2340

RE: Florance 44

Order No.: 9905091

Dear Maureen Gannon,

On Site Technologies, LTD. received 5 samples on 5/26/99 for the analyses presented in the following report.

The Samples were analyzed for the following tests:
Aromatic Volatiles by GC/PID (SW8021B)

There were no problems with the analyses and all data for associated QC met EPA or laboratory specifications except where noted in the Case Narrative.

If you have any questions regarding these tests results, please feel free to call.

Sincerely,

A handwritten signature in black ink, appearing to be "David Cox", written over a horizontal line.

David Cox

OFF: (505) 325-5667



LAB: (505) 325-1556

On Site Technologies, LTD.

Date: 08-Jun-99

CLIENT: PNM - Public Service Company of NM
Project: Florance 44
Lab Order: 9905091

CASE NARRATIVE

Samples were analyzed using the methods outlined in the following references:

Test Methods for Evaluating Solid Waste, Physical/Chemical Methods, SW846, 3rd Edition

All method blanks, laboratory spikes, and/or matrix spikes met quality assurance objectives.

OFF: (505) 325-5667



LAB: (505) 325-1556

ANALYTICAL REPORT

Date: 08-Jun-99

Client:	PNM - Public Service Company of NM	Client Sample Info:	Florance 44
Work Order:	9905091	Client Sample ID:	9905260740; MW-1
Lab ID:	9905091-01A	Matrix:	AQUEOUS
Project:	Florance 44	Collection Date:	5/26/99 7:40:00 AM
		COC Record:	7044

Parameter	Result	PQL	Qual	Units	DF	Date Analyzed
AROMATIC VOLATILES BY GC/PID		SW8021B				Analyst: DC
Benzene	ND	0.5		µg/L	1	6/3/99
Toluene	ND	0.5		µg/L	1	6/3/99
Ethylbenzene	ND	0.5		µg/L	1	6/3/99
m,p-Xylene	ND	1		µg/L	1	6/3/99
o-Xylene	ND	0.5		µg/L	1	6/3/99

Qualifiers:

PQL - Practical Quantitation Limit
ND - Not Detected at Practical Quantitation Limit
J - Analyte detected below Practical Quantitation Limit
B - Analyte detected in the associated Method Blank

S - Spike Recovery outside accepted recovery limits
R - RPD outside accepted recovery limits
E - Value above quantitation range
Sur: - Surrogate

1 of 1

P.O. BOX 2606 • FARMINGTON, NM 87499

- TECHNOLOGY BLENDING INDUSTRY WITH THE ENVIRONMENT -

OFF: (505) 325-5667



LAB: (505) 325-1556

ANALYTICAL REPORT

Date: 08-Jun-99

Client:	PNM - Public Service Company of NM	Client Sample Info:	Florance 44
Work Order:	9905091	Client Sample ID:	9905260810; MW-4
Lab ID:	9905091-02A	Matrix:	AQUEOUS
Project:	Florance 44	Collection Date:	5/26/99 8:10:00 AM
		COC Record:	7044

Parameter	Result	PQL	Qual	Units	DF	Date Analyzed
AROMATIC VOLATILES BY GC/PID		SW8021B				Analyst: DC
Benzene	ND	0.5		µg/L	1	6/3/99
Toluene	ND	0.5		µg/L	1	6/3/99
Ethylbenzene	ND	0.5		µg/L	1	6/3/99
m,p-Xylene	ND	1		µg/L	1	6/3/99
o-Xylene	ND	0.5		µg/L	1	6/3/99

Qualifiers:

PQL - Practical Quantitation Limit

ND - Not Detected at Practical Quantitation Limit

J - Analyte detected below Practical Quantitation Limit

B - Analyte detected in the associated Method Blank

S - Spike Recovery outside accepted recovery limits

R - RPD outside accepted recovery limits

E - Value above quantitation range

Surr: - Surrogate

P.O. BOX 2606 • FARMINGTON, NM 87499

- TECHNOLOGY BLENDING INDUSTRY WITH THE ENVIRONMENT -

OFF: (505) 325-5667



LAB: (505) 325-1556

ANALYTICAL REPORT

Date: 08-Jun-99

Client:	PNM - Public Service Company of NM	Client Sample Info:	Florance 44
Work Order:	9905091	Client Sample ID:	9905260850; MW-5
Lab ID:	9905091-03A	Matrix:	AQUEOUS
Project:	Florance 44	Collection Date:	5/26/99 8:50:00 AM
		COC Record:	7044

Parameter	Result	PQL	Qual	Units	DF	Date Analyzed
AROMATIC VOLATILES BY GC/PID		SW8021B		Analyst: DC		
Benzene	ND	0.5		µg/L	1	6/3/99
Toluene	ND	0.5		µg/L	1	6/3/99
Ethylbenzene	ND	0.5		µg/L	1	6/3/99
m,p-Xylene	ND	1		µg/L	1	6/3/99
o-Xylene	ND	0.5		µg/L	1	6/3/99

Qualifiers:

PQL - Practical Quantitation Limit

ND - Not Detected at Practical Quantitation Limit

J - Analyte detected below Practical Quantitation Limit

B - Analyte detected in the associated Method Blank

S - Spike Recovery outside accepted recovery limits

R - RPD outside accepted recovery limits

E - Value above quantitation range

Surr: - Surrogate

1 of 1

P.O. BOX 2606 • FARMINGTON, NM 87499

- TECHNOLOGY BLENDING INDUSTRY WITH THE ENVIRONMENT -

OFF: (505) 325-5667



LAB: (505) 325-1556

ANALYTICAL REPORT

Date: 08-Jun-99

Client:	PNM - Public Service Company of NM	Client Sample Info:	Florance 44
Work Order:	9905091	Client Sample ID:	9905260923; MW-6
Lab ID:	9905091-04A	Matrix:	AQUEOUS
Project:	Florance 44	Collection Date:	5/26/99 9:23:00 AM
		COC Record:	7044

Parameter	Result	PQL	Qual	Units	DF	Date Analyzed
AROMATIC VOLATILES BY GC/PID		SW8021B				Analyst: DC
Benzene	ND	0.5		µg/L	1	6/3/99
Toluene	ND	0.5		µg/L	1	6/3/99
Ethylbenzene	ND	0.5		µg/L	1	6/3/99
m,p-Xylene	ND	1		µg/L	1	6/3/99
o-Xylene	ND	0.5		µg/L	1	6/3/99

Qualifiers:

PQL - Practical Quantitation Limit

ND - Not Detected at Practical Quantitation Limit

J - Analyte detected below Practical Quantitation Limit

B - Analyte detected in the associated Method Blank

S - Spike Recovery outside accepted recovery limits

R - RPD outside accepted recovery limits

E - Value above quantitation range

Surr: - Surrogate

1 of 1

P.O. BOX 2606 • FARMINGTON, NM 87499

- TECHNOLOGY BLENDING INDUSTRY WITH THE ENVIRONMENT -

OFF: (505) 325-5667



LAB: (505) 325-1556

ANALYTICAL REPORT

Date: 08-Jun-99

Client:	PNM - Public Service Company of NM	Client Sample Info:	Florance 44
Work Order:	9905091	Client Sample ID:	9905260953; MW-7
Lab ID:	9905091-05A	Matrix:	AQUEOUS
Project:	Florance 44	Collection Date:	5/26/99 9:53:00 AM
		COC Record:	7044

Parameter	Result	PQL	Qual	Units	DF	Date Analyzed
AROMATIC VOLATILES BY GC/PID		SW8021B				Analyst: DC
Benzene	ND	0.5		µg/L	1	6/3/99
Toluene	ND	0.5		µg/L	1	6/3/99
Ethylbenzene	ND	0.5		µg/L	1	6/3/99
m,p-Xylene	ND	1		µg/L	1	6/3/99
o-Xylene	ND	0.5		µg/L	1	6/3/99

Qualifiers:

PQL - Practical Quantitation Limit

ND - Not Detected at Practical Quantitation Limit

J - Analyte detected below Practical Quantitation Limit

B - Analyte detected in the associated Method Blank

S - Spike Recovery outside accepted recovery limits

R - RPD outside accepted recovery limits

E - Value above quantitation range

Surr: - Surrogate

1 of 1

P.O. BOX 2606 • FARMINGTON, NM 87499

- TECHNOLOGY BLENDING INDUSTRY WITH THE ENVIRONMENT -

OFF: (505) 325-5667



LAB: (505) 325-1556

August 27, 1999

RECEIVED
SEP 01 1999

Maureen Gannon
PNM - Public Service Company of NM
Alvarado Square Mail Stop 0408
Albuquerque, NM 87158
TEL: (505) 241-2974
FAX (505) 241-2340

RE: Florance 44

Order No.: 9907068

Dear Maureen Gannon,

On Site Technologies, LTD. received 2 samples on 07/28/1999 for the analyses presented in the following report.

The Samples were analyzed for the following tests:

Aromatic Volatiles by GC/PID (SW8021B)

Mercury, Dissolved (SW7470)

There were no problems with the analyses and all data for associated QC met EPA or laboratory specifications except where noted in the Case Narrative.

If you have any questions regarding these tests results, please feel free to call.

Sincerely,

A handwritten signature in black ink, appearing to be "D Cox", written over a horizontal line.

David Cox

OFF: (505) 325-5667



LAB: (505) 325-1556

On Site Technologies, LTD.

Date: 27-Aug-99

CLIENT: PNM - Public Service Company of NM
Project: Florance 44
Lab Order: 9907068

CASE NARRATIVE

Samples were analyzed using the methods outlined in the following references:

Test Methods for Evaluating Solid Waste, Physical/Chemical Methods, SW846, 3rd Edition.

Methods for Chemical Analysis of Water and Wastes, EPA-600/4-79-020, March 1983.

All method blanks, laboratory spikes, and/or matrix spikes met quality assurance objectives.

OFF: (505) 325-5667



LAB: (505) 325-1556

ANALYTICAL REPORT

Date: 27-Aug-99

Client:	PNM - Public Service Company of NM	Client Sample Info:	Florance 44
Work Order:	9907068	Client Sample ID:	9907281111; MW-5
Lab ID:	9907068-01A	Matrix:	AQUEOUS
Project:	Florance 44	Collection Date:	07/28/1999 11:11:00 AM
		COC Record:	7052

Parameter	Result	PQL	Qual	Units	DF	Date Analyzed
AROMATIC VOLATILES BY GC/PID		SW8021B		Analyst: DC		
Benzene	ND	0.5		µg/L	1	08/04/1999
Toluene	ND	0.5		µg/L	1	08/04/1999
Ethylbenzene	ND	0.5		µg/L	1	08/04/1999
m,p-Xylene	ND	1		µg/L	1	08/04/1999
o-Xylene	ND	0.5		µg/L	1	08/04/1999

Qualifiers:

PQL - Practical Quantitation Limit

ND - Not Detected at Practical Quantitation Limit

J - Analyte detected below Practical Quantitation Limit

B - Analyte detected in the associated Method Blank

S - Spike Recovery outside accepted recovery limits

R - RPD outside accepted recovery limits

E - Value above quantitation range

Surr: - Surrogate

1 of 1

P.O. BOX 2606 • FARMINGTON, NM 87499

- TECHNOLOGY BLENDING INDUSTRY WITH THE ENVIRONMENT -

OFF: (505) 325-5667



LAB: (505) 325-1556

ANALYTICAL REPORT

Date: 27-Aug-99

Client:	PNM - Public Service Company of NM	Client Sample Info:	Florance 44
Work Order:	9907068	Client Sample ID:	9907281133; MW-6
Lab ID:	9907068-02A	Matrix:	AQUEOUS
Project:	Florance 44	Collection Date:	07/28/1999 11:33:00 AM
		COC Record:	7052

Parameter	Result	PQL	Qual	Units	DF	Date Analyzed
AROMATIC VOLATILES BY GC/PID		SW8021B		Analyst: DC		
Benzene	ND	0.5		µg/L	1	08/04/1999
Toluene	ND	0.5		µg/L	1	08/04/1999
Ethylbenzene	ND	0.5		µg/L	1	08/04/1999
m,p-Xylene	ND	1		µg/L	1	08/04/1999
o-Xylene	ND	0.5		µg/L	1	08/04/1999

Qualifiers:

PQL - Practical Quantitation Limit

ND - Not Detected at Practical Quantitation Limit

J - Analyte detected below Practical Quantitation Limit

B - Analyte detected in the associated Method Blank

S - Spike Recovery outside accepted recovery limits

R - RPD outside accepted recovery limits

E - Value above quantitation range

Surr: - Surrogate

1 of 1

P.O. BOX 2606 • FARMINGTON, NM 87499

- TECHNOLOGY BLENDING INDUSTRY WITH THE ENVIRONMENT -

ACZ Laboratories, Inc.

2773 Downhill Drive

Steamboat Springs, CO 80487
(800) 334-5493

Florance 44 9907281111; MW-5

Lab Sample ID: L24154-01

Client Sample ID: 9907068-01B

Client Project ID:

ACZ Report ID: RG99025

On Site Technologies, LTD.

612 E Murray Dr

Farmington, NM 87499

David Cox

Date Sampled: 7/28/99 11:11:00 AM

Date Received: 7/30/99

Date Reported: 8/16/99

Sample Matrix: Ground Water

Metals Analysis

Parameter	EPA Method	Result	Qual	Units	MDL	PQL	Date	Analyst
Mercury, dissolved	M245.1 CVAA	0.0003	B	mg/L	0.0002	0.001	8/14/99	ms

Inorganic Qualifiers (based on EPA CLP 3/90)

U = Analyte was analyzed for but not detected at the indicated MDL

B = Analyte concentration detected at a value between MDL and PQL

PQL = Practical Quantitation Limit

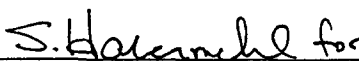

Vice President of Operations: Ralph Poulsen

CLIENT:

ON SITE

DATE _____

7/30/99

PROJECT #:

L 2415N

ANALYST:

DALE

ID

2° to 6°

uR/hr

ON SITE

3.0°

13

If container radioactivity is
> 25 $\mu\text{R/hr}$ then each sample
must be screened.

SAMPLE

R

G

Y

YG

B

BG

Q

T

P

RAD

2

2

<2

<2

<2

<2

<2

> 12

> 12

 $\mu R/hr$

DWT

INTERNAL COMMENTS:

REPORT COMMENTS:

SAMPLE RECEIPT FORM

CLIENT:

ON SITE

DATE

7/30/97

PROJECT #:

L241534
Dirt

1) Does this project require special handling procedures such as CLP protocol?	<u>NA</u>	YES	NO
2) Are the custody seals on the cooler intact?	<u>NA</u>	YES	NO
3) Are the custody seals on the sample containers intact?	<u>NA</u>	YES	NO
4) Is there a Chain of Custody (COC), or other directive shipping papers present?		<u>YES</u>	NO
5) Is the COC complete? Relinquished? Yes ___ No ___ Requested Analysis? Yes ___ No ___		<u>YES</u>	NO
6) Is the COC in agreement with the samples received? # of Samples: Yes ___ No ___ Sample ID: Yes ___ No ___ Matrix: Yes ___ No ___ # of Containers: Yes ___ No ___		<u>YES</u>	NO
7) Is there enough sample for all requested analysis?		<u>YES</u>	NO
8) Are all samples within holding times for requested analysis?		<u>YES</u>	NO
9) Were all sample containers received intact?		<u>YES</u>	NO
10) Are samples requiring no headspace, headspace free?	<u>NA</u>	YES	NO
11) Do the samples require a Foreign Soils Permit Label or quarantine?		YES	<u>NO</u>
12) Do samples require special disposal/hold considerations? Non-Hazardous: Yes ___ No ___ Hazardous: Yes ___ No ___ Hold: ___ months			

Describe "NO" items (except #1, 11, & 12):

Was the client contacted? Yes ___ No ___

If yes: Date: _____

Name of person contacted: _____

Actions taken or client instructions:

Signature: Palmer

OFF: (505) 325-5667



LAB: (505) 325-1556

November 01, 1999

Maureen Gannon
PNM - Public Service Company of NM
Alvarado Square Mail Stop 0408
Albuquerque, NM 87158
TEL: (505) 241-2974
FAX (505) 241-2340

RECEIVED
NOV 05 1999

RE: Florance #44

Order No.: 9910033

Dear Maureen Gannon,

On Site Technologies, LTD. received 5 samples on 10/20/99 for the analyses presented in the following report.

The Samples were analyzed for the following tests:
Aromatic Volatiles by GC/PID (SW8021B)

There were no problems with the analyses and all data for associated QC met EPA or laboratory specifications except where noted in the Case Narrative.

If you have any questions regarding these tests results, please feel free to call.

Sincerely,

A handwritten signature in black ink, appearing to be "David Cox", written in a cursive style.

David Cox

OFF: (505) 325-5667



LAB: (505) 325-1556

On Site Technologies, LTD.

Date: 01-Nov-99

CLIENT: PNM - Public Service Company of NM
Project: Florance #44
Lab Order: 9910033

CASE NARRATIVE

Samples were analyzed using the methods outlined in the following references:

Test Methods for Evaluating Solid Waste, Physical/Chemical Methods, SW846, 3rd Edition

All method blanks, laboratory spikes, and/or matrix spikes met quality assurance objectives.

OFF: (505) 325-5667



LAB: (505) 325-1556

ANALYTICAL REPORT

Date: 01-Nov-99

Client:	PNM - Public Service Company of NM	Client Sample Info:	Florance #44
Work Order:	9910033	Client Sample ID:	9910201410; MW-1
Lab ID:	9910033-01A	Matrix:	AQUEOUS
Project:	Florance #44	Collection Date:	10/20/99 2:10:00 PM
		COC Record:	7741

Parameter	Result	PQL	Qual	Units	DF	Date Analyzed
AROMATIC VOLATILES BY GC/PID		SW8021B		Analyst: DC		
Benzene	ND	0.5		µg/L	1	10/25/99
Toluene	ND	0.5		µg/L	1	10/25/99
Ethylbenzene	ND	0.5		µg/L	1	10/25/99
m,p-Xylene	ND	1		µg/L	1	10/25/99
o-Xylene	ND	0.5		µg/L	1	10/25/99

Qualifiers:	PQL - Practical Quantitation Limit	S - Spike Recovery outside accepted recovery limits
	ND - Not Detected at Practical Quantitation Limit	R - RPD outside accepted recovery limits
	J - Analyte detected below Practical Quantitation Limit	E - Value above quantitation range
	B - Analyte detected in the associated Method Blank	Surr: - Surrogate

P.O. BOX 2606 • FARMINGTON, NM 87499

- TECHNOLOGY BLENDING INDUSTRY WITH THE ENVIRONMENT -

OFF: (505) 325-5667



LAB: (505) 325-1556

ANALYTICAL REPORT

Date: 01-Nov-99

Client:	PNM - Public Service Company of NM	Client Sample Info:	Florance #44
Work Order:	9910033	Client Sample ID:	9910201435; MW-6
Lab ID:	9910033-02A	Matrix:	AQUEOUS
Project:	Florance #44	Collection Date:	10/20/99 2:35:00 PM
		COC Record:	7741

Parameter	Result	PQL	Qual	Units	DF	Date Analyzed
AROMATIC VOLATILES BY GC/PID		SW8021B		Analyst: DC		
Benzene	ND	0.5		µg/L	1	10/25/99
Toluene	ND	0.5		µg/L	1	10/25/99
Ethylbenzene	ND	0.5		µg/L	1	10/25/99
m,p-Xylene	ND	1		µg/L	1	10/25/99
o-Xylene	ND	0.5		µg/L	1	10/25/99

Qualifiers:

PQL - Practical Quantitation Limit

ND - Not Detected at Practical Quantitation Limit

J - Analyte detected below Practical Quantitation Limit

B - Analyte detected in the associated Method Blank

S - Spike Recovery outside accepted recovery limits

R - RPD outside accepted recovery limits

E - Value above quantitation range

Surr: - Surrogate

1 of 1

P.O. BOX 2606 • FARMINGTON, NM 87499

- TECHNOLOGY BLENDING INDUSTRY WITH THE ENVIRONMENT -

OFF: (505) 325-5667



LAB: (505) 325-1556

ANALYTICAL REPORT

Date: 01-Nov-99

Client:	PNM - Public Service Company of NM	Client Sample Info:	Florance #44
Work Order:	9910033	Client Sample ID:	9910201450; MW-5
Lab ID:	9910033-03A	Matrix:	AQUEOUS
Project:	Florance #44	Collection Date:	10/20/99 2:50:00 PM
		COC Record:	7741

Parameter	Result	PQL	Qual	Units	DF	Date Analyzed
AROMATIC VOLATILES BY GC/PID		SW8021B		Analyst: DC		
Benzene	ND	0.5		µg/L	1	10/25/99
Toluene	ND	0.5		µg/L	1	10/25/99
Ethylbenzene	ND	0.5		µg/L	1	10/25/99
m,p-Xylene	ND	1		µg/L	1	10/25/99
o-Xylene	ND	0.5		µg/L	1	10/25/99

Qualifiers:

PQL - Practical Quantitation Limit
ND - Not Detected at Practical Quantitation Limit
J - Analyte detected below Practical Quantitation Limit
B - Analyte detected in the associated Method Blank

S - Spike Recovery outside accepted recovery limits
R - RPD outside accepted recovery limits
E - Value above quantitation range
Surr: - Surrogate

1 of 1

P.O. BOX 2606 • FARMINGTON, NM 87499

- TECHNOLOGY BLENDING INDUSTRY WITH THE ENVIRONMENT -

OFF: (505) 325-5667



LAB: (505) 325-1556

ANALYTICAL REPORT

Date: 01-Nov-99

Client:	PNM - Public Service Company of NM	Client Sample Info:	Florance #44
Work Order:	9910033	Client Sample ID:	9910201515; MW-4
Lab ID:	9910033-04A	Matrix:	AQUEOUS
Project:	Florance #44	Collection Date:	10/20/99 3:15:00 PM
		COC Record:	7741

Parameter	Result	PQL	Qual	Units	DF	Date Analyzed
AROMATIC VOLATILES BY GC/PID		SW8021B		Analyst: DC		
Benzene	ND	0.5		µg/L	1	10/25/99
Toluene	ND	0.5		µg/L	1	10/25/99
Ethylbenzene	ND	0.5		µg/L	1	10/25/99
m,p-Xylene	ND	1		µg/L	1	10/25/99
o-Xylene	ND	0.5		µg/L	1	10/25/99

Qualifiers:

PQL - Practical Quantitation Limit

ND - Not Detected at Practical Quantitation Limit

J - Analyte detected below Practical Quantitation Limit

B - Analyte detected in the associated Method Blank

S - Spike Recovery outside accepted recovery limits

R - RPD outside accepted recovery limits

E - Value above quantitation range

Surr: - Surrogate

P.O. BOX 2606 • FARMINGTON, NM 87499

- TECHNOLOGY BLENDING INDUSTRY WITH THE ENVIRONMENT -

1 of 1

OFF: (505) 325-5667



LAB: (505) 325-1556

ANALYTICAL REPORT

Date: 01-Nov-99

Client:	PNM - Public Service Company of NM	Client Sample Info:	Florance #44
Work Order:	9910033	Client Sample ID:	9910201530; MW-7
Lab ID:	9910033-05A	Matrix:	AQUEOUS
Project:	Florance #44	Collection Date:	10/20/99 3:30:00 PM
		COC Record:	7741

Parameter	Result	PQL	Qual	Units	DF	Date Analyzed
AROMATIC VOLATILES BY GC/PID		SW8021B		Analyst: DC		
Benzene	ND	0.5		µg/L	1	10/25/99
Toluene	ND	0.5		µg/L	1	10/25/99
Ethylbenzene	ND	0.5		µg/L	1	10/25/99
m,p-Xylene	ND	1		µg/L	1	10/25/99
o-Xylene	ND	0.5		µg/L	1	10/25/99

Qualifiers:

PQL - Practical Quantitation Limit

ND - Not Detected at Practical Quantitation Limit

J - Analyte detected below Practical Quantitation Limit

B - Analyte detected in the associated Method Blank

S - Spike Recovery outside accepted recovery limits

R - RPD outside accepted recovery limits

E - Value above quantitation range

Surr: - Surrogate

1 of 1

P.O. BOX 2606 • FARMINGTON, NM 87499

- TECHNOLOGY BLENDING INDUSTRY WITH THE ENVIRONMENT -

