

3R - 335

REPORTS

DATE:

JAN. 28, 1999

Public Service Company
of New Mexico
603 W. Elm - P.O. Box 4750
Farmington, NM 87499
505 950-1997
Fax 505 325-7365

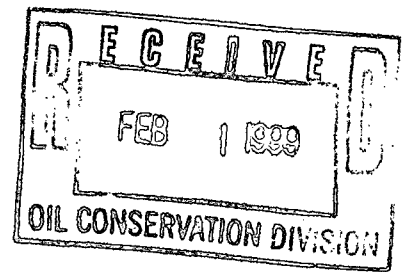

January 28, 1999

Oil Conservation Division
Attention: Bill Olson
2040 South Pacheco
Santa Fe, NM 87505



Subject: OCD Closure Reports – Groundwater Sites
4th Reporting Quarter, 1998

Dear Mr. Olson:

PNM Environmental Services is submitting closure reports to the Oil Conservation Division for the following groundwater sites:

Miles Federal #1E
Turner #3

In addition, I will be sending you copies of closure reports for OCD/BLM and Jicarilla soil sites via regular US mail.

If you have any questions, please call me at 324-3764.

Sincerely,

A handwritten signature in cursive script that reads "Kathy Juckes".

Kathy Juckes
Staff Assistant III

cc: Denny Foust
BLM - Farmington
Williams Field Services

District I
P.O. Box 1980, Hobbs, NM

State of New Mexico
Energy, Minerals and Natural Resources Department

SUBMIT 1 COPY TO
APPROPRIATE
DISTRICT OFFICE
AND 1 COPY TO
SANTA FE OFFICE

District II
P.O. Drawer DD, Artesia, NM 88221

OIL CONSERVATION DIVISION

District III
1000 Rio Brazos Rd, Aztec, NM 87410

2040 South Pacheco Street
Santa Fe, New Mexico 87505

PIT REMEDIATION AND CLOSURE REPORT

Operator: <u>PNM Gas Services (Dreyfus)</u>		Telephone: <u>324-3764</u>	
Address: <u>603 W. Elm Street Farmington, NM 87401</u>			
Facility or Well Name: <u>Miles Federal #1E</u>			
Location:	Unit <u>N</u>	Sec <u>5</u>	T <u>26 N</u> R <u>7 W</u> County <u>Rio Arriba</u>
Pit Type:	Separator <input type="checkbox"/>	Dehydrator <input checked="" type="checkbox"/>	Other _____
Land Type:	BLM <input checked="" type="checkbox"/>	State <input type="checkbox"/>	Fee <input type="checkbox"/> Other _____
Pit Location:	Pit dimensions: length <u>20</u> ' width <u>20</u> ' depth <u>3</u> '		
(Attach diagram)	Reference: wellhead <input checked="" type="checkbox"/> other _____		
	Footage from reference: <u>98'</u>		
	Direction from reference: <u>40</u> Degrees <input checked="" type="checkbox"/> East <input checked="" type="checkbox"/> North <input type="checkbox"/> West <input type="checkbox"/> South _____ of _____		
Depth to Ground Water:	Less than 50 feet	(20 points)	
	50 feet to 99 feet	(10 points)	
	Greater than 100 feet	(0 points)	<u>20</u>
<small>(Vertical distance from contaminants to seasonal high water elevation of ground water)</small>			
RECEIVED			
Wellhead Protection Area:	Yes	(20 points)	
	No	(0 points)	<u>20</u>
<small>(Less than 200 feet from a private domestic water source, or; less than 1,000 feet from all other water sources)</small>			
FEB 01 1999 ENVIRONMENTAL BUREAU OIL CONSERVATION DIVISION			
Distance to Surface Water:	Less than 200 feet	(20 points)	
	200 feet to 1,000 feet	(10 points)	
	Greater than 1,000 feet	(0 points)	<u>20</u>
<small>(Horizontal distance to perennial lakes, ponds, rivers, streams, creeks, irrigation canals and ditches)</small>			
RANKING SCORE (TOTAL POINTS) :			<u>60</u>

Miles Federal #1E

Date Remediation Started: 6/4/97

Date Completed: 6/6/97

Remediation Method: Excavation X

Approx. Cubic Yard 684

(Check all appropriate sections)

Landfarmed X

Amount Landfarmed (cubic yds) 466

Other 218 cu. yds. clean overburden.

Remediation Location: Onsite X

Offsite _____

(i.e., landfarmed onsite, name and location of offsite facility)

Backfill Material Location: _____

General Description of Remedial Action:

Excavated pit to a pit size of 27' X 38' X 18' and landfarmed soil onsite within a bermed area at a depth of 6" to 12". Soil was aerated by plowing/disking until soil met regulatory levels.

*** See Groundwater Report (attached).

Ground Water Encountered: No Yes Depth 16'

Final Pit Closure Sampling:

Sample Location Middle of pit.

(if multiple samples, attach sample result and diagram of sample locations and depths.)

Sample depth 16'

Sample date 6/6/97 Sample time 8:30:00 AM

Sample Results

Benzene (ppm) 0.0950

Total BTEX (ppm) 1.4430

Field headspace (ppm) _____

TPH (ppm) *** Method 8020

Vertical Extent (ft) _____ Risk Analysis form attached Yes No

Ground Water Sample: Yes No (If yes, see attached Groundwater Site Summary Report)

I HEREBY CERTIFY THAT THE INFORMATION ABOVE IS TRUE AND COMPLETE TO THE BEST OF MY KNOWLEDGE AND MY BELIEF

DATE January 26, 1999

PRINTED NAME **Maureen Gannon**
AND TITLE **Project Manager**

SIGNATURE Maureen Gannon

Miles Federal #1 E
Louis Oreyfus Natural Gas Corp.
Sec. 5, 26N, 7W, N

6-4-97

Start of excavation:

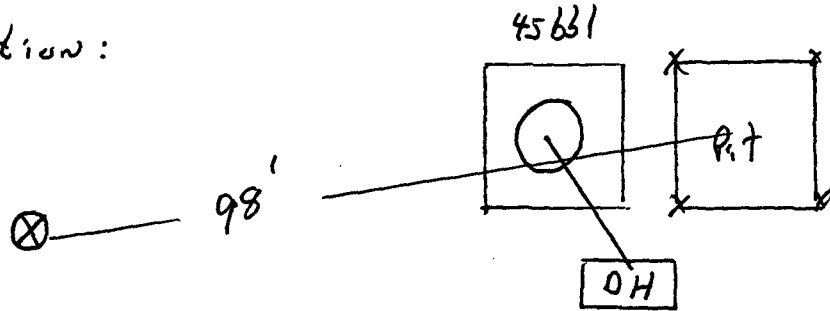

End of excavation:

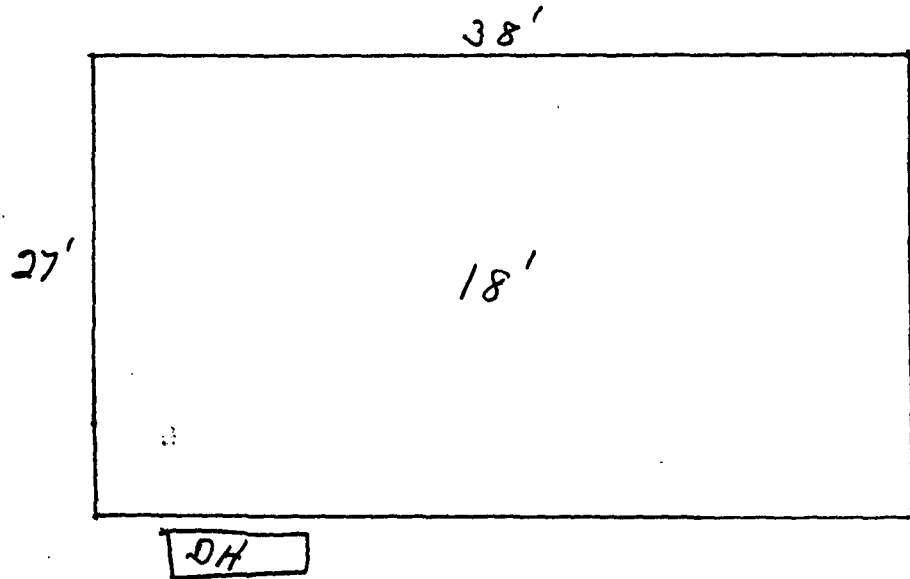

H₂O at 16'

OFF: (505) 325-5667



LAB: (505) 325-1556

ANALYTICAL REPORT

Attn: *Denver Bearden*
 Company: *PNM Gas Services*
 Address: *603 W. Elm*
 City, State: *Farmington, NM 87401*

Date: *17-Jun-97*
 COC No.: *5881*
 Sample No.: *14875*
 Job No.: *2-1000*

Project Name: *PNM Gas Services - Miles Federal #1E*
 Project Location: *9706060830*
 Sampled by: *GC* Date: *6-Jun-97* Time: *8:30*
 Analyzed by: *DC* Date: *12-Jun-97*
 Sample Matrix: *Liquid*

Parameter	Results as Received	Unit of Measure	Limit of Quantitation	Unit of Measure
<i>Benzene</i>	<i>95</i>	<i>ug/L</i>	<i>2</i>	<i>ug/L</i>
<i>Toluene</i>	<i>526</i>	<i>ug/L</i>	<i>2</i>	<i>ug/L</i>
<i>Ethylbenzene</i>	<i>38</i>	<i>ug/L</i>	<i>2</i>	<i>ug/L</i>
<i>m,p-Xylene</i>	<i>619</i>	<i>ug/L</i>	<i>2</i>	<i>ug/L</i>
<i>o-Xylene</i>	<i>164</i>	<i>ug/L</i>	<i>2</i>	<i>ug/L</i>
<i>TOTAL</i>	<i>1443</i>	<i>ug/L</i>		

ND - Not Detected at Limit of Quantitation

Method - SW-846 EPA Method 8020A Aromatic Volatile Organics by Gas Chromatography

Approved By: *[Signature]*
 Date: *6/17/97*

P.O. BOX 2606 • FARMINGTON, NM 87499

TECHNOLOGY BLENDING INDUSTRY WITH THE ENVIRONMENT

7
N

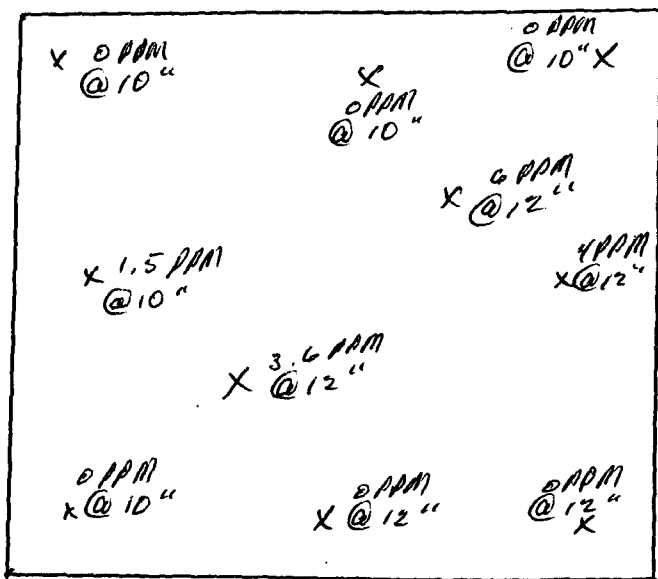

Miles Federal IE

6-28-97

@ 1130

OFF: (505) 325-5667



LAB: (505) 325-1556

ANALYTICAL REPORT

Attn: *Denver Bearden*
 Company: *PNM Gas Services*
 Address: *603 W. Elm*
 City, State: *Farmington, NM 87401*

Date: *3-Jul-97*
 COC No.: *5178*
 Sample No.: *15144*
 Job No.: *2-1000*

Project Name: *PNM Gas Services - Miles Federal 1E Landfarm*
 Project Location: *9706281130; 10pt. Composite*
 Sampled by: *RH* Date: *28-Jun-97* Time: *11:30*
 Analyzed by: *DC/HR* Date: *3-Jul-97*
 Sample Matrix: *Soil*

Laboratory Analysis

Parameter	Results as Received	Unit of Measure	Limit of Quantitation	Unit of Measure
<i>Diesel Range Organics (C10 - C28)</i>	<i>64</i>	<i>mg/kg</i>	<i>5</i>	<i>mg/kg</i>

ND - Not Detected at Limit of Quantitation

Quality Assurance Report

DRO QC No.: 0548-STD

Continuing Calibration Verification

Parameter	Method Blank	Unit of Measure	True Value	Analyzed Value	RPD	RPD Limit
<i>Diesel Range (C10 - C28)</i>	<i>ND</i>	<i>ppm</i>	<i>200</i>	<i>189</i>	<i>5.6</i>	<i>15%</i>

Matrix Spike

Parameter	1- Percent Recovered	2 - Percent Recovered	Limit	RPD	RPD Limit
<i>Diesel Range (C10-C28)</i>	<i>96</i>	<i>98</i>	<i>(70-130)</i>	<i>2</i>	<i>20%</i>

Method - SW-846 EPA Method 8015A mod. - Nonhalogenated Volatile Hydrocarbons by Gas Chromatography

Approved by: *DAC*
 Date: *7/3/97*

P.O. BOX 2606 • FARMINGTON, NM 87499

- TECHNOLOGY BLENDING INDUSTRY WITH THE ENVIRONMENT -

OFF: (505) 325-5667



LAB: (505) 325-1556

ANALYTICAL REPORT

Attn: *Denver Bearden*
 Company: *PNM Gas Services*
 Address: *603 W. Elm*
 City, State: *Farmington, NM 87401*

Date: *3-Jul-97*
 COC No.: *5178*
 Sample No.: *15144*
 Job No.: *2-1000*

Project Name: *PNM Gas Services - Miles Federal 1E Landfarm*

Project Location: *9706281130; 10pt. Composite*

Sampled by: *RH* Date: *28-Jun-97* Time: *11:30*

Analyzed by: *DC* Date: *30-Jun-97*

Sample Matrix: *Soil*

Laboratory Analysis

Parameter	Results as Received	Unit of Measure	Limit of Quantitation	Unit of Measure
<i>Benzene</i>	<i>ND</i>	<i>ug/kg</i>	<i>1</i>	<i>ug/kg</i>
<i>Toluene</i>	<i>11</i>	<i>ug/kg</i>	<i>1</i>	<i>ug/kg</i>
<i>Ethylbenzene</i>	<i>4</i>	<i>ug/kg</i>	<i>1</i>	<i>ug/kg</i>
<i>m,p-Xylene</i>	<i>64</i>	<i>ug/kg</i>	<i>1</i>	<i>ug/kg</i>
<i>o-Xylene</i>	<i>36</i>	<i>ug/kg</i>	<i>1</i>	<i>ug/kg</i>
	TOTAL	<i>115</i>		<i>ug/kg</i>

ND - Not Detected at Limit of Quantitation

Method - SW-846 EPA Method 8020A Aromatic Volatile Organics by Gas Chromatography

Approved by: *[Signature]*
 Date: *7/13/97*

P.O. BOX 2606 • FARMINGTON, NM 87499

- TECHNOLOGY BLENDING INDUSTRY WITH THE ENVIRONMENT -

Groundwater Site Summary Report

Quarter/Year: 2nd/98, 3rd/98

Operator: Dreyfus
Sec: 5 Twn: 26N Rng: 7W Unit: N
Canyon: Largo

Vulnerable Class: Original
OCD Ranking: 60
Lead Agency: NMOCD

Topo Map: Figure 1

Well Completion Diagram: previously submitted

Site Map with Analytical Results: Figure 2

Groundwater Contour Map: Figure 3 (December 1997), Figure 4 (February 1998), Figure 5 (May 1998) and Figure 6 (September 1998)

Hydrograph: Figure 7

Full Suite-Groundwater Sampling Results: previously submitted

Analytical Results: attached

Site Hydrology:

The Miles Federal 1E site lies in the alluvial deposits of Largo Canyon. Largo Canyon is a perennial stream which runs from southeast to northwest across the area of the site. Alluvium lying between steep canyon walls is several thousand feet wide at the site. Thickness of valley-fill alluvium deposits may exceed 100 feet (Stone et al., 1983). Regional flow in the alluvial aquifer is expected to be towards the northwest, following the topographic gradient of Largo Canyon.

The site is situated where Big Rincón Canyon runs into Largo Canyon. Big Rincón flows northward and its alluvial deposits span a width of 250 feet or more. The influence of Big Rincón Canyon would impart a northerly flow direction to conditions beneath the site. Depth to water is shallow at the site (about ten feet below land surface). The site is located about ten feet or so higher in elevation than the main channel of Largo Canyon, which is less than 1000 feet north of the site. Groundwater at the site should discharge as surface water flow in Largo Canyon, or follow the regional gradient northwest after joining the flow beneath Largo Canyon.

Groundwater elevation data indicate that flow is towards the north-northwest, as expected. Seasonal water level maps show a consistent gradient of about 0.004 (.2 ft./50 ft.), with insignificant changes in flow direction through time.

Materials in the borings were reportedly silty and clayey. Relatively low hydraulic conductivity values would therefore be expected. Organic carbon would also tend to be higher. These factors, combined with the low hydraulic gradient, would tend to produce slow contaminant movement beneath the site.

Activities for Previous Year:

PNM performed groundwater monitoring at the well site during the second and third quarter of 1998 on May 20, 1998 and September 24, 1998, respectively. Previous activities and monitoring events at the site were reported in PNM's 1998 Annual Groundwater Report. Laboratory results and groundwater contour maps for the previous four quarters are provided for reference. During the May and September 1998 sampling events, water level measurements were taken in each of the four monitoring wells. PNM conducted groundwater sampling in the appropriate well(s) for chemical analyses of benzene, toluene, ethylbenzene, and xylenes (BTEX). MW-1 and MW-2 were resampled for sulfates and lead in September 1998. All sampling was performed in strict compliance with EPA protocol.

PNM delivered the samples to OnSite Technologies, Farmington, New Mexico. The samples were analyzed using the following methods:

Public Service Company of New Mexico - Gas Services

Environmental Services Division - Alvarado Square, MS-0408
Albuquerque, NM 87158

Contact: Maureen Gannon

Telephone: 505-241-2974

January 27, 1999

4th Qtr 1998 Pit Closure Report

PNMGS Well Site: Miles Federal 1E (cont'd)

- benzene, toluene, ethylbenzene, and xylenes (BTEX) using EPA Method 8020
- major cations/anions using various EPA methods
- WQCC metals- filtered (Pb).

Results:

Figure 1 is an updated topographic map showing the site location. Figure 2 presents the site map with analytical results to date. MW-1, -3 and -4 show BTEX concentrations to be non-detectable or below WQCC standards since monitoring began. Over several quarters, MW-2, the source well, exhibited a significant downward trend in BTEX concentration and has been below WQCC standards for four consecutive quarters. The water quality analysis shows MW-1 and MW-2 with elevated levels of sulfates (which are common in the region). The most recent sampling round of lead in MW-1 and MW-2 indicates lead concentrations at the site are below the method detection limit.

Figures 3, 4, 5 and 6 provide groundwater contour maps for December 1997 and February, May and September 1998, respectively. Figure 7 is an updated hydrograph for the site. All wells exhibited decreases in water levels through 1998. Flow has been north-northwest for the last four quarters of groundwater monitoring.

Future Actions:

Consistent with PNM's San Juan Basin Groundwater Management Plan, PNM requests closure of the Miles Federal 1E. This request is based upon the analytical data collected over the last two years at the site. BTEX concentrations have been consistently below WQCC standards for four consecutive quarters. The remediation approach at the site was effective. The monitoring well network appears to provide representative data, sufficient to discriminate seasonal trends. The data collected show that groundwater beneath the site cleaned up quickly once excavation was complete and has remained clean through seasonal variations in flow direction. Based on these considerations, PNM requests OCD approve closure of PNM's former pit at the Miles Federal 1E site.

Upon approval of this groundwater closure report, PNM will plug and abandon the four groundwater monitoring wells at the Miles Federal 1E. The concrete pad and metal vault surrounding each well will be removed. The well casing will be cut to ground surface and each well will be plugged to the surface with cement containing 5% bentonite.

Public Service Company of New Mexico - Gas Services

Environmental Services Division - Alvarado Square, MS-0408
Albuquerque, NM 87158

Contact: Maureen Gannon

Telephone: 505-241-2974

January 27, 1999
4th Qtr 1998 Pit Closure Report



Figure 1.
Miles Federal 1E Groundwater Site
Twn. 26N Rng. 7W Sec. 5 Unit N



Gould Pass, NM Quadrangle

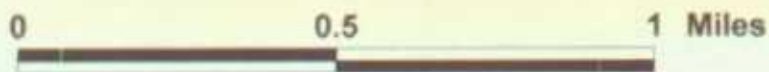
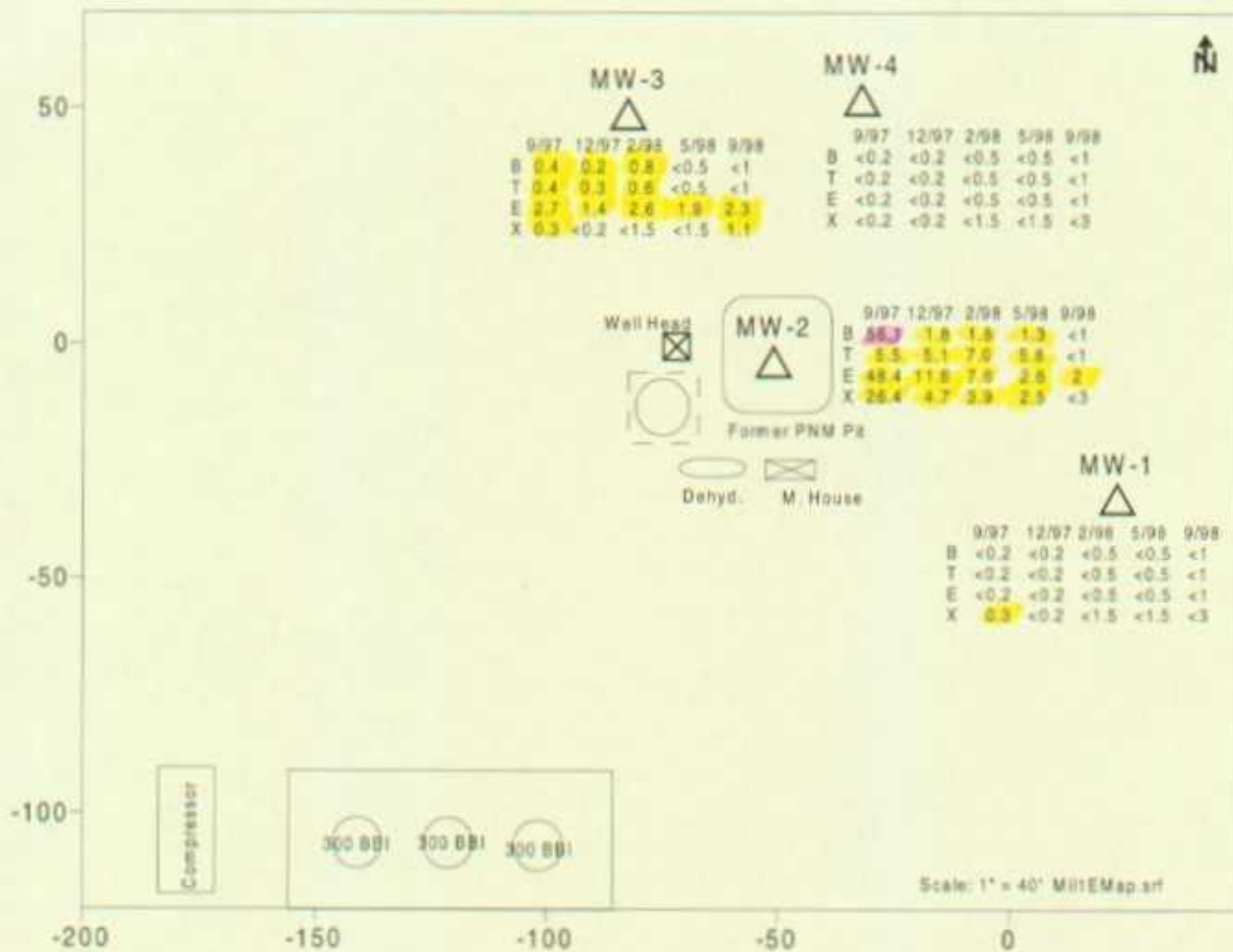
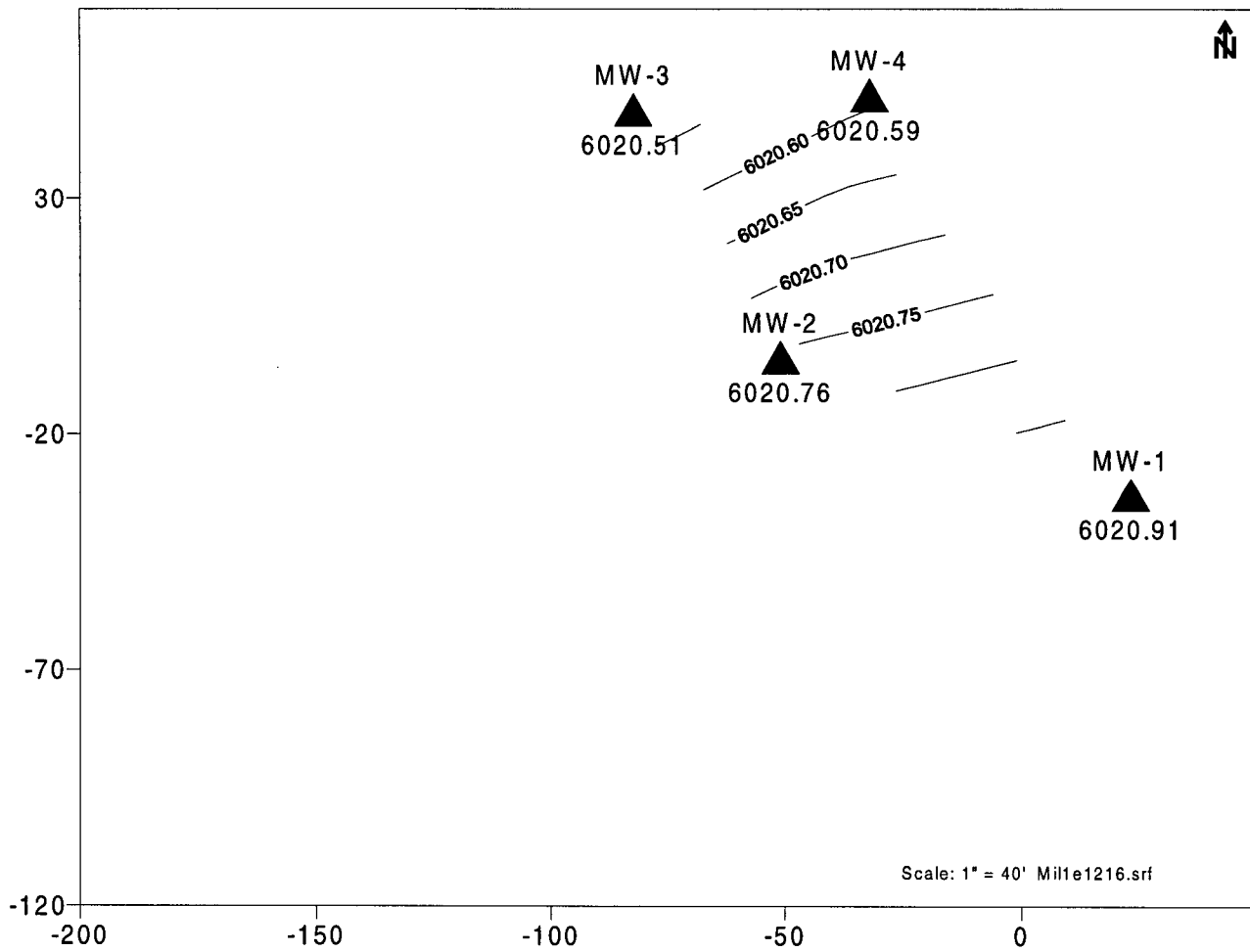

Figure 2
Miles Federal 1E Site Map and Analytical Results
(Concentrations in ppb)

Largo Canyon



**Figure 3. Miles Federal 1E Groundwater Contour Map
(December 16, 1997)**



**Figure 4. Miles Federal 1E Groundwater Contour Map
(February 10, 1998)**

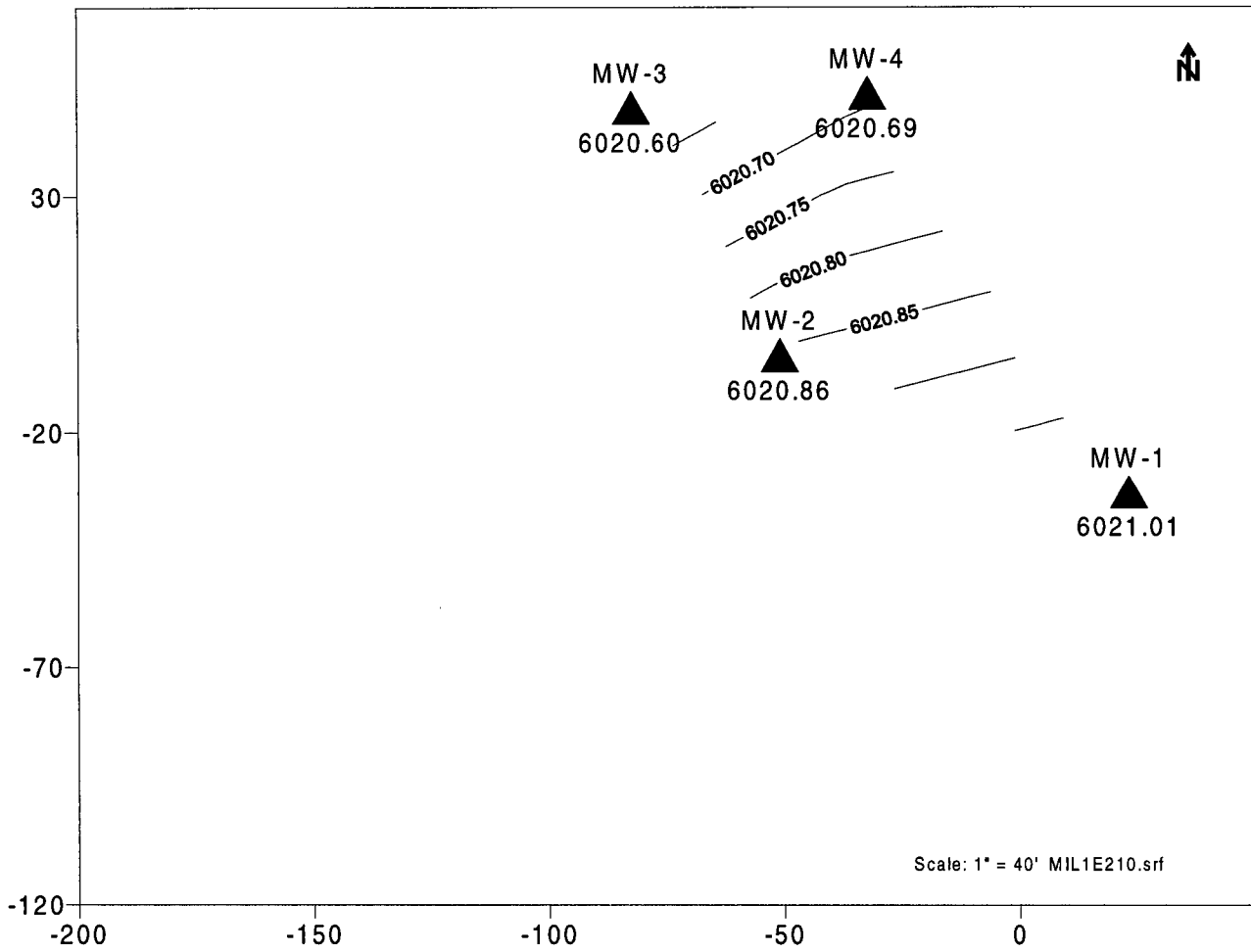

**Figure 5. Miles Federal 1E Groundwater Contour Map
(May 20, 1998)**

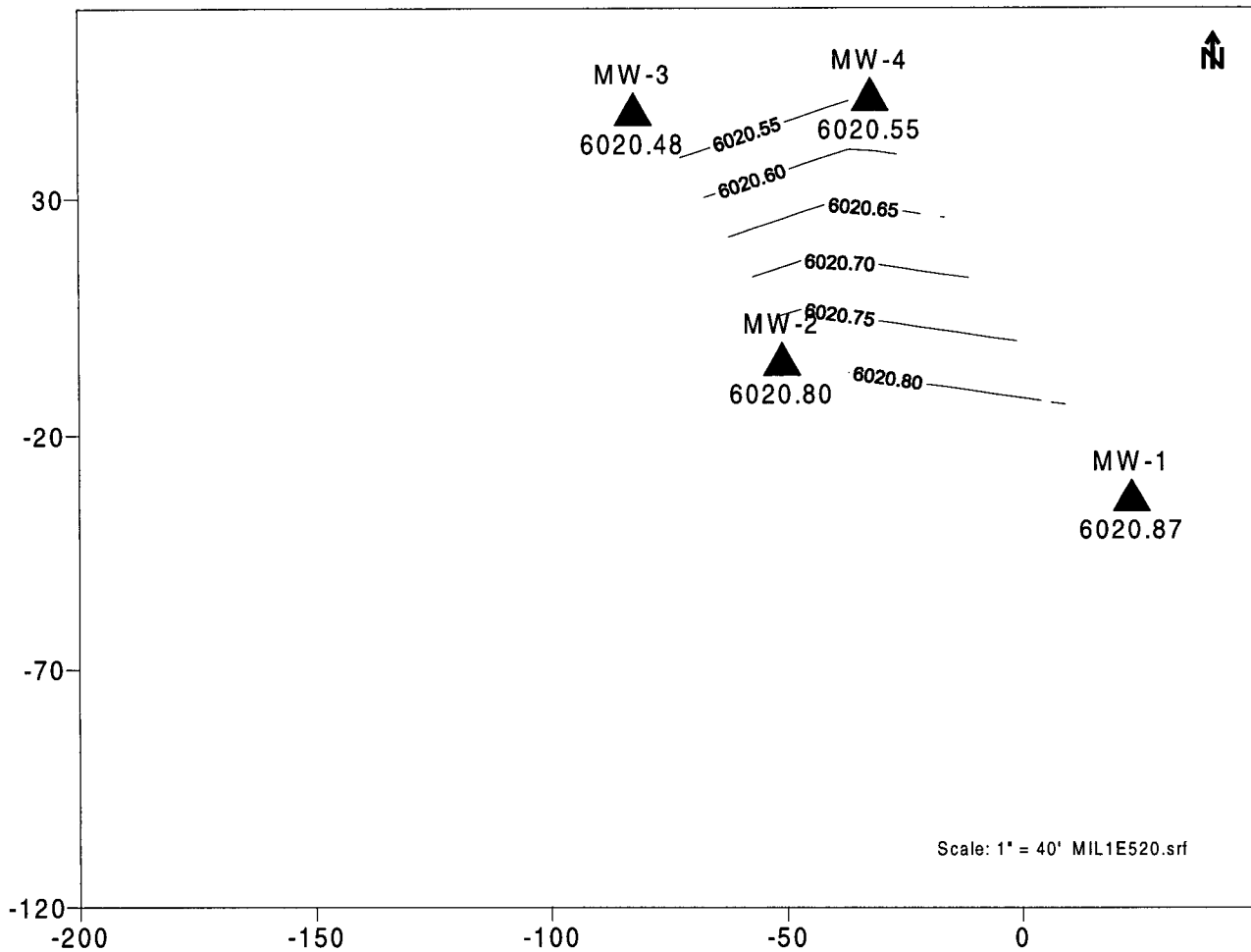

**Figure 6. Miles Federal 1E Groundwater Contour Map
(September 24, 1998)**

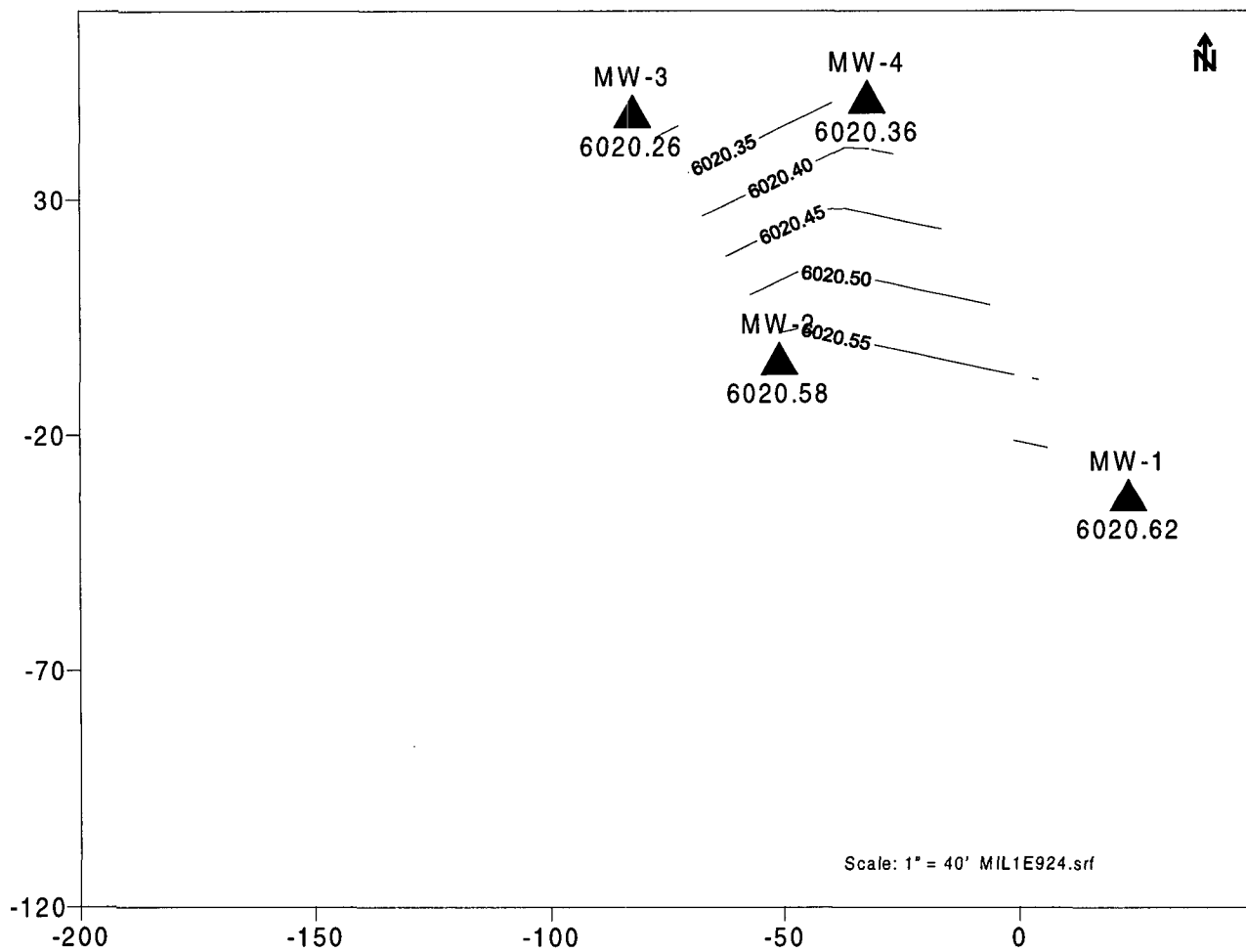
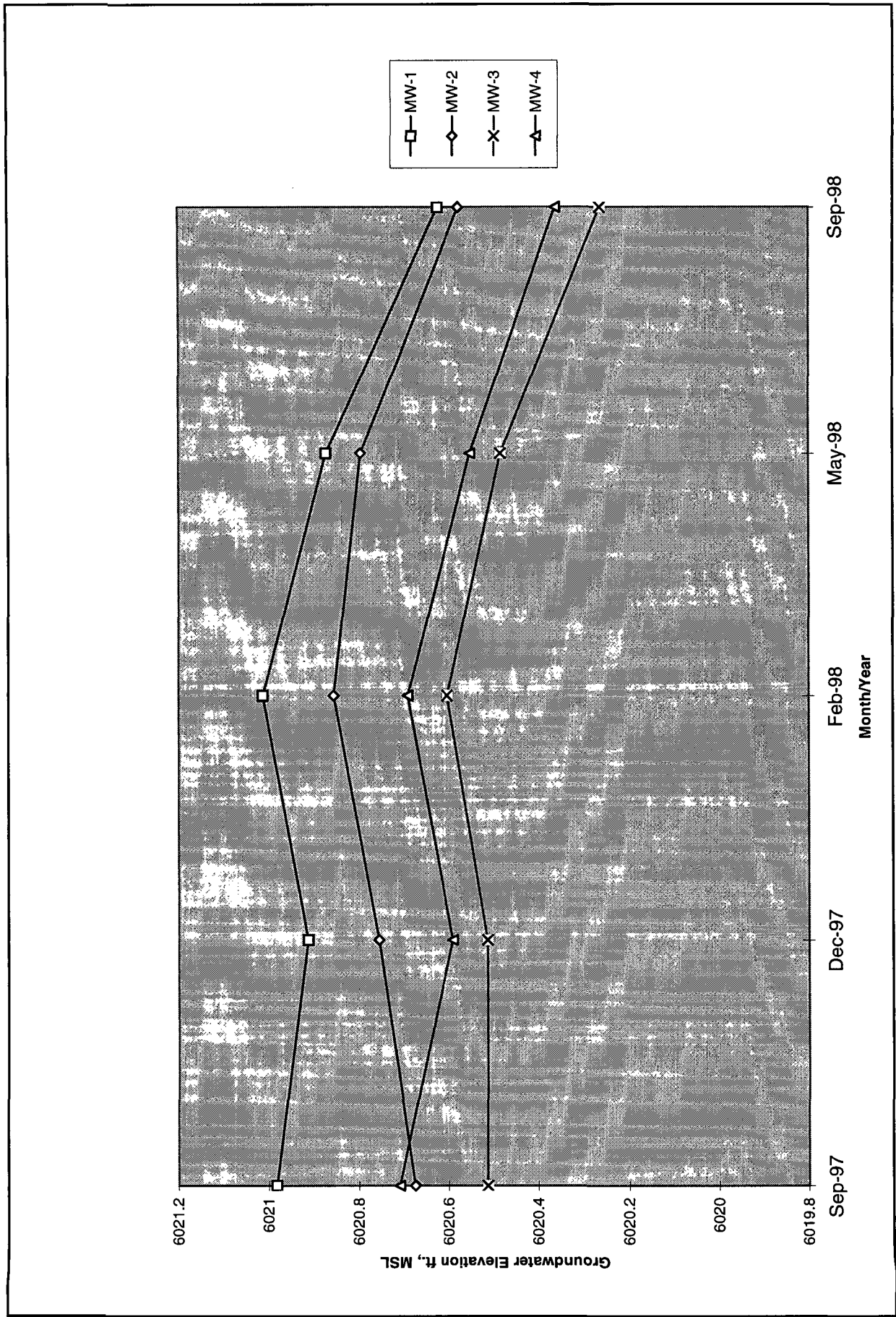

Figure 7. Miles Federal 1E Hydrograph



OFF: (505) 325-5667



LAB: (505) 325-1556

October 19, 1998

Maureen Gannon
PNM - Public Service Company of NM
Alvarado Square Mail Stop 0408
Albuquerque, NM 87158
TEL: (505) 241-2974
FAX (505) 241-2340

3rd Quarter 1998

RE: Miles Federal 1E

Order No.: 9809075

Dear Maureen Gannon,

On Site Technologies, LTD. received 5 samples on 9/25/98 for the analyses presented in the following report.

The Samples were analyzed for the following tests:

Alkalinity, Total (M2320 B)
BTEX (SW8020A)
Calcium by AA (SW7140)
Chloride (M4500-Cl C.)
~~Conductivity (E120.1)~~
Hardness, Total (E130.1)
Lead, Dissolved (SW6010A)
Magnesium by AA (SW7450)
pH (E150.1)
Potassium by AA (SW7610)
Sodium by AA (SW7770)
Sulfate (M4500-SO4 D)
Total Dissolved Solids (M2540 C.)

There were no problems with the analyses and all data for associated QC met EPA or laboratory specifications except where noted in the Case Narrative.

If you have any questions regarding these tests results, please feel free to call.

Sincerely,

A handwritten signature in black ink, appearing to read "David Cox".

David Cox

OFF: (505) 325-5667



LAB: (505) 325-1556

On Site Technologies, LTD.

Date: 19-Oct-98

CLIENT: PNM - Public Service Company of NM
Project: Miles Federal 1E
Lab Order: 9809075

CASE NARRATIVE

Samples were analyzed using the methods outlined in the following references:

Test Methods for Evaluating Solid Waste, Physical/Chemical Methods, SW846, 3rd Edition.

Standard Methods for The Examination of Water and Wastewater, 18th Edition.

All method blanks, laboratory spikes, and/or matrix spikes met quality assurance objectives.

Cation-Anion Balance 9809075-01A: Miles Federal 1E, MW-1

Total Cation-Anion = 57.12 me/L
Difference Cation-Anion = 2.35 me/L
% Difference = 4.1%

Cation-Anion Balance 9809075-02A: Miles Federal 1E, MW-2

Total Cation-Anion = 131.62 me/L
Difference Cation-Anion = 5.71 me/L
% Difference = 4.3%

OFF: (505) 325-5667



LAB: (505) 325-1556

ANALYTICAL REPORT

Date: 19-Oct-98

Client:	PNM - Public Service Company of NM	Client Sample Info:	Miles Federal 1E
Work Order:	9809075	Client Sample ID:	9809241700; MW-2
Lab ID:	9809075-02A	Matrix:	AQUEOUS
Project:	Miles Federal 1E	Collection Date:	9/24/98 5:00:00 PM
		COC Record:	7296

Parameter	Result	PQL	Qual	Units	DF	Date Analyzed
BTEX		SW8020A				Analyst: DC
Benzene	ND	1		µg/L	1	10/5/98
Toluene	ND	1		µg/L	1	10/5/98
Ethylbenzene	2	1		µg/L	1	10/5/98
m,p-Xylene	ND	2		µg/L	1	10/5/98
o-Xylene	ND	1		µg/L	1	10/5/98

Qualifiers:	PQL - Practical Quantitation Limit	S - Spike Recovery outside accepted recovery limits
	ND - Not Detected at Practical Quantitation Limit	R - RPD outside accepted recovery limits
	J - Analyte detected below Practical Quantitation Limit	E - Value above quantitation range
	B - Analyte detected in the associated Method Blank	Surr: - Surrogate

P.O. BOX 2606 • FARMINGTON, NM 87499

- TECHNOLOGY BLENDING INDUSTRY WITH THE ENVIRONMENT -



ANALYTICAL REPORT

Date: 19-Oct-98

Client:	PNM - Public Service Company of NM	Client Sample Info:	Miles Federal 1E
Work Order:	9809075	Client Sample ID:	9809241700; MW-2
Lab ID:	9809075-02B	Matrix:	AQUEOUS
Project:	Miles Federal 1E	Collection Date:	9/24/98 5:00:00 PM
		COC Record:	7296

Parameter	Result	PQL	Qual	Units	DF	Date Analyzed
CALCIUM BY AA		SW7140				Analyst: HR
Calcium	380	25		mg/L	100	10/2/98
POTASSIUM BY AA		SW7610				Analyst: HR
Potassium	12	2.5		mg/L	10	10/2/98
MAGNESIUM BY AA		SW7450				Analyst: HR
Magnesium	80	6.2		mg/L	25	10/2/98
SODIUM BY AA		SW7770				Analyst: HR
Sodium	990	100		mg/L	400	10/2/98
ALKALINITY, TOTAL		M2320 B				Analyst: HR
Alkalinity, Bicarbonate (As CaCO3)	1400	20		mg/L CaCO3	1	9/29/98
Alkalinity, Carbonate (As CaCO3)	ND	20		mg/L CaCO3	1	9/29/98
Alkalinity, Total (As CaCO3)	1400	20		mg/L CaCO3	1	9/29/98
CHLORIDE		M4500-CL C.				Analyst: HR
Chloride	110	10		mg/L	1	9/29/98
CONDUCTIVITY		E120.1				Analyst: HR
Specific Conductance	4720	2		uS/cm	1	9/28/98
HARDNESS, TOTAL		E130.1				Analyst: HR
Hardness (As CaCO3)	1270	1		mg/L	1	10/2/98
PH		E150.1				Analyst: HR
pH	6.90	2		pH units	1	9/28/98
SULFATE		M4500-SO4 D				Analyst: HR
Sulfate	1800	25		mg/L	1	10/2/98
TOTAL DISSOLVED SOLIDS		M2540 C.				Analyst: HR
Total Dissolved Solids (Residue, Filterable)	4700	40		mg/L	1	10/2/98

Qualifiers:

PQL - Practical Quantitation Limit	S - Spike Recovery outside accepted recovery limits
ND - Not Detected at Practical Quantitation Limit	R - RPD outside accepted recovery limits
J - Analyte detected below Practical Quantitation Limit	E - Value above quantitation range
B - Analyte detected in the associated Method Blank	Surr: - Surrogate

OFF: (505) 325-5667



LAB: (505) 325-1556

ANALYTICAL REPORT

Date: 19-Oct-98

Client:	PNM - Public Service Company of NM	Client Sample Info:	Miles Federal 1E
Work Order:	9809075	Client Sample ID:	9809241730; MW-3
Lab ID:	9809075-03A	Matrix:	AQUEOUS
Project:	Miles Federal 1E	Collection Date:	9/24/98 5:30:00 PM
		COC Record:	7296

Parameter	Result	PQL	Qual	Units	DF	Date Analyzed
BTEX		SW8020A				Analyst: DC
Benzene	ND		1	µg/L	1	10/5/98
Toluene	ND		1	µg/L	1	10/5/98
Ethylbenzene	2.3		1	µg/L	1	10/5/98
m,p-Xylene	ND		2	µg/L	1	10/5/98
o-Xylene	1.1		1	µg/L	1	10/5/98

Qualifiers:	PQL - Practical Quantitation Limit	S - Spike Recovery outside accepted recovery limits
	ND - Not Detected at Practical Quantitation Limit	R - RPD outside accepted recovery limits
	J - Analyte detected below Practical Quantitation Limit	E - Value above quantitation range
	B - Analyte detected in the associated Method Blank	Surr: - Surrogate

P.O. BOX 2606 • FARMINGTON, NM 87499

- TECHNOLOGY BLENDING INDUSTRY WITH THE ENVIRONMENT -

OFF: (505) 325-5667



LAB: (505) 325-1556

ANALYTICAL REPORT

Date: 19-Oct-98

Client:	PNM - Public Service Company of NM	Client Sample Info:	Miles Federal 1E
Work Order:	9809075	Client Sample ID:	9809241800; MW-4
Lab ID:	9809075-04A	Matrix:	AQUEOUS
Project:	Miles Federal 1E	Collection Date:	9/24/98 6:00:00 PM
		COC Record:	7296

Parameter	Result	PQL	Qual	Units	DF	Date Analyzed
BTEX		SW8020A				Analyst: DC
Benzene	ND	1		µg/L	1	10/5/98
Toluene	ND	1		µg/L	1	10/5/98
Ethylbenzene	ND	1		µg/L	1	10/5/98
m,p-Xylene	ND	2		µg/L	1	10/5/98
o-Xylene	ND	1		µg/L	1	10/5/98

Qualifiers:	PQL - Practical Quantitation Limit	S - Spike Recovery outside accepted recovery limits
	ND - Not Detected at Practical Quantitation Limit	R - RPD outside accepted recovery limits
	J - Analyte detected below Practical Quantitation Limit	E - Value above quantitation range
	B - Analyte detected in the associated Method Blank	Surr: - Surrogate

P.O. BOX 2606 • FARMINGTON, NM 87499

OFF: (505) 325-5667



LAB: (505) 325-1556

ANALYTICAL REPORT

Date: 19-Oct-98

Client:	PNM - Public Service Company of NM	Client Sample Info:	Miles Federal 1E
Work Order:	9809075	Client Sample ID:	9809241830; MW-5
Lab ID:	9809075-05A	Matrix:	AQUEOUS
Project:	Miles Federal 1E	Collection Date:	9/24/98 6:30:00 PM
		COC Record:	7296

Parameter	Result	PQL	Qual	Units	DF	Date Analyzed
BTEX		SW8020A				Analyst: DC
Benzene	ND	1		µg/L	1	10/5/98
Toluene	ND	1		µg/L	1	10/5/98
Ethylbenzene	ND	1		µg/L	1	10/5/98
m,p-Xylene	ND	2		µg/L	1	10/5/98
o-Xylene	ND	1		µg/L	1	10/5/98

Qualifiers:

PQL - Practical Quantitation Limit	S - Spike Recovery outside accepted recovery limits
ND - Not Detected at Practical Quantitation Limit	R - RPD outside accepted recovery limits
J - Analyte detected below Practical Quantitation Limit	E - Value above quantitation range
B - Analyte detected in the associated Method Blank	Surr: - Surrogate

P.O. BOX 2606 • FARMINGTON, NM 87499

On Site Technologies, LTD.

Date: 19-Oct-98

CLIENT: PNM - Public Service Company of NM
Work Order: 9809075
Project: Miles Federal 1E

QC SUMMARY REPORT

Method Blank

Sample ID: MB1 Batch ID: GC-1_981005 Test Code: SW8020A Units: µg/L Analysis Date 10/5/98 Prep Date:
 Client ID: 9809075 Run ID: GC-1_981005A SeqNo: 7318

Analyte	Result	PQL	SPK value	SPK Ref Val	%REC	LowLimit	HighLimit	RPD Ref Val	%RPD	RPDLimit	Qual
Benzene	.045	1									J
Ethylbenzene	ND	1									
m,p-Xylene	ND	2									
Methyl tert-Butyl Ether	ND	1									
o-Xylene	ND	1									
Toluene	.0848	1									J

Sample ID: MB1 Batch ID: GC-1_981010 Test Code: SW8020A Units: µg/L Analysis Date 10/10/98 Prep Date:
 Client ID: 9809075 Run ID: GC-1_981010A SeqNo: 7552

Analyte	Result	PQL	SPK value	SPK Ref Val	%REC	LowLimit	HighLimit	RPD Ref Val	%RPD	RPDLimit	Qual
Benzene	.0539	1									J
Ethylbenzene	ND	1									
m,p-Xylene	.1836	2									J
o-Xylene	.0811	1									J
Toluene	.1533	1									J

Qualifiers: ND - Not Detected at the Reporting Limit S - Spike Recovery outside accepted recovery limits B - Analyte detected in the associated Method Blank
 J - Analyte detected below quantitation limits R - RPD outside accepted recovery limits

On Site Technologies, LTD.

Date: 19-Oct-98

CLIENT: PNM - Public Service Company of NM
 Work Order: 9809075
 Project: Miles Federal 1E

QC SUMMARY REPORT

Sample Matrix Spike

Sample ID: 9809063-06AMS Batch ID: GC-1_981005 Test Code: SW8020A Units: µg/L Analysis Date 10/5/98

Prep Date:

Client ID: 9809075 Run ID: GC-1_981005A

SeqNo: 7319

Analyte	Result	PQL	SPK value	SPK Ref Val	%REC	LowLimit	HighLimit	RPD Ref Val	%RPD	RPDLimit	Qual
Benzene	1445	10	400	1007	109.5%	56	128				S ✓
Ethylbenzene	1268	10	400	812.1	114.0%	78	107				
m,p-Xylene	983.7	20	800	150.6	104.1%	67	118				
Methyl tert-Butyl Ether	415.3	10	400	86.91	82.1%	70	130				
o-Xylene	490.4	10	400	97.51	98.2%	78	107				
Toluene	509	10	400	90.15	104.7%	74	116				

Sample ID: 9809063-06AMS Batch ID: GC-1_981005 Test Code: SW8020A Units: µg/L Analysis Date 10/5/98

Prep Date:

Client ID: 9809075 Run ID: GC-1_981005A

SeqNo: 7320

Analyte	Result	PQL	SPK value	SPK Ref Val	%REC	LowLimit	HighLimit	RPD Ref Val	%RPD	RPDLimit	Qual
Benzene	1360	10	400	1007	88.1%	56	128	1445	6.1%	12	
Ethylbenzene	1168	10	400	812.1	88.9%	78	107	1268	8.2%	11	
m,p-Xylene	898	20	800	150.6	93.4%	67	118	983.7	9.1%	10	
Methyl tert-Butyl Ether	403.8	10	400	86.91	79.2%	70	130	415.3	2.8%	15	
o-Xylene	463.9	10	400	97.51	91.6%	78	107	490.4	5.6%	14	
Toluene	473.3	10	400	90.15	95.8%	74	116	509	7.3%	14	

Sample ID: 9809078-01AMS Batch ID: GC-1_981010 Test Code: SW8020A Units: µg/L Analysis Date 10/10/98

Prep Date:

Client ID: 9809075 Run ID: GC-1_981010A

SeqNo: 7553

Analyte	Result	PQL	SPK value	SPK Ref Val	%REC	LowLimit	HighLimit	RPD Ref Val	%RPD	RPDLimit	Qual
Benzene	384.3	10	400	5.268	94.8%	56	128				
Ethylbenzene	413.4	10	400	1.482	103.0%	78	107				
m,p-Xylene	880.2	20	800	120.6	95.0%	67	118				
o-Xylene	388	10	400	5.668	95.6%	78	107				
Toluene	402.1	10	400	7.565	98.6%	74	116				

Qualifiers: ND - Not Detected at the Reporting Limit

S - Spike Recovery outside accepted recovery limits

B - Analyte detected in the associated Method Blank

J - Analyte detected below quantitation limits

R - RPD outside accepted recovery limits

QC SUMMARY REPORT

Sample Matrix Spike Duplicate

CLIENT: PNM - Public Service Company of NM
 Work Order: 9809075
 Project: Miles Federal IE

Sample ID: 9809078-01AMSD Batch ID: GC-1_981010 Test Code: SW8020A Units: µg/L Analysis Date 10/10/98 Prep Date:
 Client ID: 9809075 Run ID: GC-1_981010A SeqNo: 7555

Analyte	Result	PQL	SPK value	SPK Ref Val	%REC	LowLimit	HighLimit	RPD Ref Val	%RPD	RPDLimit	Qual
Benzene	380.5	10	400	5.268	93.8%	56	128	384.3	1.0%	12	
Ethylbenzene	398.8	10	400	1.482	99.3%	78	107	413.4	3.6%	11	
m,p-Xylene	871	20	800	120.6	93.8%	67	118	880.2	1.0%	10	
o-Xylene	395.5	10	400	5.668	97.5%	78	107	388	1.9%	14	
Toluene	400.5	10	400	7.565	98.2%	74	116	402.1	0.4%	14	

Sample ID: 9809082-01AMS Batch ID: GC-1_981010 Test Code: SW8020A Units: µg/L Analysis Date 10/12/98 Prep Date:
 Client ID: 9809075 Run ID: GC-1_981010A SeqNo: 7554

Analyte	Result	PQL	SPK value	SPK Ref Val	%REC	LowLimit	HighLimit	RPD Ref Val	%RPD	RPDLimit	Qual
Benzene	401.4	10	400	10.74	97.7%	56	128				
Ethylbenzene	1024	10	400	610	103.4%	78	107				
m,p-Xylene	1163	20	800	389.7	96.7%	67	118				
o-Xylene	531.8	10	400	128.1	100.9%	78	107				
Toluene	1033	10	400	628.1	101.1%	74	116				

Sample ID: 9809082-01AMSD Batch ID: GC-1_981010 Test Code: SW8020A Units: µg/L Analysis Date 10/12/98 Prep Date:
 Client ID: 9809075 Run ID: GC-1_981010A SeqNo: 7556

Analyte	Result	PQL	SPK value	SPK Ref Val	%REC	LowLimit	HighLimit	RPD Ref Val	%RPD	RPDLimit	Qual
Benzene	398.5	10	400	10.74	97.0%	56	128	401.4	0.7%	12	
Ethylbenzene	1017	10	400	610	101.7%	78	107	1024	0.7%	11	
m,p-Xylene	1158	20	800	389.7	96.0%	67	118	1163	0.4%	10	
o-Xylene	531.7	10	400	128.1	100.9%	78	107	531.8	0.0%	14	
Toluene	1028	10	400	628.1	99.9%	74	116	1033	0.5%	14	

Qualifiers: ND - Not Detected at the Reporting Limit S - Spike Recovery outside accepted recovery limits B - Analyte detected in the associated Method Blank
 J - Analyte detected below quantitation limits R - RPD outside accepted recovery limits

2 of 2

On Site Technologies, LTD.

Date: 19-Oct-98

CLIENT: PNM - Public Service Company of NM
Work Order: 9809075
Project: Miles Federal IE

QC SUMMARY REPORT
 Laboratory Control Spike - generic

Sample ID: LCS WATER Batch ID: GC-1_981005 Test Code: SW8020A Units: µg/L Analysis Date 10/5/98
 Client ID: 9809075 Run ID: GC-1_981005A SeqNo: 7317 Prep Date:

Analyte	Result	PQL	SPK value	SPK Ref Val	%REC	LowLimit	HighLimit	RPD Ref Val	%RPD	RPDLimit	Qual
Benzene	40.27	1	40	0.045	100.6%	56	128				
Ethylbenzene	41.28	1	40	0	103.2%	78	107				
m,p-Xylene	81.47	2	80	0	101.8%	67	118				
Methyl tert-Butyl Ether	36.37	1	40	0	90.9%	70	130				
o-Xylene	40.64	1	40	0	101.6%	78	107				
Toluene	40.08	1	40	0.0848	100.0%	74	116				

Sample ID: LCS WATER Batch ID: GC-1_981010 Test Code: SW8020A Units: µg/L Analysis Date 10/10/98
 Client ID: 9809075 Run ID: GC-1_981010A SeqNo: 7551 Prep Date:

Analyte	Result	PQL	SPK value	SPK Ref Val	%REC	LowLimit	HighLimit	RPD Ref Val	%RPD	RPDLimit	Qual
Benzene	38.35	1	40	0.0539	95.7%	56	128				
Ethylbenzene	38.82	1	40	0	97.0%	78	107				
m,p-Xylene	76.82	2	80	0.1836	95.8%	67	118				
o-Xylene	39.36	1	40	0.0811	98.2%	78	107				
Toluene	38.71	1	40	0.1533	96.4%	74	116				

Qualifiers: ND - Not Detected at the Reporting Limit
 J - Analyte detected below quantitation limits

J - Spike Recovery outside accepted recovery limits
 K - RPD outside accepted recovery limits

B - Analyte detected in the associated Method Blank

On Site Technologies, LTD.

Date: 19-Oct-98

CLIENT: PNM - Public Service Company of NM
 Work Order: 9809075
 Project: Miles Federal 1E

QC SUMMARY REPORT
 Continuing Calibration Verification Standard

Sample ID: CCV1 QC0606/07 Batch ID: GC-1_981005 Test Code: SW8020A Units: µg/L Analysis Date 10/5/98

Prep Date:

Client ID: 9809075 Run ID: GC-1_981005A

SeqNo: 7310

Analyte	Result	PQL	SPK value	SPK Ref Val	%REC	LowLimit	HighLimit	RPD Ref Val	%RPD	RPDLimit	Qual
Benzene	20.59	1	20	0	103.0%	85	115				
Ethylbenzene	21.17	1	20	0	105.9%	85	115				
m,p-Xylene	41.4	2	40	0	103.5%	85	115				
Methyl tert-Butyl Ether	19.69	1	20	0	98.4%	85	115				
o-Xylene	20.9	1	20	0	104.5%	85	115				
Toluene	20.68	1	20	0	103.4%	85	115				
1,4-Difluorobenzene	91.25	0	100	0	91.3%	70	130				
4-Bromochlorobenzene	98.67	0	100	0	98.7%	70	130				
Fluorobenzene	89.98	0	100	0	90.0%	70	130				

Sample ID: CCV2 QC0606/07 Batch ID: GC-1_981005 Test Code: SW8020A Units: µg/L Analysis Date 10/5/98

Prep Date:

Client ID: 9809075 Run ID: GC-1_981005A

SeqNo: 7311

Analyte	Result	PQL	SPK value	SPK Ref Val	%REC	LowLimit	HighLimit	RPD Ref Val	%RPD	RPDLimit	Qual
Benzene	20.37	1	20	0	101.9%	85	115				
Ethylbenzene	20.95	1	20	0	104.8%	85	115				
m,p-Xylene	41.04	2	40	0	102.6%	85	115				
Methyl tert-Butyl Ether	19.97	1	20	0	99.9%	85	115				
o-Xylene	20.79	1	20	0	104.0%	85	115				
Toluene	20.49	1	20	0	102.4%	85	115				
1,4-Difluorobenzene	91.26	0	100	0	91.3%	70	130				
4-Bromochlorobenzene	99.5	0	100	0	99.5%	70	130				
Fluorobenzene	89.66	0	100	0	89.7%	70	130				

Qualifiers: ND - Not Detected at the Reporting Limit
 J - Analyte detected below quantitation limits

§ - Spike Recovery outside accepted recovery limits
 ¶ - RPD outside accepted recovery limits

B - Analyte detected in the associated Method Blank

CLIENT: PNM - Public Service Company of NM

Work Order: 9809075

Project: Miles Federal 1E

QC SUMMARY REPORT

Continuing Calibration Verification Standard

Sample ID: CCV3 QC0606/07 Batch ID: GC-1_981005 Test Code: SW8020A Units: µg/L

Client ID: 9809075 Run ID: GC-1_981005A

Analysis Date 10/5/98

SeqNo: 7312

Prep Date:

Analyte	Result	PQL	SPK value	SPK Ref Val	%REC	LowLimit	HighLimit	RPD Ref Val	%RPD	RPDLimit	Qual
Benzene	20.52	1	20	0	102.6%	85	115				
Ethylbenzene	21.07	1	20	0	105.4%	85	115				
m,p-Xylene	41.62	2	40	0	104.0%	85	115				
Methyl tert-Butyl Ether	16.94	1	20	0	84.7%	85	115				
o-Xylene	21.32	1	20	0	106.6%	85	115				
Toluene	21.15	1	20	0	105.7%	85	115				
1,4-Difluorobenzene	90.25	0	100	0	90.3%	70	130				
4-Bromochlorobenzene	87.72	0	100	0	87.7%	70	130				
Fluorobenzene	88.84	0	100	0	88.8%	70	130				S

Sample ID: CCV4 QC0606/07 Batch ID: GC-1_981005 Test Code: SW8020A Units: µg/L

Client ID: 9809075 Run ID: GC-1_981005A

Analysis Date 10/5/98

SeqNo: 7313

Prep Date:

Analyte	Result	PQL	SPK value	SPK Ref Val	%REC	LowLimit	HighLimit	RPD Ref Val	%RPD	RPDLimit	Qual
Benzene	20.02	1	20	0	100.1%	85	115				
Ethylbenzene	20.55	1	20	0	102.8%	85	115				
m,p-Xylene	40.87	2	40	0	102.2%	85	115				
Methyl tert-Butyl Ether	17.77	1	20	0	88.9%	85	115				
o-Xylene	21.11	1	20	0	105.5%	85	115				
Toluene	20.74	1	20	0	103.7%	85	115				
1,4-Difluorobenzene	90.75	0	100	0	90.7%	70	130				
4-Bromochlorobenzene	85.14	0	100	0	85.1%	70	130				
Fluorobenzene	88.9	0	100	0	88.9%	70	130				

Qualifiers: ND - Not Detected at the Reporting Limit

J - Analyte detected below quantitation limits

§ - Spike Recovery outside accepted recovery limits

¶ - RPD outside accepted recovery limits

B - Analyte detected in the associated Method Blank

QC SUMMARY REPORT
Continuing Calibration Verification Standard

CLIENT: PNM - Public Service Company of NM
Work Order: 9809075
Project: Miles Federal 1E

Sample ID: CCV5 QC0606/07 Batch ID: GC-1_981005 Test Code: SW8020A Units: µg/L
Client ID: 9809075 Run ID: GC-1_981005A

Analysis Date 10/5/98
SeqNo: 7321

Prep Date:

Analyte	Result	PQL	SPK value	SPK Ref Val	%REC	LowLimit	HighLimit	RPD Ref Val	%RPD	RPDLimit	Qual
Benzene	19.79	1	20	0	99.0%	85	115				
Ethylbenzene	20.81	1	20	0	104.1%	85	115				
m,p-Xylene	40.81	2	40	0	102.0%	85	115				
o-Xylene	20.56	1	20	0	102.8%	85	115				
Toluene	20.34	1	20	0	101.7%	85	115				
1,4-Difluorobenzene	90.49	0	100	0	90.5%	70	130				
4-Bromochlorobenzene	87.07	0	100	0	87.1%	70	130				
Fluorobenzene	88.88	0	100	0	88.9%	70	130				

Sample ID: CCV6 QC0606/07 Batch ID: GC-1_981005 Test Code: SW8020A Units: µg/L
Client ID: 9809075 Run ID: GC-1_981005A

Analysis Date 10/5/98
SeqNo: 7314

Prep Date:

Analyte	Result	PQL	SPK value	SPK Ref Val	%REC	LowLimit	HighLimit	RPD Ref Val	%RPD	RPDLimit	Qual
Benzene	20.42	1	20	0	102.1%	85	115				
Ethylbenzene	22.58	1	20	0	112.9%	85	115				
m,p-Xylene	44.24	2	40	0	110.6%	85	115				
o-Xylene	21.04	1	20	0	105.2%	85	115				
Toluene	21.69	1	20	0	108.5%	85	115				
1,4-Difluorobenzene	88.39	0	100	0	88.4%	70	130				S
4-Bromochlorobenzene	62.52	0	100	0	62.5%	70	130				
Fluorobenzene	86.17	0	100	0	86.2%	70	130				

Qualifiers: ND - Not Detected at the Reporting Limit
J - Analyte detected below quantitation limits
S - Spike Recovery outside accepted recovery limits
R - RPD outside accepted recovery limits
B - Analyte detected in the associated Method Blank

CLIENT: PNM - Public Service Company of NM
 Work Order: 9809075
 Project: Miles Federal 1E

QC SUMMARY REPORT
 Continuing Calibration Verification Standard

Sample ID: CCV7 QC0606/07 Batch ID: GC-1_981005 Test Code: SW8020A Units: µg/L Analysis Date 10/5/98 Prep Date:
 Client ID: 9809075 Run ID: GC-1_981005A SeqNo: 7315

Analyte	Result	PQL	SPK value	SPK Ref Val	%REC	LowLimit	HighLimit	RPD Ref Val	%RPD	RPDLimit	Qual
Benzene	20.27	1	20	0	101.4%	85	115				
Ethylbenzene	21.91	1	20	0	109.5%	85	115				
m,p-Xylene	42.63	2	40	0	106.6%	85	115				
o-Xylene	21.01	1	20	0	105.1%	85	115				
Toluene	21.37	1	20	0	106.9%	85	115				
1,4-Difluorobenzene	89.71	0	100	0	89.7%	70	130				
4-Bromochlorobenzene	65.83	0	100	0	65.8%	70	130				S
Fluorobenzene	88.41	0	100	0	88.4%	70	130				

Sample ID: CCV8 QC0606/07 Batch ID: GC-1_981005 Test Code: SW8020A Units: µg/L Analysis Date 10/5/98 Prep Date:
 Client ID: 9809075 Run ID: GC-1_981005A SeqNo: 7316

Analyte	Result	PQL	SPK value	SPK Ref Val	%REC	LowLimit	HighLimit	RPD Ref Val	%RPD	RPDLimit	Qual
Benzene	19.98	1	20	0	99.9%	85	115				
Ethylbenzene	21.29	1	20	0	106.4%	85	115				
m,p-Xylene	41.58	2	40	0	104.0%	85	115				
o-Xylene	21.11	1	20	0	105.5%	85	115				
Toluene	20.86	1	20	0	104.3%	85	115				
1,4-Difluorobenzene	90.22	0	100	0	90.2%	70	130				
4-Bromochlorobenzene	83.45	0	100	0	83.4%	70	130				
Fluorobenzene	89.08	0	100	0	89.1%	70	130				

Qualifiers: ND - Not Detected at the Reporting Limit
 J - Analyte detected below quantitation limits

S - Spike Recovery outside accepted recovery limits
 R - RPD outside accepted recovery limits

B - Analyte detected in the associated Method Blank

QC SUMMARY REPORT

Continuing Calibration Verification Standard

CLIENT: PNM - Public Service Company of NM
 Work Order: 9809075
 Project: Miles Federal 1E

Sample ID:	CCV1 QC0606/07	Batch ID:	GC-1_981010	Test Code:	SW8020A	Units:	µg/L	Analysis Date:	10/10/98	Prep Date:			
Client ID:	9809075	Run ID:	GC-1_981010A	PQL	SPK value	SPK Ref Val	%REC	LowLimit	HighLimit	RPD Ref Val	%RPD	RPDLimit	Qual
Analyte	Result	20.63	1	20	0	103.1%	85	115					
Benzene	20.63	1	20	0	103.1%	85	115						
Ethylbenzene	21.03	1	20	0	105.1%	85	115						
m,p-Xylene	41.52	2	40	0	103.8%	85	115						
o-Xylene	21.26	1	20	0	106.3%	85	115						
Toluene	20.87	1	20	0	104.3%	85	115						
1,4-Difluorobenzene	91.12	0	100	0	91.1%	70	130						
4-Bromochlorobenzene	99.37	0	100	0	99.4%	70	130						
Fluorobenzene	90.47	0	100	0	90.5%	70	130						

Sample ID:	CCV2 QC0606/07	Batch ID:	GC-1_981010	Test Code:	SW8020A	Units:	µg/L	Analysis Date:	10/10/98	Prep Date:			
Client ID:	9809075	Run ID:	GC-1_981010A	PQL	SPK value	SPK Ref Val	%REC	LowLimit	HighLimit	RPD Ref Val	%RPD	RPDLimit	Qual
Analyte	Result	20.21	1	20	0	101.0%	85	115					
Benzene	20.21	1	20	0	101.0%	85	115						
Ethylbenzene	20.52	1	20	0	102.6%	85	115						
m,p-Xylene	40.18	2	40	0	100.5%	85	115						
o-Xylene	20.8	1	20	0	104.0%	85	115						
Toluene	20.34	1	20	0	101.7%	85	115						
1,4-Difluorobenzene	91.45	0	100	0	91.5%	70	130						
4-Bromochlorobenzene	99.84	0	100	0	99.8%	70	130						
Fluorobenzene	90.84	0	100	0	90.8%	70	130						

Qualifiers: ND - Not Detected at the Reporting Limit
 J - Analyte detected below quantitation limits
 S - Spike Recovery outside accepted recovery limits
 R - RPD outside accepted recovery limits
 B - Analyte detected in the associated Method Blank

CLIENT: PNM - Public Service Company of NM
 Work Order: 9809075
 Project: Miles Federal 1E

QC SUMMARY REPORT

Continuing Calibration Verification Standard

Sample ID: CCV3 QC0606/07 Batch ID: GC-1_981010 Test Code: SW8020A Units: µg/L Analysis Date 10/10/98 Prep Date:
 Client ID: 9809075 Run ID: GC-1_981010A SeqNo: 7548

Analyte	Result	PQL	SPK value	SPK Ref Val	%REC	LowLimit	HighLimit	RPD Ref Val	%RPD	RPDLimit	Qual
Benzene	38.86	1	40	0	99.6%	85	115				
Ethylbenzene	40.09	1	40	0	100.2%	85	115				
m,p-Xylene	79.23	2	80	0	99.0%	85	115				
o-Xylene	40.7	1	40	0	101.7%	85	115				
Toluene	40.2	1	40	0	100.5%	85	115				
1,4-Difluorobenzene	90.63	0	100	0	90.6%	70	130				
4-Bromochlorobenzene	95.53	0	100	0	95.5%	70	130				
Fluorobenzene	89.9	0	100	0	89.9%	70	130				

Sample ID: CCV4 QC0606/07 Batch ID: GC-1_981010 Test Code: SW8020A Units: µg/L Analysis Date 10/12/98 Prep Date:
 Client ID: 9809075 Run ID: GC-1_981010A SeqNo: 7549

Analyte	Result	PQL	SPK value	SPK Ref Val	%REC	LowLimit	HighLimit	RPD Ref Val	%RPD	RPDLimit	Qual
Benzene	21.17	1	20	0	105.9%	85	115				
Ethylbenzene	21.54	1	20	0	107.7%	85	115				
m,p-Xylene	42.44	2	40	0	106.1%	85	115				
o-Xylene	21.74	1	20	0	108.7%	85	115				
Toluene	21.37	1	20	0	106.8%	85	115				
1,4-Difluorobenzene	91.19	0	100	0	91.2%	70	130				
4-Bromochlorobenzene	97.57	0	100	0	97.6%	70	130				
Fluorobenzene	90.69	0	100	0	90.7%	70	130				

Qualifiers: ND - Not Detected at the Reporting Limit
 J - Analyte detected below quantitation limits

S - Spike Recovery outside accepted recovery limits
 R - RPD outside accepted recovery limits

B - Analyte detected in the associated Method Blank

QC SUMMARY REPORT
Continuing Calibration Verification Standard

CLIENT: PNM - Public Service Company of NM
Work Order: 9809075
Project: Miles Federal 1E

Sample ID: CCV5 QC0606/07 **Batch ID:** GC-1_981010 **Test Code:** SW8020A **Units:** µg/L **Analysis Date:** 10/12/98 **Prep Date:**
Client ID: 9809075 **Run ID:** GC-1_981010A **SeqNo.:** 7550

Analyte	Result	PQL	SPK value	SPK Ref Val	%REC	LowLimit	HighLimit	RPD Ref Val	%RPD	RPDLimit	Qual
Benzene	20.59	1	20	0	103.0%	85	115				
Ethylbenzene	20.98	1	20	0	104.9%	85	115				
m,p-Xylene	41.18	2	40	0	102.9%	85	115				
o-Xylene	21.23	1	20	0	106.2%	85	115				
Toluene	20.88	1	20	0	104.4%	85	115				
1,4-Difluorobenzene	91.12	0	100	0	91.1%	70	130				
4-Bromochlorobenzene	98.55	0	100	0	98.6%	70	130				
Fluorobenzene	90.14	0	100	0	90.1%	70	130				

Qualifiers: ND - Not Detected at the Reporting Limit S - Spike Recovery outside accepted recovery limits B - Analyte detected in the associated Method Blank
J - Analyte detected below quantitation limits R - RPD outside accepted recovery limits

CLIENT: PNM - Public Service Company of NM
 Work Order: 9809075
 Project: Miles Federal 1E
 Test No: SW8020A

**QC SUMMARY REPORT
 SURROGATE RECOVERIES**

BTEX

Sample ID	14FBZ	4BCBZ	FLBZ				
9809060-05A	91.4	99.2	89.9				
9809060-06A	91.2	89.8	90				
9809060-07A	91.2	89.3	88.2				
9809060-08A	89	87.1	87.2				
9809060-09A	87	84.5	85.7				
9809063-03A	90.9	92.5	90				
9809063-04A	86.4	84.1	86				
9809063-05A	84.4	87.3	85.6				
9809063-06A	98.9	91.6	96.3				
9809063-06AMS	101	91	97.4				
9809063-06AMSD	99.7	93.7	96.8				
9809073-01A	90.4	63 *	87.9				
9809074-02A	82.9	62.5 *	81.3				
9809074-03A	90.5	74.3	88.7				
9809074-04A	90.7	88.5	88.8				
9809074-05A	83.4	61.8 *	82.2				
9809075-01A	90.6	86.3	88.8				
9809075-02A	89.2	71.2	86.6				
9809075-03A	89.3	62.6 *	86.1				
9809075-04A	88.5	56.7 *	86.1				
9809075-05A	87.5	53.5 *	84.2				
9809078-01A	86.9	103	95.5				
9809078-01AMS	88.9	97.7	88.9				
9809078-01AMSD	88.9	97.3	89.1				
9809078-02A	90.6	99.3	90.4				
9809078-03A	91.1	98.8	90.4				
9809078-04A	91.3	98	90.6				

Acronym	Surrogate	QC Limits
14FBZ	= 1,4-Difluorobenzene	70-130
4BCBZ	= 4-Bromochlorobenzene	70-130
FLBZ	= Fluorobenzene	70-130

* Surrogate recovery outside acceptance limits

CLIENT: PNM - Public Service Company of NM
Work Order: 9809075
Project: Miles Federal 1E
Test No: SW8020A

QC SUMMARY REPORT SURROGATE RECOVERIES

BTEX

Sample ID	14FBZ	4BCBZ	FLBZ					
9809078-05A	91.5	106	90.3					
9809078-06A	90.2	98.8	91.4					
9809082-01A	90.9	96.5	90.2					
9809082-01AMS	90.5	98.8	89.9					
9809082-01AMSD	91.1	98.9	90.2					
9810013-01A	91	100	91.3					
9810013-02A	91.6	101	91.3					
9810013-03A	91.3	100	90.2					
CCV1 QC0606/07	91.1	99.4	90.5					
CCV2 QC0606/07	91.4	99.8	90.8					
CCV3 QC0606/07	90.6	95.5	89.9					
CCV4 QC0606/07	91.2	97.6	90.7					
CCV5 QC0606/07	91.1	98.6	90.1					
CCV6 QC0606/07	88.4	62.5 *	86.2					
CCV7 QC0606/07	89.7	65.8 *	88.4					
CCV8 QC0606/07	90.2	83.4	89.1					
LCS WATER	90.3	99	90.1					
MB1	91.2	98.8	90.5					

Acronym	Surrogate	QC Limits
14FBZ	= 1,4-Difluorobenzene	70-130
4BCBZ	= 4-Bromochlorobenzene	70-130
FLBZ	= Fluorobenzene	70-130

* Surrogate recovery outside acceptance limits

On Site Technologies, LTD.

Date: 14-Oct-98

CLIENT: PNM - Public Service Company of NM
Work Order: 9809075
Project: Miles Federal 1E

QC SUMMARY REPORT
 Method Blank

Sample ID: MBlank	Batch ID: API H2O_981	Test Code: SW7140	Units: mg/L	Analysis Date: 10/2/98	Prep Date:						
Client ID:	9809075	Run ID: API H2O_981002A		SeqNo: 7167							
Analyte	Result	PQL	SPK value	SPK Ref Val	%REC	LowLimit	HighLimit	RPD Ref Val	%RPD	RPDLimit	Qual
Calcium	.02	0.25									J

Sample ID: MBlank	Batch ID: API H2O_981	Test Code: SW7450	Units: mg/L	Analysis Date: 10/2/98	Prep Date:						
Client ID:	9809075	Run ID: API H2O_981002A		SeqNo: 7176							
Analyte	Result	PQL	SPK value	SPK Ref Val	%REC	LowLimit	HighLimit	RPD Ref Val	%RPD	RPDLimit	Qual
Magnesium	ND	0.25									

Sample ID: MBlank	Batch ID: API H2O_981	Test Code: SW7610	Units: mg/L	Analysis Date: 10/2/98	Prep Date:						
Client ID:	9809075	Run ID: API H2O_981002A		SeqNo: 7194							
Analyte	Result	PQL	SPK value	SPK Ref Val	%REC	LowLimit	HighLimit	RPD Ref Val	%RPD	RPDLimit	Qual
Potassium	ND	0.25									

Sample ID: MBlank	Batch ID: API H2O_981	Test Code: SW7770	Units: mg/L	Analysis Date: 10/2/98	Prep Date:						
Client ID:	9809075	Run ID: API H2O_981002A		SeqNo: 7203							
Analyte	Result	PQL	SPK value	SPK Ref Val	%REC	LowLimit	HighLimit	RPD Ref Val	%RPD	RPDLimit	Qual
Sodium	ND	0.25									

Sample ID: MBlank	Batch ID: API H2O_981	Test Code: M2320 B	Units: mg/L CaCO3	Analysis Date: 9/29/98	Prep Date:						
Client ID:	9809075	Run ID: API H2O_981002A		SeqNo: 7212							
Analyte	Result	PQL	SPK value	SPK Ref Val	%REC	LowLimit	HighLimit	RPD Ref Val	%RPD	RPDLimit	Qual
Alkalinity, Bicarbonate (As CaCO3)	2.3	5									J
Alkalinity, Carbonate (As CaCO3)	ND	5									
Alkalinity, Total (As CaCO3)	2.3	5									J

Qualifiers: ND - Not Detected at the Reporting Limit
 S - Spike Recovery outside accepted recovery limits
 B - Analyte detected in the associated Method Blank
 J - Analyte detected below quantitation limits
 R - RPD outside accepted recovery limits

QC SUMMARY REPORT

Method Blank

CLIENT: PNM - Public Service Company of NM
 Work Order: 9809075
 Project: Miles Federal 1E

Sample ID: MBlank Batch ID: API H2O_981 Test Code: M4500-Cl C Units: mg/L Analysis Date: 9/29/98 Prep Date:
 Client ID: 9809075 Run ID: API H2O_981002A SeqNo: 7220

Analyte	Result	PQL	SPK value	SPK Ref Val	%REC	LowLimit	HighLimit	RPD Ref Val	%RPD	RPDLimit	Qual
Chloride	1.4										J

Sample ID: MBlank Batch ID: API H2O_981 Test Code: M4500-Cl C Units: mg/L Analysis Date: 9/29/98 Prep Date:
 Client ID: 9809075 Run ID: API H2O_981002A SeqNo: 7225

Analyte	Result	PQL	SPK value	SPK Ref Val	%REC	LowLimit	HighLimit	RPD Ref Val	%RPD	RPDLimit	Qual
Chloride	2.4										J

Sample ID: MBlank Batch ID: API H2O_981 Test Code: E120.1 Units: uS/cm Analysis Date: 9/28/98 Prep Date:
 Client ID: 9809075 Run ID: API H2O_981002A SeqNo: 7231

Analyte	Result	PQL	SPK value	SPK Ref Val	%REC	LowLimit	HighLimit	RPD Ref Val	%RPD	RPDLimit	Qual
Specific Conductance	ND										J

Sample ID: MBlank Batch ID: API H2O_981 Test Code: M4500-SO4 D Units: mg/L Analysis Date: 10/2/98 Prep Date:
 Client ID: 9809075 Run ID: API H2O_981002A SeqNo: 7249

Analyte	Result	PQL	SPK value	SPK Ref Val	%REC	LowLimit	HighLimit	RPD Ref Val	%RPD	RPDLimit	Qual
Sulfate	ND										J

Qualifiers: ND - Not Detected at the Reporting Limit S - Spike Recovery outside accepted recovery limits B - Analyte detected in the associated Method Blank
 J - Analyte detected below quantitation limits R - RPD outside accepted recovery limits

On Site Technologies, LTD.

Date: 14-Oct-98

CLIENT: PNM - Public Service Company of NM
Work Order: 9809075
Project: Miles Federal 1E

QC SUMMARY REPORT
 Sample Duplicate

Sample ID: 9809073-01BD	Batch ID: API H2O_981	Test Code: M2320 B	Units: mg/L CaCO3	Analysis Date: 9/29/98	Prep Date:						
Client ID:	9809075	Run ID: API H2O_981002A	SeqNo: 7215								
Analyte	Result	PQL	SPK value	SPK Ref Val	%REC	LowLimit	HighLimit	RPD Ref Val	%RPD	RPDLimit	Qual
Alkalinity, Bicarbonate (As CaCO3)	236	5	0	0	0.0%	0	0	236	0.0%	3	3
Alkalinity, Carbonate (As CaCO3)	ND	5	0	0	0.0%	0	0	0	0.0%	3	3
Alkalinity, Total (As CaCO3)	236	5	0	0	0.0%	0	0	236	0.0%	3	3

Sample ID: 9809073-01BD	Batch ID: API H2O_981	Test Code: M4500-Cl C.	Units: mg/L	Analysis Date: 9/29/98	Prep Date:						
Client ID:	9809075	Run ID: API H2O_981002A	SeqNo: 7228								
Analyte	Result	PQL	SPK value	SPK Ref Val	%REC	LowLimit	HighLimit	RPD Ref Val	%RPD	RPDLimit	Qual
Chloride	607	10	0	0	0.0%	0	0	616	1.5%	7	7

Sample ID: 9809074-01BD	Batch ID: API H2O_981	Test Code: M4500-SO4 D	Units: mg/L	Analysis Date: 9/29/98	Prep Date:						
Client ID:	9809075	Run ID: API H2O_981002A	SeqNo: 7223								
Analyte	Result	PQL	SPK value	SPK Ref Val	%REC	LowLimit	HighLimit	RPD Ref Val	%RPD	RPDLimit	Qual
Chloride	9.93	10	0	0	0.0%	0	0	11.05	0.0%	7	J

Sample ID: 9809074-01BD	Batch ID: API H2O_981	Test Code: M4500-SO4 D	Units: mg/L	Analysis Date: 10/2/98	Prep Date:						
Client ID:	9809075	Run ID: API H2O_981002A	SeqNo: 7253								
Analyte	Result	PQL	SPK value	SPK Ref Val	%REC	LowLimit	HighLimit	RPD Ref Val	%RPD	RPDLimit	Qual
Sulfate	1910	25	0	0	0.0%	0	0	1904	0.3%	6	6

Qualifiers: ND - Not Detected at the Reporting Limit
 J - Analyte detected below quantitation limits

S - Spike Recovery outside accepted recovery limits
 R - RPD outside accepted recovery limits

B - Analyte detected in the associated Method Blank
 1 of 1

On Site Technologies, LTD.

Date: 14-Oct-98

CLIENT: PNM - Public Service Company of NM
Work Order: 9809075
Project: Miles Federal 1E

QC SUMMARY REPORT
 Sample Matrix Spike

Sample ID: 9809073-01AMS Batch ID: API H2O_981 Test Code: SW7610 Units: mg/L Analysis Date: 10/2/98 Prep Date:
 Client ID: 9809075 Run ID: API H2O_981002A SeqNo: 7201

Analyte	Result	PQL	SPK value	SPK Ref Val	%REC	LowLimit	HighLimit	RPD Ref Val	%RPD	RPDLimit	Qual
Potassium	12.6	0.25	5	7.4	104.0%	67	157				

Sample ID: 9809074-02BMS Batch ID: API H2O_981 Test Code: SW7140 Units: mg/L Analysis Date: 10/2/98 Prep Date:
 Client ID: 9809075 Run ID: API H2O_981002A SeqNo: 7174

Analyte	Result	PQL	SPK value	SPK Ref Val	%REC	LowLimit	HighLimit	RPD Ref Val	%RPD	RPDLimit	Qual
Calcium	298	0.25	100	182	116.0%	69	159				

Sample ID: 9809074-02BMS Batch ID: API H2O_981 Test Code: SW7450 Units: mg/L Analysis Date: 10/2/98 Prep Date:
 Client ID: 9809075 Run ID: API H2O_981002A SeqNo: 7183

Analyte	Result	PQL	SPK value	SPK Ref Val	%REC	LowLimit	HighLimit	RPD Ref Val	%RPD	RPDLimit	Qual
Magnesium	66.4	0.25	20	44	112.0%	78	126				

Sample ID: 9809075-02BMS Batch ID: API H2O_981 Test Code: SW7770 Units: mg/L Analysis Date: 10/2/98 Prep Date:
 Client ID: 9809241700; MW- Run ID: API H2O_981002A SeqNo: 7210

Analyte	Result	PQL	SPK value	SPK Ref Val	%REC	LowLimit	HighLimit	RPD Ref Val	%RPD	RPDLimit	Qual
Sodium	1360	0.25	400	990	92.5%	81	135				

Qualifiers: ND - Not Detected at the Reporting Limit
 J - Analyte detected below quantitation limits

S - Spike Recovery outside accepted recovery limits
 R - RPD outside accepted recovery limits

B - Analyte detected in the associated Method Blank

On Site Technologies, LTD.

612 E. Murray Drive
Farmington, NM 87401
(505) 325-2432

CHAIN-OF-CUSTODY RECORD

Subcontractor:

Mountain States Analytical, Inc.
1645 West 2200 South

TEL: (800) 973-6724
FAX: (801) 972-6278

Salt Lake City, UT 84119

Acct #:

30-Sep-98

Sample ID	Matrix	Collection Date	Bottle Type	Requested Tests	
				SW6010A	
9809075-01C	Aqueous	9/24/98 4:30:00 PM	1LCU	1	
9809075-02C	Aqueous	9/24/98 5:00:00 PM	1LCU	1	

Comments: Please analyze two (2) water samples for Lead (Pb). Dissolved ONLY per WQCC Standards.

Relinquished by: Heidi Reese	Date/Time: 9/30/98 1600	Received by: <i>Ruth A. Blank</i>	Date/Time: 9/30/98 07:10/01/98 10:15
Relinquished by:		Received by:	

On Site Technologies, LTD.

Date: 14-Oct-98

CLIENT: PNM - Public Service Company of NM
Work Order: 9809075
Project: Miles Federal IE

QC SUMMARY REPORT
 Laboratory Control Spike - generic

Sample ID: LCS Batch ID: API H2O_981 Test Code: M2320 E Units: mg/L CaCO3 Analysis Date: 9/29/98 Prep Date:
 Client ID: 9809075 Run ID: API H2O_981002A SeqNo: 7213

Analyte	Result	PQL	SPK value	SPK Ref Val	%REC	LowLimit	HighLimit	RPD Ref Val	%RPD	RPDLimit	Qual
Alkalinity, Total (As CaCO3)	207	5	201	2	102.0%	91	116				

Sample ID: LCS Batch ID: API H2O_981 Test Code: M4500-G1 C. Units: mg/L Analysis Date: 9/29/98 Prep Date:
 Client ID: 9809075 Run ID: API H2O_981002A SeqNo: 7221

Analyte	Result	PQL	SPK value	SPK Ref Val	%REC	LowLimit	HighLimit	RPD Ref Val	%RPD	RPDLimit	Qual
Chloride	112	10	108	1	102.8%	90	114				

Sample ID: LCS Batch ID: API H2O_981 Test Code: E120.1 Units: uS/cm Analysis Date: 9/29/98 Prep Date:
 Client ID: 9809075 Run ID: API H2O_981002A SeqNo: 7232

Analyte	Result	PQL	SPK value	SPK Ref Val	%REC	LowLimit	HighLimit	RPD Ref Val	%RPD	RPDLimit	Qual
Specific Conductance	1121	2	1100	0	101.9%	97	103				

Sample ID: LCS Batch ID: API H2O_981 Test Code: E150.1 Units: pH units Analysis Date: 9/28/98 Prep Date:
 Client ID: 9809075 Run ID: API H2O_981002A SeqNo: 7243

Analyte	Result	PQL	SPK value	SPK Ref Val	%REC	LowLimit	HighLimit	RPD Ref Val	%RPD	RPDLimit	Qual
pH	8.982	2	9.11	0	98.6%	98	102				

Qualifiers: ND - Not Detected at the Reporting Limit
 J - Analyte detected below quantitation limits
 S - Spike Recovery outside accepted recovery limits
 R - RPD outside accepted recovery limits

B - Analyte detected in the associated Method Blank

CLIENT: PNM - Public Service Company of NM
Work Order: 9809075
Project: Miles Federal 1E

QC SUMMARY REPORT
 Laboratory Control Spike - generic

Sample ID: LCS **Batch ID:** API H2O_981 **Test Code:** M4500-Sb4 D **Units:** mg/L **Analysis Date:** 10/2/98 **Prep Date:**

Client ID: 9809075 **Run ID:** API H2O_981002A **SeqNo:** 7250

Analyte	Result	PQL	SPK value	SPK Ref Val	%REC	LowLimit	HighLimit	RPD Ref Val	%RPD	RPDLimit	Qual
Sulfate	123	5	139	0	88.5%	83	113				

Qualifiers: ND - Not Detected at the Reporting Limit
 J - Analyte detected below quantitation limits

S - Spike Recovery outside accepted recovery limits
 R - RPD outside accepted recovery limits

B - Analyte detected in the associated Method Blank

Date: 14-Oct-98

On Site Technologies, LTD.

CLIENT: PNM - Public Service Company of NM
Work Order: 9809075
Project: Miles Federal 1E

QC SUMMARY REPORT

Continuing Calibration Verification Standard

Sample ID: CCV1 QC0573 Batch ID: API H2O_981 Test Code: SW7450 Units: mg/L
Client ID: 9809075 Run ID: API H2O_981002A

Analysis Date: 10/2/98
SeqNo: 7177

Prep Date:

Analyte	Result	PQL	SPK value	SPK Ref Val	%REC	LowLimit	HighLimit	RPD Ref Val	%RPD	RPDLimit	Qual
Magnesium	1.61	0.25	1.58	0	101.9%	96	114				

Sample ID: CCV1 QC0610 Batch ID: API H2O_981 Test Code: SW7610 Units: mg/L
Client ID: 9809075 Run ID: API H2O_981002A

Analysis Date: 10/2/98
SeqNo: 7195

Prep Date:

Analyte	Result	PQL	SPK value	SPK Ref Val	%REC	LowLimit	HighLimit	RPD Ref Val	%RPD	RPDLimit	Qual
Potassium	2.65	0.25	2.68	0	98.9%	84	114				

Sample ID: CCV1 QC0610 Batch ID: API H2O_981 Test Code: SW7770 Units: mg/L
Client ID: 9809075 Run ID: API H2O_981002A

Analysis Date: 10/2/98
SeqNo: 7204

Prep Date:

Analyte	Result	PQL	SPK value	SPK Ref Val	%REC	LowLimit	HighLimit	RPD Ref Val	%RPD	RPDLimit	Qual
Sodium	2.84	0.25	2.64	0	107.6%	87	111				

Sample ID: CCV1 QC0611 Batch ID: API H2O_981 Test Code: SW7140 Units: mg/L
Client ID: 9809075 Run ID: API H2O_981002A

Analysis Date: 10/2/98
SeqNo: 7168

Prep Date:

Analyte	Result	PQL	SPK value	SPK Ref Val	%REC	LowLimit	HighLimit	RPD Ref Val	%RPD	RPDLimit	Qual
Calcium	1.98	0.25	1.95	0	101.5%	89	107				

Sample ID: CCV2 QC0573 Batch ID: API H2O_981 Test Code: SW7450 Units: mg/L
Client ID: 9809075 Run ID: API H2O_981002A

Analysis Date: 10/2/98
SeqNo: 7184

Prep Date:

Analyte	Result	PQL	SPK value	SPK Ref Val	%REC	LowLimit	HighLimit	RPD Ref Val	%RPD	RPDLimit	Qual
Magnesium	1.62	0.25	1.58	0	102.5%	96	114				

Qualifiers: ND - Not Detected at the Reporting Limit
J - Analyte detected below quantitation limits

S - Spike Recovery outside accepted recovery limits
R - RPD outside accepted recovery limits

B - Analyte detected in the associated Method Blank

CLIENT: PNM - Public Service Company of NM
 Work Order: 9809075
 Project: Miles Federal IE

QC SUMMARY REPORT
 Continuing Calibration Verification Standard

Sample ID: CCV2 QC0610 Batch ID: API H2O_981 Test Code: SW7610 Units: mg/L
 Client ID: 9809075 Run ID: API H2O_981002A

Analysis Date: 10/2/98
 SeqNo: 7202

Prep Date:

Analyte	Result	PQL	SPK value	SPK Ref Val	%REC	LowLimit	HighLimit	RPD Ref Val	%RPD	RPDLimit	Qual
Potassium	2.66	0.25	2.68	0	99.3%	84	114				

Sample ID: CCV2 QC0610 Batch ID: API H2O_981 Test Code: SW7770 Units: mg/L
 Client ID: 9809075 Run ID: API H2O_981002A

Analysis Date: 10/2/98
 SeqNo: 7211

Prep Date:

Analyte	Result	PQL	SPK value	SPK Ref Val	%REC	LowLimit	HighLimit	RPD Ref Val	%RPD	RPDLimit	Qual
Sodium	2.8	0.25	2.64	0	106.1%	87	111				

Sample ID: CCV2 QC0611 Batch ID: API H2O_981 Test Code: SW7140 Units: mg/L
 Client ID: 9809075 Run ID: API H2O_981002A

Analysis Date: 10/2/98
 SeqNo: 7175

Prep Date:

Analyte	Result	PQL	SPK value	SPK Ref Val	%REC	LowLimit	HighLimit	RPD Ref Val	%RPD	RPDLimit	Qual
Calcium	1.98	0.25	1.95	0	101.5%	89	107				

Qualifiers: ND - Not Detected at the Reporting Limit
 J - Analyte detected below quantitation limits

S - Spike Recovery outside accepted recovery limits
 R - RPD outside accepted recovery limits

B - Analyte detected in the associated Method Blank

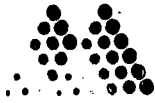

Mountain States Analytical, Inc.

The Quality Solution

October 12, 1998

Mr. David Cox
On Site Technologies, Ltd.
612 E Murray Drive
Farmington, NM 87401

Reference:

Project: WQCC Pb Analysis
MSAI Group: 24281

Dear Mr. Cox:

Enclosed are the analytical results for your project referenced above. The following samples are included in the report.

9809075-01C

9809075-02C

All holding times were met for the tests performed on these samples.

Thank you for selecting Mountain States Analytical, Inc. to serve as your analytical laboratory on this project. If you have any questions concerning these results, please feel free to contact me at any time.

We look forward to working with you on future projects.

With Regards,

Rolf E. Larsen
Project Manager

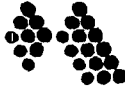
Analytical Report**Mountain States Analytical, Inc.***The Quality Solution*

On Site Technologies, Ltd.
612 E Murray Drive
Farmington, NM 87401

Attn: Mr. David Cox
Project: WQCC Pb Analysis

Sample ID: 9809075-01C MILES FEDERAL IE
Matrix: Water 9809241630 MW-1

MSAI Sample: 87355
MSAI Group: 24281
Date Reported: 10/12/98
Discard Date: 11/11/98
Date Submitted: 10/01/98
Date Sampled: 09/24/98
Collected by:
Purchase Order:
Project No.:

Test Analysis	Results as Received	Units	Method Detection Limit
03921 Flame/ICP Prep, w/w, 3005A Method: SW-846 3005A	Batch. w650		
13001 Metals by ICP, 6010A, w/w Method: SW-846 6010A Lead	ND	mg/l	0.050
0939 Sample Filtering, w, MSAI Method: IN HOUSE MSAI	COMPLETE		

ND - Not detected at the Method Detection Limit.

This report consists of the following items: A cover letter, a signed analytical report for each sample specified on the cover letter, and if applicable, an inorganic quality control summary. Organic sample reports contain footnotes which describe any quality control anomalies which may have occurred.

Respectfully Submitted,
Reviewed and Approved by:

Rolf E. Larsen
Project Manager

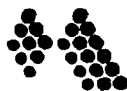
Analytical Report**Mountain States Analytical, Inc.***The Quality Solution*

On Site Technologies, Ltd.
612 E Murray Drive
Farmington, NM 87401

Attn: Mr. David Cox
Project: WQCC Pb Analysis

Sample ID: 9809075-02C MILES FEDERAL 1E
Matrix: Water 9809241700 MW-2

MSAI Sample: 87356
MSAI Group: 24281
Date Reported: 10/12/98
Discard Date: 11/11/98
Date Submitted: 10/01/98
Date Sampled: 09/24/98
Collected by:
Purchase Order:
Project No.:

Test Analysis	Results as Received	Units	Method Detection Limit
03921 Flame/ICP Prep, w/w, 3005A Method: SW-846 3005A	Batch. w650		
13001 Metals by ICP, 6010A, w/w Method: SW-846 6010A Lead	ND	ng/l	0.050
0939 Sample Filtering, ww, MSAI Method: IN HOUSE MSAI	COMPLETE		

ND - Not detected at the Method Detection Limit.

This report consists of the following items: A cover letter, a signed analytical report for each sample specified on the cover letter, and if applicable, an inorganic quality control summary. Organic sample reports contain footnotes which describe any quality control anomalies which may have occurred.

Respectfully Submitted,
Reviewed and Approved by:

Rolf E. Larsen
Project Manager

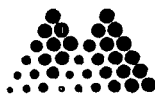

Mountain States Analytical, Inc.

The Quality Solution

On Site Technologies, Ltd.
612 E Murray Drive
Farmington, NM 87401

Attn: Mr. David Cox
Project: WQCC Pb Analysis

Sample ID: 9809075-01C

Matrix: Water

Miles Federal 1E 9809241630; MW-1

MSAI Sample: 87355
MSAI Group: 24281
Date Reported: 10/12/98
Discard Date: 11/11/98
Date Submitted: 10/01/98
Date Sampled: 09/24/98
Collected by:
Purchase Order:
Project No.:

Test Analysis	Results as Received	Units	Limit of Quantitation
0392I Flame/ICP Prep, w/w, 3005A Method: SW-846 3005A	Batch. w650		
13001 Metals by ICP, 6010A, w/w Method: SW-846 6010A			
Lead	ND	mg/l	0.250
0939 Sample Filtering, ww, MSAI Method: IN HOUSE MSAI	COMPLETE		

ND - Not detected at the Limit of Quantitation.

This report consists of the following items: A cover letter, a signed analytical report for each sample specified on the cover letter, and if applicable, an inorganic quality control summary. Organic sample reports contain footnotes which describe any quality control anomalies which may have occurred.

Respectfully Submitted,
Reviewed and Approved by:

Rolf E. Larsen
Project Manager

10
Years of
Quality
Service

Corporate Office
1645 West 2200 South, Salt Lake City, Utah 84119
801-973-0050 • 1-800-973-6724(MSAI) • FAX 801-972-6278
e-mail: service@msailabs.com

Southwest States Region
6223 Bayonne, Spring, Texas 77389
281-320-2842 • FAX 281-320-0989
e-mail: gbrewer@msailabs.com

MEMBER
ACIL

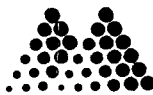

Mountain States Analytical, Inc.

The Quality Solution

On Site Technologies, Ltd.
612 E Murray Drive
Farmington, NM 87401

Attn: Mr. David Cox
Project: WQCC Pb Analysis

Sample ID: 9809075-02C

Matrix: Water

Miles Federal 1E 9809241700; MW-2 ^(V)

MSAI Sample: 87356
MSAI Group: 24281
Date Reported: 10/12/98
Discard Date: 11/11/98
Date Submitted: 10/01/98
Date Sampled: 09/24/98
Collected by:
Purchase Order:
Project No.:

Test Analysis	Results as Received	Units	Limit of Quantitation
03921 Flame/ICP Prep, w/ww, 3005A Method: SW-846 3005A	Batch. w650		
13001 Metals by ICP, 6010A, w/ww Method: SW-846 6010A			
Lead	ND	mg/l	0.250
0939 Sample Filtering, ww, MSAI Method: IN HOUSE MSAI	COMPLETE		

ND - Not detected at the Limit of Quantitation.

This report consists of the following items: A cover letter, a signed analytical report for each sample specified on the cover letter, and if applicable, an inorganic quality control summary. Organic sample reports contain footnotes which describe any quality control anomalies which may have occurred.

Respectfully Submitted,
Reviewed and Approved by:

Rolf E. Larsen
Project Manager

10
Years of
Quality
Service

Corporate Office
1645 West 2200 South, Salt Lake City, Utah 84119
801-973-0050 • 1-800-973-6724(MSAI) • FAX 801-972-6278
e-mail: service@msailabs.com

Southwest States Region
6223 Bayonne, Spring, Texas 77389
281-320-2842 • FAX 281-320-0989
e-mail: gbrewer@msailabs.com

MEMBER
ACIL

Mountain States Analytical, Inc.
Daily QC Batching Data
Data Released for Reporting

10/12/98
12:55:48
Group: 24281

Analysis Batch Number: ICPWA-10/06/98-061 -1
Test Identification : ICPWA-*Metals by ICP
Number of Samples : 7
Batch Date/Time : 10/07/98 / 17:43:29

Sequence : DATA279

BLANK#	ANALYTE	CONC FOUND #	CONC LIMIT
0BW-650	Aluminum	0.0266	0.0300
	Arsenic	ND	0.0350
	Calcium	0.0652	0.3000
	Cadmium	ND	0.0040
	Chromium	ND	0.0100
	Copper	ND	0.0100
	Iron	0.0156	0.2000
	Potassium	0.0030	0.1500
	Magnesium	0.0125	0.0500
	Sodium	0.2547(1c)	0.1500
	Lead	ND	0.0500
	Selenium	ND	0.0600
	Zinc	0.0250	0.0250

SPIKE							QC LIMITS	
SAMPLE#	ANALYTE	CONC ADDED	CONC SAMPLE	CONC SPIKE	% REC #	LOWER	UPPER	
24274-87338	Aluminum	4.0000	0.0507	4.0739	100.6	80.0	120.0	
	Arsenic	4.0000	-0.0007	4.0537	101.4	80.0	120.0	
	Calcium	4.0000	99.6287	99.7651	3.4(2k)	80.0	120.0	
	Cadmium	0.1000	0.0025	0.1039	101.4	80.0	120.0	
	Chromium	0.4000	0.0008	0.4155	103.7	80.0	120.0	
	Copper	0.5000	-0.0031	0.5031	101.2	80.0	120.0	
	Iron	2.0000	0.1111	2.1192	100.4	80.0	120.0	
	Potassium	20.0000	4.4708	24.5650	100.5	80.0	120.0	
	Magnesium	4.0000	64.7513	67.1555	60.1(2k)	80.0	120.0	
	Sodium	20.0000	58.1826	78.1379	99.8	80.0	120.0	
	Lead	1.0000	0.0016	1.0615	106.0	80.0	120.0	
	Selenium	4.0000	-0.0171	4.0757	102.3	80.0	120.0	
	Zinc	1.0000	0.0567	1.1505	109.4	80.0	120.0	

MSD							QC LIMITS			
SAMPLE#	ANALYTE	CONC ADDED	CONC SAMPLE	RESULT 2	%REC2 #	LOWER	UPPER	RPD #	LIMIT	
24274-87338	Aluminum	4.0000	0.0507	4.3477	107.4	80.0	120.0	6.5	20.0	
	Arsenic	4.0000	-0.0007	4.1923	104.8	80.0	120.0	3.4	20.0	
	Calcium	4.0000	99.6287	108.2528	215.6(2k)	80.0	120.0	8.2	20.0	
	Cadmium	0.1000	0.0025	0.1092	106.7	80.0	120.0	4.9	20.0	
	Chromium	0.4000	0.0008	0.4216	105.2	80.0	120.0	1.5	20.0	
	Copper	0.5000	-0.0031	0.5144	103.5	80.0	120.0	2.2	20.0	
	Iron	2.0000	0.1111	2.2177	105.3	80.0	120.0	4.5	20.0	
	Potassium	20.0000	4.4708	25.4818	105.1	80.0	120.0	3.7	20.0	
	Magnesium	4.0000	64.7513	72.5666	195.4(2k)	80.0	120.0	7.7	20.0	
	Sodium	20.0000	58.1826	83.0821	124.5(2f)	80.0	120.0	6.1	20.0	
	Lead	1.0000	0.0016	1.0913	109.0	80.0	120.0	2.8	20.0	
	Selenium	4.0000	-0.0171	4.2109	105.7	80.0	120.0	3.3	20.0	
	Zinc	1.0000	0.0567	1.1606	110.4	80.0	120.0	0.9	20.0	

DUPLICATE						
SAMPLE#	ANALYTE	RESULT 1	RESULT 2	RPD #	LIMIT	DILUTION
24274-87338	Aluminum	0.0507	0.0394	25.0(5a)	20.0	1.00
	Arsenic	-0.0007	0.0048	265.4(11)	20.0	1.00

Mountain States Analytical, Inc.
Daily QC Batching Data
Data Released for Reporting

10/12/98
12:55:49
Group: 24281

Analysis Batch Number: ICPWA-10/06/98-061 -1
Test Identification : ICPWA-*Metals by ICP
Number of Samples : 7
Batch Data-Date/Time : 10/07/98 / 17:43:29

Sequence : DATA279

DUPLICATE

SAMPLE#	ANALYTE	RESULT 1	RESULT 2	RPD #	LIMIT	DILUTION
24274-87338	Calcium	99.6287	99.6216	0.0	20.0	1.00
	Cadmium	0.0025	0.0002	172.0(11)	20.0	1.00
	Chromium	0.0008	0.0047	140.5(11)	20.0	1.00
	Copper	-0.0031	0.0031	***** (11)	20.0	1.00
	Iron	0.1111	0.1013	9.2	20.0	1.00
	Potassium	4.4708	4.6474	3.9	20.0	1.00
	Magnesium	64.7513	64.6938	0.1	20.0	1.00
	Sodium	58.1826	57.9215	0.4	20.0	1.00
	Lead	0.0016	0.0159	164.6(11)	20.0	1.00
	Selenium	-0.0171	0.0000	200.0(11)	20.0	1.00
	Zinc	0.0567	0.1099	63.9(5a)	20.0	1.00

CONTROL

SAMPLE#	ANALYTE	CONC FOUND	CONC KNOWN	% REC #	QC LIMITS	
					LOWER	UPPER
LCSW-650	Aluminum	3.9920	4.0000	99.8	80.0	120.0
	Arsenic	4.0637	4.0000	101.6	80.0	120.0
	Calcium	4.2563	4.0000	106.4	80.0	120.0
	Cadmium	0.1070	0.1000	107.0	80.0	120.0
	Chromium	0.4196	0.4000	104.9	80.0	120.0
	Copper	0.5076	0.5000	101.5	80.0	120.0
	Iron	2.1450	2.0000	107.2	80.0	120.0
	Potassium	19.5778	20.0000	97.9	80.0	120.0
	Magnesium	3.9736	4.0000	99.3	80.0	120.0
	Sodium	20.1730	20.0000	100.9	80.0	120.0
	Lead	1.0754	1.0000	107.5	80.0	120.0
	Selenium	4.0125	4.0000	100.3	80.0	120.0
	Zinc	1.1225	1.0000	112.3	80.0	120.0

QC LIMITS

CCV #	ANALYTE	TRUE VALUE	BATCH READ	% REC #	QC LIMITS	
					LOWER	UPPER
ICV-	Aluminum	20.0000	20.1813	100.9	90.0	110.0
	Arsenic	1.6000	1.6546	103.4	90.0	110.0
	Calcium	40.0000	41.5082	103.8	90.0	110.0
	Cadmium	4.0000	4.1896	104.7	90.0	110.0
	Chromium	4.0000	4.2005	105.0	90.0	110.0
	Copper	4.0000	4.0895	102.2	90.0	110.0
	Iron	4.0000	4.2808	107.0	90.0	110.0
	Potassium	40.0000	40.1933	100.5	90.0	110.0
	Magnesium	20.0000	20.3530	101.8	90.0	110.0
	Sodium	40.0000	40.0427	100.1	90.0	110.0
	Lead	20.0000	21.3896	106.9	90.0	110.0
	Selenium	1.6000	1.5892	99.3	90.0	110.0
	Zinc	4.0000	4.2066	105.2	90.0	110.0
CCV1--2	Aluminum	20.0000	20.1204	100.6	90.0	110.0
	Arsenic	1.6000	1.6404	102.5	90.0	110.0
	Calcium	40.0000	41.2105	103.0	90.0	110.0
	Cadmium	4.0000	4.1821	104.6	90.0	110.0
	Chromium	4.0000	4.1810	104.5	90.0	110.0
	Copper	4.0000	4.0748	101.9	90.0	110.0

Mountain States Analytical, Inc.
 Daily QC Batching Data
 Data Released for Reporting

10/12/98
 12:55:49
 Group: 24281

Analysis Batch Number: ICPWA-10/06/98-061 -1
 Test Identification : ICPWA-*Metals by ICP
 Number of Samples : 7
 Batch Data-Date/Time : 10/07/98 / 17:43:29

Sequence : DATA279

CCV #	ANALYTE	TRUE VALUE	BATCH READ	% REC #	QC LIMITS	
					LOWER	UPPER
CCV1--2	Iron	4.0000	4.2410	106.0	90.0	110.0
	Potassium	40.0000	39.9918	100.0	90.0	110.0
	Magnesium	20.0000	20.2215	101.1	90.0	110.0
	Sodium	40.0000	39.8686	99.7	90.0	110.0
	Lead	20.0000	21.3246	106.6	90.0	110.0
	Selenium	1.6000	1.6264	101.6	90.0	110.0
	Zinc	4.0000	4.1855	104.6	90.0	110.0
CCV2--3	Aluminum	20.0000	20.1005	100.5	90.0	110.0
	Arsenic	1.6000	1.6295	101.8	90.0	110.0
	Calcium	40.0000	41.1645	102.9	90.0	110.0
	Cadmium	4.0000	4.1754	104.4	90.0	110.0
	Chromium	4.0000	4.1770	104.4	90.0	110.0
	Copper	4.0000	4.0925	102.3	90.0	110.0
	Iron	4.0000	4.2111	105.3	90.0	110.0
	Potassium	40.0000	40.3054	100.8	90.0	110.0
	Magnesium	20.0000	20.2326	101.2	90.0	110.0
	Sodium	40.0000	39.9524	99.9	90.0	110.0
	Lead	20.0000	21.3444	106.7	90.0	110.0
	Selenium	1.6000	1.5983	99.9	90.0	110.0
	Zinc	4.0000	4.1819	104.5	90.0	110.0
	CCV3--4	Aluminum	20.0000	19.9076	99.5	90.0
Arsenic		1.6000	1.6256	101.6	90.0	110.0
Calcium		40.0000	40.7550	101.9	90.0	110.0
Cadmium		4.0000	4.1549	103.9	90.0	110.0
Chromium		4.0000	4.1463	103.7	90.0	110.0
Copper		4.0000	4.0685	101.7	90.0	110.0
Iron		4.0000	4.1524	103.8	90.0	110.0
Potassium		40.0000	40.1589	100.4	90.0	110.0
Magnesium		20.0000	20.1634	100.8	90.0	110.0
Sodium		40.0000	39.6352	99.1	90.0	110.0
Lead		20.0000	21.2088	106.0	90.0	110.0
Selenium		1.6000	1.5775	98.6	90.0	110.0
Zinc		4.0000	4.1437	103.6	90.0	110.0

CCB#	ANALYTE	CONC FOUND #	CONC LIMIT
ICB-	Aluminum	0.0228	0.0300
	Arsenic	0.0128	0.0350
	Calcium	0.0206	0.3000
	Cadmium	ND	0.0040
	Chromium	ND	0.0100
	Copper	0.0010	0.0100
	Iron	0.0282	0.2000
	Potassium	ND	0.1500
	Magnesium	0.0303	0.0500
	Sodium	ND	0.1500
	Lead	ND	0.0500
	Selenium	0.0004	0.0600
	Zinc	0.0012	0.0250
CCB1-	Aluminum	ND	0.0300

Mountain States Analytical, Inc.
 Daily QC Batching Data
 Data Released for Reporting

10/12/98
 12:55:50
 Group: 24281

Analysis Batch Number: ICPWA-10/06/98-061 -1
 Test Identification : ICPWA-*Metals by ICP
 Number of Samples : 7
 Batch Data-Date/Time : 10/07/98 / 17:43:29

Sequence : DATA279

CCB#	ANALYTE	CONC FOUND #	CONC LIMIT
CCB1-	Arsenic	0.0122	0.0350
	Calcium	0.0134	0.3000
	Cadmium	0.0018	0.0040
	Chromium	0.0066	0.0100
	Copper	0.0064	0.0100
	Iron	0.0113	0.2000
	Potassium	0.1377	0.1500
	Magnesium	0.0331	0.0500
	Sodium	ND	0.1500
	Lead	ND	0.0500
	Selenium	0.0240	0.0600
	Zinc	0.0014	0.0250
	CCB2-	Aluminum	ND
Arsenic		0.0068	0.0350
Calcium		0.0133	0.3000
Cadmium		0.0004	0.0040
Chromium		0.0033	0.0100
Copper		0.0039	0.0100
Iron		0.0031	0.2000
Potassium		0.0534	0.1500
Magnesium		0.0228	0.0500
Sodium		ND	0.1500
Lead		0.0094	0.0500
Selenium		0.0028	0.0600
Zinc		0.0011	0.0250
CCB3-	Aluminum	ND	0.0300
	Arsenic	0.0006	0.0350
	Calcium	0.0124	0.3000
	Cadmium	0.0009	0.0040
	Chromium	0.0037	0.0100
	Copper	0.0032	0.0100
	Iron	ND	0.2000
	Potassium	0.0778	0.1500
	Magnesium	0.0251	0.0500
	Sodium	ND	0.1500
	Lead	ND	0.0500
	Selenium	0.0171	0.0600
	Zinc	0.0009	0.0250

----- Result Footnotes -----

- (1c) - The preparation blank concentration is less than 5% of each sample in the batch
- (2k) - Sample concentration >4X spk added. Serial dilution was recovered within 10% limits.
- (2f) - Spike result outside limits. Serial dilution is within 10% acceptance limits.
- (5a) - Duplicates not evaluated: Results are <10x detection limit
- (11) - The duplicate results cannot be evaluated because both results are <MDL.

Mountain States Analytical, Inc.
Daily QC Batching Data
Data Released for Reporting

10/12/98
12:55:50
Group: 24281

Analysis Batch Number: ICPWA-10/06/98-061 -1
Test Identification : ICPWA-*Metals by ICP
Number of Samples : 7
Batch Date-Time : 10/07/98 / 17:43:29

Sequence : DATA279

Groups & Samples

24217-87124 24255-87258 24255-87259 24274-87338 24280-87354 24281-87355 24281-87356

OFF: (505) 325-5667



LAB: (505) 325-1556

June 01, 1998

Maureen Gannon
PNM - Public Service Company of NM
Alvarado Square Mail Stop 0408
Albuquerque, NM 87158
TEL: (505) 241-2974
FAX (505) 241-2340

2nd Quarter 98

RE: Miles Fed. 1E

Order No.: 9805065

Dear Maureen Gannon,

On Site Technologies, LTD. received 5 samples on 5/20/98 for the analyses presented in the following report.

The Samples were analyzed for the following tests:
BTEX (SW8020A)

There were no problems with the analyses and all data for associated QC met EPA or laboratory specifications except where noted in the Case Narrative.

If you have any questions regarding these tests results, please feel free to call.

Sincerely,

David Cox



OFF: (505) 325-5667

LAB: (505) 325-1556

On Site Technologies, LTD.

Date: 01-Jun-98

CLIENT: PNM - Public Service Company of NM
Project: Miles Fed. 1E
Lab Order: 9805065

CASE NARRATIVE

Samples were analyzed using the methods outlined in the following references:

Test Methods for Evaluating Solid Waste, Physical/Chemical Methods, SW846, 3rd Edition

All method blanks, laboratory spikes, and/or matrix spikes met quality assurance objectives.

OFF: (505) 325-5667



LAB: (505) 325-1556

On Site Technologies, LTD.

Date: 01-Jun-98

CLIENT: PNM - Public Service Company of NM
Project: Miles Fed. 1E
Lab Order: 9805065

CASE NARRATIVE

Samples were analyzed using the methods outlined in the following references:

Test Methods for Evaluating Solid Waste, Physical/Chemical Methods, SW846, 3rd Edition

All method blanks, laboratory spikes, and/or matrix spikes met quality assurance objectives.

OFF: (505) 325-5667



LAB: (505) 325-1556

ANALYTICAL REPORT

Date: 01-Jun-98

Client:	PNM - Public Service Company of NM	Client Sample Info:	Miles Fed. 1E
Work Order:	9805065	Client Sample ID:	9805201315; MW-1
Lab ID:	9805065-01A	Matrix:	AQUEOUS
Project:	Miles Fed. 1E	Collection Date:	5/20/98 1:15:00 PM
		COC Record:	7257

Parameter	Result	PQL	Qual	Units	DF	Date Analyzed
BTEX		SW8020A				Analyst: DC
Benzene	ND	0.5		µg/L	1	5/29/98
Toluene	ND	0.5		µg/L	1	5/29/98
Ethylbenzene	ND	0.5		µg/L	1	5/29/98
m,p-Xylene	ND	1		µg/L	1	5/29/98
o-Xylene	ND	0.5		µg/L	1	5/29/98

Qualifiers:	PQL - Practical Quantitation Limit	S - Spike Recovery outside accepted recovery limits
	ND - Not Detected at Practical Quantitation Limit	R - RPD outside accepted recovery limits
	J - Analyte detected below Practical Quantitation Limit	E - Value above quantitation range
	B - Analyte detected in the associated Method Blank	Surr: - Surrogate

P.O. BOX 2606 • FARMINGTON, NM 87499

- TECHNOLOGY BLENDING INDUSTRY WITH THE ENVIRONMENT -

OFF: (505) 325-5667



LAB: (505) 325-1556

ANALYTICAL REPORT

Date: 01-Jun-98

Client:	PNM - Public Service Company of NM	Client Sample Info:	Miles Fed. 1E
Work Order:	9805065	Client Sample ID:	9805201343; MW-2
Lab ID:	9805065-02A	Matrix:	AQUEOUS
Project:	Miles Fed. 1E	Collection Date:	5/20/98 1:43:00 PM
		COC Record:	7257

Parameter	Result	PQL	Qual	Units	DF	Date Analyzed
BTEX		SW8020A				Analyst: HR
Benzene	1.3	0.5		µg/L	1	5/28/98
Toluene	5.8	0.5		µg/L	1	5/28/98
Ethylbenzene	2.6	0.5		µg/L	1	5/28/98
m,p-Xylene	1.9	1		µg/L	1	5/28/98
o-Xylene	0.6	0.5		µg/L	1	5/28/98

Qualifiers:	PQL - Practical Quantitation Limit	S - Spike Recovery outside accepted recovery limits
	ND - Not Detected at Practical Quantitation Limit	R - RPD outside accepted recovery limits
	J - Analyte detected below Practical Quantitation Limit	E - Value above quantitation range
	B - Analyte detected in the associated Method Blank	Surr: - Surrogate

P.O. BOX 2606 • FARMINGTON, NM 87499

OFF: (505) 325-5667



LAB: (505) 325-1556

ANALYTICAL REPORT

Date: 01-Jun-98

Client:	PNM - Public Service Company of NM	Client Sample Info:	Miles Fed. 1E
Work Order:	9805065	Client Sample ID:	9805201403; MW-3
Lab ID:	9805065-03A	Matrix:	AQUEOUS
Project:	Miles Fed. 1E	Collection Date:	5/20/98 2:03:00 PM
		COC Record:	7257

Parameter	Result	PQL	Qual	Units	DF	Date Analyzed
BTEX		SW8020A				Analyst: DC
Benzene	ND	0.5		µg/L	1	5/29/98
Toluene	ND	0.5		µg/L	1	5/29/98
Ethylbenzene	1.9	0.5		µg/L	1	5/29/98
m,p-Xylene	ND	1		µg/L	1	5/29/98
o-Xylene	ND	0.5		µg/L	1	5/29/98

Qualifiers: PQL - Practical Quantitation Limit S - Spike Recovery outside accepted recovery limits
ND - Not Detected at Practical Quantitation Limit R - RPD outside accepted recovery limits
J - Analyte detected below Practical Quantitation Limit E - Value above quantitation range
B - Analyte detected in the associated Method Blank Surr: - Surrogate

P.O. BOX 2606 • FARMINGTON, NM 87499

OFF: (505) 325-5667



LAB: (505) 325-1556

ANALYTICAL REPORT

Date: 01-Jun-98

Client:	PNM - Public Service Company of NM	Client Sample Info:	Miles Fed. 1E
Work Order:	9805065	Client Sample ID:	9805201422; MW-4
Lab ID:	9805065-04A	Matrix:	AQUEOUS
Project:	Miles Fed. 1E	Collection Date:	5/20/98 2:22:00 PM
		COC Record:	7257

Parameter	Result	PQL	Qual	Units	DF	Date Analyzed
BTEX		SW8020A				Analyst: HR
Benzene	ND	0.5		µg/L	1	5/28/98
Toluene	ND	0.5		µg/L	1	5/28/98
Ethylbenzene	ND	0.5		µg/L	1	5/28/98
m,p-Xylene	ND	1		µg/L	1	5/28/98
o-Xylene	ND	0.5		µg/L	1	5/28/98

Qualifiers:

PQL - Practical Quantitation Limit	S - Spike Recovery outside accepted recovery limits
ND - Not Detected at Practical Quantitation Limit	R - RPD outside accepted recovery limits
J - Analyte detected below Practical Quantitation Limit	E - Value above quantitation range
B - Analyte detected in the associated Method Blank	Surr: - Surrogate

OFF: (505) 325-5667



LAB: (505) 325-1556

ANALYTICAL REPORT

Date: 01-Jun-98

*Duplicate
of MW-2*

Client:	PNM - Public Service Company of NM	Client Sample Info:	Miles Fed. 1E
Work Order:	9805065	Client Sample ID:	9805201444; MW-5
Lab ID:	9805065-05A	Matrix:	AQUEOUS
Project:	Miles Fed. 1E	Collection Date:	5/20/98 2:44:00 PM
		COC Record:	7257

Parameter	Result	PQL	Qual	Units	DF	Date Analyzed
BTEX		SW8020A				Analyst: HR
Benzene	1.3	0.5		µg/L	1	5/28/98
Toluene	5.1	0.5		µg/L	1	5/28/98
Ethylbenzene	2.4	0.5		µg/L	1	5/28/98
m,p-Xylene	ND	1		µg/L	1	5/28/98
o-Xylene	ND	0.5		µg/L	1	5/28/98

Qualifiers:	PQL - Practical Quantitation Limit	S - Spike Recovery outside accepted recovery limits
	ND - Not Detected at Practical Quantitation Limit	R - RPD outside accepted recovery limits
	J - Analyte detected below Practical Quantitation Limit	E - Value above quantitation range
	B - Analyte detected in the associated Method Blank	Surr: - Surrogate

On Site Technologies, LTD.

Date: 01-Jun-98

CLIENT: PNM - Public Service Company of NM
Work Order: 9805065
Project: Miles Fed. 1E

QC SUMMARY REPORT

Method Blank

Sample ID: MB1	Batch ID: GC-1_980528	Test Code: SW8020A	Units: µg/L	Analysis Date 5/28/98	Prep Date:						
Client ID:	9805065	Run ID: GC-1_980528A		SeqNo: 2503							
Analyte	Result	PQL	SPK value	SPK Ref Val	%REC	LowLimit	HighLimit	RPD Ref Val	%RPD	RPDLimit	Qual
Benzene	.0626	0.5									J
Ethylbenzene	ND	0.5									J
m,p-Xylene	.1027	1									J
o-Xylene	ND	0.5									J
Toluene	.1758	0.5									J

Sample ID: MB1	Batch ID: GC-1_980529	Test Code: SW8020A	Units: µg/L	Analysis Date 5/29/98	Prep Date:						
Client ID:	9805065	Run ID: GC-1_980529A		SeqNo: 2517							
Analyte	Result	PQL	SPK value	SPK Ref Val	%REC	LowLimit	HighLimit	RPD Ref Val	%RPD	RPDLimit	Qual
Benzene	.0801	0.5									J
Ethylbenzene	ND	0.5									J
m,p-Xylene	ND	1									J
Methyl tert-Butyl Ether	.0986	1									J
o-Xylene	ND	0.5									J
Toluene	.1744	0.5									J

Qualifiers: ND - Not Detected at the Reporting Limit S - Spike Recovery outside accepted recovery limits B - Analyte detected in the associated Method Blank
 J - Analyte detected below quantitation limits R - RPD outside accepted recovery limits 1 of 1

On Site Technologies, LTD.

CLIENT: PNM - Public Service Company of NM
Work Order: 9805065
Project: Miles Fed. 1E

Date: 01-Jun-98

QC SUMMARY REPORT
 Sample Matrix Spike

Sample ID: 9805064-02AMS Batch ID: GC-1_980528 Test Code: SW8020A Units: µg/L Analysis Date 5/28/98 Prep Date:
 Client ID: 9805065 Run ID: GC-1_980528A SeqNo: 2504

Analyte	Result	PQL	SPK value	SPK Ref Val	%REC	LowLimit	HighLimit	RPD Ref Val	%RPD	RPDLimit	Qual
Benzene	165.2	12	100	58.04	107.2%	56	128				
Ethylbenzene	119.5	12	100	11.2	108.3%	78	107				
m,p-Xylene	239.5	25	200	28.63	105.5%	67	118				
o-Xylene	109.9	12	100	0.8835	109.0%	78	107				
Toluene	122.2	12	100	14.79	107.4%	74	116				

SV FINN-EPD
 COM-FINN-EPD
 SV 6/1/98
 WZ 6/1/98

Sample ID: 9805064-02AMS Batch ID: GC-1_980528 Test Code: SW8020A Units: µg/L Analysis Date 5/28/98 Prep Date:
 Client ID: 9805065 Run ID: GC-1_980528A SeqNo: 2505

Analyte	Result	PQL	SPK value	SPK Ref Val	%REC	LowLimit	HighLimit	RPD Ref Val	%RPD	RPDLimit	Qual
Benzene	161	12	100	58.04	103.0%	56	128	165.2	2.6%	12	
Ethylbenzene	117.7	12	100	11.2	106.5%	78	107	119.5	1.5%	11	
m,p-Xylene	235.8	25	200	28.63	103.6%	67	118	239.5	1.6%	10	
o-Xylene	109.6	12	100	0.8835	108.7%	78	107	109.9	0.3%	14	S ✓
Toluene	119	12	100	14.79	104.2%	74	116	122.2	2.6%	14	

Sample ID: 9805080-03AMS Batch ID: GC-1_980529 Test Code: SW8020A Units: µg/L Analysis Date 5/29/98 Prep Date:
 Client ID: 9805065 Run ID: GC-1_980529A SeqNo: 2518

Analyte	Result	PQL	SPK value	SPK Ref Val	%REC	LowLimit	HighLimit	RPD Ref Val	%RPD	RPDLimit	Qual
Benzene	1095	5	400	724.6	92.6%	56	128				
Ethylbenzene	478	5	400	82.45	98.9%	78	107				
m,p-Xylene	934.8	10	800	170.2	95.6%	67	118				
Methyl tert-Butyl Ether	930.9	10	400	563.8	91.8%	70	130				
o-Xylene	462.9	5	400	68.48	98.6%	78	107				
Toluene	1040	5	400	675.5	91.2%	74	116				

Qualifiers: ND - Not Detected at the Reporting Limit
 J - Analyte detected below quantitation limits

S - Spike Recovery outside accepted recovery limits
 R - RPD outside accepted recovery limits

B - Analyte detected in the associated Method Blank

QC SUMMARY REPORT

Sample Matrix Spike Duplicate

CLIENT: PNM - Public Service Company of NM
 Work Order: 9805065
 Project: Miles Fed. 1E

Sample ID: 9805080-03AMSD	Batch ID: GC-1_980529	Test Code: SW8020A	Units: µg/L	Analysis Date 5/29/98	Prep Date:				
Client ID: 9805065	Run ID: GC-1_980529A	PQL	SPK value	SeqNo: 2520					
Analyte	Result	SPK Ref Val	SPK Ref Val	LowLimit	HighLimit	RPD Ref Val	%RPD	RPDLimit	Qual
Benzene	1076	5	400	56	128	1095	1.8%	12	
Ethylbenzene	468.9	5	400	78	107	478	1.9%	11	
m,p-Xylene	918.3	10	800	67	118	934.8	1.8%	10	
Methyl tert-Butyl Ether	940.8	10	400	70	130	930.9	1.1%	15	
o-Xylene	456.6	5	400	78	107	462.9	1.4%	14	
Toluene	1022	5	400	74	116	1040	1.8%	14	

Sample ID: 9805080-04AMS	Batch ID: GC-1_980529	Test Code: SW8020A	Units: µg/L	Analysis Date 5/29/98	Prep Date:				
Client ID: 9805065	Run ID: GC-1_980529A	PQL	SPK value	SeqNo: 2519					
Analyte	Result	SPK Ref Val	SPK Ref Val	LowLimit	HighLimit	RPD Ref Val	%REC	RPDLimit	Qual
Benzene	419.7	5	400	56	128		104.5%		
Ethylbenzene	420.2	5	400	78	107		104.7%		
m,p-Xylene	806.4	10	800	67	118		100.5%		
Methyl tert-Butyl Ether	419.7	10	400	70	130		104.7%		
o-Xylene	417.4	5	400	78	107		104.1%		
Toluene	417.8	5	400	74	116		103.6%		

Sample ID: 9805080-04AMSD	Batch ID: GC-1_980529	Test Code: SW8020A	Units: µg/L	Analysis Date 5/29/98	Prep Date:				
Client ID: 9805065	Run ID: GC-1_980529A	PQL	SPK value	SeqNo: 2521					
Analyte	Result	SPK Ref Val	SPK Ref Val	LowLimit	HighLimit	RPD Ref Val	%REC	RPDLimit	Qual
Benzene	404	5	400	56	128	419.7	100.5%	12	
Ethylbenzene	405.4	5	400	78	107	420.2	101.0%	11	
m,p-Xylene	778.3	10	800	67	118	806.4	96.9%	10	
Methyl tert-Butyl Ether	408	10	400	70	130	419.7	101.7%	15	
o-Xylene	404.9	5	400	78	107	417.4	101.0%	14	
Toluene	403.2	5	400	74	116	417.8	99.9%	14	

Qualifiers: ND - Not Detected at the Reporting Limit
 J - Analyte detected below quantitation limits
 S - Spike Recovery outside accepted recovery limits
 R - RPD outside accepted recovery limits
 B - Analyte detected in the associated Method Blank

On Site Technologies, LTD.

Date: 01-Jun-98

CLIENT: PNM - Public Service Company of NM
Work Order: 9805065
Project: Miles Fed. 1E

QC SUMMARY REPORT
 Laboratory Control Spike - generic

Sample ID: LCS	Batch ID: GC-1_980528	Test Code: SW8020A	Units: µg/L	Analysis Date 5/28/98	Prep Date:						
Client ID:	9805065	Run ID: GC-1_980528A		SeqNo: 2502							
Analyte	Result	PQL	SPK value	SPK Ref Val	%REC	LowLimit	HighLimit	RPD Ref Val	%RPD	RPDLimit	Qual
Benzene	43.02	0.5	40	0.0626	107.4%	56	128				
Ethylbenzene	43.08	0.5	40	0	107.7%	78	107				
m,p-Xylene	82.61	1	80	0.1027	103.1%	67	118				
o-Xylene	42.73	0.5	40	0	106.8%	78	107				
Toluene	42.63	0.5	40	0.1758	106.1%	74	116				

SE 6/1/98
 JWC 6/1/98

Sample ID: LCS	Batch ID: GC-1_980529	Test Code: SW8020A	Units: µg/L	Analysis Date 5/29/98	Prep Date:						
Client ID:	9805065	Run ID: GC-1_980529A		SeqNo: 2516							
Analyte	Result	PQL	SPK value	SPK Ref Val	%REC	LowLimit	HighLimit	RPD Ref Val	%RPD	RPDLimit	Qual
Benzene	40.38	0.5	40	0.0801	100.8%	56	128				
Ethylbenzene	40.56	0.5	40	0	101.4%	78	107				
m,p-Xylene	77.94	1	80	0	97.4%	67	118				
Methyl tert-Butyl Ether	40.57	1	40	0.0986	101.2%	70	130				
o-Xylene	40.38	0.5	40	0	100.9%	78	107				
Toluene	40.28	0.5	40	0.1744	100.3%	74	116				

Qualifiers: ND - Not Detected at the Reporting Limit
 J - Analyte detected below quantitation limits

S - Spike Recovery outside accepted recovery limits
 R - RPD outside accepted recovery limits

B - Analyte detected in the associated Method Blank
 I of I

Date: 01-Jun-98

On Site Technologies, LTD.

CLIENT: PNM - Public Service Company of NM
Work Order: 9805065
Project: Miles Fed. 1E

QC SUMMARY REPORT
 Continuing Calibration Verification Standard

Sample ID: CCV1 QC0529/30	Batch ID: GC-1_980528	Test Code: SW8020A	Units: µg/L	Analysis Date: 5/28/98	Prep Date:						
Client ID: 9805065	Run ID: GC-1_980528A			SeqNo: 2499							
Analyte	Result	PQL	SPK value	SPK Ref Val	%REC	LowLimit	HighLimit	RPD Ref Val	%RPD	RPDLimit	Qual
Benzene	21.8	0.5	20	0	109.0%	85	115				
Ethylbenzene	21.96	0.5	20	0	109.8%	85	115				
m,p-Xylene	41.88	1	40	0	104.7%	85	115				
o-Xylene	21.65	0.5	20	0	108.2%	85	115				
Toluene	21.72	0.5	20	0	108.6%	85	115				
1,4-Difluorobenzene	91.91	0	100	0	91.9%	70	130				
4-Bromochlorobenzene	88.8	0	100	0	88.8%	70	130				
Fluorobenzene	91.37	0	100	0	91.4%	70	130				

Sample ID: CCV2 QC0529/30	Batch ID: GC-1_980528	Test Code: SW8020A	Units: µg/L	Analysis Date: 5/28/98	Prep Date:						
Client ID: 9805065	Run ID: GC-1_980528A			SeqNo: 2500							
Analyte	Result	PQL	SPK value	SPK Ref Val	%REC	LowLimit	HighLimit	RPD Ref Val	%RPD	RPDLimit	Qual
Benzene	20.8	0.5	20	0	104.0%	85	115				
Ethylbenzene	21.06	0.5	20	0	105.3%	85	115				
m,p-Xylene	40.16	1	40	0	100.4%	85	115				
o-Xylene	20.86	0.5	20	0	104.3%	85	115				
Toluene	20.88	0.5	20	0	104.4%	85	115				
1,4-Difluorobenzene	92.07	0	100	0	92.1%	70	130				
4-Bromochlorobenzene	85.01	0	100	0	85.0%	70	130				
Fluorobenzene	90.86	0	100	0	90.9%	70	130				

Qualifiers: ND - Not Detected at the Reporting Limit
 J - Analyte detected below quantitation limits
 S - Spike Recovery outside accepted recovery limits
 R - RPD outside accepted recovery limits
 B - Analyte detected in the associated Method Blank

QC SUMMARY REPORT

Continuing Calibration Verification Standard

CLIENT: PNM - Public Service Company of NM
Work Order: 9805065
Project: Miles Fed. IE

Analyte	Result	PQL	SPK value	SPK Ref Val	%REC	LowLimit	HighLimit	RPD Ref Val	%RPD	RPDLimit	Qual	Prep Date:	
												Analysis Date	SeqNo:
Benzene	20.97	0.5	20	0	104.8%	85	115					5/28/98	2501
Ethylbenzene	21.12	0.5	20	0	105.6%	85	115						
m,p-Xylene	40.36	1	40	0	100.9%	85	115						
o-Xylene	21.39	0.5	20	0	107.0%	85	115						
Toluene	21.22	0.5	20	0	106.1%	85	115						
1,4-Difluorobenzene	91.69	0	100	0	91.7%	70	130						
4-Bromochlorobenzene	73.95	0	100	0	74.0%	70	130						
Fluorobenzene	90.82	0	100	0	90.8%	70	130						

Analyte	Result	PQL	SPK value	SPK Ref Val	%REC	LowLimit	HighLimit	RPD Ref Val	%RPD	RPDLimit	Qual	Prep Date:	
												Analysis Date	SeqNo:
Benzene	21.41	0.5	20	0	107.1%	85	115					5/29/98	2513
Ethylbenzene	21.63	0.5	20	0	108.2%	85	115						
m,p-Xylene	41.3	1	40	0	103.2%	85	115						
Methyl tert-Butyl Ether	20.78	1	20	0	103.9%	85	115						
o-Xylene	21.38	0.5	20	0	106.9%	85	115						
Toluene	21.53	0.5	20	0	107.6%	85	115						
1,4-Difluorobenzene	92.28	0	100	0	92.3%	70	130						
4-Bromochlorobenzene	87.76	0	100	0	87.8%	70	130						
Fluorobenzene	90.91	0	100	0	90.9%	70	130						

Qualifiers: ND - Not Detected at the Reporting Limit
 J - Analyte detected below quantitation limits
 S - Spike Recovery outside accepted recovery limits
 R - RPD outside accepted recovery limits
 B - Analyte detected in the associated Method Blank

CLIENT: PNM - Public Service Company of NM
 Work Order: 9805065
 Project: Miles Fed. 1E

QC SUMMARY REPORT
 Continuing Calibration Verification Standard

Sample ID: CCV2 QC0529/30 Batch ID: GC-1_980529 Test Code: SW8020A Units: µg/L Analysis Date 5/29/98 Prep Date:

Client ID: 9805065 Run ID: GC-1_980529A SeqNo: 2514

Analyte	Result	PQL	SPK value	SPK Ref Val	%REC	LowLimit	HighLimit	RPD Ref Val	%RPD	RPDLimit	Qual
Benzene	21.16	0.5	20	0	105.8%	85	115				
Ethylbenzene	21.83	0.5	20	0	109.2%	85	115				
m,p-Xylene	41.03	1	40	0	102.6%	85	115				
Methyl tert-Butyl Ether	21.78	1	20	0	108.9%	85	115				
o-Xylene	21.14	0.5	20	0	105.7%	85	115				
Toluene	21.21	0.5	20	0	106.1%	85	115				
1,4-Difluorobenzene	92.21	0	100	0	92.2%	70	130				
4-Bromochlorobenzene	90.07	0	100	0	90.1%	70	130				
Fluorobenzene	90.85	0	100	0	90.8%	70	130				

Sample ID: CCV3 QC0529/30 Batch ID: GC-1_980529 Test Code: SW8020A Units: µg/L Analysis Date 5/29/98 Prep Date:

Client ID: 9805065 Run ID: GC-1_980529A SeqNo: 2515

Analyte	Result	PQL	SPK value	SPK Ref Val	%REC	LowLimit	HighLimit	RPD Ref Val	%RPD	RPDLimit	Qual
Benzene	21.79	0.5	20	0	109.0%	85	115				
Ethylbenzene	22.39	0.5	20	0	111.9%	85	115				
m,p-Xylene	42.22	1	40	0	105.6%	85	115				
Methyl tert-Butyl Ether	21.28	1	20	0	106.4%	85	115				
o-Xylene	21.67	0.5	20	0	108.4%	85	115				
Toluene	21.79	0.5	20	0	108.9%	85	115				
1,4-Difluorobenzene	91.64	0	100	0	91.6%	70	130				
4-Bromochlorobenzene	88.47	0	100	0	88.5%	70	130				
Fluorobenzene	91.11	0	100	0	91.1%	70	130				

Qualifiers: ND - Not Detected at the Reporting Limit
 J - Analyte detected below quantitation limits

S - Spike Recovery outside accepted recovery limits
 R - RPD outside accepted recovery limits

B - Analyte detected in the associated Method Blank

CLIENT: PNM - Public Service Company of NM
 Work Order: 9805065
 Project: Miles Fed. 1E
 Test No: SW8020A

**QC SUMMARY REPORT
 SURROGATE RECOVERIES**

BTEX

Sample ID	14FBZ	4BCBZ	FLBZ				
9805062-05A	91.9	89.6	90.9				
9805062-10A	91.6	89.4	91.1				
9805063-01A	93.2	88.1	92				
9805063-02A	88.4	87.6	87.9				
9805063-03A	92.5	89	91.7				
9805063-04A	93.2	88.4	91.7				
9805063-05A	93.1	88.6	91.6				
9805063-06A	88.5	86.3	87.9				
9805064-01A	92.5	87.2	91.4				
9805064-02A	80.6	85.1	80.4				
9805064-02AMS	89.5	84.6	89.3				
9805064-02AMSD	90	83.8	89.2				
9805064-03A	92.8	84.4	91.2				
9805064-04A	92.3	80.9	91.2				
9805064-05A	83.9	78.7	83.9				
9805065-01A	92.5	90.2	91.8				
9805065-02A	90.4	80.9	88.7				
9805065-03A	92.7	89.1	91				
9805065-04A	92	75.8	90.8				
9805065-05A	91.6	75.7	90.4				
9805080-03A	91.7	88.1	90.2				
9805080-03AMS	90.7	89.2	89.9				
9805080-03AMSD	91.1	89.8	89.8				
9805080-04A	92.2	87.8	91				
9805080-04AMS	91.5	89.8	90.9				
9805080-04AMSD	91.7	88.6	90.6				
CCV1 QC0529/30	92.3	87.8	90.9				

Acronym	Surrogate	QC Limits
14FBZ	= 1,4-Difluorobenzene	70-130
4BCBZ	= 4-Bromochlorobenzene	70-130
FLBZ	= Fluorobenzene	70-130

* Surrogate recovery outside acceptance limits

CLIENT: PNM - Public Service Company of NM
Work Order: 9805065
Project: Miles Fed. 1E
Test No: SW8020A

QC SUMMARY REPORT
SURROGATE RECOVERIES

BTEX

Sample ID	14FBZ	4BCBZ	FLBZ					
CCV2 QC0529/30	92.2	90.1	90.8					
CCV3 QC0529/30	91.6	88.5	91.1					
LCS	91.7	89.6	91					
MB1	93.3	84.2	91.5					

Acronym	Surrogate	QC Limits
14FBZ	= 1,4-Difluorobenzene	70-130
4BCBZ	= 4-Bromochlorobenzene	70-130
FLBZ	= Fluorobenzene	70-130

* Surrogate recovery outside acceptance limits

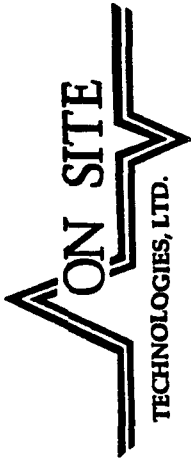

CHAIN OF CUSTODY RECORD

7257

Date: 5/26/98 Page: 1 of 1

612 E. Murphy Dr. • P.O. Box 2606 • Farmington, NM 87499
 LAB: (505) 325-5667 • FAX: (505) 325-6256

Purchase Order No.:		Job No.	
Name: Denver Bearden		Title: Maureen Gannon	
Company: PNM Gas Services		Company: PNM Gas Services	
Address: 603 W. Elm Street		Mailing Address: Alverado Square, Mail Stop 0408	
City, State, Zip: Farmington, NM 87401		City, State, Zip: Albuquerque, NM 87158	
Sampling Location:		Telephone No.: 505-848-2974	
Miles Fed. IE		Telefax No.:	
Sampler: R. Dedrick		ANALYSIS REQUESTED	
SAMPLE IDENTIFICATION		REPORT TO RESULTS TO	
DATE	TIME	MATRIX	PRES.
5/24/98	1315	H ₂ O	HCl
5/24/98	1343	H ₂ O	Ice
5/24/98	1403	H ₂ O	HCl
5/24/98	1422	H ₂ O	HCl
5/24/98	1444	H ₂ O	Ice
Number of Containers		LAB ID	
9805201315		9805015-01A	
9805201343		-02A	
9805201403		-03A	
9805201422		-04A	
9805201444		-05A	
Relinquished by: <i>Ronald D. Dedrick</i>		Received by: <i>Maureen Gannon</i>	
Date/Time: <i>5/29/98 1606</i>		Date/Time: <i>5/20/98 1600</i>	
Relinquished by:		Received by:	
Date/Time:		Date/Time:	
Relinquished by:		Received by:	
Date/Time:		Date/Time:	
Method of Shipment:		Rush	
Authorized by: <i>Ronald D. Dedrick</i>		24-48 Hours	
(Client Signature Must Accompany Request)		10 Working Days	
		Special Instructions:	
		Results to be sent to both parties.	

CHAIN OF CUSTODY RECORD

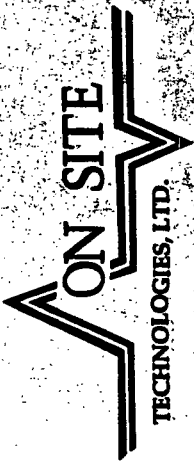

612 E. Murphy Dr. • P.O. Box 2606 • Farmington, NM 87489
LAB: (505) 325-5667 • FAX: (505) 325-6256

Date: 2/26/98 Page: 1 of 1

Purchase Order No.	Name Maureen Gannon	Title	
Name Denver Bearden	Company PNM Gas Services	Mailing Address Alverado Square, Mail Stop 0408	
Company PNM Gas Services	Address 603 W. Elm Street	City, State, Zip Albuquerque, NM 87158	Telephone No. 505-848-2974
Address 603 W. Elm Street	City, State, Zip Farmington, NM 87401	Teletax No.	
Job No.	ANALYSIS REQUESTED		

SEND INVOICE TO	REPORT TO	Number of Containers	LAB ID

SAMPLE IDENTIFICATION	SAMPLE DATE		MATRIX		PRES.
	DATE	TIME	MATRIX	PRES.	
7805201315 NW-1	7/9/98	1345	H2C	HCL	
7805201343 NW-2	7/9/98	1353	H2C	HCL	
7805201403 NW-3	7/9/98	1403	H2C	HCL	
7805201422 NW-4	7/9/98	1422	H2C	HCL	
7805201444 NW-5	7/9/98	1444	H2C	HCL	

Relinquished by: <i>Ronald D. Dadd</i>	Date/Time: 3/2/98 1606	Received by: <i>Heidi Rose</i>	Date/Time: both 1606
Relinquished by:	Date/Time:	Received by:	Date/Time:
Relinquished by:	Date/Time:	Received by:	Date/Time:

Method of Shipment: 24-48 Hours

Authorized by: *Ronald D. Dadd* Date: 3/2/98

(Client Signature Must Accompany Request)

Results to be sent to both parties.

Distributor: White - On Site Yellow - Lab Print Sampler Goldsmed - Client

2/10/98

OFF: (505) 325-5667



LAB: (505) 325-1556

February 24, 1998

Maureen Gannon
PNM Gas Services
Alevardo Square, Mail Stop 0408
Albuquerque, NM 87401
TEL: (505) 241-2974
FAX (505) 241-2340

1st Quarter 1998

RE: Miles Federal 1E

Order No.: 9802004

Dear Maureen Gannon,

On Site Technologies, LTD. received 5 samples on 2/11/98 for the analyses presented in the following report.

The Samples were analyzed for the following tests:

Aromatic Volatiles by GC-PID (SW8021A)

There were no problems with the analyses and all data for associated QC met EPA or laboratory specifications except where noted in the Case Narrative.

If you have any questions regarding these tests results, please feel free to call.

Sincerely,

A handwritten signature in black ink, appearing to read "D Cox", is written over the name David Cox.

David Cox

OFF: (505) 325-5667



LAB: (505) 325-1556

ANALYTICAL REPORT

Date: 24-Feb-98

Client: PNM Gas Services

Client Sample Info: Miles Federal 1E

Work Order: 9802004

Client Sample ID: 9802101408; MW-1

Lab ID: 9802004-01A **Matrix:** AQUEOUS

Collection Date: 2/10/98 2:08:00 PM

Project: Miles Federal 1E

COC#: 7140

Parameter	Result	Limit	Qual	Units	DF	Date Analyzed
AROMATIC VOLATILES BY GC-PID		SW8021A		Analyst: DC		
Benzene	ND	0.5		µg/L	1	2/18/98
Toluene	ND	0.5		µg/L	1	2/18/98
Ethylbenzene	ND	0.5		µg/L	1	2/18/98
m,p-Xylene	ND	1		µg/L	1	2/18/98
o-Xylene	ND	0.5		µg/L	1	2/18/98
Surr: Fluorobenzene	99.7	70-130		%REC	1	2/18/98
Surr: 1,4-Difluorobenzene	101.2	70-130		%REC	1	2/18/98
Surr: 4-Bromochlorobenzene	98.2	70-130		%REC	1	2/18/98

Qualifiers:

- ND - Not Detected at the Reporting Limit
- J - Analyte detected below quantitation limits
- B - Analyte detected in the associated Method Blank
- * - Value exceeds Maximum Contaminant Level

- S - Spike Recovery outside accepted recovery limits
- R - RPD outside accepted recovery limits
- E - Value above quantitation range

P.O. BOX 2606 • FARMINGTON, NM 87499

- TECHNOLOGY BLENDING INDUSTRY WITH THE ENVIRONMENT -

OFF: (505) 325-5667



LAB: (505) 325-1556

ANALYTICAL REPORT

Date: 24-Feb-98

Client: PNM Gas Services	Client Sample Info: Miles Federal 1E
Work Order: 9802004	Client Sample ID: 9802101426; MW-2
Lab ID: 9802004-02A Matrix: AQUEOUS	Collection Date: 2/10/98 2:26:00 PM
Project: Miles Federal 1E	COC#: 7140

Parameter	Result	Limit	Qual	Units	DF	Date Analyzed
AROMATIC VOLATILES BY GC-PID		SW8021A				Analyst: DC
Benzene	1.8	0.5		µg/L	1	2/18/98
Toluene	7.0	0.5		µg/L	1	2/18/98
Ethylbenzene	7.6	0.5		µg/L	1	2/18/98
m,p-Xylene	3.9	1		µg/L	1	2/18/98
o-Xylene	ND	0.5		µg/L	1	2/18/98
Surr: Fluorobenzene	97.1	70-130		%REC	1	2/18/98
Surr: 1,4-Difluorobenzene	98.9	70-130		%REC	1	2/18/98
Surr: 4-Bromochlorobenzene	97.6	70-130		%REC	1	2/18/98

Qualifiers:

ND - Not Detected at the Reporting Limit	S - Spike Recovery outside accepted recovery limits
J - Analyte detected below quantitation limits	R - RPD outside accepted recovery limits
B - Analyte detected in the associated Method Blank	E - Value above quantitation range
* - Value exceeds Maximum Contaminant Level	

P.O. BOX 2606 • FARMINGTON, NM 87499

- TECHNOLOGY BLENDING INDUSTRY WITH THE ENVIRONMENT -

OFF: (505) 325-5667



LAB: (505) 325-1556

ANALYTICAL REPORT

Date: 24-Feb-98

Client: PNM Gas Services	Client Sample Info: Miles Federal 1E
Work Order: 9802004	Client Sample ID: 9802101444; MW-3
Lab ID: 9802004-03A Matrix: AQUEOUS	Collection Date: 2/10/98 2:44:00 PM
Project: Miles Federal 1E	COC#: 7140

Parameter	Result	Limit	Qual	Units	DF	Date Analyzed
AROMATIC VOLATILES BY GC-PID		SW8021A		Analyst: DC		
Benzene	0.8	0.5		µg/L	1	2/19/98
Toluene	0.6	0.5		µg/L	1	2/19/98
Ethylbenzene	2.6	0.5		µg/L	1	2/19/98
m,p-Xylene	ND	1		µg/L	1	2/19/98
o-Xylene	ND	0.5		µg/L	1	2/19/98
Surr: Fluorobenzene	99.6	70-130		%REC	1	2/19/98
Surr: 1,4-Difluorobenzene	101.2	70-130		%REC	1	2/19/98
Surr: 4-Bromochlorobenzene	94.9	70-130		%REC	1	2/19/98

Qualifiers:

ND - Not Detected at the Reporting Limit	S - Spike Recovery outside accepted recovery limits
J - Analyte detected below quantitation limits	R - RPD outside accepted recovery limits
B - Analyte detected in the associated Method Blank	E - Value above quantitation range
* - Value exceeds Maximum Contaminant Level	

P.O. BOX 2606 • FARMINGTON, NM 87499

- TECHNOLOGY BLENDING INDUSTRY WITH THE ENVIRONMENT -

OFF: (505) 325-5667



LAB: (505) 325-1556

ANALYTICAL REPORT

Date: 24-Feb-98

Client:	PNM Gas Services	Client Sample Info:	Miles Federal 1E
Work Order:	9802004	Client Sample ID:	9802101458; MW-4
Lab ID:	9802004-04A	Matrix:	AQUEOUS
Project:	Miles Federal 1E	Collection Date:	2/10/98 2:58:00 PM
		COC#:	7140

Parameter	Result	Limit	Qual	Units	DF	Date Analyzed
AROMATIC VOLATILES BY GC-PID		SW8021A				Analyst: DC
Benzene	ND	0.5		µg/L	1	2/18/98
Toluene	ND	0.5		µg/L	1	2/18/98
Ethylbenzene	ND	0.5		µg/L	1	2/18/98
m,p-Xylene	ND	1		µg/L	1	2/18/98
o-Xylene	0.6	0.5		µg/L	1	2/18/98
Surr: Fluorobenzene	99.5	70-130		%REC	1	2/18/98
Surr: 1,4-Difluorobenzene	101.5	70-130		%REC	1	2/18/98
Surr: 4-Bromochlorobenzene	98.2	70-130		%REC	1	2/18/98

Qualifiers:

ND - Not Detected at the Reporting Limit	S - Spike Recovery outside accepted recovery limits
J - Analyte detected below quantitation limits	R - RPD outside accepted recovery limits
B - Analyte detected in the associated Method Blank	E - Value above quantitation range
* - Value exceeds Maximum Contaminant Level	

OFF: (505) 325-5667



LAB: (505) 325-1556

*Duplicate
of MW-2*

ANALYTICAL REPORT

Date: 24-Feb-98

Client: PNM Gas Services

Client Sample Info: Miles Federal 1E

Work Order: 9802004

Client Sample ID: 9802101515; MW-5

Lab ID: 9802004-05A **Matrix:** AQUEOUS

Collection Date: 2/10/98 3:15:00 PM

Project: Miles Federal 1E

COC#: 7140

Parameter	Result	Limit	Qual	Units	DF	Date Analyzed
AROMATIC VOLATILES BY GC-PID		SW8021A				Analyst: DC
Benzene	1.8	0.5		µg/L	1	2/18/98
Toluene	7.2	0.5		µg/L	1	2/18/98
Ethylbenzene	7.4	0.5		µg/L	1	2/18/98
m,p-Xylene	4.0	1		µg/L	1	2/18/98
o-Xylene	ND	0.5		µg/L	1	2/18/98
Surr: Fluorobenzene	96.9	70-130		%REC	1	2/18/98
Surr: 1,4-Difluorobenzene	99.5	70-130		%REC	1	2/18/98
Surr: 4-Bromochlorobenzene	97.8	70-130		%REC	1	2/18/98

Qualifiers:

- ND - Not Detected at the Reporting Limit
- J - Analyte detected below quantitation limits
- B - Analyte detected in the associated Method Blank
- * - Value exceeds Maximum Contaminant Level

- S - Spike Recovery outside accepted recovery limits
- R - RPD outside accepted recovery limits
- E - Value above quantitation range

On Site Technologies, LTD.

Date: 24-Feb-98

QC SUMMARY REPORT
Method Blank

CLIENT: PNM Gas Services
Work Order: 9802004
Project: Miles Federal 1E

Sample ID: MB1 W **Batch ID:** GC-1_980218 **Test Code:** SW8021A **Units:** µg/L **Analysis Date:** 2/18/98 **Prep Date:**
Client ID: 9802004 **Run ID:** GC-1_980218A **SeqNo:** 257

Analyte	Result	PQL	SPK value	SPK Ref Val	%REC	LowLimit	HighLimit	RPD Ref Val	%RPD	RPDLimit	Qual
Benzene	.1623	0.5									J
Ethylbenzene	ND	0.5									
m,p-Xylene	ND	1									
o-Xylene	ND	0.5									J
Toluene	.0581	0.5									

Qualifiers: ND - Not Detected at the Reporting Limit
J - Analyte detected below quantitation limits

S - Spike Recovery outside accepted recovery limits
R - RPD outside accepted recovery limits

B - Analyte detected in the associated Method Blank

On Site Technologies, LTD.

Date: 24-Feb-98

QC SUMMARY REPORT
Continuing Calibration Verification Standard

CLIENT: PNM Gas Services
Work Order: 9802004
Project: Miles Federal 1E

Sample ID: CCV1 QC0529/30	Batch ID: GC-1_980218	Test Code: SW8021A	Units: µg/L	Analysis Date: 2/18/98	Prep Date:						
Client ID: 9802004	Run ID: GC-1_980218A			SeqNo: 258							
Analyte	Result	PQL	SPK value	SPK Ref Val	%REC	LowLimit	HighLimit	RPD Ref Val	%RPD	RPDLimit	Qual
Benzene	21.28	0.5	20	0	106.4%	85	115				
Ethylbenzene	22.72	0.5	20	0	113.6%	85	115				
m,p-Xylene	42.78	1	40	0	107.0%	85	115				
o-Xylene	22.12	0.5	20	0	110.6%	85	115				
Toluene	21.7	0.5	20	0	108.5%	85	115				
1,4-Difluorobenzene	105.5	0	100	0	105.5%	70	130				
4-Bromochlorobenzene	95.89	0	100	0	95.9%	70	130				
Fluorobenzene	99.12	0	100	0	99.1%	70	130				

Sample ID: CCV2 QC0529/30	Batch ID: GC-1_980218	Test Code: SW8021A	Units: µg/L	Analysis Date: 2/18/98	Prep Date:						
Client ID: 9802004	Run ID: GC-1_980218A			SeqNo: 267							
Analyte	Result	PQL	SPK value	SPK Ref Val	%REC	LowLimit	HighLimit	RPD Ref Val	%RPD	RPDLimit	Qual
Benzene	21.01	0.5	20	0	105.0%	85	115				
Ethylbenzene	22.35	0.5	20	0	111.7%	85	115				
m,p-Xylene	42	1	40	0	105.0%	85	115				
o-Xylene	21.71	0.5	20	0	108.5%	85	115				
Toluene	21.42	0.5	20	0	107.1%	85	115				
1,4-Difluorobenzene	100.8	0	100	0	100.8%	70	130				
4-Bromochlorobenzene	97.87	0	100	0	97.9%	70	130				
Fluorobenzene	99.21	0	100	0	99.2%	70	130				

Qualifiers: ND - Not Detected at the Reporting Limit
J - Analyte detected below quantitation limits

S - Spike Recovery outside accepted recovery limits
R - RPD outside accepted recovery limits

B - Analyte detected in the associated Method Blank

CLIENT: PNM Gas Services
 Work Order: 9802004
 Project: Miles Federal 1E

QC SUMMARY REPORT
 Continuing Calibration Verification Standard

Prep Date:

Analysis Date: 2/18/98

Units: µg/L

Test Code: SW8021A

Batch ID: GC-1_980218

Sample ID: CCV3 QC0529/30

SeqNo: 279

Run ID: GC-1_980218A

Analyte	Result	PQL	SPK value	SPK Ref Val	%REC	LowLimit	HighLimit	RPD Ref Val	%RPD	RPDLimit	Qual
Benzene	21.04	0.5	20	0	105.2%	85	115				
Ethylbenzene	22.47	0.5	20	0	112.4%	85	115				
m,p-Xylene	42.3	1	40	0	105.8%	85	115				
o-Xylene	22.07	0.5	20	0	110.3%	85	115				
Toluene	21.51	0.5	20	0	107.5%	85	115				
1,4-Difluorobenzene	100.6	0	100	0	100.6%	70	130				
4-Bromochlorobenzene	95.78	0	100	0	95.8%	70	130				
Fluorobenzene	99.07	0	100	0	99.1%	70	130				

Qualifiers: ND - Not Detected at the Reporting Limit
 J - Analyte detected below quantitation limits

S - Spike Recovery outside accepted recovery limits
 R - RPD outside accepted recovery limits

B - Analyte detected in the associated Method Blank

On Site Technologies, LTD.

Date: 24-Feb-98

CLIENT: PNM Gas Services
Work Order: 9802004
Project: Miles Federal 1E

QC SUMMARY REPORT
 Laboratory Control Spike - generic

Sample ID: LCS WATER Batch ID: GC-1_980218 Test Code: SW8021A Units: µg/L Analysis Date: 2/18/98 Prep Date:
 Client ID: 9802004 Run ID: GC-1_980218A SeqNo: 259

Analyte	Result	PQL	SPK value	SPK Ref Val	%REC	LowLimit	HighLimit	RPD Ref Val	%RPD	RPDLimit	Qual
Benzene	41.54	0.5	40	0.1623	103.4%	84	114				
Ethylbenzene	44.37	0.5	40	0	110.9%	86	118				
m,p-Xylene	84.33	1	80	0	105.4%	50	150				
o-Xylene	43.43	0.5	40	0	108.6%	49	147				
Toluene	42.69	0.5	40	0.0581	106.6%	87	120				

Qualifiers: ND - Not Detected at the Reporting Limit
 J - Analyte detected below quantitation limits

S - Spike Recovery outside accepted recovery limits
 R - RPD outside accepted recovery limits

B - Analyte detected in the associated Method Blank

On Site Technologies, LTD.

Date: 24-Feb-98

CLIENT: PNM Gas Services
Work Order: 9802004
Project: Miles Federal 1E

QC SUMMARY REPORT
 Sample Matrix Spike

Sample ID: 9802002-03AMS	Batch ID: GC-1_980218	Test Code: SW8021A	Units: µg/L	Analysis Date: 2/18/98	Prep Date:				
Client ID: 9802004	Run ID: GC-1_980218A	PQL	SPK value	SeqNo: 276					
Analyte	Result	SPK Ref Val	%REC	LowLimit	HighLimit	RPD Ref Val	%RPD	RPDLimit	Qual
Benzene	3055	10	800	107.8%	57	128			
Ethylbenzene	915	10	800	105.2%	78	107			
m,p-Xylene	2035	20	1600	100.6%	67	118			
o-Xylene	898.6	10	800	107.5%	78	107			S
Toluene	856	10	800	106.6%	74	116			

LC5 ✓
 (2/18/98)

Sample ID: 9802002-03AMSD	Batch ID: GC-1_980218	Test Code: SW8021A	Units: µg/L	Analysis Date: 2/18/98	Prep Date:				
Client ID: 9802004	Run ID: GC-1_980218A	PQL	SPK value	SeqNo: 277					
Analyte	Result	SPK Ref Val	%REC	LowLimit	HighLimit	RPD Ref Val	%RPD	RPDLimit	Qual
Benzene	2927	10	800	91.8%	57	128	4.3%	12	
Ethylbenzene	899	10	800	103.2%	78	107	1.8%	11	
m,p-Xylene	1984	20	1600	97.4%	67	118	2.5%	10	
o-Xylene	842.4	10	800	100.5%	78	107	6.5%	14	
Toluene	808	10	800	100.6%	74	116	5.8%	14	

Qualifiers: ND - Not Detected at the Reporting Limit
 J - Analyte detected below quantitation limits
 S - Spike Recovery outside accepted recovery limits
 R - RPD outside accepted recovery limits
 B - Analyte detected in the associated Method Blank

On Site Technologies, LTD.

Date: 25-Feb-98

QC SUMMARY REPORT
Method Blank

CLIENT: PNM Gas Services
Work Order: 9802004
Project: Miles Federal 1E

Sample ID: MB1 W Batch ID: GC-1_980219 Test Code: SW8021A Units: µg/L Analysis Date: 2/19/98 Prep Date:
Client ID: 9802004 Run ID: GC-1_980219A SeqNo: 280

Analyte	Result	PQL	SPK value	SPK Ref Val	%REC	LowLimit	HighLimit	RPD Ref Val	%RPD	RPDLimit	Qual
Benzene	.1628	0.5									J
Ethylbenzene	ND	0.5									
m,p-Xylene	ND	1									
o-Xylene	ND	0.5									J
Toluene	.0594	0.5									J

Qualifiers: ND - Not Detected at the Reporting Limit
J - Analyte detected below quantitation limits
S - Spike Recovery outside accepted recovery limits
R - RPD outside accepted recovery limits
B - Analyte detected in the associated Method Blank

On Site Technologies, LTD.

CLIENT: PNM Gas Services
Work Order: 9802004
Project: Miles Federal 1E

Date: 25-Feb-98

QC SUMMARY REPORT
 Sample Matrix Spike

Sample ID: 9802009-04AMS	Batch ID: GC-1_980219	Test Code: SW8021A	Units: µg/L	Analysis Date: 2/19/98	Prep Date:				
Client ID: 9802004	Run ID: GC-1_980219A	PQL	SPK value	SeqNo: 297					
Analyte	Result	SPK	SPK Ref Val	LowLimit	HighLimit	RPD Ref Val	%RPD	RPDLimit	Qual
Benzene	251.8	2.5	44.9	57	128		103.5%		
Ethylbenzene	391	2.5	176.4	78	107		107.3%		LCS ✓ S ✓
m,p-Xylene	420	5	4.002	67	118		104.0%		
o-Xylene	221.7	2.5	3.372	78	107		109.2%		RPD ✓ S ✓
Toluene	216.8	2.5	5.65	74	116		105.6%		

Sample ID: 9802009-04AMSD	Batch ID: GC-1_980219	Test Code: SW8021A	Units: µg/L	Analysis Date: 2/19/98	Prep Date:				
Client ID: 9802004	Run ID: GC-1_980219A	PQL	SPK value	SeqNo: 298					
Analyte	Result	SPK	SPK Ref Val	LowLimit	HighLimit	RPD Ref Val	%REC	RPDLimit	Qual
Benzene	240.2	2.5	44.9	57	128	251.8	97.6%		4.7%
Ethylbenzene	368.8	2.5	176.4	78	107	391	96.2%		5.8%
m,p-Xylene	396.8	5	4.002	67	118	420	98.2%		5.7%
o-Xylene	210.4	2.5	3.372	78	107	221.7	103.5%		5.2%
Toluene	206.8	2.5	5.65	74	116	216.8	100.6%		4.7%

Qualifiers: ND - Not Detected at the Reporting Limit
 J - Analyte detected below quantitation limits

S - Spike Recovery outside accepted recovery limits
 R - RPD outside accepted recovery limits

B - Analyte detected in the associated Method Blank

On Site Technologies, LTD.

Date: 25-Feb-98

QC SUMMARY REPORT
Laboratory Control Spike - generic

CLIENT: PNM Gas Services
Work Order: 9802004
Project: Miles Federal IE

Sample ID: LCS WATER **Batch ID:** GC-1_980219 **Test Code:** SW8021A **Units:** µg/L **Analysis Date:** 2/19/98 **Prep Date:**
Client ID: 9802004 **Run ID:** GC-1_980219A **SeqNo:** 282

Analyte	Result	PQL	SPK value	SPK Ref Val	%REC	LowLimit	HighLimit	RPD Ref Val	%RPD	RPDLimit	Qual
Benzene	41.94	0.5	40	0.1628	104.4%	84	114				
Ethylbenzene	44.9	0.5	40	0	112.2%	86	118				
m,p-Xylene	85.5	1	80	0	106.9%	50	150				
o-Xylene	44.06	0.5	40	0	110.1%	49	147				
Toluene	43.16	0.5	40	0.0594	107.8%	87	120				

Qualifiers: ND - Not Detected at the Reporting Limit S - Spike Recovery outside accepted recovery limits B - Analyte detected in the associated Method Blank
J - Analyte detected below quantitation limits R - RPD outside accepted recovery limits

Date: 25-Feb-98

On Site Technologies, LTD.

QC SUMMARY REPORT

Continuing Calibration Verification Standard

CLIENT: PNM Gas Services
Work Order: 9802004
Project: Miles Federal 1E

Sample ID: CCV1 QC0529/30	Batch ID: GC-1_980219	Test Code: SW8021A	Units: µg/L	Analysis Date: 2/19/98	Prep Date:	
Client ID: 9802004	Run ID: GC-1_980219A	PQL	SPK value	SPK Ref Val	SeqNo: 281	
Analyte	Result	SPK	SPK	SPK	%RPD	
		value	value	Ref Val	RPDLimit	
					Qual	
Benzene	20.6	0.5	20	0	85	115
Ethylbenzene	22.11	0.5	20	0	85	115
m,p-Xylene	41.68	1	40	0	85	115
o-Xylene	21.6	0.5	20	0	85	115
Toluene	21.04	0.5	20	0	85	115
1,4-Difluorobenzene	101.1	0	100	0	70	130
4-Bromochlorobenzene	95.58	0	100	0	70	130
Fluorobenzene	99.14	0	100	0	70	130

Sample ID: CCV2 QC0529/30	Batch ID: GC-1_980219	Test Code: SW8021A	Units: µg/L	Analysis Date: 2/19/98	Prep Date:	
Client ID: 9802004	Run ID: GC-1_980219A	PQL	SPK value	SPK Ref Val	SeqNo: 292	
Analyte	Result	SPK	SPK	SPK	%RPD	
		value	value	Ref Val	RPDLimit	
					Qual	
Benzene	20.71	0.5	20	0	85	115
Ethylbenzene	22.06	0.5	20	0	85	115
m,p-Xylene	41.51	1	40	0	85	115
o-Xylene	21.67	0.5	20	0	85	115
Toluene	21.09	0.5	20	0	85	115
1,4-Difluorobenzene	101.4	0	100	0	70	130
4-Bromochlorobenzene	98.06	0	100	0	70	130
Fluorobenzene	99.28	0	100	0	70	130

Qualifiers: ND - Not Detected at the Reporting Limit
 J - Analyte detected below quantitation limits
 S - Spike Recovery outside accepted recovery limits
 R - RPD outside accepted recovery limits
 B - Analyte detected in the associated Method Blank

CLIENT: PNM Gas Services
 Work Order: 9802004
 Project: Miles Federal 1E

QC SUMMARY REPORT

Continuing Calibration Verification Standard

Sample ID: CCV3 QC0529/30 Batch ID: GC-1_980219 Test Code: SW8021A Units: µg/L Analysis Date: 2/19/98 Prep Date:

Client ID: 9802004 Run ID: GC-1_980219A SeqNo: 301

Analyte	Result	PQL	SPK value	SPK Ref Val	%REC	LowLimit	HighLimit	RPD Ref Val	%RPD	RPDLimit	Qual
Benzene	20.94	0.5	20	0	104.7%	85	115				
Ethylbenzene	22.56	0.5	20	0	112.8%	85	115				
m,p-Xylene	42.19	1	40	0	105.5%	85	115				
o-Xylene	22.05	0.5	20	0	110.3%	85	115				
Toluene	21.48	0.5	20	0	107.4%	85	115				
1,4-Difluorobenzene	107.3	0	100	0	101.3%	70	130				
4-Bromochlorobenzene	96.31	0	100	0	96.3%	70	130				
Fluorobenzene	98.88	0	100	0	98.9%	70	130				

Sample ID: CCV4 QC0529/30 Batch ID: GC-1_980219 Test Code: SW8021A Units: µg/L Analysis Date: 2/19/98 Prep Date:

Client ID: 9802004 Run ID: GC-1_980219A SeqNo: 304

Analyte	Result	PQL	SPK value	SPK Ref Val	%REC	LowLimit	HighLimit	RPD Ref Val	%RPD	RPDLimit	Qual
Benzene	20.16	0.5	20	0	100.8%	85	115				
Ethylbenzene	20.93	0.5	20	0	104.7%	85	115				
m,p-Xylene	39.5	1	40	0	98.7%	85	115				
o-Xylene	21.14	0.5	20	0	105.7%	85	115				
Toluene	20.81	0.5	20	0	104.1%	85	115				
1,4-Difluorobenzene	107.1	0	100	0	101.1%	70	130				
4-Bromochlorobenzene	96.32	0	100	0	96.3%	70	130				
Fluorobenzene	98.63	0	100	0	98.6%	70	130				

Qualifiers: ND - Not Detected at the Reporting Limit
 J - Analyte detected below quantitation limits
 S - Spike Recovery outside accepted recovery limits
 R - RPD outside accepted recovery limits
 B - Analyte detected in the associated Method Blank

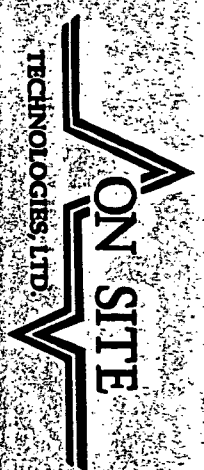

CHAIN OF CUSTODY RECORD

TECHNOLOGIES, LTD. 812 E. Murphy Dr. • P.O. Box 2606 • Farmington, NM 87499
 LAB: (505) 325-5687 • FAX: (505) 325-8258

Date: 1/21/78

Page: 1 of 1

7140

Purchase Order No.: _____ Job No.: _____

Name: Denver Bearden
 Company: PNM Gas Services
 Address: 603 W. Elm Street
 City, State, Zip: Farmington, NM 87401

Dept. 324-3763

REPORT RESULTS TO

Name: Maureen Gannon Title: _____
 Company: PNM Gas Services
 Mailing Address: Alvarado Square, Mail Stop 0408
 City, State, Zip: Albuquerque, NM 87158
 Telephone No.: 505-948-2974
 Telefax No.: _____

SEND INVOICE TO

ANALYSIS REQUESTED

Sampling Location: Miles Field

Sampler: R. D. Dick

SAMPLE IDENTIFICATION	SAMPLE		MATRIX	PRES.	Number of Containers	LAB ID
	DATE	TIME				
9802101408	1/19/78	1408	H2O	HC1	X	160104-015
9802101426	1/19/78	1426	H2O	HC1	X	-021
9802101444	1/19/78	1444	H2O	HC1	X	-021
9802101458	1/19/78	1458	H2O	HC1	X	-01A
9802101515	1/19/78	1515	H2O	HC1	X	-05A

Relinquished by: *R. D. Dick* Date/Time: 1/19/78 0805
 Received by: *Maureen Gannon* Date/Time: 1/19/78 0805

Relinquished by: _____ Date/Time: _____
 Received by: _____ Date/Time: _____

Method of Shipment: _____
 Rush: _____ 24 Hr Hours: _____
 10 Working Days
 Special Instructions: Results to be sent to both parties.

Authorized by: *R. D. Dick* Date: 1/19/78
 (Client Signature Must Accompany Request)

OFF: (505) 325-5667



LAB: (505) 325-1556

ANALYTICAL REPORT

Attn: *Denver Bearden*
 Company: *PNM Gas Services*
 Address: *603 W. Elm*
 City, State: *Farmington, NM 87401*

4th Quarter 1997

Date: *30-Dec-97*
 COC No.: *5634*
 Sample No.: *17105*
 Job No.: *2-1000*

Project Name: *PNM Gas Services - Miles Federal 1E*
 Project Location: *9712161259; MW-1*
 Sampled by: *RD* Date: *16-Dec-97* Time: *12:59*
 Analyzed by: *DC* Date: *24-Dec-97*
 Sample Matrix: *Liquid*

Parameter	Results as Received	Unit of Measure	Limit of Quantitation	Unit of Measure
<i>Benzene</i>	ND	ug/L	0.2	ug/L
<i>Toluene</i>	ND	ug/L	0.2	ug/L
<i>Ethylbenzene</i>	ND	ug/L	0.2	ug/L
<i>m,p-Xylene</i>	ND	ug/L	0.2	ug/L
<i>o-Xylene</i>	ND	ug/L	0.2	ug/L
<i>TOTAL</i>	ND	ug/L		

ND - Not Detected at Limit of Quantitation

Method - SW-846 EPA Method 8020A Aromatic Volatile Organics by Gas Chromatography

Approved By: *[Signature]*
 Date: *12/30/97*

P.O. BOX 2606 • FARMINGTON, NM 87499

- TECHNOLOGY BLENDING INDUSTRY WITH THE ENVIRONMENT -

OFF: (505) 325-5667



LAB: (505) 325-1556

ANALYTICAL REPORT

Attn: *Denver Bearden*
 Company: *PNM Gas Services*
 Address: *603 W. Elm*
 City, State: *Farmington, NM 87401*

Date: *30-Dec-97*
 COC No.: *5634*
 Sample No.: *17106*
 Job No.: *2-1000*

Project Name: *PNM Gas Services - Miles Federal 1E*
 Project Location: *9712161321; MW-2*
 Sampled by: *RD* Date: *16-Dec-97* Time: *13:21*
 Analyzed by: *DC* Date: *24-Dec-97*
 Sample Matrix: *Liquid*

Parameter	Results as Received	Unit of Measure	Limit of Quantitation	Unit of Measure
<i>Benzene</i>	<i>1.8</i>	<i>ug/L</i>	<i>0.2</i>	<i>ug/L</i>
<i>Toluene</i>	<i>5.1</i>	<i>ug/L</i>	<i>0.2</i>	<i>ug/L</i>
<i>Ethylbenzene</i>	<i>11.6</i>	<i>ug/L</i>	<i>0.2</i>	<i>ug/L</i>
<i>m,p-Xylene</i>	<i>2.8</i>	<i>ug/L</i>	<i>0.2</i>	<i>ug/L</i>
<i>o-Xylene</i>	<i>1.9</i>	<i>ug/L</i>	<i>0.2</i>	<i>ug/L</i>
<i>TOTAL</i>	<i>23.3</i>	<i>ug/L</i>		

ND - Not Detected at Limit of Quantitation

Method - SW-846 EPA Method 8020A Aromatic Volatile Organics by Gas Chromatography

Approved By: *[Signature]*
 Date: *12/30/97*

P.O. BOX 2606 • FARMINGTON, NM 87499

- TECHNOLOGY BLENDING INDUSTRY WITH THE ENVIRONMENT -

OFF: (505) 325-5667



LAB: (505) 325-1556

ANALYTICAL REPORT

Attn: *Denver Bearden*
 Company: *PNM Gas Services*
 Address: *603 W. Elm*
 City, State: *Farmington, NM 87401*

Date: *30-Dec-97*
 COC No.: *5634*
 Sample No.: *17107*
 Job No.: *2-1000*

Project Name: *PNM Gas Services - Miles Federal 1E*

Project Location: *9712161339; MW-3*

Sampled by: *RD* Date: *16-Dec-97* Time: *13:39*

Analyzed by: *DC* Date: *24-Dec-97*

Sample Matrix: *Liquid*

Parameter	Results as Received	Unit of Measure	Limit of Quantitation	Unit of Measure
<i>Benzene</i>	<i>0.2</i>	<i>ug/L</i>	<i>0.2</i>	<i>ug/L</i>
<i>Toluene</i>	<i>0.3</i>	<i>ug/L</i>	<i>0.2</i>	<i>ug/L</i>
<i>Ethylbenzene</i>	<i>1.4</i>	<i>ug/L</i>	<i>0.2</i>	<i>ug/L</i>
<i>m,p-Xylene</i>	<i>ND</i>	<i>ug/L</i>	<i>0.2</i>	<i>ug/L</i>
<i>o-Xylene</i>	<i>ND</i>	<i>ug/L</i>	<i>0.2</i>	<i>ug/L</i>
<i>TOTAL</i>	<i>1.9</i>	<i>ug/L</i>		

ND - Not Detected at Limit of Quantitation

Method - *SW-846 EPA Method 8020A Aromatic Volatile Organics by Gas Chromatography*

Approved By: *DAE*
 Date: *12/30/97*

P.O. BOX 2606 • FARMINGTON, NM 87499

- TECHNOLOGY BLENDING INDUSTRY WITH THE ENVIRONMENT -

OFF: (505) 325-5667



LAB: (505) 325-1556

ANALYTICAL REPORT

Attn: *Denver Bearden*
 Company: *PNM Gas Services*
 Address: *603 W. Elm*
 City, State: *Farmington, NM 87401*

Date: *30-Dec-97*
 COC No.: *5634*
 Sample No.: *17108*
 Job No.: *2-1000*

Project Name: *PNM Gas Services - Miles Federal 1E*
 Project Location: *9712161356; MW-4*
 Sampled by: *RD* Date: *16-Dec-97* Time: *13:56*
 Analyzed by: *DC* Date: *24-Dec-97*
 Sample Matrix: *Liquid*

Parameter	Results as Received	Unit of Measure	Limit of Quantitation	Unit of Measure
<i>Benzene</i>	ND	ug/L	0.2	ug/L
<i>Toluene</i>	ND	ug/L	0.2	ug/L
<i>Ethylbenzene</i>	ND	ug/L	0.2	ug/L
<i>m,p-Xylene</i>	ND	ug/L	0.2	ug/L
<i>o-Xylene</i>	ND	ug/L	0.2	ug/L
TOTAL	ND	ug/L		

ND - Not Detected at Limit of Quantitation

Method - *SW-846 EPA Method 8020A Aromatic Volatile Organics by Gas Chromatography*

Approved By: *[Signature]*
 Date: *12/30/97*

P.O. BOX 2606 • FARMINGTON, NM 87499

- TECHNOLOGY BLENDING INDUSTRY WITH THE ENVIRONMENT -

OFF: (505) 325-5667



LAB: (505) 325-1556

ANALYTICAL REPORT

Attn: *Denver Bearden*
 Company: *PNM Gas Services*
 Address: *603 W. Elm*
 City, State: *Farmington, NM 87401*

Date: *30-Dec-97*
 COC No.: *5634*
 Sample No.: *17109*
 Job No.: *2-1000*

*Duplicate
 of MW-3*

Project Name: *PNM Gas Services - Miles Federal 1E*
 Project Location: *9712161416; MW-5*
 Sampled by: *RD* Date: *16-Dec-97* Time: *14:16*
 Analyzed by: *DC* Date: *24-Dec-97*
 Sample Matrix: *Liquid*

Parameter	Results as Received	Unit of Measure	Limit of Quantitation	Unit of Measure
<i>Benzene</i>	<i>0.2</i>	<i>ug/L</i>	<i>0.2</i>	<i>ug/L</i>
<i>Toluene</i>	<i>0.3</i>	<i>ug/L</i>	<i>0.2</i>	<i>ug/L</i>
<i>Ethylbenzene</i>	<i>1.6</i>	<i>ug/L</i>	<i>0.2</i>	<i>ug/L</i>
<i>m,p-Xylene</i>	<i>ND</i>	<i>ug/L</i>	<i>0.2</i>	<i>ug/L</i>
<i>o-Xylene</i>	<i>ND</i>	<i>ug/L</i>	<i>0.2</i>	<i>ug/L</i>
<i>TOTAL</i>	<i>2.1</i>	<i>ug/L</i>		

ND - Not Detected at Limit of Quantitation

Method - SW-846 EPA Method 8020A Aromatic Volatile Organics by Gas Chromatography

Approved By: *[Signature]*
 Date: *12/30/97*



QUALITY ASSURANCE REPORT
for EPA Method 8020

Date Analyzed: 24-Dec-97

Internal QC No.: 0559-STD

Surrogate QC No.: 0567-STD

Reference Standard QC No.: 0529/30-QC

Method Blank

Parameter	Result	Unit of Measure
Average Amount of All Analytes In Blank	<0.2	ppb

Calibration Check

Parameter	Unit of Measure	True Value	Analyzed Value	RPD	Limit
Benzene	ppb	20.0	18.2	9	15%
Toluene	ppb	20.0	19.1	4	15%
Ethylbenzene	ppb	20.0	19.2	4	15%
m,p-Xylene	ppb	40.0	36.9	8	15%
o-Xylene	ppb	20.0	19.0	5	15%

Matrix Spike

Parameter	1 - Percent Recovered	2 - Percent Recovered	Limit	RPD	Limit
Benzene	101	88	(39-150)	6	20%
Toluene	100	94	(46-148)	6	20%
Ethylbenzene	100	93	(32-160)	6	20%
m,p-Xylene	97	90	(35-145)	6	20%
o-Xylene	99	93	(35-145)	6	20%

Surrogate Recoveries

Laboratory Identification	S1 Percent Recovered	S2 Percent Recovered	Laboratory Identification	S1 Percent Recovered	S2 Percent Recovered
Limit Percent Recovered	(70-130)		Limit Percent Recovered	(70-130)	
17105-5634	94				
17106-5634	93				
17107-5634	93				
17108-5634	94				
17109-5634	94				
				JHL 12/30/97	(PCE) 12/30/97

S1: Fluorobenzene

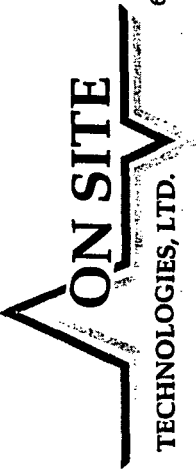

CHAIN OF CUSTODY RECORD

5634

Page 1 of 1

Date: 12/16/97

657 W. Maple • P. O. Box 2606 • Farmington NM 87499
 L.A.B: (505) 325-5667 • FAX: (505) 325-6256

SEND INVOICE TO

Name: **Denver Bearden**
 Company: **PNM Gas Services**
 Address: **603 W. Elm Street**
 City, State, Zip: **Farmington, NM 87401**

Job No. _____

Name: **Maureen Gannon**
 Company: **PNM Gas Services**
 Mailing Address: **Alverado Square, Mail Stop 0408**
 City, State, Zip: **Albuquerque, NM 87158**
 Telephone No.: **505-848-2974**
 Telefax No. _____

Title: _____

Sampling Location: Miles Fed. 1E

Sampler: R. Redrick

SAMPLE ID	DATE	TIME	MATRIX	PRES.	Number of Containers	ANALYSIS REQUESTED	LAB ID
9712161259	12/16/97	1259	H ₂ O	HCL	2	BTEX-CO20	17105-5634
9712161321	12/16/97	1321	H ₂ O	HCL	2		17106-
9712161339	12/16/97	1339	H ₂ O	HCL	2		17107-
9712161356	12/16/97	1356	H ₂ O	HCL	2		17108-
9712161416	12/16/97	1416	H ₂ O	HCL	2		17109-

Relinquished by: Ronald J. Redrick Date/Time: 12/16/97 1452

Relinquished by: _____ Date/Time: _____

Relinquished by: _____ Date/Time: _____

Method of Shipment: _____ Date: 12/16/97

Authorized by: Ronald J. Redrick (Client Signature Must Accompany Request)

Received by: [Signature] Date/Time: 12/16/97 1652

Received by: _____ Date/Time: _____

Received by: _____ Date/Time: _____

Rush: _____ 24-48 Hours _____ 10 Working Days _____

Special Instructions: **Results to be sent to both parties.**

Distribution: White - On Site Yellow - LAB Pink - Sampler Goldenrod - Client

OFF: (505) 325-5667



LAB: (505) 325-1556

ANALYTICAL REPORT

Attn: *Denver Bearden*
 Company: *PNM Gas Services*
 Address: *603 W. Elm*
 City, State: *Farmington, NM 87401*

Date: *2-Oct-97*
 COC No.: *5845*
 Sample No.: *16432*
 Job No.: *2-1000*

Project Name: *PNM Gas Services - Miles Federal 1E*

Project Location: *9709291030; MW-1*

Sampled by: *MS* Date: *29-Sep-97* Time: *10:30*

Analyzed by: *DC* Date: *1-Oct-97*

Sample Matrix: *Liquid*

Parameter	Results as Received	Unit of Measure	Limit of Quantitation	Unit of Measure
<i>Benzene</i>	ND	ug/L	0.2	ug/L
<i>Toluene</i>	ND	ug/L	0.2	ug/L
<i>Ethylbenzene</i>	ND	ug/L	0.2	ug/L
<i>m,p-Xylene</i>	0.3	ug/L	0.2	ug/L
<i>o-Xylene</i>	ND	ug/L	0.2	ug/L
<i>TOTAL</i>	0.3	ug/L		

ND - Not Detected at Limit of Quantitation

Method - *SW-846 EPA Method 8020A Aromatic Volatile Organics by Gas Chromatography*

Approved By: *[Signature]*
 Date: *10/2/97*

P.O. BOX 2606 • FARMINGTON, NM 87499

OFF: (505) 325-5667



LAB: (505) 325-1556

ANALYTICAL REPORT

Attn: *Denver Bearden*
 Company: *PNM Gas Services*
 Address: *603 W. Elm*
 City, State: *Farmington, NM 87401*

Date: *2-Oct-97*
 COC No.: *5845*
 Sample No.: *16433*
 Job No.: *2-1000*

Project Name: *PNM Gas Services - Miles Federal 1E*

Project Location: *9709291100; MW-2*

Sampled by: *MS* Date: *29-Sep-97* Time: *11:00*

Analyzed by: *DC* Date: *1-Oct-97*

Sample Matrix: *Liquid*

Parameter	Results as Received	Unit of Measure	Limit of Quantitation	Unit of Measure
<i>Benzene</i>	<i>56.1</i>	<i>ug/L</i>	<i>0.2</i>	<i>ug/L</i>
<i>Toluene</i>	<i>5.5</i>	<i>ug/L</i>	<i>0.2</i>	<i>ug/L</i>
<i>Ethylbenzene</i>	<i>48.4</i>	<i>ug/L</i>	<i>0.2</i>	<i>ug/L</i>
<i>m,p-Xylene</i>	<i>25.4</i>	<i>ug/L</i>	<i>0.2</i>	<i>ug/L</i>
<i>o-Xylene</i>	<i>1.0</i>	<i>ug/L</i>	<i>0.2</i>	<i>ug/L</i>
<i>TOTAL</i>	<i>136.4</i>	<i>ug/L</i>		

ND - Not Detected at Limit of Quantitation

Method - SW-846 EPA Method 8020A Aromatic Volatile Organics by Gas Chromatography

Approved By: *[Signature]*
 Date: *10/2/97*

P.O. BOX 2606 • FARMINGTON, NM 87499

OFF: (505) 325-5667



LAB: (505) 325-1556

ANALYTICAL REPORT

Attn: *Denver Bearden*
 Company: *PNM Gas Services*
 Address: *603 W. Elm*
 City, State: *Farmington, NM 87401*

Date: *14-Oct-97*
 COC No.: *5845*
 Sample ID.: *16433*
 Job No.: *2-1000*

Project Name: *PNM Gas Services - Miles Federal 1E*
 Project Location: *9709291100; MW-2*

Sampled by: *MS* Date: *29-Sep-97* Time: *11:00*
 Analyzed by: *HR* Date: *10-Oct-97*

Laboratory Analysis

Parameter	Results as Received	Unit of Measure	Results as Received	Unit of Measure
<u>Cations</u>				
Sodium <i>Na</i>	842	mg/L	36.62	me/L
Calcium <i>Ca</i>	381	mg/L	19.01	me/L
Magnesium <i>Mg</i>	63.2	mg/L	5.20	me/L
Potassium <i>K</i>	14.1	mg/L	0.36	me/L
<u>Anions</u>				
Chloride <i>Cl</i>	172	mg/L	4.85	me/L
Sulfate <i>SO4</i>	2214	mg/L	46.09	me/L
Carbonate <i>CO3 as CaCO3</i>	<1	mg/L	<0.01	me/L
Bicarbonate <i>HCO3 as CaCO3</i>	1216	mg/L	19.93	me/L
Hydroxide <i>OH as CaCO3</i>	<1	mg/L	<0.01	me/L
<u>Total Dissolved Solids</u>				
Calculated, Sum of Cation/Anion	4902	mg/L	<u>Cation-Anion Balance</u> 9.68 <i>Difference Cation-Anion, me/L</i> 132.07 <i>Total Cation-Anion, me/L</i> 7.3 <i>% Difference Cation-Anion</i>	
Total Dissolved Solids Dried @ 180 C	4518	mg/L		
pH	6.80			
Conductivity @ 25 C	5110	uS/cm		
Total Hardness as CaCO3	1212	mg/L	<u>Comments</u>	

Approved by: *JAC*
 Date: *10/15/97*

OFF: (505) 325-5667



LAB: (505) 325-1556

ANALYTICAL REPORT

Attn: *Denver Bearden*
 Company: *PNM Gas Services*
 Address: *603 W. Elm*
 City, State: *Farmington, NM 87401*

Date: *2-Oct-97*
 COC No.: *5845*
 Sample No.: *16434*
 Job No.: *2-1000*

Project Name: *PNM Gas Services - Miles Federal 1E*

Project Location: *9709291130; MW-3*

Sampled by: *MS* Date: *29-Sep-97* Time: *11:30*

Analyzed by: *DC* Date: *1-Oct-97*

Sample Matrix: *Liquid*

Parameter	Results as Received	Unit of Measure	Limit of Quantitation	Unit of Measure
<i>Benzene</i>	<i>0.4</i>	<i>ug/L</i>	<i>0.2</i>	<i>ug/L</i>
<i>Toluene</i>	<i>0.4</i>	<i>ug/L</i>	<i>0.2</i>	<i>ug/L</i>
<i>Ethylbenzene</i>	<i>2.7</i>	<i>ug/L</i>	<i>0.2</i>	<i>ug/L</i>
<i>m,p-Xylene</i>	<i>0.3</i>	<i>ug/L</i>	<i>0.2</i>	<i>ug/L</i>
<i>o-Xylene</i>	<i>ND</i>	<i>ug/L</i>	<i>0.2</i>	<i>ug/L</i>
<i>TOTAL</i>	<i>3.8</i>	<i>ug/L</i>		

ND - Not Detected at Limit of Quantitation

Method - *SW-846 EPA Method 8020A Aromatic Volatile Organics by Gas Chromatography*

Approved By: *[Signature]*
 Date: *10/2/97*

P.O. BOX 2606 • FARMINGTON, NM 87499

OFF: (505) 325-5667



LAB: (505) 325-1556

ANALYTICAL REPORT

Attn: *Denver Bearden*
 Company: *PNM Gas Services*
 Address: *603 W. Elm*
 City, State: *Farmington, NM 87401*

Date: *2-Oct-97*
 COC No.: *5845*
 Sample No.: *16435*
 Job No.: *2-1000*

Project Name: *PNM Gas Services - Miles Federal 1E*
 Project Location: *9709291200; MW-4*
 Sampled by: *MS* Date: *29-Sep-97* Time: *12:00*
 Analyzed by: *DC* Date: *1-Oct-97*
 Sample Matrix: *Liquid*

Parameter	Results as Received	Unit of Measure	Limit of Quantitation	Unit of Measure
<i>Benzene</i>	ND	ug/L	0.2	ug/L
<i>Toluene</i>	ND	ug/L	0.2	ug/L
<i>Ethylbenzene</i>	ND	ug/L	0.2	ug/L
<i>m,p-Xylene</i>	ND	ug/L	0.2	ug/L
<i>o-Xylene</i>	ND	ug/L	0.2	ug/L
<i>TOTAL</i>	ND	ug/L		

ND - Not Detected at Limit of Quantitation

Method - SW-846 EPA Method 8020A Aromatic Volatile Organics by Gas Chromatography

Approved By: *[Signature]*
 Date: *10/2/97*

P.O. BOX 2606 • FARMINGTON, NM 87499

TECHNOLOGICAL SERVICES INDUSTRIES WITH THE ENVIRONMENT

OFF: (505) 325-5667



LAB: (505) 325-1556

ANALYTICAL REPORT

Attn: *Denver Bearden*
 Company: *PNM Gas Services*
 Address: *603 W. Elm*
 City, State: *Farmington, NM 87401*

Date: *2-Oct-97*
 COC No.: *5845*
 Sample No.: *16436*
 Job No.: *2-1000*

Project Name: *PNM Gas Services - Miles Federal 1E*

Project Location: *9709291230; MW-5*

Sampled by: *MS* Date: *29-Sep-97* Time: *12:30*

Analyzed by: *DC* Date: *1-Oct-97*

Sample Matrix: *Liquid*

Parameter	Results as Received	Unit of Measure	Limit of Quantitation	Unit of Measure
<i>Benzene</i>	<i>58.7</i>	<i>ug/L</i>	<i>0.2</i>	<i>ug/L</i>
<i>Toluene</i>	<i>6.3</i>	<i>ug/L</i>	<i>0.2</i>	<i>ug/L</i>
<i>Ethylbenzene</i>	<i>49.4</i>	<i>ug/L</i>	<i>0.2</i>	<i>ug/L</i>
<i>m,p-Xylene</i>	<i>25.6</i>	<i>ug/L</i>	<i>0.2</i>	<i>ug/L</i>
<i>o-Xylene</i>	<i>1.0</i>	<i>ug/L</i>	<i>0.2</i>	<i>ug/L</i>
<i>TOTAL</i>	<i>140.9</i>	<i>ug/L</i>		

ND - Not Detected at Limit of Quantitation

Method - SW-846 EPA Method 8020A Aromatic Volatile Organics by Gas Chromatography

Approved By: *DGC*
 Date: *10/2/97*

P.O. BOX 2606 • FARMINGTON, NM 87499

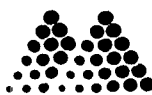

Mountain States Analytical, Inc.

The Quality Solution

On Site Technologies, Ltd.
612 E Murray Drive
Farmington, NM 87401

Attn: Mr. David Cox
Project: Miles Federal IE/~~Drp~~

Sample ID: 16433-5845 (Dissolved) *MW2*
Matrix: Waste Water

MSAI Sample: 69113
MSAI Group: 18095
Date Reported: 10/23/97
Discard Date: 11/22/97
Date Submitted: 10/01/97
Date Sampled: 09/29/97
Collected by: DC
Purchase Order: 5845
Project No.:

Test Analysis	Results as Received	Units	Method Detection Limit
0259B Mercury by CVAA, w/ww, 7470 Method: SW-846 7470	ND	mg/l	0.0001
0392I Flame/ICP Prep, w/ww, 3005A Method: SW-846 3005A	W 0		
0392M Mercury Prep CVAA, w/ww, 7470 Method: SW-846 7470	W 719		
0401 Prep for HAA, w/ww, 7062/7742 Method: SW-846 7062/7742	W 0		
1451 Selenium by HAA, w/ww, 7742 Method: SW-846 7742	0.004	mg/l	0.002
7245 Arsenic by ICP, w/ww, 6010A Method: SW-846 6010A	ND	mg/l	0.030
7246 Barium by ICP, w/ww, 6010A Method: SW-846 6010A	0.129	mg/l	0.003
7249 Cadmium by ICP, w/ww, 6010A Method: SW-846 6010A	ND	mg/l	0.004
7251 Chromium by ICP, w/ww, 6010A Method: SW-846 6010A	ND	mg/l	0.010
7255 Lead by ICP, w/ww, 6010A Method: SW-846 6010A	0.134	mg/l	0.040
7266 Silver by ICP, w/ww, 6010A Method: SW-846 6010A	ND	mg/l	0.006

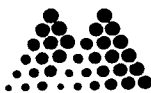

Mountain States Analytical, Inc.

The Quality Solution

Page 2

On Site Technologies, Ltd.

Sample ID: 16433-5845 (Dissolved)

MSAI Sample: 69113

MSAI Group: 18095

Test	Analysis	Results as Received	Units	Method Detection Limit
0939	Sample Filtering, ww, MSAI Method: IN HOUSE MSAI	Complete		

This report consists of the following items: A cover letter, a signed analytical report for each sample specified on the cover letter, and if applicable, an inorganic quality control summary. Organic sample reports contain footnotes which describe any quality control anomalies which may have occurred.

Respectfully Submitted,
Reviewed and Approved by:

Rolf E. Larsen
Project Manager