

District I
1625 N. French Dr., Hobbs, NM 88240
District II
1301 W. Grand Avenue, Artesia, NM 88210
District III
1000 Rio Brazos Road, Aztec, NM 87410
District IV
1220 S. St. Francis Dr., Santa Fe, NM 87505

State of New Mexico
Energy Minerals and Natural Resources

Form C-144
June 1, 2004

Oil Conservation Division
1220 South St. Francis Dr.
Santa Fe, NM 87505

For drilling and production facilities, submit to
appropriate NMOCD District Office.
For downstream facilities, submit to Santa Fe
office

Pit or Below-Grade Tank Registration or Closure

Is pit or below-grade tank covered by a "general plan"? Yes ☐ No ☒

Type of action: Registration of a pit or below-grade tank ☐ Closure of a pit or below-grade tank ☐

Operator: BTA Oil Producers, LLC

Telephone: 432-682-3753

e-mail address: sbaca@btaoil.com

Address: _____

Facility or well name: Young 8709 JV-P #1 API #: 30-025-3005 U/L or Qtr/Qtr: 660 FNL, 330 FEL Sec 11 T 18S R 32E

County: Lea Latitude N 32° 46.057 Longitude W 103° 43.796 NAD: 1927 ☒ 1983 ☐

Surface Owner: Federal ☒ State ☐ Private ☐ Indian ☐

Pit

Type: Drilling ☒ Production ☐ Disposal ☐

Workover ☐ Emergency ☐

Lined ☐ Unlined ☐

Liner type: Synthetic ☐ Thickness _____ mil Clay ☐

Pit Volume 25,646 bbl

Below-grade tank

Volume: _____ bbl Type of fluid: _____

Construction material: _____

Double-walled, with leak detection? Yes ☐ If not, explain why not. _____

Depth to ground water (vertical distance from bottom of pit to seasonal high water elevation of ground water.) 100+

Less than 50 feet ☐

50 feet or more, but less than 100 feet ☐

100 feet or more ☒

(20 points) ☐

(10 points) ☐

(0 points) ☒

Wellhead protection area: (Less than 200 feet from a private domestic water source, or less than 1000 feet from all other water sources.)

Yes ☐

No ☒

(20 points) ☐

(0 points) ☒

Distance to surface water: (horizontal distance to all wetlands, playas, irrigation canals, ditches, and perennial and ephemeral watercourses.)

Less than 200 feet ☐

200 feet or more, but less than 1000 feet ☐

1000 feet or more ☒

(20 points) ☐

(10 points) ☐

(0 points) ☒

Ranking Score (Total Points)

0

If this is a pit closure: (1) Attach a diagram of the facility showing the pit's relationship to other equipment and tanks. (2) Indicate disposal location: (check the onsite box if you are burying in place) onsite ☐ offsite ☐ If offsite, name of facility _____. (3) Attach a general description of remedial action taken including remediation start date and end date. (4) Groundwater encountered: No ☒ Yes ☐ If yes, show depth below ground surface _____ ft. and attach sample results. (5) Attach soil sample results and a diagram of sample locations and excavations.

Additional Comments: We would clean and remove debris from the surface of the reserve pit and disk the surface. We would then seed the area with BLM seed mixtures two (2) and three (3) for sandy soils. The entire reserve pit area would be dragged in order to cover the seed as much seed as possible. Seed will lay dormant through the winter months receiving nourishment from precipitation and natural fertilizers. Dragging would also hide the seed from birds that would use it as a food source. A copy of the plan is attached to this form along with a site map, depicting the pit and its relation to the oil well and the heater/treater.

I hereby certify that the information above is true and complete to the best of my knowledge and belief. I further certify that the above-described pit or below-grade tank has been/will be constructed or closed according to NMOCD guidelines ☐, a general permit ☐, or an (attached) alternative OCD-approved plan ☐.

Date: 2/5/08

Printed Name/Title J. A. BACA

Signature [Signature]

Your certification and NMOCD approval of this application/closure does not relieve the operator of liability should the contents of the pit or tank contaminate ground water or otherwise endanger public health or the environment. Nor does it relieve the operator of its responsibility for compliance with any other federal, state, or local laws and/or regulations.

Approval:

Printed Name/Title _____

Signature _____

Date: _____



PIT CLOSURE REPORT

**8709 JV-P Young #1 Reserve Pit (NMNM69371)
19 Miles West of Eunice, New Mexico
NW/NE, Section 11, T18S, R32E
Lea County, New Mexico
BTA Project Number: Env. 2008-024
BLM Reference # 08-JKB-110**

Prepared for:
**United States Department of the Interior
Bureau of Land Management
Carlsbad Field Office
620 E. Greene St.
Carlsbad, New Mexico 88220-6292**

Prepared by:
**BTA Oil Producers
104 S. Pecos
Midland, Texas 79701**

April 2008

Joseph A. Baca, P.G.
Environmental Coordinator
BTA Oil Producers

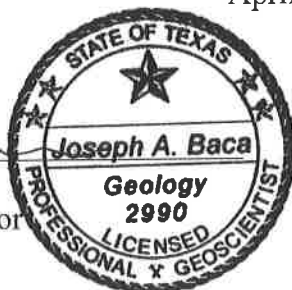

TABLE OF CONTENTS

1.0	INTRODUCTION	1
1.1	Purpose of Report	1
2.0	SUMMARY OF FIELD CTIVITIES	1
2.1	Surface Preparations, Seeding and Back Dragging	1
2.2	Surface Reclamation.....	1
3.0	SUMMARY AND REQUEST FOR CLOSURE	1
4.0	LIMITATIONS.....	2
5.0	DISTRIBUTION LIST	3

ATTACHMENTS

FIGURES

- Figure 1: Site Location Map
Figure 2: Site Details Map with Confirmation Soil Sample Locations

TABLES

- Table 1 Collected Samples Analysis

APPENDICES

- Appendix A: BLM Letter of Inspection
Appendix B: BLM Letter of Reclamation Plan Approval
Appendix C: Laboratory Analytical Results

1.0 INTRODUCTION

BTA Oil Producers (BTA) is pleased to submit this Pit Closure Report (PCR) for the BTA Young 8709 JV-P #1 (Young) reserve pit and surface reclamation. The Young (Project No. Env. 2008-024) site is located in Lea County approximately 30 miles west and 3.5 south of NM 529 west of Eunice, New Mexico. The GPS coordinates are N 32° 46.057' and W 103° 43.796'. A Site Location Map is provided as FIGURE 1.

According to a letter dated January 15, 2008 (Appendix A), The United States Department of the Interior, Bureau of Land Management, Carlsbad Field Office, Carlsbad, New Mexico (BLM) performed an inspection of the BTA Young #1 production facility sight on January 10, 2008. It was found that the pit area failed to grow adequate desirable vegetation. The BLM requested that BTA prepare a reclamation plan and submit it to the BLM. The plan was submitted on February 11, 2008 and was approved by the BLM on March 5, 2008 (Appendix B).

1.1 Purpose of Report

The purpose of this report is to document reclamation activities at the Young #1 site for the BLM in accordance with the Reclamation Plan dated February 11, 2008 written by BTA and approved by the BLM March 5, 2008.

2.0 SUMMARY OF FIELD ACTIVITIES

2.1 Surface Preparations, Seeding and Back Dragging

On February 22, 2008 samples were collected from the reserve pit at the request of the BLM to make sure that no chloride had impacted the reserve pit area (Figure 2). The samples were submitted to a laboratory for chloride analysis (Appendix C). The results of the chloride analysis were submitted to the BLM as proof that the chloride levels in the reserve pit were below state regulatory limits. The reclamation plan was approved and reclamation activities could begin (Table 1). BTA mobilized equipment to the site on April 2, 2008 and began reclamation activities. Field activities included the removal of debris and completely cleaning the surface of trash. The crew set the disk at approximately 6-inches and the surface was disked. Following the disking, BLM Blend #2 (NM#2) and #3 (NM#3) were mechanically broad cast. A chain devise pulled behind a tractor was used to back drag the seeded soil of the reserve pit. A site detail map displaying the extents of the reclamation project reclamation limits and other site details is included with this report (Figure 2).

2.2 Surface Reclamation

Based on reclamation activities of the affected area it was restored to as near its original condition as possible.

3.0 SUMMARY AND REQUEST FOR CLOSURE

Based on the reclamation activities associated with this project and restoration of natural seeds, no further action is recommended or planned for the site at this time. BTA requests that the BLM grant closure to the BTA Young 8709 JV-P #1 remediation site.

4.0 LIMITATIONS

BTA has prepared this Site Closure Report to the best of its ability. No other warranty, expressed or implied, is made or intended. BTA has examined and relied upon documents referenced in the report and on oral statements made by certain individuals. BTA has not conducted an independent examination of the facts contained in referenced materials and statements. We have presumed the genuineness of the documents and that the information provided in documents or statements is true and accurate. BTA has prepared this report in a professional manner, using a degree of skill and care. BTA also notes that the facts and conditions referenced in this report may change over time and the conclusions and recommendations set forth herein are applicable only to the facts and conditions as described at the time of this report.

This report has been prepared by BTA. The information contained in this report including all exhibits and attachments may not be used by any other party without the express written consent of BTA.



**DRAWING NOT
TO SCALE**

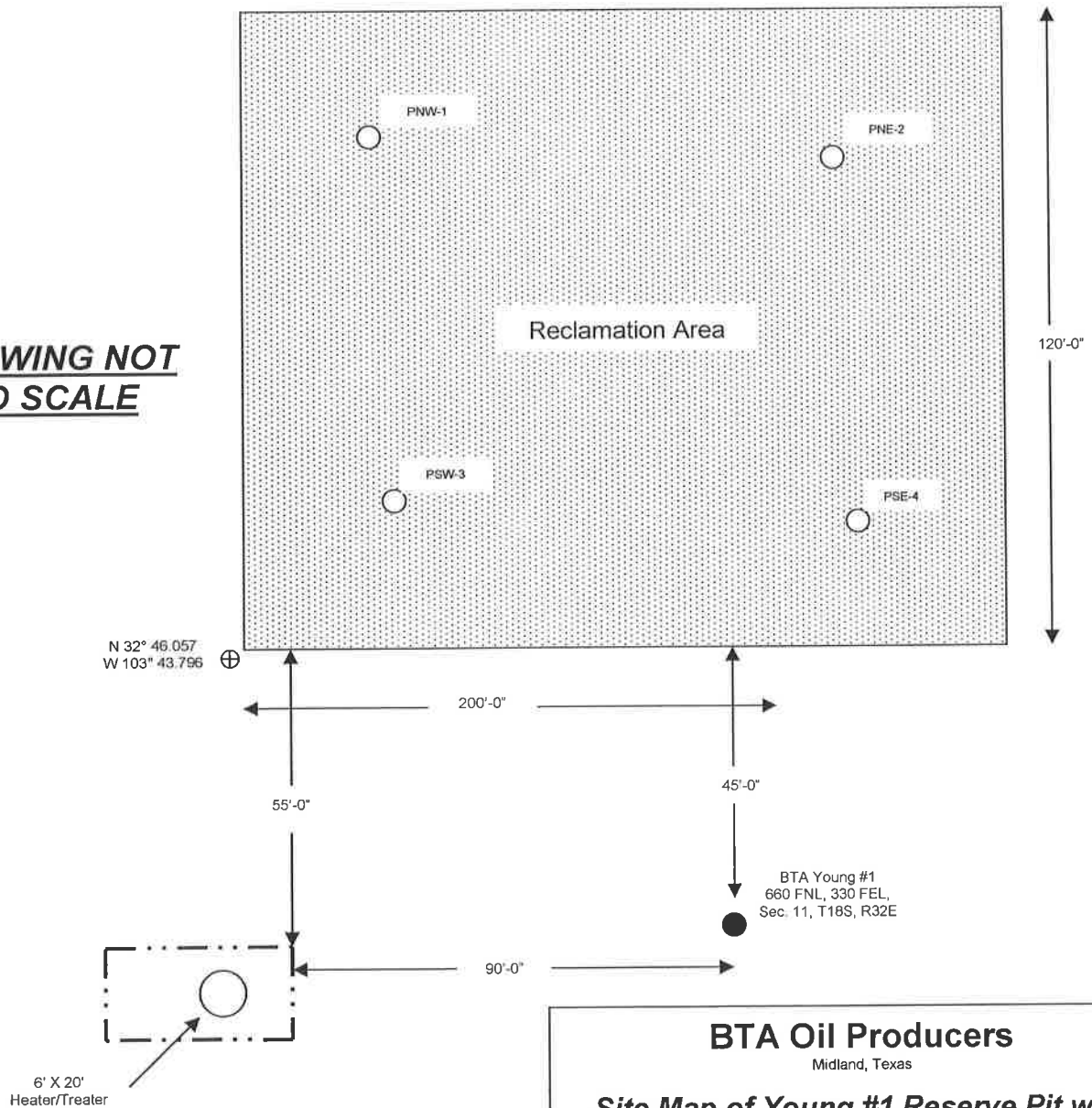

BTA Oil Producers
Midland, Texas

**Site Map of Young #1 Reserve Pit with
Sample Locations**
(Figure 2)

NE/NE, Section 11, T18S, R32E,
Lea County, New Mexico

Date: 02/04/2008
Drawn by: JAB

Scale: None
Checked by: JAB