



PO Box 1120
Carlsbad, New Mexico 88221
Phone (575) 236-6600

August 19, 2020

NMOCD District 2
Mr. Robert Hamlet
811 S. First Street
Artesia, New Mexico 88210

Dear Mr. Hamlet:

M&M Excavating, Inc. (MMX) has prepared this Remediation Closure Report for Devon Energy Production Company that describes the remediation of a release of liquids at the Cactus State #009. site. The site is in Unit O, Section 16, Township 21S, Range 26E, Latitude 32.4750443, Longitude -104.2966919, Eddy County, New Mexico, on State land. Figure 1 provides the vicinity and site location on an USGS 7.5-minute quadrangle map.

Site Information and Closure Criteria

The Cactus State #009. is located approximately six (6) miles north west of Carlsbad, New Mexico on State land at an elevation of approximately 3,293 feet above mean sea level (amsl).

Based upon well water data. (Appendix B), depth to groundwater in the area is estimated to be 150 feet below grade surface (bgs). There are no known water wells within ½ mile of the location, according to the New Mexico Office of the State Engineer (NMOSE) and USGS. The nearest significant watercourse is an unnamed draw located approximately 1,200 feet to the south.

The site is in an area identified as high karst and has therefor been remediated to the applicable NMOCD Closure Criteria for groundwater less than 50 feet bgs. The site has been restored to meet the standards of Table I of 19.15.29.12 NMAC.

Table 2 demonstrates the Closure Criteria applicable to this location. Pertinent well data is attached in Appendix B.

Release Information and Closure Criteria			
Name	Cactus State #009		
API Number	30-015-28496		
Incident Number	2RP-5369		
Source of Release	Frac tank Hauler		
Released Material	Produced Water	Released Volume	15 BBLS
Recovered Volume	0 BBLS	Net Release	15BBLS
NMOCD Closure Criteria	<50 feet to groundwater		

Release Information

On January 23, 2019, a release was discovered at the Cactus State #009 site due to a frac tank hauler releasing fluids from a water tank onto location and adjacent pasture. Initial response activities were conducted by the operator and included source elimination and site containment. Figure 1 illustrates the vicinity and site location. Figure 2 illustrates the release location. The C-141 form is included in Appendix A.

Release Characterization and Remediation Activities

On January 24, 2019, MMX personnel arrived on site in response to the release associated with Cactus State #009. MMX collected initial soil samples around the release site and throughout the visibly stained area. A total of seven (7) samples (S1-S7), were collected for laboratory analysis for total chloride using EPA Method 300.0; benzene, toluene, ethylbenzene and total xylenes (BTEX) using EPA Method 8021B; and motor, diesel and gasoline range organics (MRO, DRO, and GRO) by EPA Method 8015D.

As summarized in Table 3, TPH and chloride results exceeded Closure Criteria. MMX proceeded to excavate the identified impacted area.

On February 6, 2019, MMX collected confirmation samples of the walls and base of the excavation. Confirmation samples (S1-S7) were comprised of five-point composites. A total of seven (7) samples were collected for laboratory analysis using the methods listed above. Samples were placed into laboratory supplied glassware, labeled, and maintained on ice until delivery to Cardinal Laboratories in Hobbs, New Mexico (Appendix C).

Samples (S1-S7) exceeded Closure Criteria for TPH. MMX returned to site on May 31, 2019 to continue excavation, sample (S4) was excavated down to five (5) feet bgs. Sample locations (S1-S3 & S5-S7) were excavated down to one-foot bgs.

Confirmation samples (S1-S3 & S5-S7) were collected at one (1) foot and confirmation sample (S4) was collected at five (5) feet. Samples were analyzed using the methods listed above. Figure 3 shows the final extent of the excavation and sample locations.

On July 16, 2020, sidewall confirmation samples of the pre-existing release area were collected to confirm lateral migration did not occur. Confirmation Samples (SW1-SW8) was collected and analyzed for total chloride using EPA Method 300.0; benzene, toluene, ethylbenzene and total xylenes (BTEX) using EPA Method 8021B; and motor, diesel and gasoline range organics (MRO, DRO, and GRO) by EPA Method 8015D.

Final Laboratory results are summarized in Table 3. All Laboratory reports are included in Appendix C.

Contaminated soils were removed and replaced with clean backfill material to return the surface to previous contours. The contaminated soil was transported and

disposed of at an NMOCD permitted disposal facility. Georeferenced photos are included in Appendix D.

On behalf of Devon Energy, MMX requests closure for the release associated with 2RP-5369.

Submitted by:
M&M Excavating, Inc.

Lupe Carrasco

Lupe Carrasco

ATTACHMENTS:

Figures:

Figure 1: Vicinity and Well Head Protection Map

Figure 2: Surface Water Radius Map

Figure 3: Site and Sample Location Map

Tables:

Table 2: NMOCD Closure Criteria Justification

Table 3: Summary of Sample Results

Appendices:

Appendix A: Form C-141

Appendix B: Water Well Data

Appendix C: Laboratory Analytical Reports

Appendix D: Photo Log & Manifest

Figures



M & M EXCAVATING, INC.

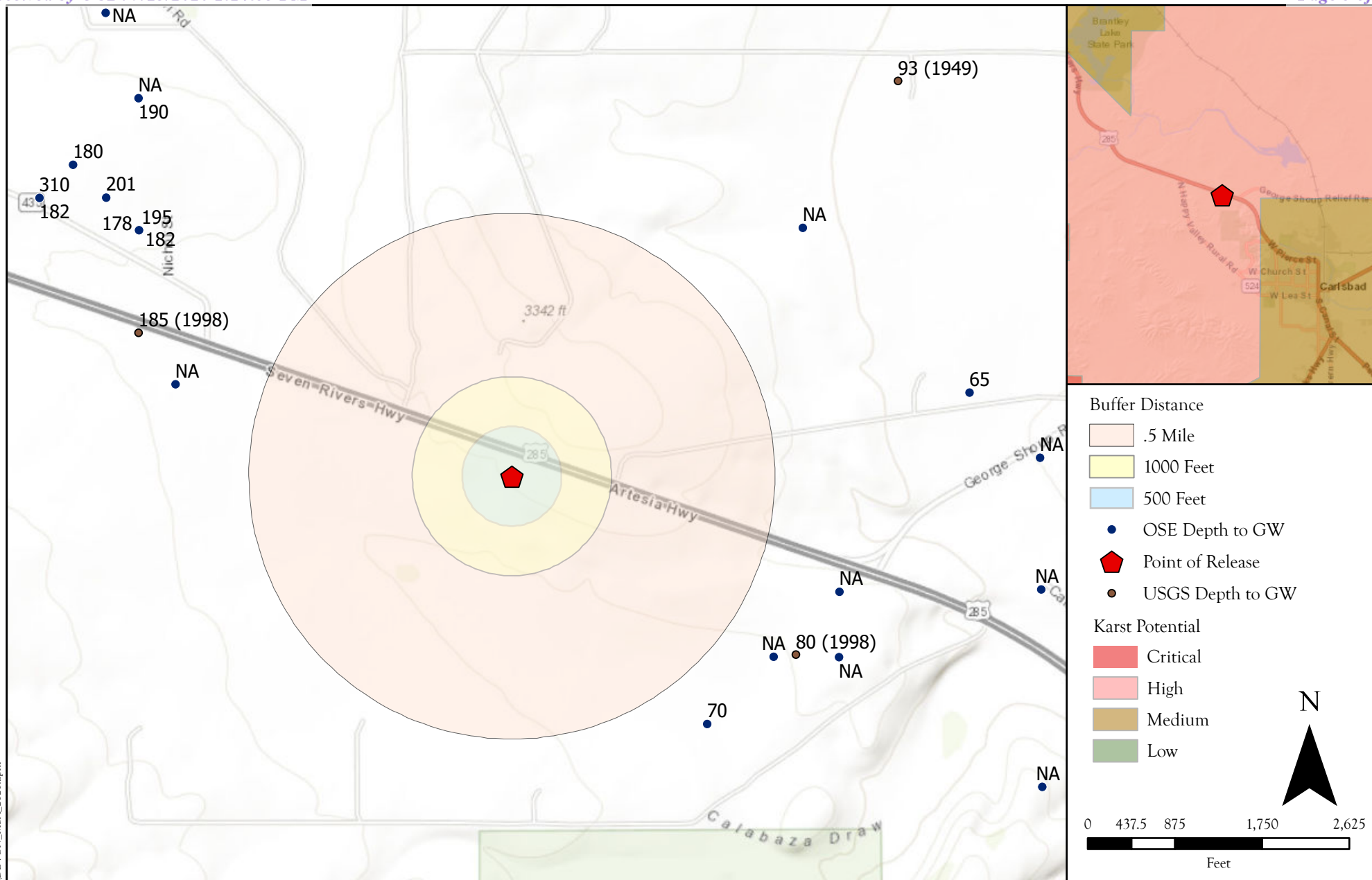

Site Map
Cactus State #009- Devon Energy Production Company
32.20931, -103.70375, Lea County, New Mexico

Figure 1

Revisions

By: _____ Date: _____ Descr: _____

By: _____ Date: _____ Descr: _____

Drawn
Date
Checked
Approved

Sebastian Orozco
8/19/2020



201 South Halaguena Street
Carlsbad, New Mexico 88221
(575) 689-7040
Serving the Southwest & Rocky Mountains

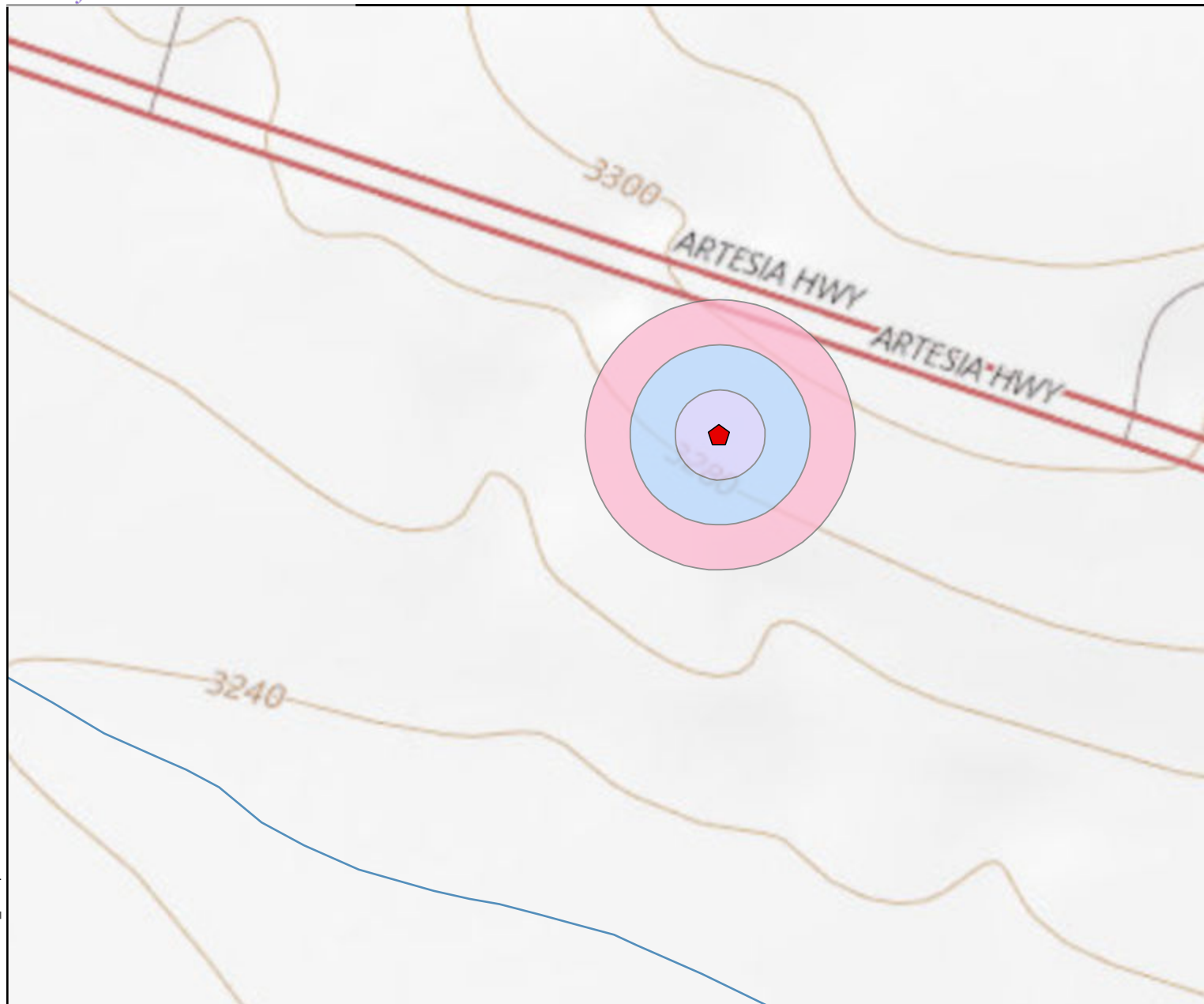

- Point of Release
 - Springs Seeps
 - Streams Canals
 - Rivers
 - NM Wetlands
 - Lakes Playas
 - FEMA Flood Zones 2011
- Buffer Distance**
- 100 Feet
 - 200 Feet
 - 300 Feet
 - Release Area

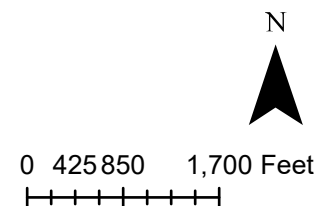

Surface Water Protection Map
Cactus State #9 - Devon Energy
Sec 16 T21S R26E Eddy County, New Mexico

Figure 2

P:\5-MM Excavating (5128335)\GIS\ARCGIS\MMX_MIT.aprx

Date Saved:
5/27/2019

Revisions		
By: _____	Date: _____	Descr: _____
By: _____	Date: _____	Descr: _____

Copyright 2019 M&M Excavating, Inc.- All Rights Reserved

Drawn	LC
Date	<u>5/27/2019</u>
Checked	_____
Approved	_____



78 Roberson Rd
Carlsbad, NM 88220
(575) 236-6600

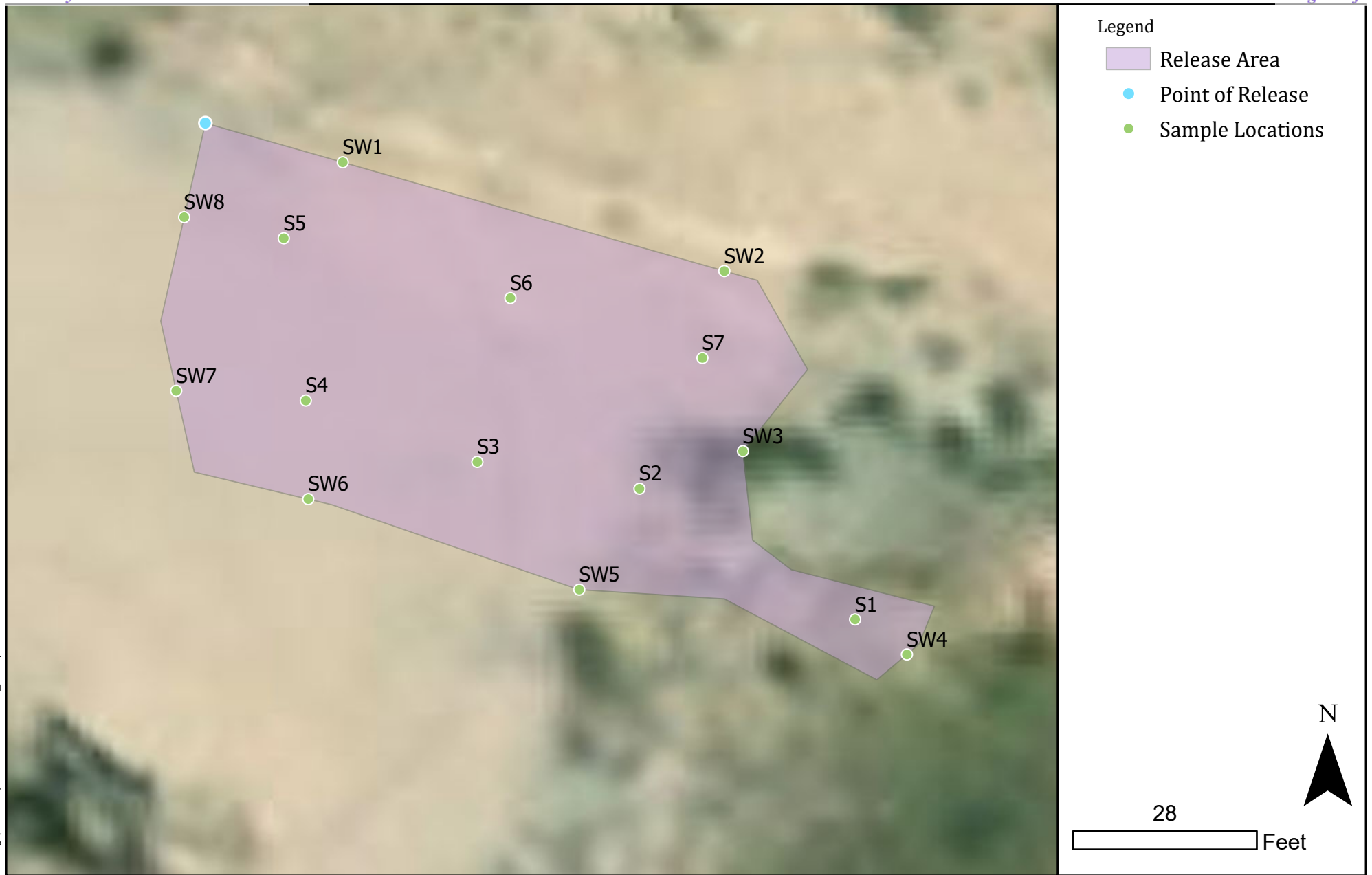

Site & Sample Locations
 Cactus State #9 - Devon Energy
 Sec 16 T21S R26E Eddy County, New Mexico

Figure 3

Revisions

By:	Date:	Descr:

Copyright 2019 M&M Excavating, Inc. - All Rights Reserved

Drawn _____
 Date 8/17/2020
 Checked _____
 Approved _____



78 Roberson Rd
 Carlsbad, NM 88220
 (575) 236-6600

Tables

Table 2:
NMOCD Closure Criteria

Devon Energy
Cactus State #009

Site Information (19.15.29.11.A(2, 3, and 4) NMAC)		Source/Notes
Depth to Groundwater (feet bgs)	<50	NMOSE & USGS
Horizontal Distance From All Water Sources Within 1/2 Mile (ft)	N/A	-
Horizontal Distance to Nearest Significant Watercourse (ft)	1200	Unnamed Draw

Closure Criteria (19.15.29.12.B(4) and Table 1 NMAC)						
Depth to Groundwater		Closure Criteria (units in mg/kg)				
		Chloride *numerical limit or background, whichever is greater	TPH	GRO + DRO	BTEX	Benzene
< 50' BGS	X	600	100		50	10
51' to 100'		10000	2500	1000	50	10
>100'		20000	2500	1000	50	10
Surface Water	yes or no	if yes, then				
<300' from continuously flowing watercourse or other significant watercourse?	No	600	100		50	10
<200' from lakebed, sinkhole or playa lake?	No					
Water Well or Water Source						
<500 feet from spring or a private, domestic fresh water well used by less than 5 households for domestic or stock watering purposes?	No					
<1000' from fresh water well or spring?	No					
Human and Other Areas						
<300' from an occupied permanent residence, school, hospital, institution or church?	No					
within incorporated municipal boundaries or within a defined municipal fresh water well field?	No					
<100' from wetland?	No					
within area overlying a subsurface mine	No					
within an unstable area?	Yes					
within a 100-year floodplain?	No					

Table 3: Summary of Sample Results

Cactus State #009
 Devon Energy Production Company
 2RP-5369

Sample ID	Sample Date	Depth (feet bgs)	BTEX mg/Kg	Benzene mg/Kg	GRO mg/Kg	DRO mg/Kg	MRO mg/Kg	Total TPH mg/Kg	Cl- mg/Kg
NMOCD Closure Criteria			50	10				100	600
S1	1/24/2019	Surface	<0.300	<0.050	<10.0	163	36.9	199.9	175
	2/6/2019	1	<0.300	<0.050	<10.0	11.4	<10.0	11.4	32.0
S2	1/24/2019	Surface	1.53	<0.050	165	4,800	946	5,911	304
	2/7/2019	1	<0.300	<0.050	<10.0	<10.0	<10.0	<30.0	32
S3	1/24/2019	Surface	<0.300	<0.050	<10.0	412	140	552	144
	2/6/2019	1	<0.300	<0.050	<10.0	<10.0	<10.0	<30.0	48.0
S4	1/24/2019	Surface	0.313	<0.050	16.6	5,000	4,180	9,196.6	19,200
	2/6/2019	3	<0.300	<0.050	<10.0	710	121	831.0	96.0
	2/6/2019	4	<0.300	<0.050	<10.0	490	90	579.7	64.0
	5/31/2019	5	<0.300	<0.050	<10.0	<10.0	<10.0	<30.0	32.0
S5	1/24/2019	Surface	<0.300	<0.050	<10.0	225	279	504	3,120
	2/6/2019	1	<0.300	<0.050	<10.0	<10.0	<10.0	<30.0	32.0
S6	1/24/2019	Surface	40.2	<1.00	2,680	47,400	11,200	61,280	576
	2/6/2019	1	<0.300	<0.050	<10.0	<10.0	<10.0	<30.0	48.0
S7	1/24/2019	Surface	<0.300	<0.050	<10.0	887	283	1,170	576
	2/6/2019	1	<0.300	<0.050	<10.0	<10.0	<10.0	<30.0	16.0
SW1	7/16/2020	Surface	<0.300	<0.050	<10.0	<10.0	<10.0	<30.0	48
SW2		Surface	<0.300	<0.050	<10.0	<10.0	<10.0	<30.0	64
SW3		Surface	<0.300	<0.050	<10.0	<10.0	<10.0	<30.0	32
SW4		Surface	<0.300	<0.050	<10.0	<10.0	<10.0	<30.0	64
SW5		Surface	<0.300	<0.050	<10.0	<10.0	<10.0	<30.0	32
SW6		Surface	<0.300	<0.050	<10.0	<10.0	<10.0	<30.0	48
SW7		Surface	<0.300	<0.050	<10.0	<10.0	<10.0	<30.0	48
SW8		Surface	<0.300	<0.050	<10.0	<10.0	<10.0	<30.0	32

Appendix A

District I
1625 N. French Dr., Hobbs, NM 88240
District II
811 S. First St., Artesia, NM 88210
District III
1000 Rio Brazos Road, Aztec, NM 87410
District IV
1220 S. St. Francis Dr., Santa Fe, NM 87505

State of New Mexico
Energy Minerals and Natural
Resources Department

Oil Conservation Division
1220 South St. Francis Dr.
Santa Fe, NM 87505

Form C-141
Revised August 24, 2018
Submit to appropriate OCD District office

Incident ID	
District RP	
Facility ID	
Application ID	

Release Notification

Responsible Party

Responsible Party	OGRID
Contact Name	Contact Telephone
Contact email	Incident # (assigned by OCD)
Contact mailing address	

Location of Release Source

Latitude _____ Longitude _____
(NAD 83 in decimal degrees to 5 decimal places)

Site Name	Site Type
Date Release Discovered	API# (if applicable)

Unit Letter	Section	Township	Range	County

Surface Owner: ☐ State ☐ Federal ☐ Tribal ☐ Private (Name: _____)

Nature and Volume of Release

Material(s) Released (Select all that apply and attach calculations or specific justification for the volumes provided below)

<input type="checkbox"/> Crude Oil	Volume Released (bbls)	Volume Recovered (bbls)
<input type="checkbox"/> Produced Water	Volume Released (bbls)	Volume Recovered (bbls)
	Is the concentration of total dissolved solids (TDS) in the produced water >10,000 mg/l?	<input type="checkbox"/> Yes <input type="checkbox"/> No
<input type="checkbox"/> Condensate	Volume Released (bbls)	Volume Recovered (bbls)
<input type="checkbox"/> Natural Gas	Volume Released (Mcf)	Volume Recovered (Mcf)
<input type="checkbox"/> Other (describe)	Volume/Weight Released (provide units)	Volume/Weight Recovered (provide units)

Cause of Release

Incident ID	
District RP	
Facility ID	
Application ID	

Was this a major release as defined by 19.15.29.7(A) NMAC? <input type="checkbox"/> Yes <input type="checkbox"/> No	If YES, for what reason(s) does the responsible party consider this a major release?
If YES, was immediate notice given to the OCD? By whom? To whom? When and by what means (phone, email, etc)?	

Initial Response

The responsible party must undertake the following actions immediately unless they could create a safety hazard that would result in injury

<input type="checkbox"/> The source of the release has been stopped.	
<input type="checkbox"/> The impacted area has been secured to protect human health and the environment.	
<input type="checkbox"/> Released materials have been contained via the use of berms or dikes, absorbent pads, or other containment devices.	
<input type="checkbox"/> All free liquids and recoverable materials have been removed and managed appropriately.	
If all the actions described above have <u>not</u> been undertaken, explain why:	
Per 19.15.29.8 B. (4) NMAC the responsible party may commence remediation immediately after discovery of a release. If remediation has begun, please attach a narrative of actions to date. If remedial efforts have been successfully completed or if the release occurred within a lined containment area (see 19.15.29.11(A)(5)(a) NMAC), please attach all information needed for closure evaluation.	
I hereby certify that the information given above is true and complete to the best of my knowledge and understand that pursuant to OCD rules and regulations all operators are required to report and/or file certain release notifications and perform corrective actions for releases which may endanger public health or the environment. The acceptance of a C-141 report by the OCD does not relieve the operator of liability should their operations have failed to adequately investigate and remediate contamination that pose a threat to groundwater, surface water, human health or the environment. In addition, OCD acceptance of a C-141 report does not relieve the operator of responsibility for compliance with any other federal, state, or local laws and/or regulations.	
Printed Name: _____	Title: _____
Signature: <u>Kendra DeHoyos</u>	Date: _____
email: _____	Telephone: _____
<u>OCD Only</u>	
Received by: <u>Ana Maria Beramonte</u>	Date: _____

Incident ID	NAB1911934008
District RP	2RP-5369
Facility ID	
Application ID	

Site Assessment/Characterization

This information must be provided to the appropriate district office no later than 90 days after the release discovery date.

What is the shallowest depth to groundwater beneath the area affected by the release?	≤50 (ft bgs)
Did this release impact groundwater or surface water?	<input type="checkbox"/> Yes <input checked="" type="checkbox"/> No
Are the lateral extents of the release within 300 feet of a continuously flowing watercourse or any other significant watercourse?	<input type="checkbox"/> Yes <input checked="" type="checkbox"/> No
Are the lateral extents of the release within 200 feet of any lakebed, sinkhole, or playa lake (measured from the ordinary high-water mark)?	<input type="checkbox"/> Yes <input checked="" type="checkbox"/> No
Are the lateral extents of the release within 300 feet of an occupied permanent residence, school, hospital, institution, or church?	<input type="checkbox"/> Yes <input checked="" type="checkbox"/> No
Are the lateral extents of the release within 500 horizontal feet of a spring or a private domestic fresh water well used by less than five households for domestic or stock watering purposes?	<input type="checkbox"/> Yes <input checked="" type="checkbox"/> No
Are the lateral extents of the release within 1000 feet of any other fresh water well or spring?	<input type="checkbox"/> Yes <input checked="" type="checkbox"/> No
Are the lateral extents of the release within incorporated municipal boundaries or within a defined municipal fresh water well field?	<input type="checkbox"/> Yes <input checked="" type="checkbox"/> No
Are the lateral extents of the release within 300 feet of a wetland?	<input type="checkbox"/> Yes <input checked="" type="checkbox"/> No
Are the lateral extents of the release overlying a subsurface mine?	<input type="checkbox"/> Yes <input checked="" type="checkbox"/> No
Are the lateral extents of the release overlying an unstable area such as karst geology?	<input checked="" type="checkbox"/> Yes <input type="checkbox"/> No
Are the lateral extents of the release within a 100-year floodplain?	<input type="checkbox"/> Yes <input checked="" type="checkbox"/> No
Did the release impact areas not on an exploration, development, production, or storage site?	<input type="checkbox"/> Yes <input checked="" type="checkbox"/> No

Attach a comprehensive report (electronic submittals in .pdf format are preferred) demonstrating the lateral and vertical extents of soil contamination associated with the release have been determined. Refer to 19.15.29.11 NMAC for specifics.

Characterization Report Checklist: *Each of the following items must be included in the report.*

- ☒ Scaled site map showing impacted area, surface features, subsurface features, delineation points, and monitoring wells.
- ☒ Field data
- ☒ Data table of soil contaminant concentration data
- ☒ Depth to water determination
- ☒ Determination of water sources and significant watercourses within ½-mile of the lateral extents of the release
- ☐ Boring or excavation logs
- ☒ Photographs including date and GIS information
- ☒ Topographic/Aerial maps
- ☒ Laboratory data including chain of custody

If the site characterization report does not include completed efforts at remediation of the release, the report must include a proposed remediation plan. That plan must include the estimated volume of material to be remediated, the proposed remediation technique, proposed sampling plan and methods, anticipated timelines for beginning and completing the remediation. The closure criteria for a release are contained in Table 1 of 19.15.29.12 NMAC, however, use of the table is modified by site- and release-specific parameters.

Incident ID	NAB1911934008
District RP	2RP-5369
Facility ID	
Application ID	

I hereby certify that the information given above is true and complete to the best of my knowledge and understand that pursuant to OCD rules and regulations all operators are required to report and/or file certain release notifications and perform corrective actions for releases which may endanger public health or the environment. The acceptance of a C-141 report by the OCD does not relieve the operator of liability should their operations have failed to adequately investigate and remediate contamination that pose a threat to groundwater, surface water, human health or the environment. In addition, OCD acceptance of a C-141 report does not relieve the operator of responsibility for compliance with any other federal, state, or local laws and/or regulations.

Printed Name: _____ Lupe Carrasco _____ Title: _____ EHS Professional _____

Signature: _____ *Lupe Carrasco* _____ Date: _____ 9/22/20 _____

email: _____ Lupe.Carrasco@dvn.com _____ Telephone: _____ 575-748-0165 _____

OCD Only

Received by: _____ Cristina Eads _____ Date: _____ 09/23/2020 _____

Incident ID	NAB1911934008
District RP	2RP-5369
Facility ID	
Application ID	

Closure

The responsible party must attach information demonstrating they have complied with all applicable closure requirements and any conditions or directives of the OCD. This demonstration should be in the form of a comprehensive report (electronic submittals in .pdf format are preferred) including a scaled site map, sampling diagrams, relevant field notes, photographs of any excavation prior to backfilling, laboratory data including chain of custody documents of final sampling, and a narrative of the remedial activities. Refer to 19.15.29.12 NMAC.

Closure Report Attachment Checklist: *Each of the following items must be included in the closure report.*

- ☒ A scaled site and sampling diagram as described in 19.15.29.11 NMAC
- ☒ Photographs of the remediated site prior to backfill or photos of the liner integrity if applicable (Note: appropriate OCD District office must be notified 2 days prior to liner inspection)
- ☒ Laboratory analyses of final sampling (Note: appropriate ODC District office must be notified 2 days prior to final sampling)
- ☒ Description of remediation activities

I hereby certify that the information given above is true and complete to the best of my knowledge and understand that pursuant to OCD rules and regulations all operators are required to report and/or file certain release notifications and perform corrective actions for releases which may endanger public health or the environment. The acceptance of a C-141 report by the OCD does not relieve the operator of liability should their operations have failed to adequately investigate and remediate contamination that pose a threat to groundwater, surface water, human health or the environment. In addition, OCD acceptance of a C-141 report does not relieve the operator of responsibility for compliance with any other federal, state, or local laws and/or regulations. The responsible party acknowledges they must substantially restore, reclaim, and re-vegetate the impacted surface area to the conditions that existed prior to the release or their final land use in accordance with 19.15.29.13 NMAC including notification to the OCD when reclamation and re-vegetation are complete.

Printed Name: Lupe Carrasco Title: EHS Professional

Signature: *Lupe Carrasco* Date: 9/22/20

email: Lupe.Carrasco@dvn.com Telephone: 575-748-0165

OCD Only

Received by: Cristina Eads Date: 09/23/2020

Closure approval by the OCD does not relieve the responsible party of liability should their operations have failed to adequately investigate and remediate contamination that poses a threat to groundwater, surface water, human health, or the environment nor does not relieve the responsible party of compliance with any other federal, state, or local laws and/or regulations.

Closure Approved by: *Cristina Eads* Date: 11/10/2020

Printed Name: Cristina Eads Title: Environmental Specialist

Appendix B



M & M EXCAVATING, INC.



New Mexico Office of the State Engineer

Water Column/Average Depth to Water







(A CLW##### in the POD suffix indicates the POD has been replaced & no longer serves a water right file.)

(R=POD has been replaced,
O=orphaned,
C=the file is closed)

(quarters are 1=NW 2=NE 3=SW 4=SE)

(quarters are smallest to largest) (NAD83 UTM in meters)

(In feet)

POD																
POD Number	Code	Sub-basin	County	Q Q Q						X	Y	Distance	DepthWell	DepthWater	Water Column	
				64	16	4	Sec	Tws	Rng							
C 01529		C	ED	2	4	2	21	21S	26E	566689	3592556*		965	130	70	60
C 04359	POD1	C	ED	4	2	4	17	21S	26E	565057	3593597		1069	256	230	26
C 01817		C	ED		4	2	17	21S	26E	564942	3594056*		1366	215	195	20
C 01940		C	ED		4	2	17	21S	26E	564942	3594056*		1366	212	182	30
C 02137		C	ED		4	2	17	21S	26E	564942	3594056*		1366	217	178	39
C 02562		C	ED	4	2	3	15	21S	26E	567485	3593575*		1422	160	65	95

Average Depth to Water: **153 feet**

Minimum Depth: **65 feet**

Maximum Depth: **230 feet**

Record Count: 6

UTMNAD83 Radius Search (in meters):

Easting (X): 566087.12

Northing (Y): 3593310.51

Radius: 1500

*UTM location was derived from PLSS - see Help

The data is furnished by the NMOSE/ISC and is accepted by the recipient with the expressed understanding that the OSE/ISC make no warranties, expressed or implied, concerning the accuracy, completeness, reliability, usability, or suitability for any particular purpose of the data.

8/19/20 10:23 AM

WATER COLUMN/ AVERAGE DEPTH TO
WATER



USGS Home
Contact USGS
Search USGS

National Water Information System: Web Interface

[USGS Water Resources](#)

Data Category:	Geographic Area:	
Groundwater	United States	GO

Click to hideNews Bulletins

- [Introducing The Next Generation of USGS Water Data for the Nation](#)
- [Full News](#) 

Groundwater levels for the Nation

Search Results -- 1 sites found

Agency code = usgs

site_no list =

- 322909104170101

Minimum number of levels = 1

[Save file of selected sites](#) to local disk for future upload

USGS 322909104170101 21S.26E.15.114212

Eddy County, New Mexico

Latitude 32°29'09", Longitude 104°17'01" NAD27

Land-surface elevation 3,195 feet above NAVD88

The depth of the well is 152 feet below land surface.

This well is completed in the Yates Formation, Guadalupe Group (313YATS) local aquifer.

Output formats

Table of data
Tab-separated data
Graph of data
Reselect period

Date	Time	? Water-level date-time accuracy	Water level, feet below land surface	Water level, feet above specific vertical datum	Referenced vertical datum	? Water-level accuracy	? Status	? Method of measurement	? Measuring agency	? Source of measurement
1949-05-23		D	93.60			2		U		

Explanation

Section	Code	Description
Water-level date-time accuracy	D	Date is accurate to the Day
Water-level accuracy	2	Water level accuracy to nearest hundredth of a foot
Status		The reported water-level measurement represents a static level
Method of measurement	U	Unknown method.
Measuring agency		Not determined
Source of measurement	U	Source is unknown.
Water-level approval status	A	Approved for publication -- Processing and review completed.

[Questions about sites/data?](#)

[Feedback on this web site](#)

[Automated retrievals](#)

[Help](#)

[Data Tips](#)

[Explanation of terms](#)

[Subscribe for system changes](#)

[News](#)

[Accessibility](#) [FOIA](#) [Privacy](#) [Policies and Notices](#)

[U.S. Department of the Interior](#) | [U.S. Geological Survey](#)

Title: Groundwater for USA: Water Levels

URL: <https://nwis.waterdata.usgs.gov/nwis/gwlevels?>



Page Contact Information: [USGS Water Data Support Team](#)

Page Last Modified: 2020-08-19 12:53:56 EDT

0.26 0.25 nadww01



USGS Home
Contact USGS
Search USGS

National Water Information System: Web Interface

[USGS Water Resources](#)

Data Category:	Geographic Area:	
Groundwater	United States	GO

Click to hideNews Bulletins

- [Introducing The Next Generation of USGS Water Data for the Nation](#)
- [Full News](#)

Groundwater levels for the Nation

Search Results -- 1 sites found

Agency code = usgs
site_no list =

- 322812104171301

Minimum number of levels = 1
[Save file of selected sites](#) to local disk for future upload

USGS 322812104171301 21S.26E.22.11333

Eddy County, New Mexico
Latitude 32°28'12", Longitude 104°17'13" NAD27
Land-surface elevation 3,242 feet above NAVD88
The depth of the well is 130 feet below land surface.
This well is completed in the Yates Formation, Guadalupe Group (313YATS) local aquifer.

Output formats

Table of data
Tab-separated data
Graph of data
Reselect period

Date	Time	? Water-level date-time accuracy	Water level, feet below land surface	Water level, feet above specific vertical datum	Referenced vertical datum	? Water-level accuracy	? Status	? Method of measurement	? Measuring agency	? Source of measurement
1978-01-05		D	80.59				2		U	
1987-10-13		D	79.44				2		U	
1993-01-12		D	79.62				2		S	
1998-01-15		D	80.04				2		S	

Explanation

Section	Code	Description
Water-level date-time accuracy	D	Date is accurate to the Day
Water-level accuracy	2	Water level accuracy to nearest hundredth of a foot
Status		The reported water-level measurement represents a static level
Method of measurement	S	Steel-tape measurement.
Method of measurement	U	Unknown method.
Measuring agency		Not determined
Source of measurement	U	Source is unknown.
Water-level approval status	A	Approved for publication -- Processing and review completed.

[Questions about sites/data?](#)
[Feedback on this web site](#)
[Automated retrievals](#)
[Help](#)

[Data Tips](#)
[Explanation of terms](#)
[Subscribe for system changes](#)
[News](#)

[Accessibility](#) [FOIA](#) [Privacy](#) [Policies and Notices](#)

[U.S. Department of the Interior](#) | [U.S. Geological Survey](#)

Title: Groundwater for USA: Water Levels

URL: <https://nwis.waterdata.usgs.gov/nwis/gwlevels?>



Page Contact Information: [USGS Water Data Support Team](#)

Page Last Modified: 2020-08-19 12:57:06 EDT

0.28 0.26 nadww01



USGS Home
Contact USGS
Search USGS

National Water Information System: Web Interface

[USGS Water Resources](#)

Data Category:

Geographic Area:

Groundwater

United States

GO

Click to hideNews Bulletins

- [Introducing The Next Generation of USGS Water Data for the Nation](#)
- [Full News](#)

Groundwater levels for the Nation

Search Results -- 1 sites found

Agency code = usgs
site_no list =

- 322844104183001

Minimum number of levels = 1
[Save file of selected sites](#) to local disk for future upload

USGS 322844104183001 21S.26E.17.41244

Eddy County, New Mexico
Latitude 32°28'44", Longitude 104°18'30" NAD27
Land-surface elevation 3,275 feet above NAVD88
The depth of the well is 187 feet below land surface.
This well is completed in the Yates Formation, Guadalupe Group (313YATS) local aquifer.

Output formats

Table of data
Tab-separated data
Graph of data
Reselect period

Date	Time	? Water-level date-time accuracy	Water level, feet below land surface	Water level, feet above specific vertical datum	Referenced vertical datum	? Water-level accuracy	? Status	? Method of measurement	? Measuring agency	? Source of measurement
1947-12-15		D	174.00				2		U	
1954-03-25		D	178.67				2		U	
1955-08-31		D	179.49				2		U	
1978-01-03		D	182.42				2		U	
1983-01-13		D	182.33				2		U	
1987-10-13		D	179.30				2		U	
1993-01-12		D	181.77				2		S	
1998-01-15		D	185.40				2		S	

Explanation

Section	Code	Description
Water-level date-time accuracy	D	Date is accurate to the Day
Water-level accuracy	2	Water level accuracy to nearest hundredth of a foot
Status		The reported water-level measurement represents a static level
Method of measurement	S	Steel-tape measurement.
Method of measurement	U	Unknown method.
Measuring agency		Not determined
Source of measurement	U	Source is unknown.
Water-level approval status	A	Approved for publication -- Processing and review completed.

[Questions about sites/data?](#)
[Feedback on this web site](#)
[Automated retrievals](#)
[Help](#)
[Data Tips](#)
[Explanation of terms](#)
[Subscribe for system changes](#)
[News](#)

[Accessibility](#) [FOIA](#) [Privacy](#) [Policies and Notices](#)

[U.S. Department of the Interior](#) | [U.S. Geological Survey](#)

Title: Groundwater for USA: Water Levels

URL: <https://nwis.waterdata.usgs.gov/nwis/gwlevels?>



Page Contact Information: [USGS Water Data Support Team](#)

Page Last Modified: 2020-08-19 12:52:18 EDT

0.27 0.25 nadww01

Appendix C



PHONE (575) 393-2326 ° 101 E. MARLAND ° HOBBS, NM 88240

January 25, 2019

LUPE CARRASCO

MMX

2737 PECOS HWY

CARLSBAD, NM 88220

RE: CACTUS STATE #9

Enclosed are the results of analyses for samples received by the laboratory on 01/24/19 11:40.

Cardinal Laboratories is accredited through Texas NELAP under certificate number T104704398-18-11. Accreditation applies to drinking water, non-potable water and solid and chemical materials. All accredited analytes are denoted by an asterisk (*). For a complete list of accredited analytes and matrices visit the TCEQ website at www.tceq.texas.gov/field/qa/lab_accred_certif.html.

Cardinal Laboratories is accredited through the State of Colorado Department of Public Health and Environment for:

Method EPA 552.2	Haloacetic Acids (HAA-5)
Method EPA 524.2	Total Trihalomethanes (TTHM)
Method EPA 524.4	Regulated VOCs (V1, V2, V3)

Accreditation applies to public drinking water matrices.

This report meets NELAP requirements and is made up of a cover page, analytical results, and a copy of the original chain-of-custody. If you have any questions concerning this report, please feel free to contact me.

Sincerely,

A handwritten signature in black ink that reads "Celey D. Keene". The signature is written in a cursive, flowing style.

Celey D. Keene

Lab Director/Quality Manager



PHONE (575) 393-2326 ° 101 E. MARLAND ° HOBBS, NM 88240

Analytical Results For:

MMX
 LUPE CARRASCO
 2737 PECOS HWY
 CARLSBAD NM, 88220
 Fax To: (575) 236-6201

Received:	01/24/2019	Sampling Date:	01/24/2019
Reported:	01/25/2019	Sampling Type:	Soil
Project Name:	CACTUS STATE #9	Sampling Condition:	Cool & Intact
Project Number:	NONE GIVEN	Sample Received By:	Tamara Oldaker
Project Location:	NOT GIVEN		

Sample ID: S 1 (H900257-01)

BTEX 8021B			mg/kg		Analyzed By: MS				
Analyte	Result	Reporting Limit	Analyzed	Method Blank	BS	% Recovery	True Value QC	RPD	Qualifier
Benzene*	<0.050	0.050	01/24/2019	ND	2.07	103	2.00	2.21	
Toluene*	<0.050	0.050	01/24/2019	ND	2.14	107	2.00	2.23	
Ethylbenzene*	<0.050	0.050	01/24/2019	ND	2.14	107	2.00	1.93	
Total Xylenes*	<0.150	0.150	01/24/2019	ND	6.25	104	6.00	0.644	
Total BTEX	<0.300	0.300	01/24/2019	ND					

Surrogate: 4-Bromofluorobenzene (PID) 98.8 % 73.3-129

Chloride, SM4500Cl-B			mg/kg		Analyzed By: JH				
Analyte	Result	Reporting Limit	Analyzed	Method Blank	BS	% Recovery	True Value QC	RPD	Qualifier
Chloride	176	16.0	01/25/2019	ND	432	108	400	0.00	

TPH 8015M			mg/kg		Analyzed By: MS				
Analyte	Result	Reporting Limit	Analyzed	Method Blank	BS	% Recovery	True Value QC	RPD	Qualifier
GRO C6-C10*	<10.0	10.0	01/24/2019	ND	209	105	200	4.91	
DRO >C10-C28*	163	10.0	01/24/2019	ND	195	97.6	200	7.37	
EXT DRO >C28-C36	36.9	10.0	01/24/2019	ND					

Surrogate: 1-Chlorooctane 87.9 % 41-142

Surrogate: 1-Chlorooctadecane 94.9 % 37.6-147

Cardinal Laboratories

*=Accredited Analyte

PLEASE NOTE: Liability and Damages. Cardinal's liability and client's exclusive remedy for any claim arising, whether based in contract or tort, shall be limited to the amount paid by client for analyses. All claims, including those for negligence and any other cause whatsoever shall be deemed waived unless made in writing and received by Cardinal within thirty (30) days after completion of the applicable service. In no event shall Cardinal be liable for incidental or consequential damages, including, without limitation, business interruptions, loss of use, or loss of profits incurred by client, its subsidiaries, affiliates or successors arising out of or related to the performance of the services hereunder by Cardinal, regardless of whether such claim is based upon any of the above stated reasons or otherwise. Results relate only to the samples identified above. This report shall not be reproduced except in full with written approval of Cardinal Laboratories.

Celey D. Keene, Lab Director/Quality Manager



PHONE (575) 393-2326 ° 101 E. MARLAND ° HOBBS, NM 88240

Analytical Results For:

MMX
 LUPE CARRASCO
 2737 PECOS HWY
 CARLSBAD NM, 88220
 Fax To: (575) 236-6201

Received:	01/24/2019	Sampling Date:	01/24/2019
Reported:	01/25/2019	Sampling Type:	Soil
Project Name:	CACTUS STATE #9	Sampling Condition:	Cool & Intact
Project Number:	NONE GIVEN	Sample Received By:	Tamara Oldaker
Project Location:	NOT GIVEN		

Sample ID: S 2 (H900257-02)

BTX 8021B		mg/kg		Analyzed By: MS				S-04	
Analyte	Result	Reporting Limit	Analyzed	Method Blank	BS	% Recovery	True Value QC	RPD	Qualifier
Benzene*	<0.050	0.050	01/24/2019	ND	2.07	103	2.00	2.21	
Toluene*	0.087	0.050	01/24/2019	ND	2.14	107	2.00	2.23	
Ethylbenzene*	0.436	0.050	01/24/2019	ND	2.14	107	2.00	1.93	
Total Xylenes*	1.01	0.150	01/24/2019	ND	6.25	104	6.00	0.644	
Total BTX	1.53	0.300	01/24/2019	ND					

Surrogate: 4-Bromofluorobenzene (PID) 131 % 73.3-129

Chloride, SM4500CI-B		mg/kg		Analyzed By: JH					
Analyte	Result	Reporting Limit	Analyzed	Method Blank	BS	% Recovery	True Value QC	RPD	Qualifier
Chloride	304	16.0	01/25/2019	ND	432	108	400	0.00	

TPH 8015M		mg/kg		Analyzed By: MS				S-04	
Analyte	Result	Reporting Limit	Analyzed	Method Blank	BS	% Recovery	True Value QC	RPD	Qualifier
GRO C6-C10*	165	10.0	01/24/2019	ND	209	105	200	4.91	
DRO >C10-C28*	4800	10.0	01/24/2019	ND	195	97.6	200	7.37	
EXT DRO >C28-C36	946	10.0	01/24/2019	ND					

Surrogate: 1-Chlorooctane 110 % 41-142

Surrogate: 1-Chlorooctadecane 224 % 37.6-147

Cardinal Laboratories

*=Accredited Analyte

PLEASE NOTE: Liability and Damages. Cardinal's liability and client's exclusive remedy for any claim arising, whether based in contract or tort, shall be limited to the amount paid by client for analyses. All claims, including those for negligence and any other cause whatsoever shall be deemed waived unless made in writing and received by Cardinal within thirty (30) days after completion of the applicable service. In no event shall Cardinal be liable for incidental or consequential damages, including, without limitation, business interruptions, loss of use, or loss of profits incurred by client, its subsidiaries, affiliates or successors arising out of or related to the performance of the services hereunder by Cardinal, regardless of whether such claim is based upon any of the above stated reasons or otherwise. Results relate only to the samples identified above. This report shall not be reproduced except in full with written approval of Cardinal Laboratories.

Celey D. Keene, Lab Director/Quality Manager



PHONE (575) 393-2326 ° 101 E. MARLAND ° HOBBS, NM 88240

Analytical Results For:

MMX
 LUPE CARRASCO
 2737 PECOS HWY
 CARLSBAD NM, 88220
 Fax To: (575) 236-6201

Received: 01/24/2019
 Reported: 01/25/2019
 Project Name: CACTUS STATE #9
 Project Number: NONE GIVEN
 Project Location: NOT GIVEN

Sampling Date: 01/24/2019
 Sampling Type: Soil
 Sampling Condition: Cool & Intact
 Sample Received By: Tamara Oldaker

Sample ID: S 3 (H900257-03)

BTEx 8021B		mg/kg		Analyzed By: MS					
Analyte	Result	Reporting Limit	Analyzed	Method Blank	BS	% Recovery	True Value QC	RPD	Qualifier
Benzene*	<0.050	0.050	01/24/2019	ND	2.07	103	2.00	2.21	
Toluene*	<0.050	0.050	01/24/2019	ND	2.14	107	2.00	2.23	
Ethylbenzene*	<0.050	0.050	01/24/2019	ND	2.14	107	2.00	1.93	
Total Xylenes*	<0.150	0.150	01/24/2019	ND	6.25	104	6.00	0.644	
Total BTEx	<0.300	0.300	01/24/2019	ND					

Surrogate: 4-Bromofluorobenzene (PID) 101 % 73.3-129

Chloride, SM4500CI-B		mg/kg		Analyzed By: JH					
Analyte	Result	Reporting Limit	Analyzed	Method Blank	BS	% Recovery	True Value QC	RPD	Qualifier
Chloride	144	16.0	01/25/2019	ND	416	104	400	3.92	

TPH 8015M		mg/kg		Analyzed By: MS					
Analyte	Result	Reporting Limit	Analyzed	Method Blank	BS	% Recovery	True Value QC	RPD	Qualifier
GRO C6-C10*	<10.0	10.0	01/24/2019	ND	209	105	200	4.91	
DRO >C10-C28*	412	10.0	01/24/2019	ND	195	97.6	200	7.37	
EXT DRO >C28-C36	140	10.0	01/24/2019	ND					

Surrogate: 1-Chlorooctane 95.4 % 41-142

Surrogate: 1-Chlorooctadecane 110 % 37.6-147

Cardinal Laboratories

*=Accredited Analyte

PLEASE NOTE: Liability and Damages. Cardinal's liability and client's exclusive remedy for any claim arising, whether based in contract or tort, shall be limited to the amount paid by client for analyses. All claims, including those for negligence and any other cause whatsoever shall be deemed waived unless made in writing and received by Cardinal within thirty (30) days after completion of the applicable service. In no event shall Cardinal be liable for incidental or consequential damages, including, without limitation, business interruptions, loss of use, or loss of profits incurred by client, its subsidiaries, affiliates or successors arising out of or related to the performance of the services hereunder by Cardinal, regardless of whether such claim is based upon any of the above stated reasons or otherwise. Results relate only to the samples identified above. This report shall not be reproduced except in full with written approval of Cardinal Laboratories.

Celey D. Keene, Lab Director/Quality Manager



PHONE (575) 393-2326 ° 101 E. MARLAND ° HOBBS, NM 88240

Analytical Results For:

MMX
 LUPE CARRASCO
 2737 PECOS HWY
 CARLSBAD NM, 88220
 Fax To: (575) 236-6201

Received:	01/24/2019	Sampling Date:	01/24/2019
Reported:	01/25/2019	Sampling Type:	Soil
Project Name:	CACTUS STATE #9	Sampling Condition:	Cool & Intact
Project Number:	NONE GIVEN	Sample Received By:	Tamara Oldaker
Project Location:	NOT GIVEN		

Sample ID: S 4 (H900257-04)

BTEx 8021B		mg/kg		Analyzed By: MS					
Analyte	Result	Reporting Limit	Analyzed	Method Blank	BS	% Recovery	True Value QC	RPD	Qualifier
Benzene*	<0.050	0.050	01/24/2019	ND	2.07	103	2.00	2.21	
Toluene*	<0.050	0.050	01/24/2019	ND	2.14	107	2.00	2.23	
Ethylbenzene*	0.056	0.050	01/24/2019	ND	2.14	107	2.00	1.93	
Total Xylenes*	0.258	0.150	01/24/2019	ND	6.25	104	6.00	0.644	
Total BTEX	0.313	0.300	01/24/2019	ND					

Surrogate: 4-Bromofluorobenzene (PID) 110 % 73.3-129

Chloride, SM4500Cl-B		mg/kg		Analyzed By: JH						
Analyte	Result	Reporting Limit	Analyzed	Method Blank	BS	% Recovery	True Value QC	RPD	Qualifier	
Chloride	19200	16.0	01/25/2019	ND	416	104	400	3.92		

TPH 8015M		mg/kg		Analyzed By: MS					
Analyte	Result	Reporting Limit	Analyzed	Method Blank	BS	% Recovery	True Value QC	RPD	Qualifier
GRO C6-C10*	16.6	10.0	01/24/2019	ND	209	105	200	4.91	
DRO >C10-C28*	5000	10.0	01/24/2019	ND	195	97.6	200	7.37	
EXT DRO >C28-C36	4180	10.0	01/24/2019	ND					

Surrogate: 1-Chlorooctane 93.8 % 41-142

Surrogate: 1-Chlorooctadecane 130 % 37.6-147

Cardinal Laboratories

*=Accredited Analyte

PLEASE NOTE: Liability and Damages. Cardinal's liability and client's exclusive remedy for any claim arising, whether based in contract or tort, shall be limited to the amount paid by client for analyses. All claims, including those for negligence and any other cause whatsoever shall be deemed waived unless made in writing and received by Cardinal within thirty (30) days after completion of the applicable service. In no event shall Cardinal be liable for incidental or consequential damages, including, without limitation, business interruptions, loss of use, or loss of profits incurred by client, its subsidiaries, affiliates or successors arising out of or related to the performance of the services hereunder by Cardinal, regardless of whether such claim is based upon any of the above stated reasons or otherwise. Results relate only to the samples identified above. This report shall not be reproduced except in full with written approval of Cardinal Laboratories.

Celey D. Keene, Lab Director/Quality Manager



PHONE (575) 393-2326 ° 101 E. MARLAND ° HOBBS, NM 88240

Analytical Results For:

MMX
 LUPE CARRASCO
 2737 PECOS HWY
 CARLSBAD NM, 88220
 Fax To: (575) 236-6201

Received: 01/24/2019
 Reported: 01/25/2019
 Project Name: CACTUS STATE #9
 Project Number: NONE GIVEN
 Project Location: NOT GIVEN

Sampling Date: 01/24/2019
 Sampling Type: Soil
 Sampling Condition: Cool & Intact
 Sample Received By: Tamara Oldaker

Sample ID: S 5 (H900257-05)

BTEx 8021B		mg/kg		Analyzed By: MS					
Analyte	Result	Reporting Limit	Analyzed	Method Blank	BS	% Recovery	True Value QC	RPD	Qualifier
Benzene*	<0.050	0.050	01/24/2019	ND	2.07	103	2.00	2.21	
Toluene*	<0.050	0.050	01/24/2019	ND	2.14	107	2.00	2.23	
Ethylbenzene*	<0.050	0.050	01/24/2019	ND	2.14	107	2.00	1.93	
Total Xylenes*	<0.150	0.150	01/24/2019	ND	6.25	104	6.00	0.644	
Total BTEx	<0.300	0.300	01/24/2019	ND					

Surrogate: 4-Bromofluorobenzene (PID) 103 % 73.3-129

Chloride, SM4500Cl-B		mg/kg		Analyzed By: JH					
Analyte	Result	Reporting Limit	Analyzed	Method Blank	BS	% Recovery	True Value QC	RPD	Qualifier
Chloride	3120	16.0	01/25/2019	ND	416	104	400	3.92	

TPH 8015M		mg/kg		Analyzed By: MS					
Analyte	Result	Reporting Limit	Analyzed	Method Blank	BS	% Recovery	True Value QC	RPD	Qualifier
GRO C6-C10*	<10.0	10.0	01/24/2019	ND	209	105	200	4.91	
DRO >C10-C28*	225	10.0	01/24/2019	ND	195	97.6	200	7.37	
EXT DRO >C28-C36	279	10.0	01/24/2019	ND					

Surrogate: 1-Chlorooctane 95.9 % 41-142

Surrogate: 1-Chlorooctadecane 97.9 % 37.6-147

Cardinal Laboratories

*=Accredited Analyte

PLEASE NOTE: Liability and Damages. Cardinal's liability and client's exclusive remedy for any claim arising, whether based in contract or tort, shall be limited to the amount paid by client for analyses. All claims, including those for negligence and any other cause whatsoever shall be deemed waived unless made in writing and received by Cardinal within thirty (30) days after completion of the applicable service. In no event shall Cardinal be liable for incidental or consequential damages, including, without limitation, business interruptions, loss of use, or loss of profits incurred by client, its subsidiaries, affiliates or successors arising out of or related to the performance of the services hereunder by Cardinal, regardless of whether such claim is based upon any of the above stated reasons or otherwise. Results relate only to the samples identified above. This report shall not be reproduced except in full with written approval of Cardinal Laboratories.

Celey D. Keene, Lab Director/Quality Manager



PHONE (575) 393-2326 ° 101 E. MARLAND ° HOBBS, NM 88240

Analytical Results For:

MMX
 LUPE CARRASCO
 2737 PECOS HWY
 CARLSBAD NM, 88220
 Fax To: (575) 236-6201

Received: 01/24/2019
 Reported: 01/25/2019
 Project Name: CACTUS STATE #9
 Project Number: NONE GIVEN
 Project Location: NOT GIVEN

Sampling Date: 01/24/2019
 Sampling Type: Soil
 Sampling Condition: Cool & Intact
 Sample Received By: Tamara Oldaker

Sample ID: S 6 (H900257-06)

BTX 8021B		mg/kg		Analyzed By: MS					
Analyte	Result	Reporting Limit	Analyzed	Method Blank	BS	% Recovery	True Value QC	RPD	Qualifier
Benzene*	<1.00	1.00	01/24/2019	ND	2.07	103	2.00	2.21	
Toluene*	5.76	1.00	01/24/2019	ND	2.14	107	2.00	2.23	
Ethylbenzene*	9.14	1.00	01/24/2019	ND	2.14	107	2.00	1.93	
Total Xylenes*	25.3	3.00	01/24/2019	ND	6.25	104	6.00	0.644	
Total BTX	40.2	6.00	01/24/2019	ND					

Surrogate: 4-Bromofluorobenzene (PID) 121 % 73.3-129

Chloride, SM4500CI-B		mg/kg		Analyzed By: JH						
Analyte	Result	Reporting Limit	Analyzed	Method Blank	BS	% Recovery	True Value QC	RPD	Qualifier	
Chloride	576	16.0	01/25/2019	ND	416	104	400	3.92		

TPH 8015M		mg/kg		Analyzed By: MS				S-06	
Analyte	Result	Reporting Limit	Analyzed	Method Blank	BS	% Recovery	True Value QC	RPD	Qualifier
GRO C6-C10*	2680	100	01/24/2019	ND	209	105	200	4.91	
DRO >C10-C28*	47400	100	01/24/2019	ND	195	97.6	200	7.37	
EXT DRO >C28-C36	11200	100	01/24/2019	ND					

Surrogate: 1-Chlorooctane 181 % 41-142

Surrogate: 1-Chlorooctadecane 1450 % 37.6-147

Cardinal Laboratories

*=Accredited Analyte

PLEASE NOTE: Liability and Damages. Cardinal's liability and client's exclusive remedy for any claim arising, whether based in contract or tort, shall be limited to the amount paid by client for analyses. All claims, including those for negligence and any other cause whatsoever shall be deemed waived unless made in writing and received by Cardinal within thirty (30) days after completion of the applicable service. In no event shall Cardinal be liable for incidental or consequential damages, including, without limitation, business interruptions, loss of use, or loss of profits incurred by client, its subsidiaries, affiliates or successors arising out of or related to the performance of the services hereunder by Cardinal, regardless of whether such claim is based upon any of the above stated reasons or otherwise. Results relate only to the samples identified above. This report shall not be reproduced except in full with written approval of Cardinal Laboratories.

Celey D. Keene, Lab Director/Quality Manager



PHONE (575) 393-2326 ° 101 E. MARLAND ° HOBBS, NM 88240

Analytical Results For:

MMX
 LUPE CARRASCO
 2737 PECOS HWY
 CARLSBAD NM, 88220
 Fax To: (575) 236-6201

Received: 01/24/2019
 Reported: 01/25/2019
 Project Name: CACTUS STATE #9
 Project Number: NONE GIVEN
 Project Location: NOT GIVEN

Sampling Date: 01/24/2019
 Sampling Type: Soil
 Sampling Condition: Cool & Intact
 Sample Received By: Tamara Oldaker

Sample ID: S 7 (H900257-07)

BTEx 8021B		mg/kg		Analyzed By: MS					
Analyte	Result	Reporting Limit	Analyzed	Method Blank	BS	% Recovery	True Value QC	RPD	Qualifier
Benzene*	<0.050	0.050	01/24/2019	ND	2.07	103	2.00	2.21	
Toluene*	<0.050	0.050	01/24/2019	ND	2.14	107	2.00	2.23	
Ethylbenzene*	<0.050	0.050	01/24/2019	ND	2.14	107	2.00	1.93	
Total Xylenes*	<0.150	0.150	01/24/2019	ND	6.25	104	6.00	0.644	
Total BTEx	<0.300	0.300	01/24/2019	ND					

Surrogate: 4-Bromofluorobenzene (PID) 100 % 73.3-129

Chloride, SM4500Cl-B		mg/kg		Analyzed By: JH					
Analyte	Result	Reporting Limit	Analyzed	Method Blank	BS	% Recovery	True Value QC	RPD	Qualifier
Chloride	576	16.0	01/25/2019	ND	416	104	400	3.92	

TPH 8015M		mg/kg		Analyzed By: MS					
Analyte	Result	Reporting Limit	Analyzed	Method Blank	BS	% Recovery	True Value QC	RPD	Qualifier
GRO C6-C10*	<10.0	10.0	01/24/2019	ND	209	105	200	4.91	
DRO >C10-C28*	887	10.0	01/24/2019	ND	195	97.6	200	7.37	
EXT DRO >C28-C36	283	10.0	01/24/2019	ND					

Surrogate: 1-Chlorooctane 81.5 % 41-142

Surrogate: 1-Chlorooctadecane 112 % 37.6-147

Cardinal Laboratories

*=Accredited Analyte

PLEASE NOTE: Liability and Damages. Cardinal's liability and client's exclusive remedy for any claim arising, whether based in contract or tort, shall be limited to the amount paid by client for analyses. All claims, including those for negligence and any other cause whatsoever shall be deemed waived unless made in writing and received by Cardinal within thirty (30) days after completion of the applicable service. In no event shall Cardinal be liable for incidental or consequential damages, including, without limitation, business interruptions, loss of use, or loss of profits incurred by client, its subsidiaries, affiliates or successors arising out of or related to the performance of the services hereunder by Cardinal, regardless of whether such claim is based upon any of the above stated reasons or otherwise. Results relate only to the samples identified above. This report shall not be reproduced except in full with written approval of Cardinal Laboratories.

Celey D. Keene, Lab Director/Quality Manager

PHONE (575) 393-2326 ° 101 E. MARLAND ° HOBBS, NM 88240

Notes and Definitions

S-06	The recovery of this surrogate is outside control limits due to sample dilution required from high analyte concentration and/or matrix interference's.
S-04	The surrogate recovery for this sample is outside of established control limits due to a sample matrix effect.
QM-07	The spike recovery was outside acceptance limits for the MS and/or MSD. The batch was accepted based on acceptable LCS recovery.
ND	Analyte NOT DETECTED at or above the reporting limit
RPD	Relative Percent Difference
**	Samples not received at proper temperature of 6°C or below.
***	Insufficient time to reach temperature.
-	Chloride by SM4500Cl-B does not require samples be received at or below 6°C Samples reported on an as received basis (wet) unless otherwise noted on report

Cardinal Laboratories

*=Accredited Analyte

PLEASE NOTE: Liability and Damages. Cardinal's liability and client's exclusive remedy for any claim arising, whether based in contract or tort, shall be limited to the amount paid by client for analyses. All claims, including those for negligence and any other cause whatsoever shall be deemed waived unless made in writing and received by Cardinal within thirty (30) days after completion of the applicable service. In no event shall Cardinal be liable for incidental or consequential damages, including, without limitation, business interruptions, loss of use, or loss of profits incurred by client, its subsidiaries, affiliates or successors arising out of or related to the performance of the services hereunder by Cardinal, regardless of whether such claim is based upon any of the above stated reasons or otherwise. Results relate only to the samples identified above. This report shall not be reproduced except in full with written approval of Cardinal Laboratories.

A handwritten signature in black ink, appearing to read "Celey D. Keene".

Celey D. Keene, Lab Director/Quality Manager



CHAIN-OF-CUSTODY AND ANALYSIS REQUEST

101 East Marland, Hobbs, NM 88240
(575) 393-2326 FAX (575) 393-2476

Company Name: <u>MMX</u> Project Manager: <u>Lupe Carrasco</u> Address: City: _____ State: _____ Zip: _____ Phone #: _____ Fax #: _____ Project #: _____ Project Owner: _____ Project Name: <u>Cañon State #9</u> Project Location: _____ Sampler Name: _____ FOR LAB USE ONLY		BILL TO P.O. #: _____ Company: <u>MMX</u> Attn: <u>Lupe Carrasco</u> Address: <u>PO Box 1120</u> City: <u>Carlsbad</u> State: <u>NM</u> Zip: <u>88224</u> Phone #: _____ Fax #: _____		ANALYSIS REQUEST																					
Lab I.D. <u>H900257</u>		Sample I.D. _____		(G)RAB OR (C)OMP. # CONTAINERS		MATRIX GROUNDWATER WASTEWATER SOIL OIL SLUDGE OTHER : _____		PRESERV. ACID/BASE: ICE / COOL OTHER : _____		SAMPLING DATE <u>1/24/19</u>		TIME _____		BTEX TPH Chlorides											
1		51		6										X											
2		52												X											
3		53												X											
4		54												X											
5		55												X											
6		56												X											
7		57												X											

PLEASE NOTE: Liability and Damages. Cardinal's liability and client's exclusive remedy for any claim arising whether based in contract or tort, shall be limited to the amount paid by the client for the analyses. All claims including those for negligence and any other cause whatsoever shall be deemed waived unless made in writing and received by Cardinal within 30 days after completion of the applicable service. In no event shall Cardinal be liable for incidental or consequential damages, including without limitation, business interruptions, loss of use, or loss of profits incurred by client, its subsidiaries, affiliates or successors arising out of or related to the performance of services hereunder by Cardinal, regardless of whether such claim is based upon any of the above stated reasons or otherwise.

Relinquished By: _____ Relinquished By: _____ Date: <u>1-24-19</u> Time: <u>11:40am</u> Date: _____ Time: _____		Received By: <u>Amara Delatorre</u> Date: _____ Time: _____		Sample Condition Cool <input type="checkbox"/> Intact <input type="checkbox"/> Yes <input type="checkbox"/> No <input type="checkbox"/>		CHECKED BY: _____ (Initials)	
Delivered By: (Circle One) Sampler - UPS - Bus - Other: _____		5552 #97		70-			

REMARKS: email: lupemarcinc@gmail.com
Amara Delatorre
Amara Delatorre @ delatorre.com

Phone Result: ☐ Yes ☐ No ☐ Add'l Phone #: _____
 Fax Result: ☐ Yes ☐ No ☐ Add'l Fax #: _____



PHONE (575) 393-2326 ° 101 E. MARLAND ° HOBBS, NM 88240

February 07, 2019

LUPE CARRASCO

MMX

2737 PECOS HWY

CARLSBAD, NM 88220

RE: CACTUS STATE #9

Enclosed are the results of analyses for samples received by the laboratory on 02/06/19 14:15.

Cardinal Laboratories is accredited through Texas NELAP under certificate number T104704398-18-11. Accreditation applies to drinking water, non-potable water and solid and chemical materials. All accredited analytes are denoted by an asterisk (*). For a complete list of accredited analytes and matrices visit the TCEQ website at www.tceq.texas.gov/field/qa/lab_accred_certif.html.

Cardinal Laboratories is accredited through the State of Colorado Department of Public Health and Environment for:

Method EPA 552.2	Haloacetic Acids (HAA-5)
Method EPA 524.2	Total Trihalomethanes (TTHM)
Method EPA 524.4	Regulated VOCs (V1, V2, V3)

Accreditation applies to public drinking water matrices.

This report meets NELAP requirements and is made up of a cover page, analytical results, and a copy of the original chain-of-custody. If you have any questions concerning this report, please feel free to contact me.

Sincerely,

A handwritten signature in black ink that reads "Celey D. Keene". The signature is written in a cursive, flowing style.

Celey D. Keene

Lab Director/Quality Manager



PHONE (575) 393-2326 ° 101 E. MARLAND ° HOBBS, NM 88240

Analytical Results For:

MMX
 LUPE CARRASCO
 2737 PECOS HWY
 CARLSBAD NM, 88220
 Fax To: (575) 236-6201

Received:	02/06/2019	Sampling Date:	02/06/2019
Reported:	02/07/2019	Sampling Type:	Soil
Project Name:	CACTUS STATE #9	Sampling Condition:	Cool & Intact
Project Number:	NONE GIVEN	Sample Received By:	Jodi Henson
Project Location:	NOT GIVEN		

Sample ID: S5 -1' (H900457-01)

BTEX 8021B		mg/kg		Analyzed By: ms					
Analyte	Result	Reporting Limit	Analyzed	Method Blank	BS	% Recovery	True Value QC	RPD	Qualifier
Benzene*	<0.050	0.050	02/07/2019	ND	2.03	102	2.00	4.08	
Toluene*	<0.050	0.050	02/07/2019	ND	1.96	97.9	2.00	4.88	
Ethylbenzene*	<0.050	0.050	02/07/2019	ND	1.92	96.0	2.00	4.83	
Total Xylenes*	<0.150	0.150	02/07/2019	ND	5.82	97.0	6.00	4.36	
Total BTEX	<0.300	0.300	02/07/2019	ND					

Surrogate: 4-Bromofluorobenzene (PID) 101 % 73.3-129

Chloride, SM4500Cl-B		mg/kg		Analyzed By: AC					
Analyte	Result	Reporting Limit	Analyzed	Method Blank	BS	% Recovery	True Value QC	RPD	Qualifier
Chloride	32.0	16.0	02/07/2019	ND	416	104	400	3.77	

TPH 8015M		mg/kg		Analyzed By: MS					
Analyte	Result	Reporting Limit	Analyzed	Method Blank	BS	% Recovery	True Value QC	RPD	Qualifier
GRO C6-C10*	<10.0	10.0	02/06/2019	ND	198	99.1	200	1.94	
DRO >C10-C28*	<10.0	10.0	02/06/2019	ND	208	104	200	1.75	
EXT DRO >C28-C36	<10.0	10.0	02/06/2019	ND					

Surrogate: 1-Chlorooctane 82.9 % 41-142

Surrogate: 1-Chlorooctadecane 90.4 % 37.6-147

Cardinal Laboratories

*=Accredited Analyte

PLEASE NOTE: Liability and Damages. Cardinal's liability and client's exclusive remedy for any claim arising, whether based in contract or tort, shall be limited to the amount paid by client for analyses. All claims, including those for negligence and any other cause whatsoever shall be deemed waived unless made in writing and received by Cardinal within thirty (30) days after completion of the applicable service. In no event shall Cardinal be liable for incidental or consequential damages, including, without limitation, business interruptions, loss of use, or loss of profits incurred by client, its subsidiaries, affiliates or successors arising out of or related to the performance of the services hereunder by Cardinal, regardless of whether such claim is based upon any of the above stated reasons or otherwise. Results relate only to the samples identified above. This report shall not be reproduced except in full with written approval of Cardinal Laboratories.

Celey D. Keene, Lab Director/Quality Manager



PHONE (575) 393-2326 ° 101 E. MARLAND ° HOBBS, NM 88240

Analytical Results For:

MMX
 LUPE CARRASCO
 2737 PECOS HWY
 CARLSBAD NM, 88220
 Fax To: (575) 236-6201

Received: 02/06/2019
 Reported: 02/07/2019
 Project Name: CACTUS STATE #9
 Project Number: NONE GIVEN
 Project Location: NOT GIVEN

Sampling Date: 02/06/2019
 Sampling Type: Soil
 Sampling Condition: Cool & Intact
 Sample Received By: Jodi Henson

Sample ID: S6 -1' (H900457-02)

BTEx 8021B		mg/kg		Analyzed By: ms					
Analyte	Result	Reporting Limit	Analyzed	Method Blank	BS	% Recovery	True Value QC	RPD	Qualifier
Benzene*	<0.050	0.050	02/07/2019	ND	2.03	102	2.00	4.08	
Toluene*	<0.050	0.050	02/07/2019	ND	1.96	97.9	2.00	4.88	
Ethylbenzene*	<0.050	0.050	02/07/2019	ND	1.92	96.0	2.00	4.83	
Total Xylenes*	<0.150	0.150	02/07/2019	ND	5.82	97.0	6.00	4.36	
Total BTEX	<0.300	0.300	02/07/2019	ND					

Surrogate: 4-Bromofluorobenzene (PID) 99.5 % 73.3-129

Chloride, SM4500Cl-B		mg/kg		Analyzed By: AC					
Analyte	Result	Reporting Limit	Analyzed	Method Blank	BS	% Recovery	True Value QC	RPD	Qualifier
Chloride	48.0	16.0	02/07/2019	ND	416	104	400	3.77	

TPH 8015M		mg/kg		Analyzed By: MS					
Analyte	Result	Reporting Limit	Analyzed	Method Blank	BS	% Recovery	True Value QC	RPD	Qualifier
GRO C6-C10*	<10.0	10.0	02/06/2019	ND	198	99.1	200	1.94	
DRO >C10-C28*	<10.0	10.0	02/06/2019	ND	208	104	200	1.75	
EXT DRO >C28-C36	<10.0	10.0	02/06/2019	ND					

Surrogate: 1-Chlorooctane 88.4 % 41-142

Surrogate: 1-Chlorooctadecane 93.2 % 37.6-147

Cardinal Laboratories

*=Accredited Analyte

PLEASE NOTE: Liability and Damages. Cardinal's liability and client's exclusive remedy for any claim arising, whether based in contract or tort, shall be limited to the amount paid by client for analyses. All claims, including those for negligence and any other cause whatsoever shall be deemed waived unless made in writing and received by Cardinal within thirty (30) days after completion of the applicable service. In no event shall Cardinal be liable for incidental or consequential damages, including, without limitation, business interruptions, loss of use, or loss of profits incurred by client, its subsidiaries, affiliates or successors arising out of or related to the performance of the services hereunder by Cardinal, regardless of whether such claim is based upon any of the above stated reasons or otherwise. Results relate only to the samples identified above. This report shall not be reproduced except in full with written approval of Cardinal Laboratories.

Celey D. Keene, Lab Director/Quality Manager



PHONE (575) 393-2326 ° 101 E. MARLAND ° HOBBS, NM 88240

Notes and Definitions

ND	Analyte NOT DETECTED at or above the reporting limit
RPD	Relative Percent Difference
**	Samples not received at proper temperature of 6°C or below.
***	Insufficient time to reach temperature.
-	Chloride by SM4500Cl-B does not require samples be received at or below 6°C Samples reported on an as received basis (wet) unless otherwise noted on report

Cardinal Laboratories

*=Accredited Analyte

PLEASE NOTE: Liability and Damages. Cardinal's liability and client's exclusive remedy for any claim arising, whether based in contract or tort, shall be limited to the amount paid by client for analyses. All claims, including those for negligence and any other cause whatsoever shall be deemed waived unless made in writing and received by Cardinal within thirty (30) days after completion of the applicable service. In no event shall Cardinal be liable for incidental or consequential damages, including, without limitation, business interruptions, loss of use, or loss of profits incurred by client, its subsidiaries, affiliates or successors arising out of or related to the performance of the services hereunder by Cardinal, regardless of whether such claim is based upon any of the above stated reasons or otherwise. Results relate only to the samples identified above. This report shall not be reproduced except in full with written approval of Cardinal Laboratories.

A handwritten signature in black ink, appearing to read "Celey D. Keene".

Celey D. Keene, Lab Director/Quality Manager



101 East Marland, Hobbs, NM 88240
(575) 393-2326 FAX (575) 393-2476

+ Cardinal cannot wash shewar Dinner for within shewar to /E7E/ 202 6926



PHONE (575) 393-2326 ° 101 E. MARLAND ° HOBBS, NM 88240

February 07, 2019

LUPE CARRASCO

MMX

2737 PECOS HWY

CARLSBAD, NM 88220

RE: CACTUS STATE #9

Enclosed are the results of analyses for samples received by the laboratory on 02/06/19 14:15.

Cardinal Laboratories is accredited through Texas NELAP under certificate number T104704398-18-11. Accreditation applies to drinking water, non-potable water and solid and chemical materials. All accredited analytes are denoted by an asterisk (*). For a complete list of accredited analytes and matrices visit the TCEQ website at www.tceq.texas.gov/field/qa/lab_accred_certif.html.

Cardinal Laboratories is accredited through the State of Colorado Department of Public Health and Environment for:

Method EPA 552.2	Haloacetic Acids (HAA-5)
Method EPA 524.2	Total Trihalomethanes (TTHM)
Method EPA 524.4	Regulated VOCs (V1, V2, V3)

Accreditation applies to public drinking water matrices.

This report meets NELAP requirements and is made up of a cover page, analytical results, and a copy of the original chain-of-custody. If you have any questions concerning this report, please feel free to contact me.

Sincerely,

A handwritten signature in black ink that reads "Celey D. Keene". The signature is written in a cursive, flowing style.

Celey D. Keene

Lab Director/Quality Manager



PHONE (575) 393-2326 ° 101 E. MARLAND ° HOBBS, NM 88240

Analytical Results For:

MMX
 LUPE CARRASCO
 2737 PECOS HWY
 CARLSBAD NM, 88220
 Fax To: (575) 236-6201

Received:	02/06/2019	Sampling Date:	02/06/2019
Reported:	02/07/2019	Sampling Type:	Soil
Project Name:	CACTUS STATE #9	Sampling Condition:	Cool & Intact
Project Number:	NONE GIVEN	Sample Received By:	Jodi Henson
Project Location:	NOT GIVEN		

Sample ID: S4 -3' (H900458-01)

BTEX 8021B		mg/kg		Analyzed By: ms					
Analyte	Result	Reporting Limit	Analyzed	Method Blank	BS	% Recovery	True Value QC	RPD	Qualifier
Benzene*	<0.050	0.050	02/07/2019	ND	2.03	102	2.00	4.08	
Toluene*	<0.050	0.050	02/07/2019	ND	1.96	97.9	2.00	4.88	
Ethylbenzene*	<0.050	0.050	02/07/2019	ND	1.92	96.0	2.00	4.83	
Total Xylenes*	<0.150	0.150	02/07/2019	ND	5.82	97.0	6.00	4.36	
Total BTEX	<0.300	0.300	02/07/2019	ND					

Surrogate: 4-Bromofluorobenzene (PID) 98.9 % 73.3-129

Chloride, SM4500Cl-B		mg/kg		Analyzed By: AC					
Analyte	Result	Reporting Limit	Analyzed	Method Blank	BS	% Recovery	True Value QC	RPD	Qualifier
Chloride	96.0	16.0	02/07/2019	ND	416	104	400	3.77	

TPH 8015M		mg/kg		Analyzed By: MS					
Analyte	Result	Reporting Limit	Analyzed	Method Blank	BS	% Recovery	True Value QC	RPD	Qualifier
GRO C6-C10*	<10.0	10.0	02/06/2019	ND	198	99.1	200	1.94	
DRO >C10-C28*	710	10.0	02/06/2019	ND	208	104	200	1.75	
EXT DRO >C28-C36	121	10.0	02/06/2019	ND					

Surrogate: 1-Chlorooctane 90.2 % 41-142

Surrogate: 1-Chlorooctadecane 112 % 37.6-147

Cardinal Laboratories

*=Accredited Analyte

PLEASE NOTE: Liability and Damages. Cardinal's liability and client's exclusive remedy for any claim arising, whether based in contract or tort, shall be limited to the amount paid by client for analyses. All claims, including those for negligence and any other cause whatsoever shall be deemed waived unless made in writing and received by Cardinal within thirty (30) days after completion of the applicable service. In no event shall Cardinal be liable for incidental or consequential damages, including, without limitation, business interruptions, loss of use, or loss of profits incurred by client, its subsidiaries, affiliates or successors arising out of or related to the performance of the services hereunder by Cardinal, regardless of whether such claim is based upon any of the above stated reasons or otherwise. Results relate only to the samples identified above. This report shall not be reproduced except in full with written approval of Cardinal Laboratories.

Celey D. Keene, Lab Director/Quality Manager



PHONE (575) 393-2326 ° 101 E. MARLAND ° HOBBS, NM 88240

Analytical Results For:

MMX
 LUPE CARRASCO
 2737 PECOS HWY
 CARLSBAD NM, 88220
 Fax To: (575) 236-6201

Received: 02/06/2019
 Reported: 02/07/2019
 Project Name: CACTUS STATE #9
 Project Number: NONE GIVEN
 Project Location: NOT GIVEN

Sampling Date: 02/06/2019
 Sampling Type: Soil
 Sampling Condition: Cool & Intact
 Sample Received By: Jodi Henson

Sample ID: S4 -4' (H900458-02)

BTX 8021B		mg/kg		Analyzed By: ms						
Analyte	Result	Reporting Limit	Analyzed	Method Blank	BS	% Recovery	True Value QC	RPD	Qualifier	
Benzene*	<0.050	0.050	02/07/2019	ND	2.03	102	2.00	4.08		
Toluene*	<0.050	0.050	02/07/2019	ND	1.96	97.9	2.00	4.88		
Ethylbenzene*	<0.050	0.050	02/07/2019	ND	1.92	96.0	2.00	4.83		
Total Xylenes*	<0.150	0.150	02/07/2019	ND	5.82	97.0	6.00	4.36		
Total BTX	<0.300	0.300	02/07/2019	ND						

Surrogate: 4-Bromofluorobenzene (PID) 97.8 % 73.3-129

Chloride, SM4500Cl-B		mg/kg		Analyzed By: AC					
Analyte	Result	Reporting Limit	Analyzed	Method Blank	BS	% Recovery	True Value QC	RPD	Qualifier
Chloride	64.0	16.0	02/07/2019	ND	416	104	400	3.77	

TPH 8015M		mg/kg		Analyzed By: MS					
Analyte	Result	Reporting Limit	Analyzed	Method Blank	BS	% Recovery	True Value QC	RPD	Qualifier
GRO C6-C10*	<10.0	10.0	02/06/2019	ND	198	99.1	200	1.94	
DRO >C10-C28*	490	10.0	02/06/2019	ND	208	104	200	1.75	
EXT DRO >C28-C36	89.7	10.0	02/06/2019	ND					

Surrogate: 1-Chlorooctane 90.8 % 41-142

Surrogate: 1-Chlorooctadecane 107 % 37.6-147

Cardinal Laboratories

*=Accredited Analyte

PLEASE NOTE: Liability and Damages. Cardinal's liability and client's exclusive remedy for any claim arising, whether based in contract or tort, shall be limited to the amount paid by client for analyses. All claims, including those for negligence and any other cause whatsoever shall be deemed waived unless made in writing and received by Cardinal within thirty (30) days after completion of the applicable service. In no event shall Cardinal be liable for incidental or consequential damages, including, without limitation, business interruptions, loss of use, or loss of profits incurred by client, its subsidiaries, affiliates or successors arising out of or related to the performance of the services hereunder by Cardinal, regardless of whether such claim is based upon any of the above stated reasons or otherwise. Results relate only to the samples identified above. This report shall not be reproduced except in full with written approval of Cardinal Laboratories.

Celey D. Keene, Lab Director/Quality Manager



PHONE (575) 393-2326 ° 101 E. MARLAND ° HOBBS, NM 88240

Notes and Definitions

ND	Analyte NOT DETECTED at or above the reporting limit
RPD	Relative Percent Difference
**	Samples not received at proper temperature of 6°C or below.
***	Insufficient time to reach temperature.
-	Chloride by SM4500Cl-B does not require samples be received at or below 6°C Samples reported on an as received basis (wet) unless otherwise noted on report

Cardinal Laboratories

*=Accredited Analyte

PLEASE NOTE: Liability and Damages. Cardinal's liability and client's exclusive remedy for any claim arising, whether based in contract or tort, shall be limited to the amount paid by client for analyses. All claims, including those for negligence and any other cause whatsoever shall be deemed waived unless made in writing and received by Cardinal within thirty (30) days after completion of the applicable service. In no event shall Cardinal be liable for incidental or consequential damages, including, without limitation, business interruptions, loss of use, or loss of profits incurred by client, its subsidiaries, affiliates or successors arising out of or related to the performance of the services hereunder by Cardinal, regardless of whether such claim is based upon any of the above stated reasons or otherwise. Results relate only to the samples identified above. This report shall not be reproduced except in full with written approval of Cardinal Laboratories.

A handwritten signature in black ink, appearing to read "Celey D. Keene", written over a horizontal line.

Celey D. Keene, Lab Director/Quality Manager

10/1

(575) 393-2326 FAX (575) 393-2476

4 Cardinal Ernest Wyszynski Dinner for Cardinal Wyszynski and 15721 200 2222



PHONE (575) 393-2326 ° 101 E. MARLAND ° HOBBS, NM 88240

February 07, 2019

LUPE CARRASCO

MMX

2737 PECOS HWY

CARLSBAD, NM 88220

RE: CACTUS STATE #9

Enclosed are the results of analyses for samples received by the laboratory on 02/06/19 14:15.

Cardinal Laboratories is accredited through Texas NELAP under certificate number T104704398-18-11. Accreditation applies to drinking water, non-potable water and solid and chemical materials. All accredited analytes are denoted by an asterisk (*). For a complete list of accredited analytes and matrices visit the TCEQ website at www.tceq.texas.gov/field/qa/lab_accred_certif.html.

Cardinal Laboratories is accredited through the State of Colorado Department of Public Health and Environment for:

Method EPA 552.2	Haloacetic Acids (HAA-5)
Method EPA 524.2	Total Trihalomethanes (TTHM)
Method EPA 524.4	Regulated VOCs (V1, V2, V3)

Accreditation applies to public drinking water matrices.

This report meets NELAP requirements and is made up of a cover page, analytical results, and a copy of the original chain-of-custody. If you have any questions concerning this report, please feel free to contact me.

Sincerely,

A handwritten signature in black ink that reads "Celey D. Keene". The signature is written in a cursive style with a large, stylized 'C' and 'K'.

Celey D. Keene

Lab Director/Quality Manager



PHONE (575) 393-2326 ° 101 E. MARLAND ° HOBBS, NM 88240

Analytical Results For:

MMX
 LUPE CARRASCO
 2737 PECOS HWY
 CARLSBAD NM, 88220
 Fax To: (575) 236-6201

Received:	02/06/2019	Sampling Date:	02/06/2019
Reported:	02/07/2019	Sampling Type:	Soil
Project Name:	CACTUS STATE #9	Sampling Condition:	Cool & Intact
Project Number:	NONE GIVEN	Sample Received By:	Jodi Henson
Project Location:	NOT GIVEN		

Sample ID: S1 - 1' (H900459-01)

BTEX 8021B		mg/kg		Analyzed By: ms					
Analyte	Result	Reporting Limit	Analyzed	Method Blank	BS	% Recovery	True Value QC	RPD	Qualifier
Benzene*	<0.050	0.050	02/07/2019	ND	2.03	102	2.00	4.08	
Toluene*	<0.050	0.050	02/07/2019	ND	1.96	97.9	2.00	4.88	
Ethylbenzene*	<0.050	0.050	02/07/2019	ND	1.92	96.0	2.00	4.83	
Total Xylenes*	<0.150	0.150	02/07/2019	ND	5.82	97.0	6.00	4.36	
Total BTEX	<0.300	0.300	02/07/2019	ND					

Surrogate: 4-Bromofluorobenzene (PID) 100 % 73.3-129

Chloride, SM4500Cl-B		mg/kg		Analyzed By: AC						
Analyte	Result	Reporting Limit	Analyzed	Method Blank	BS	% Recovery	True Value QC	RPD	Qualifier	
Chloride	32.0	16.0	02/07/2019	ND	416	104	400	3.77		

TPH 8015M		mg/kg		Analyzed By: MS					
Analyte	Result	Reporting Limit	Analyzed	Method Blank	BS	% Recovery	True Value QC	RPD	Qualifier
GRO C6-C10*	<10.0	10.0	02/06/2019	ND	198	99.1	200	1.94	
DRO >C10-C28*	11.4	10.0	02/06/2019	ND	208	104	200	1.75	
EXT DRO >C28-C36	<10.0	10.0	02/06/2019	ND					

Surrogate: 1-Chlorooctane 89.7 % 41-142

Surrogate: 1-Chlorooctadecane 95.1 % 37.6-147

Cardinal Laboratories

*=Accredited Analyte

PLEASE NOTE: Liability and Damages. Cardinal's liability and client's exclusive remedy for any claim arising, whether based in contract or tort, shall be limited to the amount paid by client for analyses. All claims, including those for negligence and any other cause whatsoever shall be deemed waived unless made in writing and received by Cardinal within thirty (30) days after completion of the applicable service. In no event shall Cardinal be liable for incidental or consequential damages, including, without limitation, business interruptions, loss of use, or loss of profits incurred by client, its subsidiaries, affiliates or successors arising out of or related to the performance of the services hereunder by Cardinal, regardless of whether such claim is based upon any of the above stated reasons or otherwise. Results relate only to the samples identified above. This report shall not be reproduced except in full with written approval of Cardinal Laboratories.

Celey D. Keene, Lab Director/Quality Manager



PHONE (575) 393-2326 ° 101 E. MARLAND ° HOBBS, NM 88240

Analytical Results For:

MMX
 LUPE CARRASCO
 2737 PECOS HWY
 CARLSBAD NM, 88220
 Fax To: (575) 236-6201

Received: 02/06/2019
 Reported: 02/07/2019
 Project Name: CACTUS STATE #9
 Project Number: NONE GIVEN
 Project Location: NOT GIVEN

Sampling Date: 02/06/2019
 Sampling Type: Soil
 Sampling Condition: Cool & Intact
 Sample Received By: Jodi Henson

Sample ID: S2 - 1' (H900459-02)

BTEx 8021B		mg/kg		Analyzed By: ms					
Analyte	Result	Reporting Limit	Analyzed	Method Blank	BS	% Recovery	True Value QC	RPD	Qualifier
Benzene*	<0.050	0.050	02/07/2019	ND	2.03	102	2.00	4.08	
Toluene*	<0.050	0.050	02/07/2019	ND	1.96	97.9	2.00	4.88	
Ethylbenzene*	<0.050	0.050	02/07/2019	ND	1.92	96.0	2.00	4.83	
Total Xylenes*	<0.150	0.150	02/07/2019	ND	5.82	97.0	6.00	4.36	
Total BTEx	<0.300	0.300	02/07/2019	ND					

Surrogate: 4-Bromofluorobenzene (PID) 100 % 73.3-129

Chloride, SM4500Cl-B		mg/kg		Analyzed By: AC					
Analyte	Result	Reporting Limit	Analyzed	Method Blank	BS	% Recovery	True Value QC	RPD	Qualifier
Chloride	32.0	16.0	02/07/2019	ND	416	104	400	3.77	

TPH 8015M		mg/kg		Analyzed By: MS					
Analyte	Result	Reporting Limit	Analyzed	Method Blank	BS	% Recovery	True Value QC	RPD	Qualifier
GRO C6-C10*	<10.0	10.0	02/06/2019	ND	198	99.1	200	1.94	
DRO >C10-C28*	<10.0	10.0	02/06/2019	ND	208	104	200	1.75	
EXT DRO >C28-C36	<10.0	10.0	02/06/2019	ND					

Surrogate: 1-Chlorooctane 90.0 % 41-142

Surrogate: 1-Chlorooctadecane 97.4 % 37.6-147

Cardinal Laboratories

*=Accredited Analyte

PLEASE NOTE: Liability and Damages. Cardinal's liability and client's exclusive remedy for any claim arising, whether based in contract or tort, shall be limited to the amount paid by client for analyses. All claims, including those for negligence and any other cause whatsoever shall be deemed waived unless made in writing and received by Cardinal within thirty (30) days after completion of the applicable service. In no event shall Cardinal be liable for incidental or consequential damages, including, without limitation, business interruptions, loss of use, or loss of profits incurred by client, its subsidiaries, affiliates or successors arising out of or related to the performance of the services hereunder by Cardinal, regardless of whether such claim is based upon any of the above stated reasons or otherwise. Results relate only to the samples identified above. This report shall not be reproduced except in full with written approval of Cardinal Laboratories.

Celey D. Keene, Lab Director/Quality Manager



PHONE (575) 393-2326 ° 101 E. MARLAND ° HOBBS, NM 88240

Analytical Results For:

MMX
 LUPE CARRASCO
 2737 PECOS HWY
 CARLSBAD NM, 88220
 Fax To: (575) 236-6201

Received: 02/06/2019
 Reported: 02/07/2019
 Project Name: CACTUS STATE #9
 Project Number: NONE GIVEN
 Project Location: NOT GIVEN

Sampling Date: 02/06/2019
 Sampling Type: Soil
 Sampling Condition: Cool & Intact
 Sample Received By: Jodi Henson

Sample ID: S3 - 1' (H900459-03)

BTEx 8021B		mg/kg		Analyzed By: ms					
Analyte	Result	Reporting Limit	Analyzed	Method Blank	BS	% Recovery	True Value QC	RPD	Qualifier
Benzene*	<0.050	0.050	02/07/2019	ND	2.03	102	2.00	4.08	
Toluene*	<0.050	0.050	02/07/2019	ND	1.96	97.9	2.00	4.88	
Ethylbenzene*	<0.050	0.050	02/07/2019	ND	1.92	96.0	2.00	4.83	
Total Xylenes*	<0.150	0.150	02/07/2019	ND	5.82	97.0	6.00	4.36	
Total BTEx	<0.300	0.300	02/07/2019	ND					

Surrogate: 4-Bromofluorobenzene (PID) 99.3 % 73.3-129

Chloride, SM4500Cl-B		mg/kg		Analyzed By: AC					
Analyte	Result	Reporting Limit	Analyzed	Method Blank	BS	% Recovery	True Value QC	RPD	Qualifier
Chloride	48.0	16.0	02/07/2019	ND	416	104	400	3.77	

TPH 8015M		mg/kg		Analyzed By: MS					
Analyte	Result	Reporting Limit	Analyzed	Method Blank	BS	% Recovery	True Value QC	RPD	Qualifier
GRO C6-C10*	<10.0	10.0	02/06/2019	ND	198	99.1	200	1.94	
DRO >C10-C28*	<10.0	10.0	02/06/2019	ND	208	104	200	1.75	
EXT DRO >C28-C36	<10.0	10.0	02/06/2019	ND					

Surrogate: 1-Chlorooctane 87.5 % 41-142

Surrogate: 1-Chlorooctadecane 94.1 % 37.6-147

Cardinal Laboratories

*=Accredited Analyte

PLEASE NOTE: Liability and Damages. Cardinal's liability and client's exclusive remedy for any claim arising, whether based in contract or tort, shall be limited to the amount paid by client for analyses. All claims, including those for negligence and any other cause whatsoever shall be deemed waived unless made in writing and received by Cardinal within thirty (30) days after completion of the applicable service. In no event shall Cardinal be liable for incidental or consequential damages, including, without limitation, business interruptions, loss of use, or loss of profits incurred by client, its subsidiaries, affiliates or successors arising out of or related to the performance of the services hereunder by Cardinal, regardless of whether such claim is based upon any of the above stated reasons or otherwise. Results relate only to the samples identified above. This report shall not be reproduced except in full with written approval of Cardinal Laboratories.

Celey D. Keene, Lab Director/Quality Manager



PHONE (575) 393-2326 ° 101 E. MARLAND ° HOBBS, NM 88240

Analytical Results For:

MMX
 LUPE CARRASCO
 2737 PECOS HWY
 CARLSBAD NM, 88220
 Fax To: (575) 236-6201

Received: 02/06/2019
 Reported: 02/07/2019
 Project Name: CACTUS STATE #9
 Project Number: NONE GIVEN
 Project Location: NOT GIVEN

Sampling Date: 02/06/2019
 Sampling Type: Soil
 Sampling Condition: Cool & Intact
 Sample Received By: Jodi Henson

Sample ID: S7 - 1' (H900459-04)

BTEx 8021B		mg/kg		Analyzed By: ms					
Analyte	Result	Reporting Limit	Analyzed	Method Blank	BS	% Recovery	True Value QC	RPD	Qualifier
Benzene*	<0.050	0.050	02/07/2019	ND	2.03	102	2.00	4.08	
Toluene*	<0.050	0.050	02/07/2019	ND	1.96	97.9	2.00	4.88	
Ethylbenzene*	<0.050	0.050	02/07/2019	ND	1.92	96.0	2.00	4.83	
Total Xylenes*	<0.150	0.150	02/07/2019	ND	5.82	97.0	6.00	4.36	
Total BTEX	<0.300	0.300	02/07/2019	ND					

Surrogate: 4-Bromofluorobenzene (PID) 98.7 % 73.3-129

Chloride, SM4500Cl-B		mg/kg		Analyzed By: AC					
Analyte	Result	Reporting Limit	Analyzed	Method Blank	BS	% Recovery	True Value QC	RPD	Qualifier
Chloride	16.0	16.0	02/07/2019	ND	416	104	400	3.77	

TPH 8015M		mg/kg		Analyzed By: MS					
Analyte	Result	Reporting Limit	Analyzed	Method Blank	BS	% Recovery	True Value QC	RPD	Qualifier
GRO C6-C10*	<10.0	10.0	02/06/2019	ND	198	99.1	200	1.94	
DRO >C10-C28*	<10.0	10.0	02/06/2019	ND	208	104	200	1.75	
EXT DRO >C28-C36	<10.0	10.0	02/06/2019	ND					

Surrogate: 1-Chlorooctane 90.6 % 41-142

Surrogate: 1-Chlorooctadecane 98.0 % 37.6-147

Cardinal Laboratories

*=Accredited Analyte

PLEASE NOTE: Liability and Damages. Cardinal's liability and client's exclusive remedy for any claim arising, whether based in contract or tort, shall be limited to the amount paid by client for analyses. All claims, including those for negligence and any other cause whatsoever shall be deemed waived unless made in writing and received by Cardinal within thirty (30) days after completion of the applicable service. In no event shall Cardinal be liable for incidental or consequential damages, including, without limitation, business interruptions, loss of use, or loss of profits incurred by client, its subsidiaries, affiliates or successors arising out of or related to the performance of the services hereunder by Cardinal, regardless of whether such claim is based upon any of the above stated reasons or otherwise. Results relate only to the samples identified above. This report shall not be reproduced except in full with written approval of Cardinal Laboratories.

Celey D. Keene, Lab Director/Quality Manager



PHONE (575) 393-2326 ° 101 E. MARLAND ° HOBBS, NM 88240

Notes and Definitions

ND	Analyte NOT DETECTED at or above the reporting limit
RPD	Relative Percent Difference
**	Samples not received at proper temperature of 6°C or below.
***	Insufficient time to reach temperature.
-	Chloride by SM4500Cl-B does not require samples be received at or below 6°C Samples reported on an as received basis (wet) unless otherwise noted on report

Cardinal Laboratories

*=Accredited Analyte

PLEASE NOTE: Liability and Damages. Cardinal's liability and client's exclusive remedy for any claim arising, whether based in contract or tort, shall be limited to the amount paid by client for analyses. All claims, including those for negligence and any other cause whatsoever shall be deemed waived unless made in writing and received by Cardinal within thirty (30) days after completion of the applicable service. In no event shall Cardinal be liable for incidental or consequential damages, including, without limitation, business interruptions, loss of use, or loss of profits incurred by client, its subsidiaries, affiliates or successors arising out of or related to the performance of the services hereunder by Cardinal, regardless of whether such claim is based upon any of the above stated reasons or otherwise. Results relate only to the samples identified above. This report shall not be reproduced except in full with written approval of Cardinal Laboratories.

A handwritten signature in cursive script, appearing to read "Celey D. Keene", written in black ink.

Celey D. Keene, Lab Director/Quality Manager

CHAIN-OF-CUSTODY AND ANALYSIS REQUEST

1201

+ Cardinal cannot wash hands. Please for written abnarr to (EZE) 2022226



PHONE (575) 393-2326 ° 101 E. MARLAND ° HOBBS, NM 88240

June 04, 2019

LUPE CARRASCO

MMX

2737 PECOS HWY

CARLSBAD, NM 88220

RE: CACTUS STATE #9

Enclosed are the results of analyses for samples received by the laboratory on 06/03/19 10:20.

Cardinal Laboratories is accredited through Texas NELAP under certificate number T104704398-18-11. Accreditation applies to drinking water, non-potable water and solid and chemical materials. All accredited analytes are denoted by an asterisk (*). For a complete list of accredited analytes and matrices visit the TCEQ website at www.tceq.texas.gov/field/qa/lab_accred_certif.html.

Cardinal Laboratories is accredited through the State of Colorado Department of Public Health and Environment for:

Method EPA 552.2	Haloacetic Acids (HAA-5)
Method EPA 524.2	Total Trihalomethanes (TTHM)
Method EPA 524.4	Regulated VOCs (V1, V2, V3)

Accreditation applies to public drinking water matrices.

This report meets NELAP requirements and is made up of a cover page, analytical results, and a copy of the original chain-of-custody. If you have any questions concerning this report, please feel free to contact me.

Sincerely,

A handwritten signature in black ink that reads "Celey D. Keene". The signature is written in a cursive style with a large, stylized 'C' and 'K'.

Celey D. Keene

Lab Director/Quality Manager



PHONE (575) 393-2326 ° 101 E. MARLAND ° HOBBS, NM 88240

Analytical Results For:

MMX
 LUPE CARRASCO
 2737 PECOS HWY
 CARLSBAD NM, 88220
 Fax To: (575) 236-6201

Received:	06/03/2019	Sampling Date:	05/31/2019
Reported:	06/04/2019	Sampling Type:	Soil
Project Name:	CACTUS STATE #9	Sampling Condition:	Cool & Intact
Project Number:	NONE GIVEN	Sample Received By:	Tamara Oldaker
Project Location:	NOT GIVEN		

Sample ID: S 4 - 5' (H901933-01)

BTEX 8021B		mg/kg		Analyzed By: MS					
Analyte	Result	Reporting Limit	Analyzed	Method Blank	BS	% Recovery	True Value QC	RPD	Qualifier
Benzene*	<0.050	0.050	06/03/2019	ND	1.81	90.6	2.00	18.1	
Toluene*	<0.050	0.050	06/03/2019	ND	2.00	99.9	2.00	15.4	
Ethylbenzene*	<0.050	0.050	06/03/2019	ND	2.00	100	2.00	22.3	
Total Xylenes*	<0.150	0.150	06/03/2019	ND	6.08	101	6.00	8.72	
Total BTEX	<0.300	0.300	06/03/2019	ND					

Surrogate: 4-Bromofluorobenzene (PID) 92.0 % 73.3-129

Chloride, SM4500Cl-B		mg/kg		Analyzed By: AC						
Analyte	Result	Reporting Limit	Analyzed	Method Blank	BS	% Recovery	True Value QC	RPD	Qualifier	
Chloride	32.0	16.0	06/04/2019	ND	416	104	400	0.00		

TPH 8015M		mg/kg		Analyzed By: MS					
Analyte	Result	Reporting Limit	Analyzed	Method Blank	BS	% Recovery	True Value QC	RPD	Qualifier
GRO C6-C10*	<10.0	10.0	06/04/2019	ND	214	107	200	1.33	
DRO >C10-C28*	<10.0	10.0	06/04/2019	ND	186	93.1	200	2.90	
EXT DRO >C28-C36	<10.0	10.0	06/04/2019	ND					

Surrogate: 1-Chlorooctane 84.4 % 41-142

Surrogate: 1-Chlorooctadecane 83.6 % 37.6-147

Cardinal Laboratories

*=Accredited Analyte

PLEASE NOTE: Liability and Damages. Cardinal's liability and client's exclusive remedy for any claim arising, whether based in contract or tort, shall be limited to the amount paid by client for analyses. All claims, including those for negligence and any other cause whatsoever shall be deemed waived unless made in writing and received by Cardinal within thirty (30) days after completion of the applicable service. In no event shall Cardinal be liable for incidental or consequential damages, including, without limitation, business interruptions, loss of use, or loss of profits incurred by client, its subsidiaries, affiliates or successors arising out of or related to the performance of the services hereunder by Cardinal, regardless of whether such claim is based upon any of the above stated reasons or otherwise. Results relate only to the samples identified above. This report shall not be reproduced except in full with written approval of Cardinal Laboratories.

Celey D. Keene, Lab Director/Quality Manager



PHONE (575) 393-2326 ° 101 E. MARLAND ° HOBBS, NM 88240

Notes and Definitions

QR-04	The RPD for the BS/BSD was outside of historical limits.
ND	Analyte NOT DETECTED at or above the reporting limit
RPD	Relative Percent Difference
**	Samples not received at proper temperature of 6°C or below.
***	Insufficient time to reach temperature.
-	Chloride by SM4500Cl-B does not require samples be received at or below 6°C Samples reported on an as received basis (wet) unless otherwise noted on report

Cardinal Laboratories

*=Accredited Analyte

PLEASE NOTE: Liability and Damages. Cardinal's liability and client's exclusive remedy for any claim arising, whether based in contract or tort, shall be limited to the amount paid by client for analyses. All claims, including those for negligence and any other cause whatsoever shall be deemed waived unless made in writing and received by Cardinal within thirty (30) days after completion of the applicable service. In no event shall Cardinal be liable for incidental or consequential damages, including, without limitation, business interruptions, loss of use, or loss of profits incurred by client, its subsidiaries, affiliates or successors arising out of or related to the performance of the services hereunder by Cardinal, regardless of whether such claim is based upon any of the above stated reasons or otherwise. Results relate only to the samples identified above. This report shall not be reproduced except in full with written approval of Cardinal Laboratories.

A handwritten signature in black ink, appearing to read "Celey D. Keene".

Celey D. Keene, Lab Director/Quality Manager

101 East Marland, Hobbs, NM 88240
(575) 393-2326 FAX (575) 393-2476

+ Cardinal cannot wash hands. Please for written response to (EZE) 000 0000

Rush! - added 6/3/19 @ 13:31 TO



PHONE (575) 393-2326 ° 101 E. MARLAND ° HOBBS, NM 88240

July 21, 2020

LYNN A ACOSTA

SOUDER MILLER AND ASSOCIATES

201 S. HALAGUENO

CARLSBAD, NM 88220

RE: CACTUS STATE #9

Enclosed are the results of analyses for samples received by the laboratory on 07/16/20 15:20.

Cardinal Laboratories is accredited through Texas NELAP under certificate number T104704398-20-13. Accreditation applies to drinking water, non-potable water and solid and chemical materials. All accredited analytes are denoted by an asterisk (*). For a complete list of accredited analytes and matrices visit the TCEQ website at www.tceq.texas.gov/field/qa/lab_accred_certif.html.

Cardinal Laboratories is accredited through the State of Colorado Department of Public Health and Environment for:

Method EPA 552.2	Haloacetic Acids (HAA-5)
Method EPA 524.2	Total Trihalomethanes (TTHM)
Method EPA 524.4	Regulated VOCs (V1, V2, V3)

Accreditation applies to public drinking water matrices.

This report meets NELAP requirements and is made up of a cover page, analytical results, and a copy of the original chain-of-custody. If you have any questions concerning this report, please feel free to contact me.

Sincerely,

A handwritten signature in black ink that reads "Celey D. Keene". The signature is written in a cursive style with a large, stylized "C" at the beginning.

Celey D. Keene

Lab Director/Quality Manager



PHONE (575) 393-2326 • 101 E. MARLAND • HOBBS, NM 88240

Analytical Results For:

SOUDER MILLER AND ASSOCIATES
 LYNN A ACOSTA
 201 S. HALAGUENO
 CARLSBAD NM, 88220
 Fax To: NONE

Received:	07/16/2020	Sampling Date:	07/16/2020
Reported:	07/21/2020	Sampling Type:	Soil
Project Name:	CACTUS STATE #9	Sampling Condition:	Cool & Intact
Project Number:	NONE GIVEN	Sample Received By:	Tamara Oldaker
Project Location:	DEVON ENERGY - CARLSBAD, NM		

Sample ID: SW 1 (H001862-01)

BTEX 8021B		mg/kg		Analyzed By: MS						
Analyte	Result	Reporting Limit	Analyzed	Method Blank	BS	% Recovery	True Value QC	RPD	Qualifier	
Benzene*	<0.050	0.050	07/17/2020	ND	1.90	95.0	2.00	2.56		
Toluene*	<0.050	0.050	07/17/2020	ND	1.91	95.6	2.00	2.56		
Ethylbenzene*	<0.050	0.050	07/17/2020	ND	1.92	96.1	2.00	2.85		
Total Xylenes*	<0.150	0.150	07/17/2020	ND	5.55	92.5	6.00	2.84		
Total BTEX	<0.300	0.300	07/17/2020	ND						

Surrogate: 4-Bromofluorobenzene (PID) 94.9 % 73.3-129

Chloride, SM4500Cl-B		mg/kg		Analyzed By: GM						
Analyte	Result	Reporting Limit	Analyzed	Method Blank	BS	% Recovery	True Value QC	RPD	Qualifier	
Chloride	48.0	16.0	07/20/2020	ND	416	104	400	0.00		

TPH 8015M		mg/kg		Analyzed By: MS					
Analyte	Result	Reporting Limit	Analyzed	Method Blank	BS	% Recovery	True Value QC	RPD	Qualifier
GRO C6-C10*	<10.0	10.0	07/17/2020	ND	209	105	200	2.37	
DRO >C10-C28*	<10.0	10.0	07/17/2020	ND	228	114	200	0.662	
EXT DRO >C28-C36	<10.0	10.0	07/17/2020	ND					

Surrogate: 1-Chlorooctane 89.2 % 44.3-144

Surrogate: 1-Chlorooctadecane 89.3 % 42.2-156

Cardinal Laboratories

*=Accredited Analyte

PLEASE NOTE: Liability and Damages. Cardinal's liability and client's exclusive remedy for any claim arising, whether based in contract or tort, shall be limited to the amount paid by client for analyses. All claims, including those for negligence and any other cause whatsoever shall be deemed waived unless made in writing and received by Cardinal within thirty (30) days after completion of the applicable service. In no event shall Cardinal be liable for incidental or consequential damages, including, without limitation, business interruptions, loss of use, or loss of profits incurred by client, its subsidiaries, affiliates or successors arising out of or related to the performance of the services hereunder by Cardinal, regardless of whether such claim is based upon any of the above stated reasons or otherwise. Results relate only to the samples identified above. This report shall not be reproduced except in full with written approval of Cardinal Laboratories.

Celey D. Keene, Lab Director/Quality Manager



PHONE (575) 393-2326 ° 101 E. MARLAND ° HOBBS, NM 88240

Analytical Results For:

SOUDER MILLER AND ASSOCIATES
 LYNN A ACOSTA
 201 S. HALAGUENO
 CARLSBAD NM, 88220
 Fax To: NONE

Received:	07/16/2020	Sampling Date:	07/16/2020
Reported:	07/21/2020	Sampling Type:	Soil
Project Name:	CACTUS STATE #9	Sampling Condition:	Cool & Intact
Project Number:	NONE GIVEN	Sample Received By:	Tamara Oldaker
Project Location:	DEVON ENERGY - CARLSBAD, NM		

Sample ID: SW 2 (H001862-02)

BTX 8021B		mg/kg		Analyzed By: MS						
Analyte	Result	Reporting Limit	Analyzed	Method Blank	BS	% Recovery	True Value QC	RPD	Qualifier	
Benzene*	<0.050	0.050	07/17/2020	ND	1.90	95.0	2.00	2.56		
Toluene*	<0.050	0.050	07/17/2020	ND	1.91	95.6	2.00	2.56		
Ethylbenzene*	<0.050	0.050	07/17/2020	ND	1.92	96.1	2.00	2.85		
Total Xylenes*	<0.150	0.150	07/17/2020	ND	5.55	92.5	6.00	2.84		
Total BTX	<0.300	0.300	07/17/2020	ND						

Surrogate: 4-Bromofluorobenzene (PID) 95.9 % 73.3-129

Chloride, SM4500CI-B		mg/kg		Analyzed By: GM					
Analyte	Result	Reporting Limit	Analyzed	Method Blank	BS	% Recovery	True Value QC	RPD	Qualifier
Chloride	64.0	16.0	07/20/2020	ND	416	104	400	0.00	

TPH 8015M		mg/kg		Analyzed By: MS					
Analyte	Result	Reporting Limit	Analyzed	Method Blank	BS	% Recovery	True Value QC	RPD	Qualifier
GRO C6-C10*	<10.0	10.0	07/17/2020	ND	209	105	200	2.37	
DRO >C10-C28*	<10.0	10.0	07/17/2020	ND	228	114	200	0.662	
EXT DRO >C28-C36	<10.0	10.0	07/17/2020	ND					

Surrogate: 1-Chlorooctane 98.1 % 44.3-144

Surrogate: 1-Chlorooctadecane 99.0 % 42.2-156

Cardinal Laboratories

*=Accredited Analyte

PLEASE NOTE: Liability and Damages. Cardinal's liability and client's exclusive remedy for any claim arising, whether based in contract or tort, shall be limited to the amount paid by client for analyses. All claims, including those for negligence and any other cause whatsoever shall be deemed waived unless made in writing and received by Cardinal within thirty (30) days after completion of the applicable service. In no event shall Cardinal be liable for incidental or consequential damages, including, without limitation, business interruptions, loss of use, or loss of profits incurred by client, its subsidiaries, affiliates or successors arising out of or related to the performance of the services hereunder by Cardinal, regardless of whether such claim is based upon any of the above stated reasons or otherwise. Results relate only to the samples identified above. This report shall not be reproduced except in full with written approval of Cardinal Laboratories.

Celey D. Keene, Lab Director/Quality Manager



PHONE (575) 393-2326 ° 101 E. MARLAND ° HOBBS, NM 88240

Analytical Results For:

SOUDER MILLER AND ASSOCIATES
 LYNN A ACOSTA
 201 S. HALAGUENO
 CARLSBAD NM, 88220
 Fax To: NONE

Received:	07/16/2020	Sampling Date:	07/16/2020
Reported:	07/21/2020	Sampling Type:	Soil
Project Name:	CACTUS STATE #9	Sampling Condition:	Cool & Intact
Project Number:	NONE GIVEN	Sample Received By:	Tamara Oldaker
Project Location:	DEVON ENERGY - CARLSBAD, NM		

Sample ID: SW 3 (H001862-03)

BTX 8021B		mg/kg		Analyzed By: MS						
Analyte	Result	Reporting Limit	Analyzed	Method Blank	BS	% Recovery	True Value QC	RPD	Qualifier	
Benzene*	<0.050	0.050	07/17/2020	ND	1.90	95.0	2.00	2.56		
Toluene*	<0.050	0.050	07/17/2020	ND	1.91	95.6	2.00	2.56		
Ethylbenzene*	<0.050	0.050	07/17/2020	ND	1.92	96.1	2.00	2.85		
Total Xylenes*	<0.150	0.150	07/17/2020	ND	5.55	92.5	6.00	2.84		
Total BTX	<0.300	0.300	07/17/2020	ND						

Surrogate: 4-Bromofluorobenzene (PID) 95.6 % 73.3-129

Chloride, SM4500CI-B		mg/kg		Analyzed By: GM					
Analyte	Result	Reporting Limit	Analyzed	Method Blank	BS	% Recovery	True Value QC	RPD	Qualifier
Chloride	32.0	16.0	07/20/2020	ND	416	104	400	0.00	

TPH 8015M		mg/kg		Analyzed By: MS					
Analyte	Result	Reporting Limit	Analyzed	Method Blank	BS	% Recovery	True Value QC	RPD	Qualifier
GRO C6-C10*	<10.0	10.0	07/17/2020	ND	209	105	200	2.37	
DRO >C10-C28*	<10.0	10.0	07/17/2020	ND	228	114	200	0.662	
EXT DRO >C28-C36	<10.0	10.0	07/17/2020	ND					

Surrogate: 1-Chlorooctane 99.5 % 44.3-144

Surrogate: 1-Chlorooctadecane 98.7 % 42.2-156

Cardinal Laboratories

*=Accredited Analyte

PLEASE NOTE: Liability and Damages. Cardinal's liability and client's exclusive remedy for any claim arising, whether based in contract or tort, shall be limited to the amount paid by client for analyses. All claims, including those for negligence and any other cause whatsoever shall be deemed waived unless made in writing and received by Cardinal within thirty (30) days after completion of the applicable service. In no event shall Cardinal be liable for incidental or consequential damages, including, without limitation, business interruptions, loss of use, or loss of profits incurred by client, its subsidiaries, affiliates or successors arising out of or related to the performance of the services hereunder by Cardinal, regardless of whether such claim is based upon any of the above stated reasons or otherwise. Results relate only to the samples identified above. This report shall not be reproduced except in full with written approval of Cardinal Laboratories.

Celey D. Keene, Lab Director/Quality Manager



PHONE (575) 393-2326 ° 101 E. MARLAND ° HOBBS, NM 88240

Analytical Results For:

SOUDER MILLER AND ASSOCIATES
 LYNN A ACOSTA
 201 S. HALAGUENO
 CARLSBAD NM, 88220
 Fax To: NONE

Received:	07/16/2020	Sampling Date:	07/16/2020
Reported:	07/21/2020	Sampling Type:	Soil
Project Name:	CACTUS STATE #9	Sampling Condition:	Cool & Intact
Project Number:	NONE GIVEN	Sample Received By:	Tamara Oldaker
Project Location:	DEVON ENERGY - CARLSBAD, NM		

Sample ID: SW 4 (H001862-04)

BTX 8021B		mg/kg		Analyzed By: MS						
Analyte	Result	Reporting Limit	Analyzed	Method Blank	BS	% Recovery	True Value QC	RPD	Qualifier	
Benzene*	<0.050	0.050	07/17/2020	ND	1.90	95.0	2.00	2.56		
Toluene*	<0.050	0.050	07/17/2020	ND	1.91	95.6	2.00	2.56		
Ethylbenzene*	<0.050	0.050	07/17/2020	ND	1.92	96.1	2.00	2.85		
Total Xylenes*	<0.150	0.150	07/17/2020	ND	5.55	92.5	6.00	2.84		
Total BTX	<0.300	0.300	07/17/2020	ND						

Surrogate: 4-Bromofluorobenzene (PID) 94.5 % 73.3-129

Chloride, SM4500CI-B		mg/kg		Analyzed By: GM						
Analyte	Result	Reporting Limit	Analyzed	Method Blank	BS	% Recovery	True Value QC	RPD	Qualifier	
Chloride	64.0	16.0	07/20/2020	ND	416	104	400	0.00		

TPH 8015M		mg/kg		Analyzed By: MS					
Analyte	Result	Reporting Limit	Analyzed	Method Blank	BS	% Recovery	True Value QC	RPD	Qualifier
GRO C6-C10*	<10.0	10.0	07/17/2020	ND	209	105	200	2.37	
DRO >C10-C28*	<10.0	10.0	07/17/2020	ND	228	114	200	0.662	
EXT DRO >C28-C36	<10.0	10.0	07/17/2020	ND					

Surrogate: 1-Chlorooctane 109 % 44.3-144

Surrogate: 1-Chlorooctadecane 113 % 42.2-156

Cardinal Laboratories

*=Accredited Analyte

PLEASE NOTE: Liability and Damages. Cardinal's liability and client's exclusive remedy for any claim arising, whether based in contract or tort, shall be limited to the amount paid by client for analyses. All claims, including those for negligence and any other cause whatsoever shall be deemed waived unless made in writing and received by Cardinal within thirty (30) days after completion of the applicable service. In no event shall Cardinal be liable for incidental or consequential damages, including, without limitation, business interruptions, loss of use, or loss of profits incurred by client, its subsidiaries, affiliates or successors arising out of or related to the performance of the services hereunder by Cardinal, regardless of whether such claim is based upon any of the above stated reasons or otherwise. Results relate only to the samples identified above. This report shall not be reproduced except in full with written approval of Cardinal Laboratories.

Celey D. Keene, Lab Director/Quality Manager



PHONE (575) 393-2326 ° 101 E. MARLAND ° HOBBS, NM 88240

Analytical Results For:

SOUDER MILLER AND ASSOCIATES
 LYNN A ACOSTA
 201 S. HALAGUENO
 CARLSBAD NM, 88220
 Fax To: NONE

Received:	07/16/2020	Sampling Date:	07/16/2020
Reported:	07/21/2020	Sampling Type:	Soil
Project Name:	CACTUS STATE #9	Sampling Condition:	Cool & Intact
Project Number:	NONE GIVEN	Sample Received By:	Tamara Oldaker
Project Location:	DEVON ENERGY - CARLSBAD, NM		

Sample ID: SW 5 (H001862-05)

BTX 8021B		mg/kg		Analyzed By: MS						
Analyte	Result	Reporting Limit	Analyzed	Method Blank	BS	% Recovery	True Value QC	RPD	Qualifier	
Benzene*	<0.050	0.050	07/17/2020	ND	1.90	95.0	2.00	2.56		
Toluene*	<0.050	0.050	07/17/2020	ND	1.91	95.6	2.00	2.56		
Ethylbenzene*	<0.050	0.050	07/17/2020	ND	1.92	96.1	2.00	2.85		
Total Xylenes*	<0.150	0.150	07/17/2020	ND	5.55	92.5	6.00	2.84		
Total BTX	<0.300	0.300	07/17/2020	ND						

Surrogate: 4-Bromofluorobenzene (PID) 95.7 % 73.3-129

Chloride, SM4500CI-B		mg/kg		Analyzed By: GM						
Analyte	Result	Reporting Limit	Analyzed	Method Blank	BS	% Recovery	True Value QC	RPD	Qualifier	
Chloride	32.0	16.0	07/20/2020	ND	416	104	400	0.00		

TPH 8015M		mg/kg		Analyzed By: MS					
Analyte	Result	Reporting Limit	Analyzed	Method Blank	BS	% Recovery	True Value QC	RPD	Qualifier
GRO C6-C10*	<10.0	10.0	07/17/2020	ND	209	105	200	2.37	
DRO >C10-C28*	<10.0	10.0	07/17/2020	ND	228	114	200	0.662	
EXT DRO >C28-C36	<10.0	10.0	07/17/2020	ND					

Surrogate: 1-Chlorooctane 101 % 44.3-144

Surrogate: 1-Chlorooctadecane 103 % 42.2-156

Cardinal Laboratories

*=Accredited Analyte

PLEASE NOTE: Liability and Damages. Cardinal's liability and client's exclusive remedy for any claim arising, whether based in contract or tort, shall be limited to the amount paid by client for analyses. All claims, including those for negligence and any other cause whatsoever shall be deemed waived unless made in writing and received by Cardinal within thirty (30) days after completion of the applicable service. In no event shall Cardinal be liable for incidental or consequential damages, including, without limitation, business interruptions, loss of use, or loss of profits incurred by client, its subsidiaries, affiliates or successors arising out of or related to the performance of the services hereunder by Cardinal, regardless of whether such claim is based upon any of the above stated reasons or otherwise. Results relate only to the samples identified above. This report shall not be reproduced except in full with written approval of Cardinal Laboratories.

Celey D. Keene, Lab Director/Quality Manager



PHONE (575) 393-2326 ° 101 E. MARLAND ° HOBBS, NM 88240

Analytical Results For:

SOUDER MILLER AND ASSOCIATES
 LYNN A ACOSTA
 201 S. HALAGUENO
 CARLSBAD NM, 88220
 Fax To: NONE

Received:	07/16/2020	Sampling Date:	07/16/2020
Reported:	07/21/2020	Sampling Type:	Soil
Project Name:	CACTUS STATE #9	Sampling Condition:	Cool & Intact
Project Number:	NONE GIVEN	Sample Received By:	Tamara Oldaker
Project Location:	DEVON ENERGY - CARLSBAD, NM		

Sample ID: SW 6 (H001862-06)

BTX 8021B		mg/kg		Analyzed By: MS						
Analyte	Result	Reporting Limit	Analyzed	Method Blank	BS	% Recovery	True Value QC	RPD	Qualifier	
Benzene*	<0.050	0.050	07/17/2020	ND	1.90	95.0	2.00	2.56		
Toluene*	<0.050	0.050	07/17/2020	ND	1.91	95.6	2.00	2.56		
Ethylbenzene*	<0.050	0.050	07/17/2020	ND	1.92	96.1	2.00	2.85		
Total Xylenes*	<0.150	0.150	07/17/2020	ND	5.55	92.5	6.00	2.84		
Total BTX	<0.300	0.300	07/17/2020	ND						

Surrogate: 4-Bromofluorobenzene (PID) 95.3 % 73.3-129

Chloride, SM4500CI-B		mg/kg		Analyzed By: GM						
Analyte	Result	Reporting Limit	Analyzed	Method Blank	BS	% Recovery	True Value QC	RPD	Qualifier	
Chloride	48.0	16.0	07/20/2020	ND	416	104	400	0.00		

TPH 8015M		mg/kg		Analyzed By: MS					
Analyte	Result	Reporting Limit	Analyzed	Method Blank	BS	% Recovery	True Value QC	RPD	Qualifier
GRO C6-C10*	<10.0	10.0	07/18/2020	ND	209	105	200	2.37	
DRO >C10-C28*	<10.0	10.0	07/18/2020	ND	228	114	200	0.662	
EXT DRO >C28-C36	<10.0	10.0	07/18/2020	ND					

Surrogate: 1-Chlorooctane 89.8 % 44.3-144

Surrogate: 1-Chlorooctadecane 90.7 % 42.2-156

Cardinal Laboratories

*=Accredited Analyte

PLEASE NOTE: Liability and Damages. Cardinal's liability and client's exclusive remedy for any claim arising, whether based in contract or tort, shall be limited to the amount paid by client for analyses. All claims, including those for negligence and any other cause whatsoever shall be deemed waived unless made in writing and received by Cardinal within thirty (30) days after completion of the applicable service. In no event shall Cardinal be liable for incidental or consequential damages, including, without limitation, business interruptions, loss of use, or loss of profits incurred by client, its subsidiaries, affiliates or successors arising out of or related to the performance of the services hereunder by Cardinal, regardless of whether such claim is based upon any of the above stated reasons or otherwise. Results relate only to the samples identified above. This report shall not be reproduced except in full with written approval of Cardinal Laboratories.

Celey D. Keene, Lab Director/Quality Manager



PHONE (575) 393-2326 ° 101 E. MARLAND ° HOBBS, NM 88240

Analytical Results For:

SOUDER MILLER AND ASSOCIATES
 LYNN A ACOSTA
 201 S. HALAGUENO
 CARLSBAD NM, 88220
 Fax To: NONE

Received:	07/16/2020	Sampling Date:	07/16/2020
Reported:	07/21/2020	Sampling Type:	Soil
Project Name:	CACTUS STATE #9	Sampling Condition:	Cool & Intact
Project Number:	NONE GIVEN	Sample Received By:	Tamara Oldaker
Project Location:	DEVON ENERGY - CARLSBAD, NM		

Sample ID: SW 7 (H001862-07)

BTX 8021B		mg/kg		Analyzed By: MS						
Analyte	Result	Reporting Limit	Analyzed	Method Blank	BS	% Recovery	True Value QC	RPD	Qualifier	
Benzene*	<0.050	0.050	07/17/2020	ND	1.90	95.0	2.00	2.56		
Toluene*	<0.050	0.050	07/17/2020	ND	1.91	95.6	2.00	2.56		
Ethylbenzene*	<0.050	0.050	07/17/2020	ND	1.92	96.1	2.00	2.85		
Total Xylenes*	<0.150	0.150	07/17/2020	ND	5.55	92.5	6.00	2.84		
Total BTX	<0.300	0.300	07/17/2020	ND						

Surrogate: 4-Bromofluorobenzene (PID) 96.3 % 73.3-129

Chloride, SM4500CI-B		mg/kg		Analyzed By: GM					
Analyte	Result	Reporting Limit	Analyzed	Method Blank	BS	% Recovery	True Value QC	RPD	Qualifier
Chloride	48.0	16.0	07/20/2020	ND	416	104	400	0.00	

TPH 8015M		mg/kg		Analyzed By: MS					
Analyte	Result	Reporting Limit	Analyzed	Method Blank	BS	% Recovery	True Value QC	RPD	Qualifier
GRO C6-C10*	<10.0	10.0	07/18/2020	ND	209	105	200	2.37	
DRO >C10-C28*	<10.0	10.0	07/18/2020	ND	228	114	200	0.662	
EXT DRO >C28-C36	<10.0	10.0	07/18/2020	ND					

Surrogate: 1-Chlorooctane 95.3 % 44.3-144

Surrogate: 1-Chlorooctadecane 99.5 % 42.2-156

Cardinal Laboratories

*=Accredited Analyte

PLEASE NOTE: Liability and Damages. Cardinal's liability and client's exclusive remedy for any claim arising, whether based in contract or tort, shall be limited to the amount paid by client for analyses. All claims, including those for negligence and any other cause whatsoever shall be deemed waived unless made in writing and received by Cardinal within thirty (30) days after completion of the applicable service. In no event shall Cardinal be liable for incidental or consequential damages, including, without limitation, business interruptions, loss of use, or loss of profits incurred by client, its subsidiaries, affiliates or successors arising out of or related to the performance of the services hereunder by Cardinal, regardless of whether such claim is based upon any of the above stated reasons or otherwise. Results relate only to the samples identified above. This report shall not be reproduced except in full with written approval of Cardinal Laboratories.

Celey D. Keene, Lab Director/Quality Manager



PHONE (575) 393-2326 ° 101 E. MARLAND ° HOBBS, NM 88240

Analytical Results For:

SOUDER MILLER AND ASSOCIATES
 LYNN A ACOSTA
 201 S. HALAGUENO
 CARLSBAD NM, 88220
 Fax To: NONE

Received:	07/16/2020	Sampling Date:	07/16/2020
Reported:	07/21/2020	Sampling Type:	Soil
Project Name:	CACTUS STATE #9	Sampling Condition:	Cool & Intact
Project Number:	NONE GIVEN	Sample Received By:	Tamara Oldaker
Project Location:	DEVON ENERGY - CARLSBAD, NM		

Sample ID: SW 8 (H001862-08)

BTX 8021B		mg/kg		Analyzed By: MS						
Analyte	Result	Reporting Limit	Analyzed	Method Blank	BS	% Recovery	True Value QC	RPD	Qualifier	
Benzene*	<0.050	0.050	07/17/2020	ND	1.90	95.0	2.00	2.56		
Toluene*	<0.050	0.050	07/17/2020	ND	1.91	95.6	2.00	2.56		
Ethylbenzene*	<0.050	0.050	07/17/2020	ND	1.92	96.1	2.00	2.85		
Total Xylenes*	<0.150	0.150	07/17/2020	ND	5.55	92.5	6.00	2.84		
Total BTX	<0.300	0.300	07/17/2020	ND						

Surrogate: 4-Bromofluorobenzene (PID) 94.5 % 73.3-129

Chloride, SM4500CI-B		mg/kg		Analyzed By: GM					
Analyte	Result	Reporting Limit	Analyzed	Method Blank	BS	% Recovery	True Value QC	RPD	Qualifier
Chloride	32.0	16.0	07/20/2020	ND	416	104	400	0.00	

TPH 8015M		mg/kg		Analyzed By: MS					
Analyte	Result	Reporting Limit	Analyzed	Method Blank	BS	% Recovery	True Value QC	RPD	Qualifier
GRO C6-C10*	<10.0	10.0	07/18/2020	ND	209	105	200	2.37	
DRO >C10-C28*	<10.0	10.0	07/18/2020	ND	228	114	200	0.662	
EXT DRO >C28-C36	<10.0	10.0	07/18/2020	ND					

Surrogate: 1-Chlorooctane 93.9 % 44.3-144

Surrogate: 1-Chlorooctadecane 95.0 % 42.2-156

Cardinal Laboratories

*=Accredited Analyte

PLEASE NOTE: Liability and Damages. Cardinal's liability and client's exclusive remedy for any claim arising, whether based in contract or tort, shall be limited to the amount paid by client for analyses. All claims, including those for negligence and any other cause whatsoever shall be deemed waived unless made in writing and received by Cardinal within thirty (30) days after completion of the applicable service. In no event shall Cardinal be liable for incidental or consequential damages, including, without limitation, business interruptions, loss of use, or loss of profits incurred by client, its subsidiaries, affiliates or successors arising out of or related to the performance of the services hereunder by Cardinal, regardless of whether such claim is based upon any of the above stated reasons or otherwise. Results relate only to the samples identified above. This report shall not be reproduced except in full with written approval of Cardinal Laboratories.

Celey D. Keene, Lab Director/Quality Manager



PHONE (575) 393-2326 ° 101 E. MARLAND ° HOBBS, NM 88240

Notes and Definitions

ND	Analyte NOT DETECTED at or above the reporting limit
RPD	Relative Percent Difference
**	Samples not received at proper temperature of 6°C or below.
***	Insufficient time to reach temperature.
-	Chloride by SM4500Cl-B does not require samples be received at or below 6°C Samples reported on an as received basis (wet) unless otherwise noted on report

Cardinal Laboratories

*=Accredited Analyte

PLEASE NOTE: Liability and Damages. Cardinal's liability and client's exclusive remedy for any claim arising, whether based in contract or tort, shall be limited to the amount paid by client for analyses. All claims, including those for negligence and any other cause whatsoever shall be deemed waived unless made in writing and received by Cardinal within thirty (30) days after completion of the applicable service. In no event shall Cardinal be liable for incidental or consequential damages, including, without limitation, business interruptions, loss of use, or loss of profits incurred by client, its subsidiaries, affiliates or successors arising out of or related to the performance of the services hereunder by Cardinal, regardless of whether such claim is based upon any of the above stated reasons or otherwise. Results relate only to the samples identified above. This report shall not be reproduced except in full with written approval of Cardinal Laboratories.

A handwritten signature in black ink, appearing to read "Celey D. Keene".

Celey D. Keene, Lab Director/Quality Manager



CHAIN-OF-CUSTODY AND ANALYSIS REQUEST

101 East Marland, Hobbs, NM 88240
(575) 393-2326 FAX (575) 393-2476

Company Name: Souder Miller & Associates		BILL TO	
Project Manager: Lynn A. Acosta		P.O. #:	
Address: 261 S. Hialeghero St		Company:	
City: Carlsbad		Attn:	
State: NM Zip: 88220		Address:	
Phone #: (505) 516-7469 Fax #:		City:	
Project #:		State:	
Project Name: Cactus State #9		Zip:	
Project Location: Carlsbad, NM		Phone #:	
Sample Name: CA		Fax #:	

FOR LAB USE ONLY	
Lab I.D. 4201812	Sample I.D.
	(G)RAB OR (C)OMP.
	# CONTAINERS
	GROUNDWATER
	WASTEWATER
	SOIL
	OIL
	SLUDGE
	OTHER :
	ACID/BASE:
	ICE / COOL
	OTHER :
	MATRIX
	PRESERV.
	SAMPLING
	DATE
	TIME

PLEASE NOTE: Liability and Damages Cardinal's liability and client's exclusive remedy for any claim arising whether based in contract or tort, shall be limited to the amount paid by the client for the analyses. All claims including those for negligence and any other cause whatsoever shall be deemed waived unless made in writing and received by Cardinal within 30 days after completion of the applicable service. In no event shall Cardinal be liable for incidental or consequential damages, including without limitation, business interruptions, loss of use, or loss of profits incurred by client, its subsidiaries, affiliates or successors arising out of or related to the performance of services hereunder by Cardinal, regardless of whether such claim is based upon any of the above stated reasons or otherwise.	<table border="1" style="width:100%; border-collapse: collapse;"> <tr> <th>Lab I.D.</th> <th>Sample I.D.</th> <th>DATE</th> <th>TIME</th> <th>TESTS</th> <th>RESULTS</th> <th>REMARKS</th> </tr> <tr> <td>4201812</td> <td>SW1</td> <td>7/18/20</td> <td>8:00</td> <td>X</td> <td>BTEX (8021)</td> <td></td> </tr> <tr> <td>2</td> <td>SW2</td> <td></td> <td>8:05</td> <td>X</td> <td>TPH (8015) (GRO/DEQ/MRO)</td> <td></td> </tr> <tr> <td>3</td> <td>SW3</td> <td></td> <td>8:12</td> <td>X</td> <td>CI-</td> <td></td> </tr> <tr> <td>4</td> <td>SW4</td> <td></td> <td>8:09</td> <td></td> <td></td> <td></td> </tr> <tr> <td>5</td> <td>SW5</td> <td></td> <td>8:14</td> <td></td> <td></td> <td></td> </tr> <tr> <td>6</td> <td>SW6</td> <td></td> <td>8:18</td> <td></td> <td></td> <td></td> </tr> <tr> <td>7</td> <td>SW7</td> <td></td> <td>8:20</td> <td></td> <td></td> <td></td> </tr> <tr> <td>8</td> <td>SW8</td> <td></td> <td>8:22</td> <td></td> <td></td> <td></td> </tr> </table>	Lab I.D.	Sample I.D.	DATE	TIME	TESTS	RESULTS	REMARKS	4201812	SW1	7/18/20	8:00	X	BTEX (8021)		2	SW2		8:05	X	TPH (8015) (GRO/DEQ/MRO)		3	SW3		8:12	X	CI-		4	SW4		8:09				5	SW5		8:14				6	SW6		8:18				7	SW7		8:20				8	SW8		8:22			
Lab I.D.	Sample I.D.	DATE	TIME	TESTS	RESULTS	REMARKS																																																										
4201812	SW1	7/18/20	8:00	X	BTEX (8021)																																																											
2	SW2		8:05	X	TPH (8015) (GRO/DEQ/MRO)																																																											
3	SW3		8:12	X	CI-																																																											
4	SW4		8:09																																																													
5	SW5		8:14																																																													
6	SW6		8:18																																																													
7	SW7		8:20																																																													
8	SW8		8:22																																																													

Relinquished By: Lynn A. Acosta Date: 7/18/20 Time: 1520	Received By: Lynn A. Acosta Date: 7/18/20 Time: 1520
REMARKS: Email results: Lynn.Acosta@SouderMiller.com	

Delivered By: (Circle One) Sampler - UPS - Bus - Other:	Sample Condition Cool <input checked="" type="checkbox"/> Intact <input type="checkbox"/> Yes <input checked="" type="checkbox"/> No <input type="checkbox"/> Checked By: VB
--	--

Appendix D



M & M EXCAVATING, INC.

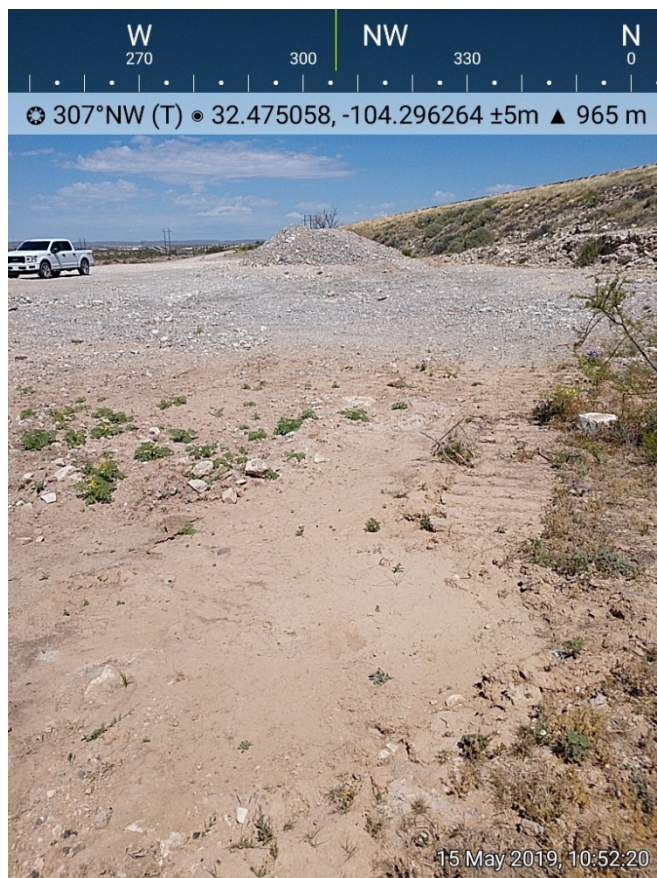







Permian Basin

Customer: CASH-Halfway
 Customer #: CRI1770
 Ordered by: NORMAN FAVER
 AFE #:
 PO #:
 Manifest #: 391203
 Manif. Date: 5/20/2019
 Hauler: SUNRISE TRUCKING
 Driver: MANUEL
 Truck #: 2872
 Card #
 Job Ref #

Ticket #: 700-1011832
 Bid #: Walk-in Bid
 Date: 5/20/2019
 Generator: DEVON ENERGY PRODUCTIO
 Generator #:
 Well Ser. #: 27236
 Well Name: CACTUS STATE
 Well #: 001
 Field:
 Field #:
 Rig: NON-DRILLING
 County: EDDY (NM)

Facility: CRI

Product / Service

Quantity Units

Contaminated Soil (RCRA Exempt)

20.00 yards

	Cell	pH	Cl	Cond.	%Solids	TDS	PCI/GM	MR/HR	H2S	% Oil	Weight
Lab Analysis:	50/51	0.00	0.00	0.00	0						

Generator Certification Statement of Waste Status

I hereby certify that according to the Resource Conservation and Recovery Act (RCRA) and the US Environmental Protection Agency's July 1988 regulatory determination, the above described waste is:

☒ RCRA Exempt: Oil Field wastes generated from oil and gas exploration and production operations and are not mixed with non-exempt waste
☐ RCRA Non-Exempt: Oil field waste which is non-hazardous that does not exceed the minimum standards for waste hazardous by characteristics established in RCRA regulations, 40 CFR 261.21-261.24 or listed hazardous waste as defined in 40 CFR, part 261, subpart D, as amended. The following documentation is attached to demonstrate the above-described waste is non-hazardous. (Check the appropriate items):
☐ MSDS Information ☐ RCRA Hazardous Waste Analysis ☐ Process Knowledge ☐ Other (Provide description above)

Driver/ Agent Signature

R360 Representative Signature

Customer Approval

THIS IS NOT AN INVOICE!

Approved By: _____

Date: _____



NEW MEXICO NON-HAZARDOUS OILFIELD WASTE MANIFEST

Company Man Contact Information

(PLEASE PRINT)

Name Norman Faver

Phone No. _____

GENERATOR

NO. 391203 (6137)

Operator No. _____
 Operators Name Deven Energy
 Address 6468 7 Rivers Hwy
 City, State, Zip Artesia NM 88210
 Phone No. _____

Permit/RRC No. _____
 Lease/Well Name & No. Cactus State #9
 County Eddy
 API No. 30-015-28496
 Rig Name & No. W/A
 AFE/PO No. _____

EXEMPT E&P Waste/Service Identification and Amount (place volume next to waste type in barrels or cubic yards)

	NON-INJECTABLE WATERS	INJECTABLE WATERS
Oil Based Muds	Washout Water (Non-Injectable)	Washout Water (Injectable)
Oil Based Cuttings	Completion Fluid/Flow back (Non-Injectable)	Completion Fluid/Flow back (Injectable)
Water Based Muds	Produced Water (Non-Injectable)	Produced Water (Injectable)
Water Based Cuttings	Gathering Line Water/Waste (Non-Injectable)	Gathering Line Water/Waste (Injectable)
Produced Formation Solids	INTERNAL USE ONLY	OTHER EXEMPT WASTES (type and generation process of the waste)
Tank Bottoms	Truck Washout (exempt waste)	<u>Soil</u>
E&P Contaminated Soil		
Gas Plant Waste		

WASTE GENERATION PROCESS: ☐ DRILLING ☐ COMPLETION ☒ PRODUCTION ☐ GATHERING LINES

NON-EXEMPT E&P Waste/Service Identification and Amount

All non-exempt E&P waste must be analysed and be below the threshold limits for toxicity (TCLP), Ignitability, Corrosivity and Reactivity.

Non-Exempt Other _____ *please select from Non-Exempt Waste List on back

QUANTITY 20 B - BARRELS L - LIQUID Y - YARDS E - EACH

I hereby certify that according to the Resource Conservation and Recovery Act (RCRA) and the US Environmental Protection Agency's July 1988 regulatory determination, the above described waste load is (Check the appropriate classification)

- ☒ RCRA EXEMPT: Oil field wastes generated from oil and gas exploration and production operations and are not mixed with non-exempt waste (R360 Accepts certifications on a per load basis only)
- ☐ RCRA NON-EXEMPT: Oil field waste which is non-hazardous that does not exceed the minimum standards for waste hazardous by characteristics established in RCRA regulations, 40 CFR 261.21-261.24, or listed hazardous waste as defined by 40 CFR, part 261, subpart D, as amended. The following documentation demonstrating the waste as non-hazardous is attached. (Check the appropriate items as provided)
- ☐ MSDS Information ☐ RCRA Hazardous Waste Analysis ☐ Other (Provide Description Below)

☐ EMERGENCY NON-OILFIELD: Emergency non-hazardous, non-oilfield waste that has been ordered by the Department of Public Safety (the order, documentation of non-hazardous waste determination and a description of the waste must accompany this form)

(PRINT) AUTHORIZED AGENTS NAME

DATE

SIGNATURE

TRANSPORTER

Transporter's Name Sunset well Service
 Address P.O. Box 7131
Milada 14 79708
 Phone No. 432-561-8600

Driver's Name Manuel Chavez
 Print Name Manuel Chavez
 Phone No. _____
 Truck No. 2872

I hereby certify that the above named material(s) was/were picked up at the Generator's site listed above and delivered without incident to the disposal facility listed below.

SHIPMENT DATE

DRIVER'S SIGNATURE

DELIVERY DATE

DRIVER'S SIGNATURE

TRUCK TIME STAMP

DISPOSAL FACILITY

RECEIVING AREA

IN: _____ OUT: _____

Name/No. 541570

Site Name/ Permit No. Halfway Facility / NM1-006
 Address 6601 Hobbs Hwy US 62/180 Mile Marker 66 Carlsbad, NM 88220

Phone No. 575-393-1079

NORM READINGS TAKEN? (Circle One) YES ☒ NO ☐
 PASS THE PAINT FILTER TEST? (Circle One) YES ☒ NO ☐

If YES, was reading > 50 micro roentgens? (circle one) YES ☐ NO ☒

TANK BOTTOMS

Feet

Inches

1st Gauge	
2nd Gauge	
Received	

BS&W/BBLs Received		BS&W (%)	
Free Water			
Total Received			

I hereby certify that the above load material has been (circle one):

ACCEPTED

DENIED

If denied, why?

NAME (PRINT)

DATE

TITLE

SIGNATURE



Permian Basin

Customer: CASH-Halfway
 Customer #: CRI1770
 Ordered by: NORMAN FAVER
 AFE #:
 PO #:
 Manifest #: 391206
 Manif. Date: 5/20/2019
 Hauler: SUNSET WELL
 Driver: MANUEL
 Truck #: 2872
 Card #
 Job Ref #

Ticket #: 700-1011941
 Bid #: Walk-in Bid
 Date: 5/20/2019
 Generator: DEVON ENERGY PRODUCTIO
 Generator #:
 Well Ser. #: 28496
 Well Name: CACTUIS STATE
 Well #: 9
 Field:
 Field #:
 Rig: NON-DRILLING
 County: EDDY (NM)

Facility: CRI

Product / Service	Quantity Units										
Contaminated Soil (RCRA Exempt)	20.00 yards										
	Cell	pH	Cl	Cond.	%Solids	TDS	PCI/GM	MR/HR	H2S	% Oil	Weight
Lab Analysis:	50/51	0.00	0.00	0.00	0						

Generator Certification Statement of Waste Status

I hereby certify that according to the Resource Conservation and Recovery Act (RCRA) and the US Environmental Protection Agency's July 1988 regulatory determination, the above described waste is:

☒ RCRA Exempt: Oil Field wastes generated from oil and gas exploration and production operations and are not mixed with non-exempt waste.
☐ RCRA Non-Exempt: Oil field waste which is non-hazardous that does not exceed the minimum standards for waste hazardous by characteristics established in RCRA regulations, 40 CFR 261.21-261.24 or listed hazardous waste as defined in 40 CFR, part 261, subpart D, as amended. The following documentation is attached to demonstrate the above-described waste is non-hazardous. (Check the appropriate items):
☐ MSDS Information ☐ RCRA Hazardous Waste Analysis ☐ Process Knowledge ☐ Other (Provide description above)

Driver/ Agent Signature

R360 Representative Signature

Customer Approval

THIS IS NOT AN INVOICE!

Approved By: _____

Date: _____



NEW MEXICO NON-HAZARDOUS OILFIELD WASTE MANIFEST

Company Man Contact Information

Bill to Sunset Well Service (PLEASE PRINT)

Name Norman Faver

Phone No. _____

GENERATOR

NO. 391206

Operator No. _____
 Operators Name Devon Energy
 Address 6488 7 Rivers Hwy
 City, State, Zip Artesia NM 88210
 Phone No. _____

Permit/RRC No. _____
 Lease/Well Name & No. Cartus State #5
 County Curry
 API No. 30-015-28496
 Rig Name & No. _____
 AFE/PO No. _____

EXEMPT E&P Waste/Service Identification and Amount (place volume next to waste type in barrels or cubic yards)

	NON-INJECTABLE WATERS	INJECTABLE WATERS
Oil Based Muds	Washout Water (Non-Injectable)	Washout Water (Injectable)
Oil Based Cuttings	Completion Fluid/Flow back (Non-Injectable)	Completion Fluid/Flow back (Injectable)
Water Based Muds	Produced Water (Non-Injectable)	Produced Water (Injectable)
Water Based Cuttings	Gathering Line Water/Waste (Non-Injectable)	Gathering Line Water/Waste (Injectable)
Produced Formation Solids	INTERNAL USE ONLY	OTHER EXEMPT WASTES (type and generation process of the waste)
Tank Bottoms	Truck Washout (exempt waste)	
E&P Contaminated Soil		
Gas Plant Waste		

WASTE GENERATION PROCESS: ☐ DRILLING ☐ COMPLETION ☒ PRODUCTION ☐ GATHERING LINES

NON-EXEMPT E&P Waste/Service Identification and Amount

All non-exempt E&P waste must be analysed and be below the threshold limits for toxicity (TCLP), Ignitability, Corrosivity and Reactivity.

Non-Exempt Other _____ *please select from Non-Exempt Waste List on back

QUANTITY 20 B - BARRELS L - LIQUID Y - YARDS E - EACH

I hereby certify that according to the Resource Conservation and Recovery Act (RCRA) and the US Environmental Protection Agency's July 1988 regulatory determination, the above described waste load is (Check the appropriate classification)

- ☒ RCRA EXEMPT: Oil field wastes generated from oil and gas exploration and production operations and are not mixed with non-exempt waste (R360 Accepts certifications on a per load basis only)
- ☐ RCRA NON-EXEMPT: Oil field waste which is non-hazardous that does not exceed the minimum standards for waste hazardous by characteristics established in RCRA regulations, 40 CFR 261.21-261.24, or listed hazardous waste as defined by 40 CFR, part 261, subpart D, as amended. The following documentation demonstrating the waste as non-hazardous is attached. (Check the appropriate items as provided)
- ☐ MSDS Information ☐ RCRA Hazardous Waste Analysis ☐ Other (Provide Description Below)

- ☐ EMERGENCY NON-OILFIELD: Emergency non-hazardous, non-oilfield waste that has been ordered by the Department of Public Safety (the order, documentation of non-hazardous waste determination and a description of the waste must accompany this form)

Norman Faver
 (PRINT) AUTHORIZED AGENTS NAME

DATE

SIGNATURE

TRANSPORTER

Transporter's Name Sunset Well Service
 Address P.O. Box 7135
Midland TX 79708
 Phone No. 432-561-2600

Driver's Name Manuel Chavez
 Print Name Manuel Chavez
 Phone No. 505-379-9234
 Truck No. 2872

I hereby certify that the above named material(s) was/were picked up at the Generator's site listed above and delivered without incident to the disposal facility listed below.

SHIPMENT DATE

DRIVER'S SIGNATURE

DELIVERY DATE

DRIVER'S SIGNATURE

TRUCK TIME STAMP

IN: _____ OUT: _____

DISPOSAL FACILITY

RECEIVING AREA

Name/No. 50/51

Site Name/ Permit No. Halfway Facility / NM1-006
 Address 6601 Hobbs Hwy US 62/180 Mile Marker 66 Carlsbad, NM 88220

Phone No. 575-393-1079

NORM READINGS TAKEN? (Circle One) YES ☐ NO ☒

If YES, was reading > 50 micro roentgens? (circle one) YES ☐ NO ☒

PASS THE PAINT FILTER TEST? (Circle One) YES ☒ NO ☐

TANK BOTTOMS

Feet

Inches

1st Gauge	
2nd Gauge	
Received	

BS&W/BBLs Received		BS&W (%)	
Free Water			
Total Received			

I hereby certify that the above load material has been (circle one): ACCEPTED DENIED If denied, why? _____

NAME (PRINT)

DATE

TITLE

SIGNATURE



Permian Basin

Customer: CASH-Halfway
 Customer #: CRI1770
 Ordered by: NORMAN FAVER
 AFE #:
 PO #:
 Manifest #: 391205
 Manif. Date: 5/21/2019
 Hauler: SUNSET WELL
 Driver: MANUEL
 Truck #: 272
 Card #
 Job Ref #

Ticket #: 700-1012186
 Bid #: Walk-in Bid
 Date: 5/21/2019
 Generator: DEVON ENERGY PRODUCTI
 Generator #:
 Well Ser. #: 28496
 Well Name: CACTUIS STATE
 Well #: 9
 Field:
 Field #:
 Rig: NON-DRILLING
 County: EDDY (NM)

Facility: CRI

Product / Service	Quantity	Units
Contaminated Soil (RCRA Exempt)	20.00	yards
	Cell	pH
Lab Analysis:	50/51	0.00
	Cl	Cond.
	0.00	0.00
	%Solids	TDS
	0	
	PCI/GM	MR/HR
	H2S	% Oil
	Weight	

Generator Certification Statement of Waste Status

I hereby certify that according to the Resource Conservation and Recovery Act (RCRA) and the US Environmental Protection Agency's July 1988 regulatory determination, the above described waste is:

☒ RCRA Exempt: Oil Field wastes generated from oil and gas exploration and production operations and are not mixed with non-exempt waste
☐ RCRA Non-Exempt: Oil field waste which is non-hazardous that does not exceed the minimum standards for waste hazardous by characteristics established in RCRA regulations, 40 CFR 261.21-261.24 or listed hazardous waste as defined in 40 CFR, part 261, subpart D, as amended. The following documentation is attached to demonstrate the above-described waste is non-hazardous. (Check the appropriate items):
☐ MSDS Information ☐ RCRA Hazardous Waste Analysis ☐ Process Knowledge ☐ Other (Provide description above)

Driver/ Agent Signature

R360 Representative Signature

Customer Approval

THIS IS NOT AN INVOICE!

Approved By: _____

Date: _____



NEW MEXICO NON-HAZARDOUS OILFIELD WASTE MANIFEST

Company Man Contact Information

(PLEASE PRINT)

Name Norman Faver

Phone No. _____

GENERATOR

NO. **391205**

Operator No. _____

Operators Name Devon EnergyAddress 6189 7th Ave NECity, State, Zip Artesia NM 88210

Phone No. _____

Permit/RRC No. _____

Lease/Well Name & No. Cactus State #9County Doña AnaAPI No. 30-015-28496Rig Name & No. N/A

AFE/PO No. _____

EXEMPT E&P Waste/Service Identification and Amount (place volume next to waste type in barrels or cubic yards)

	NON-INJECTABLE WATERS	INJECTABLE WATERS
Oil Based Muds	Washout Water (Non-Injectable)	Washout Water (Injectable)
Oil Based Cuttings	Completion Fluid/Flow back (Non-Injectable)	Completion Fluid/Flow back (Injectable)
Water Based Muds	Produced Water (Non-Injectable)	Produced Water (Injectable)
Water Based Cuttings	Gathering Line Water/Waste (Non-Injectable)	Gathering Line Water/Waste (Injectable)
Produced Formation Solids	INTERNAL USE ONLY	OTHER EXEMPT WASTES (type and generation process of the waste)
Tank Bottoms	Truck Washout (exempt waste)	
E&P Contaminated Soil		
Gas Plant Waste		

WASTE GENERATION PROCESS: ☐ DRILLING ☐ COMPLETION ☒ PRODUCTION ☐ GATHERING LINES

NON-EXEMPT E&P Waste/Service Identification and Amount

All non-exempt E&P waste must be analysed and be below the threshold limits for toxicity (TCLP), Ignitability, Corrosivity and Reactivity.

Non-Exempt Other _____ *please select from Non-Exempt Waste List on back

QUANTITY 20 B - BARRELS L - LIQUID Y - YARDS E - EACH

I hereby certify that according to the Resource Conservation and Recovery Act (RCRA) and the US Environmental Protection Agency's July 1988 regulatory determination, the above described waste load is (Check the appropriate classification)

☒ RCRA EXEMPT: Oil field wastes generated from oil and gas exploration and production operations and are not mixed with non-exempt waste (R360 Accepts certifications on a per load basis only)☐ RCRA NON-EXEMPT: Oil field waste which is non-hazardous that does not exceed the minimum standards for waste hazardous by characteristics established in RCRA regulations, 40 CFR 261.21-261.24, or listed hazardous waste as defined by 40 CFR, part 261, subpart D, as amended. The following documentation demonstrating the waste as non-hazardous is attached. (Check the appropriate items as provided)☐ MSDS Information ☐ RCRA Hazardous Waste Analysis ☐ Other (Provide Description Below)☐ EMERGENCY NON-OILFIELD: Emergency non-hazardous, non-oilfield waste that has been ordered by the Department of Public Safety (the order, documentation of non-hazardous waste determination and a description of the waste must accompany this form)

(PRINT) AUTHORIZED AGENTS NAME

DATE

SIGNATURE

TRANSPORTER

Transporter's Name Samsel well serviceAddress P.O. Box 9139Midland TX 79706Phone No. 432-561-8600Driver's Name Manuel ChavezPrint Name Manuel ChavezPhone No. 936-551-3255Truck No. 2872

I hereby certify that the above named material(s) was/were picked up at the Generator's site listed above and delivered without incident to the disposal facility listed below.

SHIPMENT DATE

DRIVER'S SIGNATURE

DELIVERY DATE

DRIVER'S SIGNATURE

TRUCK TIME STAMP

IN: _____ OUT: _____

DISPOSAL FACILITY

RECEIVING AREA

Name/No. 30151Site Name/ Permit No. Halfway Facility / NM1-006Phone No. 575-393-1079Address 6601 Hobbs Hwy US 62/180 Mile Marker 66 Carlsbad, NM 88220NORM READINGS TAKEN? (Circle One) YES ☒ NO ☐If YES, was reading > 50 micro roentgens? (circle one) YES ☐ NO ☒PASS THE PAINT FILTER TEST? (Circle One) YES ☒ NO ☐

TANK BOTTOMS

	Feet	Inches
1st Gauge		
2nd Gauge		
Received		

BS&W/BBLs Received		BS&W (%)	
Free Water			
Total Received			

I hereby certify that the above load material has been (circle one):

ACCEPTED

DENIED

If denied, why?

NAME (PRINT)

DATE

TITLE

SIGNATURE



Permian Basin

Customer: CASH-Halfway
 Customer #: CRI1770
 Ordered by: NORMAN FAVER
 AFE #:
 PO #:
 Manifest #: 391204
 Manif. Date: 5/21/2019
 Hauler: SUNSET WELL
 Driver: MANUEL
 Truck #: 2872
 Card #
 Job Ref #

Ticket #: 700-1012228
 Bid #: Walk-in Bid
 Date: 5/21/2019
 Generator: DEVON ENERGY PRODUCTI
 Generator #:
 Well Ser. #: 28496
 Well Name: CACTUIS STATE
 Well #: 9
 Field:
 Field #:
 Rig: NON-DRILLING
 County: EDDY (NM)

Facility: CRI

Product / Service	Quantity Units										
Contaminated Soil (RCRA Exempt)	20.00 yards										
	Cell	pH	Cl	Cond.	%Solids	TDS	PCI/GM	MR/HR	H2S	% Oil	Weight
Lab Analysis:	50/51	0.00	0.00	0.00	0						

Generator Certification Statement of Waste Status

I hereby certify that according to the Resource Conservation and Recovery Act (RCRA) and the US Environmental Protection Agency's July 1988 regulatory determination, the above described waste is:

☒ RCRA Exempt: Oil Field wastes generated from oil and gas exploration and production operations and are not mixed with non-exempt waste
☐ RCRA Non-Exempt: Oil field waste which is non-hazardous that does not exceed the minimum standards for waste hazardous by characteristics established in RCRA regulations, 40 CFR 261.21-261.24 or listed hazardous waste as defined in 40 CFR, part 261, subpart D, as amended. The following documentation is attached to demonstrate the above-described waste is non-hazardous. (Check the appropriate items):
☐ MSDS Information ☐ RCRA Hazardous Waste Analysis ☐ Process Knowledge ☐ Other (Provide description above)

Driver/ Agent Signature

R360 Representative Signature

Customer Approval

THIS IS NOT AN INVOICE!

Approved By: _____

Date: _____



NEW MEXICO NON-HAZARDOUS OILFIELD WASTE MANIFEST

Company Man Contact Information

Bill to Suncel Well Service (PLEASE PRINT)

Name Norman Favor

Phone No.

GENERATOR

NO. 391204

Operator No. _____
 Operators Name Danx Energy
 Address 6498 7th St NW Hwy
 City, State, Zip Artesia NM 88210
 Phone No. _____

Permit/RRC No. _____
 Lease/Well Name & No. Center State #9
 County Doña Ana
 API No. 30-015-28496
 Rig Name & No. _____
 AFE/PO No. N/A

EXEMPT E&P Waste/Service Identification and Amount (place volume next to waste type in barrels or cubic yards)

	NON-INJECTABLE WATERS	INJECTABLE WATERS
Oil Based Muds	Washout Water (Non-Injectable)	Washout Water (Injectable)
Oil Based Cuttings	Completion Fluid/Flow back (Non-Injectable)	Completion Fluid/Flow back (Injectable)
Water Based Muds	Produced Water (Non-Injectable)	Produced Water (Injectable)
Water Based Cuttings	Gathering Line Water/Waste (Non-Injectable)	Gathering Line Water/Waste (Injectable)
Produced Formation Solids	INTERNAL USE ONLY	OTHER EXEMPT WASTES (type and generation process of the waste)
Tank Bottoms	Truck Washout (exempt waste)	
E&P Contaminated Soil		
Gas Plant Waste		

WASTE GENERATION PROCESS: ☐ DRILLING ☐ COMPLETION ☒ PRODUCTION ☐ GATHERING LINES

NON-EXEMPT E&P Waste/Service Identification and Amount

All non-exempt E&P waste must be analysed and be below the threshold limits for toxicity (TCLP), Ignitability, Corrosivity and Reactivity.

Non-Exempt Other _____ *please select from Non-Exempt Waste List on back

QUANTITY 20 B - BARRELS L - LIQUID Y - YARDS E - EACH

I hereby certify that according to the Resource Conservation and Recovery Act (RCRA) and the US Environmental Protection Agency's July 1988 regulatory determination, the above described waste load is (Check the appropriate classification)

- ☒ RCRA EXEMPT: Oil field wastes generated from oil and gas exploration and production operations and are not mixed with non-exempt waste (R360 Accepts certifications on a per load basis only)
- ☐ RCRA NON-EXEMPT: Oil field waste which is non-hazardous that does not exceed the minimum standards for waste hazardous by characteristics established in RCRA regulations, 40 CFR 261.21-261.24, or listed hazardous waste as defined by 40 CFR, part 261, subpart D, as amended. The following documentation demonstrating the waste as non-hazardous is attached. (Check the appropriate items as provided)
- ☐ MSDS Information ☐ RCRA Hazardous Waste Analysis ☐ Other (Provide Description Below)

☐ EMERGENCY NON-OILFIELD: Emergency non-hazardous, non-oilfield waste that has been ordered by the Department of Public Safety (the order, documentation of non-hazardous waste determination and a description of the waste must accompany this form)

(PRINT) AUTHORIZED AGENTS NAME

DATE

SIGNATURE

TRANSPORTER

Transporter's Name Suncel Well Service
 Address PO Box 7135
Midland TX 79708
 Phone No. 432-561-8600

Driver's Name Manuel Chavez
 Print Name Manuel Chavez
 Phone No. 432-534-5233
 Truck No. 2872

I hereby certify that the above named material(s) was/were picked up at the Generator's site listed above and delivered without incident to the disposal facility listed below.

SHIPMENT DATE

DRIVER'S SIGNATURE

DELIVERY DATE

DRIVER'S SIGNATURE

TRUCK TIME STAMP

IN: _____ OUT: _____

DISPOSAL FACILITY

RECEIVING AREA

Name/No. 70151

Site Name/ Permit No. Halfway Facility / NM1-006
 Address 6601 Hobbs Hwy US 62/180 Mile Marker 66 Carlsbad, NM 88220

Phone No. 575-393-1079

NORM READINGS TAKEN? (Circle One) YES ☒ NO ☐
 PASS THE PAINT FILTER TEST? (Circle One) YES ☒ NO ☐

If YES, was reading > 50 micro roentgens? (circle one) YES ☐ NO ☒

TANK BOTTOMS

	Feet	Inches	BS&W/BBLS Received	BS&W (%)
1st Gauge			Free Water	
2nd Gauge			Total Received	
Received				

I hereby certify that the above load material has been (circle one):

ACCEPTED

DENIED

If denied, why?

NAME (PRINT)

DATE

TITLE

SIGNATURE



Permian Basin

Customer: CASH-Halfway
 Customer #: CRI1770
 Ordered by: NORMAN FAVER
 AFE #:
 PO #:
 Manifest #: 391202
 Manif. Date: 5/21/2019
 Hauler: SUNSET WELL
 Driver: MANUEL
 Truck #: 2872
 Card #
 Job Ref #

Ticket #: 700-1012256
 Bid #: Walk-in Bid
 Date: 5/21/2019
 Generator: DEVON ENERGY PRODUCTIO
 Generator #:
 Well Ser. #: 28496
 Well Name: CACTUIS STATE
 Well #: 9
 Field:
 Field #:
 Rig: NON-DRILLING
 County: EDDY (NM)

Facility: CRI

Product / Service	Quantity Units									
Contaminated Soil (RCRA Exempt)	20.00 yards									
	Cell	pH	Cl	Cond.	%Solids	TDS	PCI/GM	MR/HR	H2S	% Oil Weight
Lab Analysis:	50/51	0.00	0.00	0.00	0					

Generator Certification Statement of Waste Status

I hereby certify that according to the Resource Conservation and Recovery Act (RCRA) and the US Environmental Protection Agency's July 1988 regulatory determination, the above described waste is:

- ☒ RCRA Exempt: Oil Field wastes generated from oil and gas exploration and production operations and are not mixed with non-exempt waste
☐ RCRA Non-Exempt: Oil field waste which is non-hazardous that does not exceed the minimum standards for waste hazardous by characteristics established in RCRA regulations, 40 CFR 261.21-261.24 or listed hazardous waste as defined in 40 CFR, part 261, subpart D, as amended. The following documentation is attached to demonstrate the above-described waste is non-hazardous. (Check the appropriate items):
☐ MSDS Information ☐ RCRA Hazardous Waste Analysis ☐ Process Knowledge ☐ Other (Provide description above)

Driver/ Agent Signature

R360 Representative Signature

Customer Approval

THIS IS NOT AN INVOICE!

Approved By: _____

Date: _____



NEW MEXICO NON-HAZARDOUS OILFIELD WASTE MANIFEST

Company Man Contact Information

(PLEASE PRINT)

Name _____

Phone No. _____

GENERATOR

NO. 391202

Operator No. _____
 Operators Name Deven Energy
 Address 6485 7 Rivers Hwy
 City, State, Zip Artesia NM 88210
 Phone No. _____

Permit/RRC No. _____
 Lease/Well _____
 Name & No. _____
 County Cactus State #5
 API No. Eddy
 Rig Name & No. 30-015-28496
 AFE/PO No. _____

EXEMPT E&P Waste/Service Identification and Amount (place volume next to waste type in barrels or cubic yards)

	NON-INJECTABLE WATERS	INJECTABLE WATERS
Oil Based Muds	Washout Water (Non-Injectable) _____	Washout Water (Injectable) _____
Oil Based Cuttings	Completion Fluid/Flow back (Non-Injectable) _____	Completion Fluid/Flow back (Injectable) _____
Water Based Muds	Produced Water (Non-Injectable) _____	Produced Water (Injectable) _____
Water Based Cuttings	Gathering Line Water/Waste (Non-Injectable) _____	Gathering Line Water/Waste (Injectable) _____
Produced Formation Solids	INTERNAL USE ONLY	OTHER EXEMPT WASTES (type and generation process of the waste)
Tank Bottoms	Truck Washout (exempt waste) _____	
E&P Contaminated Soil		
Gas Plant Waste		

WASTE GENERATION PROCESS: ☐ DRILLING ☐ COMPLETION ☐ PRODUCTION ☐ GATHERING LINES

NON-EXEMPT E&P Waste/Service Identification and Amount

All non-exempt E&P waste must be analysed and be below the threshold limits for toxicity (TCLP), Ignitability, Corrosivity and Reactivity.

Non-Exempt Other _____ *please select from Non-Exempt Waste List on back

QUANTITY 20 B - BARRELS L - LIQUID YARDS E - EACH

I hereby certify that according to the Resource Conservation and Recovery Act (RCRA) and the US Environmental Protection Agency's July 1988 regulatory determination, the above described waste load is (Check the appropriate classification)

- ☐ RCRA EXEMPT: Oil field wastes generated from oil and gas exploration and production operations and are not mixed with non-exempt waste (R360 Accepts certifications on a per load basis only)
- ☐ RCRA NON-EXEMPT: Oil field waste which is non-hazardous that does not exceed the minimum standards for waste hazardous by characteristics established in RCRA regulations, 40 CFR 261.21-261.24, or listed hazardous waste as defined by 40 CFR, part 261, subpart D, as amended. The following documentation demonstrating the waste as non-hazardous is attached. (Check the appropriate items as provided)
- ☐ MSDS Information ☐ RCRA Hazardous Waste Analysis ☐ Other (Provide Description Below)

- ☐ EMERGENCY NON-OILFIELD: Emergency non-hazardous, non-oilfield waste that has been ordered by the Department of Public Safety (the order, documentation of non-hazardous waste determination and a description of the waste must accompany this form)

(PRINT) AUTHORIZED AGENTS NAME

DATE

SIGNATURE

TRANSPORTER

Transporter's Name Sunset Well Serv
 Address PO Box 7139
Midland TX 79704
 Phone No. 432-561-8600

Driver's Name Manuel Chavez
 Print Name Manuel Chavez
 Phone No. 432-934-8253
 Truck No. 2872

I hereby certify that the above named material(s) was/were picked up at the Generator's site listed above and delivered without incident to the disposal facility listed below.

SHIPMENT DATE

DRIVER'S SIGNATURE

DELIVERY DATE

DRIVER'S SIGNATURE

TRUCK TIME STAMP

IN: _____ OUT: _____

DISPOSAL FACILITY

RECEIVING AREA

Name/No. 50151

Site Name/ Permit No. Halfway Facility / NM1-006
 Address 6601 Hobbs Hwy US 62/180 Mile Marker 66 Carlsbad, NM 88220

Phone No. 575-393-1079

NORM READINGS TAKEN? (Circle One) YES NO
 PASS THE PAINT FILTER TEST? (Circle One) YES NO

If YES, was reading > 50 micro roentgens? (circle one) YES NO

TANK BOTTOMS

	Feet	Inches
1st Gauge		
2nd Gauge		
Received		

BS&W/BBLs Received		BS&W (%)	
Free Water			
Total Received			

I hereby certify that the above load material has been (circle one):

ACCEPTED

DENIED

If denied, why?

NAME (PRINT)

DATE

TITLE

SIGNATURE



Customer: CASH-Halfway
 Customer #: CRI1770
 Ordered by: NORMAN FAVER
 AFE #:
 PO #:
 Manifest #: 391208
 Manif. Date: 5/21/2019
 Hauler: SUNSET WELL
 Driver: MANUEL
 Truck #: 2872
 Card #
 Job Ref #

Ticket #: 700-1012296
 Bid #: Walk-in Bid
 Date: 5/21/2019
 Generator: DEVON ENERGY PRODUCTI
 Generator #:
 Well Ser. #: 28496
 Well Name: CACTUIS STATE
 Well #: 9
 Field:
 Field #:
 Rig: NON-DRILLING
 County: EDDY (NM)

Permian Basin

Facility: CRI

Product / Service		Quantity Units									
Contaminated Soil (RCRA Exempt)		20.00 yards									
	Cell	pH	Cl	Cond.	%Solids	TDS	PCI/GM	MR/HR	H2S	% Oil	Weight
Lab Analysis:	50/51	0.00	0.00	0.00	0						

Generator Certification Statement of Waste Status

I hereby certify that according to the Resource Conservation and Recovery Act (RCRA) and the US Environmental Protection Agency's July 1988 regulatory determination, the above described waste is:

- ☒ RCRA Exempt: Oil Field wastes generated from oil and gas exploration and production operations and are not mixed with non-exempt waste
☐ RCRA Non-Exempt: Oil field waste which is non-hazardous that does not exceed the minimum standards for waste hazardous by characteristics established in RCRA regulations, 40 CFR 261.21-261.24 or listed hazardous waste as defined in 40 CFR, part 261, subpart D, as amended. The following documentation is attached to demonstrate the above-described waste is non-hazardous. (Check the appropriate items):
☐ MSDS Information ☐ RCRA Hazardous Waste Analysis ☐ Process Knowledge ☐ Other (Provide description above)

Driver/ Agent Signature

R360 Representative Signature

Customer Approval

THIS IS NOT AN INVOICE!

Approved By: _____

Date: _____



NEW MEXICO NON-HAZARDOUS OILFIELD WASTE MANIFEST

(PLEASE PRINT)

Company Man Contact Information

Name Norman Faver

Phone No. _____

GENERATOR

NO. **391208**

Operator No. _____

Operators Name Devon EnergyAddress 6448 7 Rivers HwyCity, State, Zip Artesia NM 87200

Phone No. _____

Permit/RRC No. _____

Lease/Well

Name & No. Cactus State #9

County

API No. 30-015-28496

Rig Name & No. _____

AFE/PO No. N/A

EXEMPT E&P Waste/Service Identification and Amount (place volume next to waste type in barrels or cubic yards)

	NON-INJECTABLE WATERS	INJECTABLE WATERS
Oil Based Muds	Washout Water (Non-Injectable)	Washout Water (Injectable)
Oil Based Cuttings	Completion Fluid/Flow back (Non-Injectable)	Completion Fluid/Flow back (Injectable)
Water Based Muds	Produced Water (Non-Injectable)	Produced Water (Injectable)
Water Based Cuttings	Gathering Line Water/Waste (Non-Injectable)	Gathering Line Water/Waste (Injectable)
Produced Formation Solids	INTERNAL USE ONLY	OTHER EXEMPT WASTES (type and generation process of the waste)
Tank Bottoms	Truck Washout (exempt waste)	
E&P Contaminated Soil		
Gas Plant Waste		

WASTE GENERATION PROCESS: ☐ DRILLING ☐ COMPLETION ☐ PRODUCTION ☐ GATHERING LINES

NON-EXEMPT E&P Waste/Service Identification and Amount

All non-exempt E&P waste must be analysed and be below the threshold limits for toxicity (TCPL), Ignitability, Corrosivity and Reactivity.

Non-Exempt Other _____

*please select from Non-Exempt Waste List on back

QUANTITY 20

B - BARRELS

L - LIQUID

Y - YARDS

E - EACH

I hereby certify that according to the Resource Conservation and Recovery Act (RCRA) and the US Environmental Protection Agency's July 1988 regulatory determination, the above described waste load is (Check the appropriate classification)

☒ RCRA EXEMPT:

Oil field wastes generated from oil and gas exploration and production operations and are not mixed with non-exempt waste (R360 Accepts certifications on a per load basis only)

☐ RCRA NON-EXEMPT:

Oil field waste which is non-hazardous that does not exceed the minimum standards for waste hazardous by characteristics established in RCRA regulations, 40 CFR 261.21-261.24, or listed hazardous waste as defined by 40 CFR, part 261, subpart D, as amended. The following documentation demonstrating the waste as non-hazardous is attached. (Check the appropriate items as provided)

☐ MSDS Information☐ RCRA Hazardous Waste Analysis☐ Other (Provide Description Below)☐ EMERGENCY NON-OILFIELD:

Emergency non-hazardous, non-oilfield waste that has been ordered by the Department of Public Safety (the order, documentation of non-hazardous waste determination and a description of the waste must accompany this form)

(PRINT) AUTHORIZED AGENTS NAME Norman FaverDATE 5-21-19

SIGNATURE _____

TRANSPORTER

Transporter's Name Sunset well ServiceAddress P.O. Box 2139Phone No. Mesa 1775208
432-561-8600Driver's Name Manuel ChavezPrint Name Manuel ChavezPhone No. 432-434-3233Truck No. 2972

I hereby certify that the above named material(s) was/were picked up at the Generator's site listed above and delivered without incident to the disposal facility listed below.

SHIPMENT DATE 5-21-19DRIVER'S SIGNATURE [Signature]DELIVERY DATE 5-21-19DRIVER'S SIGNATURE [Signature]

TRUCK TIME STAMP

IN: _____ OUT: _____

DISPOSAL FACILITY

RECEIVING AREA

Name/No. 5015

Site Name/

Permit No. Halfway Facility / NM1-006Phone No. 575-393-1079Address 6601 Hobbs Hwy US 62/180 Mile Marker 66 Carlsbad, NM 88220

NORM READINGS TAKEN? (Circle One)

YES

NO

If YES, was reading > 50 micro roentgens? (circle one)

YES

NO

PASS THE PAINT FILTER TEST? (Circle One)

YES

NO

TANK BOTTOMS

Feet

Inches

1st Gauge
2nd Gauge
Received

BS&W/BBLs Received

BS&W (%)

Free Water

Total Received

I hereby certify that the above load material has been (circle one):

ACCEPTED

DENIED

If denied, why? _____

NAME (PRINT) Norman FaverDATE 5/21/19TITLE SALESSIGNATURE [Signature]



Permian Basin

Customer: CASH-Halfway
 Customer #: CRI1770
 Ordered by: NORMAN FAVER
 AFE #:
 PO #:
 Manifest #: 391209
 Manif. Date: 5/21/2019
 Hauler: SUNSET WELL
 Driver: MANUEL
 Truck #: 2872
 Card #
 Job Ref #

Ticket #: 700-1012334
 Bid #: Walk-in Bid
 Date: 5/21/2019
 Generator: DEVON ENERGY PRODUCTI
 Generator #:
 Well Ser. #: 28496
 Well Name: CACTUIS STATE
 Well #: 9
 Field:
 Field #:
 Rig: NON-DRILLING
 County: EDDY (NM)

Facility: CRI

Product / Service							Quantity Units				
Contaminated Soil (RCRA Exempt)							20.00 yards				
	Cell	pH	Cl	Cond.	%Solids	TDS	PCI/GM	MR/HR	H2S	% Oil	Weight
Lab Analysis:	50/51	0.00	0.00	0.00	0						

Generator Certification Statement of Waste Status

I hereby certify that according to the Resource Conservation and Recovery Act (RCRA) and the US Environmental Protection Agency's July 1988 regulatory determination, the above described waste is:

- ☒ RCRA Exempt: Oil Field wastes generated from oil and gas exploration and production operations and are not mixed with non-exempt waste
☐ RCRA Non-Exempt: Oil field waste which is non-hazardous that does not exceed the minimum standards for waste hazardous by characteristics established in RCRA regulations, 40 CFR 261.21-261.24 or listed hazardous waste as defined in 40 CFR, part 261, subpart D, as amended. The following documentation is attached to demonstrate the above-described waste is non-hazardous. (Check the appropriate items):
☐ MSDS Information ☐ RCRA Hazardous Waste Analysis ☐ Process Knowledge ☐ Other (Provide description above)

Driver/ Agent Signature

R360 Representative Signature

Customer Approval

THIS IS NOT AN INVOICE!

Approved By: _____

Date: _____



NEW MEXICO NON-HAZARDOUS OILFIELD WASTE MANIFEST

(PLEASE PRINT)

Company Man Contact Information

Name _____

Phone No. _____

GENERATOR

NO. 391209

Operator No. _____
 Operators Name Deven Energy
 Address 6488 7 Rivers Hwy
Artesia NM 88010
 City, State, Zip _____
 Phone No. _____

Permit/RRC No. _____
 Lease/Well Name & No. Cactus State #9
 County EDDY
 API No. 30-015-28496
 Rig Name & No. _____
 AFE/PO No. _____

EXEMPT E&P Waste/Service Identification and Amount (place volume next to waste type in barrels or cubic yards)

	NON-INJECTABLE WATERS	INJECTABLE WATERS
Oil Based Muds	Washout Water (Non-Injectable)	Washout Water (Injectable)
Oil Based Cuttings	Completion Fluid/Flow back (Non-Injectable)	Completion Fluid/Flow back (Injectable)
Water Based Muds	Produced Water (Non-Injectable)	Produced Water (Injectable)
Water Based Cuttings	Gathering Line Water/Waste (Non-Injectable)	Gathering Line Water/Waste (Injectable)
Produced Formation Solids	INTERNAL USE ONLY	OTHER EXEMPT WASTES (type and generation process of the waste)
Tank Bottoms	Truck Washout (exempt waste)	
E&P Contaminated Soil		
Gas Plant Waste		

WASTE GENERATION PROCESS: ☐ DRILLING ☐ COMPLETION ☒ PRODUCTION ☐ GATHERING LINES

NON-EXEMPT E&P Waste/Service Identification and Amount

All non-exempt E&P waste must be analysed and be below the threshold limits for toxicity (TCLP), Ignitability, Corrosivity and Reactivity.

Non-Exempt Other _____ *please select from Non-Exempt Waste List on back

QUANTITY 70 B - BARRELS L - LIQUID Y - YARDS E - EACH

I hereby certify that according to the Resource Conservation and Recovery Act (RCRA) and the US Environmental Protection Agency's July 1988 regulatory determination, the above described waste load is (Check the appropriate classification)

- ☐ RCRA EXEMPT: Oil field wastes generated from oil and gas exploration and production operations and are not mixed with non-exempt waste (R360 Accepts certifications on a per load basis only)
- ☐ RCRA NON-EXEMPT: Oil field waste which is non-hazardous that does not exceed the minimum standards for waste hazardous by characteristics established in RCRA regulations, 40 CFR 261.21-261.24, or listed hazardous waste as defined by 40 CFR, part 261, subpart D, as amended. The following documentation demonstrating the waste as non-hazardous is attached. (Check the appropriate items as provided)
- ☐ MSDS Information ☐ RCRA Hazardous Waste Analysis ☐ Other (Provide Description Below)

- ☐ EMERGENCY NON-OILFIELD: Emergency non-hazardous, non-oilfield waste that has been ordered by the Department of Public Safety (the order, documentation of non-hazardous waste determination and a description of the waste must accompany this form)

(PRINT) AUTHORIZED AGENTS NAME

DATE

SIGNATURE

TRANSPORTER

Transporter's Name Sunset Well Service
 Address PO Box 1137
Midland TX 79708
 Phone No. 732-861-8600

Driver's Name Manuel Chavez
 Print Name Manuel Chavez
 Phone No. 432-734-3233
 Truck No. 2872

I hereby certify that the above named material(s) was/were picked up at the Generator's site listed above and delivered without incident to the disposal facility listed below.

SHIPMENT DATE

DRIVER'S SIGNATURE

DELIVERY DATE

DRIVER'S SIGNATURE

TRUCK TIME STAMP

DISPOSAL FACILITY

RECEIVING AREA

IN: _____ OUT: _____

Name/No. 50157

Site Name/ Permit No. Halfway Facility / NM1-006
 Address 6601 Hobbs Hwy US 62/180 Mile Marker 66 Carlsbad, NM 88220

Phone No. 575-393-1079

NORM READINGS TAKEN? (Circle One) YES ☒ NO ☐ If YES, was reading > 50 micro roentgens? (circle one) YES ☐ NO ☒

PASS THE PAINT FILTER TEST? (Circle One) YES ☒ NO ☐

TANK BOTTOMS

	Feet	Inches	BS&W/BBLs Received	BS&W (%)
1st Gauge			Free Water	
2nd Gauge			Total Received	
Received				

I hereby certify that the above load material has been (circle one): ACCEPTED ☒ DENIED ☐ If denied, why? _____

NAME (PRINT)

DATE

TITLE

SIGNATURE



Permian Basin

Customer:	DEVON ENERGY PRODUCTION	Ticket #:	700-1012584
Customer #:	CRI2450	Bid #:	O6UJ9A000D7S
Ordered by:	NORMAN FAVER	Date:	5/22/2019
AFE #:		Generator:	DEVON ENERGY PRODUCTION
PO #:		Generator #:	
Manifest #:	391219	Well Ser. #:	28496
Manif. Date:	5/22/2019	Well Name:	CACTUIS STATE
Hauler:	SUNSET WELL	Well #:	9
Driver:	MANUEL	Field:	
Truck #:	2872	Field #:	
Card #:		Rig:	NON-DRILLING
Job Ref #:		County:	EDDY (NM)

Facility: CRI

Product / Service		Quantity Units									
Contaminated Soil (RCRA Exempt)		20.00 yards									
	Cell	pH	Cl	Cond.	%Solids	TDS	PCI/GM	MR/HR	H2S	% Oil	Weight
Lab Analysis:	50/51	0.00	0.00	0.00	0						

Generator Certification Statement of Waste Status

I hereby certify that according to the Resource Conservation and Recovery Act (RCRA) and the US Environmental Protection Agency's July 1988 regulatory determination, the above described waste is:

☒ RCRA Exempt: Oil field wastes generated from oil and gas exploration and production operations and are not mixed with non-exempt waste
☐ RCRA Non-Exempt: Oil field waste which is non-hazardous that does not exceed the minimum standards for waste hazardous by characteristics established in RCRA regulations, 40 CFR 261.21-261.24 or listed hazardous waste as defined in 40 CFR, part 261, subpart D, as amended. The following documentation is attached to demonstrate the above-described waste is non-hazardous. (Check the appropriate items):
☐ MSDS Information ☐ RCRA Hazardous Waste Analysis ☐ Process Knowledge ☐ Other (Provide description above)

Driver/ Agent Signature

R360 Representative Signature

Customer Approval

THIS IS NOT AN INVOICE!

Approved By: _____

Date: _____



NEW MEXICO NON-HAZARDOUS OILFIELD WASTE MANIFEST

(PLEASE PRINT)

Company Man Contact Information

Name Norman Fayer

Phone No. _____

GENERATOR

NO. **391219**

Operator No. _____

Operators Name Devon EnergyAddress 4488 7 R. Siders HwyCity, State, Zip Artesia NM 88210

Phone No. _____

Permit/RRC No. _____

Lease/Well Name & No. Rafus State #9County EdmAPI No. 30-015-28496Rig Name & No. WRS # 150359.01. ADD

AFE/PO No. _____

EXEMPT E&P Waste/Service Identification and Amount (place volume next to waste type in barrels or cubic yards)

	NON-INJECTABLE WATERS	INJECTABLE WATERS
Oil Based Muds	Washout Water (Non-Injectable)	Washout Water (Injectable)
Oil Based Cuttings	Completion Fluid/Flow back (Non-Injectable)	Completion Fluid/Flow back (Injectable)
Water Based Muds	Produced Water (Non-Injectable)	Produced Water (Injectable)
Water Based Cuttings	Gathering Line Water/Waste (Non-Injectable)	Gathering Line Water/Waste (Injectable)
Produced Formation Solids	INTERNAL USE ONLY	OTHER EXEMPT WASTES (type and generation process of the waste)
Tank Bottoms	Truck Washout (exempt waste)	
E&P Contaminated Soil		
Gas Plant Waste		

WASTE GENERATION PROCESS: ☐ DRILLING ☐ COMPLETION ☐ PRODUCTION ☐ GATHERING LINES

NON-EXEMPT E&P Waste/Service Identification and Amount

All non-exempt E&P waste must be analysed and be below the threshold limits for toxicity (TCLP), Ignitability, Corrosivity and Reactivity.

Non-Exempt Other _____ *please select from Non-Exempt Waste List on back

QUANTITY 20 B - BARRELS L - LIQUID Y - YARDS E - EACH

I hereby certify that according to the Resource Conservation and Recovery Act (RCRA) and the US Environmental Protection Agency's July 1988 regulatory determination, the above described waste load is (Check the appropriate classification)

☒ RCRA EXEMPT: Oil field wastes generated from oil and gas exploration and production operations and are not mixed with non-exempt waste (R360 Accepts certifications on a per load basis only)☐ RCRA NON-EXEMPT: Oil field waste which is non-hazardous that does not exceed the minimum standards for waste hazardous by characteristics established in RCRA regulations, 40 CFR 261.21-261.24, or listed hazardous waste as defined by 40 CFR, part 261, subpart D, as amended. The following documentation demonstrating the waste as non-hazardous is attached. (Check the appropriate items as provided)☐ MSDS Information ☐ RCRA Hazardous Waste Analysis ☐ Other (Provide Description Below)☐ EMERGENCY NON-OILFIELD: Emergency non-hazardous, non-oilfield waste that has been ordered by the Department of Public Safety (the order, documentation of non-hazardous waste determination and a description of the waste must accompany this form)Norman Fayer
(PRINT) AUTHORIZED AGENTS NAME

DATE

SIGNATURE

TRANSPORTER

Transporter's Name Sunset well ServiceAddress P.O. Box 7139Midland TX 79708Phone No. 409-361-8400Driver's Name Manuel ChavezPrint Name Manuel ChavezPhone No. 505-379-9234Truck No. 2472

I hereby certify that the above named material(s) was/were picked up at the Generator's site listed above and delivered without incident to the disposal facility listed below.

SHIPMENT DATE

DRIVER'S SIGNATURE

DELIVERY DATE

DRIVER'S SIGNATURE

TRUCK TIME STAMP

IN: _____ OUT: _____

DISPOSAL FACILITY

RECEIVING AREA

Name/No. 50131Site Name/ Permit No. Halfway Facility / NM1-006Phone No. 575-393-1079Address 6601 Hobbs Hwy US 62/180 Mile Marker 66 Carlsbad, NM 88220

NORM READINGS TAKEN? (Circle One) YES NO If YES, was reading > 50 micro roentgens? (circle one) YES NO

PASS THE PAINT FILTER TEST? (Circle One) YES NO

TANK BOTTOMS

Feet

Inches

1st Gauge		
2nd Gauge		
Received		

BS&W/BBLS Received		BS&W (%)	
Free Water			
Total Received			

I hereby certify that the above load material has been (circle one):

ACCEPTED

DENIED

If denied, why?

NAME (PRINT)

DATE

TITLE

SIGNATURE



Customer: DEVON ENERGY PRODUCTION
 Customer #: CRI2450
 Ordered by: NORMAN FAVER
 AFE #:
 PO #:
 Manifest #: 391201
 Manif. Date: 5/22/2019
 Hauler: SUNSET WELL
 Driver: MANUEL
 Truck #: 2782
 Card #
 Job Ref #

Ticket #: 700-1012620
 Bid #: O6UJ9A000D7S
 Date: 5/22/2019
 Generator: DEVON ENERGY PRODUCTION
 Generator #:
 Well Ser. #: 28496
 Well Name: CACTUIS STATE
 Well #: 9
 Field:
 Field #:
 Rig: NON-DRILLING
 County: EDDY (NM)

Permian Basin

Facility: CRI

Product / Service						Quantity Units					
Contaminated Soil (RCRA Exempt)						20.00 yards					
	Cell	pH	Cl	Cond.	%Solids	TDS	PCI/GM	MR/HR	H2S	% Oil	Weight
Lab Analysis:	50/51	0.00	0.00	0.00	0						

Generator Certification Statement of Waste Status

I hereby certify that according to the Resource Conservation and Recovery Act (RCRA) and the US Environmental Protection Agency's July 1988 regulatory determination, the above described waste is:

- ☒ RCRA Exempt: Oil Field wastes generated from oil and gas exploration and production operations and are not mixed with non-exempt waste
☐ RCRA Non-Exempt: Oil field waste which is non-hazardous that does not exceed the minimum standards for waste hazardous by characteristics established in RCRA regulations, 40 CFR 261.21-261.24 or listed hazardous waste as defined in 40 CFR, part 261, subpart D, as amended. The following documentation is attached to demonstrate the above-described waste is non-hazardous. (Check the appropriate items):
☐ MSDS Information ☐ RCRA Hazardous Waste Analysis ☐ Process Knowledge ☐ Other (Provide description above)

Driver/ Agent Signature

R360 Representative Signature

Customer Approval

THIS IS NOT AN INVOICE!

Approved By: _____

Date: _____