

District I
1625 N. French Dr., Hobbs, NM 88240
District II
1301 W. Grand Avenue, Artesia, NM 88210
District III
1000 Rio Brazos Road, Aztec, NM 87410
District IV
1220 S. St. Francis Dr., Santa Fe, NM 87505

State of New Mexico
Energy Minerals and Natural Resources
Oil Conservation Division
1220 South St. Francis Dr.
Santa Fe, NM 87505

DEC 2007
Received
Hobl.
OCD

Form C-141
Revised October 10, 2003

Submit 2 Copies to appropriate
District Office in accordance
with Rule 116 on back
side of form

Release Notification and Corrective Action

OPERATOR

☒ Initial Report ☐ Final Report

Name of Company	Key Energy Services, Inc.	Contact	Sam Blevins
Address	2105 Ave O	Telephone No.	505-394-2581
Facility Name	Key Energy State "S" Brine and Water Station (BW-028)	Facility Type	Brine and Freshwater Station

Surface Owner	Millard Deck Trust	Mineral Owner	State of New Mexico	Lease No.	#1
---------------	--------------------	---------------	---------------------	-----------	----

LOCATION OF RELEASE

Unit Letter	Section	Township	Range	Feet from the	North/South Line	Feet from the	East/West Line	County
D	15	21s	37e	See attached map				Lea

Latitude N32° 29' 02.2" Longitude W103° 09' 28.8"

NATURE OF RELEASE

Type of Release	Brine	Volume of Release	300bbbls	Volume Recovered	275bbbls
Source of Release	Load line valve left open by unidentified 3 rd party driver.	Date and Hour of Occurrence	11/24/07 09:00	Date and Hour of Discovery	11/24/07 09:00, Clarence Fyte (Chevron)
Was Immediate Notice Given?	<input checked="" type="checkbox"/> Yes <input type="checkbox"/> No <input type="checkbox"/> Not Required	If YES, To Whom?	Pat Richards, OCD		
By Whom?	Edward (Ted) Philley, Key Energy Services	Date and Hour	11/26/07 10:25		
Was a Watercourse Reached?	<input type="checkbox"/> Yes <input checked="" type="checkbox"/> No	If YES, Volume Impacting the Watercourse.			

If a Watercourse was Impacted, Describe Fully.*

Describe Cause of Problem and Remedial Action Taken.*

Brine valve was left open at load line at east end of water station by 3rd party, line drained into diked area. Dike gave way and ran down lease road onto Chevron well location.

Describe Area Affected and Cleanup Action Taken.*

Affected lease road, Chevron State S #1 Unit D, Sec15-T21S-R37E well site and area surrounding. Recovered 275bbbls with vacuum trucks. Terracon developing workplan.

I hereby certify that the information given above is true and complete to the best of my knowledge and understand that pursuant to NMOCD rules and regulations all operators are required to report and/or file certain release notifications and perform corrective actions for releases which may endanger public health or the environment. The acceptance of a C-141 report by the NMOCD marked as "Final Report" does not relieve the operator of liability should their operations have failed to adequately investigate and remediate contamination that pose a threat to ground water, surface water, human health or the environment. In addition, NMOCD acceptance of a C-141 report does not relieve the operator of responsibility for compliance with any other federal, state, or local laws and/or regulations.

Signature: <i>Edward D. Philley</i>	OIL CONSERVATION DIVISION	
Printed Name: <i>Edward D (Ted) Philley</i>	Approved by District Supervisor: <i>[Signature]</i> ENVIRONMENTAL ENGINEER	
Title: <i>Environmental Specialist II</i>	Approval Date: <i>12-4-07</i>	Expiration Date: <i>12-31-07</i>
E-mail Address: <i>TPhilley@KeyEnergy.com</i>	Conditions of Approval: <i>SUBMIT DELINEATION & PLAN BY</i>	Attached <input type="checkbox"/>
Date: <i>11/27/07</i>	Phone: <i>432-571-7141</i>	

* Attach Additional Sheets If Necessary

RP# 1672

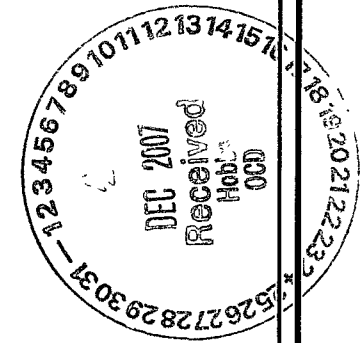
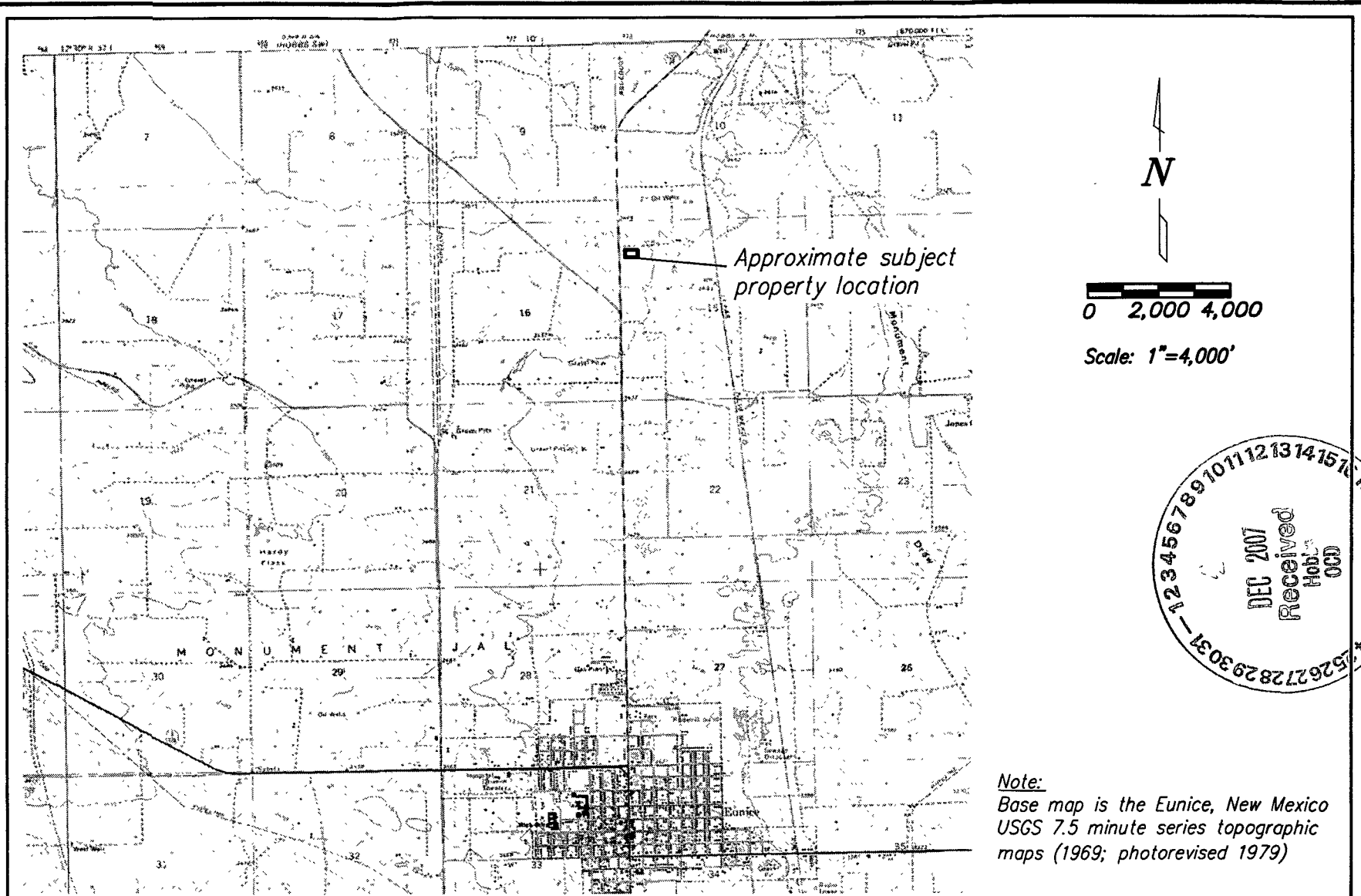

Note:
Base map is the Eunice, New Mexico
USGS 7.5 minute series topographic
maps (1969; photorevised 1979)

Site Location Map
Key Energy Discharge Plan BW-028
Near Eunice, New Mexico

Figure 1

5/17/08 08-07	Revisions By: _____ Date: _____ Descr.: _____ By: _____ Date: _____ Descr.: _____		Drawn: <u>MLV</u> Checked: <u>DJE</u> Approved: <u>DJE</u>		401 North Seventeenth Street, Suite 4 Las Cruces, New Mexico 88005-8131 (505) 647-0799 / 647-0680 (Fax) www.soudermiller.com Serving the Southwest & Rocky Mountains
	Copyright 2007 Souder, Miller & Associates - All Rights Reserved				