

NEW MEXICO OIL CONSERVATION COMMISSION
WELL LOCATION AND ACREAGE DEDICATION PLAT

Form C-102
Supersedes C-128
Effective 1-1-65

All distances must be from the outer boundaries of the Section.

SEP 26 1974

Operator Amoco Production Company		Lease Moore Ranch		Well No. 1
Unit Letter H	Section 32	Township 30 North	Range 24 East	County Colfax
Actual Footage Location of Well: 2310 feet from the North line and 330 feet from the East line				
Ground Level Elev. 6250 est.	Producing Formation Ft. Hays	Pool Wildcat	Dedicated Acreage: 40 Acres	

1. Outline the acreage dedicated to the subject well by colored pencil or hachure marks on the plat below.
2. If more than one lease is dedicated to the well, outline each and identify the ownership thereof (both as to working interest and royalty).
3. If more than one lease of different ownership is dedicated to the well, have the interests of all owners been consolidated by communitization, unitization, force-pooling, etc?

Yes No If answer is "yes," type of consolidation _____

If answer is "no," list the owners and tract descriptions which have actually been consolidated. (Use reverse side of this form if necessary.) _____

No allowable will be assigned to the well until all interests have been consolidated (by communitization, unitization, forced-pooling, or otherwise) or until a non-standard unit, eliminating such interests, has been approved by the Commission.

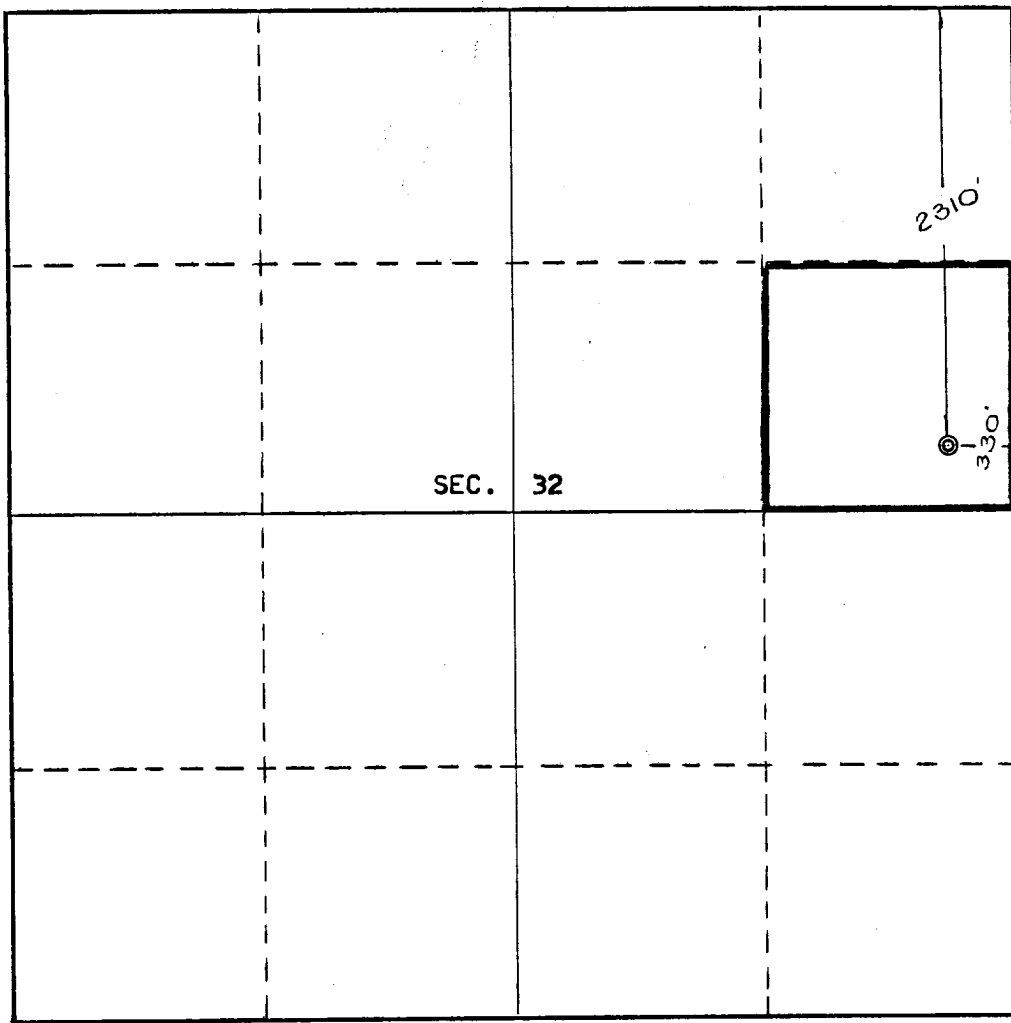

CERTIFICATION

I hereby certify that the information contained herein is true and complete to the best of my knowledge and belief.

R. E. McCleskey

Name

R. E. McCleskey

Position

Area Engineer

Company

AMOCO PRODUCTION COMPANY

Date

September 23, 1974

STATE OF NEW MEXICO
I hereby certify that the well location shown on this plat was plotted from field notes of actual surveys made by me or under my supervision, and that the same are true and correct to the best of my knowledge and belief.
REGISTERED LAND SURVEYOR

Date Surveyed

September 19, 1974

Registered Professional Engineer and/or Land Surveyor

E. V. Echohawk

Certificate No. 3602 E.V. Echohawk LS

