

NEW MEXICO OIL CONSERVATION COMMISSION

JUL 20 1982

RECEIVED	
SECTION	
DATE	
BY	
OFFICE	
FIELD	

API # 30-019-20074

1. Indicate Type of Lease
STATE STATE FEE

5. State Oil & Gas Lease No.

7. Unit Agreement Name
NNA

8. Farm or Lease Name
Walker

9. Well No.
2

10. Field and Pool, or Wildcat
Wildcat

12. County
Guadalupe

18. Proposed Depth
5,500'

19A. Formation
Pre-Cambrian Granite

20. Rotary or C.T.
Rotary

21A. Kind & Status Plug Bond
Blanket Bond-Multiple

21B. Drilling Contractor
Undesignated

22. Approx. Date Work will start
7-31-82

APPLICATION FOR PERMIT TO DRILL, DEEPEN, OR PLUG BACK

1. Type of Work
 a. Kind of Well: DRILL DEEPEN PLUG BACK
 b. Gas Well: GAS WELL OTHER SINGLE ZONE MULTIPLE ZONE

2. Name of Operator
Alta Energy Corporation

3. Address of Operator
3000 N. Garfield, Suite 210 Midland, Texas 79701

4. Location of Well
 UNIT LETTER **G** LOCATED **1980** FEET FROM THE **North** LINE
1980 FEET FROM THE **East** LINE OF SEC. **11** TWP. **7-N** RGE. **21-E** NMPM

6. Elevation (Show whether DF, RT, etc.)
4935.7 GL

PROPOSED CASING AND CEMENT PROGRAM

SIZE OF HOLE	SIZE OF CASING	WEIGHT PER FOOT	SETTING DEPTH	SACKS OF CEMENT	EST. TOP
12-1/4"	9-5/8"	36	600'	600	Circ.
8-3/4"	7"	20	2300'	100	1800'
6-1/4"	4-1/2"	10.5	5500'	600	2250'

1. Drill 12-1/4" hole with rotary tools and spud mud to 600'
2. Run and set 9-5/8", 36#/ft., ERW, IT-SS, 8rd, ST casing and cement with 600 sacks of cement + 1/4# floccel/sk. and 2% CaCl2. WOC - 12 hrs.
3. Install 3000 psi WP blowout preventer and test casing to 1000 psi, drill out cement and drill 8-3/4" hole to 2300'
4. Run and set 7", 20#/ft., ERW, K-55, 8rd STC casing and cement with 100 sacks Class "C" cement + 2% CaCl2. WOC - 18 hrs.
5. Test casing to 1500 psi, drill out cement and drill 6-1/4" hole to 5500'. Run open-hole logs. Set 4-1/2", 10.5#/ft., K-55, 8rd, STC, seamless casing at 5500' and cement with 600 sacks Class "C" 50-50 pozz "A" + 6# salt per sack, 2% gel and 1/4# floccel/sack WOC - 24 hrs.
6. Run cement bond log and proceed with completion.

APPROVAL VALID FOR 90 DAYS
 PERMIT EXPIRES 10-19-82
 UNLESS DRILLING UNDERWAY

IN ABOVE SPACE DESCRIBE PROPOSED PROGRAM; IF PROPOSAL IS TO DEEPEN OR PLUG BACK, GIVE DATA ON PRESENT PRODUCTIVE ZONE AND PROPOSED NEW PRODUCTIVE ZONE. GIVE BLOWOUT PREVENTER PROGRAM, IF ANY.

I hereby certify that the information above is true and complete to the best of my knowledge and belief.

Signed Don E. Bennett Title Agent Date 7-15-82

(This space for State Use)

APPROVED BY Carl Wlog TITLE SENIOR PETROLEUM GEOLOGIST DATE 7/21/82

CONDITIONS OF APPROVAL, IF ANY:

COLLECT AND SACK SAMPLES FOR NEW MEXICO DEPARTMENT OF MINES, SOCORRO AT AT LEAST TEN FOOT INTERVALS

OIL CONSERVATION COMMISSION TO BE NOTIFIED WITHIN 24 HOURS OF BEGINNING OPERATIONS

NEW MEXICO OIL CONSERVATION COMMISSION
WELL LOCATION AND ACREAGE DEDICATION PLAT

Form O-102
Supersedes O-128
Effective 1-1-65

JUL 20 1982

All distances must be from the outer boundaries of the Section

Operator Alta Energy Corp.		Lease Walker		Oil No.	Well No. 2
Unit Letter G	Section 11	Township 7 North	Range 21 East	County SANTA FE	
Actual Well Location Year 1980		feet from the north line and		1980 feet from the east line	
Ground Elevation 4935.7	Elevation of Well		Depth	Production Authority	

1. Outline the acreage dedicated to the subject well by colored pencil or hachure marks on the plat below.
2. If more than one lease is dedicated to the well, outline each and identify the ownership there of (both as to working interest and royalty)
3. If more than one lease of different ownership is dedicated to the well, have the interests of all owners been consolidated by communitization, unitization, force-pooling, etc.?

Yes No If answer is "yes," type of consolidation _____

If answer is "no" list the owners and tract descriptions which have actually been consolidated (Use reverse side of this form if necessary.) _____

No allowable will be assigned to the well until all interests have been consolidated (by communitization, unitization, forced-pooling, or otherwise) or until a non-standard unit eliminating such interests has been approved by the Commission.

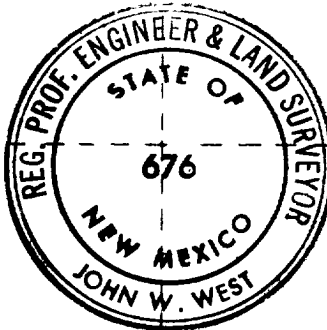
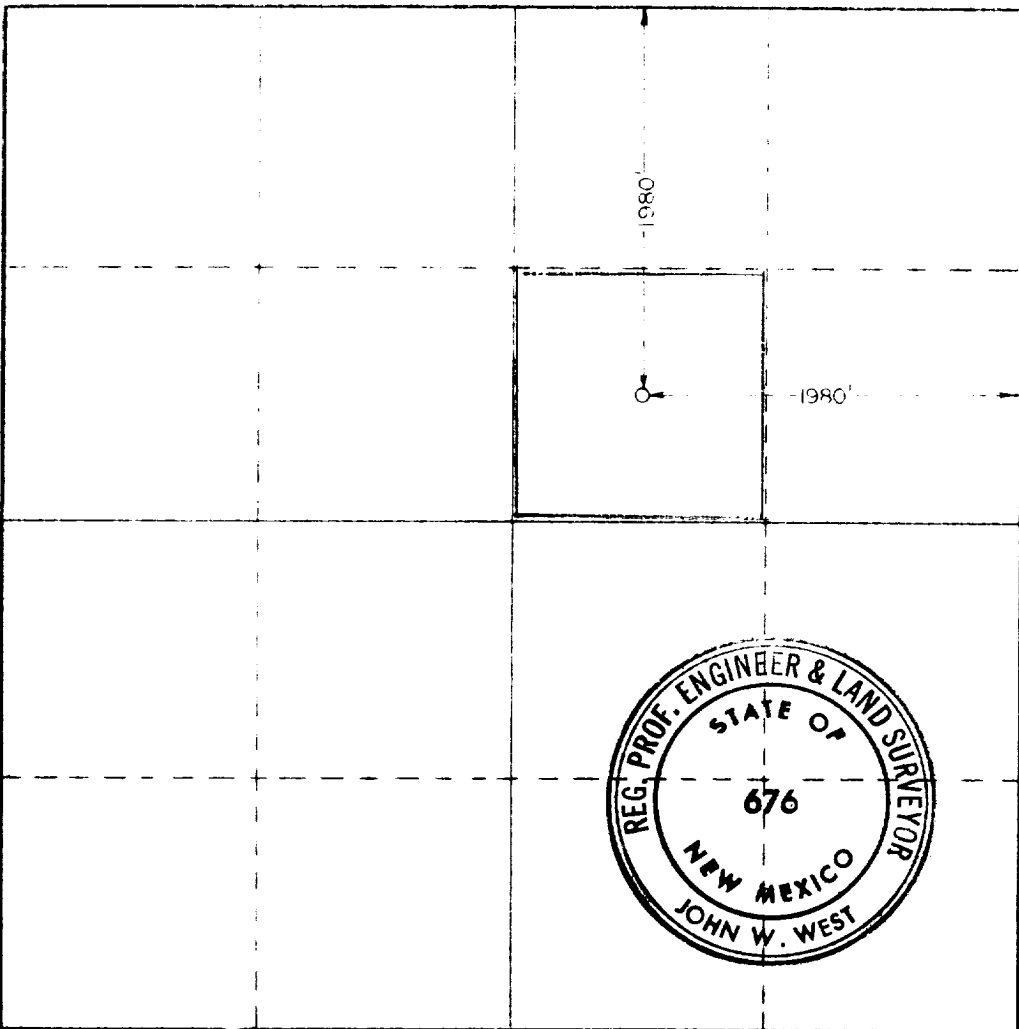

CERTIFICATION

I hereby certify that the information contained here in is true and complete to the best of my knowledge and belief

Don Roberts
Name

Agent

Position

Alta Energy Corporation

Company

7-15-82

Date

I hereby certify that the well location shown on this plat was plotted from field notes of actual surveys made by me or under my supervision, and that the same is true and correct to the best of my knowledge and belief.

Date surveyed

7-12 & 13-82

Registered Professional Engineer and/or Land Surveyor

John W. West

Certificate No **JOHN W. WEST 676**
PATRICK A. ROMERO 6883
Ronald J. Eldson 3239

