

District I
PO Box 1980, Hobbs, NM 88241-1980

District II
811 South First, Artesia, NM 88210

District III
1000 Rio Brazos Rd., Aztec, NM 87410

District IV
2040 South Pacheco, Santa Fe, NM 87505

State of New Mexico
Energy, Minerals & Natural Resources Department

OIL CONSERVATION DIVISION
2040 South Pacheco
Santa Fe, NM 87505

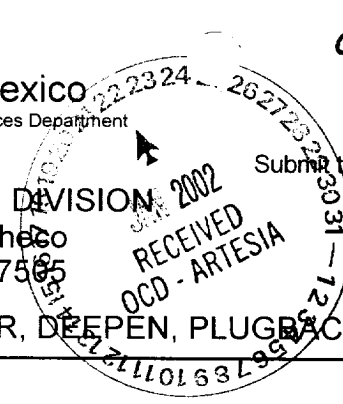

Form C-101
Revised October 18, 1994
Instructions on back
Submit to Appropriate District Office
State Lease - 6 Copies
Fee Lease - 5 Copies

AMENDED REPORT

APPLICATION FOR PERMIT TO DRILL, RE-ENTER, DEEPEN, PLUG BACK, OR ADD A ZONE

Operator Name and Address MARBOB ENERGY CORPORATION PO BOX 227 ARTESIA, NM 88211-0227		OGRID Number 14049
		API Number 30 - 0 15-20829
Property Code 26665	Property Name AIRPORT GRACE	Well No. 1

Surface Location

UL or lot no.	Section	Township	Range	Lot ldn	Feet from the	North/South line	Feet from the	East/West Line	County
K	36	22S	26E		1980	SOUTH	2164	WEST	EDDY

Proposed Bottom Hole Location If Different From Surface

UL or lot no.	Section	Township	Range	Lot ldn	Feet from the	North/South line	Feet from the	East/West Line	County
Proposed Pool 1 CARLSBAD STRAWN SOUTH					Proposed Pool 2				

Work Type Code P	Well Type Code G	Cable/Rotary R	Lease Type Code S	Ground Level Elevation 3221
Multiple No	Proposed Depth 11956	Formation STRAWN	Contractor	Spud Date 01-15-02

Proposed Casing and Cement Program

Hole Size	Casing Size	Casing weight/foot	Setting Depth	Sacks of Cement	Estimated TOC
17"	13 3/8"	48# & 72#	358'	375 SX	
12 1/4"	9 5/8"	36# & 40#	5395'	1650 SX	
8 3/4"	7"	23# & 32#	11956'	680 SX	6900'

Describe the proposed program. If this application is to DEEPEN or PLUG BACK give the data on the present productive zone and proposed new productive zone. Describe the blowout prevention program, if any. Use additional sheets if necessary.

PLUG BACK AS FOLLOWS: SET CIBP + 35' CMT @ 11,400' (MORROW PERFS 11,429' - 11,439'). SET CIBP + 35' CMT @ 10,865' (ATOKA PERFS 10,900' - 10,904'). TEST STRAWN ZONES WITHIN 10,435' - 10,564' GROSS INTERVAL. IF NOT COMMERCIAL IN STRAWN, SET CIBP + 35' CMT @ 10,400'. TEST CANYON @ 10,200' - 10,206'. IF NOT COMMERCIAL IN CANYON, SET CIBP + 35' CMT @ 10,150'. TEST WOLFCAMP ZONES WITHIN 9,525' - 9,878' GROSS INTERVAL.

Open to use ROPE, NSL required to produce. BQ

Signature: <i>Diana J. Cannon</i>		OIL CONSERVATION DIVISION	
Printed name: DIANA J. CANNON		Approved By: ORIGINAL SIGNED BY TIM W. GUM DISTRICT II SUPERVISOR	
Title: PRODUCTION ANALYST		Approval Date: JAN 28 2002	Expiration Date: JAN 28 2003
Date: 01-18-02	Phone: 505-748-3303	Conditions of Approval: Attached: <input type="checkbox"/>	

MEXICO OIL CONSERVATION COMMISSION
WELL LOCATION AND ACREAGE DEDICATION PLAT

Form C-102
Supersedes C-234
Effective 1-1-65

All distances must be from the outer boundaries of the Section.

Operator MARBOB ENERGY CORPORATION		Lease AIRPORT GRACE		Well No. 1
Unit Letter K	Section 36	Township 22 SOUTH	Range 26 EAST	County EDDY
Actual Well Location of Well: 1980 feet from the SOUTH line and 2164 feet from the WEST line.				
Ground Level Elev. 3221'	Producing Formation STRAWN	Pool SOUTH CARLSBAD	Dedicated Acreage 320 Acres	

- Outline the acreage dedicated to the subject well by colored pencil or hachure marks on the plat below.
- If more than one lease is dedicated to the well, outline each and identify the ownership thereof (both as to working interest and royalty).
- If more than one lease of different ownership is dedicated to the well, have the interests of all owners been consolidated by communitization, unitization, force-pooling, etc?
 Yes No If answer is "yes," type of consolidation: _____

If answer is "no," list the owners and tract descriptions which have actually been consolidated. (Use reverse side of this form if necessary.) _____

No allowable will be assigned to the well until all interests have been consolidated (by communitization, unitization, forced-pooling, or otherwise) or until a non-standard unit, eliminating such interests, has been approved by the Commission.

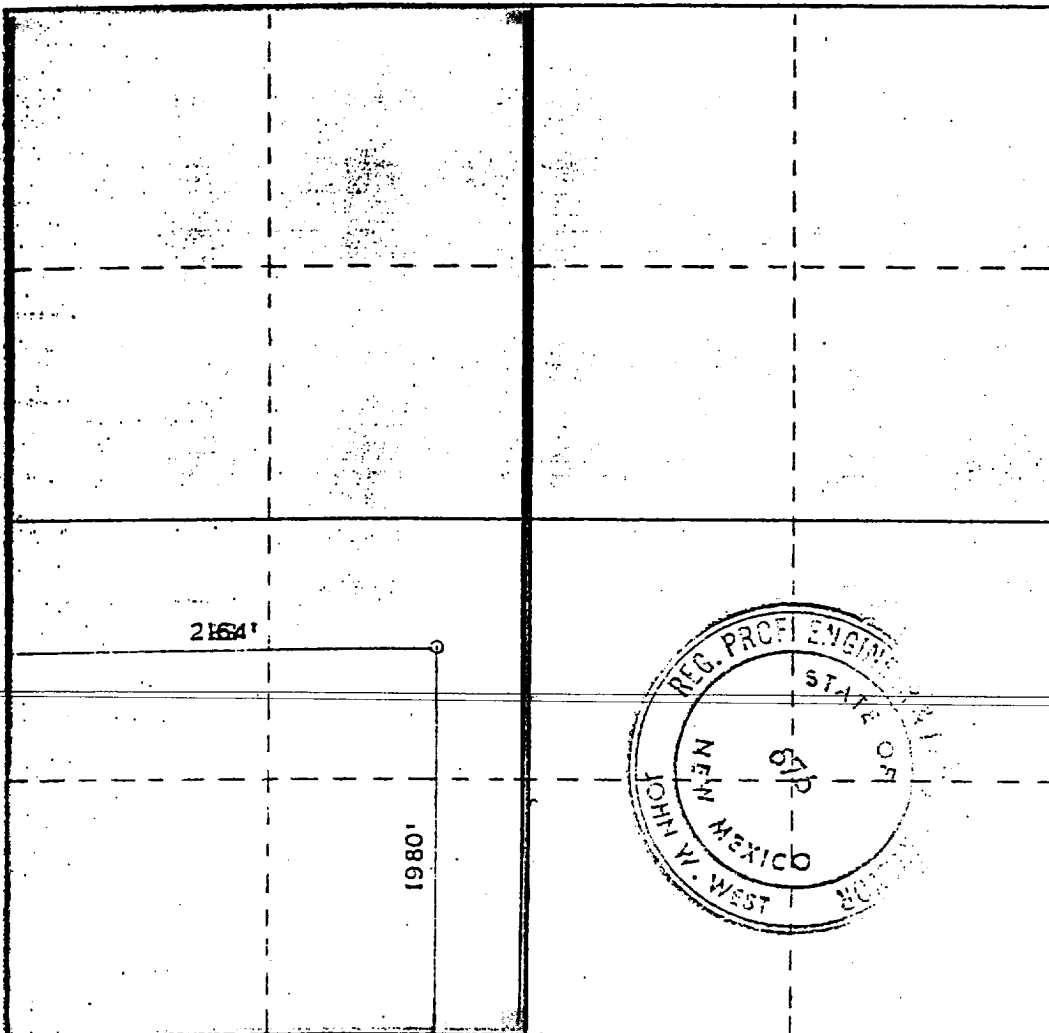

CERTIFICATION

I hereby certify that the information contained herein is true and complete to the best of my knowledge and belief.

Diana J. Cannon
Name

DIANA J. CANNON

Profession

PRODUCTION ANALYST

Company

MARBOB ENERGY CORPORATION

Date

JANUARY 18, 2002

I hereby certify that the well location shown on this plat was plotted from field notes of actual surveys made by me or under my supervision, and that the same is true and correct to the best of my knowledge and belief.

Date Surveyed

1-6-73

Registered Professional Engineer and/or Land Surveyor

John W. West
Certificate No. 676

