



PHONE (575) 397-6388 • FAX (575) 397- 0397 • 1324 W. MARLAND • P.O. BOX 805 • HOBBS, NM 88241-0805
E-MAIL: cbrunson@bbcinternational.com

OXY – SHU INJECTION BUILDING 7 TRUNKLINE

REMEDIATION PLAN

OXY will excavate the spill area as depicted on the following site diagram. The entire spill area will be excavated to a depth of 1 foot. All excavated materials will be disposed of at an NMOCD-approved disposal facility.

This plan will remove the contaminants to NMOCD acceptable levels as agreed upon.

The site will then be backfilled with clean soil.

RECEIVED

By JKeyes at 2:35 pm, Sep 30, 2015

APPROVED

Conditionally

By JKeyes at 2:35 pm, Sep 30, 2015

Stipulations:

1. At SP 3 excavate 2 ft.
2. At SP 6 two more samples, if results still exceed 250ppm continue sampling until completely delineated.

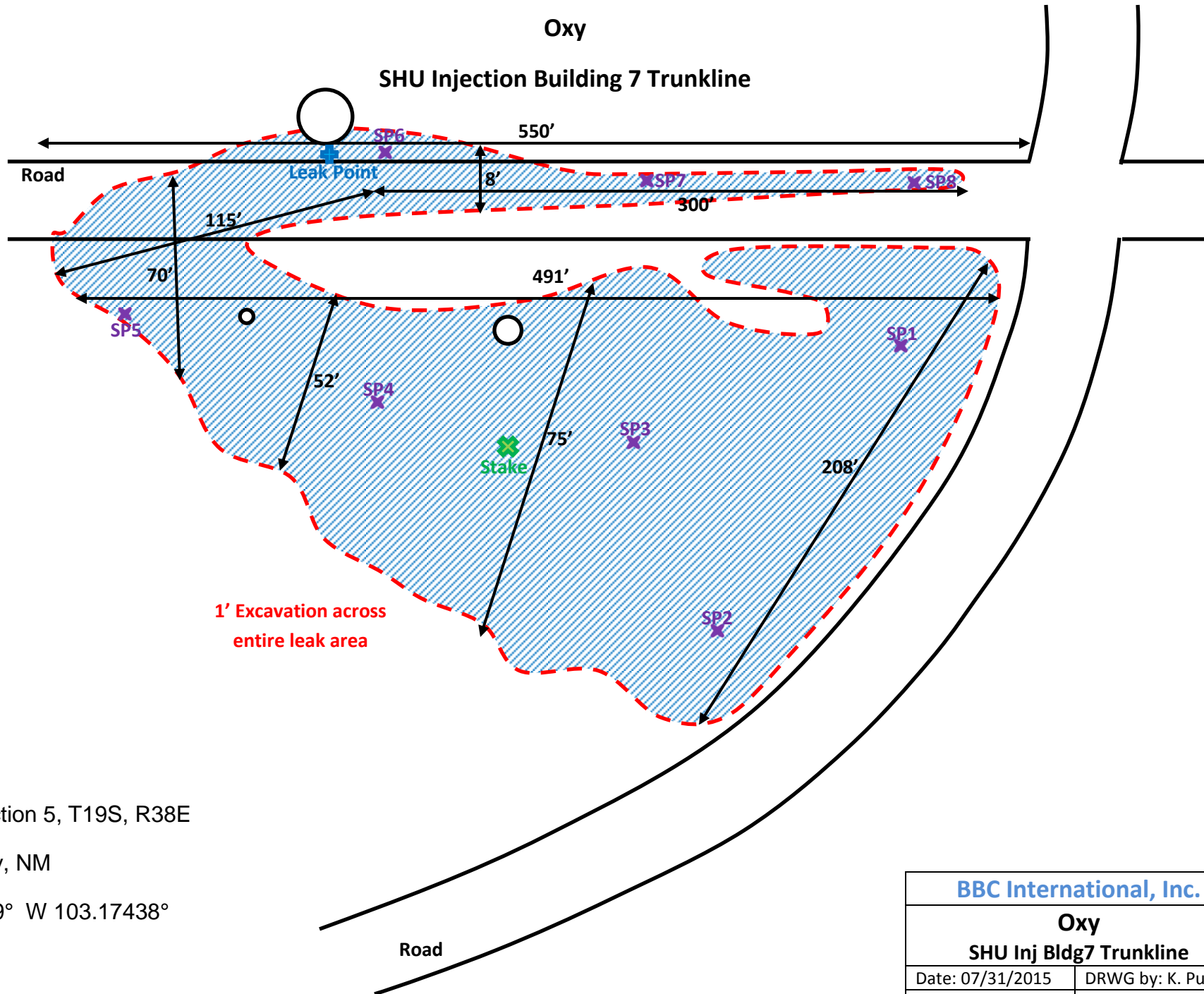

SW ¼, Section 5, T19S, R38E

Lea County, NM

N 32.68739° W 103.17438°

BBC International, Inc.

Oxy
SHU Inj Bldg7 Trunkline

Date: 07/31/2015 DRWG by: K. Purvis

NOT TO SCALE File: Oxy 2015-Was

Oxy SHU Injection Bldg 7 Trunkline

County: Lea Unit Letter: SW ¼ Section: 5 Township: 19S Range: 38E

Trend Map <50'

1

2

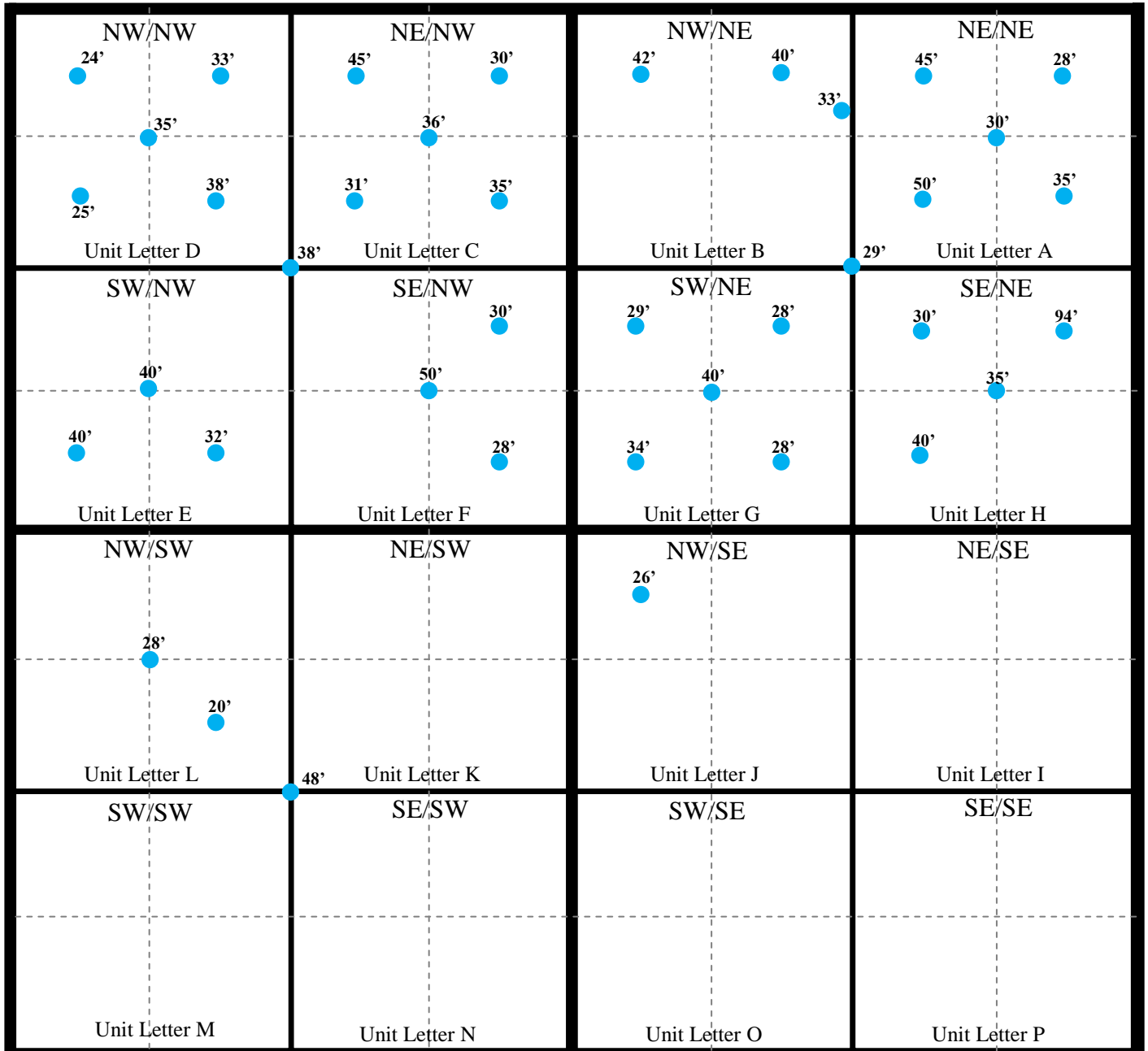

3

4

Laboratory Analytical Results Summary
SHU Injection Bldg 7 Trunkline

		Sample	SP1 @ SURFACE	SP1 @ 1'	SP1 @ 2'	SP1 @ 2.5'
Analyte	Method	Date	8/7/15	8/7/15	8/7/15	8/7/15
			mg/Kg	mg/Kg	mg/Kg	mg/Kg
Chloride	SM4500CI-B		208	496	224	112

		Sample	SP2 @ SURFACE	SP2 @ 1'	SP2 @ 2'	SP2 @ 2.5'
Analyte	Method	Date	8/7/15	8/7/15	8/7/15	8/7/15
			mg/Kg	mg/Kg	mg/Kg	mg/Kg
Chloride	SM4500CI-B		160	288	224	112

		Sample	SP3 @ SURFACE	SP3 @ 1'	SP3 @ 2'	SP3 @ 2.5'
Analyte	Method	Date	8/7/15	8/7/15	8/7/15	8/7/15
			mg/Kg	mg/Kg	mg/Kg	mg/Kg
Chloride	SM4500CI-B		208	240	512	80

		Sample	SP4 @ SURFACE	SP4 @ 1'	SP4 @ 2'	SP4 @ 2.5'
Analyte	Method	Date	8/7/15	8/7/15	8/10/15	8/10/15
			mg/Kg	mg/Kg	mg/Kg	mg/Kg
Chloride	SM4500CI-B		640	336	224	48

		Sample	SP5 @ SURFACE	SP5 @ 1'	SP5 @ 2'	SP5 @ 2.5'
Analyte	Method	Date	8/10/15	8/10/15	8/10/15	8/10/15
			mg/Kg	mg/Kg	mg/Kg	mg/Kg
Chloride	SM4500CI-B		544	448	64	80

		Sample	SP6 @ SURFACE	SP6 @ 1'	SP6 @ 2'
Analyte	Method	Date	8/10/15	8/10/15	8/10/15
			mg/Kg	mg/Kg	mg/Kg
Chloride	SM4500CI-B		32	176	320

		Sample	SP7 @ SURFACE	SP7 @ 1'	SP7 @ 2'	SP7 @ 2.5'
Analyte	Method	Date	8/10/15	8/10/15	8/10/15	8/10/15
			mg/Kg	mg/Kg	mg/Kg	mg/Kg
Chloride	SM4500CI-B		592	576	240	192

		Sample	SP8 @ SURFACE	SP8 @ 1'	SP8 @ 2'	SP8 @ 2.5'
Analyte	Method	Date	8/10/15	8/10/15	8/10/15	8/10/15
			mg/Kg	mg/Kg	mg/Kg	mg/Kg
Chloride	SM4500CI-B		592	464	208	144

August 17, 2015

Cliff Brunson

BBC International, Inc.

P.O. Box 805

Hobbs, NM 88241

RE: SHU -REMOTE INJECTION HEADER BUILDING #5

This lab was completed before Oxy requested the name be changed to SHU Injection Bldg 7 Trunkline.

Enclosed are the results of analyses for samples received by the laboratory on 08/11/15 11:44.

Cardinal Laboratories is accredited through Texas NELAP under certificate number T104704398-13-5. Accreditation applies to drinking water, non-potable water and solid and chemical materials. All accredited analytes are denoted by an asterisk (*). For a complete list of accredited analytes and matrices visit the TCEQ website at www.tceq.texas.gov/field/qa/lab_accred_certif.html.

Cardinal Laboratories is accredited through the State of Colorado Department of Public Health and Environment for:

Method EPA 552.2	Haloacetic Acids (HAA-5)
Method EPA 524.2	Total Trihalomethanes (TTHM)
Method EPA 524.4	Regulated VOCs (V1, V2, V3)

Accreditation applies to public drinking water matrices.

This report meets NELAP requirements and is made up of a cover page, analytical results, and a copy of the original chain-of-custody. If you have any questions concerning this report, please feel free to contact me.

Sincerely,



Celey D. Keene

Lab Director/Quality Manager

Analytical Results For:

BBC International, Inc.
Cliff Brunson
P.O. Box 805
Hobbs NM, 88241
Fax To: (575) 397-0397

Received:	08/11/2015	Sampling Date:	08/07/2015
Reported:	08/17/2015	Sampling Type:	Soil
Project Name:	SHU -REMOTE INJECTION HEADER BUIL	Sampling Condition:	Cool & Intact
Project Number:	NONE GIVEN	Sample Received By:	Judy Garcia
Project Location:	HOBB,NM		

Sample ID: SP1 @ SURFACE (H502085-01)

Chloride, SM4500CI-B		mg/kg		Analyzed By: AP					
Analyte	Result	Reporting Limit	Analyzed	Method Blank	BS	% Recovery	True Value QC	RPD	Qualifier
Chloride	208	16.0	08/14/2015	ND	432	108	400	7.69	

Sample ID: SP1 @ 1 (H502085-02)

Chloride, SM4500CI-B		mg/kg		Analyzed By: AP					
Analyte	Result	Reporting Limit	Analyzed	Method Blank	BS	% Recovery	True Value QC	RPD	Qualifier
Chloride	496	16.0	08/17/2015	ND	432	108	400	7.69	

Sample ID: SP1 @ 2 (H502085-03)

Chloride, SM4500CI-B		mg/kg		Analyzed By: AP					
Analyte	Result	Reporting Limit	Analyzed	Method Blank	BS	% Recovery	True Value QC	RPD	Qualifier
Chloride	224	16.0	08/17/2015	ND	432	108	400	7.69	

Sample ID: SP1 @ 2 1/2 (H502085-04)

Chloride, SM4500CI-B		mg/kg		Analyzed By: AP					
Analyte	Result	Reporting Limit	Analyzed	Method Blank	BS	% Recovery	True Value QC	RPD	Qualifier
Chloride	112	16.0	08/17/2015	ND	432	108	400	7.69	

Cardinal Laboratories

*=Accredited Analyte

PLEASE NOTE: Liability and Damages. Cardinal's liability and client's exclusive remedy for any claim arising, whether based in contract or tort, shall be limited to the amount paid by client for analyses. All claims, including those for negligence and any other cause whatsoever shall be deemed waived unless made in writing and received by Cardinal within thirty (30) days after completion of the applicable service. In no event shall Cardinal be liable for incidental or consequential damages, including, without limitation, business interruptions, loss of use, or loss of profits incurred by client, its subsidiaries, affiliates or successors arising out of or related to the performance of the services hereunder by Cardinal, regardless of whether such claim is based upon any of the above stated reasons or otherwise. Results relate only to the samples identified above. This report shall not be reproduced except in full with written approval of Cardinal Laboratories.



Celey D. Keene, Lab Director/Quality Manager

Analytical Results For:

BBC International, Inc.
Cliff Brunson
P.O. Box 805
Hobbs NM, 88241
Fax To: (575) 397-0397

Received:	08/11/2015	Sampling Date:	08/07/2015
Reported:	08/17/2015	Sampling Type:	Soil
Project Name:	SHU -REMOTE INJECTION HEADER BUIL	Sampling Condition:	Cool & Intact
Project Number:	NONE GIVEN	Sample Received By:	Judy Garcia
Project Location:	HOBBS,NM		

Sample ID: SP2 @ SURFACE (H502085-05)

Chloride, SM4500Cl-B		mg/kg		Analyzed By: AP						
Analyte	Result	Reporting Limit	Analyzed	Method Blank	BS	% Recovery	True Value QC	RPD	Qualifier	
Chloride	160	16.0	08/17/2015	ND	432	108	400	7.69		

Sample ID: SP2 @ 1 (H502085-06)

Chloride, SM4500CI-B		mg/kg		Analyzed By: AP					
Analyte	Result	Reporting Limit	Analyzed	Method Blank	BS	% Recovery	True Value QC	RPD	Qualifier
Chloride	288	16.0	08/17/2015	ND	432	108	400	7.69	

Sample ID: SP2 @ 2 (H502085-07)

Chloride, SM4500CI-B		mg/kg		Analyzed By: AP						
Analyte	Result	Reporting Limit	Analyzed	Method Blank	BS	% Recovery	True Value QC	RPD	Qualifier	
Chloride	224	16.0	08/17/2015	ND	432	108	400	7.69		

Sample ID: SP2 @ 2 1/2 (H502085-08)

Chloride, SM4500CI-B		mg/kg		Analyzed By: AP					
Analyte	Result	Reporting Limit	Analyzed	Method Blank	BS	% Recovery	True Value QC	RPD	Qualifier
Chloride	112	16.0	08/17/2015	ND	432	108	400	7.69	

Sample ID: SP3 @ SURFACE (H502085-09)

Chloride, SM4500Cl-B		mg/kg		Analyzed By: AP					
Analyte	Result	Reporting Limit	Analyzed	Method Blank	BS	% Recovery	True Value QC	RPD	Qualifier
Chloride	208	16.0	08/17/2015	ND	400	100	400	3.92	

Cardinal Laboratories

*=Accredited Analyte

PLEASE NOTE: Liability and Damages. Cardinal's liability and client's exclusive remedy for any claim arising, whether based in contract or tort, shall be limited to the amount paid by client for analyses. All claims, including those for negligence and any other cause whatsoever shall be deemed waived unless made in writing and received by Cardinal within thirty (30) days after completion of the applicable service. In no event shall Cardinal be liable for incidental or consequential damages, including, without limitation, business interruptions, loss of use, or loss of profits incurred by client, its subsidiaries, affiliates or successors arising out of or related to the performance of the services hereunder by Cardinal, regardless of whether such claim is based upon any of the above stated reasons or otherwise. Results relate only to the samples identified above. This report shall not be reproduced except in full with written approval of Cardinal Laboratories.



Celey D. Keene, Lab Director/Quality Manager

Analytical Results For:

BBC International, Inc.
Cliff Brunson
P.O. Box 805
Hobbs NM, 88241
Fax To: (575) 397-0397

Received:	08/11/2015	Sampling Date:	08/07/2015
Reported:	08/17/2015	Sampling Type:	Soil
Project Name:	SHU -REMOTE INJECTION HEADER BUIL	Sampling Condition:	Cool & Intact
Project Number:	NONE GIVEN	Sample Received By:	Judy Garcia
Project Location:	HOBBS,NM		

Sample ID: SP3 @ 1 (H502085-10)

Chloride, SM4500Cl-B		mg/kg		Analyzed By: AP						
Analyte	Result	Reporting Limit	Analyzed	Method Blank	BS	% Recovery	True Value QC	RPD	Qualifier	
Chloride	240	16.0	08/17/2015	ND	432	108	400	7.69		

Sample ID: SP3 @ 2 (H502085-11)

Chloride, SM4500Cl-B		mg/kg		Analyzed By: AP					
Analyte	Result	Reporting Limit	Analyzed	Method Blank	BS	% Recovery	True Value QC	RPD	Qualifier
Chloride	512	16.0	08/17/2015	ND	400	100	400	3.92	

Sample ID: SP3 @ 2 1/2 (H502085-12)

Chloride, SM4500Cl-B		mg/kg		Analyzed By: AP					
Analyte	Result	Reporting Limit	Analyzed	Method Blank	BS	% Recovery	True Value QC	RPD	Qualifier
Chloride	80.0	16.0	08/17/2015	ND	400	100	400	3.92	

Sample ID: SP4 @ SURFACE (H502085-13)

Chloride, SM4500Cl-B		mg/kg		Analyzed By: AP						
Analyte	Result	Reporting Limit	Analyzed	Method Blank	BS	% Recovery	True Value QC	RPD	Qualifier	
Chloride	640	16.0	08/17/2015	ND	400	100	400	3.92		

Sample ID: SP4 @ 1 (H502085-14)

Chloride, SM4500Cl-B		mg/kg		Analyzed By: AP						
Analyte	Result	Reporting Limit	Analyzed	Method Blank	BS	% Recovery	True Value QC	RPD	Qualifier	
Chloride	336	16.0	08/17/2015	ND	400	100	400	3.92		

Cardinal Laboratories

*=Accredited Analyte

PLEASE NOTE: Liability and Damages. Cardinal's liability and client's exclusive remedy for any claim arising, whether based in contract or tort, shall be limited to the amount paid by client for analyses. All claims, including those for negligence and any other cause whatsoever shall be deemed waived unless made in writing and received by Cardinal within thirty (30) days after completion of the applicable service. In no event shall Cardinal be liable for incidental or consequential damages, including, without limitation, business interruptions, loss of use, or loss of profits incurred by client, its subsidiaries, affiliates or successors arising out of or related to the performance of the services hereunder by Cardinal, regardless of whether such claim is based upon any of the above stated reasons or otherwise. Results relate only to the samples identified above. This report shall not be reproduced except in full with written approval of Cardinal Laboratories.



Celey D. Keene, Lab Director/Quality Manager

Analytical Results For:

BBC International, Inc.
Cliff Brunson
P.O. Box 805
Hobbs NM, 88241
Fax To: (575) 397-0397

Received:	08/11/2015	Sampling Date:	08/10/2015
Reported:	08/17/2015	Sampling Type:	Soil
Project Name:	SHU -REMOTE INJECTION HEADER BUIL	Sampling Condition:	Cool & Intact
Project Number:	NONE GIVEN	Sample Received By:	Judy Garcia
Project Location:	HOBB,NM		

Sample ID: SP4 @ 2 (H502085-15)

Chloride, SM4500Cl-B		mg/kg		Analyzed By: AP					
Analyte	Result	Reporting Limit	Analyzed	Method Blank	BS	% Recovery	True Value QC	RPD	Qualifier
Chloride	224	16.0	08/17/2015	ND	400	100	400	3.92	

Sample ID: SP4 @ 2 1/2 (H502085-16)

Chloride, SM4500CI-B		mg/kg		Analyzed By: AP					
Analyte	Result	Reporting Limit	Analyzed	Method Blank	BS	% Recovery	True Value QC	RPD	Qualifier
Chloride	48.0	16.0	08/17/2015	ND	400	100	400	3.92	

Sample ID: SP5 @ SURFACE (H502085-17)

Chloride, SM4500CI-B		mg/kg		Analyzed By: AP					
Analyte	Result	Reporting Limit	Analyzed	Method Blank	BS	% Recovery	True Value QC	RPD	Qualifier
Chloride	544	16.0	08/17/2015	ND	400	100	400	3.92	

Sample ID: SP5 @ 1 (H502085-18)

Chloride, SM4500CI-B		mg/kg		Analyzed By: AP					
Analyte	Result	Reporting Limit	Analyzed	Method Blank	BS	% Recovery	True Value QC	RPD	Qualifier
Chloride	448	16.0	08/17/2015	ND	400	100	400	3.92	

Sample ID: SP5 @ 2 (H502085-19)

Chloride, SM4500Cl-B		mg/kg		Analyzed By: AP					
Analyte	Result	Reporting Limit	Analyzed	Method Blank	BS	% Recovery	True Value QC	RPD	Qualifier
Chloride	64.0	16.0	08/17/2015	ND	400	100	400	3.92	

Cardinal Laboratories

*=Accredited Analyte

PLEASE NOTE: Liability and Damages. Cardinal's liability and client's exclusive remedy for any claim arising, whether based in contract or tort, shall be limited to the amount paid by client for analyses. All claims, including those for negligence and any other cause whatsoever shall be deemed waived unless made in writing and received by Cardinal within thirty (30) days after completion of the applicable service. In no event shall Cardinal be liable for incidental or consequential damages, including, without limitation, business interruptions, loss of use, or loss of profits incurred by client, its subsidiaries, affiliates or successors arising out of or related to the performance of the services hereunder by Cardinal, regardless of whether such claim is based upon any of the above stated reasons or otherwise. Results relate only to the samples identified above. This report shall not be reproduced except in full with written approval of Cardinal Laboratories.



Celey D. Keene, Lab Director/Quality Manager

Analytical Results For:

BBC International, Inc.
Cliff Brunson
P.O. Box 805
Hobbs NM, 88241
Fax To: (575) 397-0397

Received:	08/11/2015	Sampling Date:	08/10/2015
Reported:	08/17/2015	Sampling Type:	Soil
Project Name:	SHU -REMOTE INJECTION HEADER BUIL	Sampling Condition:	Cool & Intact
Project Number:	NONE GIVEN	Sample Received By:	Judy Garcia
Project Location:	HOBBS,NM		

Sample ID: SP5 @ 2 1/2 (H502085-20)

Chloride, SM4500Cl-B		mg/kg		Analyzed By: AP					
Analyte	Result	Reporting Limit	Analyzed	Method Blank	BS	% Recovery	True Value QC	RPD	Qualifier
Chloride	80.0	16.0	08/17/2015	ND	400	100	400	3.92	

Sample ID: SP6 @ SURFACE (H502085-21)

Chloride, SM4500Cl-B		mg/kg		Analyzed By: AP					
Analyte	Result	Reporting Limit	Analyzed	Method Blank	BS	% Recovery	True Value QC	RPD	Qualifier
Chloride	32.0	16.0	08/17/2015	ND	400	100	400	3.92	

Sample ID: SP6 @ 1 (H502085-22)

Chloride, SM4500Cl-B		mg/kg		Analyzed By: AP					
Analyte	Result	Reporting Limit	Analyzed	Method Blank	BS	% Recovery	True Value QC	RPD	Qualifier
Chloride	176	16.0	08/17/2015	ND	400	100	400	3.92	

Sample ID: SP6 @ 2 (H502085-23)

Chloride, SM4500Cl-B		mg/kg		Analyzed By: AP					
Analyte	Result	Reporting Limit	Analyzed	Method Blank	BS	% Recovery	True Value QC	RPD	Qualifier
Chloride	320	16.0	08/17/2015	ND	400	100	400	3.92	

Sample ID: SP7 @ SURFACE (H502085-24)

Chloride, SM4500Cl-B		mg/kg		Analyzed By: AP					
Analyte	Result	Reporting Limit	Analyzed	Method Blank	BS	% Recovery	True Value QC	RPD	Qualifier
Chloride	592	16.0	08/17/2015	ND	400	100	400	3.92	

Cardinal Laboratories

*=Accredited Analyte

PLEASE NOTE: Liability and Damages. Cardinal's liability and client's exclusive remedy for any claim arising, whether based in contract or tort, shall be limited to the amount paid by client for analyses. All claims, including those for negligence and any other cause whatsoever shall be deemed waived unless made in writing and received by Cardinal within thirty (30) days after completion of the applicable service. In no event shall Cardinal be liable for incidental or consequential damages, including, without limitation, business interruptions, loss of use, or loss of profits incurred by client, its subsidiaries, affiliates or successors arising out of or related to the performance of the services hereunder by Cardinal, regardless of whether such claim is based upon any of the above stated reasons or otherwise. Results relate only to the samples identified above. This report shall not be reproduced except in full with written approval of Cardinal Laboratories.



Celey D. Keene, Lab Director/Quality Manager

Analytical Results For:

BBC International, Inc.
Cliff Brunson
P.O. Box 805
Hobbs NM, 88241
Fax To: (575) 397-0397

Received:	08/11/2015	Sampling Date:	08/10/2015
Reported:	08/17/2015	Sampling Type:	Soil
Project Name:	SHU -REMOTE INJECTION HEADER BUIL	Sampling Condition:	Cool & Intact
Project Number:	NONE GIVEN	Sample Received By:	Judy Garcia
Project Location:	HOBBS,NM		

Sample ID: SP7 @ 1 (H502085-25)

Chloride, SM4500Cl-B		mg/kg		Analyzed By: AP					
Analyte	Result	Reporting Limit	Analyzed	Method Blank	BS	% Recovery	True Value QC	RPD	Qualifier
Chloride	576	16.0	08/17/2015	ND	400	100	400	3.92	

Sample ID: SP7 @ 2 (H502085-26)

Chloride, SM4500CI-B		mg/kg		Analyzed By: AP					
Analyte	Result	Reporting Limit	Analyzed	Method Blank	BS	% Recovery	True Value QC	RPD	Qualifier
Chloride	240	16.0	08/17/2015	ND	400	100	400	3.92	

Sample ID: SP7 @ 2 1/2 (H502085-27)

Chloride, SM4500CI-B		mg/kg		Analyzed By: AP						
Analyte	Result	Reporting Limit	Analyzed	Method Blank	BS	% Recovery	True Value QC	RPD	Qualifier	
Chloride	192	16.0	08/17/2015	ND	400	100	400	3.92		

Sample ID: SP8 @ SURFACE (H502085-28)

Chloride, SM4500CI-B		mg/kg		Analyzed By: AP					
Analyte	Result	Reporting Limit	Analyzed	Method Blank	BS	% Recovery	True Value QC	RPD	Qualifier
Chloride	592	16.0	08/17/2015	ND	400	100	400	3.92	

Sample ID: SP8 @ 1 (H502085-29)

Chloride, SM4500Cl-B		mg/kg		Analyzed By: AP					
Analyte	Result	Reporting Limit	Analyzed	Method Blank	BS	% Recovery	True Value QC	RPD	Qualifier
Chloride	464	16.0	08/17/2015	ND	400	100	400	3.92	

Cardinal Laboratories

*=Accredited Analyte

PLEASE NOTE: Liability and Damages. Cardinal's liability and client's exclusive remedy for any claim arising, whether based in contract or tort, shall be limited to the amount paid by client for analyses. All claims, including those for negligence and any other cause whatsoever shall be deemed waived unless made in writing and received by Cardinal within thirty (30) days after completion of the applicable service. In no event shall Cardinal be liable for incidental or consequential damages, including, without limitation, business interruptions, loss of use, or loss of profits incurred by client, its subsidiaries, affiliates or successors arising out of or related to the performance of the services hereunder by Cardinal, regardless of whether such claim is based upon any of the above stated reasons or otherwise. Results relate only to the samples identified above. This report shall not be reproduced except in full with written approval of Cardinal Laboratories.



Celey D. Keene, Lab Director/Quality Manager

Analytical Results For:

BBC International, Inc.
Cliff Brunson
P.O. Box 805
Hobbs NM, 88241
Fax To: (575) 397-0397

Received:	08/11/2015	Sampling Date:	08/10/2015
Reported:	08/17/2015	Sampling Type:	Soil
Project Name:	SHU -REMOTE INJECTION HEADER BUIL	Sampling Condition:	Cool & Intact
Project Number:	NONE GIVEN	Sample Received By:	Judy Garcia
Project Location:	HOBB,NM		

Sample ID: SP8 @ 2 (H502085-30)

Chloride, SM4500Cl-B		mg/kg		Analyzed By: AP						
Analyte	Result	Reporting Limit	Analyzed	Method Blank	BS	% Recovery	True Value QC	RPD	Qualifier	
Chloride	208	16.0	08/17/2015	ND	400	100	400	3.92		

Sample ID: SP8 @ 2 1/2 (H502085-31)

Chloride, SM4500Cl-B		mg/kg		Analyzed By: AP						
Analyte	Result	Reporting Limit	Analyzed	Method Blank	BS	% Recovery	True Value QC	RPD	Qualifier	
Chloride	144	16.0	08/17/2015	ND	400	100	400	3.92		

Cardinal Laboratories

*=Accredited Analyte

PLEASE NOTE: Liability and Damages. Cardinal's liability and client's exclusive remedy for any claim arising, whether based in contract or tort, shall be limited to the amount paid by client for analyses. All claims, including those for negligence and any other cause whatsoever shall be deemed waived unless made in writing and received by Cardinal within thirty (30) days after completion of the applicable service. In no event shall Cardinal be liable for incidental or consequential damages, including, without limitation, business interruptions, loss of use, or loss of profits incurred by client, its subsidiaries, affiliates or successors arising out of or related to the performance of the services hereunder by Cardinal, regardless of whether such claim is based upon any of the above stated reasons or otherwise. Results relate only to the samples identified above. This report shall not be reproduced except in full with written approval of Cardinal Laboratories.



Celey D. Keene, Lab Director/Quality Manager

Notes and Definitions

ND	Analyte NOT DETECTED at or above the reporting limit
RPD	Relative Percent Difference
**	Samples not received at proper temperature of 6°C or below.
***	Insufficient time to reach temperature.
-	Chloride by SM4500Cl-B does not require samples be received at or below 6°C Samples reported on an as received basis (wet) unless otherwise noted on report

Cardinal Laboratories

*=Accredited Analyte

PLEASE NOTE: Liability and Damages. Cardinal's liability and client's exclusive remedy for any claim arising, whether based in contract or tort, shall be limited to the amount paid by client for analyses. All claims, including those for negligence and any other cause whatsoever shall be deemed waived unless made in writing and received by Cardinal within thirty (30) days after completion of the applicable service. In no event shall Cardinal be liable for incidental or consequential damages, including, without limitation, business interruptions, loss of use, or loss of profits incurred by client, its subsidiaries, affiliates or successors arising out of or related to the performance of the services hereunder by Cardinal, regardless of whether such claim is based upon any of the above stated reasons or otherwise. Results relate only to the samples identified above. This report shall not be reproduced except in full with written approval of Cardinal Laboratories.



Celey D. Keene, Lab Director/Quality Manager



101 East Marland, Hobbs, NM 88240
(505) 393-2326 FAX (505) 393-2476

14

Page 10 of 13



101 East Marland, Hobbs, NM 88240
(505) 393-2326 FAX (505) 393-2476

CHAIN-OF-CUSTODY AND ANALYSIS REQUEST

2/4

Page 11 of 13



CARDINAL LABORATORIES

101 East Marland, Hobbs, NM 88240
(505) 393-2326 FAX (505) 393-2476

CHAIN-OF-CUSTODY AND ANALYSIS REQUEST

Company Name: BBC International, Inc.
Project Manager: Cliff Brunson

Address: P.O. Box 805

City: Hobbs

State: NM Zip: 88241

Phone #: 575-397-6388

Fax #: 575-397-0397

Project #:

Project Owner: OK

Project Name: 544-Route Hydration Heater & Hydrants

Project Location: Hobbs

Sampler Name: L.D. Sprague

FOR LAB USE ONLY

BILL TO

ANALYSIS REQUEST

P.O. #:

Company:

Attn:

Address:

City:

State: Zip:

Phone #:

Fax #:

Lab I.D.

Sample I.D.

H502085

Spec 212

(G)RAB OR (C)OMP

CONTAINERS

GROUNDWATER

WASTEWATER

SOIL

OIL

SLUDGE

OTHER

ACID/BASE

ICE / COOL

OTHER

DATE

TIME

CL-

8-26

353

X

PLEASE NOTE: Liability and claims exclusive remedy for any claim arising hereunder shall be limited to the amount paid by the client for the analysis. All claims, including those for negligence and any other cause whatsoever shall be deemed waived unless made in writing and received by Cardinal within 30 days after completion of the applicable service. In no event shall Cardinal be liable for incidental or consequential damages, including without limitation, business interruption, loss of use, or loss of profits incurred by client, its subsidiaries, affiliates or successors arising out of or related to the performance of services hereunder by Cardinal, regardless of whether such claim is based upon any of the above stated reasons or otherwise.

Relinquished By:

Date: 8-11-15

Received By:

Relinquished By:

Date: 8-11-15

Received By:

Delivered By: (Circle One)

Sampler - UPS - Bus - Other:

Time: 11:44

Sample Condition: Cool, intact

CHECKED BY: (Initials)

Phone Result: ☐ Yes ☐ No

Fax Result: ☐ Yes ☐ No

REMARKS:

Cardinal cannot accept verbal changes. Please fax written changes to 505-393-2476

#54

District I
1625 N. French Dr., Hobbs, NM 88240
District II
811 S. First St., Artesia, NM 88210
District III
1000 Rio Brazos Road, Aztec, NM 87410
District IV
1220 S. St. Francis Dr., Santa Fe, NM 87505

State of New Mexico
Energy Minerals and Natural Resources

Oil Conservation Division
1220 South St. Francis Dr.
Santa Fe, NM 87505

Form C-141
Revised August 8, 2011

Submit 1 Copy to appropriate District Office in
accordance with 19.15.29 NMAC.

Release Notification and Corrective Action

OPERATOR

☒ Initial Report ☐ Final Report

Name of Company	Oxy Permian	Contact	Tony Aguilar
Address	1017 W. Stanolind Road	Telephone No.	(575) 397-8251
Facility Name	SHU Injection Building 7 Trunkline	Facility Type	Injection

Surface Owner	Mineral Owner	API No.	30-025-07623
---------------	---------------	---------	--------------

LOCATION OF RELEASE

Unit Letter	Section	Township	Range	Feet from the	North/South Line	Feet from the	East/West Line	County
SW ¼	5	19S	38E					Lea County, NM

Latitude N 32.68739° Longitude W 103.17438°

NATURE OF RELEASE

Type of Release	Produced water	Volume of Release	2338 bbls	Volume Recovered	600 bbls
Source of Release	Internal corrosion of an injection line	Date and Hour of Occurrence	07/28/2015	Date and Hour of Discovery	
Was Immediate Notice Given?	<input checked="" type="checkbox"/> Yes <input type="checkbox"/> No <input type="checkbox"/> Not Required	If YES, To Whom?	Kellie Jones and Maxie Brown- NMOCD		
By Whom?	Tony Aguilar, Oxy	Date and Hour	07/28/2015 @ 4:24 pm		
Was a Watercourse Reached?	<input type="checkbox"/> Yes <input checked="" type="checkbox"/> No	If YES, Volume Impacting the Watercourse.			

If a Watercourse was Impacted, Describe Fully.*

Describe Cause of Problem and Remedial Action Taken.*

Internal corrosion of an injection line caused 2338 bbls of produced water to leak onto the ground. A vacuum truck recovered 600 bls of water and the line was repaired or replaced.

Describe Area Affected and Cleanup Action Taken.*

The area affected is approximately 500' x 300' off location and into the pasture. Remediation will be completed in accordance with a remediation plan approved by NMOCD.

I hereby certify that the information given above is true and complete to the best of my knowledge and understand that pursuant to NMOCD rules and regulations all operators are required to report and/or file certain release notifications and perform corrective actions for releases which may endanger public health or the environment. The acceptance of a C-141 report by the NMOCD marked as "Final Report" does not relieve the operator of liability should their operations have failed to adequately investigate and remediate contamination that pose a threat to ground water, surface water, human health or the environment. In addition, NMOCD acceptance of a C-141 report does not relieve the operator of responsibility for compliance with any other federal, state, or local laws and/or regulations.

Signature: 	OIL CONSERVATION DIVISION		
Printed Name: Tony Aguilar	Approved by Environmental Specialist:		
Title: HES Specialist	Approval Date:	Expiration Date:	
E-mail Address: Raymond_aguilar@oxy.com	Conditions of Approval:		Attached <input type="checkbox"/>
Date: 9-16-15	Phone: (575) 397-8251		

* Attach Additional Sheets If Necessary