

RECEIVED

By JKeyes at 3:32 pm, Dec 18, 2015

Closure Report**APPROVED**

By JKeyes at 3:32 pm, Dec 18, 2015

Site Description

Site Name:	Proximity 31 Federal #4 SWD Battery
Company:	Oxy Permian Ltd.
Legal Description:	U/L B, Section 31, T22S, R32E
County:	Lea County, NM
GPS Coordinates:	N 32.35339° W 103.71131°

Release Data

Date of Release:	07/27/2015
Type of Release:	Oil and Produced water
Source of Release:	Stress/fatigue of an 8" fiberglass suction line off of tank
Volume of Release:	10 bbls oil and 100 bbls produced water
Volume Recovered:	5 bbls oil, 100 bbls produced water

Remediation Specifications

Remediation Parameters:	Surface scrape the entire leak area to a depth of 6 inches. Backfill the site with clean soil.	
Remediation Activities:	12/02/2015 to 12/08/2015	
Plan Sent to OCD:	08/17/2015	Email from Cliff Brunson to Kellie Jones
OCD Approval of Plan:	08/18/2015	Email from Kellie Jones to Cliff Brunson
Plan Sent to BLM:	08/19/2015	Email from Cliff Brunson to Shelly Tucker
BLM Approval of Plan:	08/20/2015	Email from Shelly Tucker to Cliff Brunson

Supporting Documentation

Initial C-141	Signed 08/13/2015
Final C-141	Signed 12/09/2015
Site Diagram	July 2015
Groundwater Plot	275'
TOPO Maps	July 2015
Lab Summary	07/31/2015
Lab Analysis	07/31/2015
Correspondence	Request and approval of remediation plan via email

Request for Closure

Based on the completion of the remediation plan as agreed upon, BBC International requests closure approval from NMOCD.

Cliff Brunson, President of BBC International Inc.

12/18/2015

District I
1625 N. French Dr., Hobbs, NM 88240
District II
811 S. First St., Artesia, NM 88210
District III
1000 Rio Brazos Road, Aztec, NM 87410
District IV
1220 S. St. Francis Dr., Santa Fe, NM 87505

State of New Mexico
Energy Minerals and Natural Resources

Oil Conservation Division
1220 South St. Francis Dr.
Santa Fe, NM 87505

Form C-141
Revised August 8, 2011

Submit 1 Copy to appropriate District Office in
accordance with 19.15.29 NMAC.

Release Notification and Corrective Action

OPERATOR

☒ Initial Report ☐ Final Report

Name of Company	Oxy Permian Ltd.	Contact	CJ Summers
Address	6 Desta Drive, Midland, TX 79705	Telephone No.	(432) 685-5824
Facility Name	Proximity 31 Federal #4 SWD Battery	Facility Type	Battery

Surface Owner	BLM	Mineral Owner		API No.	30-025-20423
---------------	-----	---------------	--	---------	--------------

LOCATION OF RELEASE

Unit Letter	Section	Township	Range	Feet from the	North/South Line	Feet from the	East/West Line	County
B	31	22S	32E					Lea County, NM

Latitude N 32.35339° Longitude W 103.71131°

NATURE OF RELEASE

Type of Release	Oil and produced water	Volume of Release	10 bbls oil and 100 bbls produced water	Volume Recovered	5 bbls oil, 100 bbls produced water
Source of Release	Stress/fatigue of an 8" fiberglass suction line off a tank	Date and Hour of Occurrence	07/27/2015	Date and Hour of Discovery	
Was Immediate Notice Given?	<input checked="" type="checkbox"/> Yes <input type="checkbox"/> No <input type="checkbox"/> Not Required	If YES, To Whom?	Kellie Jones, Jamie Keyes, & Tomas Oberding-NMOCD; Shelly Tucker-BLM		
By Whom?	Kathy Purvis @ BBC International Inc.	Date and Hour	7/28/2015 @ 3:28 pm		
Was a Watercourse Reached?	<input type="checkbox"/> Yes <input checked="" type="checkbox"/> No	If YES, Volume Impacting the Watercourse.			

If a Watercourse was Impacted, Describe Fully.*

Describe Cause of Problem and Remedial Action Taken.*

Stress/fatigue of an 8" fiberglass suction line off of a tank caused 10 bbls of oil and 100 bbls of produced water to leak onto the ground. A vacuum truck recovered 5 bbls of oil and 100 bbls of produced water and the line was repaired/replaced.

Describe Area Affected and Cleanup Action Taken.*

The affected area is approximately 50' x 25' on location inside the firewall. Remediation will be completed according to a remediation plan approved by NMOCD and the BLM.

I hereby certify that the information given above is true and complete to the best of my knowledge and understand that pursuant to NMOCD rules and regulations all operators are required to report and/or file certain release notifications and perform corrective actions for releases which may endanger public health or the environment. The acceptance of a C-141 report by the NMOCD marked as "Final Report" does not relieve the operator of liability should their operations have failed to adequately investigate and remediate contamination that pose a threat to ground water, surface water, human health or the environment. In addition, NMOCD acceptance of a C-141 report does not relieve the operator of responsibility for compliance with any other federal, state, or local laws and/or regulations.

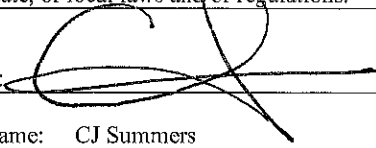
Signature: 	OIL CONSERVATION DIVISION		
Printed Name: CJ Summers	Approved by Environmental Specialist:		
Title: HES Lead	Approval Date:	Expiration Date:	
E-mail Address: chancey_summers@oxy.com	Conditions of Approval:		Attached <input type="checkbox"/>
Date: 8-13-15	Phone: (432) 685-5824		

* Attach Additional Sheets If Necessary

District I
1625 N. French Dr., Hobbs, NM 88240
District II
811 S. First St., Artesia, NM 88210
District III
1000 Rio Brazos Road, Aztec, NM 87410
District IV
1220 S. St. Francis Dr., Santa Fe, NM 87505

State of New Mexico
Energy Minerals and Natural Resources

Oil Conservation Division
1220 South St. Francis Dr.
Santa Fe, NM 87505

Form C-141
Revised August 8, 2011

Submit 1 Copy to appropriate District Office in
accordance with 19.15.29 NMAC.

Release Notification and Corrective Action

OPERATOR

☐ Initial Report ☒ Final Report

Name of Company	Oxy Permian Ltd.	Contact	Dusty Wilson
Address	6 Desta Drive, Midland, TX 79705	Telephone No.	(432) 685-5771
Facility Name	Proximity 31 Federal #4 SWD Battery	Facility Type	Battery
Surface Owner	BLM	Mineral Owner	
		API No.	30-025-20423

LOCATION OF RELEASE

Unit Letter	Section	Township	Range	Feet from the	North/South Line	Feet from the	East/West Line	County
B	31	22S	32E					Lea County, NM

Latitude N 32.35339° Longitude W 103.71131°

NATURE OF RELEASE

Type of Release	Oil and produced water	Volume of Release	10 bbls oil and 100 bbls produced water	Volume Recovered	5 bbls oil, 100 bbls produced water
Source of Release	Stress/fatigue of an 8" fiberglass suction line off a tank	Date and Hour of Occurrence	07/27/2015	Date and Hour of Discovery	
Was Immediate Notice Given?	<input checked="" type="checkbox"/> Yes <input type="checkbox"/> No <input type="checkbox"/> Not Required	If YES, To Whom?	Kellie Jones, Jamie Keyes, & Tomas Oberding-NMOCD; Shelly Tucker-BLM		
By Whom?	Kathy Purvis @ BBC International Inc.	Date and Hour	7/28/2015 @ 3:28 pm		
Was a Watercourse Reached?	<input type="checkbox"/> Yes <input checked="" type="checkbox"/> No	If YES, Volume Impacting the Watercourse.			

If a Watercourse was Impacted, Describe Fully.*



Describe Cause of Problem and Remedial Action Taken.*

Stress/fatigue of an 8" fiberglass suction line off of a tank caused 10 bbls of oil and 100 bbls of produced water to leak onto the ground. A vacuum truck recovered 5 bbls of oil and 100 bbls of produced water and the line was repaired/replaced.

Describe Area Affected and Cleanup Action Taken.*

The affected area is approximately 50' x 25' on location inside the firewall. Remediation was completed in accordance with the remediation plan approved by Kellie Jones of NMOCD via email on 08/18/2015 and approved by Shelly Tucker of the BLM via email on 08/20/2015.

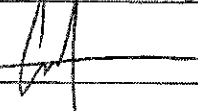
I hereby certify that the information given above is true and complete to the best of my knowledge and understand that pursuant to NMOCD rules and regulations all operators are required to report and/or file certain release notifications and perform corrective actions for releases which may endanger public health or the environment. The acceptance of a C-141 report by the NMOCD marked as "Final Report" does not relieve the operator of liability should their operations have failed to adequately investigate and remediate contamination that pose a threat to ground water, surface water, human health or the environment. In addition, NMOCD acceptance of a C-141 report does not relieve the operator of responsibility for compliance with any other federal, state, or local laws and/or regulations.

Signature: 		<u>OIL CONSERVATION DIVISION</u>	
Printed Name: Casey Summers		Approved by Environmental Specialist: 	
Title: NM Environmental Advisor		Approval Date: 12/18/2015	Expiration Date: ///
E-mail Address: casey_summers@oxy.com		Conditions of Approval: ///	Attached <input type="checkbox"/>
Date: 12-9-15	Phone: (575)513-8289	1RP 3802	

* Attach Additional Sheets If Necessary



Oxy
Proximity 31 Federal #4 SWD Battery

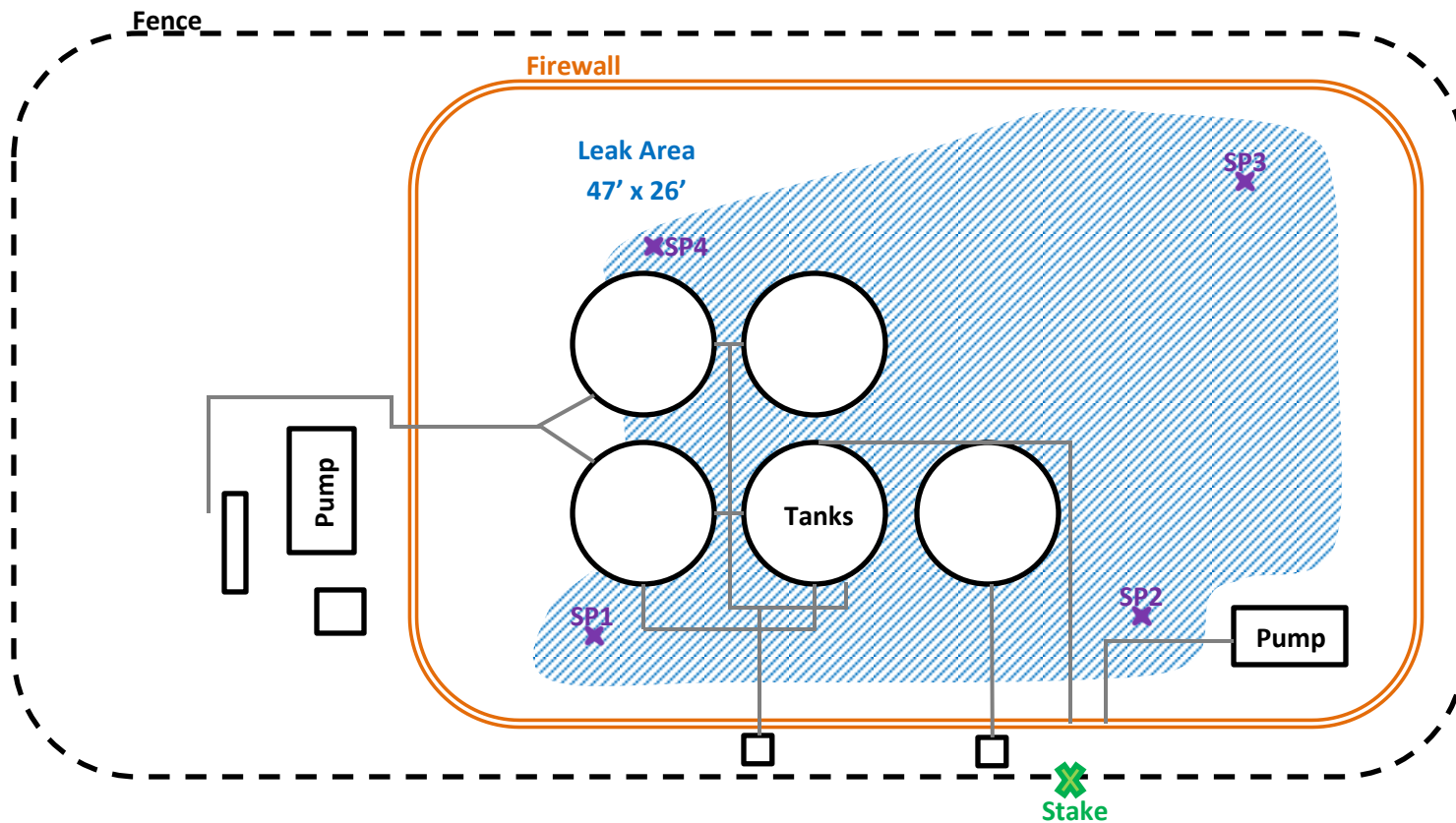

U/L B, Section 31, T22S, R32E

Lea County, NM

N 32.35339° W 103.71131°

API#30-025-20423

BBC International, Inc.

Oxy

Proximity 31 Federal #4 SWD Btry

Date: 07/31/2015

DRWG by: K. Purvis

NOT TO SCALE

File: Oxy 2015



Groundwater Plot

Oxy Proximity 31 Federal #4 SWD Btry

County
Lea

Unit Letter
B

Section
31

Township
22S

Range
32E

Trend Map 275'

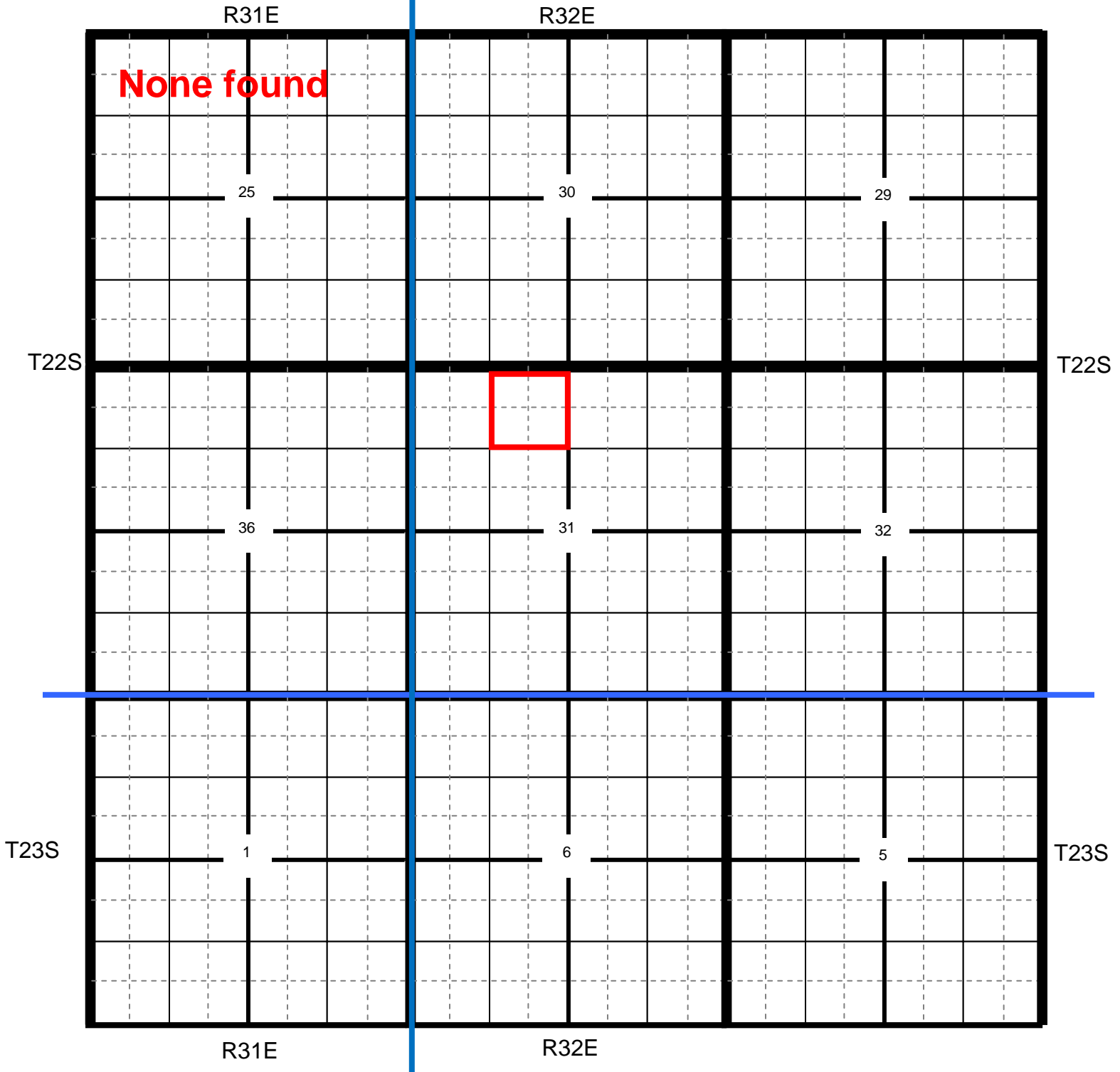

Location

OCD

USGS

SEO

All Databases

Section Quarters

Oxy Proximity 31 Federal #4 SWD Btry

County
 Lea

Unit Letter
 B

Section
 31

Township
 22S

Range
 32E

Trend Map 275'

1

2

NW/NW None found	NE/NW	NW/NE	NE/NE
Unit Letter D	Unit Letter C	Unit Letter B	Unit Letter A
SW/NW	SE/NW	SW/NE	SE/NE
Unit Letter E	Unit Letter F	Unit Letter G	Unit Letter H
NW/SW	NE/SW	NW/SE	NE/SE
Unit Letter L	Unit Letter K	Unit Letter J	Unit Letter I
SW/SW	SE/SW	SW/SE	SE/SE
Unit Letter M	Unit Letter N	Unit Letter O	Unit Letter P

3

4

Oxy

Proximity 31 Federal #4 SWD Battery

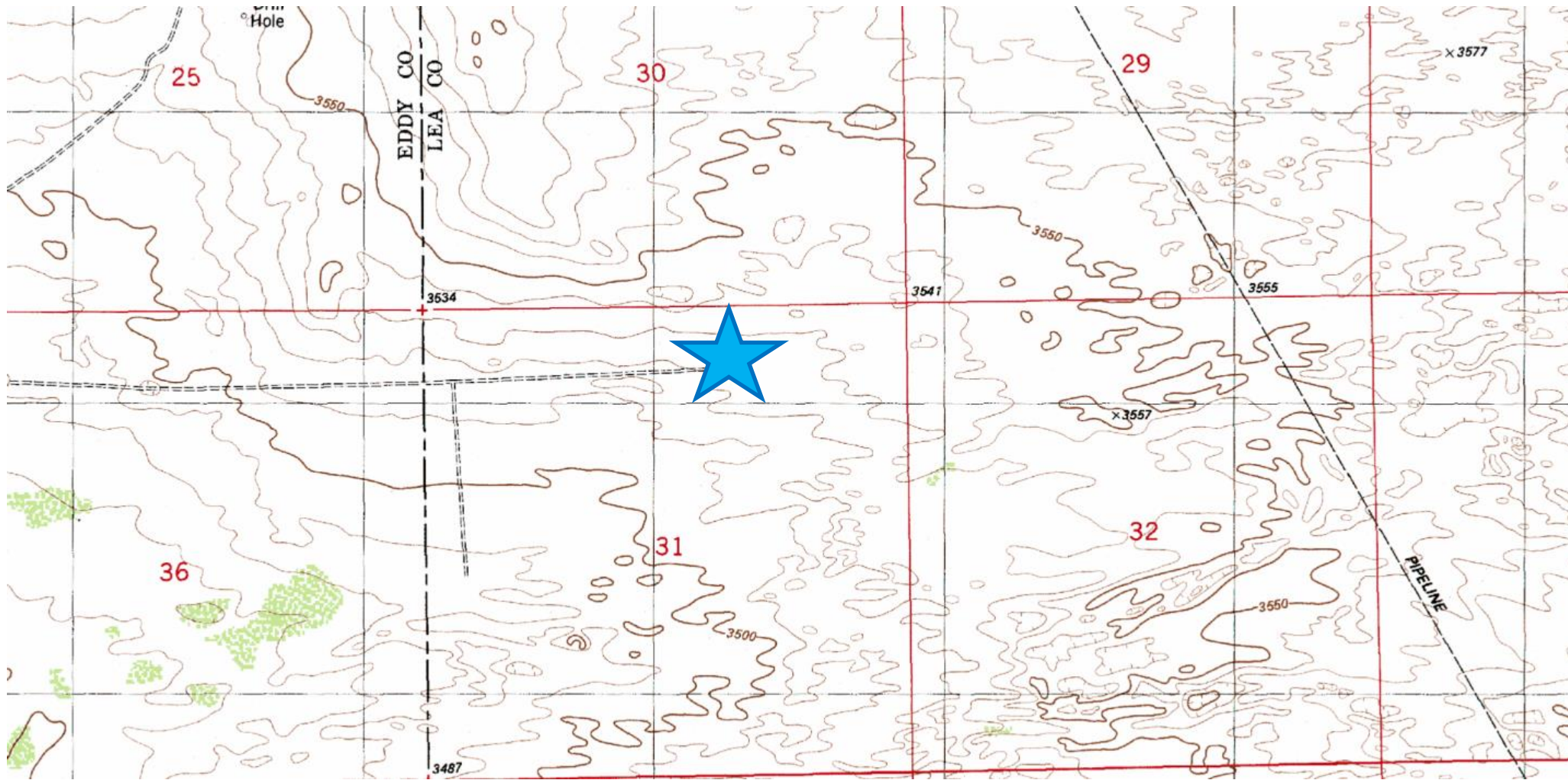

**Laboratory Analytical Results Summary
Proximity 31 Federal #4 SWD Battery**

		Sample	SP1 @ 1'	SP1 @ 2'	SP1 @ 3'	SP1 @ 4'
Analyte	Method	Date	7/31/15	7/31/15	7/31/15	7/31/15
			mg/Kg	mg/Kg	mg/Kg	mg/Kg
Benzene	BTEX 8021B		<0.050	<0.050	<0.050	<0.050
Toluene	BTEX 8021B		<0.050	<0.050	<0.050	<0.050
Ethylbenzene	BTEX 8021B		<0.050	<0.050	<0.050	<0.050
Total Xylenes	BTEX 8021B		<0.150	<0.150	<0.150	<0.150
Total BTEX	BTEX 8021B		<0.300	<0.300	<0.300	<0.300
Chloride	SM4500Cl-B		576	800	240	240
GRO	TPH 8015M		<10.0	<10.0	<10.0	<10.0
DRO	TPH 8015M		40.2	<10.0	<10.0	<10.0

		Sample	SP2 @ 1'	SP2 @ 2'	SP2 @ 3'
Analyte	Method	Date	7/31/15	7/31/15	7/31/15
			mg/Kg	mg/Kg	mg/Kg
Benzene	BTEX 8021B		<0.050	<0.050	<0.050
Toluene	BTEX 8021B		<0.050	<0.050	<0.050
Ethylbenzene	BTEX 8021B		<0.050	<0.050	<0.050
Total Xylenes	BTEX 8021B		<0.150	<0.150	<0.150
Total BTEX	BTEX 8021B		<0.300	<0.300	<0.300
Chloride	SM4500Cl-B		448	112	192
GRO	TPH 8015M		<10.0	<10.0	<10.0
DRO	TPH 8015M		655	61.8	125

		Sample	SP3 @ 1'	SP3 @ 2'	SP3 @ 3'
Analyte	Method	Date	7/31/15	7/31/15	7/31/15
			mg/Kg	mg/Kg	mg/Kg
Benzene	BTEX 8021B		<0.050	<0.050	<0.050
Toluene	BTEX 8021B		<0.050	<0.050	<0.050
Ethylbenzene	BTEX 8021B		<0.050	<0.050	<0.050
Total Xylenes	BTEX 8021B		<0.150	<0.150	<0.150
Total BTEX	BTEX 8021B		<0.300	<0.300	<0.300
Chloride	SM4500Cl-B		352	80	528
GRO	TPH 8015M		<10.0	<10.0	<10.0
DRO	TPH 8015M		383	94.1	102

		Sample	SP4 @ 1'	SP4 @ 2'	SP4 @ 3'
Analyte	Method	Date	7/31/15	7/31/15	7/31/15
			mg/Kg	mg/Kg	mg/Kg
Benzene	BTEX 8021B		<0.050	<0.050	<0.050
Toluene	BTEX 8021B		<0.050	<0.050	<0.050
Ethylbenzene	BTEX 8021B		<0.050	<0.050	<0.050
Total Xylenes	BTEX 8021B		<0.150	<0.150	<0.150
Total BTEX	BTEX 8021B		<0.300	<0.300	<0.300
Chloride	SM4500Cl-B		448	640	96
GRO	TPH 8015M		<10.0	<10.0	<10.0
DRO	TPH 8015M		36.2	102	12.4



PHONE (575) 393-2326 ° 101 E. MARLAND ° HOBBS, NM 88240

August 10, 2015

Cliff Brunson

BBC International, Inc.

P.O. Box 805

Hobbs, NM 88241

RE: PROXIMITY 31 FED 4 SWD

Enclosed are the results of analyses for samples received by the laboratory on 08/03/15 16:55.

Cardinal Laboratories is accredited through Texas NELAP under certificate number T104704398-13-5. Accreditation applies to drinking water, non-potable water and solid and chemical materials. All accredited analytes are denoted by an asterisk (*). For a complete list of accredited analytes and matrices visit the TCEQ website at www.tceq.texas.gov/field/qa/lab_accred_certif.html.

Cardinal Laboratories is accredited through the State of Colorado Department of Public Health and Environment for:

Method EPA 552.2	Haloacetic Acids (HAA-5)
Method EPA 524.2	Total Trihalomethanes (TTHM)
Method EPA 524.4	Regulated VOCs (V1, V2, V3)

Accreditation applies to public drinking water matrices.

This report meets NELAP requirements and is made up of a cover page, analytical results, and a copy of the original chain-of-custody. If you have any questions concerning this report, please feel free to contact me.

Sincerely,

A handwritten signature in black ink that reads "Celey D. Keene". The signature is written in a cursive, flowing style.

Celey D. Keene

Lab Director/Quality Manager

Analytical Results For:

BBC International, Inc.
Cliff Brunson
P.O. Box 805
Hobbs NM, 88241
Fax To: (575) 397-0397

Received:	08/03/2015	Sampling Date:	07/31/2015
Reported:	08/10/2015	Sampling Type:	Soil
Project Name:	PROXIMITY 31 FED 4 SWD	Sampling Condition:	Cool & Intact
Project Number:	NONE GIVEN	Sample Received By:	Jodi Henson
Project Location:	NOT GIVEN		

Sample ID: SP1 @ 1' (H502009-01)

BTX 8021B			mg/kg		Analyzed By: MS				
Analyte	Result	Reporting Limit	Analyzed	Method Blank	BS	% Recovery	True Value QC	RPD	Qualifier
Benzene*	<0.050	0.050	08/05/2015	ND	1.93	96.4	2.00	1.12	
Toluene*	<0.050	0.050	08/05/2015	ND	1.92	96.2	2.00	0.00411	
Ethylbenzene*	<0.050	0.050	08/05/2015	ND	2.09	105	2.00	0.135	
Total Xylenes*	<0.150	0.150	08/05/2015	ND	5.47	91.2	6.00	0.0753	
Total BTX	<0.300	0.300	08/05/2015	ND					

Surrogate: 4-Bromofluorobenzene (PID) 124 % 85.6-137

Chloride, SM4500Cl-B			mg/kg		Analyzed By: AP				
Analyte	Result	Reporting Limit	Analyzed	Method Blank	BS	% Recovery	True Value QC	RPD	Qualifier
Chloride	576	16.0	08/10/2015	ND	416	104	400	0.00	

TPH 8015M			mg/kg		Analyzed By: MS				
Analyte	Result	Reporting Limit	Analyzed	Method Blank	BS	% Recovery	True Value QC	RPD	Qualifier
GRO C6-C10	<10.0	10.0	08/05/2015	ND	197	98.7	200	0.790	
DRO >C10-C28	40.2	10.0	08/05/2015	ND	178	88.9	200	4.52	

Surrogate: 1-Chlorooctane 100 % 47.2-157

Surrogate: 1-Chlorooctadecane 124 % 52.1-176

Cardinal Laboratories

*=Accredited Analyte

PLEASE NOTE: Liability and Damages. Cardinal's liability and client's exclusive remedy for any claim arising, whether based in contract or tort, shall be limited to the amount paid by client for analyses. All claims, including those for negligence and any other cause whatsoever shall be deemed waived unless made in writing and received by Cardinal within thirty (30) days after completion of the applicable service. In no event shall Cardinal be liable for incidental or consequential damages, including, without limitation, business interruptions, loss of use, or loss of profits incurred by client, its subsidiaries, affiliates or successors arising out of or related to the performance of the services hereunder by Cardinal, regardless of whether such claim is based upon any of the above stated reasons or otherwise. Results relate only to the samples identified above. This report shall not be reproduced except in full with written approval of Cardinal Laboratories.



Celey D. Keene, Lab Director/Quality Manager

Analytical Results For:

BBC International, Inc.
Cliff Brunson
P.O. Box 805
Hobbs NM, 88241
Fax To: (575) 397-0397

Received:	08/03/2015	Sampling Date:	07/31/2015
Reported:	08/10/2015	Sampling Type:	Soil
Project Name:	PROXIMITY 31 FED 4 SWD	Sampling Condition:	Cool & Intact
Project Number:	NONE GIVEN	Sample Received By:	Jodi Henson
Project Location:	NOT GIVEN		

Sample ID: SP1 @ 2' (H502009-02)

BTEx 8021B		mg/kg		Analyzed By: MS					
Analyte	Result	Reporting Limit	Analyzed	Method Blank	BS	% Recovery	True Value QC	RPD	Qualifier
Benzene*	<0.050	0.050	08/05/2015	ND	1.93	96.4	2.00	1.12	
Toluene*	<0.050	0.050	08/05/2015	ND	1.92	96.2	2.00	0.00411	
Ethylbenzene*	<0.050	0.050	08/05/2015	ND	2.09	105	2.00	0.135	
Total Xylenes*	<0.150	0.150	08/05/2015	ND	5.47	91.2	6.00	0.0753	
Total BTEx	<0.300	0.300	08/05/2015	ND					

Surrogate: 4-Bromofluorobenzene (PID) 122 % 85.6-137

Chloride, SM4500CI-B		mg/kg		Analyzed By: AP					
Analyte	Result	Reporting Limit	Analyzed	Method Blank	BS	% Recovery	True Value QC	RPD	Qualifier
Chloride	800	16.0	08/10/2015	ND	416	104	400	0.00	

TPH 8015M		mg/kg		Analyzed By: MS					
Analyte	Result	Reporting Limit	Analyzed	Method Blank	BS	% Recovery	True Value QC	RPD	Qualifier
GRO C6-C10	<10.0	10.0	08/05/2015	ND	197	98.7	200	0.790	
DRO >C10-C28	<10.0	10.0	08/05/2015	ND	178	88.9	200	4.52	

Surrogate: 1-Chlorooctane 106 % 47.2-157

Surrogate: 1-Chlorooctadecane 126 % 52.1-176

Cardinal Laboratories

*=Accredited Analyte

PLEASE NOTE: Liability and Damages. Cardinal's liability and client's exclusive remedy for any claim arising, whether based in contract or tort, shall be limited to the amount paid by client for analyses. All claims, including those for negligence and any other cause whatsoever shall be deemed waived unless made in writing and received by Cardinal within thirty (30) days after completion of the applicable service. In no event shall Cardinal be liable for incidental or consequential damages, including, without limitation, business interruptions, loss of use, or loss of profits incurred by client, its subsidiaries, affiliates or successors arising out of or related to the performance of the services hereunder by Cardinal, regardless of whether such claim is based upon any of the above stated reasons or otherwise. Results relate only to the samples identified above. This report shall not be reproduced except in full with written approval of Cardinal Laboratories.



Celey D. Keene, Lab Director/Quality Manager

Analytical Results For:

BBC International, Inc.
Cliff Brunson
P.O. Box 805
Hobbs NM, 88241
Fax To: (575) 397-0397

Received: 08/03/2015
Reported: 08/10/2015
Project Name: PROXIMITY 31 FED 4 SWD
Project Number: NONE GIVEN
Project Location: NOT GIVEN

Sampling Date: 07/31/2015
Sampling Type: Soil
Sampling Condition: Cool & Intact
Sample Received By: Jodi Henson

Sample ID: SP1 @ 3' (H502009-03)

BTEx 8021B		mg/kg		Analyzed By: MS					
Analyte	Result	Reporting Limit	Analyzed	Method Blank	BS	% Recovery	True Value QC	RPD	Qualifier
Benzene*	<0.050	0.050	08/05/2015	ND	1.93	96.4	2.00	1.12	
Toluene*	<0.050	0.050	08/05/2015	ND	1.92	96.2	2.00	0.00411	
Ethylbenzene*	<0.050	0.050	08/05/2015	ND	2.09	105	2.00	0.135	
Total Xylenes*	<0.150	0.150	08/05/2015	ND	5.47	91.2	6.00	0.0753	
Total BTEx	<0.300	0.300	08/05/2015	ND					

Surrogate: 4-Bromofluorobenzene (PID) 121 % 85.6-137

Chloride, SM4500CI-B		mg/kg		Analyzed By: AP					
Analyte	Result	Reporting Limit	Analyzed	Method Blank	BS	% Recovery	True Value QC	RPD	Qualifier
Chloride	240	16.0	08/10/2015	ND	416	104	400	0.00	

TPH 8015M		mg/kg		Analyzed By: MS					
Analyte	Result	Reporting Limit	Analyzed	Method Blank	BS	% Recovery	True Value QC	RPD	Qualifier
GRO C6-C10	<10.0	10.0	08/05/2015	ND	197	98.7	200	0.790	
DRO >C10-C28	<10.0	10.0	08/05/2015	ND	178	88.9	200	4.52	

Surrogate: 1-Chlorooctane 106 % 47.2-157

Surrogate: 1-Chlorooctadecane 137 % 52.1-176

Cardinal Laboratories

*=Accredited Analyte

PLEASE NOTE: Liability and Damages. Cardinal's liability and client's exclusive remedy for any claim arising, whether based in contract or tort, shall be limited to the amount paid by client for analyses. All claims, including those for negligence and any other cause whatsoever shall be deemed waived unless made in writing and received by Cardinal within thirty (30) days after completion of the applicable service. In no event shall Cardinal be liable for incidental or consequential damages, including, without limitation, business interruptions, loss of use, or loss of profits incurred by client, its subsidiaries, affiliates or successors arising out of or related to the performance of the services hereunder by Cardinal, regardless of whether such claim is based upon any of the above stated reasons or otherwise. Results relate only to the samples identified above. This report shall not be reproduced except in full with written approval of Cardinal Laboratories.



Celey D. Keene, Lab Director/Quality Manager

Analytical Results For:

BBC International, Inc.
Cliff Brunson
P.O. Box 805
Hobbs NM, 88241
Fax To: (575) 397-0397

Received:	08/03/2015	Sampling Date:	07/31/2015
Reported:	08/10/2015	Sampling Type:	Soil
Project Name:	PROXIMITY 31 FED 4 SWD	Sampling Condition:	Cool & Intact
Project Number:	NONE GIVEN	Sample Received By:	Jodi Henson
Project Location:	NOT GIVEN		

Sample ID: SP1 @ 4' (H502009-04)

BTEx 8021B		mg/kg		Analyzed By: MS					
Analyte	Result	Reporting Limit	Analyzed	Method Blank	BS	% Recovery	True Value QC	RPD	Qualifier
Benzene*	<0.050	0.050	08/05/2015	ND	1.93	96.4	2.00	1.12	
Toluene*	<0.050	0.050	08/05/2015	ND	1.92	96.2	2.00	0.00411	
Ethylbenzene*	<0.050	0.050	08/05/2015	ND	2.09	105	2.00	0.135	
Total Xylenes*	<0.150	0.150	08/05/2015	ND	5.47	91.2	6.00	0.0753	
Total BTEx	<0.300	0.300	08/05/2015	ND					

Surrogate: 4-Bromofluorobenzene (PID) 121 % 85.6-137

Chloride, SM4500CI-B		mg/kg		Analyzed By: AP					
Analyte	Result	Reporting Limit	Analyzed	Method Blank	BS	% Recovery	True Value QC	RPD	Qualifier
Chloride	240	16.0	08/10/2015	ND	416	104	400	0.00	

TPH 8015M		mg/kg		Analyzed By: MS					
Analyte	Result	Reporting Limit	Analyzed	Method Blank	BS	% Recovery	True Value QC	RPD	Qualifier
GRO C6-C10	<10.0	10.0	08/05/2015	ND	197	98.7	200	0.790	
DRO >C10-C28	<10.0	10.0	08/05/2015	ND	178	88.9	200	4.52	

Surrogate: 1-Chlorooctane 104 % 47.2-157

Surrogate: 1-Chlorooctadecane 134 % 52.1-176

Cardinal Laboratories

*=Accredited Analyte

PLEASE NOTE: Liability and Damages. Cardinal's liability and client's exclusive remedy for any claim arising, whether based in contract or tort, shall be limited to the amount paid by client for analyses. All claims, including those for negligence and any other cause whatsoever shall be deemed waived unless made in writing and received by Cardinal within thirty (30) days after completion of the applicable service. In no event shall Cardinal be liable for incidental or consequential damages, including, without limitation, business interruptions, loss of use, or loss of profits incurred by client, its subsidiaries, affiliates or successors arising out of or related to the performance of the services hereunder by Cardinal, regardless of whether such claim is based upon any of the above stated reasons or otherwise. Results relate only to the samples identified above. This report shall not be reproduced except in full with written approval of Cardinal Laboratories.



Celey D. Keene, Lab Director/Quality Manager

Analytical Results For:

BBC International, Inc.
Cliff Brunson
P.O. Box 805
Hobbs NM, 88241
Fax To: (575) 397-0397

Received:	08/03/2015	Sampling Date:	07/31/2015
Reported:	08/10/2015	Sampling Type:	Soil
Project Name:	PROXIMITY 31 FED 4 SWD	Sampling Condition:	Cool & Intact
Project Number:	NONE GIVEN	Sample Received By:	Jodi Henson
Project Location:	NOT GIVEN		

Sample ID: SP2 @ 1' (H502009-05)

BTEx 8021B		mg/kg		Analyzed By: MS					
Analyte	Result	Reporting Limit	Analyzed	Method Blank	BS	% Recovery	True Value QC	RPD	Qualifier
Benzene*	<0.050	0.050	08/05/2015	ND	1.93	96.4	2.00	1.12	
Toluene*	<0.050	0.050	08/05/2015	ND	1.92	96.2	2.00	0.00411	
Ethylbenzene*	<0.050	0.050	08/05/2015	ND	2.09	105	2.00	0.135	
Total Xylenes*	<0.150	0.150	08/05/2015	ND	5.47	91.2	6.00	0.0753	
Total BTEx	<0.300	0.300	08/05/2015	ND					

Surrogate: 4-Bromofluorobenzene (PID) 126 % 85.6-137

Chloride, SM4500CI-B		mg/kg		Analyzed By: AP					
Analyte	Result	Reporting Limit	Analyzed	Method Blank	BS	% Recovery	True Value QC	RPD	Qualifier
Chloride	448	16.0	08/10/2015	ND	416	104	400	0.00	

TPH 8015M		mg/kg		Analyzed By: MS					
Analyte	Result	Reporting Limit	Analyzed	Method Blank	BS	% Recovery	True Value QC	RPD	Qualifier
GRO C6-C10	<10.0	10.0	08/05/2015	ND	195	97.6	200	6.22	
DRO >C10-C28	655	10.0	08/05/2015	ND	177	88.5	200	9.55	

Surrogate: 1-Chlorooctane 106 % 47.2-157

Surrogate: 1-Chlorooctadecane 152 % 52.1-176

Cardinal Laboratories

*=Accredited Analyte

PLEASE NOTE: Liability and Damages. Cardinal's liability and client's exclusive remedy for any claim arising, whether based in contract or tort, shall be limited to the amount paid by client for analyses. All claims, including those for negligence and any other cause whatsoever shall be deemed waived unless made in writing and received by Cardinal within thirty (30) days after completion of the applicable service. In no event shall Cardinal be liable for incidental or consequential damages, including, without limitation, business interruptions, loss of use, or loss of profits incurred by client, its subsidiaries, affiliates or successors arising out of or related to the performance of the services hereunder by Cardinal, regardless of whether such claim is based upon any of the above stated reasons or otherwise. Results relate only to the samples identified above. This report shall not be reproduced except in full with written approval of Cardinal Laboratories.



Celey D. Keene, Lab Director/Quality Manager

Analytical Results For:

BBC International, Inc.
Cliff Brunson
P.O. Box 805
Hobbs NM, 88241
Fax To: (575) 397-0397

Received:	08/03/2015	Sampling Date:	07/31/2015
Reported:	08/10/2015	Sampling Type:	Soil
Project Name:	PROXIMITY 31 FED 4 SWD	Sampling Condition:	Cool & Intact
Project Number:	NONE GIVEN	Sample Received By:	Jodi Henson
Project Location:	NOT GIVEN		

Sample ID: SP2 @ 2' (H502009-06)

BTEx 8021B		mg/kg		Analyzed By: MS					
Analyte	Result	Reporting Limit	Analyzed	Method Blank	BS	% Recovery	True Value QC	RPD	Qualifier
Benzene*	<0.050	0.050	08/05/2015	ND	1.93	96.4	2.00	1.12	
Toluene*	<0.050	0.050	08/05/2015	ND	1.92	96.2	2.00	0.00411	
Ethylbenzene*	<0.050	0.050	08/05/2015	ND	2.09	105	2.00	0.135	
Total Xylenes*	<0.150	0.150	08/05/2015	ND	5.47	91.2	6.00	0.0753	
Total BTEx	<0.300	0.300	08/05/2015	ND					

Surrogate: 4-Bromofluorobenzene (PID) 122 % 85.6-137

Chloride, SM4500CI-B		mg/kg		Analyzed By: AP					
Analyte	Result	Reporting Limit	Analyzed	Method Blank	BS	% Recovery	True Value QC	RPD	Qualifier
Chloride	112	16.0	08/10/2015	ND	416	104	400	0.00	

TPH 8015M		mg/kg		Analyzed By: MS					
Analyte	Result	Reporting Limit	Analyzed	Method Blank	BS	% Recovery	True Value QC	RPD	Qualifier
GRO C6-C10	<10.0	10.0	08/05/2015	ND	195	97.6	200	6.22	
DRO >C10-C28	61.8	10.0	08/05/2015	ND	177	88.5	200	9.55	

Surrogate: 1-Chlorooctane 106 % 47.2-157

Surrogate: 1-Chlorooctadecane 129 % 52.1-176

Cardinal Laboratories

*=Accredited Analyte

PLEASE NOTE: Liability and Damages. Cardinal's liability and client's exclusive remedy for any claim arising, whether based in contract or tort, shall be limited to the amount paid by client for analyses. All claims, including those for negligence and any other cause whatsoever shall be deemed waived unless made in writing and received by Cardinal within thirty (30) days after completion of the applicable service. In no event shall Cardinal be liable for incidental or consequential damages, including, without limitation, business interruptions, loss of use, or loss of profits incurred by client, its subsidiaries, affiliates or successors arising out of or related to the performance of the services hereunder by Cardinal, regardless of whether such claim is based upon any of the above stated reasons or otherwise. Results relate only to the samples identified above. This report shall not be reproduced except in full with written approval of Cardinal Laboratories.



Celey D. Keene, Lab Director/Quality Manager

Analytical Results For:

BBC International, Inc.
Cliff Brunson
P.O. Box 805
Hobbs NM, 88241
Fax To: (575) 397-0397

Received:	08/03/2015	Sampling Date:	07/31/2015
Reported:	08/10/2015	Sampling Type:	Soil
Project Name:	PROXIMITY 31 FED 4 SWD	Sampling Condition:	Cool & Intact
Project Number:	NONE GIVEN	Sample Received By:	Jodi Henson
Project Location:	NOT GIVEN		

Sample ID: SP2 @ 3' (H502009-07)

BTEx 8021B		mg/kg		Analyzed By: MS					
Analyte	Result	Reporting Limit	Analyzed	Method Blank	BS	% Recovery	True Value QC	RPD	Qualifier
Benzene*	<0.050	0.050	08/05/2015	ND	1.93	96.4	2.00	1.12	
Toluene*	<0.050	0.050	08/05/2015	ND	1.92	96.2	2.00	0.00411	
Ethylbenzene*	<0.050	0.050	08/05/2015	ND	2.09	105	2.00	0.135	
Total Xylenes*	<0.150	0.150	08/05/2015	ND	5.47	91.2	6.00	0.0753	
Total BTEx	<0.300	0.300	08/05/2015	ND					

Surrogate: 4-Bromofluorobenzene (PID) 123 % 85.6-137

Chloride, SM4500CI-B		mg/kg		Analyzed By: AP					
Analyte	Result	Reporting Limit	Analyzed	Method Blank	BS	% Recovery	True Value QC	RPD	Qualifier
Chloride	192	16.0	08/10/2015	ND	416	104	400	0.00	

TPH 8015M		mg/kg		Analyzed By: MS					
Analyte	Result	Reporting Limit	Analyzed	Method Blank	BS	% Recovery	True Value QC	RPD	Qualifier
GRO C6-C10	<10.0	10.0	08/05/2015	ND	195	97.6	200	6.22	
DRO >C10-C28	125	10.0	08/05/2015	ND	177	88.5	200	9.55	

Surrogate: 1-Chlorooctane 97.1 % 47.2-157

Surrogate: 1-Chlorooctadecane 115 % 52.1-176

Cardinal Laboratories

*=Accredited Analyte

PLEASE NOTE: Liability and Damages. Cardinal's liability and client's exclusive remedy for any claim arising, whether based in contract or tort, shall be limited to the amount paid by client for analyses. All claims, including those for negligence and any other cause whatsoever shall be deemed waived unless made in writing and received by Cardinal within thirty (30) days after completion of the applicable service. In no event shall Cardinal be liable for incidental or consequential damages, including, without limitation, business interruptions, loss of use, or loss of profits incurred by client, its subsidiaries, affiliates or successors arising out of or related to the performance of the services hereunder by Cardinal, regardless of whether such claim is based upon any of the above stated reasons or otherwise. Results relate only to the samples identified above. This report shall not be reproduced except in full with written approval of Cardinal Laboratories.



Celey D. Keene, Lab Director/Quality Manager

Analytical Results For:

BBC International, Inc.
Cliff Brunson
P.O. Box 805
Hobbs NM, 88241
Fax To: (575) 397-0397

Received:	08/03/2015	Sampling Date:	07/31/2015
Reported:	08/10/2015	Sampling Type:	Soil
Project Name:	PROXIMITY 31 FED 4 SWD	Sampling Condition:	Cool & Intact
Project Number:	NONE GIVEN	Sample Received By:	Jodi Henson
Project Location:	NOT GIVEN		

Sample ID: SP3 @ 1' (H502009-08)

BTEx 8021B		mg/kg		Analyzed By: MS						
Analyte	Result	Reporting Limit	Analyzed	Method Blank	BS	% Recovery	True Value QC	RPD	Qualifier	
Benzene*	<0.050	0.050	08/05/2015	ND	1.93	96.4	2.00	1.12		
Toluene*	<0.050	0.050	08/05/2015	ND	1.92	96.2	2.00	0.00411		
Ethylbenzene*	<0.050	0.050	08/05/2015	ND	2.09	105	2.00	0.135		
Total Xylenes*	<0.150	0.150	08/05/2015	ND	5.47	91.2	6.00	0.0753		
Total BTEx	<0.300	0.300	08/05/2015	ND						

Surrogate: 4-Bromofluorobenzene (PID) 121 % 85.6-137

Chloride, SM4500CI-B		mg/kg		Analyzed By: AP						
Analyte	Result	Reporting Limit	Analyzed	Method Blank	BS	% Recovery	True Value QC	RPD	Qualifier	
Chloride	352	16.0	08/10/2015	ND	416	104	400	0.00		

TPH 8015M		mg/kg		Analyzed By: MS					
Analyte	Result	Reporting Limit	Analyzed	Method Blank	BS	% Recovery	True Value QC	RPD	Qualifier
GRO C6-C10	<10.0	10.0	08/05/2015	ND	195	97.6	200	6.22	
DRO >C10-C28	383	10.0	08/05/2015	ND	177	88.5	200	9.55	

Surrogate: 1-Chlorooctane 102 % 47.2-157

Surrogate: 1-Chlorooctadecane 116 % 52.1-176

Cardinal Laboratories

*=Accredited Analyte

PLEASE NOTE: Liability and Damages. Cardinal's liability and client's exclusive remedy for any claim arising, whether based in contract or tort, shall be limited to the amount paid by client for analyses. All claims, including those for negligence and any other cause whatsoever shall be deemed waived unless made in writing and received by Cardinal within thirty (30) days after completion of the applicable service. In no event shall Cardinal be liable for incidental or consequential damages, including, without limitation, business interruptions, loss of use, or loss of profits incurred by client, its subsidiaries, affiliates or successors arising out of or related to the performance of the services hereunder by Cardinal, regardless of whether such claim is based upon any of the above stated reasons or otherwise. Results relate only to the samples identified above. This report shall not be reproduced except in full with written approval of Cardinal Laboratories.



Celey D. Keene, Lab Director/Quality Manager

Analytical Results For:

BBC International, Inc.
Cliff Brunson
P.O. Box 805
Hobbs NM, 88241
Fax To: (575) 397-0397

Received:	08/03/2015	Sampling Date:	07/31/2015
Reported:	08/10/2015	Sampling Type:	Soil
Project Name:	PROXIMITY 31 FED 4 SWD	Sampling Condition:	Cool & Intact
Project Number:	NONE GIVEN	Sample Received By:	Jodi Henson
Project Location:	NOT GIVEN		

Sample ID: SP3 @ 2' (H502009-09)

BTEx 8021B		mg/kg		Analyzed By: MS					
Analyte	Result	Reporting Limit	Analyzed	Method Blank	BS	% Recovery	True Value QC	RPD	Qualifier
Benzene*	<0.050	0.050	08/05/2015	ND	1.93	96.4	2.00	1.12	
Toluene*	<0.050	0.050	08/05/2015	ND	1.92	96.2	2.00	0.00411	
Ethylbenzene*	<0.050	0.050	08/05/2015	ND	2.09	105	2.00	0.135	
Total Xylenes*	<0.150	0.150	08/05/2015	ND	5.47	91.2	6.00	0.0753	
Total BTEx	<0.300	0.300	08/05/2015	ND					

Surrogate: 4-Bromofluorobenzene (PID) 121 % 85.6-137

Chloride, SM4500CI-B		mg/kg		Analyzed By: AP					
Analyte	Result	Reporting Limit	Analyzed	Method Blank	BS	% Recovery	True Value QC	RPD	Qualifier
Chloride	80.0	16.0	08/10/2015	ND	416	104	400	0.00	

TPH 8015M		mg/kg		Analyzed By: MS					
Analyte	Result	Reporting Limit	Analyzed	Method Blank	BS	% Recovery	True Value QC	RPD	Qualifier
GRO C6-C10	<10.0	10.0	08/05/2015	ND	195	97.6	200	6.22	
DRO >C10-C28	94.1	10.0	08/05/2015	ND	177	88.5	200	9.55	

Surrogate: 1-Chlorooctane 111 % 47.2-157

Surrogate: 1-Chlorooctadecane 136 % 52.1-176

Cardinal Laboratories

*=Accredited Analyte

PLEASE NOTE: Liability and Damages. Cardinal's liability and client's exclusive remedy for any claim arising, whether based in contract or tort, shall be limited to the amount paid by client for analyses. All claims, including those for negligence and any other cause whatsoever shall be deemed waived unless made in writing and received by Cardinal within thirty (30) days after completion of the applicable service. In no event shall Cardinal be liable for incidental or consequential damages, including, without limitation, business interruptions, loss of use, or loss of profits incurred by client, its subsidiaries, affiliates or successors arising out of or related to the performance of the services hereunder by Cardinal, regardless of whether such claim is based upon any of the above stated reasons or otherwise. Results relate only to the samples identified above. This report shall not be reproduced except in full with written approval of Cardinal Laboratories.



Celey D. Keene, Lab Director/Quality Manager

Analytical Results For:

BBC International, Inc.
Cliff Brunson
P.O. Box 805
Hobbs NM, 88241
Fax To: (575) 397-0397

Received:	08/03/2015	Sampling Date:	07/31/2015
Reported:	08/10/2015	Sampling Type:	Soil
Project Name:	PROXIMITY 31 FED 4 SWD	Sampling Condition:	Cool & Intact
Project Number:	NONE GIVEN	Sample Received By:	Jodi Henson
Project Location:	NOT GIVEN		

Sample ID: SP3 @ 3' (H502009-10)

BTEx 8021B		mg/kg		Analyzed By: MS					
Analyte	Result	Reporting Limit	Analyzed	Method Blank	BS	% Recovery	True Value QC	RPD	Qualifier
Benzene*	<0.050	0.050	08/05/2015	ND	1.93	96.4	2.00	1.12	
Toluene*	<0.050	0.050	08/05/2015	ND	1.92	96.2	2.00	0.00411	
Ethylbenzene*	<0.050	0.050	08/05/2015	ND	2.09	105	2.00	0.135	
Total Xylenes*	<0.150	0.150	08/05/2015	ND	5.47	91.2	6.00	0.0753	
Total BTEx	<0.300	0.300	08/05/2015	ND					

Surrogate: 4-Bromofluorobenzene (PID) 119 % 85.6-137

Chloride, SM4500CI-B		mg/kg		Analyzed By: AP					
Analyte	Result	Reporting Limit	Analyzed	Method Blank	BS	% Recovery	True Value QC	RPD	Qualifier
Chloride	528	16.0	08/06/2015	ND	416	104	400	0.00	

TPH 8015M		mg/kg		Analyzed By: MS					
Analyte	Result	Reporting Limit	Analyzed	Method Blank	BS	% Recovery	True Value QC	RPD	Qualifier
GRO C6-C10	<10.0	10.0	08/05/2015	ND	195	97.6	200	6.22	
DRO >C10-C28	102	10.0	08/05/2015	ND	177	88.5	200	9.55	

Surrogate: 1-Chlorooctane 113 % 47.2-157

Surrogate: 1-Chlorooctadecane 133 % 52.1-176

Cardinal Laboratories

*=Accredited Analyte

PLEASE NOTE: Liability and Damages. Cardinal's liability and client's exclusive remedy for any claim arising, whether based in contract or tort, shall be limited to the amount paid by client for analyses. All claims, including those for negligence and any other cause whatsoever shall be deemed waived unless made in writing and received by Cardinal within thirty (30) days after completion of the applicable service. In no event shall Cardinal be liable for incidental or consequential damages, including, without limitation, business interruptions, loss of use, or loss of profits incurred by client, its subsidiaries, affiliates or successors arising out of or related to the performance of the services hereunder by Cardinal, regardless of whether such claim is based upon any of the above stated reasons or otherwise. Results relate only to the samples identified above. This report shall not be reproduced except in full with written approval of Cardinal Laboratories.



Celey D. Keene, Lab Director/Quality Manager

Analytical Results For:

BBC International, Inc.
Cliff Brunson
P.O. Box 805
Hobbs NM, 88241
Fax To: (575) 397-0397

Received:	08/03/2015	Sampling Date:	07/31/2015
Reported:	08/10/2015	Sampling Type:	Soil
Project Name:	PROXIMITY 31 FED 4 SWD	Sampling Condition:	Cool & Intact
Project Number:	NONE GIVEN	Sample Received By:	Jodi Henson
Project Location:	NOT GIVEN		

Sample ID: SP4 @ 1' (H502009-11)

BTEx 8021B		mg/kg		Analyzed By: MS					
Analyte	Result	Reporting Limit	Analyzed	Method Blank	BS	% Recovery	True Value QC	RPD	Qualifier
Benzene*	<0.050	0.050	08/05/2015	ND	1.93	96.4	2.00	1.12	
Toluene*	<0.050	0.050	08/05/2015	ND	1.92	96.2	2.00	0.00411	
Ethylbenzene*	<0.050	0.050	08/05/2015	ND	2.09	105	2.00	0.135	
Total Xylenes*	<0.150	0.150	08/05/2015	ND	5.47	91.2	6.00	0.0753	
Total BTEX	<0.300	0.300	08/05/2015	ND					

Surrogate: 4-Bromofluorobenzene (PID) 124 % 85.6-137

Chloride, SM4500Cl-B		mg/kg		Analyzed By: AP					
Analyte	Result	Reporting Limit	Analyzed	Method Blank	BS	% Recovery	True Value QC	RPD	Qualifier
Chloride	448	16.0	08/06/2015	ND	416	104	400	0.00	

TPH 8015M		mg/kg		Analyzed By: MS					
Analyte	Result	Reporting Limit	Analyzed	Method Blank	BS	% Recovery	True Value QC	RPD	Qualifier
GRO C6-C10	<10.0	10.0	08/05/2015	ND	195	97.6	200	6.22	
DRO >C10-C28	36.2	10.0	08/05/2015	ND	177	88.5	200	9.55	

Surrogate: 1-Chlorooctane 106 % 47.2-157

Surrogate: 1-Chlorooctadecane 133 % 52.1-176

Cardinal Laboratories

*=Accredited Analyte

PLEASE NOTE: Liability and Damages. Cardinal's liability and client's exclusive remedy for any claim arising, whether based in contract or tort, shall be limited to the amount paid by client for analyses. All claims, including those for negligence and any other cause whatsoever shall be deemed waived unless made in writing and received by Cardinal within thirty (30) days after completion of the applicable service. In no event shall Cardinal be liable for incidental or consequential damages, including, without limitation, business interruptions, loss of use, or loss of profits incurred by client, its subsidiaries, affiliates or successors arising out of or related to the performance of the services hereunder by Cardinal, regardless of whether such claim is based upon any of the above stated reasons or otherwise. Results relate only to the samples identified above. This report shall not be reproduced except in full with written approval of Cardinal Laboratories.



Celey D. Keene, Lab Director/Quality Manager

Analytical Results For:

BBC International, Inc.
Cliff Brunson
P.O. Box 805
Hobbs NM, 88241
Fax To: (575) 397-0397

Received:	08/03/2015	Sampling Date:	07/31/2015
Reported:	08/10/2015	Sampling Type:	Soil
Project Name:	PROXIMITY 31 FED 4 SWD	Sampling Condition:	Cool & Intact
Project Number:	NONE GIVEN	Sample Received By:	Jodi Henson
Project Location:	NOT GIVEN		

Sample ID: SP4 @ 2' (H502009-12)

BTEx 8021B		mg/kg		Analyzed By: MS					
Analyte	Result	Reporting Limit	Analyzed	Method Blank	BS	% Recovery	True Value QC	RPD	Qualifier
Benzene*	<0.050	0.050	08/05/2015	ND	1.93	96.4	2.00	1.12	
Toluene*	<0.050	0.050	08/05/2015	ND	1.92	96.2	2.00	0.00411	
Ethylbenzene*	<0.050	0.050	08/05/2015	ND	2.09	105	2.00	0.135	
Total Xylenes*	<0.150	0.150	08/05/2015	ND	5.47	91.2	6.00	0.0753	
Total BTEx	<0.300	0.300	08/05/2015	ND					

Surrogate: 4-Bromofluorobenzene (PID) 122 % 85.6-137

Chloride, SM4500CI-B		mg/kg		Analyzed By: AP					
Analyte	Result	Reporting Limit	Analyzed	Method Blank	BS	% Recovery	True Value QC	RPD	Qualifier
Chloride	640	16.0	08/06/2015	ND	416	104	400	0.00	

TPH 8015M		mg/kg		Analyzed By: MS					
Analyte	Result	Reporting Limit	Analyzed	Method Blank	BS	% Recovery	True Value QC	RPD	Qualifier
GRO C6-C10	<10.0	10.0	08/05/2015	ND	195	97.6	200	6.22	
DRO >C10-C28	102	10.0	08/05/2015	ND	177	88.5	200	9.55	

Surrogate: 1-Chlorooctane 115 % 47.2-157

Surrogate: 1-Chlorooctadecane 140 % 52.1-176

Cardinal Laboratories

*=Accredited Analyte

PLEASE NOTE: Liability and Damages. Cardinal's liability and client's exclusive remedy for any claim arising, whether based in contract or tort, shall be limited to the amount paid by client for analyses. All claims, including those for negligence and any other cause whatsoever shall be deemed waived unless made in writing and received by Cardinal within thirty (30) days after completion of the applicable service. In no event shall Cardinal be liable for incidental or consequential damages, including, without limitation, business interruptions, loss of use, or loss of profits incurred by client, its subsidiaries, affiliates or successors arising out of or related to the performance of the services hereunder by Cardinal, regardless of whether such claim is based upon any of the above stated reasons or otherwise. Results relate only to the samples identified above. This report shall not be reproduced except in full with written approval of Cardinal Laboratories.



Celey D. Keene, Lab Director/Quality Manager

Analytical Results For:

BBC International, Inc.
Cliff Brunson
P.O. Box 805
Hobbs NM, 88241
Fax To: (575) 397-0397

Received:	08/03/2015	Sampling Date:	07/31/2015
Reported:	08/10/2015	Sampling Type:	Soil
Project Name:	PROXIMITY 31 FED 4 SWD	Sampling Condition:	Cool & Intact
Project Number:	NONE GIVEN	Sample Received By:	Jodi Henson
Project Location:	NOT GIVEN		

Sample ID: SP4 @ 3' (H502009-13)

BTX 8021B		mg/kg		Analyzed By: MS						
Analyte	Result	Reporting Limit	Analyzed	Method Blank	BS	% Recovery	True Value QC	RPD	Qualifier	
Benzene*	<0.050	0.050	08/05/2015	ND	1.93	96.4	2.00	1.12		
Toluene*	<0.050	0.050	08/05/2015	ND	1.92	96.2	2.00	0.00411		
Ethylbenzene*	<0.050	0.050	08/05/2015	ND	2.09	105	2.00	0.135		
Total Xylenes*	<0.150	0.150	08/05/2015	ND	5.47	91.2	6.00	0.0753		
Total BTX	<0.300	0.300	08/05/2015	ND						

Surrogate: 4-Bromofluorobenzene (PID) 119 % 85.6-137

Chloride, SM4500CI-B		mg/kg		Analyzed By: AP					
Analyte	Result	Reporting Limit	Analyzed	Method Blank	BS	% Recovery	True Value QC	RPD	Qualifier
Chloride	96.0	16.0	08/06/2015	ND	416	104	400	0.00	

TPH 8015M		mg/kg		Analyzed By: MS					
Analyte	Result	Reporting Limit	Analyzed	Method Blank	BS	% Recovery	True Value QC	RPD	Qualifier
GRO C6-C10	<10.0	10.0	08/05/2015	ND	195	97.6	200	6.22	
DRO >C10-C28	12.4	10.0	08/05/2015	ND	177	88.5	200	9.55	

Surrogate: 1-Chlorooctane 114 % 47.2-157

Surrogate: 1-Chlorooctadecane 139 % 52.1-176

Cardinal Laboratories

*=Accredited Analyte

PLEASE NOTE: Liability and Damages. Cardinal's liability and client's exclusive remedy for any claim arising, whether based in contract or tort, shall be limited to the amount paid by client for analyses. All claims, including those for negligence and any other cause whatsoever shall be deemed waived unless made in writing and received by Cardinal within thirty (30) days after completion of the applicable service. In no event shall Cardinal be liable for incidental or consequential damages, including, without limitation, business interruptions, loss of use, or loss of profits incurred by client, its subsidiaries, affiliates or successors arising out of or related to the performance of the services hereunder by Cardinal, regardless of whether such claim is based upon any of the above stated reasons or otherwise. Results relate only to the samples identified above. This report shall not be reproduced except in full with written approval of Cardinal Laboratories.



Celey D. Keene, Lab Director/Quality Manager

Notes and Definitions

ND	Analyte NOT DETECTED at or above the reporting limit
RPD	Relative Percent Difference
**	Samples not received at proper temperature of 6°C or below.
***	Insufficient time to reach temperature.
-	Chloride by SM4500Cl-B does not require samples be received at or below 6°C Samples reported on an as received basis (wet) unless otherwise noted on report

Cardinal Laboratories

*=Accredited Analyte

PLEASE NOTE: Liability and Damages. Cardinal's liability and client's exclusive remedy for any claim arising, whether based in contract or tort, shall be limited to the amount paid by client for analyses. All claims, including those for negligence and any other cause whatsoever shall be deemed waived unless made in writing and received by Cardinal within thirty (30) days after completion of the applicable service. In no event shall Cardinal be liable for incidental or consequential damages, including, without limitation, business interruptions, loss of use, or loss of profits incurred by client, its subsidiaries, affiliates or successors arising out of or related to the performance of the services hereunder by Cardinal, regardless of whether such claim is based upon any of the above stated reasons or otherwise. Results relate only to the samples identified above. This report shall not be reproduced except in full with written approval of Cardinal Laboratories.



Celey D. Keene, Lab Director/Quality Manager



101 East Marland, Hobbs, NM 88240
(505) 393-2326 FAX (505) 393-2476

CHAIN-OF-CUSTODY AND ANALYSIS REQUEST

292

[illegible]

† Cardinal cannot accept verbal changes. Please fax written changes to 505-393-2476

54#

Kathy Purvis

From: Jones, Kellie, EMNRD <Kellie.Jones@state.nm.us>
Sent: Tuesday, August 18, 2015 11:27 AM
To: Cliff Brunson
Cc: Keyes, Jamie, EMNRD; Oberding, Tomas, EMNRD; C J Summers; Ken Swinney; Jennifer Gilkey; Kathy Purvis
Subject: RE: OXY Proximity 31 Federal #4 SWD Battery - Remediation Plan - RP #3802

Cliff,

The plan is approved. Please let me know if you have any questions.

Have a great day!

Kellie Jones
Environmental Specialist, District 1
Oil Conservation Division, EMNRD
575-393-6161 ext. 111
575-370-3180 (emergency-cell)
E-Mail: kellie.jones@state.nm.us

OCD approval does not relieve the operator of liability should their operations fail to adequately investigate and remediate contamination that may pose a threat to ground water, surface water, human health or the environment. In addition, OCD approval does not relieve the operator of responsibility for compliance with any other federal, state, local laws and/or regulations.

Please note:

- The OCD is no longer granting "risk-based," or standard closure of events/RPs with remediation deferred to site abandonment/sale/closure. The RP will remain open until such time as historic contamination is addressed.
- Photographic documentation is stipulated for all events involving liquids.

If you have any questions or concerns, and for notification, please contact me.

From: Cliff Brunson [<mailto:cbrunson@bbcinternational.com>]
Sent: Monday, August 17, 2015 2:48 PM
To: Jones, Kellie, EMNRD
Cc: Keyes, Jamie, EMNRD; Oberding, Tomas, EMNRD; C J Summers; Ken Swinney; Jennifer Gilkey; Kathy Purvis
Subject: OXY Proximity 31 Federal #4 SWD Battery - Remediation Plan - RP #3802

Kellie,

This e-mail is to confirm our discussion on Friday, August 14, 2015 concerning the remediation plan for the Oxy Proximity 31 Federal #4 SWD Battery. I have attached the information packet that we used in our discussion with a cover page describing the remediation plan that we agreed upon.

If you would please reply back via e-mail with your concurrence on this plan, it would be greatly appreciated.

Thanks, Cliff

Cliff P. Brunson, CEI, CRS
President
BBC International, Inc.
World-Wide Environmental Specialists
Mailing Address:
P. O. Box 805
Hobbs, NM 88241-0805 USA
Shipping Address:
1324 W. Marland St.
Hobbs, NM 88240 USA
Phone: (575) 397-6388
Fax: (575) 397-0397
E-Mail: cbrunson@bbcinternational.com

Confidentiality Notice: This electronic transmission (and any attached documents) is intended only for the person(s) to whom it is addressed and may contain information that is privileged, confidential, or otherwise protected from disclosure. If you have received this transmission in error, please immediately notify the sender by e-mail or by telephone call to (575) 397-6388 for handling instructions. Any disclosure or distribution of the contents of this transmission by anyone other than the named recipient(s) is strictly prohibited.

Kathy Purvis

From: Tucker, Shelly <stucker@blm.gov>
Sent: Thursday, August 20, 2015 9:28 AM
To: Cliff Brunson
Cc: C J Summers; Ken Swinney; Jennifer Gilkey; Kathy Purvis
Subject: Re: FW: OXY Proximity 31 Federal #4 SWD Battery - Remediation Plan - RP #3802

BLM accepts/approves your Work Plan.

The BLM approval does not relieve the operator of liability should their operations have failed to adequately investigate and remediate contamination that may pose a threat to groundwater, surface water, human health or the environment or if the location fails to reclaim properly. In such an event that the location does not revegetate, or future issues with contaminants are encountered, the operator will be asked to address the issues until the contaminant issues are fully mitigated and the location is successfully reclaimed. In addition, BLM approval does not relieve the operator of responsibility for compliance with any other federal, state or local laws/regulations.

If you have any questions or concerns, please do not hesitate to contact me.

Sincerely,

Shelly J Tucker

Environmental Protection Specialist
Bureau of Land Management

620 E. Greene St
Carlsbad, NM 88220

575.234.5905 - Direct
575.361.0084 - Cellular

stucker@blm.gov



On Wed, Aug 19, 2015 at 7:39 PM, Cliff Brunson <cbrunson@bbcinternational.com> wrote:

Shelly,

I have attached a remediation plan for the OXY Proximity 31 Federal #4 SWD Battery. This plan has been approved by the NMOCD as seen in the email below. I am requesting BLM's approval as well. If you would please review this plan and email back with your concurrence and approval, it would be greatly appreciated.

Thanks, Cliff

Cliff P. Brunson, CEI, CRS

President

BBC International, Inc.

World-Wide Environmental Specialists

Mailing Address:

P. O. Box 805

Hobbs, NM 88241-0805 USA

Shipping Address:

1324 W. Marland St.

Hobbs, NM 88240 USA

Phone: (575) 397-6388

Fax: (575) 397-0397

E-Mail: cbrunson@bbcinternational.com

Confidentiality Notice: This electronic transmission (and any attached documents) is intended only for the person(s) to whom it is addressed and may contain information that is privileged, confidential, or otherwise protected from disclosure. If you have received this transmission in error, please immediately notify the sender by e-mail or by telephone call to (575) 397-6388 for handling instructions. Any disclosure or distribution of the contents of this transmission by anyone other than the named recipient(s) is strictly prohibited.

From: Jones, Kellie, EMNRD [mailto:Kellie.Jones@state.nm.us]

Sent: Tuesday, August 18, 2015 11:27 AM

To: Cliff Brunson <cbrunson@bbcinternational.com>

Cc: Keyes, Jamie, EMNRD <Jamie.Keyes@state.nm.us>; Oberding, Tomas, EMNRD

<Tomas.Oberding@state.nm.us>; C J Summers <Chancey_Summers@oxy.com>; Ken Swinney

<kswinney@bbcinternational.com>; Jennifer Gilkey <jgilkey@bbcinternational.com>; Kathy Purvis

<kathy@bbcinternational.com>

Subject: RE: OXY Proximity 31 Federal #4 SWD Battery - Remediation Plan - RP #3802

Cliff,

The plan is approved. Please let me know if you have any questions.

Have a great day!

Kellie Jones

Environmental Specialist, District 1

Oil Conservation Division, EMNRD

575-393-6161 ext. 111

575-370-3180 (emergency-cell)

E-Mail: kellie.jones@state.nm.us

OCD approval does not relieve the operator of liability should their operations fail to adequately investigate and remediate contamination that may pose a threat to ground water, surface water, human health or the environment. In addition, OCD approval does not relieve the operator of responsibility for compliance with any other federal, state, local laws and/or regulations.

Please note:

-The OCD is no longer granting “risk-based,” or standard closure of events/RPs with remediation deferred to site abandonment/sale/closure. The RP will remain open until such time as historic contamination is addressed.

-Photographic documentation is stipulated for all events involving liquids.

If you have any questions or concerns, and for notification, please contact me.

From: Cliff Brunson [<mailto:cbrunson@bbcinternational.com>]

Sent: Monday, August 17, 2015 2:48 PM

To: Jones, Kellie, EMNRD

Cc: Keyes, Jamie, EMNRD; Oberding, Tomas, EMNRD; C J Summers; Ken Swinney; Jennifer Gilkey; Kathy

Purvis

Subject: OXY Proximity 31 Federal #4 SWD Battery - Remediation Plan - RP #3802

Kellie,

This e-mail is to confirm our discussion on Friday, August 14, 2015 concerning the remediation plan for the Oxy Proximity 31 Federal #4 SWD Battery. I have attached the information packet that we used in our discussion with a cover page describing the remediation plan that we agreed upon.

If you would please reply back via e-mail with your concurrence on this plan, it would be greatly appreciated.

Thanks, Cliff

Cliff P. Brunson, CEI, CRS

President

BBC International, Inc.

World-Wide Environmental Specialists

Mailing Address:

P. O. Box 805

Hobbs, NM 88241-0805 USA

Shipping Address:

1324 W. Marland St.

Hobbs, NM 88240 USA

Phone: (575) 397-6388

Fax: (575) 397-0397

E-Mail: cbrunson@bbcinternational.com

Confidentiality Notice: This electronic transmission (and any attached documents) is intended only for the person(s) to whom it is addressed and may contain information that is privileged, confidential, or otherwise protected from disclosure. If you have received this transmission in error, please immediately notify the sender by e-mail or by telephone call to (575) 397-6388 for handling instructions. Any disclosure or distribution of the contents of this transmission by anyone other than the named recipient(s) is strictly prohibited.







