



PHONE (575) 397-6388 • FAX (575) 397- 0397 • 1324 W. MARLAND • P.O. BOX 805 • HOBBS, NM 88241-0805
E-MAIL: cbrunson@bbcinternational.com

APPROVED

NMOCD RP 4444

By Kristen Lynch at 7:56 am, Nov 10, 2016

COG – AIRSTRIP FEE COM #001H (9/11/16)

REMEDIATION PLAN

COG will excavate the spill area as depicted on the following site diagram. The leak area near SB1 and SB2 will be excavated to a depth of 1 foot. The leak area near SB3 and SB4 will be excavated to a depth of 3 feet. The leak area near SB5 will be excavated to a depth of 6 inches. The leak area near SB6 will be excavated to a depth of 5 feet. The leak area near SB7 will be excavated to a depth of 2 feet.

The entire site will then be backfilled with clean soil.

All excavated materials will be disposed of at an NMOCD-approved disposal facility.



COG

Airstrip Fee Com #001H (9/11/16)

Two-track
road

Flag @ N 32.67826°
W 103.51340°

Flag @ N 32.67850°
W 103.51458°

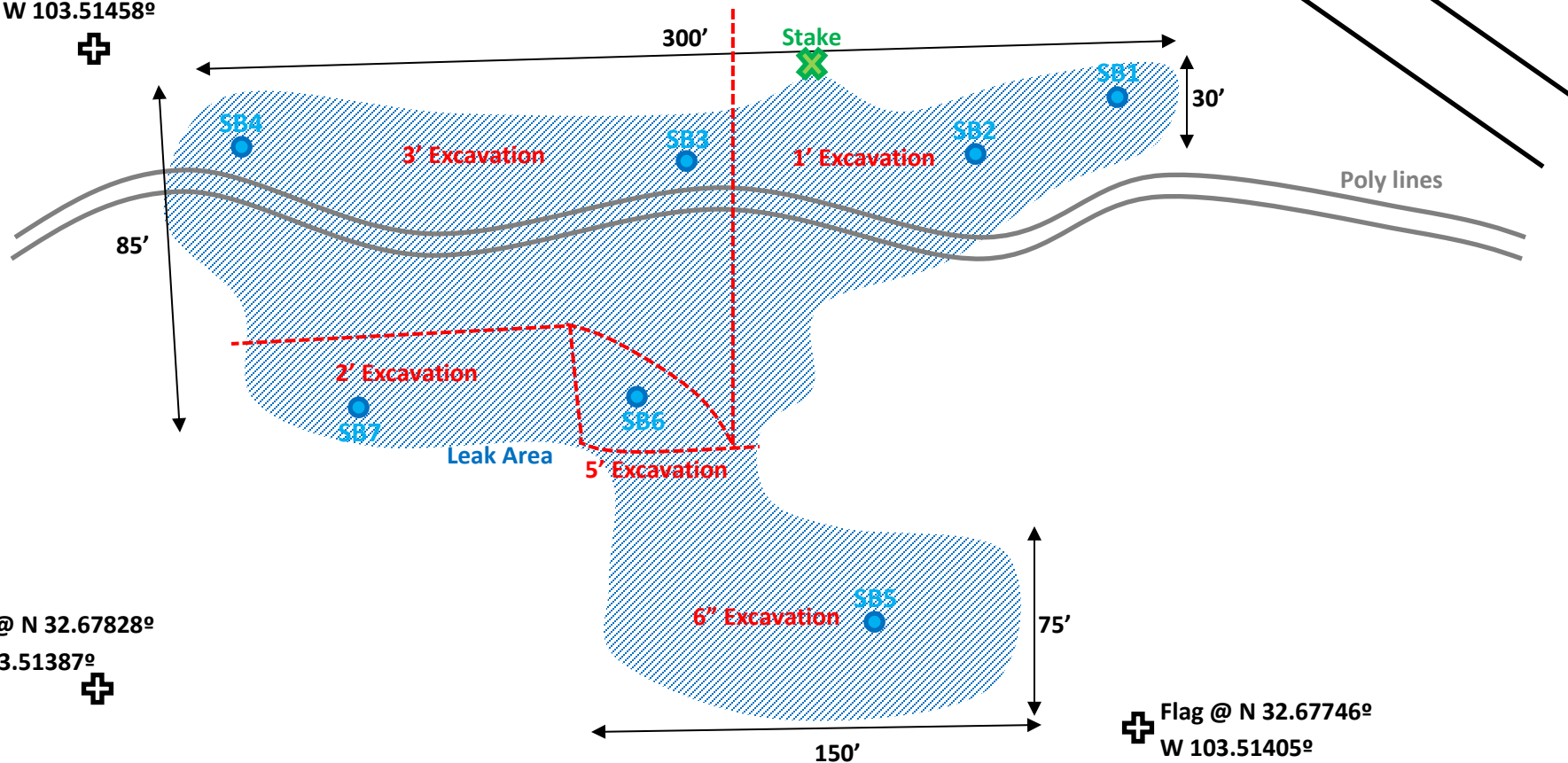

Flag @ N 32.67828°
W 103.51387°

Flag @ N 32.67746°
W 103.51405°

U/L C, Section 12, T19S, R34E at leak site

Lea County, NM

N 32.67850° W 103.51458°

API# 30-025-41152

BBC International, Inc.

COG

Airstrip Fee Com #001H

Date: 10/04/2016

DRWG by: K. Purvis

NOT TO SCALE

File: COG 2016



Groundwater Plot

COG Airstrip Fee Com #001H

County
Lea

Unit Letter
C

Section
12

Township
19S

Range
34E

Trend Map 75'-100'

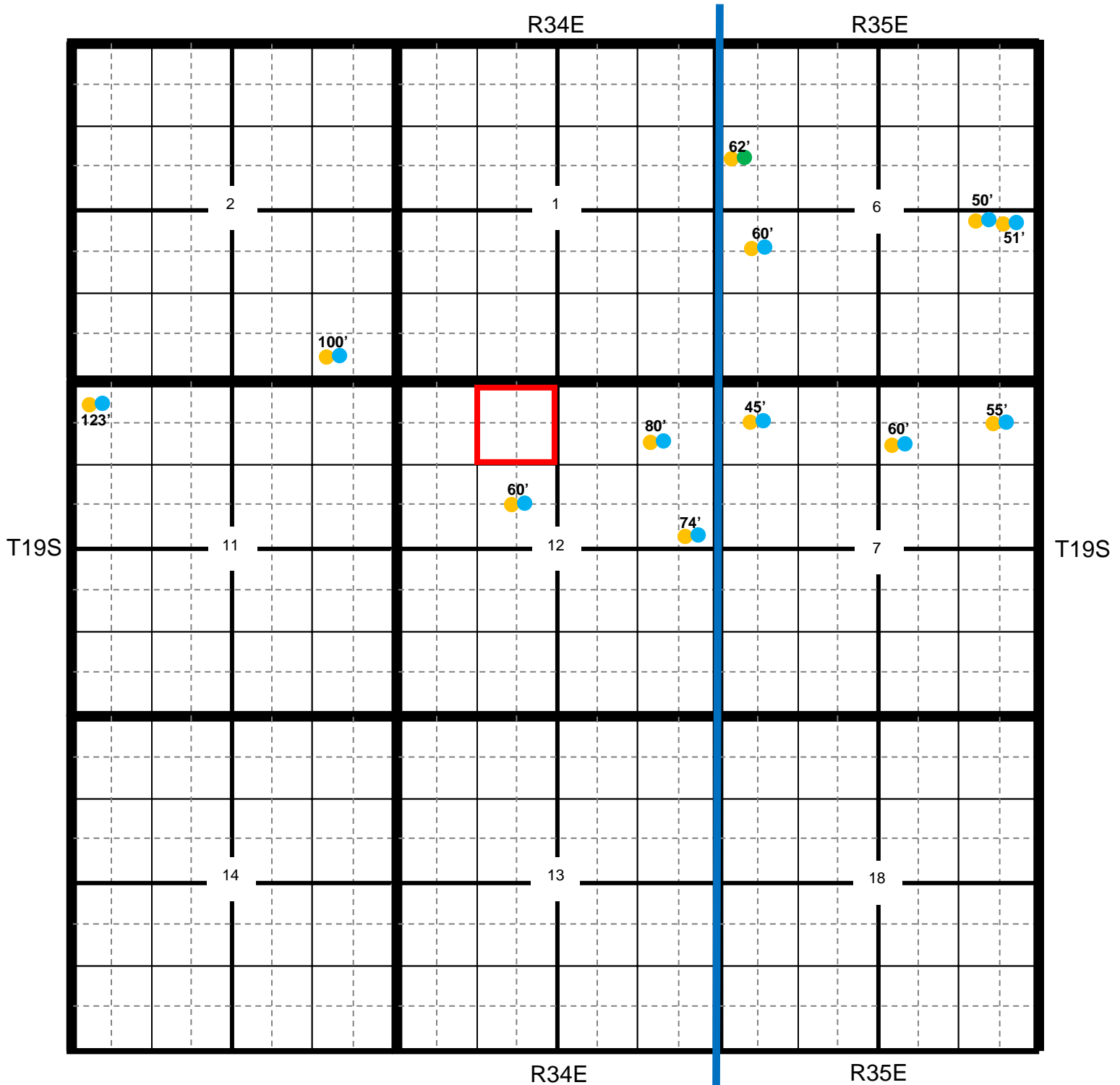

Location

OCD

USGS

SEO

All Databases

COG Airstrip Fee Com #001H

County	Unit Letter	Section	Township	Range
Lea	C	12	19S	34E

Trend Map 75'-100'

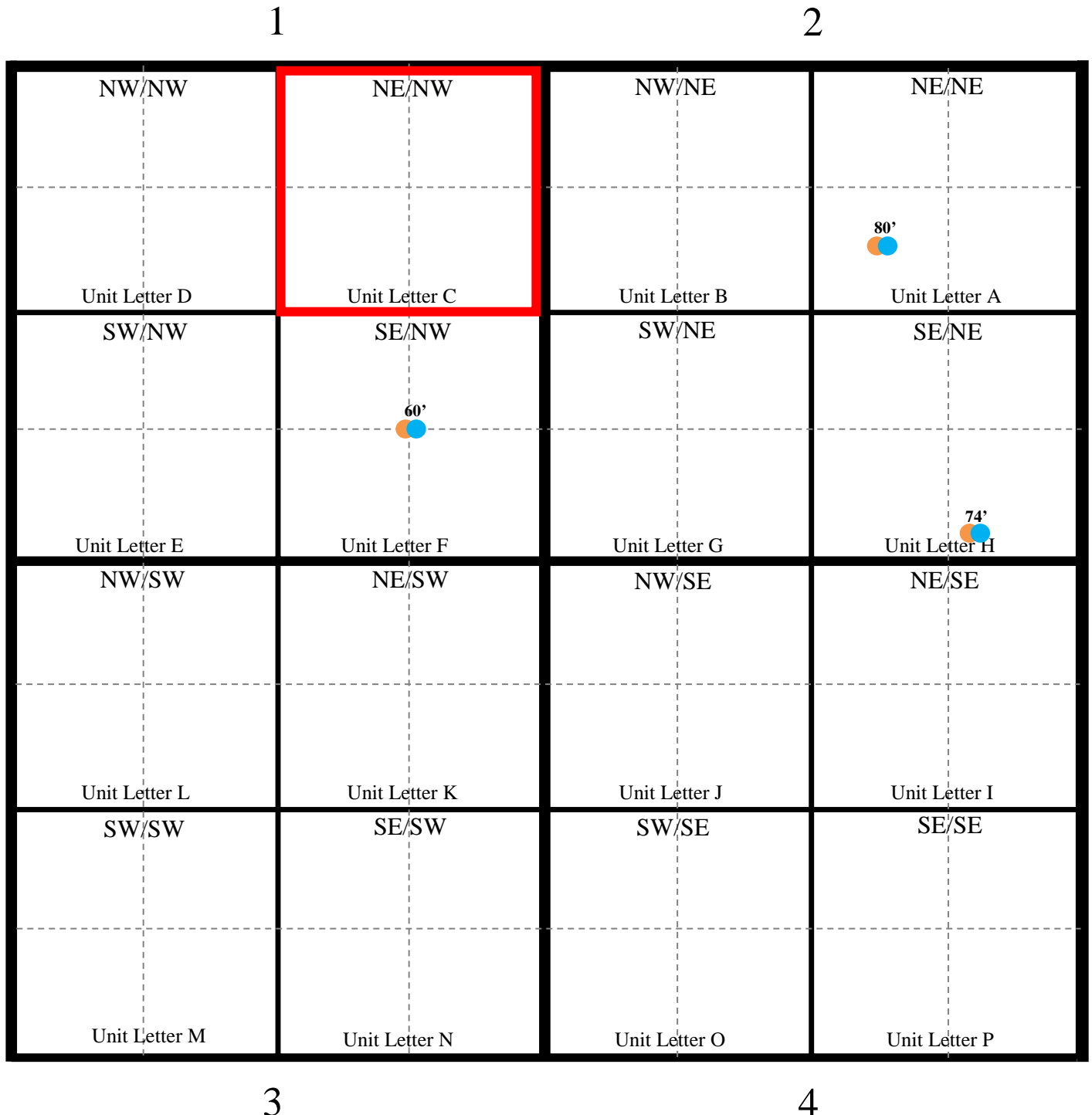

**Laboratory Analytical Results Summary
Airstrip Fee Com #1H Battery**

		Sample	SB1 @ 1'	SB1 @ 2'	SB1 @ 3'
Analyte	Method	Date	10/18/16	10/18/16	10/18/16
			mg/Kg	mg/Kg	mg/Kg
Chloride	SM4500Cl-B		544	112	48

		Sample	SB2 @ 1'	SB2 @ 2'	SB2 @ 3'
Analyte	Method	Date	10/18/16	10/18/16	10/18/16
			mg/Kg	mg/Kg	mg/Kg
Chloride	SM4500Cl-B		528	496	48

		Sample	SB3 @ 1'	SB3 @ 2'	SB3 @ 3'	SB3 @ 5'	SB3 @ 6'
Analyte	Method	Date	10/18/16	10/18/16	10/18/16	10/18/16	10/18/16
			mg/Kg	mg/Kg	mg/Kg	mg/Kg	mg/Kg
Chloride	SM4500Cl-B		11600	3880	1380	1040	176

		Sample	SB4 @ 1'	SB4 @ 2'	SB4 @ 3'	SB4 @ 4'
Analyte	Method	Date	10/18/16	10/18/16	10/18/16	10/18/16
			mg/Kg	mg/Kg	mg/Kg	mg/Kg
Chloride	SM4500Cl-B		16800	8930	1570	384

		Sample	SB5 @ 1'	SB5 @ 2'
Analyte	Method	Date	10/18/16	10/18/16
			mg/Kg	mg/Kg
Chloride	SM4500Cl-B		240	112

		Sample	SB6 @ 1'	SB6 @ 2'	SB6 @ 3'	SB6 @ 5'	SB6 @ 6'
Analyte	Method	Date	10/18/16	10/18/16	10/18/16	10/18/16	10/18/16
			mg/Kg	mg/Kg	mg/Kg	mg/Kg	mg/Kg
Chloride	SM4500Cl-B		12100	2320	2480	1360	128

		Sample	SB7 @ 1'	SB7 @ 2'	SB7 @ 3'	SB7 @ 4'	SB7 @ 5'
Analyte	Method	Date	10/18/16	10/18/16	10/18/16	10/18/16	10/18/16
			mg/Kg	mg/Kg	mg/Kg	mg/Kg	mg/Kg
Chloride	SM4500Cl-B		13200	5280	416	368	352



PHONE (575) 393-2326 ° 101 E. MARLAND ° HOBBS, NM 88240

October 24, 2016

Cliff Brunson

BBC International, Inc.

P.O. Box 805

Hobbs, NM 88241

RE: AIRSTRIP FEE COM

Enclosed are the results of analyses for samples received by the laboratory on 10/19/16 16:47.

Cardinal Laboratories is accredited through Texas NELAP under certificate number T104704398-16-8. Accreditation applies to drinking water, non-potable water and solid and chemical materials. All accredited analytes are denoted by an asterisk (*). For a complete list of accredited analytes and matrices visit the TCEQ website at www.tceq.texas.gov/field/qa/lab_accred_certif.html.

Cardinal Laboratories is accredited through the State of Colorado Department of Public Health and Environment for:

Method EPA 552.2	Haloacetic Acids (HAA-5)
Method EPA 524.2	Total Trihalomethanes (TTHM)
Method EPA 524.4	Regulated VOCs (V1, V2, V3)

Accreditation applies to public drinking water matrices.

This report meets NELAP requirements and is made up of a cover page, analytical results, and a copy of the original chain-of-custody. If you have any questions concerning this report, please feel free to contact me.

Sincerely,

A handwritten signature in black ink that reads "Celey D. Keene". The signature is written in a cursive, flowing style.

Celey D. Keene

Lab Director/Quality Manager

Analytical Results For:

BBC International, Inc.
Cliff Brunson
P.O. Box 805
Hobbs NM, 88241
Fax To: (575) 397-0397

Received: 10/19/2016
Reported: 10/24/2016
Project Name: AIRSTRIP FEE COM
Project Number: NONE GIVEN
Project Location: NOT GIVEN

Sampling Date: 10/18/2016
Sampling Type: Soil
Sampling Condition: Cool & Intact
Sample Received By: Jodi Henson

Sample ID: SB 1 @ 1' (H602348-01)

Chloride, SM4500Cl-B		mg/kg		Analyzed By: AC					
Analyte	Result	Reporting Limit	Analyzed	Method Blank	BS	% Recovery	True Value QC	RPD	Qualifier
Chloride	544	16.0	10/20/2016	ND	432	108	400	3.77	

Sample ID: SB 1 @ 2' (H602348-02)

Chloride, SM4500Cl-B		mg/kg		Analyzed By: AC					
Analyte	Result	Reporting Limit	Analyzed	Method Blank	BS	% Recovery	True Value QC	RPD	Qualifier
Chloride	112	16.0	10/20/2016	ND	432	108	400	3.77	

Sample ID: SB 1 @ 3' (H602348-03)

Chloride, SM4500Cl-B		mg/kg		Analyzed By: AC					
Analyte	Result	Reporting Limit	Analyzed	Method Blank	BS	% Recovery	True Value QC	RPD	Qualifier
Chloride	48.0	16.0	10/20/2016	ND	432	108	400	3.77	

Sample ID: SB 2 @ 1' (H602348-04)

Chloride, SM4500Cl-B		mg/kg		Analyzed By: AC					
Analyte	Result	Reporting Limit	Analyzed	Method Blank	BS	% Recovery	True Value QC	RPD	Qualifier
Chloride	528	16.0	10/20/2016	ND	432	108	400	3.77	

Cardinal Laboratories

*=Accredited Analyte

PLEASE NOTE: Liability and Damages. Cardinal's liability and client's exclusive remedy for any claim arising, whether based in contract or tort, shall be limited to the amount paid by client for analyses. All claims, including those for negligence and any other cause whatsoever shall be deemed waived unless made in writing and received by Cardinal within thirty (30) days after completion of the applicable service. In no event shall Cardinal be liable for incidental or consequential damages, including, without limitation, business interruptions, loss of use, or loss of profits incurred by client, its subsidiaries, affiliates or successors arising out of or related to the performance of the services hereunder by Cardinal, regardless of whether such claim is based upon any of the above stated reasons or otherwise. Results relate only to the samples identified above. This report shall not be reproduced except in full with written approval of Cardinal Laboratories.



Celey D. Keene, Lab Director/Quality Manager

Analytical Results For:

BBC International, Inc.
Cliff Brunson
P.O. Box 805
Hobbs NM, 88241
Fax To: (575) 397-0397

Received: 10/19/2016
Reported: 10/24/2016
Project Name: AIRSTRIP FEE COM
Project Number: NONE GIVEN
Project Location: NOT GIVEN

Sampling Date: 10/18/2016
Sampling Type: Soil
Sampling Condition: Cool & Intact
Sample Received By: Jodi Henson

Sample ID: SB 2 @ 2' (H602348-05)

Chloride, SM4500Cl-B		mg/kg		Analyzed By: AC					
Analyte	Result	Reporting Limit	Analyzed	Method Blank	BS	% Recovery	True Value QC	RPD	Qualifier
Chloride	496	16.0	10/21/2016	ND	416	104	400	3.92	

Sample ID: SB 2 @ 3' (H602348-06)

Chloride, SM4500CI-B		mg/kg		Analyzed By: AC					
Analyte	Result	Reporting Limit	Analyzed	Method Blank	BS	% Recovery	True Value QC	RPD	Qualifier
Chloride	48.0	16.0	10/21/2016	ND	416	104	400	3.92	

Sample ID: SB 3 @ 1' (H602348-07)

Chloride, SM4500Cl-B		mg/kg		Analyzed By: AC						
Analyte	Result	Reporting Limit	Analyzed	Method Blank	BS	% Recovery	True Value QC	RPD	Qualifier	
Chloride	11600	16.0	10/21/2016	ND	416	104	400	3.92		

Sample ID: SB 3 @ 2' (H602348-08)

Chloride, SM4500CI-B		mg/kg		Analyzed By: AC					
Analyte	Result	Reporting Limit	Analyzed	Method Blank	BS	% Recovery	True Value QC	RPD	Qualifier
Chloride	3880	16.0	10/21/2016	ND	416	104	400	3.92	

Sample ID: SB 3 @ 3' (H602348-09)

Chloride, SM4500Cl-B		mg/kg		Analyzed By: AC					
Analyte	Result	Reporting Limit	Analyzed	Method Blank	BS	% Recovery	True Value QC	RPD	Qualifier
Chloride	1380	16.0	10/21/2016	ND	416	104	400	3.92	

Cardinal Laboratories

*=Accredited Analyte

PLEASE NOTE: Liability and Damages. Cardinal's liability and client's exclusive remedy for any claim arising, whether based in contract or tort, shall be limited to the amount paid by client for analyses. All claims, including those for negligence and any other cause whatsoever shall be deemed waived unless made in writing and received by Cardinal within thirty (30) days after completion of the applicable service. In no event shall Cardinal be liable for incidental or consequential damages, including, without limitation, business interruptions, loss of use, or loss of profits incurred by client, its subsidiaries, affiliates or successors arising out of or related to the performance of the services hereunder by Cardinal, regardless of whether such claim is based upon any of the above stated reasons or otherwise. Results relate only to the samples identified above. This report shall not be reproduced except in full with written approval of Cardinal Laboratories.



Celey D. Keene, Lab Director/Quality Manager

Analytical Results For:

BBC International, Inc.
Cliff Brunson
P.O. Box 805
Hobbs NM, 88241
Fax To: (575) 397-0397

Received: 10/19/2016
Reported: 10/24/2016
Project Name: AIRSTRIP FEE COM
Project Number: NONE GIVEN
Project Location: NOT GIVEN

Sampling Date: 10/18/2016
Sampling Type: Soil
Sampling Condition: Cool & Intact
Sample Received By: Jodi Henson

Sample ID: SB 3 @ 5' (H602348-10)

Chloride, SM4500Cl-B		mg/kg		Analyzed By: AC					
Analyte	Result	Reporting Limit	Analyzed	Method Blank	BS	% Recovery	True Value QC	RPD	Qualifier
Chloride	1040	16.0	10/21/2016	ND	416	104	400	3.92	

Sample ID: SB 3 @ 6' (H602348-11)

Chloride, SM4500Cl-B		mg/kg		Analyzed By: AC					
Analyte	Result	Reporting Limit	Analyzed	Method Blank	BS	% Recovery	True Value QC	RPD	Qualifier
Chloride	176	16.0	10/21/2016	ND	416	104	400	3.92	

Sample ID: SB 4 @ 1' (H602348-12)

Chloride, SM4500Cl-B		mg/kg		Analyzed By: AC						
Analyte	Result	Reporting Limit	Analyzed	Method Blank	BS	% Recovery	True Value QC	RPD	Qualifier	
Chloride	16800	16.0	10/21/2016	ND	416	104	400	3.92		

Sample ID: SB 4 @ 2' (H602348-13)

Chloride, SM4500Cl-B		mg/kg		Analyzed By: AC					
Analyte	Result	Reporting Limit	Analyzed	Method Blank	BS	% Recovery	True Value QC	RPD	Qualifier
Chloride	8930	16.0	10/21/2016	ND	416	104	400	3.92	

Sample ID: SB 4 @ 3' (H602348-14)

Chloride, SM4500Cl-B		mg/kg		Analyzed By: AC					
Analyte	Result	Reporting Limit	Analyzed	Method Blank	BS	% Recovery	True Value QC	RPD	Qualifier
Chloride	1570	16.0	10/21/2016	ND	416	104	400	3.92	

Cardinal Laboratories

*=Accredited Analyte

PLEASE NOTE: Liability and Damages. Cardinal's liability and client's exclusive remedy for any claim arising, whether based in contract or tort, shall be limited to the amount paid by client for analyses. All claims, including those for negligence and any other cause whatsoever shall be deemed waived unless made in writing and received by Cardinal within thirty (30) days after completion of the applicable service. In no event shall Cardinal be liable for incidental or consequential damages, including, without limitation, business interruptions, loss of use, or loss of profits incurred by client, its subsidiaries, affiliates or successors arising out of or related to the performance of the services hereunder by Cardinal, regardless of whether such claim is based upon any of the above stated reasons or otherwise. Results relate only to the samples identified above. This report shall not be reproduced except in full with written approval of Cardinal Laboratories.



Celey D. Keene, Lab Director/Quality Manager

Analytical Results For:

BBC International, Inc.
Cliff Brunson
P.O. Box 805
Hobbs NM, 88241
Fax To: (575) 397-0397

Received: 10/19/2016
Reported: 10/24/2016
Project Name: AIRSTRIP FEE COM
Project Number: NONE GIVEN
Project Location: NOT GIVEN

Sampling Date: 10/18/2016
Sampling Type: Soil
Sampling Condition: Cool & Intact
Sample Received By: Jodi Henson

Sample ID: SB 4 @ 4' (H602348-15)

Chloride, SM4500Cl-B		mg/kg		Analyzed By: AC					
Analyte	Result	Reporting Limit	Analyzed	Method Blank	BS	% Recovery	True Value QC	RPD	Qualifier
Chloride	384	16.0	10/21/2016	ND	416	104	400	3.92	

Sample ID: SB 5 @ 1' (H602348-16)

Chloride, SM4500CI-B		mg/kg		Analyzed By: AC					
Analyte	Result	Reporting Limit	Analyzed	Method Blank	BS	% Recovery	True Value QC	RPD	Qualifier
Chloride	240	16.0	10/21/2016	ND	416	104	400	3.92	

Sample ID: SB 5 @ 2' (H602348-17)

Chloride, SM4500CI-B		mg/kg		Analyzed By: AC					
Analyte	Result	Reporting Limit	Analyzed	Method Blank	BS	% Recovery	True Value QC	RPD	Qualifier
Chloride	112	16.0	10/21/2016	ND	416	104	400	3.92	

Sample ID: SB 6 @ 1' (H602348-18)

Chloride, SM4500CI-B		mg/kg		Analyzed By: AC					
Analyte	Result	Reporting Limit	Analyzed	Method Blank	BS	% Recovery	True Value QC	RPD	Qualifier
Chloride	12100	16.0	10/21/2016	ND	416	104	400	3.92	

Sample ID: SB 6 @ 2' (H602348-19)

Chloride, SM4500Cl-B		mg/kg		Analyzed By: AC					
Analyte	Result	Reporting Limit	Analyzed	Method Blank	BS	% Recovery	True Value QC	RPD	Qualifier
Chloride	2320	16.0	10/21/2016	ND	416	104	400	3.92	

Cardinal Laboratories

*=Accredited Analyte

PLEASE NOTE: Liability and Damages. Cardinal's liability and client's exclusive remedy for any claim arising, whether based in contract or tort, shall be limited to the amount paid by client for analyses. All claims, including those for negligence and any other cause whatsoever shall be deemed waived unless made in writing and received by Cardinal within thirty (30) days after completion of the applicable service. In no event shall Cardinal be liable for incidental or consequential damages, including, without limitation, business interruptions, loss of use, or loss of profits incurred by client, its subsidiaries, affiliates or successors arising out of or related to the performance of the services hereunder by Cardinal, regardless of whether such claim is based upon any of the above stated reasons or otherwise. Results relate only to the samples identified above. This report shall not be reproduced except in full with written approval of Cardinal Laboratories.



Celey D. Keene, Lab Director/Quality Manager

Analytical Results For:

BBC International, Inc.
Cliff Brunson
P.O. Box 805
Hobbs NM, 88241
Fax To: (575) 397-0397

Received: 10/19/2016
Reported: 10/24/2016
Project Name: AIRSTRIP FEE COM
Project Number: NONE GIVEN
Project Location: NOT GIVEN

Sampling Date: 10/18/2016
Sampling Type: Soil
Sampling Condition: Cool & Intact
Sample Received By: Jodi Henson

Sample ID: SB 6 @ 3' (H602348-20)

Chloride, SM4500Cl-B		mg/kg		Analyzed By: AC					
Analyte	Result	Reporting Limit	Analyzed	Method Blank	BS	% Recovery	True Value QC	RPD	Qualifier
Chloride	2480	16.0	10/21/2016	ND	416	104	400	3.92	

Sample ID: SB 6 @ 5' (H602348-21)

Chloride, SM4500Cl-B		mg/kg		Analyzed By: AC					
Analyte	Result	Reporting Limit	Analyzed	Method Blank	BS	% Recovery	True Value QC	RPD	Qualifier
Chloride	1360	16.0	10/21/2016	ND	416	104	400	3.92	

Sample ID: SB 6 @ 6' (H602348-22)

Chloride, SM4500CI-B		mg/kg		Analyzed By: AC					
Analyte	Result	Reporting Limit	Analyzed	Method Blank	BS	% Recovery	True Value QC	RPD	Qualifier
Chloride	128	16.0	10/21/2016	ND	416	104	400	3.92	

Sample ID: SB 7 @ 1' (H602348-23)

Chloride, SM4500CI-B		mg/kg		Analyzed By: AC					
Analyte	Result	Reporting Limit	Analyzed	Method Blank	BS	% Recovery	True Value QC	RPD	Qualifier
Chloride	13200	16.0	10/21/2016	ND	416	104	400	3.92	

Sample ID: SB 7 @ 2' (H602348-24)

Chloride, SM4500Cl-B		mg/kg		Analyzed By: AC					
Analyte	Result	Reporting Limit	Analyzed	Method Blank	BS	% Recovery	True Value QC	RPD	Qualifier
Chloride	5280	16.0	10/21/2016	ND	416	104	400	3.92	

Cardinal Laboratories

*=Accredited Analyte

PLEASE NOTE: Liability and Damages. Cardinal's liability and client's exclusive remedy for any claim arising, whether based in contract or tort, shall be limited to the amount paid by client for analyses. All claims, including those for negligence and any other cause whatsoever shall be deemed waived unless made in writing and received by Cardinal within thirty (30) days after completion of the applicable service. In no event shall Cardinal be liable for incidental or consequential damages, including, without limitation, business interruptions, loss of use, or loss of profits incurred by client, its subsidiaries, affiliates or successors arising out of or related to the performance of the services hereunder by Cardinal, regardless of whether such claim is based upon any of the above stated reasons or otherwise. Results relate only to the samples identified above. This report shall not be reproduced except in full with written approval of Cardinal Laboratories.



Celey D. Keene, Lab Director/Quality Manager

Analytical Results For:

BBC International, Inc.
Cliff Brunson
P.O. Box 805
Hobbs NM, 88241
Fax To: (575) 397-0397

Received: 10/19/2016
Reported: 10/24/2016
Project Name: AIRSTRIP FEE COM
Project Number: NONE GIVEN
Project Location: NOT GIVEN

Sampling Date: 10/18/2016
Sampling Type: Soil
Sampling Condition: Cool & Intact
Sample Received By: Jodi Henson

Sample ID: SB 7 @ 3' (H602348-25)

Chloride, SM4500Cl-B		mg/kg		Analyzed By: AC					
Analyte	Result	Reporting Limit	Analyzed	Method Blank	BS	% Recovery	True Value QC	RPD	Qualifier
Chloride	416	16.0	10/24/2016	ND	400	100	400	0.00	

Sample ID: SB 7 @ 4' (H602348-26)

Chloride, SM4500Cl-B		mg/kg		Analyzed By: AC					
Analyte	Result	Reporting Limit	Analyzed	Method Blank	BS	% Recovery	True Value QC	RPD	Qualifier
Chloride	368	16.0	10/24/2016	ND	400	100	400	0.00	

Sample ID: SB 7 @ 5' (H602348-27)

Chloride, SM4500Cl-B		mg/kg		Analyzed By: AC					
Analyte	Result	Reporting Limit	Analyzed	Method Blank	BS	% Recovery	True Value QC	RPD	Qualifier
Chloride	352	16.0	10/24/2016	ND	400	100	400	0.00	

Cardinal Laboratories

*=Accredited Analyte

PLEASE NOTE: Liability and Damages. Cardinal's liability and client's exclusive remedy for any claim arising, whether based in contract or tort, shall be limited to the amount paid by client for analyses. All claims, including those for negligence and any other cause whatsoever shall be deemed waived unless made in writing and received by Cardinal within thirty (30) days after completion of the applicable service. In no event shall Cardinal be liable for incidental or consequential damages, including, without limitation, business interruptions, loss of use, or loss of profits incurred by client, its subsidiaries, affiliates or successors arising out of or related to the performance of the services hereunder by Cardinal, regardless of whether such claim is based upon any of the above stated reasons or otherwise. Results relate only to the samples identified above. This report shall not be reproduced except in full with written approval of Cardinal Laboratories.



Celey D. Keene, Lab Director/Quality Manager

Notes and Definitions

QM-07	The spike recovery was outside acceptance limits for the MS and/or MSD. The batch was accepted based on acceptable LCS recovery.
ND	Analyte NOT DETECTED at or above the reporting limit
RPD	Relative Percent Difference
**	Samples not received at proper temperature of 6°C or below.
***	Insufficient time to reach temperature.
-	Chloride by SM4500Cl-B does not require samples be received at or below 6°C Samples reported on an as received basis (wet) unless otherwise noted on report

Cardinal Laboratories

*=Accredited Analyte

PLEASE NOTE: Liability and Damages. Cardinal's liability and client's exclusive remedy for any claim arising, whether based in contract or tort, shall be limited to the amount paid by client for analyses. All claims, including those for negligence and any other cause whatsoever shall be deemed waived unless made in writing and received by Cardinal within thirty (30) days after completion of the applicable service. In no event shall Cardinal be liable for incidental or consequential damages, including, without limitation, business interruptions, loss of use, or loss of profits incurred by client, its subsidiaries, affiliates or successors arising out of or related to the performance of the services hereunder by Cardinal, regardless of whether such claim is based upon any of the above stated reasons or otherwise. Results relate only to the samples identified above. This report shall not be reproduced except in full with written approval of Cardinal Laboratories.



Celey D. Keene, Lab Director/Quality Manager



ARDINAL LABORATORIES
101 East Marland, Hobbs, NM 88240
(505) 393-2326 FAX (505) 393-2476

CHAIN-OF-CUSTODY AND ANALYSIS REQUEST

(505) 393-2326 FAX (505) 393-2410

BILL TO

ANALYSIS REQUEST

Company Name: BBC International, Inc.
Project Manager: Cliff Brunson
Address: P.O. Box 805
City: Hobbs
State: NM Zip: 88241
Phone #: 575-397-6388 Fax #: 575-397-0397
Project #:
Project Owner: CCG
Project Location:

P.O. #:

Company:

Attn:

Address:

City:

State:

Zip:

Phone #:

Fax #:

Sample Name: BPC Brunson

FOR LAB USE ONLY

Lab I.D. Sample I.D.

H002348

(G)RAB OR (C)OMP.	
# CONTAINERS	
GROUNDWATER	
WASTEWATER	
SOIL	
OIL	
SLUDGE	
OTHER :	
ACID/BASE:	
ICE / COOL	
OTHER :	

DATE TIME

SB1 @ 1'	G	/	1025	
SB1 @ 2'	G	/	1030	
SB1 @ 3'	G	/	1035	
SB2 @ 1'	G	/	1040	
SB2 @ 2'	G	/	1045	
SB2 @ 3'	G	/	1050	
SB3 @ 1'	G	/	1110	
SB3 @ 2'	G	/	1120	
SB3 @ 3'	G	/	1125	
SB3 @ 5'	G	/	1135	

PLEASE NOTE: Liability and Damages. Cardinal's liability and client's exclusive remedy for any claim arising whether based in contract or tort, shall be limited to the amount paid by the client for the service. All claims, including those for negligence and any other cause whatsoever shall be deemed waived unless made in writing and received by Cardinal within 30 days after completion of the applicable service. In no event shall Cardinal be liable for incidental or consequential damages, including without limitation, business interruptions, loss of use, or loss of profits incurred by client, its subsidiaries, affiliates or successors arising out of or related to the performance of services hereunder by Cardinal, regardless of whether such claim is based upon any of the above stated remedies or otherwise.

Relinquished By:

Date: 10/19/16

Time: 4:47

Received By:

Debi Henderson

Relinquished By:

Date:

Time:

Received By:

Debi Henderson

Delivered By: (Circle One)

Sample - UPS - Bus - Other:

#75

-16.32

Cool Intact Yes No

CHECKED BY: (Initials)

REMARKS:

Phone Result: Yes No Add'l Phone #:
Fax Result: Yes No Add'l Fax #:



ARDINAL LABORATORIES

101 East Marland, Hobbs, NM 88240
(505) 393-2326 FAX (505) 393-2476

CHAIN-OF-CUSTODY AND ANALYSIS REQUEST

BILL TO

ANALYSIS REQUEST

Company Name: BBC International, Inc.

Project Manager: Cliff Brunson

Address: P.O. Box 805

City: Hobbs

Phone #: 575-397-6388

Project #:

Project Name: Partnership Tree Cam

Project Location:

Sample Name: Base Brunson

FOR LAB USE ONLY

Lab I.D.

Sample I.D.

11007348

Lab I.D.	Sample I.D.	(G)RAB OR (C)OMP.	# CONTAINERS	MATRIX					DATE	TIME										
				GROUNDWATER	WASTEWATER	SOIL	OIL	SLUDGE	OTHER :											
11	58306										10/18/16	1148								
12	58401										10/18/16	1200								
13	58402										10/18/16	115								
14	58403										10/18/16	120								
15	58404										10/18/16	125								
16	58501										10/18/16	135								
17	58502										10/18/16	140								
18	58601										10/18/16	150								
19	58602										10/18/16	155								
20	58603										10/18/16	200								

PLEASE NOTE: Liability and Damages: Cardinal's liability and clients exclusive remedy for any claim arising whether based in contract or tort, shall be limited to the amount paid by the client for the analyses. All claims, including those for negligence and any other cause whatsoever shall be deemed waived unless made in writing and received by Cardinal within 30 days after completion of the applicable service. In no event shall Cardinal be liable for incidental or consequential damages, including without limitation, business interruptions, loss of use, or loss of profits incurred by client, its subsidiaries, affiliates or successors arising out of or related to the performance of services rendered by Cardinal, regardless of whether such claim is based upon any of the above stated reasons or otherwise.

Relinquished By:

Date: 10/18/16

Received By:

Phone Result:

Yes ☐ No ☐

Add'l Phone #:

Add'l Fax #:

Relinquished By:

Date: 4:47

Received By:

Phone Result:

Yes ☐ No ☐

Add'l Phone #:

Add'l Fax #:

Delivered By: (Circle One)

Sample Condition

Cool ☒ Intact ☒

Yes ☒ No ☐

Yes ☒ No ☐

Yes ☒ No ☐

Sampler - UPS - Bus - Other:

#75 - 6.32

Yes ☒ No ☐

Yes ☒ No ☐

Yes ☒ No ☐

Yes ☒ No ☐

Yes ☒ No ☐

+ Cardinal cannot accept verbal changes. Please fax written changes to 505-393-2476

#75



CARDINAL LABORATORIES

101 East Marland, Hobbs, NM 88240
(505) 393-2326 FAX (505) 393-2476

CHAIN-OF-CUSTODY AND ANALYSIS REQUEST

5453

Company Name: BBC International, Inc.

Project Manager: Cliff Brunson

Address: P.O. Box 805

City: Hobbs

Phone #: 575-397-6388

Project #:

Project Name: Arship Fee Con

Project Location:

Sample Name: base Brunson

BILL TO

ANALYSIS REQUEST

P.O. #:

Company:

Attn:

Address:

City:

State: Zip:

Phone #:

Fax #:

FOR LAB USE ONLY

Lab I.D.

Sample I.D.

H100348

21 56605
23 56606
24 56701
25 56702
26 56703
27 56704
28 56705

(G)RAB OR (C)OMP.

CONTAINERS

GROUNDWATER

WASTEWATER

SOIL

OIL

SLUDGE

OTHER :

ACID/BASE:

ICE / COOL

OTHER :

DATE

TIME

10/16/16 220
10/16/16 225
10/16/16 235
10/16/16 245
10/16/16 300
10/16/16 310
10/16/16 320

CL-

PLEASE NOTE: Liability and Damages. Cardinal's liability and client's exclusive remedy for any claim arising whether based in contract or tort, shall be limited to the amount paid by the client for the analyses. All claims, including those for negligence and any other cause whatsoever shall be deemed waived unless made in writing and received by Cardinal within 30 days after completion of the applicable service. In no event shall Cardinal be liable for incidental or consequential damages, including without limitation, business interruptions, loss of use, or loss of profits incurred by client, its subsidiaries, affiliates or successors arising out of or related to the performance of services hereunder by Cardinal, regardless of whether such claim is based upon any of the above stated reasons or otherwise.

Relinquished By:

Date:

Time:

Received By:

Cliff Brunson

Relinquished By:

Date:

Time:

Received By:

Cliff Brunson

Delivered By: (Circle One)

Sampler - UPS - Bus - Other:

#75

-10.30

10.30

10.30

10.30

10.30

10.30

10.30

10.30

10.30

10.30

10.30

10.30

10.30

10.30

10.30

10.30

10.30

10.30

10.30

10.30

10.30

10.30

10.30

10.30

10.30

10.30

10.30

10.30

+ Cardinal cannot accept verbal changes. Please fax written changes to 505-393-2476

District I
1625 N. French Dr., Hobbs, NM 88240
District II
811 S. First St., Artesia, NM 88210
District III
1000 Rio Brazos Road, Aztec, NM 87410
District IV
1220 S. St. Francis Dr., Santa Fe, NM 87505

State of New Mexico
Energy Minerals and Natural Resources

Oil Conservation Division
1220 South St. Francis Dr.
Santa Fe, NM 87505

Form C-141
Revised August 8, 2011

Submit 1 Copy to appropriate District Office in
accordance with 19.15.29 NMAC.

Release Notification and Corrective Action

OPERATOR		<input checked="" type="checkbox"/> Initial Report	<input type="checkbox"/> Final Report
Name of Company:	COG Operating LLC	Contact:	Robert McNeill
Address:	600 West Illinois Avenue, Midland TX 79701	Telephone No.	432-683-7443
Facility Name:	AIRSTrip FEE COM #001H	Facility Type:	Flowline
Surface Owner:	State	Mineral Owner:	API No. 30-025-41152

LOCATION OF RELEASE

Unit Letter	Section	Township	Range	Feet from the	North/South Line	Feet from the	East/West Line	County
P	07	19S	32E	190'	South	460'	East	Lea

Latitude 32.6684113 Longitude 103.4896698

NATURE OF RELEASE

Type of Release:	Produced Water	Volume of Release:	100bbls	Volume Recovered:	0bbls
Source of Release:	4" Polyline	Date and Hour of Occurrence:	09-11-2016 10:00 am	Date and Hour of Discovery:	09-11-2016 10:00 am
Was Immediate Notice Given?	<input checked="" type="checkbox"/> Yes <input type="checkbox"/> No <input type="checkbox"/> Not Required	If YES, To Whom?	Jamie Keyes - NMOCD / Amber Groves - SLO		
By Whom?	Robert Grubbs Jr.	Date and Hour:	Mon 9/12/2016 11:29 AM		
Was a Watercourse Reached?	<input type="checkbox"/> Yes <input checked="" type="checkbox"/> No	If YES, Volume Impacting the Watercourse.			

If a Watercourse was Impacted, Describe Fully.*

Describe Cause of Problem and Remedial Action Taken.*

This release was caused by a 4" polyline. The bad section was cut out and replaced.

Describe Area Affected and Cleanup Action Taken.*

This release occurred on a 4" polyline in the pasture. Concho will have the spill site sampled to delineate any possible contamination from the release and we will present a remediation work plan to the NMOCD for approval prior to any significant remediation work.

I hereby certify that the information given above is true and complete to the best of my knowledge and understand that pursuant to NMOCD rules and regulations all operators are required to report and/or file certain release notifications and perform corrective actions for releases which may endanger public health or the environment. The acceptance of a C-141 report by the NMOCD marked as "Final Report" does not relieve the operator of liability should their operations have failed to adequately investigate and remediate contamination that pose a threat to ground water, surface water, human health or the environment. In addition, NMOCD acceptance of a C-141 report does not relieve the operator of responsibility for compliance with any other federal, state, or local laws and/or regulations.

Signature:		OIL CONSERVATION DIVISION	
Printed Name:	Robert Grubbs Jr.	Approved by Environmental Specialist:	
Title:	Senior Environmental Coordinator	Approval Date:	Expiration Date:
E-mail Address:	rgrubbs@concho.com	Conditions of Approval:	Attached <input type="checkbox"/>
Date:	August 19, 2016	Phone:	432-683-7443

* Attach Additional Sheets If Necessary