

PRELIMINARY RESULTS

ConocoPhillips Corrective action Plan for the

SEMU 034 1RP-4218

On March 21st 2016 a flow line leak occurred on the SEMU 34 resulting in the release of 15 bbls. of produced water with 1 bbl recovered. When doing our initial site assessment, it was discovered that the leak occurred on top of an old historic spill. We scheduled a meeting at the site with Jamie Keyes of the NMOCD and Shelly Tucker of the BLM on March 28th 2016. After sampling it was determined chlorides could be cleaned up easily but the old historic spill resulting in high DRO and GRO readings at deeper levels would need to be addressed at the request of the BLM. The initial leak area is approx. 1500 sq. feet the additional area being requested for cleanup by the BLM is 23,368 sq. feet of area. ConocoPhillips will excavate the entire area to a depth of 4' and backfill with clean topsoil. The contaminated material will be transported to a State approved disposal and clean top soil will be sampled before backfill use to insure it is clean. The depth to groundwater in this area is 59'. I have attached maps and sample results from the lab for you to look at. If you have any questions, please feel free to contact me by email or my phone number is 575-631-9092. We will begin work on the spill area of this project as soon as I receive approval to do so. Below I have listed the GPS coordinates and a legal description of the area. Thanks, Justin Wright

GPS: 32.557904-103.189613

UL-K, Section-19

T-20-S, R-38-E

Lea County, NM



PHONE (575) 393-2326 ° 101 E. MARLAND ° HOBBS, NM 88240

April 04, 2016

KYLE NORMAN

Basin Environmental Service

P.O. Box 301

Lovington, NM 88260

RE: SEMU PERMIAN #34 HISTORICAL

Enclosed are the results of analyses for samples received by the laboratory on 03/29/16 14:05.

Cardinal Laboratories is accredited through Texas NELAP under certificate number T104704398-15-7. Accreditation applies to drinking water, non-potable water and solid and chemical materials. All accredited analytes are denoted by an asterisk (*). For a complete list of accredited analytes and matrices visit the TCEQ website at www.tceq.texas.gov/field/qa/lab_accred_certif.html.

Cardinal Laboratories is accredited through the State of Colorado Department of Public Health and Environment for:

Method EPA 552.2	Haloacetic Acids (HAA-5)
Method EPA 524.2	Total Trihalomethanes (TTHM)
Method EPA 524.4	Regulated VOCs (V1, V2, V3)

Accreditation applies to public drinking water matrices.

This report meets NELAP requirements and is made up of a cover page, analytical results, and a copy of the original chain-of-custody. If you have any questions concerning this report, please feel free to contact me.

Sincerely,

A handwritten signature in black ink that reads "Celey D. Keene". The signature is written in a cursive, flowing style.

Celey D. Keene

Lab Director/Quality Manager

Analytical Results For:

Basin Environmental Service
KYLE NORMAN
P.O. Box 301
Lovington NM, 88260
Fax To: (575) 396-1429

Received:	03/29/2016	Sampling Date:	03/28/2016
Reported:	04/04/2016	Sampling Type:	Soil
Project Name:	SEMU PERMIAN #34 HISTORICAL	Sampling Condition:	Cool & Intact
Project Number:	NONE GIVEN	Sample Received By:	Jodi Henson
Project Location:	NONE GIVEN		

Sample ID: PT. 1 @ 2' (H600659-01)

BTX 8021B			mg/kg		Analyzed By: MS				
Analyte	Result	Reporting Limit	Analyzed	Method Blank	BS	% Recovery	True Value QC	RPD	Qualifier
Benzene*	<0.050	0.050	03/30/2016	ND	2.11	106	2.00	4.65	
Toluene*	<0.050	0.050	03/30/2016	ND	2.00	99.8	2.00	6.38	
Ethylbenzene*	<0.050	0.050	03/30/2016	ND	1.75	87.7	2.00	6.84	
Total Xylenes*	<0.150	0.150	03/30/2016	ND	5.39	89.8	6.00	6.36	
Total BTX	<0.300	0.300	03/30/2016	ND					

Surrogate: 4-Bromofluorobenzene (PID) 99.3 % 73.6-140

Chloride, SM4500Cl-B			mg/kg		Analyzed By: AP				
Analyte	Result	Reporting Limit	Analyzed	Method Blank	BS	% Recovery	True Value QC	RPD	Qualifier
Chloride	<16.0	16.0	03/30/2016	ND	400	100	400	7.69	

TPH 8015M			mg/kg		Analyzed By: MS				
Analyte	Result	Reporting Limit	Analyzed	Method Blank	BS	% Recovery	True Value QC	RPD	Qualifier
GRO C6-C10	<10.0	10.0	03/31/2016	ND	173	86.7	200	2.18	
DRO >C10-C28	64.9	10.0	03/31/2016	ND	157	78.7	200	2.90	

Surrogate: 1-Chlorooctane 87.1 % 35-147

Surrogate: 1-Chlorooctadecane 91.8 % 28-171

Cardinal Laboratories

*=Accredited Analyte

PLEASE NOTE: Liability and Damages. Cardinal's liability and client's exclusive remedy for any claim arising, whether based in contract or tort, shall be limited to the amount paid by client for analyses. All claims, including those for negligence and any other cause whatsoever shall be deemed waived unless made in writing and received by Cardinal within thirty (30) days after completion of the applicable service. In no event shall Cardinal be liable for incidental or consequential damages, including, without limitation, business interruptions, loss of use, or loss of profits incurred by client, its subsidiaries, affiliates or successors arising out of or related to the performance of the services hereunder by Cardinal, regardless of whether such claim is based upon any of the above stated reasons or otherwise. Results relate only to the samples identified above. This report shall not be reproduced except in full with written approval of Cardinal Laboratories.



Celey D. Keene, Lab Director/Quality Manager

Analytical Results For:

 Basin Environmental Service
 KYLE NORMAN
 P.O. Box 301
 Lovington NM, 88260
 Fax To: (575) 396-1429

Received:	03/29/2016	Sampling Date:	03/28/2016
Reported:	04/04/2016	Sampling Type:	Soil
Project Name:	SEMU PERMIAN #34 HISTORICAL	Sampling Condition:	Cool & Intact
Project Number:	NONE GIVEN	Sample Received By:	Jodi Henson
Project Location:	NONE GIVEN		

Sample ID: PT. 1 @ 4' (H600659-02)

BTEx 8021B		mg/kg		Analyzed By: MS					
Analyte	Result	Reporting Limit	Analyzed	Method Blank	BS	% Recovery	True Value QC	RPD	Qualifier
Benzene*	<0.050	0.050	03/30/2016	ND	2.11	106	2.00	4.65	
Toluene*	<0.050	0.050	03/30/2016	ND	2.00	99.8	2.00	6.38	
Ethylbenzene*	<0.050	0.050	03/30/2016	ND	1.75	87.7	2.00	6.84	
Total Xylenes*	<0.150	0.150	03/30/2016	ND	5.39	89.8	6.00	6.36	
Total BTEx	<0.300	0.300	03/30/2016	ND					

Surrogate: 4-Bromofluorobenzene (PID) 100 % 73.6-140

Chloride, SM4500Cl-B		mg/kg		Analyzed By: AP					
Analyte	Result	Reporting Limit	Analyzed	Method Blank	BS	% Recovery	True Value QC	RPD	Qualifier
Chloride	<16.0	16.0	03/30/2016	ND	400	100	400	7.69	

TPH 8015M		mg/kg		Analyzed By: MS					
Analyte	Result	Reporting Limit	Analyzed	Method Blank	BS	% Recovery	True Value QC	RPD	Qualifier
GRO C6-C10	<10.0	10.0	03/31/2016	ND	173	86.7	200	2.18	
DRO >C10-C28	516	10.0	03/31/2016	ND	157	78.7	200	2.90	

Surrogate: 1-Chlorooctane 86.5 % 35-147

Surrogate: 1-Chlorooctadecane 111 % 28-171

Cardinal Laboratories

*=Accredited Analyte

PLEASE NOTE: Liability and Damages. Cardinal's liability and client's exclusive remedy for any claim arising, whether based in contract or tort, shall be limited to the amount paid by client for analyses. All claims, including those for negligence and any other cause whatsoever shall be deemed waived unless made in writing and received by Cardinal within thirty (30) days after completion of the applicable service. In no event shall Cardinal be liable for incidental or consequential damages, including, without limitation, business interruptions, loss of use, or loss of profits incurred by client, its subsidiaries, affiliates or successors arising out of or related to the performance of the services hereunder by Cardinal, regardless of whether such claim is based upon any of the above stated reasons or otherwise. Results relate only to the samples identified above. This report shall not be reproduced except in full with written approval of Cardinal Laboratories.



Celey D. Keene, Lab Director/Quality Manager

Analytical Results For:

Basin Environmental Service
KYLE NORMAN
P.O. Box 301
Lovington NM, 88260
Fax To: (575) 396-1429

Received:	03/29/2016	Sampling Date:	03/28/2016
Reported:	04/04/2016	Sampling Type:	Soil
Project Name:	SEMU PERMIAN #34 HISTORICAL	Sampling Condition:	Cool & Intact
Project Number:	NONE GIVEN	Sample Received By:	Jodi Henson
Project Location:	NONE GIVEN		

Sample ID: PT. 2 @ 2' (H600659-03)

BTX 8021B		mg/kg		Analyzed By: MS						
Analyte	Result	Reporting Limit	Analyzed	Method Blank	BS	% Recovery	True Value QC	RPD	Qualifier	
Benzene*	<0.050	0.050	03/30/2016	ND	2.11	106	2.00	4.65		
Toluene*	<0.050	0.050	03/30/2016	ND	2.00	99.8	2.00	6.38		
Ethylbenzene*	<0.050	0.050	03/30/2016	ND	1.75	87.7	2.00	6.84		
Total Xylenes*	<0.150	0.150	03/30/2016	ND	5.39	89.8	6.00	6.36		
Total BTX	<0.300	0.300	03/30/2016	ND						

Surrogate: 4-Bromofluorobenzene (PID) 99.7 % 73.6-140

Chloride, SM4500CI-B		mg/kg		Analyzed By: AP						
Analyte	Result	Reporting Limit	Analyzed	Method Blank	BS	% Recovery	True Value QC	RPD	Qualifier	
Chloride	<16.0	16.0	03/30/2016	ND	400	100	400	7.69		

TPH 8015M		mg/kg		Analyzed By: MS					
Analyte	Result	Reporting Limit	Analyzed	Method Blank	BS	% Recovery	True Value QC	RPD	Qualifier
GRO C6-C10	<100	100	03/30/2016	ND	173	86.7	200	2.18	
DRO >C10-C28	<100	100	03/30/2016	ND	157	78.7	200	2.90	

Surrogate: 1-Chlorooctane 77.1 % 35-147

Surrogate: 1-Chlorooctadecane 97.9 % 28-171

Cardinal Laboratories

*=Accredited Analyte

PLEASE NOTE: Liability and Damages. Cardinal's liability and client's exclusive remedy for any claim arising, whether based in contract or tort, shall be limited to the amount paid by client for analyses. All claims, including those for negligence and any other cause whatsoever shall be deemed waived unless made in writing and received by Cardinal within thirty (30) days after completion of the applicable service. In no event shall Cardinal be liable for incidental or consequential damages, including, without limitation, business interruptions, loss of use, or loss of profits incurred by client, its subsidiaries, affiliates or successors arising out of or related to the performance of the services hereunder by Cardinal, regardless of whether such claim is based upon any of the above stated reasons or otherwise. Results relate only to the samples identified above. This report shall not be reproduced except in full with written approval of Cardinal Laboratories.



Celey D. Keene, Lab Director/Quality Manager

Analytical Results For:

Basin Environmental Service
KYLE NORMAN
P.O. Box 301
Lovington NM, 88260
Fax To: (575) 396-1429

Received:	03/29/2016	Sampling Date:	03/28/2016
Reported:	04/04/2016	Sampling Type:	Soil
Project Name:	SEMU PERMIAN #34 HISTORICAL	Sampling Condition:	Cool & Intact
Project Number:	NONE GIVEN	Sample Received By:	Jodi Henson
Project Location:	NONE GIVEN		

Sample ID: PT. 2 @ 4' (H600659-04)

BTX 8021B		mg/kg		Analyzed By: MS						
Analyte	Result	Reporting Limit	Analyzed	Method Blank	BS	% Recovery	True Value QC	RPD	Qualifier	
Benzene*	<0.050	0.050	03/30/2016	ND	2.11	106	2.00	4.65		
Toluene*	<0.050	0.050	03/30/2016	ND	2.00	99.8	2.00	6.38		
Ethylbenzene*	<0.050	0.050	03/30/2016	ND	1.75	87.7	2.00	6.84		
Total Xylenes*	<0.150	0.150	03/30/2016	ND	5.39	89.8	6.00	6.36		
Total BTX	<0.300	0.300	03/30/2016	ND						

Surrogate: 4-Bromofluorobenzene (PID) 99.5 % 73.6-140

Chloride, SM4500CI-B		mg/kg		Analyzed By: AP						
Analyte	Result	Reporting Limit	Analyzed	Method Blank	BS	% Recovery	True Value QC	RPD	Qualifier	
Chloride	<16.0	16.0	03/30/2016	ND	400	100	400	7.69		

TPH 8015M		mg/kg		Analyzed By: MS					
Analyte	Result	Reporting Limit	Analyzed	Method Blank	BS	% Recovery	True Value QC	RPD	Qualifier
GRO C6-C10	<10.0	10.0	03/30/2016	ND	173	86.7	200	2.18	
DRO >C10-C28	<10.0	10.0	03/30/2016	ND	157	78.7	200	2.90	

Surrogate: 1-Chlorooctane 84.6 % 35-147

Surrogate: 1-Chlorooctadecane 97.3 % 28-171

Cardinal Laboratories

*=Accredited Analyte

PLEASE NOTE: Liability and Damages. Cardinal's liability and client's exclusive remedy for any claim arising, whether based in contract or tort, shall be limited to the amount paid by client for analyses. All claims, including those for negligence and any other cause whatsoever shall be deemed waived unless made in writing and received by Cardinal within thirty (30) days after completion of the applicable service. In no event shall Cardinal be liable for incidental or consequential damages, including, without limitation, business interruptions, loss of use, or loss of profits incurred by client, its subsidiaries, affiliates or successors arising out of or related to the performance of the services hereunder by Cardinal, regardless of whether such claim is based upon any of the above stated reasons or otherwise. Results relate only to the samples identified above. This report shall not be reproduced except in full with written approval of Cardinal Laboratories.



Celey D. Keene, Lab Director/Quality Manager

Analytical Results For:

Basin Environmental Service
KYLE NORMAN
P.O. Box 301
Lovington NM, 88260
Fax To: (575) 396-1429

Received:	03/29/2016	Sampling Date:	03/28/2016
Reported:	04/04/2016	Sampling Type:	Soil
Project Name:	SEMU PERMIAN #34 HISTORICAL	Sampling Condition:	Cool & Intact
Project Number:	NONE GIVEN	Sample Received By:	Jodi Henson
Project Location:	NONE GIVEN		

Sample ID: PT. 3 @ 2' (H600659-05)

BTX 8021B		mg/kg		Analyzed By: MS					
Analyte	Result	Reporting Limit	Analyzed	Method Blank	BS	% Recovery	True Value QC	RPD	Qualifier
Benzene*	<0.050	0.050	03/31/2016	ND	2.00	100	2.00	16.6	
Toluene*	<0.050	0.050	03/31/2016	ND	1.91	95.6	2.00	17.2	
Ethylbenzene*	0.082	0.050	03/31/2016	ND	1.69	84.5	2.00	17.2	
Total Xylenes*	<0.150	0.150	03/31/2016	ND	5.18	86.4	6.00	16.0	
Total BTX	<0.300	0.300	03/31/2016	ND					

Surrogate: 4-Bromofluorobenzene (PID) 99.0 % 73.6-140

Chloride, SM4500CI-B		mg/kg		Analyzed By: AP					
Analyte	Result	Reporting Limit	Analyzed	Method Blank	BS	% Recovery	True Value QC	RPD	Qualifier
Chloride	<16.0	16.0	03/30/2016	ND	400	100	400	7.69	

TPH 8015M		mg/kg		Analyzed By: MS					
Analyte	Result	Reporting Limit	Analyzed	Method Blank	BS	% Recovery	True Value QC	RPD	Qualifier
GRO C6-C10	<10.0	10.0	03/31/2016	ND	173	86.7	200	2.18	
DRO >C10-C28	395	10.0	03/31/2016	ND	157	78.7	200	2.90	

Surrogate: 1-Chlorooctane 89.7 % 35-147

Surrogate: 1-Chlorooctadecane 108 % 28-171

Cardinal Laboratories

*=Accredited Analyte

PLEASE NOTE: Liability and Damages. Cardinal's liability and client's exclusive remedy for any claim arising, whether based in contract or tort, shall be limited to the amount paid by client for analyses. All claims, including those for negligence and any other cause whatsoever shall be deemed waived unless made in writing and received by Cardinal within thirty (30) days after completion of the applicable service. In no event shall Cardinal be liable for incidental or consequential damages, including, without limitation, business interruptions, loss of use, or loss of profits incurred by client, its subsidiaries, affiliates or successors arising out of or related to the performance of the services hereunder by Cardinal, regardless of whether such claim is based upon any of the above stated reasons or otherwise. Results relate only to the samples identified above. This report shall not be reproduced except in full with written approval of Cardinal Laboratories.



Celey D. Keene, Lab Director/Quality Manager

Analytical Results For:

Basin Environmental Service
KYLE NORMAN
P.O. Box 301
Lovington NM, 88260
Fax To: (575) 396-1429

Received:	03/29/2016	Sampling Date:	03/28/2016
Reported:	04/04/2016	Sampling Type:	Soil
Project Name:	SEMU PERMIAN #34 HISTORICAL	Sampling Condition:	Cool & Intact
Project Number:	NONE GIVEN	Sample Received By:	Jodi Henson
Project Location:	NONE GIVEN		

Sample ID: PT. 3 @ 4' (H600659-06)

BTX 8021B		mg/kg		Analyzed By: MS					
Analyte	Result	Reporting Limit	Analyzed	Method Blank	BS	% Recovery	True Value QC	RPD	Qualifier
Benzene*	<0.500	0.500	03/31/2016	ND	2.00	100	2.00	16.6	
Toluene*	1.06	0.500	03/31/2016	ND	1.91	95.6	2.00	17.2	
Ethylbenzene*	5.97	0.500	03/31/2016	ND	1.69	84.5	2.00	17.2	
Total Xylenes*	9.31	1.50	03/31/2016	ND	5.18	86.4	6.00	16.0	
Total BTX	16.3	3.00	03/31/2016	ND					

Surrogate: 4-Bromofluorobenzene (PID) 110 % 73.6-140

Chloride, SM4500CI-B		mg/kg		Analyzed By: AP						
Analyte	Result	Reporting Limit	Analyzed	Method Blank	BS	% Recovery	True Value QC	RPD	Qualifier	
Chloride	<16.0	16.0	03/30/2016	ND	400	100	400	7.69		

TPH 8015M	mg/kg		Analyzed By: MS					S-06	
Analyte	Result	Reporting Limit	Analyzed	Method Blank	BS	% Recovery	True Value QC	RPD	Qualifier
GRO C6-C10	691	200	03/30/2016	ND	173	86.7	200	2.18	
DRO >C10-C28	6770	200	03/30/2016	ND	157	78.7	200	2.90	

Surrogate: 1-Chlorooctane 117 % 35-147

Surrogate: 1-Chlorooctadecane 245 % 28-171

Cardinal Laboratories

*=Accredited Analyte

PLEASE NOTE: Liability and Damages. Cardinal's liability and client's exclusive remedy for any claim arising, whether based in contract or tort, shall be limited to the amount paid by client for analyses. All claims, including those for negligence and any other cause whatsoever shall be deemed waived unless made in writing and received by Cardinal within thirty (30) days after completion of the applicable service. In no event shall Cardinal be liable for incidental or consequential damages, including, without limitation, business interruptions, loss of use, or loss of profits incurred by client, its subsidiaries, affiliates or successors arising out of or related to the performance of the services hereunder by Cardinal, regardless of whether such claim is based upon any of the above stated reasons or otherwise. Results relate only to the samples identified above. This report shall not be reproduced except in full with written approval of Cardinal Laboratories.



Celey D. Keene, Lab Director/Quality Manager

Notes and Definitions

S-06	The recovery of this surrogate is outside control limits due to sample dilution required from high analyte concentration and/or matrix interference's.
QR-03	The RPD value for the sample duplicate or MS/MSD was outside if QC acceptance limits due to matrix interference. QC batch accepted based on LCS and/or LCSD recovery and/or RPD values.
QR-02	The RPD result exceeded the QC control limits; however, both percent recoveries were acceptable. Sample results for the QC batch were accepted based on percent recoveries and completeness of QC data.
ND	Analyte NOT DETECTED at or above the reporting limit
RPD	Relative Percent Difference
**	Samples not received at proper temperature of 6°C or below.
***	Insufficient time to reach temperature.
-	Chloride by SM4500Cl-B does not require samples be received at or below 6°C Samples reported on an as received basis (wet) unless otherwise noted on report



Celey D. Keene, Lab Director/Quality Manager



PHONE (575) 393-2326 ° 101 E. MARLAND ° HOBBS, NM 88240

April 04, 2016

KYLE NORMAN

Basin Environmental Service

P.O. Box 301

Lovington, NM 88260

RE: SEMU PERMIAN #34

Enclosed are the results of analyses for samples received by the laboratory on 03/29/16 14:05.

Cardinal Laboratories is accredited through Texas NELAP under certificate number T104704398-15-7. Accreditation applies to drinking water, non-potable water and solid and chemical materials. All accredited analytes are denoted by an asterisk (*). For a complete list of accredited analytes and matrices visit the TCEQ website at www.tceq.texas.gov/field/qa/lab_accred_certif.html.

Cardinal Laboratories is accredited through the State of Colorado Department of Public Health and Environment for:

Method EPA 552.2	Haloacetic Acids (HAA-5)
Method EPA 524.2	Total Trihalomethanes (TTHM)
Method EPA 524.4	Regulated VOCs (V1, V2, V3)

Accreditation applies to public drinking water matrices.

This report meets NELAP requirements and is made up of a cover page, analytical results, and a copy of the original chain-of-custody. If you have any questions concerning this report, please feel free to contact me.

Sincerely,

A handwritten signature in black ink that reads "Celey D. Keene". The signature is written in a cursive, flowing style.

Celey D. Keene

Lab Director/Quality Manager

Analytical Results For:

 Basin Environmental Service
 KYLE NORMAN
 P.O. Box 301
 Lovington NM, 88260
 Fax To: (575) 396-1429

 Received: 03/29/2016
 Reported: 04/04/2016
 Project Name: SEMU PERMIAN #34
 Project Number: NONE GIVEN
 Project Location: NOT GIVEN

 Sampling Date: 03/23/2016
 Sampling Type: Soil
 Sampling Condition: Cool & Intact
 Sample Received By: Jodi Henson

Sample ID: PT. 1 @ 4' (H600660-01)

BTX 8021B		mg/kg		Analyzed By: MS					
Analyte	Result	Reporting Limit	Analyzed	Method Blank	BS	% Recovery	True Value QC	RPD	Qualifier
Benzene*	<0.050	0.050	03/31/2016	ND	2.00	100	2.00	16.6	
Toluene*	<0.050	0.050	03/31/2016	ND	1.91	95.6	2.00	17.2	
Ethylbenzene*	<0.050	0.050	03/31/2016	ND	1.69	84.5	2.00	17.2	
Total Xylenes*	<0.150	0.150	03/31/2016	ND	5.18	86.4	6.00	16.0	
Total BTX	<0.300	0.300	03/31/2016	ND					

Surrogate: 4-Bromofluorobenzene (PID) 99.0 % 73.6-140

Chloride, SM4500Cl-B		mg/kg		Analyzed By: AP						
Analyte	Result	Reporting Limit	Analyzed	Method Blank	BS	% Recovery	True Value QC	RPD	Qualifier	
Chloride	48.0	16.0	03/30/2016	ND	400	100	400	7.69		

TPH 8015M		mg/kg		Analyzed By: MS					
Analyte	Result	Reporting Limit	Analyzed	Method Blank	BS	% Recovery	True Value QC	RPD	Qualifier
GRO C6-C10	<10.0	10.0	03/30/2016	ND	173	86.7	200	2.18	
DRO >C10-C28	<10.0	10.0	03/30/2016	ND	157	78.7	200	2.90	

Surrogate: 1-Chlorooctane 86.5 % 35-147

Surrogate: 1-Chlorooctadecane 95.5 % 28-171

Cardinal Laboratories

*=Accredited Analyte

PLEASE NOTE: Liability and Damages. Cardinal's liability and client's exclusive remedy for any claim arising, whether based in contract or tort, shall be limited to the amount paid by client for analyses. All claims, including those for negligence and any other cause whatsoever shall be deemed waived unless made in writing and received by Cardinal within thirty (30) days after completion of the applicable service. In no event shall Cardinal be liable for incidental or consequential damages, including, without limitation, business interruptions, loss of use, or loss of profits incurred by client, its subsidiaries, affiliates or successors arising out of or related to the performance of the services hereunder by Cardinal, regardless of whether such claim is based upon any of the above stated reasons or otherwise. Results relate only to the samples identified above. This report shall not be reproduced except in full with written approval of Cardinal Laboratories.



Celey D. Keene, Lab Director/Quality Manager

Analytical Results For:

 Basin Environmental Service
 KYLE NORMAN
 P.O. Box 301
 Lovington NM, 88260
 Fax To: (575) 396-1429

 Received: 03/29/2016
 Reported: 04/04/2016
 Project Name: SEMU PERMIAN #34
 Project Number: NONE GIVEN
 Project Location: NOT GIVEN

 Sampling Date: 03/23/2016
 Sampling Type: Soil
 Sampling Condition: Cool & Intact
 Sample Received By: Jodi Henson

Sample ID: PT. 1 @ 6' (H600660-02)

BTX 8021B		mg/kg		Analyzed By: MS					
Analyte	Result	Reporting Limit	Analyzed	Method Blank	BS	% Recovery	True Value QC	RPD	Qualifier
Benzene*	<0.200	0.200	03/31/2016	ND	2.00	100	2.00	16.6	
Toluene*	0.305	0.200	03/31/2016	ND	1.91	95.6	2.00	17.2	
Ethylbenzene*	1.86	0.200	03/31/2016	ND	1.69	84.5	2.00	17.2	
Total Xylenes*	5.91	0.600	03/31/2016	ND	5.18	86.4	6.00	16.0	
Total BTX	8.08	1.20	03/31/2016	ND					

Surrogate: 4-Bromofluorobenzene (PID) 126 % 73.6-140

Chloride, SM4500CI-B		mg/kg		Analyzed By: AP					
Analyte	Result	Reporting Limit	Analyzed	Method Blank	BS	% Recovery	True Value QC	RPD	Qualifier
Chloride	<16.0	16.0	03/30/2016	ND	400	100	400	7.69	

TPH 8015M		mg/kg		Analyzed By: MS					
Analyte	Result	Reporting Limit	Analyzed	Method Blank	BS	% Recovery	True Value QC	RPD	Qualifier
GRO C6-C10	353	100	03/30/2016	ND	173	86.7	200	2.18	
DRO >C10-C28	2850	100	03/30/2016	ND	157	78.7	200	2.90	

Surrogate: 1-Chlorooctane 116 % 35-147

Surrogate: 1-Chlorooctadecane 117 % 28-171

Cardinal Laboratories

*=Accredited Analyte

PLEASE NOTE: Liability and Damages. Cardinal's liability and client's exclusive remedy for any claim arising, whether based in contract or tort, shall be limited to the amount paid by client for analyses. All claims, including those for negligence and any other cause whatsoever shall be deemed waived unless made in writing and received by Cardinal within thirty (30) days after completion of the applicable service. In no event shall Cardinal be liable for incidental or consequential damages, including, without limitation, business interruptions, loss of use, or loss of profits incurred by client, its subsidiaries, affiliates or successors arising out of or related to the performance of the services hereunder by Cardinal, regardless of whether such claim is based upon any of the above stated reasons or otherwise. Results relate only to the samples identified above. This report shall not be reproduced except in full with written approval of Cardinal Laboratories.



Celey D. Keene, Lab Director/Quality Manager

Analytical Results For:

Basin Environmental Service
KYLE NORMAN
P.O. Box 301
Lovington NM, 88260
Fax To: (575) 396-1429

Received: 03/29/2016
Reported: 04/04/2016
Project Name: SEMU PERMIAN #34
Project Number: NONE GIVEN
Project Location: NOT GIVEN

Sampling Date: 03/23/2016
Sampling Type: Soil
Sampling Condition: Cool & Intact
Sample Received By: Jodi Henson

Sample ID: PT. 2 @ 3' (H600660-03)

BTX 8021B		mg/kg		Analyzed By: MS					
Analyte	Result	Reporting Limit	Analyzed	Method Blank	BS	% Recovery	True Value QC	RPD	Qualifier
Benzene*	<0.050	0.050	03/31/2016	ND	2.00	100	2.00	16.6	
Toluene*	<0.050	0.050	03/31/2016	ND	1.91	95.6	2.00	17.2	
Ethylbenzene*	<0.050	0.050	03/31/2016	ND	1.69	84.5	2.00	17.2	
Total Xylenes*	<0.150	0.150	03/31/2016	ND	5.18	86.4	6.00	16.0	
Total BTX	<0.300	0.300	03/31/2016	ND					

Surrogate: 4-Bromofluorobenzene (PID) 102 % 73.6-140

Chloride, SM4500Cl-B		mg/kg		Analyzed By: AP					
Analyte	Result	Reporting Limit	Analyzed	Method Blank	BS	% Recovery	True Value QC	RPD	Qualifier
Chloride	48.0	16.0	03/30/2016	ND	400	100	400	7.69	

TPH 8015M		mg/kg		Analyzed By: MS					
Analyte	Result	Reporting Limit	Analyzed	Method Blank	BS	% Recovery	True Value QC	RPD	Qualifier
GRO C6-C10	<10.0	10.0	03/30/2016	ND	173	86.7	200	2.18	
DRO >C10-C28	<10.0	10.0	03/30/2016	ND	157	78.7	200	2.90	

Surrogate: 1-Chlorooctane 81.4 % 35-147

Surrogate: 1-Chlorooctadecane 92.2 % 28-171

Cardinal Laboratories

*=Accredited Analyte

PLEASE NOTE: Liability and Damages. Cardinal's liability and client's exclusive remedy for any claim arising, whether based in contract or tort, shall be limited to the amount paid by client for analyses. All claims, including those for negligence and any other cause whatsoever shall be deemed waived unless made in writing and received by Cardinal within thirty (30) days after completion of the applicable service. In no event shall Cardinal be liable for incidental or consequential damages, including, without limitation, business interruptions, loss of use, or loss of profits incurred by client, its subsidiaries, affiliates or successors arising out of or related to the performance of the services hereunder by Cardinal, regardless of whether such claim is based upon any of the above stated reasons or otherwise. Results relate only to the samples identified above. This report shall not be reproduced except in full with written approval of Cardinal Laboratories.



Celey D. Keene, Lab Director/Quality Manager

Analytical Results For:

Basin Environmental Service
KYLE NORMAN
P.O. Box 301
Lovington NM, 88260
Fax To: (575) 396-1429

Received: 03/29/2016
Reported: 04/04/2016
Project Name: SEMU PERMIAN #34
Project Number: NONE GIVEN
Project Location: NOT GIVEN

Sampling Date: 03/28/2016
Sampling Type: Soil
Sampling Condition: Cool & Intact
Sample Received By: Jodi Henson

Sample ID: PT. 3 @ 5' (H600660-04)

BTX 8021B		mg/kg		Analyzed By: MS					
Analyte	Result	Reporting Limit	Analyzed	Method Blank	BS	% Recovery	True Value QC	RPD	Qualifier
Benzene*	<0.050	0.050	03/31/2016	ND	2.00	100	2.00	16.6	
Toluene*	<0.050	0.050	03/31/2016	ND	1.91	95.6	2.00	17.2	
Ethylbenzene*	<0.050	0.050	03/31/2016	ND	1.69	84.5	2.00	17.2	
Total Xylenes*	<0.150	0.150	03/31/2016	ND	5.18	86.4	6.00	16.0	
Total BTX	<0.300	0.300	03/31/2016	ND					

Surrogate: 4-Bromofluorobenzene (PID) 102 % 73.6-140

Chloride, SM4500CI-B		mg/kg		Analyzed By: AP					
Analyte	Result	Reporting Limit	Analyzed	Method Blank	BS	% Recovery	True Value QC	RPD	Qualifier
Chloride	576	16.0	03/30/2016	ND	400	100	400	7.69	

TPH 8015M		mg/kg		Analyzed By: MS					
Analyte	Result	Reporting Limit	Analyzed	Method Blank	BS	% Recovery	True Value QC	RPD	Qualifier
GRO C6-C10	<10.0	10.0	03/30/2016	ND	173	86.7	200	2.18	
DRO >C10-C28	<10.0	10.0	03/30/2016	ND	157	78.7	200	2.90	

Surrogate: 1-Chlorooctane 86.3 % 35-147

Surrogate: 1-Chlorooctadecane 98.1 % 28-171

Cardinal Laboratories

*=Accredited Analyte

PLEASE NOTE: Liability and Damages. Cardinal's liability and client's exclusive remedy for any claim arising, whether based in contract or tort, shall be limited to the amount paid by client for analyses. All claims, including those for negligence and any other cause whatsoever shall be deemed waived unless made in writing and received by Cardinal within thirty (30) days after completion of the applicable service. In no event shall Cardinal be liable for incidental or consequential damages, including, without limitation, business interruptions, loss of use, or loss of profits incurred by client, its subsidiaries, affiliates or successors arising out of or related to the performance of the services hereunder by Cardinal, regardless of whether such claim is based upon any of the above stated reasons or otherwise. Results relate only to the samples identified above. This report shall not be reproduced except in full with written approval of Cardinal Laboratories.



Celey D. Keene, Lab Director/Quality Manager

Analytical Results For:

Basin Environmental Service
KYLE NORMAN
P.O. Box 301
Lovington NM, 88260
Fax To: (575) 396-1429

Received: 03/29/2016
Reported: 04/04/2016
Project Name: SEMU PERMIAN #34
Project Number: NONE GIVEN
Project Location: NOT GIVEN

Sampling Date: 03/28/2016
Sampling Type: Soil
Sampling Condition: Cool & Intact
Sample Received By: Jodi Henson

Sample ID: PT. 3 @ 8' (H600660-05)

BTX 8021B		mg/kg		Analyzed By: MS					
Analyte	Result	Reporting Limit	Analyzed	Method Blank	BS	% Recovery	True Value QC	RPD	Qualifier
Benzene*	<0.050	0.050	03/31/2016	ND	2.00	100	2.00	16.6	
Toluene*	<0.050	0.050	03/31/2016	ND	1.91	95.6	2.00	17.2	
Ethylbenzene*	<0.050	0.050	03/31/2016	ND	1.69	84.5	2.00	17.2	
Total Xylenes*	<0.150	0.150	03/31/2016	ND	5.18	86.4	6.00	16.0	
Total BTX	<0.300	0.300	03/31/2016	ND					

Surrogate: 4-Bromofluorobenzene (PID) 101 % 73.6-140

Chloride, SM4500CI-B		mg/kg		Analyzed By: AP					
Analyte	Result	Reporting Limit	Analyzed	Method Blank	BS	% Recovery	True Value QC	RPD	Qualifier
Chloride	128	16.0	03/30/2016	ND	400	100	400	7.69	

TPH 8015M		mg/kg		Analyzed By: MS					
Analyte	Result	Reporting Limit	Analyzed	Method Blank	BS	% Recovery	True Value QC	RPD	Qualifier
GRO C6-C10	<10.0	10.0	03/30/2016	ND	173	86.7	200	2.18	
DRO >C10-C28	<10.0	10.0	03/30/2016	ND	157	78.7	200	2.90	

Surrogate: 1-Chlorooctane 86.0 % 35-147

Surrogate: 1-Chlorooctadecane 93.1 % 28-171

Cardinal Laboratories

*=Accredited Analyte

PLEASE NOTE: Liability and Damages. Cardinal's liability and client's exclusive remedy for any claim arising, whether based in contract or tort, shall be limited to the amount paid by client for analyses. All claims, including those for negligence and any other cause whatsoever shall be deemed waived unless made in writing and received by Cardinal within thirty (30) days after completion of the applicable service. In no event shall Cardinal be liable for incidental or consequential damages, including, without limitation, business interruptions, loss of use, or loss of profits incurred by client, its subsidiaries, affiliates or successors arising out of or related to the performance of the services hereunder by Cardinal, regardless of whether such claim is based upon any of the above stated reasons or otherwise. Results relate only to the samples identified above. This report shall not be reproduced except in full with written approval of Cardinal Laboratories.



Celey D. Keene, Lab Director/Quality Manager

Analytical Results For:

Basin Environmental Service
KYLE NORMAN
P.O. Box 301
Lovington NM, 88260
Fax To: (575) 396-1429

Received: 03/29/2016
Reported: 04/04/2016
Project Name: SEMU PERMIAN #34
Project Number: NONE GIVEN
Project Location: NOT GIVEN

Sampling Date: 03/28/2016
Sampling Type: Soil
Sampling Condition: Cool & Intact
Sample Received By: Jodi Henson

Sample ID: PT. 4 @ 5' (H600660-06)

BTX 8021B		mg/kg		Analyzed By: MS					
Analyte	Result	Reporting Limit	Analyzed	Method Blank	BS	% Recovery	True Value QC	RPD	Qualifier
Benzene*	<0.050	0.050	03/31/2016	ND	2.00	100	2.00	16.6	
Toluene*	<0.050	0.050	03/31/2016	ND	1.91	95.6	2.00	17.2	
Ethylbenzene*	<0.050	0.050	03/31/2016	ND	1.69	84.5	2.00	17.2	
Total Xylenes*	<0.150	0.150	03/31/2016	ND	5.18	86.4	6.00	16.0	
Total BTX	<0.300	0.300	03/31/2016	ND					

Surrogate: 4-Bromofluorobenzene (PID) 102 % 73.6-140

Chloride, SM4500CI-B		mg/kg		Analyzed By: AP					
Analyte	Result	Reporting Limit	Analyzed	Method Blank	BS	% Recovery	True Value QC	RPD	Qualifier
Chloride	208	16.0	03/30/2016	ND	400	100	400	7.69	

TPH 8015M		mg/kg		Analyzed By: MS					
Analyte	Result	Reporting Limit	Analyzed	Method Blank	BS	% Recovery	True Value QC	RPD	Qualifier
GRO C6-C10	<10.0	10.0	03/31/2016	ND	191	95.4	200	6.17	QR-03
DRO >C10-C28	<10.0	10.0	03/31/2016	ND	173	86.7	200	7.67	QR-03

Surrogate: 1-Chlorooctane 91.3 % 35-147

Surrogate: 1-Chlorooctadecane 110 % 28-171

Cardinal Laboratories

*=Accredited Analyte

PLEASE NOTE: Liability and Damages. Cardinal's liability and client's exclusive remedy for any claim arising, whether based in contract or tort, shall be limited to the amount paid by client for analyses. All claims, including those for negligence and any other cause whatsoever shall be deemed waived unless made in writing and received by Cardinal within thirty (30) days after completion of the applicable service. In no event shall Cardinal be liable for incidental or consequential damages, including, without limitation, business interruptions, loss of use, or loss of profits incurred by client, its subsidiaries, affiliates or successors arising out of or related to the performance of the services hereunder by Cardinal, regardless of whether such claim is based upon any of the above stated reasons or otherwise. Results relate only to the samples identified above. This report shall not be reproduced except in full with written approval of Cardinal Laboratories.



Celey D. Keene, Lab Director/Quality Manager

Notes and Definitions

QR-03	The RPD value for the sample duplicate or MS/MSD was outside of QC acceptance limits due to matrix interference. QC batch accepted based on LCS and/or LCSD recovery and/or RPD values.
QR-02	The RPD result exceeded the QC control limits; however, both percent recoveries were acceptable. Sample results for the QC batch were accepted based on percent recoveries and completeness of QC data.
ND	Analyte NOT DETECTED at or above the reporting limit
RPD	Relative Percent Difference
**	Samples not received at proper temperature of 6°C or below.
***	Insufficient time to reach temperature.
-	Chloride by SM4500Cl-B does not require samples be received at or below 6°C Samples reported on an as received basis (wet) unless otherwise noted on report

Cardinal Laboratories

*=Accredited Analyte

PLEASE NOTE: Liability and Damages. Cardinal's liability and client's exclusive remedy for any claim arising, whether based in contract or tort, shall be limited to the amount paid by client for analyses. All claims, including those for negligence and any other cause whatsoever shall be deemed waived unless made in writing and received by Cardinal within thirty (30) days after completion of the applicable service. In no event shall Cardinal be liable for incidental or consequential damages, including, without limitation, business interruptions, loss of use, or loss of profits incurred by client, its subsidiaries, affiliates or successors arising out of or related to the performance of the services hereunder by Cardinal, regardless of whether such claim is based upon any of the above stated reasons or otherwise. Results relate only to the samples identified above. This report shall not be reproduced except in full with written approval of Cardinal Laboratories.



Celey D. Keene, Lab Director/Quality Manager



PHONE (575) 393-2326 ° 101 E. MARLAND ° HOBBS, NM 88240

April 08, 2016

KYLE NORMAN

Basin Environmental Service

P.O. Box 301

Lovington, NM 88260

RE: SEMU PERMIAN #34

Enclosed are the results of analyses for samples received by the laboratory on 04/06/16 9:30.

Cardinal Laboratories is accredited through Texas NELAP under certificate number T104704398-15-7. Accreditation applies to drinking water, non-potable water and solid and chemical materials. All accredited analytes are denoted by an asterisk (*). For a complete list of accredited analytes and matrices visit the TCEQ website at www.tceq.texas.gov/field/qa/lab_accred_certif.html.

Cardinal Laboratories is accredited through the State of Colorado Department of Public Health and Environment for:

Method EPA 552.2	Haloacetic Acids (HAA-5)
Method EPA 524.2	Total Trihalomethanes (TTHM)
Method EPA 524.4	Regulated VOCs (V1, V2, V3)

Accreditation applies to public drinking water matrices.

This report meets NELAP requirements and is made up of a cover page, analytical results, and a copy of the original chain-of-custody. If you have any questions concerning this report, please feel free to contact me.

Sincerely,

A handwritten signature in black ink that reads "Celey D. Keene". The signature is written in a cursive, flowing style.

Celey D. Keene

Lab Director/Quality Manager

Analytical Results For:

Basin Environmental Service
KYLE NORMAN
P.O. Box 301
Lovington NM, 88260
Fax To: (575) 396-1429

Received: 04/06/2016
Reported: 04/08/2016
Project Name: SEMU PERMIAN #34
Project Number: NONE GIVEN
Project Location: NOT GIVEN

Sampling Date: 03/28/2016
Sampling Type: Soil
Sampling Condition: Cool & Intact
Sample Received By: Jodi Henson

Sample ID: PT. 1 @ 10' (H600728-01)

BTX 8021B		mg/kg		Analyzed By: MS					
Analyte	Result	Reporting Limit	Analyzed	Method Blank	BS	% Recovery	True Value QC	RPD	Qualifier
Benzene*	<0.500	0.500	04/07/2016	ND	1.98	98.8	2.00	2.71	
Toluene*	1.69	0.500	04/07/2016	ND	1.88	94.0	2.00	3.17	
Ethylbenzene*	1.94	0.500	04/07/2016	ND	1.67	83.4	2.00	4.10	
Total Xylenes*	4.96	1.50	04/07/2016	ND	5.17	86.1	6.00	4.65	
Total BTX	8.58	3.00	04/07/2016	ND					

Surrogate: 4-Bromofluorobenzene (PID) 109 % 73.6-140

Chloride, SM4500Cl-B		mg/kg		Analyzed By: AP					
Analyte	Result	Reporting Limit	Analyzed	Method Blank	BS	% Recovery	True Value QC	RPD	Qualifier
Chloride	112	16.0	04/07/2016	ND	416	104	400	0.00	

TPH 8015M		mg/kg		Analyzed By: MS					
Analyte	Result	Reporting Limit	Analyzed	Method Blank	BS	% Recovery	True Value QC	RPD	Qualifier
GRO C6-C10	290	200	04/07/2016	ND	178	89.0	200	1.81	
DRO >C10-C28	4970	200	04/07/2016	ND	170	85.0	200	4.37	

Surrogate: 1-Chlorooctane 85.6 % 35-147

Surrogate: 1-Chlorooctadecane 156 % 28-171

Cardinal Laboratories

*=Accredited Analyte

PLEASE NOTE: Liability and Damages. Cardinal's liability and client's exclusive remedy for any claim arising, whether based in contract or tort, shall be limited to the amount paid by client for analyses. All claims, including those for negligence and any other cause whatsoever shall be deemed waived unless made in writing and received by Cardinal within thirty (30) days after completion of the applicable service. In no event shall Cardinal be liable for incidental or consequential damages, including, without limitation, business interruptions, loss of use, or loss of profits incurred by client, its subsidiaries, affiliates or successors arising out of or related to the performance of the services hereunder by Cardinal, regardless of whether such claim is based upon any of the above stated reasons or otherwise. Results relate only to the samples identified above. This report shall not be reproduced except in full with written approval of Cardinal Laboratories.



Celey D. Keene, Lab Director/Quality Manager

Notes and Definitions

QM-07	The spike recovery was outside acceptance limits for the MS and/or MSD. The batch was accepted based on acceptable LCS recovery.
ND	Analyte NOT DETECTED at or above the reporting limit
RPD	Relative Percent Difference
**	Samples not received at proper temperature of 6°C or below.
***	Insufficient time to reach temperature.
-	Chloride by SM4500Cl-B does not require samples be received at or below 6°C Samples reported on an as received basis (wet) unless otherwise noted on report

Cardinal Laboratories

*=Accredited Analyte

PLEASE NOTE: Liability and Damages. Cardinal's liability and client's exclusive remedy for any claim arising, whether based in contract or tort, shall be limited to the amount paid by client for analyses. All claims, including those for negligence and any other cause whatsoever shall be deemed waived unless made in writing and received by Cardinal within thirty (30) days after completion of the applicable service. In no event shall Cardinal be liable for incidental or consequential damages, including, without limitation, business interruptions, loss of use, or loss of profits incurred by client, its subsidiaries, affiliates or successors arising out of or related to the performance of the services hereunder by Cardinal, regardless of whether such claim is based upon any of the above stated reasons or otherwise. Results relate only to the samples identified above. This report shall not be reproduced except in full with written approval of Cardinal Laboratories.



Celey D. Keene, Lab Director/Quality Manager



ARDINAL LABORATORIES

101 East Marland, Hobbs, NM 88240 2111 Beechwood, Abilene, TX 79603
(505) 393-2326 FAX (505) 393-2476 (325) 673-7001 FAX (325) 673-7020

CHAIN-OF-CUSTODY AND ANALYSIS REQUEST

Company Name: Conoco Phillips

Project Manager: Kyle Norman

Address:

City:

State:

Zip:

Phone #:

Fax #:

Project #:

Project Owner:

Project Name:

Project Location: SEMU Permian #34

Sampler Name: Kyle Norman

FOR LAB USE ONLY

BILL TO

P.O. #:

Company: Basin Environmental

Attn:

Address: 419 W. Cain

City: Hobbs

State: NM Zip: 88240

Phone #:

Fax #:

ANALYSIS REQUEST

Lab I.D.

Sample I.D.

H6EDT28

Pt. 1 @ 10'

(G)RAB OR (C)OMP.

CONTAINERS

GROUNDWATER

WASTEWATER

SOIL

OIL

SLUDGE

OTHER :

ACID/BASE:

ICE / COOL

OTHER :

DATE

TIME

Chlorides

TPH 8015 M

BTEX

Texas TPH

Complete Cations/Anions

TDS

PLEASE NOTE: Liability and Damages. Cardinal's liability and client's exclusive remedy for any claim arising whether based in contract or tort, shall be limited to the amount paid by the client for the analyses. All claims including those for negligence and any other cause whatsoever shall be deemed waived unless made in writing and received by Cardinal within 30 days after completion of the applicable service. In no event shall Cardinal be liable for incidental or consequential damages, including without limitation, business interruptions, loss of use, or loss of profits incurred by client, its subsidiaries, affiliates or successors arising out of or related to the performance of services hereunder by Cardinal, regardless of whether such claim is based upon any of the above stated reasons or otherwise.

Relinquished By:

Date: 4-6-15

Received By:

Kyle Norman

Date: 4-30-15

Received By:

Relinquished By:

Date:

Received By:

Delivered By: (Circle One)

2.2c

Sample Condition
Cool ☒ Intact ☒
Yes ☒ No ☐

CHECKED BY:

(Initials)

4/30

Phone Result: ☐ Yes ☒ No Add'l Phone #:
Fax Result: ☐ Yes ☒ No Add'l Fax #:

REMARKS:

email results: knorman@basinenv.com;
jkamplain@basinenv.com; tgrieco@basinenv.com

† Cardinal cannot accept verbal changes. Please fax written changes to 505-393-2476

#54

Initial Sampling

Vertical 1									
Depth	Cl-	PID	GRO	DRO	B	T	E	X	Total
SS	61	0							
2'	<16	2.2	<10	64.9	<0.05	<0.05	<0.05	<0.15	<0.3
4'	<16	0.2	<10	516	<0.05	<0.05	<0.05	<0.15	<0.3

Vertical 2									
Depth	Cl-	PID	GRO	DRO	B	T	E	X	Total
SS	83	0							
2'	<16	0	<100	<100	<0.05	<0.05	<0.05	<0.15	<0.3
4'	<16	0.1	<10	<10	<0.05	<0.05	<0.05	<0.15	<0.3



Vertical 3									
Depth	Cl-	PID	GRO	DRO	B	T	E	X	Total
SS	56	0							
2'	<16	0	<10	395	<0.05	<0.05	0.082	<0.15	<0.3
4'	<16	312	691	6770	<0.5	1.06	5.97	9.31	16.3

Landowner: BLM
DGW: 53 ft

Legend	
	SAMPLE POINT
	ASPHALTINE 23,368 SQ FT
	STAIN - 1,500 SQ FT



CONOCOPHILLIPS
SEMU PERMIAN
HISTORICAL
1RP-4218

UL K SECTION 19
T-20-S R-38-E
LEA COUNTY, NM

**Underground facilities are
spatially projected
and need to be field verified.**

GPS: 32.557904 -103.189613

0 30 60
Feet

GPS date: 3/28/16 KN
Drawing date: 3/28/16
Drafted by: T. Grieco



Initial Sampling

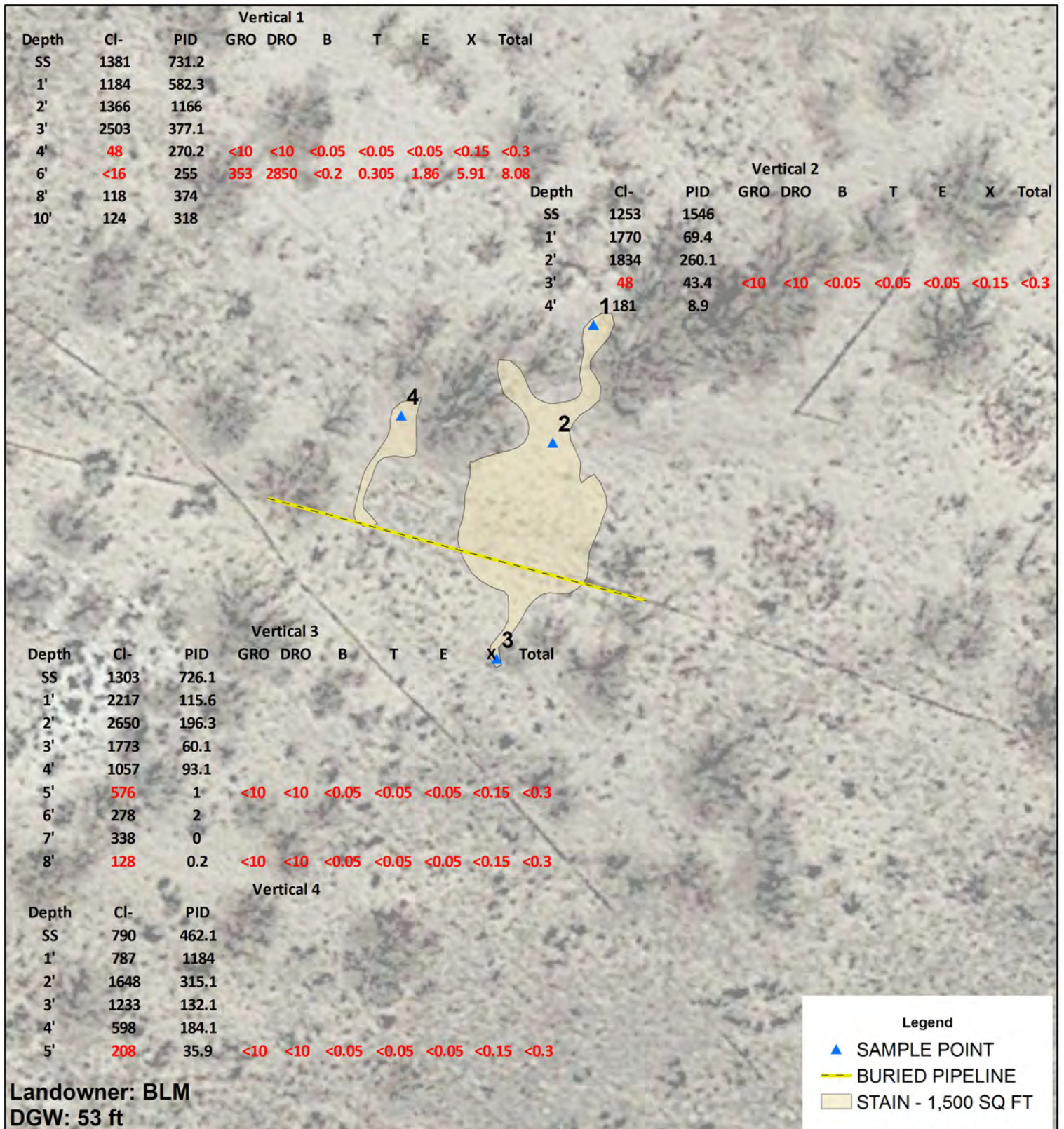

CONOCOPHILLIPS
SEMU PERMIAN
#034
1RP-4218

UL K SECTION 19
T-20-S R-38-E
LEA COUNTY, NM

Underground facilities are spatially projected and need to be field verified.

GPS: 32.557582 -103.189651

0 25 50 Feet

GPS date: 3/23/16 JK
Drawing date: 3/24/16
Drafted by: T. Grieco

