

District I
1625 N. French Dr., Hobbs, NM 88240
Phone: (575) 393-6161 Fax: (575) 393-0720
District II
811 S. First St., Artesia, NM 88210
Phone: (575) 748-1283 Fax: (575) 748-9720
District III
1000 Rio Brazos Road, Aztec, NM 87410
Phone: (505) 334-6178 Fax: (505) 334-6170
District IV
1220 S. St. Francis Dr., Santa Fe, NM 87505
Phone: (505) 476-3460 Fax: (505) 476-3462

State of New Mexico
Energy, Minerals & Natural Resources Department
OIL CONSERVATION DIVISION
1220 South St. Francis Dr.
Santa Fe, NM 87505

Form C-102
Revised August 1, 2011
Submit one copy to appropriate
District Office

☒ AMENDED REPORT
As Drilled

WELL LOCATION AND ACREAGE DEDICATION PLAT

¹ API Number 30-025-46423		² Pool Code 96660		³ Pool Name Berry; Bone Spring, South	
⁴ Property Code 322718		⁵ Property Name LYCHEE STATE COM			⁶ Well Number 503H
⁷ OGRID NO. 229137		⁸ Operator Name COG OPERATING, LLC			⁹ Elevation 3713'

¹⁰ Surface Location

UL or lot no.	Section	Township	Range	Lot Idn	Feet from the	North/South line	Feet From the	East/West line	County
N	22	21S	34E		410	SOUTH	1580	WEST	LEA

¹¹ Bottom Hole Location If Different From Surface

UL or lot no.	Section	Township	Range	Lot Idn	Feet from the	North/South line	Feet from the	East/West line	County
C	15	21S	34E		72	NORTH	1972	WEST	LEA

¹² Dedicated Acres 320	¹³ Joint or Infill	¹⁴ Consolidation Code	¹⁵ Order No.
			SL

No allowable will be assigned to this completion until all interest have been consolidated or a non-standard unit has been approved by the division.

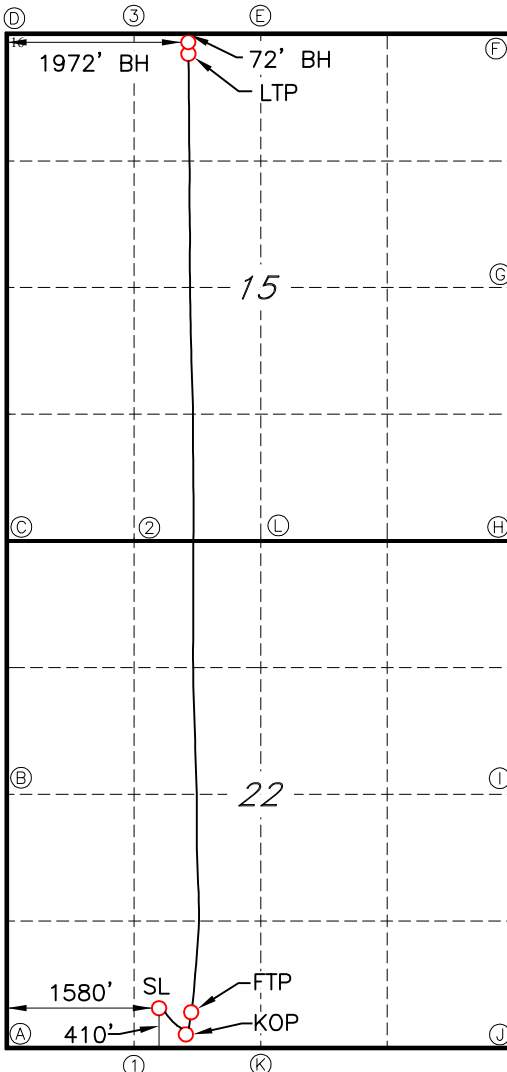

GEODETIC DATA
NAD 83 GRID - NM EAST

SURFACE LOCATION (SL)
N: 531563.4 - E: 810340.9
LAT: 32.4583113° N
LONG: 103.4611952° W
LAT: 32°27'29.9204" N
LONG: 103°27'40.3028" W

KICK OFF POINT (KOP)
134'-FSL/1857'-FWL (SEC.22)
N: 531290.5 - E: 810620.7
LAT: 32.4575550° N
LONG: 103.4602956° W
LAT: 32°27'27.1979" N
LONG: 103°27'37.0641" W
MD=10,021.00/TVD=9997.68

FIRST TAKE POINT (FTP)
408'-FSL/1921'-FWL (SEC.22)
N: 531565.1 - E: 810681.8
LAT: 32.4583081° N
LONG: 103.4600900° W
LAT: 32°27'29.9092" N
LONG: 103°27'36.3239" W
MD=10,717.00/TVD=10,563.38

LAST TAKE POINT (LTP)
253'-FNL/1972'-FWL (SEC.15)
N: 541462.5 - E: 810647.8
LAT: 32.4855119° N
LONG: 103.4599377° W
LAT: 32°29'07.8428" N
LONG: 103°27'35.7758" W
MD=20,644.00/TVD=10,665.50

BOTTOM HOLE
N: 541643.9 - E: 810645.9
LAT: 32.4860103° N
LONG: 103.4599390° W
LAT: 32°29'09.6371" N
LONG: 103°27'35.7805" W
MD=20,826.00/TVD=10,651.24

CORNER DATA
NAD 83 GRID - NM EAST

A: FOUND 100D NAIL
N: 531137.0 - E: 808764.8

B: FOUND BRASS CAP "1913"
N: 533770.0 - E: 808742.2

C: FOUND BRASS CAP "1913"
N: 536410.0 - E: 808719.0

D: FOUND BRASS CAP "1913"
N: 541690.6 - E: 808674.0

E: FOUND BRASS CAP "1913"
N: 541723.9 - E: 811313.9

F: FOUND BRASS CAP "1913"
N: 541760.5 - E: 813954.0

G: FOUND BRASS CAP "1913"
N: 539115.7 - E: 813976.4

H: FOUND BRASS CAP "1913"
N: 536472.7 - E: 814000.1

I: FOUND BRASS CAP "1913"
N: 533832.2 - E: 814022.3

J: FOUND BRASS CAP "1913"
N: 531191.3 - E: 814045.0

K: FOUND BRASS CAP "1913"
N: 531164.5 - E: 811401.4

L: FOUND BRASS CAP "1913"
N: 536439.9 - E: 811359.9

CALCULATED POINTS

1: N: 531150.8 - E: 810083.1
2: N: 536425.0 - E: 810039.4
3: N: 541707.2 - E: 809994.0

¹⁷ OPERATOR CERTIFICATION

I hereby certify that the information contained herein is true and complete to the best of my knowledge and belief, and that this organization either owns a working interest or unleased mineral interest in the land including the proposed bottom hole location or has a right to drill this well at this location pursuant to a contract with an owner of such a mineral or working interest, or to a voluntary pooling agreement or a compulsory pooling order heretofore entered by the division.

3/11/20

Signature

Date

Amanda Avery

Printed Name

aavery@concho.com

E-mail Address

¹⁸ SURVEYOR CERTIFICATION

I hereby certify that the well location shown on this plat was plotted from field notes of actual surveys made by me or under my supervision, and that the same is true and correct to the best of my belief.

09-09-2019

Date of Survey

Signature and Seal of Professional Surveyor

19680

Certificate Number

REV:3-9-2020 AS DRILL

Job No.: LS19090864AD

Intent ☐ As Drilled ☐

API # 30-025-46423								
Operator Name: COG Operating LLC			Property Name: Lychee State Com			Well Number 503H		

Kick Off Point (KOP)

UL N	Section 22	Township 21S	Range 34E	Lot	Feet 134	From N/S South	Feet 1857	From E/W West	County Lea
Latitude 32.4575550					Longitude 103.4602956				NAD 83

First Take Point (FTP)

UL N	Section 22	Township 21S	Range 34E	Lot	Feet 408	From N/S South	Feet 1921	From E/W West	County Lea
Latitude 32.4583081					Longitude 103.4600900				NAD 83

Last Take Point (LTP)

UL C	Section 15	Township 21S	Range 34E	Lot	Feet 253	From N/S North	Feet 1972	From E/W West	County Lea
Latitude 32.4855119					Longitude 103.4599377				NAD 83

Is this well the defining well for the Horizontal Spacing Unit? ☐ No

Is this well an infill well? ☐ Yes

If infill is yes please provide API if available, Operator Name and well number for Defining well for Horizontal Spacing Unit.

API # 30-025-45256								
Operator Name: COG Operating LLC			Property Name: Lychee State Com			Well Number 3H		

KZ 06/29/2018