

HOBBS OCD

DISTRICT I
1625 N. French Dr., Hobbs, NM 88240
Phone (575) 233-6161 Fax: (575) 233-0720

DISTRICT II
811 S. First St., Artesia, NM 88210
Phone (575) 746-1225 Fax: (575) 746-2720

DISTRICT III
1000 Rio Brazos Rd., Aledo, NM 87410
Phone (505) 834-6170 Fax: (505) 834-6720

DISTRICT IV
1850 S. St. Francis Dr., Santa Fe, NM 87505
Phone (505) 476-3450 Fax: (505) 476-3452

State of New Mexico
Energy, Minerals and Natural Resources Department

JAN 31 2013

Form C-102
Revised August 1, 2011

Submit one copy to appropriate District Office

OIL CONSERVATION DIVISION
1220 South St. Francis Dr.
Santa Fe, New Mexico 87505

RECEIVED

WELL LOCATION AND ACREAGE DEDICATION PLAT

AMENDED REPORT

API Number 30-025-40957	Pool Code 28432	Pool Name Grama Ridge; Bone Springs, West
Property Code 39674	Property Name WEST GRAMA RIDGE 8 STATE COM.	Well Number 1
OGRD No. 215099	Operator Name CIMAREX ENERGY CO.	Elevation 3520'

Surface Location

UL or lot No.	Section	Township	Range	Lot Idn	Feet from the	North/South line	Feet from the	East/West line	County
M	8	22 S	34 E		330	SOUTH	660	WEST	LEA

Bottom Hole Location If Different From Surface

UL or lot No.	Section	Township	Range	Lot Idn	Feet from the	North/South line	Feet from the	East/West line	County
D	8	22 S	34 E		330	NORTH	660	WEST	LEA

Dedicated Acres 160	Joint or Infill	Consolidation Code	Order No.
------------------------	-----------------	--------------------	-----------

NO ALLOWABLE WILL BE ASSIGNED TO THIS COMPLETION UNTIL ALL INTERESTS HAVE BEEN CONSOLIDATED OR A NON-STANDARD UNIT HAS BEEN APPROVED BY THE DIVISION

<p>PROPOSED BOTTOM HOLE LOCATION Lat - N 32°24'45.31" Long - W 103°29'54.41" NMSPC - N 514836.5 E 788980.9 (NAD-83)</p> <p>SURFACE LOCATION Lat - N 32°23'59.61" Long - W 103°29'54.51" NMSPC - N 510217.7 E 788008.4 (NAD-83)</p>	<p>OPERATOR CERTIFICATION I hereby certify that the information contained herein is true and complete to the best of my knowledge and belief, and that this organization either owns a working interest or unleased mineral interest in the land including the proposed bottom hole location or has a right to drill this well at this location pursuant to a contract with an owner of such a mineral or working interest, or to a voluntary pooling agreement or a compulsory pooling order heretofore entered by the division.</p> <p><i>Michelle Chappell</i> 1/30/13 Signature Date</p> <p>Michelle Chappell Printed Name</p> <p>mchappell@cimarex.com Email Address</p>
	<p>SURVEYOR CERTIFICATION I hereby certify that the well location shown on this plat was plotted from field notes of actual surveys made by me or under my supervision and that the same is true and correct to the best of my belief.</p> <p>FEBRUARY 2013 Date Surveyed</p> <p> Signature of Professional Surveyor</p> <p>Certificate No. Gary L. Jones 7977</p> <p>BASIN SURVEYS 26187</p>

FEB 04 2013

HOBBS OCD

JAN 31 2013

SR & A

9-5/8" **RECEIVED** Flowline

2" Fill Line

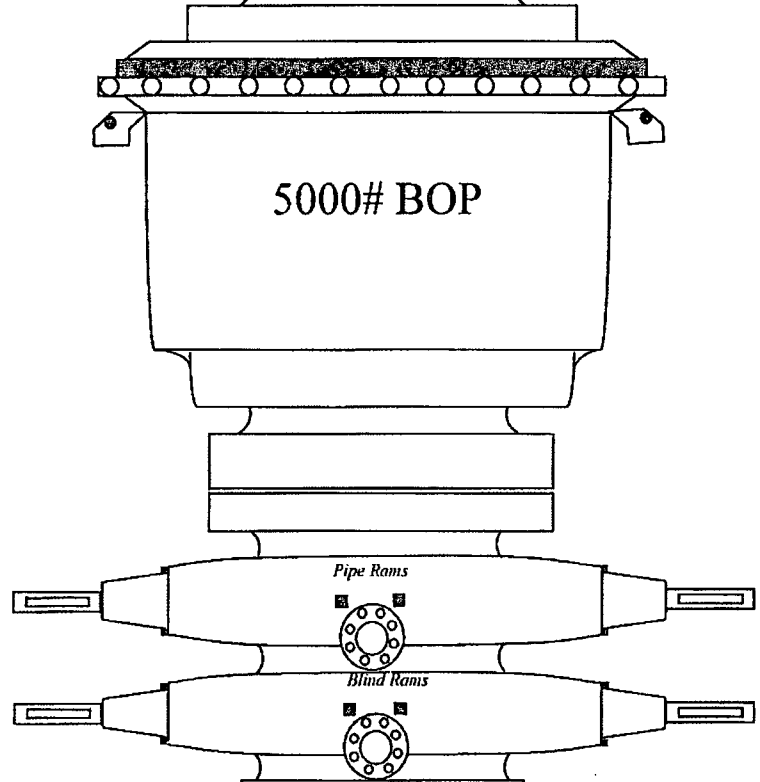

2" Kill Line

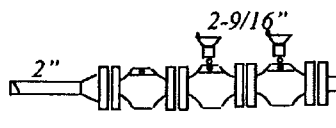

Drilling Spool

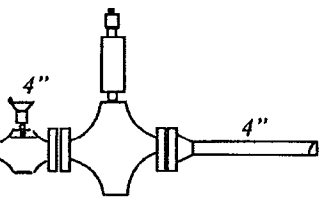

Wellhead Assembly

13 3/8" 5000# psi x 9" 5000# psi Wellhead Assembly

13 3/8" 5000# psi

Slip-on Casing Head

5000# BOP
West Grama Ridge 8 State Com #1
Cimarex Energy Co.
8-22S-34E
SHL 330 FSL & 660 FWL
BHL 330 FNL & 660 FWL
Lea County, NM

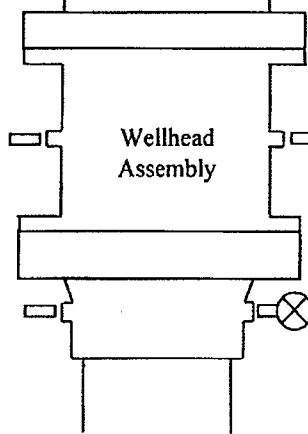



Cimarex

PATHFINDER
A Schlumberger Company

West Grama Ridge 8 State #1H		NM Lea County (NAD 83)		STRUCTURE West Grama Ridge 8 State #1H	
Map Date: 9/12/2012	Mag Dec: 7.47°	Grid North: 11	Grid East: 85142.57	Scale: 1:1000	Rev: 01/21/13

HOBBS OCD

JAN 31 2013

RECEIVED



Grid North
Tot Corr (N->G 7.0229°)
Mag Dec (7.470°)
Grid Conv (0.447°)

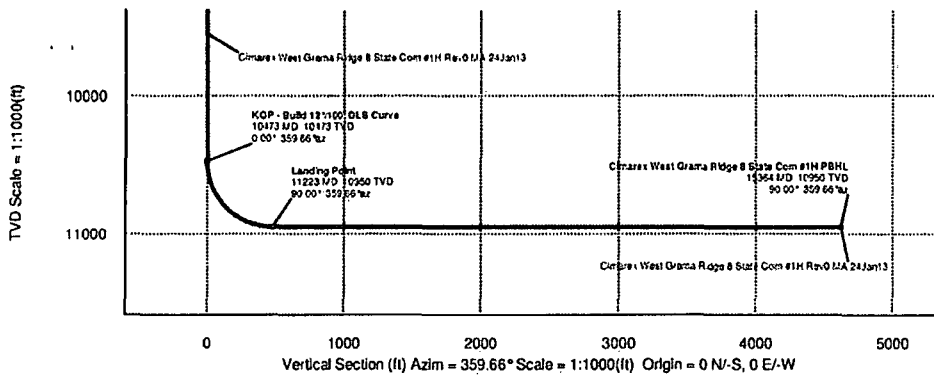
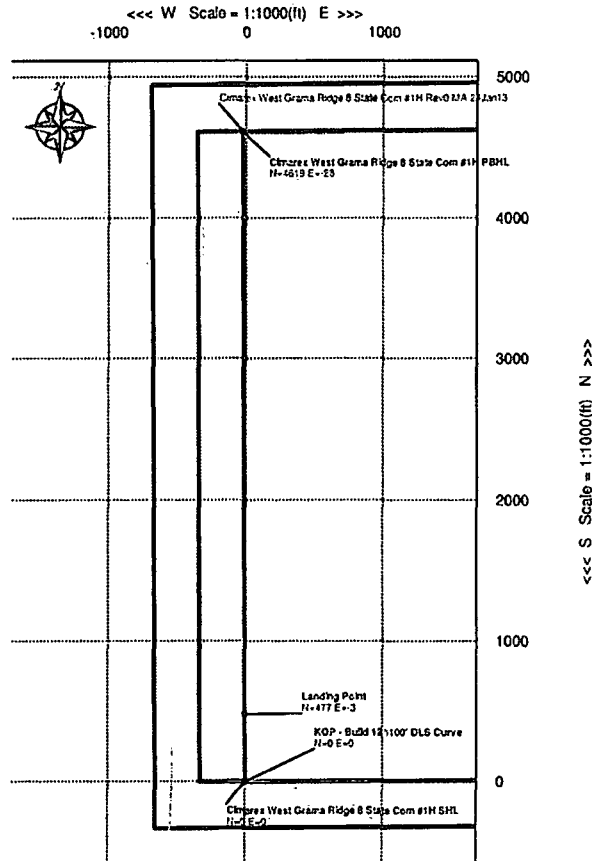

Critical Point	MP	INCL	AZIM	TVD	YSEC	N(+)/S(-)	E(+)/W(-)	DLS
Cimarex West Grama Ridge 8 State Com #1H SHL	0.00	0.00	359.66	0.00	0.00	0.00	0.00	
KOP - Build 12°/100' DLS Curve	10472.50	0.00	359.66	10472.50	0.00	0.00	0.00	0.00
Landing Point	11222.56	90.00	359.66	10950.00	477.50	477.49	-2.83	12.00
Cimarex West Grama Ridge 8 State Com #1H PBHL	15364.02	90.00	359.66	10950.00	4618.96	4618.88	-27.50	0.00



Cimarex West Grama Ridge 8 State Com #1H Rev0 MA 24Jan13 Proposal Report (Non-Def Plan)



Report Date: January 24, 2013 - 04:51 PM
Client: Cimarex
Field: NM Lea County (NAD 83)
Structure / Slot: TBD / Cimarex West Grama Ridge 8 State Com #1H
Well: Cimarex West Grama Ridge 8 State Com #1H
Borehole: Original Borehole
UWI / API#: Unknown / Unknown
Survey Name: Cimarex West Grama Ridge 8 State Com #1H Rev0 MA 24Jan13
Survey Date: January 24, 2013
Tort / AHD / DDI / ERD Ratio: 90.003 ° / 4618.960 ft / 5.766 / 0.422
Coordinate Reference System: NAD83 New Mexico State Plane, Eastom Zone, US Feet
Location Lat / Long: N 32° 23' 59.60820", W 103° 29' 54.50546"
Location Grid N/E Y/X: N 510217.700 ftUS, E 799008.400 ftUS
CRS Grid Convergence Angle: 0.4474 °
Grid Scale Factor: 0.99998513

Survey / DLS Computation: Minimum Curvature / Lubinski
Vertical Section Azimuth: 359.659 ° (Grid North)
Vertical Section Origin: 0.000 ft, 0.000 ft
TVD Reference Datum: Ground Level
TVD Reference Elevation: 3520.000 ft above MSL
Seabed / Ground Elevation: 3520.000 ft above MSL
Magnetic Declination: 7.470 °
Total Gravity Field Strength: 998.4908mgn (9.80665 Based)
Total Magnetic Field Strength: 48552.305 nT
Magnetic Dip Angle: 60.285 °
Declination Date: January 24, 2013
Magnetic Declination Model: BGGM 2012
North Reference: Grid North
Grid Convergence Used: 0.4474 °
Total Corr Mag North->Grid North: 7.0229 °
Local Coord Referenced To: Structure Reference Point

Comments	MD (ft)	Incl (°)	Azim Grid (°)	TVD (ft)	VSEC (ft)	NS (ft)	EW (ft)	Northing (ftUS)	Easting (ftUS)	Latitude (N/S ° ' ")	Longitude (E/W ° ' ")	Closure (ft)	Closure Azimuth (°)	DLS (°/100ft)
Cimarex West Grama Ridge 8 State Com #1H SHL	0.00	0.00	359.66	0.00	0.00	0.00	0.00	510217.70	799008.40	N 32 23 59.61	W 103 29 54.51	0.00	0.00	N/A
	100.00	0.00	359.66	100.00	0.00	0.00	0.00	510217.70	799008.40	N 32 23 59.61	W 103 29 54.51	0.00	0.00	0.00
	200.00	0.00	359.66	200.00	0.00	0.00	0.00	510217.70	799008.40	N 32 23 59.61	W 103 29 54.51	0.00	0.00	0.00
	300.00	0.00	359.66	300.00	0.00	0.00	0.00	510217.70	799008.40	N 32 23 59.61	W 103 29 54.51	0.00	0.00	0.00
	400.00	0.00	359.66	400.00	0.00	0.00	0.00	510217.70	799008.40	N 32 23 59.61	W 103 29 54.51	0.00	0.00	0.00
	500.00	0.00	359.66	500.00	0.00	0.00	0.00	510217.70	799008.40	N 32 23 59.61	W 103 29 54.51	0.00	0.00	0.00
	600.00	0.00	359.66	600.00	0.00	0.00	0.00	510217.70	799008.40	N 32 23 59.61	W 103 29 54.51	0.00	0.00	0.00
	700.00	0.00	359.66	700.00	0.00	0.00	0.00	510217.70	799008.40	N 32 23 59.61	W 103 29 54.51	0.00	0.00	0.00
	800.00	0.00	359.66	800.00	0.00	0.00	0.00	510217.70	799008.40	N 32 23 59.61	W 103 29 54.51	0.00	0.00	0.00
	900.00	0.00	359.66	900.00	0.00	0.00	0.00	510217.70	799008.40	N 32 23 59.61	W 103 29 54.51	0.00	0.00	0.00
	1000.00	0.00	359.66	1000.00	0.00	0.00	0.00	510217.70	799008.40	N 32 23 59.61	W 103 29 54.51	0.00	0.00	0.00
	1100.00	0.00	359.66	1100.00	0.00	0.00	0.00	510217.70	799008.40	N 32 23 59.61	W 103 29 54.51	0.00	0.00	0.00
	1200.00	0.00	359.66	1200.00	0.00	0.00	0.00	510217.70	799008.40	N 32 23 59.61	W 103 29 54.51	0.00	0.00	0.00
	1300.00	0.00	359.66	1300.00	0.00	0.00	0.00	510217.70	799008.40	N 32 23 59.61	W 103 29 54.51	0.00	0.00	0.00
	1400.00	0.00	359.66	1400.00	0.00	0.00	0.00	510217.70	799008.40	N 32 23 59.61	W 103 29 54.51	0.00	0.00	0.00
	1500.00	0.00	359.66	1500.00	0.00	0.00	0.00	510217.70	799008.40	N 32 23 59.61	W 103 29 54.51	0.00	0.00	0.00
	1600.00	0.00	359.66	1600.00	0.00	0.00	0.00	510217.70	799008.40	N 32 23 59.61	W 103 29 54.51	0.00	0.00	0.00
	1700.00	0.00	359.66	1700.00	0.00	0.00	0.00	510217.70	799008.40	N 32 23 59.61	W 103 29 54.51	0.00	0.00	0.00
	1800.00	0.00	359.66	1800.00	0.00	0.00	0.00	510217.70	799008.40	N 32 23 59.61	W 103 29 54.51	0.00	0.00	0.00
	1900.00	0.00	359.66	1900.00	0.00	0.00	0.00	510217.70	799008.40	N 32 23 59.61	W 103 29 54.51	0.00	0.00	0.00
	2000.00	0.00	359.66	2000.00	0.00	0.00	0.00	510217.70	799008.40	N 32 23 59.61	W 103 29 54.51	0.00	0.00	0.00
	2100.00	0.00	359.66	2100.00	0.00	0.00	0.00	510217.70	799008.40	N 32 23 59.61	W 103 29 54.51	0.00	0.00	0.00
	2200.00	0.00	359.66	2200.00	0.00	0.00	0.00	510217.70	799008.40	N 32 23 59.61	W 103 29 54.51	0.00	0.00	0.00
	2300.00	0.00	359.66	2300.00	0.00	0.00	0.00	510217.70	799008.40	N 32 23 59.61	W 103 29 54.51	0.00	0.00	0.00
	2400.00	0.00	359.66	2400.00	0.00	0.00	0.00	510217.70	799008.40	N 32 23 59.61	W 103 29 54.51	0.00	0.00	0.00
	2500.00	0.00	359.66	2500.00	0.00	0.00	0.00	510217.70	799008.40	N 32 23 59.61	W 103 29 54.51	0.00	0.00	0.00
	2600.00	0.00	359.66	2600.00	0.00	0.00	0.00	510217.70	799008.40	N 32 23 59.61	W 103 29 54.51	0.00	0.00	0.00

Comments	MD (ft)	Incl (°)	Azim Grid (°)	TVD (ft)	VSEC (ft)	NS (ft)	EW (ft)	Northing (ft)	Easting (ft)	Latitude (N/S ° ' ")	Longitude (E/W ° ' ")	Closure (ft)	Closure Azimuth (°)	DLS (ft/100ft)
	8200.00	0.00	359.66	8200.00	0.00	0.00	0.00	510217.70	799008.40	N 32 23 59.61	W 103 29 54.51	0.00	0.00	0.00
	8300.00	0.00	359.66	8300.00	0.00	0.00	0.00	510217.70	799008.40	N 32 23 59.61	W 103 29 54.51	0.00	0.00	0.00
	8400.00	0.00	359.66	8400.00	0.00	0.00	0.00	510217.70	799008.40	N 32 23 59.61	W 103 29 54.51	0.00	0.00	0.00
	8500.00	0.00	359.66	8500.00	0.00	0.00	0.00	510217.70	799008.40	N 32 23 59.61	W 103 29 54.51	0.00	0.00	0.00
	8600.00	0.00	359.66	8600.00	0.00	0.00	0.00	510217.70	799008.40	N 32 23 59.61	W 103 29 54.51	0.00	0.00	0.00
	8700.00	0.00	359.66	8700.00	0.00	0.00	0.00	510217.70	799008.40	N 32 23 59.61	W 103 29 54.51	0.00	0.00	0.00
	8800.00	0.00	359.66	8800.00	0.00	0.00	0.00	510217.70	799008.40	N 32 23 59.61	W 103 29 54.51	0.00	0.00	0.00
	8900.00	0.00	359.66	8900.00	0.00	0.00	0.00	510217.70	799008.40	N 32 23 59.61	W 103 29 54.51	0.00	0.00	0.00
	9000.00	0.00	359.66	9000.00	0.00	0.00	0.00	510217.70	799008.40	N 32 23 59.61	W 103 29 54.51	0.00	0.00	0.00
	9100.00	0.00	359.66	9100.00	0.00	0.00	0.00	510217.70	799008.40	N 32 23 59.61	W 103 29 54.51	0.00	0.00	0.00
	9200.00	0.00	359.66	9200.00	0.00	0.00	0.00	510217.70	799008.40	N 32 23 59.61	W 103 29 54.51	0.00	0.00	0.00
	9300.00	0.00	359.66	9300.00	0.00	0.00	0.00	510217.70	799008.40	N 32 23 59.61	W 103 29 54.51	0.00	0.00	0.00
	9400.00	0.00	359.66	9400.00	0.00	0.00	0.00	510217.70	799008.40	N 32 23 59.61	W 103 29 54.51	0.00	0.00	0.00
	9500.00	0.00	359.66	9500.00	0.00	0.00	0.00	510217.70	799008.40	N 32 23 59.61	W 103 29 54.51	0.00	0.00	0.00
	9600.00	0.00	359.66	9600.00	0.00	0.00	0.00	510217.70	799008.40	N 32 23 59.61	W 103 29 54.51	0.00	0.00	0.00
	9700.00	0.00	359.66	9700.00	0.00	0.00	0.00	510217.70	799008.40	N 32 23 59.61	W 103 29 54.51	0.00	0.00	0.00
	9800.00	0.00	359.66	9800.00	0.00	0.00	0.00	510217.70	799008.40	N 32 23 59.61	W 103 29 54.51	0.00	0.00	0.00
	9900.00	0.00	359.66	9900.00	0.00	0.00	0.00	510217.70	799008.40	N 32 23 59.61	W 103 29 54.51	0.00	0.00	0.00
	10000.00	0.00	359.66	10000.00	0.00	0.00	0.00	510217.70	799008.40	N 32 23 59.61	W 103 29 54.51	0.00	0.00	0.00
	10100.00	0.00	359.66	10100.00	0.00	0.00	0.00	510217.70	799008.40	N 32 23 59.61	W 103 29 54.51	0.00	0.00	0.00
	10200.00	0.00	359.66	10200.00	0.00	0.00	0.00	510217.70	799008.40	N 32 23 59.61	W 103 29 54.51	0.00	0.00	0.00
	10300.00	0.00	359.66	10300.00	0.00	0.00	0.00	510217.70	799008.40	N 32 23 59.61	W 103 29 54.51	0.00	0.00	0.00
	10400.00	0.00	359.66	10400.00	0.00	0.00	0.00	510217.70	799008.40	N 32 23 59.61	W 103 29 54.51	0.00	0.00	0.00
KOP - Build 12"/100' DLS Curve	10472.50	0.00	359.66	10472.50	0.00	0.00	0.00	510217.70	799008.40	N 32 23 59.61	W 103 29 54.51	0.00	0.00	0.00
	10500.00	3.30	359.66	10499.98	0.79	0.79	0.00	510218.49	799008.40	N 32 23 59.62	W 103 29 54.51	0.79	359.66	12.00
	10600.00	15.30	359.66	10588.48	16.92	16.92	-0.10	510234.62	799008.30	N 32 23 59.78	W 103 29 54.51	16.92	359.66	12.00
	10700.00	27.30	359.66	10681.48	53.18	53.18	-0.32	510270.88	799008.08	N 32 24 0.13	W 103 29 54.50	53.18	359.66	12.00
	10800.00	39.30	359.66	10774.92	107.98	107.97	-0.64	510325.87	799007.76	N 32 24 0.68	W 103 29 54.50	107.98	359.66	12.00
	10900.00	51.30	359.66	10845.14	178.92	178.92	-1.06	510396.62	799007.34	N 32 24 1.38	W 103 29 54.50	178.92	359.66	12.00
	11000.00	63.30	359.66	10899.07	262.92	262.91	-1.56	510480.81	799006.84	N 32 24 2.21	W 103 29 54.50	262.92	359.66	12.00
	11100.00	75.29	359.66	10934.36	356.29	356.28	-2.11	510573.97	799006.29	N 32 24 3.13	W 103 29 54.50	356.29	359.66	12.00
	11200.00	87.29	359.66	10949.47	454.95	454.95	-2.70	510672.64	799005.70	N 32 24 4.11	W 103 29 54.50	454.95	359.66	12.00
Landing Point	11222.56	90.00	359.66	10950.00	477.50	477.49	-2.83	510695.18	799005.57	N 32 24 4.33	W 103 29 54.50	477.50	359.66	12.00
	11300.00	90.00	359.66	10950.00	554.94	554.93	-3.29	510772.63	799005.11	N 32 24 5.10	W 103 29 54.49	554.94	359.66	0.00
	11400.00	90.00	359.66	10950.00	654.94	654.93	-3.89	510872.62	799004.51	N 32 24 6.09	W 103 29 54.49	654.94	359.66	0.00
	11500.00	90.00	359.66	10950.00	754.94	754.93	-4.48	510972.62	799003.92	N 32 24 7.08	W 103 29 54.49	754.94	359.66	0.00
	11600.00	90.00	359.66	10950.00	854.94	854.93	-5.07	511072.62	799003.33	N 32 24 8.07	W 103 29 54.49	854.94	359.66	0.00
	11700.00	90.00	359.66	10950.00	954.94	954.93	-5.67	511172.61	799002.73	N 32 24 9.06	W 103 29 54.48	954.94	359.66	0.00
	11800.00	90.00	359.66	10950.00	1054.94	1054.93	-6.26	511272.61	799002.14	N 32 24 10.05	W 103 29 54.48	1054.94	359.66	0.00
	11900.00	90.00	359.66	10950.00	1154.94	1154.92	-6.86	511372.60	799001.54	N 32 24 11.04	W 103 29 54.48	1154.94	359.66	0.00
	12000.00	90.00	359.66	10950.00	1254.94	1254.92	-7.45	511472.60	799000.95	N 32 24 12.03	W 103 29 54.48	1254.94	359.66	0.00
	12100.00	90.00	359.66	10950.00	1354.94	1354.92	-8.04	511572.60	799000.36	N 32 24 13.02	W 103 29 54.48	1354.94	359.66	0.00
	12200.00	90.00	359.66	10950.00	1454.94	1454.92	-8.64	511672.59	798999.77	N 32 24 14.00	W 103 29 54.47	1454.94	359.66	0.00
	12300.00	90.00	359.66	10950.00	1554.94	1554.92	-9.23	511772.59	798999.18	N 32 24 14.99	W 103 29 54.47	1554.94	359.66	0.00
	12400.00	90.00	359.66	10950.00	1654.94	1654.92	-9.83	511872.59	798998.57	N 32 24 15.98	W 103 29 54.47	1654.94	359.66	0.00
	12500.00	90.00	359.66	10950.00	1754.94	1754.91	-10.42	511972.58	798997.98	N 32 24 16.97	W 103 29 54.47	1754.94	359.66	0.00
	12600.00	90.00	359.66	10950.00	1854.94	1854.91	-11.02	512072.58	798997.38	N 32 24 17.96	W 103 29 54.47	1854.94	359.66	0.00
	12700.00	90.00	359.66	10950.00	1954.94	1954.91	-11.61	512172.58	798996.79	N 32 24 18.95	W 103 29 54.46	1954.94	359.66	0.00
	12800.00	90.00	359.66	10950.00	2054.94	2054.91	-12.21	512272.57	798996.19	N 32 24 19.94	W 103 29 54.46	2054.94	359.66	0.00
	12900.00	90.00	359.66	10950.00	2154.94	2154.91	-12.80	512372.57	798995.60	N 32 24 20.93	W 103 29 54.46	2154.94	359.66	0.00
	13000.00	90.00	359.66	10950.00	2254.94	2254.90	-13.40	512472.57	798995.00	N 32 24 21.92	W 103 29 54.46	2254.94	359.66	0.00
	13100.00	90.00	359.66	10950.00	2354.94	2354.90	-13.99	512572.56	798994.41	N 32 24 22.91	W 103 29 54.45	2354.94	359.66	0.00
	13200.00	90.00	359.66	10950.00	2454.94	2454.90	-14.59	512672.56	798993.81	N 32 24 23.90	W 103 29 54.45	2454.94	359.66	0.00
	13300.00	90.00	359.66	10950.00	2554.94	2554.90	-15.18	512772.56	798993.22	N 32 24 24.89	W 103 29 54.45	2554.94	359.66	0.00

Comments	MD (ft)	Incl (°)	Azim Grid (°)	TVD (ft)	VSEC (ft)	NS (ft)	EW (ft)	Northing (RUS)	Easting (RUS)	Latitude (N/S ° ' '')	Longitude (E/W ° ' '')	Closure (ft)	Closure Azimuth (°)	DLS (°/100ft)
	13400.00	90.00	359.66	10950.00	2654.94	2654.90	-15.78	512872.55	798992.62	N 32 24 25.88	W 103 29 54.45	2654.94	359.66	0.00
	13500.00	90.00	359.66	10950.00	2754.94	2754.90	-16.38	512872.55	798992.02	N 32 24 26.87	W 103 29 54.45	2754.94	359.66	0.00
	13600.00	90.00	359.66	10950.00	2854.94	2854.89	-16.97	513072.55	798991.43	N 32 24 27.86	W 103 29 54.44	2854.94	359.66	0.00
	13700.00	90.00	359.66	10950.00	2954.94	2954.89	-17.57	513172.54	798990.83	N 32 24 28.85	W 103 29 54.44	2954.94	359.66	0.00
	13800.00	90.00	359.66	10950.00	3054.94	3054.89	-18.16	513272.54	798990.24	N 32 24 29.84	W 103 29 54.44	3054.94	359.66	0.00
	13900.00	90.00	359.66	10950.00	3154.94	3154.89	-18.76	513372.54	798989.64	N 32 24 30.83	W 103 29 54.44	3154.94	359.66	0.00
	14000.00	90.00	359.66	10950.00	3254.94	3254.89	-19.36	513472.53	798989.04	N 32 24 31.82	W 103 29 54.43	3254.94	359.66	0.00
	14100.00	90.00	359.66	10950.00	3354.94	3354.89	-19.95	513572.53	798988.45	N 32 24 32.80	W 103 29 54.43	3354.94	359.66	0.00
	14200.00	90.00	359.66	10950.00	3454.94	3454.88	-20.55	513672.53	798987.85	N 32 24 33.79	W 103 29 54.43	3454.94	359.66	0.00
	14300.00	90.00	359.66	10950.00	3554.94	3554.88	-21.15	513772.52	798987.25	N 32 24 34.78	W 103 29 54.43	3554.94	359.66	0.00
	14400.00	90.00	359.66	10950.00	3654.94	3654.88	-21.74	513872.52	798986.66	N 32 24 35.77	W 103 29 54.43	3654.94	359.66	0.00
	14500.00	90.00	359.66	10950.00	3754.94	3754.88	-22.34	513972.51	798986.06	N 32 24 36.76	W 103 29 54.42	3754.94	359.66	0.00
	14600.00	90.00	359.66	10950.00	3854.94	3854.88	-22.94	514072.51	798985.46	N 32 24 37.75	W 103 29 54.42	3854.94	359.66	0.00
	14700.00	90.00	359.66	10950.00	3954.94	3954.87	-23.53	514172.51	798984.87	N 32 24 38.74	W 103 29 54.42	3954.94	359.66	0.00
	14800.00	90.00	359.66	10950.00	4054.94	4054.87	-24.13	514272.50	798984.27	N 32 24 39.73	W 103 29 54.42	4054.94	359.66	0.00
	14900.00	90.00	359.66	10950.00	4154.94	4154.87	-24.73	514372.50	798983.67	N 32 24 40.72	W 103 29 54.42	4154.94	359.66	0.00
	15000.00	90.00	359.66	10950.00	4254.94	4254.87	-25.33	514472.50	798983.08	N 32 24 41.71	W 103 29 54.41	4254.94	359.66	0.00
	15100.00	90.00	359.66	10950.00	4354.94	4354.87	-25.92	514572.49	798982.48	N 32 24 42.70	W 103 29 54.41	4354.94	359.66	0.00
	15200.00	90.00	359.66	10950.00	4454.94	4454.87	-26.52	514672.49	798981.88	N 32 24 43.69	W 103 29 54.41	4454.94	359.66	0.00
	15300.00	90.00	359.66	10950.00	4554.94	4554.86	-27.12	514772.49	798981.28	N 32 24 44.68	W 103 29 54.41	4554.94	359.66	0.00
Cimarex West Grama Ridge 8 State Com #1H PBHL	15364.02	90.00	359.66	10950.00	4618.96	4618.88	-27.50	514836.50	798980.90	N 32 24 45.31	W 103 29 54.41	4618.96	359.66	0.00

Survey Type: Non-Def Plan

Survey Error Model: ISCWSA Rev 0 *** 3-D 95.000% Confidence 2.7955 sigma
 Survey Program:

Description	MD From (ft)	MD To (ft)	EOU Freq (ft)	Hole Size (in)	Casing Diameter (in)	Survey Tool Type	Borehole / Survey
	0.000	15364.015	1/100.000	30.000	30.000	SLB_MWD-STD	Original Borehole / Cimarex West Grama Ridge 8 State Com #1H