

DEC 12 2013

DEC 16 2013

**SECTION 30, TOWNSHIP 21 SOUTH, RANGE 37 EAST, N.M.P.M.,**  
 LEA COUNTY, NEW MEXICO

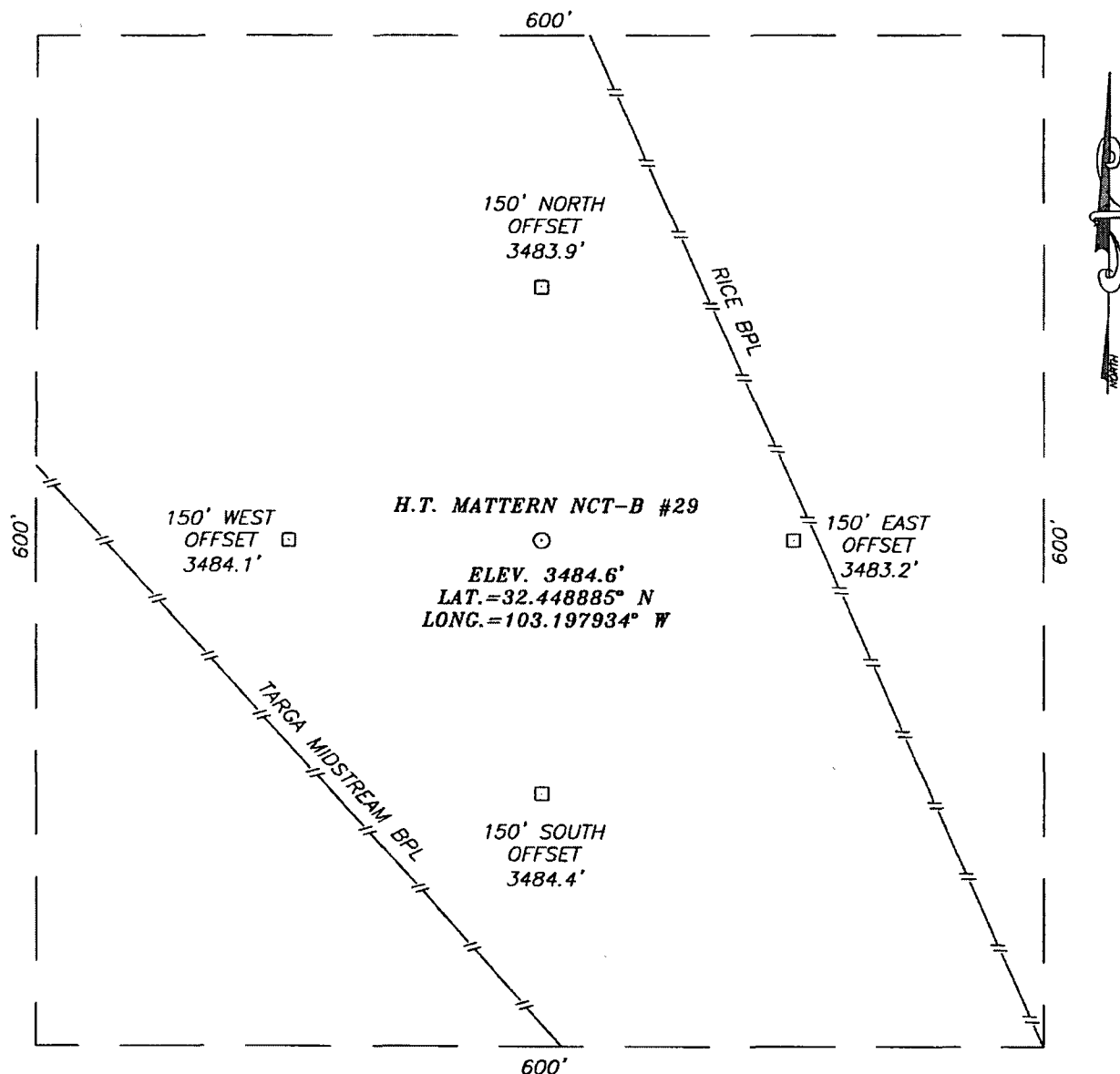

**DIRECTIONS TO LOCATION**

FROM THE INTERSECTION OF TURNER STREET AND ST. HWY. #8, GO WEST ON ST. HWY. #8 APPROX. 1.5 MILES TO A LEASE ROAD. TURN RIGHT AND GO NORTH ON LEASE ROAD APPROX. 0.25 MILES TO AN EXISTING WELL PAD. THIS LOCATION IS APPROX. 400 FEET NORTHEAST OF WELL PAD.

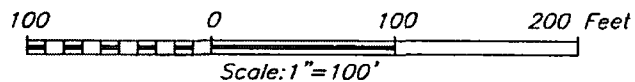

**CHEVRON USA INC.**

H.T. MATTERN NCT-B #29 WELL  
 LOCATED 2310 FEET FROM THE SOUTH LINE  
 AND 1460 FEET FROM THE EAST LINE OF SECTION 30,  
 TOWNSHIP 21 SOUTH, RANGE 37 EAST, N.M.P.M.,  
 LEA COUNTY, NEW MEXICO.

Survey Date: 12/18/08	Sheet 1 of 1 Sheets
W.O. Number: 08.11.2039	Dr By: AR
Date: 12/22/08	Disk: 08112039
	Rev 1: N/A
	Scale: 1"=100'

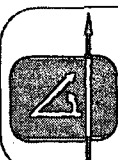

PROVIDING SURVEYING SERVICES  
 SINCE 1946  
**JOHN WEST SURVEYING COMPANY**  
 412 N. DAL PASO  
 HOBBS, N.M. 88240  
 (575) 393-3117

# VICINITY MAP

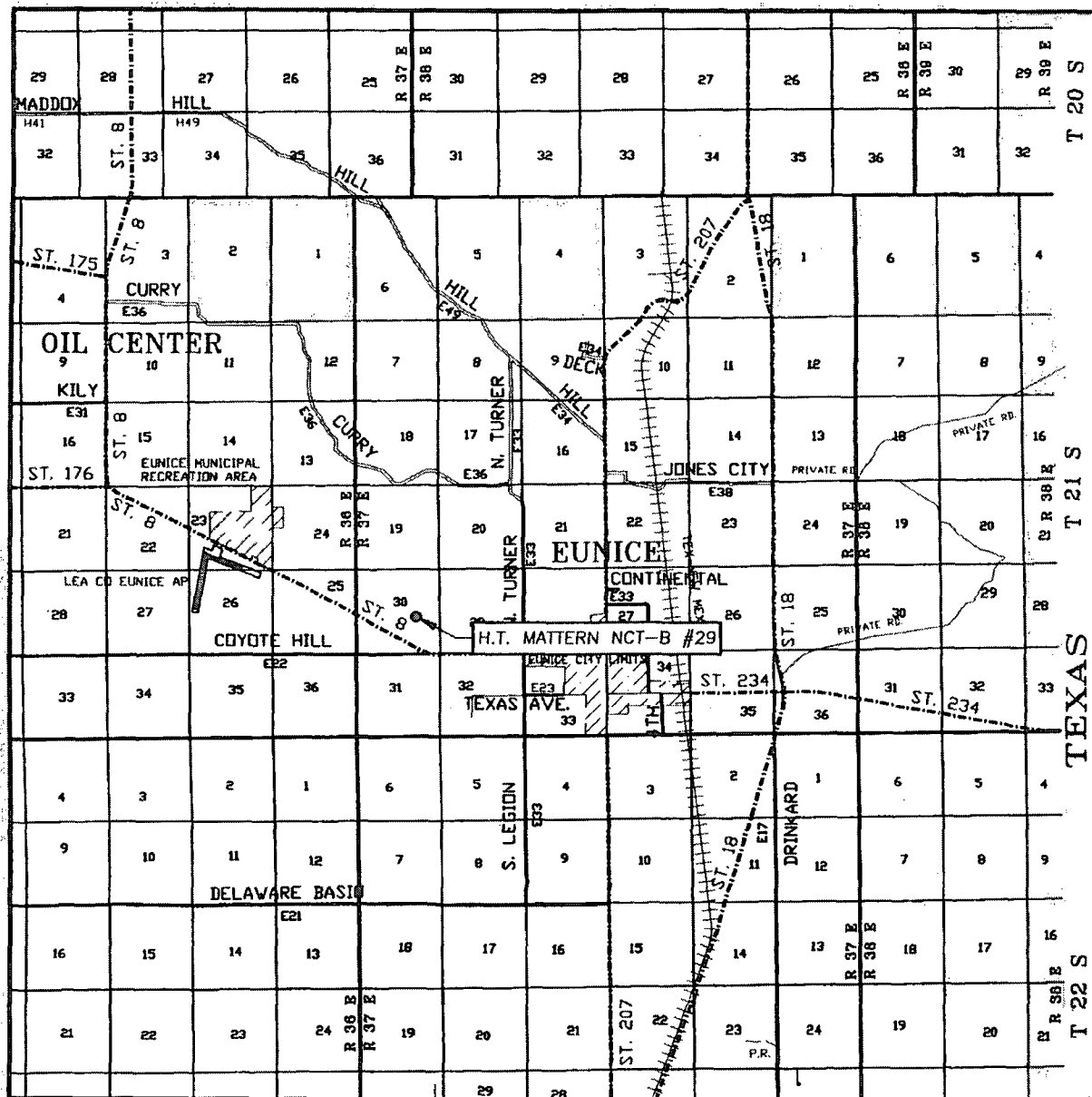

SCALE: 1" = 2 MILES

SEC. 30 TWP. 21-S RGE. 37-E

SURVEY N.M.P.M.

COUNTY LEA STATE NEW MEXICO

DESCRIPTION 2310' FSL & 1460' FEL

ELEVATION 3485'

OPERATOR CHEVRON USA INC.

LEASE H.T. MATTERN NCT-B

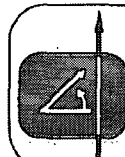

PROVIDING SURVEYING SERVICES  
SINCE 1946  
**JOHN WEST SURVEYING COMPANY**  
412 N. DAL PASO  
HOBBS, N.M. 88240  
(575) 393-3117

# LOCATION VERIFICATION MAP

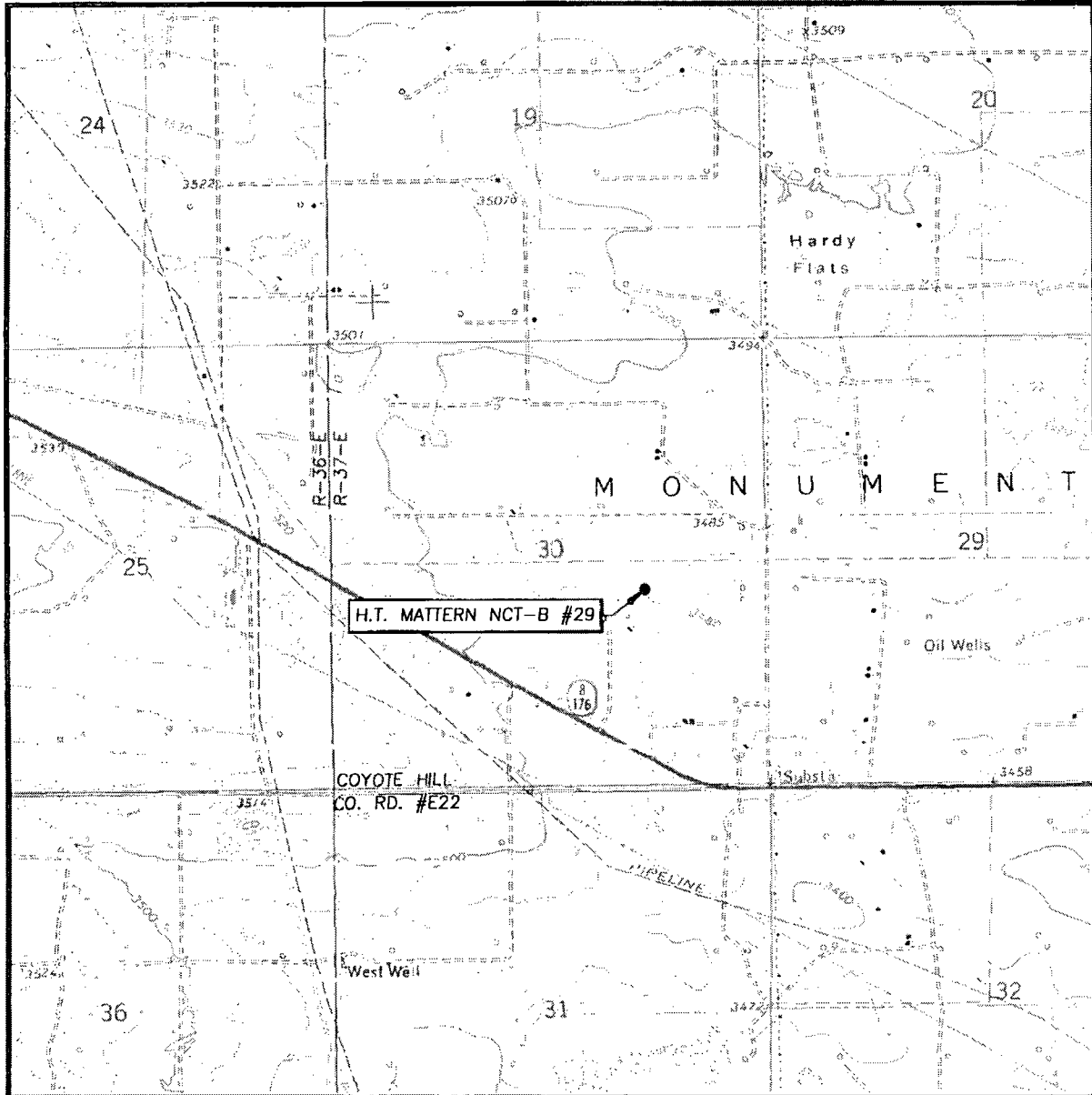

SCALE: 1" = 2000'

CONTOUR INTERVAL:  
EUNICE, N.M. - 10'

SEC. 30 TWP. 21-S RGE. 37-E

SURVEY N.M.P.M.

COUNTY LEA STATE NEW MEXICO

DESCRIPTION 2310' FSL & 1460' FEL

ELEVATION 3485'

OPERATOR CHEVRON USA INC.

LEASE H.T. MATTERN NCT-B

U.S.G.S. TOPOGRAPHIC MAP  
EUNICE, N.M.

