

UNITED STATES
DEPARTMENT OF THE INTERIOR
BUREAU OF LAND MANAGEMENT

HOBBS OCD
OCD Hobbs
DEC 01 2014

FORM APPROVED
OMB NO. 1004-0135
Expires: July 31, 2010

SUNDRY NOTICES AND REPORTS ON WELLS
Do not use this form for proposals to drill or to re-enter an abandoned well. Use form 3160-3 (APD) for such proposals.

RECEIVED

SUBMIT IN TRIPLICATE - Other instructions on reverse side.

1. Type of Well <input checked="" type="checkbox"/> Oil Well <input type="checkbox"/> Gas Well <input type="checkbox"/> Other		8. Well Name and No. LAGUNA 23 FEDERAL COM 3H
2. Name of Operator NEARBURG PRODUCING COMPANY Contact: VICKI JOHNSTON Email: vjohnston1@gmail.com		9. API Well No. 30-025-41946-00-X1
3a. Address 3300 NORTH A STREET BLDG 2 STE 120 MIDLAND, TX 79705	3b. Phone No. (include area code) Ph: 432.686.8235	10. Field and Pool, or Exploratory LEA
4. Location of Well (Footage, Sec., T., R., M., or Survey Description) Sec 23 T20S R34E SESW 330FSL 2130FWL 32.330818 N Lat, 103.315732 W Lon		11. County or Parish, and State LEA COUNTY, NM

12. CHECK APPROPRIATE BOX(ES) TO INDICATE NATURE OF NOTICE, REPORT, OR OTHER DATA

TYPE OF SUBMISSION	TYPE OF ACTION			
<input checked="" type="checkbox"/> Notice of Intent	<input type="checkbox"/> Acidize	<input type="checkbox"/> Deepen	<input type="checkbox"/> Production (Start/Resume)	<input type="checkbox"/> Water Shut-Off
<input type="checkbox"/> Subsequent Report	<input type="checkbox"/> Alter Casing	<input type="checkbox"/> Fracture Treat	<input type="checkbox"/> Reclamation	<input type="checkbox"/> Well Integrity
<input type="checkbox"/> Final Abandonment Notice	<input type="checkbox"/> Casing Repair	<input type="checkbox"/> New Construction	<input type="checkbox"/> Recomplete	<input checked="" type="checkbox"/> Other
	<input type="checkbox"/> Change Plans	<input type="checkbox"/> Plug and Abandon	<input type="checkbox"/> Temporarily Abandon	Change to Original APD
	<input type="checkbox"/> Convert to Injection	<input type="checkbox"/> Plug Back	<input type="checkbox"/> Water Disposal	

13. Describe Proposed or Completed Operation (clearly state all pertinent details, including estimated starting date of any proposed work and approximate duration thereof. If the proposal is to deepen directionally or recompleat horizontally, give subsurface locations and measured and true vertical depths of all pertinent markers and zones. Attach the Bond under which the work will be performed or provide the Bond No. on file with BLM/BIA. Required subsequent reports shall be filed within 30 days following completion of the involved operations. If the operation results in a multiple completion or recompleat in a new interval, a Form 3160-4 shall be filed once testing has been completed. Final Abandonment Notices shall be filed only after all requirements, including reclamation, have been completed, and the operator has determined that the site is ready for final inspection.)

Nearburg Producing Company submits the attached revised drilling rig diagram with V-door facing East.

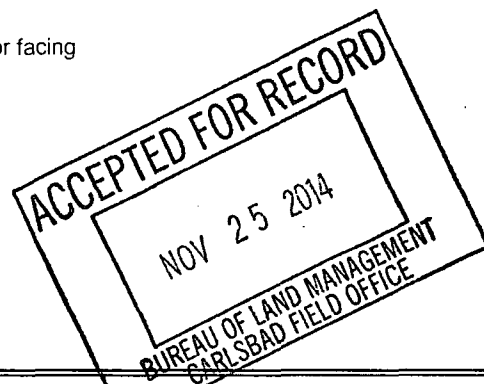

*Work Already Done
Well Drilled & completed*

14. I hereby certify that the foregoing is true and correct. Electronic Submission #261821 verified by the BLM Well Information System For NEARBURG PRODUCING COMPANY, sent to the Hobbs Committed to AFMSS for processing by LINDA JIMENEZ on 11/05/2014 (15LJ0233SE)	
Name (Printed/Typed) TIM GREEN	Title MARKETING & PRODUCTION SERVICE
Signature (Electronic Submission)	Date 09/08/2014

THIS SPACE FOR FEDERAL OR STATE OFFICE USE

Approved By ACCEPTED	EDWARD FERNANDEZ Title PETROLEUM ENGINEER	Date 11/25/2014
Conditions of approval, if any, are attached. Approval of this notice does not warrant or certify that the applicant holds legal or equitable title to those rights in the subject lease which would entitle the applicant to conduct operations thereon.		
Office Hobbs		

Title 18 U.S.C. Section 1001 and Title 43 U.S.C. Section 1212, make it a crime for any person knowingly and willfully to make to any department or agency of the United States any false, fictitious or fraudulent statements or representations as to any matter within its jurisdiction.

**** BLM REVISED ** BLM REVISED ** BLM REVISED ** BLM REVISED ** BLM REVISED ****

DEC 02 2014

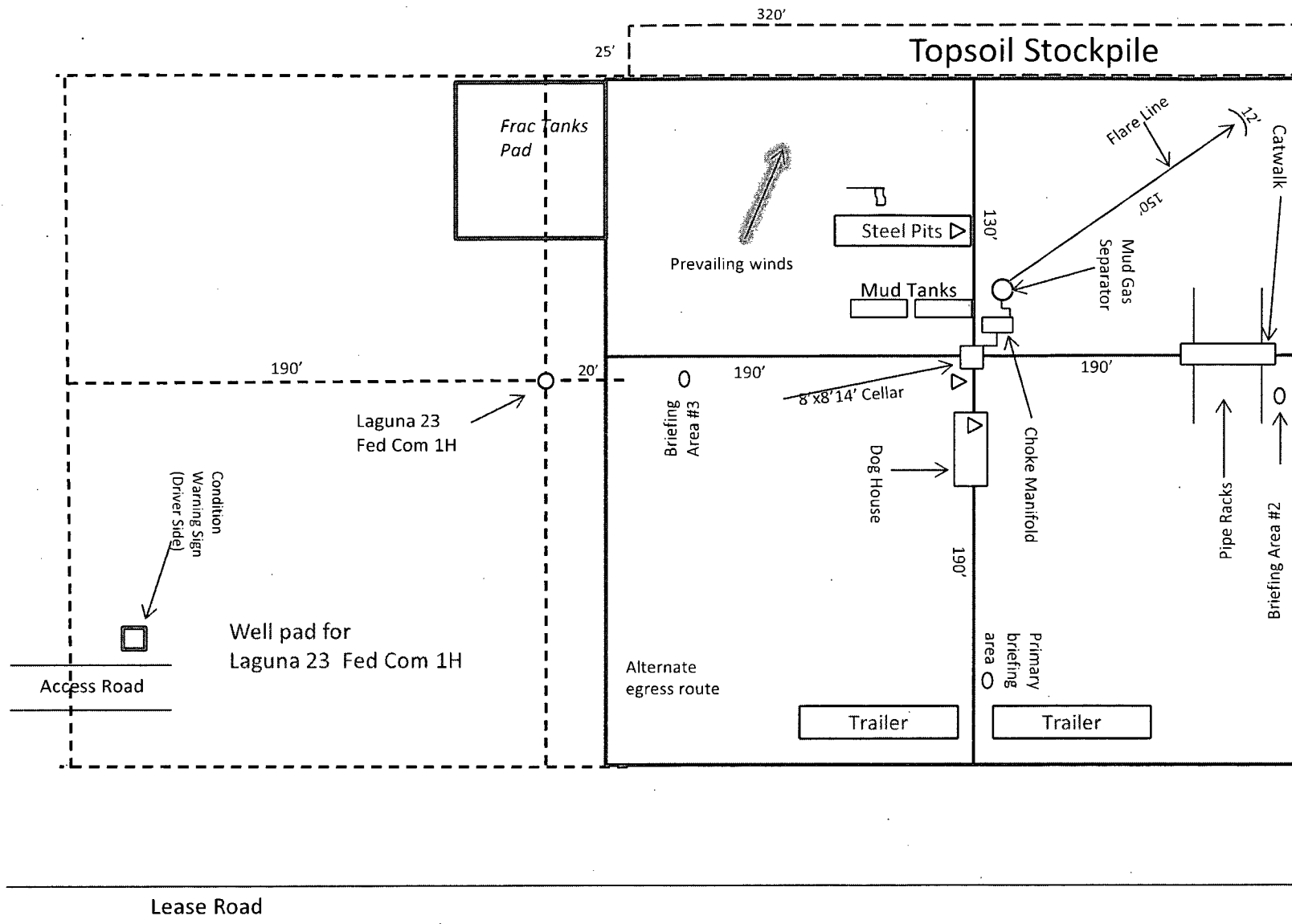



-  Wind Direction Indicators (wind sock or streamers)
-  H2S Monitors (alarms at bell nipple and shale shaker)
-  Briefing Areas



Exhibit D – Rig Diagram
Laguna 23 Federal Com #3H
 Nearburg Producing Co.
 23-20S-34E
 SHL 330 FSL & 2130 FWL
 BHL 330 FNL & 2130 FWL
 Lea County, NM

