

UNITED STATES
DEPARTMENT OF THE INTERIOR
BUREAU OF LAND MANAGEMENT

HOBBS OCD

FORM APPROVED
OMB NO. 1004-0135
Expires: July 31, 2010**SUNDRY NOTICES AND REPORTS ON WELLS**
Do not use this form for proposals to drill or to re-enter an abandoned well. Use form 3160-3 (APD) for such proposals.

AUG 03 2015

SUBMIT IN TRIPLICATE - Other instructions on reverse side.

1. Type of Well <input checked="" type="checkbox"/> Oil Well <input type="checkbox"/> Gas Well <input type="checkbox"/> Other		5. Lease Serial No. Multiple--See Attached
2. Name of Operator DEVON ENERGY PRODUCTION CO EMail: Erin.workman@devn.com		6. If Indian, Allottee or Tribe Name
3a. Address 333 WEST SHERIDAN AVE OKLAHOMA CITY, OK 73102	3b. Phone No. (include area code) Ph: 405-552-7970	7. If Unit or CA/Agreement, Name and/or No. Multiple--See Attached
4. Location of Well (Footage, Sec., T., R., M., or Survey Description) Multiple--See Attached		8. Well Name and No. Multiple--See Attached
		9. API Well No. Multiple--See Attached
		10. Field and Pool, or Exploratory JABALINA
		11. County or Parish, and State LEA COUNTY, NM

12. CHECK APPROPRIATE BOX(ES) TO INDICATE NATURE OF NOTICE, REPORT, OR OTHER DATA

TYPE OF SUBMISSION	TYPE OF ACTION			
<input checked="" type="checkbox"/> Notice of Intent	<input type="checkbox"/> Acidize	<input type="checkbox"/> Deepen	<input type="checkbox"/> Production (Start/Resume)	<input type="checkbox"/> Water Shut-Off
<input type="checkbox"/> Subsequent Report	<input type="checkbox"/> Alter Casing	<input type="checkbox"/> Fracture Treat	<input type="checkbox"/> Reclamation	<input type="checkbox"/> Well Integrity
<input type="checkbox"/> Final Abandonment Notice	<input type="checkbox"/> Casing Repair	<input type="checkbox"/> New Construction	<input type="checkbox"/> Recomplete	<input checked="" type="checkbox"/> Other
	<input type="checkbox"/> Change Plans	<input type="checkbox"/> Plug and Abandon	<input type="checkbox"/> Temporarily Abandon	Surface Commingling
	<input type="checkbox"/> Convert to Injection	<input type="checkbox"/> Plug Back	<input type="checkbox"/> Water Disposal	

13. Describe Proposed or Completed Operation (clearly state all pertinent details, including estimated starting date of any proposed work and approximate duration thereof. If the proposal is to deepen directionally or recompleat horizontally, give subsurface locations and measured and true vertical depths of all pertinent markers and zones. Attach the Bond under which the work will be performed or provide the Bond No. on file with BLM/BIA. Required subsequent reports shall be filed within 30 days following completion of the involved operations. If the operation results in a multiple completion or recompleat in a new interval, a Form 3160-4 shall be filed once testing has been completed. Final Abandonment Notices shall be filed only after all requirements, including reclamation, have been completed, and the operator has determined that the site is ready for final inspection.)

Devon Energy Production Co., LP respectfully request approval for a Central Tank Battery/Off-Lease Measurement, Sales, & Storage of the following wells:

Ragin Cajun 12 Fed 1H
Sec.12,SWSE,T26S,R34E
API# 30-025-41188
Jabalina; Delaware SW
NMNM100567 (12.5%)

Ragin Cajun 12 Fed 2H
Sec.12,SWSW,T26S,R34E
API# 30-025-42256

SEE ATTACHED FOR
CONDITIONS OF APPROVAL

30-025-41188
30-025-42256
30-025-42257
30-025-41259
30-025-41273
30-025-41247
30-023-41541

14. I hereby certify that the foregoing is true and correct. Electronic Submission #302738 verified by the BLM Well Information System For DEVON ENERGY PRODUCTION CO LP, sent to the Hobbs Committed to AFMSS for processing by DUNCAN WHITLOCK on 06/24/2015 (15DW0023SE)	
Name (Printed/Typed) ERIN WORKMAN	Title REGULATORY COMPLIANCE PROF.
Signature (Electronic Submission)	Date 05/24/2015
THIS SPACE FOR FEDERAL OR STATE OFFICE USE	
Approved By DUNCAN WHITLOCK	
Title TECHNICAL LPET	Date 07/27/2015
Conditions of approval, if any, are attached. Approval of this notice does not warrant or certify that the applicant holds legal or equitable title to those rights in the subject lease which would entitle the applicant to conduct operations thereon.	
Office Hobbs	
Title 18 U.S.C. Section 1001 and Title 43 U.S.C. Section 1212, make it a crime for any person knowingly and willfully to make to any department or agency of the United States any false, fictitious or fraudulent statements or representations as to any matter within its jurisdiction.	

** BLM REVISED ** BLM REVISED ** BLM REVISED ** BLM REVISED ** BLM REVISED **

AUG 12 2015

Additional data for EC transaction #302738 that would not fit on the form

5. Lease Serial No., continued

NMNM100567
NMNM100568
NMNM94118

Wells/Facilities, continued

Agreement	Lease	Well/Fac Name, Number	API Number	Location
NMNM100567	NMNM100567	RAGIN CAJUN 12 FEDERAL 1H	30-025-41188-00-S1	Sec 12 T26S R34E SWSE 10FSL 1685FEL 32.050664 N Lat, 103.420563 W Lon
NMNM100567	NMNM100567	RAGIN CAJUN 12 FED 2H	30-025-42256-00-X1	Sec 12 T26S R34E SWSW 10FSL 1135FWL 32.050649 N Lat, 103.432168 W Lon
NMNM100567	NMNM100567	RAGIN CAJUN 12 FED 3H	30-025-42257-00-X1	Sec 12 T26S R34E SWSW 10FSL 1085FWL 32.050677 N Lat, 103.428667 W Lon
NMNM100568	NMNM100568	RAGIN CAJUN 13 FEDERAL 1H	30-025-41259-00-S1	Sec 13 T26S R34E SESW 330FSL 1345FWL 32.037031 N Lat, 103.427820 W Lon
NMNM100568	NMNM100568	RAGIN CAJUN 13 FEDERAL 2H	30-025-41273-00-S1	Sec 13 T26S R34E SWSW 330FSL 1295FWL 32.037031 N Lat, 103.427981 W Lon
NMNM100568	NMNM100568	RATTLESNAKE 13 FEDERAL 2H	30-025-41247-00-S1	Sec 13 T26S R34E NWNE 25FNL 1650FEL 32.050567 N Lat, 103.420045 W Lon
NMNM94118	NMNM94118	RAGIN CAJUN 14 FEDERAL 1H	30-025-41541-00-X1	Sec 14 T26S R34E SESE 330FSL 330FEL 32.036136 N Lat, 130.432159 W Lon

32. Additional remarks, continued

Jabalina; Delaware SW
NMNM100567 (12.5%)

Ragin Cajun 12 Fed 3H
Sec.12,SWSW,T26S,R34E
API# 30-025-42257
Jabalina; Delaware SW
NMNM100567 (12.5%)

Ragin Cajun 13 Fed 1H
Sec.13,SESW,T26S,R34E
API# 30-025-41259
Jabalina; Delaware SW
NMNM100568 (12.5%)

Ragin Cajun 13 Fed 2H
Sec.13,SWSW,T26S,R34E
API# 30-025-41273
Jabalina; Delaware SW
NMNM100568 (12.5%)

Ragin Cajun 13 Fed 3H
Sec.13,NWNE,T26S,R34E
API# 30-025-41247
Jabalina; Delaware SW
NMNM100568 (12.5%)

Ragin Cajun 14 Fed 1H
Sec.14,SESE,T26S,R34E
API# 30-025-41541
Jabalina; Delaware SW
NMNM094118 (12.5%)

Ragin Cajun CTB
NMNM094118

The central tank battery is located at the Ragin Cajun CTB Sec. 14, SESE, T26S, R34E in Lea County, New Mexico. The production from each well will flow through its own three phase metered separator with a Micro Motion Coriolis Meter to meter the oil, flow meter to meter the water, and gas allocation meter to meter the gas. VRU will be allocated back to each well utilizing a percentage of each wells monthly oil production.

The Ragin Cajun Battery will have 4 oil tanks that all 7 wells will utilize, as well as a Ragin Cajun CTB Meter that will be used as BLM's point of royalty measurement, after measurement the production will flow through a common Regency #57496 on location in the northeast corner of the battery. Oil, gas, and water volumes from each well producing to this battery will be determined by using individual metered separators. Oil sold through a common Smith LACT Meters. LACT Meter #1343E10166 & LACT Meter #1413E10065.

32. Additional remarks, continued

ROW has or will be submitted.

Working, royalty, and overriding interest owners have been notified of this proposal via certified mail (see attached).

Attachment: Commingle Packet & Facility Diagram

Thank you!

APPLICATION FOR A CENTRAL TANK BATTERY\OFF LEASE MEASUREMENT, SALES, & STORAGE

Proposal for Ragin Cajun & Rattlesnake wells:

Devon Energy Production Company, LP is requesting approval for a Central Tank Battery for the following wells:

Federal Lease NMNM100567 (12.5%)

Well Name	Location	API #	Pool 97597	BOPD	OG	MCFPD	BTU
Ragin Cajun 12 Fed 1H	Sec. 12, SWSE, T26S, R34E	30-025-41188	Jabalina; Delaware SW	223	40.0	604	1222.1
Ragin Cajun 12 Fed 2H	Sec. 12, SWSW, T26S, R34E	30-025-42256	Jabalina; Delaware SW	223*	40.0*	604*	1222.1*
Ragin Cajun 12 Fed 3H	Sec. 12, SWSW, T26S, R34E	30-025-42257	Jabalina; Delaware SW	223*	40.0*	604*	1222.1*

Federal Lease NMNM100568 (12.5%)

Well Name	Location	API #	Pool 97597	BOPD	OG	MCFPD	BTU
Ragin Cajun 13 Fed 1H	Sec. 13, SESW, T26S, R34E	30-025-41259	Jabalina; Delaware SW	199	40.8	271	1251.2
Ragin Cajun 13 Fed 2H	Sec. 13, SWSW, T26S, R34E	30-025-41273	Jabalina; Delaware SW	132	40.4	183	1204.1
Rattlesnake 13 Fed 2H	Sec. 13, NWNE, T26S, R34E	30-025-41247	Jabalina; Delaware SW	217	41.4	625	1277.0

Federal Lease NMNM094118 (12.5%)

Well Name	Location	API#	Pool 97597	BOPD	OG	MCFPD	BTU
Ragin Cajun 14 Fed 1H	Sec. 14, SESE, T26S, R34E	30-025-41541	Jabalina; Delaware SW	199*	40.8*	271*	1251.2.*

*Proposed numbers, oil gravity will be provided upon receipt.

Attached is a map that displays the federal leases and well locations in Sec.12, T26S, R34E, Sec. 13, T26S, R34E, & Sec. 14, T26S, 34E

The BLM's interest in all eight wells is 12.5%

Oil & Gas metering:

The central tank battery is located at the Ragin Cajun CTB Sec. 14, SESE, T26S, R34E in Lea County, New Mexico. The production from each well will flow through its own three phase metered separator with a Micro Motion Coriolis Meter to meter the oil, flow meter to meter the water, and gas allocation meter to meter the gas. VRU will be allocated back to each well utilizing a percentage of each wells monthly oil production.

The Ragin Cajun Battery will have 4 oil tanks that all 7 wells will utilize, as well as a Ragin Cajun Federal Measurement Point (**number provided upon receipt**), after measurement the production will flow through a common Regency #57496 on location in the northeast corner of the battery. Oil, gas, and water volumes from each well producing to this battery will be determined by using individual metered separators. Oil sold through a common Smith LACT Meters. LACT Meter #1343E10166 & LACT Meter #1413E10065.

The Ragin Cajun 12 Fed 1H flows into a production header then into its own three phase metering separator, where after separation gas is routed to the gas allocation meter #390-49-320, then combines with the gas from the other wells and is measured by the Ragin Cajun Federal Measurement Point (**number provided upon receipt**). Once the water and oil are separated, the oil is then metered with a Micro Motion Coriolis Meter SN 14408680, commingles with the oil from all the other wells, along with the FWKO oil, and flows into one of the heater/treaters, then into a common production line which then flows to one of the 500 bbl. oil tanks. The water is metered using a turbine meter, flows to the FWKO, and then to one of the 500 bbl. water tanks, along with the water from the other wells.

The Ragin Cajun 12 Fed 2H flows into a production header then into its own three phase metering separator, where after separation gas is routed to the gas allocation meter (**number provided upon receipt**), then combines with the gas from the other wells and is measured by the Ragin Cajun Federal Measurement Point (**number provided upon receipt**). Once the water and oil are separated, the oil is then metered with a Micro Motion Coriolis Meter (**number provided upon receipt**), commingles with the oil from all the other wells, along with the FWKO oil, and flows into one of the heater/treaters, then into a common production line which then flows to one of the 500 bbl. oil tanks. The water is metered using a turbine meter, flows to the FWKO, and then to one of the 500 bbl. water tanks, along with the water from the other wells.

The Ragin Cajun 12 Fed 3H flows into a production header then into its own three phase metering separator, where after separation gas is routed to the gas allocation meter (**number provided upon receipt**), then combines with the gas from the other wells and is measured by the Ragin Cajun Federal Measurement Point (**number provided upon receipt**). Once the water and oil are separated, the oil is then metered with a Micro Motion Coriolis Meter (**number provided upon receipt**), combines with the oil from all the other wells, along with the FWKO oil, and flows into one of the heater/treaters, then into a common production line which then

flows to one of the 500 bbl. oil tanks. The water is metered using a turbine meter, flows to the FWKO, and then to one of the 500 bbl. water tanks, along with the water from the other wells.

The Ragin Cajun 13 Fed 1H flows into a production header then into its own three phase metering separator, where after separation gas is routed to the gas allocation meter #390-49-317, then combines with the gas from the other wells and is measured by the Ragin Cajun Federal Measurement Point (**number provided upon receipt**). Once the water and oil are separated, the oil is then metered with a Micro Motion Coriolis Meter S\N 14405872, commingles with the oil from all the other wells, along with the FWKO oil, and flows into one of the heater/treaters, then into a common production line which then flows to one of the 500 bbl. oil tanks. The water is metered using a turbine meter, flows to the FWKO, and then to one of the 500 bbl. water tanks, along with the water from the other wells.

The Ragin Cajun 13 Fed 2H flows into a production header then into its own three phase metering separator, where after separation gas is routed to the gas allocation meter #390-49-318, then combines with the gas from the other wells and is measured by the Ragin Cajun Federal Measurement Point (**number provided upon receipt**). Once the water and oil are separated, the oil is then metered with a Micro Motion Coriolis Meter S\N 14410278, commingles with the oil from all the other wells, along with the FWKO oil, and flows into one of the heater/treaters, then into a common production line which then flows to one of the 500 bbl. oil tanks. The water is metered using a turbine meter, flows to the FWKO, and then to one of the 500 bbl. water tanks, along with the water from the other wells.

The Rattlesnake 13 Fed 2H flows into a production header then into its own three phase metering separator, where after separation gas is routed to the gas allocation meter #390-49-319, then combines with the gas from the other wells and is measured by the Ragin Cajun Federal Measurement Point (**number provided upon receipt**). Once the water and oil are separated, the oil is then metered with a Micro Motion Coriolis Meter S\N 14405888, commingles with the oil from all the other wells, along with the FWKO oil, and flows into one of the heater/treaters, then into a common production line which then flows to one of the 500 bbl. oil tanks. The water is metered using a turbine meter, flows to the FWKO, and then to one of the 500 bbl. water tanks, along with the water from the other wells.

The Ragin Cajun 14 Fed 1H flows into a production header then into its own three phase metering separator, where after separation gas is routed to the gas allocation meter (**number provided upon receipt**), then combines with the gas from the other wells and is measured by the Ragin Cajun Federal Measurement Point (**number provided upon receipt**). Once the water and oil are separated, the oil is then metered with a Micro Motion Coriolis Meter (**number provided upon receipt**), commingles with the oil from all the other wells, along with the FWKO oil, and flows into one of the heater/treaters, then into a common production line which then flows to one of the 500 bbl. oil tanks. The water is metered using a turbine meter, flows to the FWKO, and then to one of the 500 bbl. water tanks, along with the water from the other wells.

Oil production will be allocated on a daily basis based on the Micro Motion Coriolis Meter for each well. The gas production will be allocated based on the gas allocation meters. The gas from the VRU will be allocated back to each well utilizing a percentage of each wells monthly oil production, gas allocation meters will commingle and flow to the Ragin Cajun Federal Measurement point on location, then flow to the Regency CDP on location. These meters will be calibrated on a regular basis per API, NMOCD and BLM specifications. The BLM and OCD will be notified of any future changes in the facilities.

Process and Flow Descriptions:

The flow of produced fluids is shown in detail on the enclosed Process Flow Diagram, along with a description of each vessel and map which shows the lease boundaries, location of wells, facility, and gas sales meter. The proposed commingling is appropriate based on the BLM's guidance in IM 2013-152. The proposed commingling will maximize the ultimate recovery of oil and/or gas from the federal leases and will reduce environmental impacts by minimizing surface disturbance and emissions. The proposed commingling will not adversely affect federal royalty income, production accountability, or the distribution of royalty.

Devon Energy Production Company, LP understands the requested approval will not constitute the granting of any right-of-way or construction rights not granted by the lease instrument.

Working, royalty, and overriding interest owners have been notified of this proposal via certified mail (see attached).

Signed:

Printed Name: Erin Workman

Title: Regulatory Compliance Professional

Date: 07.27.15

Ragin Cajun 14 CTB
Sec 14, SESE, T26S, R34E
Lease #: NMNM094118
Lea County, NM

PROCESS FLOW DIAGRAM

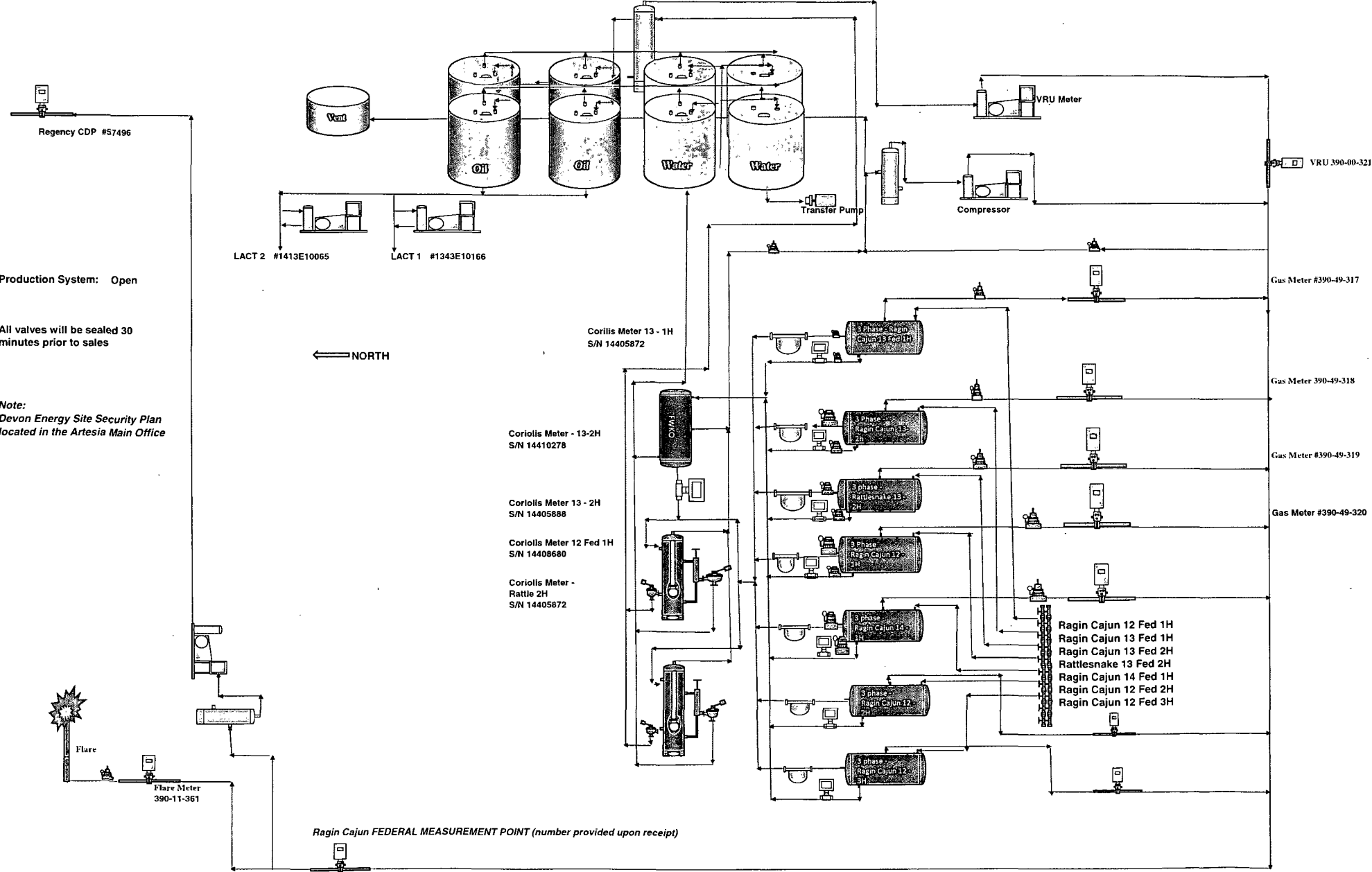

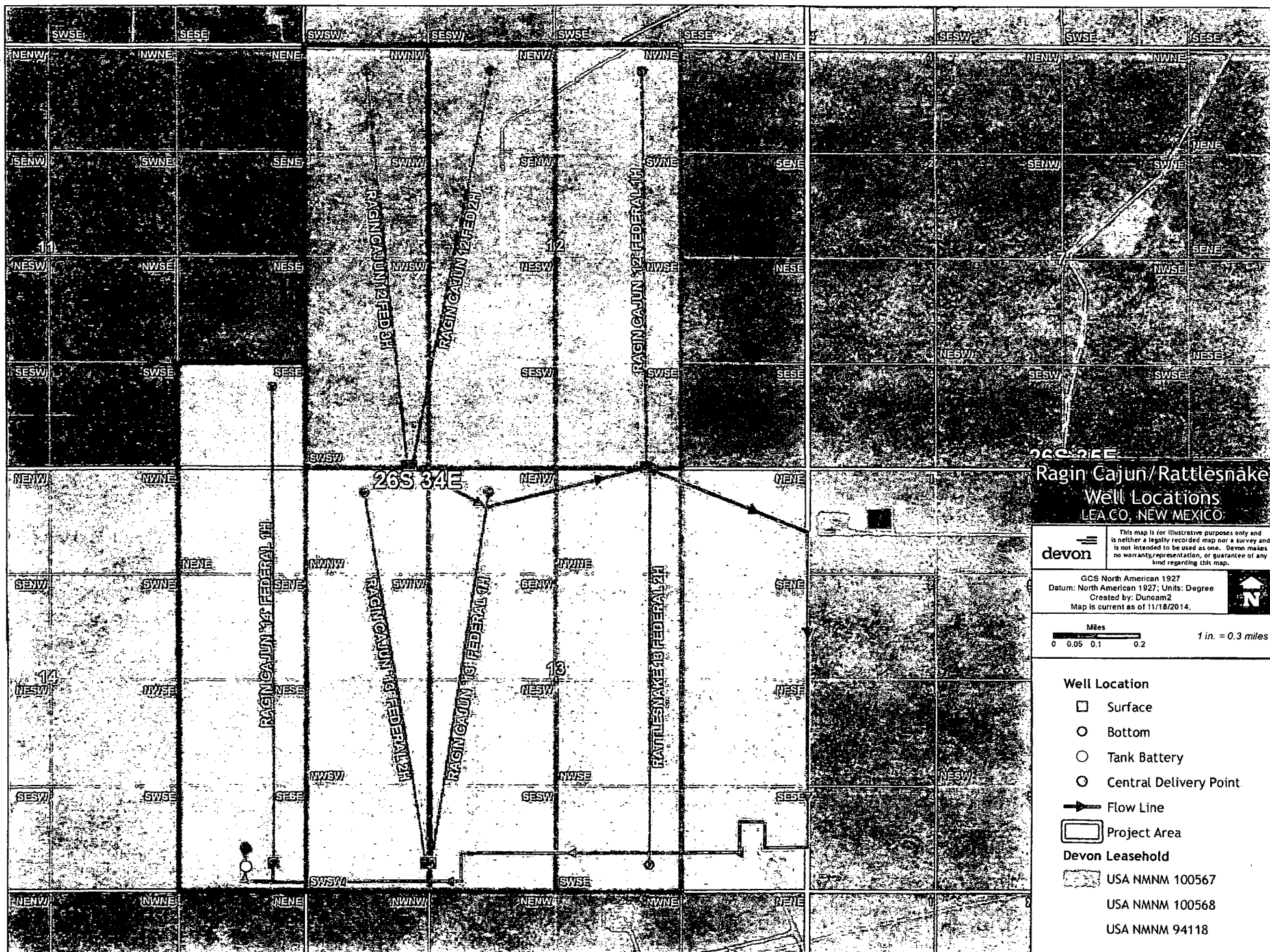

Ragin Cajun/Rattlesnake Well Locations LEA CO., NEW MEXICO

devon

This map is for illustrative purposes only and is neither a legally recorded map nor a survey and is not intended to be used as one. Devon makes no warranty, representation, or guarantee of any kind regarding this map.

GCS North American 1927
Datum: North American 1927; Units: Degree
Created by: Duocam2
Map is current as of 11/18/2014.

Miles
0 0.05 0.1 0.2
1 in. = 0.3 miles

- Well Location**
- Surface
 - Bottom
 - Tank Battery
 - Central Delivery Point
 - Flow Line
 - ▭ Project Area
- Devon Leasehold**
- USA NMNM 100567
 - USA NMNM 100568
 - USA NMNM 94118

**DEPARTMENT OF THE INTERIOR
BUREAU OF LAND MANAGEMENT
CASE RECORDATION
(MASS) Serial Register Page**

Run Time: 09:51 AM

Page 1 of 2

Run Date: 05/18/2015

01 12-22-1987;101STAT1330;30USC181 ET SE
Case Type 312021: O&G LSE COMP PD -1987
Commodity 459: OIL & GAS
Case Disposition: AUTHORIZED

Total Acres
1,760.000

Serial Number
NMNM-- - 094118

Name & Address			Serial Number: NMNM-- - 094118	Int Rel	% Interest
CHEVRON USA INC	1400 SMITH ST	HOUSTON TX 770027327	LESSEE	50.00000000	
CHEVRON USA INC	1400 SMITH ST	HOUSTON TX 770027327	OPERATING RIGHTS	0.00000000	
DEVON ENERGY PROD CO LP	333 W SHERIDAN AVE	OKLAHOMA CITY OK 731025010	LESSEE	50.00000000	
DEVON ENERGY PROD CO LP	333 W SHERIDAN AVE	OKLAHOMA CITY OK 731025010	OPERATING RIGHTS	0.00000000	
MCNIC O&G PROPERTIES	1360 POST OAK BLVD	HOUSTON TX 77056	OPERATING RIGHTS	0.00000000	
PENWELL ENERGY INC	600 N MARIENFELD #1100	MIDLAND TX 79701	OPERATING RIGHTS	0.00000000	

Serial Number: NMNM-- - 094118								
Mer Twp	Rng	Sec	STyp	SNr Suff	Subdivision	District/Field Office	County	Mgmt Agency
23	0260S	0340E	010	ALIQ	NE,SW,NESE,S2SE;	CARLSBAD FIELD OFFICE	LEA	BUREAU OF LAND MGMT
23	0260S	0340E	011	ALIQ	SESE;	CARLSBAD FIELD OFFICE	LEA	BUREAU OF LAND MGMT
23	0260S	0340E	014	ALL	ENTIRE SECTION	CARLSBAD FIELD OFFICE	LEA	BUREAU OF LAND MGMT
23	0260S	0340E	015	ALL	ENTIRE SECTION	CARLSBAD FIELD OFFICE	LEA	BUREAU OF LAND MGMT

Serial Number: NMNM-- - 094118				
Act Date	Code	Action	Action Remark	Pending Office
10/18/1994	387	CASE ESTABLISHED	9410064	
10/19/1994	191	SALE HELD		
10/19/1994	267	BID RECEIVED	\$149600.00;	
10/19/1994	392	MONIES RECEIVED	\$3520.00;	
11/01/1994	392	MONIES RECEIVED	\$146080.00;	
11/14/1994	237	LEASE ISSUED		
11/14/1994	974	AUTOMATED RECORD VERIF	SSP/ANN	
12/01/1994	084	RENTAL RECEIVED BY ONRR	\$2640.00;21/MULTIPLE	
12/01/1994	496	FUND CODE	05;145003;	
12/01/1994	530	RLTY RATE - 12 1/2%		
12/01/1994	868	EFFECTIVE DATE		
12/05/1994	600	RECORDS NOTED		
01/30/1995	932	TRF OPER RGTS FILED	SANTA FE ENE/MRL PRIN	
02/17/1995	963	CASE MICROFILMED/SCANNED	JDS	
04/27/1995	933	TRF OPER RGTS APPROVED	EFF 02/01/95;	
04/27/1995	974	AUTOMATED RECORD VERIF	JLV	
11/06/1995	084	RENTAL RECEIVED BY ONRR	\$2640.00;21/000000005	
12/08/1995	932	TRF OPER RGTS FILED	MRL PARTNERS/PENWELL	
03/25/1996	932	TRF OPER RGTS FILED	PENWELL/COENERGY	
03/27/1996	933	TRF OPER RGTS APPROVED	EFF 01/01/96;	
03/27/1996	974	AUTOMATED RECORD VERIF	MV/MV	
07/08/1996	933	TRF OPER RGTS APPROVED	EFF 04/01/96;	
07/08/1996	974	AUTOMATED RECORD VERIF	LR	
11/04/1996	084	RENTAL RECEIVED BY ONRR	\$2640.00;21/000000005	
10/09/1997	084	RENTAL RECEIVED BY ONRR	\$2640.00;21/000000005	
12/16/1997	817	MERGER RECOGNIZED	COENE CEN/MCNIC O&G	
12/16/1997	974	AUTOMATED RECORD VERIF	BTM	
11/09/1998	084	RENTAL RECEIVED BY ONRR	\$2640.00;21/000000006	
01/25/1999	899	TRF OF ORR FILED		
01/25/1999	932	TRF OPER RGTS FILED	MCNIC O&G/PENWELL	

**DEPARTMENT OF THE INTERIOR
BUREAU OF LAND MANAGEMENT
CASE RECORDATION
(MASS) Serial Register Page**

Run Time: 09:50 AM

Page 1 of 2

Run Date: 05/18/2015

01 12-22-1987;101STAT1330;30USC181 ET SE
Case Type 312021: O&G LSE COMP PD -1987
Commodity 459: OIL & GAS
Case Disposition: AUTHORIZED

Total Acres
1,920.000
Serial Number
NMNM-- - 100568

Serial Number: NMNM-- - 100568

Name & Address	Int Rel	% Interest
CHEVRON USA INC 1400 SMITH ST HOUSTON TX 770027327	LESSEE	0.000000000
CHEVRON USA INC 1400 SMITH ST HOUSTON TX 770027327	OPERATING RIGHTS	0.000000000
DEVON ENERGY PROD CO LP 333 W SHERIDAN AVE OKLAHOMA CITY OK 731025010	LESSEE	0.000000000
DEVON ENERGY PROD CO LP 333 W SHERIDAN AVE OKLAHOMA CITY OK 731025010	OPERATING RIGHTS	0.000000000

Serial Number: NMNM-- - 100568

Mer Twp Rng Sec	STyp	SNr Suff	Subdivision	District/Field Office	County	Mgmt Agency
23 0260S 0340E 013	ALL		ENTIRE SECTION	CARLSBAD FIELD OFFICE	LEA	BUREAU OF LAND MGMT
23 0260S 0340E 023	ALL		ENTIRE SECTION	CARLSBAD FIELD OFFICE	LEA	BUREAU OF LAND MGMT
23 0260S 0340E 026	ALL		ENTIRE SECTION	CARLSBAD FIELD OFFICE	LEA	BUREAU OF LAND MGMT

Serial Number: NMNM-- - 100568

Act Date	Code	Action	Action Remark	Pending Office
01/20/1998	387	CASE ESTABLISHED	9801149	
01/21/1998	191	SALE HELD		
01/21/1998	267	BID RECEIVED	\$364800.00;	
01/21/1998	392	MONIES RECEIVED	\$3840.00;	
02/04/1998	392	MONIES RECEIVED	\$360960.00;	
02/13/1998	237	LEASE ISSUED		
02/13/1998	974	AUTOMATED RECORD VERIF	AT	
03/01/1998	496	FUND CODE	05;145003	
03/01/1998	530	RLTY RATE - 12 1/2%		
03/01/1998	868	EFFECTIVE DATE		
03/05/1998	084	RENTAL RECEIVED BY ONRR	\$2880.00;11/MULTIPLE	
03/10/1998	600	RECORDS NOTED		
06/25/1998	963	CASE MICROFILMED/SCANNED		
02/03/1999	084	RENTAL RECEIVED BY ONRR	\$2880.00;21/000000006	
07/01/1999	940	NAME CHANGE RECOGNIZED	SF ENE RES/SF SNYDER	
07/01/1999	974	AUTOMATED RECORD VERIF	JLV	
02/04/2000	084	RENTAL RECEIVED BY ONRR	\$2880;21/71	
10/11/2000	940	NAME CHANGE RECOGNIZED	SANTA FE/DEVON SFS	
10/11/2000	974	AUTOMATED RECORD VERIF	AT	
03/07/2001	084	RENTAL RECEIVED BY ONRR	\$2880;11/84	
04/25/2001	791	TERMINAT'N NOTICE ISSUED	CLASS I;	
04/25/2001	974	AUTOMATED RECORD VERIF	GSB	
05/14/2001	284	REINSTATEMENT FILED	CLASS I;	
05/22/2001	282	REINSTATEMENT APPROVED	CLASS I EFF 03/01/01;	
05/22/2001	974	AUTOMATED RECORD VERIF	LBO	
12/12/2002	817	MERGER RECOGNIZED	DEVONSFS/DEVONENEPD	
11/30/2004	232	LEASE COMMITTED TO UNIT	NM111796X;RATTLESNAKE	
01/08/2006	650	HELD BY PROD - ACTUAL	/1/	
03/14/2006	643	PRODUCTION DETERMINATION	/1/	
03/14/2006	658	MEMO OF 1ST PROD-ACTUAL	/1/#1 RATTLESNAKE;	
11/20/2006	396	TRF OF INTEREST FILED	DEVON/CHESAPEAKE EXP	
11/27/2012	140	ASGN FILED	CHESAPEAKE/CHEVRON U;1	
11/27/2012	932	TRF OPER RGTS FILED	CHESAPEAKE/CHEVRON U;1	

NO WARRANTY IS MADE BY BLM FOR USE OF THE DATA FOR PURPOSES NOT INTENDED BY BLM

**DEPARTMENT OF THE INTERIOR
BUREAU OF LAND MANAGEMENT
CASE RECORDATION
(MASS) Serial Register Page**

Run Time: 09:49 AM

Page 1 of 2

Run Date: 05/18/2015

01 12-22-1987;101STAT1330;30USC181 ET SE

Total Acres

Serial Number

Case Type 312021: O&G LSE COMP PD -1987

640.000

NMNM-- - 100567

Commodity 459: OIL & GAS

Case Disposition: AUTHORIZED

Serial Number: NMNM-- - 100567.

Name & Address			Int Rel	% Interest
CHEVRON USA INC	1400 SMITH ST	HOUSTON TX 770027327	OPERATING RIGHTS	0.000000000
CHEVRON USA INC	1400 SMITH ST	HOUSTON TX 770027327	LESSEE	50.000000000
DEVON ENERGY PROD CO LP	333 W SHERIDAN AVE	OKLAHOMA CITY OK 731025010	LESSEE	50.000000000

Serial Number: NMNM-- - 100567

Mer Twp Rng Sec	STyp	SNr Suff	Subdivision	District/Field Office	County	Mgmt Agency
23 0260S 0340E 012	ALL		ENTIRE SECTION	CARLSBAD FIELD OFFICE	LEA	BUREAU OF LAND MGMT

Serial Number: NMNM-- - 100567

Act Date	Code	Action	Action Remark	Pending Office
01/20/1998	387	CASE ESTABLISHED	9801148	
01/21/1998	191	SALE HELD		
01/21/1998	267	BID RECEIVED	\$153600.00;	
01/21/1998	392	MONIES RECEIVED	\$1280.00;	
02/04/1998	392	MONIES RECEIVED	\$152320.00;	
02/13/1998	237	LEASE ISSUED		
02/13/1998	974	AUTOMATED RECORD VERIF	AT	
03/01/1998	496	FUND CODE	05;145003	
03/01/1998	530	RLTY RATE - 12 1/2%		
03/01/1998	868	EFFECTIVE DATE		
03/05/1998	084	RENTAL RECEIVED BY ONRR	\$960.00;11/MULTIPLE	
03/10/1998	600	RECORDS NOTED		
06/25/1998	963	CASE MICROFILMED/SCANNED		
02/03/1999	084	RENTAL RECEIVED BY ONRR	\$960.00;21/0000000064	
07/01/1999	940	NAME CHANGE RECOGNIZED	SF ENE RES/SF SNYDER	
07/01/1999	974	AUTOMATED RECORD VERIF	JLV	
02/07/2000	084	RENTAL RECEIVED BY ONRR	\$960.00;21/71	
10/11/2000	940	NAME CHANGE RECOGNIZED	SANTA FE/DEVON SFS	
10/11/2000	974	AUTOMATED RECORD VERIF	AT	
03/07/2001	084	RENTAL RECEIVED BY ONRR	\$960.00;11/84	
04/25/2001	791	TERMINAT'N NOTICE ISSUED	CLASS I;	
04/25/2001	974	AUTOMATED RECORD VERIF	GSB	
05/14/2001	284	REINSTATEMENT FILED	CLASS I;	
05/22/2001	282	REINSTATEMENT APPROVED	CLASS I EFF 3/1/01;	
05/22/2001	974	AUTOMATED RECORD VERIF	LBO	
12/12/2002	817	MERGER RECOGNIZED	DEVONSFS/DEVONENEPD	
11/30/2004	232	LEASE COMMITTED TO UNIT	NM111796X;RATTLESNAKE	
11/20/2006	396	TRF OF INTEREST FILED	DEVON/CHESAPEAKE EXP	
03/03/2012	226	ELIM BY CONTRACTION	NM111796X;RATTLESNAKE	
03/03/2012	235	EXTENDED	THRU 03/03/14;	
11/27/2012	140	ASGN FILED	CHESAPEAK/CHEVRON U;1	
11/27/2012	932	TRF OPER RGTS FILED	CHESAPEAK/CHEVRON U;1	
11/27/2012	974	AUTOMATED RECORD VERIF	JA;	
02/01/2013	246	LEASE COMMITTED TO CA	/1/CA NM132796	
06/03/2013	139	ASGN APPROVED	EFF 12/01/12;	

NO WARRANTY IS MADE BY BLM FOR USE OF THE DATA FOR PURPOSES NOT INTENDED BY BLM



Devon Energy Production Company
333 W. Sheridan Avenue
Oklahoma City, Oklahoma 73102
Phone: (405)-552-7970
Erin.Workman@dvn.com

July 27, 2015

CERTIFIED MAIL
RETURN RECEIPT REQUESTED

Interest Owners

Re: Central Tank Battery
Ragin Cajun 12 Fed 1H, Ragin Cajun 12 Fed 2H, Ragin Cajun 12 Fed 3H, Ragin Cajun
13 Fed 1H, Ragin Cajun 13 Fed 2H, Ragin Cajun 14 Fed 1H, Rattlesnake 13 Fed 2H
Sec., T, R: Sec 12, T26S, R34E, Sec 13, T26S, R34E, & Sec. 14, T26S, R34E
Lease: NMNM100567, NMNM100568, & NMNM094118
API: 30-025-41188, 30-025-42256, 30-025-42257, 30-025-41259, & 30-025-41273
30-025-41541, & 30-025-41247
Pool: Jabalina; Delaware SW
County: Lea Co., New Mexico

Gentlemen:

This is to advise you that Devon Energy Production Company, LP, is filing an application with the New Mexico Oil Conservation Division ("NMOCD") & Bureau of Land Management seeking approval for a Central Tank Battery for the above mentioned wells.

A copy of our application submitted is attached.

Any objections or requests that a hearing should be held regarding this application must be submitted to the New Mexico Oil Conservation Division Santa Fe office within 20 days from the date of this letter:

Please contact the undersigned at (405) 552-7970 should you have any questions or need anything further.

Sincerely,

Devon Energy Production Company, L.P.

Erin Workman
Regulatory Compliance Professional

Enclosure

E-CERTIFIED MAILING LIST

Commingle Mailing Reference: **Ragin Cajun**

<u>Repondent Name/Address:</u>	<u>E-Certified Mailing Number:</u>
Lowe Partners LP P.O. Box 832 Midland, TX 79702	9171999991703565024824
Chevron USA Inc. P.O. Box 730436 Dallas, TX 75373	9171999991703565024831
Jared Partners LTD P.O. Box 51451 Midland, TX 79710	9171999991703565024848
Penwell Employee Royalty Pool 310 W. Wall Ste. 1001 Midland, TX 79701	9171999991703565024855
C. Mark Wheeler 24 Smith Rd. Ste. 405 Midland, TX 79705	9171999991703565024862
John Lawrence Thoma P.O. Box 17656 Golden, CO 80402	9171999991703565024879
Sandra Mary Thoma 8530 Mill Run Rd. Athens, TX 75751	9171999991703565024886
Paul R. Barwis P.O. Box 230 Midland, TX 79702	9171999991703565024893
ONRR P.O. Box 25627 Denver, CO 80225	9171999991703565024909

DATE IN	SUSPENSE	ENGINEER	LOGGED IN	TYPE	APP NO.
---------	----------	----------	-----------	------	---------

ABOVE THIS LINE FOR DIVISION USE ONLY

NEW MEXICO OIL CONSERVATION DIVISION

- Engineering Bureau -

1220 South St. Francis Drive, Santa Fe, NM 87505



ADMINISTRATIVE APPLICATION CHECKLIST

THIS CHECKLIST IS MANDATORY FOR ALL ADMINISTRATIVE APPLICATIONS FOR EXCEPTIONS TO DIVISION RULES AND REGULATIONS WHICH REQUIRE PROCESSING AT THE DIVISION LEVEL IN SANTA FE

Application Acronyms:

[NSL-Non-Standard Location] **[NSP-Non-Standard Proration Unit]** **[SD-Simultaneous Dedication]**
[DHC-Downhole Commingling] **[CTB-Lease Commingling]** **[PLC-Pool/Lease Commingling]**
[PC-Pool Commingling] **[OLS - Off-Lease Storage]** **[OLM-Off-Lease Measurement]**
[WFX-Waterflood Expansion] **[PMX-Pressure Maintenance Expansion]**
[SWD-Salt Water Disposal] **[IPI-Injection Pressure Increase]**
[EOR-Qualified Enhanced Oil Recovery Certification] **[PPR-Positive Production Response]**

[1] TYPE OF APPLICATION - Check Those Which Apply for [A]

[A] Location - Spacing Unit - Simultaneous Dedication
☐ NSL ☐ NSP ☐ SD

Check One Only for [B] or [C]

[B] Commingling - Storage - Measurement
☐ DHC ☒ CTB ☐ PLC ☐ PC ☐ OLS ☐ OLM

[C] Injection - Disposal - Pressure Increase - Enhanced Oil Recovery
☐ WFX ☐ PMX ☐ SWD ☐ IPI ☐ EOR ☐ PPR

[D] Other: Specify _____

[2] NOTIFICATION REQUIRED TO: - Check Those Which Apply, or ☐ Does Not Apply

[A] ☒ Working, Royalty or Overriding Royalty Interest Owners

[B] ☐ Offset Operators, Leaseholders or Surface Owner

[C] ☐ Application is One Which Requires Published Legal Notice

[D] ☒ Notification and/or Concurrent Approval by BLM or SLO
 U.S. Bureau of Land Management - Commissioner of Public Lands, State Land Office

[E] ☐ For all of the above, Proof of Notification or Publication is Attached, and/or,

[F] ☐ Waivers are Attached

[3] SUBMIT ACCURATE AND COMPLETE INFORMATION REQUIRED TO PROCESS THE TYPE OF APPLICATION INDICATED ABOVE.

[4] **CERTIFICATION:** I hereby certify that the information submitted with this application for administrative approval is **accurate** and **complete** to the best of my knowledge. I also understand that **no action** will be taken on this application until the required information and notifications are submitted to the Division.

Note: Statement must be completed by an individual with managerial and/or supervisory capacity.

Erin Workman
 Print or Type Name

Signature

Regulatory Compliance Prof
 Title

05.24.15
 Date

Erin.Workman@dvn.com
 E-mail Address

District I
1625 N. French Drive, Hobbs, NM 88240
District II
1301 W. Grand Ave, Artesia, NM 88210
District III
1000 Rio Brazos Road, Aztec, NM 87410
District IV
1220 S. St Francis Dr, Santa Fe, NM
87505

State of New Mexico
Energy, Minerals and Natural Resources Department

Form C-107-B
Revised June 10, 2003

OIL CONSERVATION DIVISION
1220 S. St Francis Drive
Santa Fe, New Mexico 87505

Submit the original
application to the Santa Fe
office with one copy to the
appropriate District Office.

APPLICATION FOR SURFACE COMMINGLING (DIVERSE OWNERSHIP)

OPERATOR NAME: Devon Energy Production Co., LP
OPERATOR ADDRESS: 333 W Sheridan Avenue, Oklahoma City, OK 73102
APPLICATION TYPE:

☐ Pool Commingling ☒ Lease Commingling ☐ Pool and Lease Commingling ☐ Off-Lease Storage and Measurement (Only if not Surface Commingled)

LEASE TYPE: ☐ Fee ☐ State ☒ Federal

Is this an Amendment to existing Order? ☐ Yes ☒ No If "Yes", please include the appropriate Order No. _____
Have the Bureau of Land Management (BLM) and State Land office (SLO) been notified in writing of the proposed commingling
☒ Yes ☐ No

(A) POOL COMMINGLING
Please attach sheets with the following information

(1) Pool Names and Codes	Gravities / BTU of Non-Commingled Production	Calculated Gravities / BTU of Commingled Production		Calculated Value of Commingled Production	Volumes

- (2) Are any wells producing at top allowables? ☐ Yes ☐ No
(3) Has all interest owners been notified by certified mail of the proposed commingling? ☐ Yes ☐ No.
(4) Measurement type: ☐ Metering ☐ Other (Coriolis Test Method)
(5) Will commingling decrease the value of production? ☐ Yes ☐ No If "yes", describe why commingling should be approved

(B) LEASE COMMINGLING
Please attach sheets with the following information

- (1) Pool Name and Code.
(2) Is all production from same source of supply? ☒ Yes ☐ No
(3) Has all interest owners been notified by certified mail of the proposed commingling? ☒ Yes ☐ No
(4) Measurement type: ☐ Metering ☒ Other (Coriolis Test)

(C) POOL and LEASE COMMINGLING
Please attach sheets with the following information

- (1) Complete Sections A and E.

(D) OFF-LEASE STORAGE and MEASUREMENT
Please attached sheets with the following information

- (1) Is all production from same source of supply? ☒ Yes ☐ No
(2) Include proof of notice to all interest owners.

(E) ADDITIONAL INFORMATION (for all application types)
Please attach sheets with the following information

- (1) A schematic diagram of facility, including legal location.
(2) A plat with lease boundaries showing all well and facility locations. Include lease numbers if Federal or State lands are involved.
(3) Lease Names, Lease and Well Numbers, and API Numbers.

I hereby certify that the information above is true and complete to the best of my knowledge and belief.

SIGNATURE: Erin Workman TITLE: Regulatory Compliance Prof. DATE: 05.24.15

TYPE OR PRINT NAME: Erin Workman TELEPHONE NUMBER: 405-552-7970

E-MAIL ADDRESS: Erin.workman@dvn.com

**Bureau of Land Management
Carlsbad Field Office
620 East Greene Street
Carlsbad, New Mexico 88220
575-234-5972**

**Ragin Cajun 12 Fed 1H, 2H, 3H, NMNM100567 / Ragin Cajun 13 Fed 1H, 2H, Rattlesnake 13 Fed 2H, NMNM100568 /
Ragin Cajun 14 Fed 1H, NMNM94118**

**Devon Energy Production Co.
July 27, 2015**

Condition of Approval

Commingling of lease production, variance to use Coriolis meter for oil measurement

1. This approval is subject to like approval by the New Mexico Oil Conservation Division.
2. This agency shall be notified of any spill or discharge as required by NTL-3A.
3. This agency reserves the right to modify or rescind approval whenever it determines continued use of the approved method may adversely affect the surface or subsurface environments.
4. This approval does not constitute right-of-way approval for any off-lease activities. Within 30 days, an application for right-of-way approval must be submitted to the Realty Section if not already done.
5. Approval for combining production from various sources is a privilege which is granted to lessees for the purpose of aiding conservation and extending the economic life of leases. Applicants should be cognizant that failure to operate in accordance with the provisions outlined in the Authorized Officer's conditions of approval and/or subsequent stipulations or modifications will subject such approval to revocation.
6. Gas measurement for allocation must be measured as per Onshore Order #5 for sales meters.
7. All gas and oil subject to royalty shall be measured as per federal regulations and shall be reported to ONRR as required. All gas which is vented, flared or used on lease shall be reported as per NTL-4A to ONRR. All gas which is vented or flared shall be subject to royalty, unless prior approval was given by the authorized officer.
8. This agency shall be notified of any change in sales method or location of sales point.
9. Additional wells and/or leases require additional commingling approvals.
10. Notify this office 24 Hrs. prior to any meter proving to allow time for an inspector to witness.
11. Variance to Onshore Order #4 oil measurement to use Coriolis meters is approved with this approval.
12. Need to provide meter numbers upon installation.

The approval of this commingling is as per Category I of IM NMPO-2013-02. These wells are on three different leases and have the same royalty rate (12.5%). By combining the production of these leases the royalty value will not be affected due to the production all being Delaware. The BTU value of the production is similar being Delaware gas. Therefore the commingling of these leases will have no royalty rate or royalty value issues do to everything being the similar. This does not mean that the allocation of production to each lease will be 100% accurate each month. By approving this request it will only guarantee that the public's interest will not be compromised.