

HOBBS OGD

SEP 21 2015

District I
1635 N. French Dr., Hobbs, NM 88240
Phone: (575) 393-6161 Fax: (575) 393-0720

District II
811 S. First St., Artesia, NM 88210
Phone: (575) 748-1283 Fax: (575) 748-9720

District III
1000 Rio Brazos Road, Aztec, NM 87410
Phone: (505) 334-6178 Fax: (505) 334-6170

District IV
1220 S. St. Francis Dr., Santa Fe, NM 87505
Phone: (505) 476-3460 Fax: (505) 476-3462

State of New Mexico
Energy, Minerals & Natural Resources Department
OIL CONSERVATION DIVISION
1220 South St. Francis Dr.
Santa Fe, NM 87505

RECEIVED Form C-102
Revised August 1, 2011
Submit one copy to appropriate
District Office

☐ AMENDED REPORT

WELL LOCATION AND ACREAGE DEDICATION PLAT

¹ API Number 30-025-42800	² Pool Code 97838	³ Pool Name Jennings, Upper BONESpringShale
⁴ Property Code 315268	⁵ Property Name SD WE 14 FED P5	
⁷ OGRID No 4323	⁸ Operator Name CHEVRON U.S.A. INC.	⁶ Well Number 1H
		⁹ Elevation 3157'

¹⁰ Surface Location

UL or lot no.	Section	Township	Range	Lot Idn	Feet from the	North/South line	Feet from the	East/West line	County
M	14	26 SOUTH	32 EAST, N.M.P.M.		10'	SOUTH	623'	WEST	LEA

¹¹ Bottom Hole Location If Different From Surface

UL or lot no.	Section	Township	Range	Lot Idn	Feet from the	North/South line	Feet from the	East/West line	County
D	14	26 SOUTH	32 EAST, N.M.P.M.		280'	NORTH	330'	WEST	LEA

¹² Dedicated Acres 160	¹³ Joint or Infill	¹⁴ Consolidation Code	¹⁵ Order No.
--------------------------------------	-------------------------------	----------------------------------	-------------------------

No allowable will be assigned to this completion until all interests have been consolidated or a non-standard unit has been approved by the division.

<p>Proposed Last Take Point 330' FNL, 333' FWL</p> <p>Proposed Producing Interval N 03°28'26"W 5,063.91'</p> <p>Proposed First Take Point 330' FSL, 605' FWL</p>	<p>PROPOSED BOTTOM HOLE LOCATION</p> <p>X= 710,910 NAD 27 Y= 382,366 LAT. 32.049411 LONG. 103.652607</p> <p>X= 752,097 NAD83 Y= 382,423 LAT. 32.049536 LONG. 103.653077</p>	<p>¹⁷ OPERATOR CERTIFICATION</p> <p>I hereby certify that the information contained herein is true and complete to the best of my knowledge and belief, and that this organization either owns a working interest or unleased mineral interest in the land including the proposed bottom hole location or has a right to drill this well at this location pursuant to a contract with an owner of such a mineral or working interest, or to a voluntary pooling agreement or a compulsory pooling order heretofore entered by the division</p> <p>Signature: <u>Cindy Herrera-Murillo</u> Date: <u>4-27-15</u></p> <p>Printed Name: <u>Cindy Herrera-Murillo</u></p> <p>E-mail Address: <u>Cherreramurillo@chevron.com</u></p>
	<p>CORNER COORDINATES TABLE (NAD 27)</p> <p>A - Y=382643.92, X=710579.74 B - Y=382652.25, X=711907.34 C - Y=378633.33, X=710590.73 D - Y=378643.30, X=711921.56 E - Y=377296.47, X=710594.39 F - Y=377306.99, X=711926.30</p>	<p>¹⁸ SURVEYOR CERTIFICATION</p> <p>I hereby certify that the well location shown on this plat was plotted from field notes of actual surveys made by me or under my supervision, and that the same is true and correct to the best of my belief.</p> <p>Date of Survey: <u>10-29-14</u></p> <p>Signature and Seal of Professional Surveyor: <u>[Signature]</u></p> <p>Certification Number: <u>#15078</u></p>

SEP 22 2015

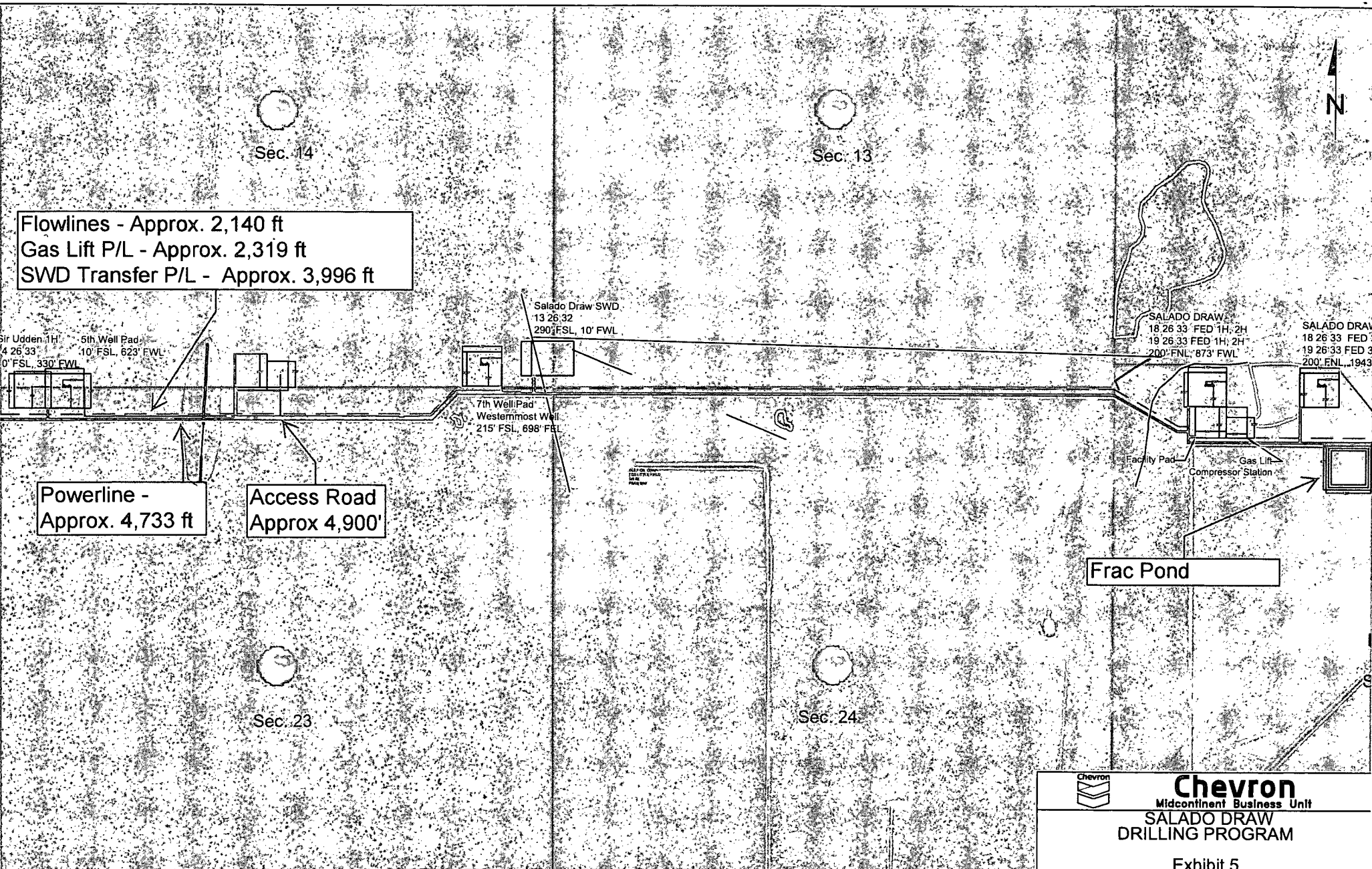
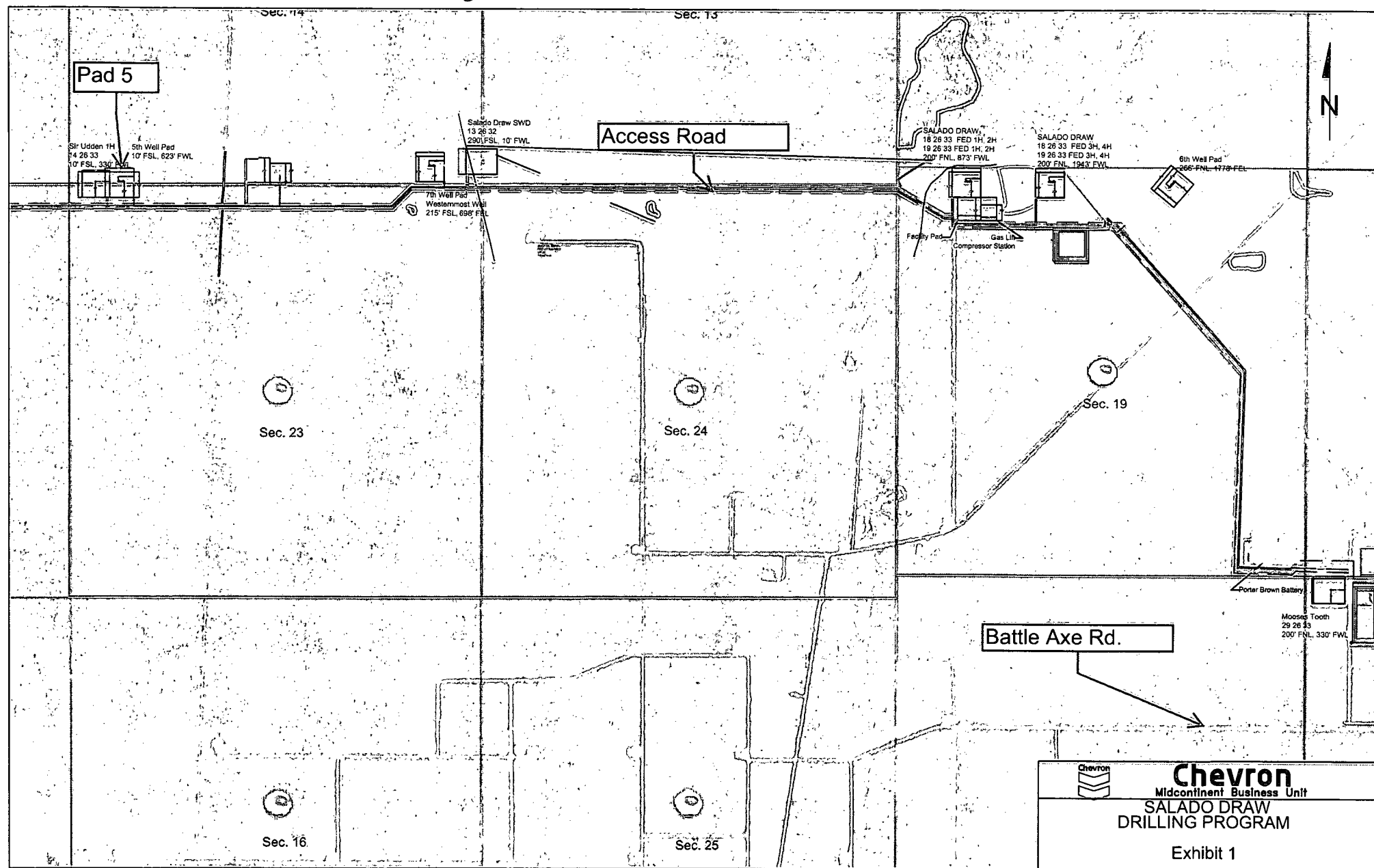

Exhibit 1



Chevron
Midcontinent Business Unit

**SALADO DRAW
DRILLING PROGRAM**

Exhibit 1

WE 14 FED P5 1H
TWN 26S - RNG 32E - SEC 14
LEA, CO NM

Surface and Bottom hole locations - 1 mile radius

Exhibit 3

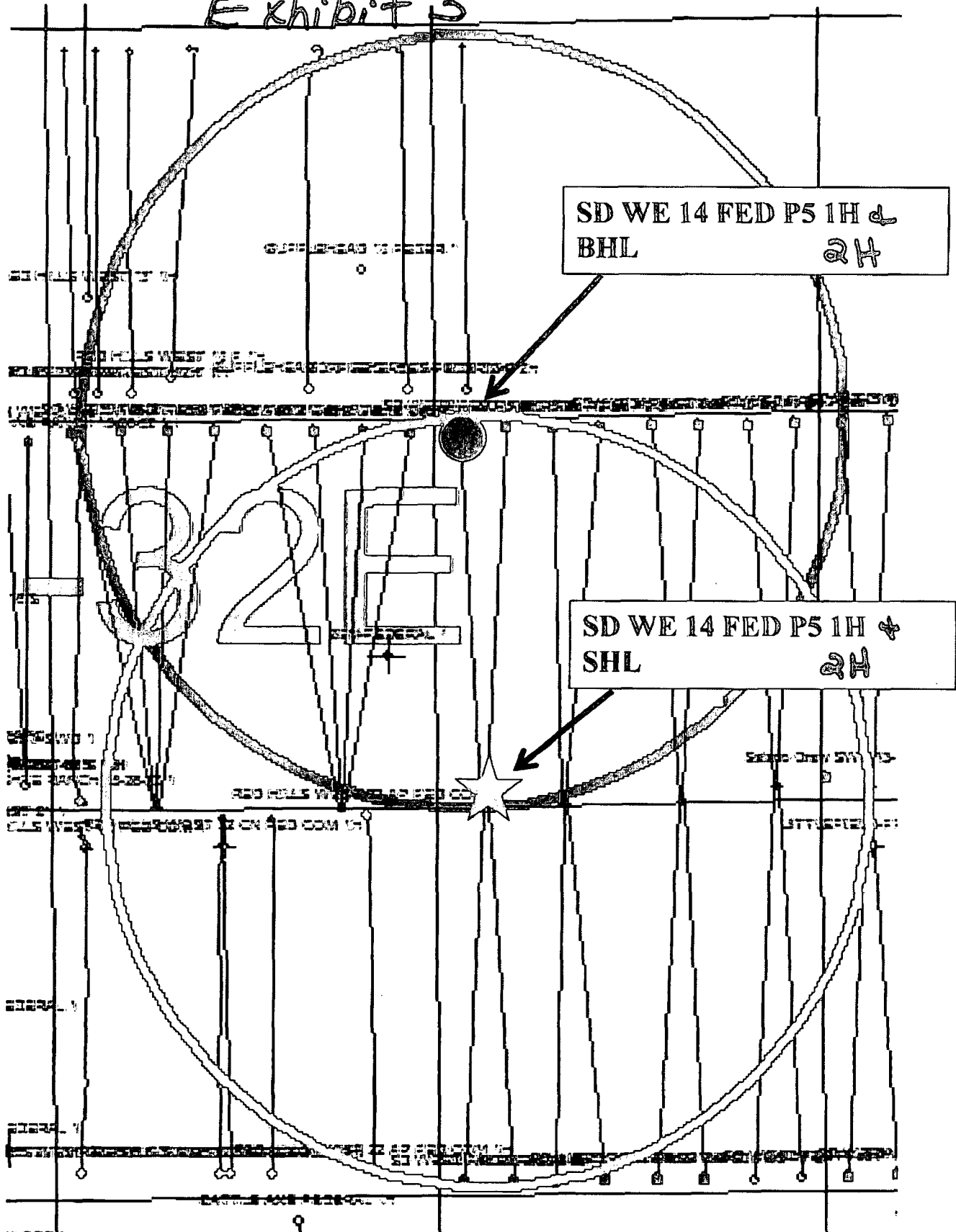

Exhibit 2

R 32 E

Sec. 14

Bureau of Land Management

SEE
PAGE 1

T
26
S

FOR THE EXCLUSIVE USE OF
CHEVRON U.S.A. INC.
I, WM. J. Daniel III, Registered Professional
Land Surveyor, do hereby state this plat is true
and correct to the best of my knowledge.



WM. J. Daniel III
Registration No. 15078

NOTE

Please be advised, that while reasonable efforts are made to locate and verify pipelines and anomalies using our standard pipeline locating equipment, it is impossible to be 100 % effective. As such, we advise using caution when performing work as there is a possibility that pipelines and other hazards, such as fiber optic cables, PVC pipelines, etc. may exist undetected on site.

NOTE

Many states maintain information centers that establish links between those who dig (excavators) and those who own and operate underground facilities (operators). It is advisable and in most states, law, for the contractor to contact the center for assistance in locating and marking underground utilities. For guidance: New Mexico One Call - www.nmonecall.org

DISCLAIMER: At this time, C.H. Fenstermaker & Associates, LLC has not performed nor was asked to perform any type of engineering, hydrological modeling, flood plain, or "No Rise" certification analyses, including but not limited to determining whether the project will impact flood hazards in connection with federal/FEMA, state, and/or local laws, ordinances and regulations. Accordingly, Fenstermaker makes no warranty or representation of any kind as to the foregoing issues, and persons or entities using this information shall do so at their own risk.

**PROPOSED
ACCESS ROAD
14' X $\pm 4,868'$
 ± 1.58 Acres
 ± 295.03 Rods**

Sec. 23

Bureau of Land Management

LEGEND

Section Line

Ferica Line

Exit

Existing P.O.

SURFACE USE PLAT

CHEVRON U.S.A. INC.
PROPOSED PAD & ACCESS ROAD
SIR UDDEN NO. 1H WELL
SECTIONS 14 & 23, T26S-R32E
LEA COUNTY, NEW MEXICO

Page 2 of 2

DRAWN BY: BOR

REVISIONS

PROJ. MGR.: VHV

☐ No

DATE:

DATE:

REVISSED BY:

DATE: AUGUST 27 2014

4. Also

DATE:

REVISER BY:

FILENAME: T:\2014\2146715\DWG\Sir Udden 1H SUP.dwg



135 Regency Sq. Lafayette, LA 70508
Ph. 337-237-2200 Fax. 337-232-3299
www.fanatemaker.com

www.fenatormaker.com

Exhibit 5

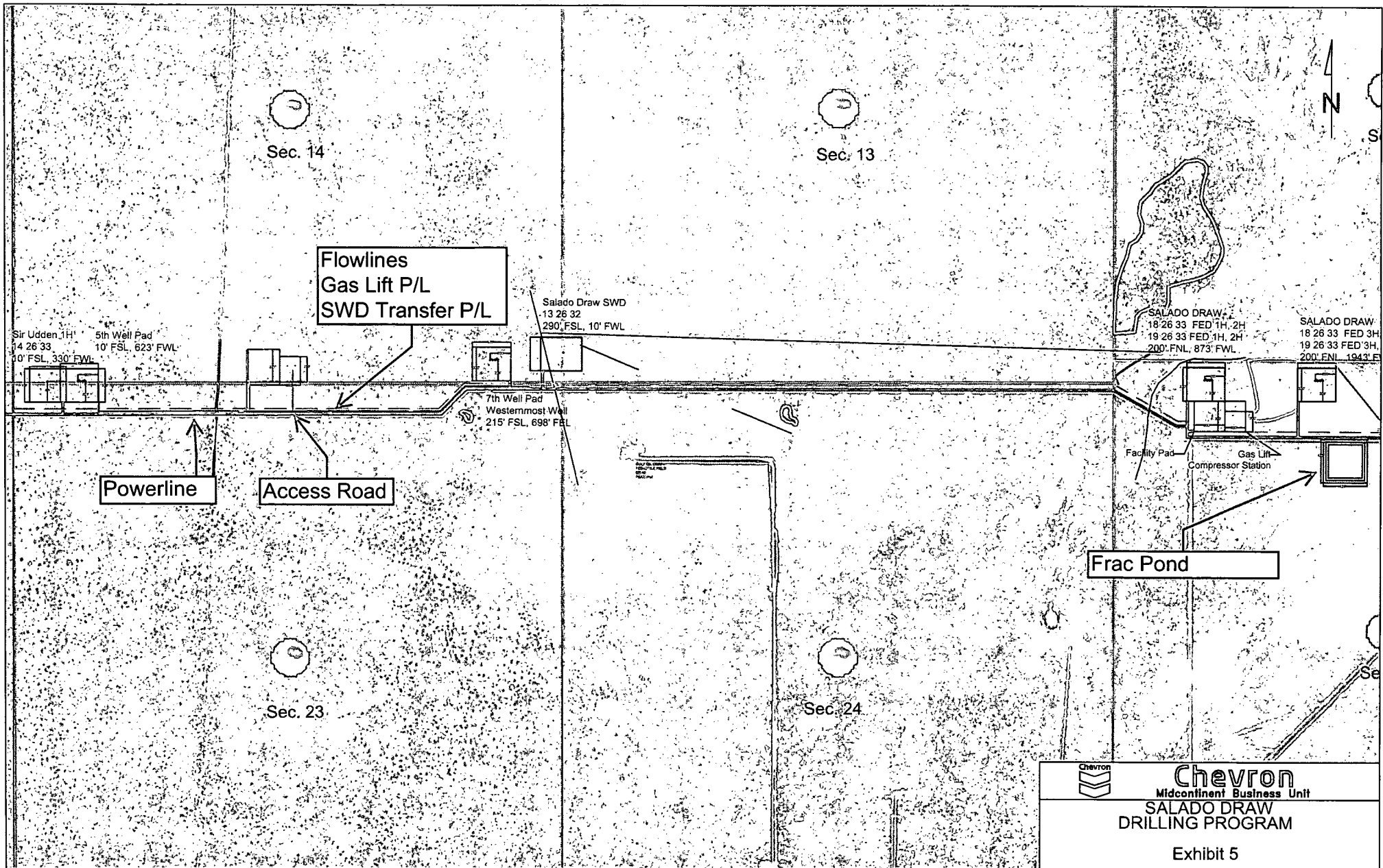

Chevron
Midcontinent Business Unit
SALADO DRAW
DRILLING PROGRAM

Exhibit 5

Exhibit 6a

R 32 E

Sec. 14

Bureau of Land Management

SD WE 14 FED P5 1H WELL	
X=	711,217 NAD 27
Y=	377,311
LAT.	32 035512
LONG.	103 661720
X=	752,405 NAD83
Y=	377,369
LAT.	32 035637
LONG.	103 662189
ELEVATION +3157' NAVD 88	
NW PAD CORNER	
X=	711,047 NAD 27
Y=	377,435
ELEVATION +3157' NAVD 88	
NE PAD CORNER & SE TOP SOIL AREA CORNER	
X=	711,417 NAD 27
Y=	377,438
ELEVATION +3157' NAVD 88	
SE PAD CORNER	
X=	711,415 NAD 27
Y=	377,108
ELEVATION +3152' NAVD 88	
SW PAD CORNER	
X=	711,045 NAD 27
Y=	377,105
ELEVATION +3157' NAVD 88	

NW TOP SOIL AREA CORNER	
X=	711,103 NAD 27
Y=	377,475
ELEVATION +3157' NAVD 88	
NE TOP SOIL AREA CORNER	
X=	711,415 NAD 27
Y=	377,478
ELEVATION +3157' NAVD 88	
SW TOP SOIL AREA CORNER	
X=	711,103 NAD 27
Y=	377,435
ELEVATION +3158' NAVD 88	

NW ARCH. AREA CORNER	
X=	710,915 NAD 27
Y=	377,809
ELEVATION +3158' NAVD 88	
NE ARCH. AREA CORNER	
X=	711,590 NAD 27
Y=	377,815
ELEVATION +3159' NAVD 88	
SE ARCH. AREA CORNER	
X=	711,595 NAD 27
Y=	377,015
ELEVATION +3154' NAVD 88	
SW ARCH. AREA CORNER	
X=	710,920 NAD 27
Y=	377,009
ELEVATION +3154' NAVD 88	

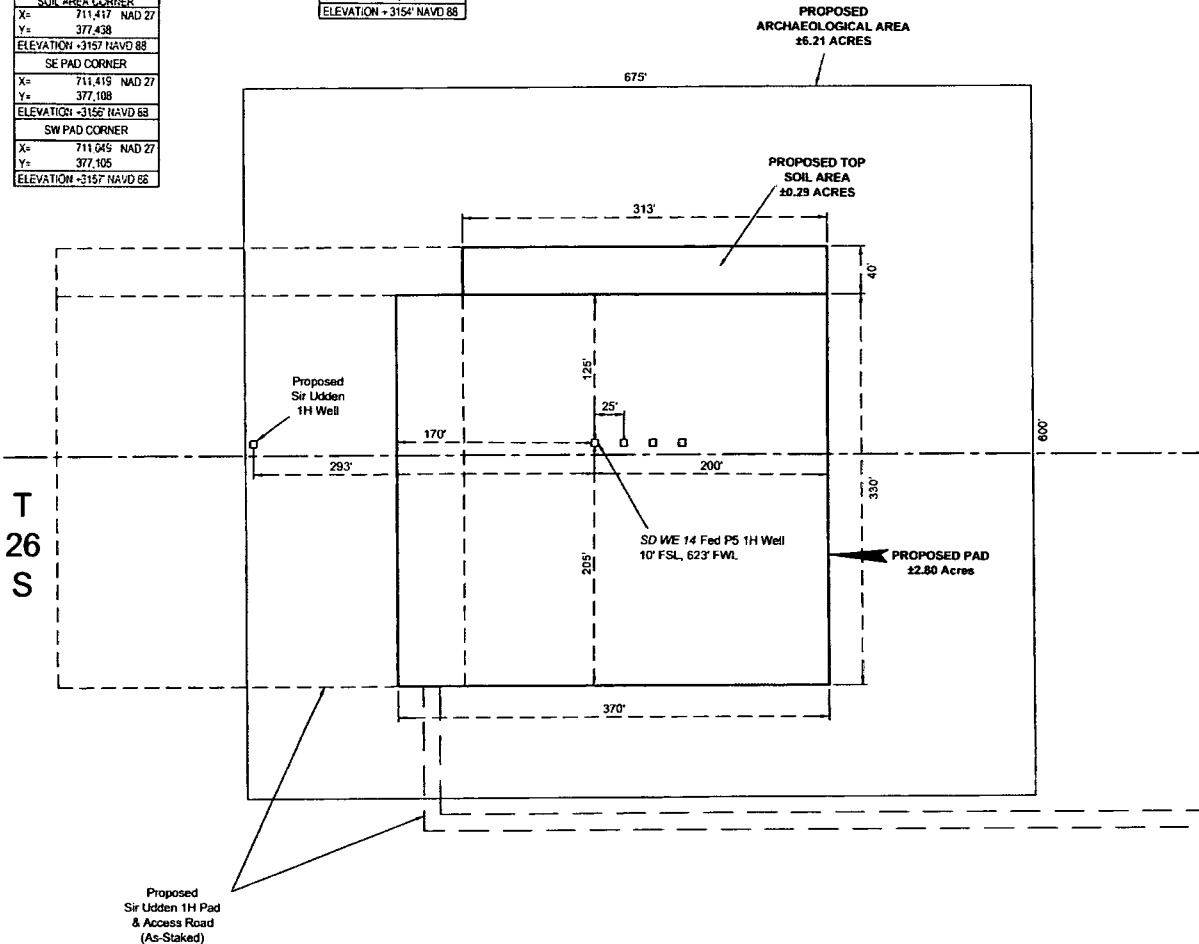

Sec. 23

Bureau of Land Management

FOR THE EXCLUSIVE USE OF
CHEVRON U.S.A. INC.
I, WM. J. DANIEL III, Registered Professional
Land Surveyor, do hereby state this plat is true
and correct to the best of my knowledge.



WM. J. DANIEL III
Registration No. 15078

NOTE:
Please be advised, that while reasonable efforts are made to locate and verify pipelines and anomalies using our standard pipeline locating equipment, it is impossible to be 100 % effective. As such, we advise using caution when performing work as there is a possibility that pipelines and other hazards, such as fiber optic cables, PVC pipelines, etc. may exist undetected on site.

NOTE:
Many states maintain information centers that establish links between those who dig (excavators) and those who own and operate underground facilities (operators). It is advisable and in most states, law, for the contractor to contact the center for assistance in locating and marking underground utilities. For guidance, New Mexico One Call, www.nmonecall.org.

DISCLAIMER: At this time, C.H. Fenstermaker & Associates, LLC has not performed nor was asked to perform any type of engineering, hydrological modeling, flood plain, or "No Rise" certification analyses, including but not limited to determining whether the project will impact flood hazards in connection with federal/FEMA, state, and/or local laws, ordinances and regulations. Accordingly, Fenstermaker makes no warranty or representation of any kind as to the foregoing issues, and persons or entities using this information shall do so at their own risk.

LEGEND			
---	Section Line		
□	Proposed Well		
---	Proposed Road		

CHEVRON U.S.A. INC.

PROPOSED PAD
SD WE 14 FED P5 1H WELL
SECTIONS 14 & 23, T26S-R32E
LEA COUNTY, NEW MEXICO



135 Regency Sq. Lafayette, LA 70508
Ph. 337-237-2200 Fax. 337-232-3299
www.fenstermaker.com

Scale: 1"=100'
100' 0 50' 100'

DRAWN BY: TPD		REVISIONS			
PROJ. MGR: VHV	No.	DATE:		REVISED BY:	
DATE: OCTOBER 14, 2014	No.	DATE:		REVISED BY:	
FILENAME: T:\2014\2146716\DWG\SD WE 14 Fed P5 1H_SUP.dwg					

Exhibit 7

R 32 E

Sec. 14

Bureau of Land Management

SD WE 14 FED P5 1H WELL
X= 711,217 NAD 27
Y= 377,311
LAT. 32 035512
LONG 103 651720
X= 752,405 NAD83
Y= 377,369
LAT. 32 035637
LONG 103 652189
ELEVATION +3157 NAVD 88
NW PAD CORNER
X= 711,047 NAD 27
Y= 377,435
ELEVATION +3157 NAVD 88
NE PAD CORNER & SE TOP SOIL AREA CORNER
X= 711,417 NAD 27
Y= 377,438
ELEVATION +3157 NAVD 88
SE PAD CORNER
X= 711,415 NAD 27
Y= 377,108
ELEVATION +3156 NAVD 88
SW PAD CORNER
X= 711,045 NAD 27
Y= 377,105
ELEVATION +3157 NAVD 88

NW TOP SOIL AREA CORNER
X= 711,103 NAD 27
Y= 377,475
ELEVATION +3157 NAVD 88
NE TOP SOIL AREA CORNER
X= 711,415 NAD 27
Y= 377,478
ELEVATION +3157 NAVD 88
SW TOP SOIL AREA CORNER
X= 711,103 NAD 27
Y= 377,435
ELEVATION +3158 NAVD 88

NW ARCH. AREA CORNER
X= 710,915 NAD 27
Y= 377,609
ELEVATION +3158 NAVD 88
NE ARCH. AREA CORNER
X= 711,590 NAD 27
Y= 377,615
ELEVATION +3159 NAVD 88
SE ARCH. AREA CORNER
X= 711,595 NAD 27
Y= 377,015
ELEVATION +3154 NAVD 88
SW ARCH. AREA CORNER
X= 710,920 NAD 27
Y= 377,009
ELEVATION +3154 NAVD 88

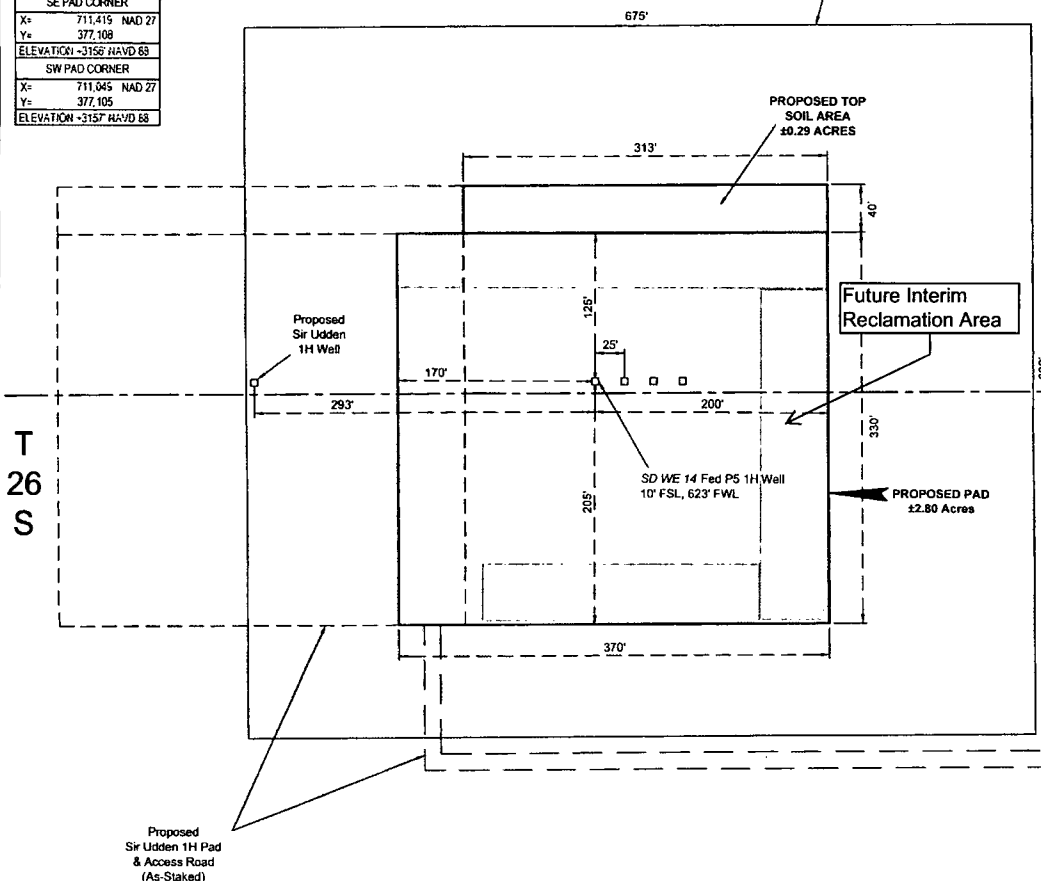

Sec. 23

Bureau of Land Management

FOR THE EXCLUSIVE USE OF
CHEVRON U.S.A. INC.
I, WM. J. DANIEL III, Registered Professional
Land Surveyor, do hereby state this plat is true
and correct to the best of my knowledge.



WM. J. DANIEL III
Registration No. 15078

NOTE:
Please be advised, that while reasonable efforts are made to locate and verify pipelines and anomalies using our standard pipeline locating equipment, it is impossible to be 100 % effective. As such, we advise using caution when performing work as there is a possibility that pipelines and other hazards, such as fiber optic cables, PVC pipelines, etc. may exist undetected on site.

NOTE:
Many states maintain information centers that establish links between those who dig (excavators) and those who own and operate underground facilities (operators). It is advisable and in most states, law, for the contractor to contact the center for assistance in locating and marking underground utilities. For guidance, New Mexico One Call, www.nmonecall.org.

DISCLAIMER: At this time, C.H. Fenstermaker & Associates, LLC has not performed nor was asked to perform any type of engineering, hydrological modeling, flood plain, or "No Rise" certification analyses, including but not limited to determining whether the project will impact flood hazards in connection with federal/FEMA, state, and/or local laws, ordinances and regulations. Accordingly, Fenstermaker makes no warranty or representation of any kind as to the foregoing issues, and persons or entities using this information shall do so at their own risk.

LEGEND			
---	Section Line		
□	Proposed Well		
---	Proposed Road		

CHEVRON U.S.A. INC.

PROPOSED PAD

SD WE 14 FED P5 1H WELL

SECTIONS 14 & 23, T26S-R32E

LEA COUNTY, NEW MEXICO



135 Regency Sq. Lafayette, LA 70508
Ph. 337-237-2200 Fax. 337-232-3299
www.fenstermaker.com

Scale: 1"=100'
100' 0 50' 100'

DRAWN BY: TPD	REVISIONS		
PROJ. MGR.: VHV	No.	DATE:	REVISED BY:
DATE: OCTOBER 14, 2014	No.	DATE:	REVISED BY:
FILENAME: T:\2014\2146716\DWG\SD WE 14 Fed P5 1H_SUP.dwg			

**Boone Arch Services of NM, LLC
506 E. Chapman Road
Carlsbad, NM 88220**



November 13, 2014

Chevron U.S.A, Inc.
15 Smith Road
Midland, TX 79705
Attn: Stephen Tarr

Re: SD WE 23 Fed P5 #1H & #2H and SD WE 14 Fed P5 #1H & #2H

Dear Mr. Tarr,

Records searches were conducted on November 4, 2014, for the proposed SD WE 23 Fed P5 #1H, SD WE 23 Fed P5 #2H, SD WE 14 Fed P5 #1H and SD WE 14 Fed P5 #2H well pad in Township 26 South (T26S), Range 32 East (R32E), Sections 14 and 23. All wells will be on a single pad.

Sources consulted included Bureau of Land Management Carlsbad Field Office (BLM/CFO) GIS database and the online GIS database maintained by the New Mexico Historic Preservation Division, Archaeological Resource Management Section, in Santa Fe, NM. These records indicate archaeological survey coverage of the project area (NMCRIS #s: 63533, 126220, and 130167). No archaeological sites have been found in the project area and only one site has been previously recorded within a ¼-mile radius.

In consultation with BLM archaeologist Stacy Galassini, it was determined that no additional survey is required. The project is recommended for approval without further archaeological survey as currently staked. A copy of this letter will be forwarded to the BLM Carlsbad archaeologist.

Legal Description: T26S R32E Section 14 S½ SW SW and 23 N½ NW NW, Lea County, New Mexico

Map Reference: U.S.G.S. 7.5' Paduca Breaks West 32103-A6

Sincerely,

Rebecca Hill
Owner/Principal Investigator
Boone Arch Services of NM, LLC

Encl: (1) project map
(2) NMCRIS Map

Office: 575-885-1352







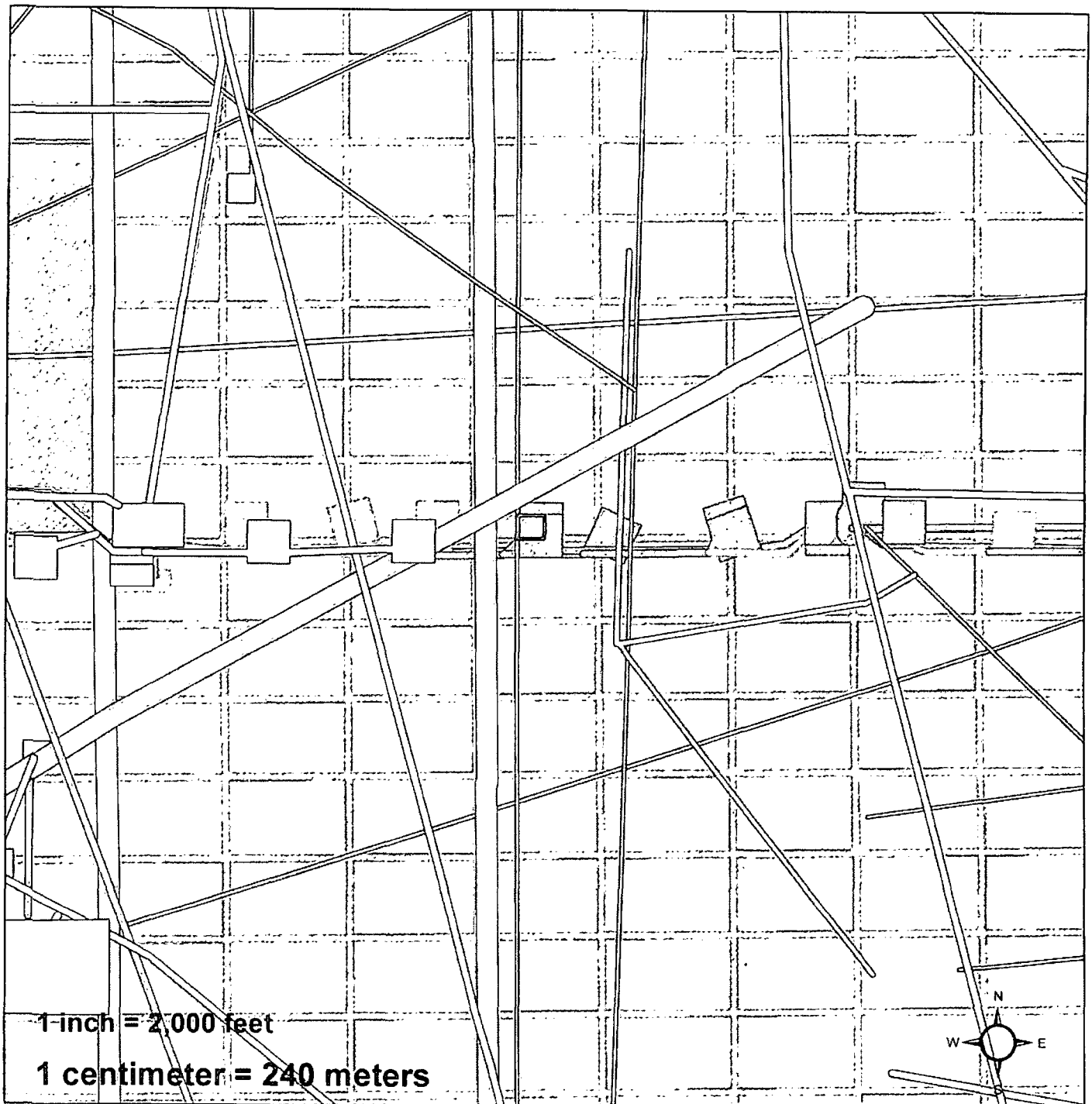



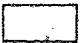

Cell: 575-361-1353

Fax: 575-887-7667

Chevron U.S.A. Inc.
SD WE 23 Fed P5 #1H & #2H and SD WE
14 Fed P5 #1H & #2H



Legend

	WellPad		BLM		NPS
	Arch Sites		BOR		Private
			DOE		NM State Trust Lands
			Forest Service		NM State Game & Fish
			BOI		NM State Park

Paduca Breaks West 32103-A6
T26S R32E S14, 23

1:24,000

BASNM 10-14-15

10-14-15 ARMS Map

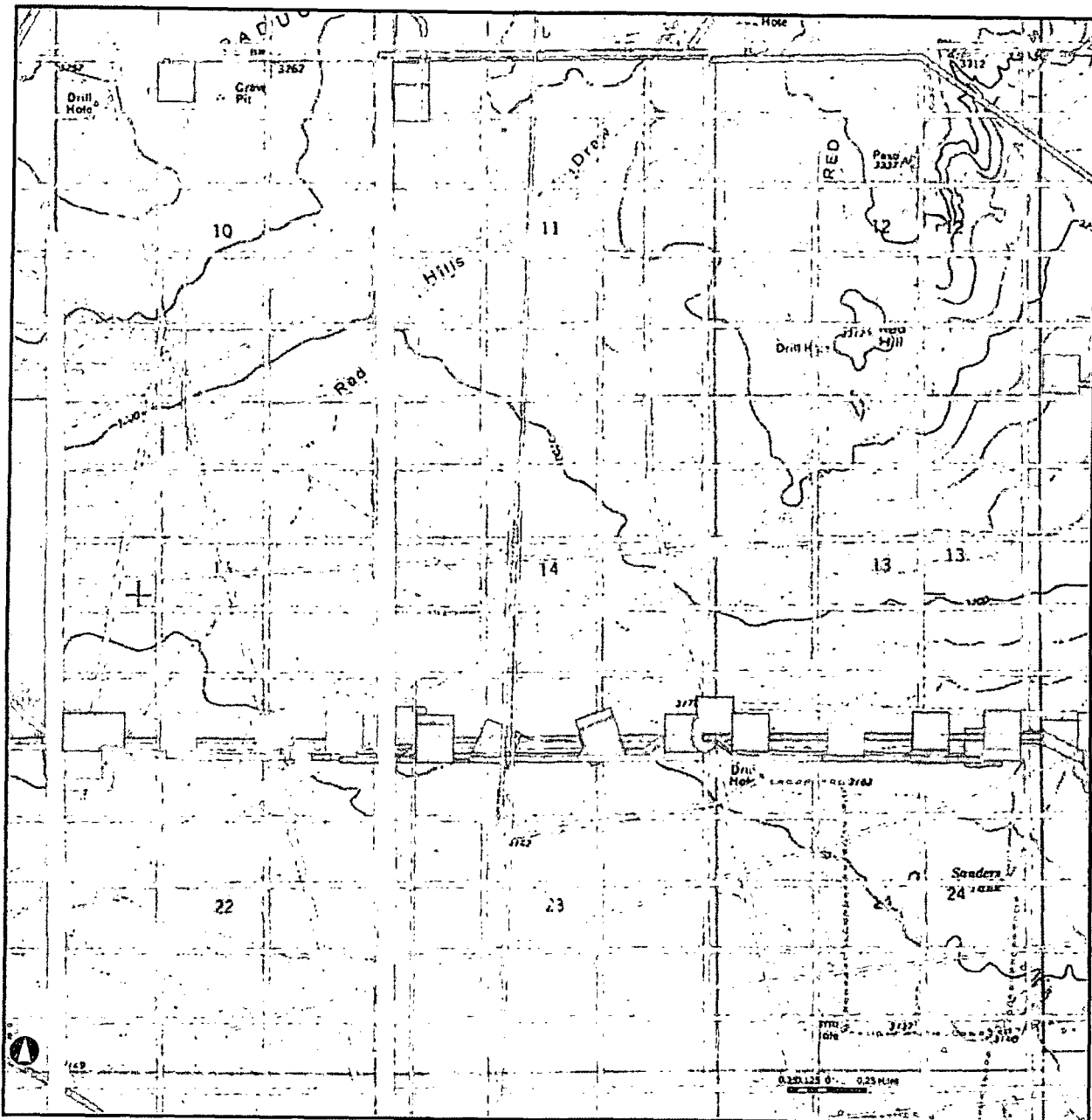

PLSS
☐ Building Labels
 ♦ Object Labels
 ♦ Linear Resource Labels
 ♦ Historic Structure Labels
 ♦ Historic Structures (Edit)

Objects
☐ Not Defined
☐ Proposed
☐ Approved
 Linear Resources
☐ Not Defined
☐ Proposed
☐ Approved
 District Labels
 ♦

Archaeological Surveys
☐ Not Defined
☐ Proposed
 ♦ Approved
 Highways
 — Primary Limited Access or Interstate
 — Primary US and State Highways
 — Secondary State and County
 — Local - Rural

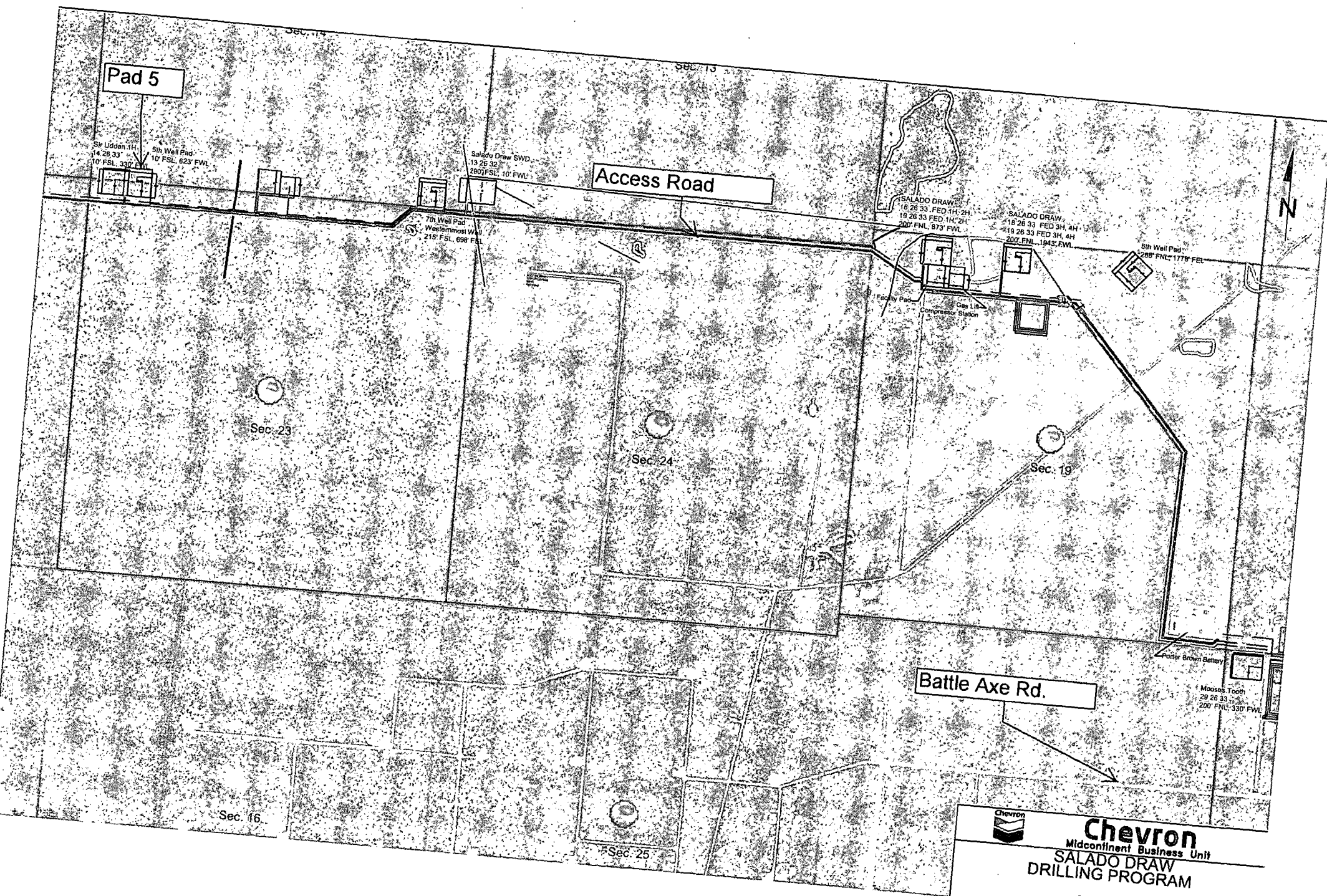

Chevron
Midcontinent Business Unit
SALADO DRAW
DRILLING PROGRAM