

FIRST PERFORATION POINT
NEW MEXICO EAST
NAD 1927
X=771368
Y=584234
LAT.: N 32.6030731
LONG.: W 103.4521374

SURFACE LOCATION
NEW MEXICO EAST
NAD 1927
X=771383
Y=584738
LAT.: N 32.6044583
LONG.: W 103.4520418

LAST PERFORATION POINT
NEW MEXICO EAST
NAD 1927
X=776001
Y=584265
LAT.: N 32.6030529
LONG.: W 103.4370932

BOTTOM HOLE LOCATION
NEW MEXICO EAST
NAD 1927
X=776091
Y=584266
LAT.: N 32.6030525
LONG.: W 103.4368010

Other Labels:
FND. BRASS CAP (multiple locations)
FND. IRON PIPE
Bearings: N 89°44'21" E 5283.22', S 89°39'39" W 2666.77', S 89°44'14" W 2652.04', 60°39'21" N 57-11.00' N, 60°32'29" E 5302.66'

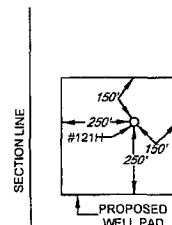
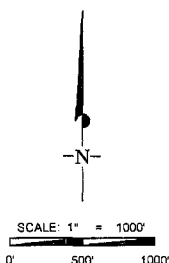

DETAIL VIEW
SCALE: 1" = 500'

THIS EASEMENT/SERVITUDE LOCATION SHOWN HEREON HAS BEEN SURVEYED ON THE GROUND UNDER MY SUPERVISION AND PREPARED ACCORDING TO THE EVIDENCE FOUND AT THE TIME OF SURVEY, AND DATA PROVIDED BY MATADOR PRODUCTION COMPANY. THIS CERTIFICATION IS MADE AND LIMITED TO THOSE PERSONS OR ENTITIES SHOWN ON THE FACE OF THIS PLAT AND IS NON-TRANSFERABLE. THIS SURVEY IS CERTIFIED FOR THIS TRANSACTION ONLY.

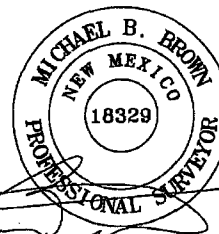

 **TOPOGRAPHIC**
LOYALTY INNOVATION LEGACY

1400 EVERMAN PARKWAY, Ste. 197 • FT. WORTH, TEXAS 76140
TELEPHONE: (817) 744-7512 • FAX (817) 744-7548
2905 NORTH BIG SPRING • MIDLAND, TEXAS 79705
TELEPHONE (432) 682-1653 OR (800) 767-1653 • FAX (432) 682-1743
WWW.TOPOGRAPHIC.COM

SEP 25 2015