

District I  
1625 N. French Dr., Hobbs, NM 88240  
Phone: (575) 393-6161 Fax: (575) 398-9720  
District II  
811 S. First St., Artesia, NM 88210  
Phone: (575) 748-1283 Fax: (575) 748-9720  
District III  
1000 Rio Brazos Road, Aztec, NM 87410  
Phone: (505) 334-6178 Fax: (505) 334-6170  
District IV  
1220 S. St. Francis Dr., Santa Fe, NM 87505  
Phone: (505) 476-3460 Fax: (505) 476-3462

**HOBBS OCD**  
**MAY 09 2016**  
**RECEIVED**

State of New Mexico  
Minerals & Natural Resources Department  
OIL CONSERVATION DIVISION  
1220 South St. Francis Dr.  
Santa Fe, NM 87505

Form C-102  
Revised August 1, 2011  
Submit one copy to appropriate  
District Office

☐ AMENDED REPORT

WELL LOCATION AND ACREAGE DEDICATION PLAT

1 API Number 30-025- <b>43222</b>		2 Pool Code 22900		3 Pool Name EUNICE; BLI-TU-DR, N.					
4 Property Code 37346		5 Property Name <b>WEST BLINEBRY DRINKARD UNIT</b>				6 Well Number <b>176</b>			
7 GRID NO. 873		8 Operator Name <b>APACHE CORPORATION</b>				9 Elevation <b>3481'</b>			
10 Surface Location									
UL or lot no. <b>0</b>	Section <b>9</b>	Township <b>21S</b>	Range <b>37E</b>	Lot Idn	Feet from the <b>260</b>	North/South line <b>SOUTH</b>	Feet From the <b>1875</b>	East/West line <b>EAST</b>	County <b>LEA</b> ✓
11 Bottom Hole Location If Different From Surface									
UL or lot no. <b>0</b>	Section <b>9</b>	Township <b>21S</b>	Range <b>37E</b>	Lot Idn	Feet from the <b>175</b>	North/South line <b>SOUTH</b>	Feet from the <b>1970</b>	East/West line <b>EAST</b>	County <b>LEA</b> ✓
12 Dedicated Acres <b>40</b>		13 Joint or Infill		14 Consolidation Code		15 Order No.			

No allowable will be assigned to this completion until all interest have been consolidated or a non-standard unit has been approved by the division.

<p>16</p> <p>GEODETIC DATA NAD 27 GRID - NM EAST</p> <p>SURFACE LOCATION N: 542770.0 - E: 860244.9 LAT: 32.48676226° N LONG: 103.16505343° W</p> <p>BOTTOM HOLE N: 542684.1 - E: 860150.9 LAT: 32.48652904° N LONG: 103.16536118° W</p> <p>CORNER DATA NAD 27 GRID - NM EAST</p> <p>A: FOUND BRASS CAP "1911" N 542476.5 - E 856839.2</p> <p>B: FOUND BRASS CAP "1911" N 545117.3 - E 856810.5</p> <p>C: FOUND BRASS CAP "1911" N 547759.2 - E 856780.2</p> <p>D: FOUND BRASS CAP "1911" N 547810.3 - E 862065.7</p> <p>E: FOUND ALUM CAP N 542528.3 - E 862122.5</p> <p>F: FOUND BRASS CAP "1911" N 542502.6 - E 859480.8</p> <p>DETAIL "A"</p> <p>SEE DETAIL "A"</p> <p>S. L.</p> <p>B. H.</p> <p>175'</p> <p>260'</p> <p>1875'</p> <p>1970'</p> <p>S 47°34'26" W (GRID) 127.32' (HORIZ.)</p> <p>S 89°26'00" W 2641.97'</p>		<p>17 OPERATOR CERTIFICATION</p> <p>I hereby certify that the information contained herein is true and complete to the best of my knowledge and belief, and that this organization either owns a working interest or unleased mineral interest in the land including the proposed bottom hole location or has a right to drill this well at this location pursuant to a contract with an owner of such a mineral or working interest, or to a voluntary pooling agreement or a compulsory pooling order heretofore entered by the division.</p> <p><i>Sorina L Flores</i> 3/11/16 Signature Sorina L Flores Printed Name sorina.flores@apachecorp.com E-mail Address</p> <p>18 SURVEYOR CERTIFICATION</p> <p>I hereby certify that the well location shown on this plat was plotted from field notes of actual surveys made by me or under my supervision, and that the same is true and correct to the best of my belief.</p> <p>1-29-2016 Date of Survey Signature and Seal of Professional Surveyor 19680 Certificate Number</p> <p>ROBERT M. HOWETT NEW MEXICO 19680 PROFESSIONAL SURVEYOR</p>
---	--	--

RRC - Firm No.: TX 10193838 NM 4655451 - Job No.: LS1601034

MAY 12 2016

APACHE CORPORATION  
WEST BLINEBRY DRINKARD UNIT #176  
(260' FSL & 1875' FEL)  
SECTION 9, T21S, R37E  
N. M. P. M., LEA COUNTY, NEW MEXICO

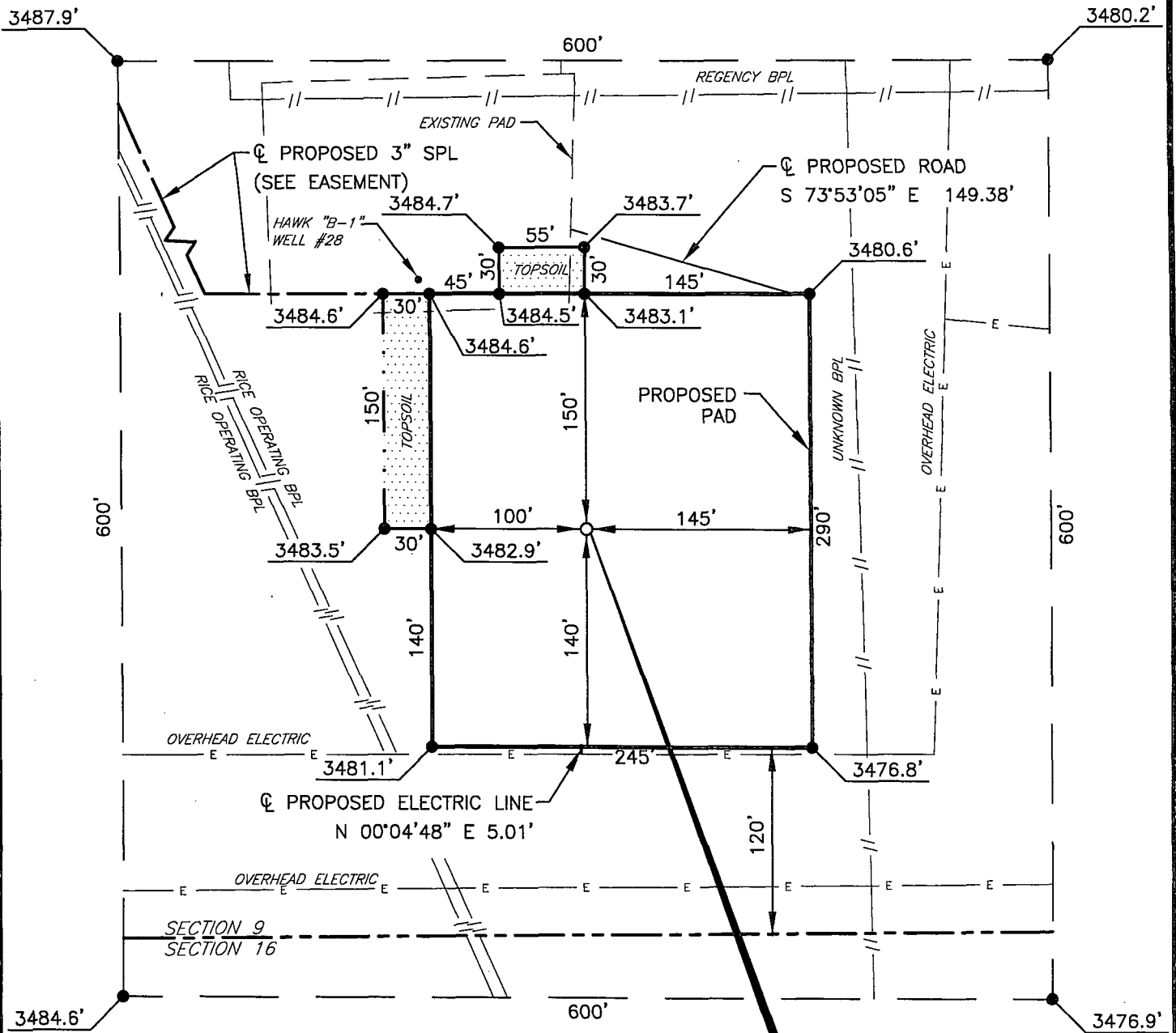

WEST BLINEBRY DRINKARD UNIT #176  
ELEV.: 3481'  
LAT: 32.48676226° N (NAD27)  
LONG: 103.16505343° W (NAD27)

DIRECTIONS TO LOCATION

From the intersection of CR-49 (Hill Rd.) and CR-33 (Turner Rd.);  
Go Southeast on CR-49 approx. 0.6 miles to a lease road on the left;  
Turn left and go East approx. 0.3 miles to location approx. 800 feet on the right.

I, R. M. Howett, a N. M. Professional Surveyor, hereby certify that I prepared this unclassified survey of a well location from an actual survey made on the ground under my direct supervision, said survey and plat meet the Min. Stas. for 1988 Surveying in the State of N. M. and are true and correct to the best of my knowledge and belief.

*Robert M. Howett*  
Robert M. Howett NM PS 19680

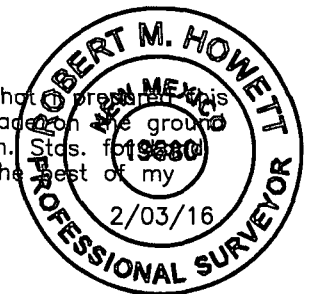

SCALE: 1" = 100'  
0 50 100  
BEARINGS ARE  
NAD 27 GRID - NM EAST  
DISTANCES ARE GROUND

Firm No.: TX 10193838 NM 4655451

Copyright 2014 - All Rights Reserved

**RRC**

NO.	REVISION	DATE
JOB NO.:	LS1601034	
DWG. NO.:	1601034PAD	

308 W. BROADWAY ST., HOBBS, NM 88240 (575) 964-8200

SCALE: 1" = 100'
DATE: 1-29-2016
SURVEYED BY: ML/CE
DRAWN BY: LPS
APPROVED BY: RMH
SHEET : 1 OF 1

# LOCATION VERIFICATION MAP

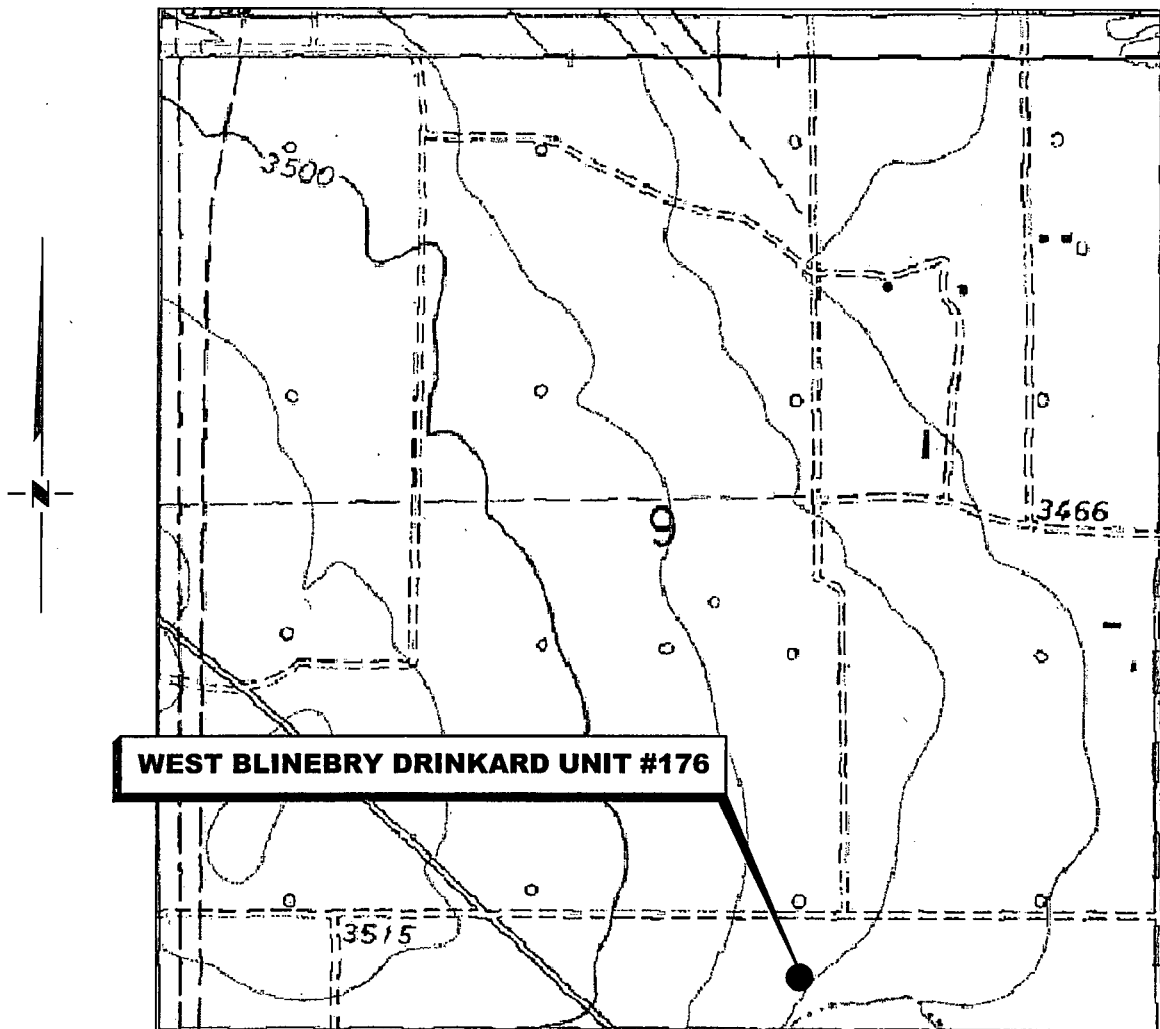

*(Eunice, NM, is located approx. 3.4 miles to the Southeast.)*

**SECTION 9, TWP. 21 SOUTH, RGE. 37 EAST,  
N. M. P. M., LEA CO., NEW MEXICO**

OPERATOR: Apache Corporation  
LEASE: West Blinebry Drinkard Unit  
WELL NO.: 176  
ELEVATION: 3481'

LOCATION: 260' FSL & 1875' FEL  
CONTOUR INTERVAL: 10'  
USGS TOPO. SOURCE MAP:  
Eunice, NM (1969)

Firm No.: TX 10193838 NM 4655451

Copyright 2015 - All Rights Reserved

# RRC

NO.	REVISION	DATE
JOB NO.: LS1601034		
DWG. NO.: 1601034LVM		

308 W. BROADWAY ST., HOBBS, NM 88240 (575) 964-8200

SCALE: 1000'
DATE: 1-29-2016
SURVEYED BY: ML/CE
DRAWN BY: LPS
APPROVED BY: RMH
SHEET : 1 OF 1

# VICINITY MAP

Exhibit #1B

NOT TO SCALE

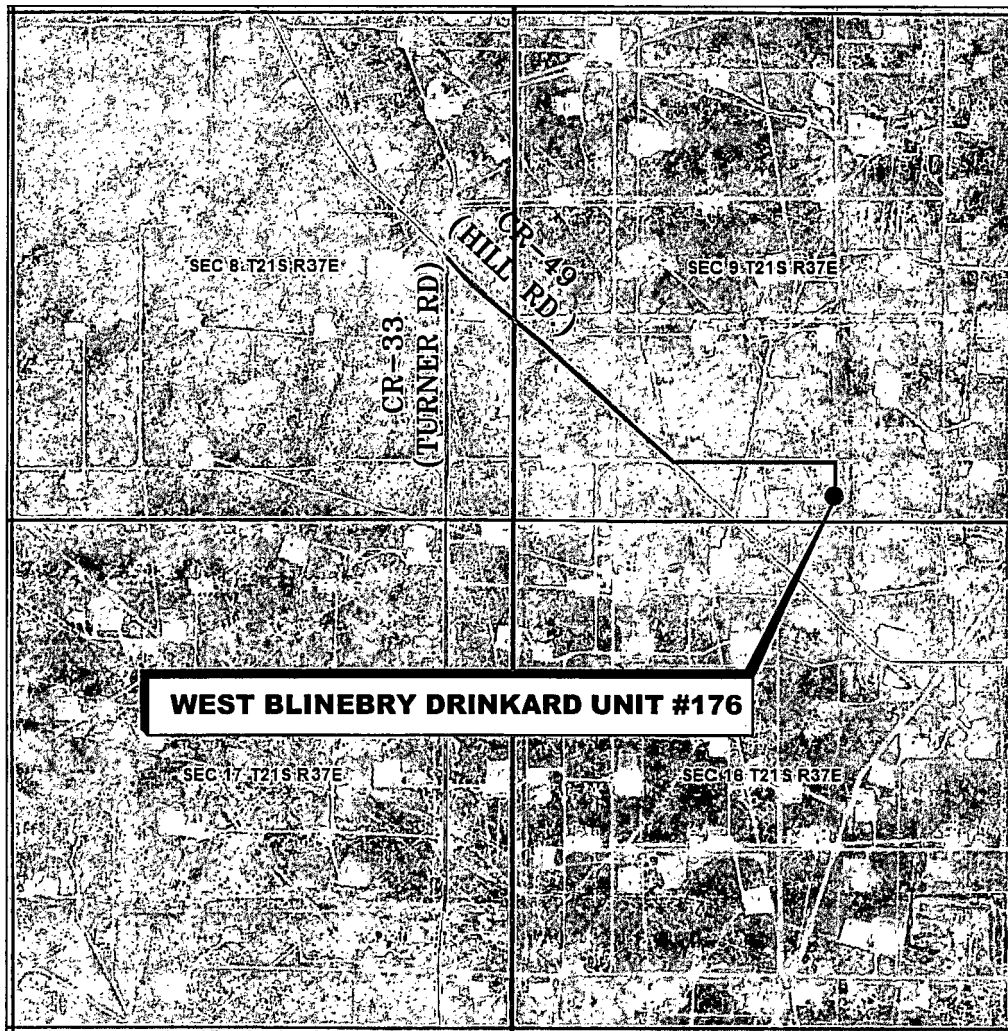

*SECTION 9, TWP. 21 SOUTH, RGE. 37 EAST,  
N. M. P. M., LEA CO., NEW MEXICO*

OPERATOR: Apache Corporation  
LEASE: West Blinebry Drinkard Unit  
WELL NO.: 176

LOCATION: 260' FSL & 1875' FEL  
ELEVATION: 3481'

Firm No.: TX 10193838 NM 4655451

Copyright 2014 - All Rights Reserved

# RRC

NO.	REVISION	DATE
JOB NO.: LS1601034		
DWG. NO.: 1601034VM		

308 W. BROADWAY ST., HOBBS, NM 88240 (575) 964-8200

SCALE: NTS
DATE: 1-29-2016
SURVEYED BY: ML/CE
DRAWN BY: LPS
APPROVED BY: RMH
SHEET : 1 OF 1

APACHE CORPORATION  
PROPOSED 3" SURFACE PIPELINE  
FROM THE WEST BLINEBRY DRINKARD UNIT #176  
TO AN EXISTING 3" VALVE HOOK-UP  
SECTION 9, T21S, R37E,  
N. M. P. M., LEA CO., NEW MEXICO

Exhibit #1

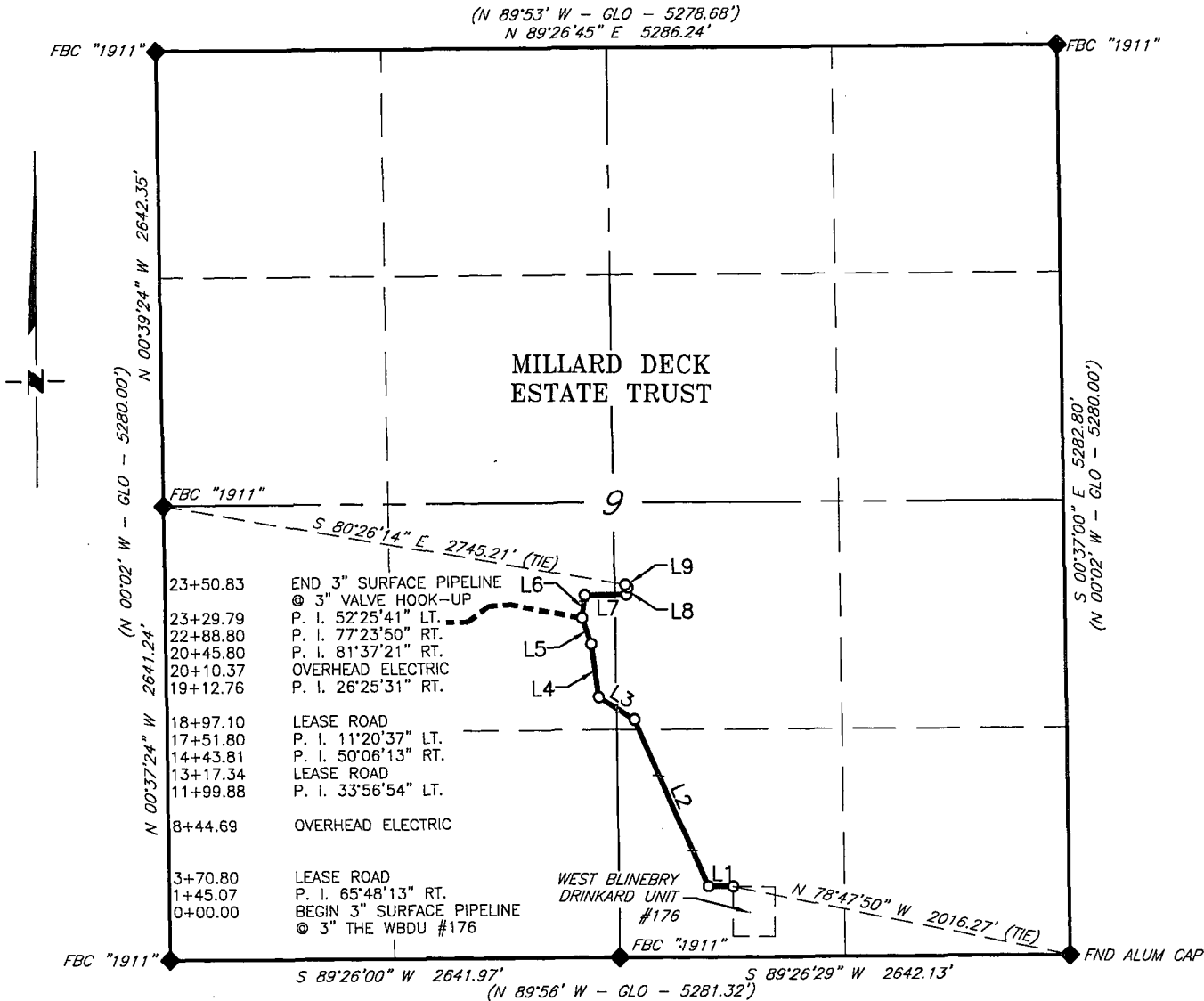

LINE TABLE		
LINE	BEARING	LENGTH
L1	S 89°59'56" W	145.07'
L2	N 24°11'51" W	1054.81'
L3	N 58°08'44" W	243.93'
L4	N 08°02'31" W	307.99'
L5	N 19°23'08" W	160.96'
L6	N 07°02'23" E	133.04'
L7	N 88°39'44" E	243.00'
L8	N 11°15'54" E	40.99'
L9	N 41°09'47" W	21.04'

Total: 2350.83'

SCALE: 1" = 1000'  
0 500' 1000'

BEARINGS ARE GRID NAD 27  
NM EAST  
DISTANCES ARE HORIZ. GROUND.

LEGEND

( ) RECORD DATA - GLO

◆ FOUND MONUMENT  
AS NOTED

— PROPOSED 3" SURFACE  
PIPELINE

Firm No.: TX 10193838 NM 4655451

I, R. M. Howett, a N. M. Professional Surveyor, hereby  
certify that I prepared this plat from an actual survey  
made on the ground under my direct supervision, said  
survey and plat meet the Min. Stds. for Land Surveying in  
the State of N. M. and are true and correct to the best  
of my knowledge and belief.

Robert M. Howett  
Robert M. Howett NM PS 19680



Copyright 2014 - All Rights Reserved

RRC

308 W. BROADWAY ST., HOBBS, NM 88240 (575) 964-8200

SCALE: 1" = 1000'

DATE: 2-05-2016

SURVEYED BY: BC/HD

DRAWN BY: LPS

APPROVED BY: RMH

SHEET : 1 OF 2

NO.	REVISION	DATE
JOB NO.:	LS1601034	
DWG. NO.:	1601034-1	

APACHE CORPORATION  
PROPOSED 3" SURFACE PIPELINE  
FROM THE WEST BLINEBRY DRINKARD UNIT #176  
TO AN EXISTING 3" VALVE HOOK-UP  
SECTION 9, T21S, R37E,  
N. M. P. M., LEA CO., NEW MEXICO

DESCRIPTION

A strip of land 30 feet wide, being 2,350.83 feet or 142.475 rods in length, lying in Section 9, Township 21 South, Range 37 East, N. M. P. M., Lea County, New Mexico, being 15 feet left and 15 feet right of the following described survey of a centerline across the lands of the Millard Deck Estate Trust:

BEGINNING at Engr. Sta. 0+00.00, a point in the Southeast quarter of Section 9, which bears N 78°47'50" W, 2,016.27 feet, from an aluminum cap, found for the Southeast corner of Section 9;

Thence S 89°59'56" W, 145.07 feet, to Engr. Sta. 1+45.07, a P. I. of 65°48'13" right;

Thence N 24°11'51" W, 1,054.81 feet, to Engr. Sta. 11+99.88, a P. I. of 33°56'53" left;

Thence N 58°08'44" W, 243.93 feet, to Engr. Sta. 14+43.81, a P. I. of 50°06'13" right;

Thence N 08°02'31" W, 307.99 feet, to Engr. Sta. 17+51.80, a P. I. of 11°20'37" left;

Thence N 19°23'08" W, 160.96 feet, to Engr. Sta. 19+12.76, a P. I. of 26°25'31" right;

Thence N 07°02'23" E, 133.04 feet, to Engr. Sta. 20+45.80, a P. I. of 81°37'21" right;

Thence N 88°39'44" E, 243.00 feet, to Engr. Sta. 22+88.80, a P. I. of 77°23'50" right;

Thence N 11°15'54" E, 40.99 feet, to Engr. Sta. 23+29.79, a P. I. of 52°25'41" left;

Thence N 41°09'47" W, 21.04 feet, to Engr. Sta. 23+50.83, the End of Survey, a point in the Southeast quarter of Section 9, which bears S 80°26'14" E, 2,745.21 feet, from a brass cap, stamped "1911", found for the West quarter corner of Section 9.

Said strip of land contains 1.619 acres, more or less, and is allocated by forties as follows:

SW 1/4 SE 1/4	68.874 Rods	0.783 Acres
NW 1/4 SE 1/4	18.889 Rods	0.214 Acres
NE 1/4 SW 1/4	54.712 Rods	0.622 Acres

Firm No.: TX 10193838 NM 4655451

Copyright 2014 - All Rights Reserved

RRC

NO.	REVISION	DATE
JOB NO.: LS1601034		
DWG. NO.: 1601034-2		

308 W. BROADWAY ST., HOBBS, NM 88240 (575) 964-8200

SCALE: 1" = 1000'
DATE: 2-05-2016
SURVEYED BY: BC/HD
DRAWN BY: LPS
APPROVED BY: RMH
SHEET : 1 OF 2

APACHE CORPORATION  
PROPOSED ELECTRIC LINE LATERAL  
FOR THE WEST BLINEBRY DRINKARD UNIT #176  
SECTION 9, T21S, R37E,  
N. M. P. M., LEA CO., NEW MEXICO

Exhibit #1A

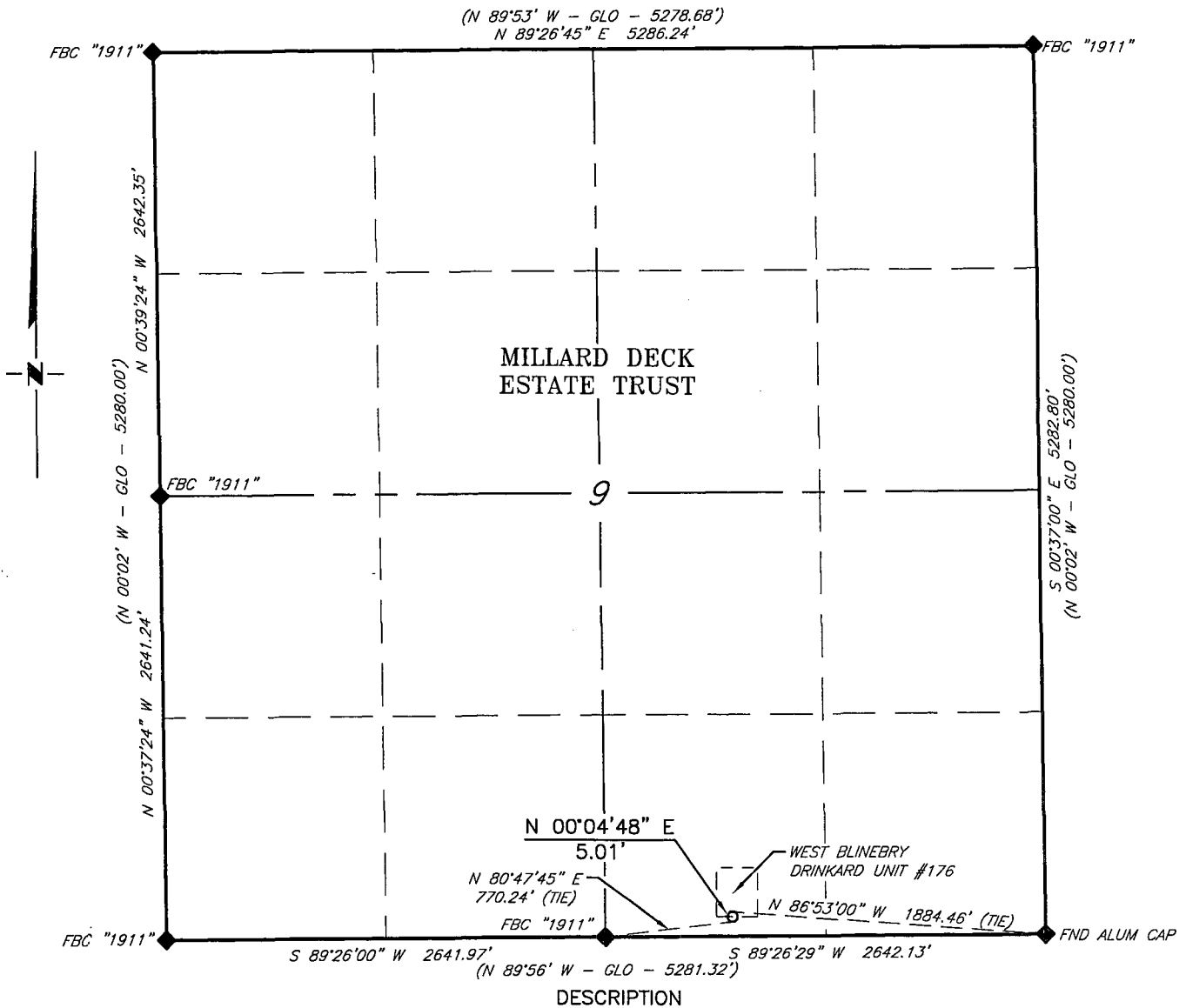

A strip of land 30 feet wide, being 5.01 feet or 0.304 rods in length, lying in Section 9, Township 21 South, Range 37 East, N. M. P. M., Lea County, New Mexico, being 15 feet left and 15 feet right of the following described survey of a centerline across the lands of the Millard Deck Estate Trust:

BEGINNING at Engr. Sta. 0+00.00, a point in the Southeast quarter of Section 9, which bears N 80°47'45" E, 770.24 feet, from a brass cap, stamped "1911", found for the South quarter corner of Section 9;

Thence N 00°04'48" E, 5.01 feet, to Engr. Sta. 0+05.01, the End of Survey, a point in the Southeast quarter of Section 9, which bears N 86°53'00" W, 1.884.46 feet, from an aluminum cap, found for the Southeast corner of Section 9.

Said strip of land contains 0.003 acres, more or less, and is allocated by forties as follows:

NE 1/4 SW 1/4      0.304 Rods      0.003 Acres

SCALE: 1" = 1000'  
0      500'      1000'

BEARINGS ARE GRID NAD 27  
NM EAST  
DISTANCES ARE HORIZ. GROUND.

LEGEND

( ) RECORD DATA - GLO

◆ FOUND MONUMENT  
AS NOTED

— PROPOSED 3" SURFACE  
PIPELINE

I, R. M. Howett, a N. M. Professional Surveyor, hereby certify that I prepared this plat from an actual survey made on the ground under my direct supervision, said survey and plat meet the Min. Stds. for Land Surveying in the State of N. M. and are true and correct to the best of my knowledge and belief.

*Robert M. Howett*  
Robert M. Howett      NM PS 19680



Firm No.: TX 10193838 NM 4655451

Copyright 2014 - All Rights Reserved

RRC

NO.	REVISION	DATE
JOB NO.:	LS1601034	
DWG. NO.:	1601034EL	

308 W. BROADWAY ST., HOBBS, NM 88240 (575) 964-8200

SCALE: 1" = 1000'
DATE: 2-05-2016
SURVEYED BY: BC/HD
DRAWN BY: LPS
APPROVED BY: RMH
SHEET : 1 OF 1



























## New Mexico Oil Conservation Division

New Mexico Oil Conservation Division



## 1 MILE RADIUS

EXHIBIT 2

- | Layer List  |  |
|---|--|
| ▼  All Wells                                 |  |
|  Miscellaneous                               |  |
|  CO2 Active                                  |  |
|  CO2 Cancelled                               |  |
|  CO2, New                                    |  |
|  CO2, Plugged                                |  |
|  CO2, Temporarily Abandoned                  |  |
|  Gas, Active                                 |  |
|  Gas, Cancelled                              |  |
|  Gas, New                                    |  |
|  Gas, Plugged                                |  |
|  Gas, Temporarily Abandoned                  |  |
|  Injection, Active                           |  |
|  Injection, Cancelled                        |  |
|  Injection, New                              |  |
|  Injection, Plugged                          |  |
|  Injection, Temporarily Abandoned            |  |
|  Oil, Active                                 |  |
|  Oil, Cancelled                              |  |
|  Oil, New                                    |  |
|  Oil, Plugged                                |  |
|  Oil, Temporarily Abandoned                  |  |
|  Salt Water Injection, Active                |  |
|  Salt Water Injection, Cancelled             |  |
|  Salt Water Injection, New                   |  |
|  Salt Water Injection, Plugged               |  |
|  Salt Water Injection, Temporarily Abandoned |  |

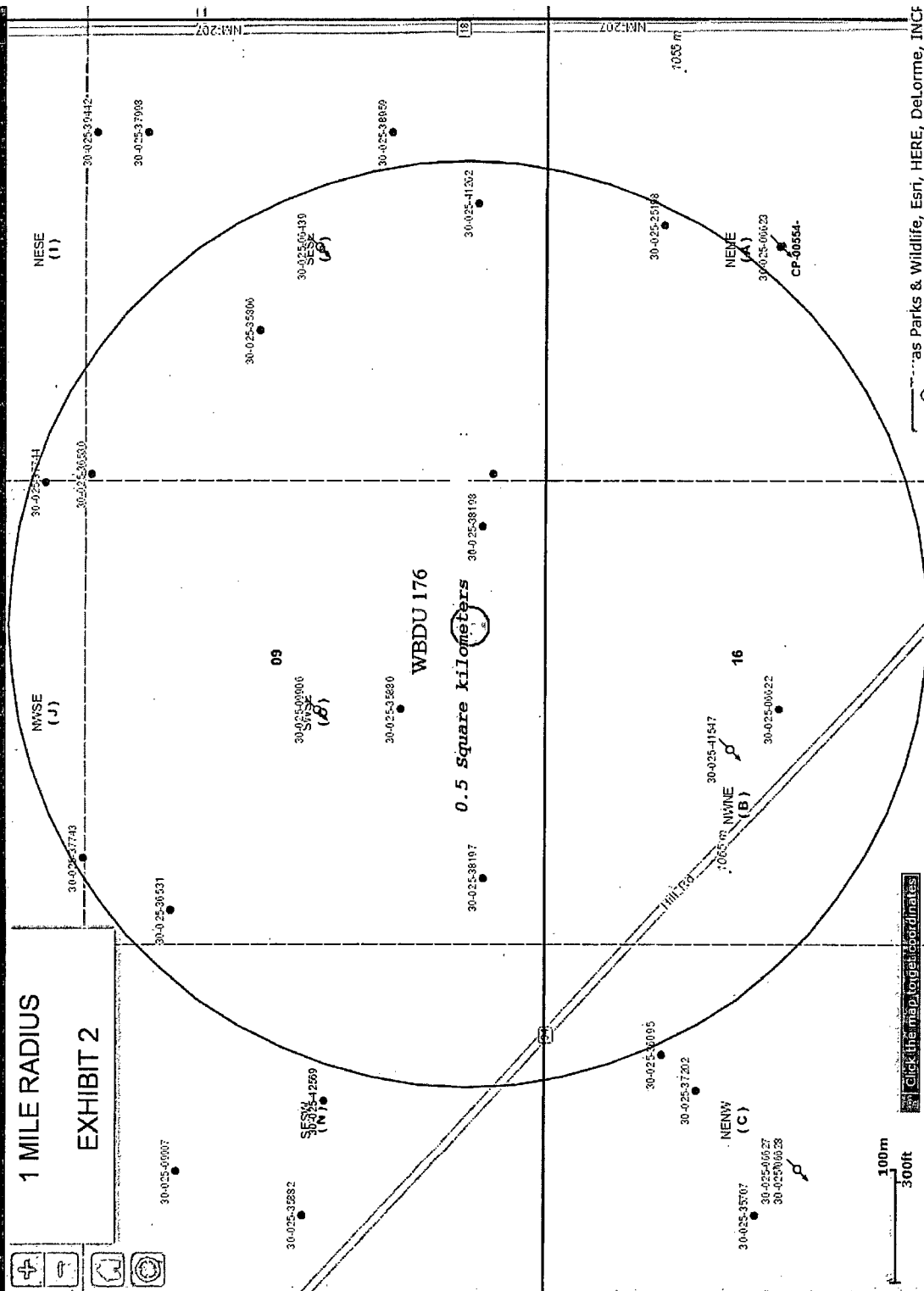

as Parks & Wildlife, Esri, HERE, DeLorme, INCF