

District I  
1625 N. French Dr., Hobbs, NM 88240  
Phone: (575) 393-6161 Fax: (575) 393-0720  
District II  
811 S. First St., Artesia, NM 88210  
Phone: (575) 748-1283 Fax: (575) 748-9720  
District III  
1000 Rio Brazos Road, Aztec, NM 87410  
Phone: (505) 334-6178 Fax: (505) 334-6170  
District IV  
1220 S. St. Francis Dr., Santa Fe, NM 87505  
Phone: (505) 476-3460 Fax: (505) 476-3462

State of New Mexico  
Energy, Minerals & Natural Resources Department  
OIL CONSERVATION DIVISION  
1220 South St. Francis Dr.  
Santa Fe, NM 87505

Form C-102  
Revised August 1, 2011  
Submit one copy to appropriate  
District Office

☐ AMENDED REPORT

WELL LOCATION AND ACREAGE DEDICATION PLAT

<sup>1</sup> API Number <b>30-025-3331</b>	<sup>2</sup> Pool Code <b>97899</b>	<sup>3</sup> Pool Name <b>WC-025 G-06 S253206M; Bone Spring</b>
<sup>4</sup> Property Code <b>300635</b>	<sup>5</sup> Property Name <b>COTTON DRAW UNIT</b>	<sup>6</sup> Well Number <b>328H</b>
<sup>7</sup> OGRID No. <b>6137</b>	<sup>8</sup> Operator Name <b>DEVON ENERGY PRODUCTION COMPANY, L.P.</b>	<sup>9</sup> Elevation <b>3431.4</b>

<sup>10</sup> Surface Location

UL or lot no.	Section	Township	Range	Lot Idn	Feet from the	North/South line	Feet from the	East/West line	County
<b>O</b>	<b>7</b>	<b>25 S</b>	<b>32 E</b>		<b>665</b>	<b>SOUTH</b>	<b>1405</b>	<b>EAST</b>	<b>LEA</b>

<sup>11</sup> Bottom Hole Location If Different From Surface

UL or lot no.	Section	Township	Range	Lot Idn	Feet from the	North/South line	Feet from the	East/West line	County
<b>A</b>	<b>7</b>	<b>25 S</b>	<b>32 E</b>		<b>330</b>	<b>NORTH</b>	<b>660</b>	<b>EAST</b>	<b>LEA</b>

<sup>12</sup> Dedicated Acres <b>160.00</b>	<sup>13</sup> Joint or Infill	<sup>14</sup> Consolidation Code	<sup>15</sup> Order No.
--	-------------------------------	----------------------------------	-------------------------

No allowable will be assigned to this completion until all interests have been consolidated or a non-standard unit has been approved by the division.

<p>N89°42'17"E 2663.17 FT</p> <p>NW CORNER SEC. 7 LAT. = 32.1520818°N LONG. = 103.7229772°W NMSP EAST (FT) N = 419598.13 E = 730229.21</p> <p>LOT 1</p>		<p>N Q CORNER SEC. 7 LAT. = 32.1520777°N LONG. = 103.7143740°W NMSP EAST (FT) N = 419611.85 E = 732891.77</p>		<p>N89°35'56"E 2660.36 FT</p> <p>NE CORNER SEC. 7 LAT. = 32.1520866°N LONG. = 103.7057799°W NMSP EAST (FT) N = 419630.47 E = 735551.49</p> <p>660'</p> <p>330'</p> <p>BOTTOM OF HOLE</p> <p>BOTTOM OF HOLE LAT. = 32.1511775°N LONG. = 103.7079154°W NMSP EAST (FT) N = 419295.92 E = 734892.49</p> <p>500°08'57"E 2651.54 FT</p>	
<p>N00°13'30"W 2639.25 FT</p> <p>LOT 2</p>		<p>NOTE: LATITUDE AND LONGITUDE COORDINATES ARE SHOWN USING THE NORTH AMERICAN DATUM OF 1983 (NAD83). LISTED NEW MEXICO STATE PLANE EAST COORDINATES ARE GRID (NAD83). BASIS OF BEARING AND DISTANCES USED ARE NEW MEXICO STATE PLANE EAST COORDINATES MODIFIED TO THE SURFACE.</p>		<p>E Q CORNER SEC. 7 LAT. = 32.1447996°N LONG. = 103.7058075°W NMSP EAST (FT) N = 416979.52 E = 735556.39</p>	
<p>W Q CORNER SEC. 7 LAT. = 32.1448286°N LONG. = 103.7229920°W NMSP EAST (FT) N = 416959.48 E = 730239.58</p> <p>LOT 3</p>		<p>COTTON DRAW UNIT 328H ELEV. = 3431.4' LAT. = 32.1394033°N (NAD83) LONG. = 103.7103629°W NMSP EAST (FT) N = 415008.25 E = 734159.81</p>		<p>SE CORNER SEC. 7 LAT. = 32.1375763°N LONG. = 103.7058305°W NMSP EAST (FT) N = 414351.72 E = 735566.57</p> <p>500°10'42"E 2628.39 FT</p>	
<p>N00°14'07"W 2639.92 FT</p> <p>LOT 4</p> <p>SW CORNER SEC. 7 LAT. = 32.1375735°N LONG. = 103.7230053°W NMSP EAST (FT) N = 414320.16 E = 730250.42</p>		<p>SURFACE LOCATION</p> <p>1405'</p> <p>665'</p> <p>DNF</p> <p>S89°39'35"W 2658.70 FT</p>		<p>S89°39'35"W 2658.70 FT</p>	

**<sup>17</sup> OPERATOR CERTIFICATION**

I hereby certify that the information contained herein is true and complete to the best of my knowledge and belief, and that this organization either owns a working interest or undivided mineral interest in the land including the proposed bottom hole location or has a right to drill this well at this location pursuant to a contract with an owner of such a mineral or working interest, or to a voluntary pooling agreement or a compulsory pooling order heretofore entered by the division.

*Linda Good* 4/29/2016  
Signature Date

Linda Good  
Printed Name

[linda.good@dvn.com](mailto:linda.good@dvn.com)  
E-mail Address

**<sup>18</sup> SURVEYOR CERTIFICATION**

I hereby certify that the well location shown on this plat was plotted from field notes of actual surveys made by me or under my supervision, and that the same is true and correct to the best of my belief.

APRIL 26, 2016  
Date of Survey

*Filimon F. Jaramillo*  
Signature and Seal of Professional Surveyor

Certificate Number: FILIMON F. JARAMILLO, PLS 12797  
SURVEY NO. 4296A

SECTION 7, TOWNSHIP 25 SOUTH, RANGE 32 EAST, N.M.P.M.  
LEA COUNTY, STATE OF NEW MEXICO

SITE MAP

NOTE: LATITUDE AND LONGITUDE COORDINATES ARE SHOWN USING THE NORTH AMERICAN DATUM OF 1983 (NAD83). LISTED NEW MEXICO STATE PLANE EAST COORDINATES ARE GRID (NAD83). BASIS OF BEARING AND DISTANCES USED ARE NEW MEXICO STATE PLANE EAST COORDINATES MODIFIED TO THE SURFACE

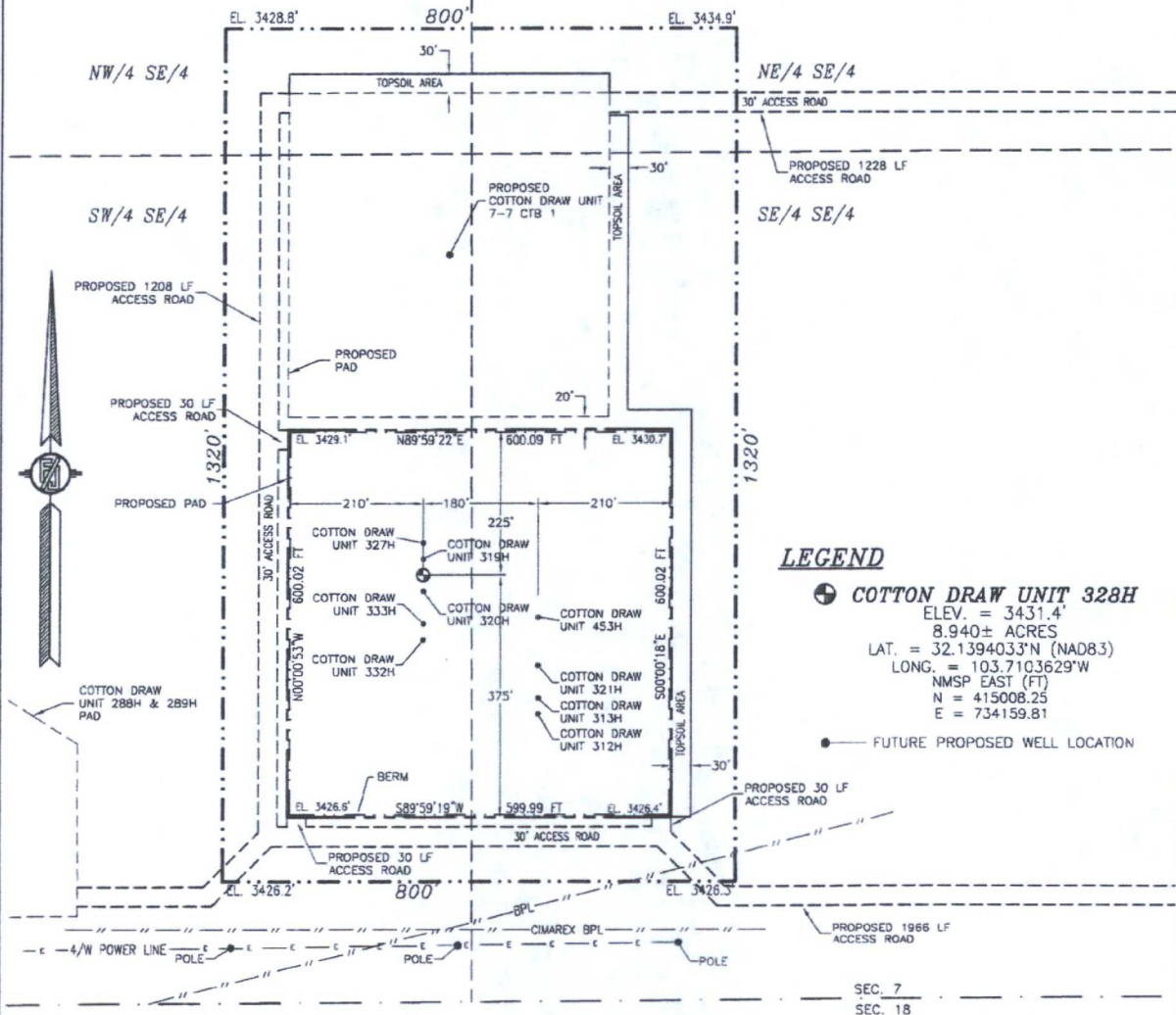

0 25 125 250 500  
SCALE 1" = 250'

DIRECTIONS TO LOCATION

FROM THE INTERSECTION OF STATE HIGHWAY 128 & CR 1 (ORLA HIGHWAY) GO SOUTH ON CR 1 APPROX. 6.2 MILES TO MONSANTO ROAD ON RIGHT (WEST). TURN WEST ON MONSANTO ROAD GO APPROX. 2.1 MILES ROAD TURNS RIGHT (NORTH). GO NORTH APPROX. 0.9 MILE ROAD TURNS LEFT (WEST). GO WEST APPROX. 25'. TURN RIGHT (NORTH) GO NORTH APPROX. 954' TO A PROPOSED ROAD LATH ON LEFT (WEST). FOLLOW PROPOSED ROAD LATHS WEST APPROX. 887', THEN NORTHWEST 132', THEN 30' NORTH (TOTAL OF 1049') TO THE SOUTHEAST PAD CORNER FOR THIS LOCATION.

DEVON ENERGY PRODUCTION COMPANY, L.P.  
**COTTON DRAW UNIT 328H**  
LOCATED 665 FT. FROM THE SOUTH LINE  
AND 1405 FT. FROM THE EAST LINE OF  
SECTION 7, TOWNSHIP 25 SOUTH,  
RANGE 32 EAST, N.M.P.M.  
LEA COUNTY, STATE OF NEW MEXICO

APRIL 26, 2016

SURVEY NO. 4296A

MADRON SURVEYING, INC. 301 SOUTH CANAL (575) 234-3341 CARLSBAD, NEW MEXICO



SECTION 7, TOWNSHIP 25 SOUTH, RANGE 32 EAST, N.M.P.M.  
LEA COUNTY, STATE OF NEW MEXICO  
LOCATION VERIFICATION MAP

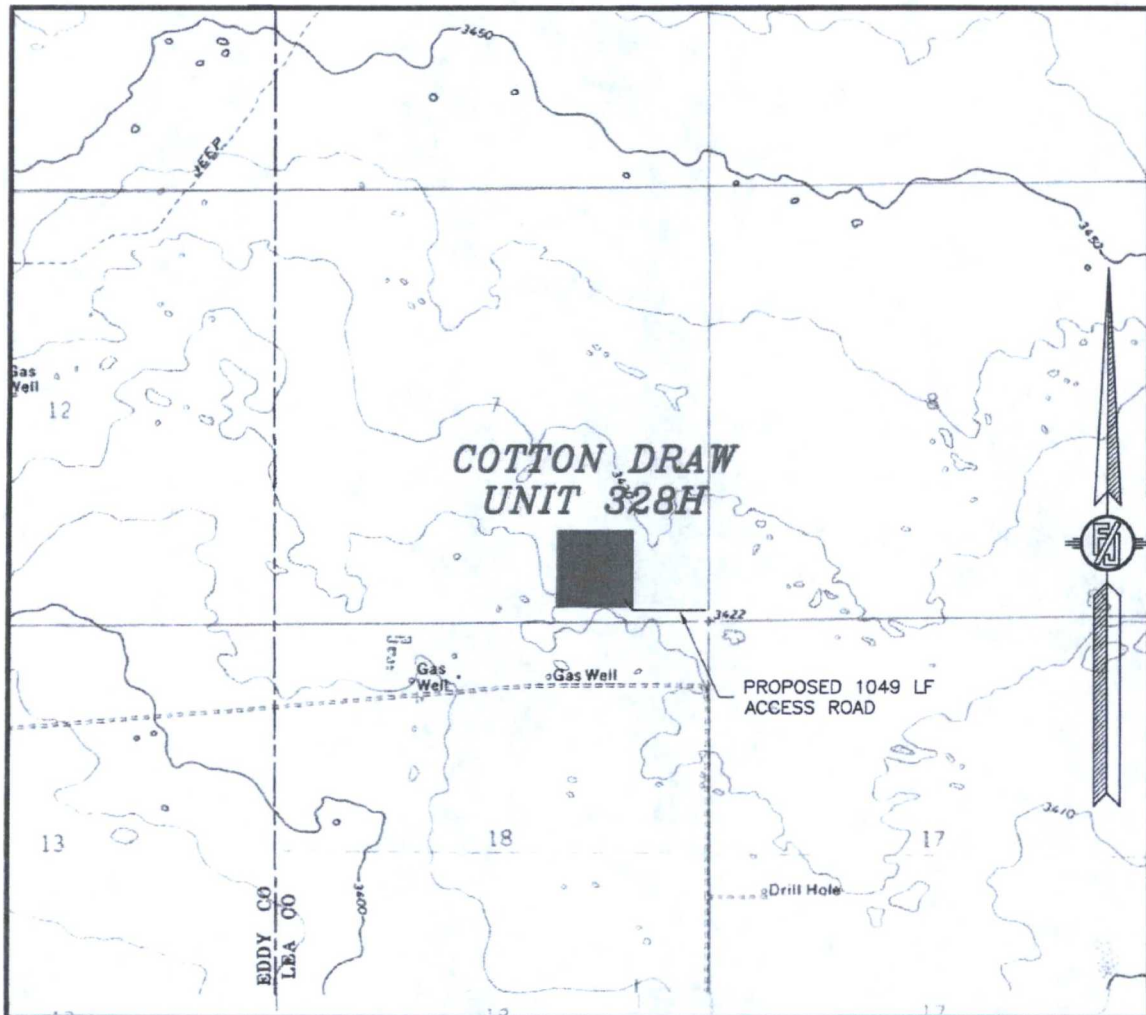

USGS QUAD MAP:  
PADUCA BREAKS WEST  
PADUCA BREAKS NW

NOT TO SCALE

DEVON ENERGY PRODUCTION COMPANY, L.P.  
**COTTON DRAW UNIT 328H**

LOCATED 665 FT. FROM THE SOUTH LINE  
AND 1405 FT. FROM THE EAST LINE OF  
SECTION 7, TOWNSHIP 25 SOUTH,  
RANGE 32 EAST, N.M.P.M.  
LEA COUNTY, STATE OF NEW MEXICO

APRIL 26, 2016

SURVEY NO. 4296A

MADRON SURVEYING, INC. 301 SOUTH CANAL (575) 234-3341 CARLSBAD, NEW MEXICO

SECTION 7, TOWNSHIP 25 SOUTH, RANGE 32 EAST, N.M.P.M.  
LEA COUNTY, STATE OF NEW MEXICO  
VICINITY MAP

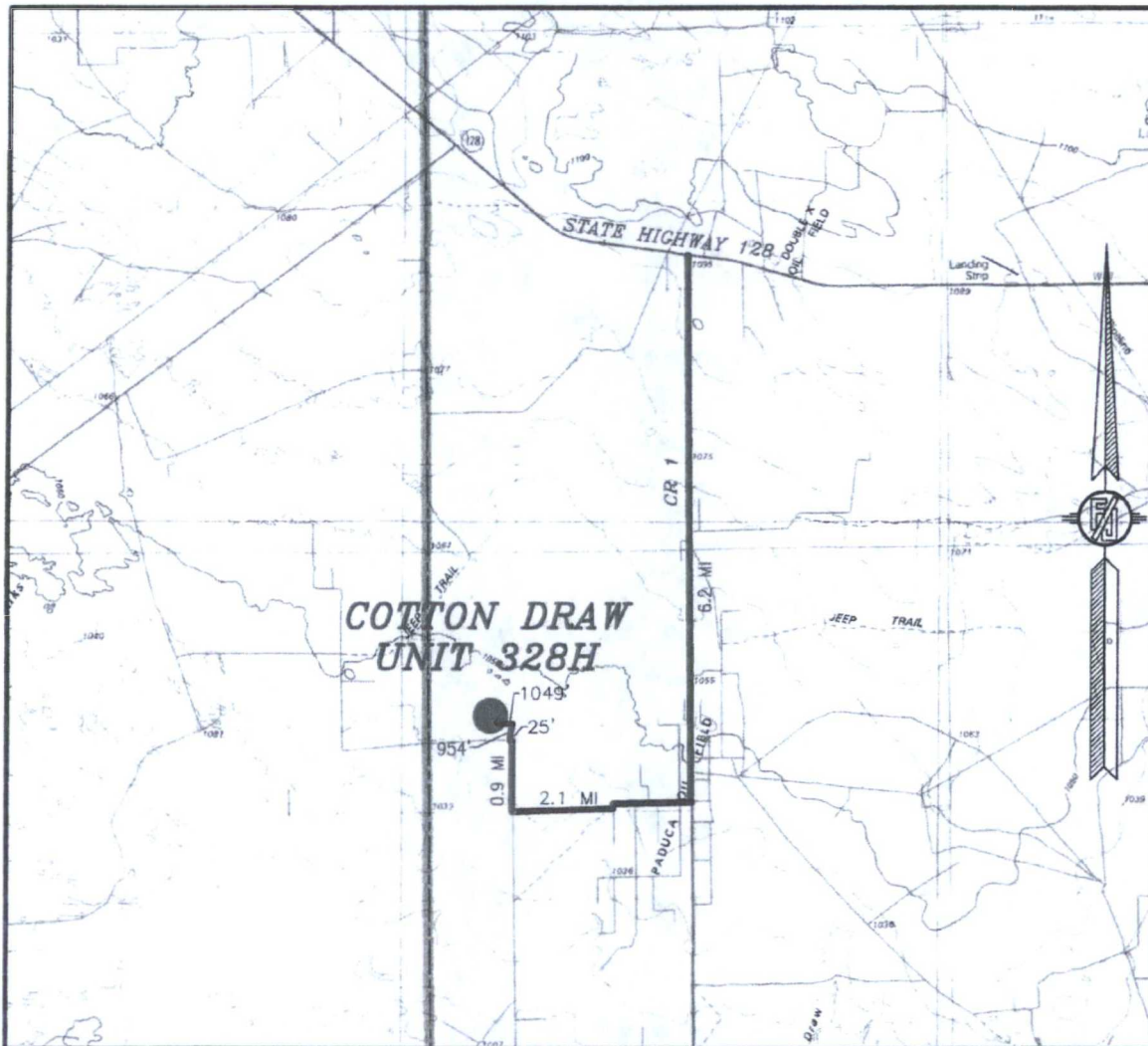

DISTANCES IN MILES

NOT TO SCALE

DEVON ENERGY PRODUCTION COMPANY, L.P.  
**COTTON DRAW UNIT 328H**  
LOCATED 665 FT. FROM THE SOUTH LINE  
AND 1405 FT. FROM THE EAST LINE OF  
SECTION 7, TOWNSHIP 25 SOUTH,  
RANGE 32 EAST, N.M.P.M.  
LEA COUNTY, STATE OF NEW MEXICO

APRIL 26, 2016

**DIRECTIONS TO LOCATION**

FROM THE INTERSECTION OF STATE HIGHWAY 128 & CR 1 (ORLA HIGHWAY) GO SOUTH ON CR 1 APPROX. 6.2 MILES TO MONSANTO ROAD ON RIGHT (WEST). TURN WEST ON MONSANTO ROAD GO APPROX. 2.1 MILES ROAD TURNS RIGHT (NORTH). GO NORTH APPROX. 0.9 MILE ROAD TURNS LEFT (WEST). GO WEST APPROX. 25'. TURN RIGHT (NORTH) GO NORTH APPROX. 954' TO A PROPOSED ROAD LATH ON LEFT (WEST). FOLLOW PROPOSED ROAD LATHS WEST APPROX. 887', THEN NORTHWEST 132', THEN 30' NORTH (TOTAL OF 1049') TO THE SOUTHEAST PAD CORNER FOR THIS LOCATION.

SURVEY NO. 4296A

MADRON SURVEYING, INC. 301 SOUTH CANAL (575) 234-3341 CARLSBAD, NEW MEXICO



SECTION 7, TOWNSHIP 25 SOUTH, RANGE 32 EAST, N.M.P.M.  
LEA COUNTY, STATE OF NEW MEXICO  
**AERIAL PHOTO**

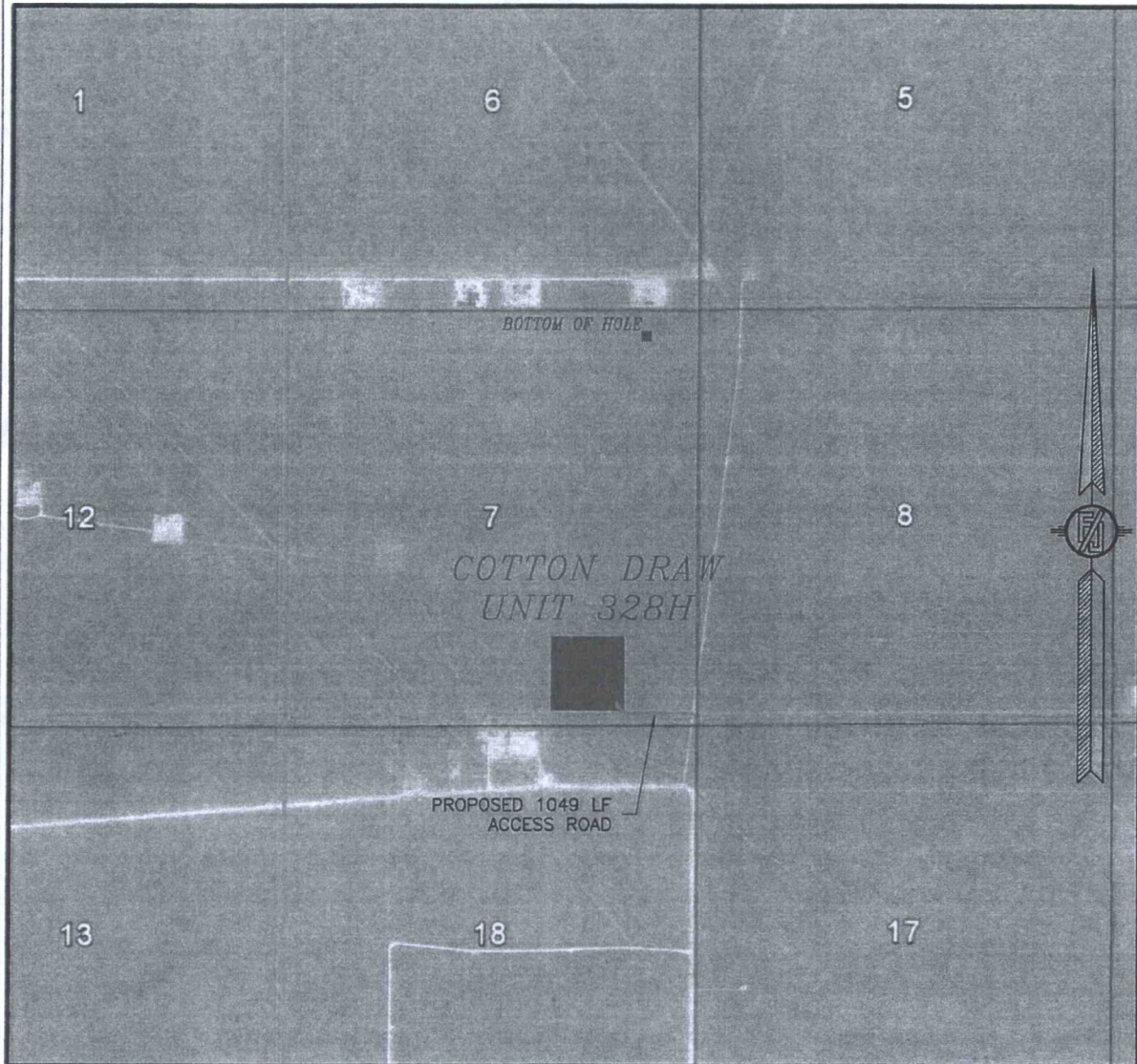

NOT TO SCALE  
AERIAL PHOTO:  
GOOGLE EARTH  
FEBRUARY 2014

DEVON ENERGY PRODUCTION COMPANY, L.P.  
**COTTON DRAW UNIT 328H**  
LOCATED 665 FT. FROM THE SOUTH LINE  
AND 1405 FT. FROM THE EAST LINE OF  
SECTION 7, TOWNSHIP 25 SOUTH,  
RANGE 32 EAST, N.M.P.M.  
LEA COUNTY, STATE OF NEW MEXICO

APRIL 26, 2016

SURVEY NO. 4296A

MADRON SURVEYING, INC. 301 SOUTH CANAL (575) 234-3341 CARLSBAD, NEW MEXICO



SECTION 7, TOWNSHIP 25 SOUTH, RANGE 32 EAST, N.M.P.M.  
LEA COUNTY, STATE OF NEW MEXICO  
ACCESS AERIAL ROUTE MAP

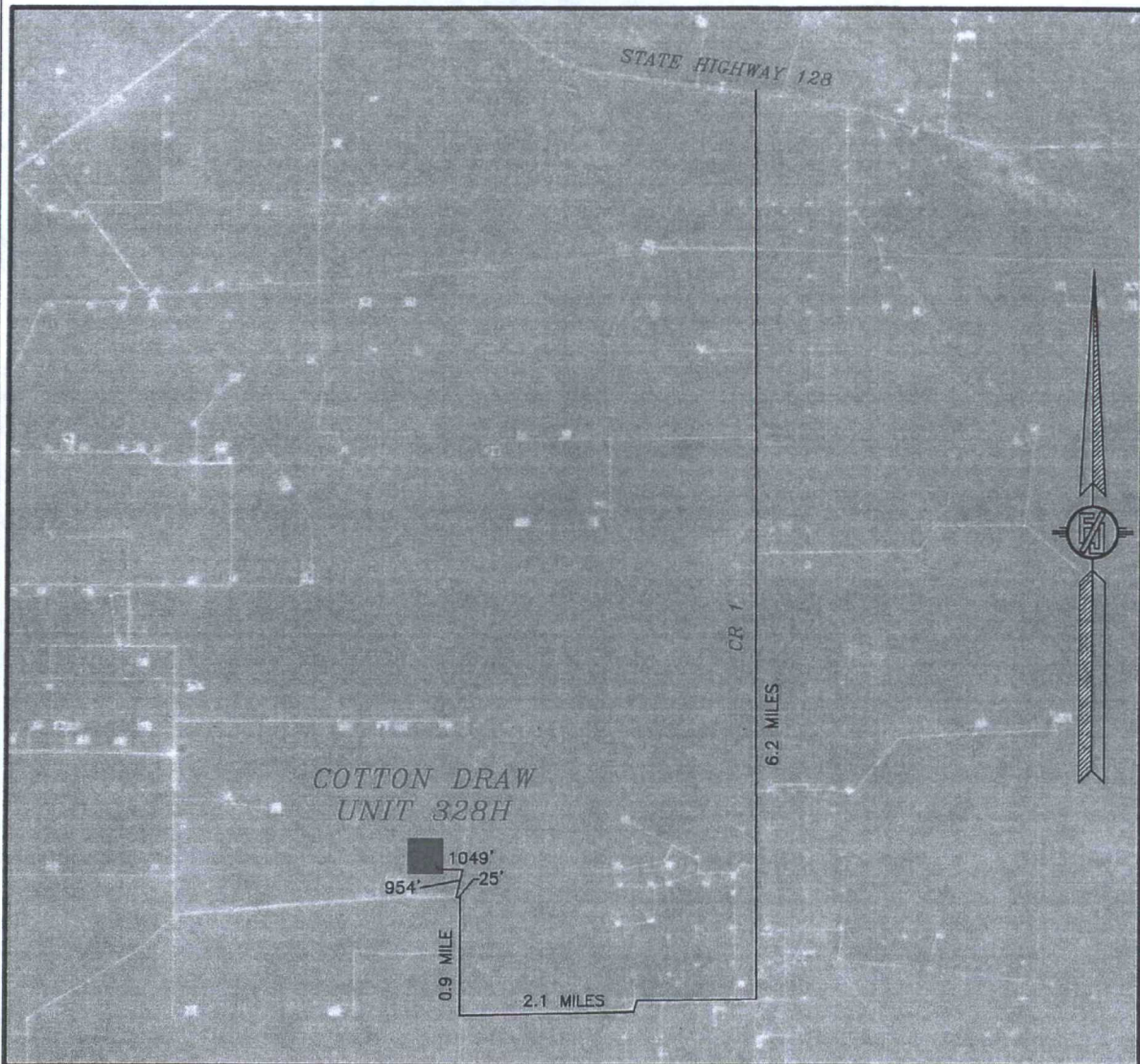

NOT TO SCALE  
AERIAL PHOTO:  
GOOGLE EARTH  
FEBRUARY 2014

DEVON ENERGY PRODUCTION COMPANY, L.P.

**COTTON DRAW UNIT 328H**

LOCATED 665 FT. FROM THE SOUTH LINE  
AND 1405 FT. FROM THE EAST LINE OF

SECTION 7, TOWNSHIP 25 SOUTH,  
RANGE 32 EAST, N.M.P.M.

LEA COUNTY, STATE OF NEW MEXICO

APRIL 26, 2016

SURVEY NO. 4296A

MADRON SURVEYING, INC. 301 SOUTH CANAL CARLSBAD, NEW MEXICO  
(575) 234-3341





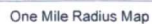

Estimated distances to nearest wellbores:

*From SHL: Cotton Draw Unit 252H	535 ft W
Trionyx 6 Fed 7H	500 ft NNE
*From BHL: Trionyx 6 Fed 8H	450 ft NE

\*From SHL: Cotton Draw Unit 252H 535 ft W  
Trionyx 6 Fed 7H 500 ft NNE  
\*From BHL: Trionyx 6 Fed 8H 450 ft NE

12



- WELL SYMBOLS**
- |   |                        |
|---|------------------------|
|  | ABANDONED WATER WELL   |
|  | DRY AND ABANDONED WELL |
|  | GAS PRODUCING WELL     |
|  | JUNKED AND ABANDONED   |
|  | OIL PRODUCING WELL     |
|  | PROPOSED               |

January 27, 2016

