

Pride Energy

N.M. 87 St. #001

11-01-2011

Workplan for Site

On October 11th 2011 crew met on site with OCD engineer Geoffrey Lecking to trench sample on east side of pad where frac tanks were sitting. Three trench samples were dug on east side and all 3 samples were clean at a depth of 2.5' according to chloride field analysis. OCD then recommended we did 3 trench samples on west side of pad where dead area in pasture is. Trench sample 4 was taken on far south end of area and clean wasn't reached until a depth of 5ft. Trench sample 5 was taken in the middle of dead area and sample came back clean at a depth of 2.5ft. On the far north end of dead area sample was taken at a depth of 1ft. and field analysis showed it to be clean, all six samples were then taken to Cardinal Labs for a full analysis. A hard caliche cap was encountered at a depth of 1-2' on both sides of location and made trench sampling extremely difficult.

All samples from site came back clean according to Cardinal Labs analysis and paperwork was taken to Geoffrey Lecking at OCD. For this site I propose to take both areas down to the caliche cap and haul off contamination to disposal. Also we will clean up well head area and scrape and sample pad area before clean is put back down. After both areas are excavated and hauled off we will then bring back in clean topsoil from landowner pit. If you have any questions or comments you can reach me at 575-602-2984.

Parker Energy Services Inc.

Environmental Supervisor

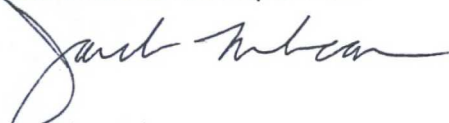

Jacob Melancon

approved
Geoff Lecking
Sew. Engineer
NM OCD - Hobbs
11/1/11

$$\begin{array}{r} 18 \\ 20 \\ 13 \overline{)60} \end{array}$$

TS4 $68 \times 20 = 1360$ 1:30 p.m. 2' Brown Soil
 $24 \times 20 = 480$ 1:50 p.m. 2 1/2' Caliche
 $20 \times 20 = 400$ 2:05 p.m. 3' Caliche
 $12 \times 20 = 240$ 2:17 p.m. 5' Caliche

TS5 $12-16 \times 20 = 240 - 320$ 2:27 p.m. 8"-1' Dark Soil
 $12 \times 20 = 240$ 2:33 p.m. 1' Caliche

TS6 $20 \times 20 = 400$ 3:05 p.m. 6-8" Dark Soil
 $12 \times 20 = 240$

Pride Energy

N.M. 87 St. #001

10.11.2011

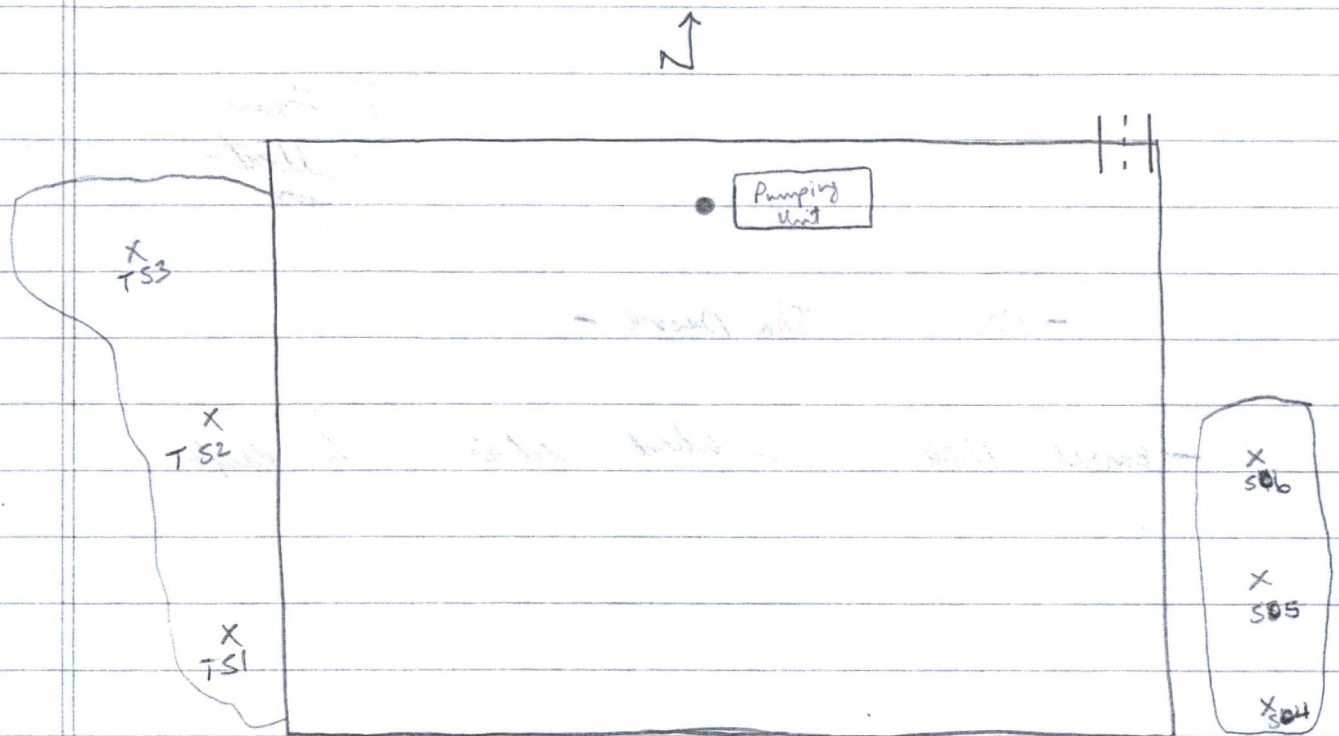

Sample ID

SI	28 X 20 = 560	9:30 am.	1'	"Solid caliche"
SI	28 X 20 = 560	10:00 am.	1-2'	"Solid caliche"
TS1	20 X 20 = 400	11:00 am.	2'	Solid caliche
TS1	12 X 20 = 240	11:21 am.	2 1/2'	Solid caliche
TS2	20 X 20 = 400	12:35 am.	2'	Solid caliche
TS2	12 X 20 = 240	12:40 am.	2 1/2'	
TS3	24 X 20 = 480	1:00 am.	2'	Solid caliche
	16 X 20 = 320	1:15 am.	2 1/2'	