

UNITED STATES
DEPARTMENT OF THE INTERIOR
BUREAU OF LAND MANAGEMENT

OCD Hobbs

FORM APPROVED
OMB NO. 1004-0137
Expires: January 31, 20185. Lease Serial No.
NMLC063228

6. If Indian, Allottee or Tribe Name

7. If Unit or CA/Agreement, Name and/or No.

8. Well Name and No.
TRISTE DRAW 25 FEDERAL COM 5H9. API Well No.
30-025-4210510. Field and Pool or Exploratory Area
TRISTE DRAW; BONE SPRING11. County or Parish, State
LEA COUNTY, NM

SUNDRY NOTICES AND REPORTS ON WELLS

Do not use this form for proposals to drill or to re-enter an abandoned well. Use form 3160-3 (APD) for such proposals.

SUBMIT IN TRIPLICATE - Other instructions on page 2

1. Type of Well

☒ Oil Well ☐ Gas Well ☐ Other2. Name of Operator
CIMAREX ENERGY COMPANYContact: ARICKA EASTERLING
E-Mail: aeasterling@cimarex.com3a. Address
202 S. CHEYENNE AVE, SUITE 1000
TULSA, OK 741033b. Phone No. (include area code)
Ph: 918-560-7060

4. Location of Well (Footage, Sec., T., R., M., or Survey Description)

Sec 25 T23S R32E SESE 310FSL 1270FEL

12. CHECK THE APPROPRIATE BOX(ES) TO INDICATE NATURE OF NOTICE, REPORT, OR OTHER DATA

TYPE OF SUBMISSION	TYPE OF ACTION			
<input checked="" type="checkbox"/> Notice of Intent	<input type="checkbox"/> Acidize	<input type="checkbox"/> Deepen	<input type="checkbox"/> Production (Start/Resume)	<input type="checkbox"/> Water Shut-Off
<input type="checkbox"/> Subsequent Report	<input type="checkbox"/> Alter Casing	<input type="checkbox"/> Hydraulic Fracturing	<input type="checkbox"/> Reclamation	<input type="checkbox"/> Well Integrity
<input type="checkbox"/> Final Abandonment Notice	<input type="checkbox"/> Casing Repair	<input type="checkbox"/> New Construction	<input type="checkbox"/> Recomplete	<input checked="" type="checkbox"/> Other
	<input type="checkbox"/> Change Plans	<input type="checkbox"/> Plug and Abandon	<input type="checkbox"/> Temporarily Abandon	Change to Original A
	<input type="checkbox"/> Convert to Injection	<input type="checkbox"/> Plug Back	<input type="checkbox"/> Water Disposal	PD

13. Describe Proposed or Completed Operation: Clearly state all pertinent details, including estimated starting date of any proposed work and approximate duration thereof. If the proposal is to deepen directionally or recompleat horizontally, give subsurface locations and measured and true vertical depths of all pertinent markers and zones. Attach the Bond under which the work will be performed or provide the Bond No. on file with BLM/BIA. Required subsequent reports must be filed within 30 days following completion of the involved operations. If the operation results in a multiple completion or recompleat in a new interval, a Form 3160-4 must be filed once testing has been completed. Final Abandonment Notices must be filed only after all requirements, including reclamation, have been completed and the operator has determined that the site is ready for final inspection.

Cimarex respectfully requests approval to change the V-door to north on the Triste Draw 25 Fed 5H. The short side of the location will be south so there will be no additional surface disturbance. Please see attached diagram.

Approved as written *IR [Signature]* *Bar Balla* 12-22-2016

14. I hereby certify that the foregoing is true and correct.

Electronic Submission #361911 verified by the BLM Well Information System
For CIMAREX ENERGY COMPANY, sent to the Hobbs

Name (Printed/Typed) ARICKA EASTERLING

Title REGULATORY ANALYST

Signature (Electronic Submission)

Date 12/22/2016

THIS SPACE FOR FEDERAL OR STATE OFFICE USE

Approved By *[Signature]*Title *[Signature]* FIELD MANAGER

Date 1/29/16

Conditions of approval, if any, are attached. Approval of this notice does not warrant or certify that the applicant holds legal or equitable title to those rights in the subject lease which would entitle the applicant to conduct operations thereon.

Office CARLSBAD FIELD OFFICE

Title 18 U.S.C. Section 1001 and Title 43 U.S.C. Section 1212, make it a crime for any person knowingly and willfully to make to any department or agency of the United States any false, fictitious or fraudulent statements or representations as to any matter within its jurisdiction.

(Instructions on page 2)

** OPERATOR-SUBMITTED ** OPERATOR-SUBMITTED ** OPERATOR-SUBMITTED **

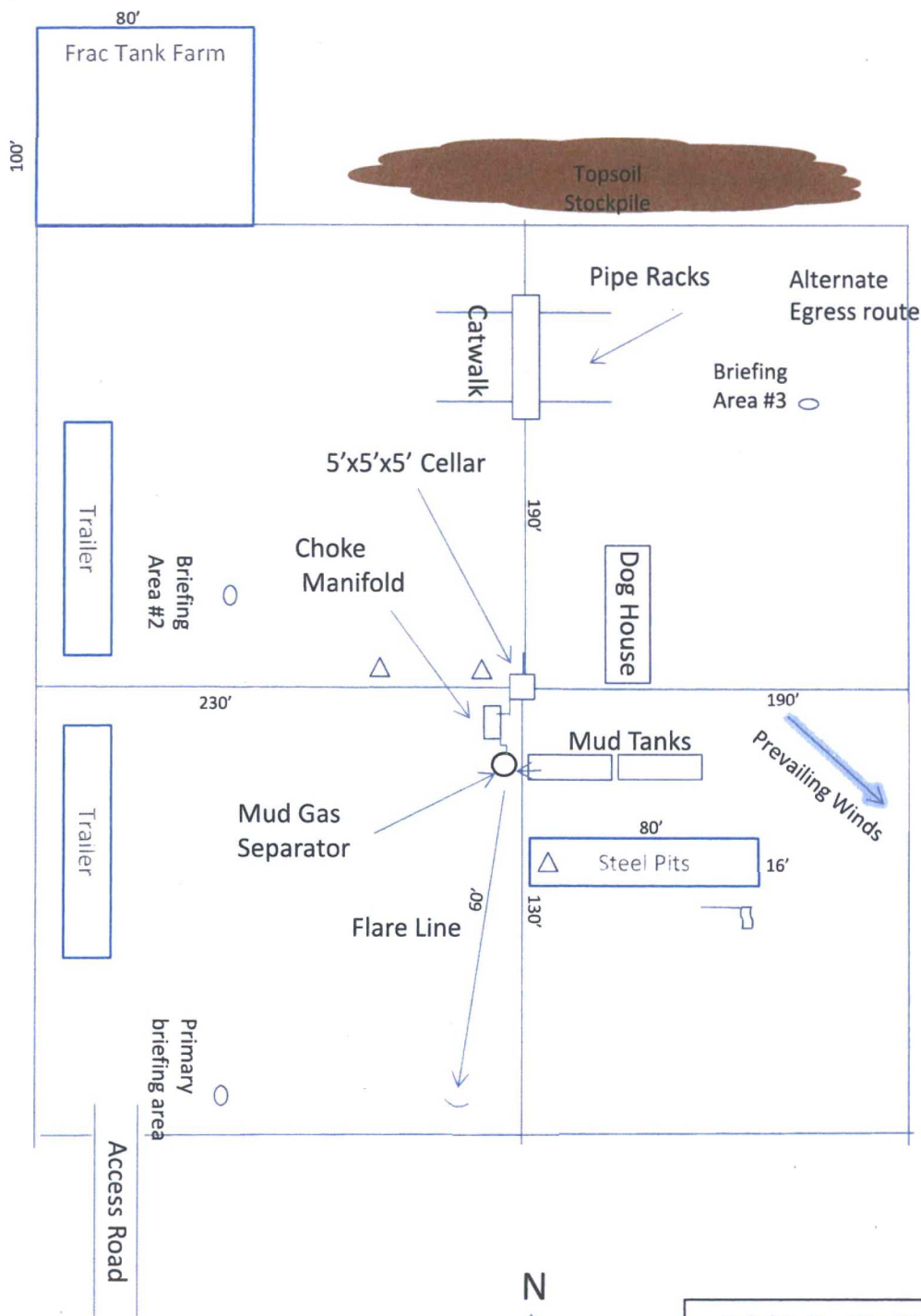



-  Wind Direction Indicators (wind sock or streamers)
- H2S Monitors (alarms at bell nipple and shale shaker)
-  Briefing Areas

Exhibit D – Rig Diagram
Triste Draw 25 Federal 5H
 Cimarex Energy Co.
 25-23S-32E
 Lea County, NM