

DISTRICT I  
1625 N. French Dr., Hobbs, NM 88240  
Phone: (575) 393-6161 Fax: (575) 393-0720  
DISTRICT II  
811 S. First St., Artesia, NM 88210  
Phone: (575) 748-1283 Fax: (575) 748-9720  
DISTRICT III  
1000 Rio Brazos Road, Aztec, NM 87410  
Phone: (505) 334-6178 Fax: (505) 334-6170  
DISTRICT IV  
1220 S. St. Francis Dr., Santa Fe, NM 87505  
Phone: (505) 476-3460 Fax: (505) 476-3462

State of New Mexico  
Energy, Minerals & Natural Resources Department  
OIL CONSERVATION DIVISION  
1220 South St. Francis Dr.  
Santa Fe, New Mexico 87505

Form C-102  
Revised August 1, 2011  
Submit one copy to appropriate  
District Office

☐ AMENDED REPORT

WELL LOCATION AND ACREAGE DEDICATION PLAT

API Number <b>70-025-44299</b>	Pool Code 98094	Pool Name <b>ROJOAT DRAW</b> <b>WC 025 G09 S253336D; UPPER WOLFCAMP</b>
Property Code <b>720524</b>	Property Name <b>ROJO 7811 34-27 FEDERAL COM</b>	Well Number 20H
OGRID No 260297	Operator Name <b>BTA OIL PRODUCERS, LLC</b>	Elevation 3323'

Surface Location

UL or lot No	Section	Township	Range	Lot Idn	Feet from the	North/South line	Feet from the	East/West line	County
L	34	25-S	33-E		1540	SOUTH	690	WEST	LEA

Bottom Hole Location If Different From Surface

UL or lot No.	Section	Township	Range	Lot Idn	Feet from the	North/South line	Feet from the	East/West line	County
D	27	25-S	33-E		50	NORTH	990	WEST	LEA
Dedicated Acres 280	Joint or Infill	Consolidation Code	Order No						

NO ALLOWABLE WILL BE ASSIGNED TO THIS COMPLETION UNTIL ALL INTERESTS HAVE BEEN CONSOLIDATED OR A NON-STANDARD UNIT HAS BEEN APPROVED BY THE DIVISION

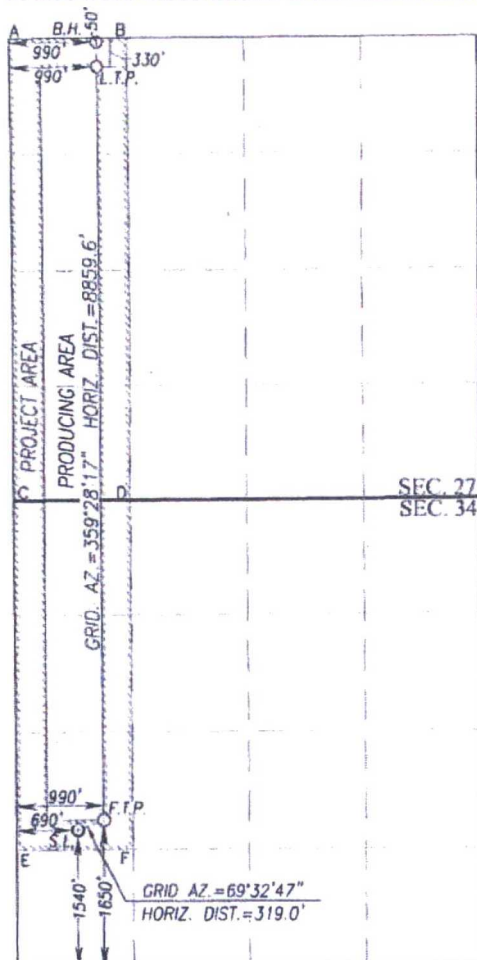

SCALE: 1"=2000'

BOTTOM HOLE LOCATION	BOTTOM HOLE LOCATION
NAD 27 NME	NAD 83 NME
Y = 404051.6 N	Y = 404109.3 N
X = 737863.0 E	X = 779049.3 E
LAT. = 32.108524° N	LAT. = 32.108649° N
LONG. = 103.565124° W	LONG. = 103.565595° W
LAST TAKE POINT	LAST TAKE POINT
NAD 27 NME	NAD 83 NME
Y = 403771.6 N	Y = 403829.3 N
X = 737865.6 E	X = 779051.8 E
LAT. = 32.107754° N	LAT. = 32.107879° N
LONG. = 103.565122° W	LONG. = 103.565593° W

CORNER COORDINATES TABLE

NAD 27 NME
A - Y = 404095.0 N, X = 736872.7 E
B - Y = 404103.8 N, X = 738199.0 E
C - Y = 398814.0 N, X = 736921.4 E
D - Y = 398822.6 N, X = 738243.9 E
E - Y = 394858.9 N, X = 736957.7 E
F - Y = 394866.1 N, X = 738279.6 E

CORNER COORDINATES TABLE

NAD 83 NME
A - Y = 404152.8 N, X = 778059.0 E
B - Y = 404161.5 N, X = 779385.3 E
C - Y = 398871.6 N, X = 778107.9 E
D - Y = 398880.1 N, X = 779430.4 E
E - Y = 394916.4 N, X = 778144.4 E
F - Y = 394923.6 N, X = 779466.4 E

FIRST TAKE POINT	FIRST TAKE POINT
NAD 27 NME	NAD 83 NME
Y = 395194.2 N	Y = 395251.7 N
X = 737944.3 E	X = 779131.0 E
LAT. = 32.084175° N	LAT. = 32.084300° N
LONG. = 103.565065° W	LONG. = 103.565535° W
GEODETIC COORDINATES	GEODETIC COORDINATES
NAD 27 NME	NAD 83 NME
SURFACE LOCATION	SURFACE LOCATION
Y = 395082.7 N	Y = 395140.2 N
X = 737645.4 E	X = 778832.1 E
LAT. = 32.083875° N	LAT. = 32.083999° N
LONG. = 103.566033° W	LONG. = 103.566502° W

OPERATOR CERTIFICATION

I hereby certify that the information herein is true and complete to the best of my knowledge and belief, and that this organization either owns a working interest or unleased mineral interest in the land including the proposed bottom hole location or has a right to drill this well at this location pursuant to a contract with an owner of such mineral or working interest, or to a voluntary pooling agreement or a compulsory pooling order heretofore entered by the division

*Kayla McConnell* 6/8/2017  
Signature Date  
Kayla McConnell  
Printed Name  
kmcconnell@btaoil.com  
E-mail Address

SURVEYOR CERTIFICATION

I hereby certify that the well location shown on this plat was plotted from field notes of actual surveys made by me or under my supervision, and that the same is true and correct to the best of my belief.

JANUARY 18, 2017

Date of Survey  
Signature & Seal of Professional Surveyor  
**RONALD J. EIDSON**  
NEW MEXICO  
REGISTERED  
3239  
PROFESSIONAL SURVEYOR  
*Ronald J. Eidson* 05/18/2017  
Certificate Number  
Ronald J. Eidson 12641  
3239  
ACK/DSS Rel W.O.: 16.11.1065 JWSC W.O.: 17.13.0501