

DISTRICT I  
1625 N. French Dr., Hobbs, NM 88240  
Phone (505) 833-6161 Fax (505) 833-0720

DISTRICT II  
811 S. First St., Artesia, NM 88210  
Phone (505) 746-1553 Fax (505) 746-0720

DISTRICT III  
1000 Rio Brazos Rd., Artec, NM 87410  
Phone (505) 834-6178 Fax (505) 834-6170

DISTRICT IV  
1226 S. St. Francis Dr., Santa Fe, NM 87505  
Phone (505) 476-8480 Fax (505) 476-3488

State of New Mexico  
Energy, Minerals and Natural Resources Department

OIL CONSERVATION DIVISION  
1226 South St. Francis Dr.  
Santa Fe, New Mexico 87505

Form C-102  
Revised August 1, 2011

Submit one copy to appropriate  
District Office

HOBBS OCD  
MAY 29 2019  
RECEIVED

WELL LOCATION AND ACREAGE DEDICATION PLAT

☐ AMENDED REPORT

API Number 30-025-44398	Pool Code 37580	Pool Name Lea Bone Spring: South
Property Code 313780	Property Name IGLOO 19 STATE	Well Number 11H
OGRID No. 249099	Operator Name CAZA OPERATING, LLC.	Elevation 3703'

Surface Location

UL or lot No. P	Section 19	Township 20 S	Range 35 E	Lot Idn	FEET from the 100	North/South line SOUTH	FEET from the 870	East/West line EAST	County LEA
--------------------	---------------	------------------	---------------	---------	----------------------	---------------------------	----------------------	------------------------	---------------

Bottom Hole Location If Different From Surface

UL or lot No. A	Section 19	Township 20 S	Range 35 E	Lot Idn	FEET from the 20	North/South line NORTH	FEET from the 777	East/West line EAST	County LEA
--------------------	---------------	------------------	---------------	---------	---------------------	---------------------------	----------------------	------------------------	---------------

Dedicated Acres 160	Joint or Infill	Consolidation Code	Order No.
------------------------	-----------------	--------------------	-----------

NO ALLOWABLE WILL BE ASSIGNED TO THIS COMPLETION UNTIL ALL INTERESTS HAVE BEEN CONSOLIDATED  
OR A NON-STANDARD UNIT HAS BEEN APPROVED BY THE DIVISION

N: 570582.3 E: 708473.7 (NAD 83)	N: 570818.1 E: 708114.3 (NAD 83)	<b>PROPOSED BOTTOM HOLE LOCATION</b> Lat - N 32.565858 Long - W 103.490547 NMSPC- N 570617.7 E 800977.7 (NAD-83)	N: 570846.8 E: 801784.5 (NAD 83)
N: 570842.3 E: 708496.0 (NAD 83)		<b>LAST TAKE POINT</b> 100' FNL & 777' FEL Lat - N 32.565639 Long - W 103.490547 NMSPC- N 570537.7 E 800978.2 (NAD-83)	N: 570846.8 E: 801772.6 (NAD 83)
N: 565310.9 E: 708508.3 (NAD 83)	N: 565334.5 E: 708154.5 (NAD 83)	<b>FIRST TAKE POINT</b> 100' FSL & 777' FEL Lat - N 32.551664 Long - W 103.490558 NMSPC- N 565453.2 E 801015.3 (NAD-83)	N: 565361.1 E: 801782.9 (NAD 83)
		<b>SURFACE LOCATION</b> Lat - N 32.551663 Long - W 103.490860 NMSPC- N 565452.5 E 800922.5 (NAD-83)	

Scale: 1" = 2000'  
WO Num.: 34429

OPERATOR CERTIFICATION

I hereby certify that the information contained herein is true and complete to the best of my knowledge and belief, and that this organization either owns a working interest or unleased mineral interest in the land including the proposed bottom hole location or has a right to drill this well at this location pursuant to a contract with an owner of such a mineral or working interest, or to a voluntary pooling agreement or a compulsory pooling order heretofore entered by the division.

5/23/2019

Signature Date

Steve Morris

Printed Name  
steve.morris@morcoreengineering.com

Email Address

SURVEYOR CERTIFICATION

I hereby certify that the well location shown on this plat was plotted from field notes of actual surveys made by me or under my supervision and that the same is true and correct to the best of my belief.

Date Surveyed  
Signature of Professional Surveyor

Certificate Number 7977  
Surveyor Name

## Kasie Logsdon

---

**From:** Steven Morris <steve.morris@morcorengineering.com>  
**Sent:** Thursday, May 23, 2019 9:01 AM  
**To:** Kasie Logsdon  
**Subject:** Igloo 19 State 11H - Move SHL - Sundry  
**Attachments:** IGLOO 19 STATE 11H C-102 Old Plat - Signed.pdf; IGLOO 19 STATE 11H - C-102-signed.pdf; Igloo 19 State 11H - Move SHL - Sundry-signed.pdf

Kasie

Please print the attached and mail to:

NMOCD District 1 - HOBBS

1625 N. French Drive  
Hobbs, New Mexico 88240

Regards,

Steve Morris  
President

**MORCOR  
ENERGY**

*A Full Service Oil & Gas Company with Integrated Directional*

**Morcor Energy LLC**

14102 West County Rd

Odessa, TX

79766

CDN Cell 403-923-9750

US Cell 985-415-9729

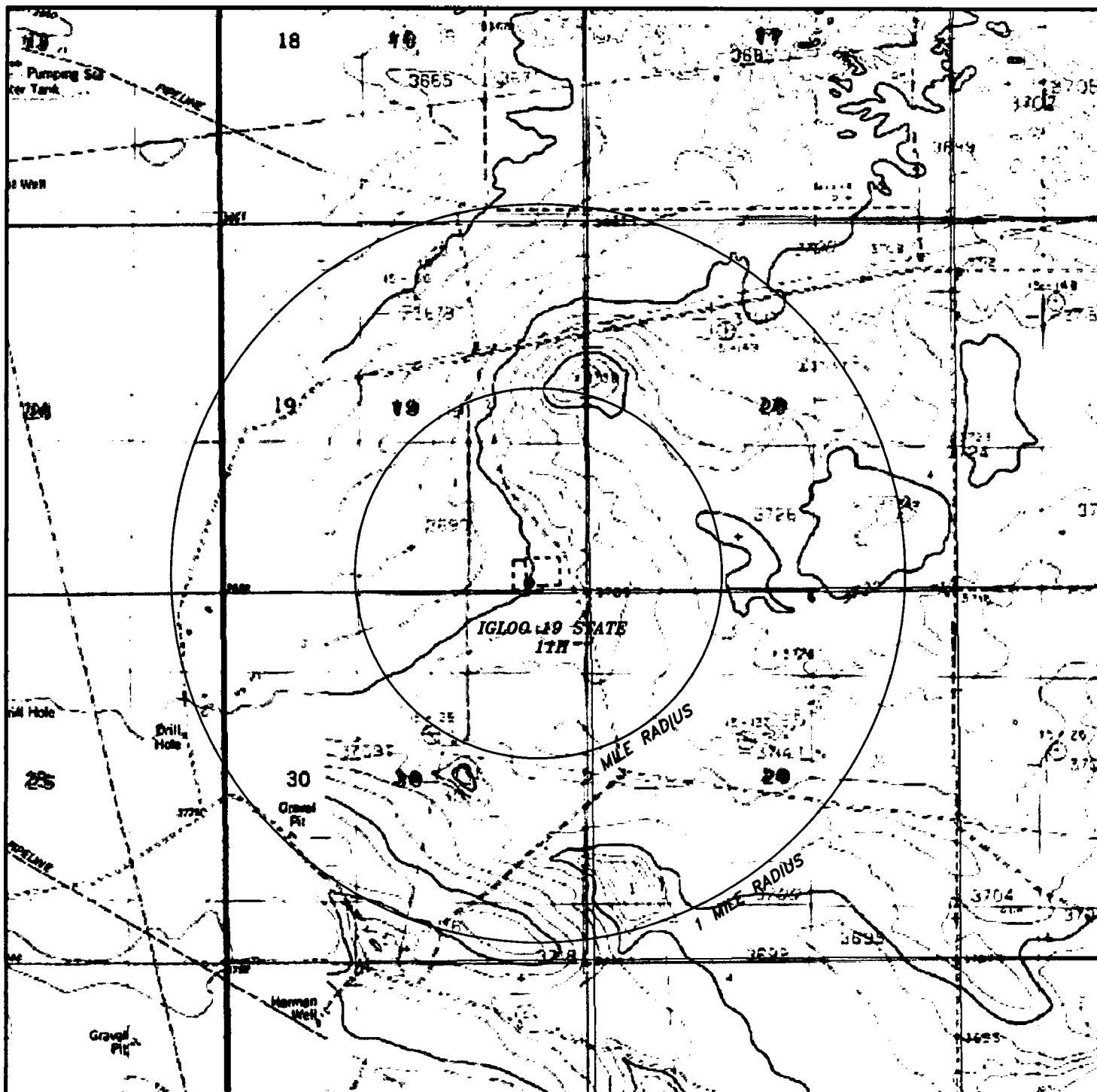

**IGLOO 19 STATE 11H**  
 Located 100' FSL and 870' FEL  
 Section 19, Township 20 South, Range 35 East,  
 N.M.P.M., Lea County, New Mexico.

**basin**  
**surveys**  
 focused on excellence  
 in the oilfield

P.O. Box 1786  
 1120 N. West County Rd.  
 Hobbs, New Mexico 88241  
 (575) 393-7316 - Office  
 (575) 392-2206 - Fax  
 basinsurveys.com

0' 1000' 2000' 3000' 4000'

SCALE: 1" = 2000'

W.O. Number: JG 34429

Survey Date: 3-18-2019

YELLOW TINT - USA LAND  
 BLUE TINT - STATE LAND  
 NATURAL COLOR - FEE LAND

**CAZA**  
**OPERATING,**  
**LLC.**

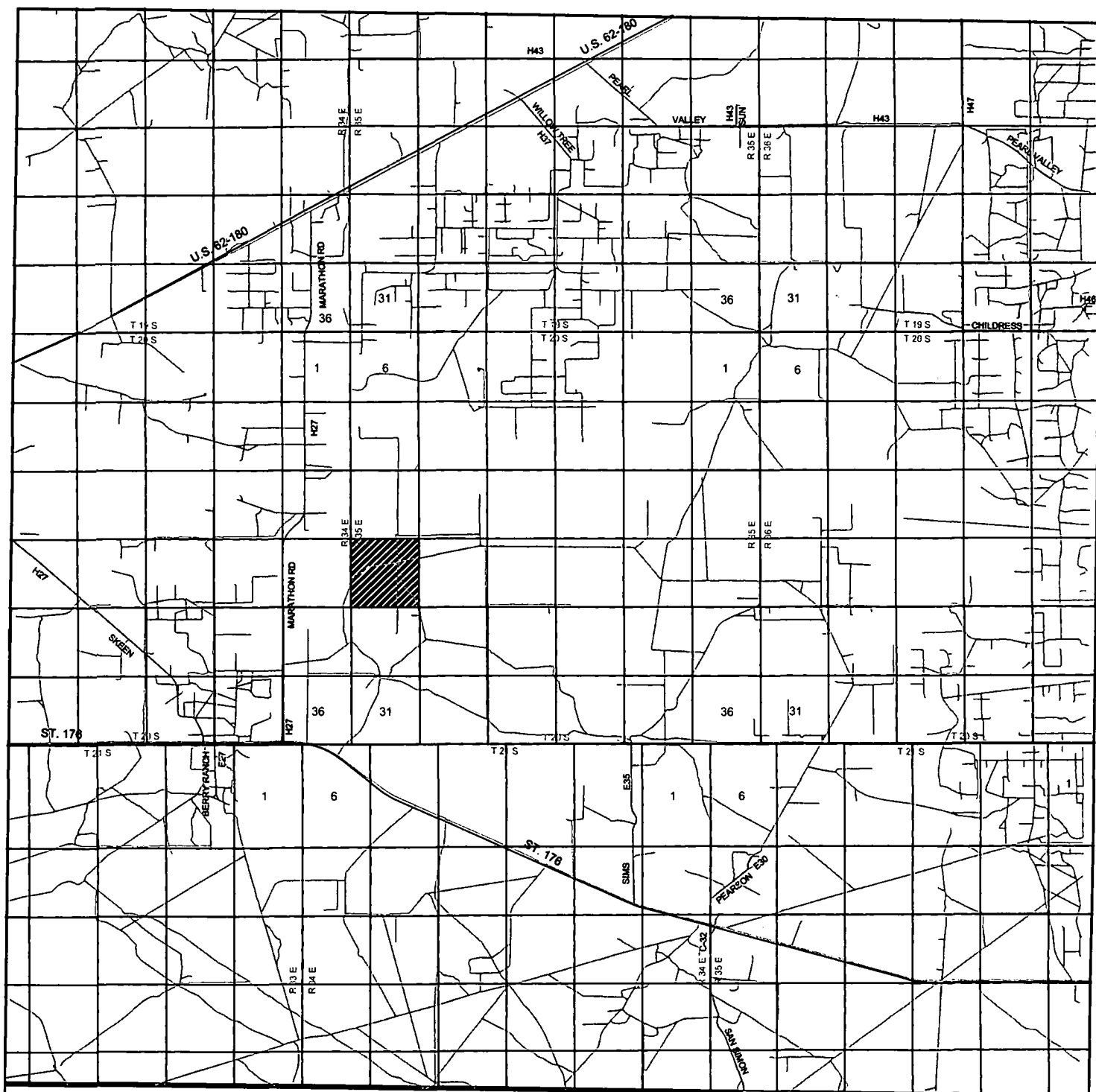

**IGL00 19 STATE 11H**  
 Located 100' FSL and 870' FEL  
 Section 19, Township 20 South, Range 35 East,  
 N.M.P.M., Lea County, New Mexico.

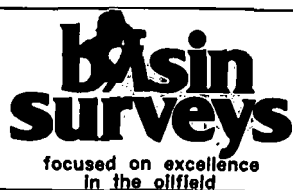

P.O. Box 1786  
 1120 N. West County Rd.  
 Hobbs, New Mexico 88241  
 (575) 393-7316 - Office  
 (575) 392-2206 - Fax  
[basinsurveys.com](http://basinsurveys.com)

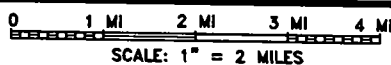

W.O. Number: JG 34429

Survey Date: 3-18-2019

YELLOW TINT - USA LAND  
 BLUE TINT - STATE LAND  
 NATURAL COLOR - FEE LAND



**CAZA  
 OPERATING,  
 LLC.**

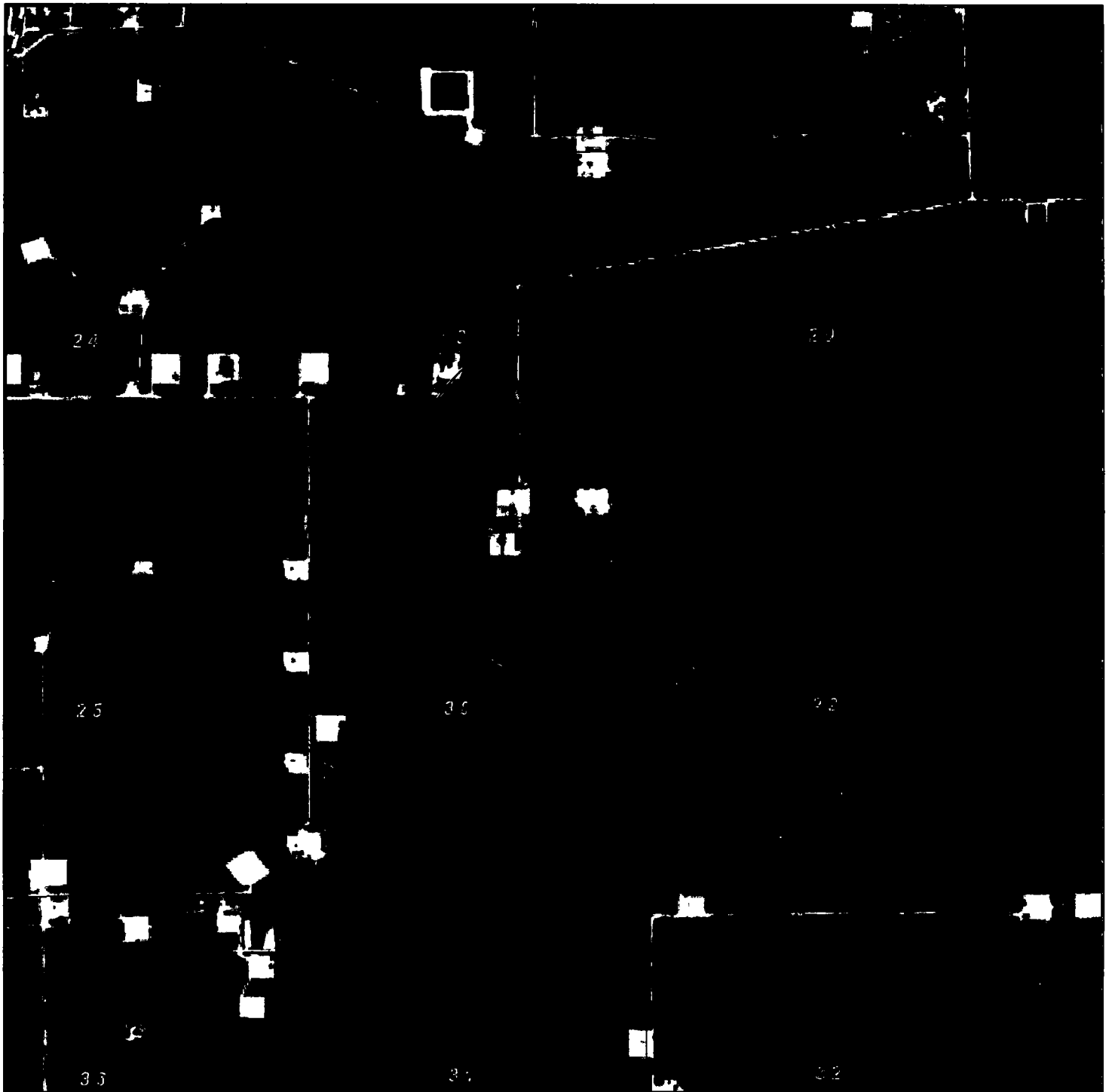

IGLOO 19 STATE 11H  
Located 100' FSL and 870' FEL  
Section 19, Township 20 South, Range 35 East,  
N.M.P.M., Lea County, New Mexico.

**basin**  
**surveys**  
focused on excellence  
in the oilfield

P.O. Box 1786  
1120 N. West County Rd.  
Hobbs, New Mexico 88241  
(575) 393-7316 - Office  
(575) 392-2206 - Fax  
basinsurveys.com

0' 1000' 2000' 3000' 4000'

SCALE: 1" = 2000'

W.O. Number: JG 34429

Survey Date: 3-18-2019

YELLOW TINT - USA LAND  
BLUE TINT - STATE LAND  
NATURAL COLOR - FEE LAND



CAZA  
OPERATING,  
LLC.