

Submit 1 Copy To Appropriate District Office  
District I - (575) 393-6161  
1625 N. French Dr., Hobbs, NM 88240  
District II - (575) 748-1283  
811 S. First St., Artesia, NM 88210  
District III - (505) 334-6178  
1000 Rio Brazos Rd., Aztec, NM 87410  
District IV - (505) 476-3460  
1220 S. St. Francis Dr., Santa Fe, NM 87505

State of New Mexico  
Energy, Minerals and Natural Resources

Form C-103  
Revised July 18, 2013

OIL CONSERVATION DIVISION  
1220 South St. Francis Dr.  
Santa Fe, NM 87505

WELL API NO. 30-025-45303
5. Indicate Type of Lease STATE <input checked="" type="checkbox"/> FEE <input type="checkbox"/>
6. State Oil & Gas Lease No.
7. Lease Name or Unit Agreement Name <b>Lennox 32 State</b>
8. Well Number 3H
9. OGRID Number 249099
10. Pool name or Wildcat <del>Featherstone</del> Bone Spring
11. Elevation (Show whether DR, RKB, RT, GR, etc.) 3539 GR

**SUNDRY NOTICES AND REPORTS ON WELLS**  
(DO NOT USE THIS FORM FOR PROPOSALS TO DRILL OR TO DEEPEN OR PLUG BACK IN A DIFFERENT RESERVOIR. USE "APPLICATION FOR PERMIT" (FORM C-101) FOR SUCH PROPOSALS.)

1. Type of Well: Oil Well ☒ Gas Well ☐ Other ☐

2. Name of Operator  
Caza Oil and Gas, Inc

3. Address of Operator  
200 N. Lorraine St #1550., Midland, TX 79701

4. Well Location  
Unit Letter **C** : **385** feet from the **N** line and **1620** feet from the **E** line  
Section **32** Township **22S** Range **35E** NMPM County **Lea**

12. Check Appropriate Box to Indicate Nature of Notice, Report or Other Data

NOTICE OF INTENTION TO:		SUBSEQUENT REPORT OF:	
PERFORM REMEDIAL WORK <input type="checkbox"/>	PLUG AND ABANDON <input type="checkbox"/>	REMEDIAL WORK <input type="checkbox"/>	ALTERING CASING <input type="checkbox"/>
TEMPORARILY ABANDON <input type="checkbox"/>	CHANGE PLANS <input type="checkbox"/>	COMMENCE DRILLING OPNS. <input type="checkbox"/>	P AND A <input type="checkbox"/>
PULL OR ALTER CASING <input type="checkbox"/>	MULTIPLE COMPL <input type="checkbox"/>	CASING/CEMENT JOB <input type="checkbox"/>	
DOWNHOLE COMMINGLE <input type="checkbox"/>			
CLOSED-LOOP SYSTEM <input type="checkbox"/>			
OTHER: <input checked="" type="checkbox"/>		OTHER: <input type="checkbox"/>	

13. Describe proposed or completed operations. (Clearly state all pertinent details, and give pertinent dates, including estimated date of starting any proposed work). SEE RULE 19.15.7.14 NMAC. For Multiple Completions: Attach wellbore diagram of proposed completion or recompletion.

Caza proposes to move the surface location from 385'FNL 1620'FWL to 425'FNL 1650'FWL. Attached is the amended C-102 plat.

Spud Date:

Rig Release Date:

I hereby certify that the information above is true and complete to the best of my knowledge and belief.

SIGNATURE

TITLE

Engineer

DATE

09/4/2019

Type or print name

Steve Morris

E-mail address:

steve.morri@morcoreengineering.com

PHONE:

985-415-9729

For State Use Only

APPROVED BY:

TITLE

Petroleum Engineer

DATE

09/10/19

Conditions of Approval (if any):

HOBBS OCD

# LOCATION VERIFICATION MAP

SEP 05 2019

RECEIVED

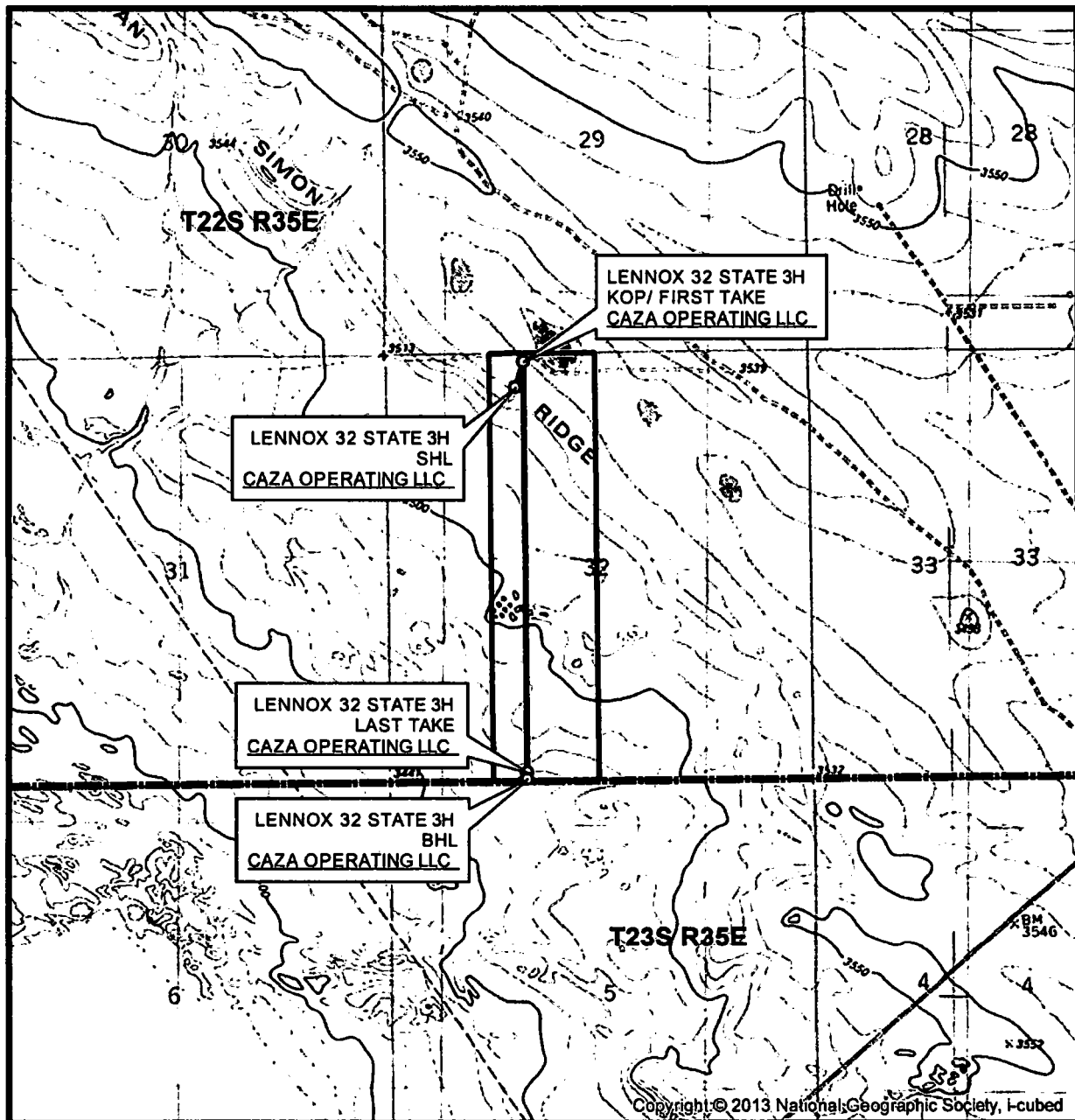

SEC. 32 TWP. 22-S RGE. 35-E  
SURVEY: N.M.P.M.  
COUNTY: LEA  
OPERATOR: CAZA OPERATING LLC  
DESCRIPTION: 425' FNL & 1650' FWL  
ELEVATION: 3535'  
LEASE: LENNOX 32 STATE  
U.S.G.S. TOPOGRAPHIC MAP: SAN SIMON SINK, NM.

1" = 2,000'  
CONTOUR INTERVAL = 10'



SHEET 2 OF 3

PREPARED BY:  
R-SQUARED GLOBAL, LLC  
1309 LOUISVILLE AVENUE, MONROE, LA 71201  
318-323-6800 OFFICE  
JOB No. R4017\_001\_B

# VICINITY MAP

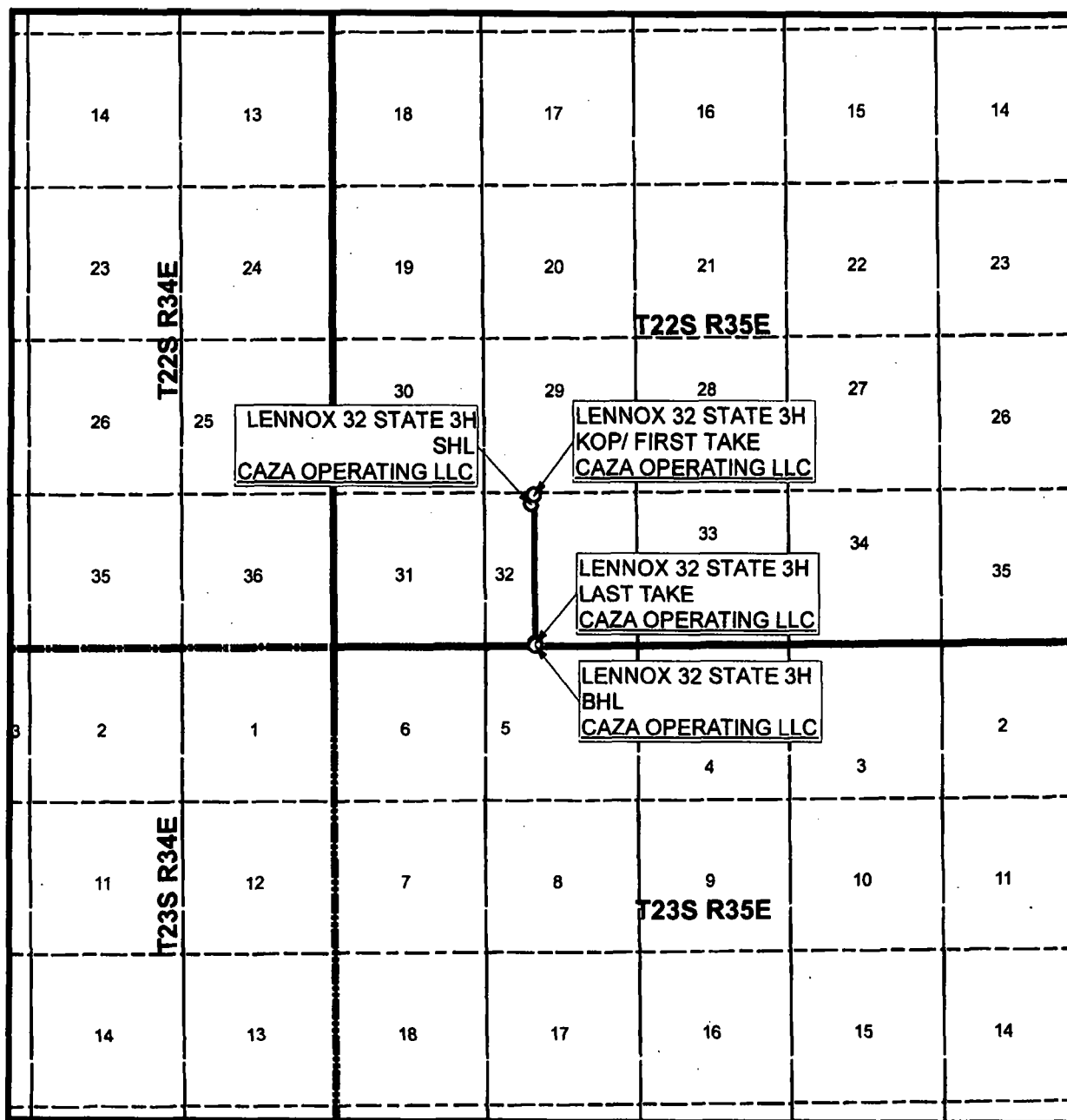

SEC. 32 TWP. 22-S RGE. 35-E

SURVEY: N.M.P.M.

COUNTY: LEA

OPERATOR: CAZA OPERATING LLC

DESCRIPTION: 425' FNL & 1650' FWL

ELEVATION: 3535'

LEASE: LENNOX 32 STATE

U.S.G.S. TOPOGRAPHIC MAP: SAN SIMON SINK, NM.

1" = 1 MILE



SHEET 3 OF 3

PREPARED BY:

R-SQUARED GLOBAL, LLC

1309 LOUISVILLE AVENUE, MONROE, LA 71201

318-323-8900 OFFICE

JOB No. R4017\_001\_B