

S

Form C-102
Revised October 12, 2005

DISTRICT I
1825 N. French Dr., Hobbs, NM 88240
DISTRICT II
1301 W. Grand Avenue, Artesia, NM 88210
DISTRICT III
1000 Rio Brazos Rd., Aztec, NM 87410
DISTRICT IV
1220 S. St. Francis Dr., Santa Fe, NM 87505

State of New Mexico
Energy, Minerals and Natural Resources Department

Submit to Appropriate District Office
State Lease - 4 Copies
Fee Lease - 3 Copies

OIL CONSERVATION DIVISION
1220 South St. Francis Dr.
Santa Fe, New Mexico 87505

DEC 14 2007 AMENDED REPORT

OCD-ARTESIA

WELL LOCATION AND ACREAGE DEDICATION PLAT

API Number 30-005-27995	Pool Code	Pool Name WILDCAT; WOLF CAMP
Property Code 36890	Property Name TAURUS STATE COM	Well Number 2H
OGRID No. 229137	Operator Name C.O.G. OPERATING L.L.C.	Elevation 4396'

Surface Location

UL or lot No.	Section	Township	Range	Lot Idn	Feet from the	North/South line	Feet from the	East/West line	County
I	10	15 S	31 E		1980	SOUTH	330	EAST	CHAVES

Bottom Hole Location If Different From Surface

UL or lot No.	Section	Township	Range	Lot Idn	Feet from the	North/South line	Feet from the	East/West line	County
L	10	15 S	31 E		1980	SOUTH	430	WEST	CHAVES

Dedicated Acres 160	Joint or Infill	Consolidation Code	Order No.
-------------------------------	-----------------	--------------------	-----------

NO ALLOWABLE WILL BE ASSIGNED TO THIS COMPLETION UNTIL ALL INTERESTS HAVE BEEN CONSOLIDATED OR A NON-STANDARD UNIT HAS BEEN APPROVED BY THE DIVISION

<p>BOTTOM HOLE LOCATION LAT.: N 33°01'42.90" LONG.: W103°49'00.46" SPC- N.: 738324.776 E.: 699645.621 (NAD-83)</p>		<p>SURFACE LOCATION LAT.: N 33°01'43.070" LONG.: W103°48'07.24" SPC- N.: 738364.797 E.: 704176.362 (NAD-83)</p>	<p>OPERATOR CERTIFICATION</p> <p>I hereby certify that the information contained herein is true and complete to the best of my knowledge and belief, and that this organization either owns a working interest or unleased mineral interest in the land including the proposed bottom hole location pursuant to a contract with an owner of such a mineral or working interest, or to a voluntary pooling agreement or a compulsory pooling order heretofore entered by the division.</p> <p><i>[Signature]</i> ^{12/13/07} Signature Date PHILIP A. EDWARDS Printed Name</p>
			<p>SURVEYOR CERTIFICATION</p> <p>I hereby certify that the well location shown on this plat was plotted from field notes of actual surveys made by me or under my supervision and that the same is true and correct to the best of my belief.</p> <p>DECEMBER 7 2007 Date Surveyed Signature & Seal of Professional Surveyor <i>[Signature]</i> Professional Surveyor 7977 W.O. No. 12903 Certificate No. Gary L. Jones 7977 BASIN SURVEYS</p>

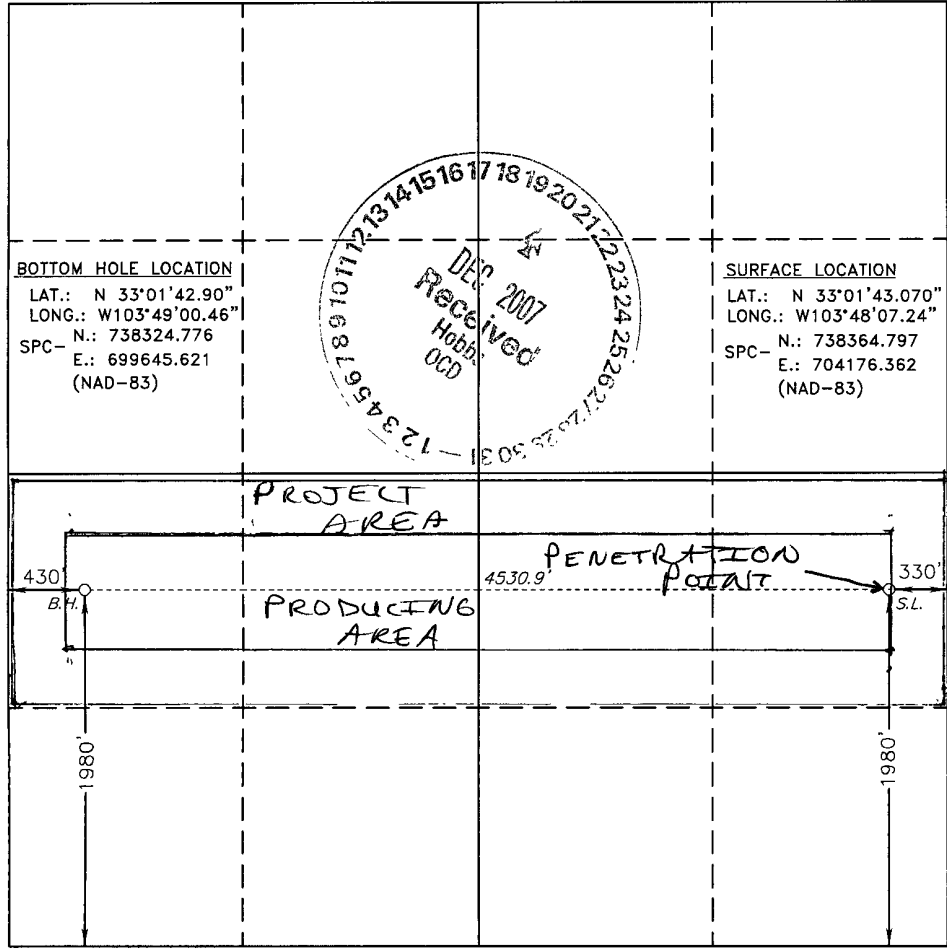

[Handwritten mark]

COG OPERATING LLC
550 W. Texas, Suite 1300
Midland, TX 79701

432-683-7443 P
432-685-4399 F

December 13, 2007

New Mexico Oil Conservation Division
Attn: Bryan Arrant
1301 W. Grand Avenue
Artesia, NM 88210

Re: Directional Plan
Taurus State 2 – Wolfcamp Oil Well

Dear Bryan,

COG has ordered a directional plan for this well, but I am submitting the Taurus Federal 1 directional plan in the interim. The Taurus State 2 will be the same, except the horizontal will be in a westerly direction.

Please call, e-mail, or fax me if you need anything further to approve this APD, and I thank you in advance for your cooperation in this matter.

Sincerely,



Phyllis Edwards
Regulatory Analyst

432-685-4340 phone
432-685-4399 fax
pedwards@conchoresources.com

Planned Wellpath Report

Plan #1
Page 1 of 5



INTEQ

REFERENCE WELLPATH IDENTIFICATION

Operator	Concho O&G	Slot	#1H_SHL
Area	Chavez County, NM	Well	#1H
Field	(Taurus)Section 10 T15S R31E	Wellbore	#1H_PWB
Facility	Taurus Federal #1H		

REPORT SETUP INFORMATION

Projection System	NAD83 / TM New Mexico State Planes, Eastern Zone (3001), US feet	Software System	WellArchitect™ 1.2
North Reference	Grid	User	Gomeoscr
Scale	0.999938	Report Generated	09/21/07 at 06:51:42
Wellbore last revised	09/20/07	Database/Source file	WA_Midland/#1H_PWB.xn

WELLPATH LOCATION

	Local coordinates		Grid coordinates		Geographic coordinates	
	North [feet]	East [feet]	Easting [US feet]	Northing [US feet]	Latitude [°]	Longitude [°]
Slot Location	0.00	0.00	699556.00	736670.60	33 01 26.537N	103 49 01.613W
Facility Reference Pt			699556.00	736670.60	33 01 26.537N	103 49 01.613W
Field Reference Pt			699556.00	736670.60	33 01 26.537N	103 49 01.613W

WELLPATH DATUM

Calculation method	Minimum curvature	Rig on #1H_SHL (RT) to Facility Vertical Datum	0.00 feet
Horizontal Reference Pt	Facility Center	Rig on #1H_SHL (RT) to GRN. ELEV.	4415.00 feet
Vertical Reference Pt	Rig on #1H_SHL (RT)	Facility Vertical Datum to Mud Line (Facility)	0.00 feet
MD Reference Pt	Rig on #1H_SHL (RT)	Section Origin	N 0.00, E 0.00 ft
Field Vertical Reference	GRN. ELEV.	Section Azimuth	89.49°

Planned Wellpath Report

Plan #1
Page 2 of 5



INTEQ

REFERENCE WELLPATH IDENTIFICATION

Operator	Concho O&G	Slot	#1H_SHL
Area	Chavez County, NM	Well	#1H
Field	(Taurus)Section 10 T15S R31E	Wellbore	#1H_PWB
Facility	Taurus Federal #1H		

WELLPATH DATA (59 stations) † = interpolated/extrapolated station

MD [feet]	Inclination [°]	Azimuth [°]	TVD [feet]	Vert Sect [feet]	North [feet]	East [feet]	DLS [°/100ft]	Design Comments	Path Comment
0.00	0.000	89.491	0.00	0.00	0.00	0.00	0.00	Tie On	
2380.00†	0.000	89.491	2380.00	0.00	0.00	0.00	0.00		Yates
3190.00†	0.000	89.491	3190.00	0.00	0.00	0.00	0.00		Queen
3920.00†	0.000	89.491	3920.00	0.00	0.00	0.00	0.00		San Andres D
6740.00†	0.000	89.491	6740.00	0.00	0.00	0.00	0.00		Tubb
7430.00†	0.000	89.491	7430.00	0.00	0.00	0.00	0.00		Abo
8200.00	0.000	89.491	8200.00	0.00	0.00	0.00	0.00	KOP	
8300.00†	12.060	89.491	8299.26	10.49	0.09	10.49	12.06		
8400.00†	24.120	89.491	8394.14	41.48	0.37	41.48	12.06		
8500.00†	36.180	89.491	8480.46	91.61	0.81	91.61	12.06		
8600.00†	48.240	89.491	8554.39	158.67	1.41	158.67	12.06		
8700.00†	60.300	89.491	8612.68	239.70	2.13	239.69	12.06		
8800.00†	72.360	89.491	8652.75	331.12	2.94	331.11	12.06		
8807.62†	73.278	89.491	8655.00	338.40	3.00	338.38	12.06		Wolfcamp
8900.00†	84.420	89.491	8672.84	428.89	3.81	428.88	12.06		
8938.28	89.037	89.491	8675.02	467.11	4.15	467.09	12.06	EOC	
9000.00†	89.037	89.491	8676.06	528.81	4.69	528.79	0.00		
9100.00†	89.037	89.491	8677.74	628.80	5.58	628.77	0.00		
9200.00†	89.037	89.491	8679.42	728.78	6.47	728.76	0.00		
9300.00†	89.037	89.491	8681.10	828.77	7.36	828.74	0.00		
9400.00†	89.037	89.491	8682.78	928.76	8.24	928.72	0.00		
9500.00†	89.037	89.491	8684.46	1028.74	9.13	1028.70	0.00		
9600.00†	89.037	89.491	8686.14	1128.73	10.02	1128.68	0.00		
9700.00†	89.037	89.491	8687.82	1228.71	10.91	1228.67	0.00		
9800.00†	89.037	89.491	8689.50	1328.70	11.79	1328.65	0.00		

Planned Wellpath Report

Plan #1
Page 3 of 5



INTEQ

REFERENCE WELLPATH IDENTIFICATION			
Operator	Concho O&G	Slot	#1H_SHL
Area	Chavez County, NM	Well	#1H
Field	(Taurus)Section 10 T15S R31E	Wellbore	#1H PWB
Facility	Taurus Federal #1H		

WELLPATH DATA (59 stations) † = interpolated/extrapolated station									
MD [feet]	Inclination [°]	Azimuth [°]	TVD [feet]	Vert Sect [feet]	North [feet]	East [feet]	DLS [%/100ft]	Design Comments	Path Comment
9900.00†	89.037	89.491	8691.18	1428.69	12.68	1428.63	0.00		
10000.00†	89.037	89.491	8692.87	1528.67	13.57	1528.61	0.00		
10100.00†	89.037	89.491	8694.55	1628.66	14.46	1628.59	0.00		
10200.00†	89.037	89.491	8696.23	1728.64	15.34	1728.57	0.00		
10300.00†	89.037	89.491	8697.91	1828.63	16.23	1828.56	0.00		
10400.00†	89.037	89.491	8699.59	1928.61	17.12	1928.54	0.00		
10500.00†	89.037	89.491	8701.27	2028.60	18.01	2028.52	0.00		
10600.00†	89.037	89.491	8702.95	2128.59	18.89	2128.50	0.00		
10700.00†	89.037	89.491	8704.63	2228.57	19.78	2228.48	0.00		
10800.00†	89.037	89.491	8706.31	2328.56	20.67	2328.47	0.00		
10900.00†	89.037	89.491	8707.99	2428.54	21.56	2428.45	0.00		
11000.00†	89.037	89.491	8709.67	2528.53	22.44	2528.43	0.00		
11100.00†	89.037	89.491	8711.35	2628.52	23.33	2628.41	0.00		
11200.00†	89.037	89.491	8713.03	2728.50	24.22	2728.39	0.00		
11300.00†	89.037	89.491	8714.71	2828.49	25.11	2828.38	0.00		
11400.00†	89.037	89.491	8716.39	2928.47	26.00	2928.36	0.00		
11500.00†	89.037	89.491	8718.07	3028.46	26.88	3028.34	0.00		
11600.00†	89.037	89.491	8719.75	3128.45	27.77	3128.32	0.00		
11700.00†	89.037	89.491	8721.44	3228.43	28.66	3228.30	0.00		
11800.00†	89.037	89.491	8723.12	3328.42	29.55	3328.29	0.00		
11900.00†	89.037	89.491	8724.80	3428.40	30.43	3428.27	0.00		
12000.00†	89.037	89.491	8726.48	3528.39	31.32	3528.25	0.00		
12100.00†	89.037	89.491	8728.16	3628.37	32.21	3628.23	0.00		
12200.00†	89.037	89.491	8729.84	3728.36	33.10	3728.21	0.00		
12300.00†	89.037	89.491	8731.52	3828.35	33.98	3828.20	0.00		

Planned Wellpath Report

Plan #1
Page 4 of 5



INTEQ

REFERENCE WELLPATH IDENTIFICATION

Operator	Concho O&G	Slot	#1H_SHL
Area	Chavez County, NM	Well	#1H
Field	(Taurus)Section 10 T15S R31E	Wellbore	#1H_PWB
Facility	Taurus Federal #1H		

WELLPATH DATA (59 stations) † = interpolated/extrapolated station

MD [feet]	Inclination [°]	Azimuth [°]	TVD [feet]	Vert Sect [feet]	North [feet]	East [feet]	DLS [°/100ft]	Design Comments	Path Comment
12400.00†	89.037	89.491	8733.20	3928.33	34.87	3928.18	0.00		
12500.00†	89.037	89.491	8734.88	4028.32	35.76	4028.16	0.00		
12600.00†	89.037	89.491	8736.56	4128.30	36.65	4128.14	0.00		
12700.00†	89.037	89.491	8738.24	4228.29	37.53	4228.12	0.00		
12800.00†	89.037	89.491	8739.92	4328.28	38.42	4328.11	0.00		
12900.00†	89.037	89.491	8741.60	4428.26	39.31	4428.09	0.00		
13000.00†	89.037	89.491	8743.28	4528.25	40.20	4528.07	0.00		
13100.00†	89.037	89.491	8744.96	4628.23	41.08	4628.05	0.00		
13102.17	89.037	89.491	8745.00 ¹	4630.40	41.10	4630.22	0.00	#1H BHL	

HOLE & CASING SECTIONS Ref Wellbore: #1H_PWB Ref Wellpath: Plan #1

String/Diameter	Start MD [feet]	End MD [feet]	Interval [feet]	Start TVD [feet]	End TVD [feet]	Start N/S [feet]	Start E/W [feet]	End N/S [feet]	End E/W [feet]
8.75in Open Hole	8200.00	8938.28	738.28	8200.00	8675.02	0.00	0.00	4.15	467.08
7.875in Open Hole	8938.28	13102.17	4163.89	8675.02	NA	4.15	467.08	NA	NA

Planned Wellpath Report

Plan #1
Page 5 of 5



INTEQ

REFERENCE WELLPATH IDENTIFICATION			
Operator	Concho O&G	Slot	#1H_SHL
Area	Chavez County, NM	Well	#1H
Field	(Taurus)Section 10 T15S R31E	Wellbore	#1H_PWB
Facility	Taurus Federal #1H		

TARGETS									
Name	MD [feet]	TVD [feet]	North [feet]	East [feet]	Grid East [us survey feet]	Grid North [us survey feet]	Latitude [°]	Longitude [°]	Shape
1) #1H BHL	13102.17	8745.00	41.10	4630.22	704185.92	736711.70	33 01 26.715N	103 48 07.231W	point

Concho O&G

Location Chavez County, NM
 Field (Taurus)Section 10 T15S R31E
 Facility TaurusFederal#1H

Slot #1H_SHL
 Well #1H
 Wellbore #1H_PWB



Well Profile Data								
Design Comment	MD (ft)	Inc (°)	Az (°)	TVD (ft)	Local N (ft)	Local E (ft)	DLS (°/100ft)	VS (ft)
Tie On	0 00	0 000	89 491	0 00	0 00	0 00	0 00	0 00
KOP	8200 00	0 000	89 491	8200 00	0 00	0 00	0 00	0 00
EOC	8938 28	89 037	89 491	8675 02	4 15	467 09	12 06	467 11
#1H BHL	13102 17	89 037	89 491	8745 00	41 10	4630 22	0 00	4630 40

Plot reference well paths Plan #1	
True vertical depths are referenced to Rigon #1H_SH(URT)	Grid System NAD83/T M New Mexico State Planes, Eastern Zone (3001) US Feet
Measured depths are referenced to Rigon #1H_SH(URT)	North Reference Grid north
Rigon #1H_SH(URT) to GRN ELEV 4415 feet	Scale True distance
GRN ELEV to Mudline (Facility: TaurusFederal#1H) -4415 feet	Depths are in feet
Coordinate are in feet referenced to Facility Center	Created by gomescon 9/21/2007

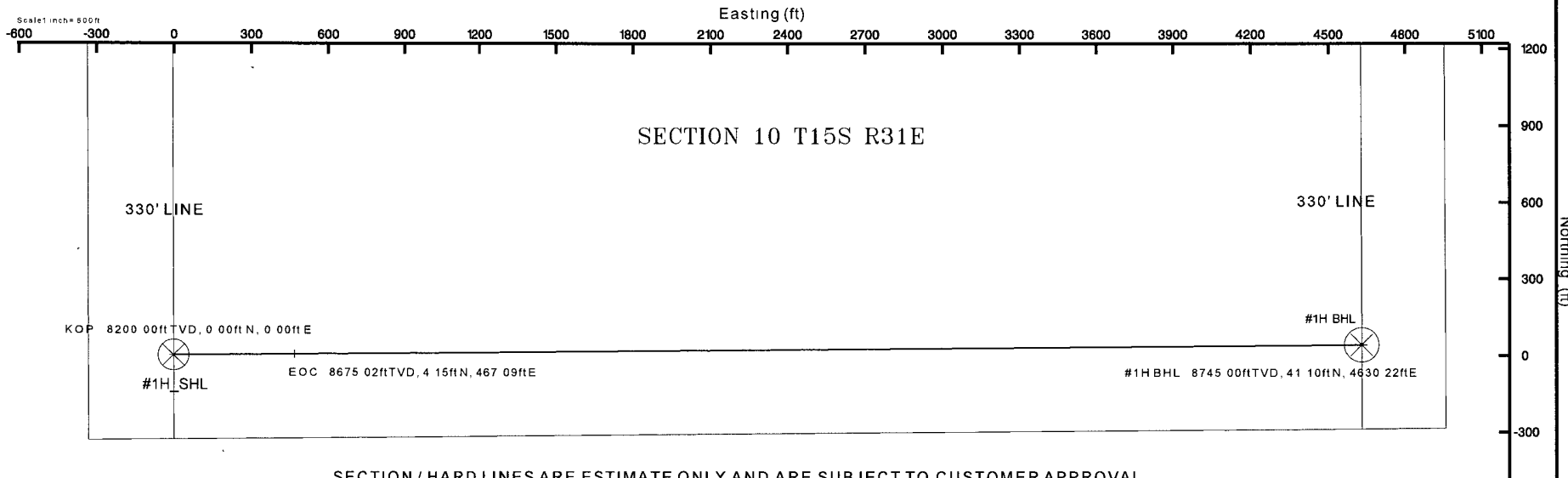

SECTION / HARD LINES ARE ESTIMATE ONLY AND ARE SUBJECT TO CUSTOMER APPROVAL.

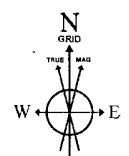
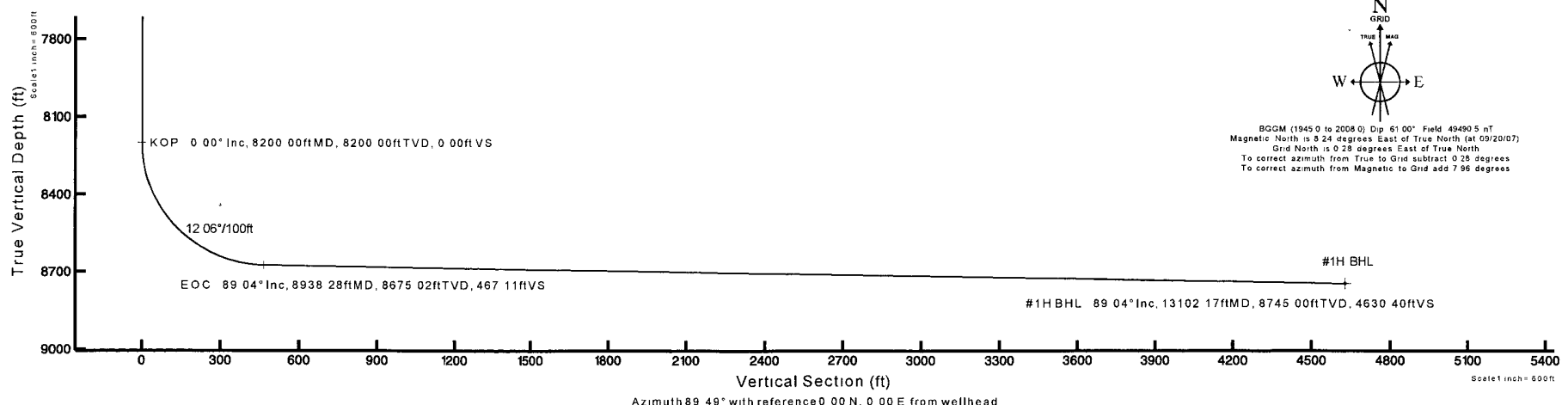

BGM (1945 0 to 2006 0) Dp 61 00° Field 48290 5 nT
 Magnetic North is 8 24 degrees East of True North (at 09/20/07)
 Grid North is 0 28 degrees East of True North
 To correct azimuth from True to Grid subtract 0 28 degrees
 To correct azimuth from Magnetic to Grid add 7 96 degrees