

UNITED STATES
DEPARTMENT OF THE INTERIOR
BUREAU OF LAND MANAGEMENT

RECEIVED

FORM APPROVED
OMB NO. 1004-0135
Expires July 31, 2010

SUNDRY NOTICES AND REPORTS ON WELLS
Do not use this form for proposals to drill or to re-enter an abandoned well. Use form 3160-3 (APD) for such proposals.

DEC 01 2009

HOBBSD

1. Type of Well <input type="checkbox"/> Oil Well <input checked="" type="checkbox"/> Gas Well <input type="checkbox"/> Other		5. Lease Serial No NMNM104724
2. Name of Operator CHESAPEAKE OPERATING INC ✓		6. If Indian, Allottee or Tribe Name
3a. Address P O BOX 18496 OKLAHOMA CITY, OK 73154-0496		7. If Unit or CA/Agreement, Name and/or No. NMNM103145X
3b. Phone No. (include area code) Ph: 405-935-4275		8. Well Name and No. Multiple--See Attached
4. Location of Well (Footage, Sec., T., R., M., or Survey Description) Multiple--See Attached		9. API Well No. Multiple--See Attached
		10. Field and Pool, or Exploratory W TEAS
		11. County or Parish, and State LEA COUNTY, NM ✓

12. CHECK APPROPRIATE BOX(ES) TO INDICATE NATURE OF NOTICE, REPORT, OR OTHER DATA

TYPE OF SUBMISSION	TYPE OF ACTION			
<input type="checkbox"/> Notice of Intent	<input type="checkbox"/> Acidize	<input type="checkbox"/> Deepen	<input type="checkbox"/> Production (Start/Resume)	<input type="checkbox"/> Water Shut-Off
<input checked="" type="checkbox"/> Subsequent Report	<input type="checkbox"/> Alter Casing	<input type="checkbox"/> Fracture Treat	<input type="checkbox"/> Reclamation	<input type="checkbox"/> Well Integrity
<input type="checkbox"/> Final Abandonment Notice	<input type="checkbox"/> Casing Repair	<input type="checkbox"/> New Construction	<input type="checkbox"/> Recomplete	<input checked="" type="checkbox"/> Other Site Facility Diagram/Security Plan
	<input type="checkbox"/> Change Plans	<input type="checkbox"/> Plug and Abandon	<input type="checkbox"/> Temporarily Abandon	
	<input type="checkbox"/> Convert to Injection	<input type="checkbox"/> Plug Back	<input type="checkbox"/> Water Disposal	

13. Describe Proposed or Completed Operation (clearly state all pertinent details, including estimated starting date of any proposed work and approximate duration thereof. If the proposal is to deepen directionally or recomplete horizontally, give subsurface locations and measured and true vertical depths of all pertinent markers and zones. Attach the Bond under which the work will be performed or provide the Bond No. on file with BLM/BIA. Required subsequent reports shall be filed within 30 days following completion of the involved operations. If the operation results in a multiple completion or recompletion in a new interval, a Form 3160-4 shall be filed once testing has been completed. Final Abandonment Notices shall be filed only after all requirements, including reclamation, have been completed, and the operator has determined that the site is ready for final inspection.)

PLEASE FIND THE ATTACHED CENTRAL TANK BATTERY FOR THE FOLLOWING WTU WELLS:

- WTU 932 (OIL) 9-20S-33E 3002531035 ✓
- WTU 946 (WIW) 9-20S-33E 3002536412 ✓
- WTU 942 (OIL) 9-20S-33E 3002532517 ✓
- WTU 931 (OIL) 9-20S-33E 3002531718 ✓
- WTU 444 (OIL) 4-20S-33E 3002532012 ✓
- WTU 434 (OIL) 4-20S-33E 3002531857 ✓
- WTU 922 (OIL) 9-20S-33E 3002529900 ✓
- WTU 622 (WSW) 16-20S-33E 3002501743 ✓
- WTU 621 (WSW) 16-20S-33E 3002533697 ✓
- WTU 943 (OIL) 9-20S-33E 3002533004 ✓

Accepted for Record Purposes.
Approval Subject to Onsite Inspection.
Date: 11-27-09

[Signature]
PETROLEUM ENGINEER
KG DEC 02 2009

14. I hereby certify that the foregoing is true and correct

**Electronic Submission #77495 verified by the BLM Well Information System
For CHESAPEAKE OPERATING INC, sent to the Hobbs
Committed to AFSS for processing by CHERYLE RYAN on 11/17/2009 (10CMR0034SE)**

Name (Printed/Typed) LINDA GOOD	Title SR. REGULATORY COMPLIANCE SPEC
Signature (Electronic Submission)	Date 11/17/2009

THIS SPACE FOR FEDERAL OR STATE OFFICE USE

Approved By ACCEPTED	JAMES A AMOS Title SUPERVISOR EPS	Date 11/27/09
Conditions of approval, if any, are attached. Approval of this notice does not warrant or certify that the applicant holds legal or equitable title to those rights in the subject lease which would entitle the applicant to conduct operations thereon.		Office Hobbs

Title 18 U.S.C. Section 1001 and Title 43 U.S.C. Section 1212, make it a crime for any person knowingly and willfully to make to any department or agency of the United States any false, fictitious or fraudulent statements or representations as to any matter within its jurisdiction.

Additional data for EC transaction #77495 that would not fit on the form

Wells/Facilities, continued

Agreement	Lease	Well/Fac Name, Number	API Number	Location
NMNM103145X	NMNM104724	WEST TEAS UNIT 932 ✓	✓ 30-025-31035-00-S1	Sec 9 T20S R33E SWNE 2310FNL 2310FEL ✓
NMNM103145X	FEE	WEST TEAS UNIT 434 ✓	✓ 30-025-31857-00-S1	Sec 4 T20S R33E SWSE 660FSL 660FEL ✓
NMNM103145X	FEE	WEST TEAS UNIT 444 ✓	✓ 30-025-32012-00-S1	Sec 4 T20S R33E SESE 660FSL 660FEL ✓
NMNM103145X	STATE	WEST TEAS UNIT 621 ✓	✓ 30-025-33697-00-S1	Sec 16 T20S R33E NWNW 990FNL 990FWL ✓
NMNM103145X	STATE	WEST TEAS UNIT 622 ✓	✓ 30-025-01743-00-S1	Sec 16 T20S R33E SENW 1980FNL 1980FWL ✓
NMNM103145X	NMNM104724	WEST TEAS UNIT 922 ✓	✓ 30-025-29900-00-S1	Sec 9 T20S R33E SENW 1980FNL 1650FWL ✓
NMNM103145X	NMNM104724	WEST TEAS UNIT 942 ✓	✓ 30-025-32517-00-S1	Sec 9 T20S R33E SENE 1650FNL 990FEL ✓
NMNM103145X	NMNM104718	WEST TEAS UNIT 943 ✓	✓ 30-025-33004-00-S1	Sec 9 T20S R33E NESE 2310FSL 990FEL ✓
NMNM104724	NMNM104724	WTU 946 ✓	✓ 30-025-36412-00-S1	Sec 9 T20S R33E NENE 990FNL 330FEL ✓

32. Additional remarks, continued

- WTU 611 (P&A) 16-20S-33E 3002533286
- WTU 944 (OIL) 9-20S-33E 3002533295
- WTU 933 (OIL) 9-20S-33E 3002530239
- WTU 632 (P&A) 16-20S-33E 3002501740
- WTU 923 (OIL) 9-20S-33E 3002529861
- WTU 621 (WSW) 16-20S-33E 3002533697

CHESAPEAKE OPERATING, INC.

WTU CTB 16-20S-33E LEA CO., NM

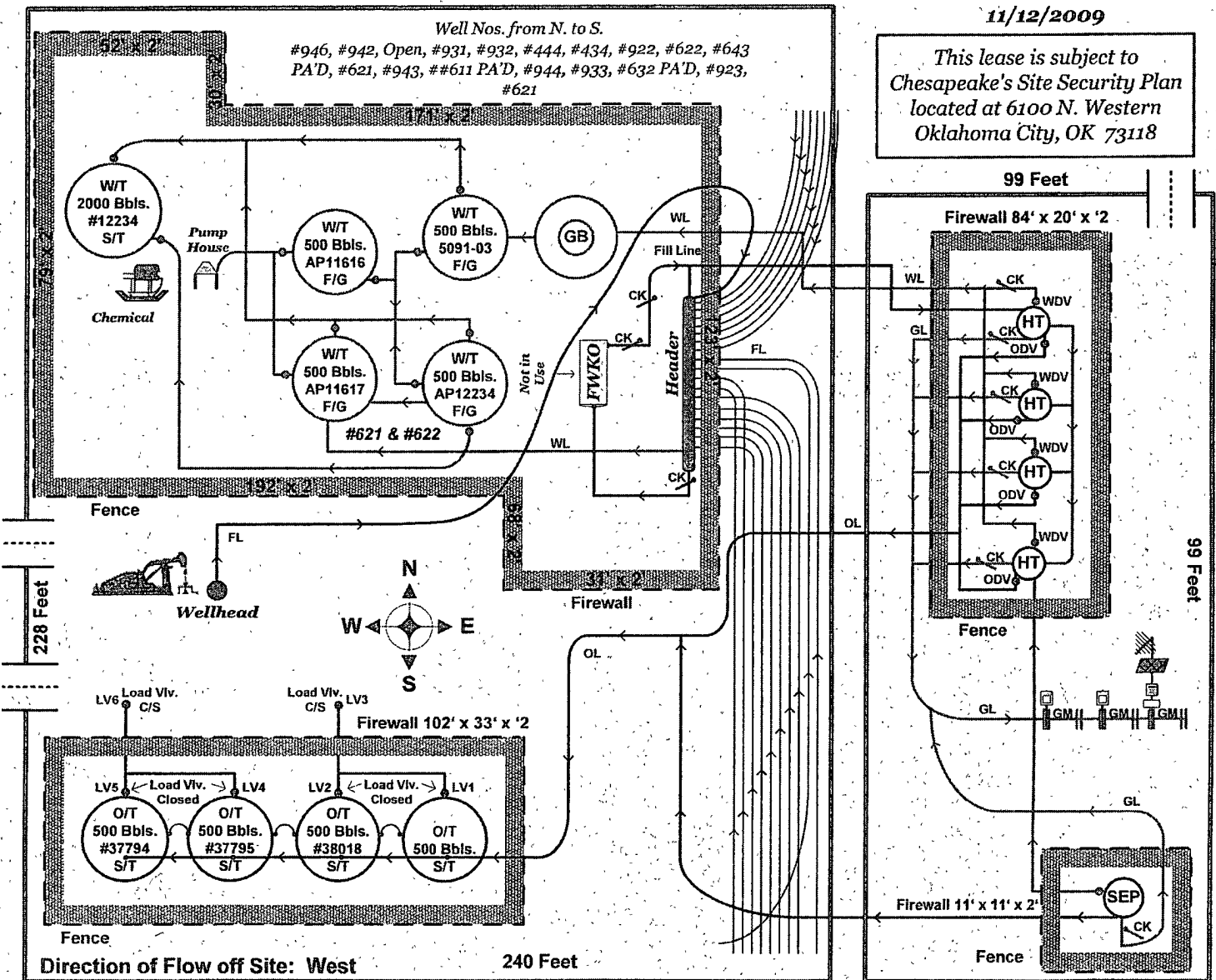

General sealing of valves and sales by tank gauging. Production phase: all drain valves (D1-D3) and sales valves (L1-L5) sealed closed. Sales phase: the tank from which sales are being made will be isolated by sealing closed the drain, fill, and any equalizer valves during sales. Draining phase: the tank being drained will be isolated by sealing closed the sales, fill, equalizer valves and drain valves on the other tanks.