

District I
1625 N. French Dr., Hobbs, NM 88240
District II
1301 W. Grand Avenue, Artesia, NM 88210
District III
1000 Rio Brazos Road, Aztec, NM 87410
District IV
1220 S. St. Francis Dr., Santa Fe, NM 87505

RECEIVED

FEB 09 2011
HOBBSOCD

State of New Mexico
Energy Minerals and Natural Resources
Oil Conservation Division
1220 South St. Francis Dr.
Santa Fe, NM 87505

Form C-101
June 16, 2008

Submit to appropriate District Office

AMENDED REPORT

APPLICATION FOR PERMIT TO DRILL, RE-ENTER, DEEPEN, PLUGBACK, OR ADD A ZONE

¹ Operator Name and Address Yates Petroleum Corporation 105 South 4 th Street Artesia, NM 88210		² OGRID Number 025575
³ Property Code 12519	⁵ Property Name LOTUS ALT STATE	³ API Number 30 - 25-40093
⁹ Proposed Pool 1 Livingston Ridge Delaware, SE		⁶ Well No. 6
¹⁰ Proposed Pool 2		

⁷ Surface Location

UL or lot no.	Section	Township	Range	Lot Idn	Feet from the	North/South line	Feet from the	East/West line	County
F	32	22S	32E		1650	N	1650	W	Lea

⁸ Proposed Bottom Hole Location If Different From Surface

UL or lot no.	Section	Township	Range	Lot Idn	Feet from the	North/South line	Feet from the	East/West line	County

Additional Well Information

¹¹ Work Type Code New Well	¹² Well Type Code Oil	¹³ Cable/Rotary	¹⁴ Lease Type Code State	¹⁵ Ground Level Elevation 3536'
¹⁶ Multiple N	¹⁷ Proposed Depth 8600'	¹⁸ Formation Delaware	¹⁹ Contractor	²⁰ Spud Date ASAP

²¹ Proposed Casing and Cement Program

Hole Size	Casing Size	Casing weight/foot	Setting Depth	Sacks of Cement	Estimated TOC
17.5	13.375"	48#	850'	450	**
11.0	8.625"	32#	4500'	1400	**
7.875	5.5"	17#	8600'	950	1200

²² Describe the proposed program. If this application is to DEEPEN or PLUG BACK, give the data on the present productive zone and proposed new productive zone. Describe the blowout prevention program, if any. Use additional sheets if necessary.
Yates Petroleum Corporation proposes to drill and test the Delaware/Intermediate formations. Approximately 850' of surface casing will be set/cement circulated to shut off gravel and cavings. If commercial, production casing will be ran and cemented, perforated, and stimulated as needed for production.
BOPE PROGRAM: A 3000# Double Ram BOPE will be installed on the 8.625" casing and tested daily for operational.
MUD PROGRAM: 0-850' FW/ Gel/Native Mud; 850'-4500' Brine; 4500'-6800' Cut Brine; 6800'-TD Cut Brine/Starch.
H2S is not anticipated
C-102 Attached.
A Closed Loop System will be used, C-144 Attached.
Previously Approved (30-02538796)

Permit Expires 2 Years From Approval Date Unless Drilling Underway

²³ I hereby certify that the information given above is true and complete to the best of my knowledge and belief.

Signature:

Printed name:
Monti Sanders
Title:
Land Regulatory Technician
E-mail Address:
montis@yatespetroleum.com

Date:
2/8/11
Phone:
575-748-4244

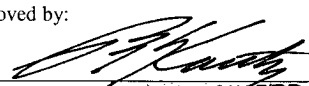
OIL CONSERVATION DIVISION	
Approved by: 	
Title: PETROLEUM ENGINEER	
Approved: MAR 24 2011	Expiration Date:
Conditions of Approval Attached <input type="checkbox"/>	

RECEIVED

FEB 09 2011

HOBBS OGD

District I
1625 N. French Dr., Hobbs, NM 88240
District II
1301 W. Grand Avenue, Artesia, NM 88210
District III
1000 Rio Brazos Rd., Aztec, NM 87410
District IV
1220 S. St. Francis Dr., Santa Fe, NM 87505

State of New Mexico
Energy, Minerals & Natural Resources Department
OIL CONSERVATION DIVISION
1220 South St. Francis Dr.
Santa Fe, NM 87505

Form C-102
Revised July 16, 2010
Submit one copy to appropriate
District Office

AMENDED REPORT

WELL LOCATION AND ACREAGE DEDICATION PLAT

¹ API Number 30-025-40093		² Pool Code 3938D		³ Pool Name Livingston Ridge Delaware SE	
⁴ Property Code 12519		⁵ Property Name Lotus ALT State			⁶ Well Number 6
⁷ OGRID No. 025575		⁸ Operator Name Yates Petroleum Corporation			⁹ Elevation 3536'

¹⁰ Surface Location

UL or lot no.	Section	Township	Range	Lot Idn	Feet from the	North/South line	Feet from the	East/West line	County
F	32	22S	32E		1650'	North	1650'	West	Lea

¹¹ Bottom Hole Location If Different From Surface

UL or lot no.	Section	Township	Range	Lot Idn	Feet from the	North/South line	Feet from the	East/West line	County

¹² Dedicated Acres 40	¹³ Joint or Infill	¹⁴ Consolidation Code	¹⁵ Order No.
-------------------------------------	-------------------------------	----------------------------------	-------------------------

No allowable will be assigned to this completion until all interests have been consolidated or a non-standard unit has been approved by the division.

¹⁶ 	¹⁷ OPERATOR CERTIFICATION <i>I hereby certify that the information contained herein is true and complete to the best of my knowledge and belief, and that this organization either owns a working interest or unleased mineral interest in the land including the proposed bottom hole location or has a right to drill this well at this location pursuant to a contract with an owner of such a mineral or working interest, or to a voluntary pooling agreement or a compulsory pooling order heretofore entered by the division.</i> Signature _____ Date 2/8/11 Monti Sanders Printed Name _____ montis@yatespetroleum.com E-mail Address _____
	¹⁸ SURVEYOR CERTIFICATION <i>I hereby certify that the well location shown on this plat was plotted from field notes of actual surveys made by me or under my supervision, and that the same is true and correct to the best of my belief.</i> REFER TO ORIGINAL PLAT Date of Survey _____ Signature and Seal of Professional Surveyor: _____ Certificate Number _____

DISTRICT I
1000 N. French St., Hobbs, NM 88240

DISTRICT II
611 South Front, Artesia, NM 88210

DISTRICT III
1000 N. Grand St., Aztec, NM 87410

DISTRICT IV
2040 South Pacheco, Santa Fe, NM 87500

State of New Mexico
Energy, Minerals and Natural Resources Department

Form O-108
Revised March 17, 1989
Instruction on back
Submit to Appropriate District Office
State Lease - 4 Copies
Fee Lease - 3 Copies

OIL CONSERVATION DIVISION
P.O. Box 2088
Santa Fe, New Mexico 87504-2088

AMENDED REPORT

WELL LOCATION AND ACREAGE DEDICATION PLAT

API Number	Pool Code 39 380	Pool Name SE LIVINGSTON RIDGE DELAWARE
Property Code 12519	Property Name LOTUS "AL" STATE	Well Number 6
OCED No. 025375	Operator Name YATES PETROLEUM CORPORATION	Elevation 3536

Surface Location

UL or lot No.	Section	Township	Range	Lot 1/4	Feet from the	North/South line	Feet from the	East/West line	County
F	32	22S	32E		1650	NORTH	1650	WEST	LEA

Bottom Hole Location if Different From Surface

UL or lot No.	Section	Township	Range	Lot 1/4	Feet from the	North/South line	Feet from the	East/West line	County

Dedicated Acres 40	Joint or Infill	Consolidation Code	Order No.
-----------------------	-----------------	--------------------	-----------

NO ALLOWABLE WILL BE ASSIGNED TO THIS COMPLETION UNTIL ALL INTERESTS HAVE BEEN CONSOLIDATED OR A NON-STANDARD UNIT HAS BEEN APPROVED BY THE DIVISION

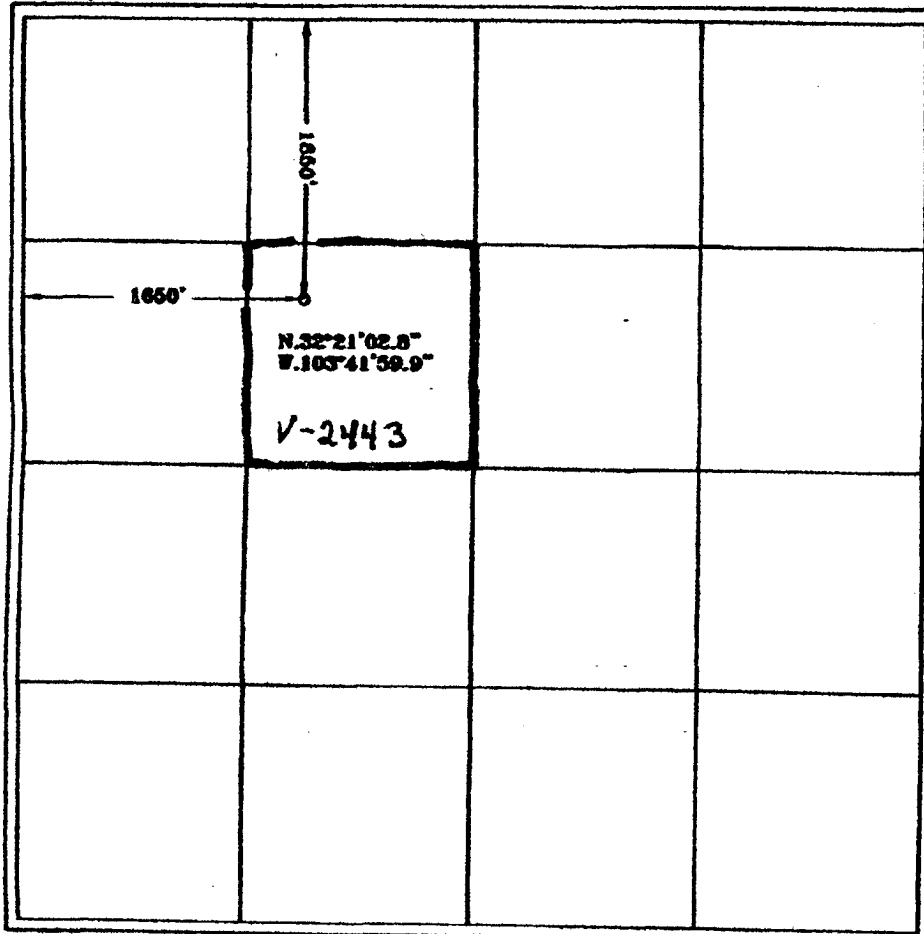

OPERATOR CERTIFICATION

I hereby certify that the information contained herein is true and complete to the best of my knowledge and belief.

Clifton R. May
Signature
CLIFTON R. MAY
Printed Name
REGULATORY AGENT
Title
12/1/2006
Date

SURVEYOR CERTIFICATION

I hereby certify that the well location shown on this plat was plotted from field notes of actual surveys made by me or under my supervision and that the same is true and correct to the best of my belief.

1/23/2003
Date Surveyed
RACHEL L. JONES
Signature
RACHEL L. JONES
Professional Land Surveyor
New Mexico
3640
Certificate No. 3640
LAW PROFESSIONAL LAND SURVEYORS RLS 3040
GENERAL SURVEYING COMPANY

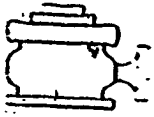

Yates Petroleum Corporation

BOP-3

Typical 3,000 psi Pressure System Schematic Annular with Double Ram Preventer Stack

RECEIVED

FEB 09 2011
HOBBSOCD

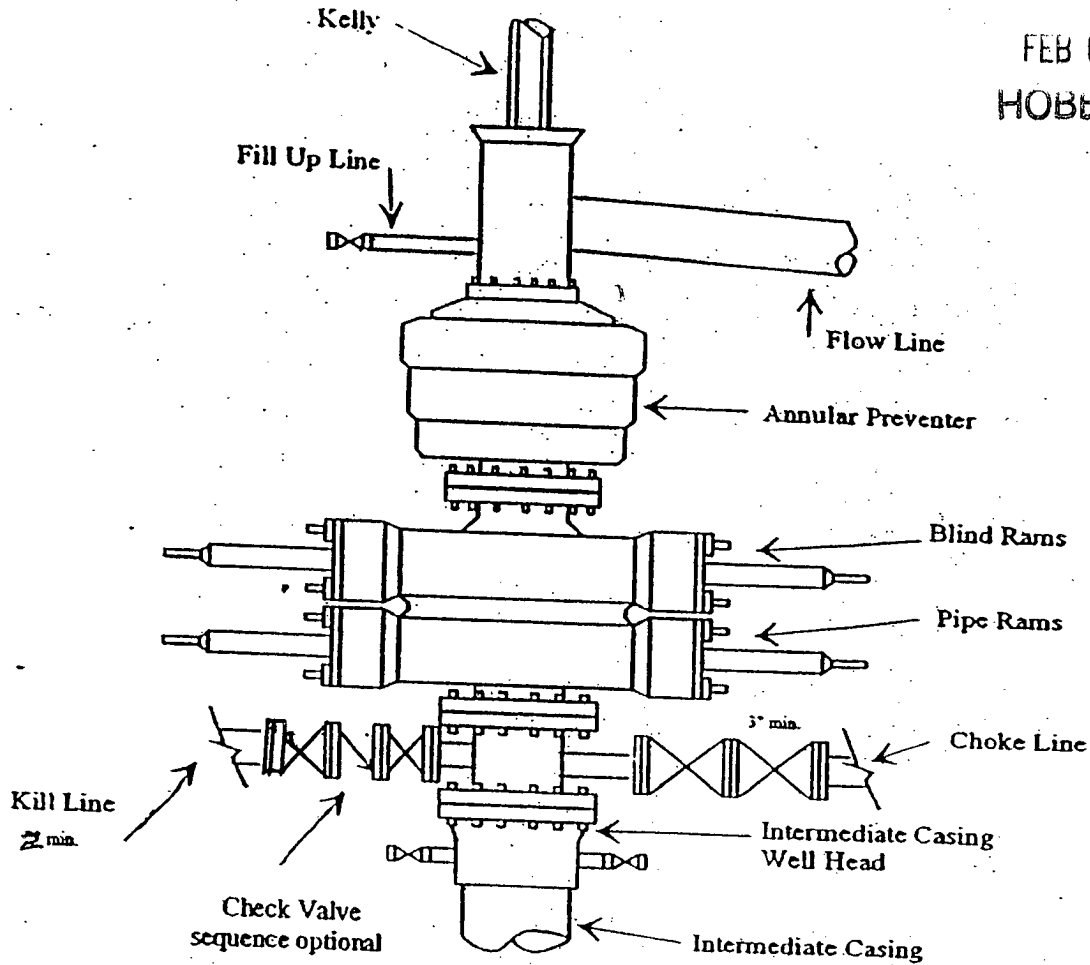

Typical 3,000 psi choke manifold assembly with at least these minimum features

