

1957 FEB 6 AM 10:0
MEXICO
OIL CONSERVATION COMMISSION

Form C-128

Well Location and/or Gas Proration Plat

Date January 30, 1957

Operator CABOT CARBON COMPANY Lease State of New Mexico "B"

Well No. 1 Section 31 Township 10 South Range 33 East NMPM

Located 1980 Feet From South Line, 660 Feet From East Line,

Lea County, New Mexico. G. L. Elevation 4267.8

Name of Producing Formation _____ Pool _____ Dedicated Acreage _____

(Note: All distances must be from outer boundaries of Section)

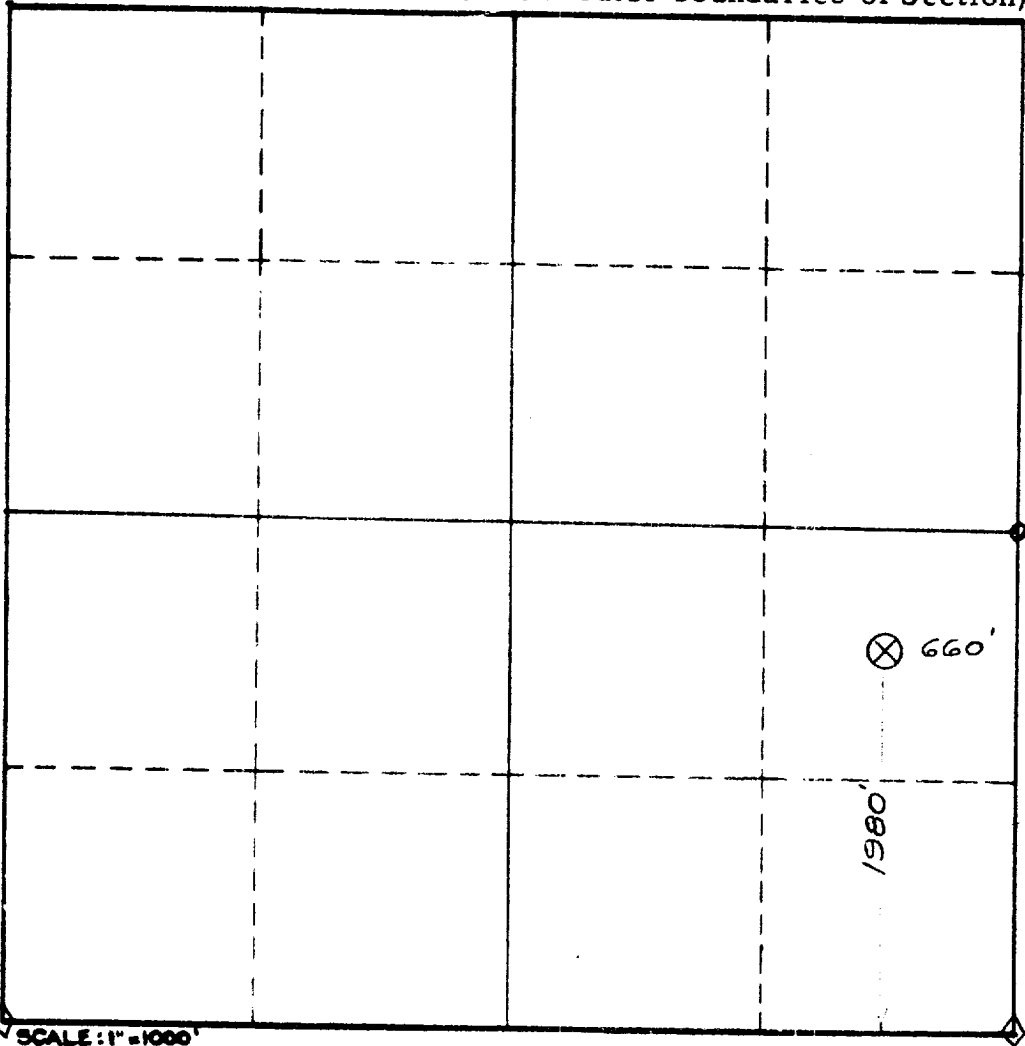

- LEGEND:**
- ⊗ Staked Location
 - Re-estab. 1/2" pipe cor.
 - ◇ Std. GLO Mkd. rock Cor.

NOTE

This section of form is to be used for gas wells only.



1. Is this Well a Dual Comp. ? Yes ___ No ___.
2. If the answer to Question 1 is yes, are there any other dually completed wells within the dedicated acreage? Yes ___ No ___.

Name _____
 Position _____
 Representing _____
 Address _____

This is to certify that the above plat was prepared from field notes of actual surveys made by me or under my supervision and that the same are true and correct to the best of my knowledge and belief.

Date Surveyed January 30, 1957
[Signature]
 Registered Professional Engineer and/or Land Surveyor License No. 1559