

NO. OF COPIES RECEIVED	
DISTRIBUTION	
SANTA FE	
FILE	
S.G.S.	
AND OFFICE	
OPERATOR	

# NEW MEXICO OIL CONSERVATION COMMISSION

Form C-101  
Revised 1-1-65

5A. Indicate Type of Lease  
STATE ☐ FEE ☒

5. State Oil & Gas Lease No.  
-----

## APPLICATION FOR PERMIT TO DRILL, DEEPEN, OR PLUG BACK

1. Type of Work Type of Well DRILL <input checked="" type="checkbox"/> DEEPEN <input type="checkbox"/> PLUG BACK <input type="checkbox"/> OIL WELL <input checked="" type="checkbox"/> GAS WELL <input type="checkbox"/> OTHER <input type="checkbox"/> SINGLE ZONE <input checked="" type="checkbox"/> MULTIPLE ZONE <input type="checkbox"/>		7. Unit Agreement Name -----
2. Name of Operator TEXACO INC.		8. Farm or Lease Name F. B. Gist
3. Address of Operator P. O. BOX 3109, MIDLAND, TEXAS 79701		9. Well No. 2
4. Location of Well UNIT LETTER H LOCATED 2080 FEET FROM TIE North LINE 660 FEET FROM THE East LINE OF SEC. 31 TWP. 11-S RGE. 33-E NMPM		10. Field and Pool, or Wildcat North Bagley-Lower Penn.
12. County Lea		
19. Proposed Depth 10,400'		19A. Formation Canyon & Strawn
20. Rotary or C.T. Rotary		
2. Elevations (Show whether DF, RT, etc.) GR-4299'	21A. Kind & Status Plug. Bond \$10,000 blanket	21B. Drilling Contractor Unknown
22. Approx. Date Work will start At once		

## PROPOSED CASING AND CEMENT PROGRAM

SIZE OF HOLE	SIZE OF CASING	WEIGHT PER FOOT	SETTING DEPTH	SACKS OF CEMENT	EST. TOP
3 3/4"	11 3/4"	42#, 23.72#	350'	*250	300% to circ.
10 5/8"	8 5/8"	24#, 28#, 32#	3750'	**670	150% to tie back
7 7/8"	4 1/2"	17#	10400'	***830	125% to tie back

\*Cement w/250 sx Class "C" w/1/4#/sx flocele & 2% CaCl<sub>2</sub>, 14.8#/gal (300% to circ.) Cmt. must circ.

\*\*Cement w/470 sx TLW w/4% gel & 5#/sx Gilsonite, 11.5#/gal followed by 200 sx Class "C" w/10#/sx salt, 14.8#/gal. (150% to tie back) Not required to tie back.

\*\*\*Cement w/500 sx TLW w/4% gel. & 5#/sx Gilsonite, 11.5#/gal followed by 330 sx Class "C" w/10#/sx salt, 14.8#/gal. (125% to tie back) Not required to tie back.

## COMPLETION PROGRAM

1. Selectively perf. pay 2 JSPI. 2. Treat w/500 gal 15% NEA followed by 1500 gal 15% CRA acid per 5 perf. intervals. 3. Use ret. pkr. and bridge plug to isolate intervals. Anticipate 20 perf. intervals if both upper and lower Bagley fields are opened.

## FORMATION TOPS EXPECTED

San Andres	3730'	Upper Penn (Canyon)	9480'	Strawn	10,070'
Abo	7310'	Canyon Marker	9990'	Total Depth	10,400'

IN ABOVE SPACE DESCRIBE PROPOSED PROGRAM; IF PROPOSAL IS TO DEEPEN OR PLUG BACK, GIVE DATA ON PRESENT PRODUCTIVE ZONE AND PROPOSED NEW PRODUCTION ZONE. GIVE BLOWOUT PREVENTER PROGRAM, IF ANY.

I hereby certify that the information above is true and complete to the best of my knowledge and belief.

Signed T. C. Landwormeyer Title Assistant Division Civil Engr. Date July 29, 1969  
(This space for State Use)

APPROVED BY John W. Runyan TITLE Engr. DATE JUL 31 1969

CONDITIONS OF APPROVAL, IF ANY:

11 3/4"

Oct. 29, 1969

**NEW MEXICO OIL CONSERVATION COMMISSION  
WELL LOCATION AND ACREAGE DEDICATION PLAT**

Form C-102  
Supersedes C-128  
Effective 1-1-65

All distances must be from the outer boundaries of the Section.

Operator <b>TEXACO Inc.</b>			Lease <b>F. B. Gist</b>			Well No. <b>2</b>		
Unit Letter <b>H</b>	Section <b>31</b>	Township <b>11-South</b>	Range <b>33-East</b>	County <b>Lea</b>				
Actual Footage Location of Well: <div style="display: flex; justify-content: space-between;"> <span>2080 feet from the North line and</span> <span>660 feet from the East line</span> </div>								
Ground Level Elev. <b>4299</b>	Producing Formation <b>Canyon &amp; Strawn</b>		Pool <b>North Bagley-Lower Pennsylvanian</b>			Dedicated Acreage: <b>80</b> Acres		

1. Outline the acreage dedicated to the subject well by colored pencil or hatchure marks on the plat below.
2. If more than one lease is dedicated to the well, outline each and identify the ownership thereof (both as to working interest and royalty).
3. If more than one lease of different ownership is dedicated to the well, have the interests of all owners been consolidated by communitization, unitization, force-pooling, etc?

☐ Yes    ☐ No    If answer is "yes," type of consolidation \_\_\_\_\_

If answer is "no," list the owners and tract descriptions which have actually been consolidated. (Use reverse side of this form if necessary.) \_\_\_\_\_

No allowable will be assigned to the well until all interests have been consolidated (by communitization, unitization, forced-pooling, or otherwise) or until a non-standard unit, eliminating such interests, has been approved by the Commission.

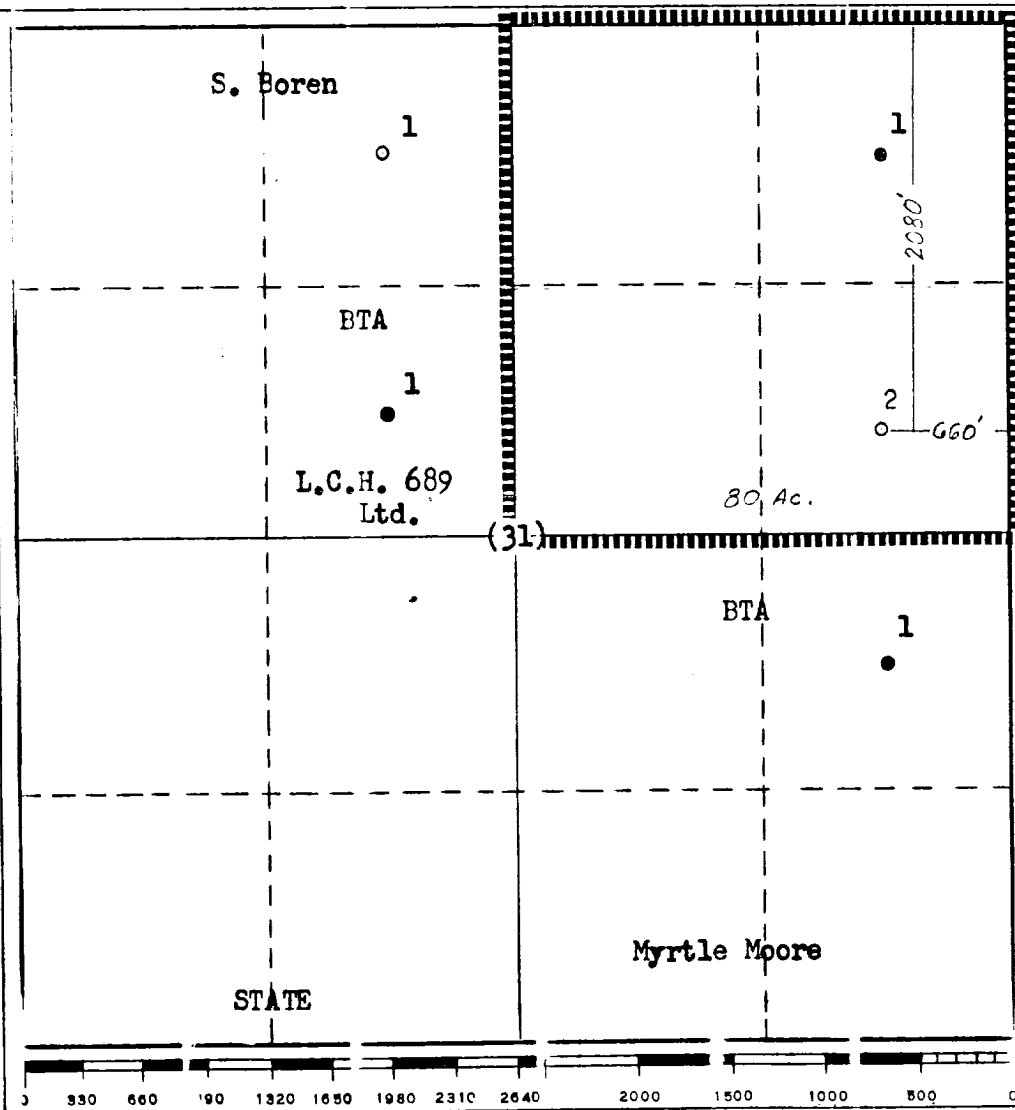

**CERTIFICATION**

I hereby certify that the information contained herein is true and complete to the best of my knowledge and belief.

*T. G. Landwermeyer*

Name  
**T. G. Landwermeyer**

Position  
**Civil Engineer**

Company  
**TEXACO Inc.**

Date  
**7/29/69**

I hereby certify that the well location shown on this plat was plotted from field notes of actual surveys made by me or under my supervision, and that the same is true and correct to the best of my knowledge and belief.

Date Surveyed  
**7/26/69**

Registered Professional Engineer and/or Land Surveyor

*T. G. Landwermeyer*

Certificate No.  
**1761**