

Field Office LC
Lease No. 069032-A
Unit F

APPROVED
MAR 22 1961
JAMES A. KNAUF
DISTRICT ENGINEER

(SUBMIT IN TRIPLICATE)

UNITED STATES
DEPARTMENT OF THE INTERIOR
GEOLOGICAL SURVEY

RECEIVED

SUNDRY NOTICES AND REPORTS ON WELLS APR 4 1961

NOTICE OF INTENTION TO DRILL.....	<input checked="" type="checkbox"/>	SUBSEQUENT REPORT OF WATER SHUT-OFF.....	
NOTICE OF INTENTION TO CHANGE PLANS.....		SUBSEQUENT REPORT OF SHOOTING OR ACIDIZING.....	
NOTICE OF INTENTION TO TEST WATER SHUT-OFF.....		SUBSEQUENT REPORT OF ALTERING CASING.....	
NOTICE OF INTENTION TO RE-DRILL OR REPAIR WELL.....		SUBSEQUENT REPORT OF RE-DRILLING OR REPAIR.....	
NOTICE OF INTENTION TO SHOOT OR ACIDIZE.....		SUBSEQUENT REPORT OF ABANDONMENT.....	
NOTICE OF INTENTION TO PULL OR ALTER CASING.....		SUPPLEMENTARY WELL HISTORY.....	
NOTICE OF INTENTION TO ABANDON WELL.....			

(INDICATE ABOVE BY CHECK MARK NATURE OF REPORT, NOTICE, OR OTHER DATA)

March 20, 1961

Well No. Tract 9
6-9 is located 2050 ft. from N line and 2100 ft. from W line of sec. 5
Nw 1/4 Sec 5 15 S 31 E T11N
(1/4 Sec. and Sec. No.) (Twp.) (Range) (Meridian)
Caprock Queen Chaves New Mexico
(Field) (County or Subdivision) (State or Territory)

The elevation of the derrick floor above sea level is 4455 ft.

DETAILS OF WORK

(State names of and expected depths to objective sands; show sizes, weights, and lengths of proposed casings; indicate mudding jobs, cementing points, and all other important proposed work)

Objectives: Queen Sand 3100'
8 5/8" 24# csg. cemented @ 325' w/175 sx
4 1/2" 9.5# csg. cemented @ 3160' w/300 sx

RECEIVED
MAR 22 1961
U. S. GEOLOGICAL SURVEY
ARTESIA, NEW MEXICO

I understand that this plan of work must receive approval in writing by the Geological Survey before operations may be commenced.

Company Union Oil Company of California
Address 205 East Washington
Lovington, New Mexico
By _____
A. T. Mannon
Title Unit Superintendent

ORIGINAL SIGNED
BY: A. T. MANNON

NEW MEXICO OIL CONSERVATION COMMISSION
WELL LOCATION AND ACREAGE DEDICATION PLAT

FORM C-128
 Revised 5/1/57

SEE INSTRUCTIONS FOR COMPLETING THIS FORM ON THE REVERSE SIDE

RECEIVED

SECTION A

Operator Union Oil of California			Lease Tract 19		APR 4 1961 6-5
South Caprock Queen Unit					
Unit Letter F	Section 5	Township 15 South	Range 31 East	County Chaves	
Actual Postage Location of Well: 2050 feet from the North line and 2100 feet from the West line					
Ground Level Elev. 4445.45	Producing Formation Queen	Pool Caprock Queen		Dedicated Acreage: 40 Acres	

O. C. C.
ARTESIA, OFFICE

1. Is the Operator the only owner in the dedicated acreage outlined on the plat below? YES NO ("Owner" means the person who has the right to drill into and to produce from any pool and to appropriate the production either for himself or for himself and another. (65-3-29 (e) NMSA 1935 Comp.)
2. If the answer to question one is "no," have the interests of all the owners been consolidated by communication agreement or otherwise? YES NO . If answer is "yes," Type of Consolidation **Consolidation**
3. If the answer to question two is "no," list all the owners and their respective interests below:

Owner	Land Description

RECEIVED

APR 9 1961

U. S. GEOLOGICAL SURVEY
 ARTESIA, NEW MEXICO
 CERTIFICATION

SECTION B

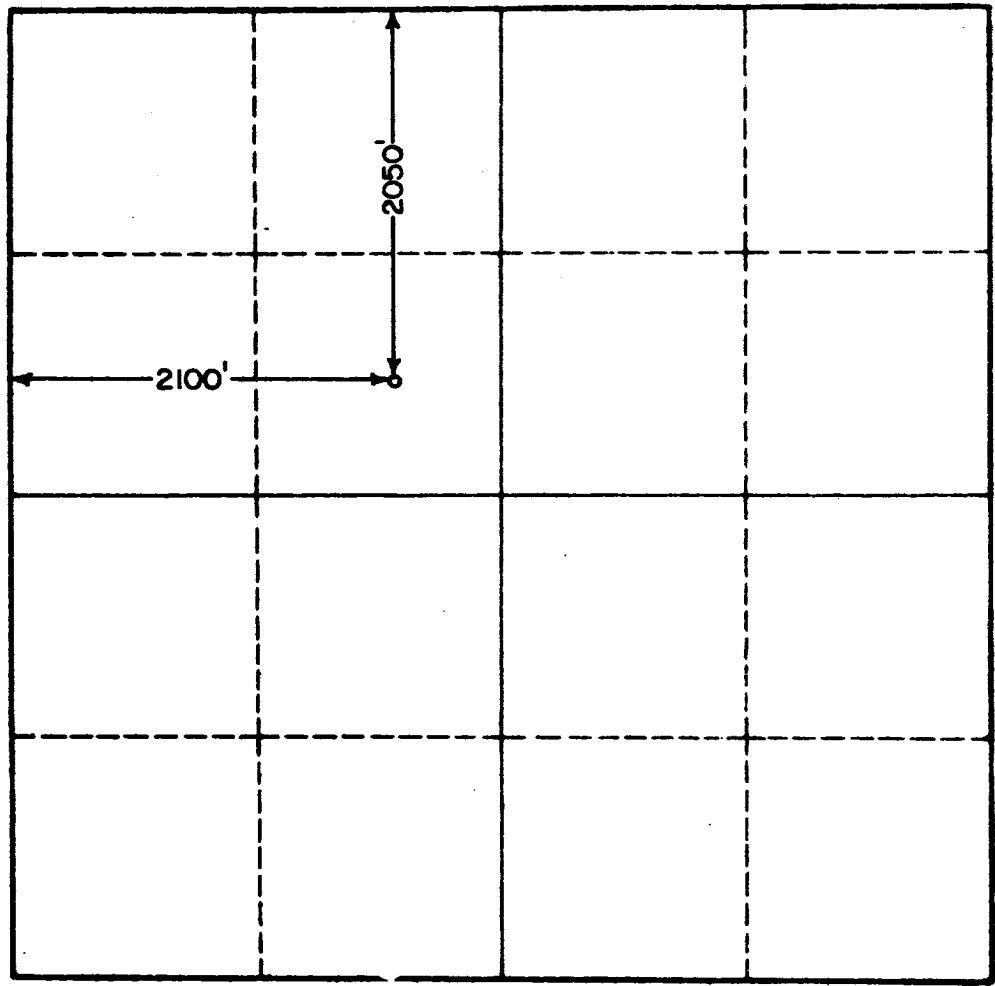

I hereby certify that the information in SECTION A above is true and complete to the best of my knowledge and belief.

Name <i>A. Mannon</i>
Position Unit Superintendent
Company Union Oil Company of Cal.
Date March 26, 1961

I hereby certify that the well location shown on the plat in SECTION B was plotted from field notes of actual surveys made by me or under my supervision, and that the same are true and correct to the best of my knowledge and belief.

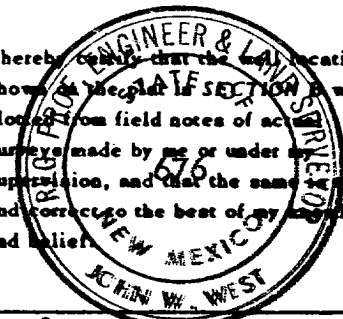

Date Surveyed 1-30-61
Registered Professional Engineer and/or Land Surveyor, JOHN W. WEST
<i>John W. West</i>
Certificate No. N. M. - P. E. & L. S. NO. 676



