

(SUBMIT IN TRIPLICATE)

Land Office Roswell

Lease No. LC-069832-2

Unit Federal "B"

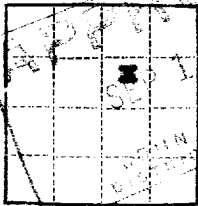

UNITED STATES  
DEPARTMENT OF THE INTERIOR  
GEOLOGICAL SURVEY

COMM. OFFICE  
ARRESTA OFFICE

SUNDRY NOTICES AND REPORTS ON WELLS

NOTICE OF INTENTION TO DRILL.....	<input checked="" type="checkbox"/>	SUBSEQUENT REPORT OF WATER SHUT-OFF.....	
NOTICE OF INTENTION TO CHANGE PLANS.....		SUBSEQUENT REPORT OF SHOOTING OR ACIDIZING.....	
NOTICE OF INTENTION TO TEST WATER SHUT-OFF.....		SUBSEQUENT REPORT OF ALTERING CASING.....	
NOTICE OF INTENTION TO RE-DRILL OR REPAIR WELL.....		SUBSEQUENT REPORT OF RE-DRILLING OR REPAIR.....	
NOTICE OF INTENTION TO SHOOT OR ACIDIZE.....		SUBSEQUENT REPORT OF ABANDONMENT.....	
NOTICE OF INTENTION TO PULL OR ALTER CASING.....		SUPPLEMENTARY WELL HISTORY.....	
NOTICE OF INTENTION TO ABANDON WELL.....			

(INDICATE ABOVE BY CHECK MARK NATURE OF REPORT, NOTICE, OR OTHER DATA)

September 17, 1957

Well No. 6 is located 1630 ft. from N 12 line and 2310 ft. from E IV line of sec. 9

NE/4 of NE/4 (1/4 Sec. and Sec. No.)      15N (Twp.)      11E (Range)      NCPM (Meridian)  
Caprock Queen (E7) (Field)      Chaves (County or Subdivision)      New Mexico (State or Territory)

The elevation of the derrick floor above sea level is 4435.9 ft.

DETAILS OF WORK

(State names of and expected depths to objective sands; show sizes, weights, and lengths of proposed casings; indicate mudding jobs, cementing points, and all other important proposed work)

Proposed to drill above listed well to an approximate TD of 3250' with rotary tools to the Queen Sand.  
Set 310' of 8 5/8" OD 2 1/2" J-55 STAC Casing and cement to surface with Approx. 300 sz cement.  
Set 3250' of 5 1/2" OD 1 1/2" J-55 STAC Casing and cement with 175 sz cement.  
Perforate Queen Sand and sandoilfree. Run 2 3/8" OD tubing and complete.

Drilling Contractors: Midland Drilling Co., 410 W. Ohio, Midland, Texas

I understand that this plan of work must receive approval in writing by the Geological Survey before operations may be commenced.

Company J. JOSEPH I. O'NEILL, JR.

Address 410 W. Ohio, Midland, Texas

By G. L. Fly, Jr. (G. L. Fly, Jr.)

Title Production Clerk

NEW MEXICO OIL CONSERVATION COMMISSION  
Well Location and Acreage Dedication Plat

Section A.

Date 9-17-1957

Operator Joseph I. O'Neill, Jr. Lease Federal "B"  
Well No. 6 Unit Letter 2G Section 9 Township 15S Range 31 East NMPM  
Located 2310 Feet From East Line, 1650 Feet From North Line  
County Chaves G. L. Elevation 4425.5 Dedicated Acreage 40 Acres  
Name of Producing Formation Queen Sand Pool Caprock Queen

1. Is the Operator the only owner\* in the dedicated acreage outlined on the plat below?  
Yes  No
2. If the answer to question one is "no," have the interests of all the owners been consolidated by communitization agreement or otherwise? Yes  No . If answer is "yes," Type of Consolidation \_\_\_\_\_
3. If the answer to question two is "no," list all the owners and their respective interests below:

<u>Owner</u>	<u>Land Description</u>

Section B

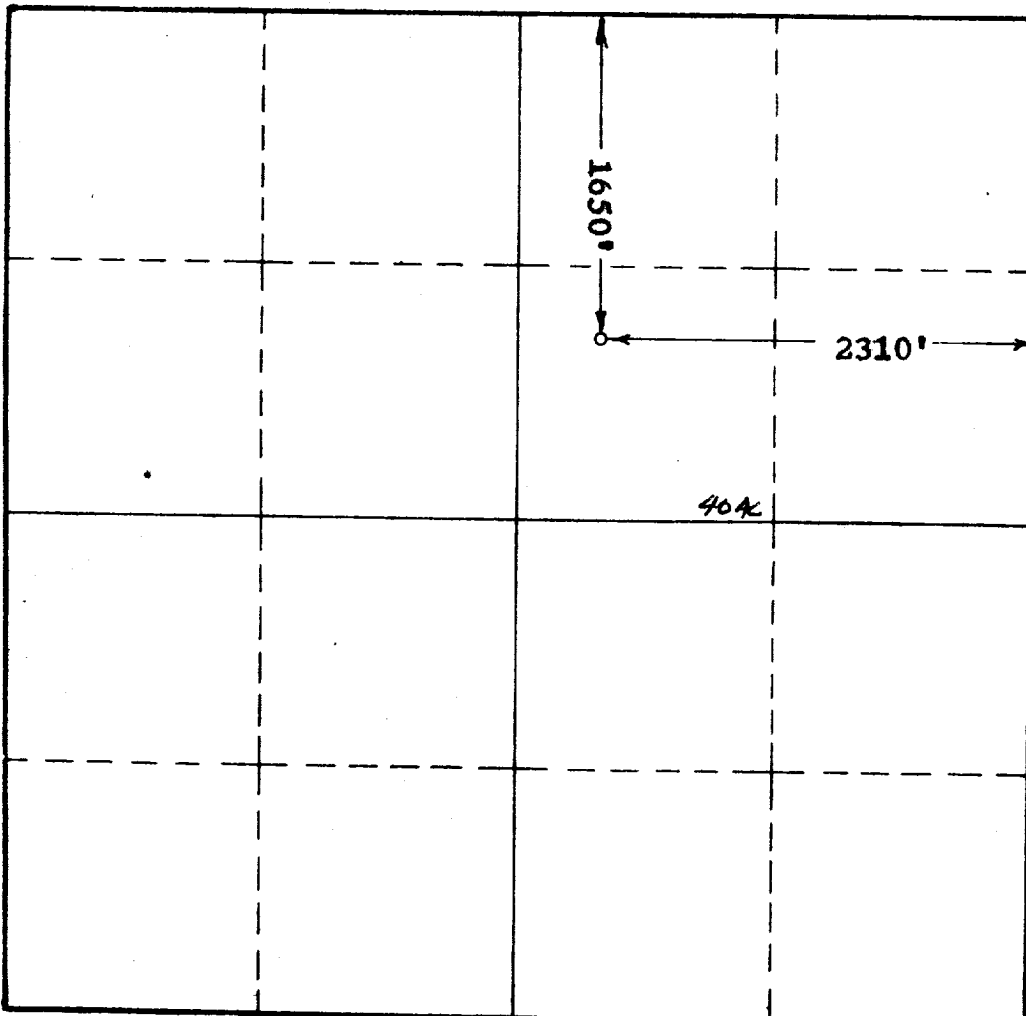

This is to certify that the information in Section A above is true and complete to the best of my knowledge and belief.

Joseph I. O'Neill, Jr.  
(Operator)  
[Signature]  
(Representative)

410 W. Ohio, Midland, Texas  
Address

This is to certify that the well location shown on the plat in Section B was plotted from field notes of actual surveys made by me or under my supervision and that the same is true and correct to the best of my knowledge and belief.

Date Surveyed 9-17-1957  
[Signature]  
Registered Professional  
Engineer and/or Land Surveyor.

Certificate No. 676