

NUMBER OF COPIES RECEIVED	
DISTRIBUTION	
SANTA FE	
FILE	
U.S.G.S.	
LAND OFFICE	
TRANSPORTER	OIL GAS
PRODUCTION OFFICE	
OPERATOR	

NEW M CO OIL CONSERVATION COMM  
Santa Fe, New Mexico

Form G-101  
Revised (12/1/55)  
1962 JUL 6 PM 2:51

## NOTICE OF INTENTION TO DRILL

Notice must be given to the District Office of the Oil Conservation Commission and approval obtained before drilling or recompletion begins. If changes in the proposed plan are considered advisable, a copy of this notice showing such changes will be returned to the sender. Submit this notice in QUINTUPLICATE. One copy will be returned following approval. See additional instructions in Rules and Regulations of the Commission. If State Land submit 6 Copies Attach Form G-128 in triplicate to first 3 copies of form G-101

Hobbs, New Mexico

July 6, 1962

(Place)

(Date)

OIL CONSERVATION COMMISSION  
SANTA FE, NEW MEXICO

Gentlemen:

You are hereby notified that it is our intention to commence the Drilling of a well to be known as

**James G. Brown & Assoc.**

(Company, or Operator)

**Lipscomb Harris**

(Lease)

Well No. **1**, in **G** The well is

(Unit)

located **1980** feet from the **North** line and **1720** feet from the

**East**

Line of Section **2**, T. **13S**, R. **38 E**, NMPM.

(GIVE LOCATION FROM SECTION LINE)

**Undesignated** Pool, **Lea** County

D	C	B	A
E	F	<b>X</b> G	H
L	K	J	I
M	N	O	P

If State Land the Oil and Gas Lease is No.

If patented land the owner is **Hollis Harris**

Address **Amarillo, Texas**

We propose to drill well with drilling equipment as follows: **Rotary tools**

The status of plugging bond is **Blanket bond**

Drilling Contractor **B. L. McFarland, Inc.**

**Midland, Texas**

We intend to complete this well in the **Wolfcamp**

formation at an approximate depth of **9200** feet.

### CASING PROGRAM

We propose to use the following strings of Casing and to cement them as indicated:

Size of Hole	Size of Casing	Weight per Foot	New or Second Hand	Depth	Sacks Cement
<b>17 1/2</b>	<b>13 3/8</b>	<b>48#</b>	<b>New</b>	<b>325</b>	<b>Circulated</b>
<b>11</b>	<b>8 5/8</b>	<b>24# &amp; 32#</b>	<b>New</b>	<b>4600</b>	<b>300</b>
<b>7 7/8</b>	<b>5 1/2</b>	<b>15.5# &amp; 17#</b>	<b>New</b>	<b>9200</b>	<b>300*</b>

If changes in the above plans become advisable we will notify you immediately.

ADDITIONAL INFORMATION (If recompletion give full details of proposed plan of work.)

**\*or sufficient to cover all commercial shows of oil and gas.**

Approved....., 19.....  
Except as follows:

Sincerely yours,

**James G. Brown & Assoc.**

(Company or Operator)

By.....

Position **Agent**

Send Communications regarding well to

Name **James G. Brown & Assoc.**

Address **Box 1625, Midland, Texas**

OIL CONSERVATION COMMISSION

By **Leslie H. Clements**

**NEW MEXICO OIL CONSERVATION COMMISSION**  
**WELL LOCATION AND ACREAGE DEDICATION PLAT**

FORM C-128  
 Revised 5/1/57

SEE INSTRUCTIONS FOR COMPLETING THIS FORM ON THE REVERSE SIDE

**SECTION A**

Operator <b>JAMES G. BROWN &amp; ASSOC.</b>			Lease <b>LIPSCOMB - HARRIS</b>		Well No. <b>51</b>
Unit Letter <b>G</b>	Section <b>2</b>	Township <b>13 SOUTH</b>	Range <b>38 EAST</b>	County <b>LEA</b>	
Actual Footage Location of Well: <b>1980</b> feet from the <b>NORTH</b> line and <b>1786</b> feet from the <b>EAST</b> line					
Ground Level Elev. <b>3793.3'</b>	Producing Formation <b>Wolfcamp</b>		Pool <b>Undesignated</b>	Dedicated Acreage: <b>40</b> Acres	

1. Is the Operator the only owner in the dedicated acreage outlined on the plat below? YES ☒ NO ☐ ("Owner" means the person who has the right to drill into and to produce from any pool and to appropriate the production either for himself or for himself and another. (65-3-29 (a) NMSA 1935 Comp.)
2. If the answer to question one is "no," have the interests of all the owners been consolidated by communitization agreement or otherwise? YES ☐ NO ☐ If answer is "yes," Type of Consolidation \_\_\_\_\_
3. If the answer to question two is "no," list all the owners and their respective interests below.

Owner	Land Description

**SECTION B**

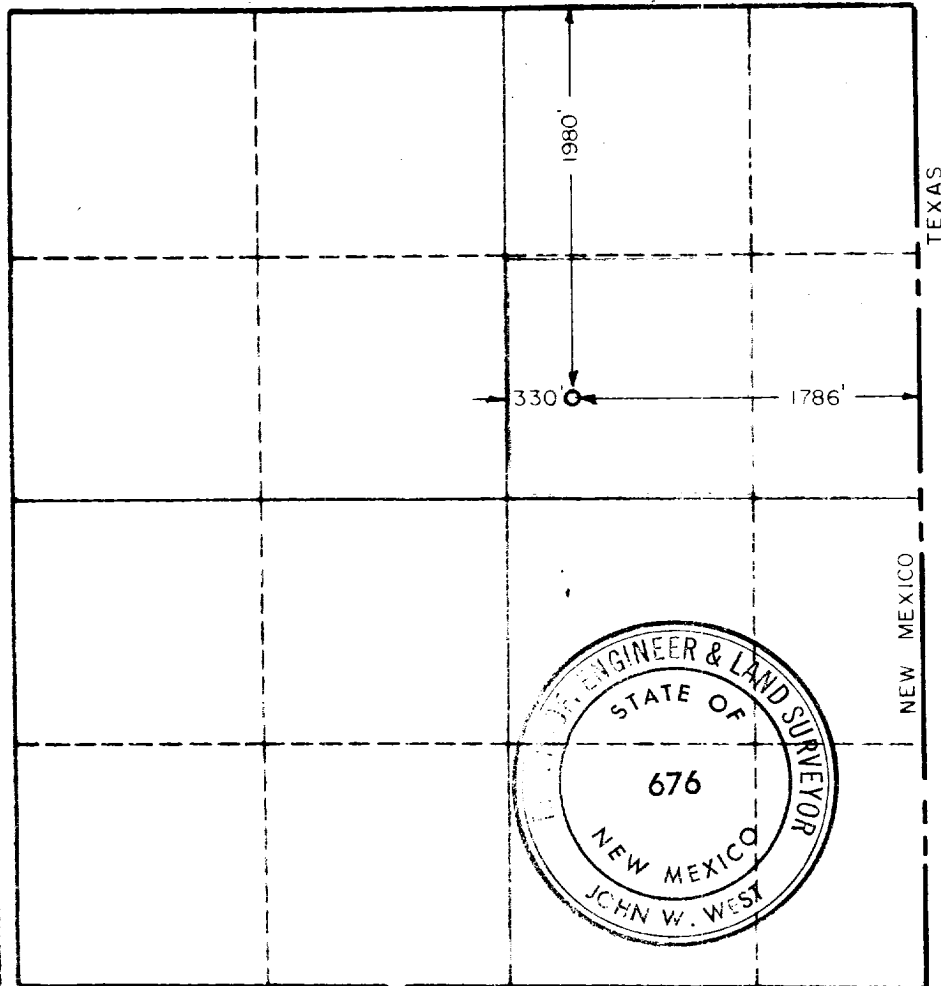

**CERTIFICATION**

I hereby certify that the information in SECTION A above is true and complete to the best of my knowledge and belief.

Name	<i>John W. West</i>
Position	<b>Agent</b>
Company	<b>James G. Brown &amp; Assoc</b>
Date	<b>July 6, 1962</b>

I hereby certify that the well location shown on the plat in SECTION B was plotted from field notes of actual surveys made by me or under my supervision, and that the same is true and correct to the best of my knowledge and belief.

Date Surveyed	<b>7-6-62</b>
Registered Professional Engineer and/or Land Surveyor,	<b>JOHN W. WEST</b>
Certificate No.	<i>John W. West</i>
<b>N. M. - P. E. &amp; L. S. NO. 676</b>	

