

COUNTY LEA FIELD Faun STATE NM 30-025-22886

OPR MWJ PRODUING CO MAP

1 Faun "F" State

Sec 4, T-14-S, R-33-E CO-ORD

1980' FSI, 660' FWL of Sec.

Spd 12-18-68

Cmp 1-17-69 CLASS EL

	FORMATION	DATUM	FORMATION	DATUM
CSG & SK - TUBING				
13 3/8" at 357' w/400 BX				
8 5/8" at 4080' w/300 BX				
5 1/2" at 10,036' w/300 SK				
LOGS EL GR RA IND HC A				

ID 10,040'; PBD 9990'

IP (Bough "C") Perf 9914-40' Swbd 309 BOPD + 290 BW. Pot based on 24 hr test. SKR 1122; Grav 42.5.

Distribution limited and publication prohibited by subscribers' agreement. Reproduction rights reserved by Williams & Lee Scouting Service, Inc.

CONT. Moran Drlg. Co. PROP DEPTH 10,100' TYPE

DATE

P.R. 12-12-68;
 H. 10,100' (Pennsylvanian)
 Contractor - Moran Drlg. Co.
 12-23-68 30" 4080'; WOC
 1-6-69 Drlg. 8818' Im
 1-13-69 ID 10,040'; PBD 9990'; MORT
 1-20-69 ID 10,040'; PBD 9990'; SI Storage
 Perf @ 9914', 9915', 9916', 9917', 9918',
 9921', 9922', 9926', 9927', 9928', 9936',
 9937', 9938', 9939', 9940'
 Acid (9914-40') 1500 gals (28%) + 2000 gals (3%)
 Swbd 6 BFPH (6% oil)
 1-27-69 ID 10,040'; PBD 9990'; SI Storage
 2-3-69 ID 10,040'; PBD 9990'; WO Potential
 2-10-69 ID 10,040'; PBD 9990'; COMPLETE

LEA
MWJ PRODUCING CO.

Baum NM Sec 4, T14S, R33E
1 Baum "B" State Page #2

2-10-69

Continued

LOG TOPS: Anhydrite 1687', Yates 2610',
San Andres 4050', Abo 7620', Wolfcamp
9276', Pennsylvanian 9768', Bough "C" 9907'

2-13-69

COMPLETION REPORTED

NEW MEXICO OIL CONSERVATION COMMISSION
WELL LOCATION AND ACREAGE DEDICATION PLAT

Form C-102
Supersedes C-128
Effective 1-1-65

All distances must be from the outer boundaries of the Section.

Operator MWJ Producing Company		Lease Baum B State Com		Well No. 1
Unit Letter L	Section 4	Township 14S	Range 33E	County Lea
Actual Footage Location of Well: 1980 feet from the South line and 660 feet from the West line				
Ground Level Elev. 4251 KB	Producing Formation Upper Penn	Pool Baum Upper Penn	Dedicated Acreage: 160 Acres	

1. Outline the acreage dedicated to the subject well by colored pencil or hachure marks on the plat below.
2. If more than one lease is dedicated to the well, outline each and identify the ownership thereof (both as to working interest and royalty). **All State of New Mexico leases with working interest ownership common to all.**
3. If more than one lease of different ownership is dedicated to the well, have the interests of all owners been consolidated by communitization, unitization, force-pooling, etc.?

Yes No If answer is "yes," type of consolidation communitization of 4-16-69 effective 1-16-69

If answer is "no," list the owners and tract descriptions which have actually been consolidated. (Use reverse side of this form if necessary.) _____

No allowable will be assigned to the well until all interests have been consolidated (by communitization, unitization, forced-pooling, or otherwise) or until a non-standard unit, eliminating such interests, has been approved by the Commission.

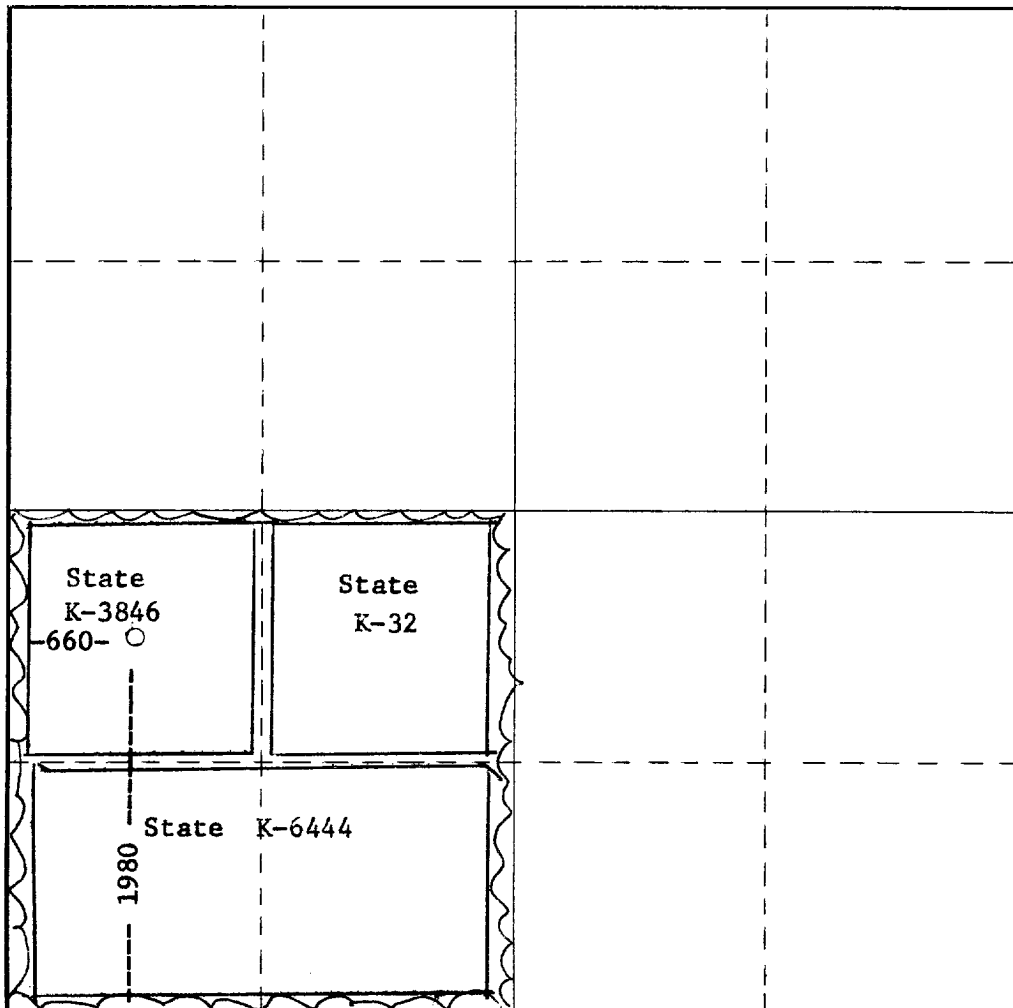

CERTIFICATION

I hereby certify that the information contained herein is true and complete to the best of my knowledge and belief.

Name *R. Ken Williams*

Position **R. Ken Williams**

Agent

Company

MWJ Producing Company

Date

4-30-69

I hereby certify that the well location shown on this plat was plotted from field notes of actual surveys made by me or under my supervision, and that the same is true and correct to the best of my knowledge and belief.

Date Surveyed

Registered Professional Engineer and/or Land Surveyor

Certificate No.

